

All distances must be from the outer boundaries of the Section.

Operator Texaco Inc.		Lease L. R. Kershaw		Well No. 11
Unit Letter D	Section 13	Township 20-S	Range 37-E	County Lea
Actual Footage Location of Well: 1654 feet from the North line and 990 feet from the West line				
Ground Level Elev. 3556	Producing Formation Seven Rivers Queen	Pool Eumont Yates 7 Rv Qn	Dedicated Acreage: 40 Acres	

1. Outline the acreage dedicated to the subject well by colored pencil or hatchure marks on the plat below.
2. If more than one lease is dedicated to the well, outline each and identify the ownership thereof (both as to working interest and royalty).
3. If more than one lease of different ownership is dedicated to the well, have the interests of all owners been consolidated by communitization, unitization, force-pooling, etc?

☐ Yes ☐ No If answer is "yes," type of consolidation _____

If answer is "no," list the owners and tract descriptions which have actually been consolidated. (Use reverse side of this form if necessary.) _____

No allowable will be assigned to the well until all interests have been consolidated (by communitization, unitization, forced-pooling, or otherwise) or until a non-standard unit, eliminating such interests, has been approved by the Division.

Reclassify to oil 9-1-88

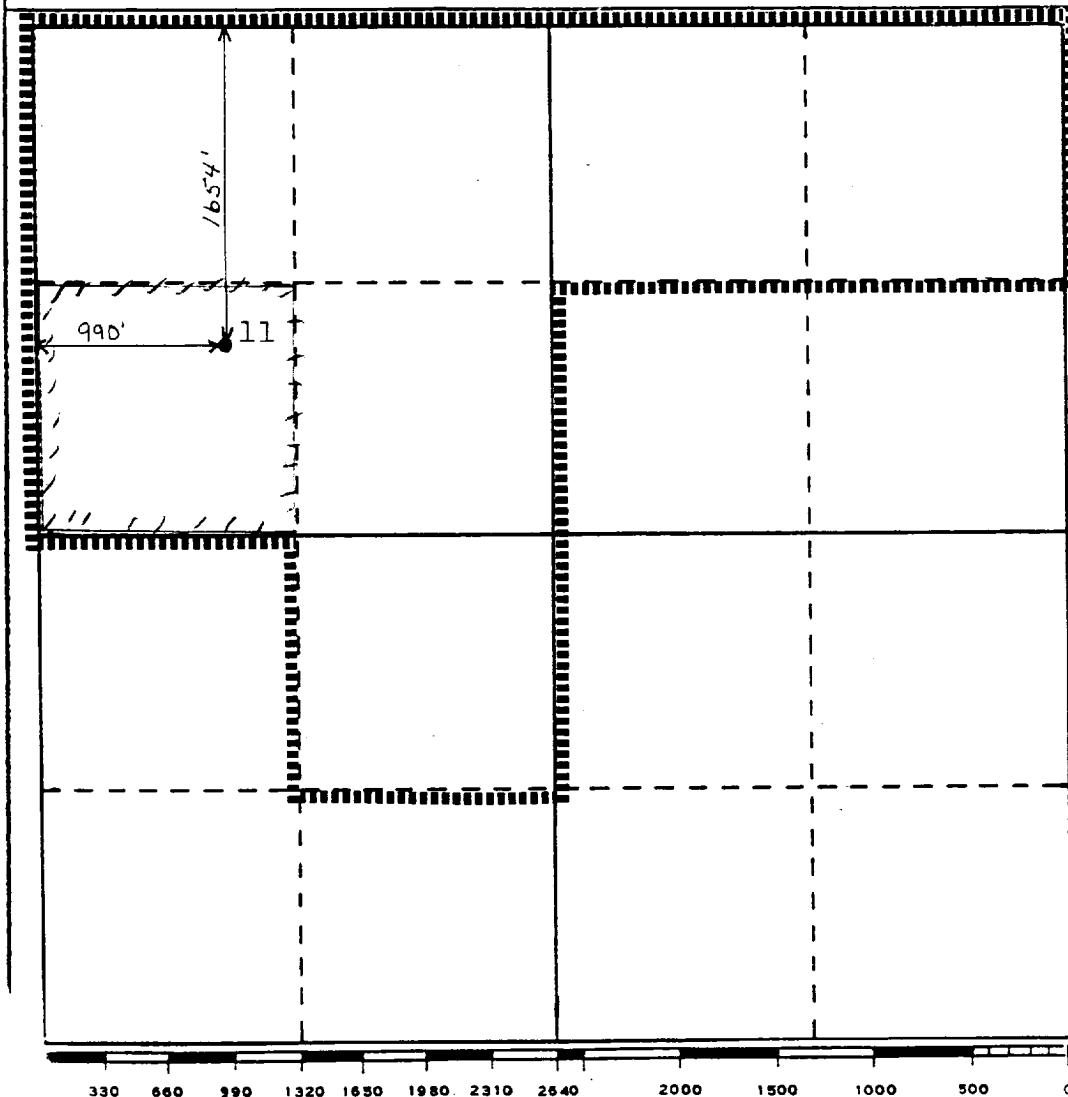

CERTIFICATION

I hereby certify that the information contained herein is true and complete to the best of my knowledge and belief.

S. R. Meck

Name

S. R. Meck

Position

Asst. Dist. Petr. Engr.

Company

Texaco Inc.

Date

August 4, 1988

I hereby certify that the well location shown on this plat was plotted from field notes of actual surveys made by me or under my supervision, and that the same is true and correct to the best of my knowledge and belief.

Date Surveyed

Registered Professional Engineer and/or Land Surveyor

Certificate No.

**NEW MEXICO OIL CONSERVATION COMMISSION
WELL LOCATION AND ACREAGE DEDICATION PLAT**

Form C-102
Supersedes C-128
Effective 1-1-65

All distances must be from the outer boundaries of the Section.

Operator TEXACO Inc.			Lease L. R. Kershaw		Well No. 11
Unit Letter E	Section 13	Township 20-S	Range 37-E	County Lea	
Actual Footage Location of Well: 1654 feet from the north line and 990 feet from the west line Sec. 13					
Ground Level Elev. 3556 Gr.	Producing Formation Seven Rivers Queen	Pool Eumont Yates		Dedicated Acreage: 160 Acres	

1. Outline the acreage dedicated to the subject well by colored pencil or hatchure marks on the plat below.
2. If more than one lease is dedicated to the well, outline each and identify the ownership thereof (both as to working interest and royalty).
3. If more than one lease of different ownership is dedicated to the well, have the interests of all owners been consolidated by communitization, unitization, force-pooling, etc?

☐ Yes ☐ No If answer is "yes," type of consolidation _____

If answer is "no," list the owners and tract descriptions which have actually been consolidated. (Use reverse side of this form if necessary.) _____

No allowable will be assigned to the well until all interests have been consolidated (by communitization, unitization, forced-pooling, or otherwise) or until a non-standard unit, eliminating such interests, has been approved by the Commission.

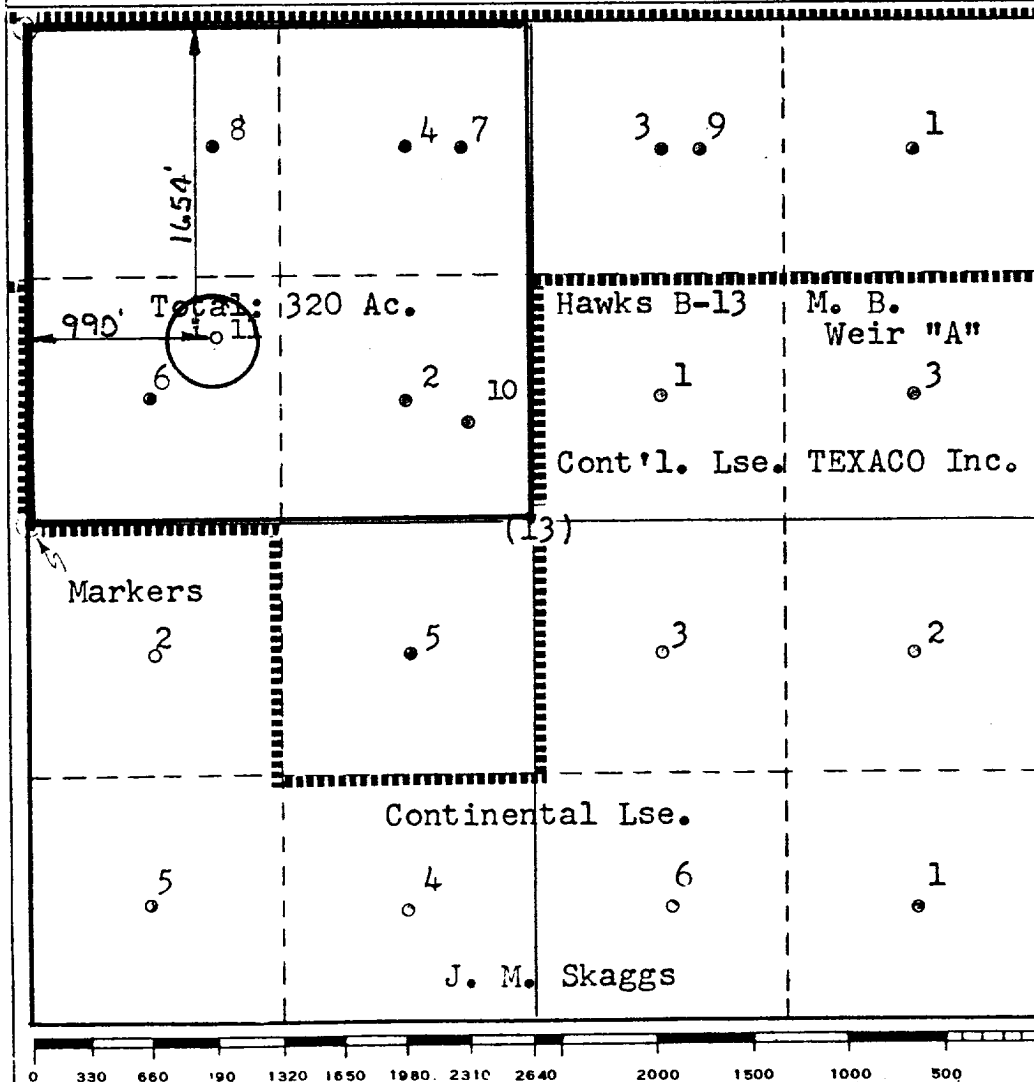

CERTIFICATION

I hereby certify that the information contained herein is true and complete to the best of my knowledge and belief.

B. L. Eiland

Name
B. L. Eiland

Position
Division Surveyor

Company
TEXACO Inc.

Date
Nov. 20, 1981

I hereby certify that the well location shown on this plat was plotted from field notes of actual surveys made by me or under my supervision, and that the same is true and correct to the best of my knowledge and belief.

Date Surveyed

Registered Professional Engineer and/or Land Surveyor

Certificate No.

RECEIVED

MAR 10 1982

**O.C.D.
HOBBS OFFICE**

WRS COMPLETION REPORTCOMPLETIONS SEC 13 TWP 20S RGE 37E
PI# 30-T-0010 06/19/92 30-025-21051-0001 PAGE 1NMEX LEA * 1654FNL 990FWL SEC SW NW
STATE COUNTY FOOTAGE SPOT
TEXACO EXPL & PROD D X D
OPERATOR WELL CLASS INIT FIN
11 KERSHAW L R
WELL NO. LEASE NAME
3566DF EUMONT
OPER ELEV. FIELD POOL AREAAPI 30-025-21051-0001
LEASE NO. PERMIT OR WELL I.D. NO.
09/01/1980 05/20/1992 WO-UNIT VERT D&AW
SPUD DATE COMP. DATE TYPE TOOL HOLE TYPE STATUS
5700 YT-SR-QN NOT RPTD
PROJ. DEPTH PROJ. FORM CONTRACTOR
DTD 6650 OTD 6650 FM/TD TUBB
DRILLERS T.D. LOG T.D. PLUG BACK TD OLD T.D. FORM T.D.**LOCATION DESCRIPTION**

5 MI SE MONUMENT, NM

CASING/LINER DATA

CMT PLUGS SET BELOW 1600 W/220 SX, SURF-1350 W/500 SX

PRODUCTION TEST DATABLINEBRY PERF 5753- 5890
TUBB PERF 6478- 6575
PERF 5753- 5890 6478- 6575
BRPG @ 5700 5753- 6575QUEEN PERF 3631- 3724 GROSS
PERF 3631, 3639, 3644, 3649, 3660, 3670, 3680, 3692
PERF 3700, 3704, 3715, 3724
CLAG 3631- 3724 2000GALS15% MCA
SWFR 3631- 3724 16000GALS 17500LBS SAND
VERSAGEL 4000 GALS CO2
20/40OPER SHUT OFF ORIG BLINEBRY & TUBB ZONES WHICH WERE
TEMP ABND 2/5/65. OPER THEN OPENED NEW PERFS IN QUEEN,
BUT DID NOT TEST WELL, PENDING PLC. NO OTHER FILINGS
ON RECORD @ OCD UNTIL OPER FILED PLUGGING NOTICE ON
NM OCD FORM C-103 ON 5/26/92. SPUD DATE IS ESTIMATED
FOR THIS OWWO.

CONTINUED IC# 300257020692

COPYRIGHT 1992

**Petroleum Information
Corporation**PI-WRS-GFT
Form No 187

COMPLETIONS SEC 13 TWP 20S RGE 37E
PI# 30-T-0010 06/19/92 30-025-21051-0001 PAGE 2

TEXACO EXPL & PROD D X D
11 KERSHAW L R

DRILLING PROGRESS DETAILS

TEXACO EXPL & PROD
BOX 3109
MIDLAND, TX 79702
915-688-4100

OWWO: OLD INFO: FORMERLY TEXACO INC #11 KERSHAW
L R. ELEV 3566 DF. SPUD 11/27/64. 8 5/8 @ 1366
W/600 SX, 2 7/8 @ 6647 W/800 SX. LOG TOPS: SAN
ANDRES 4060, GLORIETA 5270, TUBB 6402. OTD 6650.
PB 6615. TEMP ABND 2/5/65.

05/20 LOC/1992/
06/17 6650 TD
COMP 5/20/92, D&A
FIRST REPORT & COMPLETION

COUNTY	IEA	FIELD	Weir, East &/	STATE	N.M.
OPR	TEXACO INC.	Undesignated			MAP
11 Kershaw, L. R.					
Sec. 13, T-20-S, R-37-E					
1654' fr N Line & 990' fr W Line of Sec.					
Spud 11-27-64					
Temp Abd 2-5-65					
CSG & SX - TUBING		LOG:			
8 5/8"	1366'	600	Yates	2710	
2 7/8"	6647)	800	Queen	3500	
2 7/8"	6647')		SA	4060	
			Glor	5270	
			Tubb	6402	
LOGS EL GR RA IND HC A		TD 6650', PBD 6615'			

TEMPORARILY ABANDONED

Distribution limited and publication prohibited by subscribers' agreement.
Reproduction rights reserved by Williams & Lee Scouting Service, Inc.

CONT.	PROP DEPTH	6650'	TYPE
DATE			

F. R. 11-5-64.
 PD 6650' - Blinebry & Tubb.
 11-30-64 Drlg. 2602' anhy & salt.
 12-7-64 Drlg. 5035'.
 12-14-64 TD 6650', prep to run csg.
 12-21-64 TD 6650', prep to perf.
 1-4-65 TD 6650', PB 6615', SI.
 Perf. (Blinebry) @ 5753', 5792', 5800', 5815',
 5822', 5845', 5869', 5890' W/2 SPI.
 Ac. 500 gals.
 Swbd. 40 BAW/7 hrs.
 Re-Ac. 1600 gals. 5753-5890'
 Swbd. 48 BAW/11 hrs.
 Frac. 15,000 gals. oil + 15,000# sd. 5753-5890'
 Swbd. 26 BLO/8½ hrs. & swbd. dry.

- cont'd -

1-4-65 - cont. -
Perf (Tubb) @ 6478', 6491', 6503', 6534',
6541', 6560', 6575', W/2 SPI
Ac. 500 gals.
Swbd 48 BAW/6 hrs.
Re-Ac. 1400 gals. 6478-6575'
Swbd 62 BAW/7 hrs & swbd dry.
Frac 15,000 gals oil + 10,000# sd. 6478-6575'
Swbd 4 BLO + 16 BFW/2½ hrs & swbd dry.
(-340 BLO)
1-11-65 TD 6650', PBD 6615', tstg Blinebry
Pmpd 2 BLO/72 hrs from perfs 5753-5890'.
1-18-65 TD 6650', PBD 6615', tstg.
Pmpd 5 BLO/20 hrs from perfs 5753-5890'.
1-25-65 TD 6650', PBD 6615', SI.
Swbd 22 BLO + 48 BFW/8 hrs 6478-6575'.

Blinebry (-248 BLO); Tubb (-353 BLO).
2-1-65 TD 6650', PBD 6615', SI.
2-8-65 TD 6650', PBD 6615', TEMPORARILY ABANDONED.
(Holding for Secondary Recovery)