

30-025-29946

NO. OF COPIES RECEIVED	
DISTRIBUTION	
SANTA FE	
FILE	
U.S.G.S.	
LAND OFFICE	
OPERATOR	

NEW MEXICO OIL CONSERVATION COMMISSION

Form C-101
Revised 1-1-65

5A. Indicate Type of Lease
STATE FEE

5. State Oil & Gas Lease No.

APPLICATION FOR PERMIT TO DRILL, DEEPEN, OR PLUG BACK

1a. Type of Work

b. Type of Well DRILL DEEPEN PLUG BACK
OIL WELL GAS WELL OTHER injector SINGLE ZONE MULTIPLE ZONE

7. Unit Agreement Name
Eunice Monument South Unit
8. Farm or Lease Name

2. Name of Operator
Chevron U.S.A. Inc.

9. Well No.
148

3. Address of Operator
P.O. Box 670, Hobbs, NM 88240

10. Field and Pool, or Wildcat
Eunice Monument G/SA

4. Location of Well UNIT LETTER G LOCATED 2180 FEET FROM THE North LINE
AND 1980 FEET FROM THE East LINE OF SEC. 31 TWP. 20S RGE. 37E NMPM

12. County
Lea

19. Proposed Depth 4200
19A. Formation Grayburg/SA
20. Rotary or C.T.I. rotary

21. Elevations (Show whether DF, RT, etc.) 3532.8' GLE
21A. Kind & Status Plug. Bond --
21B. Drilling Contractor Not known
22. Approx. Date Work will start ASAP

PROPOSED CASING AND CEMENT PROGRAM

SIZE OF HOLE	SIZE OF CASING	WEIGHT PER FOOT	SETTING DEPTH	SACKS OF CEMENT	EST. TOP
12 1/4"	8 5/8"	24#	1350'	800	surf
7 7/8"	5 1/2"	15.5#	4200'	650	surf

Mud Program: 0' - 1350' FW Spud
1350' - 4200' Brine Water Starch 10ppg, 31vis, 9ph.

See Attached BOP drawing for 3000 psi working pressure.

The Aggies State #6, located in the same quarter-quarter section is operated by Exxon and was P&A'D 4-7-87.

R 7766 Inj

IN ABOVE SPACE DESCRIBE PROPOSED PROGRAM: IF PROPOSAL IS TO DEEPEN OR PLUG BACK, GIVE DATA ON PRESENT PRODUCTIVE ZONE AND PROPOSED NEW PRODUCTIVE ZONE. GIVE BLOWOUT PREVENTER PROGRAM, IF ANY.

I hereby certify that the information above is true and complete to the best of my knowledge and belief.

Signed M. E. Albin Title STAFF DRILLING ENGINEER Date 6-8-87

(This space for State Use)

ORIGINAL SIGNED BY JERRY SEXTON
APPROVED BY DISTRICT 1 SUPERVISOR TITLE _____ DATE _____

CONDITIONS OF APPROVAL, IF ANY: _____ DATE _____

Permit Expires 6 Months From Approval Date Unless Drilling Underway.

NEW MEXICO OIL CONSERVATION COMMISSION
WELL LOCATION AND ACREAGE DEDICATION PLAT

Form C-102
Supersedes C-128
Effective 1-1-65

All distances must be from the outer boundaries of the Section

Operator CHEVRON USA INC.		Lease EMSU			Well No. 148 WI
Grid Letter G	Section 31	Township 20 SOUTH	Range 37 EAST	County LEA	
Actual Footage Location of Well:					
2180 feet from the NORTH line and		1980 feet from the EAST line			
Ground Level Elev. 3532.3	Producing Formation Grayburg	Pool Grayburg/San Andres		Dedicated Acreage: 40 Acres	

1. Outline the acreage dedicated to the subject well by colored pencil or hachure marks on the plat below.
2. If more than one lease is dedicated to the well, outline each and identify the ownership thereof (both as to working interest and royalty).
3. If more than one lease of different ownership is dedicated to the well, have the interests of all owners been consolidated by communitization, unitization, force-pooling, etc?

Yes No If answer is "yes," type of consolidation unitization, Eunice Monument#South Unit

If answer is "no," list the owners and tract descriptions which have actually been consolidated. (Use reverse side of this form if necessary.) _____

No allowable will be assigned to the well until all interests have been consolidated (by communitization, unitization, forced-pooling, or otherwise) or until a non-standard unit, eliminating such interests, has been approved by the Commission.

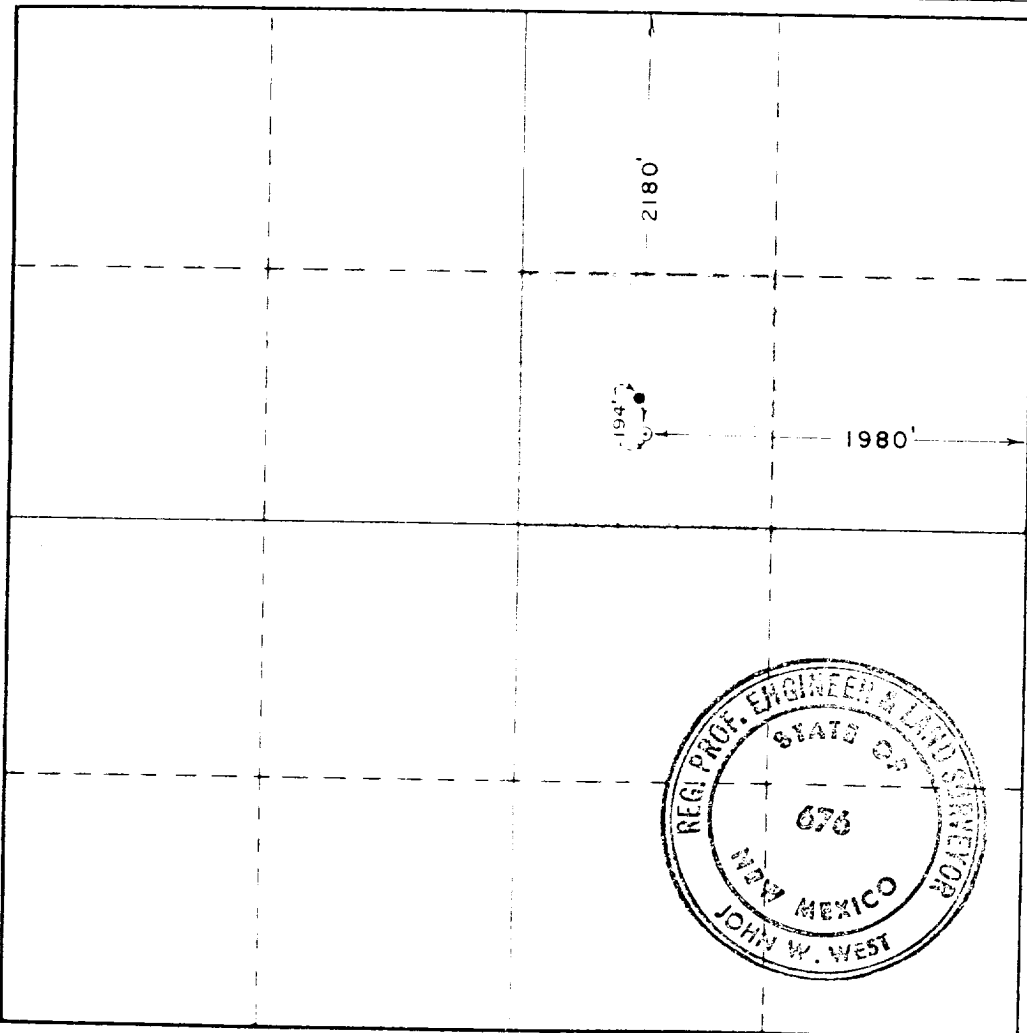

CERTIFICATION

I hereby certify that the information contained herein is true and complete to the best of my knowledge and belief.

M. E. Akins

Name M. E. Akins
Position Staff Drilling Engineer
Company Chevron U.S.A. Inc.
Date June 8, 1987

I hereby certify that the well location shown on this plat was plotted from field notes of actual surveys made by me or under my supervision, and that the same is true and correct to the best of my knowledge and belief.

Date Surveyed JUNE 2, 1987
Registered Professional Engineer and/or Land Surveyor <i>John W. West</i>

Certificate No. JOHN W. WEST, 676
RONALD J. EIDSON, 3239

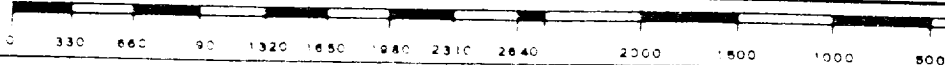

96560

HOBBS DIVISION

CLASS THREE PREVENTER

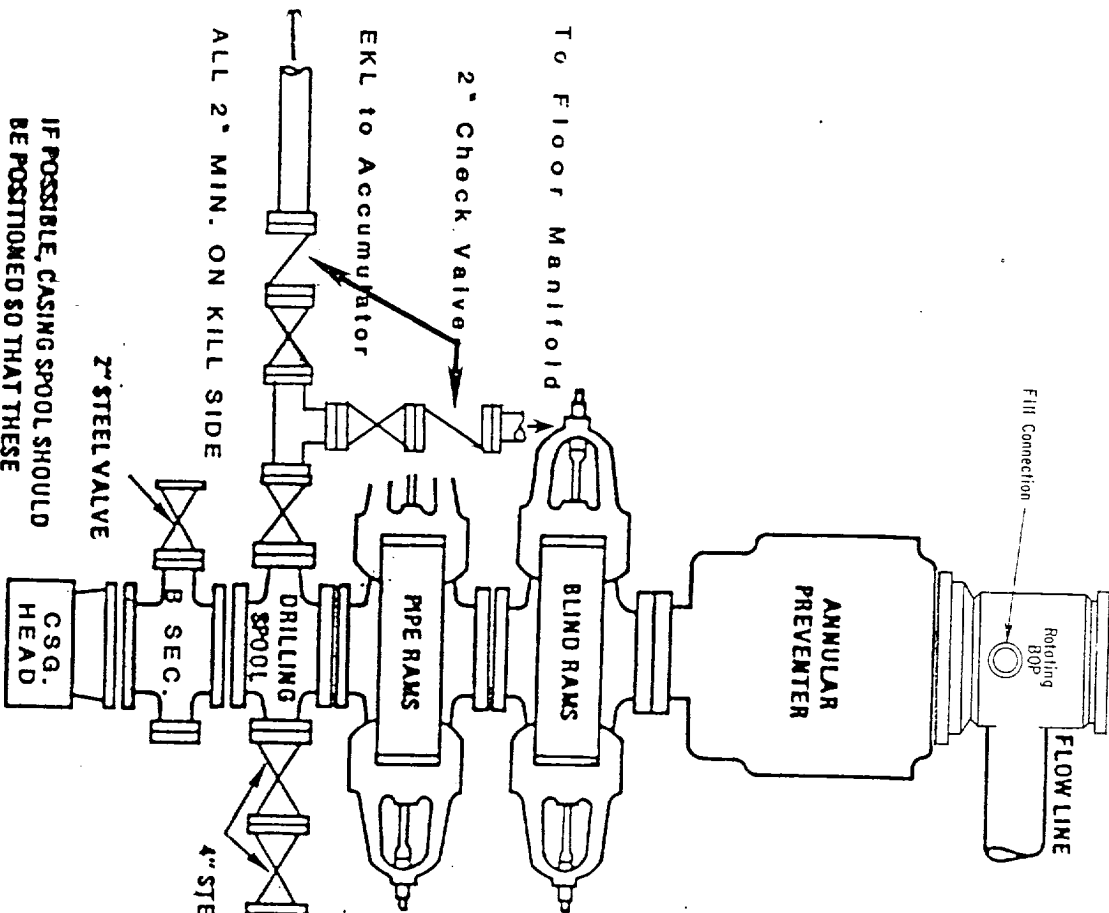

IF POSSIBLE, CASING SPOOL SHOULD BE POSITIONED SO THAT THESE VALVES ARE DIRECTLY UNDER THE BARREL OF THE RAM PREVENTER

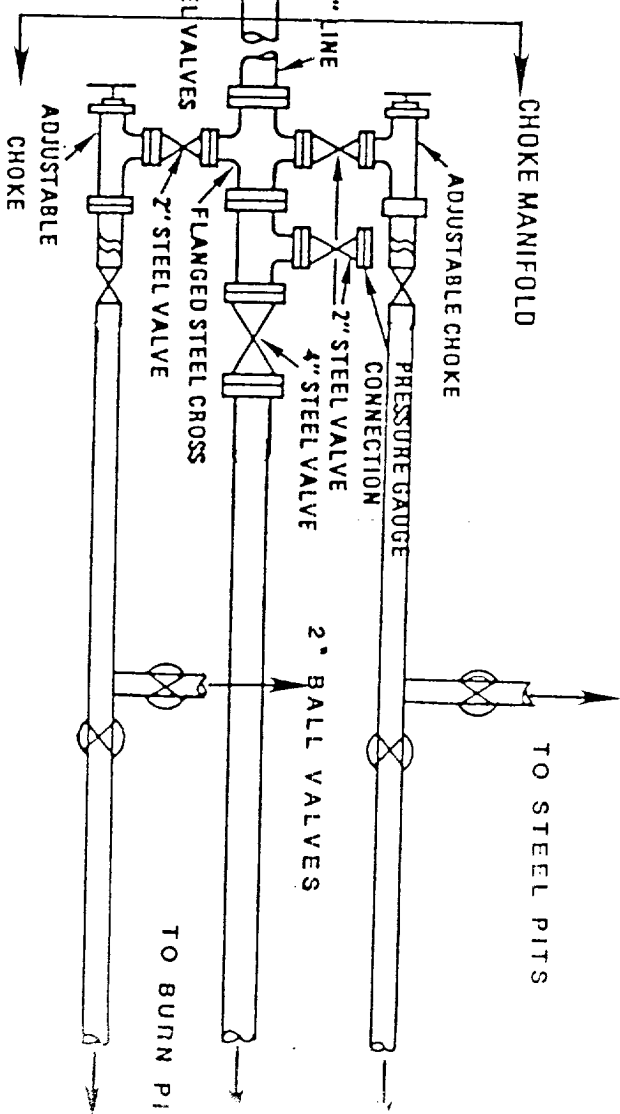

Beyond Edge of Derrick Floor

The blowout preventer shall be nipped up as needed and a spare set of drill pipe rams shall be on location. The ram preventors may be two single or double type connecting on the choke line (4") and the kill line (2"). A set of spare flange bolts and nuts shall be on the rig floor. The accumulator shall be sufficient to install a rotating blowout preventer. The accumulator shall be powered with two pumps. One shall be powered with air, the total accumulator pressure shall be 350psi. The pressurized fluid in the accumulator shall be sufficient to close all pressure operated devices installed in the well with the exception of the ram preventer. A remote closing manifold shall be installed with the accumulator. The accumulator shall be not less than 100 gal. A remote closing manifold shall have a reserve of at least 50 percent of the original manifold and remote shall have a reserve for each pressure-operated device. Controls shall be labeled as to device and opened or closed. A pressure-reducer and accumulator shall be installed in the line to be set in the line. The accumulator shall be connected to the accumulator to the preventer for operation. The accumulator shall be placed away from the rig floor. The distance is specified in contract. Hydraulic fluid must meet API specifications. The choke manifold and all lines are to be supported by metal stands and securely anchored. The choke manifold shall be as straight as possible and with out sharp turns. The choke flow line, rafter lines and choke lines shall be constructed with the edge of the manifold, universal joints if needed, and hand wheels which extend beyond the manifold. All other valves shall be equipped with handles.

WRS COMPLETION REPORT

COMPLETIONS SEC 31 TWP 20S RGE 37E
PI# 30-T-0014 09/28/87 30-025-29946-0000 PAGE 1

NMEX LEA * 2180FNL 1980FEL SEC SW NE
STATE COUNTY FOOTAGE SPOT
CHEVRON USA IW IW
OPERATOR WELL CLASS INIT FIN
WI-148 EUNICE-MONUMENT SOUTH UNIT
WELL NO LEASE NAME
3533GR EUNICE-MONUMENT
OPER ELEV FIELD POOL AREA
API 30-025-29946-0000
LEASE TYPE NO PERMIT OR WELL I.D. NO
07/08/1987 08/21/1987 ROTARY W-INJ
SPUD DATE COMP. DATE TYPE TOOL STATUS
4200 GRBG-SAD EXETER DRLG 74
PROJ. DEPTH PROJ. FORM CONTRACTOR
DTD 3900 PB 3890 FM/TD SN ANDRS
DRILLERS T.D. LOG T.D. PLUG BACK TD. OLD T.D. FORM T.D.

LOCATION DESCRIPTION

7 MI S MONUMENT, NM

CASING/LINER DATA

CSG 8 5/8 @ 1080 W/ 700 SACKS
CSG 5 1/2 @ 3900 W/ 675 SACKS

TYPE	FORMATION	LTH	TOP	DEPTH/SUB	BSE	DEPTH/SUB
LOG	RUSTLER		1060	2473		
LOG	SALT		1195	2338		
LOG	YATES		2868	665		
LOG	SVN RVRS		3090	443		
LOG	QUEEN		3316	217		
LOG	GRAYBURG		3617	-84		

PRODUCTION TEST DATA

SN ANDRS PERF W/ 47/IT 3816- 3866 GROSS
PERF 3816- 3829 3832- 3866
ACID 3816- 3866 3500GALS
NEFE HCL

GRAYBURG PERF W/ 68/IT 3648- 3804 GROSS
PERF 3648- 3656 3664- 3670 3692- 3710 3738- 3750
PERF 3777- 3792 3795- 3804
ACID 3648- 3804 3500GALS
15% NEFE HCL

CONTINUED IC# 300257017087

COMPLETIONS SEC 31 TWP 20S RGE 37E
PI# 30-T-0014 09/28/87 30-015-29946-0000 PAGE 2

CHEVRON USA EUNICE-MONUMENT SOUTH UNIT IW IW
WI-148

LOGS AND SURVEYS /INTERVAL,TYPE/

LOGS GR CBL CET

DRILLING PROGRESS DETAILS

CHEVRON USA
BOX 670
HOBBS, NM 88240
505-393-4121
WATER INJECTION WELL
06/12 LOC/1987
07/09 1080 TD, PREP RUN CSG
08/13 3900 TD, PE 389C, PREP ACID
08/21 3900 TD, PE 389C, WC INJ
09/24 3900 TD, PE 389C
COMP 8/2 /87, WIW
INJ ZONE - GRAYBURG-SAN ANDRES 3648-3866
NO CORES OF DSTS RPTD