

NEW MEXICO OIL CONSERVATION COMMISSION
WELL LOCATION AND ACREAGE DEDICATION

Form C-102
 Supersedes C-128
 Effective 1-1-65

All distances must be from the outer boundaries of the Section.

Operator TEXACO Inc.		Lease J. K. Rector			Well No. 3
Unit Letter J	Section 30	Township 21 South	Range 36 East	County Lea	
Actual Footage Location of Well: 2310 feet from the South line and 1650 feet from the East line Sec. 30					
Ground Level Elev. 3634'	Producing Formation Penrose	Pool Eumont Oil		Dedicated Acreage: Acres	

1. Outline the acreage dedicated to the subject well by colored pencil or hachure marks on the plat below.
2. If more than one lease is dedicated to the well, outline each and identify the ownership thereof (both as to working interest and royalty).
3. If more than one lease of different ownership is dedicated to the well, have the interests of all owners been consolidated by communitization, unitization, force-pooling, etc?

Yes No If answer is "yes," type of consolidation _____

If answer is "no," list the owners and tract descriptions which have actually been consolidated. (Use reverse side of this form if necessary.) _____

No allowable will be assigned to the well until all interests have been consolidated (by communitization, unitization, forced-pooling, or otherwise) or until a non-standard unit, eliminating such interests, has been approved by the Commission.

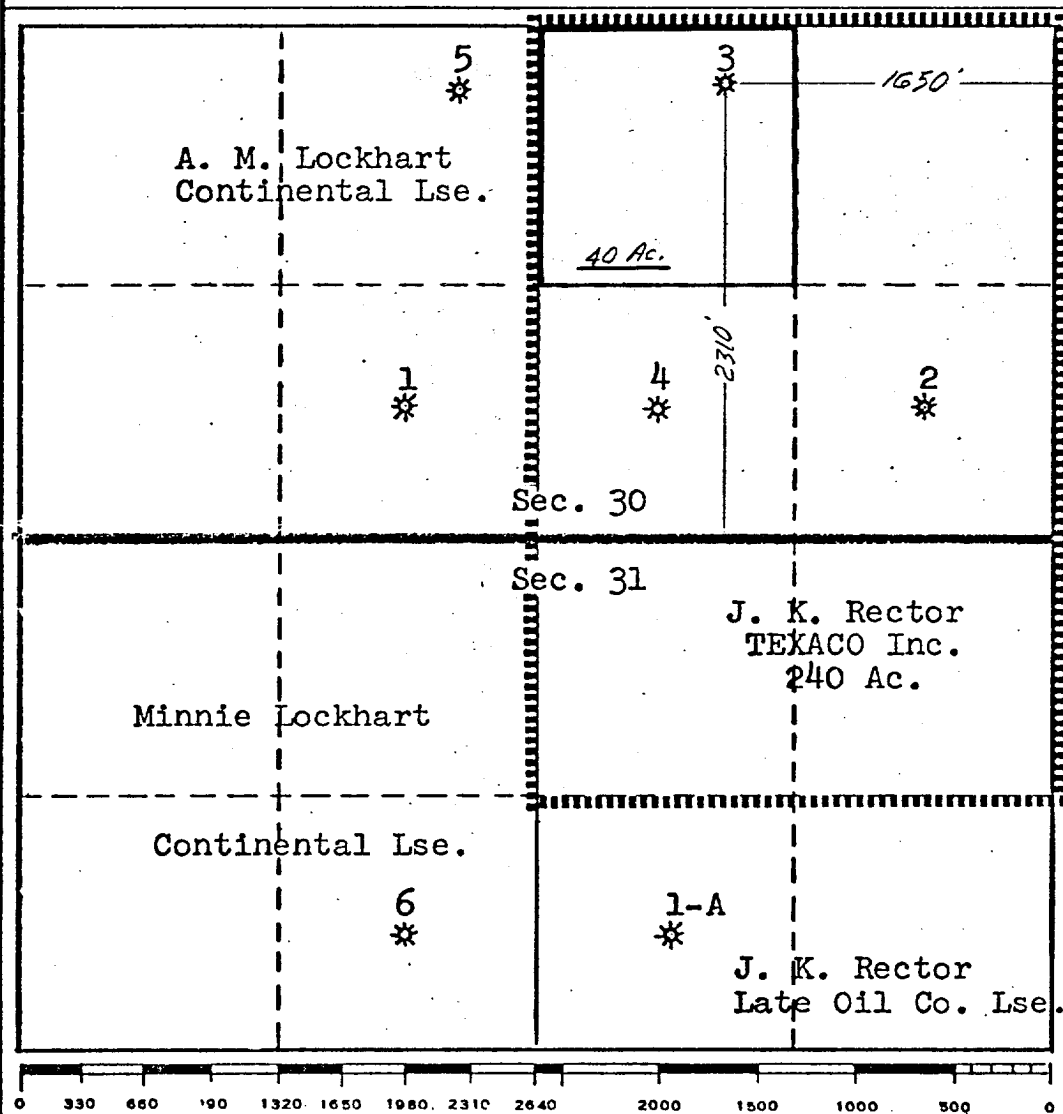

CERTIFICATION	
I hereby certify that the information contained herein is true and complete to the best of my knowledge and belief.	
<i>B. L. Eiland</i>	
Name	B. L. Eiland
Position	Division Surveyor
Company	Texaco Inc.
Date	4-29-77
I hereby certify that the well location shown on this plat was plotted from field notes of actual surveys made by me or under my supervision, and that the same is true and correct to the best of my knowledge and belief.	
Date Surveyed	1-11-37
Registered Professional Engineer and/or Land Surveyor	<i>B. L. Eiland</i> B. L. Eiland
Certificate No.	4386

NEW MEXICO
OIL CONSERVATION COMMISSION

Gas Well Plat

Date January 28, 1954

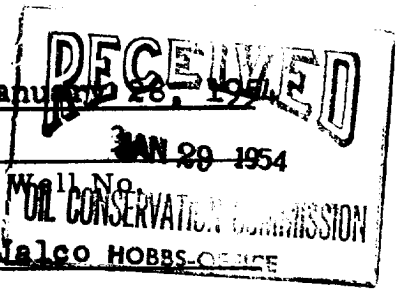

The Texas Company
Operator

J. K. Rector
Lease

Name of Producing Formation Seven Rivers Pool

Well No. _____
OIL CONSERVATION COMMISSION
JALCO HOBBS-OFFICE

No. Acres Dedicated to the Well 80

SECTION 30 TOWNSHIP 21S RANGE 36E

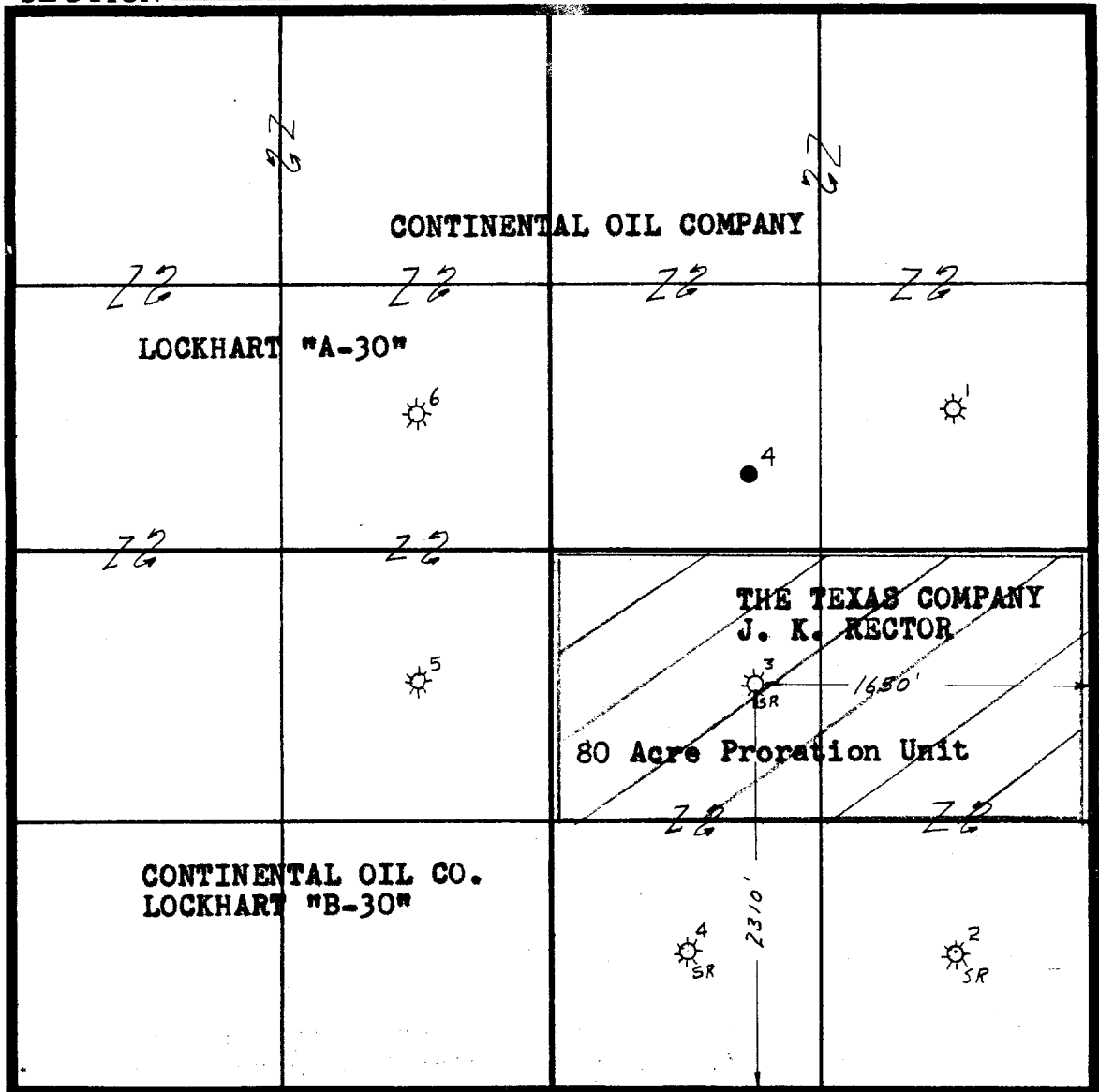

I hereby certify that the information given above is true and complete to the best of my knowledge.

Name J. J. [Signature]
Position Division Civil Engineer
Representing The Texas Company
Address P.O. Box 1720, Ft. Worth, Texas

(over)

INSTRUCTIONS

1. In this case will a dual completion? Yes _____ No Y
2. If the answer to question 1 is "yes", are there any other dually completed wells within the dedicated acreage? Yes _____ No N

NEW MEXICO OIL CONSERVATION COMMISSION
WELL LOCATION AND ACREAGE DEDICATION PLAT

FORM C-120
 Revised 5/1/57

SEE INSTRUCTIONS FOR COMPLETING THIS FORM ON THE REVERSE SIDE

SECTION A

Operator TEXACO Inc.		Lease J. K. Rector			Well No. 3
Unit Letter J	Section 30	Township 21 South	Range 36 East	County Lea	
Actual Footage Location of Well: 2310 feet from the South line and 1650 feet from the East line Sec. 30					
Ground Level Elev. 3634	Producing Formation Penrose		Pool Eumont Gas	Dedicated Acreage: 120 Acres	

1. Is the Operator the only owner in the dedicated acreage outlined on the plat below? YES NO ("Owner" means the person who has the right to drill into and to produce from any pool and to appropriate the production either for himself or for himself and another. (65-3-29 (e) NMSA 1935 Comp.)
2. If the answer to question one is "no," have the interests of all the owners been consolidated by communitization agreement or otherwise? YES NO . If answer is "yes," Type of Consolidation _____
3. If the answer to question two is "no," list all the owners and their respective interests below:

Owner	Land Description

SECTION B

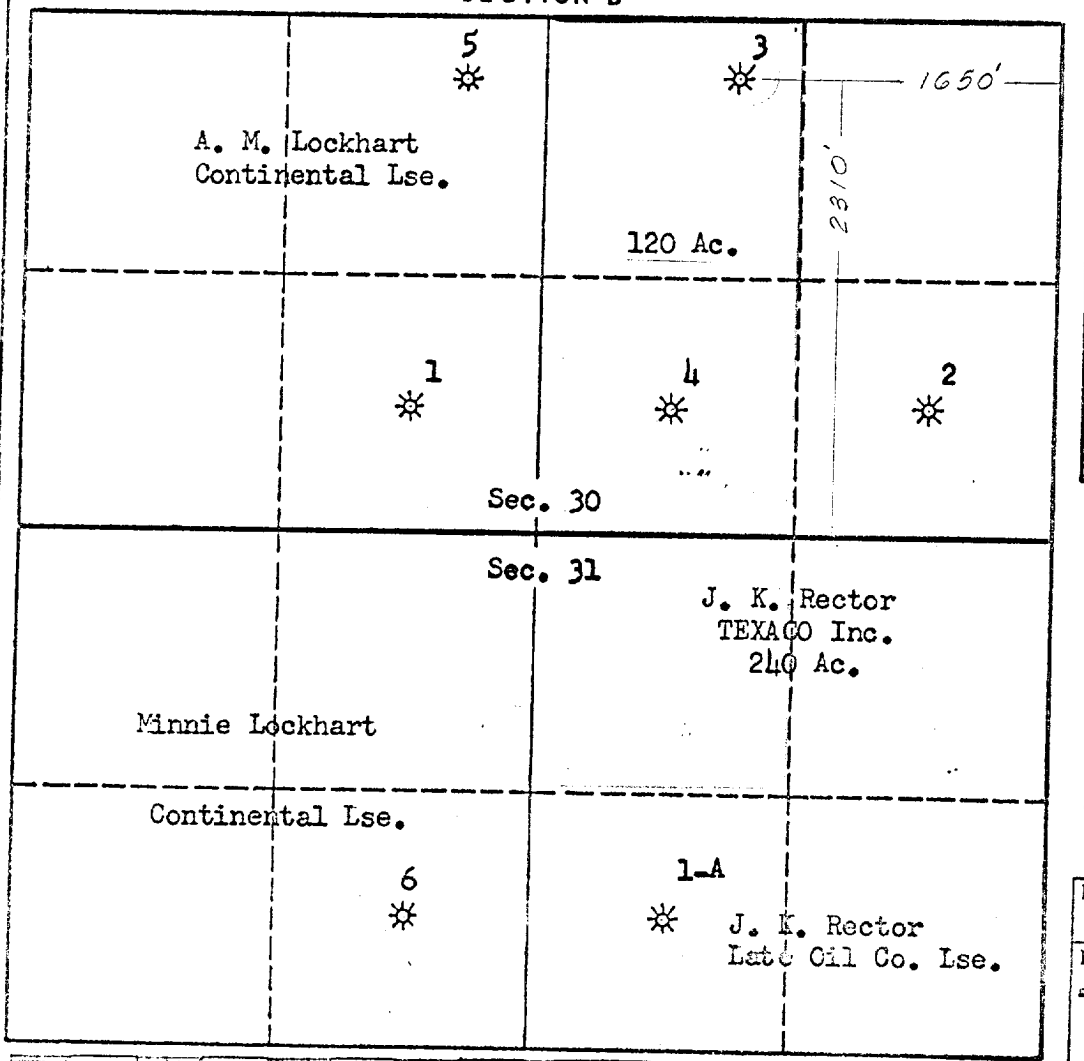

CERTIFICATION

I hereby certify that the information in SECTION A above is true and complete to the best of my knowledge and belief.

Name <i>J. J. Velten</i>
Position Division Civil Engineer
Company TEXACO Inc.
Date 11/30/62

I hereby certify that the well location shown on the plat in SECTION B was plotted from field notes of actual surveys made by me or under my supervision, and that the same is true and correct to the best of my knowledge and belief.

Date Surveyed 1/11/37
Registered Professional Engineer and/or Land Surveyor <i>J. J. Velten</i>
Certificate No. 8174

