

To: Hobbs OIL



NSP - 494  
Due June 12, 1957  
(2.66)

**Magnolia Petroleum Company**

**A Second Mobil Company  
Legal Department**

P. O. BOX 900 • DALLAS 21, TEXAS

14 May 1959

NSP - 495 (Blaine) (Blaine)  
NSL - 190

CHARLES B. WALLACE  
GENERAL COUNSEL  
R. T. WILKINSON, JR.  
ASSOCIATE GENERAL COUNSEL  
FRANK C. BOLTON, JR.  
GENERAL ATTORNEY  
WENDELL J. DOGGETT  
JACK E. EARNEST  
SAM H. FIELD  
JAMES T. FITZPATRICK  
JAMES E. HORGAN  
ROSS MACOLE  
WALLACE G. MALONE  
ROY L. MERRILL  
FLOYD B. PITTS  
WILLIAM B. RICHARDSON  
W. FOREST SMITH  
WILLIAM H. TABB  
JACK VICKREY  
ASSISTANT

Continental Oil Company  
Roswell, New Mexico

Sinclair Oil & Refining Company  
Roswell, New Mexico

Gulf Oil Corporation  
Roswell, New Mexico

Gentlemen:

Attached is Magnolia's application for administrative approval for an unorthodox well location and for a non-standard proration unit for the #1 D. A. Williamson in the Blaine and Tubb Gas Pools, Lea County, New Mexico. Please examine the application and make any objections known to the Oil Conservation Commission within twenty days.

Yours very truly,

*Jack Vickrey*  
Jack Vickrey  
Attorney For  
Magnolia Petroleum Company

DDL:sa  
Atch.  
cc - Oil Conservation Commission

NEW MEXICO OIL CONSERVATION COMMISSION

Well Location and Acreage Dedication Plat

Section A.

Date April 28, 1959

Operator Magnolia Petroleum Company Lease D. A. Williamson  
 Well No. 1 Unit Letter \_\_\_\_\_ Section 23 Township 21S Range 37E NMPM  
 Located 660 Feet From North Line, 760 Feet From East Line  
 County Lea G. L. Elevation \_\_\_\_\_ Dedicated Acreage 40 Acres  
 Name of Producing Formation Tubbs Pool Tubbs

1. Is the Operator the only owner\* in the dedicated acreage outlined on the plat below?  
 Yes 3 No \_\_\_\_\_
2. If the answer to question one is "no," have the interests of all the owners been consolidated by communitization agreement or otherwise? Yes \_\_\_\_\_ No \_\_\_\_\_. If answer is "yes," Type of Consolidation \_\_\_\_\_
3. If the answer to question two is "no," list all the owners and their respective interests below:

Owner

Land Description

<u>Owner</u>	<u>Land Description</u>

Section B

589°57' W (Call), 79.96 ft.

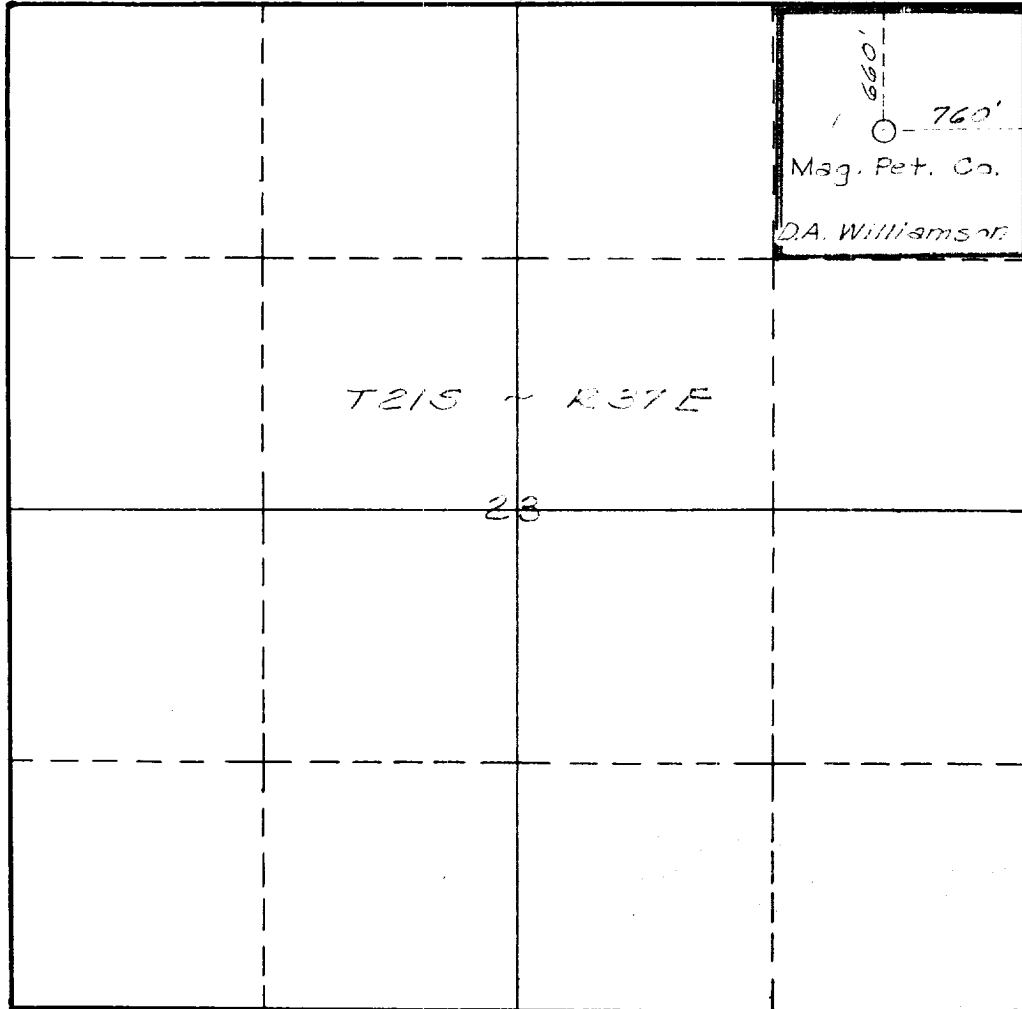

This is to certify that the information in Section A above is true and complete to the best of my knowledge and belief.

Magnolia Petroleum Company  
 (Operator)  
Lee E. Robinson  
 (Representative)

Box 2406, Hobbs, New Mexico  
 Address

This is to certify that the well location shown on the plat in Section B was plotted from field notes of actual surveys made by me or under my supervision and that the same is true and correct to the best of my knowledge and belief.

Date Surveyed 8-11-58

f. J. Godfrey, Jr.  
 Registered Professional  
 Engineer and/or Land Surveyor.

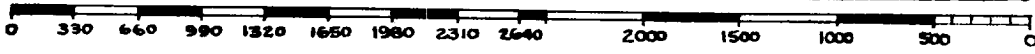

(See instructions for completing this form on the reverse side)

Certificate No. 2663

INSTRUCTIONS FOR COMPLETION

1. Operator shall furnish and certify to the information called for in Section A.
2. Operator shall outline the dedicated acreage for both oil and gas wells on the plat in Section B.
3. A registered professional engineer or land surveyor registered in the State of New Mexico or approved by the Commission shall show on the plat the location of the well and certify this information in the space provided.
4. All distances shown on the plat must be from the outer boundaries of Section.
5. If additional space is needed for listing owners and their respective interests as required in question 3, Section A, please use space below

\* "Owner" means the person who has the right to drill into and to produce from any pool and to appropriate the production either for himself or for himself and another. (65-3-29 (e) NMSA 1953 Comp.)

NEW MEXICO OIL CONSERVATION COMMISSION

Well Location and Acreage Dedication Plat

Section A.

Date April 28, 1959

Operator Magnolia Petroleum Company Lease D. A. Williamson  
 Well No. 1 Unit Letter \_\_\_\_\_ Section 23 Township 21S Range 37E NMPM  
 Located 660 Feet From North Line, 760 Feet From East Line  
 County Lea G. L. Elevation \_\_\_\_\_ Dedicated Acreage 40 Acres  
 Name of Producing Formation Blinberry Pool Blinberry

1. Is the Operator the only owner\* in the dedicated acreage outlined on the plat below?  
 Yes  No \_\_\_\_\_
2. If the answer to question one is "no," have the interests of all the owners been consolidated by communitization agreement or otherwise? Yes \_\_\_\_\_ No \_\_\_\_\_. If answer is "yes," Type of Consolidation \_\_\_\_\_
3. If the answer to question two is "no," list all the owners and their respective interests below:

Owner

Land Description

Section B

S89° 57' W (Call) 79.96 ch.

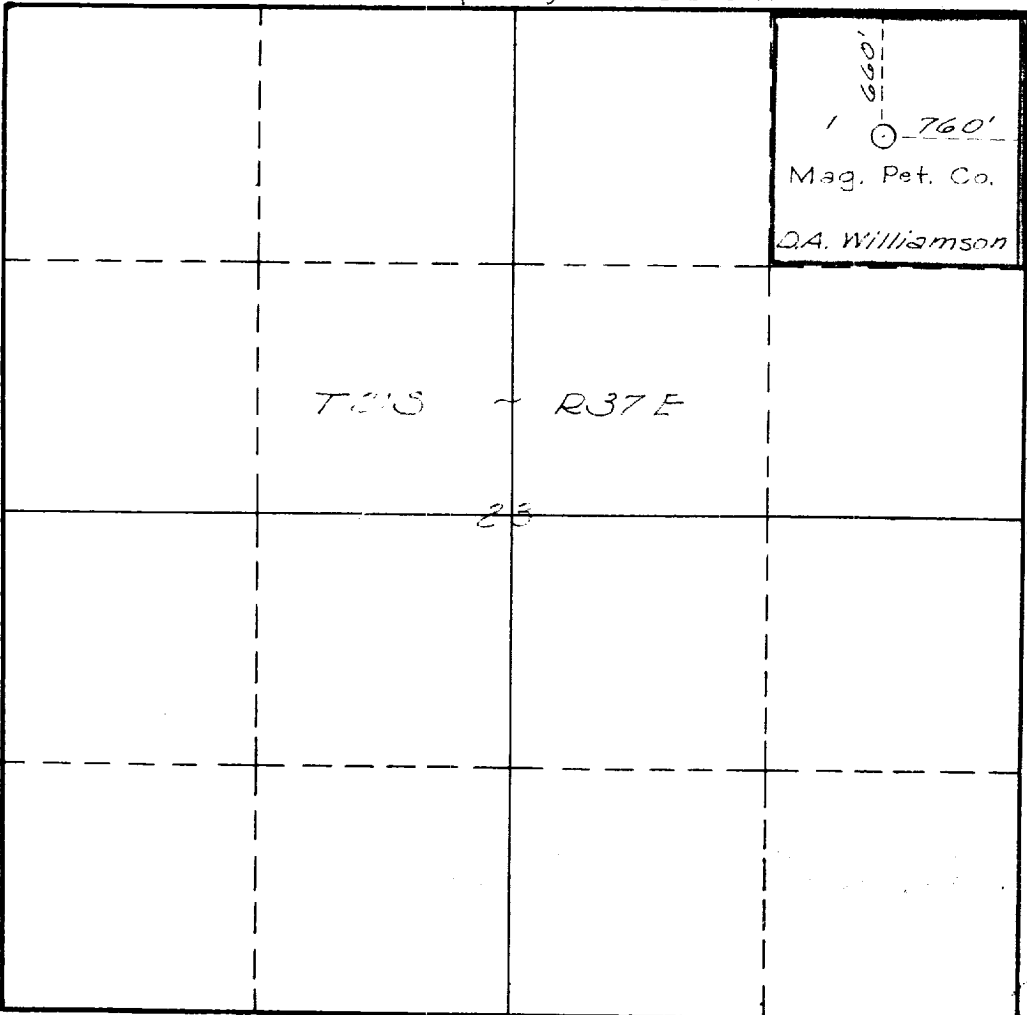

This is to certify that the information in Section A above is true and complete to the best of my knowledge and belief.

Magnolia Petroleum Company  
 (Operator)  
L. E. Robinson  
 (Representative)

Box 2406, Hobbs, New Mexico  
 Address

This is to certify that the well location shown on the plat in Section B was plotted from field notes of actual surveys made by me or under my supervision and that the same is true and correct to the best of my knowledge and belief.

Date Surveyed 8-14-52

L. J. Gentry Jr.  
 Registered Professional  
 Engineer and/or Land Surveyor.

Certificate No. 2663

INSTRUCTIONS FOR COMPLETION

1. Operator shall furnish and certify to the information called for in Section A.
2. Operator shall outline the dedicated acreage for both oil and gas wells on the plat in Section B.
3. A registered professional engineer or land surveyor registered in the State of New Mexico or approved by the Commission shall show on the plat the location of the well and certify this information in the space provided.
4. All distances shown on the plat must be from the outer boundaries of Section.
5. If additional space is needed for listing owners and their respective interests as required in question 3, Section A, please use space below

\* "Owner" means the person who has the right to drill into and to produce from any pool and to appropriate the production either for himself or for himself and another. (65-3-29 (e) NMSA 1953 Comp.)