

30 025-30281

UNITED STATES  
DEPARTMENT OF THE INTERIOR  
GEOLOGICAL SURVEY

APPLICATION FOR PERMIT TO DRILL, DEEPEN, OR PLUG BACK

1a. TYPE OF WORK  
 DRILL  DEEPEN  PLUG BACK   
 b. TYPE OF WELL  
 OIL WELL  GAS WELL  OTHER  Injector SINGLE ZONE  MULTIPLE ZONE

2. NAME OF OPERATOR  
 Chevron U.S.A. INC.

3. ADDRESS OF OPERATOR  
 P.O. Box 670, HOBBS, NM 88240

4. LOCATION OF WELL (Report location clearly and in accordance with any State requirements.)\*  
 At surface 1980' FEL and 1860' FSL  
 At proposed prod. zone

14. DISTANCE IN MILES AND DIRECTION FROM NEAREST TOWN OR POST OFFICE\*

10. DISTANCE FROM PROPOSED\* LOCATION TO NEAREST PROPERTY OR LEASE LINE, FT. (Also to nearest drilg. unit line, if any)

16. NO. OF ACRES IN LEASE  
 14,190

17. NO. OF ACRES ASSIGNED TO THIS WELL  
 40

18. DISTANCE FROM PROPOSED LOCATION\* TO NEAREST WELL, DRILLING COMPLETED, OR APPLIED FOR, ON THIS LEASE, FT.

19. PROPOSED DEPTH  
 4300

20. ROTARY OR CABLE TOOLS  
 rotary

21. ELEVATIONS (Show whether DF, RT, GR, etc.)  
 3629.9

22. APPROX. DATE WORK WILL START\*  
 March 15, 1988

23. PROPOSED CASING AND CEMENTING PROGRAM

SIZE OF HOLE	SIZE OF CASING	WEIGHT PER FOOT	SETTING DEPTH <del>325</del>	QUANTITY OF CEMENT
12 1/4"	8 5/8"	24#	1550 → 1390'	900 sx Cl CIRCULATE
7 7/8"	5 1/2"	15.5#	4300'	700 sx Cl CIRCULATE

0 - 1550' FW Spud  
 1550 - 4300 BW Starch, 10ppg, 3lvis, 9ph.

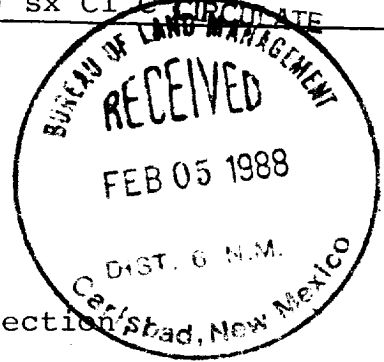

See Attached BOP drawing for 3000psi working pressure.

The Meyer A-1 #14, located in the same quarter-quarter section is in the process of being P&A'd.

IN ABOVE SPACE DESCRIBE PROPOSED PROGRAM: If proposal is to deepen or plug back, give data on present productive zone and proposed new productive zone. If proposal is to drill or deepen directionally, give pertinent data on subsurface locations and measured and true vertical depths. Give blowout preventer program, if any.

23. SIGNED F.A. Smith for MEA TITLE Staff Drilling Engineer DATE February 4, 1988

(This space for Federal or State office use)

PERMIT NO. \_\_\_\_\_ APPROVAL DATE \_\_\_\_\_  
 APPROVED BY Ray Gai TITLE \_\_\_\_\_ DATE 3-4-88  
 CONDITIONS OF APPROVAL, IF ANY: \_\_\_\_\_

**RECEIVED**

**MAR 7 - 1988**

**OCD  
HOBS OFFICE**

**N MEXICO OIL CONSERVATION COMMISSION  
WELL LOCATION AND ACREAGE DEDICATION PLAT**

Form C-102  
Supersedes C-128  
Effective 1-1-65

All distances must be from the outer boundaries of the Section

Operator <b>CHEVRON U.S.A. INC</b>			Lease <b>ENSU</b>		Well No. <b>410WIW</b>
Tract Letter <b>J</b>	Section <b>18</b>	Township <b>21 SOUTH</b>	Range <b>36 EAST</b>	County <b>LEA</b>	
Actual Footage Location of Well: <b>1860</b> feet from the <b>SOUTH</b> line and <b>1980</b> feet from the <b>EAST</b> line					
Ground Level Elev. <b>3629.9</b>	Producing Formation <b>Eunice Monument</b>		Pool <b>Eunice Monument G/SA</b>		Dedicated Acreage: <b>40</b> Acres

1. Outline the acreage dedicated to the subject well by colored pencil or hachure marks on the plat below.
2. If more than one lease is dedicated to the well, outline each and identify the ownership thereof (both as to working interest and royalty).
3. If more than one lease of different ownership is dedicated to the well, have the interests of all owners been consolidated by communitization, unitization, force-pooling, etc?

Yes     No    If answer is "yes," type of consolidation unitization

If answer is "no," list the owners and tract descriptions which have actually been consolidated. (Use reverse side of this form if necessary.) \_\_\_\_\_

No allowable will be assigned to the well until all interests have been consolidated (by communitization, unitization, forced-pooling, or otherwise) or until a non-standard unit, eliminating such interests, has been approved by the Commission.

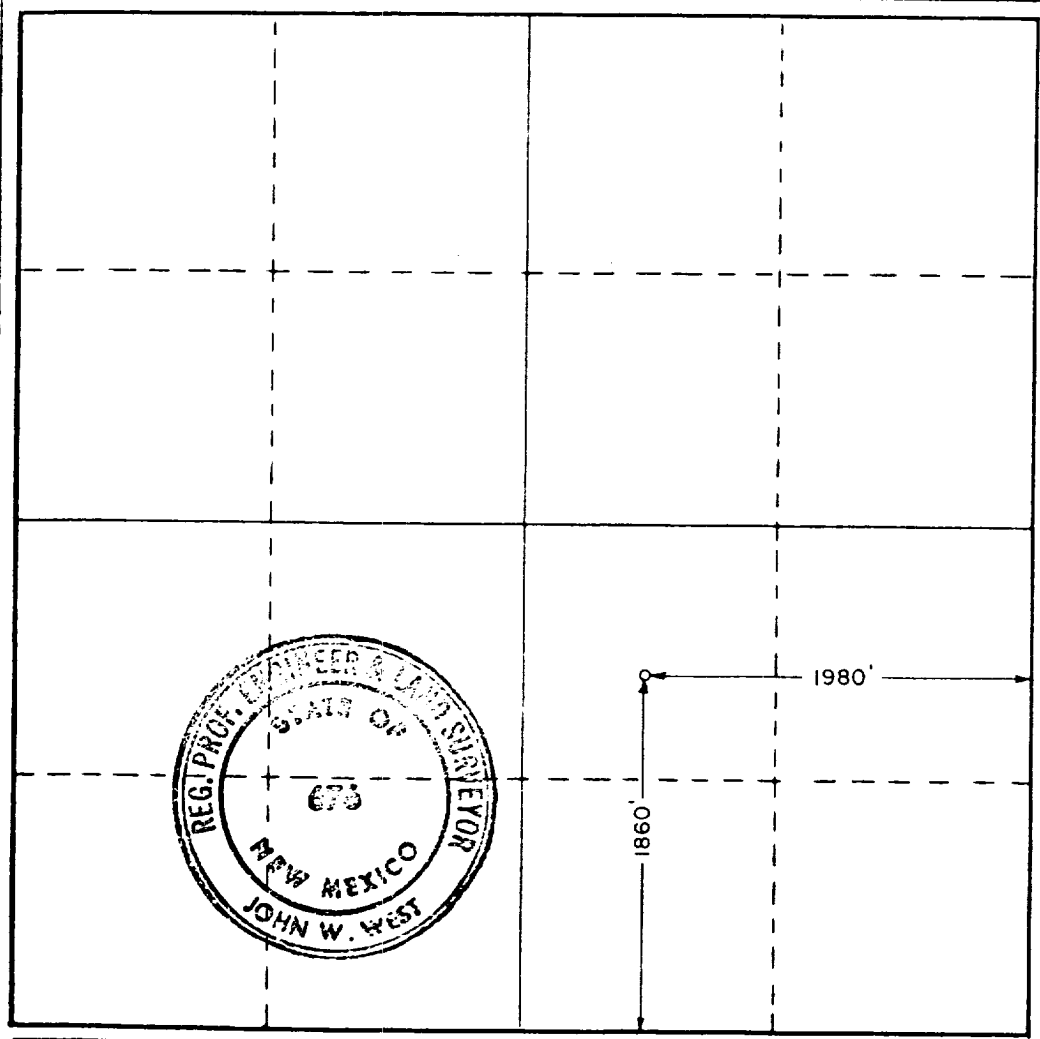

**CERTIFICATION**

*I hereby certify that the information contained herein is true and complete to the best of my knowledge and belief.*

*[Signature]*

Name  
**M. E. Akins**

Position  
**Staff Drilling Engr.**

Company  
**Chevron U.S.A. INC.**

Date  
**February 4, 1988**

*I hereby certify that the well location shown on this plat was plotted from field notes of actual surveys made by me or under my supervision, and that the same is true and correct to the best of my knowledge and belief.*

Date Surveyed  
**January 29, 1988**

Registered Professional Engineer and/or Land Surveyor  
*[Signature]*

Certificate No. **JOHN W. WEST, 676**  
**RONALD J. EIDSON, 3239**

06560

**RECEIVED**

**MAR 7 - 1988**

**OCD  
HOBBS OFFICE**

CHEVRON U.S.A. INC.  
P.O. Box 670  
Hobbs, NM 88240

---

February 4, 1988

Re: Application for Permit to  
Drill Proposed Eunice  
Monument South Unit 410 WIW  
Lea County, New Mexico

Bureau of Land Management  
P.O. Box 1778  
Carlsbad, NM 88220

Gentlemen:

We are submitting the information requested in NTL-6 which should accompany application for permit to drill.

Well: Eunice Monument South Unit 410 WIW

1. Location: Unit Letter J, 1980' FEL & 1860' FSL Section 18, T21S, R36E, Lea County, NM.
2. Elevation of Unprepared Ground: 3629.9
3. Geologic Name of Surface Formation: Ogallala Formation
4. Type Drilling Tools: Rotary
5. Proposed Drilling Depth: 4300'
6. Estimated Top of Geologic Markers:

Top Anhydrite	1290'	Top Salt	1460'
Base Salt	2750'	Top Queen	3585'
Top Grayburg	3850'		
7. Estimated Depths at which Anticipated Gas or Oil-Bearing Formations Expected:

Eunice Monument Oil	3850' - 4100'
Eumont Gas	3750' - 3850'

MAR 7 1988

MAR 7 - 1988  
OCD  
HOBBS OFFICE

# HOBBBS DIVISION

## CLASS THREE PREVENTER

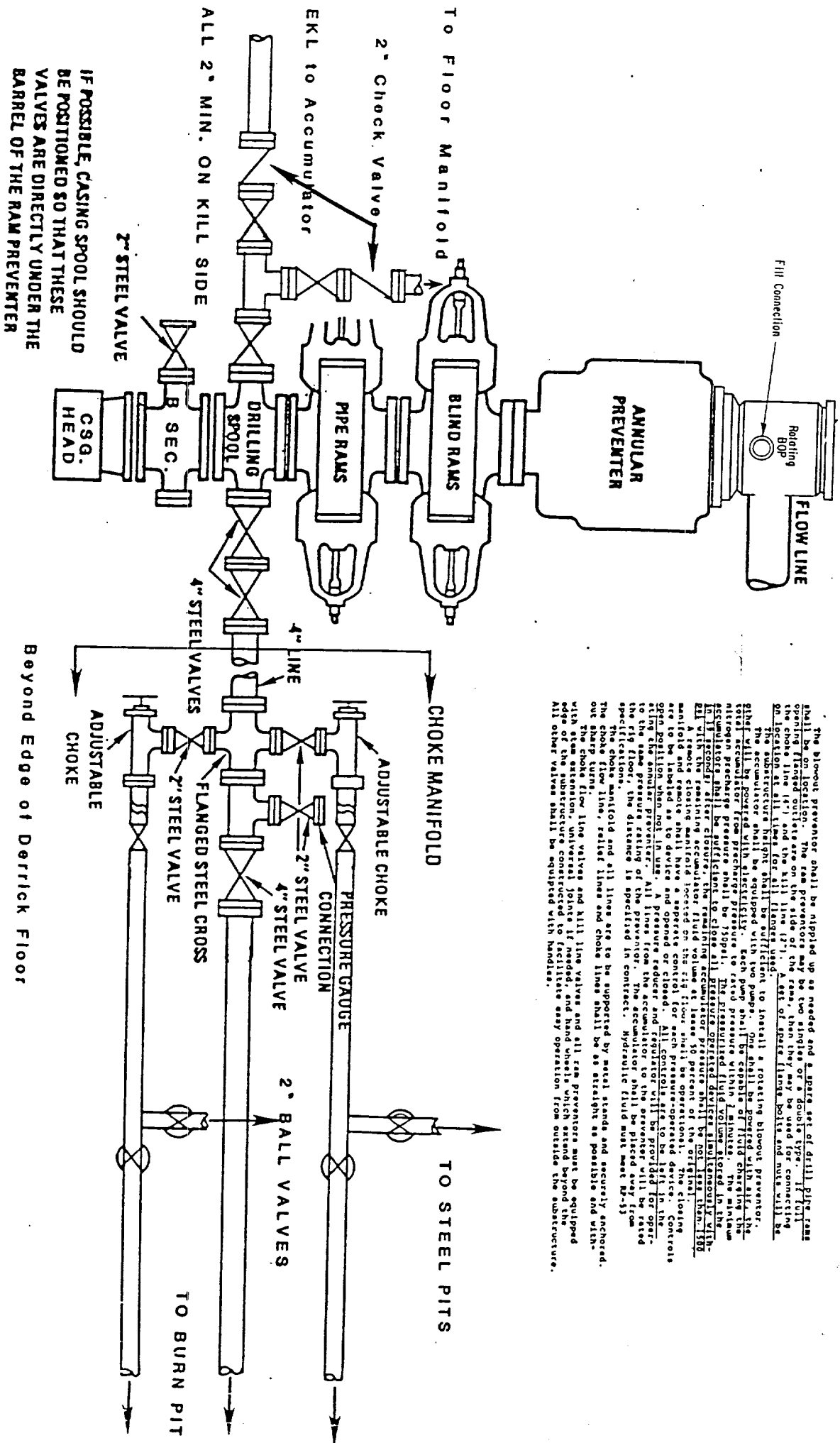

The blowout preventer shall be nipped up as needed and a spare set of drill pipe, rams shall be on location. The ram preventer may be two singles or a double type. If killing the choke lined casing are on the side of the rams, then they may be used for connecting on location at all times the kill line (2"). A set of spare flange bolts and nuts will be on location at all times the kill line (2").

The accumulator shall be equipped with two pumps. The accumulator shall be installed a rotating blowout preventer. The accumulator shall be equipped with electrically. Each pump shall be equipped with an electrical accumulator pressure pressure shall be 50psi. The pressurized fluid volume stored in the accumulator shall be sufficient to close all pressure operated devices simultaneously with the EKL with the casing accum. The remaining accumulator pressure shall be not less than 100 psi. A remote closing manifold located on the unit at least 10 percent of the original manifold and remote shall have a separate control for each pump operation. The closing line to be labeled as to device and opened or closed. All controls are to be electric. Controls are to be provided for the preventer. All lines from the accumulator to the preventer will be rated to the same pressure as the preventer. The accumulator shall be placed away from the rig floor, the distance is specified in contract. Hydraulic fluid must meet M-31 specifications.

The choke manifold and all lines are to be supported by metal stands and securely anchored. The choke flow line, relief lines and choke lines shall be as straight as possible and with out the sharp turns.

The blowout preventer shall be equipped with steam extension valves which extend beyond the edge of the substructure constructed of materials to facilitate easy operation from outside the substructure. All other valves shall be equipped with handles.

**RECEIVED**  
MAR 7 - 1988  
OCD  
HOBBS OFFICE

REC'D 4-18-88  
**ELF**