

OIL CONSERVATION DIVISION

P.O. Box 2088

Santa Fe, New Mexico 87504-2088

DISTRICT I

P.O. Box 1980, Hobbs, NM 88240

DISTRICT II

P.O. Drawer DD, Artesia, NM 88210

DISTRICT III

1000 Rio Brazos Rd., Aztec, NM 87410

SIMULTANEOUS DEDICATED

WELL LOCATION AND ACREAGE DEDICATION PLAT

All Distances must be from the outer boundaries of the section

Operator CHEVRON U.S.A. INC.			Lease R.R. BELL "A" COM.		Well No. 3
Unit Letter J	Section 8	Township 21 SOUTH	Range 36 EAST	County NMPM LEA	
Actual Footage Location of Well:					
1880 feet from the SOUTH line and			1650 feet from the EAST line		
Ground Level Elev. 3597.6'	Producing Formation QUEEN	Pool EUMONT		Dedicated Acreage: 240 Acres	

1. Outline the acreage dedicated to the subject well by colored pencil or hachure marks on the plat below.

2. If more than one lease is dedicated to the well, outline each and identify the ownership thereof (both as to working interest and royalty).

3. If more than one lease of different ownership is dedicated to the well, have the interest of all owners been consolidated by communitization, unitization, force-pooling, etc.?
 Yes No If answer is "yes" type of consolidation _____

If answer is "no" list of owners and tract descriptions which have actually been consolidated. (Use reverse side of this form necessary.) _____

No allowable will be assigned to the well unit all interests have been consolidated (by communitization, unitization, forced-pooling, otherwise) or until a non-standard unit, eliminating such interest, has been approved by the Division.

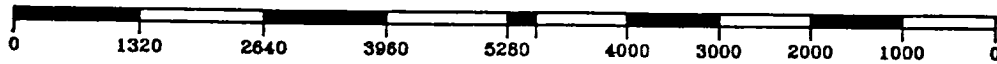
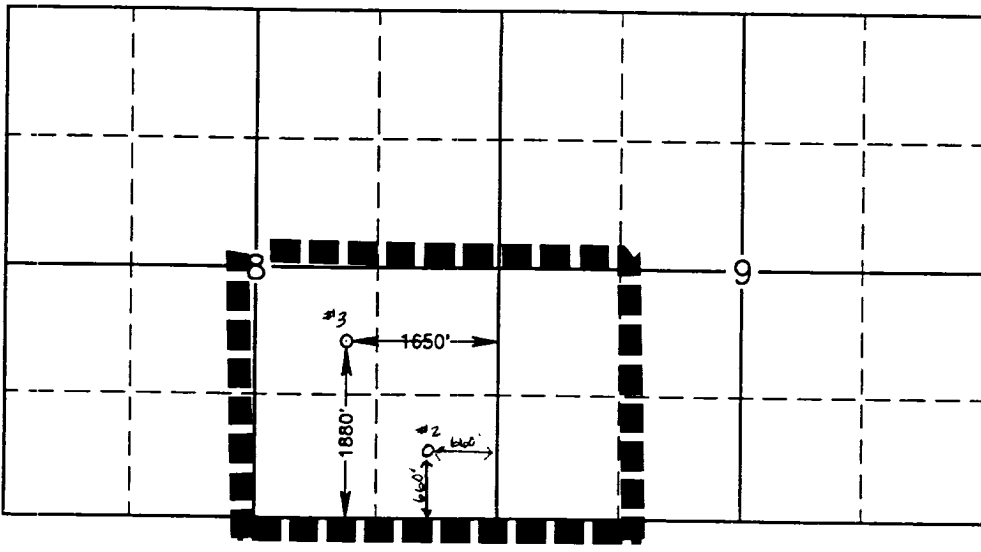

OPERATOR CERTIFICATION

I hereby certify the the information contained herein is true and complete to the best of my knowledge and belief.

Signature: *P.R. Matthews*

Printed Name: P.R. MATTHEWS

Position: TECHNICAL ASSISTANT

Company: CHEVRON U.S.A. INC.

Date: MARCH 31, 1992

SURVEYOR CERTIFICATION

I hereby certify that the well location shown on this plat was plotted from field notes of actual surveys made by me or under my supervision, and that the same is true and correct to the best of my knowledge and belief.

Date Surveyed: MARCH 27, 1992

Signature & Seal of Professional Surveyor: *GARY L. JONES*

Professional Seal: GARY L. JONES, NEW MEXICO, 7977

License No. 7977

Other License Nos. listed: JOHN S. WEST, 676; RONALD J. SIDSON, 3239; GARY L. JONES, 7977

92-11-0445

R-945 240ac. C +