

NOTICE OF INTENTION TO DRILL

Notice must be given to the District Office of the Oil Conservation Commission and approval obtained before drilling or recompletion begins. If changes in the proposed plan are considered advisable, a copy of this notice showing such changes will be returned to the sender. Submit this notice in QUINTUPLICATE. One copy will be returned following approval. See additional instructions in Rules and Regulations of the Commission. If State Land submit 6 Copies Attach Form C-128 in triplicate to first 3 copies of form C-101

Hobbs, New Mexico

March 23, 1961

(Place)

(Date)

OIL CONSERVATION COMMISSION
SANTA FE, NEW MEXICO

Gentlemen:

You are hereby notified that it is our intention to commence the Drilling of a well to be known as

STEPHEN C. MELRING AND FRANK W. FODRICHAN

(Company or Operator)

Shell State "A"

(Lease)

Well No. **1**, in **M** The well is

located **660** feet from the **South** line and **660** feet from the

West line of Section **18**, T. **23N**, R. **33E**, NMPM.

(GIVE LOCATION FROM SECTION LINE) **Underg-Wildcat** Pool, **Lee** County

If State Land the Oil and Gas Lease is No. **E-5138**

If patented land the owner is.....

Address.....

We propose to drill well with drilling equipment as follows: **Rotary**

The status of plugging bond is..... **In effect \$10,000 Blanket**

Drilling Contractor **Kirklia Drilling Company**

We intend to complete this well in the **Delaware Sand** formation at an approximate depth of **5300** feet.

CASING PROGRAM

We propose to use the following strings of Casing and to cement them as indicated:

Size of Hole	Size of Casing	Weight per Foot	New or Second Hand	Depth	Sacks Cement
12-1/4"	8-5/8"	24#	2H	300'	Cire
6-3/4"	4-1/2"	9.5#	New	70'	300

If changes in the above plans become advisable we will notify you immediately.

ADDITIONAL INFORMATION (If recompletion give full details of proposed plan of work.)

C-128 attached

MAR 23 1961

Approved....., 19.....
Except as follows:

OIL CONSERVATION COMMISSION

By.....
District F

Sincerely yours,

STEPHEN C. MELRING AND FRANK W. FODRICHAN
(Company or Operator)

By.....

Position..... **Agent**

Send Communications regarding well to

Name..... **c/o Oil Reports Box 763 Hobbs, N.M.**

Address.....

NEW MEXICO OIL CONSERVATION COMMISSION
WELL LOCATION AND ACREAGE DEDICATION PLAT

FORM C-128
 Revised 5/1/57

SEE INSTRUCTIONS FOR COMPLETING THIS FORM ON THE REVERSE SIDE

SECTION A

Operator STEPHEN C. HELBING & FRANK W. Helbing & Podpechan		Lease St. Shell "A"	Well No. 1
Unit Letter M	Section 18	Township 23 South	Range 33 East
County Lea County			
Actual Footage Location of Well: 660 feet from the South line and 660 feet from the West line			
Ground Level Elev. 3711.9	Producing Formation Delaware	Pool WC-Undesig	Dedicated Acreage: 40 Acres

1. Is the Operator the only owner in the dedicated acreage outlined on the plat below? YES NO ("Owner" means the person who has the right to drill into and to produce from any pool and to appropriate the production either for himself or for himself and another. (65-3-29 (e) NMSA 1935 Comp.)
2. If the answer to question one is "no," have the interests of all the owners been consolidated by communitization agreement or otherwise? YES NO . If answer is "yes," Type of Consolidation _____
3. If the answer to question two is "no," list all the owners and their respective interests below:

Owner	Land Description

SECTION B

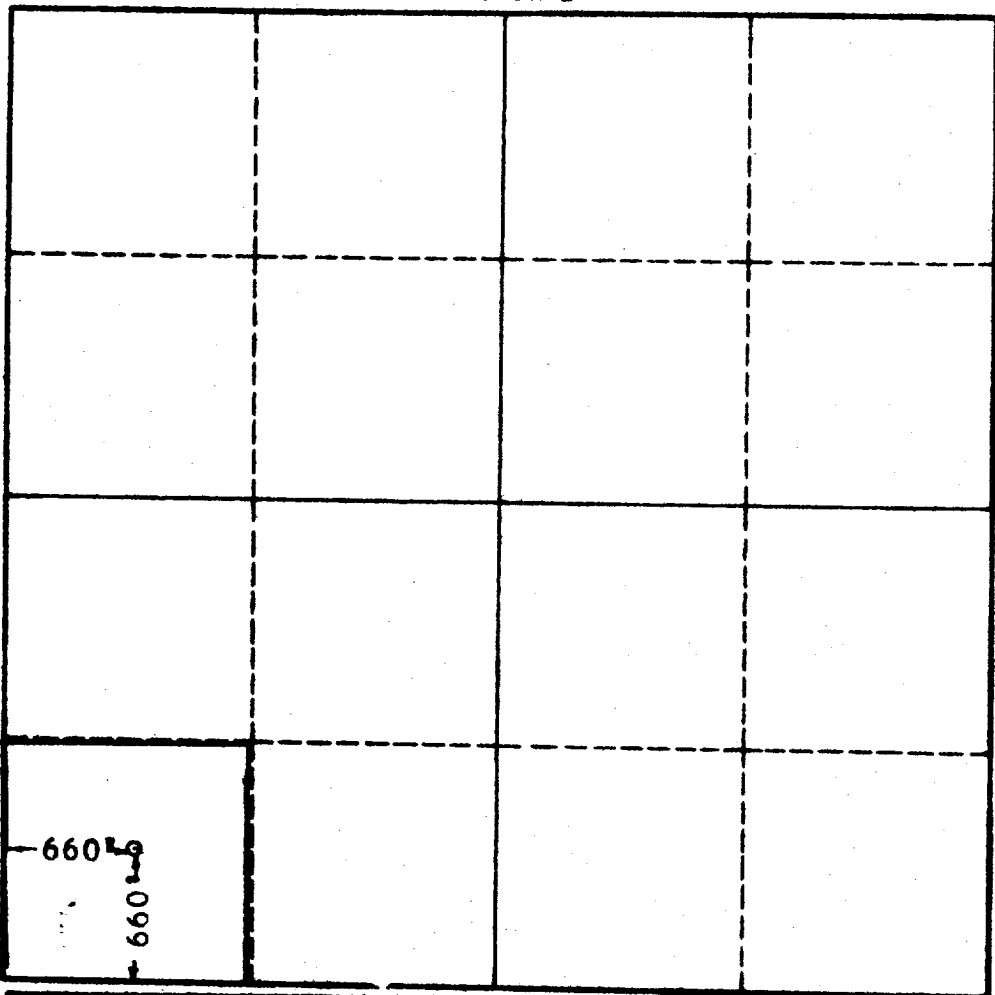

CERTIFICATION

I hereby certify that the information in SECTION A above is true and complete to the best of my knowledge and belief.

John W. West

Name Agent
Position STEPHEN C. HELBING & FRANK W. PODPECHAN
Company W. PODPECHAN
Date 3/23/61

I hereby certify that the well location shown on the plat in SECTION B was plotted from field notes of actual surveys made by me or under my supervision, and that the same is true and correct to the best of my knowledge and belief.

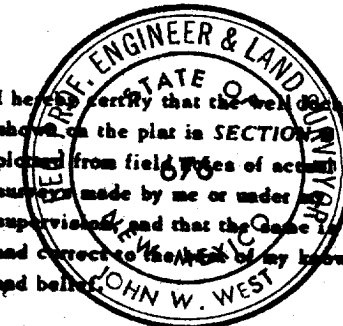

Date Surveyed 3-20-61
Registered Professional Engineer and/or Land Surveyor, JOHN W. WEST
<i>John W. West</i>
Certificate No. N. M. - P. E. & L. S. NO. 678

0 330 660 990 1320 1650 1980 2310 2640 2000 1500 1000 500 0