

NEW MEXICO OIL CONSERVATION COMMISSION

Well Location and Acreage Dedication Plat

Section A.

Date 9-14-57

Operator Neville G. Penrose, Inc. Lease Elliot State
Well No. 1 Unit Letter F Section 17 Township 22 S Range 37 E NMPM
Located 1981.5 Feet From West Line, 1980 Feet From North Line
County Lea G. L. Elevation _____ Dedicated Acreage 160 Acres
Name of Producing Formation Queen Sand Gas Pool Penrose Skelly

1. Is the Operator the only owner* in the dedicated acreage outlined on the plat below?
Yes _____ No X
2. If the answer to question one is "no," have the interests of all the owners been consolidated by communitization agreement or otherwise? Yes X No _____. If answer is "yes," Type of Consolidation joint venture
3. If the answer to question two is "no," list all the owners and their respective interests below:

<u>Owner</u>	<u>Land Description</u>

Section B

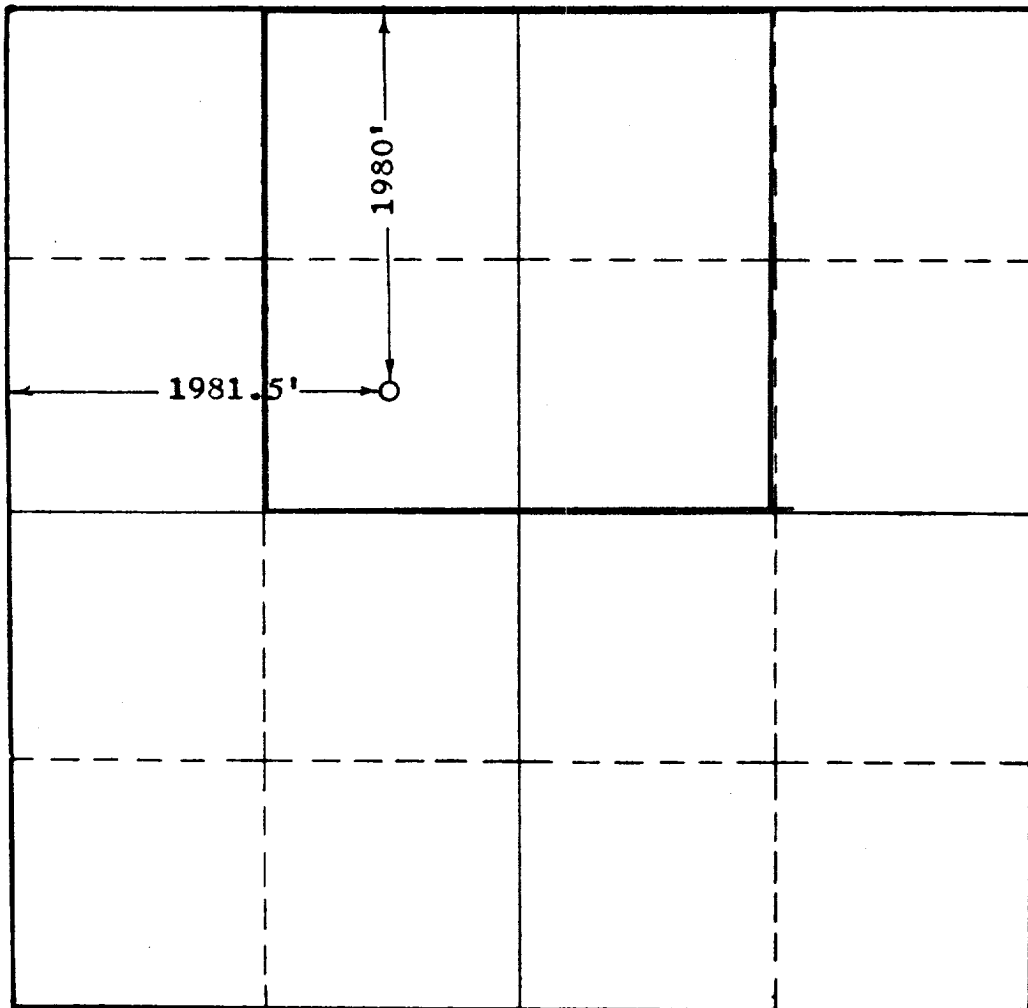

This is to certify that the information in Section A above is true and complete to the best of my knowledge and belief.

Neville G. Penrose, Inc.
(Operator)

G. G. Neill
(Representative)

Box 988
 Eunice, New Mexico
Address

This is to certify that the well location shown on the plat in Section B was plotted from field notes of actual surveys made by me or under my supervision and that the same is true and correct to the best of my knowledge and belief.

Date Surveyed 9-12-57

John W. Wat
Registered Professional
Engineer and/or Land Surveyor.

