

NEW MEXICO
OIL CONSERVATION COMMISSION

Form C-128

Well Location and/or Gas Peroration Plat

Date April 15, 1957

Operator Rowan Oil Company Lease Ruby Crosby

Well No. 1 Section 18 Township 22-S Range 37-E NMPM

Located 660 Feet From North Line, 1650 Feet From West Line,

Lee County, New Mexico. G. L. Elevation 3436'

Name of Producing Formation Queen Sand Pool Emont Dedicated Acreage 80

(Note: All distances must be from outer boundaries of Section)

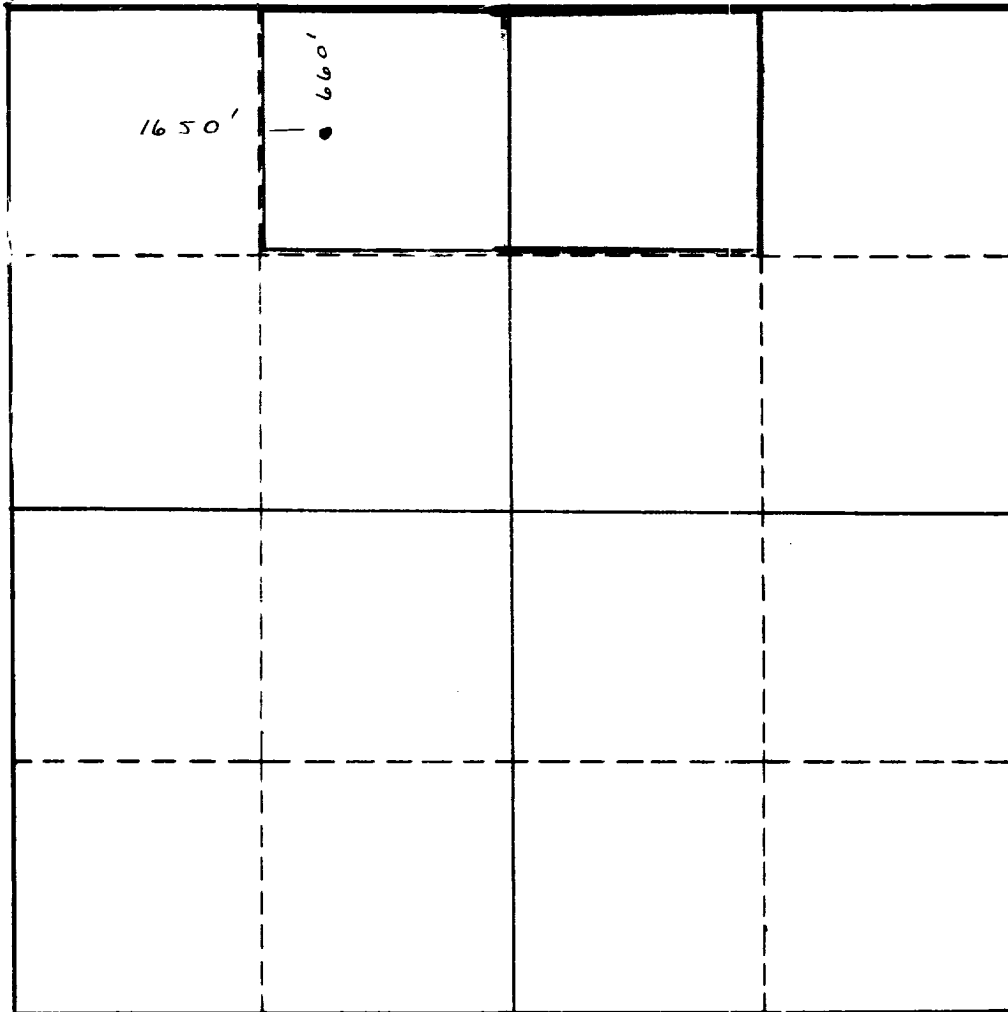

NOTE

This section of form is to be used for gas wells only.



SCALE: 1"=1000'

1. Is this Well a Dual Comp. ? Yes No .
2. If the answer to Question 1 is yes, are there any other dually completed wells within the dedicated acreage? Yes No .

Name W. F. Graham
Position Chief Production Clerk
Representing Rowan Oil Company
Address Box 12,247, Ft. Worth, Texas

This is to certify that the above plat was prepared from field notes of actual surveys made by me or under my supervision and that the same are true and correct to the best of my knowledge and belief.

Date Surveyed November 2, 1939
Charles P. Milley
Registered Professional Engineer and/or Land Surveyor

