

Form 9-331a
(Feb. 1951)

		X

W. S. ANDREY
Geological Engineer

(SUBMIT IN TRIPLICATE)

UNITED STATES
DEPARTMENT OF THE INTERIOR
GEOLOGICAL SURVEY

Budget Bureau No. 42-R358.4.
Form Approved.Land Office Las CrucesLease No. 063228Unit I

APR 12 1963

U. S. GEOLOGICAL SURVEY
LAS CRUCES, NEW MEXICO

SUNDRY NOTICES AND REPORTS ON WELLS

NOTICE OF INTENTION TO DRILL	<input checked="" type="checkbox"/>	SUBSEQUENT REPORT OF WATER SHUT-OFF	
NOTICE OF INTENTION TO CHANGE PLANS		SUBSEQUENT REPORT OF SHOOTING OR ACIDIZING	
NOTICE OF INTENTION TO TEST WATER SHUT-OFF		SUBSEQUENT REPORT OF ALTERING CASING	
NOTICE OF INTENTION TO RE-DRILL OR REPAIR WELL		SUBSEQUENT REPORT OF RE-DRILLING OR REPAIR	
NOTICE OF INTENTION TO SHOOT OR ACIDIZE		SUBSEQUENT REPORT OF ABANDONMENT	
NOTICE OF INTENTION TO PULL OR ALTER CASING		SUPPLEMENTARY WELL HISTORY	
NOTICE OF INTENTION TO ABANDON WELL			

(INDICATE ABOVE BY CHECK MARK NATURE OF REPORT, NOTICE, OR OTHER DATA)

Fields

April 11, 1963

Well No. 1 is located 1650 ft. from SW line and 330 ft. from E line of sec. 24NE 1/4 SE 1/4 Sec 24

(1/4 Sec. and Sec. No.)

23S

(Twp.)

32E

(Range)

NMPM

(Meridian)

Cruz Delaware

(Field)

Lea

(County or Subdivision)

New Mexico

(State or Territory)

The elevation of the derrick floor above sea level is _____ ft.

DETAILS OF WORK

(State names of and expected depths to objective sands; show sizes, weights, and lengths of proposed casings; indicate mudding jobs, cementing points, and all other important proposed work)

It is my intention to drill a well at the above location to an approximate depth of 5150' to attempt a completion in the Delaware Sand Horizon. All casing points will be cemented in accordance with approved methods of the USGS, and any special requirements will be complied with.

It is planned to use the following casing pattern: 11" hole, 7 5/8" casing to be set at approximately 400' and cemented with 200 sacks. Cement is to circulate. 6 3/4" hole, 4 1/2" casing to be set at 5150' and cemented with 200 sacks. Cement is to return to 3800'.

Permission is requested to produce the well upon completion.

I understand that this plan of work must receive approval in writing by the Geological Survey before operations may be commenced.

Company Hugh L. Johnston, Sr.Address 1901 South Heights DriveRoswell, New Mexico

By _____

Title Owner

USGS (5) File

GPO 914974

NEW MEXICO OIL CONSERVATION COMMISSION
WELL LOCATION AND ACREAGE DEDICATION PLAT

FORM C-128
Revised 5/1/57

SEE INSTRUCTIONS FOR COMPLETING THIS FORM ON THE REVERSE SIDE

SECTION A

Operator H. L. JOHNSTON		Lease FIELDS FEDERAL		Well No. 1
Unit Letter I	Section 24	Township 23 SOUTH	Range 32 EAST	County LEA
Actual Footage Location of Well: 1650 feet from the SOUTH line and 330 feet from the EAST line				
Ground Level Elev.	Producing Formation DELWARE SANDS	Pool UNDESIGNATED	Dedicated Acreage: 40 Acres	

1. Is the Operator the only owner in the dedicated acreage outlined on the plat below? YES X NO ____ . ("Owner" means the person who has the right to drill into and to produce from any pool and to appropriate the production either for himself or for himself and another. (65-3-29 (e) NMSA 1935 Comp.)
2. If the answer to question one is "no," have the interests of all the owners been consolidated by communitization agreement or otherwise? YES ____ NO ____ . If answer is "yes," Type of Consolidation ____
3. If the answer to question two is "no," list all the owners and their respective interests below:

Owner	Land Description

SECTION B

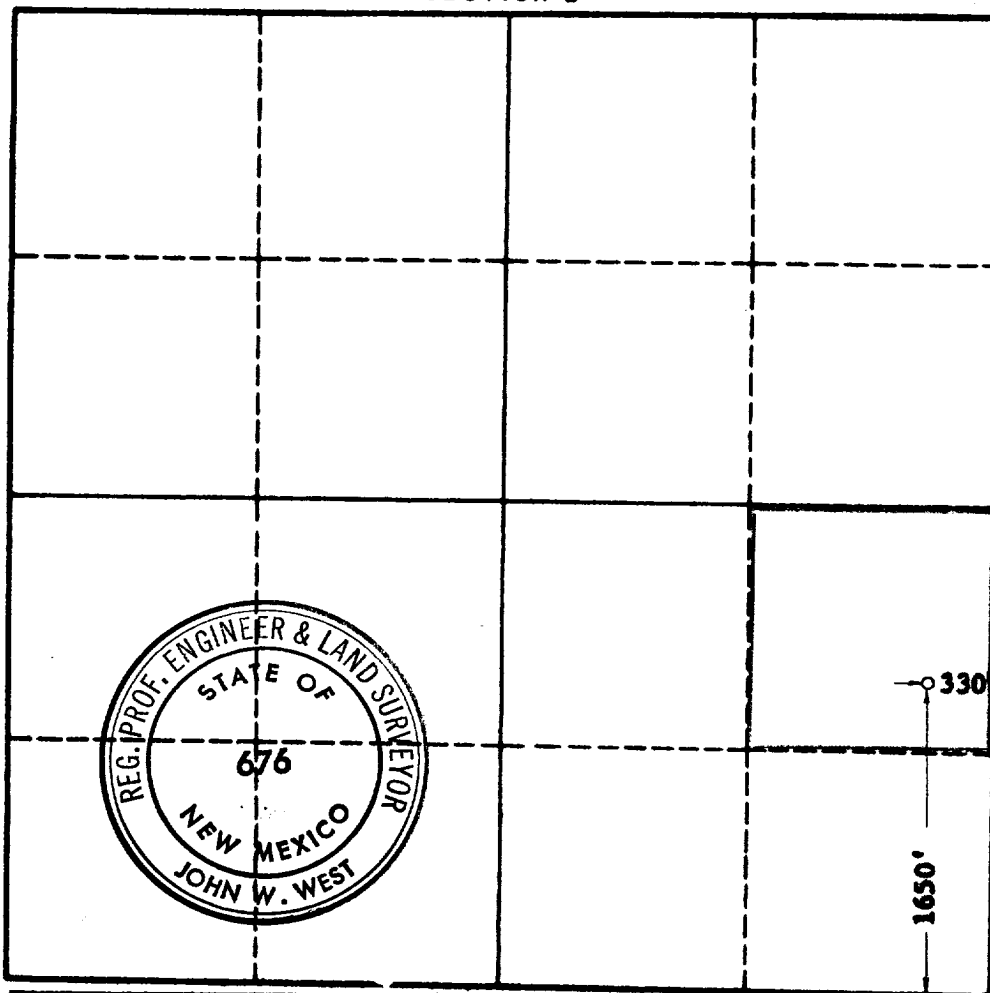

CERTIFICATION

I hereby certify that the information in SECTION A above is true and complete to the best of my knowledge and belief.

Name
JOHN W. WEST
Position
AGENT
Company
H. L. JOHNSTON
Date
4-11-63

I hereby certify that the well location shown on the plat in SECTION B was plotted from field notes of actual surveys made by me or under my supervision, and that the same is true and correct to the best of my knowledge and belief.

Date Surveyed
4-11-63
Registered Professional Engineer and/or Land Surveyor, **JOHN W. WEST**
John W. West
Certificate No.
N. M. - P. E. & L. S. NO. 676

0 330 660 990 1320 1650 1980 2310 2640 2000 1500 1000 500 0