

NO. OF COPIES RECEIVED		
DISTRIBUTION		
SANTA FE		
FILE		
U.S.G.S.		
LAND OFFICE		
OPERATOR		

NEW MEXICO OIL CONSERVATION COMMISSION

Form C-101
Revised 1-1-65

5A. Indicate Type of Lease	
STATE <input type="checkbox"/>	FEE <input checked="" type="checkbox"/>
5. State Oil & Gas Lease No.	

APPLICATION FOR PERMIT TO DRILL, DEEPEN, OR PLUG BACK

1a. Type of Work		7. Unit Agreement Name	
b. Type of Well DRILL <input checked="" type="checkbox"/> DEEPEN <input type="checkbox"/> PLUG BACK <input type="checkbox"/> OIL WELL <input checked="" type="checkbox"/> GAS WELL <input type="checkbox"/> OTHER <input type="checkbox"/> SINGLE ZONE <input checked="" type="checkbox"/> MULTIPLE ZONE <input type="checkbox"/>		8. Farm or Lease Name Brunson C	
2. Name of Operator Cities Service Oil Company		9. Well No. 11	
3. Address of Operator P. O. Box 69 - Hobbs, New Mexico 88240		10. Field and Pool, or Wildcat Penrose Skelly	
4. Location of Well UNIT LETTER P LOCATED 860 FEET FROM THE South LINE AND 660 FEET FROM THE East LINE OF SEC. 3 TWP. 22S RGE. 37E NMPM		12. County Lea	
19. Proposed Depth 4000		19A. Formation Grayburg	
20. Rotary or C.T. Rotary		21. Elevations (Show whether DF, RT, etc.) 3405 RT est.	
21A. Kind & Status Plug. Bond Approved		21B. Drilling Contractor Unassigned	
22. Approx. Date Work will start 6-8-70			

PROPOSED CASING AND CEMENT PROGRAM

SIZE OF HOLE	SIZE OF CASING	WEIGHT PER FOOT	SETTING DEPTH	SACKS OF CEMENT	EST. TOP
12 1/4"	8 5/8" ON	24#	300'	300	Circulate
7 7/8"	5 1/2" ON	14#	4000'	300	3000'

It is proposed to drill to a T.D. of 4000' and attempt completion in the Grayburg formation:

The blowout preventer program is as follows:

1. One set of blind rams.
2. One set of drill pipe rams.

THE COMMISSION MUST BE NOTIFIED
24 HOURS PRIOR TO RUNNING 8 7/8

APPROVAL VALID
UNTIL 9-5-70 UNLESS
EXTENDED BY COMMISSION
EXPIRES 9-5-70

IN ABOVE SPACE DESCRIBE PROPOSED PROGRAM; IF PROPOSAL IS TO DEEPEN OR PLUG BACK, GIVE DATA ON PRESENT PRODUCTIVE ZONE AND PROPOSED NEW PRODUCTIVE ZONE. GIVE BLOWOUT PREVENTER PROGRAM, IF ANY.

I hereby certify that the information above is true and complete to the best of my knowledge and belief.

Signed E. J. Pender Title District Manager Date June 3, 1970

(This space for State Use)

APPROVED BY J. A. Pender TITLE SUPERVISOR DISTRICT DATE JUN 5 1970

CONDITIONS OF APPROVAL, IF ANY:

RECEIVED

JUN 6 1970

OIL CONSERVATION COMM.
HOBBS, N. M.

10-1-70

**NEW MEXICO OIL CONSERVATION COMMISSION
WELL LOCATION AND ACREAGE DEDICATION PLAT**

Form C-102
Supersedes C-128
Effective 1-1-65

All distances must be from the outer boundaries of the Section.

Operator CITIES SERVICE OIL COMPANY			Lease BRUNSON C		Well No. 11
Unit Letter P	Section 3	Township 22 SOUTH	Range 37 EAST	County LEA	
Actual Footage Location of Well: <div style="display: flex; justify-content: space-between;"> 860 feet from the SOUTH line and 660 feet from the EAST line </div>					
Ground Level Elev. 3395' est.	Producing Formation Gandyburg	Pool Panrose Shelly	Dedicated Acreage: 40 Acres		

1. Outline the acreage dedicated to the subject well by colored pencil or hachure marks on the plat below.
2. If more than one lease is dedicated to the well, outline each and identify the ownership thereof (both as to working interest and royalty).
3. If more than one lease of different ownership is dedicated to the well, have the interests of all owners been consolidated by communitization, unitization, force-pooling, etc?

☐ Yes ☐ No If answer is "yes," type of consolidation _____

If answer is "no," list the owners and tract descriptions which have actually been consolidated. (Use reverse side of this form if necessary.) _____

No allowable will be assigned to the well until all interests have been consolidated (by communitization, unitization, forced-pooling, or otherwise) or until a non-standard unit, eliminating such interests, has been approved by the Commission.

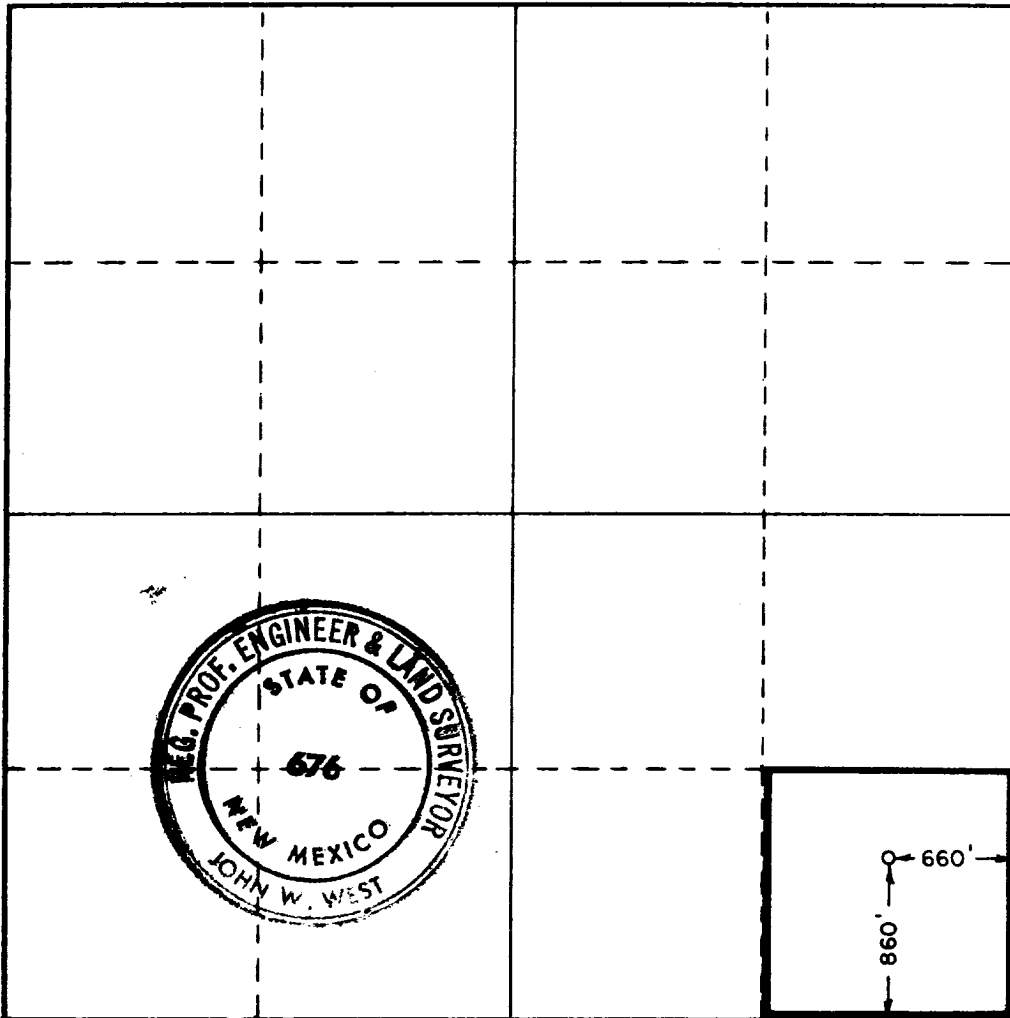

CERTIFICATION

I hereby certify that the information contained herein is true and complete to the best of my knowledge and belief.

Name *E. J. J. J.*
 Position **District Manager**
 Company **Cities Service Oil Company**
 Date **June 3, 1970**

I hereby certify that the well location shown on this plat was plotted from field notes of actual surveys made by me or under my supervision, and that the same is true and correct to the best of my knowledge and belief.

Date Surveyed
JUNE 1, 1970

Registered Professional Engineer and/or Land Surveyor

John W. West
 Certificate No. **676**

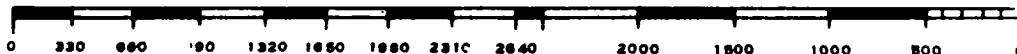

173

RECEIVED

JUN 4 1970

OIL CONSERVATION COM.
HOBBS, N. M.