

30-025-26713

NO. OF COPIES RECEIVED		
DISTRIBUTION		
SANTA FE		
FILE		
U.S.G.S.		
LAND OFFICE		
OPERATOR		

NEW MEXICO OIL CONSERVATION COMMISSION

Form C-101
Revised 1-1-65

5A. Indicate Type of Lease
 STATE FEDERAL

5. State Oil & Gas Lease No.

APPLICATION FOR PERMIT TO DRILL, DEEPEN, OR PLUG BACK

1a. Type of Work

b. Type of Well
 DRILL DEEPEN PLUG BACK
 OIL WELL GAS WELL OTHER
 SINGLE ZONE MULTIPLE ZONE

2. Name of Operator
 Amoco Production Company

3. Address of Operator
 P.O. Box 68 Hobbs, NM 88240

4. Location of Well
 UNIT LETTER G LOCATED 1838 FEET FROM THE North LINE
 AND 1750 FEET FROM THE East LINE OF SEC. 8 TWP. 22-S RGE. 37-E NMPM

7. Unit Agreement Date

8. Farm or Lease Name
 Grizzell B

9. Well No.
 4

10. Field and Pool, or Wildcat
~~Grinson~~
 Eunice Fusselman

12. County
 Lea

19. Proposed Depth: 7500'
 19A. Formation: Fusselman
 20. Rotary or C.T.: Rotary

21. Elevations (Show whether DF, RT, etc.): 3418.7 GL
 21A. Kind & Status Plug. Bond: Blanket-on-file
 21B. Drilling Contractor: NA
 22. Approx. Date Work will start: 3-7-80

PROPOSED CASING AND CEMENT PROGRAM

SIZE OF HOLE	SIZE OF CASING	WEIGHT PER FOOT	SETTING DEPTH	SACKS OF CEMENT	EST. TOP
17 1/2"	13-3/8"	48#	1250'	Circ	Surf
12 1/4"	9-5/8"	36#	3900'	Circ	Surf
8-3/4"	7"	17#, 20#, 23#	7500'	Tie back to 9-5/8"	Btm 9-5/8"

Propose to drill and equip well in the Fusselman zone. After reaching TD logs will be run and evaluated; perforate and/or stimulate as necessary in attempting commercial production.

Mud Program: 0'-1250' Native mud and fresh water.
 1250'-3900' Native mud and brine water.
 3900'-TD Commercial mud and brine with minimum properties for safe hole conditions.

BOP Program attached.

APPROVAL VALID
 FOR 90 DAYS UNLESS
 DRILLING COMMENCED,

EXPIRES 6/3/80

IN ABOVE SPACE DESCRIBE PROPOSED PROGRAM; IF PROPOSAL IS TO DEEPEN OR PLUG BACK, GIVE DATA ON PRESENT PRODUCTIVE ZONE AND PROPOSED NEW PRODUCTIVE ZONE. GIVE BLOWOUT PREVENTER PROGRAM, IF ANY.

I hereby certify that the information above is true and complete to the best of my knowledge and belief.

Signed Bob Davis Title Asst. Admin. Analyst Date 3-3-80

(This space for State Use)

APPROVED BY Leslie A. Clements TITLE OIL & GAS INSPECTOR DATE MAR 1980

CONDITIONS OF APPROVAL, IF ANY:

0+5-NMOCD-H 1-Hou 1-Susp 1-BD

NEW MEXICO OIL CONSERVATION COMMISSION
WELL LOCATION AND ACREAGE DEDICATION PLAT

Form O-102
Supersedes O-128
Effective 1-1-65

All distances must be from the outer boundaries of the Section

Operator AMOCO Production Co.		Lease Grizzell "B"		Well No. 4
Unit Letter G	Section 3	Township 22 South	Range 37 East	County Lea
Actual Footage Location of Well: 1838 feet from the North line and 1750 feet from the East line				
Ground Level Elev. 3418.7	Producing Formation Fusselman	Owner <i>Boj</i> Eunice Fusselman		Dedicated Acreage: 40 Acres

- Outline the acreage dedicated to the subject well by colored pencil or hachure marks on the plat below.
- If more than one lease is dedicated to the well, outline each and identify the ownership thereof (both as to working interest and royalty).
- If more than one lease of different ownership is dedicated to the well, have the interests of all owners been consolidated by communitization, unitization, force-pooling, etc?

Yes No If answer is "yes," type of consolidation _____

If answer is "no," list the owners and tract descriptions which have actually been consolidated. (Use reverse side of this form if necessary.) _____

No allowable will be assigned to the well until all interests have been consolidated (by communitization, unitization, forced-pooling, or otherwise) or until a non-standard unit, eliminating such interests, has been approved by the Commission.

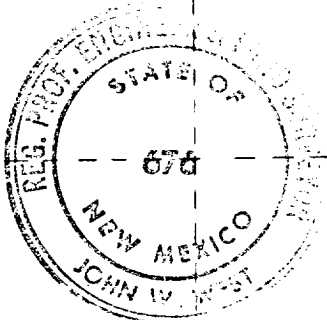
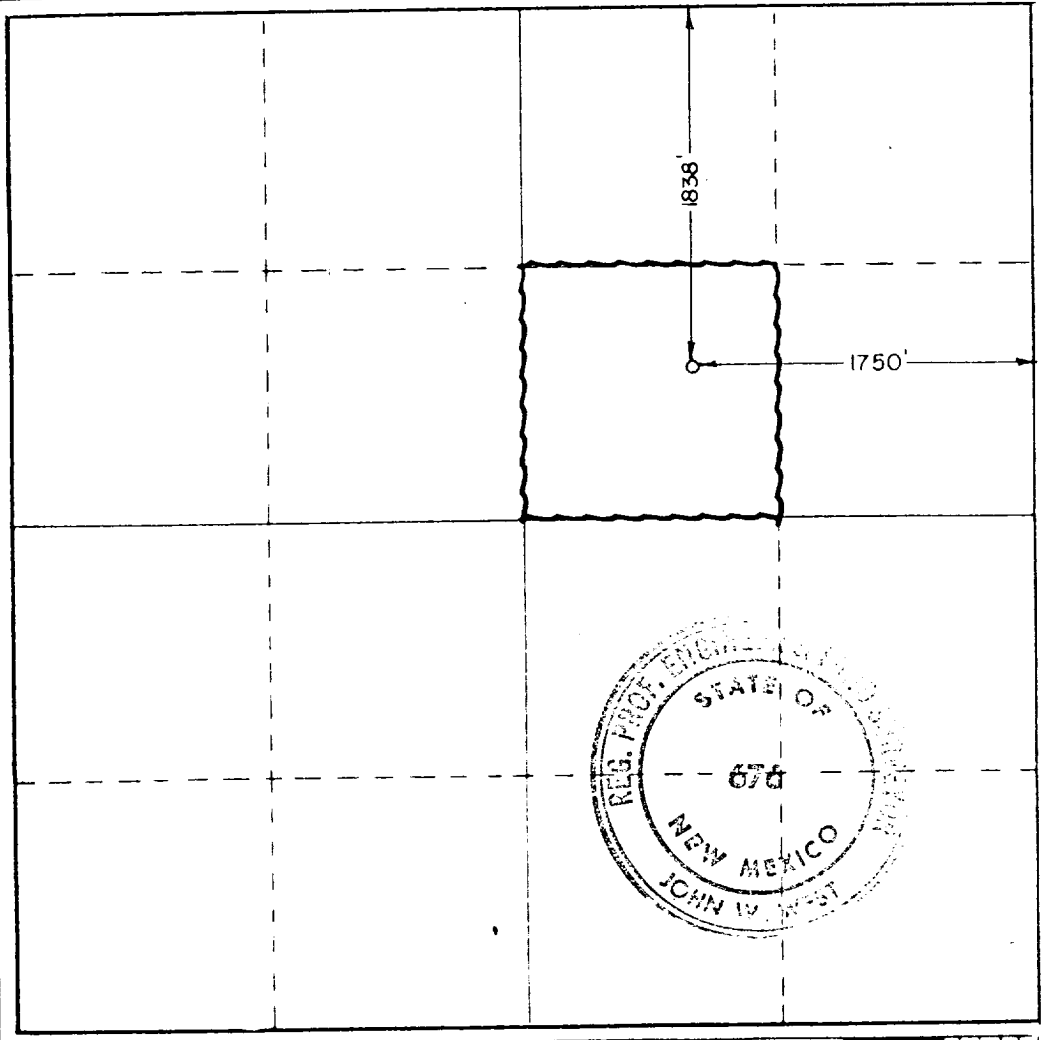

CERTIFICATION

I hereby certify that the information contained herein is true and complete to the best of my knowledge and belief.

Bob Davis

Name
Asst. Admin. Analyst
Position
Amoco Production Company
Company
3-3-80
Date

I hereby certify that the well location shown on this plat was plotted from field notes of actual surveys made by me or under my supervision, and that the same is true and correct to the best of my knowledge and belief.

Date Surveyed:
March 1, 1980
Registered Professional Engineer
in Oil and Gas Surveying

John W. West
Certificate No. **JOHN W. WEST 676**
PATRICK A. ROMERO 6863
Ronald J. Eidson 3239

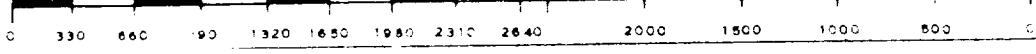

1. Blow-out preventers and master valve to be fluid operated and oil fittings must be in good condition, 3,000# W.P. (6,000 p.s.i. test), minimum.
2. Equipment through which bit must pass shall be as large as the inside diameter of the casing that is being drilled through.
3. Nipple above blow-out preventer shall be same size as casing being drilled through.
4. Kelly cock required, 3,000# W.P. (6,000 p.s.i. test) minimum.
5. OMSCO or comparable safety valve must be available on rig floor at all times with proper connection or sub, 3,000# W.P. (6,000 p.s.i. test), minimum.
6. Blow-out preventers and master valve while drilling intermediate hole to 6000' may be 2,000# W.P. (4,000 p.s.i. test), minimum.
7. Choke assembly, beyond second valve from cross, may be positioned (Optional) outside of derrick foundation.
8. Spool or cross may be eliminated if connections are available in the lower part of the blow-out preventer body.
9. Plug valves - gate valves are optional. Valves shown as 2" are minimum size.
10. Casing head and casing head spool, including attached valves, to be furnished by Amoco.
11. Rams in preventers will be installed as follows:

When drilling, use:	When running casing, use:
Top Preventer - Drill pipe rams	Top Preventer - Casing rams
Bottom Preventer - Blind rams or master valve	Bottom Preventer - Blind rams or master valve

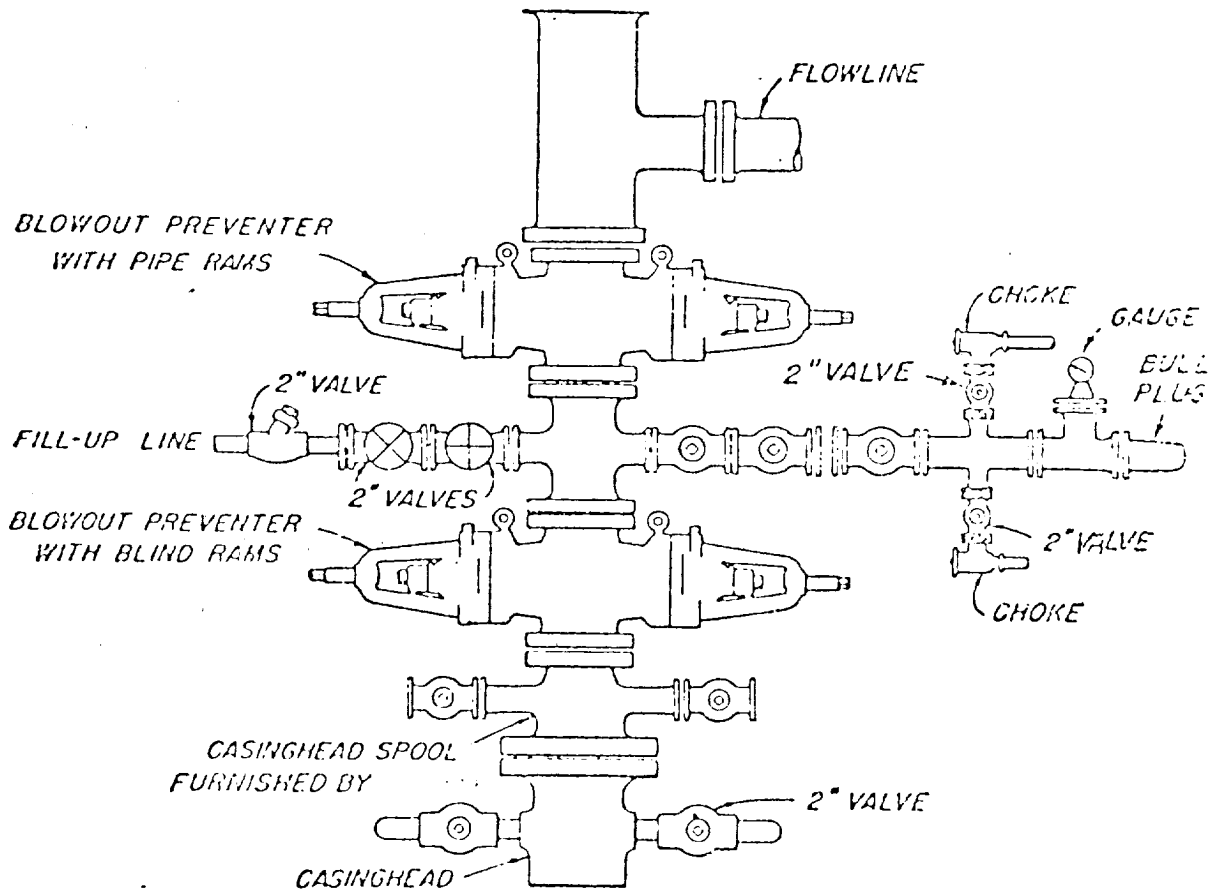

BLOWOUT PREVENTER HOOK-UP

AMOCO PRODUCTION COMPANY

EXHIBIT D-1 MODIFIED

JUNE 1, 1962

RECEIVED

MAR 3 1980

OIL CONSERVATION DIV

111