

NEW MEXICO OIL CONSERVATION COMMISSION
WELL LOCATION AND ACREAGE DEDICATION PLAT

FORM C-128
 Revised 5/1/57

SEE INSTRUCTIONS FOR COMPLETING THIS FORM ON THE REVERSE SIDE

SECTION A

Operator CONTINENTAL OIL COMPANY		Date NOV 13 AM 10:07		Well No. 1
Unit Letter G	Section 11	Township 24 SOUTH	Range 32 EAST	County LEA
Actual Footage Location of Well: 1980 feet from the NORTH line and 1980 feet from the EAST line				
Ground Level Elev.	Producing Formation Delaware	Pool Double X Delaware	Dedicated Acreage: 49 Acres	

1. Is the Operator the only owner in the dedicated acreage outlined on the plat below? YES NO ("Owner" means the person who has the right to drill into and to produce from any pool and to appropriate the production either for himself or for himself and another. (65-3-29 (e) NMSA 1935 Comp.)
2. If the answer to question one is "no," have the interests of all the owners been consolidated by communitization agreement or otherwise? YES NO . If answer is "yes," Type of Consolidation _____
3. If the answer to question two is "no," list all the owners and their respective interests below:

Owner	Land Description

SECTION B

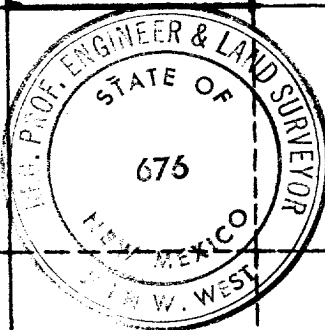
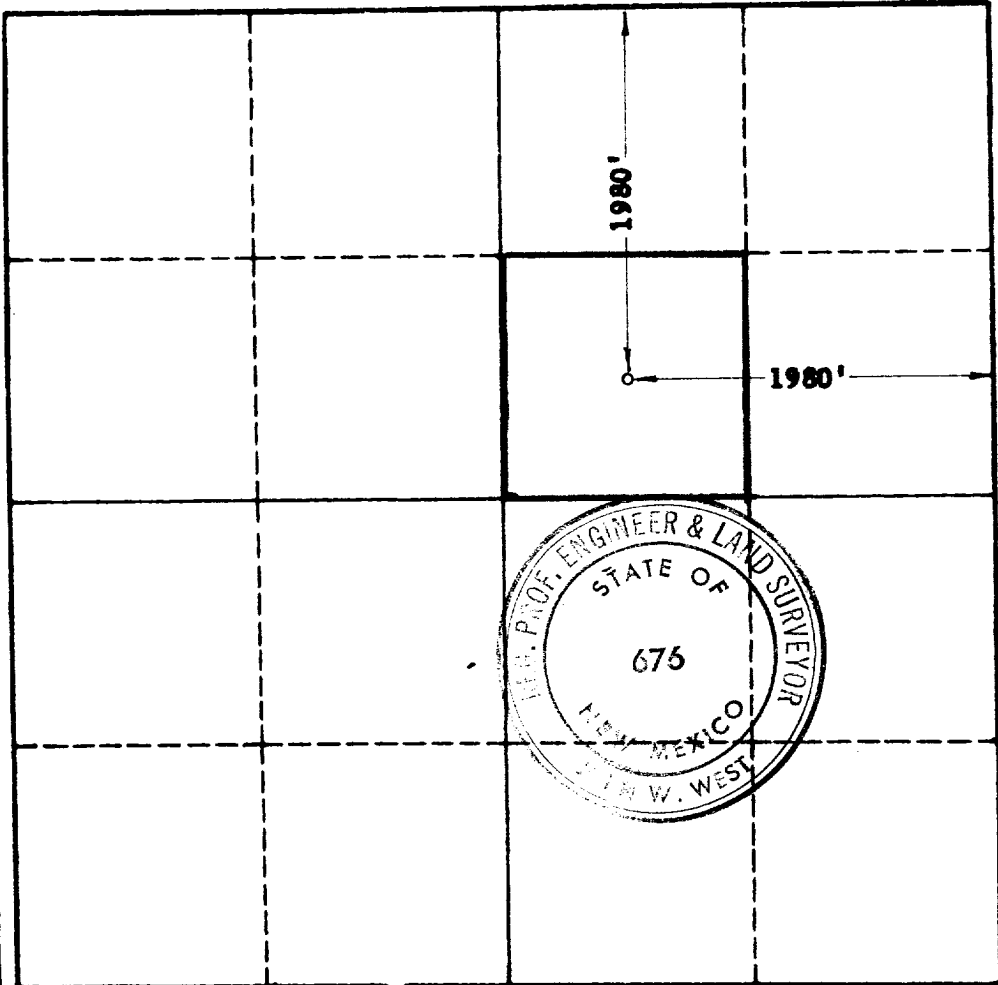

CERTIFICATION

I hereby certify that the information in SECTION A above is true and complete to the best of my knowledge and belief.

Name <i>J. W. West</i>
Position District Superintendent
Company Continental Oil Company
Date November 6, 1962

I hereby certify that the well location shown on the plat in SECTION B was plotted from field notes of actual surveys made by me or under my supervision, and that the same is true and correct to the best of my knowledge and belief.

Date Surveyed 11-5-62
Registered Professional Engineer and/or Land Surveyor, JOHN W. WEST <i>John W. West</i>
Certificate No. N. M. - P. E. & L. S. NO. 675

0 330 660 990 1320 1650 1980 2310 2640 2000 1600 1200 800 400