

APPROVED

COPY TO C. C.

Budget Bureau No. 42-R358.4.  
Approval expires 12-31-60.Form 9-331a  
(Feb. 1951)

JAN 4 1962

(SUBMIT IN TRIPLICATE)

Land Office Las CrucesLease No. 062269-

Unit \_\_\_\_\_

E. W. STANDLEY  
DISTRICT ENGINEER

UNITED STATES

DEPARTMENT OF THE INTERIOR

GEOLOGICAL SURVEY

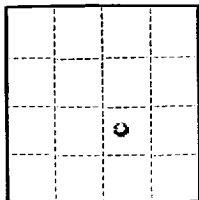

JAN 4 1962

## SUNDRY NOTICES AND REPORTS ON WELLS

U. S. GEOLOGICAL SURVEY  
BOBBS, NEW MEXICO

NOTICE OF INTENTION TO DRILL	X	SUBSEQUENT REPORT OF WATER SHUT-OFF	
NOTICE OF INTENTION TO CHANGE PLANS		SUBSEQUENT REPORT OF SHOOTING OR ACIDIZING	
NOTICE OF INTENTION TO TEST WATER SHUT-OFF		SUBSEQUENT REPORT OF ALTERING CASING	
NOTICE OF INTENTION TO RE-DRILL OR REPAIR WELL		SUBSEQUENT REPORT OF RE-DRILLING OR REPAIR	
NOTICE OF INTENTION TO SHOOT OR ACIDIZE		SUBSEQUENT REPORT OF ABANDONMENT	
NOTICE OF INTENTION TO PULL OR ALTER CASING		SUPPLEMENTARY WELL HISTORY	
NOTICE OF INTENTION TO ABANDON WELL			

(INDICATE ABOVE BY CHECK MARK NATURE OF REPORT, NOTICE, OR OTHER DATA)

December 28, 1961

Well No. \_\_\_\_\_ is located 1980 ft. from {N} line and 1980 ft. from {E} line of sec. 22

NW 1/4 Sec. 22

(1/4 Sec. and Sec. No.)

24N

(Twp.)

32E

(Range)

N. M. P. M.

(Meridian)

Double X

(Field)

Lea

(County or Subdivision)

New Mexico

(State or Territory)

The elevation of the ~~surface~~ <sup>ground level</sup> above sea level is 3597.4 ft.

## DETAILS OF WORK

(State names of and expected depths to objective sands; show sizes, weights, and lengths of proposed casings; indicate mudding jobs, cementing points, and all other important proposed work)

It is proposed to drill with rotary tools at the above location to approximately 5000 feet for a Delaware test. Surface casing to be 8 5/8" 24# set at 300 feet, cement circulated to surface. In the event commercial production is obtained 4 1/2" 9.5# casing will be set at total depth and cemented with 200 sacks.

I understand that this plan of work must receive approval in writing by the Geological Survey before operations may be commenced.

Company Charles B. ReadAddress Box 1822, Roswell, New Mexico

By

Title Operator

NEW MEXICO OIL CONSERVATION COMMISSION  
WELL LOCATION AND ACREAGE DEDICATION PLAT

FORM C-128  
Revised 5/1/57

SEE INSTRUCTIONS FOR COMPLETING THIS FORM ON THE REVERSE SIDE

SECTION A

Operator <b>CHARLES B READ</b>		Lease <b>BRADLEY</b>		Well No. <b>1</b>
Unit Letter <b>J</b>	Section <b>22</b>	Township <b>24 SOUTH</b>	Range <b>32 EAST</b>	County <b>LEA</b>
Actual Footage Location of Well: <b>1980</b> feet from the <b>SOUTH</b> line and <b>1980</b> feet from the <b>EAST</b> line				
Ground Level Elev. <b>3597.4</b>	Producing Formation <b>RAMSEY</b>	Pool <b>DOUBLE X</b>	Dedicated Acreage: <b>40 (NWSE)</b> Acres	

1. Is the Operator the only owner in the dedicated acreage outlined on the plat below? YES ☒ NO \_\_\_\_ ("Owner" means the person who has the right to drill into and to produce from any pool and to appropriate the production either for himself or for himself and another. (65-3-29 (e) NMSA 1935 Comp.)
2. If the answer to question one is "no," have the interests of all the owners been consolidated by communitization agreement or otherwise? YES \_\_\_\_ NO \_\_\_\_ . If answer is "yes," Type of Consolidation \_\_\_\_
3. If the answer to question two is "no," list all the owners and their respective interests below:

Owner	Land Description

SECTION B

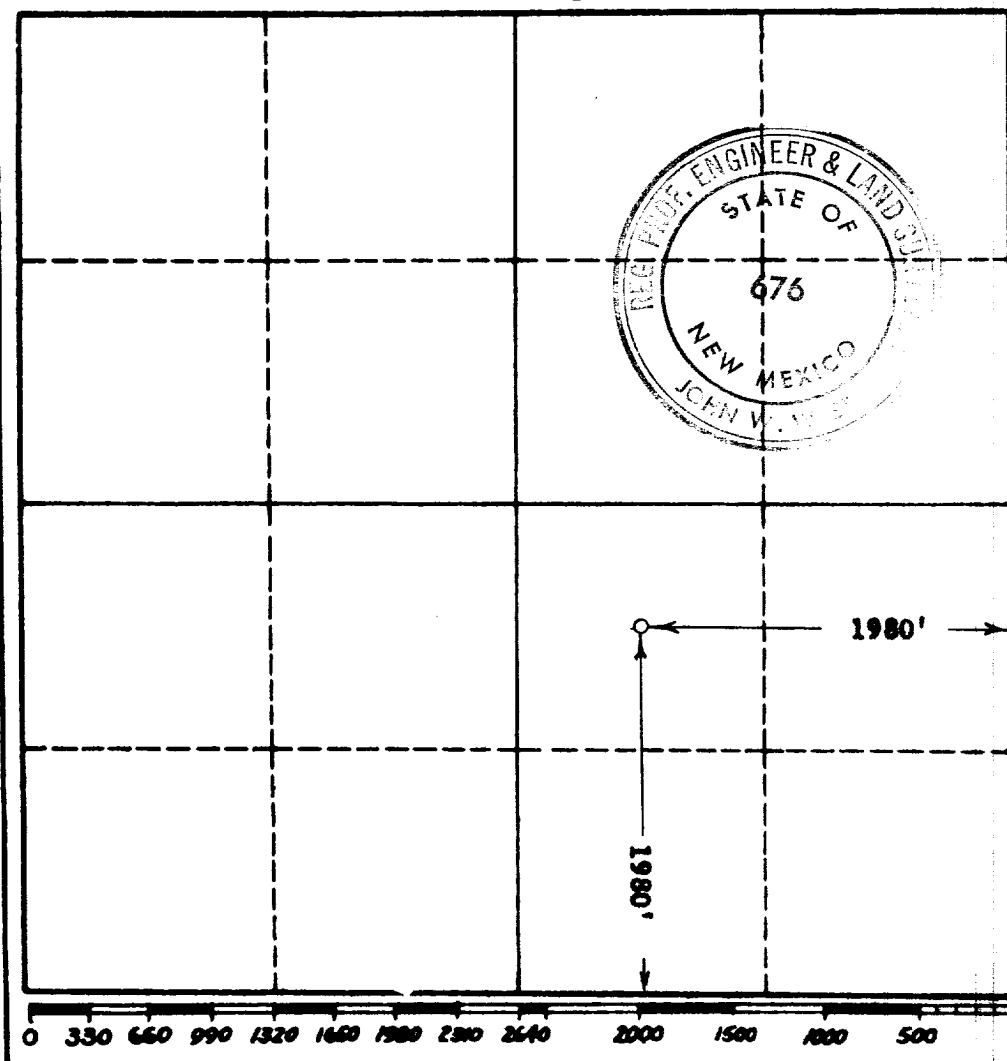

CERTIFICATION

I hereby certify that the information in SECTION A above is true and complete to the best of my knowledge and belief.

Name <i>John W. West</i>
Position <b>AGENT</b>
Company <b>CHARLES B. READ</b>
Date <b>12-26-1961</b>

I hereby certify that the well location shown on the plat in SECTION B was plotted from field notes of actual surveys made by me or under my supervision, and that the same is true and correct to the best of my knowledge and belief.

Date Surveyed <b>12-15-1961</b>
Registered Professional Engineer and/or Land Surveyor, <b>JOHN W. WEST</b>
Certificate No. <i>John W. West</i> <b>N.M. - P.E. &amp; L.S. NO. 676</b>