HOBBS
(SUBMIT IN TRIPLICATE)Land Office Las CrucesLease No. 069515UNITED STATES
DEPARTMENT OF THE INTERIOR
GEOLOGICAL SURVEY

GAC

I

FILED FEB 1 1960

SUNDRY NOTICES AND REPORTS ON WELLS

NOTICE OF INTENTION TO DRILL	<input checked="" type="checkbox"/>	SUBSEQUENT REPORT OF WATER SHUT-OFF	
NOTICE OF INTENTION TO CHANGE PLANS		SUBSEQUENT REPORT OF SHOOTING OR ACIDIZING	
NOTICE OF INTENTION TO TEST WATER SHUT-OFF		SUBSEQUENT REPORT OF ALTERING CASING	
NOTICE OF INTENTION TO RE-DRILL OR REPAIR WELL		SUBSEQUENT REPORT OF RE-DRILLING OR REPAIR	
NOTICE OF INTENTION TO SHOOT OR ACIDIZE		SUBSEQUENT REPORT OF ABANDONMENT	
NOTICE OF INTENTION TO PULL OR ALTER CASING		SUPPLEMENTARY WELL HISTORY	
NOTICE OF INTENTION TO ABANDON WELL			

(INDICATE ABOVE BY CHECK MARK NATURE OF REPORT, NOTICE, OR OTHER DATA)

February 3, 1960

19

Wilder

Well No. 17 is located 1980 ft. from (MX) line and 800 ft. from (E) line of sec. 26SE/4 Sec 26
(¼ Sec. and Sec. No.)26-3
(Twp.)32-1
(Range)MTN
(Meridian)El Mar Delaware
(Field)Lea
(County or Subdivision)New Mexico
(State or Territory)The elevation of the derrick floor above sea level is 3103 ft.

DETAILS OF WORK

(State names of and expected depths to objective sands; show sizes, weights, and lengths of proposed casings; indicate mudding jobs, cementing points, and all other important proposed work)

It is intended to drill a well at the above location with rotary tools to a depth of 4625' in the Delaware Sand. Casing will be cemented in accordance with USGS regulations and other special requirements will be complied with.

The following casing program is planned: 7 5/8" OD set at 350' w/175 sacks, cement to circulate to surface; 4 1/2" OD set at 4625' w/175 sacks, cement to return to 4000'.

I understand that this plan of work must receive approval in writing by the Geological Survey before operations may be commenced.

Company Continental Oil CompanyAddress Box 68Lunice, New Mexico

By

Title District Superintendent

0/4 USGS/5 plats; WAD HLS WAR/plot file

NEW MEXICO OIL CONSERVATION COMMISSION
WELL LOCATION AND ACREAGE DEDICATION PLAT

FORM C-128
Revised 5/1/57

SEE INSTRUCTIONS FOR COMPLETING THIS FORM ON THE REVERSE SIDE

HOBBS OFFICE UCC

SECTION A

Operator Continental Oil Co.		Lease Wilder		1960 FEB 8 PM		Well No. 1:4217
Unit Letter I	Section 26	Township 26 South	Range 32 East	County Lea		
Actual Footage Location of Well: 1980 feet from the South line and 660 feet from the East line						
Ground Level Elev. 3103.3	Producing Formation Delaware Sand		Pool El Mar Delaware		Dedicated Acreage: 40 Acres	

1. Is the Operator the only owner in the dedicated acreage outlined on the plat below? YES **XX** NO ____ ("Owner" means the person who has the right to drill into and to produce from any pool and to appropriate the production either for himself or for himself and another. (65-3-29 (e) NMSA 1935 Comp.)
2. If the answer to question one is "no," have the interests of all the owners been consolidated by communitization agreement or otherwise? YES ____ NO ____ If answer is "yes," Type of Consolidation ____
3. If the answer to question two is "no," list all the owners and their respective interests below:

Owner	Land Description

FEB 5 1960
U. S. DEPT. OF THE INTERIOR
HOBBS, NEW MEXICO

SECTION B

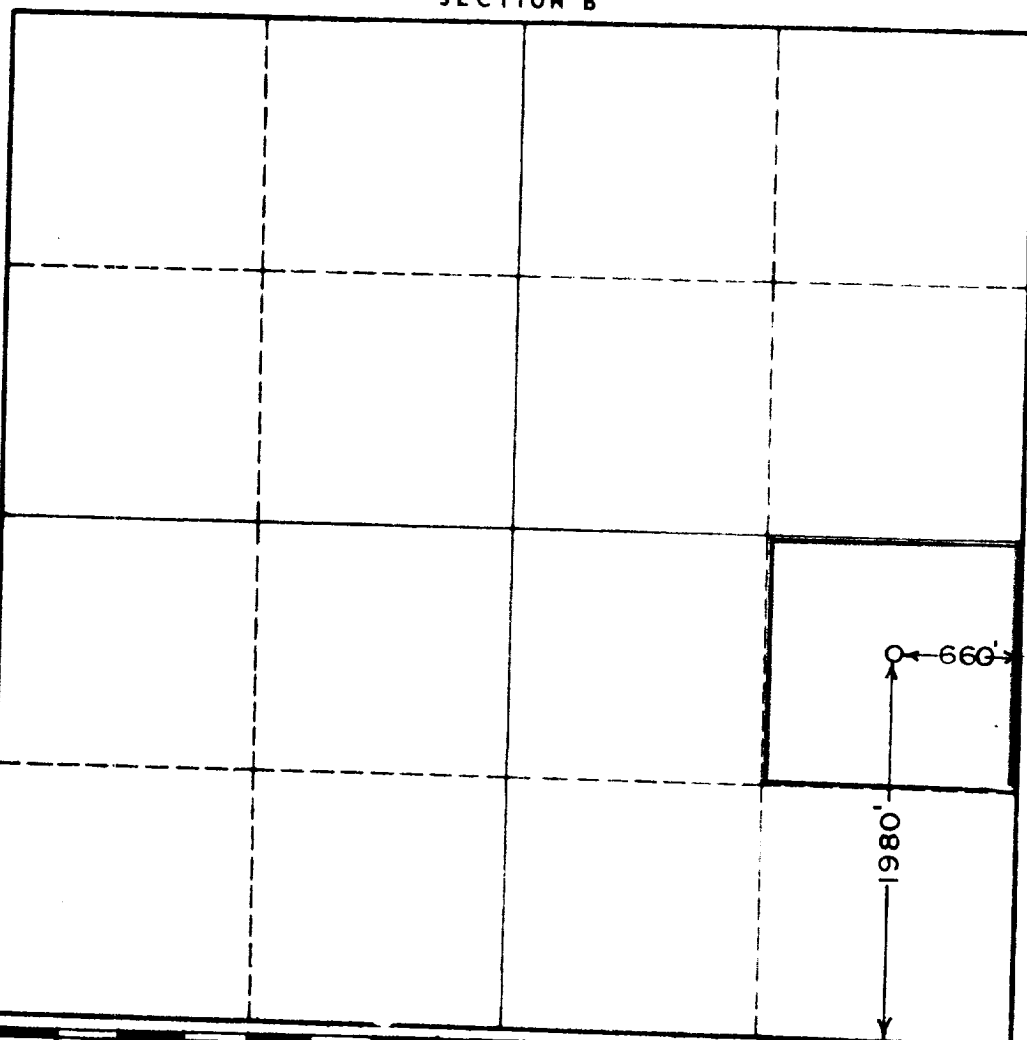

CERTIFICATION

I hereby certify that the information in SECTION A above is true and complete to the best of my knowledge and belief.

Name
J. K. Parker
Position
District Superintendent
Company
Continental Oil Company
Date
February 3, 1960

I hereby certify that the well location shown on the plat in SECTION B was plotted from field notes of actual surveys made by me or under my supervision, and that the same is true and correct to the best of my knowledge and belief.

Date Surveyed
1-26-60
Registered Professional Engineer and/or Land Surveyor
JOHN W. WEST
John W. West
Certificate No.
N.M. - P.E. & L.S. NO. 676