

NEW MEXICO OIL CONSERVATION COMMISSION  
Santa Fe, New Mexico

Form C-101  
Revised (12/1/55)

NOTICE OF INTENTION TO DRILL

Notice must be given to the District Office of the Oil Conservation Commission and approval obtained before drilling or recompletion begins. If changes in the proposed plan are considered advisable, a copy of this notice showing such changes will be returned to the sender. Submit this notice in QUINTUPPLICATE. One copy will be returned following approval. See additional instructions in Rules and Regulations of the Commission. If State Land submit 6 Copies Attach Form C-128 in triplicate to first 3 copies of form C-101

Roswell, New Mexico

(Place)

February 13, 1961

(Date)

OIL CONSERVATION COMMISSION  
SANTA FE, NEW MEXICO

Gentlemen:

You are hereby notified that it is our intention to commence the Drilling of a well to be known as

Byard Bennett

(Company or Operator)

J.L. Holland et al

(Lease)

, Well No. 1, in H The well is

(Unit)

located 660 feet from the East line and 1980 feet from the

North line of Section 13, T. 24 S, R. 33 E, NMPM.

(GIVE LOCATION FROM SECTION LINE) Wildcat Pool, Lea County

If State Land the Oil and Gas Lease is No.

If patented land the owner is J.L. Holland Et al

Address.

We propose to drill well with drilling equipment as follows: Rotary Tools

The status of plugging bond is Blanket Bond approved 7/28/58

Drilling Contractor

We intend to complete this well in the Delaware

formation at an approximate depth of 5,200 feet.

CASING PROGRAM

We propose to use the following strings of Casing and to cement them as indicated:

Size of Hole	Size of Casing	Weight per Foot	New or Second Hand	Depth	Sacks Cement
11	8-5/8	24	New	350	Cement
7-7/8	4-1/2	9.5	New	5,200	Solid to Surface
					150

If changes in the above plans become advisable we will notify you immediately.

ADDITIONAL INFORMATION (If recompletion give full details of proposed plan of work.)

Approved....., 19.....  
Except as follows:

OIL CONSERVATION COMMISSION

By Leslie A. Clements

Sincerely yours,

Byard Bennett

(Company or Operator)

By

Position Operator

Send Communication regarding well to

Name Byard Bennett Box 48 Roswell, N.M.

Address

NEW MEXICO OIL CONSERVATION COMMISSION  
Well Location and Acreage Dedication Plat

Section A.

Date January 30, 1961

Operator Byard Bennett Lease J. L. Holland et al  
Well No. 1 Unit Letter H Section 13 Township 24 South Range 33 East NMPM  
Located 1980 Feet From North Line, 660 Feet From East Line  
County Lea G. L. Elevation 3572' est 6L Dedicated Acreage 40 Acres  
Name of Producing Formation Delaware Pool Wildcat---Undesignated

1. Is the Operator the only owner\* in the dedicated acreage outlined on the plat below?  
Yes X No       .
2. If the answer to question one is "no," have the interests of all the owners been consolidated by communitization agreement or otherwise? Yes        No       . If answer is "yes," Type of Consolidation
3. If the answer to question two is "no," list all the owners and their respective interests below:

Owner

Land Description

<u>Owner</u>	<u>Land Description</u>

Section B

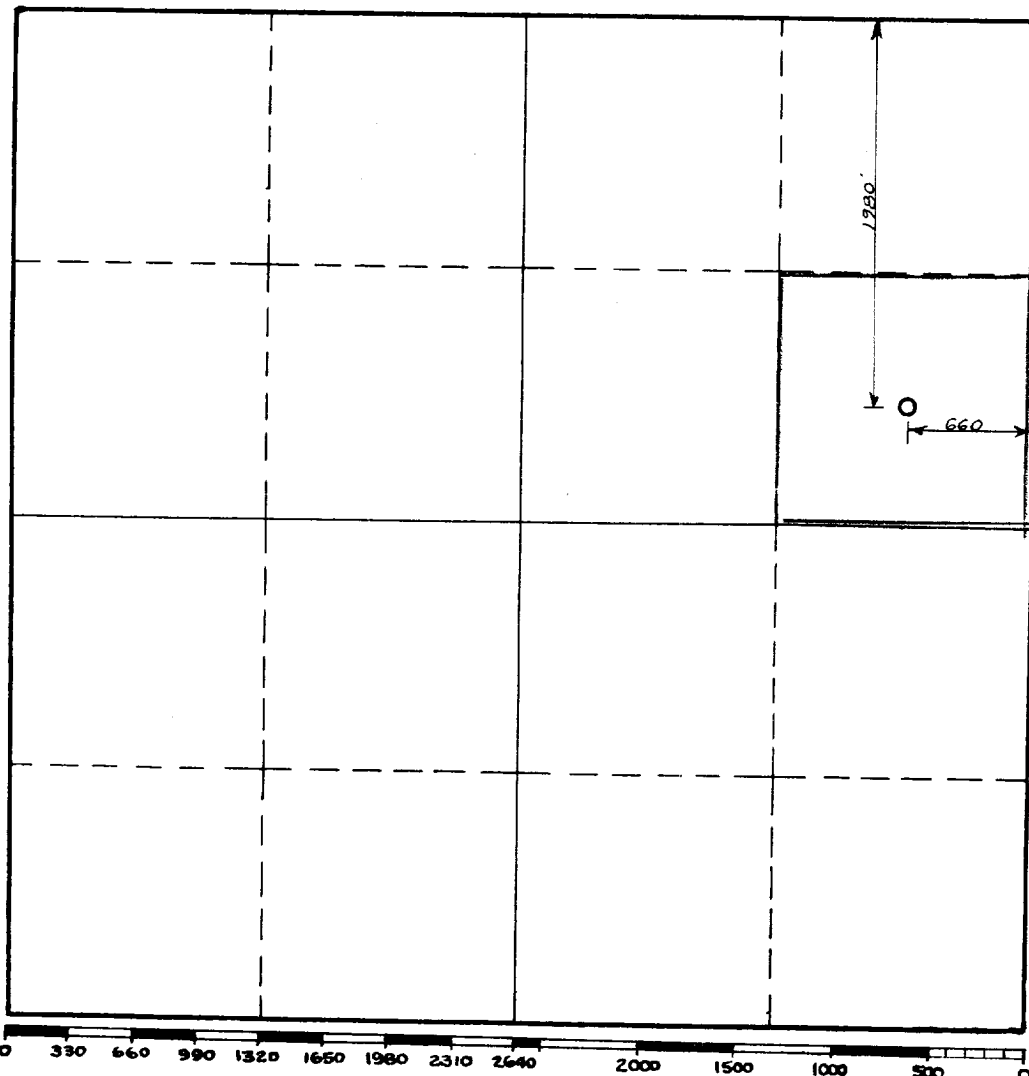

This is to certify that the information in Section A above is true and complete to the best of my knowledge and belief.

Byard Bennett

(Operator)

Byard Bennett  
(Representative)

P.O. Box 48

207 West 3rd, Roswell, N. M.

Address

This is to certify that the well location shown on the plat in Section B was plotted from field notes of actual surveys made by me or under my supervision and that the same is true and correct to the best of my knowledge and belief.

Date Surveyed 1-29-61

Ernest C. Lantry  
Registered Professional  
Engineer and/or Land Surveyor.

Certificate No. 2787

(See instructions for completing this form on the reverse side)

INSTRUCTIONS FOR COMPLETION:

1. Operator shall furnish and certify to the information called for in Section A.
2. Operator shall outline the dedicated acreage for both oil and gas wells on the plat in Section B.
3. A registered professional engineer or land surveyor registered in the State of New Mexico or approved by the Commission shall show on the plat the location of the well and certify this information in the space provided.
4. All distances shown on the plat must be from the outer boundaries of Section.
5. If additional space is needed for listing owners and their respective interests as required in question 3, Section A, please use space below

\* "Owner" means the person who has the right to drill into and to produce from any pool and to appropriate the production either for himself or for himself and another. (65-3-29 (e) NMSA 1953 Comp.)