

NOTICE OF INTENTION TO DRILL

Notice must be given to the District Office of the Oil Conservation Commission and approval obtained before drilling or recompletion begins. If changes in the proposed plan are considered advisable, a copy of this notice showing such changes will be returned to the sender. Submit this notice in QUINTUPLICATE. One copy will be returned following approval. See additional instructions in Rules and Regulations of the Commission. If State Land submit 6 Copies Attach Form G-128 in triplicate to first 3 copies of form G-101

Hobbs, New Mexico

January 4, 1961

(Place)

(Date)

OIL CONSERVATION COMMISSION  
SANTA FE, NEW MEXICO

Gentlemen:

You are hereby notified that it is our intention to commence the Drilling of a well to be known as  
**KIRKLIN DRILLING COMPANY**

**Continental State**

(Company or Operator)

1

NW/NW D

Well No.

(Unit)

The well is

located **330** feet from the **North** line and **330** feet from the

**West**

line of Section **30**, T **24S**, R **33E**, NMPM.

(GIVE LOCATION FROM SECTION LINE)

**Wildcat**

**Lea**

**E-5011**

County

If State Land the Oil and Gas Lease is No. \_\_\_\_\_

If patented land the owner is \_\_\_\_\_

Address \_\_\_\_\_

We propose to drill well with drilling equipment as follows: \_\_\_\_\_

The status of plugging bond is **\$10,000 Blanket Bond in effect**

Drilling Contractor **Company tools**

We intend to complete this well in the **Delaware**

formation at an approximate depth of **5300'** feet.

CASING PROGRAM

We propose to use the following strings of Casing and to cement them as indicated:

Size of Hole	Size of Casing	Weight per Foot	New or Second Hand	Depth	Sacks Cement
11"	8-5/8"	24#	N	300	CIFC
6-3/4"	4-1/2"	will be cemented to total depth if commercial production is obtained			150

If changes in the above plans become advisable we will notify you immediately.

ADDITIONAL INFORMATION (If recompletion give full details of proposed plan of work.)

C-128 attached 4 copies

Approved \_\_\_\_\_, 19\_\_\_\_  
Except as follows:

Sincerely yours,

**KIRKLIN DRILLING COMPANY**

(Company or Operator)

By \_\_\_\_\_

Agent

Position \_\_\_\_\_

Send Communications regarding well to

Name **P. O. Box 763 Hobbs, N.M.**

Address \_\_\_\_\_

OIL CONSERVATION COMMISSION

By \_\_\_\_\_

**NEW MEXICO OIL CONSERVATION COMMISSION**  
**WELL LOCATION AND ACREAGE DEDICATION PLAT**

FORM C-128  
 Revised 5/1/57

SEE INSTRUCTIONS FOR COMPLETING THIS FORM ON THE REVERSE SIDE

**SECTION A**

Operator <b>KIRKLIN DRILLING COMPANY</b>		Lessee <b>CONTINENTAL STATE</b>		Well No. <b>1</b>
Unit Letter <b>D</b>	Section <b>30</b>	Township <b>24 SOUTH</b>	Range <b>33 EAST</b>	County <b>LEA</b>
Actual Footage Location of Well: <b>330</b> feet from the <b>NORTH</b> line and <b>330</b> feet from the <b>WEST</b> line				
Ground Level Elev. <b>3542.6 FEET</b>	Producing Formation <b>Del</b>	Pool <b>WC</b>	Dedicated Acreage: <b>40</b> Acres	

1. Is the Operator the only owner in the dedicated acreage outlined on the plat below? YES  NO  ("Owner" means the person who has the right to drill into and to produce from any pool and to appropriate the production either for himself or for himself and another. (65-3-29 (e) NMSA 1935 Comp.)
2. If the answer to question one is "no," have the interests of all the owners been consolidated by communitization agreement or otherwise? YES  NO . If answer is "yes," Type of Consolidation \_\_\_\_\_
3. If the answer to question two is "no," list all the owners and their respective interests below:

Owner	Lead Description

**SECTION B**

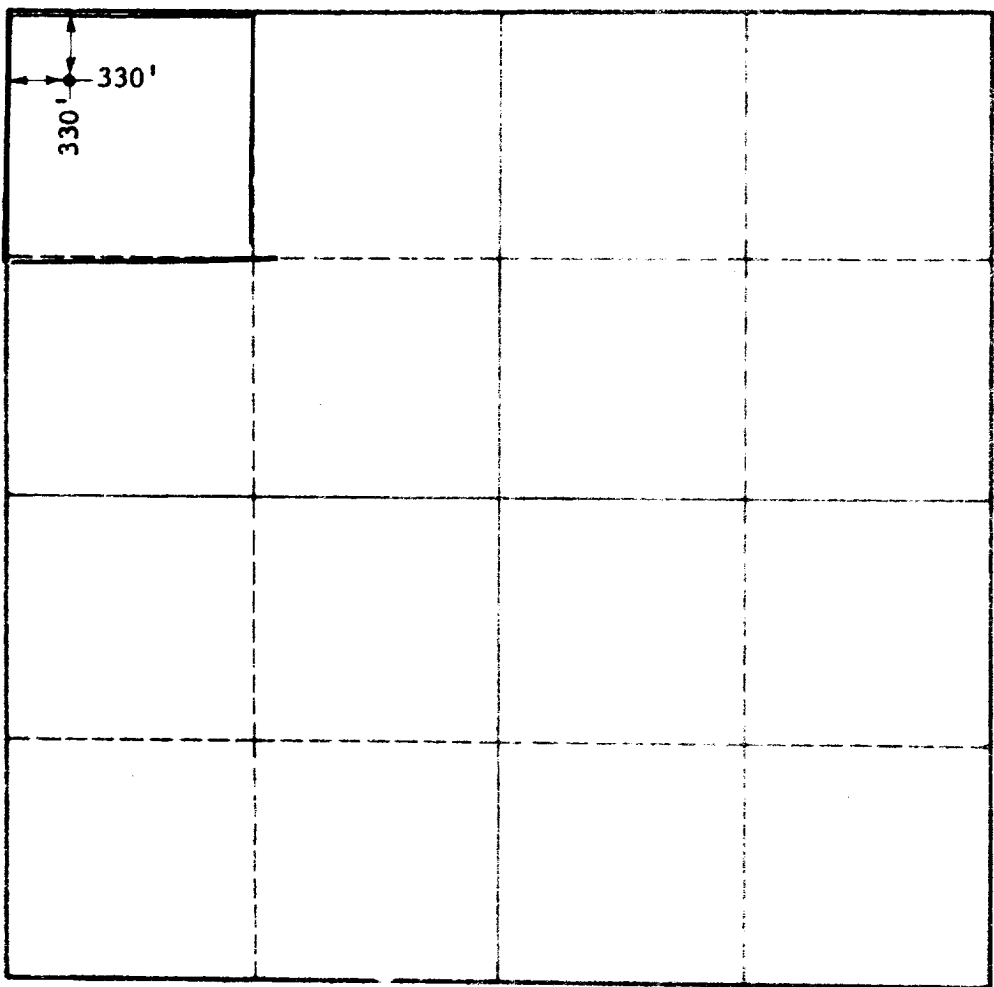

**CERTIFICATION**

I hereby certify that the information in SECTION A above is true and complete to the best of my knowledge and belief.

*John West*

Name <b>Agent</b>
Position <b>KIRKLIN DRILLING COMPANY</b>
Company
Date <b>1/6/61</b>

I hereby certify that the well location shown on the plat in SECTION B plotted on field notes of actual surveys made by me or under my supervision, and that the same is true and correct to the best of my knowledge and belief.

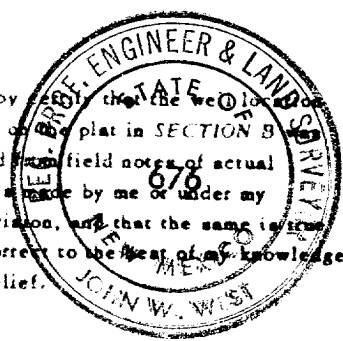

Date Surveyed <b>JANUARY 3, 1961</b>
Registered Professional Engineer and/or Land Surveyor, <b>JOHN W. WEST</b>
<i>John W. West</i>
Certificate No. <b>N. M. - P. E. &amp; L. S. NO. 676</b>

