

SECTION PLAT

GULF FW 636

Date: 5-1-53

SCALE 1 IN. = 800 FT.

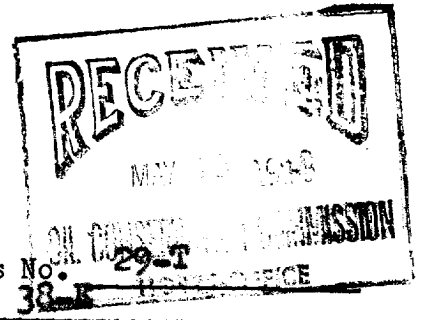

This Plat exhibits the exact location of Gulf Oil Corporation's No. 29-T
 Harry Leonard "A" in Sec. 4 Twosp. 25-S Range 38-E

1/2 Gov't L.P.

SECTION 4 East TOWNSHIP 25-S RANGE 38-E

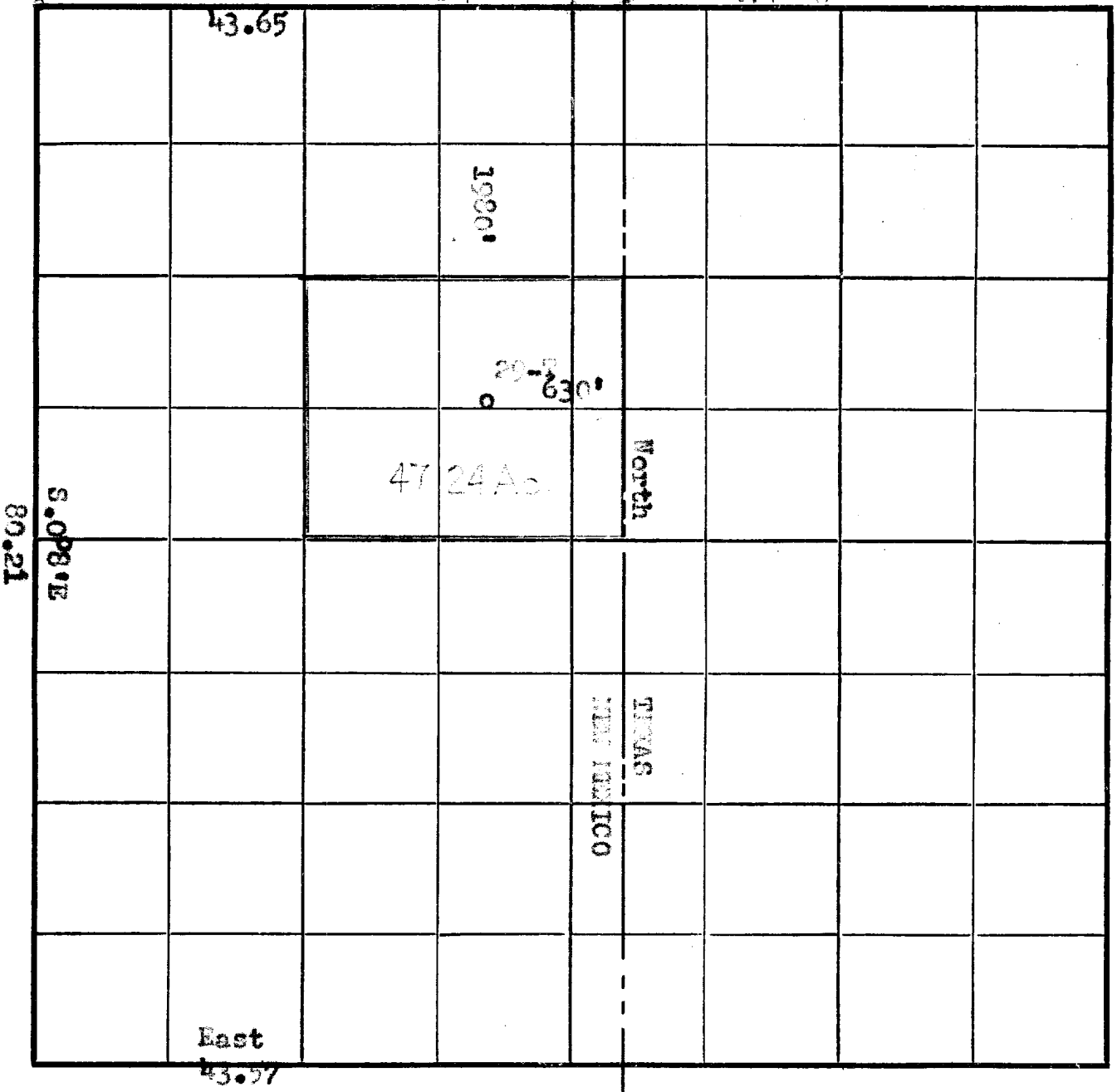

This is to certify that I am a Registered Land Surveyor, that the above plat was prepared under my direction and that the same is true and correct to the best of my knowledge and belief.

J. A. Teague
 J. A. Teague