

COUNTY	IEA	FIELD	Langlie-Mattix	STATE	NM
OPR	CARTER FOUNDATION PROD. CO.			MAP	
WI-16 Blinebry					
Sec. 34, T-23-S, R-37-E					
1340' FNL, 1340' FEL of Sec.				CO-ORD	MN 21696
Spd 6-16-67					
Cmp 7-7-67		CLASS		EL	
		FORMATION	DATUM	FORMATION	DATUM
:SG & SX - TUBING					
7 5/8" 335'					
4 1/2" 3638'					
LOGS EL GR RA IND HC A					
		TD 3638'			
Penrose Perfs 3393-3555' - WATER INJECTION WELL					

Distribution limited and publication prohibited by subscribers' agreement.
Reproduction rights reserved by Williams & Lee Scouting Service, Inc.

CONT. Leatherwood Drlg. Co.	PROP DEPTH 3700'	TYPE RT
DATE		

F.R. 6-8-67; WATER INJECTION WELL
PD 3700' - Penrose
(Orig. Aband. Loc. 5-1-67)
Contr. - Leatherwood
6-19-67 Drlg. 2716'.
6-26-67 Coring @ 3665'
Cored 3381-3431', rec 50', no desc.
Cored 3431-82', rec 51', no desc.
Cored 3482-3534', rec 52', no desc.
7-5-67 TD 3638', WO Injection
Cored 3534-84', rec 50', no desc.
Perf 3393-3555' W/108 shots (Overall)
Acid (3393-3555') 7500 gals.
1-17-67 TD 3638', COMPLETE.

COUNTY LEA FIELD Langlie-Mattix STATE NM
 OPR CARTER FOUNDATION PROD. CO. MAP
 WI-16 Blinebry
 Sec. 34, T-23-S, R-37-E CO-ORD
 1340' FNL, 1340' FEL of Sec. MN 21696

Cmp 5-1-67	CLASS		EL	
	FORMATION	DATUM	FORMATION	DATUM
CSG & SX - TUBING				
LOGS EL GR RA IND HC A				

ABANDON LOCATION

Distribution limited and publication prohibited by subscribers' agreement.
 Reproduction rights reserved by Williams & Lee Scouting Service, Inc.

CONT. PROP DEPTH 3700' TYPE
 DATE

5-1-67 F.R. 12-23-65; WATER INJECTION WELL
 PD 3700' - Penrose
 COMPLETION REPORTED
 ABANDON LOCATION



UNITED STATES
DEPARTMENT OF THE INTERIOR
HOBBS OFFICE U.S.G.
GEOLOGICAL SURVEY

P. O. Box 1157
Hobbs, New Mexico 88240

August 9, 1966

Carter Foundation Production Company
P. O. Box 900
Kermit, Texas

Attention: Mr. Roy E. Carter

Gentlemen:

Your Application for Permit to Drill well No. 16 Blinetry in the SW $\frac{1}{4}$ NE $\frac{1}{4}$ sec. 34, T. 23 S., R. 37 E., Lea County, New Mexico, lease Las Cruces 064118, was approved January 25, 1966.

Since drilling operations were not commenced within 90 days after approval, the Permit to Drill is hereby cancelled.

If you should desire to drill a well at this location at some future date, an Application for Permit to Drill may be re-submitted at that time.

Sincerely yours,

Arthur R. Brown
District Engineer

cc: NMOCC

UNITED STATES
DEPARTMENT OF THE INTERIOR
BUREAU OF LAND MANAGEMENT



UNITED STATES
DEPARTMENT OF THE INTERIOR
GEOLOGICAL SURVEY

APPLICATION FOR PERMIT TO DRILL, DEEPEN, OR PLUG BACK

1a. TYPE OF WORK

DRILL ☒DEEPEN ☐PLUG BACK ☐

b. TYPE OF WELL

OIL
WELL ☒GAS
WELL ☐OTHER ☐SINGLE
ZONE ☒MULTIPLE
ZONE ☐

2. NAME OF OPERATOR

Carter Foundation Production Company

3. ADDRESS OF OPERATOR

P. O. Box 900, Kermit, Texas

4. LOCATION OF WELL (Report location clearly and in accordance with any State requirements.)*

At surface 1,340 feet from North line and 1,340 feet from East line
of Section 34, T-23-S, R-37-E, Lea County, New Mexico.
At proposed prod. zone
Same

14. DISTANCE IN MILES AND DIRECTION FROM NEAREST TOWN OR POST OFFICE*

13 miles Northeast of Jal, New Mexico.

15. DISTANCE FROM PROPOSED*

LOCATION TO NEAREST
PROPERTY OR LEASE LINE, FT.
(Also to nearest drlg. unit line, if any)

1,340

18. DISTANCE FROM PROPOSED LOCATION*
TO NEAREST WELL, DRILLING, COMPLETED,
OR APPLIED FOR, ON THIS LEASE, FT.

917

16. NO. OF ACRES IN LEASE

520

17. NO. OF ACRES ASSIGNED
TO THIS WELL

20

19. PROPOSED DEPTH

3,700

20. ROTARY OR CABLE TOOLS

Rotary

21. ELEVATIONS (Show whether DF, RT, GR, etc.)

Ground 3,257

22. APPROX. DATE WORK WILL START*

January 25th, 1966

23.

PROPOSED CASING AND CEMENTING PROGRAM

SIZE OF HOLE	SIZE OF CASING	WEIGHT PER FOOT	SETTING DEPTH	QUANTITY OF CEMENT
11"	5-5/8" OD	24.2	325	200 sacks
7-7/8"	5-1/2" OD	15.504	3,600	750 sacks

Propose to drill new well for oil and gas production to approximately 3,700 feet.

ILLEGIBLE

IN ABOVE SPACE DESCRIBE PROPOSED PROGRAM: If proposal is to deepen or plug back, give data on present productive zone and proposed new productive zone. If proposal is to drill or deepen directionally, give pertinent data on subsurface locations and measured and true vertical depths. Give blowout preventer program, if any.

24.

SIGNED

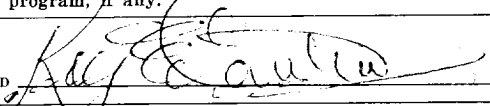

TITLE

Field Manager

DATE

12-16-1965

(This space for Federal or State office use)

PERMIT NO.

APPROVAL DATE

APPROVED BY

TITLE

DATE

CONDITIONS OF APPROVAL, IF ANY:

*See Instructions On Reverse Side

JAN 25 1966
J. L. GARDNER
ACTING DEPT. OF THE INTERIOR

Instructions

General: This form is designed for submitting proposals to perform certain well operations, as indicated, on all types of lands and leases for appropriate action by either a Federal or a State agency, or both, pursuant to applicable Federal and/or State laws and regulations. Any necessary special instructions concerning the use of this form and the number of copies to be submitted, particularly with regard to local, area, or regional procedures and practices, either are shown below or will be issued by, or may be obtained from, the local Federal and/or State office.

Item 1: If the proposal is to redrill to the same reservoir at a different subsurface location or to a new reservoir, use this form with appropriate notations. Consult applicable State or Federal regulations concerning subsequent work proposals or reports on the well.

Item 4: If there are no applicable State requirements, locations on Federal or Indian land should be described in accordance with Federal requirements. Consult local State or Federal office for specific instructions.

Item 14: Needed only when location of well cannot readily be found by road from the land or lease description. A plat, or plats, separate or on this reverse side, showing the roads to, and the surveyed location of, the well, and any other required information, should be furnished when required by Federal or State agency offices.

Items 15 and 18: If well is to be, or has been directionally drilled, give distances for subsurface location of hole in any present or objective production zone.

Item 22: Consult applicable Federal or State regulations, or appropriate officials, concerning approval of the proposal before operations are started.

NUMBER OF COPIES RECEIVED	
DISTRIBUTION	
SANTA FE	
FILE	
U.S.G.S.	
LAND OFFICE	
TRANSPORTER	OIL
	GAS
PRODUCTION OFFICE	
OPERATOR	

NEW MEXICO OIL CONSERVATION COMMISSION WELL LOCATION AND ACREAGE DEDICATION PLAT SEE INSTRUCTIONS FOR COMPLETING THIS FORM ON THE REVERSE SIDE

FORM C-128
Revised 5/1/57

JAN 25 11 17 AM '66

SECTION A

Operator Carter Foundation Production Co.		Lease Blinebry		Well No. 16
Unit Letter	Section 34	Township 23 South	Range 37 East	County Lea
Actual Footage Location of Well: 1340 feet from the east line and 1340 feet from the north line				
Ground Level Elev. 3257 ft.	Producing Formation Penrose Sand	Pool Langlie-Mattix	Dedicated Acreage: 20 Acres	

- Is the Operator the only owner in the dedicated acreage outlined on the plat below? YES ☒ NO ☐ ("Owner" means the person who has the right to drill into and to produce from any pool and to appropriate the production either for himself or for himself and another. (65-3-29 (e) NMSA 1935 Comp.)
- If the answer to question one is "no," have the interests of all the owners been consolidated by communization agreement or otherwise? YES ☐ NO ☐ . If answer is "yes," Type of Consolidation
- If the answer to question two is "no," list all the owners and their respective interests below:

Owner Mrs. Melba Goins,	Land Description E 1/2 Sec. 34, NW 1/4 and SW 1/4 of SW 1/4 Sec
Eunice, New Mexico	35, T-23-S, R-37-E, Lea County, New Mexico

SECTION B

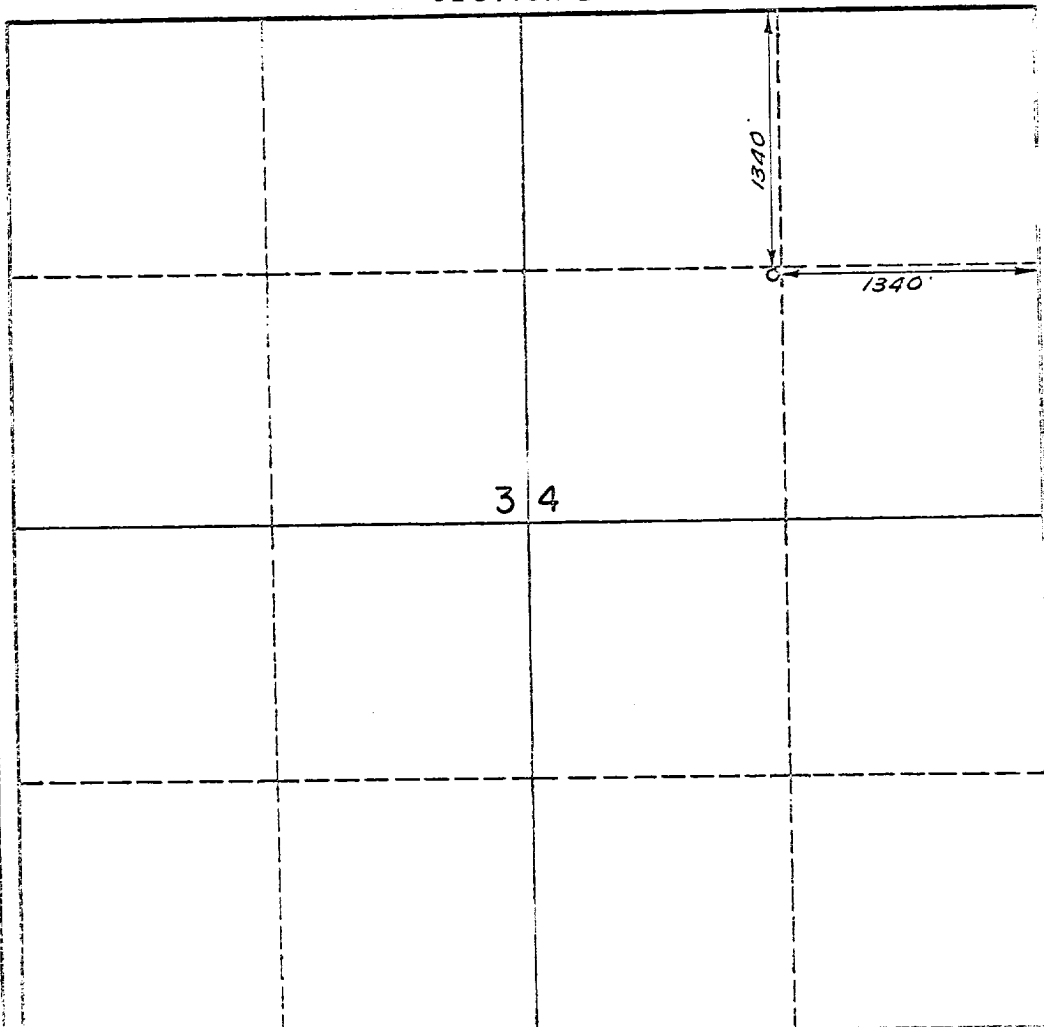

CERTIFICATION

I hereby certify that the information in SECTION A above is true and complete to the best of my knowledge and belief.

Name	K. E. Carter
Position	Field Manager
Company	CARTER FOUNDATION PRODUCTION COMPANY
Date	December 16th, 1965

I hereby certify that the well location shown on the plat in SECTION B was plotted from field notes of actual surveys made by me or under my supervision, and that the same is true and correct to the best of my knowledge and belief.

Date Surveyed	December 2, 1965
Registered Professional Engineer and/or Land Surveyor	[Signature]

Certificate No. 1587

UNITED STATES
DEPARTMENT OF THE INTERIOR
GEOLOGICAL SURVEY
J. H. BOBBS OFFICE O. C. C.

APPLICATION FOR PERMIT TO DRILL, DEEPEN, OR PLUG BACK

1a. TYPE OF WORK

DRILL ☒DEEPEN ☐PLUG BACK ☐

b. TYPE OF WELL

OIL
WELL ☒GAS
WELL ☐

OTHER

SINGLE
ZONE ☒MULTIPLE
ZONE ☐

2. NAME OF OPERATOR

Carter Foundation Production Company

3. ADDRESS OF OPERATOR

P. O. Box 900, Kermit, Texas

4. LOCATION OF WELL (Report location clearly and in accordance with any State requirements.*)

At surface 1,340 feet from North Line and 1,340 feet from East Line
of Section 34, T-23-S, R-37-E, Lea County, New Mexico.
At proposed prod. zone

Same

14. DISTANCE IN MILES AND DIRECTION FROM NEAREST TOWN OR POST OFFICE*

13 Miles Northeast of Jal, New Mexico.

15. DISTANCE FROM PROPOSED*

LOCATION TO NEAREST
PROPERTY OR LEASE LINE, FT.
(Also to nearest drlg. unit line, if any)

1,340

16. NO. OF ACRES IN LEASE

520

17. NO. OF ACRES ASSIGNED
TO THIS WELL

20

18. DISTANCE FROM PROPOSED LOCATION*

TO NEAREST WELL, DRILLING, COMPLETED,
OR APPLIED FOR, ON THIS LEASE, FT.

917

19. PROPOSED DEPTH

3,700

20. ROTARY OR CABLE TOOLS

Rotary

21. ELEVATIONS (Show whether DF, RT, GR, etc.)

Ground 3,257

22. APPROX. DATE WORK WILL START*

January 25th, 1966

23.

PROPOSED CASING AND CEMENTING PROGRAM

SIZE OF HOLE	SIZE OF CASING	WEIGHT PER FOOT	SETTING DEPTH	QUANTITY OF CEMENT
11"	8-5/8" OD	24#	325	200 sacks
7-7/8"	5-1/2" OD	15.50#	3,600	750 sacks

Propose to drill new well for oil and gas production to approximately 3,700 feet.

IN ABOVE SPACE DESCRIBE PROPOSED PROGRAM: If proposal is to deepen or plug back, give data on present productive zone and proposed new productive zone. If proposal is to drill or deepen directionally, give pertinent data on subsurface locations and measured and true vertical depths. Give blowout preventer program, if any.

24.

SIGNED

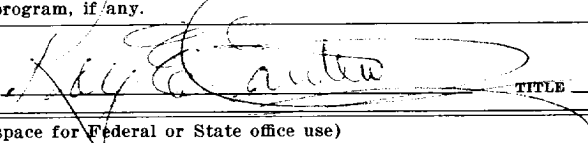

TITLE

Field Manager

DATE 12-16-1965

(This space for Federal or State office use)

PERMIT NO.

APPROVAL DATE

APPROVED BY

TITLE

DATE

CONDITIONS OF APPROVAL, IF ANY:

*See Instructions On Reverse Side

Instructions

General: This form is designed for submitting proposals to perform certain well operations, as indicated, on all types of lands and leases for appropriate action by either a Federal or a State agency, or both, pursuant to applicable Federal and/or State laws and regulations. Any necessary special instructions concerning the use of this form and the number of copies to be submitted, particularly with regard to local, area, or regional procedures and practices, either are shown below or will be issued by, or may be obtained from, the local Federal and/or State office.

Item 1: If the proposal is to redrill to the same reservoir at a different subsurface location or to a new reservoir, use this form with appropriate notations. Consult applicable State or Federal regulations concerning subsequent work proposals or reports on the well.

Item 4: If there are no applicable State requirements, locations on Federal or Indian land should be described in accordance with Federal requirements. Consult local State or Federal office for specific instructions.

Item 14: Needed only when location of well cannot readily be found by road from the land or lease description. A plat, or plats, separate or on this reverse side, showing the roads to, and the surveyed location of, the well, and any other required information, should be furnished when required by Federal or State agency offices.

Items 15 and 18: If well is to be, or has been directionally drilled, give distances for subsurface location of hole in any present or objective production zone.

Item 22: Consult applicable Federal or State regulations, or appropriate officials, concerning approval of the proposal before operations are started.

NUMBER OF COPIES RECEIVED	
DISTRIBUTION	
SANTA FE	
FILE	
U.S.G.S.	
LAND OFFICE	
TRANSPORTER	OIL GAS
PRODUCTION OFFICE	
OPERATOR	

NEW MEXICO OIL CONSERVATION COMMISSION
WELL LOCATION AND ACREAGE DEDICATION PLAT
 SEE INSTRUCTIONS FOR COMPLETING THIS FORM ON THE REVERSE SIDE

FORM C-128
 Revised 5/1/57

SECTION A

Operator Carter Foundation Production Co.		Lease Blinebry		Well No. 16
Unit Letter	Section 34	Township 23 South	Range 37 East	County Lea
Actual Footage Location of Well: 1340 feet from the east line and 1340 feet from the north line				
Ground Level Elev. 3257 ft.	Producing Formation Penrose Sand	Pool Langlie-Mattix	Dedicated Acreage: 20 Acres	

- Is the Operator the only owner in the dedicated acreage outlined on the plat below? YES ☒ NO ____ . ("Owner" means the person who has the right to drill into and to produce from any pool and to appropriate the production either for himself or for himself and another. (65-3-29 (e) NMSA 1935 Comp.)
- If the answer to question one is "no," have the interests of all the owners been consolidated by communitization agreement or otherwise? YES ____ NO ____ . If answer is "yes," Type of Consolidation ____
- If the answer to question two is "no," list all the owners and their respective interests below: ____

Owner Mrs. Melba Goins,	Land Description E 1/2 Sec. 34, NW 1/4 and SW 1/4 of SW 1/4 Sec
Bunice, New Mexico	35, T-23-S, R-37-E, Lea County, New Mexico.

SECTION B

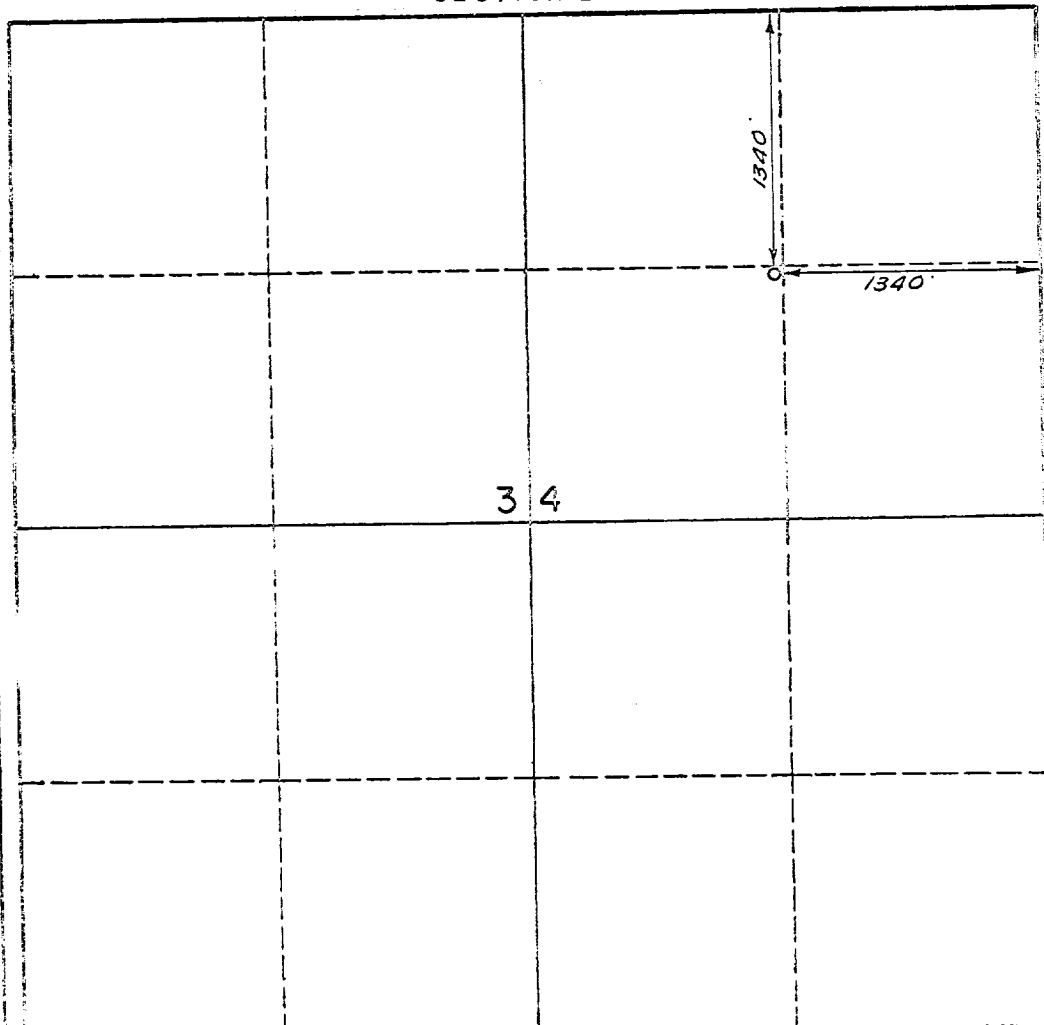

CERTIFICATION

I hereby certify that the information in SECTION A above is true and complete to the best of my knowledge and belief.

Name <i>Ray E. Carter</i>
Position Field Manager
Company CARTER FOUNDATION PRODUCTION COMPANY
Date December 16th, 1965

I hereby certify that the well location shown on the plat in SECTION B was plotted from field notes of actual surveys made by me or under my supervision, and that the same is true and correct to the best of my knowledge and belief.

Date Surveyed December 2, 1965
Registered Professional Engineer and/or Land Surveyor <i>E. J. [Signature]</i>
Certificate No. 1587

0 330 660 990 1320 1650 1980 2310 2640 2000 1500 1000 500 0