

Oil Reports and Gas Services

P. O. BOX 763
HORBS, NEW MEXICO

W. L. SMITH, OWNER

December 14, 1967

EX 3-2727

Oil Conservation Commission
P. O. Box 1148
Santa Fe, New Mexico

Gentlemen:

In accordance with the provisions of Rule 104, Section F, an application is hereby made for administrative approval of an unorthodox location on behalf of William F. Grauten of Midland, Texas.

This location to be known as the William F. Grauten - Russell Federal No. 6, 2341 feet from the South line and 1395 feet from the West line of Section 20, Township 26 South, Range 32 East, Lea County, New Mexico as shown on the attached plats.

In support of this application we state as follows:

1. An orthodox location of 330 feet from the North and West lines of the NE/4 of the SW/4 of said Section 26 would fall in the right-of-way of County Road C-1.

2. A location East of County Road C-1 would be geologically unfeasible with small chance of obtaining commercial production.

3. All offset acreage and diagonal acreage is operated by William F. Grauten by virtue of a farm-out agreement with Continental Oil Company and said unorthodox location would not result in any undue advantage to William F. Grauten at the expense of any offset operator.

As stated in Item 3 above there are no offset operators that require notification and therefore it is respectfully requested that the 30-day waiting period be waived.

Yours very truly,

OIL REPORTS AND GAS SERVICES

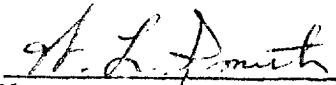
W. L. Smith

DH

cc Oil Conservation Commission
P. O. Box 1980
Hobbs, New Mexico

NEW MEXICO OIL CONSERVATION COMMISSION
WELL LOCATION AND ACREAGE DEDICATION PLAT

Form C-102
Supersedes C-128
Effective 1-1-65

All distances must be from the outer boundaries of the Section.

Operator WILLIAM F. GRAUTEN		Lease RUSSELL - FEDERAL		Well No. 6	
Unit Letter "K"	Section 20	Township 26-S	Range 32-E	County LEA	
Actual Footage Location of Well: 2341 feet from the SOUTH line and 1395 feet from the WEST line					
Ground Level Elev. 3185	Producing Formation DELAWARE		Pool EAST NORTH MASON		Dedicated Acreage: 40 Acres

1. Outline the acreage dedicated to the subject well by colored pencil or hachure marks on the plat below.
2. If more than one lease is dedicated to the well, outline each and identify the ownership thereof (both as to working interest and royalty).
3. If more than one lease of different ownership is dedicated to the well, have the interests of all owners been consolidated by communitization, unitization, force-pooling, etc?

☐ Yes ☐ No If answer is "yes," type of consolidation _____

If answer is "no" list the owners and tract descriptions which have actually been consolidated. (Use reverse side of this form if necessary.) _____

No allowable will be assigned to the well until all interests have been consolidated (by communitization, unitization, forced-pooling, or otherwise) or until a non-standard unit, eliminating such interests, has been approved by the Commission.

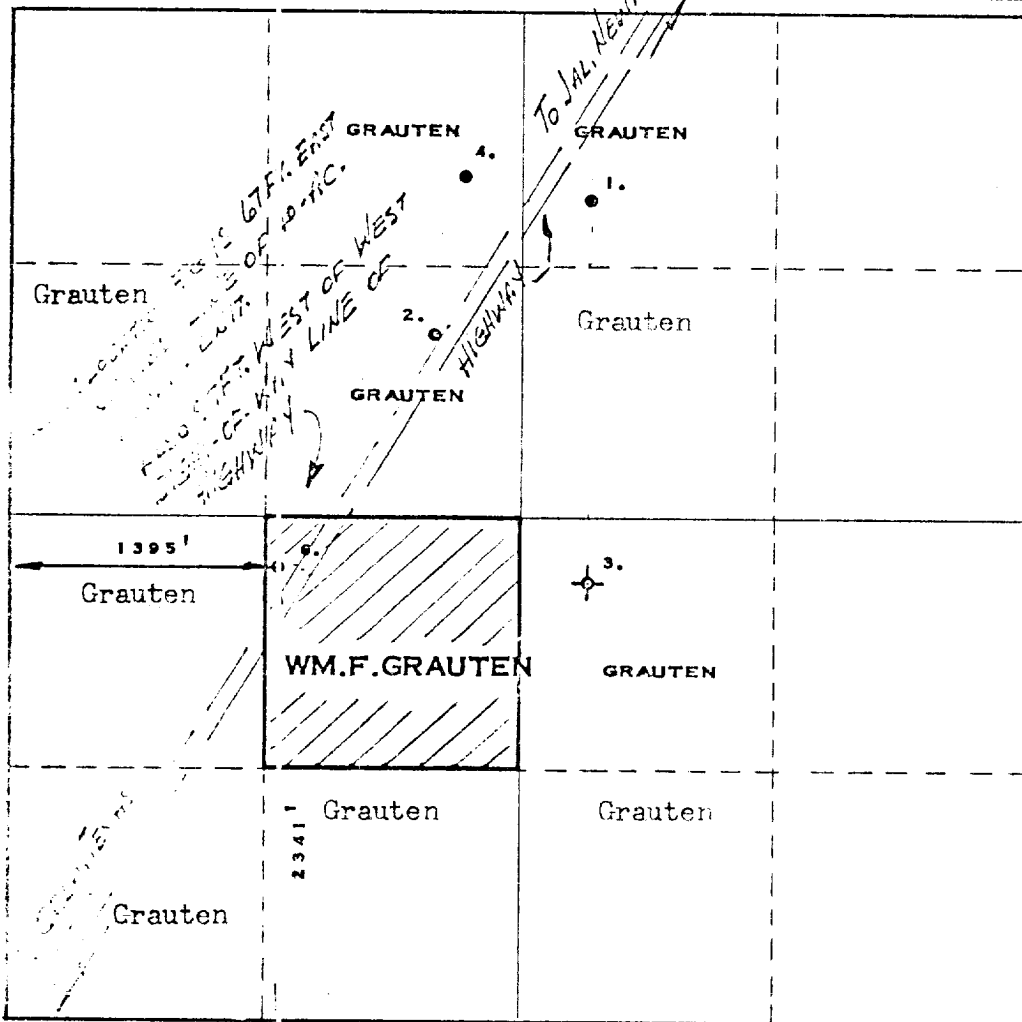

CERTIFICATION

I hereby certify that the information contained herein is true and complete to the best of my knowledge and belief.

Name W. L. Smith
Position
Agent
Company
William F. Grauten
Date
December 14, 1967

I hereby certify that the well location shown on this plat was plotted from field notes of actual surveys made by me or under my supervision, and that the same is true and correct to the best of my knowledge and belief.

Date Surveyed
DECEMBER 11, 1967
Registered Professional Surveyor
and Land Surveyor
Max A. Schumann
MAX A. SCHUMANN
Certificate No. **1510**

