

**UNITED STATES
DEPARTMENT OF THE INTERIOR
GEOLOGICAL SURVEY**

APPLICATION FOR PERMIT TO DRILL, DEEPEN, OR PLUG BACK

1a. TYPE OF WORK
 DRILL DEEPEN PLUG BACK

b. TYPE OF WELL
 OIL WELL GAS WELL OTHER
 SINGLE ZONE MULTIPLE ZONE

2. NAME OF OPERATOR
Gulf Oil Corporation

3. ADDRESS OF OPERATOR
P. O. Box 980, Kermit, Texas 79745

4. LOCATION OF WELL (Report location clearly and in accordance with any State requirements.)*
 At surface
1980' FWL and 2130' FWL
 At proposed prod. zone
Within 300' of surface location

14. DISTANCE IN MILES AND DIRECTION FROM NEAREST TOWN OR POST OFFICE*
12 miles North of Jal, New Mexico

10. DISTANCE FROM PROPOSED* LOCATION TO NEAREST PROPERTY OR LEASE LINE, FT. (Also to nearest drlg. unit line, if any)
510'

16. NO. OF ACRES IN LEASE
1600

17. NO. OF ACRES ASSIGNED TO THIS WELL
40

18. DISTANCE FROM PROPOSED LOCATION* TO NEAREST WELL, DRILLING, COMPLETED, OR APPLIED FOR, ON THIS LEASE, FT.
Approx. 2700' North of #22

19. PROPOSED DEPTH
6300'

20. ROTARY OR CABLE TOOLS
Rotary

21. ELEVATIONS (Show whether DF, RT, GR, etc.)
3304.7 GR

22. APPROX. DATE WORK WILL START*
Upon approval of Permit

23. PROPOSED CASING AND CEMENTING PROGRAM

SIZE OF HOLE	SIZE OF CASING	WEIGHT PER FOOT	SETTING DEPTH	QUANTITY OF CEMENT
11"	8-5/8"	24#	850'	Circuitite
7-7/8"	5-1/2"	15.50#	6000'	Top of base of salt (2300')

Will drill to 6000' to test the Teagus Klinebry formation within the interval 5350' to 5900'.

IN ABOVE SPACE DESCRIBE PROPOSED PROGRAM: If proposal is to deepen or plug back, give data on present productive zone and proposed new productive zone. If proposal is to drill or deepen directionally, give pertinent data on subsurface locations and measured and true vertical depths. Give blowout preventer program, if any.

24. SIGNED H. F. Swannack TITLE Area Manager DATE 2-9-68

(This space for Federal or State office use)

PERMIT NO. _____ APPROVAL DATE _____

APPROVED

APPROVED BY _____ TITLE _____ DATE _____

FEB 12 1968

*See Instructions On Reverse Side J L GORDON
ACTING DISTRICT ENGINEER

5. LEASE DESIGNATION AND SERIAL NO.
Federal LC 030157

6. IF INDIAN, ALLOTTEE OR TRIBE NAME

7. UNIT AGREEMENT NAME

8. FARM OR LEASE NAME
C. E. Lamington

9. WELL NO.
27

10. FIELD AND POOL, OR WILDCAT
Teagus Klinebry

11. SEC., T., R., M., OR BLK. AND SURVEY OR AREA
Sec. 21, T-23S, R-37E

12. COUNTY OR PARISH
Lea

13. STATE
New Mexico

Instructions

General: This form is designed for submitting proposals to perform certain well operations, as indicated, on all types of lands and leases for appropriate action by either a Federal or a State agency, or both, pursuant to applicable Federal and/or State laws and regulations. Any necessary special instructions concerning the use of this form and the number of copies to be submitted, particularly with regard to local, area, or regional procedures and practices, either are shown below or will be issued by, or may be obtained from, the local Federal and/or State office.

Item 1: If the proposal is to redrill to the same reservoir at a different subsurface location or to a new reservoir, use this form with appropriate notations. Consult applicable State or Federal regulations concerning subsequent work proposals or reports on the well.

Item 4: If there are no applicable State requirements, locations on Federal or Indian land should be described in accordance with Federal requirements. Consult local State or Federal office for specific instructions.

Item 14: Needed only when location of well cannot readily be found by road from the land or lease description. A plat, or plats, separate or on this reverse side, showing the route to, and the surveyed location of, the well, and any other required information, should be furnished when required by Federal or State agency offices.

Items 15 and 18: If well is to be, or has been directionally drilled, give distances for subsurface location of hole in any present or objective production zone.

Item 24: Consult applicable Federal or State regulations, or appropriate officials, concerning approval of the proposal before operations are started.

NEW MEXICO OIL CONSERVATION COMMISSION
WELL LOCATION AND ACREAGE DEDICATION PLAT

Form C-102
Supersedes C-128
Effective 1-1-65

All distances must be from the outer boundaries of the Section

Operator GULF OIL CORP.		Lease C. E. LAMUNYON		Well No. 27
Unit Letter F	Section 21	Township 23 SOUTH	Range 37 EAST	County LEA
Actual Footage Location of Well: 1980 feet from the NORTH line and 2130 feet from the WEST line				
Ground Level Elev. 3304.7	Producing Formation Elmley	Pool Tampa Elmley	Dedicated Acreage: 40 Acres	

- Outline the acreage dedicated to the subject well by colored pencil or hachure marks on the plat below.
- If more than one lease is dedicated to the well, outline each and identify the ownership thereof (both as to working interest and royalty).
- If more than one lease of different ownership is dedicated to the well, have the interests of all owners been consolidated by communitization, unitization, force-pooling, etc?

Yes No If answer is "yes," type of consolidation _____

If answer is "no," list the owners and tract descriptions which have actually been consolidated. (Use reverse side of this form if necessary.) _____

No allowable will be assigned to the well until all interests have been consolidated (by communitization, unitization, forced-pooling, or otherwise) or until a non-standard unit, eliminating such interests, has been approved by the Commission.

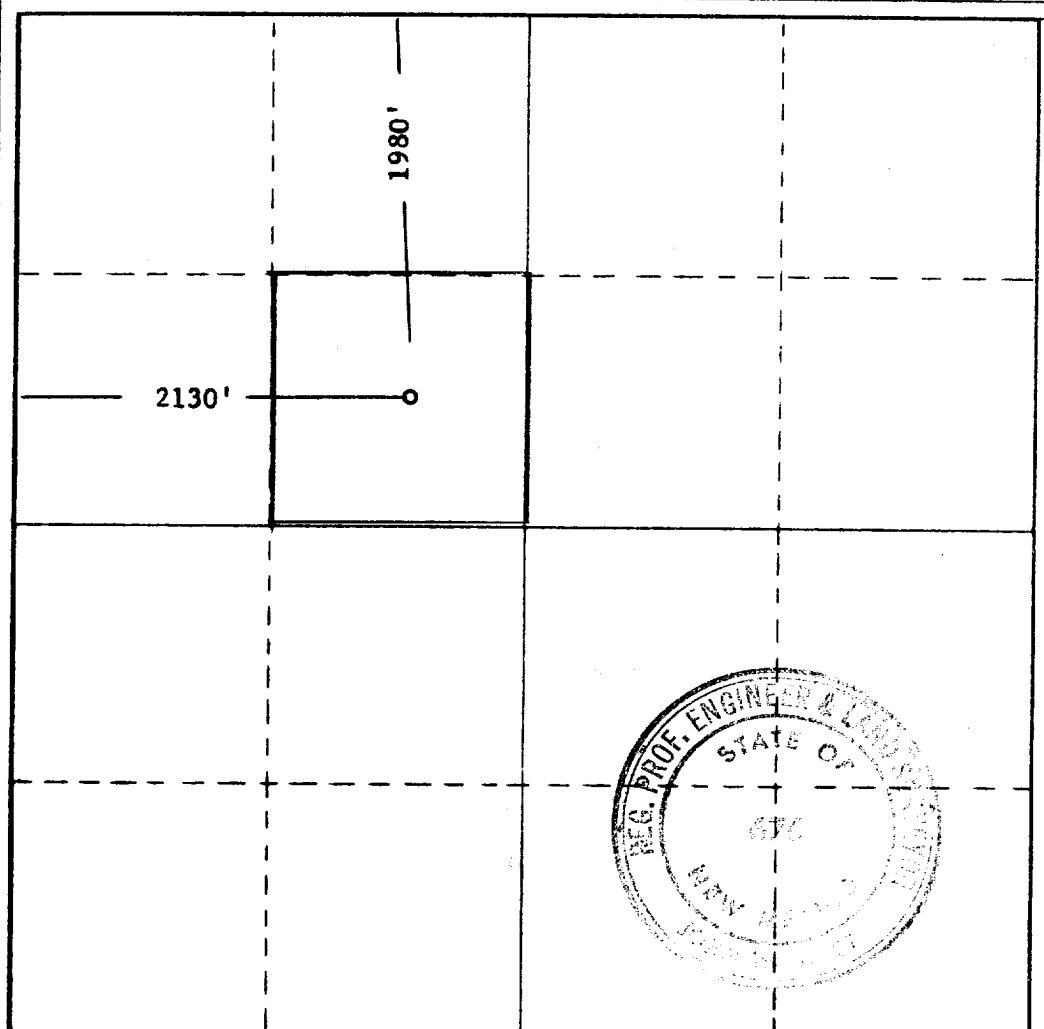

CERTIFICATION

I hereby certify that the information contained herein is true and complete to the best of my knowledge and belief.

ORIGINAL
SIGNED BY: **H. F. SWANNACK**
Name

H. F. Swannack
Position

Area Manager
Company
Gulf Oil Corporation

Date
February 9, 1968

I hereby certify that the well location shown on this plat was plotted from field notes of actual surveys made by me or under my supervision, and that the same is true and correct to the best of my knowledge and belief.

Date Surveyed
FEB. 2, 1968

Registered Professional Engineer
and/or Land Surveyor

John W. West
Certificate No. **676**

