

NEW MEXICO OIL CONSERVATION COMMISSION  
WELL LOCATION AND ACREAGE DEDICATION PLAT

Form C-102  
Supersedes C-128  
Effective 1-1-65

All distances must be from the outer boundaries of the Section.

Operator <b>SOLAR OIL COMPANY</b>		Lease <b>ELK STATE</b>			Well No. <b>2</b>
Tract Letter <b>M</b>	Section <b>16</b>	Township <b>23 SOUTH</b>	Range <b>37 EAST</b>	County <b>LEA</b>	
Actual Footage Location of Well: <b>330</b> feet from the <b>SOUTH</b> line and <b>990</b> feet from the <b>WEST</b> line					
Ground Level Elev. <b>3311.8</b>	Producing Formation <b>BLINEBRY</b>		Pool <b>TEAGUE BLINEBRY</b>	Dedicated Acreage: <b>SW 1/4 40</b> Acres	

1. Outline the acreage dedicated to the subject well by colored pencil or hachure marks on the plat below.
2. If more than one lease is dedicated to the well, outline each and identify the ownership thereof (both as to working interest and royalty).
3. If more than one lease of different ownership is dedicated to the well, have the interests of all owners been consolidated by communitization, unitization, force-pooling, etc?

Yes  No If answer is "yes," type of consolidation \_\_\_\_\_

If answer is "no," list the owners and tract descriptions which have actually been consolidated. (Use reverse side of this form if necessary.) \_\_\_\_\_

No allowable will be assigned to the well until all interests have been consolidated (by communitization, unitization, forced-pooling, or otherwise) or until a non-standard unit, eliminating such interests, has been approved by the Commission.

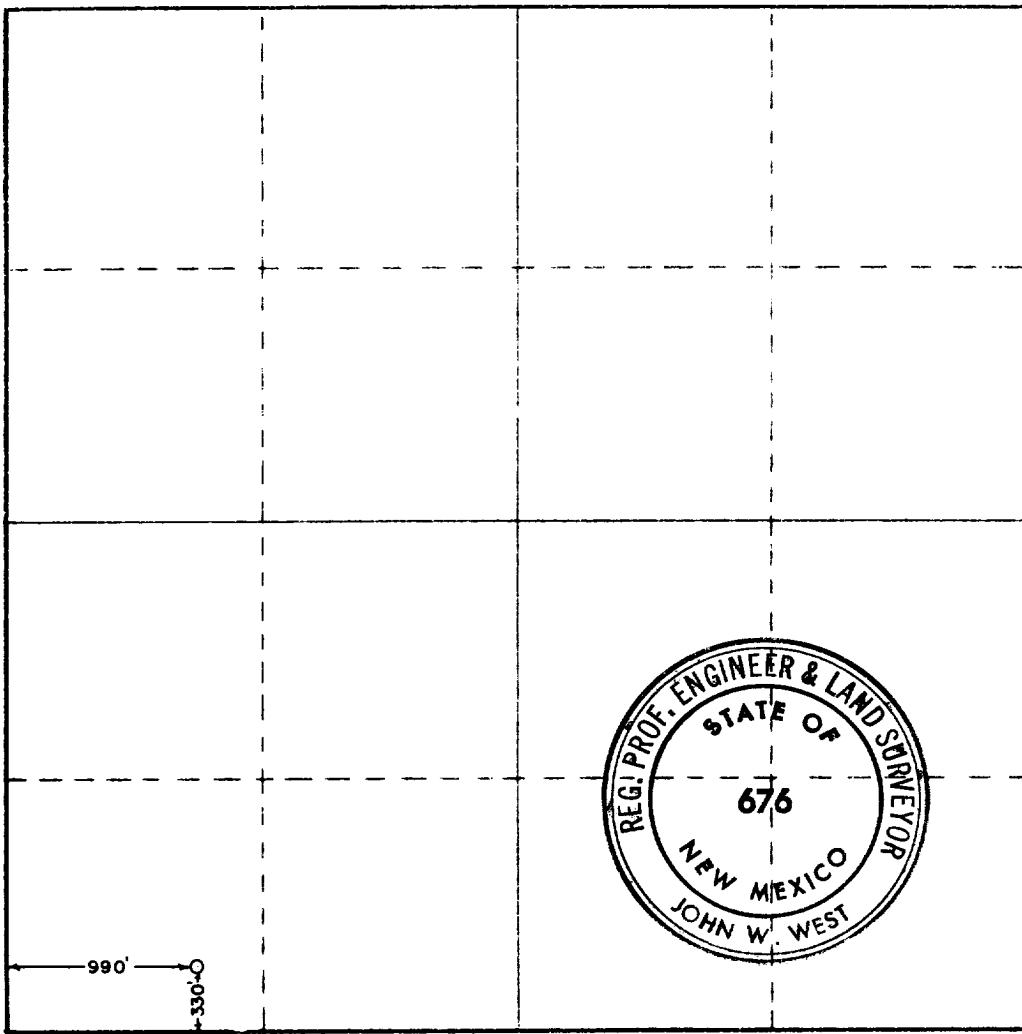

CERTIFICATION

I hereby certify that the information contained herein is true and complete to the best of my knowledge and belief

Name *John W West*  
Position  
**AGENT**

Company  
**SOLAR OIL COMPANY**

Date *30 JUL 3 AM '67*  
**6024-1968**

I hereby certify that the well location shown on this plat was plotted from field notes of actual surveys made by me or under my supervision, and that the same is true and correct to the best of my knowledge and belief.

Date Surveyed  
**DEC. 11, 1967**

Registered Professional Engineer and/or Land Surveyor

*John W West*  
Certificate No. **676**

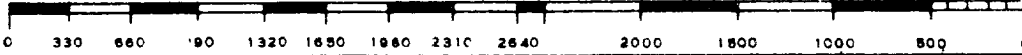

7-30-68

Cont.

Acid (5393-5488') 1500 gals.  
Frac (5393-5488') 20,000 gals wtr + 32,500# sd.  
Acid (5536-5729') 2250 gals.  
Frac (5536-5729') 40,000 gals wtr + 49,500# sd.  
Acid (5760-5944') 2250 gals.  
Frac (5760-5944') 40,000 gals wtr + 59,400# sd.

8-5-68

TD 6160', PBD 6128', COMPLETE

8-12-68

TD 6160', PBD 6128', COMPLETION REPORTED  
LOG: Anhy 1060', Yates 2584', Seven Rivers  
2840', Queen 3410', Grayburg 3590', SA  
3843', Glorieta 4973', Elinebry 5367', Tubb  
6007', Drinkard 6158'.

COUNTY LEA FIELD Teague STATE NM 30-025-22639

OPR SOLAR OIL CO. MAP

2 Elk-State

Sec. 16, T-23-S, R-37-E CO-ORD

330' ESL, 990' FWL of Sec.

Spd 6-29-68 CLASS EL

Cmp 7-27-68

CSG & SX - TUBING	FORMATION			
	FORMATION	DATUM	FORMATION	DATUM
9 5/8" 1035' 400				
5 1/2" 6160' 530				

LOGS EL GR RA IND HC A TD 6160', PBD 6128'

IP Blinebry Perfs 5393-5944' Flwd 109 BOPD + 12 BW. Pot. Based on 24 hr test thru 32/64" chk., TP 550#, CP 800#, Gravity 39.6, GOR 480.

Distribution limited and publication prohibited by subscribers' agreement. Reproduction rights reserved by Williams & Lee Scouting Service, Inc.

CONT. Johnn Drlg. Co. PROP DEPTH 6000' TYPE RT

DATE

- F.R. 7-3-68; Elev. 3328' DF
- PD 6000' - Blinebry
- Contr. - Johnn Drlg. Co.
- 7-9-68 Drlg. 4440'.  
Cored 4270-83', rec 13' dolo., bldg wtr.  
Cored 4283-4313', rec 30' dolo., bldg wtr.  
Cored 4313-65', rec 52' dolo., bldg sul wtr.
- 7-15-68 Drlg. 5742'.  
Cored 4550-79', rec 29' dolo., bldg wtr.
- 7-24-68 TD 6160', prep perf.
- 7-30-68 TD 6160', PBD 6128', swbg load.  
Perf 5393-5488' W/11 shots (Overall)  
Perf 5536-5729' W/16 shots (Overall)  
Perf 5760-5944' W/17 shots (Overall)