

NEW MEXICO OIL CONSERVATION COMMISSION

Form 7-121
Revised 1-1-65

NO. OF COPIES RECEIVED	
DISTRIBUTION	
SANTA FE	
FILE	
U.S.G.S.	
LAND OFFICE	
OPERATOR	

5A. Indicate Type of Lease
STATE FEE
6. State Oil & Gas Lease No.

APPLICATION FOR PERMIT TO DRILL, DEEPEN, OR PLUG BACK

1a. Type of Work

DRILL

DEEPEN

PLUG BACK

MULTIPLE ZONE

b. Type of Well

GAS WELL

OTHER

Water Supply

7. Unit Agreement Name

8. Firm or Lease Name

Jal Water System

9. Well No.

6

10. Field and Pool, or Wildcat

c. Name of Operator

Skelly Oil Company

d. Address of Operator
P. O. Box 1351, Midland, Texas 79701

LOCATED 1313 FEET FROM THE

North

LINE

e. Location of Well

UNIT LETTER B

East

LINE OF SEC. 4

TWP. 24S

RGE. 36E

NADPM

12. County
Lea

AND 1327 FEET FROM THE

18. Proposed Depth
4500'

19A. Formation
Capitan Reef

20. Rotary or C.T.
Rotary

22. Approx. Date Work will start
Immediately

21A. Kind & Status Plug. Bond
Blanket Bond #1253688
#100,000 W/Fed. Ins. Co.

21B. Drilling Contractor
Leatherwood Drilling Company

23. Cement (Specify whether DF, RT, etc.)
Unknown

PROPOSED CASING AND CEMENT PROGRAM

SIZE OF HOLE	SIZE OF CASING	WEIGHT PER FOOT	SETTING DEPTH	SACKS OF CEMENT	EST. TO SURFACE
17"	13-3/8"	44.5#	360'	300	2700'
12-1/4"	9-5/8"	36.0#	3900'	475	
8-3/4"	Open hole to 4500'				

The pump and plug process will be used in cementing all strings of casing and cement will be circulated to surface on the 13-3/8" casing. The 9-5/8" will be set at 3900' and cemented with 475 sacks of cement. Well will be treated for corrosion and scale inhibition and will be utilized as a water supply well for Skelly's Jal Water System.

The drilling fluid will be brine water with sufficient salt gel to condition the hole during logging and running casing. Blow out preventer will be installed and tested to 1000 psi.

APPROVAL VALID FOR 90 DAYS UNLESS DRILLING COMMENCED,

EXPIRES 4-22-73

IN ABOVE SPACE DESCRIBE PROPOSED PROGRAM: IF PROPOSAL IS TO DEEPEN OR PLUG BACK, GIVE DATA ON PRESENT PRODUCTIVE ZONE AND PRODUCTIVE ZONE. GIVE BLOW-OUT PREVENTER PROGRAM, IF ANY.

I hereby certify that the information above is true and complete to the best of my knowledge and belief.

Signed (Signed) C. J. LOVE c. J. Love title District Prod. Manager

Date January

APPROVED BY
CONDITIONS OF APPROVAL, IF ANY:

TITLE

DATE

NEW MEXICO OIL CONSERVATION COMMISSION
WELL LOCATION AND ACREAGE DEDICATION PLAT

Form O-102
Supersedes O-128
Effective 1-1-65

All distances must be from the outer boundaries of the Section.

Operator SKELLY OIL CO.		Lease JAL WATER SYSTEM			Well No. 6
Tract Letter B	Section 4	Township 24 SOUTH	Range 36 EAST	County LEA	
Actual Footage Location of Well: 1313 feet from the NORTH line and 1327 feet from the EAST line.					
Ground Level Elev.	Producing Formation	Pool	Estimated Acreage		

1. Outline the acreage dedicated to the subject well by colored pencil or washure marks on the plat below.
2. If more than one lease is dedicated to the well, outline each and identify the ownership thereof (both as to working interest and royalty).
3. If more than one lease of different ownership is dedicated to the well, have the interests of all owners been consolidated by communitization, unitization, force-pooling, etc?

Yes No If answer is "yes," type of consolidation _____

If answer is "no," list the owners and tract descriptions which have actually been consolidated. (Use reverse side of this form if necessary.) _____

No allowable will be assigned to the well until all interests have been consolidated (by communitization, unitization, forced-pooling, or otherwise) or until a non-standard unit, eliminating such interests, has been approved by the Commission.

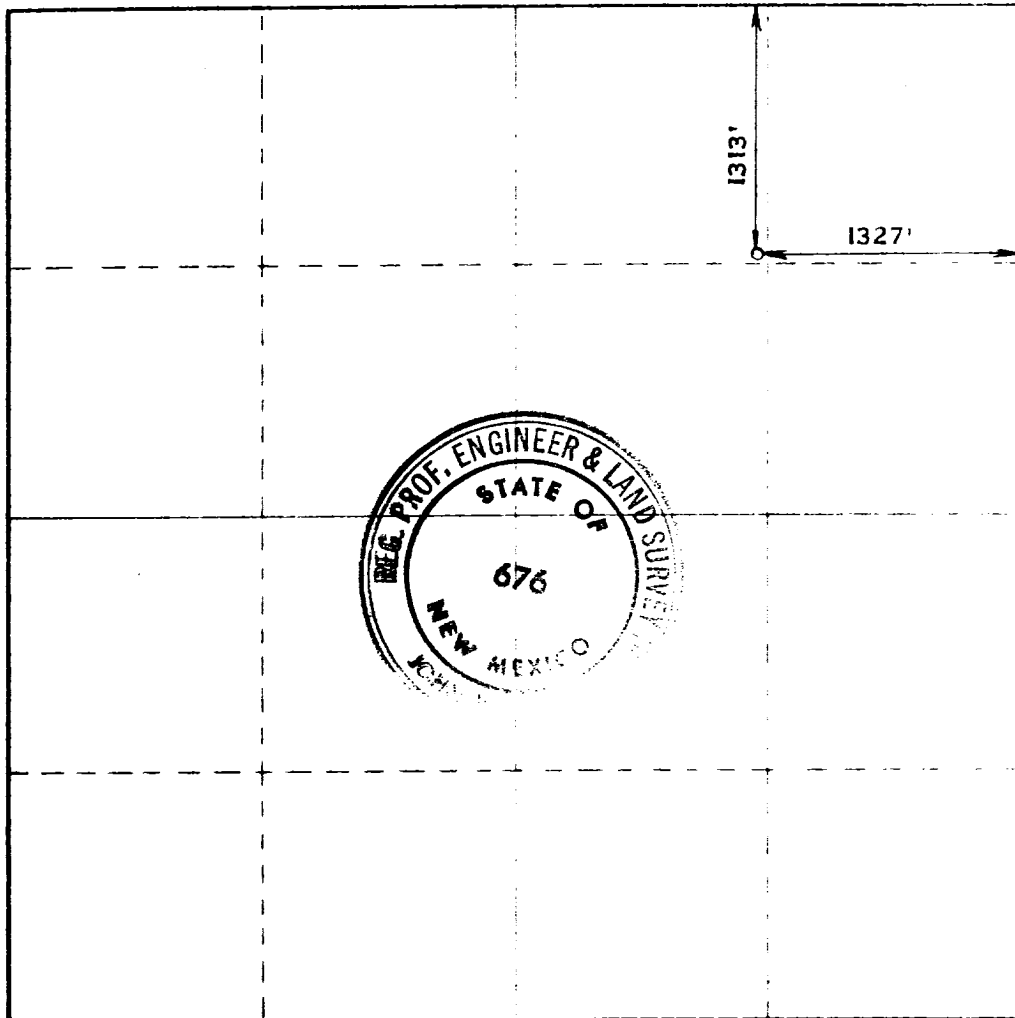

CERTIFICATION

I hereby certify that the information contained herein is true and complete to the best of my knowledge and belief.

C. J. Love

C. J. Love

District Prod. Manager

Skelly Oil Company

January 17, 1973

I hereby certify that the well location shown on this plat was plotted from field notes of actual surveys made by me or under my supervision, and that the same is true and correct to the best of my knowledge and belief.

JANUARY 12, 1973

Registered Professional Engineer

John W West

676

