

NEW MEXICO OIL CONSERVATION COMMISSION
WELL LOCATION AND ACREAGE DEDICATION PLAT

Form C-102
Supersedes C-128
Effective 1-1-65

All distances must be from the outer boundaries of the Section

Operator Tenneco Oil Co.			Lease Leonard Brothers			Well No. 26
Init Letter D	Section 13	Township 26 South	Range 37 East	County Lea		
Actual Footage Location of Well: 660 feet from the North line and 660 feet from the West line						
Ground Level Elev.	Producing Formation Queen	Pool UNDESIGNATED	Dedicated Acreage: 40 Acres			

- Outline the acreage dedicated to the subject well by colored pencil or hatchure marks on the plat below.
- If more than one lease is dedicated to the well, outline each and identify the ownership thereof (both as to working interest and royalty).
- If more than one lease of different ownership is dedicated to the well, have the interests of all owners been consolidated by communitization, unitization, force-pooling, etc?
☐ Yes ☐ No If answer is "yes," type of consolidation _____

If answer is "no," list the owners and tract descriptions which have actually been consolidated. (Use reverse side of this form if necessary.) _____

No allowable will be assigned to the well until all interests have been consolidated (by communitization, unitization, forced-pooling, or otherwise) or until a non-standard unit, eliminating such interests, has been approved by the Commission.

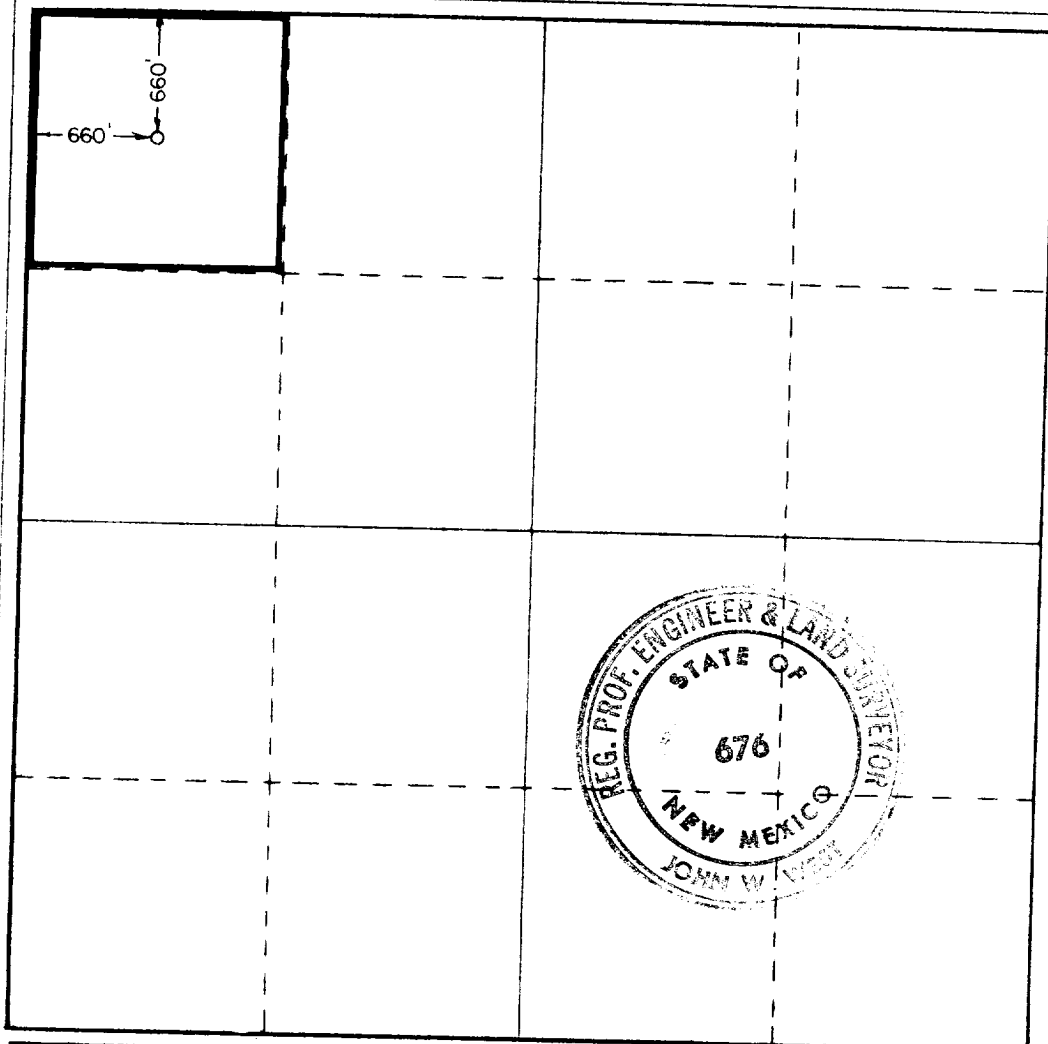

CERTIFICATION

I hereby certify that the information contained herein is true and complete to the best of my knowledge and belief.

Name J. A. Rush
 Position Environmental Coordinator
Tenneco Oil Company
 Date May 22, 1978

I hereby certify that the well location shown on this plat was plotted from field notes of actual surveys made by me or under my supervision, and that the same is true and correct to the best of my knowledge and belief.

Date Surveyed 4/17/78
 Registered Professional Engineer and/or Land Surveyor

John W. West
 Certificate No. John W. West 676
Ronald J. Eidson 3239

SPECIAL STIPULATION

9. Dirt contractor (C & O of Tatum, N.M.) will consult with Manton Botsford, archeologist BLM, Roswell office prior to construction.

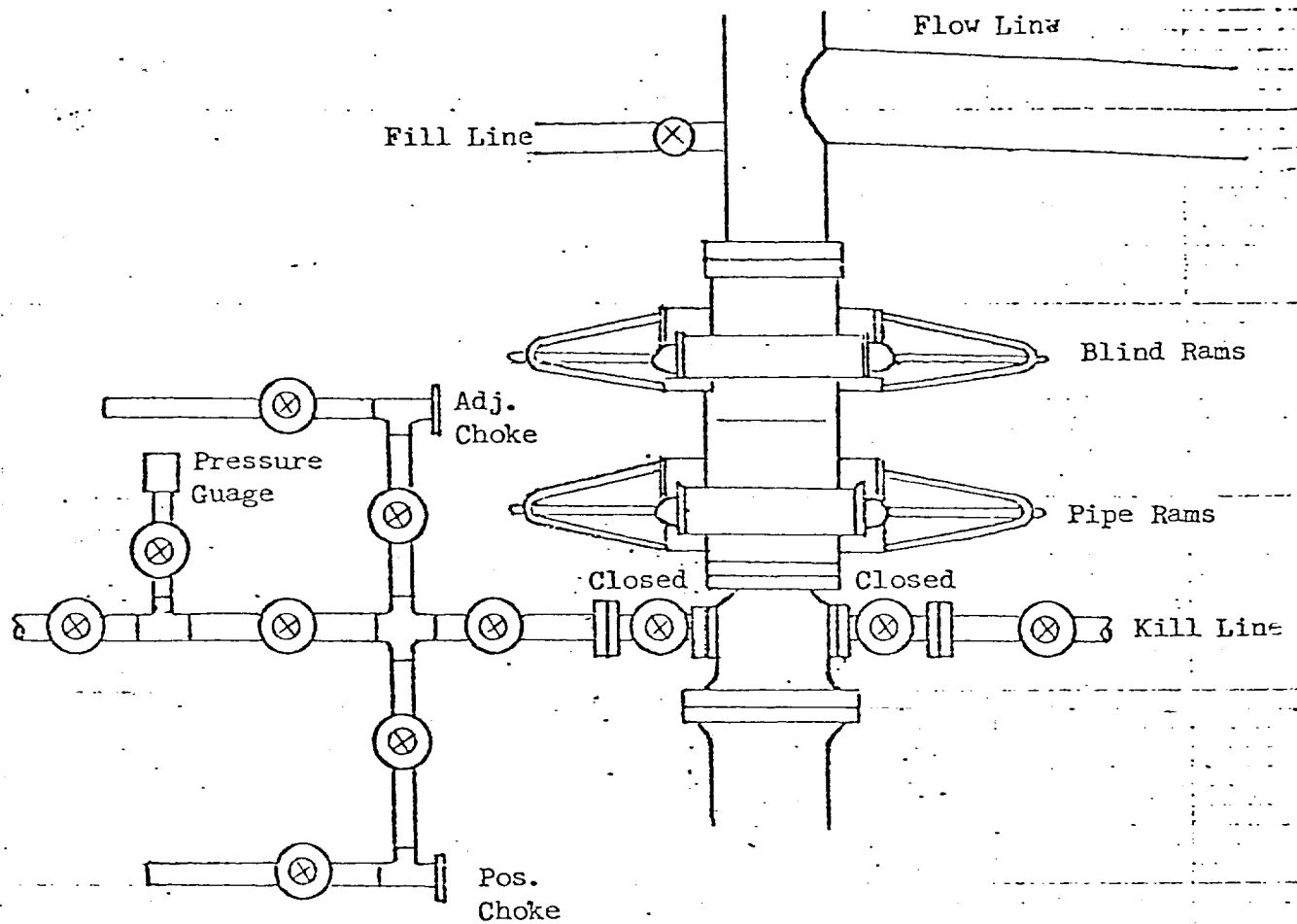

All valves 2"

All BOPs, flanges, spools, valves, & lines must be series 900 or 3000 psi working press.

Choke manifold must be at ground level and extended out from under substructure.

TENNECO OIL COMPANY

REQUIRED MINIMUM BLOWOUT PREVENTOR

HOOKUP

Denver, Colorado