

| | |
|------------------------|--|
| NO. OF COPIES RECEIVED | |
| DISTRIBUTION | |
| SANTA FE | |
| FILE | |
| U.S.G.S. | |
| LAND OFFICE | |
| OPERATOR | |

NEW MEXICO OIL CONSERVATION COMMISSION

Form C-101
Revised 1-1-65

5A. Indicate Type of Lease
STATE ☐ FEE ☒

5. State Oil & Gas Lease No.

APPLICATION FOR PERMIT TO DRILL, DEEPEN, OR PLUG BACK

| | | | |
|---|---|---|---|
| 1a. Type of Work DRILL <input checked="" type="checkbox"/> DEEPEN <input type="checkbox"/> PLUG BACK <input type="checkbox"/> | | | 7. Unit Agreement Name |
| b. Type of Well OIL WELL <input checked="" type="checkbox"/> GAS WELL <input type="checkbox"/> OTHER <input type="checkbox"/> SINGLE ZONE <input checked="" type="checkbox"/> MULTIPLE ZONE <input type="checkbox"/> | | | 8. Farm or Lease Name Lea |
| 3. Name of Operator Alpha Twenty-One Production Company | | | 9. Well No. 2 |
| 2. Address of Operator 2100 First National Bank Building, Midland, Texas 79701 | | | 10. Field and Pool, or Wildcat Undesignated Drinkard |
| 4. Location of Well UNIT LETTER <u>A</u> LOCATED <u>850</u> FEET FROM THE <u>North</u> LINE AND <u>950</u> FEET FROM THE <u>East</u> LINE OF SEC. <u>17</u> TWP. <u>23S</u> RGE. <u>37E</u> NMPM | | | 12. County Lea |
| 19. Proposed Depth 6700 | | 19A. Formation Drinkard | 20. Rotary or C.T. Rotary |
| 21. Elevations (Show whether DE, RT, etc.) 3327 (Ground Level) | 21A. Kind & Status Plug. Bond State Wide | 21B. Drilling Contractor Kenai Capitan | 22. Approx. Date Work will start December 28, 1981 |

PROPOSED CASING AND CEMENT PROGRAM

| SIZE OF HOLE | SIZE OF CASING | WEIGHT PER FOOT | SETTING DEPTH | SACKS OF CEMENT | EST. TOP |
|--------------|----------------|-----------------|---------------|-----------------|-----------|
| 12 1/4" | 8-5/8" | 28 | 1,150' | 700 | Circulate |
| 7-7/8" | 5 1/2" | 17 | 6,700' | 2,000 | Circulate |

The proposed well will be drilled to a total depth of 6,700' and completed as a Drinkard producer. From the base of the Surface Pipe through the running of the Production Casing, the subject well will be equipped with a 3000 PSI Double Ram BOP System.

APPROVAL VALID FOR 180 DAYS
PERMIT EXPIRES 6/17/82
UNLESS DRILLING UNDERWAY

IN ABOVE SPACE DESCRIBE PROPOSED PROGRAM: IF PROPOSAL IS TO DEEPEN OR PLUG BACK, GIVE DATA ON PRESENT PRODUCTIVE ZONE AND PROPOSED NEW PRODUCTIVE ZONE. GIVE BLOWOUT PREVENTER PROGRAM, IF ANY.

I hereby certify that the information above is true and complete to the best of my knowledge and belief.

Signed Tony Phipps Title Executive Vice President Date December 14, 1981
(This space for State Use)

APPROVED BY Jerry L. Sipe TITLE _____ DATE _____

CONDITIONS OF APPROVAL, IF ANY:

NEW MEXICO OIL CONSERVATION COMMISSION
WELL LOCATION AND ACREAGE DEDICATION PLAT

Form O-100
Supersedes O-128
Effective 1-1-85

All distances must be from the outer boundaries of the Section

| | | | | | |
|--|----------------------|--------------------------------------|-------------------------|------------------------------------|--|
| Operator ALPHA 21 PRODUCTION CO. | | Lease LEA XXXX | | Acres 2 | |
| Section A | Section 17 | Township 23 SOUTH | Range 37 EAST | County LEA | |
| Acreage to be Dedicated to Well: 850 feet from the NORTH line and 950 feet from the EAST line. Producing Formation: Drinkard Pool: Undesignated Drinkard | | | | | |
| Well Depth: 3327.4 | | Producing Formation: Drinkard | | Pool: Undesignated Drinkard | |
| | | | | Acres: 40 | |

- Outline the acreage dedicated to the subject well by colored pencil or hatchure marks on the plat below.
- If more than one lease is dedicated to the well, outline each and identify the ownership thereof (both as to working interest and royalty).
- If more than one lease of different ownership is dedicated to the well, have the interests of all owners been consolidated by communitization, unitization, force-pooling, etc?

☐ Yes ☐ No If answer is "yes," type of consolidation _____

If answer is "no," list the owners and tract descriptions which have actually been consolidated. (Use reverse side of this form if necessary.) _____

No allowable will be assigned to the well until all interests have been consolidated (by communitization, unitization, forced-pooling, or otherwise) or until a non-standard unit, eliminating such interests, has been approved by the Commission.

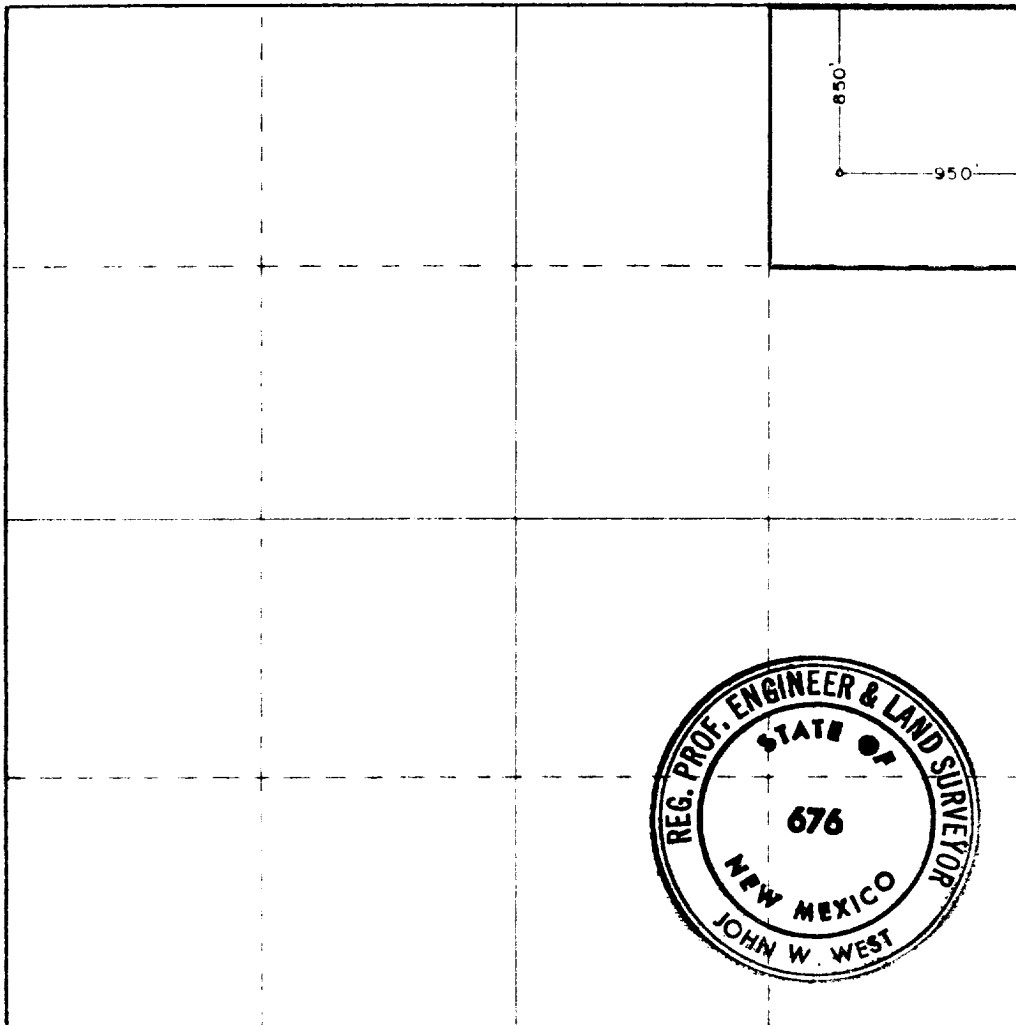

CERTIFICATION

I hereby certify that the information contained herein is true and complete to the best of my knowledge and belief.

Tommy Phipps
Tommy Phipps

Executive Vice President

Alpha Twenty-One Production Co.

December 15, 1981

I hereby certify that the well location shown on this plat was plotted from field notes of actual surveys made by me or under my supervision, and that the same is true and correct to the best of my knowledge and belief.

12-11-81

Signature: *John W. West*
Title: Registered Professional Engineer

Certification No. **JOHN W. WEST 676**
PATRICK A. ROMERO 6868
Ronald J. G. 3239