

**30-025-27749**  
 5. LEASE DESIGNATION AND SERIAL NO.

**NM-12280**

6. IF INDIAN, ALLOTTEE OR TRIBE NAME

7. UNIT AGREEMENT NAME

**TALCO UNIT**

8. FARM OR LEASE NAME

9. WELL NO.

**3**

10. FIELD AND POOL, OR WILDCAT

**WILDCAT**

11. SEC., T., R., M., OR BLK. AND SURVEY OR AREA

**SEC. 12, T. 26 S., R. 35 E.**

12. COUNTY OR PARISH

**LEA**

13. STATE

**NEW MEXICO**

1a. TYPE OF WORK

**DRILL ☒**

**DEEPEN ☐**

**PLUG BACK ☐**

b. TYPE OF WELL

OIL WELL ☐

GAS WELL ☒

OTHER

SINGLE ZONE ☒

MULTIPLE ZONE ☐

2. NAME OF OPERATOR

**AMERICAN TRADING AND PRODUCTION CORPORATION**

3. ADDRESS OF OPERATOR

**P.O. DRAWER 992, MIDLAND, TEXAS 79702**

4. LOCATION OF WELL (Report location clearly and in accordance with any State requirements.)\*

At surface

**1650' FSL AND 990' FWL OF SECTION 12**

At proposed prod. zone

14. DISTANCE IN MILES AND DIRECTION FROM NEAREST TOWN OR POST OFFICE\*

**9 MILES SOUTHWEST OF JAL, NEW MEXICO**

15. DISTANCE FROM PROPOSED\*

LOCATION TO NEAREST PROPERTY OR LEASE LINE, FT. (Also to nearest drlg. unit line, if any)

**990'**

16. NO. OF ACRES IN LEASE

**1240**

17. NO. OF ACRES ASSIGNED TO THIS WELL

**320**

18. DISTANCE FROM PROPOSED LOCATION\*

TO NEAREST WELL, DRILLING COMPLETED, OR APPLIED FOR, ON THIS LEASE, FT.

**2380'**

19. PROPOSED DEPTH

**16,200**

20. ROTARY OR CABLE TOOLS

**ROTARY**

21. ELEVATIONS (Show whether DF, RT, GR, etc.)

**3023.9 GR**

22. APPROX. DATE WORK WILL START\*

**FEBRUARY 20, 1982**

23. PROPOSED CASING AND CEMENTING PROGRAM

| SIZE OF HOLE | SIZE OF CASING | WEIGHT PER FOOT | SETTING DEPTH | QUANTITY OF CEMENT            |
|--------------|----------------|-----------------|---------------|-------------------------------|
| 17-1/2"      | 13-3/8"        | 48#             | 500'          | SUFFICIENT TO CIRCULATE       |
| 12-1/4"      | 10-3/4"        | 40.5# & 45.5#   | 5100'         | SUFFICIENT TO CIRCULATE       |
| 9-1/2"       | 7-5/8"         | 26.4# & 29.7#   | 12,600'       | SUFFICIENT TO TIE BACK        |
| 6-1/2"       | 5" (Liner)     | 18#             | 16,200'       | SUFFICIENT TO CIRCULATE LINER |

PRODUCING ZONE WILL BE PERFORATED AND STIMULATED AS NECESSARY.

SEE ATTACHED FOR: SUPPLEMENTAL DRILLING DATA  
 BOP SKETCH  
 SURFACE USE AND OPERATIONS PLAN

GAS IS DEDICATED.

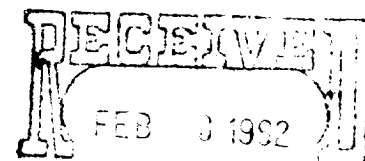

**OIL & GAS**  
**U.S. GEOLOGICAL SURVEY**  
**ROSWELL, NEW MEXICO**

IN ABOVE SPACE DESCRIBE PROPOSED PROGRAM: If proposal is to deepen or plug back, give data on present productive zone and proposed new productive zone. If proposal is to drill or deepen directionally, give pertinent data on subsurface locations and measured and true vertical depths. Give blowout preventer program, if any.

24.

SIGNED

**Arthur R. Brown**

TITLE **AGENT**

DATE **JANUARY 29, 1982**

(This space for Federal or State office use)

PERMIT NO.

**APPROVED**

APPROVED BY

CONDITIONS OF APPROVAL, IF ANY

**FEB 11 1982**

**JAMES A. GILLHAM**  
**DISTRICT SUPERVISOR**

APPROVAL DATE

**APPROVAL SUBJECT TO**

**GENERAL REQUIREMENTS AND**

**SPECIAL STIPULATIONS**

**ATTACHED**

**MEXICO OIL CONSERVATION COMMISSION  
WELL LOCATION AND ACREAGE DEDICATION PLAT**

Form C-102  
Supersedes C-128  
Effective 1-1-65

All distances must be from the outer boundaries of the Section.

|   |                                      |                        |                            |  |                      |
|---|--------------------------------------|------------------------|----------------------------|--|----------------------|
| Operator<br><b>American Trading &amp; Production Corp.</b>  |                                      |                        | Lease<br><b>Talco Unit</b> |  | Well No.<br><b>3</b> |
| Unit Letter<br><b>L</b>   | Section<br><b>12</b>                 | Township<br><b>26S</b> | Range<br><b>35E</b>        | County<br><b>Lea County</b>            |                      |
| Actual Footage Location of Well:<br><b>1650</b> feet from the <b>South</b> line and <b>990</b> feet from the <b>West</b> line |                                      |                        |                            |  |                      |
| Ground Level Elev.<br><b>3023.9</b>   | Producing Formation<br><b>MORROW</b> |                        | Pool<br><b>WILDCAT</b>     | Dedicated Acreage:<br><b>320</b> Acres |                      |

1. Outline the acreage dedicated to the subject well by colored pencil or hachure marks on the plat below.
2. If more than one lease is dedicated to the well, outline each and identify the ownership thereof (both as to working interest and royalty).
3. If more than one lease of different ownership is dedicated to the well, have the interests of all owners been consolidated by communitization, unitization, force-pooling, etc?

☒ Yes    ☐ No    If answer is "yes," type of consolidation UNITIZATION

If answer is "no," list the owners and tract descriptions which have actually been consolidated. (Use reverse side of this form if necessary.) \_\_\_\_\_

No allowable will be assigned to the well until all interests have been consolidated (by communitization, unitization, forced-pooling, or otherwise) or until a non-standard unit, eliminating such interests, has been approved by the Commission.

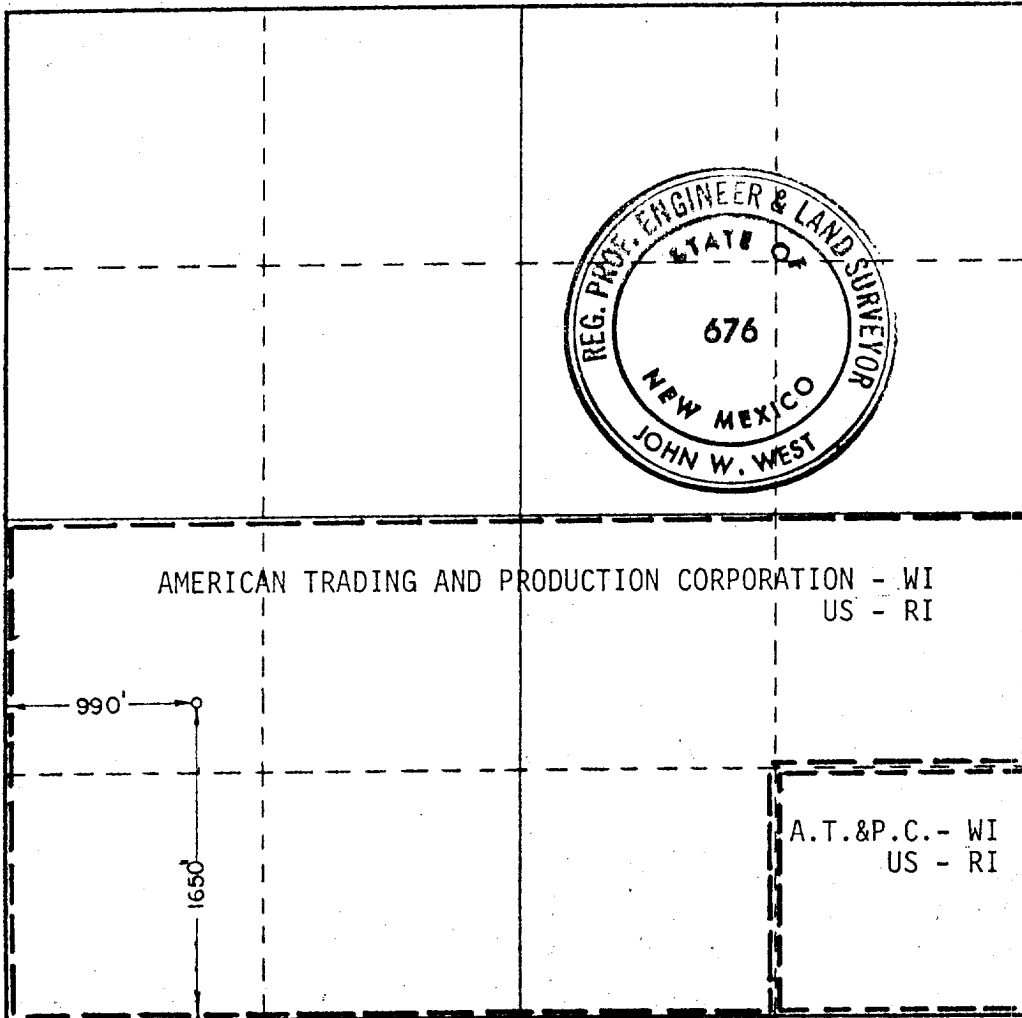
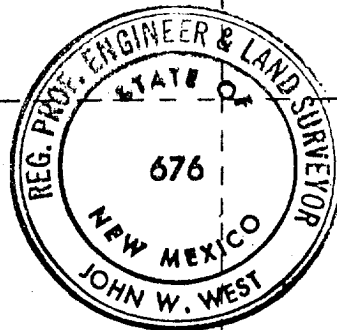

**CERTIFICATION**

I hereby certify that the information contained herein is true and complete to the best of my knowledge and belief.

*Arthur R. Brown*  
Name  
**Arthur R. Brown**

Position  
**Agent for**  
Company **AMERICAN TRADING AND PRODUCTION CORPORATION**

Date  
**JANUARY 29, 1982**

I hereby certify that the well location shown on this plat was plotted from field notes of actual surveys made by me or under my supervision, and that the same is true and correct to the best of my knowledge and belief.

Date Surveyed  
**01/15/82**

Registered Professional Engineer and/or Land Surveyor

*John W. West*  
Certificate No. **JOHN W. WEST 676**  
**PATRICK A. ROMERO 6863**  
**Ronald J. Eldon 3239**

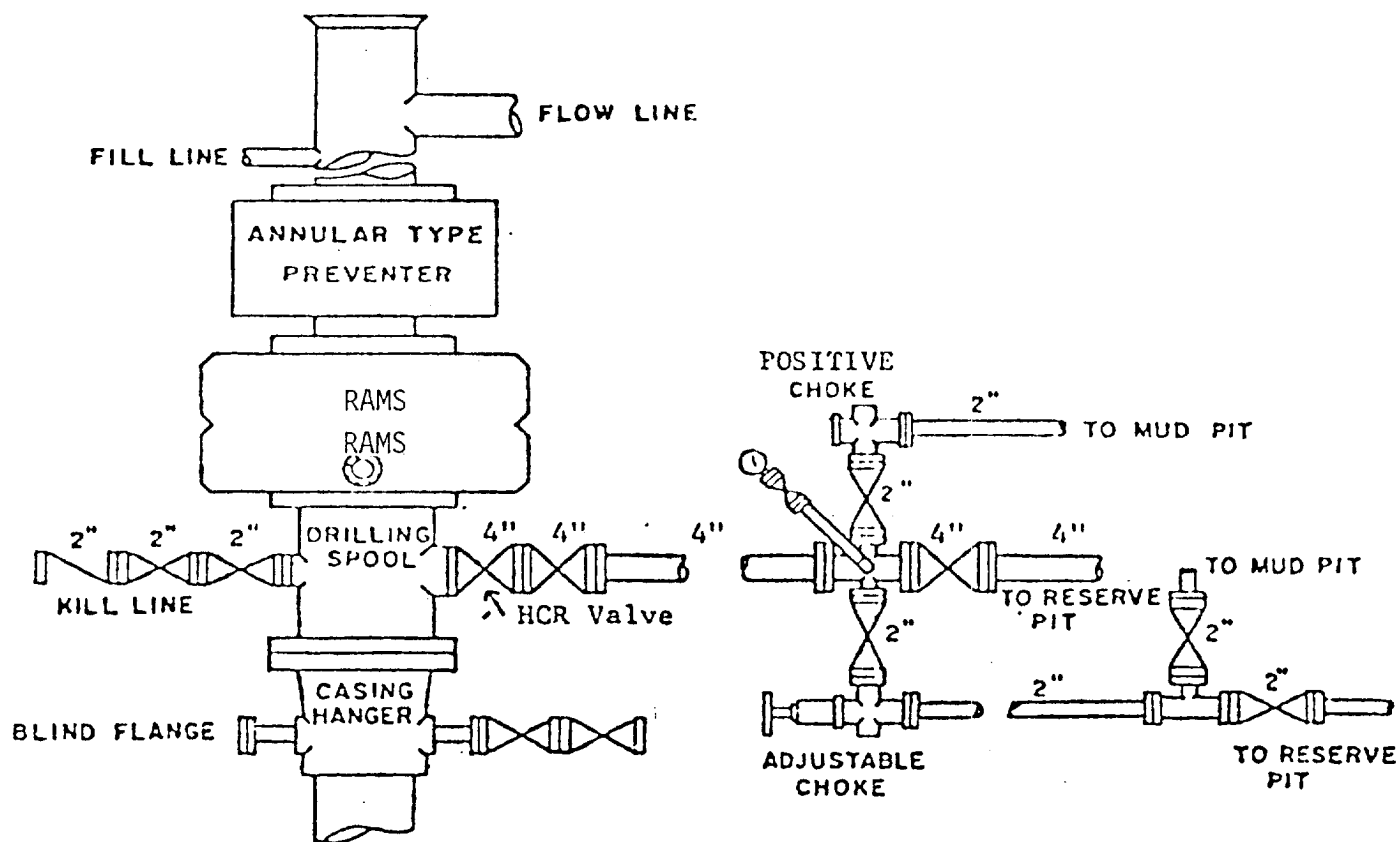

### BOP STACK

5000 PSI WORKING PRESSURE ABOVE 7-5/8" CASING SEAT

10,000 PSI WORKING PRESSURE BELOW 7-5/8" CASING SEAT

BOP ARRANGEMENT