

DISTRICT I

P.O. Box 1980, Hobbs, NM 88240

DISTRICT II

P.O. Box Drawer DD, Artesia, NM 88210

DISTRICT III

1000 Rio Brazos Rd., Aztec, NM 87410

OIL CONSERVATION DIVISION

P.O. Box 2088

Santa Fe, New Mexico 87504-2088

WELL API NO.

30-025-32229

5. Indicate Type of Lease

STATE

FEE

6. State Oil / Gas Lease

7. Lease Name or Unit Agreement Name

DAVIS, F. B.

8. Well No. 4

9. Pool Name or Wildcat

SW TEAGUE, GLORIETA U.P. PADDOCK

WELL COMPLETION OR RECOMPLETION REPORT AND LOG

1a. Type of Well:

OIL WELL GAS WELL DRY OTHER

b. Type of Completion:

NEW WELL WORKOVER DEEPEN PLUG BACK DIFF RES. OTHER HORIZONTAL

2. Name of Operator

TEXACO EXPLORATION & PRODUCTION INC.

3. Address of Operator

15 SMITH ROAD, MIDLAND, TX 79705

4. Well Location

BHL. 699' FNL, 334' FEL

Unit Letter H : 2004 Feet From The NORTH Line and 650 Feet From The EAST Line

Section 8 Township 23-S Range 37-E NMPM LEA COUNTY

10. Date Spudded

1/3/02

11. Date T.D. Reached

1/8/02

12. Date Compl. (Ready to Prod.)

1/19/02

13. Elevations (DF & RKB, RT, GR, etc.)

GR-3319'

14. Elev. Csghead

15. Total Depth

6398'

16. Plug Back T.D.

17. If Mult. Compl. How Many Zones?

18. Intervals Drilled By

Rotary Tools

Cable Tools

0'-5475'

19. Producing Interval(s), of this completion - Top, Bottom, Name

5009-5015'

20. Was Directional Survey Made

YES

21. Type Electric and Other Logs Run

N/A

22. Was Well Cored

NO

23. CASING RECORD (Report all Strings set in well)

CASING SIZE	WEIGHT LB./FT.	DEPTH SET	HOLE SIZE	CEMENT RECORD	AMOUNT PULLED
8-5/8"	24#	1185'	11"	550 SX CL C, CIR126	
5-1/2"	15.5#, 17#	2409'	7-7/8"	1290 SX, CIR 47	

24. LINER RECORD

SIZE	TOP	BOTTOM	SACKS CEMENT	SCREEN
NONE				

25. TUBING RECORD

SIZE	DEPTH SET	PACKER SET
2-7/8"	5274'	

26. Perforation record (interval, size, and number)

5009-5015'

27. ACID, SHOT, FRACTURE, CEMENT, SQUEEZE, ETC.

DEPTH INTERVAL AMOUNT AND KIND MATERIAL USED

5009-5015' FRAC W/6100 GALS WF110

& 30,000 GALS 20% HCL

28. PRODUCTION

Date First Production 1/24/02 Production Method (Flowing, gas lift, pumping - size and type pump) PUMPING 2 1/2"X1 1/2"X24' Well Status (Prod. or Shut-in) PROD.

Date of Test 2-05-02 Hours tested 24 Choke Size Prod'n For Test Period Oil - Bbl. 25 Gas - MCF 14 Water - Bbl. 125 Gas - Oil Ratio

Flow Tubing Press. Casing Pressure Calculated 24-Hour Rate Oil - Bbl. Gas - MCF Water - Bbl. Oil Gravity - API -(Corr.)

29. Disposition of Gas (Sold, used for fuel, vented, etc.)

SOLD

Test Witnessed By

30. List Attachments NOTARIZED DEVIATIONS

31. I hereby certify that the information on both sides of this form is true and complete to the best of my knowledge and belief.

SIGNATURE *J. Denise Leake* TITLE Regulatory Specialist

DATE 3/5/02

TYPE OR PRINT NAME J. Denise Leake

Telephone No. 915-687-7375

KZ

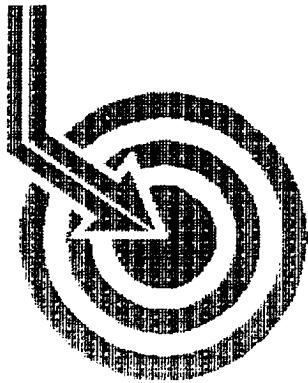

Scientific Drilling



TEXACO E & P INC.

Field: Teague (Glorietta Upper Paddock)
Site: Lea County, NM
Well: F.B. Davis #4H
Wellpath: DH - Job #32D0102005
Survey: 1/3/02-1/8/01

This survey is correct to the best of my knowledge and is supported by actual field data.

David Moody.....Company Representative

Notorized this date 21st of February, 2002.

Deborah Sue Bynum
Notary Signature
County of Midland
State of Texas

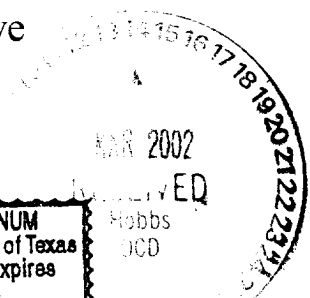
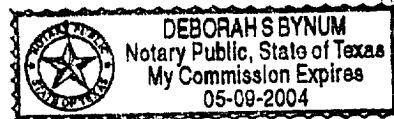

Scientific Drilling International

Survey Report

Company: TEXACO E & P INC.	Date: 2/21/2002	Time: 14:23:12	Page: 1
Field: Teague (Glorietta Upper Paddock)	Co-ordinate(NE) Reference:	Site: Lea County, NM, True North	
Site: Lea County, NM	Vertical (TVD) Reference:	SITE 0.0 above Mean Sea Level	
Well: F.B. Davis #4H	Section (VS) Reference:	Well (0.0E,0.0N,13.8Azi)	
Wellpath: VH - Job #32K0102004	Survey Calculation Method:	Minimum Curvature	

Survey: 1/3/02 KSRG 0'-4990'	Start Date: 2/21/2002
--	------------------------------

Company: Scientific Drilling Internatio	Engineer: Gary DeSpain
Tool: Keeper	

Survey

MD ft	Incl deg	Azim deg	TVD ft	VS ft	N/S ft	E/W ft	ClsD ft	ClsA deg	DLS deg/100ft
0.0	0.00	0.00	0.0	0.0	0.0	0.0	0.0	0.00	0.00
100.0	0.42	199.37	100.0	-0.4	-0.3	-0.1	0.4	199.37	0.42
200.0	0.40	195.79	200.0	-1.1	-1.0	-0.3	1.1	198.22	0.03
300.0	0.50	199.74	300.0	-1.9	-1.8	-0.6	1.9	198.12	0.10
400.0	0.50	193.45	400.0	-2.7	-2.6	-0.8	2.7	197.63	0.05
500.0	0.50	192.70	500.0	-3.6	-3.5	-1.0	3.6	196.53	0.01
600.0	0.42	195.20	600.0	-4.4	-4.2	-1.2	4.4	196.04	0.08
700.0	0.44	195.28	700.0	-5.2	-5.0	-1.4	5.2	195.93	0.02
800.0	0.32	196.95	800.0	-5.8	-5.6	-1.6	5.8	195.93	0.12
900.0	0.25	212.18	900.0	-6.3	-6.1	-1.8	6.3	196.53	0.10
1000.0	0.07	261.20	1000.0	-6.5	-6.2	-2.0	6.5	197.53	0.21
1100.0	0.22	318.73	1100.0	-6.4	-6.1	-2.2	6.5	199.47	0.19
1200.0	0.39	309.22	1200.0	-6.2	-5.8	-2.6	6.3	203.91	0.18
1300.0	0.42	315.25	1300.0	-5.9	-5.3	-3.1	6.1	210.21	0.05
1400.0	0.39	340.00	1400.0	-5.4	-4.7	-3.4	5.8	216.28	0.18
1500.0	0.59	2.08	1500.0	-4.6	-3.9	-3.5	5.2	222.55	0.27
1600.0	0.69	4.51	1600.0	-3.5	-2.7	-3.5	4.4	231.70	0.10
1700.0	0.85	9.71	1699.9	-2.2	-1.4	-3.3	3.6	246.82	0.17
1800.0	0.95	10.49	1799.9	-0.6	0.1	-3.0	3.0	272.48	0.10
1900.0	2.22	26.25	1899.9	2.1	2.7	-2.0	3.4	323.00	1.33
2000.0	3.51	31.53	1999.8	6.9	7.0	0.4	7.0	3.55	1.32
2100.0	3.67	32.49	2099.6	12.9	12.3	3.8	12.9	16.93	0.17
2200.0	3.46	34.37	2199.4	18.7	17.5	7.2	18.9	22.27	0.24
2300.0	2.89	36.74	2299.2	23.9	22.0	10.4	24.4	25.24	0.58
2400.0	2.93	37.49	2399.1	28.5	26.1	13.5	29.4	27.28	0.06
2500.0	2.49	39.91	2499.0	32.8	29.8	16.4	34.0	28.84	0.45
2600.0	1.92	44.50	2598.9	36.2	32.6	19.0	37.8	30.16	0.60
2700.0	1.57	46.59	2698.9	38.8	34.8	21.1	40.7	31.29	0.36
2800.0	1.34	64.66	2798.8	40.7	36.2	23.2	43.0	32.63	0.51
2900.0	0.94	71.70	2898.8	41.9	37.0	25.0	44.7	34.09	0.42
3000.0	0.80	89.27	2998.8	42.5	37.2	26.5	45.7	35.44	0.30
3100.0	0.67	87.97	3098.8	42.8	37.3	27.8	46.5	36.70	0.13
3200.0	0.60	88.92	3198.8	43.1	37.3	28.9	47.2	37.76	0.07
3300.0	0.54	84.44	3298.8	43.4	37.4	29.9	47.8	38.66	0.07
3400.0	0.46	83.69	3398.8	43.7	37.5	30.8	48.5	39.39	0.08
3500.0	0.36	72.91	3498.8	44.0	37.6	31.5	49.0	39.92	0.13
3600.0	0.28	69.52	3598.8	44.3	37.8	32.0	49.5	40.26	0.08
3700.0	0.32	66.38	3698.8	44.6	38.0	32.5	50.0	40.54	0.04
3800.0	0.37	34.31	3798.8	45.1	38.3	32.9	50.5	40.64	0.20
3900.0	0.38	44.24	3898.8	45.7	38.8	33.3	51.2	40.62	0.07
4000.0	0.33	74.21	3998.8	46.1	39.2	33.8	51.7	40.82	0.19
4100.0	0.36	132.56	4098.8	46.1	39.0	34.3	52.0	41.34	0.34
4200.0	0.58	150.11	4198.8	45.6	38.4	34.8	51.8	42.22	0.26
4300.0	0.92	151.00	4298.8	44.6	37.2	35.5	51.4	43.60	0.34
4400.0	1.47	158.90	4398.7	43.0	35.3	36.3	50.7	45.78	0.57
4500.0	1.83	162.43	4498.7	40.6	32.6	37.3	49.5	48.80	0.37
4600.0	1.80	163.44	4598.6	37.8	29.6	38.2	48.3	52.23	0.04
4700.0	1.50	156.09	4698.6	35.4	26.9	39.2	47.5	55.53	0.37

Scientific Drilling International Survey Report

Company: TEXACO E & P INC. Field: Teague (Glorietta Upper Paddock) Site: Lea County, NM Well: F.B. Davis #4H Wellpath: VH - Job #32K0102004	Date: 2/21/2002 Co-ordinate(NE) Reference: Vertical (TVD) Reference: Section (VS) Reference: Survey Calculation Method:	Time: 14:23:12 Site: Lea County, NM, True North SITE: 0.0 above Mean Sea Level Well: (0.0E, 0.0N, 13.8Azi)	Page: 2 Minimum Curvature
--	--	---	--

Survey

MD ft	Incl deg	Azim deg	TVD ft	VS ft	N/S ft	E/W ft	ClsD ft	ClsA deg	DLS deg/100ft
4800.0	1.12	154.15	4798.6	33.7	24.8	40.1	47.2	58.27	0.38
4900.0	0.91	149.88	4898.6	32.3	23.2	40.9	47.1	60.42	0.22
4990.0	0.64	156.01	4988.5	31.4	22.2	41.5	47.1	61.89	0.31



Scientific Drilling International

Survey Report

Company: TEXACO E & P INC.	Date: 2/21/2002	Time: 14:27:33	Page: 1
Field: Teague (Glorietta Upper Paddock)	Co-ordinate(NE) Reference:	Site: Lea County, NM, True North	
Site: Lea County, NM	Vertical (TVD) Reference:	SITE 0.0 above Mean Sea Level	
Well: F.B. Davis #4H	Section (VS) Reference:	Well (0.0E,0.0N,13.8Azi)	
Wellpath: DH - Job #32D0102005	Survey Calculation Method:	Minimum Curvature	

Survey: 1/3/02-1/8/01 MWD 5009'-6398' Start Date: 2/21/2002

Company: SDI w/Unidril Engineer: Lamb/Kemp
Tool:

Survey

MD ft	Incl deg	Azim deg	TVD ft	VS ft	N/S ft	E/W ft	ClsD ft	ClsA deg	DLS deg/100ft
4990.0	0.64	156.01	4988.5	31.4	22.2	41.5	47.1	61.89	0.00
5009.0	0.64	156.10	5007.5	31.3	22.0	41.6	47.0	62.15	0.01
5060.0	21.40	354.30	5057.4	39.9	31.1	40.8	51.3	52.68	43.15
5086.0	32.70	351.60	5080.5	50.9	42.8	39.3	58.1	42.55	43.71
5118.0	50.30	353.20	5104.4	70.6	63.7	36.5	73.5	29.82	55.10
5143.0	65.70	356.60	5117.6	90.6	84.8	34.7	91.6	22.26	62.66
5181.0	83.80	3.90	5127.6	126.1	121.3	35.0	126.2	16.08	51.08
5213.0	86.70	9.30	5130.2	157.7	152.9	38.6	157.7	14.18	19.10
5244.0	90.90	11.80	5130.9	188.7	183.4	44.3	188.7	13.58	15.77
5276.0	90.30	12.10	5130.5	220.6	214.7	50.9	220.7	13.35	2.10
5307.0	89.30	11.90	5130.6	251.6	245.0	57.4	251.6	13.18	3.29
5339.0	88.40	13.70	5131.3	283.6	276.2	64.5	283.6	13.14	6.29
5370.0	89.70	13.20	5131.8	314.6	306.4	71.7	314.6	13.17	4.49
5401.0	89.00	12.60	5132.2	345.6	336.6	78.6	345.6	13.14	2.97
5433.0	90.60	14.60	5132.3	377.6	367.7	86.1	377.6	13.18	8.00
5465.0	90.20	14.70	5132.0	409.6	398.6	94.2	409.6	13.30	1.29
5496.0	91.30	15.30	5131.6	440.6	428.6	102.2	440.6	13.42	4.04
5527.0	91.10	15.00	5131.0	471.6	458.5	110.3	471.6	13.53	1.16
5559.0	90.40	14.10	5130.6	503.6	489.5	118.4	503.6	13.60	3.56
5590.0	90.00	14.70	5130.5	534.6	519.5	126.1	534.6	13.64	2.33
5622.0	90.00	15.70	5130.5	566.6	550.4	134.5	566.6	13.73	3.12
5654.0	90.40	13.60	5130.3	598.5	581.3	142.6	598.5	13.78	6.68
5685.0	89.90	14.00	5130.3	629.5	611.4	150.0	629.5	13.78	2.07
5717.0	90.30	14.00	5130.2	661.5	642.5	157.7	661.5	13.79	1.25
5749.0	90.00	13.40	5130.1	693.5	673.6	165.3	693.5	13.79	2.10
5780.0	90.40	11.40	5130.0	724.5	703.8	171.9	724.5	13.73	6.58
5811.0	90.40	12.10	5129.8	755.5	734.2	178.2	755.5	13.65	2.26
5843.0	91.00	13.20	5129.4	787.5	765.4	185.3	787.5	13.61	3.92
5875.0	91.30	13.60	5128.8	819.5	796.5	192.7	819.5	13.60	1.56
5907.0	91.80	13.80	5127.9	851.5	827.6	200.2	851.5	13.60	1.68
5938.0	91.50	14.20	5127.0	882.5	857.7	207.7	882.5	13.62	1.61
5970.0	87.90	15.20	5127.2	914.5	888.6	215.9	914.5	13.65	11.68
6002.0	88.00	15.40	5128.3	946.4	919.5	224.3	946.4	13.71	0.70
6032.0	89.60	15.60	5129.0	976.4	948.4	232.3	976.4	13.76	5.37
6063.0	89.70	14.70	5129.1	1007.4	978.3	240.4	1007.4	13.81	2.92
6095.0	90.10	12.40	5129.2	1039.4	1009.4	247.9	1039.4	13.80	7.30
6127.0	90.30	12.30	5129.1	1071.4	1040.7	254.8	1071.4	13.76	0.70
6158.0	90.20	12.60	5128.9	1102.4	1070.9	261.4	1102.4	13.72	1.02
6190.0	90.20	12.40	5128.8	1134.4	1102.2	268.4	1134.4	13.68	0.62
6222.0	90.00	12.00	5128.8	1166.4	1133.4	275.1	1166.4	13.64	1.40
6253.0	89.80	11.90	5128.8	1197.3	1163.8	281.5	1197.3	13.60	0.72
6285.0	91.20	14.10	5128.6	1229.3	1195.0	288.7	1229.3	13.58	8.15
6317.0	91.30	13.60	5127.9	1261.3	1226.0	296.4	1261.3	13.59	1.59
6349.0	90.50	14.20	5127.4	1293.3	1257.1	304.1	1293.3	13.60	3.12
6398.0	90.50	14.20	5126.9	1342.3	1304.6	316.1	1342.3	13.62	0.00

DISTRICT II

P.O. Box Drawer DD, Artesia, NM 88211-0719

DISTRICT III

1000 Rio Brazos Rd., Aztec, NM 87410

DISTRICT IV

P.O. Box 2088, Santa Fe, NM 87504-2088

OIL CONSERVATION DIVISION

P.O. Box 2088
Santa Fe, New Mexico 87504-2088

Revised February 10, 199

Instructions on back
Submit to Appropriate District Office
State Lease - 4 Copie

Fee Lease - 3 Copie

AMENDED REPORT

WELL LOCATION AND ACREAGE DEDICATION PLAT

¹ API Number 30-025-32229	² Pool Code 58595	³ Pool Name SW TEAGUE, GLORIETA/UP PADDOCK
⁴ Property Code 013195	⁵ Property Name DAVIS, F. B.	⁶ Well No. 4
⁷ OGRID Number 022351	⁸ Operator Name TEXACO EXPLORATION & PRODUCTION INC.	⁹ Elevation GR-3319'

¹⁰ Surface Location

Ul or lot no	Section	Township	Range	Lot.Idn	Feet From The	North/South Line	Feet From The	East/West Line	County
H	8	23-S	37-E		2004	NORTH	650	EAST	LEA

¹¹ Bottom Hole Location If Different From Surface

Ul or lot no	Section	Township	Range	Lot.Idn	Feet From The	North/South Line	Feet From The	East/West Line	County
A	8	23-S	37-E		649'	NORTH	334'	EAST	LEA

¹² Dedicated Acre 80	¹³ Joint or Infill No	¹⁴ Consolidation Code	¹⁵ Order No.
------------------------------------	-------------------------------------	----------------------------------	-------------------------

NO ALLOWABLE WILL BE ASSIGNED TO THIS COMPLETION UNTIL ALL INTERESTS HAVE BEEN CONSOLIDATED OR A NON-STANDARD UNIT HAS BEEN APPROVED BY THE DIVISION

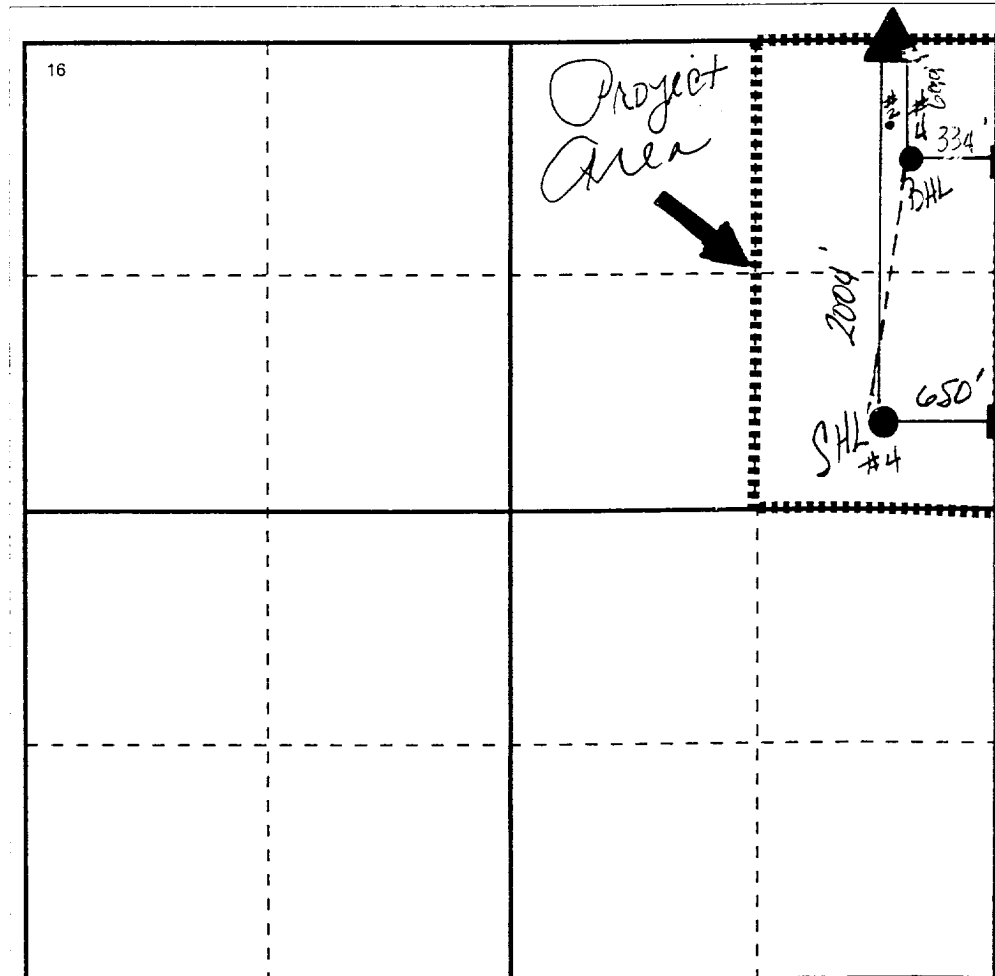

¹⁷ OPERATOR CERTIFICATION
I hereby certify that the information contained herein is true and complete to the best of my knowledge and belief

Signature
J. Denise Leake
Printed Name

J. Denise Leake

Positio
Engineering Assistant

Date
11/14/01

¹⁸ SURVEYOR CERTIFICATION
I hereby certify that the well location shown on this plat was plotted from field notes of actual surveys made by me or under my supervision, and that the same is true and correct to the best of my knowledge and belief.

Date Surveyed .

Signature & Seal of
Professional Surveyor

Certificate No.

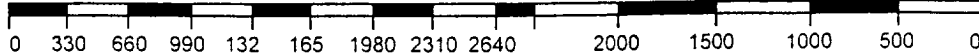

KA