

Schermerhorn

Amerada

Continental

Texas

7  
E. Woolworth

2  
"Jack" U.S.

Lillie M. Knight

"Jack" U.S.

"Fristos" U.S.

33

34

Phillips

Humble N° 16141

Texas

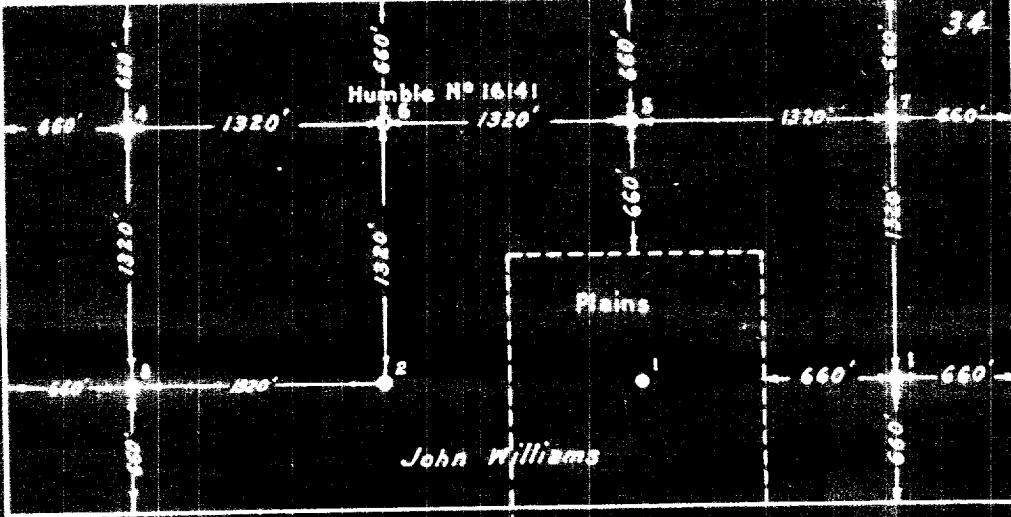

John Williams

J. Williams "Jack" U.S.

Culberson & Irwin

Plains

2 Texas

Repello

Mrs. R. L. Mosely

C.D. Woolworth

C.L. Moore Erwin U.S.

4

3

JOHN WILLIAMS LEASE N° 16141  
SEC. 34, T-24-S, R-37-E, LEA CO. N.M.

HUMBLE OIL & REFINING COMPANY  
**CIVIL ENGINEERING DEPARTMENT**  
MIDLAND TEXAS

DRAWN <u>W. H. N.</u>	SCALE <u>1" = 1000'</u>	FILE NO.
CHECKED _____	DATE _____	<b>W.T. A-171</b>
APPR. _____	REVISED _____	