

APPROVED

Form 9-381a  
(Feb. 1961)

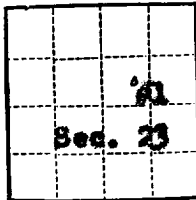

MAR 24 1961

(SUBMIT IN TRIPLICATE)

E. W. STANDLEY  
DISTRICT ENGINEER

UNITED STATES  
DEPARTMENT OF THE INTERIOR  
GEOLOGICAL SURVEY

COPY TO O.C.D.  
HOBBS

Budget Bureau No. 42-R388.4.  
Approval expires 12-31-60.

Land Office Hobbs, N. M.

Lease No. LC 033575

Unit Las Cruces "C"

RECEIVED

MAR 24 1961

SUNDRY NOTICES AND REPORTS ON WELLS  
GEOLOGICAL SURVEY  
HOBBS, NEW MEXICO

NOTICE OF INTENTION TO DRILL.....	<input checked="" type="checkbox"/>	SUBSEQUENT REPORT OF WATER SHUT-OFF.....	
NOTICE OF INTENTION TO CHANGE PLANS.....		SUBSEQUENT REPORT OF SHOOTING OR ACIDIZING.....	
NOTICE OF INTENTION TO TEST WATER SHUT-OFF.....		SUBSEQUENT REPORT OF ALTERING CASING.....	
NOTICE OF INTENTION TO RE-DRILL OR REPAIR WELL.....		SUBSEQUENT REPORT OF RE-DRILLING OR REPAIR.....	
NOTICE OF INTENTION TO SHOOT OR ACIDIZE.....		SUBSEQUENT REPORT OF ABANDONMENT.....	
NOTICE OF INTENTION TO PULL OR ALTER CASING.....		SUPPLEMENTARY WELL HISTORY.....	
NOTICE OF INTENTION TO ABANDON WELL.....			

(INDICATE ABOVE BY CHECK MARK NATURE OF REPORT, NOTICE, OR OTHER DATA)

Hobbs, New Mexico - March 23, 1961

Las Cruces "C"  
Well No. 1 is located 1960 ft. from N line and 1650 ft. from E line of sec. 23

SW/4 NE/4 Sec. 23 25-S 37-E N.M.P.M.  
(1/4 Sec. and Sec. No.) (Twp.) (Range) (Meridian)  
Justis Tubb Drinkard Lea New Mexico  
(Field) (County or Subdivision) (State or Territory)

The elevation of the derrick floor above sea level is \_\_\_\_\_ ft.

DETAILS OF WORK

(State names of and expected depths to objective sands; show sizes, weights, and lengths of proposed casings; indicate mudding jobs, cementing points, and all other important proposed work)

To be drilled with rotary tools from surface to total depth of approximately 6000' in the Drinkard Formation. Casing program to be approximately as follows:

Size Hole	Size Casing	Casing Point	Sacks Cement
12-1/4"	9-5/8" OD	900'	400
8-3/4"	7" OD	6000'	600

The Halliburton Process will be used in cementing both strings of casing.

I understand that this plan of work must receive approval in writing by the Geological Survey before operations may be commenced.

Company Skelly Oil Company

Address Box 36

Hobbs, New Mexico

By J. W. Standley

Title Dist. Supt.

NEW MEXICO OIL CONSERVATION COMMISSION  
WELL LOCATION AND ACREAGE DEDICATION PLAT

FORM C-123  
Revised 5-1-57

SEE INSTRUCTIONS FOR COMPLETING THIS FORM ON THE REVERSE SIDE

SECTION A

Operator <b>Skelly Oil Company</b>		Lease <b>Las Cruces "C"</b>		Well No. <b>1</b>
Unit Letter <b>G</b>	Section <b>23</b>	Township <b>25 South</b>	Range <b>37 East</b>	County <b>Lea</b>
Actual Footage Location of Well: <b>1980</b> feet from the <b>north</b> line and <b>1650</b> feet from the <b>east</b> line				
Ground Level Elev.	Production <b>Drillstone</b>	Pool <b>Justin Tubb Drinkard</b>	Dedicated acreage: <b>10</b> Acres	

1. Is the Operator the only owner in the dedicated acreage outlined on the plat below? YES ☒ NO ☐ ("Owner" means the person who has the right to drill into and to produce from any pool and to appropriate the production either for himself or for himself and another. 165-3-29 (e) NMSA 1935 Comp.)
2. If the answer to question one is "no," have the interests of all the owners been consolidated by communitization agreement or otherwise? YES ☐ NO ☐ If answer is "yes," Type of Consolidation \_\_\_\_\_
3. If the answer to question two is "no," list all the owners and their respective interests below:

Owner	Land Description

SECTION B

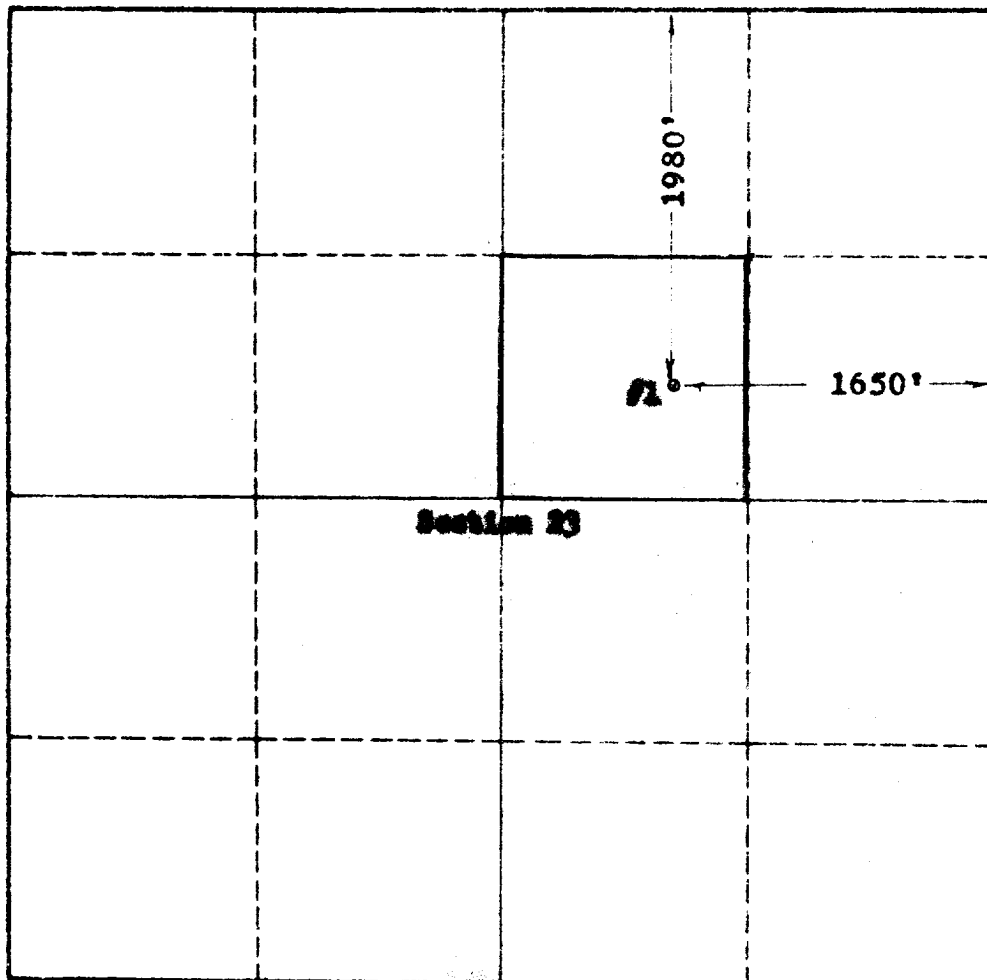

CERTIFICATION

I hereby certify that the information in SECTION A above is true and complete to the best of my knowledge and belief.

Name **J. J. Dinkley**  
Position **Dist. Supt.**  
Company **Skelly Oil Company**  
Date **March 23, 1961**

I hereby certify that the well location shown on the plat in SECTION B was plotted from field notes of actual surveys made by me or under my supervision, and that the same is true and correct to the best of my knowledge and belief.

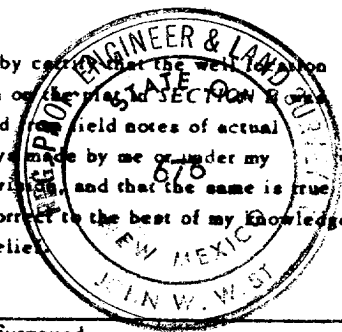

Date Surveyed **March 22, 1961**  
Registered Professional Engineer and/or Land Surveyor, **JOHN W. WEST**  
Certificate No. **J. W. West**  
N.M. - P.E. & L.S. NO. 678

0 330 660 990 1320 1650 1980 2310 2640 2000 1500 1000 500 0