

COPY TO O. C. <sup>SUBMIT IN TRIPLICATE</sup>  
(Other instructions on reverse side)

**UNITED STATES  
DEPARTMENT OF THE INTERIOR  
GEOLOGICAL SURVEY**

Form approved.  
Budget Bureau No. 42-R1425.

30-025-26809

**APPLICATION FOR PERMIT TO DRILL, DEEPEN, OR PLUG BACK**

1a. TYPE OF WORK  
 DRILL       DEEPEN       PLUG BACK

b. TYPE OF WELL  
 OIL WELL       GAS WELL       OTHER       SINGLE ZONE       MULTIPLE ZONE

2. NAME OF OPERATOR  
 Gifford, Mitchell & Wisenbaker

3. ADDRESS OF OPERATOR  
 1280 Midland National Bank Tower, Midland, Texas 79701

4. LOCATION OF WELL (Report location clearly and in accordance with any State requirements.\*)  
 At surface  
 1980' FNL and 660' FWL of Section 33  
 At proposed prod. zone

14. DISTANCE IN MILES AND DIRECTION FROM NEAREST TOWN OR POST OFFICE\*  
 5 miles Southwest of Jal, New Mexico

15. DISTANCE FROM PROPOSED\* LOCATION TO NEAREST PROPERTY OR LEASE LINE, FT. (Also to nearest drig. unit line, if any)      660

16. NO. OF ACRES IN LEASE      320

17. NO. OF ACRES ASSIGNED TO THIS WELL      40

18. DISTANCE FROM PROPOSED LOCATION\* TO NEAREST WELL, DRILLING, COMPLETED, OR APPLIED FOR, ON THIS LEASE, FT.      none

19. PROPOSED DEPTH      4000

20. ROTARY OR CABLE TOOLS  
 Rotary

21. ELEVATIONS (Show whether DF, RT, GR, etc.)  
 3022 GR

22. APPROX. DATE WORK WILL START\*  
 5/25/80

5. LEASE DESIGNATION AND SERIAL NO.  
 NM 10195

6. IF INDIAN, ALLOTTEE OR TRIBE NAME  
 NA

7. UNIT AGREEMENT NAME  
 Undesignated

8. FARM OR LEASE NAME  
 Little Hawk Federal

9. WELL NO.  
 1

10. FIELD AND POOL, OR WILDCAT  
 Sioux Yates

11. SEC., T., R., M., OR BLK. AND SURVEY OR AREA  
 Sec. 33, T-25-S, R-36-E

12. COUNTY OR PARISH      13. STATE  
 Lea      New Mexico

PROPOSED CASING AND CEMENTING PROGRAM

SIZE OF HOLE	SIZE OF CASING	WEIGHT PER FOOT	SETTING DEPTH	QUANTITY OF CEMENT
12 1/4"	8 5/8"	24	1400	750 sacks
7 7/8"	5 1/2"	14	4000	450 sacks

The Blowout Preventer Program will consist of one 10" 3000 psi WP double BOP (1 pipe ram, 1 blind ram). The BOP will be installed when 8 5/8" casing is set and cemented.

**RECEIVED**  
 APR 18 1980  
 U. S. GEOLOGICAL SURVEY  
 HOBBS, NEW MEXICO

IN ABOVE SPACE DESCRIBE PROPOSED PROGRAM: If proposal is to deepen or plug back, give data on present productive zone and proposed new productive zone. If proposal is to drill or deepen directionally, give pertinent data on subsurface locations and measured and true vertical depths. Give blowout preventer program, if any.

24. SIGNED L. B. [Signature] TITLE Production Engineer DATE 4/8/80

(This space for Federal or State office use)

PERMIT NO. \_\_\_\_\_ APPROVAL DATE \_\_\_\_\_

APPROVED BY \_\_\_\_\_ TITLE \_\_\_\_\_ DATE \_\_\_\_\_

CONDITIONS OF APPROVAL, IF ANY:

\*See Instructions On Reverse Side

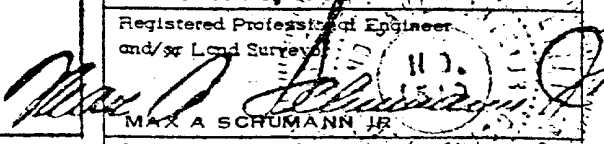
	Date Surveyed <b>MARCH 21, 1980</b>
	Registered Professional Engineer and/or Land Surveyor  MAX A. SCHUMANN JR.
	Certificate No. <b>1510</b>
	Scale: 0 330 660 90 1320 1650 1980 2310 2640 2000 1500 1000 500

WELL LOCATION AND ACREAGE DEDICATION PLAT

Supersedes C-128  
Effective 1-1-65

All distances must be from the outer boundaries of the Section.

Operator <b>GIFFORD, MITCHELL &amp; WISENBAKER</b>		Lease <b>LITTLE HAWK FEDERAL</b>			Well No. <b>1</b>
Unit Letter <b>"E"</b>	Section <b>33</b>	Township <b>-25-S</b>	Range <b>-36-E</b>	County <b>LEA</b>	
Actual Footage Location of Well: <b>1980</b> feet from the <b>NORTH</b> line and <b>660</b> feet from the <b>WEST</b> line					
Ground Level Elev. <b>3022</b>	Producing Formation <b>YATES</b>		Pool <b>SIOUX</b>	Dedicated Acreage: <b>40</b> Acres	

1. Outline the acreage dedicated to the subject well by colored pencil or hachure marks on the plat below.
2. If more than one lease is dedicated to the well, outline each and identify the ownership thereof (both as to working interest and royalty).
3. If more than one lease of different ownership is dedicated to the well, have the interests of all owners been consolidated by communitization, unitization, force-pooling, etc?

Yes  No If answer is "yes," type of consolidation \_\_\_\_\_

If answer is "no," list the owners and tract descriptions which have actually been consolidated. (Use reverse side of this form if necessary.) \_\_\_\_\_

No allowable will be assigned to the well until all interests have been consolidated (by communitization, unitization, forced-pooling, or otherwise) or until a non-standard unit, eliminating such interests, has been approved by the Commission.

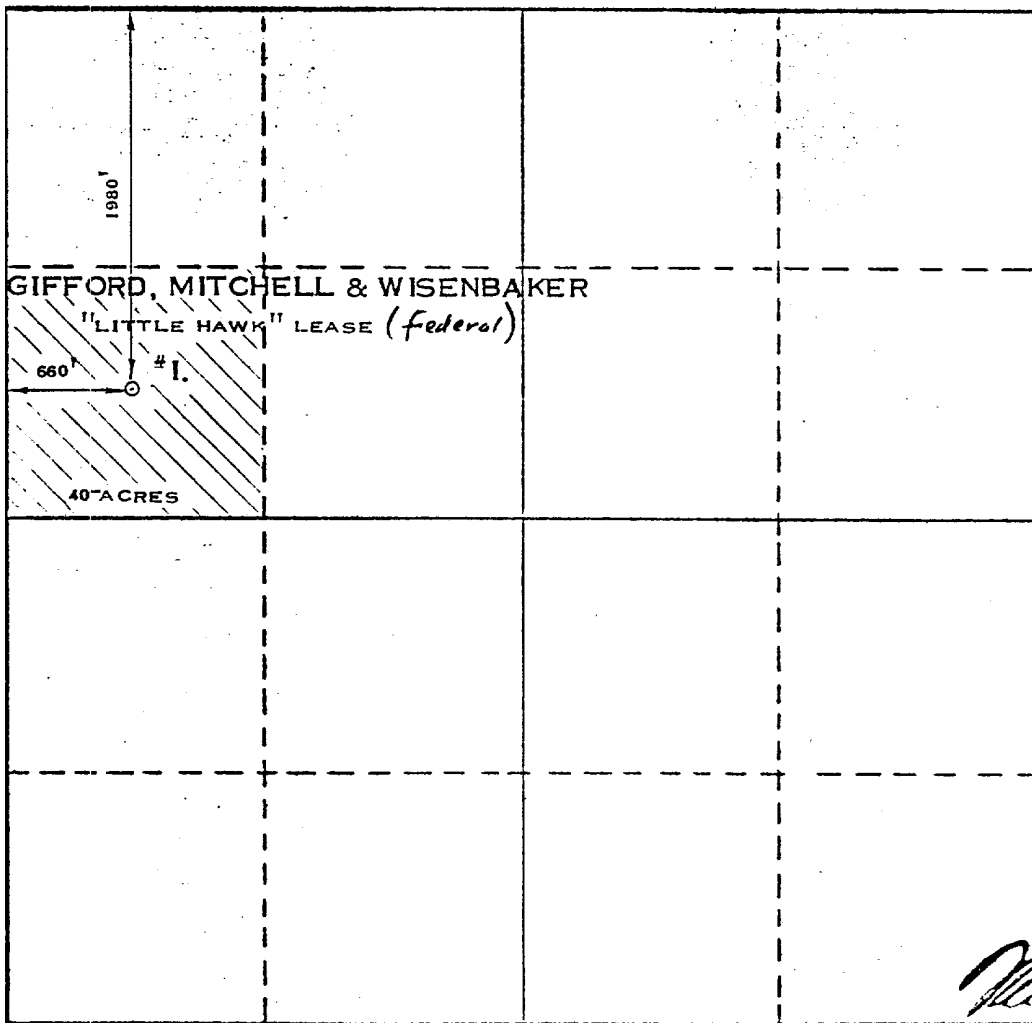

CERTIFICATION

I hereby certify that the information contained herein is true and complete to the best of my knowledge and belief.

Name *J. B. Stitt*  
 Position *Production Engineer*  
 Company *Gifford, Mitchell & Wisenbaker*  
 Date *March 25, 1980*

I hereby certify that the well location shown on this plat was plotted from field notes of actual surveys made by me or under my supervision, and that the same is true and correct to the best of my knowledge and belief.

Date Surveyed  
**MARCH 21, 1980**  
 Registered Professional Engineer  
 and/or Land Surveyor  
*Max A. Schumann Jr.*  
**MAX A. SCHUMANN JR.**

Certificate No. **1510**

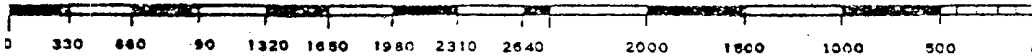

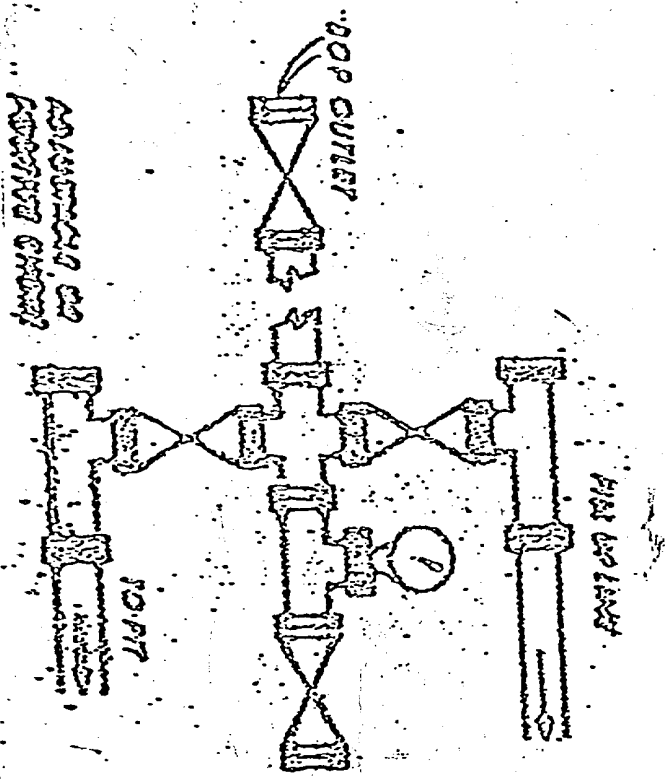
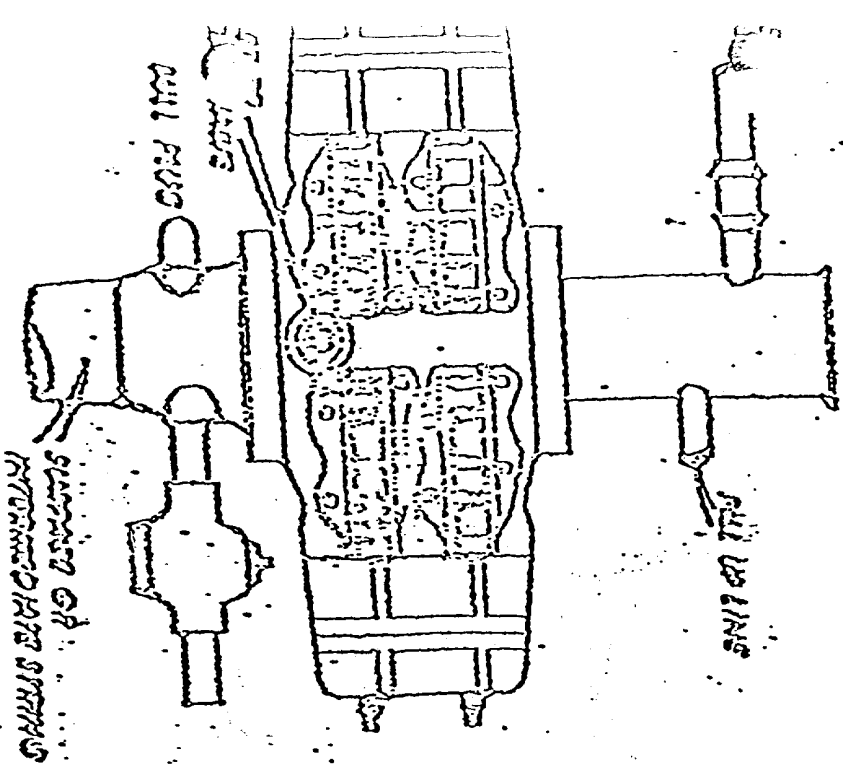

1. TOP VALVES AND ALL WORKING FITTINGS SHOULD BE IN GOOD WORKING CONDITION.
2. ALL BOLTS TO BE INSTALLED AND TIGHT.
3. ALL VALVES TO BE 3000 P.S.I. OR BETTER.
4. AFTER NIPPLING UP TEST RAHS AND PRESSURE UP TO 1500 P.S.I. FOR 15 MINUTES AND CHECK FOR POSSIBLE LEAKS, ACCURATELY.
5. ALL CREW MEMBERS TO BE FAMILIAR WITH COP AND ACCURATELY.
6. KEEP HOLE FULL ON TRIPS.
7. USE ONLY FLANGE TYPE FITTINGS.
8. RECHECK BOLTS FOR TIGHTNESS BEFORE 3000 FT. OR DISTANCE PRODUCTION ZONES.
9. WHEN DRILLING USE 2 INCH PIPE RAHS.
10. TOP PREVENTER & DRILL PIPE RAHS.
11. BOTTOM PREVENTER DRILL PIPE RAHS.
12. WHEN RUNNING CASING USE 2 INCH PIPE RAHS.