

NEW MEXICO OIL CONSERVATION COMMISSION  
WELL LOCATION AND ACREAGE DEDICATION PLAT

Form O-1  
Superseded L-128  
Effective 1-1-65

All distances must be from the outer boundaries of the Section

Operator <b>DOYLE HARTMAN</b>			Lease <b>Bates</b>		Well No. <b>3</b>
Unit Letter <b>L</b>	Section <b>20</b>	Township <b>25 SOUTH</b>	Range <b>37 EAST</b>	County <b>LEA</b>	
Actual Footage Location of Well: <b>1635</b> feet from the <b>SOUTH</b> line and <b>1210</b> feet from the <b>WEST</b> line					
Ground Level Elev. <b>3040.2</b>	Producing Formation <b>Yates</b>		Pool <b>Jalmat</b>	Dedicated Acreage <b>160</b> Acres	

1. Outline the acreage dedicated to the subject well by colored pencil or hachure marks on the plat below.
2. If more than one lease is dedicated to the well, outline each and identify the ownership thereof (both as to working interest and royalty).
3. If more than one lease of different ownership is dedicated to the well, have the interests of all owners been consolidated by communitization, unitization, force-pooling, etc?

Yes     No    If answer is "yes," type of consolidation \_\_\_\_\_

If answer is "no," list the owners and tract descriptions which have actually been consolidated (Use reverse side of this form if necessary.) \_\_\_\_\_

No allowable will be assigned to the well until all interests have been consolidated (by communitization, unitization, forced-pooling, or otherwise) or until a non-standard unit, eliminating such interests, has been approved by the Commission.

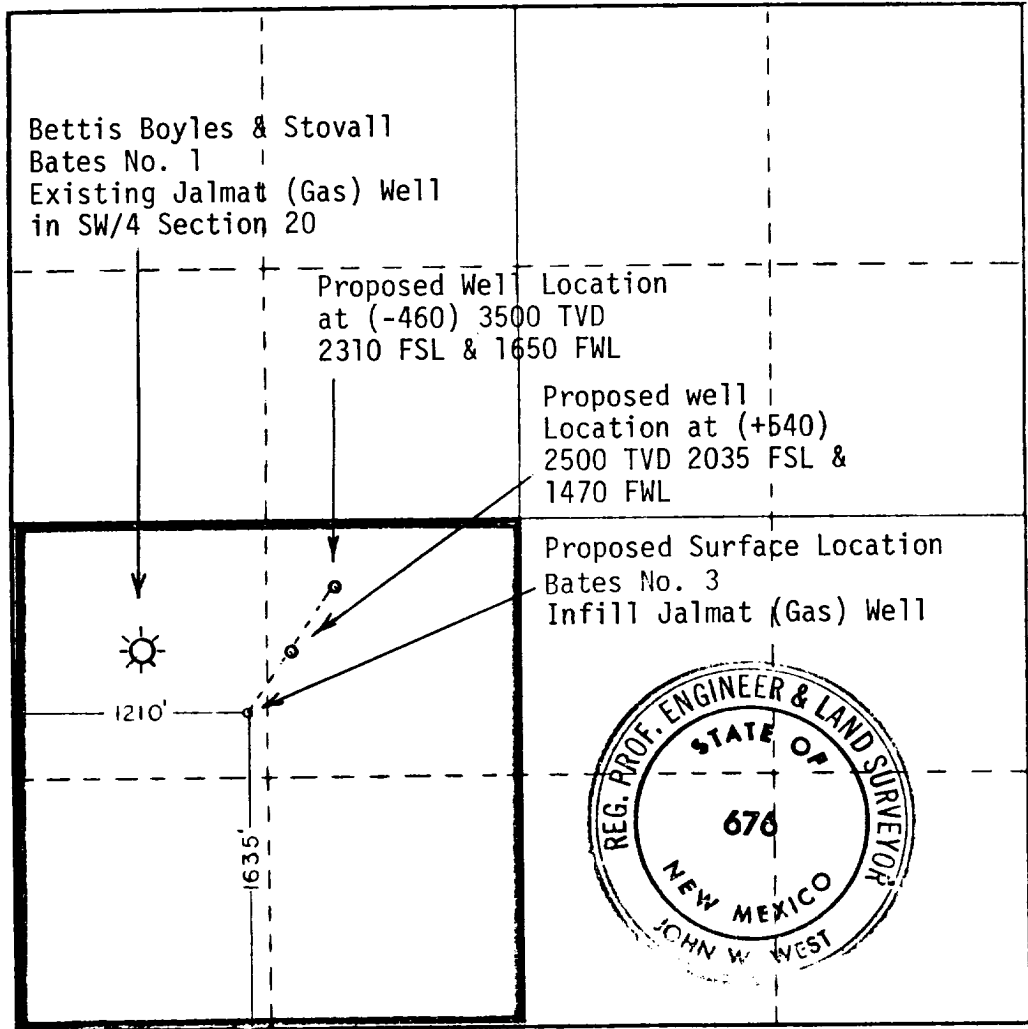

**CERTIFICATION**

I hereby certify that the information contained herein is true and complete to the best of my knowledge and belief

Name  
*Larry A. Ramsey*

Position  
**Engineer**

Company  
**Doyle Hartman**

Date  
**Aug 20, 1981**

I hereby certify that the well location shown on this plat was plotted from field notes of actual surveys made by me or under my supervision, and that the same is true and correct to the best of my knowledge and belief.

Date Surveyed  
**7-28-81**

Registered Professional Engineer and/or Land Surveyor

*John W. West*

Certificate No. **JOHN W. WEST 676**  
**PATRICK A. ROMERO 6863**  
**Ronald J. Eidson 3239**

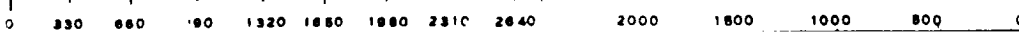

RECEIVED

AUG 24 1981

OIL CONSERVATION DI

173

COUNTY LEA FIELD Jalmat STATE NM  
 OPR HARTMAN, DOYLE PI 30-025-27542  
 NO 3 LEASE Bates MAP  
 Sec 20, T25S, R37E COORD  
 1635 FSL, 1210 FWL of Sec\* 11-1-34 NM  
 Jal Townsite SPD 9-3-81 CMF 9-24-81

CSC	WELL CLASS: INIT D FIN DG LSE. CODE			
	FORMATION	DATUM	FORMATION	DATUM
10 3/4-652-450 sx				
5 1/2-3477-550 sx				
2 3/8-3452				
	ID 3481 (QUEN)		PBD 3470	

IP (Yates-Seven Rivers) Perfs 2773-3337 F 1.01 MCFGPD. Pot based on 24 hr test thru 20/64 chk. GOR Dry; gty (Gas) (NR); CP 32; TP Pkr

CONR Kenai #18 3040 GL sub-s 13

F.R. 8-31-81  
 PD 3500 RT (Yates)  
 \*(BHL: 2429 FSL, 1662 FWL of Sec)  
 9-9-81 Drlg 2458  
 Set Plug & Drid Off  
 9-15-81 TD 3481; WOCU  
 10-5-81 TD 3481; PBD 3470; T<sup>stg</sup>  
 Perf (Yates-Seven Rivers) 2773-3337 w/17 shots  
 (overall)  
 Acid (2773-3337) 5000 gals  
 10-13-81 TD 3481; PBD 3470; WOSP  
 11-2-81 TD 3481; PBD 3470; Complete  
 LOG TOPS: Rustler 978, Salt 1138, Base Salt  
 2610, Yates 2/67, Seven Rivers 3023, Queen 3475  
 11-7-81 COMPLETION ISSUED  
 11-1-34 NM  
 IC 30-025-70465-81