

PERMIT

1-15-2002



NEW MEXICO ENERGY, MINERALS and NATURAL RESOURCES DEPARTMENT

GARY E. JOHNSON
Governor
Jennifer A. Salisbury
Cabinet Secretary

January 15, 2002

Lori Wrotenbery
Director
Oil Conservation Division

CERTIFIED MAIL
RETURN RECEIPT NO. 5357 7263

Mr Mike Talovich
Key Energy Services, Inc. Four Corners Div
P O Box 900
Farmington, NM 87499

RE: Approval of Discharge Plan UIC-CLI-005
Class I Non-Hazardous Oil Field Waste Disposal Well
API No. 30-045-28653
San Juan County, New Mexico

Dear Mr. Talovich

The groundwater discharge plan renewal for the Key Energy Services, Inc. Four Corners Div (Key) Class I non-hazardous oil field waste disposal well UIC-CLI-005 located in SW/4 NW/4 of Section 2, Township 29 North, Range 12 West, NMPM, San Juan County, New Mexico, is hereby approved under the conditions contained in the enclosed attachment. Enclosed are two copies of the conditions of approval. **Please sign and return one copy to the OCD Santa Fe Office within 30 working days of receipt of this letter.**

The original Order SWD-457 was issued January 13, 1992, the discharge plan was approved on August 26, 1996 by the OCD with an expiration date of August 26, 2001. The discharge plan renewal application dated April 18, 2001 submitted pursuant to Section 5101.B 3. of the New Mexico Water Quality Control Commission (WQCC) Regulations also includes all earlier applications and all conditions later placed on those approvals. The discharge plan renewal application was submitted pursuant to Section 5101.B 3 of the New Mexico Water Quality Control Commission (WQCC) Regulations. The discharge plan is renewed pursuant to Section 5101 A and 3109 C. Please note Section 3109.G, which provides for possible future amendment of the plan. Please be advised that approval of this plan does not relieve Key of responsibility should operations result in pollution of surface water, ground water or the environment. Nor does it relieve Key of its responsibility to comply with any other governmental authority's rules and regulations.

Please be advised that all exposed pits, including lined pits and open top tanks (exceeding 16 feet in diameter) shall be screened, netted, or otherwise rendered non-hazardous to wildlife including migratory birds.

Mr Mike Talovich
January 15, 2002
Page 2

Please note that Section 3104 of the regulations requires that when a plan has been approved, discharges must be consistent with the terms and conditions of the plan Pursuant to Section 3107 C Key is required to notify the Director of any facility expansion, production increase, pressure increase, or process modification that would result in any change in the discharge of water quality or volume

Pursuant to Section 3109 H 4, this plan is for a period of five (5) years. **This approval will expire August 26, 2006** and Key should submit an application for renewal in ample time before this date Note that under Section 5101 F of the regulations, if a discharger submits a discharge plan renewal application at least 120 days before the discharge plan expires and is in compliance with the approved plan, then the existing discharge plan will not expire until the application for renewal has been approved or disapproved.

The discharge plan for the Key Class I non-hazardous oil field waste disposal well is subject to the WQCC Regulation 3114. Every billable facility submitting a discharge plan will be assessed a fee equal to the filing fee of \$100 00 plus a flat fee of \$4500 00 for Class I injection wells. The OCD has not received the \$4500 00 flat fee. The flat fee may be paid in a single payment due on the date of the discharge plan approval or in five equal installments over the expected duration of the discharge plan. Installment payments shall be remitted yearly, with the first installment due on the date of the discharge plan approval and subsequent installments due on this date of each calendar year

**Please make all checks payable to: Water Quality Management Fund
C/o: Oil Conservation Division
1220 South Saint Francis Drive
Santa Fe, New Mexico 87505.**

If you have any questions, please contact Wayne Price of my staff at (505-476-3487) or E-mail WPRICE@state.nm.us On behalf of the staff of the OCD, I wish to thank you and your staff for your cooperation during this discharge plan review

Sincerely,



Roger C Anderson
Environmental Bureau Chief
RCA/lwp

Attachment-1

xc OCD Aztec Office
David Catanach, UIC Director, OCD Santa Fe

**ATTACHMENT TO DISCHARGE PLAN UIC-CLI-005 APPROVAL
KEY ENERGY SERVICES, INC., CLASS I WELL
API No. 30-045-28653
SW/4 NW/4 Section 2, Ts 29 N, R 12 West
SAN JUAN COUNTY, NEW MEXICO
DISCHARGE PLAN APPROVAL CONDITIONS
January 15, 2002**

- 1 Payment of Discharge Plan Fees The \$100 dollar filing fee has been paid. The \$4500.00 flat fee shall be submitted upon receipt of this approval. The required flat fee may be paid in a single payment due at the time of approval, or in equal annual installments over the duration of the plan, with the first payment due upon receipt of this approval.
2. Commitments Key will abide by all commitments submitted in the discharge plan renewal application dated April 18, 2001, all previous commitments including OCD Order SWD-457 and these conditions for approval.
- 3 Maximum Injection Pressure The maximum operating injection pressure at the wellhead will be 2850 psi in accordance with OCD Order SWD-457. The injection well or system shall be equipped with a pressure limiting device which will limit the wellhead pressure on the injection well to no more than 2850 psi. The pressure limiting device shall annually be demonstrated to operate to the satisfaction of the OCD.

Key shall take all steps necessary to ensure that the injected water enters only the proposed injection interval and is not permitted to escape to other formations or onto the ground surface.
- 4 Mechanical Integrity Testing In accordance with OCD testing procedures, a mechanical integrity test will be conducted on the well annually and any time the tubing is pulled or the packer is resealed. An approved pressure recorder will be used and copies of the chart submitted to the OCD Santa Fe Office and the OCD Aztec District Office within 30 days following the test date. The OCD will be notified prior to the test so that they may witness the test. Mechanical integrity testing charts will be maintained at Key for the life of the well.
- 5 Annulus Key shall install and maintain pressure controls and continuous monitoring devices pursuant to WQCC NMAC 20 6 2 5207 B.2.
- 6 Continuous Monitoring and Recording Continuous monitoring and recording devices will be installed and mechanical charts made of injection pressure, flow rate, flow volume, and annular pressure. Mechanical charts are to be maintained at Key for the life of the well.

- 7 Maintenance Records. All routine maintenance work on the well will be recorded and maintained at Key for the life of the well.
 - 8 Wastes Permitted for Injection Injection will be limited to approved fluids as permitted under OCD Order SWD-457 and non-hazardous oil field waste fluids as permitted under OCD 711 permit NM-01-009 All non-exempt non-hazardous oil field waste will be tested for the constituents listed below in condition number nine (9)
 - 9 Chemical Analysis of Injection Fluids The following analyses of injection fluids will be conducted on a quarterly basis:
 - a Aromatic and halogenated volatile hydrocarbon scan by EPA method 8260C GC/MS including MTBE. Semi-Volatile Organics GC/MS EPA method 8270B including 1 and 2-methylnaphthalene
 - b. General water chemistry to include calcium, potassium, magnesium, sodium, bicarbonate, carbonate, chloride, sulfate total dissolved solids (TDS), pH, and conductivity
 - c Total heavy metals using the ICAP scan (EPA method 6010/ICPMS) and Mercury using Cold Vapor (EPA method 7470)
 - d EPA RCRA Characteristics for Ignitability, Corrosivity and Reactivity
- Records of all analyses will be maintained at Key for the life of the well
- 10 Quarterly Reporting. The following reports will be signed and certified in accordance with WQCC section 5101.G and submitted quarterly to both the OCD Santa Fe and Aztec Offices
 - a Results of the chemical analysis of the injection fluids (number 9)
 - b Monthly average, maximum and minimum values for injection pressures, flow rate and flow volume, and, annular pressure
 - c Monthly volumes of injected fluids pursuant to OCD Rule 1115

- 11 Drum Storage: All drums containing materials other than fresh water must be stored on an impermeable pad with curbing. All empty drums will be stored on their sides with the bungs in and lined up on a horizontal plane. Chemicals in other containers such as sacks or buckets will also be stored on an impermeable pad and curb type containment.
- 12 Process Areas: All process and maintenance areas which show evidence that leaks and spills are reaching the ground surface must be either paved and curbed or have some type of spill collection device incorporated into the design.
13. Above Ground Tanks All above ground tanks which contain fluids other than fresh water must be bermed to contain a volume of one-third more than the total volume of the largest tank or of all interconnected tanks. All new tanks or existing tanks that undergo a major modification, as determined by the Division, must be placed within an impermeable bermed enclosure.
- 14 Above Ground Saddle Tanks Above ground saddle tanks must have impermeable pad and curb type containment unless they contain fresh water or fluids that are gases at atmospheric temperature and pressure.
15. Labeling: All tanks, drums and containers should be clearly labeled to identify their contents and other emergency notification information.
- 16 Below Grade Tanks/Sumps All below grade tanks, sumps, and pits must be approved by the OCD prior to installation or upon modification and must incorporate secondary containment and leak-detection into the design. All pre-existing sumps and below-grade tanks must be tested to demonstrate their mechanical integrity no later than March 15, 2002 and every year from tested date, thereafter. Permittees may propose various methods for testing such as pressure testing to 3 pounds per square inch above normal operating pressure and/or visual inspection of cleaned out tanks and/or sumps, or other OCD approved methods. The OCD will be notified at least 72 hours prior to all testing. The test results will be submitted to OCD 30 days after test has been conducted.
- 17 Underground Process/Wastewater Lines All underground process/wastewater pipelines must be tested to demonstrate their mechanical integrity no later than March 15, 2002 and every 5 years, from tested date, thereafter. Permittees may propose various methods for testing such as pressure testing to 3 pounds per square inch above normal operating pressure or other means acceptable to the OCD. The OCD will be notified at least 72 hours prior to all testing. The test results will be submitted to OCD 30 days after test has been conducted.

18. Well Workover Operations OCD approval will be obtained from the Director prior to performing remedial work or any other workover. Approval will be requested on OCD Form C-103 "Sundry Notices and Reports on Wells" (OCD Rule 1103 A) with appropriate copies sent to the OCD Aztec District Office.
19. Housekeeping All systems designed for spill collection/prevention will be inspected weekly and after each storm event to ensure proper operation and to prevent overtopping or system failure. A record of inspections will be retained on site for a period of five years.
20. Spill Reporting All spills/releases shall be reported pursuant to OCD Rule 116. and WQCC 1203. to the OCD Aztec District Office. Key shall immediately notify the Supervisor of the Aztec District Office and the Environmental Bureau of the Division of the failure of the tubing, casing, or packer in said well and shall take such steps as may be timely and necessary to correct such failure or leakage.
21. Transfer of Discharge Plan The OCD will be notified prior to any transfer of ownership, control, or possession of the well and associated facilities. A written commitment to comply with the terms and conditions of the previously approved discharge plan and a bond must be submitted by the purchaser and approved by the OCD prior to transfer.
22. Closure The OCD will be notified when operations of the well are discontinued for a period in excess of six months. Prior to closure of the well and associated facilities a closure plan will be submitted for approval by the Director. Closure and waste disposal will be in accordance with the statutes, rules and regulations in effect at the time of closure.
23. Plugging Bond and /or Letter of Credit Key shall have in effect a Division approved plugging bond and/or letter of credit for the estimated amount required to plug the well according to the proposed closure plan and adjusted for inflation. The required plugging bond and/or letter of credit shall be adjusted at the time of discharge plan renewal.

Key shall submit a proposal to amend Bond No. U272355 to reflect the current owner and adjust for inflation. Please submit for OCD approval by April 15, 2002.
24. Training All personnel associated with operations at the Key Class I disposal well will have appropriate training in accepting, processing, and disposing of Class I non-exempt non-hazardous oil field waste to insure proper disposal. All training documentation shall be maintained at Key for the life of the well.
25. OCD Inspections Additional requirements may be placed on the well and associated facilities based upon results from OCD inspections.
26. Storm Water Plan Submit a Stormwater run-off plan for OCD approval by April 15, 2002.

27. Waste Disposal: All wastes will be disposed of at an OCD approved facility. Only oilfield exempt wastes shall be disposed of down Class II injection wells. Non-exempt oilfield wastes that are non-hazardous may be disposed of at an OCD approved facility upon proper waste determination per 40 CFR Part 261. Any waste stream that is not listed in the discharge plan will be approved by OCD on a case-by-case basis.

Rule 712 Waste: Pursuant to Rule 712, disposal of certain non-domestic waste is allowed at solid waste facilities permitted by the New Mexico Environment Department as long as the waste stream is identified in the discharge plan, and existing process knowledge of the waste stream does not change without notification to the Oil Conservation Division.

28. Class V Wells: No Class V wells that inject non-hazardous industrial wastes or a mixture of industrial wastes and domestic wastes will be approved for construction and/or operation unless it can be demonstrated that groundwater will not be impacted in the reasonably foreseeable future. Leach fields and other wastewater disposal systems at OCD regulated facilities which inject non-hazardous fluid into or above an underground source of drinking water are considered Class V injection wells under the EPA UIC program. Class V wells that inject domestic waste only must be permitted by the New Mexico Environment Department.
29. Certification. Key Energy Services, Inc., by the officer whose signature appears below, accepts this permit and agrees to comply with all terms and conditions contained herein. Key Energy Services, Inc. further acknowledges that these conditions and requirements of this permit modification may be changed administratively by the Division for good cause shown as necessary to protect fresh water, human health and the environment.

Conditions accepted by: KEY ENERGY SERVICES, INC

HAL STONE
Company Representative- print name

Hal Stone Date 2-15-02
Company Representative- Sign

Title VICE PRESIDENT TRUCKING DIVISION



Key Energy Services, Inc.

Four Corners Division

P O Box 900

5651 US Highway 67

Falmington, NM 87499

Phone 505-327-4935

Fax 505-327-4962

RECEIVED
FEB 19 2002
Environmental Bureau
Oil Conservation Division

February 15, 2002

Mr Wayne Price
NMOCD
1220 South ST Francis Drive
Santa Fe, New Mexico 87505

RE: Discharge Plan UIC-CLI-005
Class I Non-Hazardous Oil Field Waste Disposal

Dear Mr Price

Please find enclosed check for \$4500 00 for the Discharge Plan fee and signed Permit

Key Energy is in the process of compiling various information that will address several requirements in the Attachment section (page 6) of the plan This information will be forth coming in the near future

If there is any additional information required, please contact me at 505-334-6416 or e-mail at disposal@cyberport.com

Best Regards,

Michael Talovich
Key Energy Services
Facility Manager

Cc Mr Stone KEY

ACKNOWLEDGEMENT OF RECEIPT
OF CHECK/CASH

I hereby acknowledge receipt of check No. 0094736 dated 2/12/2002
or cash received on _____ in the amount of \$ 4,500⁰⁰
from KEY ENERGY SERVICES, INC.

for CLASS I MIC-CLI-005

Submitted by: ^(Primary Name) WAYNE PRICE . Data: ^(DP No.) 2/26/02

Submitted to ASD by: _____ Data: _____

Received in ASD by: _____ Data: _____

Filing Fee _____ New Facility _____ Renewal ☒

Modification _____ Other _____
(signature)

Organization Code 521.07 Applicable FY 2002

To be deposited in the Water Quality Management Fund.

Full Payment ☒ or Annual Increment _____

THE FACE OF THIS DOCUMENT IS PRINTED BLUE - THE BACK CONTAINS A SIMULATED WATERMARK

 KEY ENERGY SERVICES, INC. Central Processing Payment Center 6 Delta Drive, Suite 4400 Midland, Texas 79705 (815) 571-7320	PNC BANK, NATIONAL ASSOCIATION JEANETTE, PA
	Check Date <u>2/12/2002</u> No. <u>0094736</u>

PAY Four Thousand Five Hundred Dollars and No Cent

TO THE ORDER OF WATER QUALITY MANAGEMENT FUND

\$ 4,500.00

Philip M. Bunt

AUTHORIZED SIGNATURE IF OVER \$10,000.00

⑈0094736⑈ ⑆043000096⑆ 1011569715⑈

APPLICATION

APPLICATION FOR AUTHORIZATION TO INJECT

- I. PURPOSE: Secondary Recovery Pressure Maintenance ☒ Disposal Storage
Application qualifies for administrative approval? ☒ Yes ☐ No
- II. OPERATOR: Coleman Oil & Gas
ADDRESS: P.O. Box 443 Farmington NM 87499
CONTACT PARTY: Chuck Badsgard PHONE: 327-0416
- III. WELL DATA: Complete the data required on the reverse side of this form for each well processed for injection. Additional sheets may be attached if necessary.
- IV. Is this an expansion of an existing project: ☒ Yes ☐ No
If yes, give the Division order number authorizing the project #SWD-457
- V. Attach a map that identifies all wells and leases within two miles of any proposed injection well with a one-half mile radius circle drawn around each proposed injection well. This circle identifies the well's area of review.
- VI. Attach a tabulation of data on all wells of public record within the area of review which penetrate the proposed injection zone. Such data shall include a description of each well's type, construction, date drilled, location, depth, record of completion, and a schematic of any plugged well illustrating all plugging detail.
- VII. Attach data on the proposed operation, including:
1. Proposed average and maximum daily rate and volume of fluids to be injected;
 2. Whether the system is open or closed,
 3. Proposed average and maximum injection pressure;
 4. Sources and an appropriate analysis of injection fluid and compatibility with the receiving formation if other than reinjected produced water, and
 5. If injection is for disposal purposes into a zone not productive of oil or gas at or within one mile of the proposed well, attach a chemical analysis of the disposal zone formation water (may be measured or inferred from existing literature, studies, nearby wells, etc.).
- *VIII. Attach appropriate geological data on the injection zone including appropriate lithologic detail, geological name, thickness and depth. Give the geologic name, and depth to bottom of all underground sources of drinking water (aquifers containing waters with total dissolved solids concentrations of 10,000 mg/l or less) overlying the proposed injection zone as well as any such sources known to be immediately underlying the injection interval.
- IX. Describe the proposed stimulation program, if any
- * X. Attach appropriate logging and test data on the well. (If well logs have been filed with the Division, they need not be resubmitted.)
- * XI. Attach a chemical analysis of fresh water from two or more fresh water wells (if available and producing) within one mile of any injection or disposal well showing location of wells and dates samples were taken
- XII. Applicants for disposal wells must make an affirmative statement that they have examined available geologic and engineering data and find no evidence of open faults or any other hydrologic connection between the disposal zone and any underground source of drinking water
- XIII. Applicants must complete the "Proof of Notice" section on the reverse side of this form
- XIV. Certification: I hereby certify that the information submitted with this application is true and correct to the best of my knowledge and belief.
- NAME: Chuck Badsgard TITLE: Vice-President
SIGNATURE: *Chuck Badsgard* DATE: 5/6/86
- * If the information required under Sections VI, VIII, X, and XI above has been previously submitted, it need not be resubmitted. Please show the date and circumstance of the earlier submittal _____

III. WELL DATA

A. The following well data must be submitted for each injection well covered by this application. The data must be both in tabular and schematic form and shall include:

- (1) Lease name; Well No.; Location by Section, Township, and Range; and footage location within the section.
- (2) Each casing string used with its size, setting depth, sacks of cement used, hole size, top of cement, and how such top was determined.
- (3) A description of the tubing to be used including its size, lining material, and setting depth.
- (4) The name, model, and setting depth of the packer used or a description of any other seal system or assembly used.

Division District Offices have supplies of Well Data Sheets which may be used or which may be used as models for this purpose. Applicants for several identical wells may submit a "typical data sheet" rather than submitting the data for each well.

B. The following must be submitted for each injection well covered by this application. All items must be addressed for the initial well. Responses for additional wells need be shown only when different. Information shown on schematics need not be repeated.

- (1) The name of the injection formation and, if applicable, the field or pool name
- (2) The injection interval and whether it is perforated or open-hole.
- (3) State if the well was drilled for injection or, if not, the original purpose of the well.
- (4) Give the depths of any other perforated intervals and detail on the sacks of cement or bridge plugs used to seal off such perforations.
- (5) Give the depth to and name of the next higher and next lower oil or gas zone in the area of the well, if any.

XIV. PROOF OF NOTICE

All applicants must furnish proof that a copy of the application has been furnished, by certified or registered mail, to the owner of the surface of the land on which the well is to be located and to each leasehold operator within one-half mile of the well location.

Where an application is subject to administrative approval, a proof of publication must be submitted. Such proof shall consist of a copy of the legal advertisement which was published in the county in which the well is located. The contents of such advertisement must include:

- (1) The name, address, phone number, and contact party for the applicant;
- (2) The intended purpose of the injection well; with the exact location of single wells or the section, township, and range location of multiple wells;
- (3) The formation name and depth with expected maximum injection rates and pressures; and
- (4) A notation that interested parties must file objections or requests for hearing with the Oil Conservation Division, PO Box 2088, Santa Fe, NM 87504-2088 within 15 days.

NO ACTION WILL BE TAKEN ON THE APPLICATION UNTIL PROPER PROOF OF NOTICE HAS BEEN SUBMITTED.

NOTICE: Surface owners or offset operators must file any objections or requests for hearing of administrative applications within 15 days from the date this application was mailed to them.

OIL CONSERVATION DIVISION
STATE OF NEW MEXICO
2040 S. PACHECO
SANTA FE NEW MEXICO 87505

APPLICATION FOR DISPOSAL WELL MODIFICATION
FROM CLASS II TO CLASS I

COLEMAN OIL & GAS INC.
P.O. BOX 443
FARMINGTON NM 87499
ATTN: CHUCK BADSGARD
PHONE: 505-327-0416

PREPARED BY:
CREATIVE FUTURE TECHNOLOGIES
P.O. BOX 364
FARMINGTON NM 87499
PHONE: 505-632-0662

MAY 3, 1996

TABLE OF CONTENTS

- I. Purpose
- II. Operator Information
- III. Well Data
- IV. Expansion
- V. Map of One Mile Radius
- VI. Area of Review Well Data
- VII. Proposed Operation
- VIII. Injection Zone Data
- IX. Stimulation Program
- X. Well Test Data
- XI. Fresh Water Data
- XII. Affirmative Statement & Contingency Plan
- XIII. Proof of Notice
- XIV. Certification
- XV. Attachments

I. Purpose

This discharge plan proposes to reclassify the existing Coleman Oil and Gas disposal well from a Class II to a Class I facility. This will allow additional sources of Oil & Gas produced wastes at this commercial facility however shall still be RCRA exempt.

II. Operator

Coleman Oil & Gas
P.O. Box 443
Farmington NM 87499
Attn: Chuck Badsgard
Phone: 505-327-0416

III. Well Data

A. Description

- 1.) Lease name; Sunco Disposal Well#1
Location; Section 2, T29N, R12W
Drawing; See attached "Exhibit A"
- 2.) Casing and Cementing; surface casing is 8 5/8" 24# K-55 set at 209' in 12-1/2" hole with 150 sacks of B cement 2% CACL₂ and 1/4# floccel circulated back to surface taking 180 cubic feet, long string 5-1/2" 15.5# K-55 set at 4762' with DV tool at 2244.17' cementing; first stage with 230 sx 65/35 Pozmix, 6% gel 5# sx Gilsonite, 1/4# sx Celoflake, and tailed with 265 sx class "B" with 5# sx Gilsonite and 1/4# Celoflake; second stage was cemented with 465 sx 65/35 Pozmix 6% gel and tailed with 50 sx class "B" neat cement with 2% Calcium Chloride. See attached "Exhibit B #1"
- 3.) Tubing Size and Depth; 2-7/8" J-55 8rd plastic lined set at 4281'; See attached "Exhibit B #2"
- 4.) Packer Information; 5-1/2' Arrow model XL-W retrievable seal bore with plastic coated bottom 2.688" seal bore set at 4282'

B. Formation

- 1.) Point Lookout 4380' to 4480'

- 2.) Interval perforated at 4350' to 4460' with 2 SPF and 220 holes; See attached "Exhibit C"
- 3.) Well was drilled for injection only.
- 4.) No other perforations.
- 5.) The depth of the next higher oil and gas producing zone is Pictured Cliffs at 2285' and the next lower is the top of the Dakota at 6550'.

IV. Expansion of Existing Well

- A. Currently operating under order #SWD-457

V. Map Identifying Leases

- A. 1/2 Mile radius; See attached "Exhibit D"
- B. One mile radius; See attached "Exhibit D"

VI. Area of Review Well Data

- A. Chart; See attached "Exhibit E"
- B. Hydrogeological Calculation; See attached "Exhibit F"

VII. Proposed Operation

- 1.) Injection rate; 2000-2800 BPD
- 2.) System; open
- 3.) Injection pressure; 2850 PSI; See attached "Exhibit G"
- 4.) Water sources shall include Oil & Gas produced Class I non-hazardous RCRA exempt; See attached "Exhibit H"
- 5.) Injection zone does not produce oil and gas and has an estimated TDS of 17,180 MG/L based on an analysis taken from the McGrath #4 well located in Unit B, Section 34, T30N, R12W; See attached "Exhibit I"

VIII. Injection Zone Data

The injection zone is the Point Lookout Sandstone of the Mesa Verde formation. It is a light to medium

XIV. Certification

I hereby certify that the information submitted with this application is true and correct to the best of my knowledge and belief.

NAME: Chuck BAOSGARD TITLE: Vice-President
SIGNATURE: Chuck Baosgard DATE: 5/6/96

ATTACHMENTS

Exhibit A

Exhibit B #1

Exhibit B #2

Exhibit C

Exhibit D

Exhibit E

Exhibit F

Exhibit G

Exhibit H

Exhibit I

Exhibit J

Exhibit K

OIL CONSERVATION DIVISION

P.O. Box 2088

Santa Fe, New Mexico 87504-2088

DISTRICT I

P.O. Box 1980, Hobbs, NM 88240

DISTRICT II

P.O. Drawer DD, Artesia, NM 88210

DISTRICT III

1000 Rio Brazos Rd., Aztec, NM 87410

WELL LOCATION AND ACREAGE DEDICATION PLAT

All Distances must be from the outer boundaries of the section

Operator COLEMAN DRILLING OIL & GAS			Lease Sunco Disposal		Well No 1
Unit Letter E	Section 2	Township 29N	Range 12W	NMPM	County SAN JUAN
Actual Footage Location of Well					
1595 feet from the NORTH		line and 1005 feet from the WEST		line	
Ground level Elev. 5859	Producing Formation MV		Pool Flora Vista		Dedicated Acreage: N/A Acres

- Outline the acreage dedicated to the subject well by colored pencil or hatchure marks on the plat below.
- If more than one lease is dedicated to the well, outline each and identify the ownership thereof (both as to working interest and royalty).
- If more than one lease of different ownership is dedicated to the well, have the interest of all owners been consolidated by communitization, unitization, force-pooling, etc.?
☐ Yes ☐ No If answer is "yes" type of consolidation _____
If answer is "no" list the owners and tract descriptions which have actually been consolidated. (Use reverse side of this form if necessary) _____
No allowable will be assigned to the well until all interests have been consolidated (by communitization, unitization, forced-pooling, or otherwise) or until a non-standard unit, eliminating such interest, has been approved by the Division.

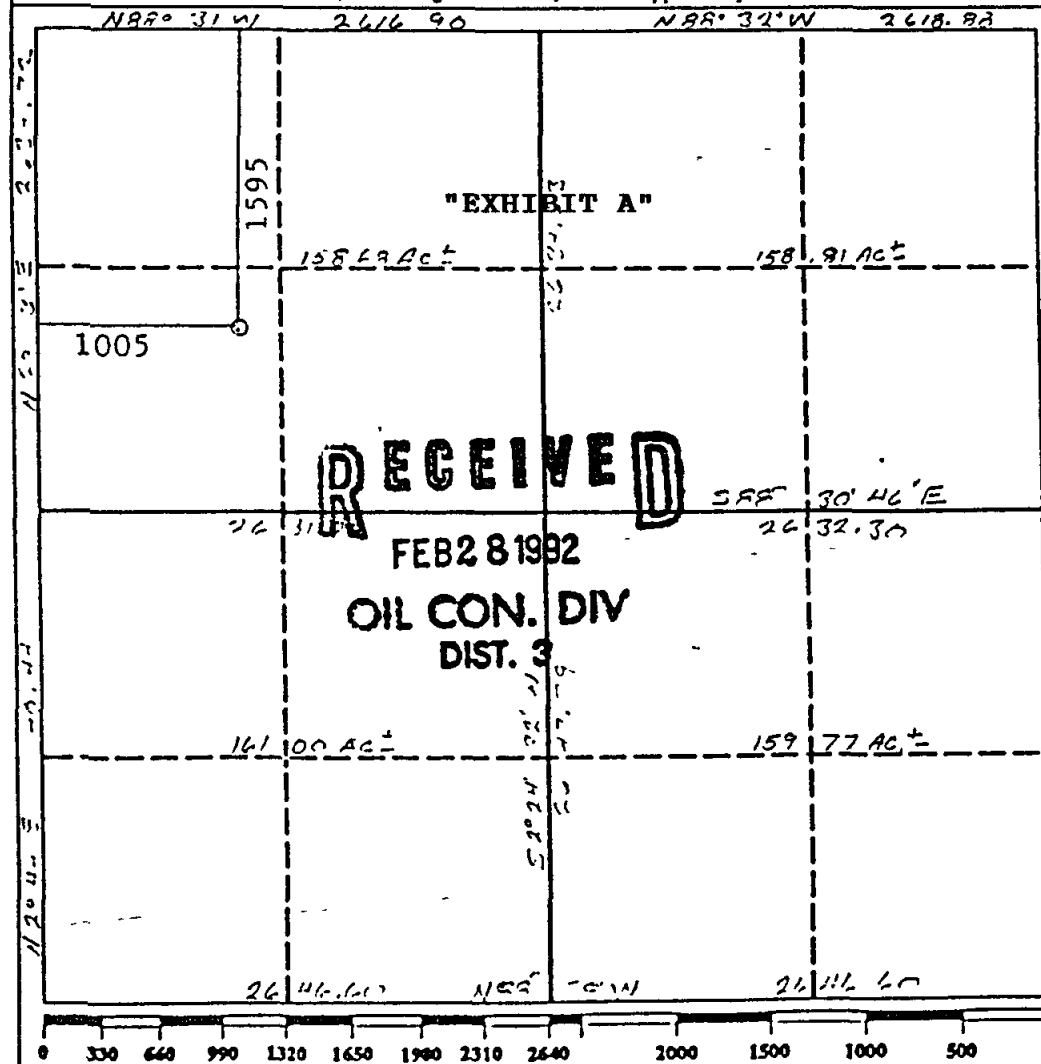

OPERATOR CERTIFICATION

I hereby certify that the information contained herein is true and complete to the best of my knowledge and belief

Signature
Ron Mahan

Printed Name
RON MAHAN

Position
CONTRACTS MGR

Company
COLEMAN O & G

Date
2/28/92

SURVEYOR CERTIFICATION

I hereby certify that the well location shown on this plat was plotted from field notes of actual surveys made by me or under my supervision, and that the same is true and correct to the best of my knowledge and belief.

Date Surveyed
June 4, 1991

Signature
Georgio B. Tullis

Professional Surveyor
2672

REGISTERED PROFESSIONAL LAND SURVEYOR

Certificate No.
9672

Coleman Oil & Gas
Sunco Well #1
Unit E, Section 2, T29N, R12W
San Juan County, New Mexico

DRILLING HISTORY

02-02-92 Ran 138 jts 15.5# K-55 ST&C and LT&C casing measuring 4768.40' and landed at 4762' KB. Ran centralizers mid first joint, top of 3rd, 5th, 7th, 9th, 11th, 67th, and 69th joints. DV tool was run in top of 68th joint and is at 2244.17' KB. Ran cement basket above and below DV tool. Rig up Western Company and cemented 1st stage with 230 sx 65/35 Pozmix, 6% gel, 5 #/sx gilsonite, and 1/4#/sx celoflake and tailed in with 265 sx Class "B" with 5 #/sx gilsonite and 1/4#/sx celoflake. Preceded job with 20 bbls mud flush. Full returns throughout job. Bumped plug with 1500 psi at 4:00 p.m. Dropped bomb and opened Baker DV tool with 500 psi. Circulated out good amount of cement from above DV tool. Waited 4 hrs and cemented 2nd stage with 465 sx 65/35 Pozmix, 6% gel and tailed in with 50 sx Class "B" neat cement with 2% calcium chloride. Preceded job with 20 bbls mud flush. Full returns through job, circulated 25 bbls good cement to surface. Tool closed with 2500 psi and held good. Plug down 9:05 p.m. Set slips and cut off casing.

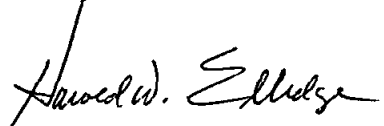
Harold W. Elledge
Petroleum Engineer

"EXHIBIT B #1"

"EXHIBIT B #1 CINTINUED"

Pipe Tally
Coleman Oil & Gas

Sunco Well #1

5 1/2" 15.5# LT&C & ST&C Casing

2/2/92

Jt.	Length	CUM	Jt.	Length	CUM	Jt.	Length	CUM	Jt.	Length	CUM	Jt.	Length	CUM	Jt.	Length	CUM
1	42.55	42.55	51	41.76	1926.50	101	1.79	2517.83	151	32.40	2550.23	201	28.96	4143.22	251	32.72	4801.12
2	40.46	83.01	52	41.52	1968.02	102		2517.83	152	32.29	2582.52	202	31.41	4174.63	252	41.78	4842.90
3	42.02	125.03	53	41.75	2009.77	103	B	2517.83	153	27.91	2610.43	203	30.39	4205.02	253	21.00	4863.90
4	35.46	160.49	54	41.72	2051.49	104	a	2517.83	154	30.44	2640.87	204	31.37	4236.39	254		4863.90
5	34.50	194.99	55	41.76	2093.25	105	k	2517.83	155	30.73	2671.60	205	29.44	4265.83	255	l	4863.90
6	39.58	234.57	56	41.72	2134.97	106	e	2517.83	156	31.25	2702.85	206	28.08	4293.91	256	e	4863.90
7	43.50	278.07	57	33.45	2168.42	107	r	2517.83	157	33.18	2736.03	207	32.38	4326.29	257	f	4863.90
8	32.94	311.01	58	28.68	2197.10	108		2517.83	158	31.37	2767.40	208	32.42	4358.71	258	t	4863.90
9	35.59	346.60	59	30.30	2227.40	109	D	2517.83	159	29.84	2797.24	209	39.88	4398.59	259		4863.90
10	30.55	377.15	60	31.63	2259.03	110	V	2517.83	160	28.36	2825.60	210	33.12	4431.71	260		4863.90
11	21.40	398.55	61	33.77	2292.80	111		2517.83	161	32.45	2858.05	211	32.18	4463.89	261	o	4863.90
12	34.96	433.51	62	31.26	2324.06	112	T	2517.83	162	30.56	2888.61	212	30.70	4494.59	262	u	4863.90
13	36.24	469.75	63	31.03	2355.09	113	o	2517.83	163	31.35	2919.96	213	30.55	4525.14	263	t	4863.90
14	35.51	505.26	64	42.88	2397.97	114	o	2517.83	164	31.73	2951.69	214	32.28	4557.42	264		4863.90
15	35.69	540.95	65	29.33	2427.30	115	l	2517.83	165	30.30	2981.99	215	32.22	4589.64	265		4863.90
16	21.45	562.40	66	27.75	2455.05	116		2517.83	166	32.06	3014.05	216	32.33	4621.97	266		4863.90
17	36.15	598.55	67	28.62	2483.67	117		2517.83	167	30.28	3044.33	217	40.85	4662.82	267		4863.90
18	41.58	640.13	68	29.68	2513.35	118		2517.83	168	30.84	3075.17	218	33.03	4695.85	268		4863.90
19	41.78	681.91	69		2513.35	119		2517.83	169	32.65	3107.82	219	39.85	4735.70	269		4863.90
20	21.91	703.82	70		2513.35	120		2517.83	170	30.70	3138.52	220	32.70	4768.40	270		4863.90
21	33.94	737.76	71	2.69	2516.04	121		2517.83	171	29.34	3167.86	221		4768.40	271		4863.90
22	25.13	762.89	72		2516.04	122		2517.83	172	31.20	3199.06	222		4768.40	272		4863.90
23	41.77	804.66	73	s	2516.04	123		2517.83	173	32.76	3231.82	223		4768.40	273		4863.90
24	36.15	840.81	74	h	2516.04	124		2517.83	174	32.69	3264.51	224		4768.40	274		4863.90
25	41.80	882.61	75	o	2516.04	125		2517.83	175	32.55	3297.06	225		4768.40	275		4863.90
26	41.62	924.23	76	e	2516.04	126		2517.83	176	29.66	3326.72	226		4768.40	276		4863.90
27	41.78	966.01	77	&	2516.04	127		2517.83	177	28.36	3355.08	227		4768.40	277		4863.90
28	41.84	1007.85	78	f	2516.04	128		2517.83	178	32.14	3387.22	228		4768.40	278		4863.90
29	41.74	1049.59	79	l	2516.04	129		2517.83	179	31.67	3418.89	229		4768.40	279		4863.90
30	40.92	1090.51	80	o	2516.04	130		2517.83	180	32.30	3451.19	230		4768.40	280		4863.90
31	33.86	1124.37	81	a	2516.04	131		2517.83	181	30.59	3481.78	231		4768.40	281		4863.90
32	41.89	1166.26	82	t	2516.04	132		2517.83	182	31.92	3513.70	232		4768.40	282		4863.90
33	41.72	1207.98	83	c	2516.04	133		2517.83	183	33.01	3546.71	233		4768.40	283		4863.90
34	41.48	1249.46	84	o	2516.04	134		2517.83	184	29.61	3576.32	234		4768.40	284		4863.90
35	41.74	1291.20	85	l	2516.04	135		2517.83	185	29.13	3605.45	235		4768.40	285		4863.90
36	41.84	1333.04	86	l	2516.04	136		2517.83	186	28.61	3634.06	236		4768.40	286		4863.90
37	41.82	1374.86	87	a	2516.04	137		2517.83	187	34.11	3668.17	237		4768.40	287		4863.90
38	41.08	1415.94	88	r	2516.04	138		2517.83	188	41.18	3709.35	238		4768.40	288		4863.90
39	41.84	1457.78	89		2516.04	139		2517.83	189	41.16	3750.51	239		4768.40	289		4863.90
40	41.84	1499.62	90		2516.04	140		2517.83	190	32.97	3783.48	240		4768.40	290		4863.90
41	41.88	1541.50	91		2516.04	141		2517.83	191	28.73	3812.21	241		4768.40	291		4863.90
42	42.58	1584.08	92		2516.04	142		2517.83	192	28.54	3840.75	242		4768.40	292		4863.90
43	41.45	1625.53	93		2516.04	143		2517.83	193	29.39	3870.14	243		4768.40	293		4863.90
44	30.73	1656.26	94		2516.04	144		2517.83	194	28.25	3898.39	244		4768.40	294		4863.90
45	36.15	1692.41	95		2516.04	145		2517.83	195	29.56	3927.95	245		4768.40	295		4863.90
46	32.62	1725.03	96		2516.04	146		2517.83	196	40.28	3968.23	246		4768.40	296		4863.90
47	41.81	1766.84	97		2516.04	147		2517.83	197	41.18	4009.41	247		4768.40	297		4863.90
48	34.45	1801.29	98		2516.04	148		2517.83	198	41.16	4050.57	248		4768.40	298		4863.90
49	41.75	1843.04	99		2516.04	149		2517.83	199	30.64	4081.21	249		4768.40	299		4863.90
50	41.70	1884.74	100		2516.04	150		2517.83	200	33.05	4114.26	250		4768.40	300		4863.90
col1884.74			631.30				1.79		1596.43			654.14			95.50		
cum1884.74			2516.04				2517.83		4114.26			4768.40			4863.90		

float & shoe 2.69

68 jts 2513.35

dv tool 1.79

CIRC CEMENT 70 jts 2250.57'

Joints #1 thru #56 are LT&C, the rest are ST&C

DV tool at 2244.17' KB

Anticipated PBTD 4717' KB

WELL PROFILE

OPERATOR COLEMAN OIL & GAS CO.
 WELL # SUNGO WDW #1
 FIELD CROUCH MESA
 COUNTY SAN JUAN
 STATE NEW MEXICO
 DATE 7/27/94

☐ NEW COMPLETION ☒ WORKOVER

	Casing	Liner	Tubing
SIZE	5 1/2		2 7/8
WEIGHT	15.5		6.5
GRADE			
THREAD			EU
DEPTH	4706		4265

ITEM NO.	EQUIPMENT AND SERVICES	LENGTH SKB	DEPTH
1	DONUT TYPE TUBING HANGER	.76	
2	2 7/8 EU PIN X PIN NIPPLE	.46	
3	2 7/8 PLASTIC LINED PUP JOINT	10.15	
4	2 7/8 PLASTIC LINED PUP JOINT	6.22	
5	135 JTS 2 7/8 PLASTIC LINED TUBING	4248.78	
6	2 7/8 X 5 1/2" ARROW 'T-2' PLASTIC COATED ON-OFF TOOL (MEAS W/ S. NIPPLE)	1.66	
7	2 7/8 X 1.87 STAINLESS STEEL NIPPLE W/ 1.87" 'F' PROFILE		4281
8	2.688 X 5 1/2" ARROW J-LATCH	.90	
9	3EA 2.688 BONDED SEAL UNITS 357		
10	2.688 1/2 MULESHOE BOTTOM	1.42	
11	5 1/2 X 2.688 ARROW 'XL-W' RETRIEVABLE SEAL BORE PACKER	4.68	4282
12	5 1/2 X 2.688 TUBING ADAPTER BOTTOM	1.18	
13	2 3/8 PLASTIC COATED PUP JOINT	5.69	
14	2 3/8 X 1.78 STAINLESS STEEL NIPPLE W/ 1.78" 'F' PROFILE	.87	4289
15	2 3/8 PLASTIC COATED PUP JOINT	6.10	
16	2 3/8 X 5 1/2 W/L ENTRY GUIDE COLLAR	.55	4296

COMMENTS:

SEAL ASSY + TUBING WERE LANDED W/ 4000# TENSION
 T-2 ON-OFF TOOL IS LEFT HAND RELEASE
 J-LATCH SEAL ASSY IS RIGHT HAND RELEASE

PREPARED BY
 B. J. WARBURTON

OFFICE
 FARMINGTON, NM

PHONE
 (505) 326-5141

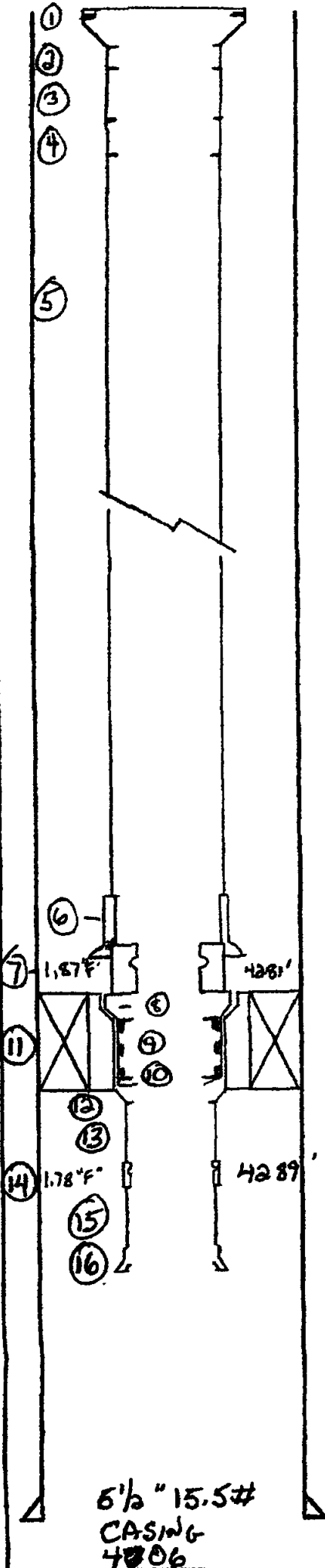

**MOUNTAIN
 STATES
 OIL TOOL**

PIPE RECORD

Coleman Oil & Gas LEASE Sunco Disposal

WELL NO. 1

7/28 1994

PIPE TALLY - Show every piece of equipment going into the hole in the order run.

COLUMN 1		COLUMN 2		COLUMN 3		COLUMN 4		COLUMN 5		COLUMN 6		COLUMN 7		COLUMN 8	
GRADE	WT	GRADE	WT	GRADE	WT	GRADE	WT	GRADE	WT	GRADE	WT	GRADE	WT	GRADE	WT
JOINT NO.	FEET	JOINT NO.	FEET	JOINT NO.	FEET	JOINT NO.	FEET	JOINT NO.	FEET	JOINT NO.	FEET	JOINT NO.	FEET	JOINT NO.	FEET
	55	6	10		87		569		110		468		90		166
2 3/8" x 5 1/2" W/L ENTRY GUIDE		2 3/8" PLASTIC LINED PUP JOINT		2 3/8" x 1.78" SS "F" NIPPLE		2 3/8" PLASTIC LINED PUP JOINT		5 1/2" x 2.688" TUBING ADAPTOR BOTTOM		5 1/2" x 2.688" ARROW "XL-W" RET. SEAL BORE PACKER		2.688" x 5 1/2" ARROW J-LATCH		2 3/8" x 5 1/2" ARROW T-2 ON/OFF TOOL W/ 1.67" FINISH	
	55	6	10		87		569		110		468		90		166

Jts. on rack before running

Jts. left on rack after running

No. Jts. run

COLUMN NO.	ITEM	JTS.	O.D.	WEIGHT	GRADE	THREAD	MAKE	FEET
1	WIRELINE ENTRY GUIDE	-	2 3/8	-	-	-	MTN STATES	55
2	PLASTIC LINED PUP JOINT	1	2 3/8	-	-	-	MTN STATES	6 10
3	1.78" STAINLESS "F" NIPPLE	-	2 3/8	-	-	-	MTN STATES	87
4	PLASTIC LINED PUP JOINT	1	2 3/8	-	-	-	MTN STATES	569
5	TUBING ADAPTOR BOTTOM	-	2 1/16"	-	-	-	MTN STATES	110
6	ARROW XL-W RETRIEVABLE PACKER	-	5 1/2"	-	-	-	ARROW	468
7	ARROW J-LATCH	-	2 1/16"	-	-	-	ARROW	90
8	ARROW T-2 ON/OFF TOOL	-	2 7/8"	-	-	-	ARROW	166

REMARKS

*ASTERISK DESIGNATES CENTRALIZER ON JOINT

TOTAL

21 55

TOP PACKER @ 4280.93' KB - BOTTOM @ 4299.92' KB

JOINTS NOT RUN

PUP JOINTS USED TO SPACE WITHIN ARE A.B.

Modified w/ Teflon Rings

TOTAL

TOP ROTARY DRIVE BUSHING TO TOP OF CASING HEAD FLANGE

(+)

SET AT

CO. REP

"EXHIBIT B #2 CONTINUED"
PIPE RECORD

Pg 2 of 2

Colongan Oil & Gas LEASE Sunco Disposal

WELL NO. 1

7/28 1994

PIPE TALLY - Show every piece of equipment going into the hole in the order run.

COLUMN 1		COLUMN 2		COLUMN 3		COLUMN 4		COLUMN 5		COLUMN 6		COLUMN 7		COLUMN 8	
GRADE	WT.	GRADE	WT.	GRADE	WT.	GRADE	WT.	GRADE	WT.	GRADE	WT.	GRADE	WT.	GRADE	WT.
JOINT NO.	FEET	JOINT NO.	FEET	JOINT NO.	FEET	JOINT NO.	FEET	JOINT NO.	FEET	JOINT NO.	FEET	JOINT NO.	FEET	JOINT NO.	FEET
	29 55		64 30		61 30		62 25	TAKEN OUT			6 22		46		76
	58 05		64 05		63 20		63 65		31 -		10 15				
	65 10		63 30		63 90		61 65		31 12						
	62 45		62 75		62 85		63 85		31 02						
	63 40		61 95		62 90		65 10		31 48						
	62 78		60 80		63 50		65 10		32 58						
	65 28		64 55		60 30		61 55		31 33						
	63 20		62 60		64 60		62 65		188 53						
	62 63		64 -		62 35		505 80								
	62 75		63 60		63 55										
	62 55		61 70		63 63		New PIPE								
	59 62		57 95		64 35		29 97		in						
	61 90		61 25		62 50		32 52		in						
	63 60		65 15		61 15		32 53		in						
	62 05		63 45		63 75		29 98		out						
	65 10		61 15		62 65		31 54		out						
	63 80		63 70		61 90		62 45		in						
	65 25		65 05		63 90		31 50		in						
	65 -		63 30		61 75		188 97		in						
	62 75		61 10		65 -										
	1226 81		1255 70		1259 03						16 37		46		76

Jts. on rack before running

Jts. left on rack after running

No. Jts. run

COLUMN NO.	ITEM	JTS.	O D	WEIGHT	GRADE	THREAD	MAKE	FEET
1	Tubing	39	27/8	65	J-55	8 ⁵⁰	SALTA	1226 81
2	Tubing	40	"	"	"	"	SALTA	1255 70
3	Tubing	40	"	"	"	"	SALTA	1259 03
4	Tubing	16	"	"	"	"	SALTA	505 80
5	Pup Joint	2	"	"	"	"	SALTA	16 37
6	End Pin x Pin N.P.P.L.E	1	"				MT STATES	46
7	Donut Hanger	1					A-1	76

REMARKS	*ASTERISK DESIGNATES CENTRALIZER ON JOINT	TOTAL	PAGE 1 & PAGE 2	4286	48
		JOINTS NOT RUN	TRADE OUT		44
			BAD JOINTS w/new		..
		TOTAL		4286	92
		TOP ROTARY DRIVE BUSHING TO TOP OF CASING HEAD FLANGE	(+)	13	00
		BOTTOM PACKER Assm.		4299	92
		CO REP			

"EXHIBIT C"

WALSH

ENGINEERING & PRODUCTION CORP.

 Petroleum Engineering Consulting
 Lease Management
 Contract Pumping

 204 N. Auburn
 Farmington, New Mexico 87401
 (505) 327-4992

 COLEMAN OIL & GAS
 SUNCO DISPOSAL WELL #1

 8 5/8", 24.0#, K-55
 SET AT 209'

MOUNTAIN STATES ARROW SET 1 PACKER AT 4206'

 136 JTS 2 7/8", 6.5#, J55, PLASTIC COATED TBC SET AT 4295'. (ONE JOINT BELOW
 PACKER)

 PERFS 4350 - 4460
 2 SPF 220 TOTAL HOLES

TOTO - 4706'

 5 1/2", 15.5#, K-55
 SET AT 4760

Paul Tompkins 10/14/93

EXHIBIT E

RECORD#	API NUMBER	UL	SEC	TWN	RGE	WELL NAME	WELL #	OPERATOR	POOL	TYPE	DATE	DEP
1	30-045-08851	D	01	29N	12W	Allen A	1	Amoco	Basin Dak	CO	4-25-62	6786
7	30-045-26014	L	01	29N	12W	Allen A	1E	Amoco	Basin Dak	CO	4-12-85	6625
12	30-045-08839	D	02	29N	12W	Young	1	Meridian	Basin Dak	CO	8-13-61	6740
15	30-045-08704	J	02	29N	12W	McGrath B	1	Meridian	Basin Dak	CO	12-3-61	6720
21	30-045-08712	I	03	29N	12W	McGrath A	1	Meridian	Basin Dak	CO	4-29-64	6689
79	35-045-13092	D	11	29N	12W	Cornell C	1	Amoco	Basin Dak	CO	12-6-61	6604
21211	30-045-26141	G	34	30N	12W	Duff Gas Com	1E	Amoco	Basin Dak	CO	1-7-85	6608
21212	30-045-08945	P	34	30N	12W	McGrath C	1	Meridian	Basin Dak	CO	3-6-63	6637
21213	30-045-11770	E	35	30N	12W	Hudson	3	Meridian	Basin Dak	CO	8-15-66	6750
21214	30-045-08946	P	35	30N	12W	Carnahan	1	Merion	Basin Dak	ZA	12-19-60	6760
21215	30-045-08946	P	35	30N	12W	Carahan Com	1	Merion	FL Mesa V	ZA	1-61	6760
21216	30-045-25844	P	35	30N	12W	Carahan Com	2	Merion	Basin Dak	CO	7-23-84	6780

*The completion records are also attached.

EXHIBIT F

Calculated Area of Review by Hydrologic Equation

$$\sqrt{\frac{QT}{L \cdot \theta_d \cdot (1 - SW) \times \pi}} = r$$

Where:

Q = volume of fluid in ft³/yr

T = life of project

h = reservoir height

θ_d = reservoir porosity

SW = water saturation

π = pi

r = radius

Q = 5.615 ft³/bbl * 2000 bbl/day * 365 days/year

Q = 4,098,950 ft³/year

T = 20 years

L = 100 ft

θ_d = .14

SW = .30

π = 3.14

$$r = \sqrt{\frac{(4,098,950)(20)}{(100)(.14)(1-.30)\pi}} = \sqrt{\frac{81,979,000}{30,772}} = 1632'$$

**Calculated Area of Review is 1632'

Chucks copy

1-3-94



STATE OF NEW MEXICO
ENERGY, MINERALS AND NATURAL RESOURCES DEPARTMENT
OIL CONSERVATION DIVISION



"Exhibit G"

BRUCE KING
GOVERNOR

ANITA LOCKWOOD
CABINET SECRETARY

December 22, 1993

POST OFFICE BOX 2088
STATE LAND OFFICE BUILDING
SANTA FE NEW MEXICO 87504
(505) 827-5800

Walsh Engineering & Production Corporation
204 North Auburn
Farmington, NM 87401

Attention: Paul C Thompson

RE: *Injection Pressure Increase, Coleman Sunco Disposal Well No. 1, Section 2, Township 29 North, Range 12 West, San Juan County, New Mexico*

Dear Mr Thompson

Reference is made to your request dated December 8, 1993 to increase the surface injection pressure on the above referenced well. This request is based on a step rate tests conducted on this well on December 7, 1993. The results of the test have been reviewed by my staff and we feel an increase in injection pressure on this well is justified at this time.

You are therefore authorized to increase the surface injection pressure on the following well

Well and Location	Maximum Injection Surface Pressure
Coleman Sunco Disposal Well No 1 1595' FNL - 1005' FWL Unit E, Section 2, Township 29 North, Range 12 West	2850 psig
This well located in San Juan County, New Mexico	

The Division Director may rescind this injection pressure increase if it becomes apparent that the injected water is not being confined to the injection zone or is endangering any fresh water aquifers

Sincerely,

William J LeMay
Director

WJL/BES/amg

cc. Oil Conservation Division - Aztec
File: SWD-457
PSI-X, 4th Quarter



ANALYSIS NO. 51-76-

FIELD RECEIPT NO. _____

API FORM 43-1

API WATER ANALYSIS REPORT FORM

Company <u>Coleman Oil & Gas</u>		Sample No. <u>2</u>	Date Sampled <u>02-25-92</u>
Field <u>SEC 2 T29N R2W</u>	Legal Description <u>SEC 2 T29N R2W</u>	County or Parish <u>San Juan</u>	State <u>NM</u>
Lease or Unit <u>SUNCO DISPOSAL</u>	Well <u>#1</u>	Depth <u>4</u>	Formation <u>M.V. (Pt. Lookout)</u>
Type of Water (Produced, Supply, etc.) <u>Produced</u>		Sampling Point <u>Pit</u>	Water. B/D <u></u>
		Sampled By <u></u>	

DISSOLVED SOLIDS

CATIONS

	mg/l	me/l
Sodium, Na (calc.)	<u>7451</u>	<u>323.94</u>
Calcium, Ca	<u>168</u>	<u>8.40</u>
Magnesium, Mg	<u>39</u>	<u>3.20</u>
Barium, Ba	<u></u>	<u></u>
Potassium, K	<u>720</u>	<u>18.41</u>

OTHER PROPERTIES

pH	<u>7.01</u>
Specific Gravity, 60/60 F.	<u>1.013</u>
Resistivity (ohm-meters)	<u>78 F.</u>
Total Hardness	<u>580</u>

ANIONS

	mg/l	me/l
Chloride, Cl	<u>11879</u>	<u>335.10</u>
Sulfate, SO ₄	<u>185</u>	<u>3.85</u>
Carbonate, CO ₃	<u>0</u>	<u>0</u>
Bicarbonate, HCO ₃	<u>915</u>	<u>15.00</u>
Hydroxide, OH	<u>0</u>	<u>0</u>

WATER PATTERNS — me/l

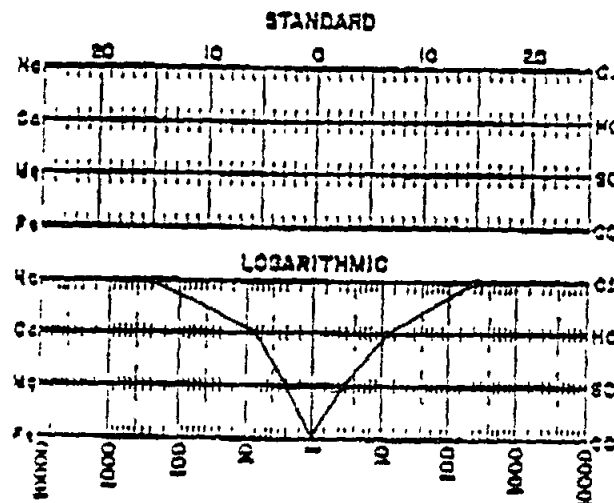

Total Dissolved Solids (calc.)

21357

Iron, Fe (total)

25 ppm

Sulfide, as H₂S

neg

REMARKS & RECOMMENDATIONS:

ANALYST: Llee

PLEASE REFER ANY QUESTIONS TO:

THE WESTERN CO. OF NORTH AMERICA
ARMINGTON, N.M.
RIAN AULT-District Engineer
(505) 327-6222

LABORATORY WATER

To Southland RoyaltyDate 9/12/84Attn: Doug HarrisBox 570Farmington, N.M. 87499

This report is the property of Halliburton Company and neither it nor any part thereof nor a copy thereof is to be published or disclosed without first securing the express written approval of laboratory management. It may however be used in the course of regular business operations by any person or concern and employees thereof receiving such report from Halliburton Company.

4255-4377

Submitted by Doug Harris Date Rec _____Well No McGrath #4 Depth 4255' - 4377' Formation Point LookoutCounty _____ Field _____ Source DST #2 4255'-4377'

	Top Recovery	Bottom Recovery	Sample Chamber
Resistivity	<u>3.16 @ 65°F</u>	<u>.97 @ 71°F</u>	<u>.68 @ 68°F</u>
Specific Gravity	_____	_____	_____
pH	<u>8.47</u>	<u>7.53</u>	<u>7.86</u>
Calcium (Ca)	<u>55</u>	<u>210</u>	<u>210</u> *MP
Magnesium (Mg)	<u>NT</u>	<u>NT</u>	<u>35</u>
Chlorides (Cl)	<u>2900</u>	<u>6950</u>	<u>9900</u>
Sulfates (SO ₄)	_____	_____	_____
Bicarbonates (HCO ₃)	<u>320</u>	<u>705</u>	<u>670</u>
Soluble Iron (Fe)	<u>NT</u>	<u>NT</u>	<u>NT</u>
_____	_____	_____	_____
_____	_____	_____	_____
_____	_____	_____	_____

Remarks:

*Milligrams per liter

Respectfully submitted,

Analyst _____
cc:

HALLIBURTON COMPANY

By B. E. P.

NOTICE

This report is limited to the described sample tested. Any user of this report agrees that Halliburton shall not be liable for any loss or damage, whether it be to act or omission, resulting from such report or its use.

SOUTH

NORTH

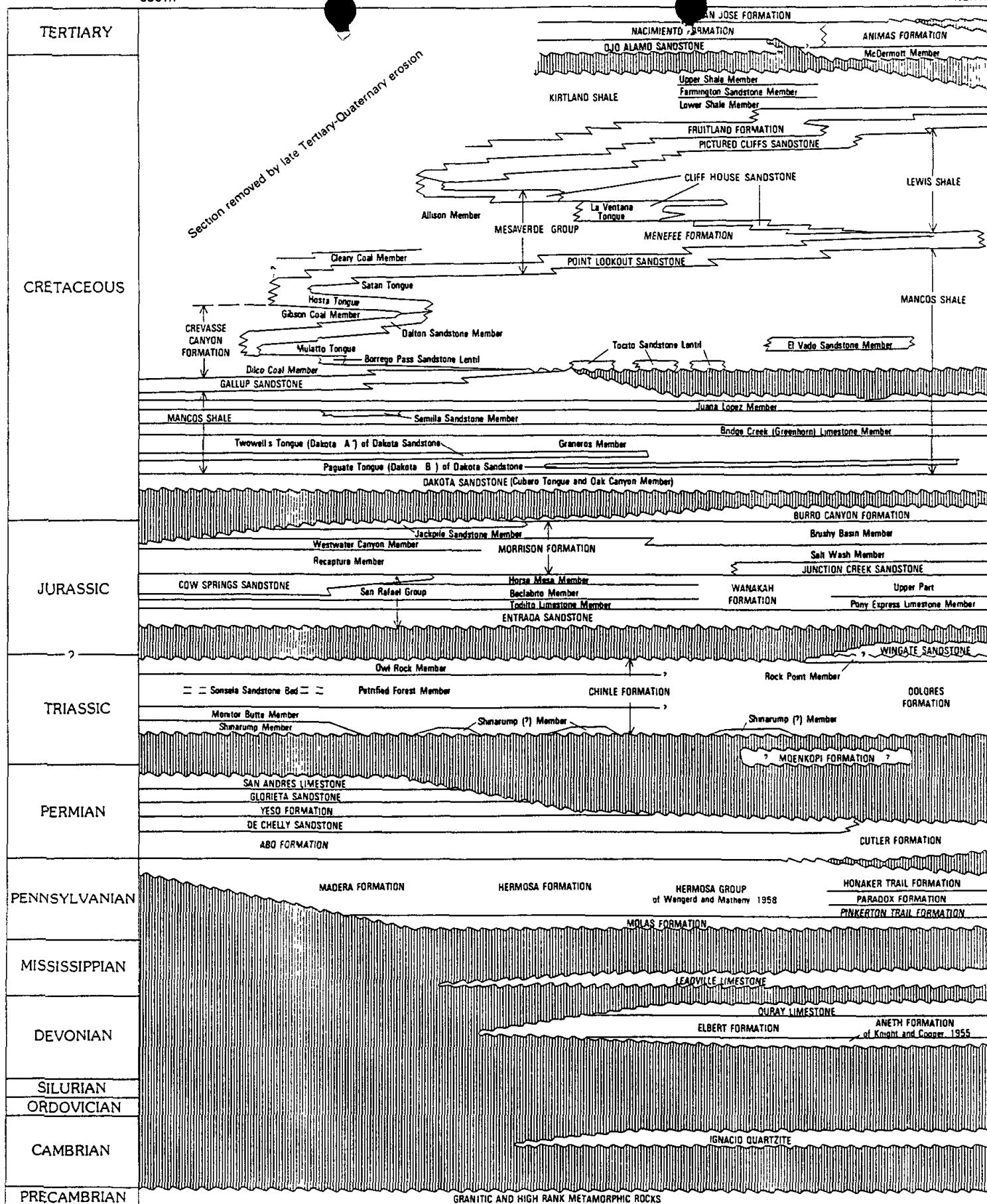

Figure 3 Time- and rock-stratigraphic framework and nomenclature.

(Modified from Molenaar 1977a,b and 1989)

Boundary of study area
of equal depth to top of Ojo Alamo Sandstone—Interval 500 feet Datum is
land surface

109°00'

30

106°30'

37°30'

"Exhibit J"
Continued

37°00'

30

36°00'

30

35°00'

34°00'

108°00'

30

107°00'

106°30'

SCALE 1:1000000

25 0 25 MILES

25 0 25 KILOMETERS

Figure 5 Approximate depth to the top of the Ojo Alamo Sandstone.

EXPLANATION

Outcrop of Ojo Alamo Sandstone—From Dane and Bachman 1965 and Fassett

NOTICE OF PUBLICATION

STATE OF NEW MEXICO
ENERGY, MINERALS AND NATURAL RESOURCES DEPARTMENT
OIL CONSERVATION DIVISION

"Exhibit K"

Notice is hereby given that pursuant to New Mexico Water Quality Control Commission Regulations, the following discharge plan application has been submitted to the Director of the Oil Conservation Division, 2040 South Pacheco, Santa Fe, New Mexico 87505, Telephone (505) 827-7131.

(GW-235) - Coleman Oil and Gas, Inc., Mr. Chuck Badsgard, P.O. Box 443, Farmington, New Mexico, 87499 has submitted a discharge plan application to reclassify their permitted Class II disposal well located in Section 2, Township 29 North, Range 12 West, NMPM, San Juan County, New Mexico to a Class I non-hazardous disposal well. Currently 2,000 barrels per day of oil field liquid waste classified as exempt from Resource Conservation and Recovery Act Subtitle III regulations are disposed of by injection into the Point Lookout Formation at a depth from 4,380 to 4,480 feet. The discharge plan application proposes to reclassify the category of the well to allow for the injection of an additional 800 barrels per day of oil field liquid waste that has been demonstrated to be "non-hazardous" by testing. A combined total of approximately 2,800 barrels per day will be disposed of by injection into the Point Lookout Formation. The total dissolved solids concentration of the injection water is approximately 24,000 mg/l. The total dissolved solids concentration of the formation fluids is approximately 14,000 mg/l. The discharge plan addresses construction, operation and monitoring of the well and associated surface facilities and provides a contingency plan in the event of accidental spills, leaks and other accidental discharges to the ground surface. Ground water most likely to be affected by any accidental discharge is at a depth from 78 to 90 feet and has a total dissolved solids concentration of approximately 450 mg/l.

Any interested person may obtain further information from the Oil Conservation Division and may submit written comments to the Director of the Oil Conservation Division at the address given above. The discharge plan application may be viewed at the above address between 8:00 a.m. and 4 00 p.m., Monday through Friday. Prior to ruling on any proposed discharge plan or its modification, the Director of the Oil Conservation Division shall allow at least thirty (30) days after the date of publication of this notice during which comments may be submitted to him and a public hearing may be requested by any interested person. Requests for a public hearing shall set forth the reasons why a hearing should be held. A hearing will be held if the Director determines there is significant public interest.

If no public hearing is held, the Director will approve or disapprove the proposed plan based on information available. If a public hearing is held, the director will approve or disapprove the proposed plan based on information in the discharge plan application and information submitted at the hearing.

GIVEN under the Seal of New Mexico Oil Conservation Commission at Santa Fe, New Mexico, on this 5th day of February 1996.

STATE OF NEW MEXICO
OIL CONSERVATION DIVISION

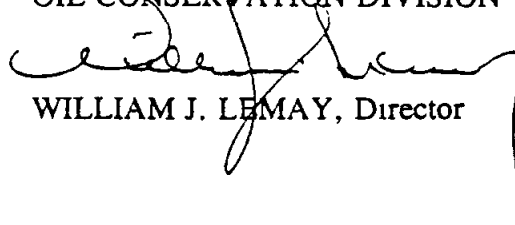

WILLIAM J. LEMAY, Director

S E A L

NEW MEXICO OIL CONSERVATION COMMISSION
WELL LOCATION AND ACREAGE DEDICATION PLAT

FORM C-128
Revised 5/1/57

SEE INSTRUCTIONS FOR COMPLETING THIS FORM ON THE REVERSE SIDE

SECTION A

Operator Tennessee Gas Transmission Company	Lease Allen Dakota Gas Unit "A"	Well No. 1
Unit Letter	Section 1	Township 29 North
	Range 12 West	County San Juan County
Actual Footage Location of Well 790 feet from the North line and 790 feet from the West line		
Ground Level Elev 5905.5	Producing Formation Dakota	Pool Basin
		Dedicated Acreage 360 320.20 Acres

1. Is the Operator the only owner in the dedicated acreage outlined on the plat below? YES ☒ NO ____ . ("Owner" means the person who has the right to drill into and to produce from any pool and to appropriate the production either for himself or for himself and another. (65-3-29 (e) NMSA 1935 Comp.)
2. If the answer to question one is "no," have the interests of all the owners been consolidated by communitization agreement or otherwise? YES ____ NO ____ . If answer is "yes," Type of Consolidation ____
3. If the answer to question two is "no," list all the owners and their respective interests below

Owner	Land Description

SECTION B

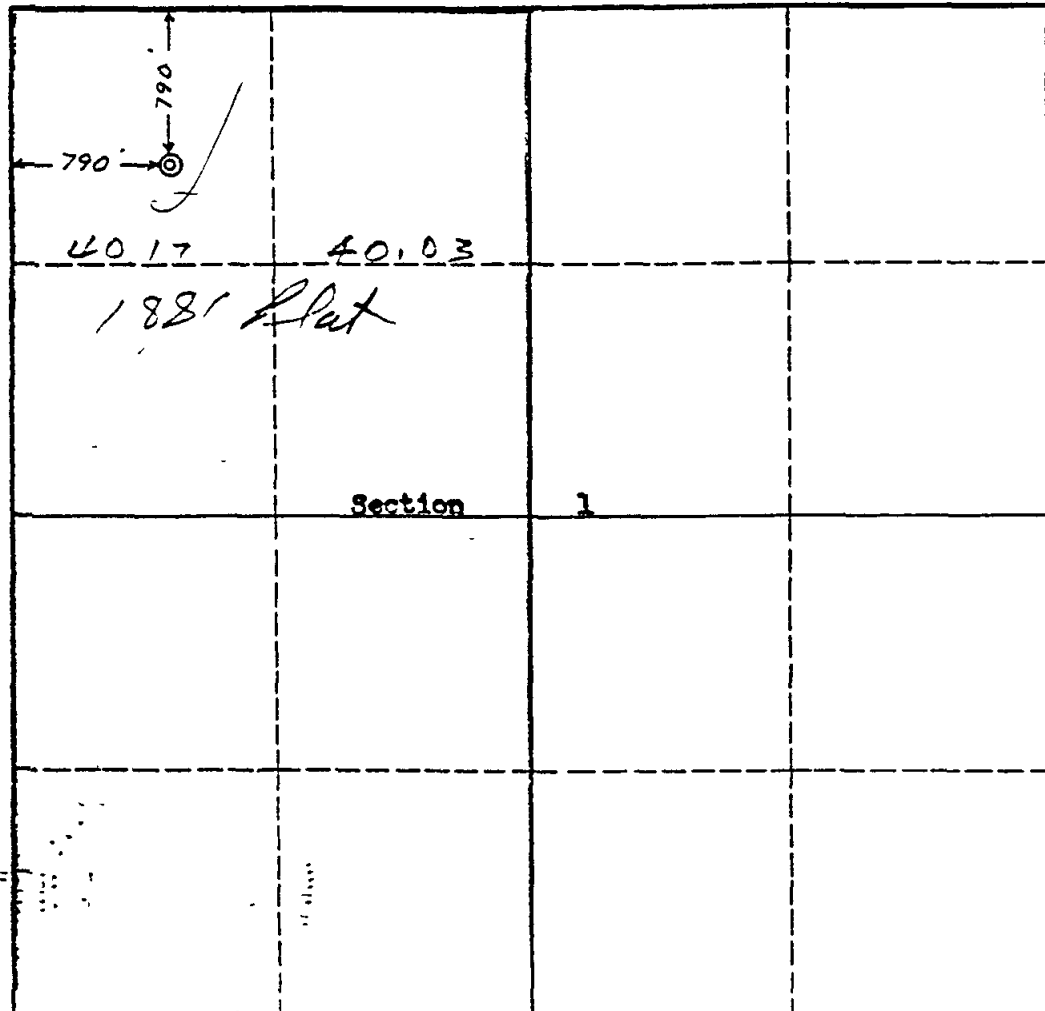

I hereby certify that the information in SECTION A above is true and complete to the best of my knowledge and belief.

Name **J. J. Lacey**
Position **District Petroleum Engineer**
Company **Tennessee Gas Transmission**
Date **March 10, 1961**

I hereby certify that the well location shown on the plat in SECTION B was plotted from field notes of actual surveys made by me or under my supervision, and that the same is true and correct to the best of my knowledge and belief.

Date Surveyed **9 March 1961**
Registered Professional Engineer and/or Land Surveyor
Robert H. Ernst

Certificate No. **PS & LS 2153**

San Juan Engineering Co.

NEW MEXICO OIL CONSERVATION COMMISSION
Santa Fe, New Mexico

WELL RECORD

Mail to District Office, Oil Conservation Commission, to which Form C-101 was sent not later than twenty days after completion of well. Follow instructions in Rules and Regulations of the Commission. Submit in QUINTUPLICATE. If State Land submit 6 Copies

AREA 640 ACRES
LOCATE WELL CORRECTLY

Tenneco Corporation (Company or Operator) Allen Dakota Gas Unit "A" (Lease)

Well No 1 in NW 1/4 of NW 1/4 of Sec 1, T. 29N, R. 12W, NMPM.

Basin Dakota Pool, San Juan County.

Well is 790 feet from N line and 790 feet from W line of Section 1. If State Land the Oil and Gas Lease No. is NM 520 NM 524

Drilling Commenced March 12, 1961 Drilling was Completed May 19, 1961.

Name of Drilling Contractor Great Western Drilling Company

Address Farmington, New Mexico

Elevation above sea level at Top of Tubing Head 5905 GL The information given is to be kept confidential until , 19

OIL SANDS OR ZONES

No 1, from 6714 to 6718 No 4, from 6605 to 6620

No 2, from 6700 to 6706 No 5, from 6518 to 6524

No 3, from 6689 to 6693 No 6, from 6527 to 6533

IMPORTANT WATER SANDS

Include data on rate of water inflow and elevation to which water rose in hole.

No 1, from None to feet

No 2, from to feet

No 3, from to feet

No 4, from to feet

CASING RECORD

SIZE	WEIGHT PER FOOT	NEW OR USED	AMOUNT	KIND OF SHOE	CUT AND PULLED FROM	PERFORATIONS	PURPOSE
8 5/8" OD 24#		New	264'	Guide			Surface
4 1/2" 9.5#		New	4628'	Float		6518-6718	Production
4 1/2" 11.6#		New	2157'				

MUDDING AND CEMENTING RECORD

SIZE OF HOLE	SIZE OF CASING	WHERE SET	NO. BAGS OF CEMENT	METHOD USED	MUD GRAVITY	AMOUNT OF MUD USED
12 1/4"	8 5/8"	264'	200 Sx	Two Plug		
7 7/8"	4 1/2"	6785'	300 Sx	Two Plug		

RECORD OF PRODUCTION AND STIMULATION

(Record the Process used, No. of Qts. or Gals used, interval treated or shot.)

Sand Frac Perfs 6714-18; 6700-06; 6689; 93, with 10,000# 20-40 sand and 20,000 gal water.

Sand Frac Perfs 6605-20 with 250 gal BDA, 43,000# 20-40 sand and 68,000 gal water.

Sand Frac Perfs 6518-24 and 6527-33 with 250 gal BDA 40,000# 20-40 sand and 52,000 gal water.

Result of Production Stimulation

TEST-- Flw 2882 MCFD, ACF 3162, 10 BBL cond per MMCF on 3/4" choke TP 230, CP 710, SITP 2096, BHP 2566.

All distances must be from the outer boundaries of the Section.

Operator TENNECO OIL COMPANY			Lease ALLEN HAN		Well No. 1E
Init Letter L	Section 1	Township 29N	Range 12W	County San Juan	
Actual Footage Location of Well:					
1450		feet from the South	line and 790	feet from the West	line
Ground Level Elev. 5831	Producing Formation Dakota		Pool Basin Dakota		Dedicated Acreage: 320 Acres

1. Outline the acreage dedicated to the subject well by colored pencil or hachure marks on the plat below.
2. If more than one lease is dedicated to the well, outline each and identify the ownership thereof (both as to working interest and royalty).
3. If more than one lease of different ownership is dedicated to the well, have the interests of all owners been consolidated by communitization, unitization, force-pooling, etc?

☒ Yes ☐ No If answer is "yes," type of consolidation Communitized

If answer is "no," list the owners and tract descriptions which have actually been consolidated. (Use reverse side of this form if necessary.)

No allowable will be assigned to the well until all interests have been consolidated (by communitization, unitization, forced-pooling, or otherwise) or until a non-standard unit, eliminating such interests, has been approved by the Commission.

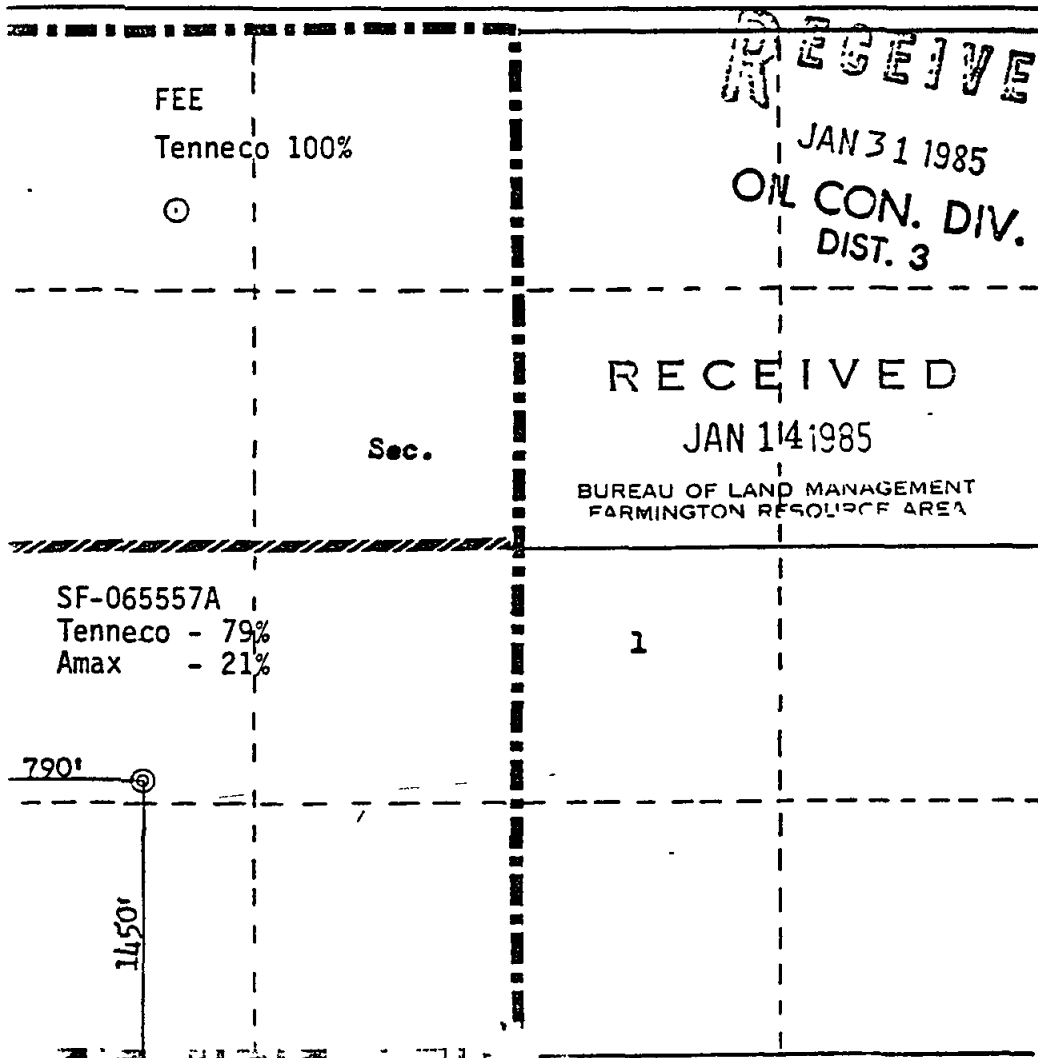

CERTIFICATION

I hereby certify that the information contained herein is true and complete to the best of my knowledge and belief.

Scott McKinney

Name
Scott McKinney

Position
Sr. Regulatory Analyst

Company
Tenneco Oil Co

Date
January 10, 1985

I hereby certify that the well location shown on this plat was plotted from field notes of actual surveys made by me or under my supervision, and that the same is true and correct to the best of my knowledge and belief.

Date Surveyed
October 27, 1984

Registered Professional Engineer and Land Surveyor
Fred B. Kerr Jr.
Fred B. Kerr Jr.

Certificate No.
3950

Scale 1"=100'

983)
9-331)

UNITED STATES
DEPARTMENT OF THE INTERIOR
BUREAU OF LAND MANAGEMENT

SUBMIT IN TRIPPLICATE
(Other instructions on reverse side)

Form approved
Budget Bureau No 1004-0135
Expires AUGUST 31, 1985

LEASE DESIGNATION AND SERIAL NO

SF-065557A

SUNDRY NOTICES AND REPORTS ON WELLS

(Do not use this form for proposals to drill or to deepen or plug back to a different reservoir
Use APPLICATION FOR PERMIT— for such proposals)

1. OIL WELL <input type="checkbox"/> GAS WELL <input checked="" type="checkbox"/> OTHER <input type="checkbox"/>		6. IF INDIAN ALLOTTEE OR TRIBE NAME
2. NAME OF OPERATOR Tenneco Oil Company		7. UNIT AGREEMENT NAME
3. ADDRESS OF OPERATOR P.O. Box 3249, Englewood, CO 80155		8. FARM OR LEASE NAME Allen A
4. LOCATION OF WELL (Report location clearly and in accordance with any State requirements. See also space 17 below) At surface 1450' FSL, 790' FWL		9. WELL NO 1E
14. PERMIT NO 30-045-26214		10. FIELD AND POOL, OR WILDCAT Basin Dakota
15. ELEVATIONS (Show whether SF, ST, OR, etc.)		11. SEC., T., R., OR B.L. AND SURVEY OR AREA SEC. 1, T29N, R12W
		12. COUNTY OR PARISH San Juan
		13. STATE NM

Check Appropriate Box To Indicate Nature of Notice, Report, or Other Data

NOTICE OF INTENTION TO

TEST WATER SHUT-OFF ☐
FRACTURE TREAT ☐
SHOOT OR ACIDIZE ☐
REPAIR WELL ☐
(Other) ☐

PLUG OR ALTER CASING ☐
MULTIPLE COMPLETE ☐
ABANDON ☐
CHANGE PLANS ☐

SUBSEQUENT REPORT OF

WATER SHUT-OFF ☐
FRACTURE TREATMENT ☐
SHOOTING OR ACIDIZING ☐
(Other) ☐

REPAIRING WELL ☐
ALTERING CASING ☐
ABANDONMENT ☐

Progress report
(Note: Report results of multiple completion on Well Completion or Recompletion Report and Log form)

17. DESCRIBE PROPOSED OR COMPLETED OPERATIONS (Clearly state all pertinent details and give pertinent dates, including estimated date of starting any proposed work. If well is directionally drilled give subsurface locations and measured and true vertical depths for all markers and zones pertinent to this work.)

3/22/85 MIRU w/Four Corners rig #7. Spud 12 1/4" surface 10:15 am 3/22/85. Drllg. TOOH RU & run 7 jts, 8 5/8 32# K-55 STC csg. Total 303 w/tools, set @318' KB. RU Western & cmt w/15 bbl H2), 274 sx (325CF), "B" w/1/4 #/sx cello-flake + 2% CaCl, plug dn 3:30 pm 3/22/85. Circ 15 bbl excess cmt. WOC NUBOP test blind rams & manifold to 1000 psi ok. TIH tag cmt @287, drill plug & cmt to 5' end of shoe, test csg & pipe rams to 1000 psi ok. Drill ahead.

3/31/85 RU run 163 jts, 5 1/2" 17# N-80 LT&C, total w/tools 6642.50. RU & circ cmt 1st stage w/20 bbls mud flush, 120 sx 221 CF 65-35 POZ 6% gel, + 1/4 #/sx cello-flake, tailed w/100 sx 118 CF "B" w/ 1/4 #/sx cello-flake. Plug on 4:15 am 4/1/85. Drop bomb Open tool & circ.

4/01/85 Cmt 2nd stage w/20 bbl mud flush 500 sx 65/35 6% gel 1/4# cello seal tailed w/100 sx "B" 1/4# cello seal. Drop bomb open tool & circ. Cmt 3rd stage w/20 bbl mud flush 200 sx 65/35 6% gel 1/4# cello seal. Plug dn 1:30 pm 4/1/85. Circ 2 bbl excess cmt. Rig release @3:30 pm 4/1/85

RECEIVED

APR 15 1985

CHAS. J. W.

Dist. 3

18. I hereby certify that the foregoing is true and correct

SIGNED Steve McKinnis TITLE Sr. Regulatory Analyst DATE April 4, 1985

(This space for Federal or State office use)

APPROVED BY _____ TITLE _____ DATE _____
CONDITIONS OF APPROVAL, IF ANY:

ACCEPTED FOR RECORD

APR 13 1985

*See Instructions on Reverse Side

NMOCC

FARMINGTON RESOURCE AR

BI _____
RV 893

Title 18 U.S.C. Sec. 1001 makes it a crime for any person knowingly and willfully to make to any department or agency of the United States a false, fictitious or fraudulent statement or representation as to any matter within its jurisdiction.

TRANSPORTER	OIL		
	GAS		
OPERATOR			
PRODUCTION OFFICE			
Operator Tenneco Oil Company			
Address P. O. Box 3249, Englewood, CO 80155			
Reason(s) for filing (Check proper box)		Other (Please explain)	
New Well	<input checked="" type="checkbox"/>	Change in Transporter of:	
Recompletion	<input type="checkbox"/>	Oil	<input type="checkbox"/>
Change in Ownership	<input type="checkbox"/>	Casinghead Gas	<input type="checkbox"/>
		Dry Gas	<input type="checkbox"/>
		Condensate	<input type="checkbox"/>

If change of ownership give name and address of previous owner _____

DESCRIPTION OF WELL AND LEASE

Lease Name Allen A	Well No. 1E	Pool Name, including Formation Basin Dakota	Kind of Lease USA State, Federal or Fee SF	Lease No 065557A
Location Unit Letter <u>L</u> : <u>1450</u> Feet From The <u>South</u> Line and <u>790</u> Feet From The <u>West</u>				
Line of Section <u>1</u> Township <u>29N</u> Range <u>12W</u> , NMPM, <u>San Juan</u> County				

DESIGNATION OF TRANSPORTER OF OIL AND NATURAL GAS

Name of Authorized Transporter of Oil <input type="checkbox"/> or Condensate <input checked="" type="checkbox"/>	Address (Give address to which approved copy of this form is to be sent)
Gary Energy Corp.	4 Inverness Ct. East, Englewood, CO 80112
Name of Authorized Transporter of Casinghead Gas <input type="checkbox"/> or Dry Gas <input checked="" type="checkbox"/>	Address (Give address to which approved copy of this form is to be sent)
El Paso Natural Gas Company	P. O. Box 4990, Farmington, NM 87499
If well produces oil or liquids, give location of tanks.	Unit : <u>L</u> Sec. : <u>1</u> Twp. : <u>29N</u> Rge. : <u>12W</u>
Is gas actually connected?	When : <u>NO</u> <u>ASAP</u>

If this production is commingled with that from any other lease or pool, give commingling order number: _____

COMPLETION DATA

Designate Type of Completion - (X)	Oil Well	Gas Well	New Well	Workover	Deepen	Plug Back	Same Res.	Diff. Res.
		<u>X</u>	<u>X</u>					
Date Spudded 3-22-85	Date Compl. Ready to Prod. 4-21-85	Total Depth 6625' KB	P.B.T.D. 6619' KB					
Elevations (DF, RAB, RT, GR, etc.) 5831' GL	Name of Producing Formation Dakota	Top Oil/Gas Pay 6425' KB	Tubing Depth 6559' KB					
Perforations 2 JSPF 43', 86 holes 6425-36', 6502-28', 6596-6602' KB			Depth Casing Shoe 6622' KB					

TUBING, CASING, AND CEMENTING RECORD

HOLE SIZE	CASING & TUBING SIZE	DEPTH SET	SACKS CEMENT
12 1/4"	8 5/8" csg	318' KB	275 sx 325 CF
7 7/8"	5 1/2" csg	6622' KB	720 sx 1745 CF 1627
	2 3/8	6559	

TEST DATA AND REQUEST FOR ALLOWABLE OIL WELL

Date First New Oil Run To Tanks	Date of Test	Producing Method (Flow, pump, gas lift, etc.)
		RECEIVED
Length of Test	Tubing Pressure	Casing Pressure
		Choke Size
Actual Prod. During Test	Oil-Bbls.	Water-Bbls.
		MAY 02 1985

OIL CON. DIV.
DIST. 3

GAS WELL			
Actual Prod. Test-MCF/D 1936	Length of Test 3 hrs	Bbls. Condensate/MCF	Gravity of Condensate
Testing Method (pilot, back pr.) back pressure	Tubing Pressure (shut-in) 1325	Casing Pressure (shut-in) 1325	Choke Size 3/4"

CERTIFICATE OF COMPLIANCE

I hereby certify that the rules and regulations of the Oil Conservation Commission have been complied with and that the information given above is true and complete to the best of my knowledge and belief.

OIL CONSERVATION COMMISSION
6-12-85
APPROVED
JUN 12 1985
BY Original Signed by FRANK T. CHAVEZ

NEW MEXICO OIL CONSERVATION COMMISSION

Well Location and Acreage Dedication Plat

TION A.

Operator Astec Oil and Gas Company Lease Young Date July 27, 1961
Well No 1-D Unit Letter D Section 2 Township 29N Range 12W NMPM
Located 990 Feet From North Line, 990 Feet From West Line
County San Juan G. L. Elevation 5847 Dedicated Acreage 320 319.94 Acres
Name of Producing Formation Dakota Pool Basin

1. Is the Operator the only owner* in the dedicated acreage outlined on the plat below? Yes X No
2. If the answer to question One is "No," have the interests of all the owners been consolidated by communitization agreement or otherwise? Yes No If answer is "Yes," Type of Consolidation
3. If the answer to question Two is "No," list all the owners and their respective interests below:

OWNER

LAND DESCRIPTION

SECTION B.

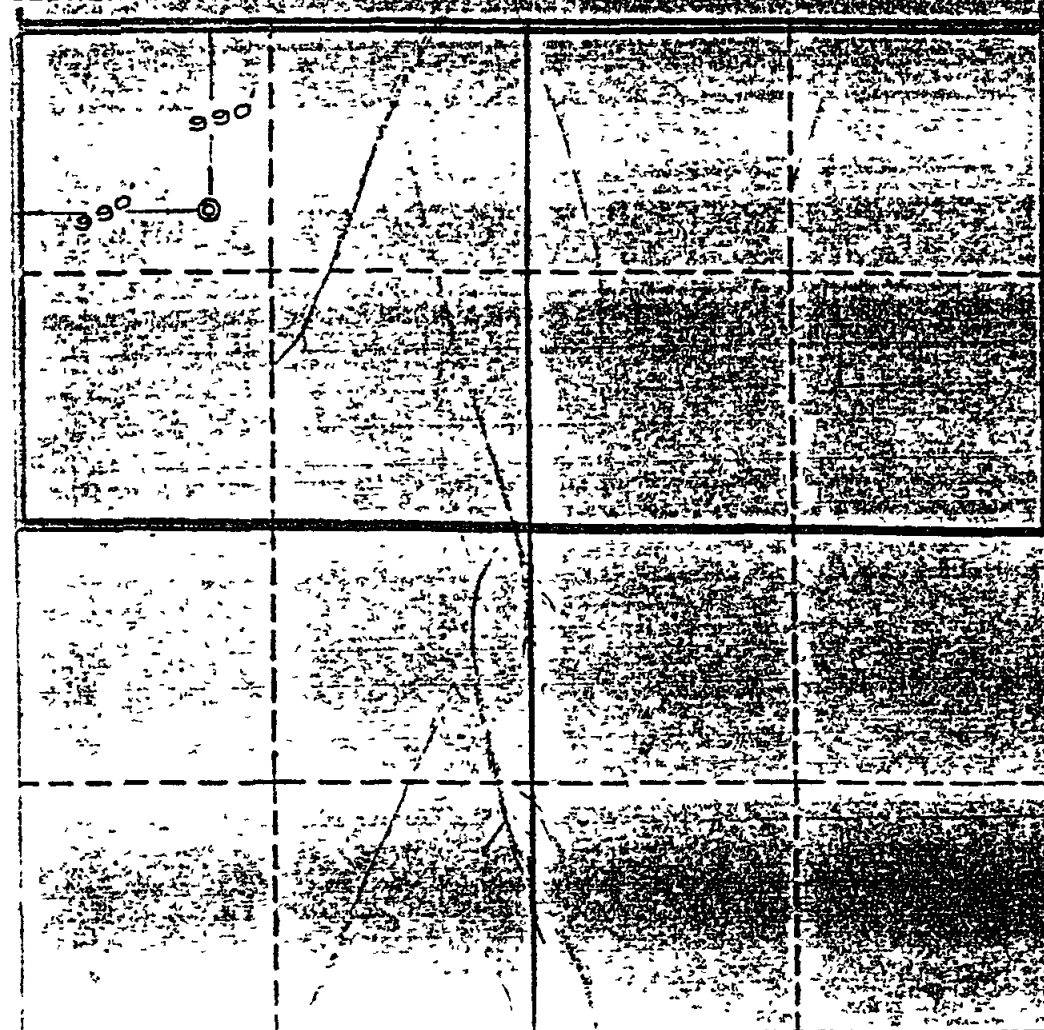

RECEIVED

JUL 31 1961

OIL CON COM
DIST 3

This is to certify that the information in Section A above is true and complete to the best of my knowledge and belief.

Astec Oil and Gas Company

OPERATOR

ORIGINAL SIGNED BY JOE C. SALMON

REPRESENTATIVE

Joe C. Salmon, Dist. Supt.
Drawer 570, Farmington, N.M.

REGISTERED

This is to certify that the well location shown on the plat in Section B was plotted from the original survey made by me or my supervisor and that the same is true and correct to the best of my knowledge and belief.

Date Surveyed July 27, 1961

Four States Engineering Co.
Albuquerque, New Mexico

REGISTERED ENGINEER OR
LAND SURVEYOR

Certificate No. 3084

COPIES RECEIVED		5	
DISTRIBUTION			
OFFICE	1	✓	
OFFICE	2		
TRANSPORTER			
OIL			
943			
PRODUCTION OFFICE			
OPERATOR	1		

Obtained 7/1/61
(Form C-108)

0									

AREA 640 ACRES
LOCATE WELL CORRECTLY

NEW MEXICO OIL CONSERVATION COMMISSION
Santa Fe, New Mexico

WELL RECORD

Mail to District Office, Oil Conservation Commission, to which Form C-101 was sent not later than twenty days after completion of well. Follow instructions in Rules and Regulations of the Commission. Submit in QUINTUPLICATE If State Land submit 6 Copies.

Astec Oil & Gas Company

Young

(Company or Operator)

(Lease)

Well No. 1-D, in NW 1/4 of Sec 2, T. 29N, R. 12W, NMPM.
Basin Dakota Pool, San Juan County.

Well is 990 feet from North line and 990 feet from West line
of Section 2. If State Land the Oil and Gas Lease No. is

Drilling Commenced 8/1/61, 19... Drilling was Completed 8/13/61, 19...

Name of Drilling Contractor Summit Drilling Company

Address Box # 190, Farmington, New Mexico

Elevation above sea level at Top of Tubing Head G.L. - 5847
non-confidential, 19... The information given is to be kept confidential until

OIL SANDS OR ZONES

No 1, from 6446 to 6456 No 4, from... to...
No 2, from 6521 to 6546 No 5, from... to...
No 3, from 6609 to 6644 No 6, from... to...

IMPORTANT WATER SANDS

Include data on rate of water inflow and elevation to which water rose in hole.

No 1, from... to... feet.
No 2, from... to... feet.
No 3, from... to... feet.
No 4, from... to... feet.

CASING RECORD

SIZE	WEIGHT PER FOOT	NEW OR USED	AMOUNT	KIND OF SHOE	CUT AND PULLED FROM	PERFORATIONS	PURPOSE
8 5/8	24	NEW	294				
4 1/2	11.6	NEW	1162				
4 1/2	9.5	NEW	5566				
2 3/8	4.7	NEW	6426				

MUDDING AND CEMENTING RECORD

SIZE OF HOLE	SIZE OF CASING	WHERE SET	NO. SACKS OF CEMENT	METHOD USED	MUD GRAVITY	AMOUNT OF MUD USED
12 1/2	8 5/8	307	275	displacement		
7 7/8	4 1/2	6739	700	two plug		
	2 3/8	6436				

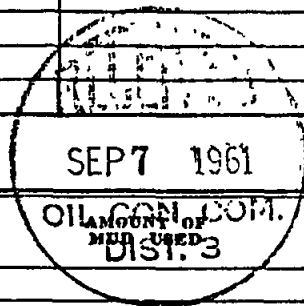

RECORD OF PRODUCTION AND STIMULATION

(Record the Process used, No. of Qts. or Gals. used, interval treated or shot.)

Sand-water fraced with 60,000# 20/40 sand, 30,000# 10/20 sand, 2038 Bbls. water
flushed with 160 Bbls. water,

Result of Production Stimulation Maximum - 3400, Avg. 2800, I.R. - 33.3 bpm, dropped 108 rubber ball
sealers, 5 min. shut-in pr. - 1200

Depth Cleaned Out 6705

NEW MEXICO OIL CONSERVATION COMMISSION
Well Location and Acreage Dedication Plat

FORM C 128
REVISED 5/1/67

Operator Aztec Oil and Gas Company Lease McGrath Date November 16, 1961
Unit Letter J Section 2 Township 29N Range 12W NMPM
d 1650 Feet From South Line, 1650 Feet From East Line
ity San Juan G. L. Elevation 5892 Dedicated Acreage 320 8/2 Acres
ne of Producing Formation Dakota Pool Basin

Is the Operator the only owner* in the dedicated acreage outlined on the plat below? Yes _____ No X

2. If the answer to question One is "No," have the interests of all the owners been consolidated by communitization or otherwise? Yes X No _____ If answer is "Yes," Type of Consolidation Communitization

3. If the answer to question Two is "No," list all the owners and their respective interests below:

OWNER

LAND DESCRIPTION

SECTION B.

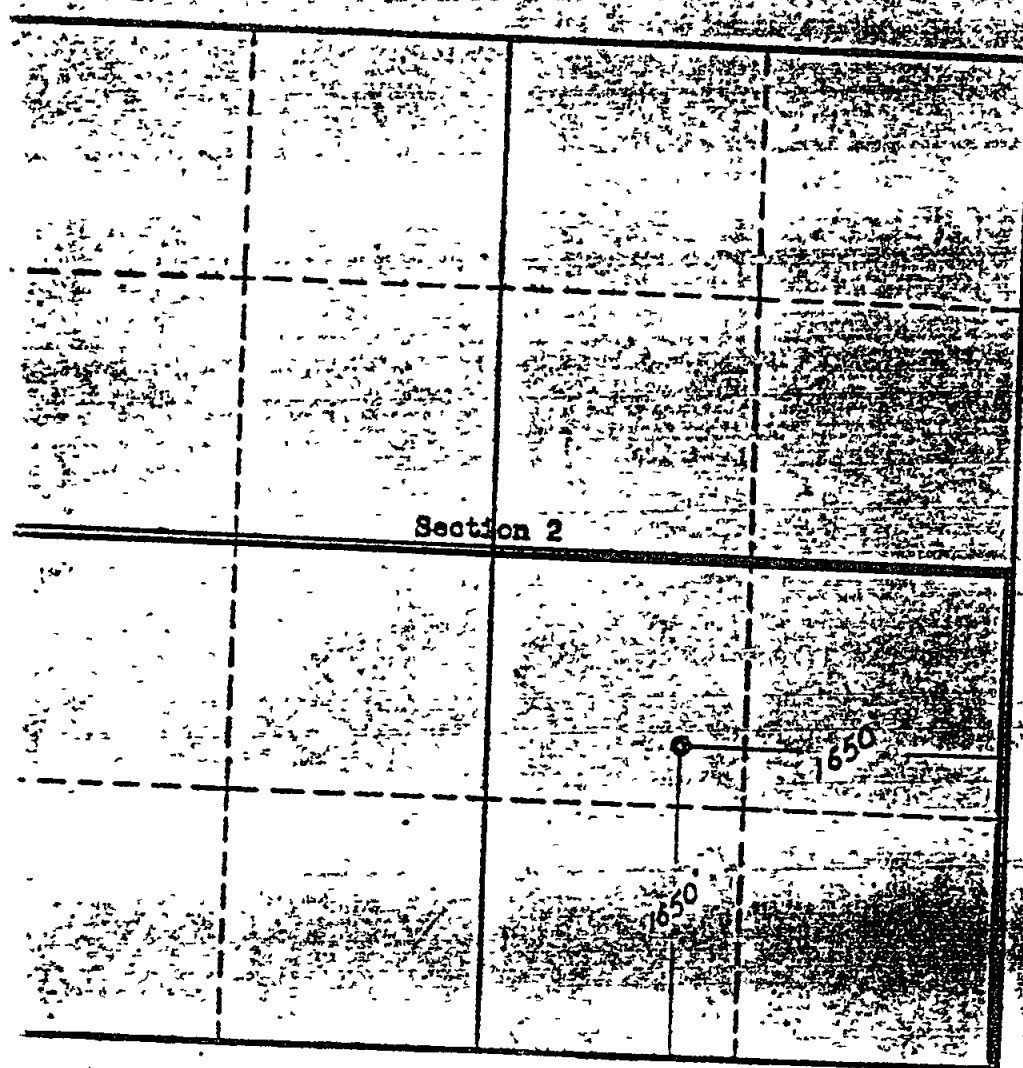

This is to certify that the information in Section A above is true and complete to the best of my knowledge and belief.

Aztec Oil and Gas Company

OPERATOR

ORIGINAL SIGNED BY JOE C. SALMON

REPRESENTATIVE

Joe C. Salmon, Dist. Supt.

P. O. Drawer 570, Farmington

ADDRESS

This is to certify that the well location shown on the plat in Section B was plotted from the actual survey of the land on my supervision and is true and correct to the best of my knowledge and belief.



Date Surveyed Nov. 15, 1961

Four Stores Engineering Co.
FARMINGTON, NEW MEXICO

E. L. Poter

REGISTERED ENGINEER OR
LAND SURVEYOR

Certificate No 3084

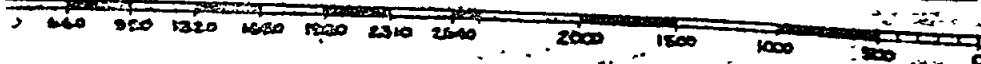

Depth Cleaned Out

NUMBER OF COPIES RECEIVED	
DISTRIBUTION	
AREA	
FILE	
USGS	
LAND OFFICE	
TRANSPORTER	OIL GAS
PRODUCTION OFFICE	
OPERATOR	

NEW MEXICO OIL CONSERVATION COMMISSION

Santa Fe New Mexico

Form C-104
Revised 7/1/57

REQUEST FOR (OIL) - (GAS) ALLOWABLE

WITHIN 1/2 mile

New Well
Recompletion

This form shall be submitted by the operator before an initial allowable will be assigned to any completed Oil or Gas well. Form C-104 is to be submitted in QUADRUPPLICATE to the same District Office to which Form C-101 was sent. The allowable will be assigned effective 7:00 A.M. on date of completion or recompletion, provided this form is filed during calendar month of completion or recompletion. The completion date shall be that date in the case of an oil well when new oil is delivered into the stock tanks. Gas must be reported on 15.025 psia at 60° Fahrenheit.

Farrington, New Mexico
(Place)

4-29-64
(Date)

WE ARE HEREBY REQUESTING AN ALLOWABLE FOR A WELL KNOWN AS.

Astec Oil & Gas Company

McGRATH "A"

Well No. 1, in SE 1/4, SE 1/4,

(Company or Operator)

(Lease)

I, Sec. 3, T. 29N, R. 12W, NMPM, Basia Dakota Pool

Unit Letter

San Juan

County Date Spudded 3-14-64 Date Drilling Completed 3-29-64

Elevation 5865 Ground Total Depth 6689' PSTD 6552'

Please indicate location

Top Oil/Gas Pay 6432 Name of Prod. Form. Dakota

PRODUCING INTERVAL -

Perforations 6432-6440; 6452-6456; 6504-6524

Open Hole Depth Casing Shoe Depth Tubing

OIL WELL TEST -

Natural Prod. Test: bbls. oil, bbls. water in hrs, min. Size Choke

Test After Acid or Fracture Treatment (after recovery of volume of oil equal to volume of load oil used). bbls. oil, bbls. water in hrs, min. Size Choke

GAS WELL TEST -

Natural Prod. Test. 1793 MCF/Day; Hours flowed Choke Size 3/4"

Method of Testing (pitot, back pressure, etc.):

Test After Acid or Fracture Treatment: MCF/Day; Hours flowed

Choke Size Method of Testing.

Acid or Fracture Treatment (Give amounts of materials used, such as acid, water, oil, and sand) Fract 8/62, 070 gals. treated with: 60,000# 20-40 mesh; 10,000# 10-20 mesh

Casing Press. Tubing Press. Date first new oil run to tanks

Oil Transporter

Gas Transporter

D	C	B	A
E	F	G	H
L	K	J	I
M	N	O	P

(FOOTAGE)

Tubing, Casing and Cementing Record

Size Feet Size

8-5/8"	307'	250
4-1/2"	6688'	500
2-3/8"	6429	

Remarks:

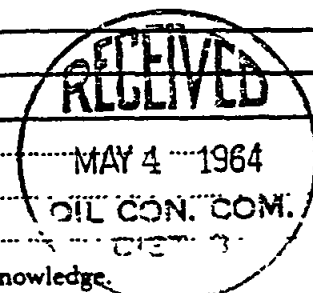

I hereby certify that the information given above is true and complete to the best of my knowledge.

Approved: April 29 MAY 4 1964, 1964

Astec Oil & Gas Company

(Company or Operator)

OIL CONSERVATION COMMISSION

Original Signed By

A. R. KENDRICK

PETROLEUM ENGINEER DIST NO 3

ORIGINAL SIGNED BY JOE C. SALMON Joe C. Salmon
(Signature)

Title: District Superintendent
Send Communications regarding well to.

Name: Astec Oil & Gas Company

Address: Drawer #570, Farrington, New Mexico

Santa Fe, New Mexico

NUMBER OF COPIES RECEIVED			
DISTRIBUTION			
SANITARY			
PILF			
USGS			
LAND OFFICE			
TRANSPORTED	OIL		
	GAS		
REGISTRATION OFFICE			
OPERATOR			

WELL RECORD

A 10x10 grid with an 'X' in the 7th column and 4th row from the top-left corner.

Mail to District Office, Oil Conservation Commission, to which Form C-101 was sent not later than twenty days after completion of well. Follow instructions in Rules and Regulations of the Commission. Submit in **QUINTUPLICATE** If State Land submit 6 Copies

Aztec Oil & Gas Company

MOGRAPH "A"

AREA 640 ACRES
LOCATE WELL CORRECTLY

(Company or Operator)

(Last)

Well No. 1, in NE $\frac{1}{4}$ of SE $\frac{1}{4}$, of Sec 3, T 29N, R 12W, NMPM.

Basin Dakota

Pool _____ San Juan

Country.

Well is 1720 feet from South line and 990 feet from East line

of Section 3 If State Land the Oil and Gas Lease No. is Patented

Drilling Commenced 3-14 19 64 Drilling was Completed 3-29 19 64

Name of Drilling Contractor Aragahos

Address

4 Elevation above sea level at Top of Tubing Head..... The information given is to be kept confidential until
..... 19.....

OIL SANDS OR ZONES

No. 1, from 6432 to 6440 No. 4, from _____ to _____

No. 2, from 6452 to 6456 No. 5, from _____ to _____

No. 3, from 6504 to 6524 No. 6, from _____ to _____

IMPORTANT WATER SANDS

Include data on rate of water inflow and elevation to which water rose in hole.

No 1, from to feet.

No. 2, from _____ to _____ feet.

No. 3, from _____ to _____ feet.

No. 4, from to feet.

CASING RECORD

SIZE	WEIGHT PER FOOT	NEW OR USED	AMOUNT	KIND OF SHOE	CUT AND PULLED FROM	PERFORATIONS	PURPOSE
8 5/8"	247	New	9 jts.				
4 1/2"	9.5 & 11.6	New	213 jts.				

MUDDING AND CEMENTING RECORD

SIZE OF HOLE	SIZE OF CASING	WHERE SET	NO. BAGS OF CEMENT	METHOD USED	MUD GRAVITY	AMOUNT OF MUD USED
7 7/8	4 1/2"	6628	500 bags			

RECEIVED

APR 15 1964

RECORD OF PRODUCTION AND STIMULATION

(Record the Process used, No. of Qts. or Gals. used, interval treated or shot.)

~~Fract well with 62,070 gals treated w/; 60,000 / 20-40 sd; 10,000 / 10-20 sand~~

Result of Production Stimulation..... No BD pressure; Max. press. 34004; Minimum pressure 28004;

Average treating pressure 3100#; AIR 41.5 HPM; TEMP 1200#; SI 5 min. 800#

Flushed w/ 1500 gals wtr treated w/ 1% cao2 & 20% Depth Cleaned Out 6552+
1000 gals WACB

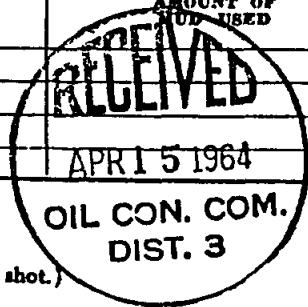

NEW MEXICO OIL CONSERVATION COMMISSION
WELL LOCATION AND ACREAGE DEDICATION PLAT
SEE INSTRUCTIONS FOR COMPLETING THIS FORM ON THE REVERSE SIDE

FORM C- 28
Revised 5/1 57

SECTION A				
Operator TENNECO OIL COMPANY		Lease CORNELL NE DAKOTA GAS UNIT "C"		Well No 1
Unit Letter D	Section 11	Township 29 North	Range 12 West	County San Juan
Actual Footage Location of Well 990 feet from the North line and 990 feet from the West line				
Ground Level Elev. 5716' ungraded	Producing Formation Dakota		Pool Basin Dakota	Dedicated Acreage 320 Acres

1. Is the Operator the only owner in the dedicated acreage outlined on the plat below? YES ☒ NO ____ . ("Owner" means the person who has the right to drill into and to produce from any pool and to appropriate the production either for himself or for himself and another. (65-3-29 (e) NMSA 1935 Comp.)
2. If the answer to question one is "no," have the interests of all the owners been consolidated by community agreement or otherwise? YES ____ NO ____ . If answer is "yes," Type of Consolidation ____
3. If the answer to question two is "no," list all the owners and their respective interests below:

Owner	Land Description

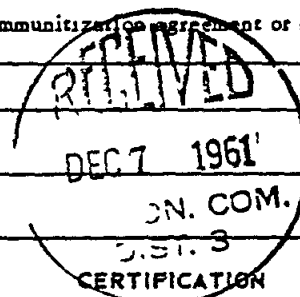

SECTION B

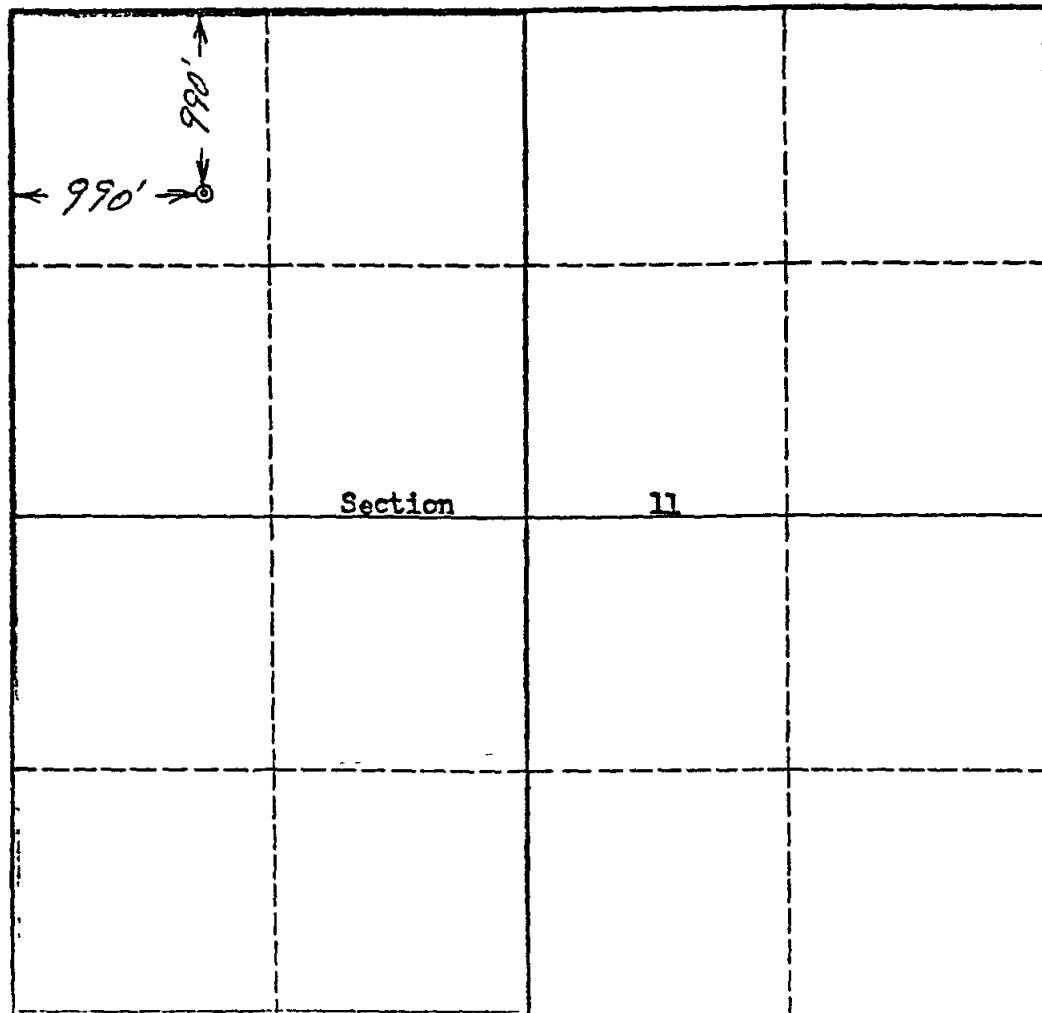

I hereby certify that the information in SECTION A above is true and complete to the best of my knowledge and belief.

Name J. J. Lacey
Position Dist. Petroleum Engineer
Company Tenneco Corp., acting and thru its managing agent, Tenneco Oil Company
Date December 6, 1961

I hereby certify that the well location shown on the plat in SECTION B was plotted from field notes of actual surveys made by me or under my supervision, and that the same is true and correct to the best of my knowledge and belief.

Date Surveyed 5 December 1961
Registered Professional Engineer and/or Land Surveyor
Robert H. Ernst
San Juan Engineer License No. 1240

Certificate No.
E & LS 2463

[illegible]

JAN 29 1962

U. S. LAND OFFICE Santa Fe
SERIAL NUMBER SF 065557-A
LEASE OR PERMIT TO PROSPECT _____

UNITED STATES
DEPARTMENT OF THE INTERIOR
GEOLOGICAL SURVEY

LOG OF OIL OR GAS WELL

LOCATE WELL CORRECTLY

Tenneco Corp., acting by & thru its managing
Company agent, Tenneco Oil Company Address P. O. Box 1714, Durango, Colorado
Lessor or Tract Cornell Dakota Gas Unit "C" Field Basin Dakota State New Mexico
Well No. 1 Sec 11 T. 29N R. 12W Meridian N.M.P.M. County San Juan
Location 990 ft. S of N Line and 990 ft. E of W Line of Section 11 Elevation 5716 GL
(Check box printing in area)

The information given herewith is a complete and correct record of the well and all work done thereon so far as can be determined from all available records.

Signed L. B. Plumb L. B. Plumb

Date January 23, 1962

Title Dist. **Production** **Supt.** _____

The summary on this page is for the condition of the well at above date.

Commenced drilling December 6, 1961 Finished drilling December 27, 1961

OIL OR GAS SANDS OR ZONES

OIL OR GAS SANDS OR ZONES

(Denote gas by G)

No. 1, from 6298 to 6306 G No. 4, from 6477 to 6483 G

No. 2, from 6380 to 6404 G No. 5, from 6390 to 6400

No. 3, from 6462 to 6466 G No. 6, from 6466 to 6477

IMPORTANT WATER SANDS

IMPORTANT WATER SANDS

No. 1, from _____ to _____ No. 3, from _____ to _____

No. 2, from _____ to _____ No. 4, from _____ to _____

CASING RECORD

Size casing	Weight per foot	Threads per inch	Make	Amount	Kind of shoe	Cut and pulled from	Perforated		Purpose
							From—	To—	
8-5/8	24	8	CRAT	245	Reaper Pattern	60100	60100	60100	Surface
4-1/2	14	8	CRAT	145	Reaper Pattern	60100	60100	60100	Production
4-1/2	9.5	8	CRAT	9.5	Reaper Pattern	60100	60100	60100	Production
MISLOX CL ON OS CYS MET									

MUDDING AND CEMENTING RECORD

Size casing	Where set	Number sacks of cement	Method used	Mud gravity	Amount of mud used
8 5/8	250'	150	Two Plug		
4 1/2	660'	300	Two Plug		

PLUGS AND ADAPTERS

Heaving plug—Material Length Depth set

Identem - Material _____ Size _____

FOLD	MARK
------	------

NEW MEXICO OIL CONSERVATION COMMISSION

Well Location and Acreage Dedication Plat

Date _____

AZTEC OIL & GAS COMPANY

Lease Mc GRATH

to C-1 Unit Letter P Section 34 Township 30N Range 12W NIMPM

red 870 Feet From South Line, 1190 Feet From East Line

County San Juan G. L. Elevation 5774 Dedicated Acreage 320 Acres

Name of Producing Formation Dakota Pool Basin Dakota

Is the Operator the only owner* in the dedicated acreage outlined on the plat below? Yes ☐ No ☒ X

If the answer to question One is "No," have the interests of all the owners been consolidated by communization agreement or otherwise? Yes ☒ X No ☐ If answer is "Yes," Type of Consolidation communization

If the answer to question Two is "No," list all the owners and their respective interests below.

OWNER

LAND DESCRIPTION

SECTION B.

This is to certify that the information in Section A above is true and complete to the best of my knowledge and belief

AZTEC OIL & GAS COMPANY

(OPERATOR)

Joe C. Salmon
Joe C. Salmon,
Dist. Supt.
Drawer # 570, Farmington, N.M.
(ADDRESS)

STATE OF NEW MEXICO
This is to certify that the well location shown on the plat in Section B was plotted from field notes of actual surveys made by me or under my supervision and that the same is true and correct to the best of my knowledge and belief

Date Surveyed Jan 18, 1962

FARMINGTON, NEW MEXICO

Conrad J. Eckhardt
REGISTERED ENGINEER OR
LAND SURVEYOR

Certificate No 3602

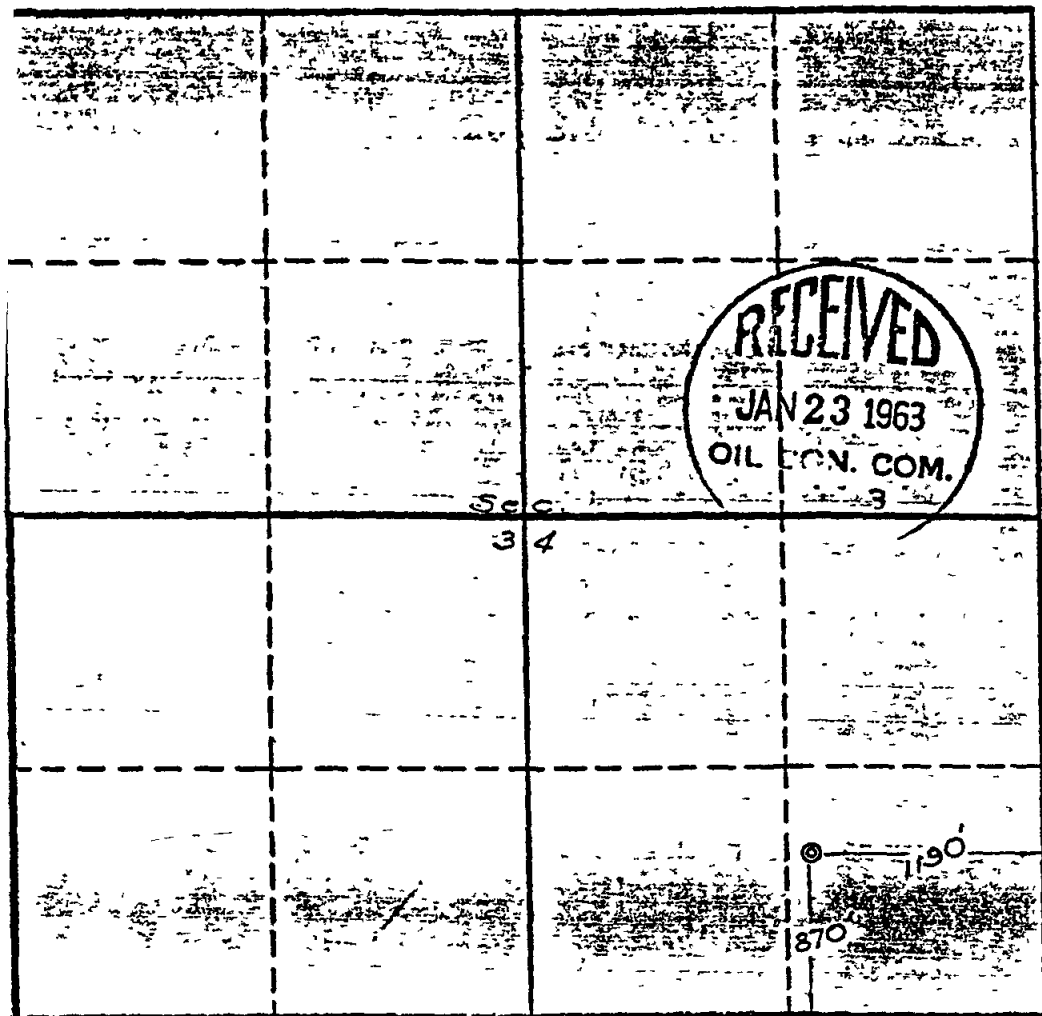

U.S. LAND OFFICE SANTA FE
SERIAL NUMBER 277922
LEASE OR PERMIT TO PROSPECT _____

UNITED STATES
DEPARTMENT OF THE INTERIOR
GEOLOGICAL SURVEY

LOG OF OIL OR GAS WELL

LOCATE WELL CORRECTLY

Company AZTEC OIL AND GAS COMPANY Address P. O. DRAWER 570-FARMINGTON, N. MEX.
Lessor or Tract McGRATH Field BASIN DAKOTA State NEW MEXICO
Well No. C-1 Sec. 34 T. 30N R. 12W Meridian N.M.P.M. County SAN JUAN
Location 870 ft. [N] of 8 Line and 1190 ft. [E] of 8 Line of SECTION 34 Elevation 5771 s.g.l.
(Describe well relative to an iron)

The information given herewith is a complete and correct record of the well and all work done thereon so far as can be determined from all available records.

Signed _____
JOE C. SALMON
 Title DISTRICT SUPERINTENDENT

Date ~~MARCH 7, 1963~~-----

The summary on this page is for the condition of the well at above date

Commenced drilling FEBRUARY 7, 1963 Finished drilling FEBRUARY 18, 1963

OIL OR GAS SANDS OR ZONES

(Denote gas by G)

No. 1, from 6387 to 6400 0 No. 4, from _____ to _____
 No. 2, from 6462 to 6484 0 No. 5, from _____ to _____
 No. 3, from 6542 to 6576 0 No. 6, from _____ to _____

IMPORTANT WATER SANDS

No. 1, from _____ to _____ No. 3, from _____ to _____
No. 2, from _____ to _____ No. 4, from _____ to _____

CASING RECORD

	Size casing	Weight per foot	Threads per inch	Make	Amount	Kind of shoe	Cut and pulled from	Perforated		Purpose
								From—	To—	
8	5/8	24	8 rd.	J-35	111					
4	1 1/2	3.5	8 rd.	J-35	111					
2	3/8	4.7	8 rd.	J-35	6399					
4	1 1/2	11.6	8 rd.	J-35	1163					

MUDDING AND CEMENTING RECORD

	Size casing	Where set	Number sacks of cement	Method used	Mud gravity	Amount of mud used
MARK 8	5/8	323	225	Displacement		
4	1/2	0637	925	Two Plug		
2	3/8	6-08				

PLUGS AND ADAPTERS

Heaving plug—Material Length Depth set

Adaptors—Material _____ Size _____

4
1983)
9-330)

UNITED STATES
DEPARTMENT OF THE INTERIOR
BUREAU OF LAND MANAGEMENT

SUBMIT IN DUPLICATE*

(See other in
instructions on
reverse side)

Form approved
Budget Bureau No 1004-0137
Expires August 31, 1985

WELL COMPLETION OR RECOMPLETION REPORT AND LOG *

1. TYPE OF WELL ☐ WELL ☒ CAN ☒ DRY ☐
2. TYPE OF COMPLETION
NEW ☒ WORK ☐ OVER ☐ REEL ☐ TIE ☐ BACK ☐ DIFF ☐ TIE ☐ Other ☐
3. NAME OF OPERATOR

Amoco Production Company

4. ADDRESS OF OPERATOR

501 Airport Drive, Farmington, NM 87401

5. LOCATION OF WELL (Report location clearly and in accordance with any special instructions)

At surface

1770' FNL x 1480' FEL

At top prod interval reported below Same

At total depth Same

FEB 20 1985

CIL CON. DIV.

RECEIVED

FEB 11 1985

BUREAU OF LAND MANAGEMENT

14 PERMIT NO. DATE IN EFFECT AREA

6. LAND DESIGNATION AND SERIAL NO

SF-07792 2

7. IF INDIAN ALLIANCE OR TRIBE NAME

8. UNIT AGREEMENT NAME

9. TOWN OR RANGE NAME

Duff Gas Com

1E

10. FIELD AND POOL, OR WILDCAT

Basin Dakota

11. SEC. T. R., M. OR BLOCK AND SURVEY OR ARPA

SW/NE Sec. 34, T30N, R12'

12. COUNTY OR PARISH

San Juan

13. STATE

NM

15. DATE SPLDDED 11/20/84 16. DATE TD REACHED 12/2/84 17. DATE COMPL (Ready to prod) 1/7/85 18. ELEVATION (OF RKB, RT, GR, ETC.) 5785' KB 19. ELEV. CASINGHEAD 5772' GR

20. TOTAL DEPTH, MD & TVD 6608' 21. PLUG, BACK T.D., MD & TVD 6604' 22. IF MULTIPLE COMPL, HOW MANY? single 23. INTERESTED DRILLED BY O-TD

24. PRODUCING INTERVAL(S), OF THIS COMPLETION—TOP, BOTTOM, NAME (MD AND TVD) 6396'-6576' Dakota 25. WAS DIRECTIONAL SURVEY MADE Yes

26. TYPE ELECTRIC AND OTHER LOGS R/T DIL-SP-GR-FDC-CNL-GR 27. WAS WELL CORED No

28. CASING RECORD (Report all strings set in well)

CASING SIZE	WEIGHT, LB/FT.	DEPTH SET (MD)	HOLE SIZE	CEMENTING RECORD	AMOUNT PULLED
8-5/8"	24#, K-55	316'	12-1/4"	295 c.f. Class B	
4-1/2"	10.5#, K-55	6608'	7-7/8"	Stage 1: 1,032 c.f. Class B & tailed in with 118 c.f. Class B Neat (cont. on back)	50-50 poz

29. LINER RECORD				30. TUBING RECORD		
SIZE	TOP (MD)	BOTTOM (MD)	BACKS CEMENT	SCREEN (MD)	SIZE	DEPTH SET (MD)
					2-3/8"	6575'

31. PERFORATION RECORD (Interval, size and number)		32. ACID, SHOT, FRACTURE, CEMENT SQUEEZE, ETC.	
6576'-6558', 4 jsfp, .50"; 6410'-6396', 6424'-6420', 6508'-6476', 6520'-6516', 2 jsfp, .50", total of 180 holes.		DEPTH INTERVAL (MD)	AMOUNT AND KIND OF MATERIAL USED
		(6558'-6576')	20,000 gal. 30# gel & 25,000# 20-40 sand
		(6396'-6520')	70,000 gal. 70 quality foam & 90,000# 20-40 sand.

33. PRODUCTION							
DATE FIRST PRODUCTION 1/30/85		PRODUCTION METHOD (Flowing, gas lift, pumping—size and type of pump) Flowing				WELL STATUS (Producing or shut in) Shut-in	
DATE OF TEST 1/31/85	HOURS TESTED 3	CHOKE SIZE .75"	PROD N FOR TEST PERIOD	OIL—BBL 168	GAS—MCF	WATER—BBL	GAS-OIL RATIO
FLOW TUBING PRESS 104 psig	CASING PRESSURE 397 psig	CALCULATED 24 HOUR RATE	OIL—BBL	GAS—MCF 1344	WATER—BBL	OIL GRAVITY-API (CORR.)	

34. DISPOSITION OF GAS (Sold, used for fuel, vented, etc) To be sold TEST WITNESSED BY J.J. Barnett

35. LIST OF ATTACHMENTS None ACCEPTED FOR RECORD

36. I hereby certify that the foregoing and attached information is complete and correct as determined from all available records
Original Signed E
SIGNED R. D. Shaw TITLE Administrative Supervisor DATE FEB 14 1985 2/4/85

COMPLETION DATA

Designate Type of Completion - (X)									Oil Well	Gas Well	New Well	Workover	Deepen	Plug Back	Same Recv.	DLL Rev.	
										X	X						
Date Spudded				Date Compl. Ready to Prod.				Total Depth				P.B.T.D.					
11/20/84				1/7/85				6608'				6604'					
Services (DF, RKB, RT, GR, etc.)				Name of Producing Formation				Top Oil/Gas Pay				Tubing Depth					
5772' GR				Dakota				6396'				6575'					
Perforations												Depth Casing Shoe					
6576'-6558', 6410'-6396', 6424'-6420', 6508'-6476', 6520'-6516'												6609'					

TUBING, CASING, AND CEMENTING RECORD

HOLE SIZE	CASING & TUBING SIZE	DEPTH SET	SACKS CEMENT
12-1/4"	8-5/8", 24#	316'	295 c.f.
7-7/8"	4-1/2", 10.5#	6609'	3031 c.f.
	2-3/8"	6575'	

TEST DATA AND REQUEST FOR ALLOWABLE (Test must be after recovery of total volume of load oil and must be equal to or exceed top allowable for this depth or be for full 24 hours)

Date First New Oil Run To Tanks	Date of Test	Producing Method (Flow, pump, gas lift, etc.)	
Length of Test	Tubing Pressure	Casing Pressure	Choke Size
Actual Prod. During Test	Oil-Bbls.	Water-Bbls.	Gas-MCF

AS WELL

Actual Prod. Test-MCF/D	Length of Test	Bbls. Condensate/MCF	Gravity of Condensate
1344 1/31/85	3 hrs.	168	
Testing Method (pilot, back pr.)	Tubing Pressure (Shut-In)	Casing Pressure (Shut-In)	Choke Size
Back pressure	1870 psig	2010 psig	.75"

All distances must be from the outer boundaries of the Section

MERRION OIL & GAS CORPORATION		Lease		CARNAHAN COM		Well No.	
35		30N		12W		San Juan	
1090		feet from the South		line and 1070		feet from the East	
Producing Formation		Pool		Dedicated Acreage		Acres	
Dakota		Basin Dakota		320		Acres	

1. Outline the acreage dedicated to the subject well by colored pencil or hatchure marks on the plat below.
2. If more than one lease is dedicated to the well, outline each and identify the ownership thereof (both as to working interest and royalty).
3. If more than one lease of different ownership is dedicated to the well, have the interests of all owners been consolidated by communitization, unitization, force-pooling, etc?

☒ Yes ☐ No If answer is "yes," type of consolidation Communitized

If answer is "no," list the owners and tract descriptions which have actually been consolidated. (Use reverse side of this form if necessary.)

No allowable will be assigned to the well until all interests have been consolidated (by communitization, unitization, forced-pooling, or otherwise) or until a non-standard unit, eliminating such interests, has been approved by the Commission.

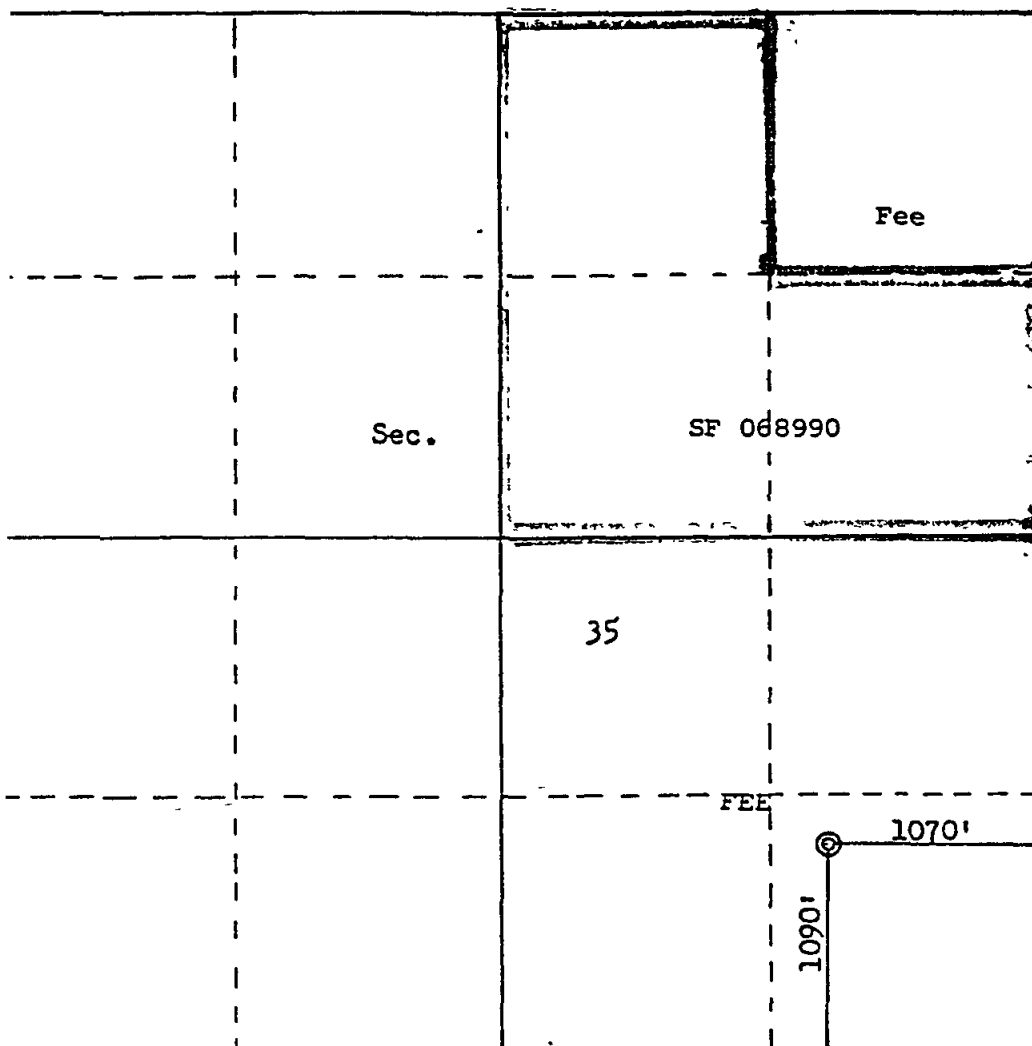

Scale: 1"=1000'

CERTIFICATION

I hereby certify that the information contained herein is true and complete to the best of my knowledge and belief.

Steve S. Dunn

Name

Steve S. Dunn

Position

Operations Manager

Company

Merrion Oil & Gas Corporation

Date

11/17/83

I hereby certify that the well location shown on this plat was plotted from field notes of actual surveys made by me or under my supervision, and that the same is true and correct to the best of my knowledge and belief.

Date Surveyed

September 1, 1983

Registered Professional Engineer
and Land Surveyor*Fred B. Kerr Jr.*
Fred B. Kerr Jr.

Certificate No. 4, 4500, 11

3950

OF NEW MEXICO
MINERALS DEPARTMENTOIL CONSERVATION DIVISION
P O BOX 2088
SANTA FE, NEW MEXICO 87501

WELL COMPLETION OR RECOMPLETION REPORT AND LOG

COPIES RECEIVED	
DISTRIBUTION	
NTA FE	
LE	
U.S.G.S.	
LAND OFFICE	
OPERATOR	

TYPE OF WELL

OIL WELL ☐GAS WELL ☒DRY ☐OTHER ☐

TYPE OF COMPLETION

NEW WELL ☒WORK OVER ☐DEEPEN ☐PLUG BACK ☐DIFF. RESER. ☐OTHER ☐

Name of Operator

Merrion Oil & Gas Corporation

Address of Operator

P. O. Box 1017, Farmington, New Mexico 87499

Location of Well

LETTER P LOCATED 1090 FEET FROM THE South LINE AND 1070 FEET FROMEast 35 TWP 30N RGE. 12W

LINE 3P SEC.

TWP

RGE.

NADP

Date Spudded	16. Date T.D. Reached	17. Date Compl. (Ready to Prod.)	18. Elevations (DF, RKB, RT, GR, etc.)	19. Elev. Casinghead
6/15/84	6/24/84	7/23/84	5918' KB	5905' GL

Total Depth	21. Plug Back T.D.	22. If Multiple Compl., How Many	23. Intervals Drilled By	Rotary Tools	Cable Tools
6780' KB	6735' KB			0 - TD	

Producing Interval(s), of this completion - Top, Bottom, Name

6714 - 6529' KB, Dakota

25. Was Directional Sur Made

No

Type Electric and Other Logs Run

IES Induction, compensated Density Logs

27. Was Well Cored

No

CASING RECORD (Report all strings set in well)

CASING SIZE	WEIGHT LB./FT.	DEPTH SET	HOLE SIZE	CEMENTING RECORD	AMOUNT PULL
8-5/8"	24 #/ft, J-55	230' KB	12-1/4	170 sx (350 cu. ft.) Class B	
4-1/2"	10.5 #/ft, J-55	6777' KB	7-7/8"	400 sx (488 cu. ft.) Class H	325x 396.
				600 sx (1236 cu. ft.) Class B	
				100 sx (122 cu. ft.) Class B	Total 22'

LINER RECORD

30. TUBING RECORD

SIZE	TOP	BOTTOM	SACKS CEMENT	SCREEN	SIZE	DEPTH SET	PACKER SET
					2-3/8"	6530' KB	

Perforation Record (Interval, size and number)

6529, 6538, 6541, 6617, 6620, 6625, 6629, 6632, 6700, 6705, 6710, 6714, 12 holes, 0.32" diameter.

32. ACID, SHOT, FRACTURE, CEMENT SQUEEZE, ETC.

DEPTH INTERVAL	AMOUNT AND KIND MATERIAL USED
6529 - 6714' KB	75 Quality Foam
	434 Bbls H2O
	1,700,198 SCF N ₂
	55,000 # 20/40 sand

PRODUCTION

First Production -- 7/23/84		Production Method (Flowing, gas lift, pumping -- Size and type pump) Flowing				Well Status (Prod. or Shut-in) Shut in	
of Test 8/3/84	Hours Tested 3	Choke Size 20/64	Prod'n. For Test Period →	Oil -- Bbl. 2 Bbls	Gas -- MCF 603 MCF/D	Water -- Bbl. trace	Gas -- Oil Ratio 37,688
Tubing Press. 850 PSI	Casing Pressure 950 PSI	Calculated 24- Hour Rate →	Oil -- Bbl. 16	Gas -- MCF 603 MCF/D	Water -- Bbl. trace	Oil Gravity -- API (Corr) 48°	

Disposition of Gas (Sold, used for fuel, vented, etc.)

Vented

Test Witnessed By

Tim Merilatt

List of Attachments

I hereby certify that the information shown on both sides of this form is true and complete to the best of my knowledge and belief.

511821

Carnation Unit #1
 Basin - Dakota Pool
 Unit P, Sect 35, 30N, 12W
 San Juan Co, New Mexico

G.L. 5911'

P & A

1. Plug over perfs
 \$ 100' to 6400'
2. Cut and pull free
 4 1/2" pipe
3. Plugs across —
 a. 4 1/2" stub
 b. Mesa Verde
 c. Picture Cliffs
 d. Ojo Alamo
 e. 8 5/8" casing seat
 f. surface
4. Monument

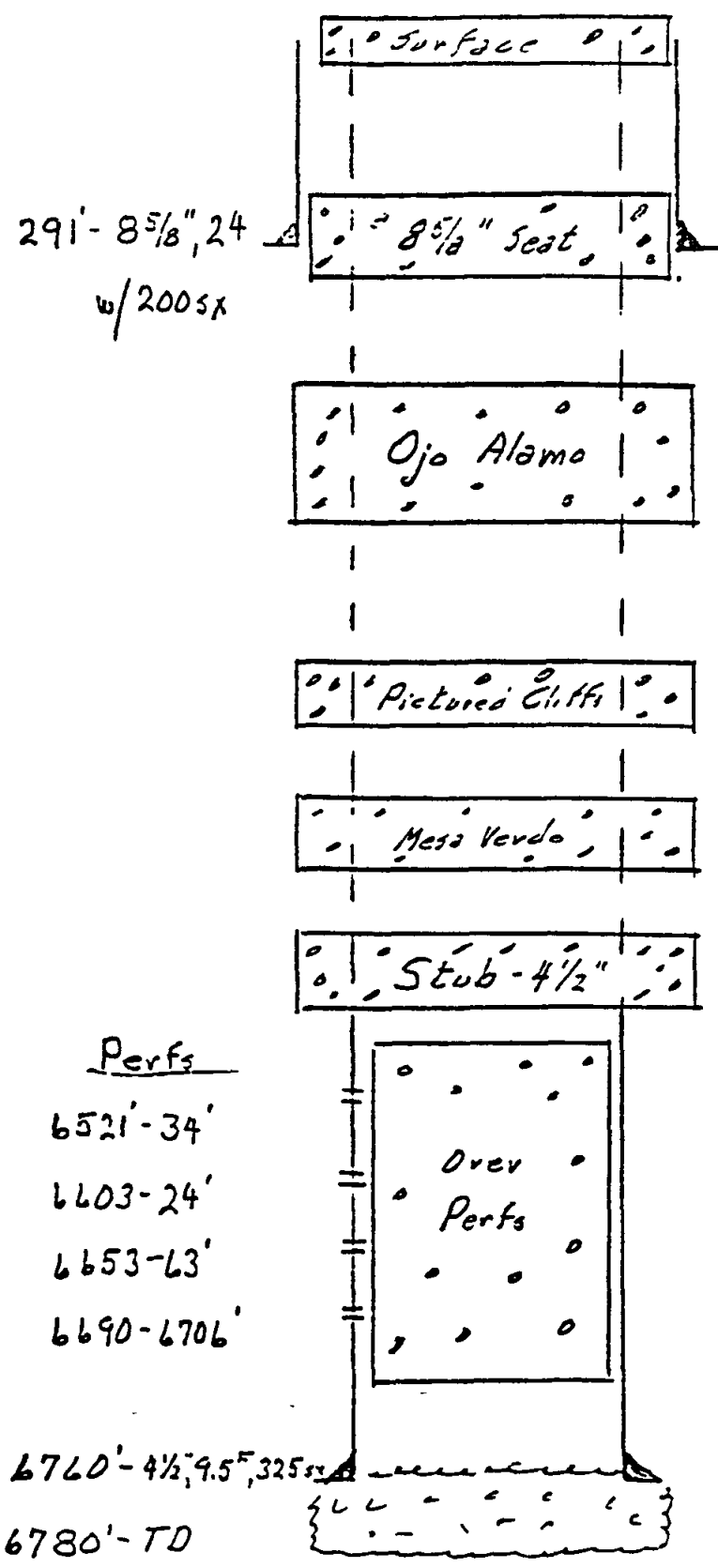

JCG/4-2-71

**NEW MEXICO OIL CONSERVATION COMMISSION
WELL LOCATION AND ACERAGE DEDICATION PLAT**

All distances must be from the outer boundaries of the Section

Operator Artec Oil & Gas Company		Lease J. Hudson		Well No 3	
Unit Letter E	Section 35	Township 30 North	Range 12 West	County San Juan	
Actual Footage Location of Well					
1750	feet from the North	line and	990	feet from the West	line
Ground Level Ele. 5857		Producing Formation Dakota - Mesaverde		Pool Basin Dakota Flora Vista Mesaverde (Ext.)	Dedicated Acreage 320
					Acres

- 1 Outline the acreage dedicated to the subject well by colored pencil or hatchure marks on the plat below
- 2 If more than one lease is dedicated to the well, outline each and identify the ownership thereof (both as to working interest and royalty),
- 3 If more than one lease of different ownership is dedicated to the well, have the interests of all owners been consolidated by communitization, unitization force-pooling etc?

☒ Yes ☐ No If answer is "yes" type of consolidation **Communitization**

If answer is "no," list the owners and tract descriptions which have actually consolidated (Use reverse side of this form if necessary)

No allowable will be assigned to the well until all interests have been consolidated (by communitization, unitization forced-pooling, or otherwise) or until a non standard unit, eliminating such interests, has been approved by the Commission

CERTIFICATION

I hereby certify that the information contained herein is true and complete to the best of my knowledge and belief

ORIGINAL SIGNED BY JOE C. SALMON

Name _____

Position **Joe C. Salmon**

Company **District Superintendent**

Date **Artec Oil and Gas**

May 27, 1966

I hereby certify that the well location shown on this plat was plotted from field notes of actual surveys made by me or under my supervision, and that the same is true and correct to the best of my knowledge and belief.

Date Surveyed _____

March 31, 1966
Registered Professional Engineer
and/or Land Surveyor

[Signature]
Certificate No **3602**

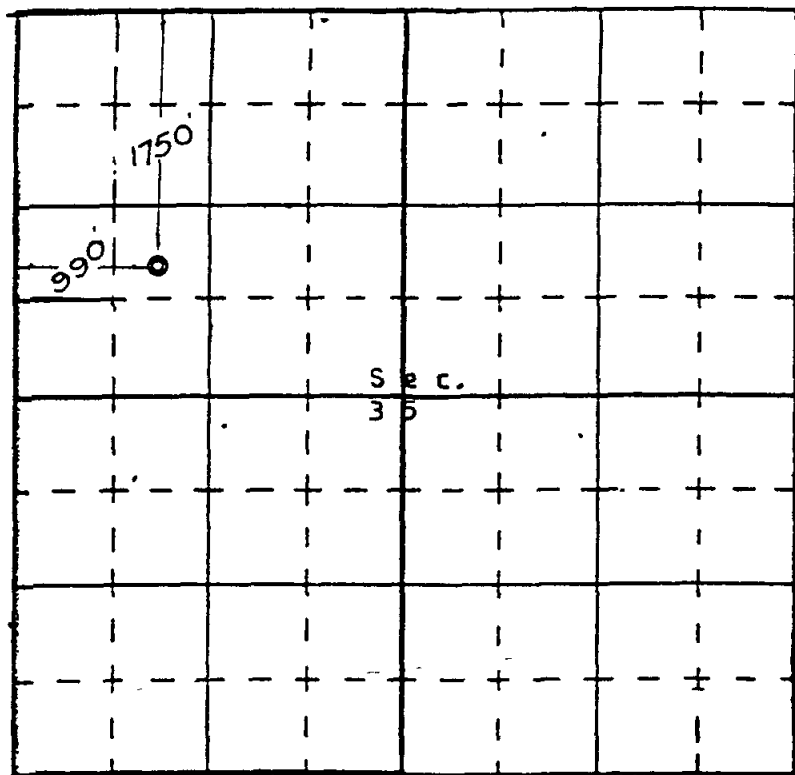

01702-2148-4207 BLM Wayne

Form 2-330
(Rev 5-63)

UNITED STATES
DEPARTMENT OF THE INTERIOR
GEOLOGICAL SURVEY

SUBMIT IN DUPLICATE

(See other instructions on reverse side)

Form approved
Budget Bureau No 42-R355 6

WELL COMPLETION OR RECOMPLETION REPORT AND LOG *

RECEIVED

1a TYPE OF WELL ☐ OIL WELL ☒ GAS WELL ☐ DRY ☐ Other ☐
b. TYPE OF COMPLETION.
NEW WELL ☒ WORK OVER ☐ DEEP-EN ☐ PLUG BACK ☐ DIFF RESVR ☐ Other ☐
AUG 24 1966

2. NAME OF OPERATOR
Aztec Oil and Gas
3 ADDRESS OF OPERATOR
Drawer 570 Farmington, New Mexico
U. S. GEOLOGICAL SURVEY

4 LOCATION OF WELL (Report location clearly and in accordance with any State requirements)*
At surface 1750 FNL & 990 FNL Sec 35, T₃₀N, R₁₂W
At top prod interval reported below
At total depth

14 PERMIT NO
DATE ISSUED

5 LEASE DESIGNATION AND SERIAL NO
SF 077922
6 IF INDIAN, ALLOTTEE OR TRIBE NAME
7 UNIT AGREEMENT NAME
8 FARM OR LEASE NAME
Hudson
9 WELL NO
3
10 FIELD AND POOL, OR WILDCAT
Basin Dakota
11 SEC. T. R. M. OR BLOCK AND SURVEY OR AREA
Sec 35, T₃₀N, R₁₂W
12 COUNTY OR PARISH
San Juan
13 STATE
New Mexico

15 DATE SPUDDED 7/22/66 16 DATE TD REACHED 8/4/66 17 DATE COMPL (Ready to prod) 8/15/66 18 ELEVATIONS (DF, REB, BT, GR, ETC)* 5857 GL 19 ELEV. CASINGHEAD 5858
20 TOTAL DEPTH, MD & TVD 6750 21 PLUG BACK TD, MD & TVD 6732 22 IF MULTIPLE COMPL, HOW MANY* 23 INTERVALS DRILLED BY
24 PRODUCING INTERVAL(S), OF THIS COMPLETION—TOP, BOTTOM, NAME (MD AND TVD)* 6460 • 6680 25 WAS DIRECTIONAL SURVEY MADE NO
26 TYPE ELECTRIC AND OTHER LOGS RUN Es • Ind and Density log 27 WAS WELL CORED NO

CASING RECORD (Report all strings set in well)					
CASING SIZE	WEIGHT, LB/FT	DEPTH SET (MD)	HOLE SIZE	CEMENTING RECORD	AMOUNT PULLED
8-5/8"	24#	306	12-1/4	250 ✓	
4-1/2	10.5#	6750	7-7/8	700 ✓	

LINER RECORD					TUBING RECORD		
SIZE	TOP (MD)	BOTTOM (MD)	SACKS CEMENT*	SCREEN (MD)	SIZE	DEPTH SET (MD)	PACKER SET (MD)
					1 1/2	6597	

1 PERFORATION RECORD (Interval, size and number)		32. ACID, SHOT, FRACTURE, CEMENT SQUEEZE, ETC.	
		DEPTH INTERVAL (MD)	AMOUNT AND KIND OF MATERIAL USED
5460-80, 6540-62, 6567-72, 6580-85, 6668-80 4 SPF		6460-6668-80	1936 bbl H2O
			40,000# 20/40
			20,000# 10/20
			125 balls

3* PRODUCTION
DATE FIRST PRODUCTION
PRODUCTION METHOD (Flowing, gas lift, pumping—size and type of pump)
flowing
WELL STATUS (Producing or shut-in)
shut-in
DATE OF TEST 8/22/66 HOURS TESTED 3 hr CHOKED SIZE 3/4" PROD'G FOR TEST PERIOD
OIL—BBL GAS—MCF WATER—BBL GAS-OIL RATIO
OW TUBING PRESS. 170 CASING PRESSURE 747 CALCULATED 24-HOUR RATE
OIL—BBL GAS—MCF 2485 WATER—BBL 123 1936
DISPOSITION OF GAS (Sold, used for fuel, vented, etc.)
vented
TEST WITNESSED
TESTED BY
DATE

LIST OF ATTACHMENTS
I hereby certify that the foregoing and attached information is complete and correct as determined from all available records
SIGNED [Signature] District Engineer DATE August 23, 1966

*(See Instructions and Spaces for Additional Data on Reverse Side)

NEW MEXICO OIL CONSERVATION COMMISSION

WELL LOCATION AND ACERAGE DEDICATION PLAT

All distances must be from the outer boundaries of the Section

Oil & Gas Company

Hudson

Acres 3

35

30 North

12 West

San Juan

1750

North

990

West

line

Producing Form of

Basin Dakota

Dedicated Average

5857

Dakota - Mesaverde

Flora Vista Mesaverde (Ext)

320

Acres

- Outline the acreage dedicated to the subject well by colored pencil or hatchure marks on the plat below
- If more than one lease is dedicated to the well, outline each and identify the ownership thereof (both as to working interest and royalty),
- If more than one lease of different ownership is dedicated to the well, have the interests of all owners been consolidated by communitization, unitization, force-pooling, etc?

☒ Yes ☐ No If answer is 'yes' type of consolidation Communitization

If answer is "no," list the owners and tract descriptions which have actually consolidated (Use reverse side of this form if necessary)

No allowable will be assigned to the well until all interests have been consolidated (by communitization, unitization, forced-pooling, or otherwise) or until a non standard unit, eliminating such interests, has been approved by the Commission

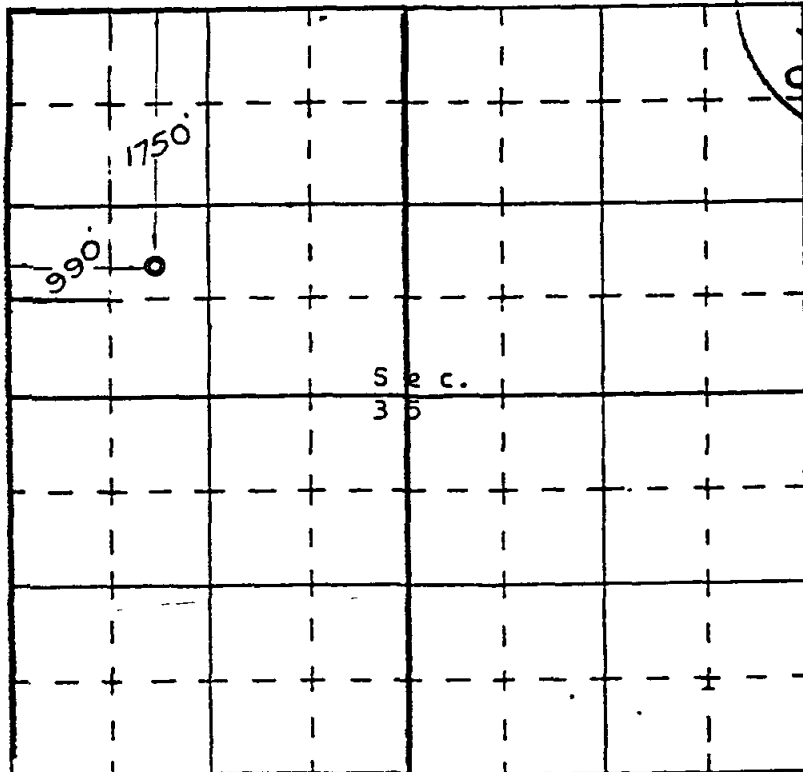

RECEIVED
JUN 2 1966
OIL CON. COM.
DIST. 3

CERTIFICATION

I hereby certify that the information contained herein is true and complete to the best of my knowledge and belief

ORIGINAL SIGNED BY JOE C. SALMON

Name

Joe C. Salmon

Position

District Superintendent

Company

Aztec Oil and Gas

Date

May 27, 1966

I hereby certify that the well location shown on this plat was plotted from field notes of actual surveys made by me or under my supervision, and that the same is true and correct to the best of my knowledge and belief

Date Surveyed

March 31, 1966

Registered Professional Engineer
and/or Land Surveyor

Certificate No 3602

NEW MEXICO OIL CONSERVATION COMMISSION
REQUEST FOR ALLOWABLE
AND
AUTHORIZATION TO TRANSPORT OIL AND NATURAL GAS

Form 1-1
Supersedes Old 1-1 and 1-2
Effective 1-1-66

Aztec Oil and Gas

Drawer 570

Farmington, New Mexico

(Check proper box)

☒

Change in Transporter of

Oil

☐

Dry Gas

☐

Casinghead Gas

☐

Condensate

☐

Other (Please explain)

If change of ownership give name
and address of previous owner

DESCRIPTION OF WELL AND LEASE

Ridson 3 Basin Dakota State of New Mexico Fed ST 077922

E 1750 feet from the North and 990 feet from the West

35 30N 12W San Juan

DESIGNATION OF TRANSPORTER OF OIL AND NATURAL GAS

Plateau Incorporated

Box 108

Farmington, New Mexico

Southern Union Gas Company

Box 815

Farmington, New Mexico

NO

This production is commingled with that from any other lease or pool give commingling order number

COMPLETION DATA

Designate Type of Completion - (X)

Oil Well

Gas Well

New Well

Workover

Refracture

Stimulate

Other

Recompletion

7/22/66 8/9/66

6750

6732

5857 GL

Dakota

6460-6680

6597

6460-80, 6540-62, 6567-72, 6580-85, 6668-80, 4 FET

6750

TUBING, CASING, AND CEMENTING RECORD

HOLE SIZE

CASING & TUBING SIZE

DEPTH SET

SACKS CEMENT

12 1/8"

8 5/8"

306

250 SX

7 7/8"

4 1/2"

6750

750 SX

1 1/2"

6597

TEST DATA AND REQUEST FOR ALLOWABLE

(Test must be after recovery of total volume of load oil and must be equal to or exceed top allowable for this depth or be for full 24 hours)

Flow Test	Date of Test	Producing Method (Flow, pump, gas lift, etc.)
Shut-in Test	Tubing Pressure	Casing Pressure
Flow During Test	Oil - Bbls	Water - Bbls
		Gas - MCF

SHUT-IN

Test - MCF/D	Length of Test	Bbls. Condensate/MMCF	Gravity of
2485	3 hr		
Shut-in Pressure (Shut-in)	Casing Pressure (Shut-in)	Choke Size	
book measure 170	747	3/4"	

CERTIFICATE OF COMPLIANCE

I hereby certify that the rules and regulations of the Oil Conservation Commission have been complied with and that the information given is true and complete to the best of my knowledge and belief

ORIGINAL SIGNED BY JOE C. SALMON

(Signature)

District Superintendent

(Title)

August 31, 1966

OIL CONSERVATION COMMISSION

SEP - 2 1966

APPROVED Original Signed by Emery C. Arnold

TITLE SUPERVISOR DIST. #3

This form is to be filed in compliance with RULE 1104

If this is a request for allowable for a newly drilled or deepened well this form must be accompanied by a tabulation of the deviation tests taken on the well in accordance with RULE 111

All sections of this form must be filled out completely for allowable on new and recompleted wells

Fill out only Sections I, II, III and VI for changes of owner, well name or number or transporter, or other such change of information

Separate Forms C-104 must be filed for each well

Submit to Appropriate
District Office
State Lease - 6 copies
Fee Lease - 5 copies
DISTRICT I
P.O. Box 1980, Hobbs, NM 88240

DISTRICT II
P.O. Box 1980, Artesia, NM 88210

DISTRICT III
1000 Rio Brazos Rd., Aztec, NM 87410

State of New Mexico
Energy, Minerals and Natural Resources Department

OIL CONSERVATION DIVISION
P.O. Box 2088
Santa Fe, New Mexico 87504-2088

Form C 105
Revised 1-1-89

WELL API NO
5. Indicate Type of Lease STATE <input type="checkbox"/> FEE <input checked="" type="checkbox"/>
6. State Oil & Gas Lease No

WELL COMPLETION OR RECOMPLETION REPORT AND LOG					
1a. Type of Well OIL WELL <input type="checkbox"/> GAS WELL <input type="checkbox"/> DRY <input type="checkbox"/> OTHER <u>DISPOSAL</u>				7. Lease Name or Unit Agreement Name SUNCO DISPOSAL	
b. Type of Completion. NEW WELL <input checked="" type="checkbox"/> WORK OVER <input type="checkbox"/> DEEPEN <input type="checkbox"/> PLUG BACK <input type="checkbox"/> DIFF RESVR <input type="checkbox"/> OTHER <input type="checkbox"/>				8. Well No. <u>#1</u>	
2. Name of Operator COLEMAN OIL & GAS COMPANY				9. Pool name or Wildcat FLORA VISTA MESA VERDE	
3. Address of Operator 708 SOUTH TUCKER, FARMINGTON, NM 87401					
4. Well Location Unit Letter <u>E</u> <u>1595</u> Feet From The <u>NORTH</u> Line and <u>1005</u> Feet From The <u>WEST</u> Line Section <u>2</u> Township <u>29N</u> Range <u>12W</u> NMPM <u>SAN JUAN</u> County					
10. Date Spudded 01-28-92	11. Date TD Reached	12. Date Compl. (Ready to Prod.) <u>2-24-92</u>	13. Elevations (DF & RKB, RT, GR, etc) 5859 GR.	14. Elev. Casinghead 5864	
15. Total Depth 4760	16. Plug Back T.D.	17. If Multiple Compl How Many Zones? <u>1</u>	18. Intervals Drilled By Rotary Tools <u>X</u> Cable Tools		
19. Producing Interval(s), of this completion - Top, Bottom, Name				20. Was Directional Survey Made YES	
21. Type Electric and Other Logs Run DUAL INDUCTION & FORMATION DENSITY				22. Was Well Cored NO	
23. CASING RECORD (Report all strings set in well)					
CASING SIZE	WEIGHT LB/FT	DEPTH SET	HOLE SIZE	CEMENTING RECORD	AMOUNT PULLED
8-5/8	24.0	209	12-1/4	250 sc Class B	0
5-1/2	15.50	4760	7-7/8	1st stage 230sx 65/35 & 265 Class B Tail.	0
				2nd stage 465sx 65/35 & 50sx "B" Tail.	
24. LINER RECORD			25. TUBING RECORD		
SIZE	TOP	BOTTOM	SACKS CEMENT	SCREEN	SIZE DEPTH SET PACKER SET
					2-7/8 4300 4300
26. Perforation record (interval, size, and number) 4350-4460 2spf .46 220			27. ACID, SHOT, FRACTURE, CEMENT, SQUEEZE, ETC DEPTH INTERVAL AMOUNT AND KIND MATERIAL USED		
28. PRODUCTION					
Date First Production 02-24-92		Production Method (Flowing, gas lift, pumping - Size and type pump) SWABBING			Well Status (Prod or Shut-in) SHUT-IN
Date of Test 02-24-92	Hours Tested 24	Choke Size 2"	Prod n For Test Period	Oil - Bbl. TR.	Gas - MCF 3.2 Water - Bbl. 164.99 Gas - Oil Ratio 19. CU/FT/BB
Flow Tubing Press. 0	Casing Pressure 315	Calculated 24-Hour Rate	Oil - Bbl	Gas - MCF	Water - Bbl 164.99 Oil Gravity - API - (Corr) NOT MEASURED
29. Disposition of Gas (Sold, used for fuel, vented, etc) VENTED				Test Witnessed By HAROLD ELLEDGE	
30. List Attachments PRODUCTION TEST					
31. I hereby certify that the information shown on both sides of this form is true and complete to the best of my knowledge and belief					
Signature <u>Rm Makher</u>		Printed Name <u>RON MABAN</u>		Title <u>CONTRACTS MGR</u>	Date <u>02-28-92</u>

Submit to Appropriate
District Office
State Lease - 6 copies
Fee Lease - 5 copies

State of New Mexico
Energy, Minerals and Natural Resources Department

Form C 101
Revised 1-1-89

OIL CONSERVATION DIVISION

P.O. Box 2088
Santa Fe, New Mexico 87504-2088

DISTRICT I
P.O. Box 1980, Hobbs, NM 88240

DISTRICT II
P.O. Drawer DD, Artesia, NM 88210

DISTRICT III
1000 Rio Brazos Rd., Aztec, NM 87410

API NO (assigned by OCD on New Wells)

30-045-28653

5. Indicate Type of Lease

STATE ☐

FEE ☒

6. State Oil & Gas Lease No

APPLICATION FOR PERMIT TO DRILL, DEEPEN, OR PLUG BACK

1a. Type of Work

DRILL ☒

RE-ENTER ☐

DEEPEN ☐

PLUG BACK ☐

b. Type of Well-

OIL
WELL ☐

GAS
WELL ☐

OTHER ☐

SWD
DISPOSAL ☒

SINGLE
ZONE ☒

MULTIPLE
ZONE ☐

7. Lease Name or Unit Agreement Name

SUNCO DISPOSAL

13795

2. Name of Operator

COLEMAN OIL & GAS COMPANY

4838

8. Well No.

#1

3. Address of Operator

700 SOUTH TUCKER, FARMINGTON, NM 87401

9. Pool name or Wildcat

76680

FLORA VISTA MESA VERDE

4. Well Location

Unit Letter E 1595 Feet From The NORTH Line and 1005 Feet From The WEST Line

Section 2

Township 29N

Range 12W

NMPM SAN JUAN

County

10. Proposed Depth

4760

11. Formation

MESA VERDE

12. Rotary or C.T

ROTARY

13. Elevations (Show whether DF, RT, GR, etc)

5859 GR.

14. Kind & Status Plug. Bond

15. Drilling Contractor

BIG "A" WELL SERVICE

16. Approx. Date Work will start

1-28-92

PROPOSED CASING AND CEMENT PROGRAM

SIZE OF HOLE	SIZE OF CASING	WEIGHT PER FOOT	SETTING DEPTH	SACKS OF CEMENT	EST TOP
12-1/4	8-5/8	24.0	200	200	SURFACE
7-7/8	5-1/2	15.50	4760	900	SURFACE

We propose to drill, log, and set casing through the point lookout member of the Mesa Verde and upon examination of the logs, a portion of the point lookout will be selectively perforated and stimulated as needed.

RECEIVED

FEB 28 1992

OIL CON. DIV
DIST

APPROVAL EXPIRES 9-5-92
UNLESS DRILLING IS COMMENCED.
SPUD NOTICE MUST BE SUBMITTED
WITHIN 10 DAYS

IN ABOVE SPACE DESCRIBE PROPOSED PROGRAM IF PROPOSAL IS TO DEEPEN OR PLUG BACK, GIVE DATA ON PRESENT PRODUCTIVE ZONE AND PROPOSED NEW PRODUCTIVE ZONE. GIVE BLOWOUT PREVENTER PROGRAM, IF ANY

I hereby certify that the information above is true and complete to the best of my knowledge and belief

SIGNATURE

Ron Mahan

TITLE CONTRACTS MANAGER

DATE 02/28/92

TYPE OR PRINT NAME

RON MAHAN

TELEPHONE NO 327-4961

(This space for State Use)

APPROVED BY

Ernie Bouch

DEPUTY OIL & GAS INSPECTOR, DIST #3

DATE

MAR 05 1992

CONDITIONS OF APPROVAL, IF ANY

P 553 308 258

US Postal Service

Receipt for Certified Mail

No Insurance Coverage Provided

Do not use for International Mail (See reverse)

Sent to Merrion Oil & Gas	
Street & Number P.O. Box 840	
Post Office Farmington NM 87499 Code	
Postage	\$
Certified Fee	
Special Delivery Fee	
Restricted Delivery Fee	
Return Receipt Showing to Whom & Date Delivered	
Return Receipt Showing to Whom, Date, & Addressee's Address	
TOTAL Postage & Fees	\$
Postmark or Date	

PS Form 3800, April 1995

Fold at line over top of envelope to the right of the return address

CERTIFIED

P 553 308 258

MAIL

Is your RETURN ADDRESS completed on the reverse side?

SENDER:

- Complete items 1 and/or 2 for additional services
- Complete items 3, 4a, and 4b
- Print your name and address on the reverse of this form so that we can return this card to you
- Attach this form to the front of the mailpiece, or on the back if space does not permit
- Write "Return Receipt Requested" on the mailpiece below the article number
- The Return Receipt will show to whom the article was delivered and the date delivered

I also wish to receive the following services (for an extra fee)

- 1 ☐ Addressee's Address
- 2 ☐ Restricted Delivery

Consult postmaster for fee

3 Article Addressed to

**Merrion Oil & Gas
P.O. Box 840
Farmington NM 87499**

4a Article Number

P 553 308 258

4b Service Type

- ☐ Registered ☒ Certified
- ☐ Express Mail ☐ Insured
- ☐ Return Receipt for Merchandise ☐ COD

7 Date of Delivery

5 Received By (Print Name)

6 Signature (Addressee or Agent)

X

8 Addressee's Address (Only if requested and fee is paid)

PS Form 3811, December 1994

Domestic Return Receipt

Thank you for using Return Receipt Service.

P 553 308 259

**US Postal Service
Receipt for Certified Mail**

No Insurance Coverage Provided
Do not use for International Mail (See reverse)

Sent to
Meridian Oil

Street & Number
P.O. Box 4289

Post Office, State, ZIP Code
NM 87499

Postage

Certified Fee

Special Delivery Fee

Restricted Delivery Fee

Return Receipt Showing to Whom & Date Delivered

Return Receipt Showing to Whom, Date, & Addressee's Address

TOTAL Postage & Fees

Postmark or Date

PS Form 3800, April 1995

Fold at line over top of envelope to the right of the return address.

CERTIFIED

P 553 308 259

MAIL

Is your RETURN ADDRESS completed on the reverse side?

SENDER:

- Complete items 1 and/or 2 for additional services
- Complete items 3, 4a, and 4b
- Print your name and address on the reverse of this form so that we can return this card to you
- Attach this form to the front of the mailpiece, or on the back if space does not permit
- Write "Return Receipt Requested" on the mailpiece below the article number
- The Return Receipt will show to whom the article was delivered and the date delivered

I also wish to receive the following services (for an extra fee)

- 1 ☐ Addressee's Address
- 2 ☐ Restricted Delivery

Consult postmaster for fee

3 Article Addressed to
**Meridian Oil Company
P.O. Box 4289
Farmington NM 87499**

4a Article Number
P 553 308 259

- 4b Service Type
 - ☐ Registered
 - ☐ Express Mail
 - ☐ Return Receipt for Merchandise
 - ☒ Certified
 - ☐ Insured
 - ☐ COD

7 Date of Delivery

5 Received By (Print Name)

8 Addressee's Address (Only if requested and fee is paid)

6 Signature (Addressee or Agent)
X

PS Form 3811, December 1994

Domestic Return Receipt

Thank you for using Return Receipt Service.



WATER AND OILFIELD HEAVY HAULING P.O. BOX 443, FARMINGTON, NM 87499 (505) 327 0416

Merrion Oil & Gas
P.O. Box 840
Farmington NM 87499
Phone: 505-327-9801

May 3, 1996

Gentleman:

Reference: Reclassification of Sunco SWD.

Sunco Trucking is in the process of applying for a new classification from Class II to Class I disposal to accept only RCRA exempt non-hazardous oil and gas wastes. The attached is a copy of that application.

Thank You,

Chuck Badsgard
Vice-President of Sunco Trucking

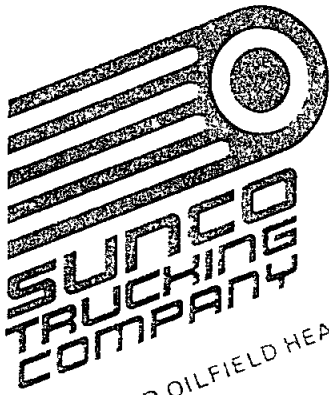

WATER AND OILFIELD HEAVY HAULING P.O. BOX 443, FARMINGTON, NM 87499 (505) 327 0416

Meridian Oil
P.O. Box 4289
Farmington NM 87499
Phone: 505-326-9700

May 3, 1996

Gentleman:

Reference: Reclassification of Sunco SWD.

Sunco Trucking is in the process of applying for a new classification from Class II to Class I disposal to accept only RCRA exempt non-hazardous oil and gas wastes. The attached is a copy of that application.

Thank You,

Chuck Badsguard
Vice-President of Sunco Trucking



Key Energy Services, Inc.

Four Corners Division
P O Box 900
5651 US Highway 64
Farmington, NM 87499

Phone 505-327-4935
Fax 505-327-4962

334-6186

APR 23 2001

April 19, 2001

Wayne Price
NMOCD
1220 S St Francis Drive
Santa Fe, New Mexico 87504

**RE: Application for renewal of Key Energy Services Injection Well Discharge Plan
UIC-CLI-005**

Dear Mr Price

Please find attached Application, Documentation and Filing Fee for renewal of our
Discharge Plan

If you require additional information, please contact me at the Office 505-334-6416 or
the Facility at 505-334-6186

Sincerely,

Michael Talovich
Facility Manager
Key Energy Services

cc Mr Hal Stone Key Energy

District I
1625 N French Dr Hobbs NM 88240
District II
811 South First Artesia NM 88210
District III
1000 Rio Brazos Road Aztec NM 87410
District IV
1220 S St Francis Dr Santa Fe NM 87505

State of New Mexico
Energy Minerals and Natural Resources
Oil Conservation Division
1220 South St Francis Dr
Santa Fe, NM 87505

Revised January 24, 2001

Submit Original
Plus 1 Copy
to Santa Fe
1 Copy to Appropriate
District Office

**DISCHARGE PLAN APPLICATION FOR SERVICE COMPANIES, GAS PLANTS,
REFINERIES, COMPRESSOR, GEOTHERMAL FACILITIES
AND CRUDE OIL PUMP STATIONS**

(Refer to the OCD Guidelines for assistance in completing the application)

☐ New

☒ Renewal

☐ Modification

1 Type Refer to next page

2 Operator _____

Address _____

Contact Person _____ Phone _____

3 Location _____ /4 _____ /4 Section _____ Township _____ Range _____

Submit large scale topographic map showing exact location

4 Attach the name telephone number and address of the landowner or the facility site

5 Attach the description of the facility with a diagram indicating location of fences pits dikes and tanks on the facility

6 Attach a description of all materials stored or used at the facility

7 Attach a description of present sources of effluent and waste solids Average quality and daily volume of waste water must be included

8 Attach a description of current liquid and solid waste collection/treatment/disposal procedures

9 Attach a description of proposed modifications to existing collection/treatment/disposal systems

10 Attach a routine inspection and maintenance plan to ensure permit compliance

11 Attach a contingency plan for reporting and clean-up of spills or releases

12 Attach geological/hydrological information for the facility Depth to and quality of ground water must be included

13 Attach a facility closure plan and other information as is necessary to demonstrate compliance with any other OCD rules regulations and/or orders

14 CERTIFICATION I hereby certify that the information submitted with this application is true and correct to the best of my knowledge and belief

Name MICHAEL TALOVICH Title 4-18-2001

Signature [Signature] Date manager

DISCHARGE PLAN APPLICATION

April 19, 2001

- 1 Discharge Plan for Key Energy Services Disposal Well
- 2 Key Energy Services Inc P O Box 900 Farmington, New Mexico 87499
Michael Talovich, 505-334-6186
- 3 Unit E, Section 2, Township 29N, Range 12W
- 4 Key Energy Services Inc 505-327-0416 P O Box 900 Farmington NM
87499
- 5 On file with NMOCD included with 711 Surface permit application NM-
01-0009
- 6 N/A
- 7 See latest Injection Well Quarterly Report (included)
- 8 Wastewater is pumped from the Evaporation Pond through an above
ground pipelines which fills a tank located at the Injection pump area
The wastewater is then pulled from the tank and filtered and injected
under pressure into the well
Please find included copies of approved Discharge Plan UIC-CLI-005
and Permit Condition Amendment
- 9 N/A
- 10 The Wastewater Disposal System is visually inspected at least 6 times
per day , this includes Unloading Area piping, Pond perimeter piping,
Injection System feed pipeline, Injection System Tank and all piping
related to Injection Pump and Well
All fluid is piped and stored above ground until fluid reaches the well
bore All Pump and Well pressures are recorded and kept at the Facility

- 11 All spills will be reported pursuant to OCD Rule 116 including their cleanup in accordance of NMOCD guidelines
Key Energy maintains spill clean up equipment on site This allows swift response to any spills or leaks that could occur at the Facility
- 12 Please find and refer to included copy of original Application for Disposal Well Modification from Class II to Class I
- 13 See State of New Mexico One -Well Plugging Bond U 2723755
The remainder of the Facility will be closed under 711 Closure Guidelines as required by permit

Advertising Receipt

AUG 8 2003

The Daily Times

PO Box 450
Farmington, NM 87499
Phone (505) 325-4545
Fax (505) 564-4580

ED MARTIN
NM ENERGY, MINERALS & NATURAL
RESOURCES DEPT, OIL CONSERVATION
1220 S FRANCIS DRIVE
ATTN FLORENE DAVIDSON
SANTA FE, NM 87505-4000

Cust#: d0102625-000
Ad#: 05522615
Phone. (505)476-3492
Date 08/01/03

Ad taker DH Salesperson: UC Classification 999

Description	Start	Stop	Ins	Cost/Day	Surcharges	Total
01 Daily Times COMMERCIAL INT	08/01/03	08/01/03	1	80 52		80 52 3 00

Payment Reference.

Total. 83 52

Tax. 5 22

Net. 88 74

Prepaid 0 00

Total Due 88 74

NOTICE OF PUBLICATION

STATE OF NEW MEXICO
ENERGY, MINERALS AND NATURAL RESOURCES DEPARTMENT
OIL CONSERVATION DIVISION

Notice is hereby given that pursuant to New Mexico Water Quality Control Commission Regulations, the following discharge plan application(s) have been submitted to the Director of the Oil Conservation Division, 1220 South St Francis Drive, Santa Fe, New Mexico 87505, Telephone (505) 476-3440

(GW-275)-Unichem (a Division of BJ Services Company), Mr Robert E Barr, 1215 Basin Road, Farmington, New Mexico 87401, has submitted a Discharge Plan Renewal Application for their Farmington Service Facility located in the NE/4 NE/4, Section 23, Township 29 North, Range 13 West, NMPM, San Juan County, New Mexico Any potential discharge at the facility will be stored in a closed top receptacle prior to transport off-site to an OCD

OK Wayne Fin
8/27/03

AFFIDAVIT OF PUBLICATION

Ad No. 48310

STATE OF NEW MEXICO County of San Juan:

CONNIE PRUITT, being duly sworn says
That she is the Classified Manager of THE
DAILY TIMES, a daily newspaper of general
circulation published in English at Farmington,
said county and state, and that the hereto
attached Legal Notice was published in a
regular and entire issue of the said DAILY
TIMES, a daily newspaper duly qualified for
the purpose within the meeting of Chapter 167
of the 1937 Session Laws of the State of New
Mexico for publication on the following day(s)
Friday, August 1, 2003

And the cost of the publication is \$88 74

Connie Pruitt

ON 8-1-03 CONNIE PRUITT appeared
before me, whom I know personally to be the
person who signed the above document

Danny Beck

My Commission Expires April 2, 2004

COPY OF PUBLICATION

918

Legals

NOTICE OF PUBLICATION

STATE OF NEW MEXICO ENERGY, MINERALS AND NATURAL RESOURCES DEPARTMENT OIL CONSERVATION DIVISION

Notice is hereby given that pursuant to New Mexico Water Quality Control Commission Regulations, the following discharge plan application(s) have been submitted to the Director of the Oil Conservation Division, 1220 South St Francis Drive, Santa Fe, New Mexico 87505, Telephone (505) 476-3440

(GW-275)-Unichem (a Division of BJ Services Company), Mr Robert E Barr, 1215 Basin Road, Farmington, New Mexico 87401, has submitted a Discharge Plan Renewal Application for their Farmington Service Facility located in the NE/4 NE/4, Section 23, Township 29 North, Range 13 West, NMPM, San Juan County, New Mexico. Any potential discharge at the facility will be stored in a closed top receptacle prior to transport off-site to an OCD approved disposal facility. Groundwater most likely to be affected by a spill, leak, or accidental discharge to the surface is at a depth of approximately 15 feet with a total dissolved solids concentration of approximately 675 mg/L. The discharge plan addresses how spills, leaks, and other accidental discharges to the surface will be managed.

UIC-CLI-005 (GW-130) - Key Energy Services, Inc., Mr Mike Talovich, P O Box 900, Farmington, New Mexico, 87499 has submitted a discharge plan renewal application for their permitted Class I disposal well located in Unit Letter E, Section 2, Township 29 North, Range 12 West, NMPM, San Juan County, New Mexico. Approximately 2,000 barrels per day of non-hazardous oil field liquid waste are disposed of by injection into the Point Lookout Formation at a depth from 4,380 to 4,480 feet. The total dissolved solids concentration of the injection water is approximately 24,000 mg/l. The total dissolved solids concentration of the formation fluids is approximately 14,000 mg/l. The discharge plan addresses construction, operation and monitoring of the well and associated surface facilities and provides a contingency plan in the event of accidental spills, leaks and other accidental discharges to the ground surface. Ground water most likely to be affected by any accidental discharge is at a depth from 78 to 90 feet and has a total dissolved solids concentration of approximately 450 mg/l.

Any interested person may obtain further information from the Oil Conservation Division and may submit written comments to the Director of the Oil Conservation Division at the address given above. The discharge permit application and draft discharge permit may be viewed at the above address between 8 00 a m and 4 00 p m, Monday through Friday. The draft discharge permit may also be viewed at OCD's web site <http://www.emnrd.state.nm.us/ocd/>. Prior to ruling on any proposed discharge permit or its modification, the Director of the Oil Conservation Division shall allow at least thirty (30) days after the date of publication of this notice during which comments may be submitted and any interested person may request a public hearing. Requests for a public hearing shall set forth the reasons why a hearing should be held. A hearing will be held if the Director determines there is significant public interest.

If no public hearing is held, the Director will approve or disapprove the proposed permit based on information available. If a public hearing is held, the director will approve or disapprove the proposed permit based on information in the permit and information submitted at the hearing.

GIVEN under the Seal of New Mexico Oil Conservation Commission at Santa Fe, New Mexico, on this 24th day of June 2003

STATE OF NEW MEXICO
OIL CONSERVATION DIVISION

SEAL

LORI WROTENBERY, Director

Legal No 48310 published in The Daily Times, Farmington, New Mexico on Friday, August 1, 2003

THE SANTA FE
NEW MEXICAN RECEIVED
Founded 1849

AUG 05 2003

Ed Martin
NM OIL CONSERVATION D
1220 ST FRANCIS DR
ATT MARY ANAYA
SANTA FE NM 87505

OIL CONSERVATION
DIVISION

ALTERNATE ACCOUNT: 56689
AD NUMBER 00019826 ACCOUNT: 00002212
LEGAL NO. 73788 P O # 04.199.050340
333 LINES 1 TIME(S) 227 92
AFFIDAVIT 5.25
TAX. 15 59
TOTAL. 248.76

AFFIDAVIT OF PUBLICATION

STATE OF NEW MEXICO
COUNTY OF SANTA FE

I, K Voorhees, being first duly sworn declare and say that I am Legal Advertising Representative of THE SANTA FE NEW MEXICAN, a daily newspaper published in the English language, and having a general circulation in the Counties of Santa Fe and Los Alamos, State of New Mexico and being a newspaper duly qualified to publish legal notices and advertisements under the provisions of Chapter 167 on Session Laws of 1937, that the publication # 73788 a copy of which is hereto attached was published in said newspaper 1 day(s) between 08/01/2003 and 08/01/2003 and that the notice was published in the newspaper proper and not in any supplement, the first date of publication being on the 1st day of August, 2003 and that the undersigned has personal knowledge of the matter and things set forth in this affidavit.

/S/ *K. Voorhees*
LEGAL ADVERTISEMENT REPRESENTATIVE

Subscribed and sworn to before me on this 1st day of August, 2003

Notary *Laure E. Harding*

Commission Expires *11/23/03*

OK Wendy
8/27/03

AFFIDAVIT OF PUBLICATION

Ad No. 48310

STATE OF NEW MEXICO County of San Juan:

CONNIE PRUITT, being duly sworn says
That she is the Classified Manager of THE
DAILY TIMES, a daily newspaper of general
circulation published in English at Farmington,
said county and state, and that the hereto
attached Legal Notice was published in a
regular and entire issue of the said DAILY
TIMES, a daily newspaper duly qualified for
the purpose within the meeting of Chapter 167
of the 1937 Session Laws of the State of New
Mexico for publication on the following day(s)
Friday, August 1, 2003

And the cost of the publication is \$88 74

Connie Pruitt

ON 8-1-03 CONNIE PRUITT appeared
before me, whom I know personally to be the
person who signed the above document

Danny Beck
My Commission Expires April 2, 2004

COPY OF PUBLICATION

918

Legals

NOTICE OF PUBLICATION

STATE OF NEW MEXICO ENERGY, MINERALS AND NATURAL RESOURCES DEPARTMENT OIL CONSERVATION DIVISION

Notice is hereby given that pursuant to New Mexico Water Quality Control Commission Regulations, the following discharge plan application(s) have been submitted to the Director of the Oil Conservation Division, 1220 South St Francis Drive, Santa Fe, New Mexico 87505, Telephone (505) 476-3440

(GW-275)-Unichem (a Division of BJ Services Company), Mr Robert E Barr, 1215 Basin Road, Farmington, New Mexico 87401, has submitted a Discharge Plan Renewal Application for their Farmington Service Facility located in the NE/4 NE/4, Section 23, Township 29 North, Range 13 West, NMPM, San Juan County, New Mexico Any potential discharge at the facility will be stored in a closed top receptacle prior to transport off-site to an OCD approved disposal facility. Groundwater most likely to be affected by a spill, leak, or accidental discharge to the surface is at a depth of approximately 15 feet with a total dissolved solids concentration of approximately 675 mg/L. The discharge plan addresses how spills, leaks, and other accidental discharges to the surface will be managed

UIC-CLI-005 (GW-130) - Key Energy Services, Inc, Mr Mike Talovich, P O Box 900, Farmington, New Mexico, 87499 has submitted a discharge plan renewal application for their permitted Class I disposal well located in Unit Letter E, Section 2, Township 29 North, Range 12 West, NMPM, San Juan County, New Mexico Approximately 2,000 barrels per day of non-hazardous oil field liquid waste are disposed of by injection into the Point Lookout Formation at a depth from 4,380 to 4,480 feet. The total dissolved solids concentration of the injection water is approximately 24,000 mg/l. The total dissolved solids concentration of the formation fluids is approximately 14,000 mg/l. The discharge plan addresses construction, operation and monitoring of the well and associated surface facilities and provides a contingency plan in the event of accidental spills, leaks and other accidental discharges to the ground surface. Ground water most likely to be affected by any accidental discharge is at a depth from 78 to 90 feet and has a total dissolved solids concentration of approximately 450 mg/l

Any interested person may obtain further information from the Oil Conservation Division and may submit written comments to the Director of the Oil Conservation Division at the address given above. The discharge permit application and draft discharge permit may be viewed at the above address between 8 00 a.m. and 4 00 p.m., Monday through Friday. The draft discharge permit may also be viewed at OCD's web site <http://www.emnrd.state.nm.us/oed/>. Prior to ruling on any proposed discharge permit or its modification, the Director of the Oil Conservation Division shall allow at least thirty (30) days after the date of publication of this notice during which comments may be submitted and any interested person may request a public hearing. Requests for a public hearing shall set forth the reasons why a hearing should be held. A hearing will be held if the Director determines there is significant public interest.

If no public hearing is held, the Director will approve or disapprove the proposed permit based on information available. If a public hearing is held, the director will approve or disapprove the proposed permit based on information in the permit and information submitted at the hearing.

GIVEN under the Seal of New Mexico Oil Conservation Commission at Santa Fe, New Mexico, on this 24th day of June 2003

STATE OF NEW MEXICO
OIL CONSERVATION DIVISION

SEAL

LORI WROTENBERY, Director

Legal No 48310 published in The Daily Times, Farmington, New Mexico on Friday, August 1, 2003

RECEIVED

OCT 10 2001

OIL CONSERVATION
DIVISION

NM OIL CONSERVATION DIVISION
ATTN. WAYNE PRICE
1220 S. ST. FRANCIS DRIVE
SANTA FE, NM 87505

THE SANTA FE

NEW MEXICAN

Founded 1849

AD NUMBER. 226352 ACCOUNT. 56689
LEGAL NO. 70014 P O.# 02199000249
206 LINES 1 time(s) at \$ 90.81
AFFIDAVITS 5.25
TAX 6 00
TOTAL 102 06

NOTICE OF PUBLICA-
TION

STATE OF NEW MEXICO
ENERGY, MINERALS
AND NATURAL RE-
SOURCES
DEPARTMENT
OIL CONSERVATION
DIVISION

Notice is hereby given that pursuant to New Mexico Water Quality Control Commission Regulations, the following discharge plan applications has been submitted to the Director of the Oil Conservation Division, 1220 S Saint Francis Drive, Santa Fe, New Mexico 87505, Telephone (505) 476-3440

UIC-CLI 005- Key Energy Services, Inc., Mr Mike Talovich, P O Box 900, Farmington, New Mexico, 87499 has submitted a discharge plan renewal application for their per-

mitted Class I disposal well located in Unit Letter E, Section 2, Township 29 North, Range 12 West, NMPM, San Juan County, New Mexico. Approximately 2,000 barrels per day of non-hazardous oil field liquid waste are disposed of by injection into the Point Lookout Formation at a depth from 4,380 to 4,480 feet. The total dissolved solids concentration of the injection water is approximately 24,000 mg/l. The total dissolved solids concentration of the formation fluids is approximately 14,000 mg/l. The discharge plan addresses construction, operation and monitoring of the well and associated surface facilities and provides a contingency plan

in the event of accidental spills, leaks and other accidental discharges to the ground surface. Ground water most likely to be affected by any accidental discharge is at a depth from 78 to 90 feet and has a total dis-

solved solids concentration of approximately 450 mg/l

Any interested person may obtain further information from the Oil Conservation Division and may submit written comments to the Director of the Oil Conservation Division at the address given above. The discharge plan application may be viewed at the above address between 8:00 a.m. and 4:00 p.m., Monday through Friday. Prior to ruling on any proposed discharge plan or its modification, the Director of the Oil Conservation Division shall allow at least thirty (30) days after the date of publication of this notice during which comments may be submitted to him and a public hearing may be requested by any interested person. Requests for a public hearing shall set forth the reasons why a hearing should be held. A hearing will be held if the Director determines there is significant public interest.

If no public hearing is held, the Director will approve or disapprove the proposed plan based on information available. If a public hearing is held, the director will approve or disapprove the proposed plan based on information in the plan and information submitted at the hearing.

GIVEN under the Seal of New Mexico Oil Conservation Commission at Santa Fe, New Mexico, on this 6th day of September 2001.

STATE OF NEW MEXICO
OIL CONSERVATION DIVISION

SEAL
LORI WROTENBERY, Director
Legal #70014
Pub September 13, 2001

AFFIDAVIT OF PUBLICATION

STATE OF NEW MEXICO
COUNTY OF SANTA FE

I, _____ being first duly sworn declare and say that I am Legal Advertising Representative of THE SANTA FE NEW MEXICAN, a daily newspaper published in the English language, and having a general circulation in the Counties of Santa Fe and Los Alamos, State of New Mexico and being a Newspaper duly qualified to publish legal notices and advertisements under the provisions of Chapter 167 on Session Laws of 1937, that the publication #70014 a copy of which is hereto attached was published in said newspaper 1 day(s) between 09/13/2001 and 09/13/2001 and that the notice was published in the newspaper proper and not in any supplement, the first publication being on the 13 day of September, 2001 and that the undersigned has personal knowledge of the matter and things set forth in this affidavit.

/S/ _____
LEGAL ADVERTISEMENT REPRESENTATIVE

Subscribed and sworn to before me on this
13 day of September A.D , 2001

Notary _____

Commission Expires _____

www.sfnwmexican.com

KEY ENERGY SERVICES**FOUR CORNERS DIVISION****PIPEYARD/DISPOSAL**

P O BOX 900

5651 US HWY 64

FARMINGTON, NEW MEXICO 87499

OFFICE (505) 334-6416 FAX (505) 334-5413

DATE 3-4-02TIME 10:00 AmTO COMPANY NMOCOPERSON MR. WAYNEPHONE _____ FAX 1-505-476-3462FROM MIKE TALOUCH

MESSAGE QUOTE + PROCEEDING FOR WELL PLUGGING
MR. RANDY BLACKMON Ph # 327-0416 Ext 117
(505)

TOTAL NUMBER OF PAGES3

(INCLUDING COVER SHEET)

**QUOTE TO PLUG & ABANDON
SUNCO DWD #1
PREPARED BY RANDY BLACKMON
PLUG & ABANDONMENT SUPERVISOR
KEY ENERGY SERVICES INC.**

ESTIMATED PROCEDURES ARE AS FOLLOWS:

1. RELEASE 5 ½" PACKER AND TOOH.
2. RIH W/5 ½" CEMENT RETAINER SET @ 4250'
3. MIX AND PUMP 50 SX CLASS B CEMENT (38 SX BELOW RETAINER & 12 SX ABOVE)
4. ESTIMATE THREE 18 SX BALANCED PLUGS INSIDE 5 ½" CASING TO COVER VARIOUS ZONES AS REQUIRED.
5. ONE 30 SX PLUG FROM 259' TO SURFACE.
6. CUT OFF WELL HEAD AND RIG ANCHORS
7. INSTALL DRY HOLE MARKER

ESTIMATED COST TO PERFORM THIS PROJECT=\$10,980.00

ESTIMATED COST TO CLEAN AND RESEED LOCATION WHERE ACTUAL
WELL IS=\$2,500.00

TOTAL= \$13,480.00

INFLATION FACTOR 20 % \$2,696.00

TOTAL ESTIMATE \$16,176.00

COMPANY KEY ENERGY WELL Sunco W #1DATE 2-22-02

EQUIP / PERSONNEL	QTY	RATE	AMOUNT	QTY	RATE	AMOUNT
MOB TIME						
REGULAR TIME	20	225	4465 ⁰⁰			
CREW TRAVEL	2	110	220 ⁰⁰			
PICKUP CHARGE	2	110	220 ⁰⁰			
MISC. CHARGE			150 ⁰⁰			
SUPERVISOR	2	350	700 ⁰⁰			
CEMENT PUMP	1		1000 ⁰⁰			
WIRELINE CHARGE						
RIG PIT / FRAC TANK						
H2S EQUIPMENT						
RESTROOM						
R&D / REPORT	1	200	200 ⁰⁰			
OTHER / PERDIEM						
OTHER						
MATERIALS / SUPLIES			6890 ⁰⁰			
CEMENT	134	10 ⁰⁰	1340 ⁰⁰			
CaCl						
MUD / SPACER						
PERFORATIONS						
CUTS						
RETAINER	1	850	850 ⁰⁰			
CIBP						
DRY HOLE MARKER	1	350	350 ⁰⁰			
FLANGE / SPOOL	1	150	150 ⁰⁰			
BIT / SUB						
ELEVATORS / RAMS						
SPEAR / SCRAPER						
DIRT WK / ANCHORS	1	650	650 ⁰⁰			
FUEL / ENVIRO						
OTHER						
OTHER						
TRUCKING COST			3340 ⁰⁰			
TKG WATER	4	60	240 ⁰⁰			
TKG EQUIPMENT	4	85	340 ⁰⁰			
TKG TUBING	2	85	170 ⁰⁰			
TKG PIT / TANK						
OTHER						
TOTAL			750 ⁰⁰	TOTAL		10,980 ⁰⁰



Key Energy Services, Inc.

April 29, 2002

Martyne Kieling
Wayne Price
Oil Conservation Division
1220 So. St. Francis Drive
Santa Fe, New Mexico 87505

Re: Address change

Dear Martyne and Wayne

I am requesting that all correspondents regarding Key Energy Services be sent to the following address.

Key Energy Services, Inc.
Attn: Gene Butler
6 Desta Drive
Suite 4400
Midland, Texas 79705

Key Energy Services PBD well list is listed below:

Contintial Water Sales	Truckers 2 Brine Station
BKE#1 SWD	RA State
Sims-McCasland Water Sales	J.H.Day#1
J.H.Day#2	Christmas#3
City of Carlsbad Brine Station	Bone Springs SWD
Atha#1 SWD	

Key Energy Services FCD well list:

Sunco Disposal

Thank You

Gene Butler

Price, Wayne

From: Price, Wayne
Sent: Thursday, March 14, 2002 10:06 AM
To: 'disposal@cyberport.com', 'wprice@state.nm.us'
Cc: Kieling, Martyne
Subject: RE: Discharge Plan Approval Conditions

APPROVED''

-----Original Message-----

From: Mike Talovich [mailto:disposal@cyberport.com]
Sent: Thursday, March 14, 2002 10:20 AM
To: 'wprice@state.nm.us.'
Subject: Discharge Plan Approval Conditions

RE: Discharge Plan UIC-CLI-005

Mr. Price:

Key Energy Services Inc. requests a 90 day extension for the following Discharge Plan Conditions:

#16 Below Grade Tanks/Sumps

#23 Plugging Bond and / or Letter of Credit

#26 Storm Water Plan

The above items are all in process and will be completed by June 14, 2002

Also required is a 30 day extension for the Financial Assurance portion of Facility Permit NM-01-0009 (711 permit)

Thankyou,

Michael Talovich
Facility Manager

Tracking:

Recipient

Read

'disposal@cyberport.com'

'wprice@state.nm.us'

Kieling, Martyne

Read 3/18/2002 8:31 AM



NEW MEXICO ENERGY, MINERALS and NATURAL RESOURCES DEPARTMENT

GARY E. JOHNSON
Governor
Jennifer A. Salisbury
Cabinet Secretary

Lori Wrotenbery
Director
Oil Conservation Division

NOTICE OF PUBLICATION

STATE OF NEW MEXICO ENERGY, MINERALS AND NATURAL RESOURCES DEPARTMENT OIL CONSERVATION DIVISION

Notice is hereby given that pursuant to New Mexico Water Quality Control Commission Regulations, the following discharge plan applications has been submitted to the Director of the Oil Conservation Division, 1220 S. Saint Francis Drive, Santa Fe, New Mexico 87505, Telephone (505) 476-3440.

UIC-CLI-005- Key Energy Services, Inc., Mr. Mike Talovich, P.O. Box 900, Farmington, New Mexico, 87499 has submitted a discharge plan renewal application for their permitted Class I disposal well located in Unit Letter E, Section 2, Township 29 North, Range 12 West, NMPM, San Juan County, New Mexico. Approximately 2,000 barrels per day of non-hazardous oil field liquid waste are disposed of by injection into the Point Lookout Formation at a depth from 4,380 to 4,480 feet. The total dissolved solids concentration of the injection water is approximately 24,000 mg/l. The total dissolved solids concentration of the formation fluids is approximately 14,000 mg/l. The discharge plan addresses construction, operation and monitoring of the well and associated surface facilities and provides a contingency plan in the event of accidental spills, leaks and other accidental discharges to the ground surface. Ground water most likely to be affected by any accidental discharge is at a depth from 78 to 90 feet and has a total dissolved solids concentration of approximately 450 mg/l.

Any interested person may obtain further information from the Oil Conservation Division and may submit written comments to the Director of the Oil Conservation Division at the address given above. The discharge plan application may be viewed at the above address between 8.00 a.m. and 4.00 p.m., Monday through Friday. Prior to ruling on any proposed discharge plan or its modification, the Director of the Oil Conservation Division shall allow at least thirty (30) days after the date of publication of this notice during which comments may be submitted to him and a public hearing may be requested by any interested person. Requests for a public hearing shall set forth the reasons why a hearing should be held. A hearing will be held if the Director determines there is significant public interest.

If no public hearing is held, the Director will approve or disapprove the proposed plan based on information available. If a public hearing is held, the director will approve or disapprove the proposed plan based on information in the plan and information submitted at the hearing.

GIVEN under the Seal of New Mexico Oil Conservation Commission at Santa Fe, New Mexico, on this 6th day of September 2001

STATE OF NEW MEXICO
OIL CONSERVATION DIVISION

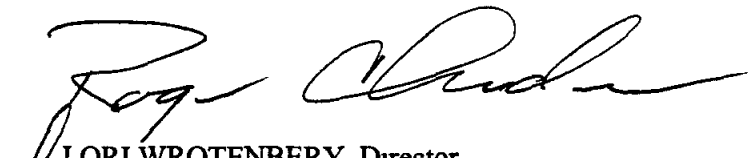
LORI WROTENBERY, Director

SEAL

THE SANTA FE
NEW MEXICAN
Founded 1849

NM OIL CONSERVATION DIVISION
ATTN: WAYNE PRICE
1220 S. ST. FRANCIS DRIVE
SANTA FE, NM 87505

AD NUMBER 226352 ACCOUNT: 56689
LEGAL NO. 70014 P.O.#. 02199000249
206 LINES 1 time(s) at \$ 90.81
AFFIDAVITS 5.25
TAX. 6 00
TOTAL 102.06

NOTICE OF PUBLICATION

**STATE OF NEW MEXICO
ENERGY, MINERALS
AND NATURAL RESOURCES
DEPARTMENT
OIL CONSERVATION
DIVISION**

Notice is hereby given that pursuant to New Mexico Water Quality Control Commission Regulations, the following discharge plan applications has been submitted to the Director of the Oil Conservation Division, 1220 S Saint Francis Drive, Santa Fe, New Mexico 87505, Telephone (505) 476 3440

UIC-CL1005- Key Energy Services, Inc., Mr Mike Talovich, P O Box 900, Farmington, New Mexico, 87499 has submitted a discharge plan renewal application for their per-

mitted Class I disposal well located in Unit Letter E, Section 2, Township 29 North, Range 12 West, NMPM, San Juan County, New Mexico Approximately 2,000 barrels per day of non-hazardous oil field liquid waste are disposed of by injection into the Point Lookout Formation at a depth from 4,380 to 4,480 feet. The total dissolved solids concentration of the injection water is approximately 24,000 mg/l. The total dissolved solids concentration of the formation fluids is approximately 14,000 mg/l. The discharge plan addresses construction, operation and monitoring of the well and associated surface facilities and provides a contingency plan in the event of accidental spills, leaks and other accidental discharges to the ground surface. Ground water most likely to be affected by any accidental discharge is at a depth from 78 to 90 feet and has a total dis-

solved solids concentration of approximately 450 mg/l

Any interested person may obtain further information from the Oil Conservation Division and may submit written comments to the Director of the Oil Conservation Division at the address given above. The discharge plan application may be viewed at the above address between 8 00 a.m. and 4 00 p.m., Monday through Friday. Prior to ruling on any proposed discharge plan or its modification, the Director of the Oil Conservation Division shall allow at least thirty (30) days after the date of publication of this notice during which comments may be submitted to him and a public hearing may be requested by any interested person. Requests for a public hearing shall set forth the reasons why a hearing should be held. A hearing will be held if the Director determines there is significant public interest.

If no public hearing is held, the Director will approve or disapprove the proposed plan based on information available. If a public hearing is held, the director will approve or disapprove the proposed plan based on information in the plan and information submitted at the hearing.

GIVEN under the Seal of New Mexico Oil Conservation Commission at Santa Fe, New Mexico, on this 6th day of September 2001

STATE OF NEW MEXICO
OIL CONSERVATION DIVISION

SEAL
LORI WROTENBERY, Director
Legal #70014
Pub September 13, 2001

AFFIDAVIT OF PUBLICATION

STATE OF NEW MEXICO
COUNTY OF SANTA FE

I, MM Weideman being first duly sworn declare and say that I am Legal Advertising Representative of THE SANTA FE NEW MEXICAN, a daily newspaper published in the English language, and having a general circulation in the Counties of Santa Fe and Los Alamos, State of New Mexico and being a Newspaper duly qualified to publish legal notices and advertisements under the provisions of Chapter 167 on Session Laws of 1937, that the publication #70014 a copy of which is hereto attached was published in said newspaper 1 day(s) between 09/13/2001 and 09/13/2001 and that the notice was published in the newspaper proper and not in any supplement, the first publication being on the 13 day of September, 2001 and that the undersigned has personal knowledge of the matter and things set forth in this affidavit

/S/

MM Weideman

LEGAL ADVERTISEMENT REPRESENTATIVE

Subscribed and sworn to before me on this
13 day of September A D., 2001

Notary

Laura J. Harding

Commission Expires

11/23/03

*APPROVE
W.P.
10/10/01*

AFFIDAVIT OF PUBLICATION

Ad No. 44995

STATE OF NEW MEXICO
County of San Juan:

CONNIE PRUITT, being duly sworn says
That she is the Classified Manager of THE
DAILY TIMES, a daily newspaper of general
circulation published in English at Farmington,
said county and state, and that the hereto
attached Legal Notice was published in a
regular and entire issue of the said DAILY
TIMES, a daily newspaper duly qualified for
the purpose within the meeting of Chapter 167
of the 1937 Session Laws of the State of New
Mexico for publication on the following day(s)

Monday, September 10, 2001

And the cost of the publication is \$82 60

Connie Pruitt

ON 9.11.01 CONNIE PRUITT appeared
before me, whom I know personally to be the
person who signed the above document

Jimmy Beck
My Commission Expires April 02, 2004

OK

COPY OF PUBLICATION

918

Legals

NOTICE OF PUBLICATION

STATE OF NEW MEXICO
ENERGY, MINERALS AND NATURAL RESOURCES DEPARTMENT
OIL CONSERVATION DIVISION

Notice is hereby given that pursuant to New Mexico Water Quality Control Commission Regulations, the following discharge plan applications has been submitted to the Director of the Oil Conservation Division, 1220 S Saint Francis Drive, Santa Fe, New Mexico 87505, Telephone (505) 476-3440

UIC-CL-005- Key Energy Services, Inc, Mr Mike Talovich, P O Box 900, Farmington, New Mexico, 87499 has submitted a discharge plan renewal application for their permitted Class I disposal well located in Unit Letter E, Section 2, Township 29 North, Range 12 West, NMPM, San Juan County, New Mexico. Approximately 2,000 barrels per day of non-hazardous oil field liquid waste are disposed of by injection into the Point Lookout Formation at a depth from 4,380 to 4,480 feet. The total dissolved solids concentration of the injection water is approximately 24,000 mg/l. The total dissolved solids concentration of the formation fluids is approximately 14,000 mg/l. The discharge plan addresses construction, operation and monitoring of the well and associated surface facilities and provides a contingency plan in the event of accidental spills, leaks and other accidental discharges to the ground surface. Ground water most likely to be affected by any accidental discharge is at a depth from 78 to 90 feet and has a total dissolved solids concentration of approximately 450 mg/l.

Any interested person may obtain further information from the Oil Conservation Division and may submit written comments to the Director of the Oil Conservation Division at the address given above. The discharge plan application may be viewed at the above address between 8 00 a m and 4 00 p m, Monday through Friday. Prior to ruling on any proposed discharge plan or its modification, the Director of the Oil Conservation Division shall allow at least thirty (30) days after the date of publication of this notice during which comments may be submitted to him and a public hearing may be requested by any interested person. Requests for a public hearing shall set forth the reasons why a hearing should be held. A hearing will be held if the Director determines there is significant public interest.

If no public hearing is held, the Director will approve or disapprove the proposed plan based on information available. If a public hearing is held, the director will approve or disapprove the proposed plan based on information in the plan and information submitted at the hearing.

GIVEN under the Seal of New Mexico Oil Conservation Commission at Santa Fe, New Mexico, on this 6th day of September 2001

STATE OF NEW MEXICO
OIL CONSERVATION DIVISION

SEAL

LORI WROTENBERY, Director

Legal No 44995, published in The Daily Times, Farmington, New Mexico, Monday, September 10, 2001

ACKNOWLEDGEMENT OF RECEIPT
OF CHECK/CASH

I hereby acknowledge receipt of check No. 141398 dated 4/19/2001
or cash received on _____ in the amount of \$ 100⁰⁰
from KEY ENERGY SERVICES, INC.
for KEY ENERGY SERVICES INJECTION WELL MIC-CLI-005
(Facility Name)
Submitted by: WAYNE PRICE Date: 5/14/01 (DP No.)
Submitted to ASD by: [Signature] Date: 11
Received in ASD by: _____ Date: _____
Filing Fee ☒ New Facility _____ Renewal _____
Modification _____ Other _____
(Signature)
Organization Code 521.07 Applicable FY 2001

To be deposited in the Water Quality Management Fund.
Full Payment _____ or Annual Increment _____



KEY ENERGY SERVICES, INC.
FOUR CORNERS DIVISION
5051 US HIGHWAY 64 P.O. BOX 900
FARMINGTON NEW MEXICO 87499
505 327-4935

PNC BANK NATIONAL ASSOCIATION
JEANNETTE PA
60101-1133

No **141398**

Check Date **4/19/2001**

PAY One Hundred Dollars and No Cent

*****100.00*****
EQUIN 2001 04 19 10 00 00

TO THE
ORDER
OF

NM ENRGY, MNRLS, & NAT RESC DEPT
OIL CONSERVATION DIVISION
1220 SOUTH ST. FRANCIS DRIVE
SANTA FE NM 87504

MIC-CLI-005

[Signature: Ron Pellabrum]

AUTHORIZED SIGNATURE IF OVER \$10,000.00

141398 00433016270 1004416783



NEW MEXICO ENERGY, MINERALS and NATURAL RESOURCES DEPARTMENT

GARY E. JOHNSON
Governor
Jennifer A. Salisbury
Cabinet Secretary

Lori Wrotenbery
Director
Oil Conservation Division

Memorandum of Meeting or Conversation

Telephone X
Personal
E-Mail X
FAX:

Date: 3/16/01

Originating Party: Wayne Price-OCD

Other Parties: Mike Talovich & Gene Butler- Key Energy Service Inc.

Subject Discharge Plan Renewal Notice for the following Facilities:

UICCL1005	Key Energy Class I Disposal Well	expires	8/26/01
GW-___	Name	expires	
GW-___	Name	expires	
GW-___	Name	expires	

WQCC 3106.F. If the holder of an approved discharge plan submits an application for discharge plan renewal at least 120 days before the discharge plan expires, and the discharger is not in violation of the approved discharge plan on the date of its expiration, then the existing approved discharge plan for the same activity shall not expire until the application for renewal has been approved or disapproved. A discharge plan continued under this provision remains fully effective and enforceable. An application for discharge plan renewal must include and adequately address all of the information necessary for evaluation of a new discharge plan. Previously submitted materials may be included by reference provided they are current, readily available to the secretary and sufficiently identified to be retrieved [12-1-95]

Discussion: Discussed WQCC 3106F and gave notice to submit Discharge Plan renewal application with \$100.00 filing fee for the above listed facilities.

Conclusions or Agreements:

Please submit before April 26, 2001

Signed: 