

CORRESPONDENCE

MISC.

**RESPONSE TO NEW MEXICO OIL CONSERVATION DIVISION
FOR ADDITIONAL INFORMATION**

**EOTT ENERGY CORP.
TNM 98-02
LEA COUNTY, NEW MEXICO**

RECEIVED

FEB 28 2001

**ENVIRONMENTAL BUREAU
OIL CONSERVATION DIVISION**

**Prepared For:
EOTT Energy Corp.
5805 East Highway 80
Midland, Texas 79701**

Environmental Technology Group, Inc. Project No. EOT2068C

**Prepared By:
Environmental Technology Group, Inc. (ETGI)
2540 West Marland Blvd.
Hobbs, New Mexico 88240**

January 26, 2001

RESPONSE TO NEW MEXICO OIL CONSERVATION DIVISION FOR ADDITIONAL INFORMATION

**TNM 98-02
Lea County, New Mexico
January 26, 2001
Prepared By:
ETGI**

INTRODUCTION

Environmental Technology Group, Inc. (ETGI) hereby submits this additional information to the New Mexico Oil Conservation Division (NMOCD) on behalf of EOTT Energy Corp. (EOTT) on the TNM 98-02 leak site. This information was requested by Mr. Bill Olson of the NMOCD, in a letter dated October 30, 2000, to assist in obtaining closure for the site.

BACKGROUND

The leak site is located northwest of the town of Monument, in NW ¼, SE ¼ of Section 31, Township 19 South, Range 37 East, in Lea County, New Mexico, as depicted in Figure 1, Site Location Map. Prior activities at the site included installation of four monitoring wells and quarterly sampling and analysis of the groundwater for constituents of concern (COC). As per NMOCD requirements, on completion of four consecutive groundwater-sampling events with no analytical results above the New Mexico Water Quality Control Commission (NMWQCC) standards, a letter was submitted for closure.

The NMOCD response, dated October 30, 2000, required the installation of a temporary monitoring well adjacent to and down gradient of the release point to perform a one time sampling event of the groundwater as well as the additional information supplied in the report.

ADDITIONAL INFORMATION

Attached are the Groundwater Gradient Maps for each of the four sampling events in the Figures section, as requested in the response letter. The summation of the groundwater elevations for the sampling events is found in Table 2, Groundwater Elevation Table.

Table 1 depicts the analytical results for the groundwater analysis on the four groundwater sampling events. The corresponding laboratory analytical and associated quality assurance/quality control data are found as an Appendix.

FIGURES

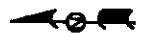
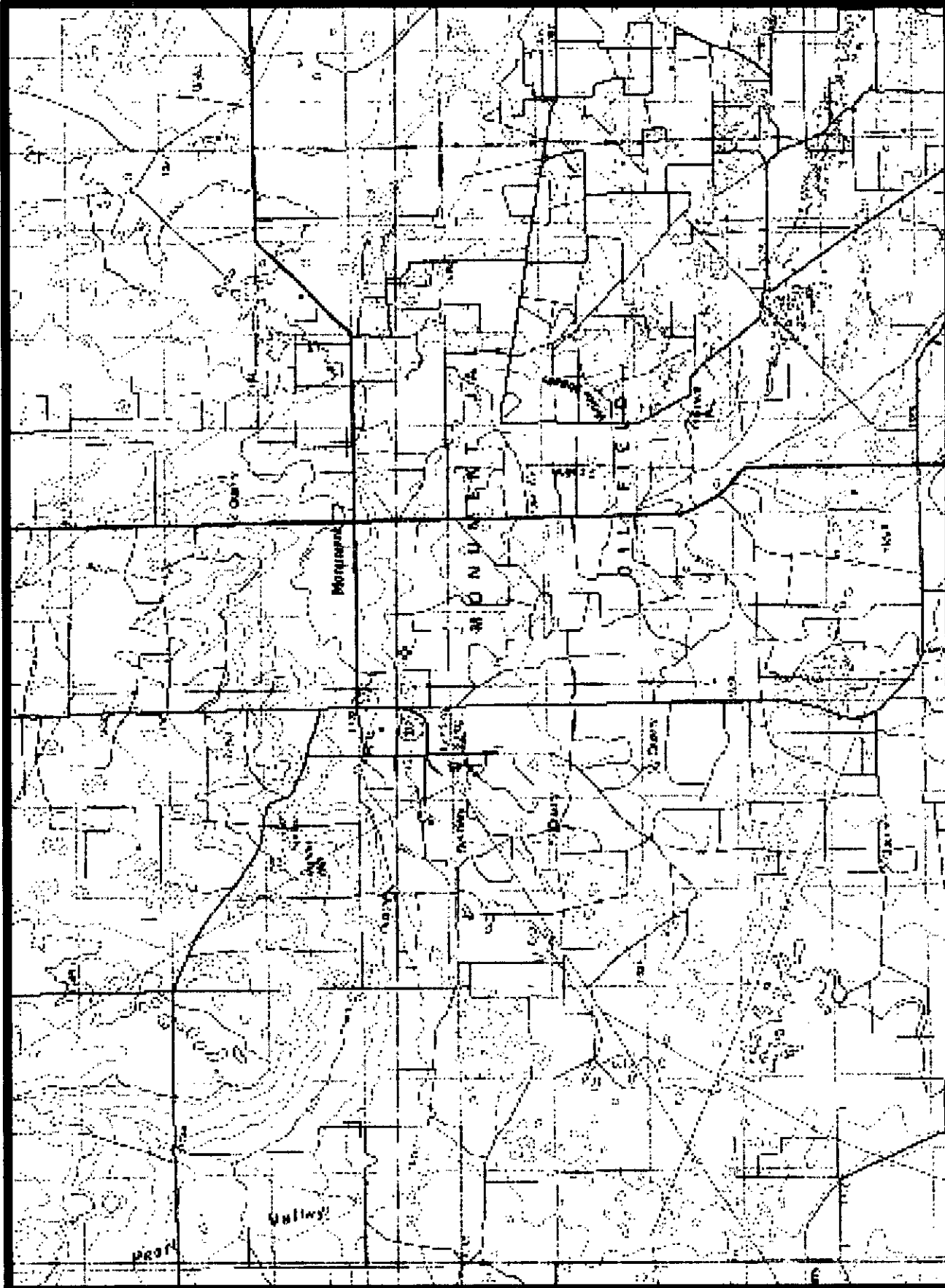

Figure 1
Site Location Map

Environmental Technology
Group, Inc.



EOTT Energy Corp.
TNM 88-02
1 1/2 Miles SE of Monument, NM

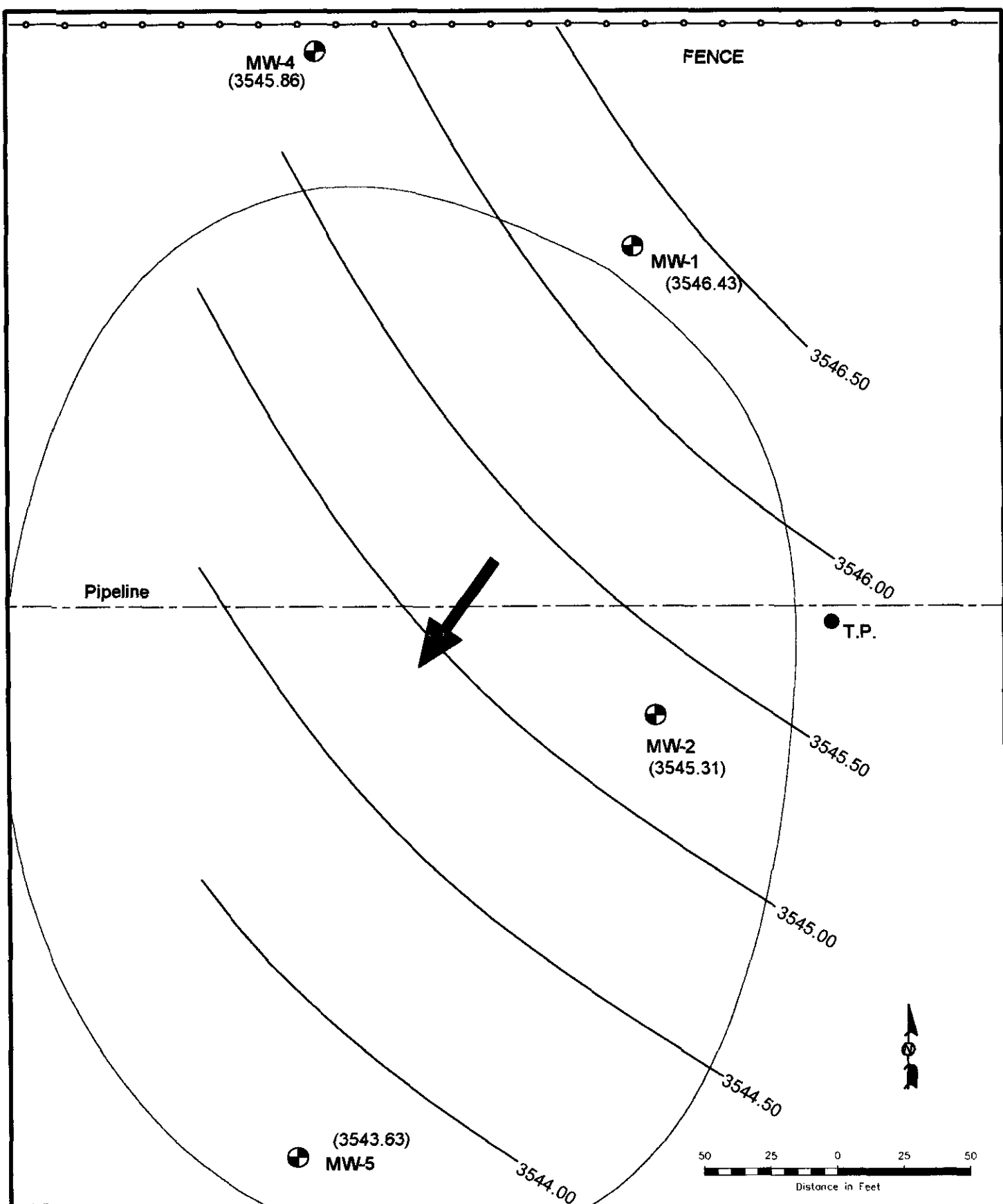

Scale: NTS	Prep By: DJ	Checked By: KD
January 23, 2001		
ETGI Project # EOT2067C		



LEGEND:

-  Monitoring Well Location
-  Groundwater Gradient Line
-  Groundwater Elevation In Feet

Inferred Groundwater
Gradient Map (11/30/99)
EOTT Energy Corp.
TNM 98-02
Lea County, NM

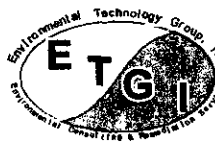

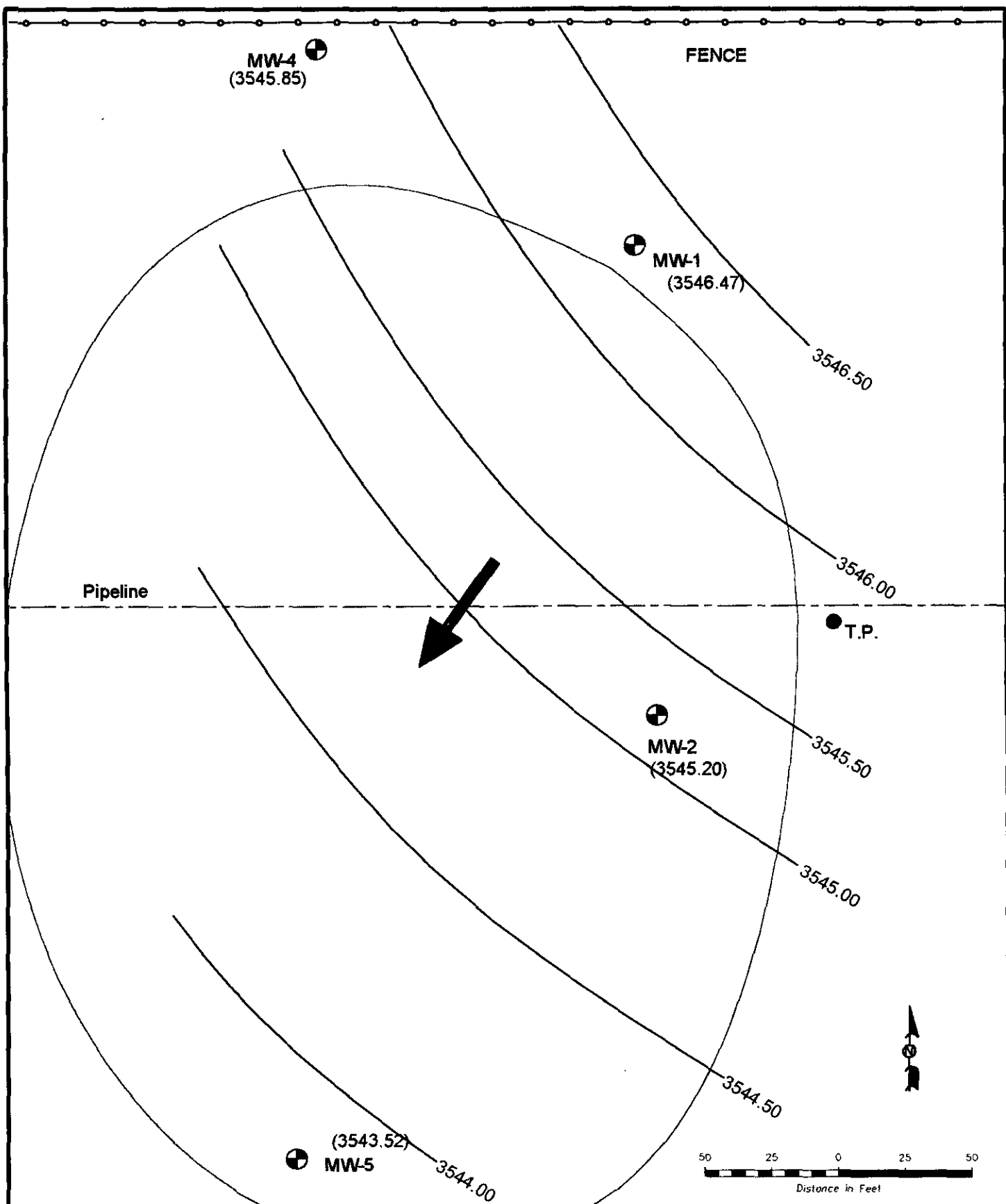

**Environmental Technology
Group, Inc.**

Scale: 1" = 50'	Prep By: JDJ	Checked By: BA
January 24, 2001	ETGI Project # EOT2068C	



LEGEND:

-  Monitoring Well Location
-  Groundwater Gradient Line
-  Groundwater Elevation In Feet (3543.52)

**Inferred Groundwater
Gradient Map (3/9/00)**

EOTT Energy Corp.
TNM 98-02
Lea County, NM

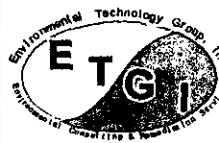

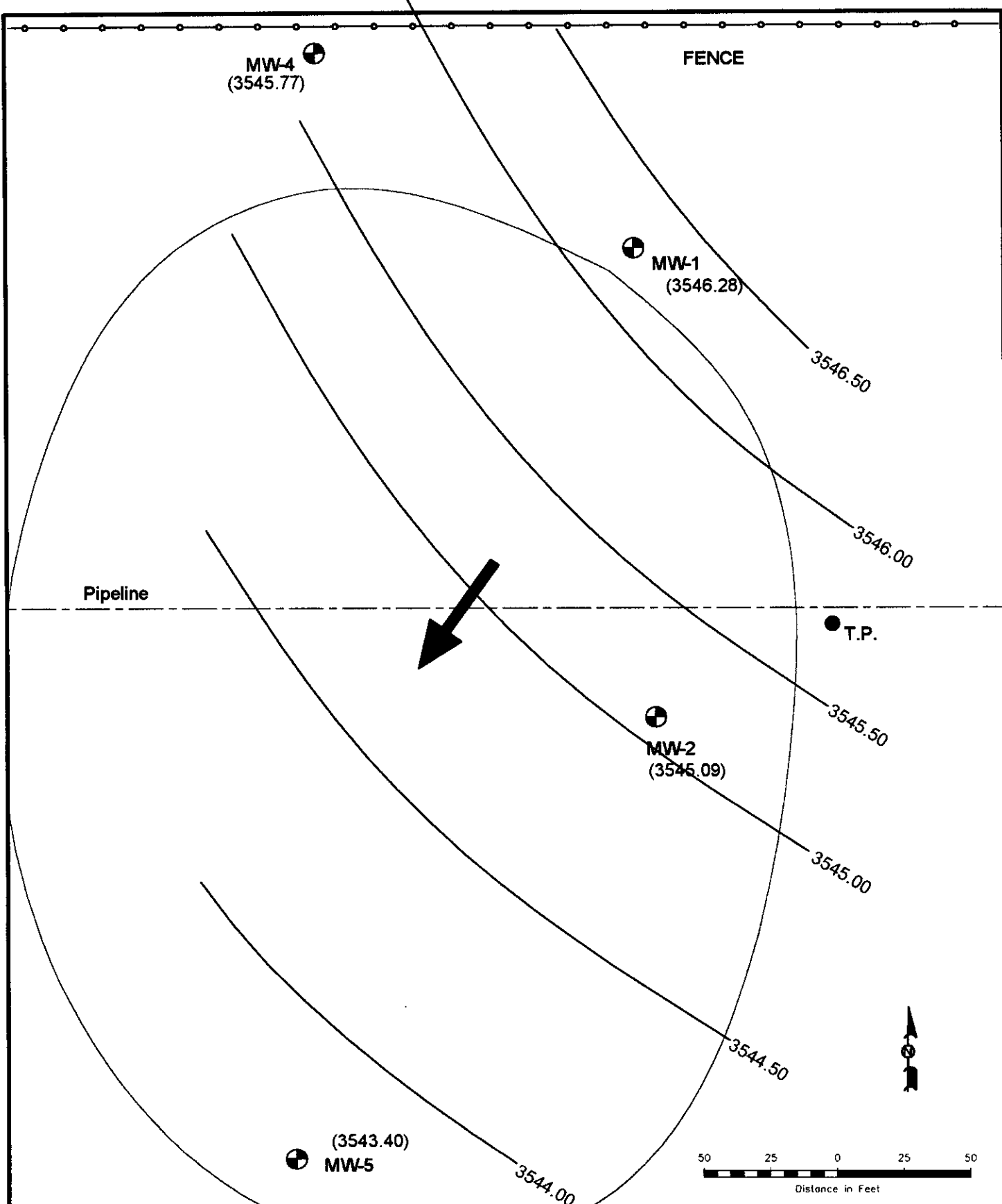

**Environmental Technology
Group, Inc.**

Scale: 1" = 50'	Prep By: JDJ	Checked By: BA
January 24, 2001 ETGI Project # EOT2068C		



LEGEND:

-  Monitoring Well Location
-  Groundwater Gradient Line
-  Groundwater Elevation In Feet

Inferred Groundwater
Gradient Map (5/19/00)
EOTT Energy Corp.
TNM 98-02
Lea County, NM

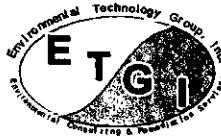

**Environmental Technology
Group, Inc.**

Scale: 1" = 50'	Prep By: JDJ	Checked By: BA
January 24, 2001	ETGI Project #EOT2068C	

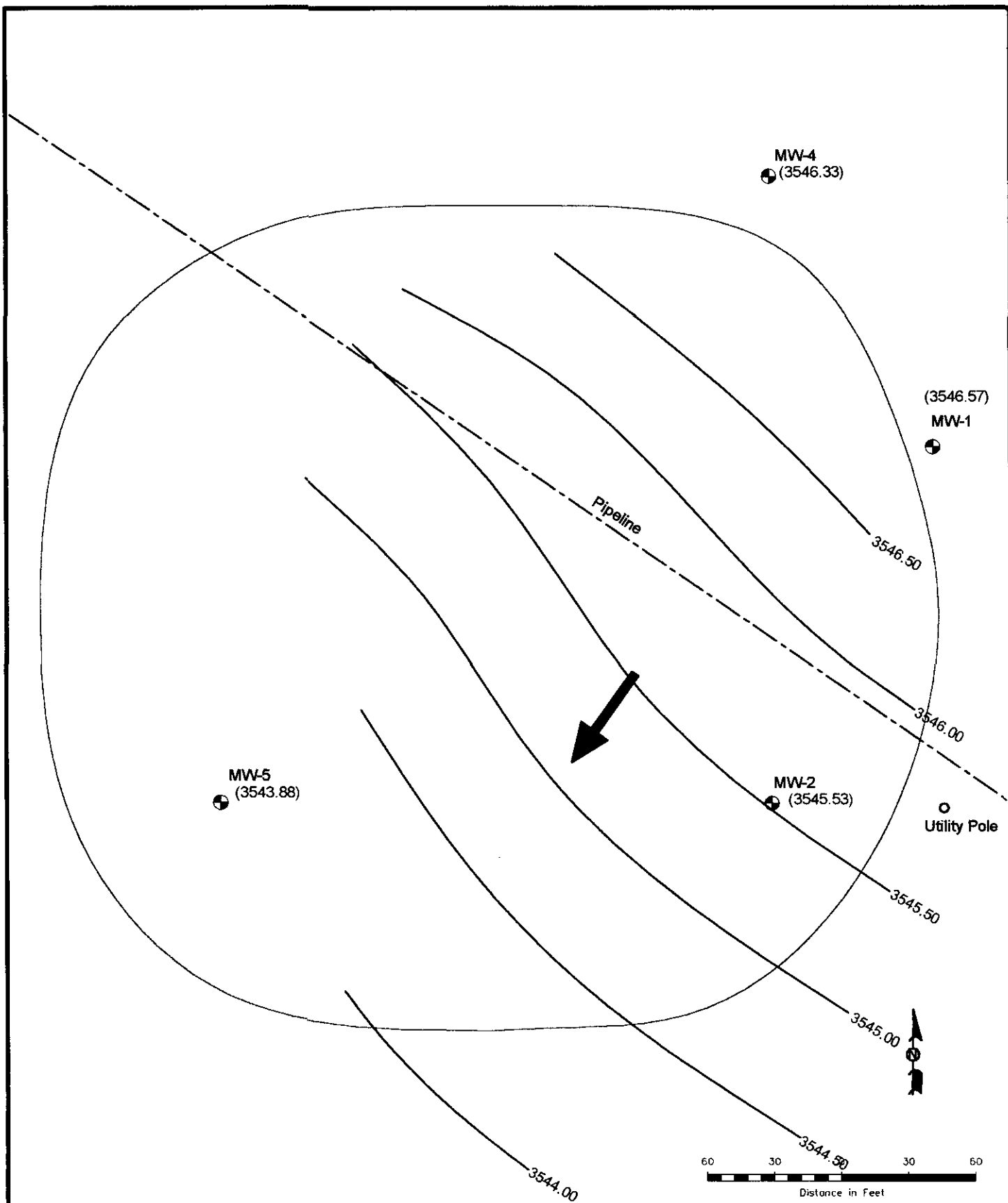

LEGEND:

- ⊕ Monitor Well Location
- Groundwater Gradient Line
- (3543.52) Groundwater Elevation in Feet

Inferred Groundwater
Gradient Map (8/30/00)

EOTT Energy Corp.
TNM 98-02
Lea County, NM



**Environmental Technology
Group, Inc.**

Scale: 1" = 60'	Prep By: JDJ	Checked By: KD
January 26, 2001	ETGI Project # EOT2068C	

TABLES

TNM 98-02
GROUNDWATER ELEVATION TABLE
PROJECT # EOT2068C
11/30/99 - 8/30/00

Well Number	Date	Casing Well Elevation	Depth to Product	Depth to Water	PSH Thickness	Corrected Groundwater Elevation
MW - 1	11/30/99	3,575.77	-	29.34	0.00	3,546.43
MW - 1	3/9/00	3,575.77	-	29.30	0.00	3,546.47
MW - 1	5/19/00	3,575.77	-	29.49	0.00	3,546.28
MW - 1	8/30/00	3,575.77	-	29.20	0.00	3,546.57
MW - 2	11/30/99	3,575.48	-	30.17	0.00	3,545.31
MW - 2	3/9/00	3,575.48	-	30.28	0.00	3,545.20
MW - 2	5/19/00	3,575.48	-	30.39	0.00	3,545.09
MW - 2	8/30/00	3,575.48	-	29.95	0.00	3,545.53
MW - 4	11/30/99	3,576.88	-	31.02	0.00	3,545.86
MW - 4	3/9/00	3,576.88	-	31.03	0.00	3,545.85
MW - 4	5/19/00	3,576.88	-	31.11	0.00	3,545.77
MW - 4	8/30/00	3,576.88	-	30.55	0.00	3,546.33
MW - 5	11/30/99	3,574.77	-	31.14	0.00	3,543.63
MW - 5	3/9/00	3,574.77	-	31.25	0.00	3,543.52
MW - 5	5/19/00	3,574.77	-	31.37	0.00	3,543.40
MW - 5	8/30/00	3,574.77	-	30.89	0.00	3,543.88

APPENDICES

ENVIRONMENTAL LAB OF , INC.

"Don't Treat Your Soil Like Dirt!"

ENVIRONMENTAL TECHNOLOGY GROUP, INC.
ATTN: MR. JESSE TAYLOR
P.O. BOX 4845
MIDLAND, TEXAS 79704
FAX: 505-392-3760

Sample Type: Water
Sample Condition: Intact/ Iced/HCl
Project #: TNM 98-02
Project Name: EOT 1015C
Project Location: Monument, N.M.

Sampling Date: 11/30/99
Receiving Date: 12/02/99
Analysis Date: 12/2 & 12/3/99

ELT#	FIELD CODE	BENZENE (mg/L)	TOLUENE (mg/L)	ETHYLBENZENE (mg/L)	m,p-XYLENE (mg/L)	o-XYLENE (mg/L)
21940	MW-1	<0.001	<0.001	<0.001	<0.001	<0.001
21941	MW-2	<0.001	<0.001	<0.001	<0.001	<0.001
21942	MW-4	<0.001	<0.001	<0.001	<0.001	<0.001
21943	MW-5	0.003	0.002	<0.001	0.001	<0.001

% IA	101	96	97	97	95
% EA	96	95	96	97	96
BLANK	<0.001	<0.001	<0.001	<0.001	<0.001

METHODS: EPA SW 846-8021B,5030

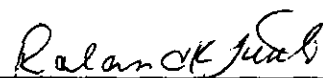
Raland K. Tuttle

12-6-99
Date

ENVIRONMENTAL LAB OF , INC.

"Don't Treat Your Soil Like Dirt!"

ENVIRONMENTAL TECHNOLOGY GROUP, INC.
ATTN: MR. JESSE TAYLOR
P.O. BOX 4845
MIDLAND, TEXAS 79704
FAX: 915-520-4310
FAX: 505-392-3760

SampleType: Water
Sample Condition: Intact/Iced/HCl
Project #: EOT 1015C
Project Name: TNM 98-02
Project Location: Monument, N.M.

Sampling Date: 03/09/00
Receiving Date: 03/10/00
Analysis Date: 3/14-3/15/00

ELT#	FIELD CODE	BENZENE mg/L	TOLUENE mg/L	ETHYLBENZENE mg/L	m,p-XYLENE mg/L	o-XYLENE mg/L
24120	MW-1	<0.001	<0.001	<0.001	<0.001	<0.001
24121	MW-2	<0.001	<0.001	<0.001	<0.001	<0.001
24122	MW-4	<0.001	<0.001	<0.001	<0.001	<0.001
24123	MW-5	0.006	<0.001	0.001	0.002	<0.001

% IA	103	94	94	102	90
% EA	95	85	83	92	82
BLANK	<0.001	<0.001	<0.001	<0.001	<0.001

METHODS: SW 846-8021B,5030

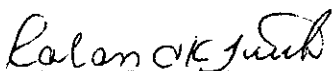
Raland K. Tuttle

3-16-00
Date

CHAIN-OF-CUSTODY RECORD AND ANALYSIS REQUEST

Сод 103

Phone #: (95) 664-9186

FAX #: (605) 392-8260

P.O. BOX 7845 MIDLAND TX 79704

Project Name:

LOT 105C

7NM 98-02

Sampler Signature:

Monuments 4/11

James C. Casper

LAB # (LAB USE ONLY)	FIELD CODE	# CONTAINERS	Volume/Amount	MATRIX	PRESERVATIVE METHOD	SAMPLING
				WATER SOIL AIR SLUDGE OTHER	HCL HNO3 ICE NONE OTHER	DATE TIME
24/20	mwl -	2	V	X	X	89 1337
24/21	mwl 2 -	1	I			✓ 1406
24/22	mwl 4 -	1	I			✓ 1349
24/23	mwl 5 -	1	I			✓ 1315

BTX 81120 (m)
TPH 418.1
TCLP Metals Ag As B
TCLP Metals Ag As B
TCLP Volatiles
TCLP Semi Volatiles
TDS
RCI

	24/20	MW1	Z	V	X		3-9	1337
	24/21	MW2						1405
	24/22	MW4						1349
	24/23	MW5						1315

Relinquished by: <i>Simon, Carlos</i>	Date: <i>3-10-00</i>	Times: <i>1600</i>	Received by: <i>[Signature]</i>	REMARKS: <i>m</i>
Relinquished by:	Date:	Times:	Received by: <i>[Signature]</i>	
Relinquished by:	Date:	Times:	Received by Laboratory:	<i>Times</i>

MARKS

MAIL RESULTS: K. DUTTON

TIME: LEONARD FOST 10:55m

ENVIRONMENTAL LAB OF , INC.

"Don't Treat Your Soil Like Dirt."

ENVIRONMENTAL TECHNOLOGY GROUP, INC.
ATTN: MR. JESSE TAYLOR
P.O. BOX 4845
MIDLAND TEXAS 79704
FAX: 915-520-4310
FAX: 505-392-3760

SampleType: Water
Sample Condition: Intact/ Iced/HCl/ 56 deg. F
Project #: EOT 2015C
Project Name: TNM 98-02
Project Location: Monument, N.M.

Sampling Date: 05/19/00
Receiving Date: 05/22/00
Analysis Date: 05/27 & 05/28/00

ELT#	FIELD CODE	BENZENE mg/L	TOLUENE mg/L	ETHYLBENZENE mg/L	m,p-XYLENE mg/L	o-XYLENE mg/L
25947	MW 1	<0.001	<0.001	<0.001	<0.001	<0.001
25948	MW 2	<0.001	<0.001	<0.001	<0.001	<0.001
25949	MW 4	<0.001	<0.001	<0.001	<0.001	<0.001
25950	MW 5	0.006	<0.001	<0.001	<0.001	<0.001

% IA	97	94	95	102	94
% EA	94	91	93	98	91
BLANK	<0.001	<0.001	<0.001	<0.001	<0.001

METHODS: SW 846-8021B.5030

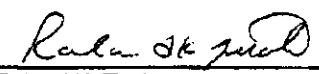
Randal K. Tuttle

5-30-00
Date

Environmental Lab of Texas, Inc. 12600 West I-20 East Odessa, Texas 79763 (915) 563-1800 FAX (915) 563-1713

Project Manager: JESSE TAYLOR

Phone #: (505) 392-8731
FAX #: (505) 392-3760

Company Name & Address:

ETG
P.O. BOX 4845 MIDLAND TX 79704

Project #:

LOT 205C
7000 98-02

Project Location:

Monument, NM
Donna Cook

Sampler Signature:

LAB # (LAB USE ONLY)	FIELD CODE	# CONTAINERS	Volume/Amount	MATRIX			PRESERVATIVE METHOD				SAMPLING	
				WATER	SOIL	AIR	SLUDGE	OTHER	HCL	HNO3	ICP	OTHER
25947	MW 1	2	✓	✓					✓	✓		DATE 5/19/98
25948	MW 2	1	✓	✓					✓	✓		DATE 5/19/98
25949	MW 4	1	✓	✓					✓	✓		DATE 5/19/98
25950	MW 5	1	✓	✓					✓	✓		DATE 5/19/98

TPH 418.1

BTEX 8020/5

TCMP Metals Ag As Ba Cd Cr Pb Hg Se

TCMP Metals Ag As Ba Cd Cr Pb Hg Se

TCMP Volatiles

TCMP Semi Volatiles

TDS

RCI

Relinquished by:

Donna Cook

Date:

5-19-98

Time:

1400

Received by:

Jan Ochoa

REMARKS

Main Roads: H. Dutton

Relinquished by:

Jan Ochoa

Date:

22 MAY 98

Time:

1114

Received by:

Donna Cook

REMARKS

Temp: 56°F

Relinquished by:

Jan Ochoa

Date:

22 MAY 98

Time:

1015

Received by Laboratory:

Temp: 56°F

ENVIRONMENTAL LAB OF , INC.

"Don't Treat Your Soil Like Dirt!"

ENVIRONMENTAL TECHNOLOGY GROUP, INC.
ATTN: BETH ALDRICH
P.O. BOX 4845
MIDLAND, TEXAS 79704
FAX: 915-520-4310

Sample Type: Water
Sample Condition: Intact/ Iced/ HCl/ 30 deg. F
Project #: EOT 2068C
Project Name: TNM 98-02
Project Location: Monument, N.M.

Sampling Date: 08/30/00
Receiving Date: 09/01/00
Analysis Date: 09/05/00

ELT#	FIELD CODE	BENZENE mg/L	TOLUENE mg/L	ETHYLBENZENE mg/L	m,p-XYLENE mg/L	o-XYLENE mg/L	TOTAL BTEX mg/L
30311	MW 1	<0.001	<0.001	<0.001	<0.001	<0.001	<0.001

% IA	103	100	103	106	99
% EA	104	104	106	110	102
BLANK	<0.001	<0.001	<0.001	<0.001	<0.001

METHODS: SW 846-8021B.5030

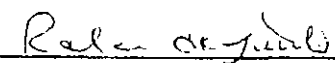
Raland K. Tuttle

9-12-00
Date

ENVIRONMENTAL LAB OF , INC.

"Don't Treat Your Soil Like Dirt!"

ENVIRONMENTAL TECHNOLOGY GROUP, INC.
ATTN: BETH ALDRICH
P.O. BOX 4845
MIDLAND, TEXAS 79704
FAX: 915-520-4310

SampleType: Water
Sample Condition: Intact/ Iced/ HCl/ 30 deg. F
Project #: EOT 2068C
Project Name: TNM 98-02
Project Location: Monument, N.M.

Sampling Date: 08/30/00
Receiving Date: 09/01/00
Analysis Date: 09/06/00

ELT#	FIELD CODE	BENZENE mg/L	TOLUENE mg/L	ETHYLBENZENE mg/L	m,p-XYLENE mg/L	o-XYLENE mg/L	TOTAL BTX mg/L
30312	MW 2	<0.001	<0.001	<0.001	<0.001	<0.001	<0.001
30313	MW 4	<0.001	<0.001	<0.001	<0.001	<0.001	<0.001
30314	MW 5	0.002	<0.001	<0.001	<0.001	<0.001	0.002
30315	EB 1	<0.001	<0.001	<0.001	<0.001	<0.001	<0.001

% IA	96	94	96	98	92
% EA	95	94	95	95	91
BLANK	<0.001	<0.001	<0.001	<0.001	<0.001

METHODS: SW 846-8021B.5030

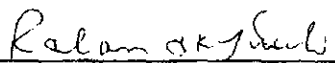
Raland K. Tuttle

9-12-00
Date

REMARKS: FAX RESULTS: HOBBS OFFICE
MAIL RESULTS: FBI
INVOICE: FBI

RECEIVED

APR 05 2001

ENVIRONMENTAL BUREAU
OIL CONSERVATION DIVISION

COPY



January 29, 2001

Mr. Bill Olson
New Mexico Oil Conservation Division
Environmental Bureau
2040 South Pacheco
Santa Fe, NM 87505

RE: EOTT TNM 98-02 Leak Site, NW ¼, SE ¼, Sec 31, T19S, R37E, Lea County, NM

Mr. Olson:

On behalf of EOTT Energy Pipeline, Environmental Technology Group, Inc. (ETGI) submits the following information in response to your letter, dated October 30, 2000, pertaining to our request for closure at the above referenced site. Our responses to your additional items requested are as follows:

- 1.) A Work Plan for the installation of an additional monitoring well is supplied under separate cover. The temporary monitoring well will be installed adjacent to and down gradient of, the release point.
- 2.) Please find attached in the Figures Section, a groundwater Gradient Map for the four sampling events identified in the previous correspondence. Also attached are Table 1, a summary of the analytical testing from December 1999 through August 2000 and Table 2, a summary of groundwater elevations for the sampling events. The corresponding laboratory analytical and associated quality assurance/quality control data are found as an Appendix. As indicated by the results, no COC has been above the NMWQCC limits during the sampling period.

An additional request for closure of this site, plugging and abandoning the monitoring wells, returning the surface to its original contour and reseeding the affected areas at the site will be submitted on completion of the Work Plan. A closure report will follow on completion of these activities.

If you have any questions or comments, please contact me at (505) 397-4882. Thank you.

Sincerely,

Beth Aldrich
Sr. Project Manager/ Geologist

May 3, 2001

Mr. Bill Olson
New Mexico Oil Conservation Division
Environmental Bureau
1220 South Francis
Santa Fe, NM 87505

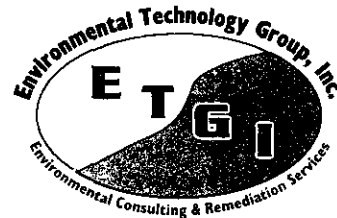

MAY - 8 2001

RE: EOTT TNM 98-02 Leak Site, NW ¼, SE ¼, Sec. 31, T19S, R37E, Lea County, NM

Mr. Olson:

On behalf of EOTT Energy Pipeline, Environmental Technology Group, Inc. (ETGI) submits the enclosed Remediation Work Plan Supplement (RWPS). The RWPS is in response to your letter, dated October 30, 2000, addressing our request for closure at the above referenced site. The RWPS contains the following:

- Figure 1- Site Location Map of the immediate area
- Figure 2- A groundwater Gradient Map showing the existing monitoring wells and the proposed location of the temporary monitoring well
- Table One- A summary of the analytical testing from December 1999 through August 2000
- Table Two- A summary of groundwater elevations for the sampling events
- Appendix A- Laboratory analytical results and associated quality assurance/quality control data indicating that no constituent of concern has been above the limits set by the New Mexico Water Quality Control Commission during the sampling period

Upon implementation of the enclosed RWPS, an additional request for closure of this site will be submitted.

If further questions or concerns arise, please call me at (505) 397-4882.

Sincerely,

Ken Dutton
Sr. Project Manager

Enclosure

cc: Chris Williams - NMOCD District I
Wayne Brunette -EOTT- Midland, TX
Mike Kelly - EOTT - Houston
ETGI - Midland, TX
ETGI - Hobbs, NM

February 20, 2001

Mr. Bill Olson
New Mexico Oil Conservation Division
Environmental Bureau
2040 South Pacheco
Santa Fe, NM 87505

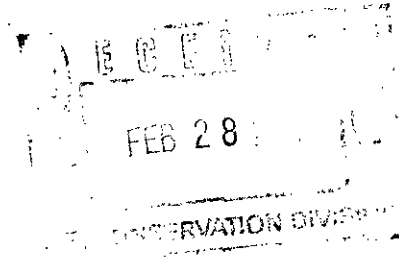

RE: EOTT TNM 98-02 Leak Site, NW ¼, SE ¼, Sec 31, T19S, R37E, Lea County, NM

Mr. Olson:

On behalf of EOTT Energy Pipeline, Environmental Technology Group, Inc. (ETGI) submits the following information in response to your letter, dated October 30, 2000, pertaining to our request for closure at the above referenced site. Our responses to your additional items requested are as follows:

- 1.) A Work Plan for the installation of an additional monitoring well was supplied under separate cover. The temporary monitoring well will be installed adjacent to and down gradient of, the release point.
- 2.) Please find attached in the Figures Section, a groundwater Gradient Map for the four sampling events identified in the previous correspondence. Also attached are Table 1, a summary of the analytical testing from December 1999 through August 2000 and Table 2, a summary of groundwater elevations for the sampling events. The corresponding laboratory analytical and associated quality assurance/quality control data are found as an Appendix. As indicated by the results, no COC has been above the NMWQCC limits during the sampling period.

An additional request for closure of this site, plugging and abandoning the monitoring wells, returning the surface to its original contour and reseeding the affected areas at the site will be submitted on completion of the Work Plan. A closure report will follow on completion of these activities.

If you have any questions or comments, please contact me at (505) 397-4882. Thank you.

Sincerely,

Beth Aldrich
Sr. Project Manager/ Geologist



NEW MEXICO ENERGY, MINERALS and NATURAL RESOURCES DEPARTMENT

GARY E. JOHNSON
Governor
Jennifer A. Salisbury
Cabinet Secretary

Lori Wrotenbery
Director
Oil Conservation Division

February 8, 2001

CERTIFIED MAIL
RETURN RECEIPT NO: 5051-4119

Mr. Glenn Waldrop
EOTT Energy Corporation
P.O. Box 1660
Midland, Texas 79702

RE: CASE # 1R0098
TNM-98-02 LEAK SITE
LEA COUNTY, NEW MEXICO

Dear Mr. Waldrop:

The New Mexico Oil Conservation Division (OCD) has reviewed EOTT Energy Corporation's (EOTT) January 19, 2001 "REMEDIATION WORK PLAN, EOTT ENERGY CORP, TNM 98-02, LEA COUNTY, NEW MEXICO" which was submitted on February 5, 2001 on behalf of EOTT by their consultant Environmental Technology Group, Inc. This document contains EOTT's work plan for installation of an additional ground water monitoring well at EOTT's TNM 98-02 leak site located in the NW/4 SE/4 of Section 31, Township 19 South, Range 37 East, NMPM, Lea County, New Mexico.

The above-referenced work plan is approved with the following conditions:

1. EOTT shall complete the new monitor wells as follows:
 - a. At least 15 feet of well screen shall be placed across the water table interface with 5 feet of the well screen above the water table and 10 feet of the well screen below the water table.
 - b. An appropriately sized gravel pack shall be set in the annulus around the well screen from the bottom of the hole to 2-3 feet above the top of the well screen.
 - c. A 2-3 foot bentonite plug shall be placed above the gravel pack.
 - d. The remainder of the hole shall be grouted to the surface with cement containing 3-5% bentonite.

2. All soil and ground water samples shall be obtained and analyzed using EPA approved methods and quality assurance/quality control (QA/QC).
3. All wastes generated during the investigation shall be disposed of at an OCD approved facility.

Please be advised that OCD approval does not relieve EOTT of responsibility should the investigation actions fail to adequately define the extent of contamination related to EOTT's pipeline, or if contamination exists which is outside the scope of the work plan. In addition, OCD approval does not relieve EOTT of responsibility for compliance with any other federal, state or local laws and regulations.

If you have any questions, please contact me at (505) 476-3491.

Sincerely,



William C. Olson
Hydrologist
Environmental Bureau

xc: Chris Williams, OCD Hobbs District Office
Beth Aldrich, Environmental Technology Group, Inc.

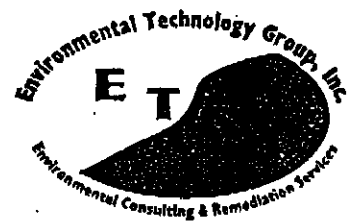

FAX COVER SHEET

DATE 2/5/01TO NMOLD
Bill OlsonFROM Beth Aldrich

ENVIRONMENTAL TECHNOLOGY GROUP

FAX NUMBER 505-476-3462FAX NUMBER 915-520-4310
505-39NUMBER OF PAGES (INCLUDING COVER) 19

NOTES:

Work Plan for add'l boring
Tim 98.02Thanks!
BethAny Questions call me505-397-4882915-238-1296 mobile

REMEDIATION WORK PLAN

**EOTT ENERGY CORP.
TNM 98-02
LEA COUNTY, NEW MEXICO**

**Prepared For:
EOTT Energy Corp.
5805 East Highway 80
Midland, Texas 79701**

Environmental Technology Group, Inc. Project No. EOT2068C

**Prepared By:
Environmental Technology Group, Inc. (ETGI)
2540 West Marland Blvd.
Hobbs, New Mexico 88240**

January 19, 2001

**WORK PLAN SUPPLEMENT
FOR SITE CLOSURE
TNM 98-02
Lea County, New Mexico
January 19, 2001
Prepared By: ETGI**

INTRODUCTION

Environmental Technology Group, Inc. (ETGI) hereby submits a Work Plan to the New Mexico Oil Conservation Division on behalf of EOTT Energy Corp. (EOTT) for the installation of an additional temporary groundwater monitoring well at the TNM 98-02 leak site. This plan will serve as a "Work Plan Supplement" as referenced in the "General Work Plan for Remediation of EOTT Pipeline Spills, Leaks, and Releases in New Mexico" approved by New Mexico Oil Conservation Division (NMOCD) on August 1, 2000. The regulatory basis for both the General Work Plan and this Work Plan Supplement is the August 1993 NMOCD Guidelines for Remediation of Leaks, Spills, and Releases.

BACKGROUND

The leak site is located northwest of the town of Monument, in NW ¼, SE ¼ of Section 31, Township 19 South, Range 37 East, in Lea County, New Mexico as depicted in Figure 1, Site Location Map. Prior activities at the site included installation of five monitoring wells, subsequent excavation of impacted soils and quarterly sampling and analysis of the groundwater of four of these monitoring wells, MW-1, MW-2, MW-4 and MW-5, for constituents of concern (COC). The soils surrounding monitoring well MW-3 as well as MW-3 were excavated to remove in-situ contamination. As per NMOCD requirements, on completion of four consecutive groundwater-sampling events with no analytical results above the New Mexico Water Quality Control Commission (NMWQCC) standards, a letter was submitted for closure.

The NMOCD response, dated October 30, 2000, required the installation of a temporary monitoring well adjacent to and down gradient of the release point to perform a one time sampling event of the groundwater. If the sample obtained is below the standards set forth in NMOCD Rule 19.B, then the NMOCD will issue closure approval for the site.

PURPOSE OF INVESTIGATION

As required by the NMOCD, in a letter dated October 30, 2000, further investigation of the groundwater at the site is necessary. An additional temporary monitoring well is to be installed in accordance with NMOCD guideline adjacent to and down gradient of the release point at the site. Once installation of the monitoring well is complete, a one-time sampling event will be performed on the groundwater.

METHODOLOGY

ETGI plans to supervise and coordinate the drilling of the temporary groundwater monitoring well at the site. The monitoring well will be installed adjacent to, and down gradient of, the release point. The proposed location is depicted on Figure 2, Site Map. During the monitoring well installation soil samples will be collected every five feet with a split spoon sampler except in those locations containing indurated materials. Each five-

foot sample will be field screened with a photo ionization detector (PID) and a continuous lithologic log of the penetrated section will be maintained and recorded. All of the soil samples, including a surface sample, will be transported under Chain of Custody to Environmental Laboratory of Texas (ELOT) for analysis.

The monitoring wells will be completed and developed in accordance with NMOCD Guideline Parts V.C.1 and V.C.3, respectively. The fluid levels will be measured within 1/100th of a foot then purged and sampled in accordance with the NMOCD Guideline Part V.C.4. As required by NMOCD Rule 19.B, the groundwater sample will be submitted for analyses identified below.

ANALYSES

All soil samples submitted for analysis will be analyzed for TPH using EPA Method 8015 Modified GRO/DRO Extended Range. Samples with a field PID reading in excess of 100ppm may be submitted for Benzene, Toluene, Ethyl benzene and Xylenes (BTEX) analysis using EPA Method 8021B.1

The groundwater sample will be submitted for the following analysis:

- BTEX (EPA Method 8021B and 5030)
- TPH – EPA Method 8015 Modified GRO/DRO Extended Range
- Major Cations and Anions – EPA Methods 375.4, 325.3 and 310
- Total Dissolved Solids (TDS) – EPA Method 160.1
- Polynuclear Aromatic Hydrocarbons (PAH) – EPA Method 8270C, 3510
- Metals – EPA Method 6010B, 7470

DISCUSSION OF FINDINGS

Four consecutive sampling events of the groundwater from the four monitoring wells that were conducted prior to this Work Plan indicated no analytical results above the NMWQCC standards. These results are shown in Table 1.

CONCLUSIONS

Groundwater contamination appears not to have migrated down gradient of the release point based on prior analytical testing at the previously installed monitoring wells. Further investigation and sampling of the groundwater adjacent to, and down gradient of, the release point is needed to delineate any hydrocarbon impact and to secure site closure as per NMOCD requirements.

FOLLOW-UP ACTIVITIES

Installation of a temporary monitoring well, adjacent to, and down gradient of the release point, can be initiated within two weeks of the work plan approval. Once installed, purging and sampling of the groundwater will be conducted. The groundwater sample will be transported under Chain of Custody to ELOT for analysis.

On notification of the results of the analysis, the site will be resubmitted for closure if the analysis indicates no COC above the NMQWCC standards. If the analysis indicates COC above the NMWQCC standards, further investigation will be addressed under separate cover.

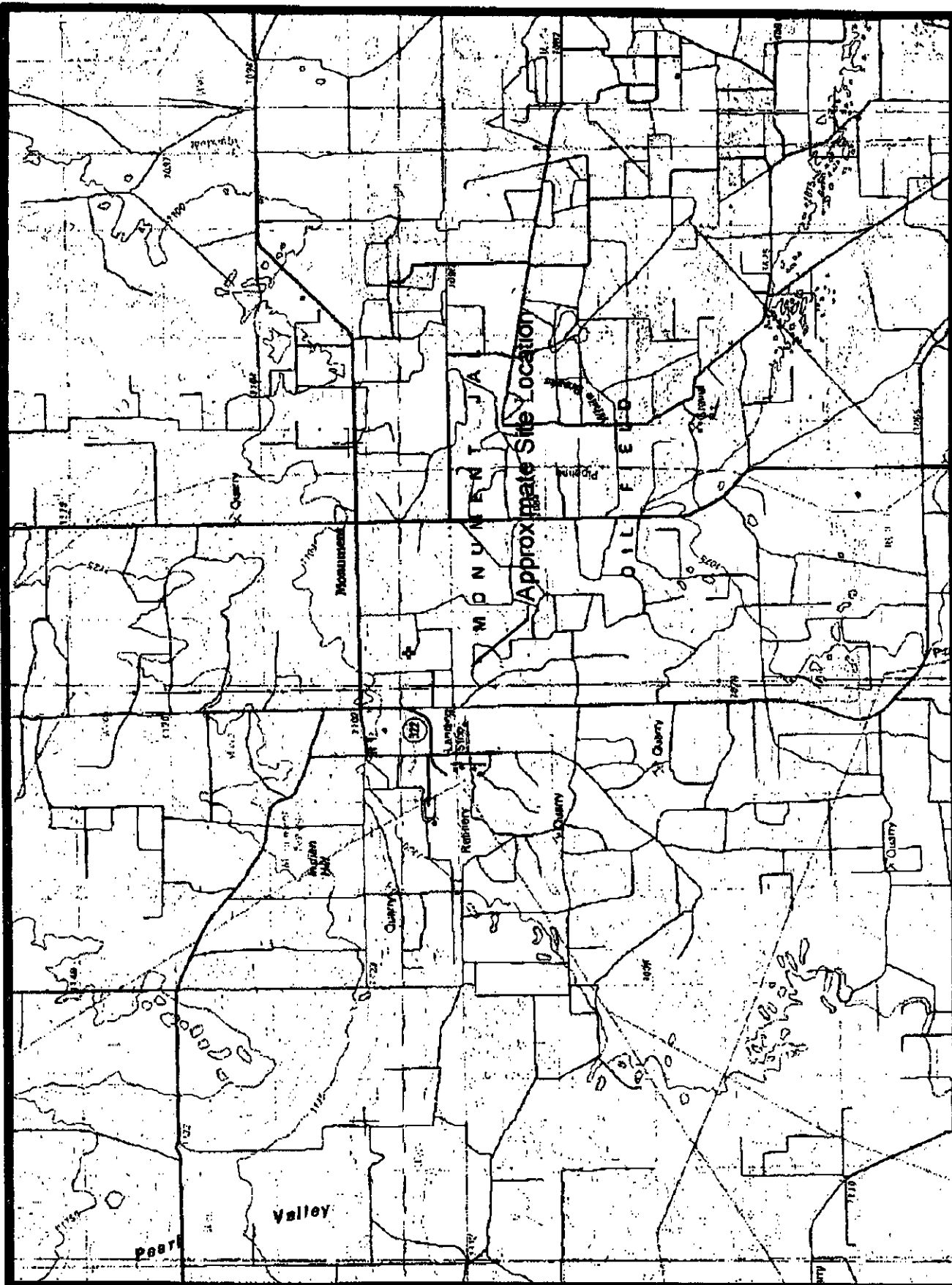

Environmental Technology
Group, Inc.

Figure 1
Site Location Map
EOTT Energy Corp.
TNM 98-02
Lea County, NM

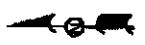

Scale: NTS
Prep By: DJ
Checked By: RD
January 23, 2001
ETG Project # E072067C

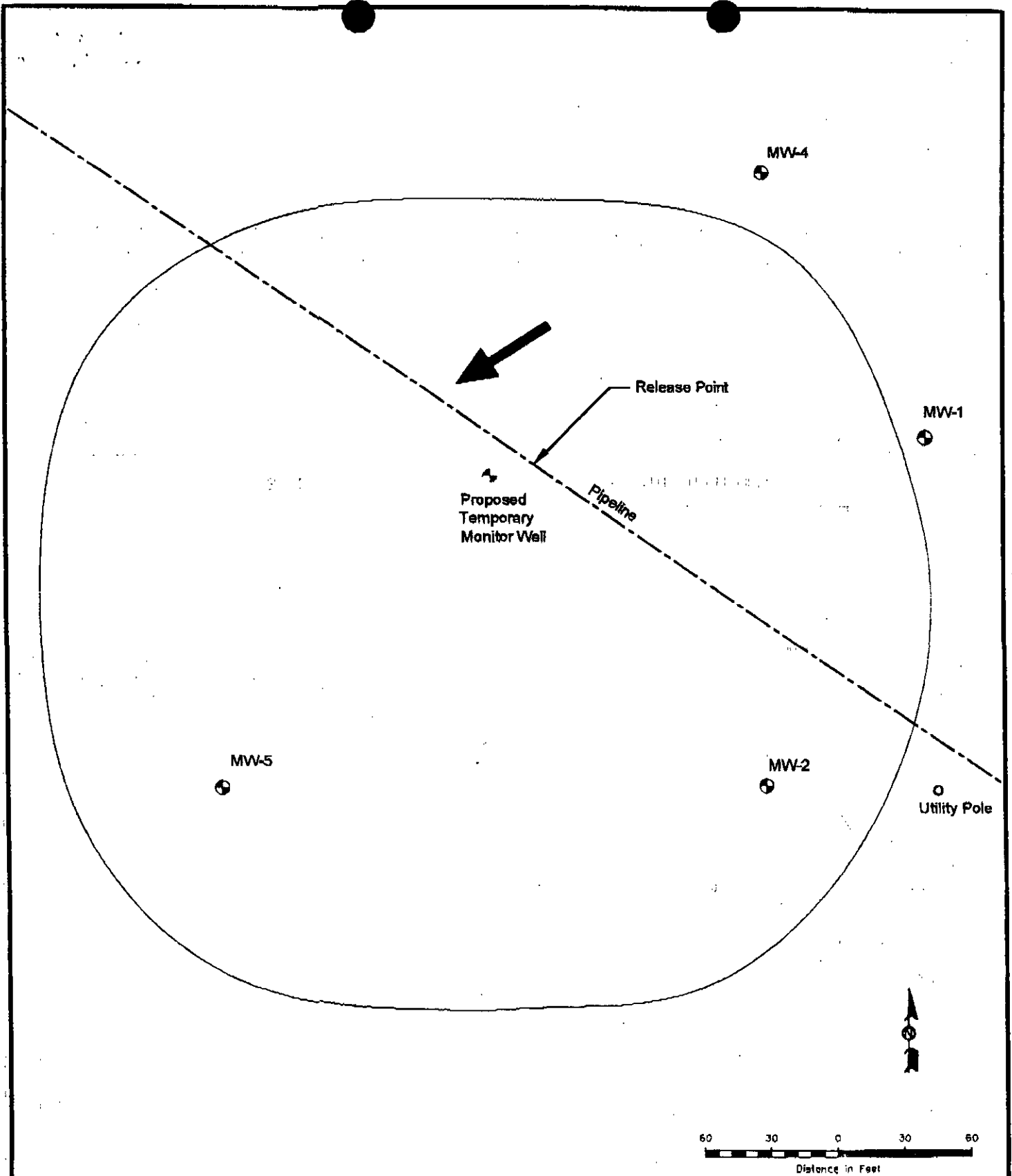
**LEGEND:**

● Monitor Well Location

Figure 2
Site Map
Proposed Temp. MW
EOTT Energy Corp.
TNM 98-02
Lea County, NM



Environmental Technology
Group, Inc.

Scale: 1" = 60' Prep By: JDI Checked By: BA
January 26, 2001 ETGI Project # EOT2068C

TABLES

Table 1

CONCENTRATIONS OF BTEX IN GROUNDWATER

EOTT ENERGY PIPELINE LIMITED PARTNERSHIP

TNM 98-02

MONUMENT(LEA COUNTY), NEW MEXICO

ETGI Project # EOT 2068C

All concentrations are in mg/L

SAMPLE DATE	SAMPLE LOCATION	SW 846-8021B, 5030				
		BENZENE	TOLUENE	ETHYL-BENZENE	M,P-XYLENES	O-XYLENES
11/30/99	MW-1	<0.001	<0.001	<0.001	<0.001	<0.001
3/9/00	MW-1	<0.001	<0.001	<0.001	<0.001	<0.001
5/19/00	MW-1	<0.001	<0.001	<0.001	<0.001	<0.001
8/30/00	MW-1	<0.001	<0.001	<0.001	<0.001	<0.001
11/30/99	MW-2	<0.001	<0.001	<0.001	<0.001	<0.001
3/9/00	MW-2	<0.001	<0.001	<0.001	<0.001	<0.001
5/19/00	MW-2	<0.001	<0.001	<0.001	<0.001	<0.001
8/30/00	MW-2	<0.001	<0.001	<0.001	<0.001	<0.001
11/30/99	MW-4	<0.001	<0.001	<0.001	<0.001	<0.001
3/9/00	MW-4	<0.001	<0.001	<0.001	<0.001	<0.001
5/19/00	MW-4	<0.001	<0.001	<0.001	<0.001	<0.001
8/30/00	MW-4	<0.001	<0.001	<0.001	<0.001	<0.001
11/30/99	MW-5	0.003	0.002	<0.001	0.001	<0.001
3/9/00	MW-5	0.006	<0.001	0.001	0.002	<0.001
5/19/00	MW-5	0.008	<0.001	<0.001	<0.001	<0.001
8/30/00	MW-5	0.002	<0.001	<0.001	<0.001	<0.001

ENVIRONMENTAL LAB OF , INC.

"Don't Treat Your Soil Like Dirt!"

ENVIRONMENTAL TECHNOLOGY GROUP, INC.
ATTN: BETH ALDRICH
P.O. BOX 4845
MIDLAND, TEXAS 79704
FAX: 915-520-4310

Sample Type: Water
Sample Condition: Intact/ Iced/ HCI/ 30 deg. F
Project #: EOT 2058C
Project Name: TNM 98-02
Project Location: Monument, N.M.

Sampling Date: 08/30/00
Receiving Date: 09/01/00
Analysis Date: 09/05/00

ELT#	FIELD CODE	BENZENE mg/L	TOLUENE mg/L	ETHYLBENZENE mg/L	m,p-XYLENE mg/L	o-XYLENE mg/L	TOTAL BTEX mg/L
30311	MW 1	<0.001	<0.001	<0.001	<0.001	<0.001	<0.001

% IA	103	100	103	106	99
% EA	104	104	106	110	102
BLANK	<0.001	<0.001	<0.001	<0.001	<0.001

METHODS: SW 846-8021B,5030

Ralene K. Tuttle

9-12-00
Date

ENVIRONMENTAL LAB OF , INC.

"Don't Treat Your Soil Like Dirt!"

ENVIRONMENTAL TECHNOLOGY GROUP, INC.

ATTN: BETH ALDRICH

P.O. BOX 4845

MIDLAND, TEXAS 79704

FAX: 915-520-4310

SampleType: Water

Sample Condition: Intact/ Iced/ HCl/ 30 deg. F

Project #: EOT 2068C

Project Name: TNM 98-02

Project Location: Monument, N.M.

Sampling Date: 08/30/00

Receiving Date: 09/01/00

Analysis Date: 09/06/00

ELT#	FIELD CODE	BENZENE mg/L	TOLUENE mg/L	ETHYLBENZENE mg/L	m,p-XYLENE mg/L	o-XYLENE mg/L	TOTAL BTX mg/L
30312	MW 2	<0.001	<0.001	<0.001	<0.001	<0.001	<0.001
30313	MW 4	<0.001	<0.001	<0.001	<0.001	<0.001	<0.001
30314	MW 5	0.002	<0.001	<0.001	<0.001	<0.001	0.002
30315	EB 1	<0.001	<0.001	<0.001	<0.001	<0.001	<0.001

% IA	96	94	96	98	92
% EA	95	94	95	95	91
BLANK	<0.001	<0.001	<0.001	<0.001	<0.001

METHODS: SW 846-8021B.5030

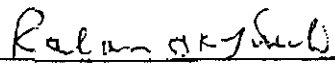
Ralston K. Tuttle

9-12-00
Date

ENVIRONMENTAL LAB OF , INC.

"Don't Treat Your Soil Like Dirt!"

ENVIRONMENTAL TECHNOLOGY GROUP, INC.

ATTN: MR. JESSE TAYLOR

P.O. BOX 4845

MIDLAND TEXAS 79704

FAX: 915-520-4310

FAX: 505-392-3780

SampleType: Water

Sample Condition: Intact/ Iced/HCl/ 50 deg. F

Project #: EOT 2015C

Project Name: TNM 98-02

Project Location: Monument N.M.

Sampling Date: 05/19/00

Receiving Date: 05/22/00

Analysis Date: 05/27 & 05/28/00

ELT#	FIELD CODE	BENZENE mg/L	TOLUENE mg/L	ETHYLBENZENE mg/L	m,p-XYLENE mg/L	o-XYLENE mg/L
25947	MW 1	<0.001	<0.001	<0.001	<0.001	<0.001
25948	MW 2	<0.001	<0.001	<0.001	<0.001	<0.001
25949	MW 4	<0.001	<0.001	<0.001	<0.001	<0.001
25950	MW 5	0.006	<0.001	<0.001	<0.001	<0.001

% IA	97	94	95	102	94
% EA	94	91	93	98	81
BLANK	<0.001	<0.001	<0.001	<0.001	<0.001

METHODS: SW 846-8021B.5030

Roland K. Tuttle

5-30-00
Date

Environmental Lab of Texas, Inc. 12500 West I-20 East Odessa, Texas 79763
(915) 563-1800 FAX (915) 561-1713

Project Manager: *Jesse T. Moore*
Phone #: (505) 342-8731
FAX #: (505) 392-3760

Company Name & Address: *ETL*
P.O. Box 4845 Midland TX 79701

Project #: *LOT 205C*
Project Name: *TMM 98-02*

Project Location: *Monument, NM*
Sampler Signature: *[Signature]*

LAB # (LAB USE ONLY)	FIELD CODE	# CONTAINERS	Volume/Amount	MATRIX						PRESERVATIVE METHOD				SAMPLING	
				WATER	SOIL	AIR	SLUDGE	OTHER	HCL	HNO3	ICE	NONE	OTHER	DATE	TIME
25947	MW 1	2	V	X						X				5-19-98	0845
25948	MW 2													5-19-98	0925
25949	MW 4													5-19-98	1005
25950	MW 5													5-19-98	0915

Requisitioned by: <i>[Signature]</i>	Date: <i>5-19-98</i>	Thrust: <i>1400</i>	Remarks: <i>MAIN RECORDS: K. DUTTON</i>
Requisitioned by: <i>[Signature]</i>	Date: <i>22 MAR 98</i>	Thrust: <i>1114</i>	Remarks: <i>Rec 56°F</i>
Requisitioned by: <i>[Signature]</i>	Date: <i>10/15/98</i>	Thrust: <i>1015</i>	Remarks: <i>INVEST: EOT 10/15/98</i>

CHAIN-OF-CUSTODY RECORD AND ANALYSIS REQUEST

COC # 141

ANALYSIS REQUEST

TCLP Metals Ag As Ba Cd Cr Pb Hg Se
TCLP Volatiles
TCLP Semi Volatiles
TOS
RCI

BTEX HAPs

TPH 418.3

ENVIRONMENTAL LAB OF , INC.

"Don't Treat Your Soil Like Dirt!"

ENVIRONMENTAL TECHNOLOGY GROUP, INC.

ATTN: MR. JESSE TAYLOR

P.O. BOX 4845

MIDLAND, TEXAS 79704

FAX: 915-520-4310

FAX: 505-382-3760

SampleType: Water

Sample Condition: Intact/ Iced/HCl

Project #: EOT 1015C

Project Name: TNM 98-02

Project Location: Monument, N.M.

Sampling Date: 03/09/00

Receiving Date: 03/10/00

Analysis Date: 3/14-3/15/00

ELT#	FIELD CODE	BENZENE mg/L	TOLUENE mg/L	ETHYLBENZENE mg/L	m,p-XYLENE mg/L	o-XYLENE mg/L
24120	MW-1	<0.001	<0.001	<0.001	<0.001	<0.001
24121	MW-2	<0.001	<0.001	<0.001	<0.001	<0.001
24122	MW-4	<0.001	<0.001	<0.001	<0.001	<0.001
24123	MW-5	0.006	<0.001	0.001	0.002	<0.001

% IA	103	94	94	102	90
% EA	95	85	83	92	82
BLANK	<0.001	<0.001	<0.001	<0.001	<0.001

METHODS: SW 846-8021B,5030

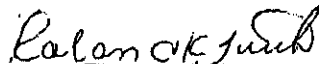
Roland K. Tuttle

3-16-00
Date

Environmental Lab of Texas, Inc. 12600 West I-20 East Odessa, Texas 79763
 (915) 563-1880 FAX (915) 563-1713

CHAIN-OF-CUSTODY RECORD AND ANALYSIS REQUEST

COC 103

Project Manager: Jesse Taylor Phone #: (915) 664-9161
 FAX #: (805) 398-8260

Company Name & Address: ETC
P.O. Box 4845 MIDLAND TX 79704

Project #: LOT 1015C Project Name: TNM 98-02

Project Location: Monument NM Sampler Signature: [Signature]

LAB # (LAB USE ONLY)	FIELD CODE	# CONTAINERS	Volume/Amount	MATRIX				PRESERVATIVE METHOD				DATE	SAMPLING TIME
				WATER	SOIL	AIR	SLUDGE	OTHER	HCL	HNO3	ICE		
24/20	MW1	2	V	X					X	X		29	1337
24/21	MW2	1	V										1405
24/22	MW4	1	V										1349
24/23	MW5	1	V										1315

TPH 418.1	
TCLP Metals Ag As Ba Cd Cr Pb Hg Se	
Total Metals Ag As Ba Cd Cr Pb Hg Se	
TCLP Volatiles	
TCLP Sem Volatiles	
TDS	
RCI	

Relinquished by: <u>[Signature]</u>	Date: <u>3-10-00</u>	Time: <u>1600</u>	Received by: <u>[Signature]</u>	Time: <u>1600</u>
Relinquished by: <u>[Signature]</u>	Date: <u></u>	Time: <u></u>	Received by: <u>[Signature]</u>	Time: <u></u>
Relinquished by: <u></u>	Date: <u></u>	Time: <u></u>	Received by: <u></u>	Time: <u></u>

REMARKS: MAIL RESULTS: K. DUTTON
INVOICE: LORIAN FASO 1015m

Environmental Lab of Texas, Inc. 12600 West 1-20 East Odessa, Texas 79763
(915) 563-1800 FAX (915) 563-1713

CHAIN-OF-CUSTODY RECORD AND ANALYSIS REQUEST

046

Project Manager:

Jesse Taylor

Phone #: (915) 44-4168

FAX#:(505) 392-3768

Company Name & Address:

...: F762
P.O. Box 4845

Project: NAME

TM 98-02

~~SECRET~~

25/01/03

Project Locations

Sample Signature:

McKusick, N. N.

Superior

LAB # (LAB USE ONLY)	FIELD CODE	# CONTAINERS	Volume/Amount	MATRIX				PRESERVATIVE METHOD				SAMPLING		TPH 418.1	TCLP Metals Ag As B	Total Metals Ag As B	TCLP Volatiles	TCLP Semi Volatiles	TDS	RCI		
				WATER	SOIL	AIR	SLUDGE	OTHER	HCL	HNO3	ICE	NONE	OTHER								DATE	TIME
21940	MW 1	2	✓	✓				X				X	11-30	1345	X							
21941	MW 2	2	✓	✓										1322								
21942	MW 4	2	✓	✓										1301								
21943	MW 5	2	✓	✓										1330	✓							

Released by

Jim Case

Date:

66-2-21

Time:

0906

Received by

207

5,167,930

Wm. Roselli, Gen. In Town

Relinquished by:

2

Date: _____

4

Abstract

1

Received by

1



NEW MEXICO ENERGY, MINERALS and NATURAL RESOURCES DEPARTMENT

GARY E. JOHNSON

Governor

Jennifer A. Salisbury

Cabinet Secretary

Lori Wrotenbery

Director

Oil Conservation Division

October 30, 2000

CERTIFIED MAIL

RETURN RECEIPT NO: 5051-3730

Mr. Glenn Waldrop
EOTT Energy Pipeline Limited Partnership
P.O. Box 1660
Midland, Texas 79702

**RE: TNM-98-02 LEAK SITE
LEA COUNTY, NEW MEXICO**

Dear Mr. Waldrop:

The New Mexico Oil Conservation Division (OCD) has reviewed EOTT Energy Pipeline Limited Partnership's (EOTT) September 21, 2000 correspondence titled "EOTT TNM 98-02 LEAK SITE" which was submitted on behalf of EOTT by their consultant Environmental Technology Group, Inc. This document contains a summary of ground water analytical sampling results from the site monitor wells and requests closure of the remediation and monitoring actions.

The remediation actions conducted to date appear satisfactory. However, the OCD has the following comments and requests for information regarding the above referenced document:

1. A review of the records on this site shows that there are no results of ground water sampling directly adjacent to the source of contamination. The OCD requires that EOTT submit a plan to install a ground water monitoring well directly adjacent to and downgradient of the excavated area. If a one time sample from this area is below the standards of OCD Rule 19.B., then the OCD will issue closure approval for the site. Please submit the work plan to the OCD Santa Fe Office by November 30, 2000 with a copy provided to the OCD Hobbs District Office.
2. The document does not contain the laboratory analytical results and associated quality assurance/quality control data for the referenced ground water samples, nor a ground water gradient map for each sampling event. Please provide this information.

If you have any questions, please contact me at (505) 827-7154.

Sincerely,

A handwritten signature in black ink, appearing to read "Will Olson". The signature is fluid and cursive, with the first name "Will" and the last name "Olson" clearly distinguishable.

William C. Olson
Hydrologist
Environmental Bureau

xc: Chris Williams, OCD Hobbs District Office
Beth Aldrich, Environmental Technology Group, Inc.

September 21, 2000

Mr. Bill Olson
New Mexico Oil Conservation Division
Environmental Bureau
2040 South Pacheco
Santa Fe, NM 87505

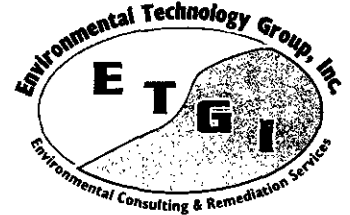

RECEIVED

CCT 04 2000

ENVIRONMENTAL BUREAU
OIL CONSERVATION DIVISION

RE: EOTT TNM 98-02 Leak Site

Mr. Olson:

On behalf of EOTT Energy Pipeline, Environmental Technology Group, Inc. (ETGI) submits the following request for site closure at the EOTT TNM 98-02 Leak Site in NE ¼, SE ¼, Section 31, Township 19 South, Range 37 East, in Lea County, New Mexico. As per your requirements, we have completed four consecutive quarters of ground water sampling for the five monitoring wells at the site, with no analytical results above the New Mexico Water Quality Control Commission (NMWQCC) standards for the monitored contaminants of concern (COC).

Please find attached Table 1, a summary of the analytical testing from November 1999 through August 2000, a period of four consecutive quarterly sampling events. As indicated by the results, no COC has been above the NMWQCC limits during the sampling period.

We are requesting approval for closure of this site, plugging and abandoning the monitoring wells, returning the surface to its original contour and reseeding the affected areas at the site. A closure report will follow on completion of these activities.

If you have any questions or comments, please contact me at (505) 397-4882. Thank you.

Sincerely,

Beth Aldrich
Geologist/New Mexico Area Manager

Cc: Glenn Waldrop, EOTT Energy Corp.
Jerry Nickel, ETGI - Midland

Table 1

CONCENTRATIONS OF BTEX IN GROUNDWATER

EOTT ENERGY PIPELINE LIMITED PARTNERSHIP

TNM 98-02

MONUMENT(LEA COUNTY), NEW MEXICO

ETGI Project # EOT 2068C

All concentrations are in mg/L

SAMPLE DATE	SAMPLE LOCATION	SW 846-8021B, 5030				
		BENZENE	TOLUENE	ETHYL-BENZENE	M,P-XYLENES	O-XYLENES
11/30/99	MW-1	<0.001	<0.001	<0.001	<0.001	<0.001
3/9/00	MW-1	<0.001	<0.001	<0.001	<0.001	<0.001
5/19/00	MW-1	<0.001	<0.001	<0.001	<0.001	<0.001
8/30/00	MW-1	<0.001	<0.001	<0.001	<0.001	<0.001
11/30/99	MW-2	<0.001	<0.001	<0.001	<0.001	<0.001
3/9/00	MW-2	<0.001	<0.001	<0.001	<0.001	<0.001
5/19/00	MW-2	<0.001	<0.001	<0.001	<0.001	<0.001
8/30/00	MW-2	<0.001	<0.001	<0.001	<0.001	<0.001
11/30/99	MW-4	<0.001	<0.001	<0.001	<0.001	<0.001
3/9/00	MW-4	<0.001	<0.001	<0.001	<0.001	<0.001
5/19/00	MW-4	<0.001	<0.001	<0.001	<0.001	<0.001
8/30/00	MW-4	<0.001	<0.001	<0.001	<0.001	<0.001
11/30/99	MW-5	0.003	0.002	<0.001	0.001	<0.001
3/9/00	MW-5	0.006	<0.001	0.001	0.002	<0.001
5/19/00	MW-5	0.006	<0.001	<0.001	<0.001	<0.001
8/30/00	MW-5	0.002	<0.001	<0.001	<0.001	<0.001

EOTT ENERGY Pipeline Limited Partnership

P.O. BOX 1660
5805 E. BUSINESS 20
MIDLAND, TEXAS 79702
(915) 682-3761

FEDERAL EXPRESS
AIR BILL # 8170 0342 3660

March 30, 2000

State of New Mexico
Oil Conservation Division
2040 S. Pacheco
Santa Fe, NM 87505
Attn: William Olson

RE: ANNUAL GROUND WATER MONITORING REPORTS

Dear Mr. Olson:

Attached please find the 2000 Annual Groundwater Monitoring Reports for the following sites:

Monument #18	Monument #10
Monument #17	TNM-97-16 (Becky Jo Doom site)
Monument #2	HDO-90-23
Monument #15	SPS-11
TNM-97-17	TNM-98-02
TNM-97-18	TNM-98-S01
TNM-98-05A	TNM-97-23
TNM-96-16	TNM-95-10 (Saunders)
TNM-97-14	TNM-97-04 (Townsend)

I hope all meets with OCD requirements for closure of the site but if you have any questions, please don't hesitate to call me at 915/684-3467.

Sincerely,



Lennah Frost
Sr. Environmental Engineer

cc: Environmental File

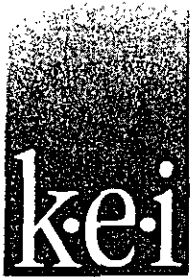

5309 Wurzbach, Suite 100
San Antonio, Texas 78238
(210) 680-3767
(210) 680-3763 FAX

October 29, 1998

RECEIVED

Mr. Tony Savoie
TEXAS - NEW MEXICO PIPE LINE COMPANY
P.O. Box 1030
Jal, New Mexico 88252

NOV 09 1998

ENVIRONMENTAL BUREAU
OIL CONSERVATION DIVISION

Re: Monitoring Wells MW-1 through MW-5
Soil Borings SB-1 through SB-10
TNM-98-02
Unit J, Section 31, Township 19 South, Range 37 East
Lea County, New Mexico
Job No. 810044-1

Dear Mr. Savoie:

Transmitted with this letter is the final Subsurface Investigation Report for the installation of monitoring wells MW-1 through MW-5 and soil borings SB-1 through SB-10 at TNM-98-02 in Lea County, New Mexico.

Please contact me at (210) 680-3767 with your comments or suggested changes.

Respectfully,

A handwritten signature in cursive script that reads 'Theresa Nix'. The signature is written in dark ink and is positioned below the word 'Respectfully,'.

Theresa Nix
Project Manager

Enclosure

cc: Marc Oler, Equilon
William Olson, OCD Santa Fe ✓
OCD Hobbs Office

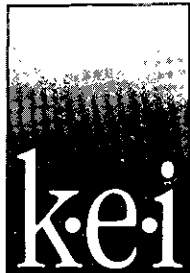

5309 Wurzbach, Suite 100
San Antonio, Texas 78238
(210) 680-3767
(210) 680-3763 FAX

August 3, 1998

Mr. Roger Anderson
STATE OF NEW MEXICO
Oil Conservation Division
2040 South Pacheco
Santa Fe, New Mexico 87505

RECEIVED
AUG - 6 1998
OIL CONSERVATION DIVISION

Re: Texas-New Mexico Pipe Line Company
TNM-98-02
Section 31, Township 19 South, Range 37 East
Lea County, New Mexico
Job No. 810044-1

Dear Mr. Anderson:

This letter provides written notification of hydrocarbon impact to ground water at the above referenced site during monitoring well installation activities.

On August 2, 1998, apparent phase-separate hydrocarbons (PSH) was observed in a 2" diameter monitoring well (designated MW-3) located on the above referenced site, following installation of that well. The apparent PSH was observed in a sand layer approximately 29 feet below ground surface during drilling. Mr. Tony Savoie of Texas - New Mexico Pipe Line Company (TNMPL) notified you of this discovery on August 3, 1998, at 8:30 a.m., by telephone.

If you have any questions please contact Mr. Savoie at (505) 395-2705 or call me at (210) 680-3767.

Respectfully,

for

Theresa Nix
Project Manager

cc: TNMPL, Tony Savoie
OCD Hobbs District Office, Wayne Price