

RELEASE REPORT

DISTRICT I
P.O. Box 1980, Hobbs, NM 88240

DISTRICT II
P.O. Drawer DD, Artesia, NM 88210

DISTRICT III
1000 Rio Brazos Rd., Aztec, NM 87410

OIL CONSERVATION DIVISION
310 Old Santa Fe Trail, Room 206
Santa Fe, New Mexico 87503

WELL API NO.

5. Indicate Type of Lease

STATE ☐

FEE ☒

6. State Oil & Gas Lease No.

SUNDRY NOTICES AND REPORTS ON WELLS
(DO NOT USE THIS FORM FOR PROPOSALS TO DRILL OR TO DEEPEN OR PLUG BACK TO A
DIFFERENT RESERVOIR. USE "APPLICATION FOR PERMIT"
(FORM C-101) FOR SUCH PROPOSALS.)

1. Type of Well:

OIL
WELL ☐

GAS
WELL ☐

OTHER

2. Name of Operator

Texas-New Mexico Pipe Line Co.

3. Address of Operator

P.O. Box 60028 San Angelo Texas

4. Well Location

Unit Letter

Feet From The

Line and

Feet From The

Line

NW 1/4 OF NW 1/4

Section 14

Township

22 S

Range

37 E

NMPM

Lea

County

10. Elevation (Show whether DF, RKB, RT, GR, etc.)

11. Check Appropriate Box to Indicate Nature of Notice, Report, or Other Data

NOTICE OF INTENTION TO:

PERFORM REMEDIAL WORK ☒

PLUG AND ABANDON ☐

TEMPORARILY ABANDON ☐

CHANGE PLANS ☐

PULL OR ALTER CASING ☐

OTHER: ☐

SUBSEQUENT REPORT OF:

REMEDIAL WORK ☐

ALTERING CASING ☐

COMMENCE DRILLING OPNS. ☐

PLUG AND ABANDONMENT ☐

CASING TEST AND CEMENT JOB ☐

OTHER: ☐

12. Describe Proposed or Completed Operations (Clearly state all pertinent details, and give pertinent dates, including estimated date of starting any proposed work) SEE RULE 1103.

See Attachments

Form PL-117 + Attachment

Env. Inc. Report

Permanent Repair Report

Site Assessment + Ranking

Analytical

Sketch of Site + Sampled Areas

Remediation Plan

Final TPH Level will be 5000 PPM Due to Shallow Vertical Extent

Landowner Has been Contacted and Approves Remedial Plan

I hereby certify that the information above is true and complete to the best of my knowledge and belief.

SIGNATURE

John A. Savoie

TITLE

Senior Tech.

DATE

10/4/95

TYPE OR PRINT NAME

John A. Savoie

TELEPHONE NO.

505-395-2705

(This space for State Use)

APPROVED BY

[Signature]

TITLE

DISTRICT 1 SUPERVISOR

DATE

OCT 06 1995

CONDITIONS OF APPROVAL, IF ANY:

OIL OR PRODUCT LOSS REPORT

Report No. TNM-43Company TEXAS NEW MEXICO PIPE LINE COMPANY Division _____Date of Loss 7-3-95 Time of Loss, if Known 1⁰⁰PM to 5⁰⁰PMAccounting Location _____ Sys. ☐ Trunk Line ☐
and Number District 0055 No. 2 Gath Line ☒ Line Size 4"Loss Reported: _____
Date 7-3-95 Time 5⁰⁰PM M. By Howard Ziegler Address _____Loss Occurred 90 Feet ☒ Miles ☐ N.E. From: ☐ Mile Post ☐ ANADARKO HUB
NW 1/4 NW 1/4 N. E. S. W. ☐ Pump Station ☐ 0055-2038
☐ Other Point ☒Section 14 Survey ☐ Township 22S Block ☐ Range 37E Parish ☐ County LEA State N.M.Property Owner WYNNE HENSON Tenant's Name UNKNOWNCause of Loss:
External Corrosion ☐ Collar ☐ Split Line ☐ Tank Run Over ☐ Bad Fitting ☐ Damaged by Others ☒ Show
Internal Corrosion ☐ Line Cut ☐ Line Parted ☐ Check Valve Failure ☐ Other (describe) ☐ Equipment Owner and how DamagedBack-Hol owned by Colborn Co. Inc. - Lined N.M. H.T. Line on 6-26-While working for WARREN Petroleum - Operator - C.W. MOTIS. - WARREN
Co. man DONALD PARKEREstimated Number _____
Barrels of Sour Lost: Gross 180 Recovered 30 Net 150If Loss on Main Line: _____ Pressure Dropped: _____
Station _____ Shut Down At _____ M. Date _____ Resumed _____
Pumping At _____ M. Date _____ From _____ # To _____Wet ☒ Sulphur ☐ Acid ☐ Sewage ☐
Nature of Soil: Dry ☐ Salt Water ☐ Alkali ☐ Other (describe) ☐Depth Line Buried 18" Coated Line: Yes ☐ No ☐Repaired: _____
By J.P. Smith & CONTRACTOR Date 7-3-95 Time 7⁰⁰PM Temporarily _____
Permanently _____Material Used 14' 4" STEEL PIPEPipe Recoated: Yes ☐ No ☐ Type Coating Used _____Number and Size Anodes Installed _____ Estimated Cost of Repairs \$ \$1,000.00Disposition of _____
Oil or Product: _____
Lost: ☐ Burned ☐ Soaked in Ground ☒ Other (describe) ☐Soaked Earth: ☐ Removed ☐ Covered ☐ Other (describe) ☐Property Damaged: _____
Land ☐ Timber ☐ Crops ☐ Pasture ☒ Live Stock ☐ Stock Water ☐ Other _____Approximate Area Covered by Oil or Product 5,850 sq. ft.

Was Consent Obtained To Burn: _____ Landowner _____ Gov't. Agency _____

Remarks: CALL IN AREA. O.C.D. CONTACTED @ 8⁰⁰PM. (BUTY)NORTH GATHERING TO JAL SOUR

RECEIVED

JUL 5 1995
OCC HUBBS
OFFICE

ATTACHMENT TO FORM PL-117

OIL LOSS REPORT # 43

AREA 5,850 (SQUARE FEET) MAXIMUM DEPTH 6" (FEET)

VOLUME 108 (CUBIC YARDS) (of soil contaminated with greater than 1 weight percent total petroleum hydrocarbons)

COMPLETE DESCRIPTION OF THE DISPOSAL OR REMEDIATION METHOD USED OR PLANNED TO BE USED FOR CLEANUP OF THE SITE:

LA-0 (PAM)

ESTIMATED DATE OF COMPLETION OF SITE CLEANUP 7-1-95 1999

[Signature]
Signature

7-3-95
Date

RECEIVED

OCT 5 1995

**UCD HUBBS
OFFICE**

ROWAGUIDELINES.RRC

Initial Report



Follow-Up Report



TMM-413

ENVIRONMENTAL INCIDENT REPORT

1. Person Filling Out This Report <u>J.P. Smith</u>		2. Company/District/Facility <u>TEXAS NEW MEXICO P/L</u>		Dist/Prop.# <u>0055-2038</u>	
Date: <u>7/3/95</u>		Landowner <u>UNKNOWN</u>		Notified: Yes <input type="checkbox"/> No <input checked="" type="checkbox"/>	
3. Location of Spill (i.e., 1/4 mile west of ..., range, section, township, etc.) (include driving directions) <u>South of Emile</u> <u>on Hwy 14 to between M.P. 28 & 29 then west</u> <u>SEC. 14 T22S R37E by CALLE P.T. TO BARLEY</u>					
4. County/State <u>LA - New Mexico</u>		5. Is Line Subject to DOT Jurisdiction? No <input checked="" type="checkbox"/> Yes <input type="checkbox"/>			
6. Part of System Involved a. Line Pipe <input checked="" type="checkbox"/> d. Truck Accident _____ b. Pump Station _____ e. Other (explain) _____ c. Tank Farm _____					
7. Cause (if b-g apply, please explain) a. Corrosion: Internal _____ External _____ b. Outside Force Damage (i.e., backhoe, road grader, etc.) <u>HIT by COLEMAN CO. HOV WHITE</u> c. Failed Weld (i.e., fillet, girth, etc.) <u>WORKING FOR WARRIOR PETROLEUM on 6-26-95</u> d. Failed Pipe (i.e., longitudinal seam split, pipe defect, etc.) _____ e. Incorrect Operation by Operator Personnel _____ f. Equipment Failure (i.e., check valve failure, broken nipple, etc.) _____ g. Other (explain) _____					
8. Diameter of Pipe <u>4"</u>		9. Date of Spill <u>7/3/95</u> Time of Spill <u>1:00</u> AM/PM Time Zone (i.e., Central, Mountain, etc.) <u>CENTRAL</u>		10. Body of Water/Water Course Involved No <input checked="" type="checkbox"/> Yes <input type="checkbox"/> (If Yes, name and type of water involved.) _____	
11. Commodity Spilled a. Crude: Sweet _____ Sour <input checked="" type="checkbox"/> b. Petroleum Product: Diesel _____ Jet Fuel _____ Gasoline _____ Other (explain) _____ c. Other (explain) _____					
12. Amount Spilled (barrels) <u>180</u>		13. Amount Recovered (barrels) <u>30</u>			
14. Cost Estimate of Property Damage (include cost of commodity not recovered, damage to other parties, and cost of clean up.) Less than \$50,000 <input checked="" type="checkbox"/> Greater than \$50,000 <input type="checkbox"/> Actual Amount (if known) _____					
15. Injuries No <input checked="" type="checkbox"/> Yes <input type="checkbox"/> If Yes, number of: Company Employees _____ Non-Employees _____ Fatalities No <input checked="" type="checkbox"/> Yes <input type="checkbox"/> If Yes, number of: Company Employees _____ Non-Employees _____					
16. Federal/State/Local Agencies Reported To (agency, person reported to, date, time) <u>STATE of NEW MEXICO O.C.D. @ 8:00 P.M. TO 13277</u>					
17. Actions Taken or Planned to Contain/Clean-Up Spill <u>AREA TO BE REMEDIATED</u>					
18. Type of Repair Performed (i.e., clamp, replacement, welded sleeve) <u>REPLACE 14' 4" P.P.C.</u>					
19. Weather Conditions on Scene (temperature, precipitation, etc.) <u>90° CLEAR SKY SOIL DAMP</u>			Description of area (i.e., farming, grazing, sandy, rocky, etc.) <u>LEASE ROAD & PASTURE</u>		
20. Press Coverage No <input checked="" type="checkbox"/> Yes <input type="checkbox"/> If Yes, explain (i.e., TV, newspaper, etc.) _____					
21. Report to Public Relations No <input checked="" type="checkbox"/> Yes <input type="checkbox"/> If Yes, Time Reported _____ AM/PM Person Reported to _____					

RECEIVED

OCT 5 1995

UCD HOBBS
OFFICE

TEXAS-NEW MEXICO PIPELINE COMPANY

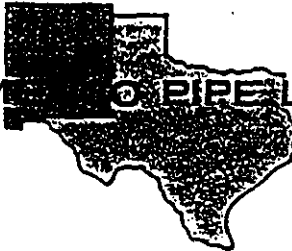

OIL LOSS --- PERMANENT REPAIRS

AREA OFFICE Enclave, N.M.

DATE 7-3-95

Permanent repairs have been made on the following leak:

OIL LOSS REPORT NO. HDO - TNM-43

INCIDENT REPORT NO. _____

LOCATION NO. 0055

DATE OF PERMANENT REPAIRS 7-3-95

INSPECTOR J.P. Smith

HOW REPAIRED AND MATERIAL USED: Replace 14' 4" steel pipe

Signed: [Signature]
Area Supervisor

Approved: _____
D. D. Beu

RECEIVED
OCT 5 1995
OCD HOBBS
OFFICE

TEXAS NEW MEXICO PIPELINE

FOR

TEXAS- NEW MEXICO PIPELINE

TOWNSHIP 22S, RANGE 37E, SECTION 14, IN THE NW1/4 OF THE NW1/4

RECEIVED
OCT 5 1985
OCC HUBBS
OFFICE

TABLE OF CONTENTS

INTRODUCTION

I. NOTICE OF LEAK, SPILL OR RELEASE

- A. RESPONSIBLE PARTY AND LOCAL CONTACT
- B. FACILITY
- C. TIME OF INCIDENT
- D. DISCHARGE EVENT
- E. TYPE OF DISCHARGE
- F. QUANTITY
- G. SITE CHARACTERISTICS
- H. IMMEDIATE CORRECTIVE ACTIONS

II. INITIAL RESPONSE ACTIONS

- A. SOURCE ELIMINATION AND SITE SECURITY
- B. CONTAINMENT
- C. SITE STABILIZATION

III. SITE ASSESSMENT

- A. GENERAL SITE CHARACTERISTICS
 - 1. Depth to Ground Water
 - 2. Wellhead Protection Area
 - 3. Distance to Nearest Surface Water Body
- B. SOIL / WASTE CHARACTERISTICS
 - 1. Unsaturated contaminated Soils
- C. GROUND WATER QUALITY

IV. SOIL AND WATER REMEDIATION ACTION LEVELS

- A. SOILS
 - 1. Unsaturated Contaminated Soils
 - a. Ranking Criteria
 - b. Recommended Remediation Level

RECEIVED
OCT 5 1995
UDD HOBBS
OFFICE

I. NOTICE OF LEAK, SPILL, OR RELEASE

A. RESPONSIBLE PARTY AND LOCAL CONTACT

TEXAS NEW MEXICO PIPELINE COMPANY, EUNICE, NEW MEXICO.
CONTACT JOHNNY CHAPMAN, AREA SUPT. 505-394-2770

B. FACILITY

A PIPELINE CONNECTED TO THE ANADARKO PETROLEUM
COMPANY - HUGH BATTERY

C. TIME OF INCIDENT

D. DISCHARGE EVENT

THE COLBORN COMPANY INC. HAD DUG OUT A PIPELINE OWNED
BY WARREN PETROLEUM OF EUNICE, NEW MEXICO, FOR REPAIR.
ON PREVIOUS DAYS. THE AREA WHERE THE WARREN
LINE WAS LEAKING IS ALSO SHARED WITH TEXAS NEW MEXICO
PIPELINE. THE TEXAS NEW MEXICO PIPELINE WAS DAMAGED
WHILE DIGGING OUT THE WARREN PETROLEUM PIPELINE
UNKNOWNINGLY. NO KNOWN VISUAL DAMAGE WAS PRESENT
TO THE TEXAS NEW MEXICO LINE, SO BACKFILL WAS DONE..
PRODUCED CRUDE OIL WAS DISCHARGED WHEN TEXAS NEW
MEXICO PIPELINE COMPANY PUT A 210 BBL. TANK ON LINE.

E. TYPE OF DISCHARGE :

CRUDE OIL

F. QUANTITY

VACUUM TRUCK PICKED UP 30 BBLs OFF OF GROUND BUT THE
LINE THAT WAS LEAKING IS ON GRAVITY FLOW. IT IS
DOUBTFUL THAT MORE THAN 60 BBLs. WAS DISCHARGED ON
THE GROUND BECAUSE OF THIS. ALSO, THE PATH THAT THE
OIL TRAVELED WAS THE SAME AS PREVIOUS FLOWS OF OIL AND
PRODUCED WATER FROM THE HUGH TANK BATTERY WHEN
MECHANICAL FAILURE OCCURED, THUS ALREADY GIVING THE
LATEST DISCHARGE A PAD TO TRAVEL ON AND REDUCING
THE AMOUNT OF ABSORPTION OF OIL INTO THE GROUND.

G. SITE CHARACTERISTICS

GENERAL CONDITIONS AT TIME OF DISCHARGE WERE AS
FOLLOWS:

DRY WITH NO MEASURABLE RAINFALL IN THE PAST 30 DAYS.
WIND S-SE AT 10-15 MPH.

TEMPERATURE- 98 DEG. F* DAYTIME AND 70 DEGREES F* NIGHT.

SOIL TYPE - SANDY TOP FOR ABOUT 4 INCHES THEN FIRM SOIL.

RECEIVED
OCT 5 1995
OCD HUBBARD
OFFICE

RECEIVED
OCT 5
OCU HUBBARD
OFFICE

NEAREST TOWN 2.5 MILES NORTH
DISTANCE TO NEAREST WATERWELL - 3/4 MILES S.-SE. OF SITE
DISTANCE TO NEAREST SURFACE WATER BODY - 10 MILES N.E. OF
SITE

H. IMMEDIATE CORRECTIVE ACTIONS

UPON NOTIFICATION OF DISCHARGE, TEXAS NEW MEXICO
PIPELINE DISPATCHED A VACUUM TRUCK TO PICK UP OIL
OFF GROUND AND ALSO REPAIRED THEIR PIPELINE.

II. INITIAL RESPONSE ACTIONS

- A. TEXAS NEW MEXICO PIPELINE DISPATCHED A VACUUM TRUCK
TO PICK UP OIL OFF GROUND AND REPAIRED THEIR PIPELINE
- B. THE OIL RAN DOWNHILL FROM LEAK SOURCE INTO A
LOW LYING AREA. PATH RANGED ANYWHERE FROM 3 FEET
TO 6 FEET WIDE AND APPROXIMATELY 300 FEET LONG.
- C. VACUUM TRUCK WAS USED TO RECOVER APPROXIMATELY 30
BARRELS OF OIL

III. SITE ASSESSMENT

A. GENERAL SITE CHARACTERISTICS

- 1. ACCORDING TO THE STATE ENGINEERS OFFICE, WATER DEPTH
IS APPROXIMATELY 65 FEET.
- 2. DISTANCE TO NEAREST WATER WELL IS 3/4 MILE S.S.E. OF SITE
- 3. DISTANCE TO NEAREST SURFACE WATER BODY IS 10 MILES.

B. SOIL / WASTE CHARACTERISTICS

- 1. NO GROUND WATER WAS ENCOUNTERED DURING
SOIL / WASTE CHARACTERIZATION OF THE IMPACTED SOIL.

IV. SOIL AND WATER REMEDIATION ACTION LEVELS

A. SOILS

- 1. SOIL WAS FOUND TO BE UNSATURATED
a. RANKING CRITERIA IS AS FOLLOWS:

DEPTH TO GROUND WATER IS 65 FEET -----10 PTS.
WELLHEAD PROTECTION AREA
3/4 MILE FROM WATER SOURCE----- 0 PTS.
3/4 MILE FROM PRIVATE DOMESTIC
WATER SOURCE-----0 PTS.

TOTAL 10 PTS.

NOTE: SOIL SAMPLES WERE TAKEN. SEE ATTACHMENT

RECEIVED
OCT 5 1995
JCD HOBBS
OFFICE



PHONE (915) 673-7001 • 2111 BEECHWOOD • ABILENE, TX 79603

PHONE (505) 393-2326 • 101 E. MARLAND • HOBBS, NM 88240

PHONE (505) 326-4669 • 118 S. COMMERCIAL AVE. • FARMINGTON, NM 87401

TPH/BTEX ANALYSIS REPORT

Company: Colburn Company
Address: P.O. Box 1804
City, State: Eunice, NM 88231

Date: 9/5/95
Lab #: H2158

Project Name: Tex-New Mexico Pipeline
Location: not given
Sampled by: RC
Analyzed by: BC, MG
Sample Type: Soil

Date: 8/28/95 Time: 1:30
Date: 8/29-30/95 Time: various
Sample Condition: Intact

Units: ppm

Samp #	Field Code	TRPHC	BENZENE	TOLUENE	ETHYL BENZENE	PARA-XYLENE	META-XYLENE	ORTHO-XYLENE
1	West	45,700	4.229	20.468	10.370	3.878	7.431	3.866
2	West Middle	6,480	0.774	0.579	0.960	0.560	1.209	1.503
3	East	38,900	2.514	0.836	0.468	0.774	2.508	2.377
4	East Middle	52,400	0.963	2.936	4.483	1.778	3.054	2.547

QC Recovery	431	0.927	0.927	0.912	0.896	0.900	0.896
QC Spike	430	0.878	0.873	0.867	0.862	0.853	0.867
Accuracy	101%	106%	106%	105%	104%	106%	103%
Air Blank	***	<0.001	<0.001	<0.001	<0.001	<0.001	<0.001

Methods - GAS CHROMATOGRAPHY; INFRARED SPECTROSCOPY
- EPA SW-846; 8020, 418.1, 3540, 3510 OR 3550

Gayle A. Potter

Date

RECEIVED
OCT 5 1995
HOBBS
OFFICE

09/06/95



PHONE (915) 873-7001 • 2111 BEECHWOOD • ABILENE, TX 79603

PHONE (505) 393-2326 • 101 E. MARLAND • HOBBS, NM 88240

PHONE (505) 328-4669 • 118 S. COMMERCIAL AVE. • FARMINGTON, NM 87401

TCLP ANALYSIS REPORT

Company: Colbarn Company
Address: P.O. Box 1804
City, State: Eunice, NM 88231

Date: 9/6/95
Lab #: H2158-3

Project Name: Tex-New Mexico Pipeline
Location: not given
Sampled by: RC
Sample Type: Soil
Sample ID: East

Date: 8/28/95
Sample Condition: Intact

TCLP INORGANICS (Leachate)

PARAMETER	RESULT	EPA LIMIT	UNITS
Silver	<0.1	5	ppm
Arsenic	<0.1	5	ppm
Barium	1.2	100	ppm
Cadmium	<0.1	1	ppm
Chromium	<0.1	5	ppm
Mercury	<0.1	0.2	ppm
Lead	<0.1	5	ppm
Selenium	<0.1	1	ppm

RECEIVED

OCT 5 1995
OGU HOBBS
OFFICE

METHODS: TCLP INORGANICS (Leachate) - EPA 1311,600/4-91/010

Gayle A. Potter

09/06/95
Date

Chain of Custody Record

Project Location:

Sampled By RACE Colborn
Client Name TEX-NEW Mexico Pipeline Colborn Co.

Address 524 TEXAS AVE

Telephone 505-294-2463 FAX 394-2281

[illegible]

PLEASE NOTE: Liability and Damages. Cardinal's liability and client's exclusive remedy for any claim arising, whether based in contract or tort, shall be limited to the amount paid by client for the analyses. All claims, including those for negligence and any other cause whatsoever shall be deemed waived unless made in writing and received by Cardinal within thirty (30) days after completion of the applicable service. In no event shall Cardinal be liable for incidental or consequential damages, including, without limitation, business interruptions, loss of use, or loss of profits incurred by client, its subsidiaries, affiliates or successors arising out of or related to the

Released by: (Signature)	Date	Time	Received by: (Signature)
<i>Rene Colwell</i>	9/28	2:15 pm	<i>Eric Casol Stevens</i>
Released by: (Signature)	Date	Time	Received by: (Signature)

ENVIRONMENTAL LAB OF , INC.

"Don't Treat Your Soil Like Dirt!"

TEXAS NEW MEXICO PIPE LINE COMPANY
ATTN: MR. TONY SAVOIE
P.O. BOX 1030
JAL, NM 88252
FAX: 505-650-0624

Receiving Date: 09/29/95
Sample Type: SOIL
Project Name: TNM 43-95

Analysis Date: 10/02/95
Sampling Date: 09/29/95
Sample Condition: Intact / loosed

ELT#	FIELD CODE	TPH (mg/kg)	IGNITABILITY (Deg. F)
6015	BOTTOM HOLE 1'	18,100	>150
6016	BOTTOM HOLE 2'	1,270	
6017	BOTTOM HOLE 18"	70	
6018	BOTTOM HOLE 3'	400	
QUALITY CONTROL		484	
TRUE VALUE		466	
% PRECISION		104	

METHODS: EPA 418.1, SW 846-1010

Michael R. Fowler

10-2-95
Date

RECEIVED
OCT 5 1995
OCD HOBBS
OFFICE

CITIZENSHIP RECORD AND ANALYSIS REQUEST

Phone #:

FAX#: 714

Texas University P. Poling

Project Name :

Sampler Signature:[illegible]

Received by:

Date:	Times:
--------------	---------------

Received by:

Date: _____ **Times:** _____

Received by Laboratory:

Date:	Times:
--------------	---------------

REMARKS

REF TNM-43-95

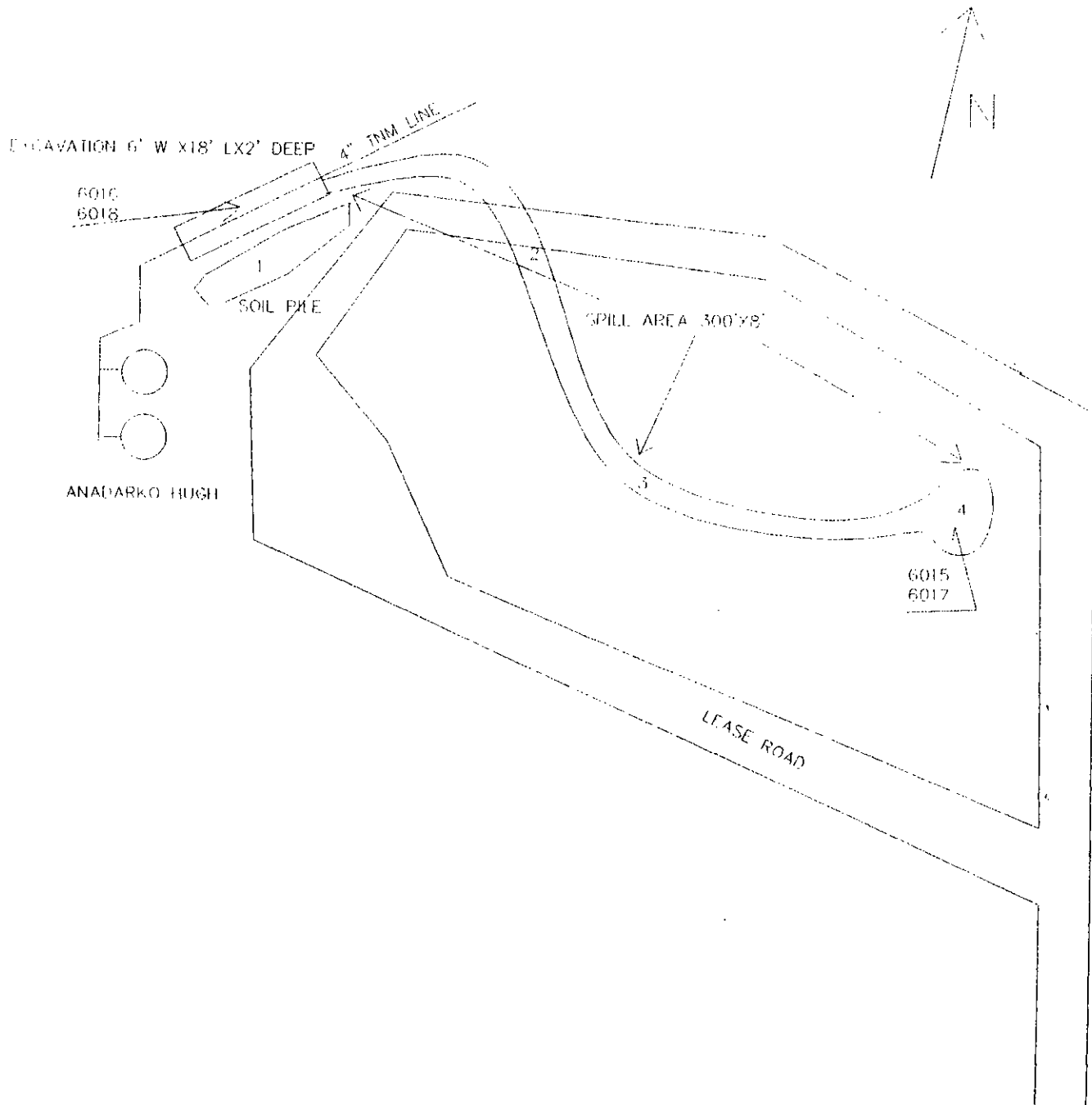

RECEIVED

OCT 5 1995

JCD HOBBS
OFFICE

SAMPLE REFERENCE

CARDINAL LAB SAMPLE I.D.

SAMPLE #1- SOIL PILE AT THE EXCAVATED AREA
SAMPLE #2- SURFACE SPILL AREA S.E. OF LEASE ROAD
SAMPLE #3- SURFACE MIDDLE OF SPILL AREA
SAMPLE #4- SURFACE WEST OF LEASE ROAD

ENVIRONMENTAL LAB OF TEXAS INC.

SAMPLE 6015-AREA WHERE OIL ACCUMULATED DEPTH OF SAMPLE 1 FT.
SAMPLE 6016-EXCAVATED AREA BOTTOM OF HOLE DEPTH 2 FT.
SAMPLE 6017-AREA WHERE OIL ACCUMULATED DEPTH OF SAMPLE 18 INCHES
SAMPLE 6018-EXCAVATED AREA DEPTH OF SAMPLE 3 FT.

Ref. 261 Appendix 2 CFR 40 1.2

Samples For BTEX utilized 20:1 dilution ✓

RECEIVED
JUL 5 1995
JCD HOBBS
OFFICE

REMEDIAL WORK PLAN

Upon O.C.D. approval, Texas New Mexico Pipe Line Company beginning October 9, 1995 will perform the following remedial clean up of spill ref# TNM-43-95.

PHASE 1- The area described as the spill area, defined as an area of 300'x8' will be scraped at a depth of aprox. 2 inches to remove oil packed and hardened soil which apparently had been involved in previous spills from equipment failure at the tank battery location. The scraped soil will be placed around the excavated area.

PHASE 2- The scraped area will be plowed and fertilized.

PHASE 3- The oil contaminated soil around the excavated area along with the soil pile will be blended with fresh soil until the TPH level is below 5000 PPM and placed back in the excavated area.

PHASE 4- The plowed and fertilized area will be composite sampled 30 days after treatment and determined if further remedial work will be needed. This treatment will be repeated monthly or until the soil TPH levels are below 5000 PPM.

CLOSURE- Texas New Mexico Pipe Line Company will submit a closure report within 30 days after achieving a clean up level of 5000 PPM. Soil sampling will include a BTEX head space measurement upon closure.

John A. Savoie

RECEIVED

OCT 5 1995

OCD HOBBS
OFFICE