

Revised March 23, 2017

RECEIVED:	REVIEWER:	TYPE:	APP NO:
-----------	-----------	-------	---------

ABOVE THIS TABLE FOR OCD DIVISION USE ONLY

NEW MEXICO OIL CONSERVATION DIVISION
 - Geological & Engineering Bureau -
 1220 South St. Francis Drive, Santa Fe, NM 87505



ADMINISTRATIVE APPLICATION CHECKLIST

THIS CHECKLIST IS MANDATORY FOR ALL ADMINISTRATIVE APPLICATIONS FOR EXCEPTIONS TO DIVISION RULES AND REGULATIONS WHICH REQUIRE PROCESSING AT THE DIVISION LEVEL IN SANTA FE

Applicant: _____ OGRID Number: _____
 Well Name: _____ API: _____
 Pool: _____ Pool Code: _____

SUBMIT ACCURATE AND COMPLETE INFORMATION REQUIRED TO PROCESS THE TYPE OF APPLICATION INDICATED BELOW

1) **TYPE OF APPLICATION:** Check those which apply for [A]

A. Location – Spacing Unit – Simultaneous Dedication

☐ NSL ☐ NSP (PROJECT AREA) ☐ NSP (PRORATION UNIT) ☐ SD

B. Check one only for [I] or [II]

[I] Commingling – Storage – Measurement

☐ DHC ☐ CTB ☐ PLC ☐ PC ☐ OLS ☐ OLM

[II] Injection – Disposal – Pressure Increase – Enhanced Oil Recovery

☐ WFX ☐ PMX ☐ SWD ☐ IPI ☐ EOR ☐ PPR

2) **NOTIFICATION REQUIRED TO:** Check those which apply.

- A. ☐ Offset operators or lease holders
 B. ☐ Royalty, overriding royalty owners, revenue owners
 C. ☐ Application requires published notice
 D. ☐ Notification and/or concurrent approval by SLO
 E. ☐ Notification and/or concurrent approval by BLM
 F. ☐ Surface owner
 G. ☐ For all of the above, proof of notification or publication is attached, and/or,
 H. ☐ No notice required

FOR OCD ONLY

- ☐ Notice Complete
☐ Application Content Complete

3) **CERTIFICATION:** I hereby certify that the information submitted with this application for administrative approval is **accurate** and **complete** to the best of my knowledge. I also understand that **no action** will be taken on this application until the required information and notifications are submitted to the Division.

Note: Statement must be completed by an individual with managerial and/or supervisory capacity.

Print or Type Name

Date

Phone Number

Signature

e-mail Address



Adam G. Rankin
Phone (505) 954-7294
Fax (505) 819-5579
AGRankin@hollandhart.com

March 11, 2022

VIA ONLINE FILING

Adrienne Sandoval
Director, Oil Conservation Division
New Mexico Department of Energy,
Minerals and Natural Resources
1220 South Saint Francis Drive
Santa Fe, New Mexico 87505

Re: Application of Matador Production Company to amend Administrative Order CTB-786-A (regarding lease commingling at the Dr K Central Tank Battery located in Unit M, Section 24, Township 23 South, Range 27 East, Eddy County, New Mexico), to authorize allocation via well test method.

Dear Ms. Sandoval:

Matador Production Company (OGRID No. 228937) seeks to amend Administrative Order CTB-786-A ("Order CTB-786-A"), attached as **Exhibit 1**. Order CTB-786-A authorizes lease surface commingling and off-lease measure pursuant to 19.15.12.10 NMAC, at the **Dr K Central Tank Battery**, of production from certain Purple Sage; Wolfcamp (Gas) Pool [98220] spacing units in the S/2 of Section 23 and All of Section 24, Township 23 South, Range 27 East. Order CTB-786-A also authorizes commingling of future leases to be added to the commingling operation (with notice only required to be given to those interest owners in the leases to be added), as well as future wells within approved leases (by filing a Sundry notice to the Engineering Bureau).

Pursuant to 19.15.12.10 NMAC, Matador seeks to amend the terms of Order CTB-786-A to allow for allocation of the approved surface commingling (at the Dr K Central Tank Battery) via well test method. Accordingly, Matador requests that the terms of the amended order allow commingling of production *via well test method*, as more fully described in Exhibit 4. The amended order would apply to *all existing and future infill wells drilled in the following spacing units*:

(a) The 320-acre Purple Sage; Wolfcamp (Gas) Pool [98220] spacing unit comprised of the S/2 of Section 23. The spacing unit is currently dedicated to the following: **Norris Thornton Com Well No. 204H** (API. No. 30-015-44659);

(b) The 320-acre Purple Sage; Wolfcamp (Gas) Pool [98220] spacing unit comprised of the N/2 of Section 24. The spacing unit is currently dedicated to the following: **Dr K 24 23S 27E RB Well No. 206H** (API. No. 30-015-43379), **Dr K 24 23S 27E RB Well No. 201H** (API. No. 30-015-45125);

(c) The 320-acre Purple Sage; Wolfcamp (Gas) Pool [98220] spacing unit comprised of the S/2 of Section 24. The spacing unit is currently dedicated to the following: **Dr K 24 23S 27E RB Well No. 203H** (API. No. 30-015-43378), **Dr K 24 23S 27E RB Well No. 204H** (API. No. 30-015-44804), **Dr K 24 23S 27E RB Well No. 223H** (API. No. 30-015-44562); and

(g) Pursuant to 19.15.12.10.C(4)(g), *future Purple Sage; Wolfcamp (Gas) Pool [98220] spacing units within the S/2 of Section 23 and Section 24 [All] connected to the Dr K Central Tank Battery* with notice provided only to the owners of interests to be added.

Exhibit 2 is a land plat showing Matador's current development plan including flow lines, wells, leases, spacing units, and surface facilities.

Exhibit 3 is a C-102 for each of the wells currently drilled within the existing spacing units, together with the available production data.

Exhibit 4 is a completed Application for Surface Commingling (Diverse Ownership) Form C-107-B, that includes a statement from Omar Enriquez, Production Engineer with Matador, identifying the facilities and the measurement devices to be utilized, a detailed schematic of the surface facilities (attachment A to the statement) and a gas sample (attachment B to the statement).

Exhibit 5 includes relevant communitization documents.

Ownership is diverse between the above-described spacing units. **Exhibit 6** is a list of the interest owners (including any owners of royalty or overriding royalty interests) affected by this application, an example of the letters sent by certified mail advising the interest owners that any objections must be filed in writing with the Division within 20 days from the date the Division receives this application, and proof of mailing.

Thank you for your attention to this matter, and please feel free to call if you have any questions or require additional information.

Sincerely,



Adam G. Rankin
ATTORNEY FOR
MATADOR PRODUCTION COMPANY

State of New Mexico
Energy, Minerals and Natural Resources Department

Susana Martinez
Governor

Ken McQueen
Cabinet Secretary

Matthias Sayer
Deputy Cabinet Secretary

Heather Riley, Division Director
Oil Conservation Division



ADMINISTRATIVE CENTRAL TANK BATTERY ORDER

Administrative Order CTB-786-A

June 8, 2018

MATADOR PRODUCTION COMPANY

Attention: Mr. Adam Rankin

Matador Production Company (OGRID 228937) is hereby authorized to surface commingle oil and gas production and off-lease measure from Purple Sage; Wolfcamp (Gas) Pool (Pool code 98220) from the following diversely owned fee leases and wells in Eddy County, New Mexico:

Lease: Norris Thornton Com Well No. 204H
Description: S/2 Section 23, Township 23 South, Range 27 East, NMPM
Well: Norris Thornton Com Well No. 204H API No. 30-015-44659

Lease: Dr K 24 23S 27E RB Well No. 206H
Description: N/2 Section 24, Township 23 South, Range 27 East, NMPM
Wells: Dr K 24 23S 27E RB Well No. 206H API No. 30-015-43379

Lease: Dr K 24 23S 27E RB Well No. 203H
Description: S/2 Section 24, Township 23 South, Range 27 East, NMPM
Wells: Dr K 24 23S 27E RB Well No. 203H API No. 30-015-43378
Dr K 24 23S 27E RB Well No. 204H API No. 30-015-44804
Dr K 24 23S 27E RB Well No. 223H API No. 30-015-44562

The commingled oil and gas production from the wells detailed above shall be measured and sold at the Dr K Central Tank Battery (CTB), located in Unit M, Section 24, Township 23 South, Range 27 East, NMPM, Eddy County, New Mexico.

Production from the subject wells shall be determined as follows:

The oil and gas production from each of the diversely-owned leases shall be measured with allocation meters.

The oil and gas production from each well will flow into a dedicated 3-phase separator. The production stream will be separated into 3 independent streams by the separator and each stream will be measured individually after it exits the separator, before commingling.

Administrative Order CTB-786-A
Matador Production Company
June 8, 2018

The allocation meters shall be calibrated quarterly in accordance with Rule 19.15.12.10.C (2) NMAC.

For future additions of wells and leases to this commingling operation, notice shall only be given to those interest owners in the wells and leases to be added, in accordance with Division Rule 19.15.12.10 C (4) (g) NMAC.

Subsequent wells within leases approved by this order may be added to this administrative surface commingle application with a Sundry notice to the Engineering Bureau.

This Order supersedes Administrative Order CTB-786, issued on April 27, 2016. This amended application adds the S/2 of Section 23, and redesignates the subject wells to the Purple Sage; Wolfcamp (Gas) Pool.

This installation shall be installed and operated in accordance with the applicable Division Rules. It is the responsibility of the producer to notify the transporter of this commingling authority.

The operator shall notify the Artesia District office of the Division prior to implementation of the commingling operations.



HEATHER RILEY
Director

HR/mam

cc: Oil Conservation Division – Artesia

Dr. K / Norris Thornton Commingling Plat

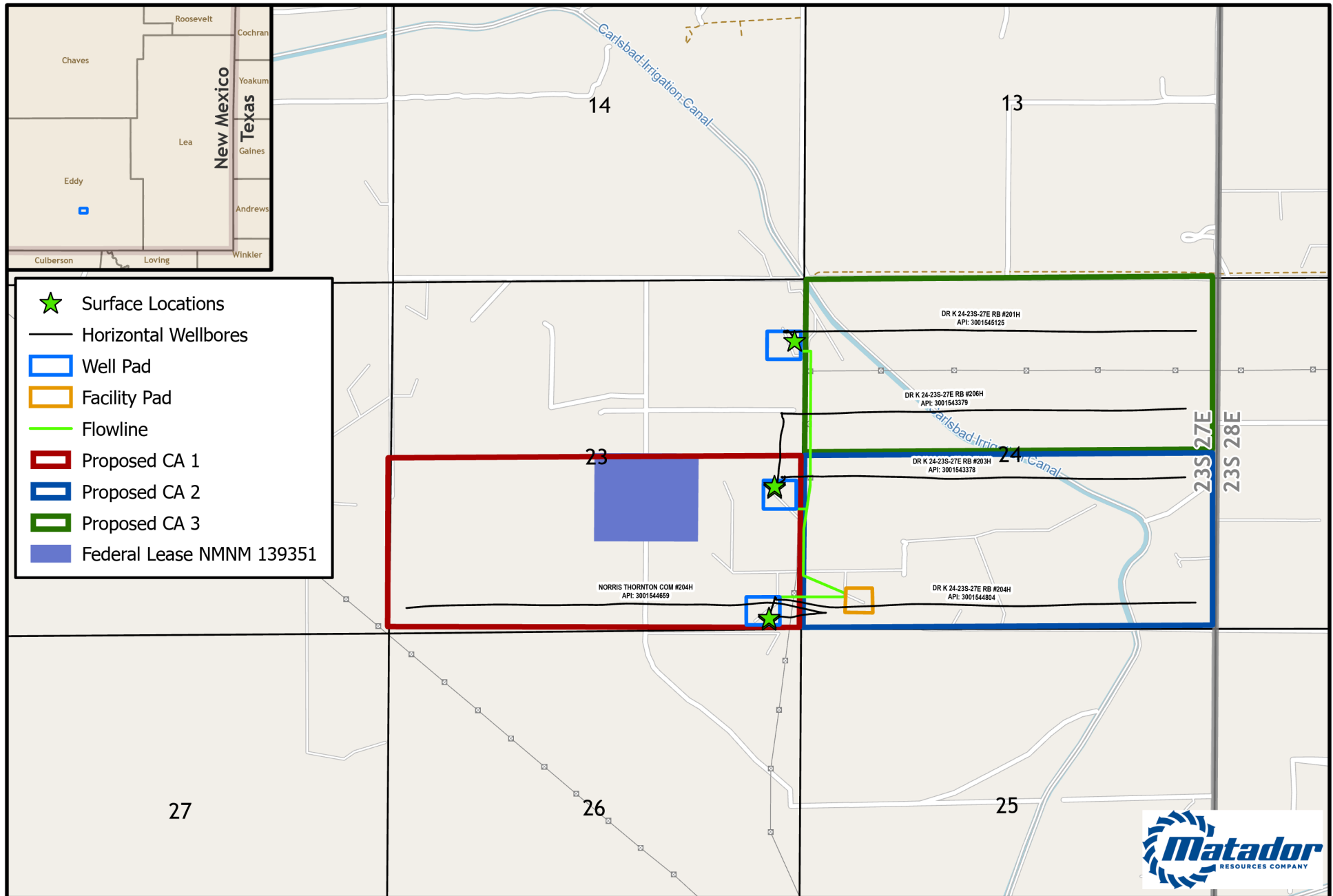

Southeast New Mexico

GIS Standard Map Disclaimer:
This cartographic product is for informational purposes and may not have been prepared for, or be suitable for, legal, engineering, or surveying purposes. Users of this information should review or consult the primary data and information sources to ascertain the usability of the information.

0 1,000 2,000 4,000 6,000 Feet

EXHIBIT 2

Map Prepared by: agreen
Project: ComminglingPlat
Date: 11/29/2021
Coordinate System: GCS WGS 1984

District I
1625 N. French Dr., Hobbs, NM 88240
Phone: (575) 393-6161 Fax: (575) 393-0720
District II
811 S. First St., Artesia, NM 88210
Phone: (575) 748-1283 Fax: (575) 748-9720
District III
1000 Rio Brazos Road, Aztec, NM 87410
Phone: (505) 334-6178 Fax: (505) 334-6170
District IV
1220 S. St. Francis Dr., Santa Fe, NM 87505
Phone: (505) 476-3460 Fax: (505) 476-3462

State of New Mexico
Energy, Minerals & Natural Resources
Department
OIL CONSERVATION DIVISION
1220 South St. Francis Dr.
Santa Fe, NM 87505

RECEIVED

FORM C-102

Revised August 1, 2011

Submit one copy to appropriate

District Office

MAR 15 2019

DISTRICT II-ARTESIA O.C.D.

AMENDED REPORT

WELL LOCATION AND ACREAGE DEDICATION PLAT

¹ API Number 30-015-44659	² Pool Code 98220	³ Pool Name PURPLE SAGE; WOLFCAMP(GAS)
⁴ Property Code 320070	⁵ Property Name NORRIS THORNTON COM RB	⁶ Well Number #204H
⁷ OGRID No. 228937	⁸ Operator Name MATADOR PRODUCTION COMPANY	⁹ Elevation 3135'

¹⁰Surface Location

UL or lot no.	Section	Township	Range	Lot Idn	Feet from the	North/South line	Feet from the	East/West line	County
P	23	23-S	27-E	-	189'	SOUTH	393'	EAST	EDDY

¹¹Bottom Hole Location If Different From Surface

UL or lot no.	Section	Township	Range	Lot Idn	Feet from the	North/South line	Feet from the	East/West line	County
M	23	23-S	27-E	-	336'	SOUTH	241'	WEST	EDDY

¹² Dedicated Acres 320	¹³ Joint or Infill	¹⁴ Consolidation Code	¹⁵ Order No.
--------------------------------------	-------------------------------	----------------------------------	-------------------------

No allowable will be assigned to this completion until all interests have been consolidated or a non-standard unit has been approved by the division.

BOTTOM HOLE LOCATION NEW MEXICO EAST NAD 1927 X=551022 Y=467150 LAT.: N 32.2842045 LONG.: W 104.1682335 NAD 1983 X=592204 Y=467209 LAT.: N 32.2843240 LONG.: W 104.1687315 MD = 14497'	LAST TAKE POINT NEW MEXICO EAST NAD 1927 X=551185 Y=467165 LAT.: N 32.2842460 LONG.: W 104.1677695 NAD 1983 X=592347 Y=467224 LAT.: N 32.2843656 LONG.: W 104.1682675 MD = 14351'	FIRST TAKE POINT NEW MEXICO EAST NAD 1927 X=555704 Y=467236 LAT.: N 32.2844205 LONG.: W 104.1530827 NAD 1983 X=596886 Y=467295 LAT.: N 32.2845403 LONG.: W 104.1535801 MD = 9800'	PENTRATION POINT NEW MEXICO EAST NAD 1927 X=556167 Y=467135 LAT.: N 32.2841403 LONG.: W 104.1515834 NAD 1983 X=597350 Y=467194 LAT.: N 32.2842602 LONG.: W 104.1520808 MD = 9307'	KICK OFF POINT NEW MEXICO EAST NAD 1927 X=556390 Y=467086 LAT.: N 32.2840043 LONG.: W 104.1508625 NAD 1983 X=597573 Y=467145 LAT.: N 32.2841241 LONG.: W 104.1513598 MD = 8840'
---	--	--	--	--

DETAIL VIEW
SCALE: 1" = 300'

SURFACE LOCATION
NEW MEXICO EAST
NAD 1927
X=555664
Y=467013
LAT.: N 32.2838083
LONG.: W 104.1532105
NAD 1983
X=596847
Y=467072
LAT.: N 32.2839280
LONG.: W 104.1537079

SEE DETAIL

17 OPERATOR CERTIFICATION
I hereby certify that the information contained herein is true and complete to the best of my knowledge and belief, and that this organization either owns a working interest or unleased mineral interest in the land including the proposed bottom hole location or has a right to drill this well at this location pursuant to a contract with an owner of such a mineral or working interest, or to a voluntary pooling agreement or a compulsory pooling order heretofore entered by the division.

Sara Hartsfield
Signature Date

Sara Hartsfield
Printed Name

shartsfield@matadorresources.com
E-mail Address

18 SURVEYOR CERTIFICATION
I hereby certify that the well location shown on this plat was plotted from field notes of actual surveys made by me or under my supervision, and that the same is true to the best of my belief.

11/22/2017
Date of Survey
Signature and Seal
MICHAEL BROWN
NEW MEXICO
18329
PROFESSIONAL SURVEYOR

Certificate Number

S:\SURVEY\MATADOR_RESOURCES\NORRIS-THORNTON_23-23S-27E\FINAL_PRODUCTS\AD_NORRIS_THORNTON_COM_RB_204H.DWG 10/23/2018 2:28:38 PM adasabele

District I
1625 N. French Dr., Hobbs, NM 88240
Phone: (575) 393-6161 Fax: (575) 393-0720

District II
811 S. First St., Artesia, NM 88210
Phone: (575) 748-1283 Fax: (575) 748-9720

District III
1000 Rio Brazos Road, Aztec, NM 87410
Phone: (505) 334-6178 Fax: (505) 334-6170

District IV
1220 S. St. Francis Dr., Santa Fe, NM 87505
Phone: (505) 476-3460 Fax: (505) 476-3462

State of New Mexico
Energy, Minerals & Natural Resources
Department
OIL CONSERVATION DIVISION
1220 South St. Francis Dr.
Santa Fe, NM 87505

NM OIL CONSERVATION

ARTESIA DISTRICT

FORM C-102

OCT 31 2018

Revised August 1, 2011

Submit one copy to appropriate

District Office

RECEIVED

AMENDED REPORT

WELL LOCATION AND ACREAGE DEDICATION PLAT

¹ API Number 30-015-44804	² Pool Code 98220	³ Pool Name Purple Sage; Wolfcamp (Gas)
⁴ Property Code 315274	⁵ Property Name DR. K 24-23S-27E RB	⁶ Well Number #204H
⁷ OGRID No. 228937	⁸ Operator Name MATADOR PRODUCTION COMPANY	⁹ Elevation 3135'

¹⁰Surface Location

UL or lot no.	Section	Township	Range	Lot Idn	Feet from the	North/South line	Feet from the	East/West line	County
P	23	23-S	27-E	-	159'	SOUTH	393'	EAST	EDDY

¹¹Bottom Hole Location If Different From Surface

UL or lot no.	Section	Township	Range	Lot Idn	Feet from the	North/South line	Feet from the	East/West line	County
P	24	23-S	27-E	-	413'	SOUTH	241'	EAST	EDDY

¹² Dedicated Acres 320	¹³ Joint or Infill	¹⁴ Consolidation Code	¹⁵ Order No.
--------------------------------------	-------------------------------	----------------------------------	-------------------------

No allowable will be assigned to this completion until all interests have been consolidated or a non-standard unit has been approved by the division.

SURFACE LOCATION NEW MEXICO EAST NAD 1983 X=596847 Y=467042 LAT.: N 32.2838458 LONG.: W 104.1537076 NAD 1927 X=555665 Y=466984 LAT.: N 32.2837260 LONG.: W 104.1532102 ELEV = 3135'	KICK OFF POINT NEW MEXICO EAST NAD 1983 X=596930 Y=467344 LAT.: N 32.2846742 LONG.: W 104.1534385 NAD 1927 X=555747 Y=467285 LAT.: N 32.2845544 LONG.: W 104.1529411 MD = 8810'	PENETRATION POINT NEW MEXICO EAST NAD 1983 X=597177 Y=467321 LAT.: N 32.2846096 LONG.: W 104.1526371 NAD 1927 X=555995 Y=467262 LAT.: N 32.2844898 LONG.: W 104.1521397 MD = 9303'	LAST TAKE POINT NEW MEXICO EAST NAD 1983 X=602148 Y=467307 LAT.: N 32.2845473 LONG.: W 104.1365518 NAD 1927 X=560966 Y=467248 LAT.: N 32.2844272 LONG.: W 104.1360550 MD = 14308'	BOTTOM HOLE LOCATION NEW MEXICO EAST NAD 1983 X=602304 Y=467308 LAT.: N 32.2845498 LONG.: W 104.1360481 NAD 1927 X=561121 Y=467249 LAT.: N 32.2844297 LONG.: W 104.1355513 MD = 14465'	17 OPERATOR CERTIFICATION I hereby certify that the information contained herein is true and complete to the best of my knowledge and belief, and that this organization either owns a working interest or unleased mineral interest in the land including the proposed bottom hole location or has a right to drill this well at this location pursuant to a contract with an owner of such a mineral or working interest, or to a voluntary pooling agreement or a compulsory pooling order heretofore entered by the division. Signature: <i>Chris Carleton</i> Date: 10/30/18 Chris Carleton Printed Name ccarleton@matadorresources.com E-mail Address
FIRST TAKE POINT NEW MEXICO EAST NAD 1983 X=597589 Y=467235 LAT.: N 32.2843721 LONG.: W 104.1513046 NAD 1927 X=556407 Y=467176 LAT.: N 32.2842523 LONG.: W 104.1508073 MD = 9740'					18 SURVEYOR CERTIFICATION I hereby certify that the well location shown on this plat was plotted from field notes of actual surveys made by me or under my supervision, and that the same is true to the best of my belief. Date of Survey: 10/12/2017 Signature and Seal of Professional Surveyor: <i>Michael Brown</i> MICHAEL BROWN NEW MEXICO PROFESSIONAL SURVEYOR 18329 Certificate Number

District I
1625 N. French Dr., Hobbs, NM 88240
Phone: (575) 393-6161 Fax: (575) 393-0720
District II
811 S. First St., Artesia, NM 88210
Phone: (575) 748-1283 Fax: (575) 748-9720
District III
1000 Rio Brazos Road, Aztec, NM 87410
Phone: (505) 334-6178 Fax: (505) 334-6170
District IV
1220 S. St. Francis Dr., Santa Fe, NM 87505
Phone: (505) 476-3460 Fax: (505) 476-3462

State of New Mexico
Energy, Minerals & Natural Resources
Department
OIL CONSERVATION DIVISION
1220 South St. Francis Dr.
Santa Fe, NM 87505

NOV 01 2018

FORM C-102

Revised August 1, 2011

DISTRICT II-ARTESIA, NM ONE copy to appropriate

District Office

☐ AMENDED REPORT

WELL LOCATION AND ACREAGE DEDICATION PLAT

¹ API Number 30-015-45125	² Pool Code 98220	³ Pool Name PURPLE SAGE; WOLFCAMP(GAS)
⁴ Property Code 315274	⁵ Property Name DR. K 24-23S-27E RB	⁶ Well Number #201H
⁷ OGRID No. 228937	⁸ Operator Name MATADOR PRODUCTION COMPANY	⁹ Elevation 3117'

¹⁰Surface Location

UL or lot no.	Section	Township	Range	Lot Idn	Feet from the	North/South line	Feet from the	East/West line	County
A	23	23-S	27-E	-	946'	NORTH	80'	EAST	EDDY

¹¹Bottom Hole Location If Different From Surface

UL or lot no.	Section	Township	Range	Lot Idn	Feet from the	North/South line	Feet from the	East/West line	County
A	24	23-S	27-E	-	792'	NORTH	240'	EAST	EDDY

¹² Dedicated Acres 320	¹³ Joint or Infill	¹⁴ Consolidation Code	¹⁵ Order No.
--------------------------------------	-------------------------------	----------------------------------	-------------------------

No allowable will be assigned to this completion until all interests have been consolidated or a non-standard unit has been approved by the division.

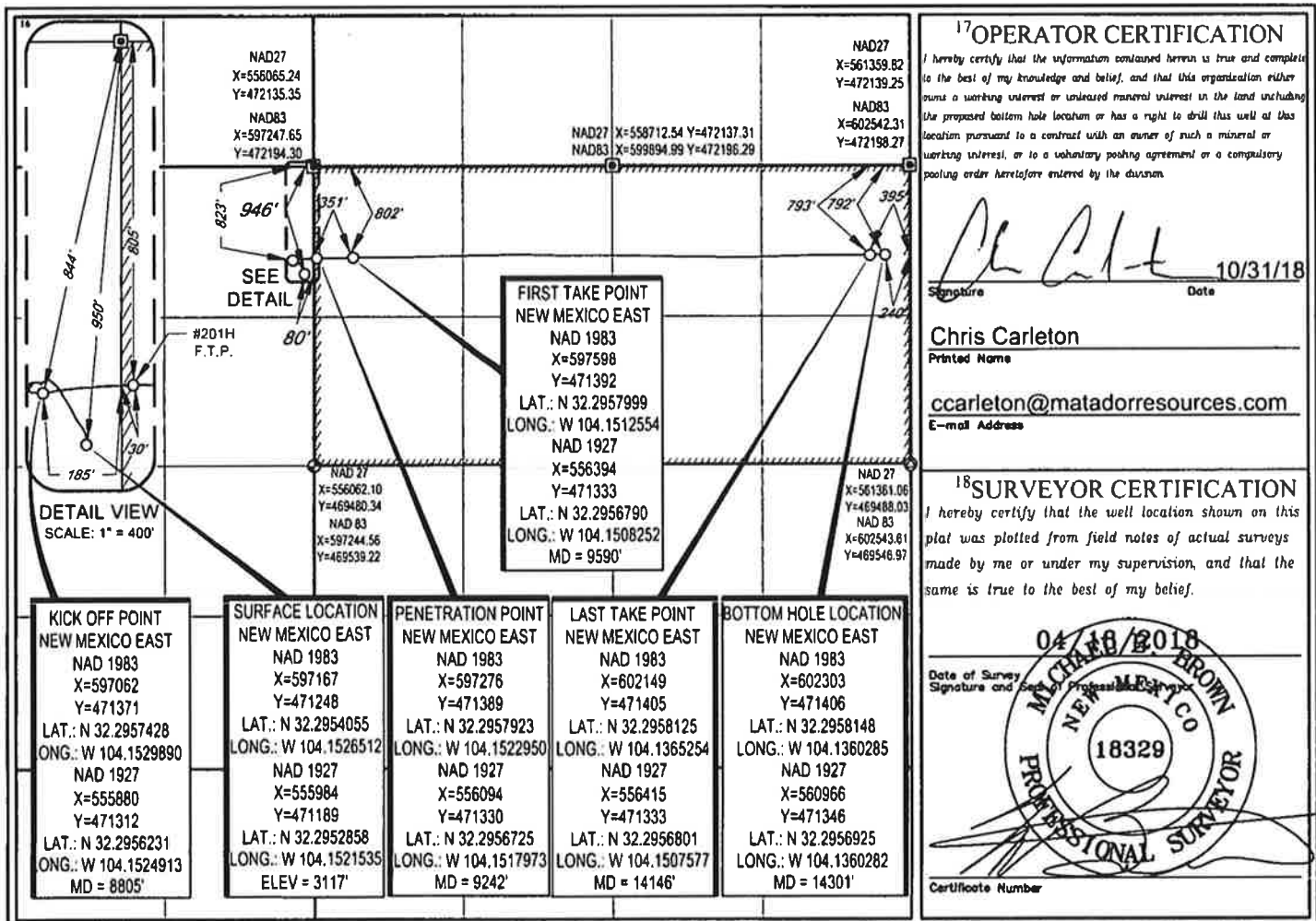

District I
1625 N French Dr., Hobbs, NM 88240
Phone: (575) 393-6161 Fax: (575) 393-0720
District II
811 S. First St., Artesia, NM 88210
Phone: (575) 748-1283 Fax: (575) 748-9720
District III
1000 Rio Brazos Road, Aztec, NM 87410
Phone: (505) 334-6178 Fax: (505) 334-6170
District IV
1220 S St. Francis Dr., Santa Fe, NM 87505
Phone: (505) 476-3460 Fax: (505) 476-3462

NM OIL CONSERVATION
State of New Mexico
ARTESIA DISTRICT
Energy, Minerals & Natural Resources
Department
OIL CONSERVATION DIVISION
RECEIVED 1220 South St. Francis Dr.
Santa Fe, NM 87505

FORM C-102

Revised August 1, 2011

Submit one copy to appropriate

District Office

☒ AMENDED REPORT**WELL LOCATION AND ACREAGE DEDICATION PLAT**

¹ API Number 30-015-43378	² Pool Code 98220	³ Pool Name PURPLE SAGE-WOLFCAMP GAS POOL
⁴ Property Code 315274	⁵ Property Name DR. K 24-23S-27E RB	⁶ Well Number #203H
⁷ OGRID No. 228937	⁸ Operator Name MATADOR PRODUCTION COMPANY	⁹ Elevation 3126'

¹⁰Surface Location

UL or lot no.	Section	Township	Range	Lot Idn	Feet from the	North/South line	Feet from the	East/West line	County
I	23	23-S	27-E	-	2183'	SOUTH	330'	EAST	EDDY

UL or lot no.	Section	Township	Range	Lot Idn	Feet from the	North/South line	Feet from the	East/West line	County
I	24	23-S	27-E	-	2310'	SOUTH	374'	EAST	EDDY

¹² Dedicated Acres 320	¹³ Joint or Infill	¹⁴ Consolidation Code	¹⁵ Order No.
---	-------------------------------	----------------------------------	-------------------------

No allowable will be assigned to this completion until all interests have been consolidated or a non-standard unit has been approved by the division.

¹⁶ 			¹⁷ OPERATOR CERTIFICATION I hereby certify that the information contained herein is true and complete to the best of my knowledge and belief, and that this organization either owns a working interest or released mineral interest in the land including the proposed bottom hole location or has a right to drill this well at this location pursuant to a contract with an owner of such a mineral or working interest, or to a voluntary pooling agreement or a compulsory pooling order heretofore entered by the division. Signature: <u>Trey Goodwin</u> Date: <u>2/21/17</u> Printed Name: <u>Trey Goodwin</u> E-mail Address: <u>tgoodwin@matadorresources.com</u>								
PENETRATION POINT NEW MEXICO EAST NAD 1927 X=556205 Y=469150 LAT.: N 32.2896784 LONG.: W 104.1514497 NAD 1983 X=597387 Y=469209 LAT.: N 32.2897982 LONG.: W 104.1519472 MD = 9335'			FIRST TAKE POINT NEW MEXICO EAST NAD 1927 X=556524 Y=469153 LAT.: N 32.2896844 LONG.: W 104.1504181 NAD 1983 X=597706 Y=469212 LAT.: N 32.2898042 LONG.: W 104.1509156 MD = 9676'			LAST TAKE POINT NEW MEXICO EAST NAD 1927 X=560842 Y=469139 LAT.: N 32.2896270 LONG.: W 104.1364437 NAD 1983 X=602025 Y=469198 LAT.: N 32.2897470 LONG.: W 104.1369406 MD = 14000'			BOTTOM HOLE LOCATION NEW MEXICO EAST NAD 1927 X=560987 Y=469146 LAT.: N 32.2896445 LONG.: W 104.1359743 NAD 1983 X=602170 Y=469205 LAT.: N 32.2897645 LONG.: W 104.1364712 MD = 14145'		
SURFACE LOCATION NEW MEXICO EAST NAD 1927 X=555731 Y=469008 LAT.: N 32.2892898 LONG.: W 104.1529834 NAD 1983 X=596913 Y=469067 LAT.: N 32.2894096 LONG.: W 104.1534810 ELEV = 3126'			¹⁸ SURVEYOR CERTIFICATION I hereby certify that the well location shown on this plat was plotted from field notes of actual surveys made by me or under my supervision, and that the same is true to the best of my belief. Date of Survey: <u>09/16/2015</u> Signature: <u>Michael Brown</u> Certificate Number: <u>18329</u>								

NM OIL CONSERVATION
ARTESIA DISTRICT

District I
1625 N. French Dr., Hobbs, NM 88240
Phone: (575) 393-6161 Fax: (575) 393-0720

District II
811 S. First St., Artesia, NM 88210
Phone: (575) 748-1283 Fax: (575) 748-9720

District III
1000 Rio Brazos Road, Aztec, NM 87410
Phone: (505) 334-6178 Fax: (505) 334-6170

District IV
1220 S. St. Francis Dr., Santa Fe, NM 87505
Phone: (505) 476-3460 Fax: (505) 476-3462

FEB 27 2017 State of New Mexico
Energy, Minerals & Natural Resources
Department
OIL CONSERVATION DIVISION
1220 South St. Francis Dr.
Sante Fe, NM 87505

FORM C-102

Revised August 1, 2011

Submit one copy to appropriate

District Office

☒ **AMENDED REPORT****WELL LOCATION AND ACREAGE DEDICATION PLAT**

¹ API Number 30-015-43379	² Pool Code 98220	³ Pool Name PURPLE SAGE-WOLFCAMP GAS POOL
⁴ Property Code 315274	⁵ Property Name DR. K 24-23S-27E RB	⁶ Well Number #206H
⁷ OGRID No. 228937	⁸ Operator Name MATADOR PRODUCTION COMPANY	⁹ Elevation 3127'

¹⁰Surface Location

UL or lot no.	Section	Township	Range	Lot Idn	Feet from the	North/South line	Feet from the	East/West line	County
I	23	23-S	27-E	-	2153'	SOUTH	330'	EAST	EDDY

UL or lot no.	Section	Township	Range	Lot Idn	Feet from the	North/South line	Feet from the	East/West line	County
H	24	23-S	27-E	-	1960'	NORTH	370'	EAST	EDDY

¹¹ Dedicated Acres 320	¹² Joint or Infill	¹⁴ Consolidation Code	¹³ Order No.
---	-------------------------------	----------------------------------	-------------------------

No allowable will be assigned to this completion until all interests have been consolidated or a non-standard unit has been approved by the division.

	16 PENETRATION POINT NEW MEXICO EAST NAD 1927 X=556042 Y=470088 LAT.: N 32.2922592 LONG.: W 104.1519735 MD = 9360'	FIRST PERFORATION POINT NEW MEXICO EAST NAD 1927 X=556526 Y=470099 LAT.: N 32.2922867 LONG.: W 104.1504065 MD = 9879'	LAST PERFORATION POINT NEW MEXICO EAST NAD 1927 X=560845 Y=470173 LAT.: N 32.2924690 LONG.: W 104.1364296 MD = 14203'	17 OPERATOR CERTIFICATION I hereby certify that the information contained herein is true and complete to the best of my knowledge and belief, and that this organization either owns a working interest or undivided mineral interest in the land including the proposed bottom hole location or has a right to drill that well at this location pursuant to a contract with an owner of such a mineral or working interest, or to a voluntary pooling agreement or a compulsory pooling order heretofore entered by the division. Signature: <u>Trey Goodwin</u> Date: <u>2/21/17</u> Printed Name: <u>Trey Goodwin</u> E-mail Address: <u>tgoodwin@matadorresources.com</u>
	18 SURVEYOR CERTIFICATION I hereby certify that the well location shown on this plat was plotted from field notes of actual surveys made by me or under my supervision, and that the same is true to the best of my belief. Date of Survey: <u>09/16/2015</u> Signature and Seal: <u>MICHAEL B. BROWN</u> Certificate Number: <u>18329</u>			

Production Summary Report API: 30-015-44659 NORRIS THORNTON COM #204H Printed On: Wednesday, November 17 2021											
Year	Pool	Month	Production				Injection				
			Oil(BBLS)	Gas(MCF)	Water(BBLS)	Days P/I	Water(BBLS)	Co2(MCF)	Gas(MCF)	Other	Pressure
2018	[98220] PURPLE SAGE;WOLFCAMP (GAS)	Sep	12565	44601	72396	30	0	0	0	0	0
2018	[98220] PURPLE SAGE;WOLFCAMP (GAS)	Oct	16556	56318	52906	31	0	0	0	0	0
2018	[98220] PURPLE SAGE;WOLFCAMP (GAS)	Nov	11384	39253	37092	26	0	0	0	0	0
2018	[98220] PURPLE SAGE;WOLFCAMP (GAS)	Dec	9059	38294	41507	31	0	0	0	0	0
2019	[98220] PURPLE SAGE;WOLFCAMP (GAS)	Jan	8359	44940	40891	31	0	0	0	0	0
2019	[98220] PURPLE SAGE;WOLFCAMP (GAS)	Feb	6576	41484	35807	28	0	0	0	0	0
2019	[98220] PURPLE SAGE;WOLFCAMP (GAS)	Mar	6033	27335	37134	31	0	0	0	0	0
2019	[98220] PURPLE SAGE;WOLFCAMP (GAS)	Apr	5267	29765	28668	30	0	0	0	0	0
2019	[98220] PURPLE SAGE;WOLFCAMP (GAS)	May	4990	27380	29279	31	0	0	0	0	0
2019	[98220] PURPLE SAGE;WOLFCAMP (GAS)	Jun	4203	24955	27624	30	0	0	0	0	0
2019	[98220] PURPLE SAGE;WOLFCAMP (GAS)	Jul	3763	24183	25263	31	0	0	0	0	0
2019	[98220] PURPLE SAGE;WOLFCAMP (GAS)	Aug	3521	22744	22964	31	0	0	0	0	0
2019	[98220] PURPLE SAGE;WOLFCAMP (GAS)	Sep	3259	22794	22569	30	0	0	0	0	0
2019	[98220] PURPLE SAGE;WOLFCAMP (GAS)	Oct	3223	22772	21910	31	0	0	0	0	0
2019	[98220] PURPLE SAGE;WOLFCAMP (GAS)	Nov	2956	21638	19556	30	0	0	0	0	0
2019	[98220] PURPLE SAGE;WOLFCAMP (GAS)	Dec	2880	16969	17946	31	0	0	0	0	0
2020	[98220] PURPLE SAGE;WOLFCAMP (GAS)	Jan	2502	17260	18285	31	0	0	0	0	0
2020	[98220] PURPLE SAGE;WOLFCAMP (GAS)	Feb	2498	16667	16282	29	0	0	0	0	0
2020	[98220] PURPLE SAGE;WOLFCAMP (GAS)	Mar	2694	18750	18794	31	0	0	0	0	0
2020	[98220] PURPLE SAGE;WOLFCAMP (GAS)	Apr	2345	17574	17178	30	0	0	0	0	0
2020	[98220] PURPLE SAGE;WOLFCAMP (GAS)	May	254	121	1715	31	0	0	0	0	0
2020	[98220] PURPLE SAGE;WOLFCAMP (GAS)	Jun	0	0	0	30	0	0	0	0	0
2020	[98220] PURPLE SAGE;WOLFCAMP (GAS)	Jul	2254	11169	4181	17	0	0	0	0	0
2020	[98220] PURPLE SAGE;WOLFCAMP (GAS)	Aug	3474	17796	23644	31	0	0	0	0	0
2020	[98220] PURPLE SAGE;WOLFCAMP (GAS)	Sep	2557	15815	19988	30	0	0	0	0	0
2020	[98220] PURPLE SAGE;WOLFCAMP (GAS)	Oct	2322	16707	19202	31	0	0	0	0	0
2020	[98220] PURPLE SAGE;WOLFCAMP (GAS)	Nov	2103	14780	16864	30	0	0	0	0	0
2020	[98220] PURPLE SAGE;WOLFCAMP (GAS)	Dec	2113	17862	16229	31	0	0	0	0	0
2021	[98220] PURPLE SAGE;WOLFCAMP (GAS)	Jan	1883	11574	12757	31	0	0	0	0	0
2021	[98220] PURPLE SAGE;WOLFCAMP (GAS)	Feb	1741	10381	13456	25	0	0	0	0	0

2021	[98220] PURPLE SAGE;WOLFCAMP (GAS)	Mar	1970	13469	16265	31	0	0	0	0	0
2021	[98220] PURPLE SAGE;WOLFCAMP (GAS)	Apr	1756	13111	14656	30	0	0	0	0	0
2021	[98220] PURPLE SAGE;WOLFCAMP (GAS)	May	1766	13982	13134	31	0	0	0	0	0
2021	[98220] PURPLE SAGE;WOLFCAMP (GAS)	Jun	1538	11668	11375	30	0	0	0	0	0
2021	[98220] PURPLE SAGE;WOLFCAMP (GAS)	Jul	1756	13467	14286	31	0	0	0	0	0
2021	[98220] PURPLE SAGE;WOLFCAMP (GAS)	Aug	1569	12306	13125	31	0	0	0	0	0
2021	[98220] PURPLE SAGE;WOLFCAMP (GAS)	Sep	1498	11576	12108	30	0	0	0	0	0

Production Summary Report API: 30-015-44804 DR K 24 23S 27E RB #204H Printed On: Wednesday, November 17 2021											
Year	Pool	Month	Production				Injection				
			Oil(BBLS)	Gas(MCF)	Water(BBLS)	Days P/I	Water(BBLS)	Co2(MCF)	Gas(MCF)	Other	Pressure
2018	[98220] PURPLE SAGE;WOLFCAMP (GAS)	Sep	11896	23298	88300	30	0	0	0	0	0
2018	[98220] PURPLE SAGE;WOLFCAMP (GAS)	Oct	14382	29756	70314	27	0	0	0	0	0
2018	[98220] PURPLE SAGE;WOLFCAMP (GAS)	Nov	13910	29322	66999	30	0	0	0	0	0
2018	[98220] PURPLE SAGE;WOLFCAMP (GAS)	Dec	9837	21995	44603	31	0	0	0	0	0
2019	[98220] PURPLE SAGE;WOLFCAMP (GAS)	Jan	8337	16661	39484	31	0	0	0	0	0
2019	[98220] PURPLE SAGE;WOLFCAMP (GAS)	Feb	6632	16262	36653	28	0	0	0	0	0
2019	[98220] PURPLE SAGE;WOLFCAMP (GAS)	Mar	2762	4746	37277	25	0	0	0	0	0
2019	[98220] PURPLE SAGE;WOLFCAMP (GAS)	Apr	4399	12934	40475	30	0	0	0	0	0
2019	[98220] PURPLE SAGE;WOLFCAMP (GAS)	May	4834	14596	34313	31	0	0	0	0	0
2019	[98220] PURPLE SAGE;WOLFCAMP (GAS)	Jun	4588	16726	32132	30	0	0	0	0	0
2019	[98220] PURPLE SAGE;WOLFCAMP (GAS)	Jul	4172	19590	30234	31	0	0	0	0	0
2019	[98220] PURPLE SAGE;WOLFCAMP (GAS)	Aug	3834	20606	27927	31	0	0	0	0	0
2019	[98220] PURPLE SAGE;WOLFCAMP (GAS)	Sep	3359	21013	26719	30	0	0	0	0	0
2019	[98220] PURPLE SAGE;WOLFCAMP (GAS)	Oct	3101	21314	25430	31	0	0	0	0	0
2019	[98220] PURPLE SAGE;WOLFCAMP (GAS)	Nov	2858	19066	21856	30	0	0	0	0	0
2019	[98220] PURPLE SAGE;WOLFCAMP (GAS)	Dec	2613	16180	21487	31	0	0	0	0	0
2020	[98220] PURPLE SAGE;WOLFCAMP (GAS)	Jan	2109	15603	20620	31	0	0	0	0	0
2020	[98220] PURPLE SAGE;WOLFCAMP (GAS)	Feb	2020	10459	16763	29	0	0	0	0	0
2020	[98220] PURPLE SAGE;WOLFCAMP (GAS)	Mar	2246	15838	20090	31	0	0	0	0	0
2020	[98220] PURPLE SAGE;WOLFCAMP (GAS)	Apr	1976	14199	17703	30	0	0	0	0	0
2020	[98220] PURPLE SAGE;WOLFCAMP (GAS)	May	1931	14299	17228	31	0	0	0	0	0
2020	[98220] PURPLE SAGE;WOLFCAMP (GAS)	Jun	1796	12365	16420	30	0	0	0	0	0
2020	[98220] PURPLE SAGE;WOLFCAMP (GAS)	Jul	1655	11672	15420	31	0	0	0	0	0
2020	[98220] PURPLE SAGE;WOLFCAMP (GAS)	Aug	1856	12046	16355	31	0	0	0	0	0
2020	[98220] PURPLE SAGE;WOLFCAMP (GAS)	Sep	1689	11424	14717	30	0	0	0	0	0
2020	[98220] PURPLE SAGE;WOLFCAMP (GAS)	Oct	1546	11320	14516	31	0	0	0	0	0
2020	[98220] PURPLE SAGE;WOLFCAMP (GAS)	Nov	1438	9078	12299	30	0	0	0	0	0
2020	[98220] PURPLE SAGE;WOLFCAMP (GAS)	Dec	1495	11176	12279	31	0	0	0	0	0
2021	[98220] PURPLE SAGE;WOLFCAMP (GAS)	Jan	1306	5880	9071	31	0	0	0	0	0
2021	[98220] PURPLE SAGE;WOLFCAMP (GAS)	Feb	1297	7338	9893	25	0	0	0	0	0

2021	[98220] PURPLE SAGE;WOLFCAMP (GAS)	Mar	1503	10090	12730	31	0	0	0	0	0
2021	[98220] PURPLE SAGE;WOLFCAMP (GAS)	Apr	1329	9126	11800	30	0	0	0	0	0
2021	[98220] PURPLE SAGE;WOLFCAMP (GAS)	May	1339	9438	12642	31	0	0	0	0	0
2021	[98220] PURPLE SAGE;WOLFCAMP (GAS)	Jun	1191	8045	10829	30	0	0	0	0	0
2021	[98220] PURPLE SAGE;WOLFCAMP (GAS)	Jul	1297	9127	12667	31	0	0	0	0	0
2021	[98220] PURPLE SAGE;WOLFCAMP (GAS)	Aug	1186	8285	12056	31	0	0	0	0	0
2021	[98220] PURPLE SAGE;WOLFCAMP (GAS)	Sep	1127	8394	12147	30	0	0	0	0	0

Production Summary Report API: 30-015-45125 DR K 24 23S 27E RB #201H Printed On: Wednesday, November 17 2021											
Year	Pool	Month	Production				Injection				
			Oil(BBLS)	Gas(MCF)	Water(BBLS)	Days P/I	Water(BBLS)	Co2(MCF)	Gas(MCF)	Other	Pressure
2018	[98220] PURPLE SAGE;WOLFCAMP (GAS)	Sep	44	445	5409	30	0	0	0	0	0
2018	[98220] PURPLE SAGE;WOLFCAMP (GAS)	Oct	24201	1615	60541	31	0	0	0	0	0
2018	[98220] PURPLE SAGE;WOLFCAMP (GAS)	Nov	15492	30719	38130	30	0	0	0	0	0
2018	[98220] PURPLE SAGE;WOLFCAMP (GAS)	Dec	12316	31138	37609	28	0	0	0	0	0
2019	[98220] PURPLE SAGE;WOLFCAMP (GAS)	Jan	9978	31606	35516	31	0	0	0	0	0
2019	[98220] PURPLE SAGE;WOLFCAMP (GAS)	Feb	7580	26300	29562	28	0	0	0	0	0
2019	[98220] PURPLE SAGE;WOLFCAMP (GAS)	Mar	5993	15411	19760	23	0	0	0	0	0
2019	[98220] PURPLE SAGE;WOLFCAMP (GAS)	Apr	6515	23253	30411	30	0	0	0	0	0
2019	[98220] PURPLE SAGE;WOLFCAMP (GAS)	May	5755	21355	26682	31	0	0	0	0	0
2019	[98220] PURPLE SAGE;WOLFCAMP (GAS)	Jun	4775	24930	23829	30	0	0	0	0	0
2019	[98220] PURPLE SAGE;WOLFCAMP (GAS)	Jul	4542	24481	23258	31	0	0	0	0	0
2019	[98220] PURPLE SAGE;WOLFCAMP (GAS)	Aug	4083	23347	22233	31	0	0	0	0	0
2019	[98220] PURPLE SAGE;WOLFCAMP (GAS)	Sep	3853	24531	22497	30	0	0	0	0	0
2019	[98220] PURPLE SAGE;WOLFCAMP (GAS)	Oct	3821	26064	23202	31	0	0	0	0	0
2019	[98220] PURPLE SAGE;WOLFCAMP (GAS)	Nov	3408	22540	20435	30	0	0	0	0	0
2019	[98220] PURPLE SAGE;WOLFCAMP (GAS)	Dec	3282	19035	19445	31	0	0	0	0	0
2020	[98220] PURPLE SAGE;WOLFCAMP (GAS)	Jan	3100	20929	21035	31	0	0	0	0	0
2020	[98220] PURPLE SAGE;WOLFCAMP (GAS)	Feb	2687	17301	20591	29	0	0	0	0	0
2020	[98220] PURPLE SAGE;WOLFCAMP (GAS)	Mar	2805	18185	21782	31	0	0	0	0	0
2020	[98220] PURPLE SAGE;WOLFCAMP (GAS)	Apr	2533	16697	18029	30	0	0	0	0	0
2020	[98220] PURPLE SAGE;WOLFCAMP (GAS)	May	2423	16501	16659	31	0	0	0	0	0
2020	[98220] PURPLE SAGE;WOLFCAMP (GAS)	Jun	2237	15285	15274	30	0	0	0	0	0
2020	[98220] PURPLE SAGE;WOLFCAMP (GAS)	Jul	2232	15094	15021	31	0	0	0	0	0
2020	[98220] PURPLE SAGE;WOLFCAMP (GAS)	Aug	2168	15245	15097	31	0	0	0	0	0
2020	[98220] PURPLE SAGE;WOLFCAMP (GAS)	Sep	2019	14853	13741	30	0	0	0	0	0
2020	[98220] PURPLE SAGE;WOLFCAMP (GAS)	Oct	2112	15787	17606	31	0	0	0	0	0
2020	[98220] PURPLE SAGE;WOLFCAMP (GAS)	Nov	1912	14220	17305	30	0	0	0	0	0
2020	[98220] PURPLE SAGE;WOLFCAMP (GAS)	Dec	1751	17191	14886	31	0	0	0	0	0
2021	[98220] PURPLE SAGE;WOLFCAMP (GAS)	Jan	1788	11663	14208	31	0	0	0	0	0
2021	[98220] PURPLE SAGE;WOLFCAMP (GAS)	Feb	1388	8724	9378	27	0	0	0	0	0

2021	[98220] PURPLE SAGE;WOLFCAMP (GAS)	Mar	1743	10301	11231	31	0	0	0	0	0
2021	[98220] PURPLE SAGE;WOLFCAMP (GAS)	Apr	1471	9719	9692	30	0	0	0	0	0
2021	[98220] PURPLE SAGE;WOLFCAMP (GAS)	May	1350	8016	8322	31	0	0	0	0	0
2021	[98220] PURPLE SAGE;WOLFCAMP (GAS)	Jun	1622	10468	10790	30	0	0	0	0	0
2021	[98220] PURPLE SAGE;WOLFCAMP (GAS)	Jul	1621	11318	11187	31	0	0	0	0	0
2021	[98220] PURPLE SAGE;WOLFCAMP (GAS)	Aug	1489	11801	11207	31	0	0	0	0	0
2021	[98220] PURPLE SAGE;WOLFCAMP (GAS)	Sep	1316	10440	10071	30	0	0	0	0	0

Production Summary Report API: 30-015-43378 DR K 24 23S 27E RB #203H Printed On: Wednesday, November 17 2021											
		Production					Injection				
Year	Pool	Month	Oil(BBLS)	Gas(MCF)	Water(BBLS)	Days P/I	Water(BBLS)	Co2(MCF)	Gas(MCF)	Other	Pressure
2016	[76780] FOREHAND RANCH;WOLFCAMP (G){ABOLISH	Jan	14463	38459	65755	23	0	0	0	0	0
2016	[76780] FOREHAND RANCH;WOLFCAMP (G){ABOLISH	Feb	18914	51028	67640	29	0	0	0	0	0
2016	[76780] FOREHAND RANCH;WOLFCAMP (G){ABOLISH	Mar	15811	37087	54852	31	0	0	0	0	0
2016	[76780] FOREHAND RANCH;WOLFCAMP (G){ABOLISH	Apr	11747	28205	44420	30	0	0	0	0	0
2016	[76780] FOREHAND RANCH;WOLFCAMP (G){ABOLISH	May	7212	16360	25076	20	0	0	0	0	0
2016	[76780] FOREHAND RANCH;WOLFCAMP (G){ABOLISH	Jun	4528	9303	34947	20	0	0	0	0	0
2016	[76780] FOREHAND RANCH;WOLFCAMP (G){ABOLISH	Jul	5502	14149	37995	30	0	0	0	0	0
2016	[76780] FOREHAND RANCH;WOLFCAMP (G){ABOLISH	Aug	1876	4384	10214	10	0	0	0	0	0
2016	[76780] FOREHAND RANCH;WOLFCAMP (G){ABOLISH	Sep	8964	25943	45680	30	0	0	0	0	0
2016	[76780] FOREHAND RANCH;WOLFCAMP (G){ABOLISH	Oct	8114	29690	40345	31	0	0	0	0	0
2016	[76780] FOREHAND RANCH;WOLFCAMP (G){ABOLISH	Nov	5841	19563	28171	30	0	0	0	0	0
2016	[76780] FOREHAND RANCH;WOLFCAMP (G){ABOLISH	Dec	5020	14157	23321	29	0	0	0	0	0
2017	[76780] FOREHAND RANCH;WOLFCAMP (G){ABOLISH	Jan	3777	11621	18666	31	0	0	0	0	0
2017	[98220] PURPLE SAGE;WOLFCAMP (GAS)	Feb	3089	11162	17947	28	0	0	0	0	0
2017	[98220] PURPLE SAGE;WOLFCAMP (GAS)	Mar	2947	12471	18298	31	0	0	0	0	0
2017	[98220] PURPLE SAGE;WOLFCAMP (GAS)	Apr	2531	11992	17936	30	0	0	0	0	0
2017	[98220] PURPLE SAGE;WOLFCAMP (GAS)	May	2517	10675	16094	31	0	0	0	0	0
2017	[98220] PURPLE SAGE;WOLFCAMP (GAS)	Jun	2357	10166	14921	30	0	0	0	0	0
2017	[98220] PURPLE SAGE;WOLFCAMP (GAS)	Jul	2486	4132	13385	31	0	0	0	0	0
2017	[98220] PURPLE SAGE;WOLFCAMP (GAS)	Aug	2438	9886	15189	31	0	0	0	0	0
2017	[98220] PURPLE SAGE;WOLFCAMP (GAS)	Sep	2351	13670	15356	30	0	0	0	0	0
2017	[98220] PURPLE SAGE;WOLFCAMP (GAS)	Oct	2092	10563	14013	31	0	0	0	0	0
2017	[98220] PURPLE SAGE;WOLFCAMP (GAS)	Nov	1730	8012	12869	30	0	0	0	0	0
2017	[98220] PURPLE SAGE;WOLFCAMP (GAS)	Dec	1886	5662	11025	31	0	0	0	0	0
2018	[98220] PURPLE SAGE;WOLFCAMP (GAS)	Jan	1849	5969	10794	31	0	0	0	0	0
2018	[98220] PURPLE SAGE;WOLFCAMP (GAS)	Feb	1553	4161	10475	28	0	0	0	0	0
2018	[98220] PURPLE SAGE;WOLFCAMP (GAS)	Mar	1726	6130	11595	31	0	0	0	0	0
2018	[98220] PURPLE SAGE;WOLFCAMP (GAS)	Apr	1891	8736	13600	30	0	0	0	0	0
2018	[98220] PURPLE SAGE;WOLFCAMP (GAS)	May	1618	8325	12210	31	0	0	0	0	0
2018	[98220] PURPLE SAGE;WOLFCAMP (GAS)	Jun	1385	7468	12548	30	0	0	0	0	0

2018	[98220] PURPLE SAGE;WOLFCAMP (GAS)	Jul	1296	4881	11295	28	0	0	0	0	0
2018	[98220] PURPLE SAGE;WOLFCAMP (GAS)	Aug	1282	6136	9986	27	0	0	0	0	0
2018	[98220] PURPLE SAGE;WOLFCAMP (GAS)	Sep	379	29	4863	13	0	0	0	0	0
2018	[98220] PURPLE SAGE;WOLFCAMP (GAS)	Oct	2108	7024	12182	31	0	0	0	0	0
2018	[98220] PURPLE SAGE;WOLFCAMP (GAS)	Nov	1157	3639	7775	30	0	0	0	0	0
2018	[98220] PURPLE SAGE;WOLFCAMP (GAS)	Dec	945	1250	4676	31	0	0	0	0	0
2019	[98220] PURPLE SAGE;WOLFCAMP (GAS)	Jan	1149	1926	7934	29	0	0	0	0	0
2019	[98220] PURPLE SAGE;WOLFCAMP (GAS)	Feb	1301	4485	9202	28	0	0	0	0	0
2019	[98220] PURPLE SAGE;WOLFCAMP (GAS)	Mar	1127	13761	11532	25	0	0	0	0	0
2019	[98220] PURPLE SAGE;WOLFCAMP (GAS)	Apr	1231	3244	14664	30	0	0	0	0	0
2019	[98220] PURPLE SAGE;WOLFCAMP (GAS)	May	1153	3460	13679	31	0	0	0	0	0
2019	[98220] PURPLE SAGE;WOLFCAMP (GAS)	Jun	1354	4833	13912	30	0	0	0	0	0
2019	[98220] PURPLE SAGE;WOLFCAMP (GAS)	Jul	1296	4948	12074	31	0	0	0	0	0
2019	[98220] PURPLE SAGE;WOLFCAMP (GAS)	Aug	1223	4804	11281	31	0	0	0	0	0
2019	[98220] PURPLE SAGE;WOLFCAMP (GAS)	Sep	1189	5316	11326	30	0	0	0	0	0
2019	[98220] PURPLE SAGE;WOLFCAMP (GAS)	Oct	1168	5569	10783	31	0	0	0	0	0
2019	[98220] PURPLE SAGE;WOLFCAMP (GAS)	Nov	1098	4335	10434	30	0	0	0	0	0
2019	[98220] PURPLE SAGE;WOLFCAMP (GAS)	Dec	1094	5759	11404	31	0	0	0	0	0
2020	[98220] PURPLE SAGE;WOLFCAMP (GAS)	Jan	964	6342	11611	31	0	0	0	0	0
2020	[98220] PURPLE SAGE;WOLFCAMP (GAS)	Feb	927	5768	9245	29	0	0	0	0	0
2020	[98220] PURPLE SAGE;WOLFCAMP (GAS)	Mar	1043	6101	10890	31	0	0	0	0	0
2020	[98220] PURPLE SAGE;WOLFCAMP (GAS)	Apr	930	6017	11398	30	0	0	0	0	0
2020	[98220] PURPLE SAGE;WOLFCAMP (GAS)	May	1003	6610	11607	31	0	0	0	0	0
2020	[98220] PURPLE SAGE;WOLFCAMP (GAS)	Jun	919	6124	10182	30	0	0	0	0	0
2020	[98220] PURPLE SAGE;WOLFCAMP (GAS)	Jul	852	5934	9526	31	0	0	0	0	0
2020	[98220] PURPLE SAGE;WOLFCAMP (GAS)	Aug	862	6204	9472	31	0	0	0	0	0
2020	[98220] PURPLE SAGE;WOLFCAMP (GAS)	Sep	840	6107	9222	30	0	0	0	0	0
2020	[98220] PURPLE SAGE;WOLFCAMP (GAS)	Oct	780	5975	9054	31	0	0	0	0	0
2020	[98220] PURPLE SAGE;WOLFCAMP (GAS)	Nov	661	5162	7980	30	0	0	0	0	0
2020	[98220] PURPLE SAGE;WOLFCAMP (GAS)	Dec	756	6862	8924	31	0	0	0	0	0
2021	[98220] PURPLE SAGE;WOLFCAMP (GAS)	Jan	591	2536	7684	31	0	0	0	0	0
2021	[98220] PURPLE SAGE;WOLFCAMP (GAS)	Feb	653	4646	6777	25	0	0	0	0	0
2021	[98220] PURPLE SAGE;WOLFCAMP (GAS)	Mar	776	5485	8481	31	0	0	0	0	0

2021	[98220] PURPLE SAGE;WOLFCAMP (GAS)	Apr	667	5270	7690	30	0	0	0	0	0
2021	[98220] PURPLE SAGE;WOLFCAMP (GAS)	May	706	5759	8891	31	0	0	0	0	0
2021	[98220] PURPLE SAGE;WOLFCAMP (GAS)	Jun	629	5013	7868	30	0	0	0	0	0
2021	[98220] PURPLE SAGE;WOLFCAMP (GAS)	Jul	695	5765	7572	31	0	0	0	0	0
2021	[98220] PURPLE SAGE;WOLFCAMP (GAS)	Aug	618	5131	6975	31	0	0	0	0	0
2021	[98220] PURPLE SAGE;WOLFCAMP (GAS)	Sep	680	5470	7087	30	0	0	0	0	0

Production Summary Report API: 30-015-43379 DR K 24 23S 27E RB #206H Printed On: Wednesday, November 17 2021											
Year	Pool	Month	Production				Injection				
			Oil(BBLS)	Gas(MCF)	Water(BBLS)	Days P/I	Water(BBLS)	Co2(MCF)	Gas(MCF)	Other	Pressure
2016	[76780] FOREHAND RANCH;WOLFCAMP (G)(ABOLISH	Jun	6236	13963	38649	13	0	0	0	0	0
2016	[76780] FOREHAND RANCH;WOLFCAMP (G)(ABOLISH	Jul	18896	35447	58779	31	0	0	0	0	0
2016	[76780] FOREHAND RANCH;WOLFCAMP (G)(ABOLISH	Aug	15567	32791	45812	31	0	0	0	0	0
2016	[76780] FOREHAND RANCH;WOLFCAMP (G)(ABOLISH	Sep	11988	25120	35058	30	0	0	0	0	0
2016	[76780] FOREHAND RANCH;WOLFCAMP (G)(ABOLISH	Oct	9881	18564	34080	31	0	0	0	0	0
2016	[76780] FOREHAND RANCH;WOLFCAMP (G)(ABOLISH	Nov	8340	20070	28688	30	0	0	0	0	0
2016	[76780] FOREHAND RANCH;WOLFCAMP (G)(ABOLISH	Dec	6835	21367	30812	24	0	0	0	0	0
2017	[76780] FOREHAND RANCH;WOLFCAMP (G)(ABOLISH	Jan	8306	21831	30812	31	0	0	0	0	0
2017	[98220] PURPLE SAGE;WOLFCAMP (GAS)	Feb	7515	23934	35048	28	0	0	0	0	0
2017	[98220] PURPLE SAGE;WOLFCAMP (GAS)	Mar	7062	25001	36175	31	0	0	0	0	0
2017	[98220] PURPLE SAGE;WOLFCAMP (GAS)	Apr	6681	25472	35619	30	0	0	0	0	0
2017	[98220] PURPLE SAGE;WOLFCAMP (GAS)	May	5982	22412	33091	31	0	0	0	0	0
2017	[98220] PURPLE SAGE;WOLFCAMP (GAS)	Jun	5118	20562	30558	30	0	0	0	0	0
2017	[98220] PURPLE SAGE;WOLFCAMP (GAS)	Jul	4492	23574	25350	31	0	0	0	0	0
2017	[98220] PURPLE SAGE;WOLFCAMP (GAS)	Aug	3626	15979	23657	31	0	0	0	0	0
2017	[98220] PURPLE SAGE;WOLFCAMP (GAS)	Sep	3203	7787	20600	30	0	0	0	0	0
2017	[98220] PURPLE SAGE;WOLFCAMP (GAS)	Oct	4247	12680	23983	31	0	0	0	0	0
2017	[98220] PURPLE SAGE;WOLFCAMP (GAS)	Nov	3832	14734	17328	30	0	0	0	0	0
2017	[98220] PURPLE SAGE;WOLFCAMP (GAS)	Dec	3533	13149	15059	31	0	0	0	0	0
2018	[98220] PURPLE SAGE;WOLFCAMP (GAS)	Jan	3657	17951	16864	31	0	0	0	0	0
2018	[98220] PURPLE SAGE;WOLFCAMP (GAS)	Feb	3074	15883	18229	28	0	0	0	0	0
2018	[98220] PURPLE SAGE;WOLFCAMP (GAS)	Mar	3133	17383	18468	31	0	0	0	0	0
2018	[98220] PURPLE SAGE;WOLFCAMP (GAS)	Apr	2668	14170	18217	27	0	0	0	0	0
2018	[98220] PURPLE SAGE;WOLFCAMP (GAS)	May	2956	19878	20204	31	0	0	0	0	0
2018	[98220] PURPLE SAGE;WOLFCAMP (GAS)	Jun	2737	19324	18776	30	0	0	0	0	0
2018	[98220] PURPLE SAGE;WOLFCAMP (GAS)	Jul	2642	16217	15966	28	0	0	0	0	0
2018	[98220] PURPLE SAGE;WOLFCAMP (GAS)	Aug	2384	17169	15465	31	0	0	0	0	0
2018	[98220] PURPLE SAGE;WOLFCAMP (GAS)	Sep	1238	3885	7207	18	0	0	0	0	0
2018	[98220] PURPLE SAGE;WOLFCAMP (GAS)	Oct	3647	7601	15323	31	0	0	0	0	0
2018	[98220] PURPLE SAGE;WOLFCAMP (GAS)	Nov	2134	5386	10791	30	0	0	0	0	0

2018	[98220] PURPLE SAGE;WOLFCAMP (GAS)	Dec	1818	3624	8182	31	0	0	0	0	0
2019	[98220] PURPLE SAGE;WOLFCAMP (GAS)	Jan	1651	4446	9590	31	0	0	0	0	0
2019	[98220] PURPLE SAGE;WOLFCAMP (GAS)	Feb	1610	4570	10207	28	0	0	0	0	0
2019	[98220] PURPLE SAGE;WOLFCAMP (GAS)	Mar	1008	1449	10170	24	0	0	0	0	0
2019	[98220] PURPLE SAGE;WOLFCAMP (GAS)	Apr	1540	3753	12755	30	0	0	0	0	0
2019	[98220] PURPLE SAGE;WOLFCAMP (GAS)	May	1328	3443	12238	31	0	0	0	0	0
2019	[98220] PURPLE SAGE;WOLFCAMP (GAS)	Jun	763	2138	7252	27	0	0	0	0	0
2019	[98220] PURPLE SAGE;WOLFCAMP (GAS)	Jul	1670	5331	14558	30	0	0	0	0	0
2019	[98220] PURPLE SAGE;WOLFCAMP (GAS)	Aug	1802	6100	15086	31	0	0	0	0	0
2019	[98220] PURPLE SAGE;WOLFCAMP (GAS)	Sep	1612	6406	14961	30	0	0	0	0	0
2019	[98220] PURPLE SAGE;WOLFCAMP (GAS)	Oct	1766	7254	14519	31	0	0	0	0	0
2019	[98220] PURPLE SAGE;WOLFCAMP (GAS)	Nov	1742	5976	13656	30	0	0	0	0	0
2019	[98220] PURPLE SAGE;WOLFCAMP (GAS)	Dec	1875	8055	13543	31	0	0	0	0	0
2020	[98220] PURPLE SAGE;WOLFCAMP (GAS)	Jan	2378	8066	12659	31	0	0	0	0	0
2020	[98220] PURPLE SAGE;WOLFCAMP (GAS)	Feb	1609	6930	12837	29	0	0	0	0	0
2020	[98220] PURPLE SAGE;WOLFCAMP (GAS)	Mar	1815	9352	14613	31	0	0	0	0	0
2020	[98220] PURPLE SAGE;WOLFCAMP (GAS)	Apr	1655	10279	13309	30	0	0	0	0	0
2020	[98220] PURPLE SAGE;WOLFCAMP (GAS)	May	1599	11608	12904	31	0	0	0	0	0
2020	[98220] PURPLE SAGE;WOLFCAMP (GAS)	Jun	1478	11288	12987	30	0	0	0	0	0
2020	[98220] PURPLE SAGE;WOLFCAMP (GAS)	Jul	1368	11555	12447	31	0	0	0	0	0
2020	[98220] PURPLE SAGE;WOLFCAMP (GAS)	Aug	1481	12044	12351	31	0	0	0	0	0
2020	[98220] PURPLE SAGE;WOLFCAMP (GAS)	Sep	1366	12403	11766	30	0	0	0	0	0
2020	[98220] PURPLE SAGE;WOLFCAMP (GAS)	Oct	1289	12939	12015	31	0	0	0	0	0
2020	[98220] PURPLE SAGE;WOLFCAMP (GAS)	Nov	1209	11077	10227	30	0	0	0	0	0
2020	[98220] PURPLE SAGE;WOLFCAMP (GAS)	Dec	1271	14246	10989	31	0	0	0	0	0
2021	[98220] PURPLE SAGE;WOLFCAMP (GAS)	Jan	1168	13344	8893	31	0	0	0	0	0
2021	[98220] PURPLE SAGE;WOLFCAMP (GAS)	Feb	1129	10533	8814	25	0	0	0	0	0
2021	[98220] PURPLE SAGE;WOLFCAMP (GAS)	Mar	1253	12798	11093	31	0	0	0	0	0
2021	[98220] PURPLE SAGE;WOLFCAMP (GAS)	Apr	1089	11347	10073	30	0	0	0	0	0
2021	[98220] PURPLE SAGE;WOLFCAMP (GAS)	May	1101	11669	10597	31	0	0	0	0	0
2021	[98220] PURPLE SAGE;WOLFCAMP (GAS)	Jun	944	10513	9181	30	0	0	0	0	0
2021	[98220] PURPLE SAGE;WOLFCAMP (GAS)	Jul	911	11267	9938	31	0	0	0	0	0
2021	[98220] PURPLE SAGE;WOLFCAMP (GAS)	Aug	851	10318	9012	31	0	0	0	0	0

2021	[98220] PURPLE SAGE;WOLFCAMP (GAS)	Sep	838	10034	8864	30	0	0	0	0	0
------	------------------------------------	-----	-----	-------	------	----	---	---	---	---	---

District I
1625 N. French Drive, Hobbs, NM 88240
District II
811 S. First St., Artesia, NM 88210
District III
1000 Rio Brazos Road, Aztec, NM 87410
District IV
1220 S. St Francis Dr, Santa Fe, NM
87505

State of New Mexico
Energy, Minerals and Natural Resources Department

Form C-107-B
Revised August 1, 2011

OIL CONSERVATION DIVISION
1220 S. St Francis Drive
Santa Fe, New Mexico 87505

Submit the original
application to the Santa Fe
office with one copy to the
appropriate District Office.

APPLICATION FOR SURFACE COMMINGLING (DIVERSE OWNERSHIP)

OPERATOR NAME: Matador Production Company
OPERATOR ADDRESS: 5400 LBJ Freeway Tower 1 Suite 1500 Dallas, TX 75240
APPLICATION TYPE:

☐ Pool Commingling ☒ Lease Commingling ☐ Pool and Lease Commingling ☐ Off-Lease Storage and Measurement (Only if not Surface Commingled)

LEASE TYPE: ☒ Fee ☐ State ☒ Federal

Is this an Amendment to existing Order? ☒ Yes ☐ No If "Yes", please include the appropriate Order No. CTB 786-A
Have the Bureau of Land Management (BLM) and State Land office (SLO) been notified in writing of the proposed commingling
☒ Yes ☐ No

(A) POOL COMMINGLING
Please attach sheets with the following information

(1) Pool Names and Codes	Gravities / BTU of Non-Commingled Production	Calculated Gravities / BTU of Commingled Production	Calculated Value of Commingled Production	Volumes

CFD

- (3) Has all interest owners been notified by certified mail of the proposed commingling? ☐ Yes ☐ No.
(4) Measurement type: ☐ Metering ☐ Other (Specify)
(5) Will commingling decrease the value of production? ☐ Yes ☐ No If "yes", describe why commingling should be approved

(B) LEASE COMMINGLING
Please attach sheets with the following information

- (1) Pool Name and Code: PURPLE SAGE; WOLFCAMP (GAS) 98220
(2) Is all production from same source of supply? ☒ Yes ☐ No
(3) Has all interest owners been notified by certified mail of the proposed commingling? ☒ Yes ☐ No
(4) Measurement type: ☒ Metering ☒ Other (Specify)
Measurement for all wells will be metered via well test

(C) POOL and LEASE COMMINGLING
Please attach sheets with the following information

- (1) Complete Sections A and E.

(D) OFF-LEASE STORAGE and MEASUREMENT
Please attached sheets with the following information

- (1) Is all production from same source of supply? ☐ Yes ☐ No
(2) Include proof of notice to all interest owners.

(E) ADDITIONAL INFORMATION (for all application types)
Please attach sheets with the following information

- (1) A schematic diagram of facility, including legal location.
(2) A plat with lease boundaries showing all well and facility locations. Include lease numbers if Federal or State lands are involved.
(3) Lease Names, Lease and Well Numbers, and API Numbers.

I hereby certify that the information above is true and complete to the best of my knowledge and belief.

SIGNATURE: _____ TITLE: Sr. Production Engineer DATE: 12/15/2021

TYPE OR PRINT NAME Omar Enriquez TELEPHONE NO.: (972) 587-4638

E-MAIL ADDRESS: oenriquez@matadorresources.com

EXHIBIT 4

Matador Production Company

One Lincoln Centre • 5400 LBJ Freeway • Suite 1500 • Dallas, Texas 75240

Voice 972.587.4638 • Fax 972.371.5201

oenriquez@matadorresources.com

Omar Enriquez
Senior Production Engineer

December 15, 2021

New Mexico Oil Conservation Division
1220 South St. Francis Drive
Santa Fe, NM 87505

Re: Application of Matador Production Company for Administrative Approval to Amend Administrative Order CTB-786-A to Surface Commingle (lease commingle) Production from the Horizontal Spacing Units Comprising of Section 24, Township 23 South, Range 27 East and the S2 of Section 23 Township 23 South, Range 27 East, NMPM, Eddy County, New Mexico (the “Lands”), and to allocate via well test method.

To Whom This May Concern,

Under NMOCD Order No. CTB-786-A, Matador Production Company (“Matador”), OGRID: 228937, was authorized to surface commingle production from the Purple Sage; Wolfcamp (Gas) Pool (Pool Code 98220) from production in the S/2 of Section 23, Township 23 South, Range 27 East and Section 24, Township 23 South, Range 27 East, NMPM, Eddy County, New Mexico. Pursuant to this application, Matador seeks to amend Order No. CTB-786-A to allow for allocation of this commingled production via well test, as described below.

Specifically, Matador requests to surface commingle current and upcoming production from five (5) wells located on the Lands and future production from the Lands as described herein. Production will be allocated on a daily basis based on the most recent individual well tests of oil, gas, and water. These well tests will last a minimum of 24 hours and will be conducted following the guidelines shown below:

Period	From:	To:	Test frequency per month
Initial Production	First Production	Peak production or 30 days after first production	10
Plateau	End of initial production	Peak decline rate	3
Decline	End of Plateau	P&A	3

Application to Amend Administrative Order CTB-786-A, October 2021

Gas exiting each test separator will flow into one gathering line, as depicted on **Exhibit A**, the Longwood Gathering line. Each test separator will have its own orifice meter manufactured and assembled in accordance with American Gas Association (AGA) specifications. All primary and secondary Electronic Flow Measurement (EFM) equipment is tested and calibrated by a reputable third-party measurement company in accordance with industry specifications.

The orifice meter is the preferred measurement device utilized by midstream and E&P companies in natural gas measurement. The gas samples are obtained at the time of the meter testing/calibration and the composition and heating value are determined by a laboratory in accordance with American Petroleum Institute (API) specifications to ensure accurate volume and Energy (MMBTU) determinations. See example from Laboratory Services attached as **Exhibit B** hereto.

The flow stream from each wellhead is demonstrated in the Process Flow Diagram (PFD) attached as **Exhibit A** hereto.

The PFD shows that the water, oil, and gas exit the wellbore and flow into a test separator which separates the oil, gas, and water. The oil is measured via turbine meter which is calibrated periodically in accordance with industry specifications by a third-party measurement company for accuracy. The gas is measured on a volume and MMBTU basis by an orifice meter and supporting EFM equipment in accordance with American Petroleum Association (API) Chapter 21.1. The gas is then sent into a gathering line where it is commingled with each of the other wells' metered gas, as previously described on page one. The gathering line gas is then metered by another orifice meter at the tank battery check to show the total volume of gas leaving the tank battery. This meter is tested and calibrated in accordance with industry specifications and volume and energy are determined on an hourly, daily, and monthly basis.

Once the gas exits this final tank battery sales check it travels directly into a third-party sales connect meter. Longwood Gathering has its own orifice meter that measures the gas for custody transfer. These meters are also calibrated periodically to ensure the measurement accuracy.

Very truly yours,

MATADOR PRODUCTION COMPANY

Omar Enriquez
Sr. Production Engineer

Enclosures





www.permianls.com
575.397.3713 2609 W Marland Hobbs NM 88240

C6+ Gas Analysis Report

9022G	40-10162	Dr K 201H	
Sample Point Code	Sample Point Name	Sample Point Location	
Laboratory Services	2021045942	1852	BF - Spot
Source Laboratory	Lab File No	Container Identity	Sampler
USA	USA	USA	New Mexico
District	Area Name	Field Name	Facility Name
Sep 16, 2021 08:00	Sep 16, 2021 08:00	Sep 22, 2021 12:07	Sep 23, 2021
Date Sampled	Date Effective	Date Received	Date Reported
70.00	965.00	Torrance	108 @ 80
Ambient Temp (°F)	Flow Rate (Mcf)	Analyst	Press PSI @ Temp °F Source Conditions
Matador Resources		NG	
Operator		Lab Source Description	

Component	Normalized Mol %	Un-Normalized Mol %	GPM
H2S (H2S)	0.0000	0	
Nitrogen (N2)	0.9530	0.95264	
CO2 (CO2)	0.0460	0.0458	
Methane (C1)	77.7180	77.71781	
Ethane (C2)	11.6240	11.62437	3.1080
Propane (C3)	5.7230	5.72318	1.5760
I-Butane (IC4)	0.7460	0.74627	0.2440
N-Butane (NC4)	1.7540	1.75426	0.5530
I-Pentane (IC5)	0.3930	0.39299	0.1440
N-Pentane (NC5)	0.4390	0.43914	0.1590
Hexanes Plus (C6+)	0.6040	0.60355	0.2620
TOTAL	100.0000	100.0000	6.0460

Method(s): Gas C6+ - GPA 2261, Extended Gas - GPA 2286, Calculations - GPA 2172

Gross Heating Values (Real, BTU/ft³)			
14.696 PSI @ 60.00 Å°F		14.73 PSI @ 60.00 Å°F	
Dry	Saturated	Dry	Saturated
1,284.9	1,263.9	1,287.9	1,266.8

Calculated Total Sample Properties	
GPA2145-16 *Calculated at Contract Conditions	
Relative Density Real	Relative Density Ideal
0.7410	0.7385
Molecular Weight	
21.3901	

C6+ Group Properties		
Assumed Composition		
C6 - 60.000%	C7 - 30.000%	C8 - 10.000%

Field H2S
4 PPM

PROTREND STATUS:

Passed By Validator on Sep 23, 2021

DATA SOURCE:

Imported

PASSED BY VALIDATOR REASON:

Close enough to be considered reasonable.

VALIDATOR:

Dustin Armstrong

VALIDATOR COMMENTS:

OK

Analyzer Information	
Device Type:	Device Make:
Device Model:	Last Cal Date:



United States Department of the Interior

BUREAU OF LAND MANAGEMENT
New Mexico State Office
301 Dinosaur Trail
Santa Fe, New Mexico 87508
<https://www.blm.gov/new-mexico>



MAR 31 2021

In Reply Refer To:

NMNM139002

3105.2 (NM920)

Reference:

Communitization Agreement

Norris Thornton Com #204H

Section 23: S2

T. 23 S., R. 27 E., N.M.P.M.

Eddy County, NM

Matador Production Company
5400 LBJ Freeway, Suite 1500
Dallas, TX 75240

Gentlemen:

Enclosed is an approved copy of Communitization Agreement NMNM139002 involving 40 acres of Federal land in lease NMNM139351 and 280 acres of fee land, Eddy County, New Mexico, which comprise a 320 acre well spacing unit.

The agreement communitizes all rights to all producible hydrocarbons from the Wolfcamp formation beneath the S2 of Sec. 23, T. 23 S., R. 27 E., NMPM, Eddy County, NM, and is effective June 1, 2018. Approval of this agreement does not warrant or certify that the operator, thereof, and other working interest owners hold legal or equitable title to the leases which are committed hereto.

Approval of this agreement does not constitute an adjudication of any state, local government, or private interests, and does not constitute a warranty or certification that the information supplied by the party submitting this agreement regarding any private, state, or local government interests is accurate.

EXHIBIT 5

INTERIOR REGION 5 · MISSOURI BASIN
Kansas, Most of Montana, North Dakota,
Nebraska, South Dakota

**INTERIOR REGION 6 · ARKANSAS-
RIO GRANDE-TEXAS GULF**
Oklahoma, Texas

**INTERIOR REGION 7 · UPPER
COLORADO BASIN**
Colorado, New Mexico, Utah, Wyoming

Copies of this approval letter are being distributed to the appropriate Federal agencies. You are requested to furnish all interested parties with the appropriate evidence of this approval. Any production royalties that are due must be reported and paid according to regulations set up by the Office of Natural Resources Revenue at 1-800-525-9167 or 303-231-3504.

If you have any questions regarding this approval, please contact Elizabeth Rivera at (505) 954-2162.

Please furnish all interested principals with appropriate evidence of this approval.

Sincerely,

Sheila Mallory
Deputy State Director
Division of Minerals

1 Enclosure:

1 - Communitization Agreement

cc:

ONRR, Denver

NM Taxation & Revenue Dept. (Revenue Processing Div.)

NMOCD

NM (9200)

NM (P0220-CFO, File Room)

NMSO (NM925, File)

NM STATE LAND COMM.

Determination - Approval - Certification

Pursuant to the authority vested in the Secretary of the Interior under Section 17(j) of the Mineral Leasing Act of 1920, as amended (74 Stat. 784; 30 U.S.C. 226(j)), and delegated to the authorized officer of the Bureau of Land Management, I do hereby:

- A. Determine that the Federal lease or leases as to the lands committed to the attached agreement cannot be independently developed and operated in conformity with the well-spacing program established for the field or area in which said lands are located, and that consummation and approval of the agreement will be in the public interest. Approval of this agreement does not warrant or certify that the operator thereof and other holders of operating rights hold legal or equitable title to those rights in the subject leases which are committed hereto.
- B. Approve the attached Communitization Agreement covering the S2 of Sec. 23, T. 23 S., R. 27 E., NMPM, as to all producible hydrocarbons from the Wolfcamp formation. This approval will become invalid if the public interest requirements under section 3105.2-3 (c) are not met. Approval also requires operator to submit copies of sundries or any other documentation regarding activity with this well to the Bureau of Land Management (BLM), Carlsbad Field Office pursuant to Item 9 of the approved Communitization Agreement.
- C. Certify and determine that the drilling, producing, rental, minimum royalty and royalty requirements of the Federal lease or leases committed to said agreement are hereby established, altered, changed, or revoked to conform with the terms and conditions of the agreement.

Approved:

MAR 31 2021

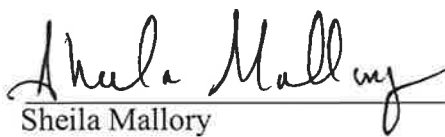

Sheila Mallory
Deputy State Director
Division of Minerals

Effective: June 1, 2018

Contract No.: Com. Agr. NMNM139002

COMMUNITIZATION AGREEMENT

Contract No. 51 NMNM 139002

THIS AGREEMENT, entered into as of the date shown in Section 10 hereof by and between the parties subscribing, ratifying, or consenting hereto, such parties being hereinafter referred to as "parties hereto."

WITNESSETH:

WHEREAS, the act of February 25, 1920 (41 Stat. 437), as amended and supplemented, authorized communitization or drilling agreements communitizing or pooling a Federal oil and gas lease, or any portion thereof, with other lands, whether or not owned by the United States, when separate tracts under such Federal lease cannot be independently developed and operated in conformity with an established well-spacing program for the field or area and such communitization or pooling is determined to be in the public interest; and

WHEREAS, the Commissioner of Public Lands of the State of New Mexico, herein called "the Commissioner", is authorized to consent to and approve agreements pooling state oil and gas leases or any portion thereof, when separate tracts under such state leases cannot be independently developed and operated economically in conformity with well-spacing and gas proration rules and regulations established for the field or area and such pooling is determined to be in the public interest; and

WHEREAS, the parties hereto own working, royalty or other leasehold interests, or operating rights under the oil and gas leases and lands subject to this agreement which cannot be independently developed and operated in conformity with the well-spacing program established for the field or area in which said lands are located; and

WHEREAS, the parties hereto desire to communitize and pool their respective mineral interests in lands subject to this agreement for the purpose of developing and producing communitized substances in accordance with the terms and conditions of this agreement;

NOW, THEREFORE, in consideration of the premises and the mutual advantages to the parties hereto, it is mutually covenanted and agreement by and between the parties hereto as follows:

1. The lands covered by this agreement (hereinafter referred to as "communitized area") are described as follows, and as depicted on "Exhibit "A".

S/2 of Section 23, Township 23 South, Range 27 East, Eddy County, New Mexico

containing **320.00 acres**, more or less, and this agreement shall include the **Wolfcamp Formation** underlying said lands and the crude oil, natural gas and associated liquid hydrocarbons, hereinafter referred to as "communitized substances," producible from such formations.

Norris Thornton Com #204H
Township 23 South, Range 27 East, N.M.P.M
Section 23: S/2
Eddy County, New Mexico

2. Attached hereto, and made a part of this agreement for all purposes is Exhibit B, designating the operator of the communitized area and showing the acreage, percentage and ownership of oil and gas interests in all lands within the communitized area, and the authorization, if any, for communitizing or pooling any patented or fee lands within the communitized area.

3. All matters of operation shall be governed by the operator under and pursuant to the terms and provisions of this agreement. A successor operator may be designated by the owners of the working interest in the communitized area and three (3) executed copies of a designation of successor operator shall be filed with the Authorized Officer and three (3) additional executed copies thereof shall be filed with the Commission.

4. Operator shall furnish the Secretary of the Interior, and the Commissioner, or his authorized representative, with a log and history of any well drilled on the communitized area, monthly reports of operations, statements of oil and gas sales and royalties and such other reports as are deemed necessary to compute monthly the royalty due the United States and the State of New Mexico, as specified in the applicable oil and gas regulations.

5. The communitized area shall be developed and operated as an entirety, with the understanding and agreement between the parties hereto that all communitized substances produced therefrom shall be allocated among the leaseholds comprising said area in the proportion that the acreage interest of each leasehold bears to the entire acreage committed to this agreement.

All proceeds, 8/8ths, attributed to unleased Federal, State, or Fee land included within the CA area are to be placed in an interest earning escrow or trust account by the designated operator until the land is leased or ownership is established.

6. The royalties payable on communitized substances allocated to the individual leases comprising the communitized area and the rentals provided for in said leases shall be determined and paid on the basis prescribed in each of the individual leases. Payments of rentals under the terms of leases subject to this agreement shall not be affected by this agreement except as provided for under the terms and provisions of said leases or as may herein be otherwise provided. Except as herein modified and changed, the oil and gas leases subject to this agreement shall remain in full force and effect as originally made and issued. It is agreed that for any Federal lease bearing a sliding or step-scale rate of royalty, such rate shall be determined separately as to production from each communitization agreement to which such lease may be committed, and separately as to any noncommunitized lease production, provided, however, as to leases where the rate of royalty for gas is based on total lease production per day, such rate shall be determined by the sum of all communitized production allocated to such a lease plus any noncommunitized lease production.

7. There shall be no obligation on the lessees to offset any well or wells completed in the same formation as covered by this agreement on separate component tracts into which the communitized area is now or may hereafter be divided, nor shall any lessee be required to measure separately communitized substances by reason of the diverse ownership thereof, but the lessees hereto shall not be released from their obligation to protect said communitized area from drainage of communitized substances by a well or wells which may be drilled offsetting said area.

8. The commencement, completion, continued operations, or production of a well or wells for communitized substances on the communitized area shall be construed and considered as a commencement, completion, continued operations, or production on each and all of the lands within and comprising said communitized area, and operations or production pursuant to this agreement shall be deemed to be operations or production as to each lease committed hereto.

9. Production of communitized substances and disposal thereof shall be in conformity with allocation, allotments, and quotas made or fixed by any duly authorized person or regulatory body under applicable Federal or State statutes. This agreement shall be subject to all applicable Federal and State laws or executive orders, rules and regulations, and no party hereto shall suffer a forfeiture or be liable in damages for failure to comply with any of the provisions of this agreement if such compliance is prevented by, or if such failure results from, compliance with any such laws, orders, rules or regulations.

10. This agreement is effective **June 1, 2018**, upon execution of the necessary parties, notwithstanding the date of execution, and upon approval by the Secretary of Interior, or his duly authorized representative, and shall remain in force and effect for a period of two (2) years and so long thereafter as communitized substances are produced or can be produced from the communitized area in paying quantities; provided, that this agreement shall not expire if there is a well capable of producing gas in paying quantities located upon some part of the communitized area, if such well is shut-in due to the inability of the operator to obtain a pipeline connection or to market the gas therefrom, and if a shut-in royalty has been timely and properly paid pursuant to the provisions of one of the State of New Mexico oil and gas leases covering lands subject to this agreement so as to prevent the expiration of such lease; provided further that prior to production in paying quantities from the communitized area and upon fulfillment of all requirements of the Secretary of Interior, or his duly authorized representative, and all requirements of the Commissioners, with respect to any dry hole or abandoned well, this agreement may be terminated at any time by mutual agreement of the parties hereto. This agreement shall not terminate upon cessation of production if, within sixty (60) days thereafter, reworking or drilling operations on the communitized area are commenced and are thereafter conducted and prosecuted with reasonable diligence during the period of nonproduction. The two-year term of this agreement will not in itself serve to extend the term of any Federal lease which would otherwise expire during said period. As to lands owned by the State of New Mexico, there shall be no cessation of more than twenty (20) consecutive days; provided, however, that as to lands owned by the State of New Mexico, written notice of intention to commence such operations shall be filed with the Commissioner within thirty (30) days after the cessation of such production, and a report of the status of such operations shall be made by the Operator to the Commissioner every thirty (30) days, and the cessation of such operations for more than twenty (20) consecutive days shall be considered as an abandonment of such operations as to any lease from the State of New Mexico included in this agreement.

11. The covenants herein shall be construed to be covenants running with the land with respect to the communitized interests of the parties hereto and their successors in interest until this agreement terminates, and any grant, transfer, or conveyance of any such land or interest subject hereto, whether voluntary or not, shall be and hereby is conditioned upon the assumption of all obligations hereunder by the grantee, transferee, or other successor in interest, and as to Federal

lands shall be subject to approval by the Secretary of the Interior, or his duly authorized representative.

12. It is agreed by the parties hereto that the Secretary of the Interior, or his duly authorized representative, shall have the right of supervision over all operations within the communitized area to the same extent and degree as provided in the oil and gas leases under which the United States of America is lessor, and in the applicable oil and gas operating regulations of the Department of the Interior. It is further agreed between the parties hereto that the Commissioner shall have the right of supervision over all operations to the same extent and degree as provided in the oil and gas leases under which the State of New Mexico is lessor and in the applicable oil and gas statutes and regulations of the State of New Mexico.

13. This agreement shall be binding upon the parties hereto and shall extend to and be binding upon their respective heirs, executors, administrators, successors, and assigns.

14. This agreement may be executed in any number of counterparts, no one of which needs to be executed by all parties, or may be ratified or consented to by separate instrument, in writing, specifically referring hereto, and shall be binding upon all parties who have executed such a counterpart, ratification or consent hereto with the same force and effect as if all parties had signed the same document.

15. Nondiscrimination: In connection with the performance of work under this agreement, the operator agrees to comply with all of the provisions of Section 202(1) to (7) inclusive, of Executive Order 11246 (30 F.R. 12319), as amended, which are hereby incorporated by reference in this agreement.

IN WITNESS WHEREOF, the parties hereto have executed this agreement as of the date and year first above written and have set opposite their respective names the date of execution.

I, the undersigned, hereby certify, on behalf of Matador Production Company, the Operator of the proposed Communitization Agreement, that all working interest owners (i.e., lessees of record and operating right owners) shown on Exhibit "B" attached to the Communitization Agreement are, to the best of my knowledge, the working interest owners of the Federal or Indian leases subject to the Communitization Agreement, and that the written consents of all of the named owners have been obtained and will be made available to the BLM immediately upon request.

OPERATOR:

Date: 6/27/18

By: 

Name: Craig N. Adams

Title: Executive Vice President

Norris Thornton Com #204H
Township 23 South, Range 27 East, N M P M
Section 23: S/2
Eddy County, New Mexico

CORPORATE ACKNOWLEDGEMENT**STATE OF TEXAS**§
§
§**COUNTY OF DALLAS**

The foregoing instrument was acknowledged before me this 27 day of June, 2018, by Craig N. Adams, Executive Vice President of **Matador Production Company**, a Texas corporation, on behalf of said corporation.



My Commission Expires:

2/12/20

Rachel Edwards
Notary Public, State of Texas

WORKING INTEREST OWNER/RECORD TITLE OWNER:

MRC Permian Company

Date:

6/27/18

By:

[Signature]Name: Craig N. AdamsTitle: Executive Vice PresidentSMH
PDL**MRC Permian LKE Company**

Date:

6/27/18

By:

[Signature]Name: Craig N. AdamsTitle: Executive Vice PresidentSMH
PDL

CORPORATE ACKNOWLEDGEMENT**STATE OF TEXAS**§
§
§**COUNTY OF DALLAS**

The foregoing instrument was acknowledged before me this 21 day of June, 2018, by **Craig N. Adams, Executive Vice President** of MRC Permian Company, a Texas corporation, on behalf of said corporation.

My Commission Expires:

2/2/20

Rachel Edwards
Notary Public, State of Texas

STATE OF TEXAS§
§
§**COUNTY OF DALLAS**

The foregoing instrument was acknowledged before me this 21 day of June, 2018, by **Craig N. Adams, Executive Vice President** of MRC Permian LKE Company, a Texas corporation, on behalf of said corporation.

My Commission Expires:

2/2/20

Rachel Edwards
Notary Public, State of Texas



EXHIBIT "A"

**PLAT OF COMMUNITIZED AREA COVERING THE S/2 OF SECTION 23,
TOWNSHIP 23 SOUTH, RANGE 27 EAST, N.M.P.M., EDDY COUNTY, NEW MEXICO**

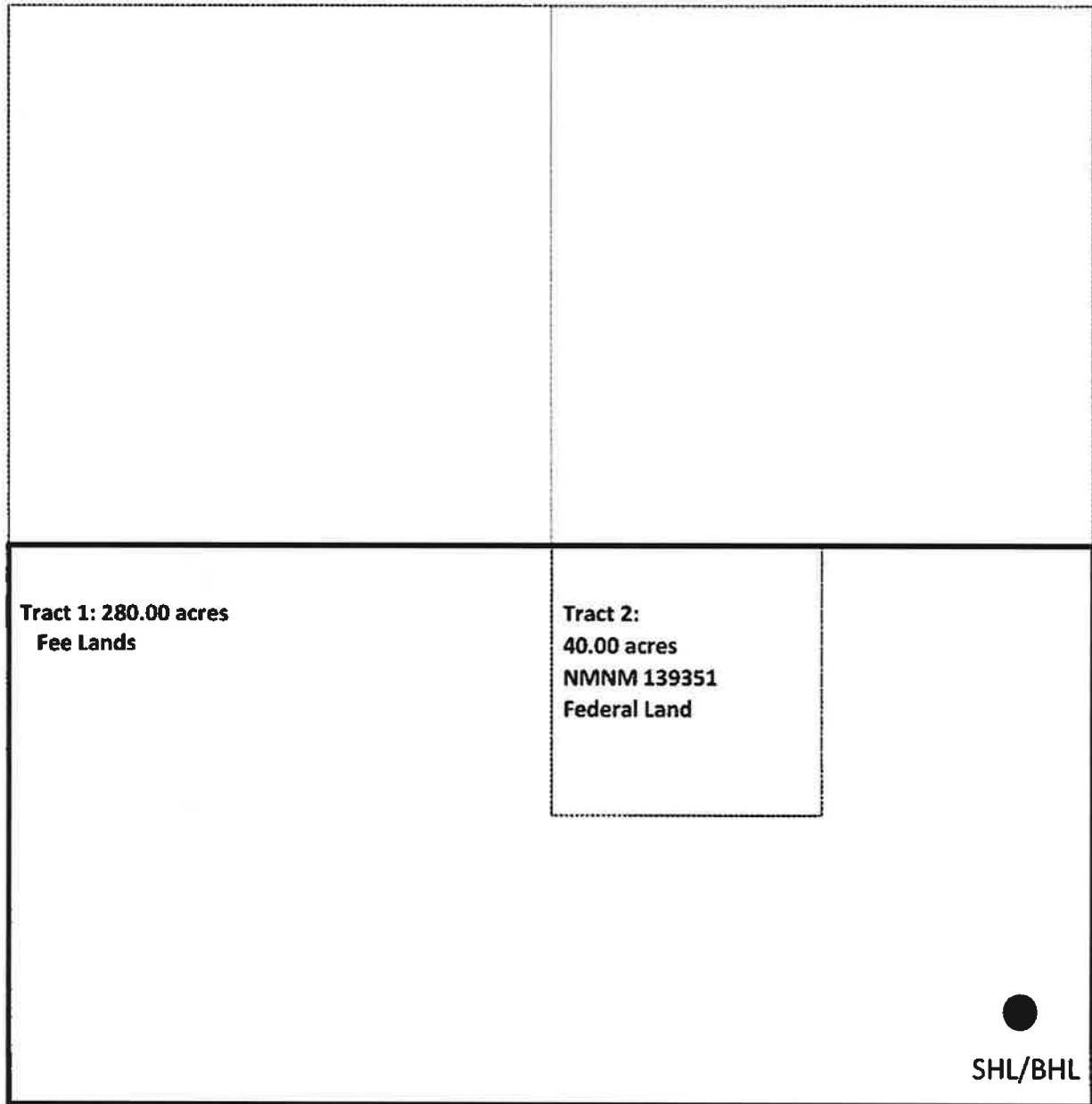

Norris Thornton Com #204H
Township 23 South, Range 27 East, N.M.P.M
Section 23: S/2
Eddy County, New Mexico

EXHIBIT "B"

**ATTACHED TO AND MADE A PART OF THAT CERTAIN COMMUNITIZATION
AGREEMENT DATED JUNE 01, 2018, COVERING THE S/2 OF SECTION 23,
TOWNSHIP 23 SOUTH, RANGE 27 EAST, N.M.P.M., EDDY COUNTY, NEW MEXICO**

DESCRIPTION OF LEASES COMMITTED:**Tract No. 1:**

Lessor: Fee Mineral Owners
 Lessee of Record: MRC Permian Company and MRC Permian LKE Company
 Description of Township 23 South, Range 27 East, N.M.P.M.
 Lands Committed: Section 23: SW/4, S/2SE/4 and NE/4SE/4
 Number of Acres: 280.00

Tract No. 1 Working Interest Owner:

MRC Permian Company	42.59246%
MRC Permian LKE Company	<u>57.40754%</u>
	100.0000%

Tract No. 2:

Lessor: United States of America (NMNM-139351)
 Lessee of Record: Flat Creek Resources
 Description of Township 23 South, Range 27 East, N.M.P.M.
 Lands Committed: Section 23: NW/4SE/4
 Number of Acres: 40.00

RECAPITULATION

<u>Tract No.</u>	<u>Acreage Committed</u>	<u>Percentage of Interest</u>
Tract 1	280.00	87.50%
Tract 2	40.00	<u>12.50%</u>
Total:	320.00 acres	100.00%

Norris Thornton Com #204H
 Township 23 South, Range 27 East, N.M.P.M.
 Section 23: S/2
 Eddy County, New Mexico

ADDR1	ADDR2	ADDR3	ADDR4	ADDR5
Big Three Energy Group LLC	P.O. Box 429	Roswell	NM	88202-0429
Bonnie R. Norfleet Newman	1564 Northcrest Lane	Vista	CA	92083
Camarie Oil and Gas, LLC	2502 Camarie Ave	Midland	TX	79705
Featherstone Development Corp.	P.O. Box 429	Roswell	NM	88202-0429
MRC Permian Company	5400 LBJ Freeway, Suite 1500	Dallas	TX	75240
Penasco Petroelum LLC	P.O. Box 2202	Roswell	NM	88202
Prospector LLC	P.O. Box 429	Rosewell	NM	88202-0429
Reed T. Kimbley, SSP	P.O. Box 595	Loving	NM	88256
Rolla R. Hinkle, III	P.O. Box 2292	Roswell	NM	88202-2292
Ross Duncan Properties LLC	P.O. Box 647	Artesia	NM	88211-0647
Sandra K. Norfleet Clark	314 Palace Dr.	St. Augustine	FL	32084
Shrader Enterprises, LP, a Kansas Ltd Partnership	3349 South St. Paul	Wichita	KS	67217
XPLO Resources LLC	1104 North Shore Drive	Carlsbad	NM	88220-4638
Chalcam Exploration LLC	403 Tierra Berrenda	Roswell	NM	88201
Gumesinda Carrasco Onsurez Rev Trust Antonio Onsurez, Trustee	P.O. Box 598	Loving	NM	88256
Hope Royalites LLC	P.O. Box 1326	Artesia	NM	88211
Lovella Williams Kilman	8425 James Ave NE	Albuquerque	NM	87111
Melissa McCarthy, f/k/a Melissa G. Williams	48073 Larrabee St.	Edwall	WA	99008
Tierra Oil Company, LLC	P.O. Box 1220	Jupiter	FL	33468-1220
1836 Royalty Partners LLC	116 S FM 1187	Aledo	TX	76008
Blind Side, LLC	P.O. Box 429	Roswell	NM	88202
GREP III-A Permian, LLC	2911 Turtle Creek Blvd., Ste. 1150	Dallas	TX	75219
Jubilee Royalty Holdings LLC	P.O. Box 192	New York	NY	10024
Michael Price	5450 Governor Circle	Stockton	CA	95210
Office of Natural Resources	P.O. Box 25627	Denver	CO	80225-0627
Robert B. Callison	406 Cimaron Trail	Carlsbad	NM	88220
Sandra K. Grant	9210 Dona Lugo Way	Stockton	CA	95210
Tundra AD3 LP	2100 Ross Ave., Ste. 1870, LB-9	Dallas	TX	75201-6773
Valspark Oil and Gas, LLC	36 Positano Loop	Roswell	NM	88220-4638
Bureau of Land Management	301 Dinosaur Trail	Santa Fe	NM	87508
Bureau of Land Management	620 E Greene St.	Carlsbad	NM	88220

EXHIBIT 6



Adam G. Rankin
Phone (505) 954-7294
Fax (505) 819-5579
AGRankin@hollandhart.com

March 10, 2022

CERTIFIED MAIL
RETURN RECEIPT REQUESTED

TO: ALL AFFECTED PARTIES

Re: Application of Matador Production Company to amend Administrative Order CTB-786-A (regarding lease commingling at the Dr K Central Tank Battery located in Unit M, Section 24, Township 23 South, Range 27 East, Eddy County, New Mexico), to authorize allocation via well test method.

Ladies and Gentlemen:

Enclosed is a copy of the above-referenced application, which was filed with the New Mexico Oil Conservation Division on this date. Any objection to this application must be filed in writing within twenty days from this date at the Division's Santa Fe office located at 1220 South St. Francis Drive, Santa Fe, New Mexico, 87505. If no objection is received within this twenty-day period, this application may be approved administratively by the Division.

If you have any questions about this application, please contact the following:

Kyle Perkins
Matador Production Company
(972) 371-5202
kperkins@matadorresources.com

Sincerely,

A handwritten signature in blue ink, appearing to be "A.G. Rankin", written over a horizontal line.

Adam G. Rankin
ATTORNEY FOR
MATADOR PRODUCTION COMPANY

Parent ID	Mail Date	Company	Name	Address	City	ST	Zip	MailClass	TrackingNo	Well
31309	03/10/2022		Big Three Energy Group LLC	PO Box 429	Roswell	NM	88202-0429	Certified with Return Receipt (Signature)	94148118987 65846511066	71998 - Matador - Dr. K_Norris Thronton CTB C107B - notice list - 1
31309	03/10/2022		Bonnie R. Norfleet Newman	1564 Northcrest Ln	Vista	CA	92083-1912	Certified with Return Receipt (Signature)	94148118987 65846511028	71998 - Matador - Dr. K_Norris Thronton CTB C107B - notice list - 2
31309	03/10/2022		Camarie Oil and Gas, LLC	2502 Camarie Ave	Midland	TX	79705-6309	Certified with Return Receipt (Signature)	94148118987 65846511004	71998 - Matador - Dr. K_Norris Thronton CTB C107B - notice list - 3
31309	03/10/2022		Featherstone Development Corp.	PO Box 429	Roswell	NM	88202-0429	Certified with Return Receipt (Signature)	94148118987 65846511097	71998 - Matador - Dr. K_Norris Thronton CTB C107B - notice list - 4
31309	03/10/2022		MRC Permian Company	5400 Lbj Fwy Ste 1500	Dallas	TX	75240-1017	Certified with Return Receipt (Signature)	94148118987 65846511042	71998 - Matador - Dr. K_Norris Thronton CTB C107B - notice list - 5
31309	03/10/2022		Penasco Petroelum LLC	PO Box 2202	Roswell	NM	88202-2202	Certified with Return Receipt (Signature)	94148118987 65846511080	71998 - Matador - Dr. K_Norris Thronton CTB C107B - notice list - 6
31309	03/10/2022		Prospector LLC	PO Box 429	Roswell	NM	88202-0429	Certified with Return Receipt (Signature)	94148118987 65846511035	71998 - Matador - Dr. K_Norris Thronton CTB C107B - notice list - 7
31309	03/10/2022		Reed T. Kimbley, SSP	PO Box 595	Loving	NM	88256-0595	Certified with Return Receipt (Signature)	94148118987 65846511073	71998 - Matador - Dr. K_Norris Thronton CTB C107B - notice list - 8

Parent ID	Mail Date	Company	Name	Address	City	ST	Zip	MailClass	TrackingNo	Well
31309	03/10/2022		Rolla R. Hinkle, III	PO Box 2292	Roswell	NM	88202-2292	Certified with Return Receipt (Signature)	94148118987 65846511417	71998 - Matador - Dr. K_Norris Thronton CTB C107B - notice list - 9
31309	03/10/2022		Ross Duncan Properties LLC	PO Box 647	Artesia	NM	88211-0647	Certified with Return Receipt (Signature)	94148118987 65846511455	71998 - Matador - Dr. K_Norris Thronton CTB C107B - notice list - 10
31309	03/10/2022		Sandra K. Norfleet Clark	314 Palace Dr	St Augustine	FL	32084-6656	Certified with Return Receipt (Signature)	94148118987 65846511462	71998 - Matador - Dr. K_Norris Thronton CTB C107B - notice list - 11
31309	03/10/2022	Shrader Enterprises, LP,	a Kansas Ltd Partnership	3349 S Saint Paul Ave	Wichita	KS	67217-1628	Certified with Return Receipt (Signature)	94148118987 65846511424	71998 - Matador - Dr. K_Norris Thronton CTB C107B - notice list - 12
31309	03/10/2022		XPLOR Resources LLC	1104 North Shore Dr	Carlsbad	NM	88220-4638	Certified with Return Receipt (Signature)	94148118987 65846511493	71998 - Matador - Dr. K_Norris Thronton CTB C107B - notice list - 13
31309	03/10/2022		Chalcam Exploration LLC	403 Tierra Berrenda Dr	Roswell	NM	88201-7837	Certified with Return Receipt (Signature)	94148118987 65846511486	71998 - Matador - Dr. K_Norris Thronton CTB C107B - notice list - 14
31309	03/10/2022	Gumesinda Carrasco Onsurez Rev Trust	Antonio Onsurez, Trustee	PO Box 598	Loving	NM	88256-0598	Certified with Return Receipt (Signature)	94148118987 65846511431	71998 - Matador - Dr. K_Norris Thronton CTB C107B - notice list - 15
31309	03/10/2022		Hope Royalites LLC	PO Box 1326	Artesia	NM	88211-1326	Certified with Return Receipt (Signature)	94148118987 65846511479	71998 - Matador - Dr. K_Norris Thronton CTB C107B - notice list - 16

Parent ID	Mail Date	Company	Name	Address	City	ST	Zip	MailClass	TrackingNo	Well
31309	03/10/2022		Lovella Williams Kilman	8425 James Ave NE	Albuquerque	NM	87111-3222	Certified with Return Receipt (Signature)	94148118987 65846511516	71998 - Matador - Dr. K_Norris Thronton CTB C107B - notice list - 17
31309	03/10/2022		Melissa McCarthy, f/k/a Melissa G. Williams	48073 Larrabee St	Edwall	WA	99008-5004	Certified with Return Receipt (Signature)	94148118987 65846511561	71998 - Matador - Dr. K_Norris Thronton CTB C107B - notice list - 18
31309	03/10/2022		Tierra Oil Company, LLC	PO Box 1220	Jupiter	FL	33468-1220	Certified with Return Receipt (Signature)	94148118987 65846511523	71998 - Matador - Dr. K_Norris Thronton CTB C107B - notice list - 19
31309	03/10/2022		1836 Royalty Partners LLC	116 S Fm 1187	Aledo	TX	76008-4404	Certified with Return Receipt (Signature)	94148118987 65846511509	71998 - Matador - Dr. K_Norris Thronton CTB C107B - notice list - 20
31309	03/10/2022		Blind Side, LLC	PO Box 429	Roswell	NM	88202-0429	Certified with Return Receipt (Signature)	94148118987 65846511592	71998 - Matador - Dr. K_Norris Thronton CTB C107B - notice list - 21
31309	03/10/2022		GREP III-A Permian, LLC	2911 Turtle Creek Blvd Ste 1150	Dallas	TX	75219-7124	Certified with Return Receipt (Signature)	94148118987 65846511547	71998 - Matador - Dr. K_Norris Thronton CTB C107B - notice list - 22
31309	03/10/2022		Jubilee Royalty Holdings LLC	PO Box 192	New York	NY	10024-0192	Certified with Return Receipt (Signature)	94148118987 65846511585	71998 - Matador - Dr. K_Norris Thronton CTB C107B - notice list - 23
31309	03/10/2022		Michael Price	5450 Governor Cir	Stockton	CA	95210-6730	Certified with Return Receipt (Signature)	94148118987 65846511530	71998 - Matador - Dr. K_Norris Thronton CTB C107B - notice list - 24

Parent ID	Mail Date	Company	Name	Address	City	ST	Zip	MailClass	TrackingNo	Well
31309	03/10/2022		Office of Natural Resources	PO Box 25627	Denver	CO	80225-0627	Certified with Return Receipt (Signature)	94148118987 65846511578	71998 - Matador - Dr. K_Norris Thronton CTB C107B - notice list - 25
31309	03/10/2022		Robert B. Callison	406 Cimarron Trl	Carlsbad	NM	88220-6602	Certified with Return Receipt (Signature)	94148118987 65846549212	71998 - Matador - Dr. K_Norris Thronton CTB C107B - notice list - 26
31309	03/10/2022		Sandra K. Grant	9210 Dona Lugo Way	Stockton	CA	95210-1263	Certified with Return Receipt (Signature)	94148118987 65846549250	71998 - Matador - Dr. K_Norris Thronton CTB C107B - notice list - 27
31309	03/10/2022		Tundra AD3 LP	2100 Ross Ave Ste 1870 Lb-9	Dallas	TX	75201-6773	Certified with Return Receipt (Signature)	94148118987 65846549267	71998 - Matador - Dr. K_Norris Thronton CTB C107B - notice list - 28
31309	03/10/2022		Valspark Oil and Gas, LLC	36 Positano Loop	Roswell	NM	88201-3325	Certified with Return Receipt (Signature)	94148118987 65846549229	71998 - Matador - Dr. K_Norris Thronton CTB C107B - notice list - 29
31309	03/10/2022		Bureau of Land Management	301 Dinosaur Trl	Santa Fe	NM	87508-1560	Certified with Return Receipt (Signature)	94148118987 65846549205	71998 - Matador - Dr. K_Norris Thronton CTB C107B - notice list - 30
31309	03/10/2022		Bureau of Land Management	620 E Greene St	Carlsbad	NM	88220-6292	Certified with Return Receipt (Signature)	94148118987 65846549298	71998 - Matador - Dr. K_Norris Thronton CTB C107B - notice list - 31

Carlsbad Current Argus.
PART OF THE USA TODAY NETWORK

RECEIVED

APR 21 2022

Holland & Hart LLP.

Affidavit of Publication

Ad # 0005182839

This is not an invoice

HOLLAND AND HART
POBOX 2208

SANTA FE, NM 87504

I, a legal clerk of the **Carlsbad Current Argus**, a newspaper published daily at the City of Carlsbad, in said county of Eddy, state of New Mexico and of general paid circulation in said county; that the same is a duly qualified newspaper under the laws of the State wherein legal notices and advertisements may be published; that the printed notice attached hereto was published in the regular and entire edition of said newspaper and not in supplement thereof in editions dated as follows:

03/23/2022

Legal Clerk

Subscribed and sworn before me this March 23, 2022:

State of WI, County of Brown
NOTARY PUBLIC

1-7-25

My commission expires

KATHLEEN ALLEN
Notary Public
State of Wisconsin

Ad # 0005182839

PO #:

of Affidavits 1

This is not an invoice

AllLegal Notice (Publication)

To: All affected parties, including: Big Three Energy Group LLC; Bonnie R. Norfleet Newman, her heirs and devisees; Camarie Oil and Gas, LLC; Featherstone Development Corp.; MRC Permian Company; Penasco Petroleum LLC; Prospector LLC; Reed T. Kimbley, SSP, his heirs and devisees; Rolla R. Hinkle, III, his heirs and devisees; Ross Duncan Properties LLC; Sandra K. Norfleet Clark, her heirs and devisees; Shrader Enterprises, LP, a Kansas Ltd Partnership; XPLO Resources LLC; Chalcam Exploration LLC; Gumesinda Carrasco Onsurez Rev Trust Antonio Onsurez, Trustee; Hope Royalites LLC; Lovella Williams Kilman, her heirs and devisees; Melissa McCarthy, f/k/a Melissa G. Williams, her heirs and devisees; Tierra Oil Company, LLC; 1836 Royalty Partners LLC; Blind Side, LLC; GREP III-A Permian, LLC; Jubilee Royalty Holdings LLC; Michael Price, his heirs and devisees; Office of Natural Resources; Robert B. Callison, his heirs and devisees; Sandra K. Grant, her heirs and devisees; Tundra AD3 LP; Valspark Oil and Gas, LLC; and Bureau of Land Management.

Application of Matador Production Company to amend Administrative Order CTB-786-A (regarding lease commingling at the Dr K Central Tank Battery located in Unit M, Section 24, Township 23 South, Range 27 East, Eddy County, New Mexico), to authorize allocation via well test method. Pursuant to 19.15.12.10 NMAC, Matador seeks to amend the terms of Order CTB-786-A to allow for allocation of the approved surface commingling (at the Dr K Central Tank Battery) via well test method. Accordingly, Matador requests that the terms of the amended order allow commingling of production via well test method, as more fully described in its application. The amended order would apply to all existing and future infill wells drilled in the following spacing units:

(a) The 320-acre Purple Sage; Wolfcamp (Gas) Pool [98220] spacing unit comprised of the S/2 of Section 23. The spacing unit is currently dedicated to the following: Norris Thornton Com Well No. 204H (API No. 30-015-44659);

(b) The 320-acre Purple Sage; Wolfcamp (Gas) Pool [98220] spacing unit comprised of the N/2 of Section 24. The spacing unit is currently dedicated to the following: Dr K 24 23S 27E RB Well No. 206H (API No. 30-015-43379), Dr K 24 23S 27E RB Well No. 201H (API No. 30-015-45125);

(c) The 320-acre Purple Sage; Wolfcamp (Gas) Pool [98220] spacing unit comprised of the S/2 of Section 24. The spacing unit is currently dedicated to the following: Dr K 24 23S 27E RB Well No. 203H (API. No. 30-015-43378), Dr K 24 23S 27E RB Well No. 204H (API. No. 30-015-44804), Dr K 24 23S 27E RB Well No. 223H (API. No. 30-015-44562); and

(g) Pursuant to 19.15.12.10.C(4)(g), future Purple Sage; Wolfcamp (Gas) Pool [98220] spacing units within the S/2 of Section 23 and Section 24 [All] connected to the Dr K Central Tank Battery with notice provided only to the owners of interests to be added.

Any objection to this application must be filed in writing within twenty days from date of publication with the New Mexico Oil Conservation Division, 1220 South St. Francis Drive, Santa Fe, New Mexico, 87505. If no objection is received within this twenty-day period, this application may be approved administratively by the Division. If you have any questions about this application, please contact Kyle Perkins, Matador Production Company, (972) 371-5202 or KPerkins@matadorresources.com. #0005182839, Current Argus, March 23, 2022

From: [McClure, Dean, EMNRD](#) on behalf of [Engineer, OCD, EMNRD](#)
To: [Adam Rankin](#); [Paula M. Vance](#)
Cc: [McClure, Dean, EMNRD](#); [Wrinkle, Justin, EMNRD](#); [Powell, Brandon, EMNRD](#); lisa@rwbyram.com; [Paradis, Kyle O](#); [Walls, Christopher](#)
Subject: Approved Administrative Order CTB-1053
Date: Tuesday, September 27, 2022 9:56:17 AM
Attachments: [CTB1053 Order.pdf](#)

NMOCD has issued Administrative Order CTB-1053 which authorizes Matador Production Company (228937) to surface commingle or off-lease measure, as applicable, the following wells:

30-015-44659	Norris Thornton Com #204H	S/2	23-23S-27E	98220
30-015-43379	Dr K 24 33S 27E RB #206H	N/2	24-23S-27E	98220
30-015-45125	Dr K 24 33S 27E RB #201H	N/2	24-23S-27E	98220
30-015-43378	Dr K 24 33S 27E RB #203H	S/2	24-23S-27E	98220
30-015-44804	Dr K 24 33S 27E RB #204H	S/2	24-23S-27E	98220

The administrative order is attached to this email and can also be found online at OCD Imaging.

Please review the content of the order to ensure you are familiar with the authorities granted and any conditions of approval. If you have any questions regarding this matter, please contact me.

Dean McClure
Petroleum Engineer, Oil Conservation Division
New Mexico Energy, Minerals and Natural Resources Department
(505) 469-8211

From: [Paula M. Vance](#)
To: [McClure, Dean, EMNRD](#)
Cc: [Adam Rankin](#)
Subject: RE: [EXTERNAL] RE: surface commingling application CTB-1053
Date: Wednesday, September 21, 2022 4:05:33 PM

Dean,

I touched base with Matador and also did a review of the application. It looks like that **Dr K 24 33S 27E RB #223H** was part of the original order (CTB-786-A) but was inadvertently added to this application. If you look through the packet, the only well information included is for the Norris Thornton Com 204H, Dr. K 201H, 206H, 203H, and 204H. All that to say, I confirmed that we can drop the Dr. K 223 well from the application.

Let me know if there is anything else you need regarding this application. Thank you again for taking the time to review and look into these commingling apps!

Kind Regards,
Paula

From: McClure, Dean, EMNRD <Dean.McClure@emnrd.nm.gov>
Sent: Wednesday, September 21, 2022 1:57 PM
To: Paula M. Vance <PMVance@hollandhart.com>
Cc: Adam Rankin <AGRankin@hollandhart.com>
Subject: RE: [EXTERNAL] RE: surface commingling application CTB-1053

Paula,

Sounds good; I only asked for clarification because I wasn't sure if you were telling me something additional and if so I wasn't sure what it was.

Typically, we have been asking for the CA packets, but as I may have mentioned before, it isn't so much the CA packet, but the configuration of the CA that the Division is interested in. The packet tends to be a useful vessel for communication of that configuration. However, considering that I do have the configuration from the now rescinded NMNM 139002 and your confirmation that the new CA will have the same configuration as NMNM 139002; my request for the new CA packet is withdrawn.

I believe the only other loose end on this application is the well mentioned within the initial email in this email chain. The APD for this well has been cancelled and approval for it to be commingled cannot be included. I don't think I had ever heard back from Adam regarding how Matador wishes to proceed on that front. Conceivably, an additional paragraph could be put into the order denying its approval, but it would be cleaner if Matador were to wish to remove it from their application.

Dean McClure
Petroleum Engineer, Oil Conservation Division
New Mexico Energy, Minerals and Natural Resources Department

(505) 469-8211

From: Paula M. Vance <PMVance@hollandhart.com>
Sent: Wednesday, September 21, 2022 9:43 AM
To: McClure, Dean, EMNRD <Dean.McClure@emnrd.nm.gov>
Cc: Adam Rankin <AGRankin@hollandhart.com>
Subject: RE: [EXTERNAL] RE: surface commingling application CTB-1053

Dean,

I apologize for any confusion.

Per my email below, Matador resubmitted documentation to the BLM to correct the “several errors in the CA and incorrect signatures” and the configuration will be the same and includes 40 acres of Federal land in lease NMNM139351 and 280 acres of fee land, Eddy County, NM.

Let me know if you need anything else.

Kind Regards,
Paula

From: McClure, Dean, EMNRD <Dean.McClure@emnrd.nm.gov>
Sent: Tuesday, September 20, 2022 4:25 PM
To: Paula M. Vance <PMVance@hollandhart.com>
Cc: Adam Rankin <AGRankin@hollandhart.com>
Subject: RE: [EXTERNAL] RE: surface commingling application CTB-1053

Paula,

Below where you state “and includes NMNM 139002”; what do you mean?

Dean McClure
Petroleum Engineer, Oil Conservation Division
New Mexico Energy, Minerals and Natural Resources Department
(505) 469-8211

From: Paula M. Vance <PMVance@hollandhart.com>
Sent: Tuesday, September 20, 2022 3:15 PM
To: McClure, Dean, EMNRD <Dean.McClure@emnrd.nm.gov>
Cc: Adam Rankin <AGRankin@hollandhart.com>
Subject: RE: [EXTERNAL] RE: surface commingling application CTB-1053

Dean,

I confirmed with Matador that they have resubmitted documentation to the BLM to correct the “several errors in the CA and incorrect signatures” and that the configuration will be the same and includes

NMNM 139002.

Let me know if you need anything else on this application. Thank you, as always!

Kind Regards,
Paula

From: McClure, Dean, EMNRD <Dean.McClure@emnrd.nm.gov>
Sent: Monday, September 19, 2022 1:00 PM
To: Adam Rankin <AGRankin@hollandhart.com>
Cc: Paula M. Vance <PMVance@hollandhart.com>
Subject: RE: [EXTERNAL] RE: surface commingling application CTB-1053

Adam,

Please confirm the status of the CA for the following tract:

CA Wolfcamp NMNM 139002

S/2 23-23S-27E

The BLM servers were down when I was reviewing this application, but now that they are back up, it appears that NMNM 139002 has had its approval rescinded due to “several errors in the CA and incorrect signatures”. Please see the attached pdf.

Presumably, Matador intends to resubmit in the same configuration, but I do not currently see it within the publicly available system. Presuming that all of the above is correct, please provide a copy of the new draft CA.

Dean McClure
Petroleum Engineer, Oil Conservation Division
New Mexico Energy, Minerals and Natural Resources Department
(505) 469-8211

From: Adam Rankin <AGRankin@hollandhart.com>
Sent: Monday, September 19, 2022 9:32 AM
To: McClure, Dean, EMNRD <Dean.McClure@state.nm.us>
Cc: Paula M. Vance <PMVance@hollandhart.com>
Subject: [EXTERNAL] RE: surface commingling application CTB-1053

CAUTION: This email originated outside of our organization. Exercise caution prior to clicking on links or opening attachments.

Dean,

We’ve confirmed with Matador that the tracts identified below meet the definition of “lease” as defined in the rule.

From: Adam Rankin
Sent: Monday, August 22, 2022 3:43 PM

To: 'McClure, Dean, EMNRD' <Dean.McClure@state.nm.us>; Paula M. Vance <PMVance@hollandhart.com>

Subject: RE: surface commingling application CTB-1053

Dean,

We've reached out to Matador for confirmation on these wells and will follow up with you ASAP.

From: McClure, Dean, EMNRD <Dean.McClure@state.nm.us>

Sent: Monday, August 22, 2022 10:46 AM

To: Adam Rankin <AGRankin@hollandhart.com>; Paula M. Vance <PMVance@hollandhart.com>

Subject: surface commingling application CTB-1053

External Email

Mr. Rankin,

I am reviewing surface commingling application CTB-1053 which involves a commingling project that includes the Dr K Central Tank Battery and is operated by Matador Production Company (228937).

Please note that the following well has had its APD cancelled and cannot be included in this application:

30-015-44562	Dr K 24 33S 27E RB #223H	S/2	24-23S-27E	98220
---------------------	---------------------------------	------------	-------------------	--------------

Please confirm that the following tracts have been pooled and may be considered to be "leases" as defined by [19.15.12.7](#) C. NMAC.

Pooled Area	S/2	24-23S-27E
Pooled Area	N/2	24-23S-27E

Dean McClure
 Petroleum Engineer, Oil Conservation Division
 New Mexico Energy, Minerals and Natural Resources Department
 (505) 469-8211

**STATE OF NEW MEXICO
ENERGY, MINERALS AND NATURAL RESOURCES DEPARTMENT
OIL CONSERVATION DIVISION**

APPLICATION FOR SURFACE COMMINGLING

SUBMITTED BY MATADOR PRODUCTION COMPANY

ORDER NO. CTB-1053

ORDER

The Director of the New Mexico Oil Conservation Division (“OCD”), having considered the application and the recommendation of the OCD Engineering Bureau, issues the following Order.

FINDINGS OF FACT

1. Matador Production Company (“Applicant”) submitted a complete application to surface commingle the oil and gas production from the pools, leases, and wells identified in Exhibit A (“Application”).
2. Applicant proposed a method to allocate the oil and gas production to the pools, leases, and wells to be commingled.
3. To the extent that ownership is identical, Applicant submitted a certification by a licensed attorney or qualified petroleum landman that the ownership in the pools, leases, and wells to be commingled is identical as defined in 19.15.12.7.B. NMAC.
4. To the extent that ownership is diverse, Applicant provided notice of the Application to all persons owning an interest in the oil and gas production to be commingled, including the owners of royalty and overriding royalty interests, regardless of whether they have a right or option to take their interests in kind, and those persons either submitted a written waiver or did not file an objection to the Application.
5. Applicant provided notice of the Application to the Bureau of Land Management (“BLM”) or New Mexico State Land Office (“NMSLO”), as applicable.
6. Applicant in the notice for the Application stated that it sought authorization to prospectively include additional pools, leases, and wells in accordance with 19.15.12.10.C.(4)(g) NMAC.
7. Applicant stated that it sought authorization to surface commingle and off-lease measure, as applicable, oil and gas production from wells which have not yet been approved to be drilled, but will produce from a pool and lease identified in Exhibit A.
8. Applicant submitted or intends to submit one or more proposed communitization agreement(s) (“Proposed Agreement(s)”) to the BLM or NMSLO, as applicable, identifying the acreage of each lease to be consolidated into a single pooled area (“Pooled Area”), as described in Exhibit B.

CONCLUSIONS OF LAW

9. OCD has jurisdiction to issue this Order pursuant to the Oil and Gas Act, NMSA 1978, §§ 70-2-6, 70-2-11, 70-2-12, 70-2-16, and 70-2-17, 19.15.12. NMAC, and 19.15.23. NMAC.
10. Applicant satisfied the notice requirements for the Application in accordance with 19.15.12.10.A.(2) NMAC, 19.15.12.10.C.(4)(c) NMAC, and 19.15.12.10.C.(4)(e) NMAC, as applicable.
11. Applicant satisfied the notice requirements for the Application in accordance with 19.15.23.9.A.(5) NMAC and 19.15.23.9.A.(6) NMAC, as applicable.
12. Applicant's proposed method of allocation, as modified herein, complies with 19.15.12.10.B.(1) NMAC or 19.15.12.10.C.(1) NMAC, as applicable.
13. Commingling of oil and gas production from state, federal, or tribal leases shall not commence until approved by the BLM or NMSLO, as applicable, in accordance with 19.15.12.10.B.(3) NMAC and 19.15.12.10.C.(4)(h) NMAC.
14. Applicant satisfied the notice requirements for the subsequent addition of pools, leases, and wells in the notice for the Application, in accordance with 19.15.12.10.C.(4)(g) NMAC. Subsequent additions of pools, leases, and wells within Applicant's defined parameters, as modified herein, will not, in reasonable probability, reduce the commingled production's value or otherwise adversely affect the interest owners in the production to be added.
15. By granting the Application with the conditions specified below, this Order prevents waste and protects correlative rights, public health, and the environment.

ORDER

1. Applicant is authorized to surface commingle oil and gas production from the pools, leases, and wells identified in Exhibit A.

Applicant is authorized to store and measure oil and gas production off-lease from the pools, leases, and wells identified in Exhibit A at a central tank battery or gas title transfer meter described in Exhibit A.

Applicant is authorized to surface commingle oil and gas production from wells not included in Exhibit A but that produce from a pool and lease identified in Exhibit A.

Applicant is authorized to store and measure oil and gas production off-lease from wells not included in Exhibit A but that produce from a pool and lease identified in Exhibit A at a central tank battery or gas title transfer meter described in Exhibit A.

2. This Order supersedes Order CTB-786-A.
3. For each Pooled Area described in Exhibit B, Applicant shall submit a Proposed Agreement to the BLM or NMSLO, as applicable, prior to commencing oil and gas production. If Applicant fails to submit the Proposed Agreement, this Order shall terminate on the following day.

No later than sixty (60) days after the BLM or NMSLO approves or denies a Proposed Agreement, Applicant shall submit a Form C-103 to OCD with a copy of the decision and a description of the approved lands, as applicable. If Applicant withdraws or the BLM or NMSLO denies a Proposed Agreement, this Order shall terminate on the date of such action, and Applicant shall cease commingling the production from the Pooled Area. If the BLM or NMSLO approves but modifies the Proposed Agreement(s), Applicant shall comply with the approved Agreement(s), and no later than sixty (60) days after such decision, Applicant shall submit a new surface commingling application to OCD to conform this Order with the approved Agreement(s). If Applicant fails to submit the new surface commingling application or OCD denies the new surface commingling application, this Order shall terminate on the date of such action.

Applicant shall allocate the oil and gas production to each lease within a Pooled Area in proportion to the acreage that each lease bears to the entire acreage of the Pooled Area described in Exhibit B until the Proposed Agreement which includes the Pooled Area is approved. After the Proposed Agreement is approved, the oil and gas production from the Pooled Area shall be allocated as required by the BLM's or NMSLO's, as applicable, approval of the Agreement, including any production that had been allocated previously in accordance with this Order.

4. The allocation of oil and gas production to wells not included in Exhibit A but that produce from a pool and lease identified in Exhibit A shall be determined in the same manner as to wells identified in Exhibit A that produce from that pool and lease, provided that if more than one allocation method is being used or if there are no wells identified in Exhibit A that produce from the pool and lease, then allocation of oil and gas production to each well not included in Exhibit A shall be determined by OCD prior to commingling production from it with the production from another well.
5. The allocation of oil and gas production shall be based on the production life of each well as measured for three periods: (a) the initial production period shall be measured from the first production until the earlier of either the peak production rate or thirty (30) days after the first production; (b) the plateau period shall be measured from the end of the initial production period to the peak decline rate; and (c) the decline period shall be measured from the end of the plateau period until the well is plugged and abandoned.

During the initial production period, the oil and gas production for each well identified in Exhibit A shall be allocated using a production curve calculated from a minimum of ten (10) well tests per month, except that any day in which a well test cannot achieve an accurate result due to a temporary change in oil and gas production shall not be included in the computation of time determining the well test schedule. The production curve shall be calculated by interpolating daily production for each day using the known daily production obtained by well tests and shall use a method of interpolation that is at minimum as accurate as maintaining a constant rate of change for each day's production between the known daily production values.

During the plateau period, the oil and gas production for each well identified in Exhibit A shall be allocated using a minimum of three (3) well tests per month.

During the decline period, the oil and gas production for each well identified in Exhibit A shall be allocated as follows: (a) a minimum of three (3) well tests per month when the decline rate is greater than twenty-two percent (22%) per month; (b) a minimum of two (2) well tests per month when the decline rate is between twenty-two percent (22%) and ten percent (10%) per month; and (c) a minimum of one (1) well test per month when the decline rate is less than ten percent (10%) per month.

Upon OCD's request, Applicant shall submit a Form C-103 to the OCD Engineering Bureau that contains the decline rate curve and other relevant information demonstrating the production life of a well.

Applicant shall conduct a well test by separating and metering the oil and gas production from that well for either (a) a minimum of twenty-four (24) consecutive hours; or (b) a combination of nonconsecutive periods that meet the following conditions: (i) each period shall be a minimum of six (6) hours; and (ii) the total duration of the nonconsecutive periods shall be a minimum of eighteen (18) hours.

The well test requirements of this Order shall be suspended for any well shut-in for a period that continues for more than fifteen (15) days until the well commences production.

6. Applicant shall measure and market the commingled oil at a central tank battery described in Exhibit A in accordance with this Order and 19.15.18.15. NMAC or 19.15.23.8. NMAC.
7. Applicant shall measure and market the commingled gas at a well pad, central delivery point, central tank battery, or gas title transfer meter described in Exhibit A in accordance with this Order and 19.15.19.9. NMAC, provided however that if the gas is vented or flared, and regardless of the reason or authorization pursuant to 19.15.28.8.B. NMAC for such venting or flaring, Applicant shall measure or estimate the gas in accordance with 19.15.28.8.E. NMAC.
8. Applicant shall calibrate the meters used to measure or allocate oil and gas production in accordance with 19.15.12.10.C.(2) NMAC.
9. If the commingling of oil and gas production from any pool, lease, or well reduces the value of the commingled oil and gas production to less than if it had remained segregated, no later than sixty (60) days after the decrease in value has occurred Applicant shall submit a new surface commingling application to OCD to amend this Order to remove the pool, lease, or well whose oil and gas production caused the decrease in value. If Applicant fails to submit a new application, this Order shall terminate on the following day, and if OCD denies the application, this Order shall terminate on the date of such action.
10. Applicant may submit an application to amend this Order to add pools, leases, and subsequently drilled wells with spacing units adjacent to or within the tracts commingled by this Order by submitting a Form C-107-B in accordance with 19.15.12.10.C.(4)(g) NMAC,

provided the pools, leases, and subsequently drilled wells are within the identified parameters included in the Application.

11. If a well is not included in Exhibit A but produces from a pool and lease identified in Exhibit A, then Applicant shall submit Forms C-102 and C-103 to the OCD Engineering Bureau after the well has been approved to be drilled and prior to off-lease measuring or commingling oil or gas production from it with the production from another well. The Form C-103 shall reference this Order and identify the well, proposed method to determine the allocation of oil and gas production to it, and the location(s) that commingling of its production will occur.
12. Applicant shall not commence commingling oil or gas production from state, federal, or tribal leases until approved by the BLM or NMSLO, as applicable.
13. If OCD determines that Applicant has failed to comply with any provision of this Order, OCD may take any action authorized by the Oil and Gas Act or the New Mexico Administrative Code (NMAC).
14. OCD retains jurisdiction of this matter and reserves the right to modify or revoke this Order as it deems necessary.

**STATE OF NEW MEXICO
OIL CONSERVATION DIVISION**



ADRIENNE E. SANDOVAL
DIRECTOR

DATE: 9/26/2022

State of New Mexico
Energy, Minerals and Natural Resources Department

Exhibit A

Order: **CTB-1053**

Operator: **Matador Production Company (228937)**

Central Tank Battery: **Dr K Central Tank Battery**

Central Tank Battery Location: **UL M, Section 24, Township 23 South, Range 27 East**

Gas Title Transfer Meter Location: **UL M, Section 24, Township 23 South, Range 27 East**

Pools

Pool Name	Pool Code
PURPLE SAGE; WOLFCAMP (GAS)	98220

Leases as defined in 19.15.12.7(C) NMAC

Lease	UL or Q/Q	S-T-R
NMNM 139351	J	23-23S-27E
Fee	S/2 minus J	23-23S-27E
Pooled Area	S/2	24-23S-27E
Pooled Area	N/2	24-23S-27E

Wells

Well API	Well Name	UL or Q/Q	S-T-R	Pool
30-015-44659	Norris Thornton Com #204H	S/2	23-23S-27E	98220
30-015-43379	Dr K 24 33S 27E RB #206H	N/2	24-23S-27E	98220
30-015-45125	Dr K 24 33S 27E RB #201H	N/2	24-23S-27E	98220
30-015-43378	Dr K 24 33S 27E RB #203H	S/2	24-23S-27E	98220
30-015-44804	Dr K 24 33S 27E RB #204H	S/2	24-23S-27E	98220

State of New Mexico
Energy, Minerals and Natural Resources Department

Exhibit B

Order: CTB-1053
Operator: Matador Production Company (228937)

Pooled Areas

Pooled Area	UL or Q/Q	S-T-R	Acres	Pooled Area ID
CA Wolfcamp BLM	S/2	23-23S-27E	320	A

Leases Comprising Pooled Areas

Lease	UL or Q/Q	S-T-R	Acres	Pooled Area ID
Fee	S/2 minus J	23-23S-27E	280	A
NMNM 139351	J	23-23S-27E	40	A

District I

1625 N. French Dr., Hobbs, NM 88240
Phone:(575) 393-6161 Fax:(575) 393-0720

District II

811 S. First St., Artesia, NM 88210
Phone:(575) 748-1283 Fax:(575) 748-9720

District III

1000 Rio Brazos Rd., Aztec, NM 87410
Phone:(505) 334-6178 Fax:(505) 334-6170

District IV

1220 S. St Francis Dr., Santa Fe, NM 87505
Phone:(505) 476-3470 Fax:(505) 476-3462

State of New Mexico
Energy, Minerals and Natural Resources
Oil Conservation Division
1220 S. St Francis Dr.
Santa Fe, NM 87505

CONDITIONS

Action 89781

CONDITIONS

Operator: MATADOR PRODUCTION COMPANY One Lincoln Centre Dallas, TX 75240	OGRID: 228937
	Action Number: 89781
	Action Type: [C-107] Surface Commingle or Off-Lease (C-107B)

CONDITIONS

Created By	Condition	Condition Date
dmcclure	Please review the content of the order to ensure you are familiar with the authorities granted and any conditions of approval. If you have any questions regarding this matter, please contact me.	9/27/2022