

NSL - 8460

Revised March 23, 2017

ID NO. 164314

RECEIVED:	REVIEWER:	TYPE:	APP NO: pLEL2229136701
-----------	-----------	-------	-------------------------------

ABOVE THIS TABLE FOR OCD DIVISION USE ONLY

NEW MEXICO OIL CONSERVATION DIVISION
 - Geological & Engineering Bureau -
 1220 South St. Francis Drive, Santa Fe, NM 87505

**ADMINISTRATIVE APPLICATION CHECKLIST**

THIS CHECKLIST IS MANDATORY FOR ALL ADMINISTRATIVE APPLICATIONS FOR EXCEPTIONS TO DIVISION RULES AND REGULATIONS WHICH REQUIRE PROCESSING AT THE DIVISION LEVEL IN SANTA FE

Applicant: Mewbourne Oil Company**OGRID Number:** 14744**Well Name:** Fuller 14/23 WIKN Fed Com #1H**API:** 30-015-49920**Pool:** Purple Sage Wolfcamp (Gas)**Pool Code:** 98220

SUBMIT ACCURATE AND COMPLETE INFORMATION REQUIRED TO PROCESS THE TYPE OF APPLICATION INDICATED BELOW

1) TYPE OF APPLICATION: Check those which apply for [A]

A. Location - Spacing Unit - Simultaneous Dedication

☒ NSL☐ NSP (PROJECT AREA)☐ NSP (PRORATION UNIT)☐ SD

B. Check one only for [I] or [II]

[I] Commingling - Storage - Measurement

☐ DHC☐ CTB☐ PLC☐ PC☐ OLS☐ OLM

[II] Injection - Disposal - Pressure Increase - Enhanced Oil Recovery

☐ WFX☐ PMX☐ SWD☐ IPI☐ EOR☐ PPR**FOR OCD ONLY**☐

Notice Complete

☐Application
Content
Complete**2) NOTIFICATION REQUIRED TO:** Check those which apply.A. ☒ Offset operators or lease holdersB. ☐ Royalty, overriding royalty owners, revenue ownersC. ☐ Application requires published noticeD. ☐ Notification and/or concurrent approval by SLOE. ☐ Notification and/or concurrent approval by BLMF. ☐ Surface ownerG. ☒ For all of the above, proof of notification or publication is attached, and/or,H. ☐ No notice required

3) CERTIFICATION: I hereby certify that the information submitted with this application for administrative approval is **accurate** and **complete** to the best of my knowledge. I also understand that **no action** will be taken on this application until the required information and notifications are submitted to the Division.

Note: Statement must be completed by an individual with managerial and/or supervisory capacity.

Mitch Robb

Print or Type Name

Signature

09/26/2022

Date

432-682-3715

Phone Number

mrobb@mewbourne.com

e-mail Address

MEWBOURNE OIL COMPANY

500 West Texas, Suite 1020

Midland, Texas 79701

Phone (432) 682-3715

November 28, 2022

Via Certified Mail

New Mexico Oil Conservation Division

1220 S. St. Francis Drive

Santa Fe, New Mexico 87505

Attn: Mr. Leonard Lowe

OCD Engineer

Re: Application for Unorthodox Well Locations

Fuller 14/23 W1KN Fed Com #1H (API #30-015-49920)

Surface Location: 2590 FSL & 510 FWL (Unit L) (Sec. 14)

Proposed First Perf: 2540 FSL & 1450 FWL (Unit K) (Sec. 14)

Bottomhole Location: 100 FSL & 1450 FWL (Unit N) (Sec. 23)

Proposed Last Perf: 100 FSL & 1450 FWL (Unit N) (Sec. 23)

Sections 14 & 23 - T26S- R29E, NMPM

Eddy County, New Mexico

Dear Mr. Lowe:

Pursuant to Division Rule 19.15.15.13, Mewbourne Oil Company ("Mewbourne") respectfully requests administrative approval of an unorthodox gas well location for the above captioned Fuller 14/23 W1KN Fed Com #1H well. This well will be drilled as a horizontal gas wells in the Purple Sage Wolfcamp (Gas) Pool (98220).

The above wells will be dedicated to a standard 480-acre gas spacing and proration unit comprising the SW/4 of Section 14 and the W/2 of Section 23.

The Purple Sage Wolfcamp (Gas) Pool is currently governed by Special Pool Rules, Hearing Order No. R-14262 which requires standard 320-acre gas spacing and proration units with wells to be located no closer than 330 feet to the outer boundary of the spacing unit, nor closer than 10 feet to any interior quarter-quarter section line or subdivision inner boundary, or in the case of a horizontal well, no closer than 330 feet to the outer boundary of the producing area.

The unorthodox location is necessary in order to maximize the recovery of oil and gas reserves from the Wolfcamp formation underlying the SW/4 of Section 14 and the W/2 of Section 23.

The affected offset acreage comprises the NW/4 of Section 26, T26S- R29E NMPM (See Attached Map). Consequently, notice of this application is being provided to WPX Energy Permian, LLC.

Attached is a Form C-102 showing the surface, first take point, and bottomhole locations for the above captioned wells. Also, attached is a map showing the affected offset acreage, a horizontal well plan, notice list and a waiver from WPX Energy Permian, LLC to not object this application.

In summary, approval of the application will provide Mewbourne Oil Company the opportunity to recover additional oil and gas reserves from the Purple Sage Wolfcamp (Gas) Pool underlying Sections 14 and 23 that may otherwise not be recovered, thereby preventing waste, and will not violate correlative rights.

Should you have any questions regarding the above, please email me at mrobb@mewbourne.com or call me at (432) 682-3715.

Sincerely,

MEWBOURNE OIL COMPANY

A handwritten signature in blue ink, appearing to read 'mrobb', is positioned above the typed name.

Mitch Robb
Landman

District I
1625 N French Dr., Hobbs, NM 88240
Phone: (575) 393-6161 Fax: (575) 393-0720
District II
811 S First St., Artesia, NM 88210
Phone: (575) 748-1283 Fax: (575) 748-9720
District III
1000 Rio Brazos Road, Aztec, NM 87410
Phone: (505) 334-6178 Fax: (505) 334-6170
District IV
1220 S. St. Francis Dr., Santa Fe, NM 87505
Phone: (505) 476-3460 Fax: (505) 476-3462

State of New Mexico
Energy, Minerals & Natural Resources Department
OIL CONSERVATION DIVISION
1220 South St. Francis Dr.
Santa Fe, NM 87505

Form C-102
Revised August 1, 2011
Submit one copy to appropriate
District Office

☐ AMENDED REPORT

WELL LOCATION AND ACREAGE DEDICATION PLAT

¹ API Number 30-015-49920		² Pool Code 98220		³ Pool Name Purple Sage Wolfcamp (Gas)					
⁴ Property Code		⁵ Property Name FULLER 14/23 W1KN FED COM						⁶ Well Number 1H	
⁷ OGRID NO. 14744		⁸ Operator Name MEWBOURNE OIL COMPANY						⁹ Elevation 2944'	
¹⁰ Surface Location									
UL or lot no. L	Section 14	Township 26S	Range 29E	Lot Idn	Feet from the 2590	North/South line SOUTH	Feet from the 510	East/West line WEST	County EDDY
¹¹ Bottom Hole Location If Different From Surface									
UL or lot no. N	Section 23	Township 26S	Range 29E	Lot Idn	Feet from the 100	North/South line SOUTH	Feet from the 1450	East/West line WEST	County EDDY
¹² Dedicated Acres 480		¹³ Joint or Infill		¹⁴ Consolidation Code		¹⁵ Order No.			

No allowable will be assigned to this completion until all interest have been consolidated or a non-standard unit has been approved by the division.

<p>¹⁶ Horizontal Spacing Unit</p> <p>CORNER DATA NAD 83 GRID - NM EAST</p> <p>A: FOUND BRASS CAP "1940" N: 371167.4 - E: 656080.2</p> <p>B: FOUND BRASS CAP "1940" N: 373856.1 - E: 656068.5</p> <p>C: FOUND BRASS CAP "1940" N: 376539.9 - E: 656060.1</p> <p>D: FOUND BRASS CAP "1940" N: 379229.8 - E: 656067.0</p> <p>E: FOUND BRASS CAP "1940" N: 381920.7 - E: 656056.9</p> <p>F: FOUND BRASS CAP "1940" N: 381901.5 - E: 658773.2</p> <p>G: FOUND BRASS CAP "1940" N: 381882.4 - E: 661489.4</p> <p>H: FOUND BRASS CAP "1940" N: 379187.8 - E: 661491.3</p> <p>I: FOUND BRASS CAP "1940" N: 376497.1 - E: 661496.5</p> <p>J: FOUND BRASS CAP "1940" N: 373802.7 - E: 661493.7</p> <p>K: FOUND BRASS CAP "1940" N: 371124.3 - E: 661488.2</p> <p>L: FOUND BRASS CAP "1940" N: 371145.6 - E: 658784.1</p> <p>M: FOUND BRASS CAP "1940" N: 376518.6 - E: 658778.8</p>	<p>N 89°35'44" W 2716.93' N 89°35'45" W 2716.78'</p> <p>GEODETIC DATA NAD 83 GRID - NM EAST</p> <p>SURFACE LOCATION N: 379125.9 - E: 656576.8 LAT: 32.0417516° N LONG: 103.9614119° W</p> <p>510' S.L. 2590' FTP 2540 FSL 1450 FWL</p> <p>N 89°32'47" W 2718.42'</p> <p>GEODETIC DATA NAD 83 GRID - NM EAST</p> <p>BOTTOM HOLE N: 371255.7 - E: 657529.5 LAT: 32.0201079° N LONG: 103.9584255° W</p> <p>1450' LTP & B.H. 100'</p> <p>N 89°32'16" W 2704.56' N 89°32'55" W 2704.75'</p>	<p>¹⁷ OPERATOR CERTIFICATION</p> <p>I hereby certify that the information contained herein is true and complete to the best of my knowledge and belief, and that this organization either owns a working interest or unleased mineral interest in the land including the proposed bottom hole location or has a right to drill this well at this location pursuant to a contract with an owner of such a mineral or working interest, or to a voluntary pooling agreement or a compulsory pooling order heretofore entered by the division.</p> <p>Signature _____ Date _____</p> <p>Printed Name _____</p> <p>E-mail Address _____</p> <p>¹⁸ SURVEYOR CERTIFICATION</p> <p>I hereby certify that the well location shown on this plat was plotted from field notes of actual surveys made by me or under my supervision, and that the same is true and correct to the best of my belief.</p> <p>8-4-20 Date of Survey</p> <p>Signature and Seal of Professional Surveyor</p> <p>19680 Certificate Number</p> <p>REV: BH MOVE - 09/27/22</p> <p>Job No.: LS20080349</p>
----------------------------------------------------------------------------------------------------------------------------------------------------------------------------------------------------------------------------------------------------------------------------------------------------------------------------------------------------------------------------------------------------------------------------------------------------------------------------------------------------------------------------------------------------------------------------------------------------------------------------------------------------------------------------------------------------------------------------------------------------------------------------------------------------------------------------------------------------------------------------------------------------------------------------------------------	------------------------------------------------------------------------------------------------------------------------------------------------------------------------------------------------------------------------------------------------------------------------------------------------------------------------------------------------------------------------------------------------------------------------------------------------------------------------------------------------------------------------------------------------	-------------------------------------------------------------------------------------------------------------------------------------------------------------------------------------------------------------------------------------------------------------------------------------------------------------------------------------------------------------------------------------------------------------------------------------------------------------------------------------------------------------------------------------------------------------------------------------------------------------------------------------------------------------------------------------------------------------------------------------------------------------------------------------------------------------------------------------------------------------------------------------------------------------------------------------------------------------------------------------------------------------------------------------------------------------------------------------------------------

Offset Plat : Fuller 14/23 W1KN Fed Com #1H

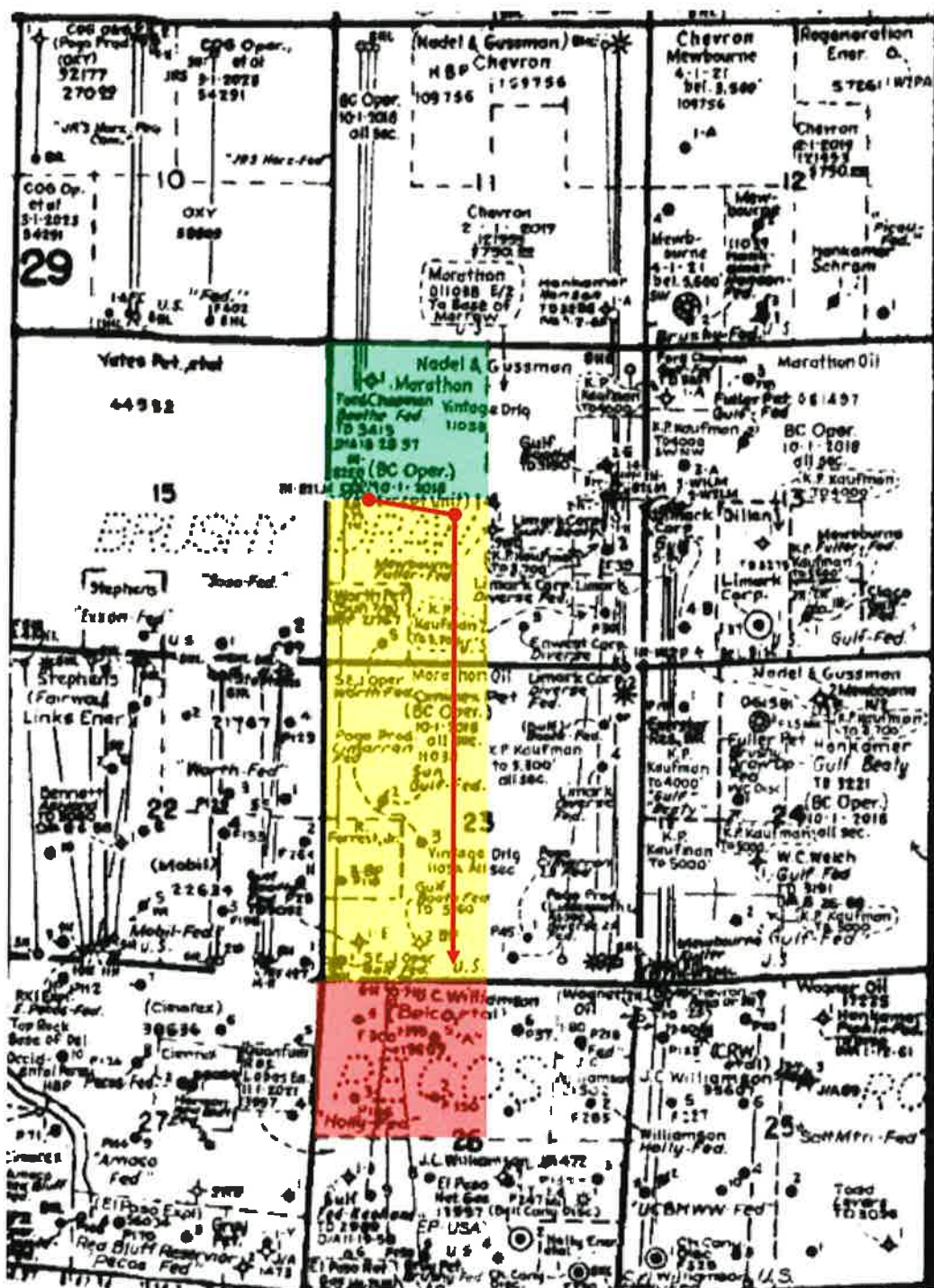

- Horizontal Spacing Unit
- Offset Owner – WPX Energy Permian, LLC (Operator)
- Offset Owner – Mewbourne Oil Company (Operator)

List of Affected Parties

Operator & Affected Party	Location	Date Letter Sent	Tracking Number
WPX Energy Permian, LLC 333 West Sheridan Avenue Oklahoma City, OK 73102 Attn: Andy Bennett	NW Sec 26 T26S R29E	9/30/2022	9414 8368 9784 6848 7910 60
Mewbourne Oil Company 500 West Texas Avenue, Suite 1020 Midland, TX 79701	NW Sec 14 T26S R29E		All owners in NW of Sec 14 have designated Mewbourne as Operator of the Wolfcamp Formation



Devon Energy Corporation
333 W. Sheridan Avenue
Oklahoma City, OK 73102-8260

405 235 3611 Phone
www.devonenergy.com

June 30th, 2022

Mewbourne Oil Company
Attn: Cy Shook
500 West Texas, Suite 1020
Midland, Texas 79701

Re: NSL Location - Steel Guitar 35-26 Fed Com #451H
Sections 26 & 35, T26S-R29E
S2 of Sections 31 & 32, T22S-R27E
Eddy County, NM

Mr. Shook,

WPX Energy Permian, LLC, a wholly owned subsidiary of Devon Energy Company ("Devon"), has applied for an unorthodox well location for the Steel Guitar 35-26 Fed Com #451H (the "Well") located in Sections 26 & 35, T26S-R29E, Eddy County, New Mexico.

In exchange for Mewbourne Oil Company's ("Mewbourne") cooperation on this matter, Devon proposes the following agreement:

1. Mewbourne hereby agrees not to protest or cause to be protested the unorthodox location for the Well, or any other well that Devon may permit in the Purple Sage; Wolfcamp (Gas) Pool (98220) in the future, so long as the well has a first take point or last take point no closer than 100' from the following section lines:
 - i. The north line of Section 26, T26S-R29E, Eddy County, NM
 - ii. The west line of the South Half of Section 32, T22S-R27E, Eddy County, NM
2. Devon hereby agrees not to protest or cause to be protested the unorthodox location for any well that Mewbourne may permit in the Purple Sage; Wolfcamp (Gas) Pool (98220) in the future, so long as the well has a first take point or last take point no closer than 100' from the following section lines:
 - i. The south line of Section 23, T26S-R29E, Eddy County, NM
 - ii. The east line of the South Half of Section 31, T22S-R27E, Eddy County, NM
3. This agreement shall be binding upon and shall inure to the benefit of the parties hereto and to their respective heirs, devisees, legal representatives, successors, and assigns.

If you are in agreement with these terms, please indicate your acceptance and agreement by executing in the space below. Should you have any questions, please feel free to contact me.

Sincerely,

A handwritten signature in blue ink, appearing to read "Andrew J. Wenzel", with a horizontal line extending to the right.

Andrew J. Wenzel
Senior Landman

Pg. 2

Re: NSL Location - Steel Guitar 35-26 Fed Com #451H

Mewbourne Oil Company
Agreed to and accepted this 6th day of July, 2022.

Signature: Cory Mitchell as
Name: Cory Mitchell Attorney-In-Fact

WPX Energy Permian, LLC 7th day of July, 2022.
Agreed to and accepted this

Signature: [Signature]
Name: Wendy Miles

District I
1625 N. French Dr., Hobbs, NM 88240
Phone:(575) 393-6161 Fax:(575) 393-0720
District II
811 S. First St., Artesia, NM 88210
Phone:(575) 748-1283 Fax:(575) 748-9720
District III
1000 Rio Brazos Rd., Aztec, NM 87410
Phone:(505) 334-6178 Fax:(505) 334-6170
District IV
1220 S. St Francis Dr., Santa Fe, NM 87505
Phone:(505) 476-3470 Fax:(505) 476-3462

State of New Mexico
Energy, Minerals and Natural Resources
Oil Conservation Division
1220 S. St Francis Dr.
Santa Fe, NM 87505

CONDITIONS

Action 164314

CONDITIONS

Operator: MEWBOURNE OIL CO P.O. Box 5270 Hobbs, NM 88241	OGRID: 14744
	Action Number: 164314
	Action Type: [UF-NSL] Non-Standard Location (NSL)

CONDITIONS

Created By	Condition	Condition Date
Ilowe	NSL - 8460 is approved. The approved Order can be retrieved at the following OCD website link. https://ocdimage.emnrd.nm.gov/imaging/AEOrderCriteria.aspx	12/7/2022