

ID NO. 163289

NSL - 8501

Revised March 23, 2017

RECEIVED:	REVIEWER:	TYPE:	APP NO: <b>pLEL2233657261</b>
-----------	-----------	-------	-------------------------------

ABOVE THIS TABLE FOR OCD DIVISION USE ONLY

**NEW MEXICO OIL CONSERVATION DIVISION**  
 - Geological & Engineering Bureau -  
 1220 South St. Francis Drive, Santa Fe, NM 87505

**ADMINISTRATIVE APPLICATION CHECKLIST**

THIS CHECKLIST IS MANDATORY FOR ALL ADMINISTRATIVE APPLICATIONS FOR EXCEPTIONS TO DIVISION RULES AND  
 REGULATIONS WHICH REQUIRE PROCESSING AT THE DIVISION LEVEL IN SANTA FE

Applicant: Cimarex Energy Co.OGRID Number: 215099Well Name: Scoter 6-31 Federal Com 15HAPI: PendingPool: Purple Sage; WolfcampPool Code: 98220

**SUBMIT ACCURATE AND COMPLETE INFORMATION REQUIRED TO PROCESS THE TYPE OF APPLICATION  
 INDICATED BELOW**

1) **TYPE OF APPLICATION:** Check those which apply for [A]

A. Location - Spacing Unit - Simultaneous Dedication

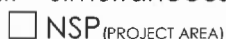

B. Check one only for [I] or [II]

[I] Commingling - Storage - Measurement



[II] Injection - Disposal - Pressure Increase - Enhanced Oil Recovery

2) **NOTIFICATION REQUIRED TO:** Check those which apply.A. ☒ Offset operators or lease holdersB. ☐ Royalty, overriding royalty owners, revenue ownersC. ☐ Application requires published noticeD. ☐ Notification and/or concurrent approval by SLOE. ☒ Notification and/or concurrent approval by BLMF. ☐ Surface ownerG. ☒ For all of the above, proof of notification or publication is attached, and/or,H. ☐ No notice required**FOR OCD ONLY**

Notice Complete

Application  
Content  
Complete

3) **CERTIFICATION:** I hereby certify that the information submitted with this application for administrative approval is **accurate** and **complete** to the best of my knowledge. I also understand that **no action** will be taken on this application until the required information and notifications are submitted to the Division.

**Note: Statement must be completed by an individual with managerial and/or supervisory capacity.**

Deana M. Bennett

Print or Type Name

Signature

December 2, 2022

Date

505-848-1834

Phone Number

deana.bennett@modrall.com

e-mail Address



**Non-Standard Location Application  
Scoter 6-31 Federal Com 15H**

**Table of Contents**

**Administrative Checklist**

**Application Cover Letter**

- **Exhibit A: C-102**
- **Exhibit B: Letter from Reservoir Engineer**
- **Exhibit C: Plat Showing Affected Tracts**
- **Exhibit D: Notice Information**
  - **Notice Letter**
  - **Chart Showing Offsets**
  - **Certified Mailing List**



December 2, 2022

Deana M. Bennett  
505.848.1834  
dmb@modrall.com

VIA E-FILING

Director Adrienne Sandoval  
*And*  
OCD Engineering Bureau  
Oil Conservation Division  
New Mexico Department of Energy,  
Minerals and Natural Resources  
1220 South Saint Francis Drive  
Santa Fe, New Mexico 87505

**Re: Application of Cimarex Energy Co. for administrative approval of unorthodox well location for its Scoter 6-31 Federal Com 15H Well located in the W/2 of Section 6, Township 25 South, Range 27 East, and the W/2 of Section 31, Township 24 South, Range 27 East, NMPM, Eddy County, New Mexico.**

Dear Director Sandoval/OCD Engineering Bureau:

Pursuant to Division rules 19.15.16.15(C)(6) and 19.15.15.13 NMAC, Cimarex Energy Co. (OGRID 215099) seeks administrative approval of an unorthodox well location ("NSL") for its Scoter 6-31 Federal Com 15H well (API No. pending) (the "Well"). The Well will be located in a 614.91-acre,<sup>1</sup> more or less, standard spacing unit underlying the W/2 of Section 6, Township 25 South, Range 27 East, and the W/2 of Section 31, Township 24 South, Range 27 East, NMPM, Eddy County, New Mexico, and will be in the Purple Sage Wolfcamp Gas Pool (Pool ID: 98220). A C-102 for the Well is attached as Exhibit A.

The Purple Sage Wolfcamp Gas Pool has special pool rules which establish 320-acre building blocks and 330' foot setback requirements. The Well will have setbacks of 100' for the toe and heel, which requires an NSL approval. As shown on Exhibit A, this is a horizontal well that will be drilled as follows:

---

<sup>1</sup> The unit is approximately 614.91 acres due to the acreage in each of the lots making up the unit. The lots in the W/2W/2 of Section 6 contain between 37.8 acres and 38.8 acres, and the lots in Section 31 contain 36 acres each.

Modrall Sperling  
Roehl Harris & Sisk P.A.

500 Fourth Street NW  
Suite 1000  
Albuquerque,  
New Mexico 87102

PO Box 2168  
Albuquerque,  
New Mexico 87103-2168

Tel: 505.848.1800  
www.modrall.com

- Surface Hole Location: 470' FSL & 1,150' FWL of Section 6-T25S-R27E;
- First Take Point: 100' FSL & 1,336' FWL of Section 6-T25S-R27E;
- Last Take Point/Bottom Hole Location: 100' FNL & 1,336' FWL of Section 31-T24S-R27E.

Cimarex has included as Exhibit B a letter explaining why this application is needed. Cimarex also provides a map of the area, attached as Exhibit C, which shows the tracts upon which the unorthodox location will encroach.

As discussed above, the first and last take points for the Well are closer than 330' from the boundary of the spacing unit. Specifically, the first take point would be 100' from the South line of Section 6, Township 25 South, Range 27 East, and the last take point would be 100' from the North line of Section 31, Township 24 South, Range 27 East. *See Exhibit A (C-102).* The unorthodox location will encroach towards the NW/4 of Section 7 of Township 25 South, Range 27 East and the SW/4 of Section 30, Township 24 South, Range 27 East. Cimarex has confirmed that the tracts adjoining the spacing unit by a corner are more the 330' away from the unorthodox locations requested.

Pursuant to Rule 19.15.4.12(A)(2) and Rule 19.15.2.7(A)(3), Cimarex is providing notice as follows:

- To Chevron USA Inc., 1400 Smith St., Houston, TX 77002, and 6301 Deauville Blvd., Midland, TX 79706, as the operator of the SW/4 of Section 30-T24S-R27E.
- To the working interest owners in the NW/4 of Section 7 because Cimarex is the operator in the W/2 of Sections 7 and 18-T25S-R27E pursuant to a JOA:
  - Chevron USA Inc., 1400 Smith St., Houston, TX 77002 and
  - 6301 Deauville Blvd., Midland, TX 79706
  - BEXP I OG, LLC, 591 W. Courtyard Dr., Ste. 340, Austin, TX 78730

Cimarex is also providing notice to the Bureau of Land Management. Proof of mailing, along with a copy of the notice letter sent to affected parties, is attached hereto as Exhibit D.

Your attention to this matter is appreciated.

Sincerely,



Earl E. DeBrine

Deana M. Bennett

Bryce H. Smith

*Attorneys for Cimarex Energy Co.*

Dispersal  
1623 N. French Dr., Hobbs, NM 88248  
Phone: (505) 393-6161 Fax: (505) 393-0730  
Dispersal II  
811 S. First St., Artesia, NM 88210  
Phone: (505) 748-1283 Fax: (505) 748-9720  
Dispersal III  
1000 Rio Hondo Road, Artesia, NM 87110  
Phone: (505) 334-6176 Fax: (505) 334-6170  
Dispersal IV  
1220 S. St. Francis Dr., Santa Fe, NM 87505  
Phone: (505) 476-3460 Fax: (505) 476-3462

State of New Mexico  
Energy, Minerals & Natural Resources Department  
**OIL CONSERVATION DIVISION**  
1220 South St. Francis Dr.  
Santa Fe, NM 87505

Form C-102  
Revised August 1, 2011  
Submit one copy to appropriate  
District Office

☐ AMENDED REPORT

**WELL LOCATION AND ACREAGE DEDICATION PLAT**

1 API Number	2 Well Name	3 Well Name
98220	Purple Sage; Wolfcamp	
4 Property Code	5 Property Name	6 Well Number
	SCOTER 6-31 FEDERAL COM	15H
7 OGBID No.	8 Operator Name	9 Elevation
	CIMAREX ENERGY CO.	3282.4'

*Surface Location							
UL or lot no.	Section	Township	Range	Lot Ids	Feet from the	North/South line	East/West line
7	6	25S	27E		470	SOUTH	WEST
							County EDDY

**Bottom Hole Location If Different From Surface							
UL or lot no.	Section	Township	Range	Lot Ids	Feet from the	North/South line	East/West line
1	31	24S	27E		100	NORTH	WEST
							County EDDY
614.91							

No allowable will be assigned to this completion until all interests have been consolidated or a non-standard unit has been approved by the division.

**\*OPERATOR CERTIFICATION**

I hereby certify that the information contained herein is true and complete to the best of my knowledge and belief, and that this organization either owns a working interest or undivided mineral interest in the land including the proposed bottom hole location or has a right to drill this well at this location pursuant to a contract with an owner of such a mineral or working interest, or to a voluntary pooling agreement or a compulsory pooling order heretofore entered by the division.

Signature \_\_\_\_\_ Date \_\_\_\_\_

Printed Name \_\_\_\_\_

E-mail Address \_\_\_\_\_

**\*SURVEYOR CERTIFICATION**

I hereby certify that the well location shown on this plat was plotted from field notes of actual surveys made by me or under my supervision, and that the same is true and correct to the best of my belief.

October 17, 2016

Date of Survey \_\_\_\_\_

Signature and Seal of Professional Surveyor: \_\_\_\_\_

**LINE TABLE**

LINE	DIRECTION	LENGTH
L1	S89°24'51"W	2622.35'
L2	S26°52'24"E	415.03'

**NOTE:**

- Distances referenced on plat to section lines are perpendicular.
- Base of Bearing is a True or Magnetic Meridian Projection with a Coard Meridian of 110°14'40" (NAD 83).

**SCALE**

DRAWN BY: S.T.O. 09-30-21

REV: 4 02-18-22 E.C. (PP & BHL MOVE)

EXHIBIT

A





November 29, 2022

**VIA E-FILING**

Director Adrienne Sandoval and OCD Engineering Bureau  
Oil Conservation Division  
Energy, Minerals and Natural Resources Department  
1220 South Saint Francis Drive  
Santa Fe, New Mexico 87505

Re: Application of Cimarex Energy Co. for administrative approval of non-standard locations for Scoter 6-31 Federal Com 14H; Scoter 6-31 Federal Com 15H; Scoter 6-31 Federal Com 16H; Scoter 6-31 Federal Com 17H wells, located in the W/2 of Section 6, Township 25 South, Range 27 East, and Section 31, Township 24 South, Range 27 East, NMPM, Eddy County, New Mexico

Dear Director Sandoval/OCD Engineering Bureau

Cimarex Energy Co., OGRID Number 215099, respectfully requests administrative approval of non-standards location ("NSL") for the following wells (the "Wells"):

- Scoter 6-31 Federal Com 14H (API No. Pending);
- Scoter 6-31 Federal Com 15H (API No. Pending);
- Scoter 6-31 Federal Com 16H (API No. Pending); and
- Scoter 6-31 Federal Com 17H API No. Pending) wells.

Cimarex is submitting four separate non-standard location applications, one for each well. The Wells will be completed within a standard 614.91-acre,<sup>1</sup> more or less, spacing unit in the Purple Sage Wolfcamp Gas Pool (Pool ID: 98220). Cimarex is requesting non-standard location approval for the Wells to allow the setbacks to be less than 330' from the northern and southern boundaries of the horizontal spacing unit. Allowing Cimarex to complete the Wells at this non-standard location will result in the greatest recovery of reserves from all of the Wells and will reduce waste.

Thank you for your consideration. Should you have any questions please contact me at [brett.stewart@coterra.com](mailto:brett.stewart@coterra.com) or (432)571-7889.

Sincerely,  
Brett Stewart  
Reservoir Engineer  
Cimarex Energy Co.

A handwritten signature in black ink that reads "Brett Stewart". The signature is written in a cursive, flowing style.

<sup>1</sup> The unit is approximately 614.91 acres due to the acreage in each of the lots making up the unit. The lots in the W/2W/2 of Section 6 contain between 37.8 acres and 38.8 acres, and the lots in Section 31 contain 36 acres each.

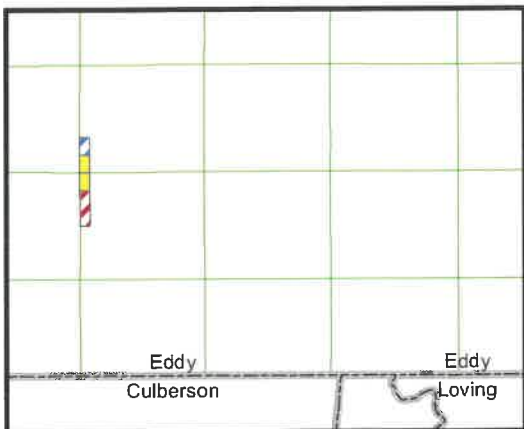
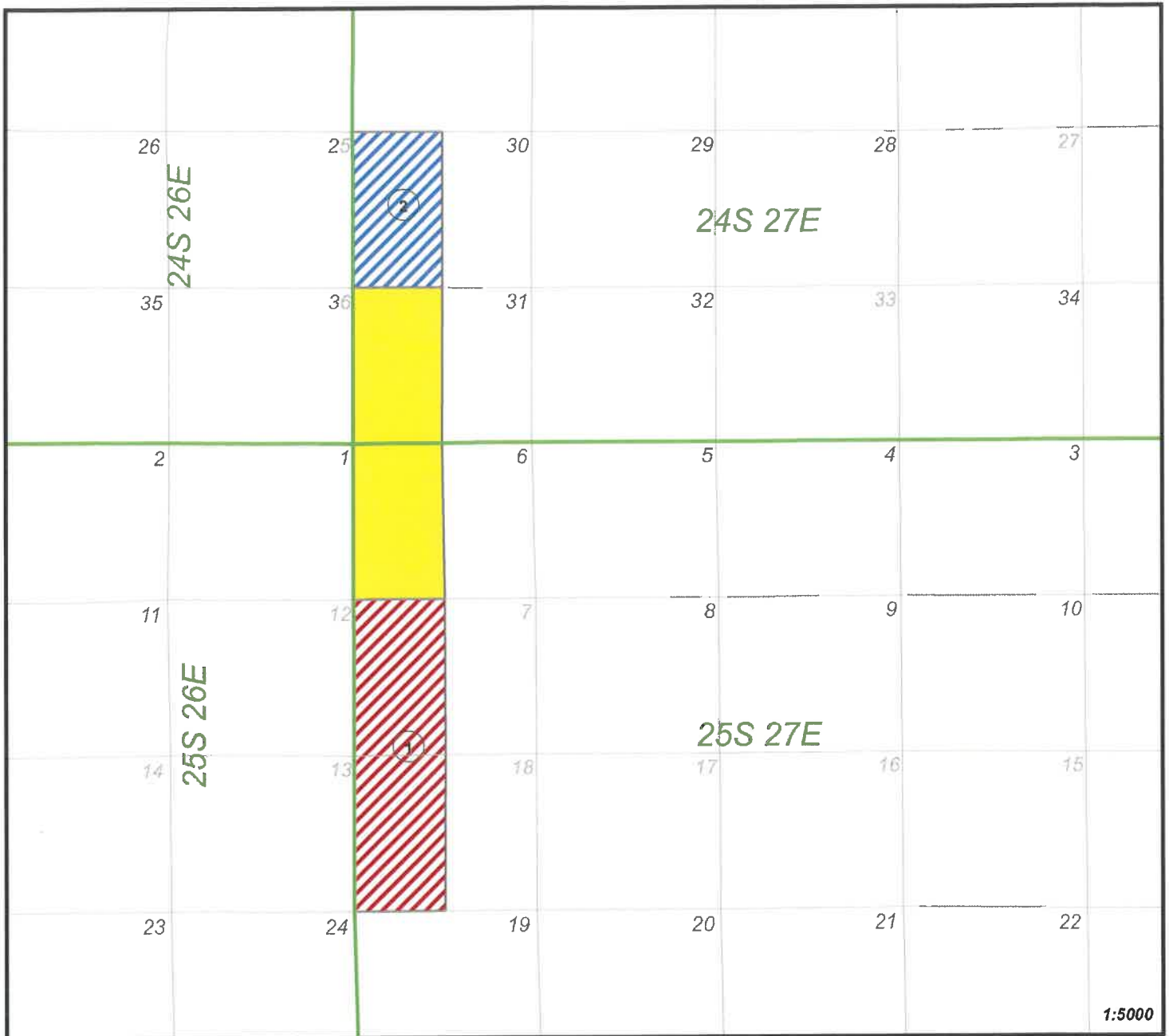

W/2 Wells

Scoter 6-31 (W2)

Cimarex



1) Cimarex, Operator  
MHP  
Chevron USA  
BEXP LOG



2) Chevron USA  
BLM

**Eddy County, New Mexico**

Township 24 South, Range 27 East, N.M.P.M.

Section 31: W2

Township 25 South, Range 27 East, N.M.P.M.

Section 6: W2

Released to Imaging: 12/29/2022 3:04:00 PM

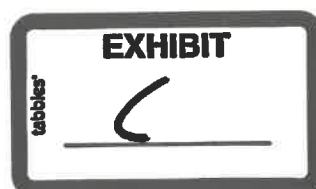

LEGACY  
ONSHORE



December 2, 2022

Deana M. Bennett  
505.848.1834  
dmb@modrall.com

**VIA CERTIFIED MAIL**

**TO AFFECTED PARTIES**

**Re: Applications of Cimarex Energy Co. for administrative approval of unorthodox well locations for its Scoter 6-31 Federal Com 14H; Scoter 6-31 Federal Com 15H; Scoter 6-31 Federal Com 16H; and Scoter 6-31 Federal Com 17H wells, located in the W/2 of Section 6, Township 25 South, Range 27 East, and the W/2 of Section 31, Township 24 South, Range 27 East, NMPM, Eddy County, New Mexico**

Dear Sir or Madam:

Enclosed are copies of the above-referenced applications filed with the New Mexico Oil Conservation Division on this date. Any objections that you have to these applications must be filed in writing with the New Mexico Oil Conservation Division, 1220 South St. Francis Drive, Santa Fe, New Mexico 87505, within twenty (20) days from the date the Division receives the above-referenced applications. If no objection is received within this twenty-day period, the applications may be approved administratively by the Division.

If you have any questions concerning these applications, please contact:

Brett Stewart  
Reservoir Engineer  
Cimarex Energy Co.  
[Brett.Stewart@coterra.com](mailto:Brett.Stewart@coterra.com)  
(432) 571-7889

Sincerely,



Earl E. DeBrine  
Deana M. Bennett  
Bryce H. Smith  
***Attorneys for Cimarex Energy Co.***

Modrall Sperling  
Roehl Harris & Sisk P.A.  
500 Fourth Street NW  
Suite 1000  
Albuquerque,  
New Mexico 87102

PO Box 2168  
Albuquerque,  
New Mexico 87103-2168

Tel: 505.848.1800  
[www.modrall.com](http://www.modrall.com)



Scoter 6-31 Federal Com



Offsetting Sections	Operator	WIOs If Needed N/A if Cimarex IS NOT operator	Date Notice Letter Sent
Section 30, T24S-R27E	Chevron USA Inc. 1400 Smith St. Houston, TX 77002 and Chevron USA Inc. 6301 Deauville Blvd. Midland, TX 79706	N/A	12/2/2022
Section 7, T25S-R27E	Cimarex Energy Co.	Magnum Hunter Production, Inc. 600 N. Marientfeld, Ste. 660 Midland, TX 79701  Chevron USA Inc. 1400 Smith St. Houston, TX 77002 and Chevron USA Inc. 6301 Deauville Blvd. Midland, TX 79706  BEXP I OG, LLC 591 W. Courtyard Dr., Ste. 340 Austin, TX 78730	12/2/2022

## Other Notice Parties:

Other Notice Parties	Date Notice Letter Sent
Bureau of Land Management	12/2/2022

Carlene Schuman  
 600 Fourth Street, Suite 1000  
 Albuquerque NM 87102

PS Form 3877

Type of Mailing: CERTIFIED MAIL  
 12/02/2022

Firm Mailing Book ID: 237455

Line	USPS Article Number	Name, Street, City, State, Zip	Postage	Service Fee	RR Fee	Rest.Del.Fee	Reference Contents
1	9314 8699 0430 0102 0061 71	Chevron USA Inc. 6301 Deauville Blvd. Midland TX 79706	\$2.64	\$4.00	\$2.00	\$0.00	82762.128Scoter Notice
2	9314 8699 0430 0102 0061 88	United States of America Bureau of Land Management 301 Dinosaur Tr. Santa Fe NM 87508	\$2.64	\$4.00	\$2.00	\$0.00	82762.128Scoter Notice
3	9314 8699 0430 0102 0061 95	BEXP I OG, LLC 591 W. Courtyard Dr., Ste 340 Austin TX 78730	\$2.64	\$4.00	\$2.00	\$0.00	82762.128Scoter Notice
4	9314 8699 0430 0102 0062 01	Chevron USA Inc. 1400 Smith St. Houston TX 77002	\$2.64	\$4.00	\$2.00	\$0.00	82762.128Scoter Notice
5	9314 8699 0430 0102 0062 18	Magnum Hunter Production, Inc. 600 N. Mariefeld, Ste 600 Midland TX 79701	\$2.64	\$4.00	\$2.00	\$0.00	82762.128Scoter Notice
<b>Totals:</b>			<b>\$13.20</b>	<b>\$20.00</b>	<b>\$10.00</b>	<b>\$0.00</b>	
			<b>Grand Total:</b>		<b>\$43.20</b>		

List Number of Pieces  
Listed by Sender

Total Number of Pieces  
Received at Post Office

Postmaster:  
Name of receiving employee

Dated:

Form C-102  
Revised August 1, 2011  
Submit one copy to appropriate  
District Office

☐ AMENDED REPORT

No allowable will be assigned to this completion until all interests have been consolidated or a non-standard unit has been approved by the division.





December 2, 2022

Deana M. Bennett  
505.848.1834  
dmb@modrall.com

**VIA CERTIFIED MAIL**

**TO AFFECTED PARTIES**

**Re: Applications of Cimarex Energy Co. for administrative approval of unorthodox well locations for its Scoter 6-31 Federal Com 14H; Scoter 6-31 Federal Com 15H; Scoter 6-31 Federal Com 16H; and Scoter 6-31 Federal Com 17H wells, located in the W/2 of Section 6, Township 25 South, Range 27 East, and the W/2 of Section 31, Township 24 South, Range 27 East, NMPM, Eddy County, New Mexico**

Dear Sir or Madam:

Enclosed are copies of the above-referenced applications filed with the New Mexico Oil Conservation Division on this date. Any objections that you have to these applications must be filed in writing with the New Mexico Oil Conservation Division, 1220 South St. Francis Drive, Santa Fe, New Mexico 87505, within twenty (20) days from the date the Division receives the above-referenced applications. If no objection is received within this twenty-day period, the applications may be approved administratively by the Division.

If you have any questions concerning these applications, please contact:

Brett Stewart  
Reservoir Engineer  
Cimarex Energy Co.  
[Brett.Stewart@coterra.com](mailto:Brett.Stewart@coterra.com)  
(432) 571-7889

Sincerely,

Earl E. DeBrine  
Deana M. Bennett  
Bryce H. Smith  
***Attorneys for Cimarex Energy Co.***

Modrall Sperling  
Roehl Harris & Sisk P.A.  
500 Fourth Street NW  
Suite 1000  
Albuquerque,  
New Mexico 87102

PO Box 2168  
Albuquerque,  
New Mexico 87103-2168

Tel: 505.848.1800  
[www.modrall.com](http://www.modrall.com)

Scoter 6-31 Federal Com



Offsetting Sections	Operator	WIOs If Needed N/A if Cimarex IS NOT operator	Date Notice Letter Sent
Section 30, T24S-R27E	Chevron USA Inc. 1400 Smith St. Houston, TX 77002 and Chevron USA Inc. 6301 Deauville Blvd. Midland, TX 79706	N/A	12/2/2022
Section 7, T25S-R27E	Cimarex Energy Co.	Magnum Hunter Production, Inc. 600 N. Marienfeld, Ste. 660 Midland, TX 79701  Chevron USA Inc. 1400 Smith St. Houston, TX 77002 and Chevron USA Inc. 6301 Deauville Blvd. Midland, TX 79706  BEXP I OG, LLC 591 W. Courtyard Dr., Ste. 340 Austin, TX 78730	12/2/2022

## Other Notice Parties:

Other Notice Parties	Date Notice Letter Sent
Bureau of Land Management	12/2/2022



Carlene Schuman  
 400 Fourth Street, Suite 1000  
 Albuquerque NM 87102

PS Form 3877

Type of Mailing: CERTIFIED MAIL  
 12/02/2022

Firm Mailing Book ID: 237455

Line	USPS Article Number	Name, Street, City, State, Zip	Postage	Service Fee	RR Fee	Rest.Del.Fee	Reference Contents
1	9314 8699 0430 0102 0061 71	Chevron USA Inc. 6301 Deauville Blvd. Midland TX 79706	\$2.64	\$4.00	\$2.00	\$0.00	82762.128Scoter Notice
2	9314 8699 0430 0102 0061 88	United States of America Bureau of Land Management 301 Dinosaur Tr. Santa Fe NM 87508	\$2.64	\$4.00	\$2.00	\$0.00	82762.128Scoter Notice
3	9314 8699 0430 0102 0061 95	BEXP I OG, LLC 591 W. Courtyard Dr., Ste 340 Austin TX 78730	\$2.64	\$4.00	\$2.00	\$0.00	82762.128Scoter Notice
4	9314 8699 0430 0102 0062 01	Chevron USA Inc. 1400 Smith St. Houston TX 77002	\$2.64	\$4.00	\$2.00	\$0.00	82762.128Scoter Notice
5	9314 8699 0430 0102 0062 18	Magnum Hunter Production, Inc. 600 N. Marienfeld, Ste 600 Midland TX 79701	\$2.64	\$4.00	\$2.00	\$0.00	82762.128Scoter Notice
<b>Totals:</b>			<b>\$13.20</b>	<b>\$20.00</b>	<b>\$10.00</b>	<b>\$0.00</b>	
<b>Grand Total:</b>						<b>\$43.20</b>	

List Number of Pieces  
Listed by Sender

Total Number of Pieces  
Received at Post Office

Postmaster:  
Name of receiving employee

Dated:



December 2, 2022

Deana M. Bennett  
505.848.1834  
dmb@modrall.com

**VIA CERTIFIED MAIL**

**TO AFFECTED PARTIES**

**Re: Applications of Cimarex Energy Co. for administrative approval of unorthodox well locations for its Scoter 6-31 Federal Com 14H; Scoter 6-31 Federal Com 15H; Scoter 6-31 Federal Com 16H; and Scoter 6-31 Federal Com 17H wells, located in the W/2 of Section 6, Township 25 South, Range 27 East, and the W/2 of Section 31, Township 24 South, Range 27 East, NMPM, Eddy County, New Mexico**

Dear Sir or Madam:

Enclosed are copies of the above-referenced applications filed with the New Mexico Oil Conservation Division on this date. Any objections that you have to these applications must be filed in writing with the New Mexico Oil Conservation Division, 1220 South St. Francis Drive, Santa Fe, New Mexico 87505, within twenty (20) days from the date the Division receives the above-referenced applications. If no objection is received within this twenty-day period, the applications may be approved administratively by the Division.

If you have any questions concerning these applications, please contact:

Brett Stewart  
Reservoir Engineer  
Cimarex Energy Co.  
[Brett.Stewart@coterra.com](mailto:Brett.Stewart@coterra.com)  
(432) 571-7889

Sincerely,

Earl E. DeBrine  
Deana M. Bennett  
Bryce H. Smith  
***Attorneys for Cimarex Energy Co.***

Modrall Sperling  
Roehl Harris & Sisk P.A.  
500 Fourth Street NW  
Suite 1000  
Albuquerque,  
New Mexico 87102

PO Box 2168  
Albuquerque,  
New Mexico 87103-2168  
Tel: 505.848.1800  
[www.modrall.com](http://www.modrall.com)



Scoter 6-31 Federal Com

Offsetting Sections	Operator	WIOs If Needed N/A if Cimarex IS NOT operator	Date Notice Letter Sent
Section 30, T24S-R27E	Chevron USA Inc. 1400 Smith St. Houston, TX 77002 and Chevron USA Inc. 6301 Deauville Blvd. Midland, TX 79706	N/A	12/2/2022
Section 7, T25S-R27E	Cimarex Energy Co.	Magnum Hunter Production, Inc. 600 N. Marienfeld, Ste. 660 Midland, TX 79701  Chevron USA Inc. 1400 Smith St. Houston, TX 77002 and Chevron USA Inc. 6301 Deauville Blvd. Midland, TX 79706  BEXP I OG, LLC 591 W. Courtyard Dr., Ste. 340 Austin, TX 78730	12/2/2022

## Other Notice Parties:

Other Notice Parties	Date Notice Letter Sent
Bureau of Land Management	12/2/2022

PS Form 3877  
Type of Mailing: CERTIFIED MAIL  
12/02/2022

Firm Mailing Book ID: 237455

Carlene Schuman  
400 Fourth Street, Suite 1000  
Albuquerque NM 87102

Line	USPS Article Number	Name, Street, City, State, Zip	Postage	Service Fee	RR Fee	Rest.Del.Fee	Reference Contents
1	9314 8699 0430 0102 0061 71	Chevron USA Inc. 6301 Deauville Blvd. Midland TX 79706	\$2.64	\$4.00	\$2.00	\$0.00	82762.128Scoter Notice
2	9314 8699 0430 0102 0061 88	United States of America Bureau of Land Management 301 Dinosaur Tr. Santa Fe NM 87508	\$2.64	\$4.00	\$2.00	\$0.00	82762.128Scoter Notice
3	9314 8699 0430 0102 0061 95	BEXP I OG, LLC 591 W. Courtyard Dr., Ste 340 Austin TX 78730	\$2.64	\$4.00	\$2.00	\$0.00	82762.128Scoter Notice
4	9314 8699 0430 0102 0062 01	Chevron USA Inc. 1400 Smith St. Houston TX 77002	\$2.64	\$4.00	\$2.00	\$0.00	82762.128Scoter Notice
5	9314 8699 0430 0102 0062 18	Magnum Hunter Production, Inc. 600 N. Marienfeld, Ste 600 Midland TX 79701	\$2.64	\$4.00	\$2.00	\$0.00	82762.128Scoter Notice
<b>Totals:</b>			<b>\$13.20</b>	<b>\$20.00</b>	<b>\$10.00</b>	<b>\$0.00</b>	
			<b>Grand Total:</b>		<b>\$43.20</b>		

List Number of Pieces  
Listed by Sender

Total Number of Pieces  
Received at Post Office

Postmaster:  
Name of receiving employee

Dated:



November 29, 2022

**VIA E-FILING**

Director Adrienne Sandoval and OCD Engineering Bureau  
Oil Conservation Division  
Energy, Minerals and Natural Resources Department  
1220 South Saint Francis Drive  
Santa Fe, New Mexico 87505

Re: Application of Cimarex Energy Co. for administrative approval of non-standard locations for Scoter 6-31 Federal Com 14H; Scoter 6-31 Federal Com 15H; Scoter 6-31 Federal Com 16H; Scoter 6-31 Federal Com 17H wells, located in the W/2 of Section 6, Township 25 South, Range 27 East, and Section 31, Township 24 South, Range 27 East, NMPM, Eddy County, New Mexico

Dear Director Sandoval/OCD Engineering Bureau

Cimarex Energy Co., OGRID Number 215099, respectfully requests administrative approval of non-standards location ("NSL") for the following wells (the "Wells"):

- Scoter 6-31 Federal Com 14H (API No. Pending);
- Scoter 6-31 Federal Com 15H (API No. Pending);
- Scoter 6-31 Federal Com 16H (API No. Pending); and
- Scoter 6-31 Federal Com 17H API No. Pending) wells.

Cimarex is submitting four separate non-standard location applications, one for each well. The Wells will be completed within a standard 614.91-acre,<sup>1</sup> more or less, spacing unit in the Purple Sage Wolfcamp Gas Pool (Pool ID: 98220). Cimarex is requesting non-standard location approval for the Wells to allow the setbacks to be less than 330' from the northern and southern boundaries of the horizontal spacing unit. Allowing Cimarex to complete the Wells at this non-standard location will result in the greatest recovery of reserves from all of the Wells and will reduce waste.

Thank you for your consideration. Should you have any questions please contact me at [brett.stewart@coterra.com](mailto:brett.stewart@coterra.com) or (432)571-7889.

Sincerely,  
Brett Stewart  
Reservoir Engineer  
Cimarex Energy Co.

A handwritten signature in black ink that reads "Brett Stewart". The signature is written in a cursive, flowing style.

<sup>1</sup> The unit is approximately 614.91 acres due to the acreage in each of the lots making up the unit. The lots in the W/2W/2 of Section 6 contain between 37.8 acres and 38.8 acres, and the lots in Section 31 contain 36 acres each.

Scoter 6-3





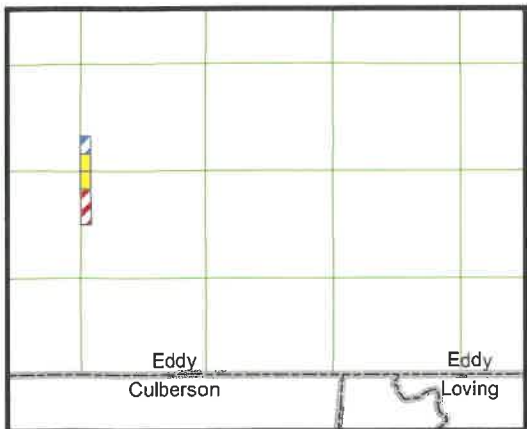
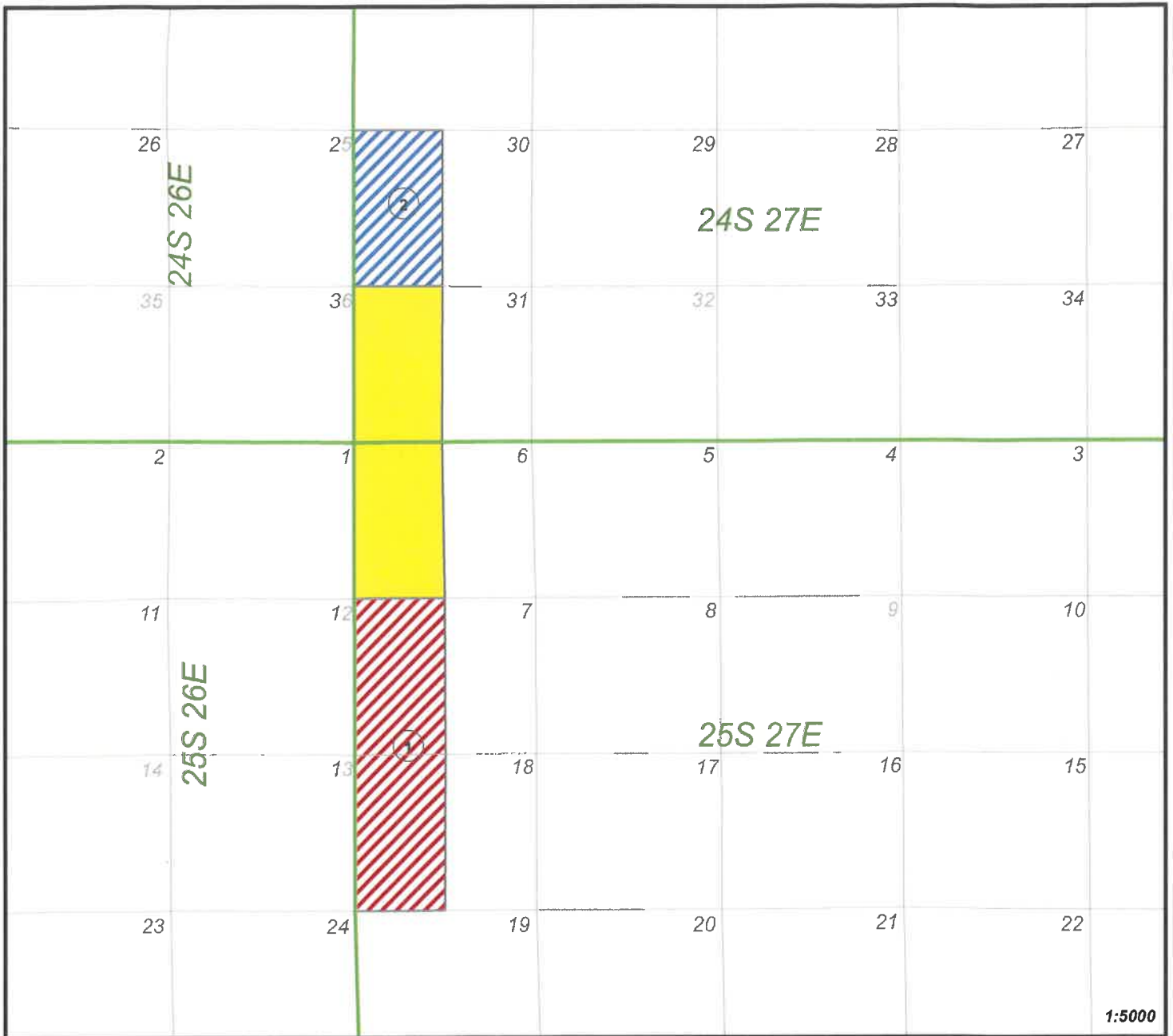

Scoter 6-31 (W2)



Cimarex



1) Cimarex, Operator  
MHPI  
Chevron USA  
BEXP I OG



2) Chevron USA  
USA BLM

## Eddy County, New Mexico

Township 24 South, Range 27 East, N.M.P.M.

Section 31: W2

Township 25 South, Range 27 East, N.M.P.M.

Section 6: W2



**District I**

1625 N. French Dr., Hobbs, NM 88240  
Phone:(575) 393-6161 Fax:(575) 393-0720

**District II**

811 S. First St., Artesia, NM 88210  
Phone:(575) 748-1283 Fax:(575) 748-9720

**District III**

1000 Rio Brazos Rd., Aztec, NM 87410  
Phone:(505) 334-6178 Fax:(505) 334-6170

**District IV**

1220 S. St Francis Dr., Santa Fe, NM 87505  
Phone:(505) 476-3470 Fax:(505) 476-3462

**State of New Mexico**  
**Energy, Minerals and Natural Resources**  
**Oil Conservation Division**  
**1220 S. St Francis Dr.**  
**Santa Fe, NM 87505**

CONDITIONS

Action 163289

**CONDITIONS**

Operator: CIMAREX ENERGY CO. 600 N. Marienfeld Street Midland, TX 79701	OGRID: 215099
	Action Number: 163289
	Action Type: [UF-NSL] Non-Standard Location (NSL)

**CONDITIONS**

Created By	Condition	Condition Date
llowe	NSL - 8501 is approved. The approved Order can be retrieved at the following OCD website link. <a href="https://ocdimage.emnrd.nm.gov/imaging/AEOrderCriteria.aspx">https://ocdimage.emnrd.nm.gov/imaging/AEOrderCriteria.aspx</a>	12/2/2022