

ID NO. 207021

NSL - 8567

Revised March 23, 2017

RECEIVED:	REVIEWER:	TYPE:	APP NO: pLEL2310330190
-----------	-----------	-------	-------------------------------

ABOVE THIS TABLE FOR OCD DIVISION USE ONLY

NEW MEXICO OIL CONSERVATION DIVISION
 - Geological & Engineering Bureau -
 1220 South St. Francis Drive, Santa Fe, NM 87505

**ADMINISTRATIVE APPLICATION CHECKLIST**

THIS CHECKLIST IS MANDATORY FOR ALL ADMINISTRATIVE APPLICATIONS FOR EXCEPTIONS TO DIVISION RULES AND
 REGULATIONS WHICH REQUIRE PROCESSING AT THE DIVISION LEVEL IN SANTA FE

Applicant: Chevron U.S.A. Inc.**OGRID Number:** 4323**Well Name:** SD 18 19 Federal Com 425H**API:** 30-025-50089**Pool:** WC-025 G-06 S263319P**Pool Code:** 97955

**SUBMIT ACCURATE AND COMPLETE INFORMATION REQUIRED TO PROCESS THE TYPE OF APPLICATION
 INDICATED BELOW**

1) TYPE OF APPLICATION: Check those which apply for [A]

A. Location - Spacing Unit - Simultaneous Dedication

☒ NSL☐ NSP (PROJECT AREA)☐ NSP (PRORATION UNIT)☐ SD

B. Check one only for [I] or [II]

[I] Commingling - Storage - Measurement

☐ DHC☐ CTB☐ PLC☐ PC☐ OLS☐ OLM

[II] Injection - Disposal - Pressure Increase - Enhanced Oil Recovery

☐ WFX☐ PMX☐ SWD☐ IPI☐ EOR☐ PPR**2) NOTIFICATION REQUIRED TO:** Check those which apply.A. ☐ Offset operators or lease holdersB. ☐ Royalty, overriding royalty owners, revenue ownersC. ☐ Application requires published noticeD. ☐ Notification and/or concurrent approval by SLOE. ☒ Notification and/or concurrent approval by BLMF. ☐ Surface ownerG. ☒ For all of the above, proof of notification or publication is attached, and/or,H. ☐ No notice required**FOR OCD ONLY**☐ Notice Complete☐ Application
Content
Complete

3) CERTIFICATION: I hereby certify that the information submitted with this application for
 administrative approval is **accurate** and **complete** to the best of my knowledge. I also
 understand that **no action** will be taken on this application until the required information and
 notifications are submitted to the Division.

Note: Statement must be completed by an individual with managerial and/or supervisory capacity.

Deana M. Bennett

Print or Type Name

Signature

April 12, 2023

Date

505-848-1834

Phone Number

Deana.Bennett@modrall.com

e-mail Address



April 12, 2023

Deana M. Bennett
505.848.1834
dmb@modrall.com

VIA E-FILING

Acting Director Dylan M. Fuge
And
OCD Engineering Bureau
Oil Conservation Division
New Mexico Department of Energy,
Minerals and Natural Resources
1220 South Saint Francis Drive
Santa Fe, New Mexico 87505

Re: Application of Chevron U.S.A. Inc. for administrative approval of unorthodox well location for its SD 18 19 Federal Com 425H Well located in the E/2E/2 of Sections 18 and 19, Township 26 South, Range 33 East, NMPM, Lea County, New Mexico.

Dear Director Fuge/OCD Engineering Bureau:

Pursuant to Division rules 19.15.16.15(C)(6) and 19.15.15.13 NMAC, Chevron U.S.A. Inc. (OGRID 4323) ("Chevron") seeks administrative approval of an unorthodox well location ("NSL") for its SD 18 19 Federal Com 425H well (API No. 30-025-50089) (the "Well"). The Well will be located in a 320-acre, more or less, standard spacing unit underlying the E/2E/2 of Sections 18 and 19, Township 26 South, Range 33 East, NMPM, Lea County, New Mexico, and will be in the WC-025 G-06 S263319P; Bone Spring pool (Pool ID: 97955). A C-102 for the Well is attached as **Exhibit A**.

The Well's completed interval will be closer than 330' from the outer boundary of the spacing unit, which requires an NSL approval. As shown on Exhibit A, this is a horizontal well that will be drilled as follows:

- Surface Hole Location: 425' FNL & 2,041' FEL of Section 18, T26S-R33E;
- First Take Point: 100' FNL & 1210' FEL of Section 18, T26S-R33E;
- Last Take Point: 100' FSL & 1210' FEL of Section 19, T26S-R33E;

Modrall Sperling
Roehl Harris & Sisk P.A.

500 Fourth Street NW
Suite 1000
Albuquerque,
New Mexico 87102

PO Box 2168
Albuquerque,
New Mexico 87103-2168

Tel: 505.848.1800
www.modrall.com

- Bottom Hole Location: 25' FSL & 1210' FEL of Section 19, T26S-R33E.

Chevron has included as **Exhibit B** a letter explaining why this application is needed. Chevron also provides a map of the area, attached as **Exhibit C**, which shows the tracts upon which the unorthodox location will encroach.

As discussed above, the completed interval of the Well is closer than 330' from the boundary of the spacing unit. See Exhibit A (C-102). The unorthodox location will encroach towards the W/2E/2 of Sections 18 and 19 of Township 26 South, Range 33 East. The tracts adjoining the spacing unit by a corner are more than 100' away from the first and last take points and, as a result, there is no need to provide notice to the offsetting corner tracts.

Chevron is the operator of the W/2E/2 of Sections 18 and 19 of Township 26 South, Range 33 East and owns 100% of the working interests in the W/2E/2 of Sections 18 and 19 of Township 26 South, Range 33 East. There are no unleased mineral interest owners in the W/2E/2 of Sections 18 and 19 of Township 26 South, Range 33 East. As a result, no notice to offset owners with respect to the W/2E/2 of Sections 18 and 19 of Township 26 South, Range 33 East is required. See Rule 19.15.4.12(A)(2) and Rule 19.15.2.7(A)(3).

Chevron is providing notice to the Bureau of Land Management ("BLM"). Proof of mailing, along with a copy of the notice letter sent to BLM, is attached hereto as **Exhibit D**.

Your attention to this matter is appreciated.

Sincerely,



Earl E. DeBrine

Deana M. Bennett

**Attorneys for Chevron U.S.A.
Inc.**

District I
1625 N. French Dr., Hobbs, NM 88240
Phone: (575) 393-6161 Fax: (575) 393-0720

District II
811 S. First St., Artesia, NM 88210
Phone: (575) 748-1283 Fax: (575) 748-9720

District III
1000 Rio Brazos Road, Aztec, NM 87410
Phone: (505) 334-6178 Fax: (505) 334-6170

District IV
1220 S. St. Francis Dr., Santa Fe, NM 87505
Phone: (505) 476-3460 Fax: (505) 476-3462

State of New Mexico
Energy, Minerals & Natural Resources Department
OIL CONSERVATION DIVISION
1220 South St. Francis Dr.
Santa Fe, NM 87505

Form C-102
Revised August 1, 2011
Submit one copy to appropriate
District Office

☐ AMENDED REPORT

WELL LOCATION AND ACREAGE DEDICATION PLAT

¹ API Number 30-025-50089		² Pool Code 97955	³ Pool Name WC-025 G-06 S263319P;BONE SPRING
⁴ Property Code 332808	⁵ Property Name SD 18 19 FEDERAL COM		⁶ Well Number 425H
⁷ OGRID No. 4323	⁸ Operator Name CHEVRON U.S.A. INC.		⁹ Elevation 3230'

10 Surface Location

UL or lot no.	Section	Township	Range	Lot Idn	Feet from the	North/South line	Feet from the	East/West line	County
B	18	26 SOUTH	33 EAST, N.M.P.M.		425'	NORTH	2041'	EAST	LEA

11 Bottom Hole Location If Different From Surface

UL or lot no.	Section	Township	Range	Lot Idn	Feet from the	North/South line	Feet from the	East/West line	County
P	19	26 SOUTH	33 EAST, N.M.P.M.		25'	SOUTH	1210'	EAST	LEA

¹² Dedicated Acres 320	¹³ Joint or Infill INFILL	¹⁴ Consolidation Code	¹⁵ Order No.
--------------------------------------	---	----------------------------------	-------------------------

No allowable will be assigned to this completion until all interests have been consolidated or a non-standard unit has been approved by the division.

<p>16</p> <table border="1" style="width: 100%; border-collapse: collapse;"> <tr> <th>SD 18 19 FEDERAL COM 425H</th> <th>PROPOSED BOTTOM HOLE LOCATION</th> </tr> <tr> <td>X= 724,435 Y= 382,484 LAT. 32.049495 N LONG. 103.608956 W NAD 27</td> <td>X= 725,343 Y= 372,380 LAT. 32.021703 N LONG. 103.606244 W NAD 27</td> </tr> <tr> <td>X= 765,622 Y= 382,542 LAT. 32.049620 N LONG. 103.609425 W NAD83/2011</td> <td>X= 766,531 Y= 372,437 LAT. 32.021828 N LONG. 103.606712 W NAD83/2011</td> </tr> <tr> <td colspan="2">ELEVATION +3230' NAVD 88</td> </tr> </table> <table border="1" style="width: 100%; border-collapse: collapse;"> <tr> <th>PROPOSED FIRST TAKE POINT</th> <th>PROPOSED LAST TAKE POINT</th> </tr> <tr> <td>X= 725,264 Y= 382,814 LAT. 32.050387 N LONG. 103.606273 W NAD 27</td> <td>X= 725,343 Y= 372,455 LAT. 32.021909 N LONG. 103.606245 W NAD 27</td> </tr> <tr> <td>X= 766,451 Y= 382,872 LAT. 32.050512 N LONG. 103.606742 W NAD83/2011</td> <td>X= 766,530 Y= 372,512 LAT. 32.022034 N LONG. 103.606712 W NAD83/2011</td> </tr> </table> <p>CORNER COORDINATES TABLE (NAD 27)</p> <p>A - X=721214.40, Y=382884.06 B - X=725158.52, Y=382913.68 C - X=726473.23, Y=382923.55 D - X=721247.39, Y=377603.37 E - X=725196.60, Y=377632.53 F - X=726513.00, Y=377642.26 G - X=721279.27, Y=372322.68 H - X=725234.87, Y=372354.00 I - X=726553.40, Y=372364.44</p>	SD 18 19 FEDERAL COM 425H	PROPOSED BOTTOM HOLE LOCATION	X= 724,435 Y= 382,484 LAT. 32.049495 N LONG. 103.608956 W NAD 27	X= 725,343 Y= 372,380 LAT. 32.021703 N LONG. 103.606244 W NAD 27	X= 765,622 Y= 382,542 LAT. 32.049620 N LONG. 103.609425 W NAD83/2011	X= 766,531 Y= 372,437 LAT. 32.021828 N LONG. 103.606712 W NAD83/2011	ELEVATION +3230' NAVD 88		PROPOSED FIRST TAKE POINT	PROPOSED LAST TAKE POINT	X= 725,264 Y= 382,814 LAT. 32.050387 N LONG. 103.606273 W NAD 27	X= 725,343 Y= 372,455 LAT. 32.021909 N LONG. 103.606245 W NAD 27	X= 766,451 Y= 382,872 LAT. 32.050512 N LONG. 103.606742 W NAD83/2011	X= 766,530 Y= 372,512 LAT. 32.022034 N LONG. 103.606712 W NAD83/2011	<p>17 OPERATOR CERTIFICATION</p> <p><i>I hereby certify that the information contained herein is true and complete to the best of my knowledge and belief, and that this organization either owns a working interest or unleased mineral interest in the land including the proposed bottom hole location or has a right to drill this well at this location pursuant to a contract with an owner of such a mineral or working interest, or to a voluntary pooling agreement or a compulsory pooling order heretofore entered by the division.</i></p> <p>Signature _____ Date _____</p> <p>Printed Name _____</p> <p>E-mail Address _____</p> <p>18 SURVEYOR CERTIFICATION</p> <p><i>I hereby certify that the well location shown on this plat was plotted from field notes of actual surveys made by me or under my supervision, and that the same is true and correct to the best of my belief.</i></p> <p>03/10/2020 Date of Survey</p> <p>Signature and Seal of Professional Surveyor: _____</p> <p>23006 03/17/2023</p> <p>Certificate Number _____</p>
SD 18 19 FEDERAL COM 425H	PROPOSED BOTTOM HOLE LOCATION														
X= 724,435 Y= 382,484 LAT. 32.049495 N LONG. 103.608956 W NAD 27	X= 725,343 Y= 372,380 LAT. 32.021703 N LONG. 103.606244 W NAD 27														
X= 765,622 Y= 382,542 LAT. 32.049620 N LONG. 103.609425 W NAD83/2011	X= 766,531 Y= 372,437 LAT. 32.021828 N LONG. 103.606712 W NAD83/2011														
ELEVATION +3230' NAVD 88															
PROPOSED FIRST TAKE POINT	PROPOSED LAST TAKE POINT														
X= 725,264 Y= 382,814 LAT. 32.050387 N LONG. 103.606273 W NAD 27	X= 725,343 Y= 372,455 LAT. 32.021909 N LONG. 103.606245 W NAD 27														
X= 766,451 Y= 382,872 LAT. 32.050512 N LONG. 103.606742 W NAD83/2011	X= 766,530 Y= 372,512 LAT. 32.022034 N LONG. 103.606712 W NAD83/2011														

EXHIBIT

A

April 7, 2023

VIA E-FILING

Acting Director Dylan M. Fuge
and OCD Engineering Bureau
Oil Conservation Division
Energy, Minerals and Natural Resources Department
1220 South Saint Francis Drive
Santa Fe, New Mexico 87505

Re: Non-Standard Location Application
SD 18 19 Federal Com well
Lea County, New Mexico

Dear Director Fuge/OCD Engineering Bureau

Chevron U.S.A. Inc. (OGRID 4323) ("Chevron") respectfully requests administrative approval of a non-standard location ("NSL") for the following well (the "Well"):

- SD 18 19 Federal Com well 425H (API No. 30-025-50089)

The Well's completed interval will be closer than 330' from the outer boundary of the spacing unit, which requires an NSL approval. The first and last take points for the Well are standard.

Chevron is requesting non-standard location approval for the Well to allow the setback from the outer boundary to be less than 330' from the western boundary of the horizontal spacing unit. Allowing Chevron to complete the Well at this non-standard location will result in the greatest recovery of reserves from the unit and will reduce waste.

Thank you for your consideration. Should you have any questions please contact me at jfleck@chevron.com or 432-687-7386.

Sincerely,

Jordan Fleck, Reservoir Engineer
Chevron U.S.A. Inc.



Offset Operators and WI Owners

NSL Well: SD 18 19 Fed Com P361 425H Well

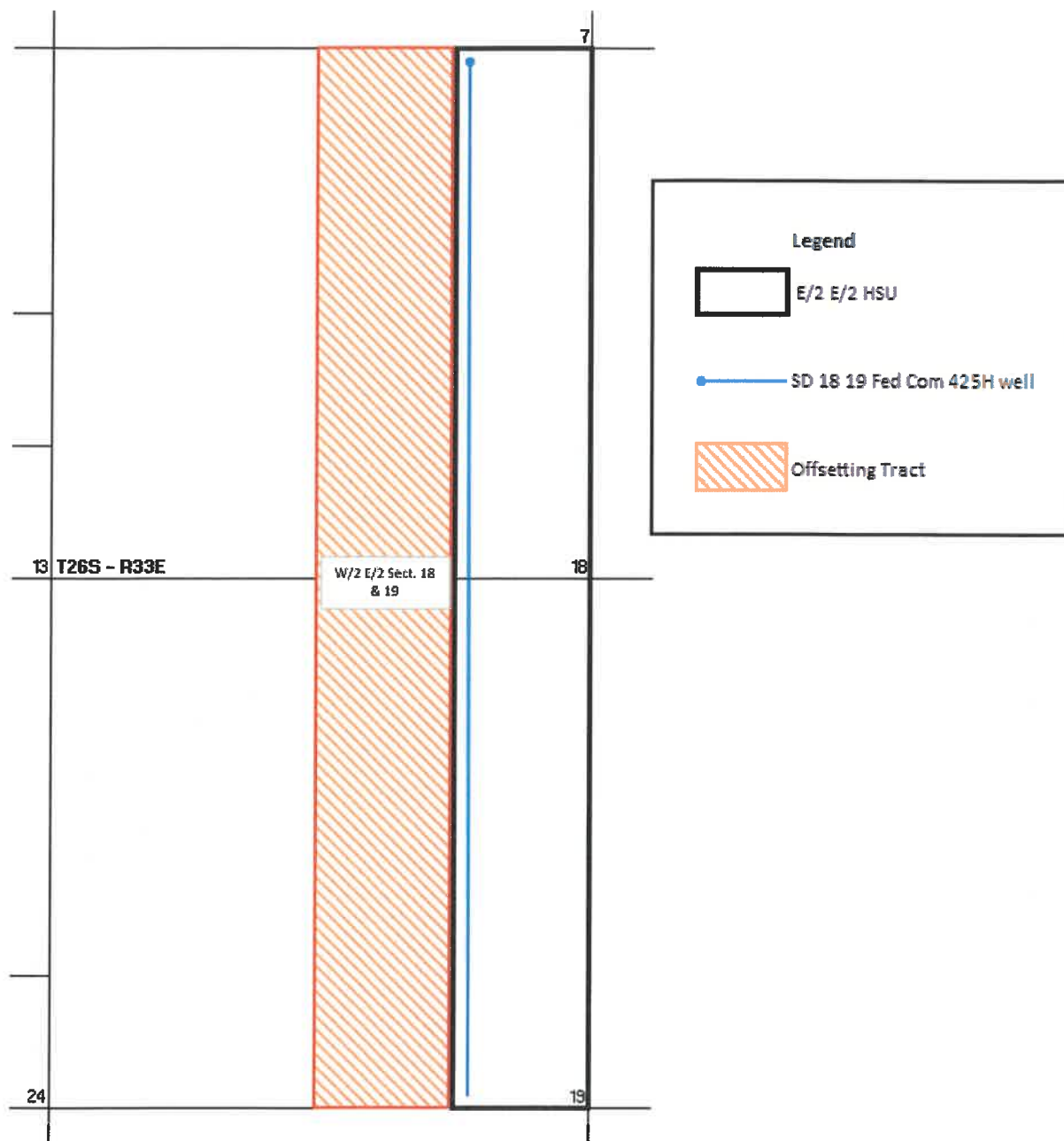

Offsetting Tracts in Township 26 South, Range 32 East:

W/2 E/2 Sect. 18 & 19:

Operator/Working Interest Owner:

Chevron U.S.A. Inc. (100% WI)

Federal/State Mineral Interest Owner:

Bureau of Land Management





April 12, 2023

Deana M. Bennett
505.848.1834
dmb@modrall.com

VIA CERTIFIED MAIL

TO AFFECTED PARTIES

Re: Application of Chevron U.S.A. Inc. for administrative approval of unorthodox well location for its SD 18 19 Federal Com 425H Well located in the E/2E/2 of Sections 18 and 19, Township 26 South, Range 33 East, NMPM, Lea County, New Mexico.

Dear Sir or Madam:

Enclosed is a copy of the above referenced application filed with the New Mexico Conservation Division on this date. Any objections that you have to this application must be filed in writing with the New Mexico Oil Conservation Division, 1220 South St. Francis Drive, Santa Fe, New Mexico 87505, within twenty (20) days from the date the Division receives the above referenced application. If no objection is received within this twenty-day period, the application may be approved administratively by the Division.

If you have any questions concerning this application, please contact:

Jordan Fleck
Reservoir Engineer
Chevron U.S.A. Inc.
jffleck@chevron.com
(432) 687-7386

Sincerely,

Deana M. Bennett
Attorney for Chevron U.S.A. Inc.

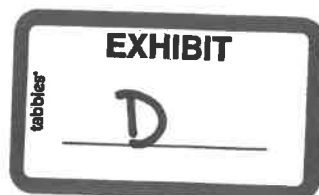

Modrall Sperling
Roehl Harris & Sisk P.A.
500 Fourth Street NW
Suite 1000
Albuquerque,
New Mexico 87102

PO Box 2168
Albuquerque,
New Mexico 87103-2168

Tel: 505.848.1800
www.modrall.com

Karlene Schuman
Modrall Sperlberg Roehl Harris & Sisk P.A.
500 Fourth Street, Suite 1000
Albuquerque NM 87102

PS Form 3877

Type of Mailing: CERTIFIED MAIL
04/12/2023

Firm Mailing Book ID: 244369

Line	USPS Article Number	Name, Street, City, State, Zip	Postage	Service Fee	RR Fee	Rest.Del.Fee	Reference Contents
1	9314 8699 0430 0106 5889 32	Bureau of Land Management 301 Dinosaur Trail Santa Fe NM 87508	\$1.74	\$4.15	\$2.10	\$0.00	83420.0050 NSL
Totals:			\$1.74	\$4.15	\$2.10	\$0.00	
			Grand Total:				\$7.99

List Number of Pieces
Listed by Sender

Total Number of Pieces
Received at Post Office

Postmaster:
Name of receiving employee

Dated:

District I
1625 N. French Dr., Hobbs, NM 88240
Phone: (575) 393-6161 Fax: (575) 393-0720

District II
811 S. First St., Artesia, NM 88210
Phone: (575) 748-1283 Fax: (575) 748-9720

District III
1000 Rio Brazos Road, Aztec, NM 87410
Phone: (505) 334-6178 Fax: (505) 334-6170

District IV
1220 S. St. Francis Dr., Santa Fe, NM 87505
Phone: (505) 476-3460 Fax: (505) 476-3462

State of New Mexico
Energy, Minerals & Natural Resources Department
OIL CONSERVATION DIVISION
1220 South St. Francis Dr.
Santa Fe, NM 87505

Form C-102
Revised August 1, 2011
Submit one copy to appropriate
District Office
☐ AMENDED REPORT

WELL LOCATION AND ACREAGE DEDICATION PLAT

¹ API Number 30-025-50089	² Pool Code 97955	³ Pool Name WC-025 G-06 S263319P;BONE SPRING
⁴ Property Code 332808	⁵ Property Name SD 18 19 FEDERAL COM	⁶ Well Number 425H
⁷ OGRID No. 4323	⁸ Operator Name CHEVRON U.S.A. INC.	⁹ Elevation 3230'

¹⁰ Surface Location

UL or lot no.	Section	Township	Range	Lot Idn	Feet from the	North/South line	Feet from the	East/West line	County
B	18	26 SOUTH	33 EAST, N.M.P.M.		425'	NORTH	2041'	EAST	LEA

¹¹ Bottom Hole Location If Different From Surface

UL or lot no.	Section	Township	Range	Lot Idn	Feet from the	North/South line	Feet from the	East/West line	County
P	19	26 SOUTH	33 EAST, N.M.P.M.		25'	SOUTH	1210'	EAST	LEA

¹² Dedicated Acres 320	¹³ Joint or Infill INFILL	¹⁴ Consolidation Code	¹⁵ Order No.
--------------------------------------	---	----------------------------------	-------------------------

No allowable will be assigned to this completion until all interests have been consolidated or a non-standard unit has been approved by the division.

<p>SD 18 19 FEDERAL COM 425H</p> <p>X= 724,435 Y= 382,484 LAT. 32.049495 N LONG. 103.608956 W NAD 27</p> <p>X= 765,622 Y= 382,542 LAT. 32.049620 N LONG. 103.609425 W NAD83/2011</p> <p>ELEVATION +3230' NAVD 88</p> <p>PROPOSED BOTTOM HOLE LOCATION</p> <p>X= 725,343 Y= 372,380 LAT. 32.021703 N LONG. 103.606244 W NAD 27</p> <p>X= 766,531 Y= 372,437 LAT. 32.021828 N LONG. 103.606712 W NAD83/2011</p> <p>PROPOSED FIRST TAKE POINT</p> <p>X= 725,264 Y= 382,814 LAT. 32.050387 N LONG. 103.606273 W NAD 27</p> <p>X= 766,451 Y= 382,872 LAT. 32.050512 N LONG. 103.606742 W NAD83/2011</p> <p>PROPOSED LAST TAKE POINT</p> <p>X= 725,343 Y= 372,455 LAT. 32.021909 N LONG. 103.606245 W NAD 27</p> <p>X= 766,530 Y= 372,512 LAT. 32.022034 N LONG. 103.606712 W NAD83/2011</p> <p>CORNER COORDINATES TABLE (NAD 27)</p> <p>A - X=721214.40, Y=382884.06 B - X=725158.52, Y=382913.68 C - X=726473.23, Y=382923.55 D - X=721247.39, Y=377603.37 E - X=725196.60, Y=377632.53 F - X=726513.00, Y=377642.26 G - X=721279.27, Y=372322.68 H - X=725234.87, Y=372354.00 I - X=726553.40, Y=372364.44</p>	<p>16</p> <p>N 68°17'07" E 892.17'</p> <p>425'</p> <p>2041'</p> <p>Proposed First Take Point 100' FNL, 1210' FEL</p> <p>18</p> <p>106'</p> <p>19</p> <p>Proposed Last Take Point 100' FSL, 1210' FEL</p> <p>25'</p> <p>1210'</p> <p>S 00°26'06" E 10,434.76'</p>	<p>17 OPERATOR CERTIFICATION</p> <p>I hereby certify that the information contained herein is true and complete to the best of my knowledge and belief, and that this organization either owns a working interest or unleased mineral interest in the land including the proposed bottom hole location or has a right to drill this well at this location pursuant to a contract with an owner of such a mineral or working interest, or to a voluntary pooling agreement or a compulsory pooling order heretofore entered by the division.</p> <p>Signature _____ Date _____</p> <p>Printed Name _____</p> <p>E-mail Address _____</p> <p>18 SURVEYOR CERTIFICATION</p> <p>I hereby certify that the well location shown on this plat was plotted from field notes of actual surveys made by me or under my supervision, and that the same is true and correct to the best of my belief.</p> <p>03/10/2020 Date of Survey</p> <p>Signature and Seal of Professional Surveyor: _____</p> <p>23006 03/17/2023</p> <p>Certificate Number _____</p>
--	---	--

EXHIBIT

A



April 12, 2023

Deana M. Bennett
505.848.1834
dmb@modrall.com

VIA CERTIFIED MAIL

TO AFFECTED PARTIES

Re: Application of Chevron U.S.A. Inc. for administrative approval of unorthodox well location for its SD 18 19 Federal Com 425H Well located in the E/2E/2 of Sections 18 and 19, Township 26 South, Range 33 East, NMPM, Lea County, New Mexico.

Dear Sir or Madam:

Enclosed is a copy of the above referenced application filed with the New Mexico Conservation Division on this date. Any objections that you have to this application must be filed in writing with the New Mexico Oil Conservation Division, 1220 South St. Francis Drive, Santa Fe, New Mexico 87505, within twenty (20) days from the date the Division receives the above referenced application. If no objection is received within this twenty-day period, the application may be approved administratively by the Division.

If you have any questions concerning this application, please contact:

Jordan Fleck
Reservoir Engineer
Chevron U.S.A. Inc.
jfleck@chevron.com
(432) 687-7386

Sincerely,

A handwritten signature in dark ink, appearing to read 'Deana M. Bennett', is written over a horizontal line.

Deana M. Bennett
Attorney for Chevron U.S.A. Inc.

Modrall Sperling
Roehl Harris & Sisk P.A.
500 Fourth Street NW
Suite 1000
Albuquerque,
New Mexico 87102

PO Box 2168
Albuquerque,
New Mexico 87103-2168

Tel: 505.848.1800
www.modrall.com

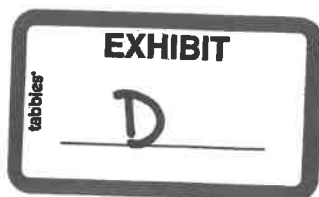

Karlene Schuman
Modrall Sperlberg Roehl Harris & Sisk P.A.
500 Fourth Street, Suite 1000
Albuquerque NM 87102

PS Form 3877

Type of Mailing: CERTIFIED MAIL
04/12/2023

Firm Mailing Book ID: 244369

Line	USPS Article Number	Name, Street, City, State, Zip	Postage	Service Fee	RR Fee	Rest.Del.Fee	Reference Contents
1	9314 8699 0430 0106 5889 32	Bureau of Land Management 301 Dinosaur Trail Santa Fe NM 87508	\$1.74	\$4.15	\$2.10	\$0.00	83420.0050 NSL
Totals:			\$1.74	\$4.15	\$2.10	\$0.00	
			Grand Total:				\$7.99

List Number of Pieces
Listed by Sender

Total Number of Pieces
Received at Post Office

Postmaster:
Name of receiving employee

Dated:



April 12, 2023

Deana M. Bennett
505.848.1834
dmb@modrall.com

VIA CERTIFIED MAIL

TO AFFECTED PARTIES

Re: Application of Chevron U.S.A. Inc. for administrative approval of unorthodox well location for its SD 18 19 Federal Com 425H Well located in the E/2E/2 of Sections 18 and 19, Township 26 South, Range 33 East, NMPM, Lea County, New Mexico.

Dear Sir or Madam:

Enclosed is a copy of the above referenced application filed with the New Mexico Conservation Division on this date. Any objections that you have to this application must be filed in writing with the New Mexico Oil Conservation Division, 1220 South St. Francis Drive, Santa Fe, New Mexico 87505, within twenty (20) days from the date the Division receives the above referenced application. If no objection is received within this twenty-day period, the application may be approved administratively by the Division.

If you have any questions concerning this application, please contact:

Jordan Fleck
Reservoir Engineer
Chevron U.S.A. Inc.
jfleck@chevron.com
(432) 687-7386

Sincerely,

A handwritten signature in dark ink, appearing to read 'Deana M. Bennett', is written over a horizontal line.

Deana M. Bennett
Attorney for Chevron U.S.A. Inc.

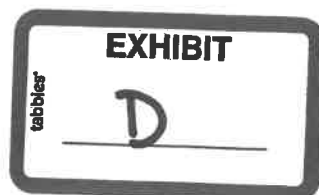

Modrall Sperling
Roehl Harris & Sisk P.A.
500 Fourth Street NW
Suite 1000
Albuquerque,
New Mexico 87102

PO Box 2168
Albuquerque,
New Mexico 87103-2168

Tel: 505.848.1800
www.modrall.com

Karlene Schuman
Modrall Sperlberg Roehl Harris & Sisk P.A.
500 Fourth Street, Suite 1000
Albuquerque NM 87102

PS Form 3877

Type of Mailing: CERTIFIED MAIL
04/12/2023

Firm Mailing Book ID: 244369

Line	USPS Article Number	Name, Street, City, State, Zip	Postage	Service Fee	RR Fee	Rest.Del.Fee	Reference Contents
1	9314 8699 0430 0106 5889 32	Bureau of Land Management 301 Dinosaur Trail Santa Fe NM 87508	\$1.74	\$4.15	\$2.10	\$0.00	83420.0050 NSL
Totals:			\$1.74	\$4.15	\$2.10	\$0.00	
			Grand Total:				\$7.99

List Number of Pieces
Listed by Sender

Total Number of Pieces
Received at Post Office

Postmaster:
Name of receiving employee

Dated:

1

April 7, 2023

VIA E-FILING

Acting Director Dylan M. Fuge
and OCD Engineering Bureau
Oil Conservation Division
Energy, Minerals and Natural Resources Department
1220 South Saint Francis Drive
Santa Fe, New Mexico 87505

Re: Non-Standard Location Application
SD 18 19 Federal Com well
Lea County, New Mexico

Dear Director Fuge/OCD Engineering Bureau

Chevron U.S.A. Inc. (OGRID 4323) ("Chevron") respectfully requests administrative approval of a non-standard location ("NSL") for the following well (the "Well"):

- SD 18 19 Federal Com well 425H (API No. 30-025-50089)

The Well's completed interval will be closer than 330' from the outer boundary of the spacing unit, which requires an NSL approval. The first and last take points for the Well are standard.

Chevron is requesting non-standard location approval for the Well to allow the setback from the outer boundary to be less than 330' from the western boundary of the horizontal spacing unit. Allowing Chevron to complete the Well at this non-standard location will result in the greatest recovery of reserves from the unit and will reduce waste.

Thank you for your consideration. Should you have any questions please contact me at jfleck@chevron.com or 432-687-7386.

Sincerely,

Jordan Fleck, Reservoir Engineer
Chevron U.S.A. Inc.



Offset Operators and WI Owners

NSL Well: SD 18 19 Fed Com P361 425H Well

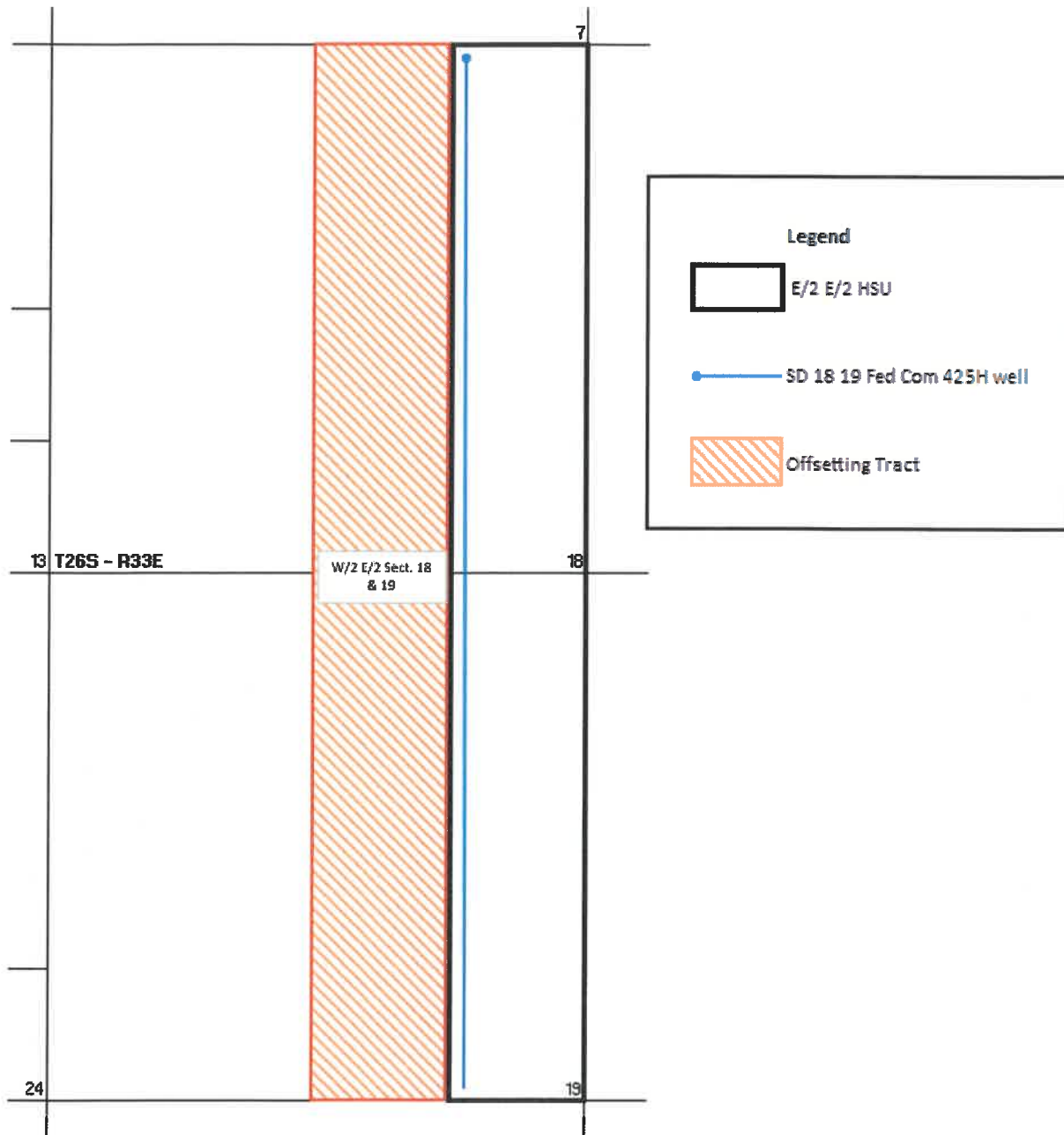

Offsetting Tracts in Township 26 South, Range 32 East:

W/2 E/2 Sect. 18 & 19:

Operator/Working Interest Owner:

Chevron U.S.A. Inc. (100% WI)

Federal/State Mineral Interest Owner:

Bureau of Land Management

EXHIBIT

C

District I
1625 N. French Dr., Hobbs, NM 88240
Phone:(575) 393-6161 Fax:(575) 393-0720

District II
811 S. First St., Artesia, NM 88210
Phone:(575) 748-1283 Fax:(575) 748-9720

District III
1000 Rio Brazos Rd., Aztec, NM 87410
Phone:(505) 334-6178 Fax:(505) 334-6170

District IV
1220 S. St Francis Dr., Santa Fe, NM 87505
Phone:(505) 476-3470 Fax:(505) 476-3462

State of New Mexico
Energy, Minerals and Natural Resources
Oil Conservation Division
1220 S. St Francis Dr.
Santa Fe, NM 87505

CONDITIONS

Action 207021

CONDITIONS

Operator: CHEVRON U S A INC 6301 Deauville Blvd Midland, TX 79706	OGRID: 4323
	Action Number: 207021
	Action Type: [UF-NSL] Non-Standard Location (NSL)

CONDITIONS

Created By	Condition	Condition Date
llowe	None	4/13/2023