

ID NO. 239146

NSL - 8620

Revised March 23, 2017

RECEIVED:	REVIEWER:	TYPE:	APP NO: pLEL2319859894
-----------	-----------	-------	-------------------------------

ABOVE THIS TABLE FOR OCD DIVISION USE ONLY

NEW MEXICO OIL CONSERVATION DIVISION
 - Geological & Engineering Bureau -
 1220 South St. Francis Drive, Santa Fe, NM 87505

**ADMINISTRATIVE APPLICATION CHECKLIST**

THIS CHECKLIST IS MANDATORY FOR ALL ADMINISTRATIVE APPLICATIONS FOR EXCEPTIONS TO DIVISION RULES AND
 REGULATIONS WHICH REQUIRE PROCESSING AT THE DIVISION LEVEL IN SANTA FE

Applicant: <u>Mewbourne Oil Company</u>	OGRID Number: <u>14744</u>
Well Name: <u>Salado Draw 10 W00B Fed Com #2H</u>	API: <u>30-025-49388</u>
Pool: <u>Red Hills; Wolfcamp</u>	Pool Code: <u>83600</u>

**SUBMIT ACCURATE AND COMPLETE INFORMATION REQUIRED TO PROCESS THE TYPE OF APPLICATION
 INDICATED BELOW**

- 1) **TYPE OF APPLICATION:** Check those which apply for [A]
 A. Location – Spacing Unit – Simultaneous Dedication
☒ NSL ☐ NSP (PROJECT AREA) ☐ NSP (PRORATION UNIT) ☐ SD

B. Check one only for [I] or [II]

[I] Commingling – Storage – Measurement

☐ DHC ☐ CTB ☐ PLC ☐ PC ☐ OLS ☐ OLM

[II] Injection – Disposal – Pressure Increase – Enhanced Oil Recovery

☐ WFX ☐ PMX ☐ SWD ☐ IPI ☐ EOR ☐ PPR

- 2) **NOTIFICATION REQUIRED TO:** Check those which apply.

- A. ☒ Offset operators or lease holders
 B. ☐ Royalty, overriding royalty owners, revenue owners
 C. ☐ Application requires published notice
 D. ☐ Notification and/or concurrent approval by SLO
 E. ☐ Notification and/or concurrent approval by BLM
 F. ☐ Surface owner
 G. ☒ For all of the above, proof of notification or publication is attached, and/or,
 H. ☐ No notice required

FOR OCD ONLY

- ☐ Notice Complete
☐ Application
 Content
 Complete

- 3) **CERTIFICATION:** I hereby certify that the information submitted with this application for administrative approval is **accurate** and **complete** to the best of my knowledge. I also understand that **no action** will be taken on this application until the required information and notifications are submitted to the Division.

Note: Statement must be completed by an individual with managerial and/or supervisory capacity.

Ariana Rodriguez

Print or Type Name

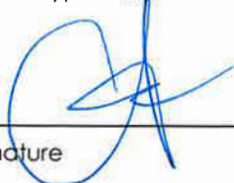
 Signature

7/10/2023

Date

(432) 682-3715

Phone Number

arodrigues@mewbourne.com

e-mail Address

MEWBOURNE OIL COMPANY

500 West Texas, Suite 1020
Midland, Texas 79701
Phone (432) 682-3715

July 10, 2023

Certified Mail

New Mexico Oil Conservation Division
1220 S. St. Francis Drive
Santa Fe, New Mexico 87505
Attn: Mr. Leonard Lowe

Re: Application for Unorthodox Well Location
Salado Draw 10 W00B Fed Com #2H (API No. 30-025-49388)
Surface Location: 235' FSL & 2030' FEL (Unit O – Section 10, T26S, R33E)
First Take Point: 100' FSL & 2310' FEL (Section 10, T26S, R33E)
Bottomhole Location: 100' FNL & 2310' FEL (Unit B – Section 10, T26S, R33E)
Last Take Point: 100' FNL & 2310' FEL (Section 10, T26S, R33E)
Proration Unit: All of Section 10, T-26-S, R-33-E, NMPM, Lea County, New Mexico
Pool: Pool (83600), Red Hills; Wolfcamp, (Gas)

Dear Mr. Lowe:

Pursuant to Division Rule 19.15.15.13, Mewbourne Oil Company (“Mewbourne”) respectfully requests administrative approval of an unorthodox gas well location for its proposed Salado Draw 10 W00B Fed Com #2H well. This well will be drilled as a horizontal gas well in the Red Hills; Wolfcamp (Gas) Pool (83600).

The Salado Draw 10 W00B Fed Com #2H well will be dedicated to a 640-acre gas spacing and proration unit comprising all of Section 10.

The Red Hills; Wolfcamp (Gas) Pool is currently governed by Special Pool Rules, Hearing Order No. R-3073 which requires standard 640-acre gas spacing and proration units with wells to be located no closer than 660 feet to the outer boundary of the spacing unit, nor closer than 10 feet to any interior quarter-quarter section line or subdivision inner boundary, or in the case of a horizontal well, no closer than 660 feet to the outer boundary of the producing area.

The unorthodox location is necessary in order to maximize the recovery of oil and gas reserves from the Wolfcamp formation underlying all of Section 10.

The affected offset acreage comprises of Sections 3 and Section 15, T26S, R33E, NMPM (See Attached Map). Notice of this application is being provided to COG Operating LLC and EOG Resources, Inc.

Enclosed is a Form C-102 showing the surface, first take point, and bottomhole locations for the Salado Draw 10 W00B Fed Com #2H well. Also, attached is a map showing the affected offset acreage, notice letter and offset notice list of parties and their addresses.

In summary, approval of the application will provide Mewbourne Oil Company the opportunity to recover additional oil and gas reserves from the Red Hills; Wolfcamp (Gas) Pool underlying all of Section 10 that may otherwise not be recovered, thereby preventing waste, and will not violate correlative rights.

Should you have any questions regarding the above, please email me at arodrigues@mewbourne.com or call me at (432) 682-3715.

Sincerely,

MEWBOURNE OIL COMPANY

A handwritten signature in blue ink, appearing to read 'Ariana Rodrigues', is written over the company name.

Ariana Rodrigues
Landman

Enclosures

Offset Plat

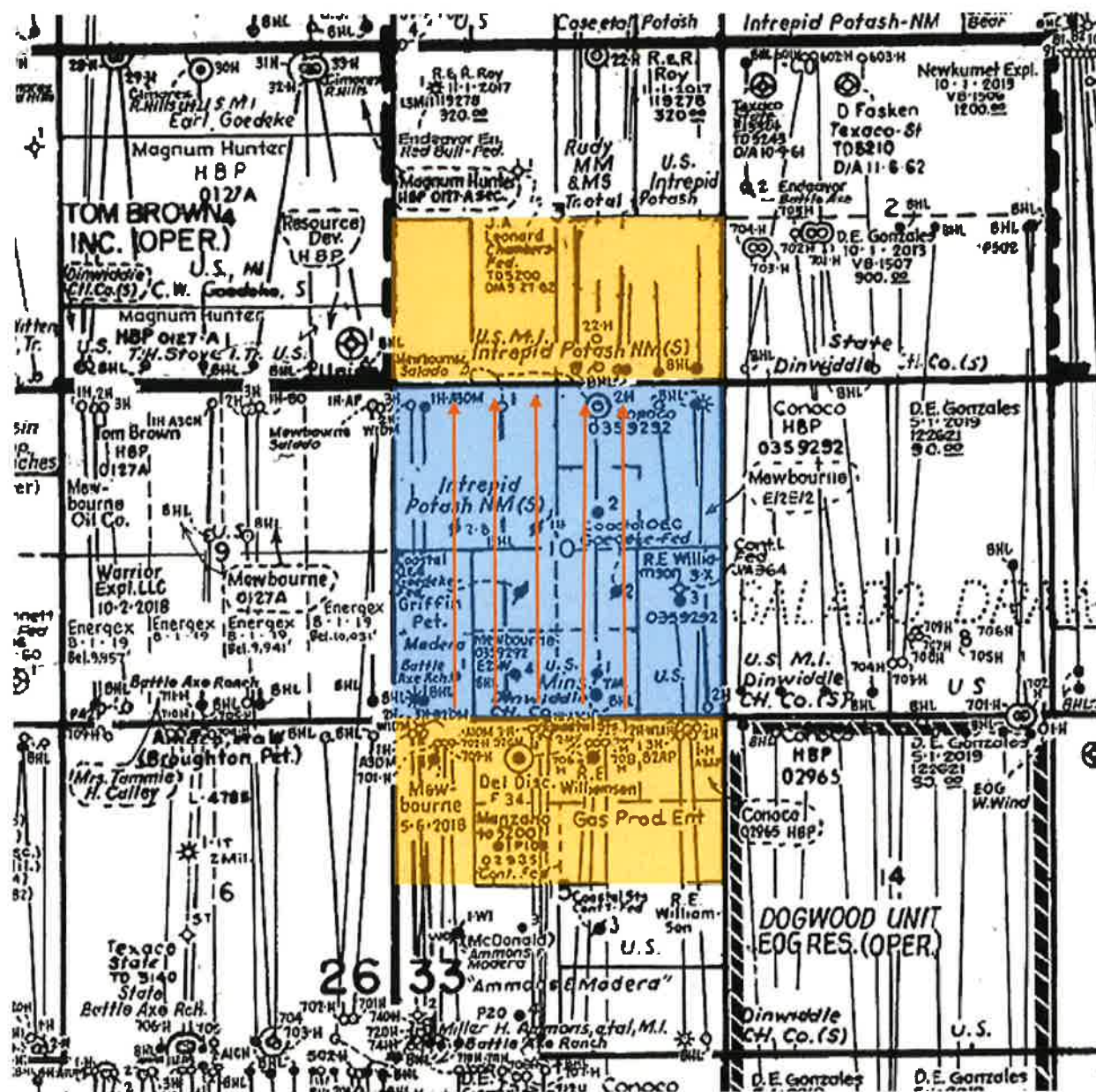

District I
1625 N. French Dr., Hobbs, NM 88240
Phone: (575) 393-6161 Fax: (575) 393-0720
District II
811 S. First St., Artesia, NM 88210
Phone: (505) 748-1283 Fax: (505) 748-9720
District III
1000 Rio Brazos Road, Aztec, NM 87410
Phone: (505) 334-6178 Fax: (505) 334-6170
District IV
1220 S. St. Francis Dr., Santa Fe, NM 87505
Phone: (505) 476-3460 Fax: (505) 476-3462

State of New Mexico
Energy, Minerals & Natural Resources Department
OIL CONSERVATION DIVISION
1220 South St. Francis Dr.
Santa Fe, NM 87505

Form C-102
Revised August 1, 2011
Submit one copy to appropriate
District Office

☐ AMENDED REPORT

WELL LOCATION AND ACREAGE DEDICATION PLAT

¹ API Number	² Pool Code 83600	³ Pool Name RED HILLS; WOLFCAMP
⁴ Property Code	⁵ Property Name SALADO DRAW 10 WOOF FED COM	⁶ Well Number 2H
⁷ GRID NO. 14744	⁸ Operator Name MEWBOURNE OIL COMPANY	⁹ Elevation 3316'

¹⁰ Surface Location

UL or lot no.	Section	Township	Range	Lot Idn	Feet from the	North/South line	Feet from the	East/West line	County
0	10	26S	33E		235	SOUTH	2030	EAST	LEA

¹¹ Bottom Hole Location If Different From Surface

UL or lot no.	Section	Township	Range	Lot Idn	Feet from the	North/South line	Feet from the	East/West line	County
B	10	26S	33E		100	NORTH	2310	EAST	LEA

¹² Dedicated Acres 640	¹³ Joint or Infill	¹⁴ Consolidation Code	¹⁵ Order No.
--------------------------------------	-------------------------------	----------------------------------	-------------------------

No allowable will be assigned to this completion until all interest have been consolidated or a non-standard unit has been approved by the division.

<p>GEODETIC DATA NAD 83 GRID - NM EAST</p> <p>SURFACE LOCATION N: 383291.5 - E: 781488.0</p> <p>LAT: 32.0513783° N LONG: 103.5582023° W</p> <p>GEODETIC DATA NAD 83 GRID - NM EAST</p> <p>BOTTOM HOLE N: 388234.5 - E: 781171.7</p> <p>LAT: 32.0649716° N LONG: 103.5591087° W</p> <p>CORNER DATA NAD 83 GRID - NM EAST</p> <p>A: CALCULATED CORNER N: 383036.8 - E: 778228.5</p> <p>B: FOUND BRASS CAP "1913" N: 385677.6 - E: 778212.9</p> <p>C: FOUND BRASS CAP "1913" N: 388317.6 - E: 778194.4</p> <p>D: FOUND BRASS CAP "1913" N: 388332.7 - E: 780836.2</p> <p>E: FOUND BRASS CAP "1913" N: 388347.1 - E: 783480.5</p> <p>F: FOUND BRASS CAP "1913" N: 383068.1 - E: 783519.3</p> <p>G: FOUND BRASS CAP "1913" N: 383053.0 - E: 780869.9</p>	<p>100'</p> <p>B.H.</p> <p>LTP - 100' FNL & 2310' FEL</p> <p>2310'</p> <p>10</p> <p>FTP - 100' FSL & 2310' FEL</p> <p>S.L.</p> <p>235'</p> <p>2030'</p>	<p>¹⁷ OPERATOR CERTIFICATION I hereby certify that the information contained herein is true and complete to the best of my knowledge and belief, and that this organization either owns a working interest or unleased mineral interest in the land including the proposed bottom hole location or has a right to drill this well at this location pursuant to a contract with an owner of such a mineral or working interest, or to a voluntary pooling agreement or a compulsory pooling order heretofore entered by the division.</p> <p>Signature: <i>Bradley Bishop</i> Date: 04-01-2022</p> <p>Printed Name: BRADLEY BISHOP</p> <p>E-mail Address: BBISHOP@MEWBOURNE.COM</p> <p>¹⁸ SURVEYOR CERTIFICATION I hereby certify that the well location shown on this plat was plotted from field notes of actual surveys made by me or under my supervision, and that the same is true and correct to the best of my belief.</p> <p>4-15-2020 Date of Survey</p> <p>Signature and Seal of Professional Surveyor: <i>Robert M. Howett</i></p> <p>19680 Certificate Number</p>
--	---	---

Job No.: LS19010099R

MEWBOURNE OIL COMPANY

500 West Texas, Suite 1020
Midland, Texas 79701
Phone (432) 682-3715

July 10, 2023

Certified Mail

«Owners»
«Attn»
«Address_Line_1»
«Address_Line_2»
«City», «State» «Zip_Code»

Re: Mewbourne Oil Company's Applications for Unorthodox Well Locations
Salado Draw 10, T26S, R33E, Lea County, New Mexico

Ladies and Gentlemen:

Enclosed please find a copy of the applications filed by Mewbourne Oil Company ("Mewbourne") for approval of unorthodox gas well locations for the below Salado Draw 10 wells located at the surface, first take point, last take point, and bottomhole locations described below. The wells will test Red Hills; Wolfcamp (Gas) Pool and will be dedicated to a standard 640-acre gas spacing and proration unit comprising all of Section 10, T-26-S, R-33-E, NMPM, Lea County, New Mexico. The unorthodox locations are necessary in order to maximize the recovery of oil and gas reserves within the Wolfcamp formation underlying all of Section 10.

Salado Draw 10 W0NC Fed Com #3H (API No. 30-025-50288)

Surface Location: 235' FSL & 2295' FWL (Unit N – Section 10, T26S, R33E)
First Take Point: 100' FSL & 1650' FWL (Section 10, T26S, R33E)
Bottomhole Location: 100' FNL & 1650' FWL (Unit C – Section 10, T26S, R33E)
Last Take Point: 100' FNL & 1650' FWL (Section 10, T26S, R33E)
Proration Unit: All of Section 10, T-26-S, R-33-E, NMPM, Lea County, New Mexico
Pool: Pool (83600), Red Hills; Wolfcamp, (Gas)

Salado Draw 10 W0OB Fed Com #2H (API No. 30-025-49388)

Surface Location: 235' FSL & 2030' FEL (Unit O – Section 10, T26S, R33E)
First Take Point: 100' FSL & 2310' FEL (Section 10, T26S, R33E)
Bottomhole Location: 100' FNL & 2310' FEL (Unit B – Section 10, T26S, R33E)
Last Take Point: 100' FNL & 2310' FEL (Section 10, T26S, R33E)
Proration Unit: All of Section 10, T-26-S, R-33-E, NMPM, Lea County, New Mexico
Pool: Pool (83600), Red Hills; Wolfcamp, (Gas)

Salado Draw 10 W1MD Fed Com #3H (API No. 30-025-50289)

Surface Location: 235' FSL & 2265' FWL (Unit N – Section 10, T26S, R33E)
First Take Point: 100' FSL & 990' FWL (Section 10, T26S, R33E)
Bottomhole Location: 100' FNL & 990' FWL (Unit D – Section 10, T26S, R33E)
Last Take Point: 100' FNL & 990' FWL (Section 10, T26S, R33E)
Proration Unit: All of Section 10, T-26-S, R-33-E, NMPM, Lea County, New Mexico
Pool: Pool (83600), Red Hills; Wolfcamp, (Gas)

Salado Draw 10 W1NC Fed Com #2H (API No. 30-025-50290)

Surface Location: 235' FSL & 2325' FWL (Unit N – Section 10, T26S, R33E)
First Take Point: 100' FSL & 2310' FWL (Section 10, T26S, R33E)
Bottomhole Location: 100' FNL & 2310' FWL (Unit C – Section 10, T26S, R33E)
Last Take Point: 100' FNL & 2310' FWL (Section 10, T26S, R33E)
Proration Unit: All of Section 10, T-26-S, R-33-E, NMPM, Lea County, New Mexico
Pool: Pool (83600), Red Hills; Wolfcamp, (Gas)

Salado Draw 10 W1OB Fed Com #1H (API No. 30-025-48376)

Surface Location: 235' FSL & 2000' FEL (Unit O – Section 10, T26S, R33E)
First Take Point: 100' FSL & 1650' FWL (Section 10, T26S, R33E)
Bottomhole Location: 100' FNL & 1650' FEL (Unit B – Section 10, T26S, R33E)
Last Take Point: 100' FNL & 1650' FEL (Section 10, T26S, R33E)
Proration Unit: All of Section 10, T-26-S, R-33-E, NMPM, Lea County, New Mexico
Pool: Pool (83600), Red Hills; Wolfcamp, (Gas)

As the owner of an interest that may be affected by the proposed unorthodox gas well locations, you are being provided notice as per Division rules and regulations. *Objections must be filed in writing at the Division's Santa Fe office within 20 days from the date this notice was sent to you.* If no objection is received within twenty days after the filing of these applications and proof of notice with the Division, the applications may be approved.

Should you have any questions regarding the above, please email me at arodrigues@mewbourne.com or call at (432) 682-3715.

Very truly yours,

MEWBOURNE OIL COMPANY

Ariana Rodrigues
Landman

Enclosures

Notice List for Non-Standard Location Application
Salado Draw 10
Lea County, New Mexico

Certified Tracking Number	Owners	Attn	Address Line 1	City	State	Zip Code
9414 8361 0544 0059 9910 88	COG Operating LLC	Attn: Jess Ritter	600 W Illinois Ave	Midland	TX	79701
9414 8361 0544 0059 9809 38	EOG Resources Inc.	Attn: Brian Pond	5509 Champions Drive	Midland	TX	79706

District I
1625 N. French Dr., Hobbs, NM 88240
Phone:(575) 393-6161 Fax:(575) 393-0720

District II
811 S. First St., Artesia, NM 88210
Phone:(575) 748-1283 Fax:(575) 748-9720

District III
1000 Rio Brazos Rd., Aztec, NM 87410
Phone:(505) 334-6178 Fax:(505) 334-6170

District IV
1220 S. St Francis Dr., Santa Fe, NM 87505
Phone:(505) 476-3470 Fax:(505) 476-3462

State of New Mexico
Energy, Minerals and Natural Resources
Oil Conservation Division
1220 S. St Francis Dr.
Santa Fe, NM 87505

CONDITIONS

Action 239146

CONDITIONS

Operator: MEWBOURNE OIL CO P.O. Box 5270 Hobbs, NM 88241	OGRID: 14744
	Action Number: 239146
	Action Type: [UF-NSL] Non-Standard Location (NSL)

CONDITIONS

Created By	Condition	Condition Date
llowe	None	7/17/2023