

ID NO. 278959

NSL - 8670

Revised March 23, 2017

RECEIVED: 10/24/23	REVIEWER:	TYPE:	APP NO: pLEL2329836063
--------------------	-----------	-------	------------------------

ABOVE THIS TABLE FOR OCD DIVISION USE ONLY

NEW MEXICO OIL CONSERVATION DIVISION
 - Geological & Engineering Bureau -
 1220 South St. Francis Drive, Santa Fe, NM 87505

**ADMINISTRATIVE APPLICATION CHECKLIST**

THIS CHECKLIST IS MANDATORY FOR ALL ADMINISTRATIVE APPLICATIONS FOR EXCEPTIONS TO DIVISION RULES AND
 REGULATIONS WHICH REQUIRE PROCESSING AT THE DIVISION LEVEL IN SANTA FE

Applicant: Mewbourne Oil Company **OGRID Number:** 14744
Well Name: Salado Draw 16/9 Fed Com #808H (aka Salado Draw 16/9 W2PA Fed Com 1H) **API:** Pending
Pool: Salado Draw; Wolfcamp **Pool Code:** 84410

**SUBMIT ACCURATE AND COMPLETE INFORMATION REQUIRED TO PROCESS THE TYPE OF APPLICATION
 INDICATED BELOW**

- 1) **TYPE OF APPLICATION:** Check those which apply for [A]
 A. Location – Spacing Unit – Simultaneous Dedication
☒ NSL ☐ NSP (PROJECT AREA) ☐ NSP (PRORATION UNIT) ☐ SD

B. Check one only for [I] or [II]

[I] Commingling – Storage – Measurement

☐ DHC ☐ CTB ☐ PLC ☐ PC ☐ OLS ☐ OLM

[II] Injection – Disposal – Pressure Increase – Enhanced Oil Recovery

☐ WFX ☐ PMX ☐ SWD ☐ IPI ☐ EOR ☐ PPR

- 2) **NOTIFICATION REQUIRED TO:** Check those which apply.

- A. ☒ Offset operators or lease holders
 B. ☐ Royalty, overriding royalty owners, revenue owners
 C. ☐ Application requires published notice
 D. ☐ Notification and/or concurrent approval by SLO
 E. ☐ Notification and/or concurrent approval by BLM
 F. ☐ Surface owner
 G. ☒ For all of the above, proof of notification or publication is attached, and/or,
 H. ☐ No notice required

FOR OCD ONLY

- ☐ Notice Complete
☐ Application
 Content
 Complete

- 3) **CERTIFICATION:** I hereby certify that the information submitted with this application for administrative approval is **accurate** and **complete** to the best of my knowledge. I also understand that **no action** will be taken on this application until the required information and notifications are submitted to the Division.

Note: Statement must be completed by an individual with managerial and/or supervisory capacity.

Ariana Rodriguez

Print or Type Name

Signature

10/24/2023

Date

(432) 682-3715

Phone Number

arodrigues@mewbourne.com

e-mail Address

MEWBOURNE OIL COMPANY

500 West Texas, Suite 1020
Midland, Texas 79701
Phone (432) 682-3715

October 24, 2023

Certified Mail

New Mexico Oil Conservation Division
1220 S. St. Francis Drive
Santa Fe, New Mexico 87505
Attn: Mr. Leonard Lowe

Re: Application for Unorthodox Well Location
Salado Draw 16/9 Fed Com #808H (aka Salado Draw 16/9 W2PA Fed Com #1H)
(API No. Pending)

Surface Location:	290' FSL & 1510' FEL (Unit O – Section 16, T26S, R33E)
First Take Point:	100' FSL & 420' FEL (Section 16, T26S, R33E)
Bottomhole Location:	100' FNL & 420' FEL (Unit A – Section 9, T26S, R33E)
Last Take Point:	100' FNL & 420' FEL (Section 9, T26S, R33E)
Proration Unit:	E/2 of Sections 16 & 9, T26S, R33E, NMPM, Lea County, New Mexico
Pool:	Pool (84410), Salado Draw; Wolfcamp, (Gas)

Dear Mr. Lowe:

Pursuant to Division Rule 19.15.15.13, Mewbourne Oil Company (“Mewbourne”) respectfully requests administrative approval of an unorthodox gas well location for its proposed Salado Draw 16/9 Fed Com #808H well. This well will be drilled as a horizontal gas well in the Salado Draw; Wolfcamp, (Gas) Pool (84410).

The Salado Draw 16/9 Fed Com #808H well will be dedicated to a 640-acre gas spacing and proration unit comprising E/2 of Sections 16 & 9.

The Salado Draw; Wolfcamp (Gas) Pool is currently governed by Division Rule 19.15.15.10 which requires standard 320-acre gas spacing and proration units with wells to be located no closer than 660 feet to the outer boundary of the spacing unit, nor closer than 10 feet to any interior quarter-quarter section line or subdivision inner boundary, or in the case of a horizontal well, no closer than 660 feet to the outer boundary of the producing area.

The unorthodox location is necessary in order to maximize the recovery of oil and gas reserves from the Wolfcamp formation underlying E/2 of Sections 16 & 9.

The affected offset acreage comprises of NE/4 of Sections 21, NW/4 of Section 22, W/2 of Section 15, W/2 of Section 10, SW/4 of Section 3, and SE/4 of Section 4, T26S, R33E, NMPM (See Attached Map). Notice of this application is being provided to the attached list of parties.

Enclosed is a Form C-102 showing the surface, first take point, and bottomhole locations for the Salado Draw 16/9 Fed Com #808H well. Also, attached is a map showing the affected offset acreage, notice letter and offset notice list of parties and their addresses.

In summary, approval of the application will provide Mewbourne Oil Company the opportunity to recover additional oil and gas reserves from the Salado Draw; Wolfcamp (Gas) Pool underlying the E/2 of Sections 16 & 9 that may otherwise not be recovered, thereby preventing waste, and will not violate correlative rights.

Should you have any questions regarding the above, please email me at arodrigues@mewbourne.com or call me at (432) 682-3715.

Sincerely,

MEWBOURNE OIL COMPANY



Ariana Rodriguez
Landman

Enclosures

Offset Plat

T26S, R33E
Lea County, NM

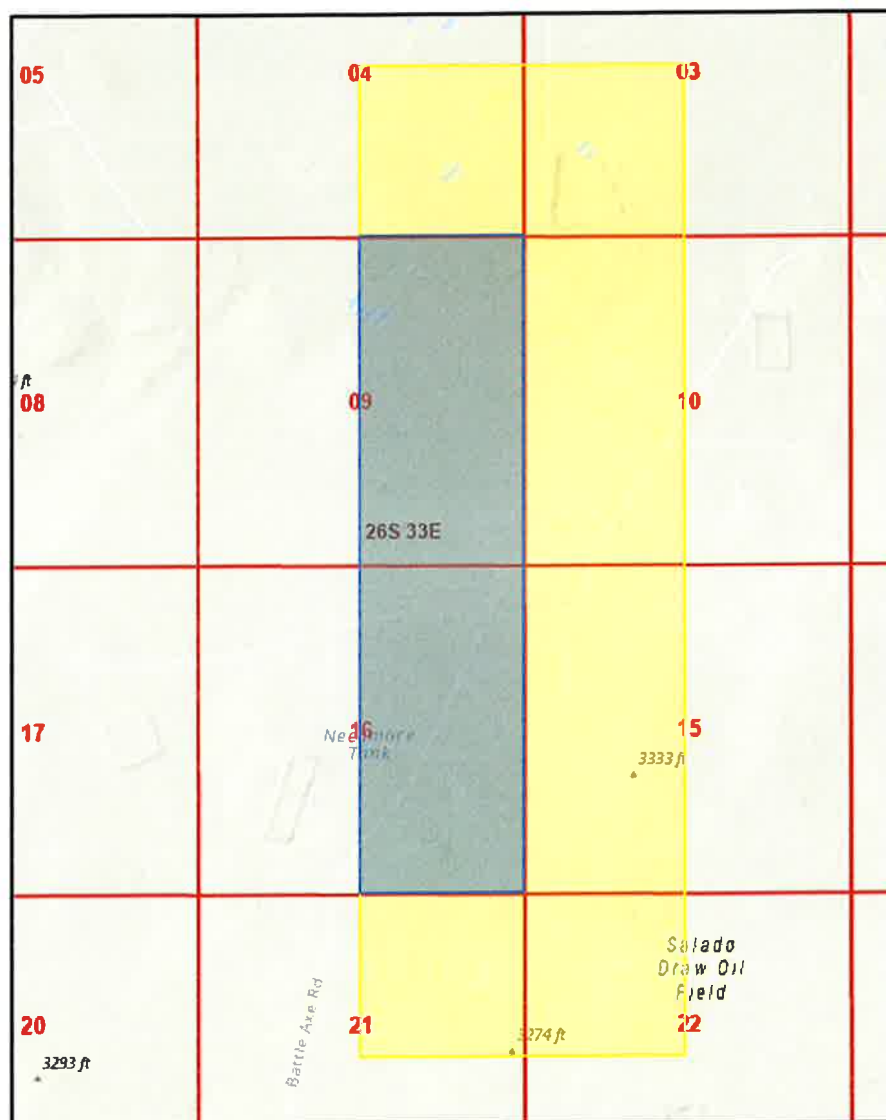
**Affected Tracts****Proration Unit**

District I
1625 N. French Dr., Hobbs, NM 88240
Phone: (575) 393-6161 Fax: (575) 393-0720
District II
811 S. First St., Artesia, NM 88210
Phone: (575) 748-1283 Fax: (575) 748-9720
District III
1000 Rio Brazos Road, Aztec, NM 87410
Phone: (505) 334-6178 Fax: (505) 334-6170
District IV
1220 S. St. Francis Dr., Santa Fe, NM 87505
Phone: (505) 476-3460 Fax: (505) 476-3462

State of New Mexico
Energy, Minerals & Natural Resources Department
OIL CONSERVATION DIVISION
1220 South St. Francis Dr.
Santa Fe, NM 87505

Form C-102
Revised August 1, 2011
Submit one copy to appropriate
District Office

☐ AMENDED REPORT

WELL LOCATION AND ACREAGE DEDICATION PLAT

¹ API Number		² Pool Code 84410		³ Pool Name SALADO DRAW; WOLFCAMP					
⁴ Property Code		⁵ Property Name SALADO DRAW 16/9 W2PA FED COM						⁶ Well Number 1H	
⁷ GRID NO. 14744		⁸ Operator Name MEWBOURNE OIL COMPANY						⁹ Elevation 3294'	
¹⁰ Surface Location									
UL or lot no. 0	Section 16	Township 26S	Range 33E	Lot Idn	Feet from the 290	North/South line SOUTH	Feet From the 1510	East/West line EAST	County LEA
¹¹ Bottom Hole Location If Different From Surface									
UL or lot no. A	Section 9	Township 26S	Range 33E	Lot Idn	Feet from the 100	North/South line NORTH	Feet from the 420	East/West line EAST	County LEA
¹² Dedicated Acres 640		¹³ Joint or Infill		¹⁴ Consolidation Code		¹⁵ Order No.			

No allowable will be assigned to this completion until all interest have been consolidated or a non-standard unit has been approved by the division.

	<p>17 OPERATOR CERTIFICATION</p> <p>I hereby certify that the information contained herein is true and complete to the best of my knowledge and belief, and that this organization either owns a working interest or unleased mineral interest in the land including the proposed bottom hole location or has a right to drill this well at this location pursuant to a contract with an owner of such a mineral or working interest, or to a voluntary pooling agreement or a compulsory pooling order heretofore entered by the division.</p> <p>Signature _____ Date _____</p> <p>Printed Name _____</p> <p>E-mail Address _____</p>
	<p>18 SURVEYOR CERTIFICATION</p> <p>I hereby certify that the well location shown on this plat was plotted from field notes of actual surveys made by me or under my supervision, and that the same is true and correct to the best of my belief.</p> <p>01/26/2023 Date of Survey</p> <p>Signature and Seal of Professional Surveyor _____</p> <p>19680 Certificate Number</p> <p>REV: SL MOVE 03/16/23</p>
	<p>19680 Certificate Number</p> <p>REV: SL MOVE 03/16/23</p>
	<p>Job No: LS23010085R</p>

MEWBOURNE OIL COMPANY

500 West Texas, Suite 1020
Midland, Texas 79701
Phone (432) 682-3715

October 24, 2023

Certified Mail

EOG Resources Inc.
Attn: Brian Pond
5509 Champions Drive
Midland, TX 79706

Re: Mewbourne Oil Company's Applications for Unorthodox Well Locations
Salado Draw 16/9, T26S, R33E, Lea County, New Mexico

Ladies and Gentlemen:

Enclosed please find a copy of the applications filed by Mewbourne Oil Company ("Mewbourne") for approval of unorthodox gas well locations for the below Salado Draw 16/9 wells located at the surface, first take point, last take point, and bottomhole locations described below. The wells will test Salado Draw; Wolfcamp (Gas) Pool and will be dedicated to a standard 640-acre gas spacing and proration unit comprising the E/2 of Section 16 & 9, T26S, R33E, NMPM, Lea County, New Mexico. The unorthodox locations are necessary in order to maximize the recovery of oil and gas reserves within the Wolfcamp formation underlying the E/2 of Section 16 & 9.

Salado Draw 16/9 Fed Com #808H (aka Salado Draw 16/9 W2PA Fed Com #1H)
(API No. Pending)

Surface Location: 290' FSL & 1510' FEL (Unit O – Section 16, T26S, R33E)
First Take Point: 100' FSL & 420' FEL (Section 16, T26S, R33E)
Bottomhole Location: 100' FNL & 420' FEL (Unit A – Section 9, T26S, R33E)
Last Take Point: 100' FNL & 420' FEL (Section 9, T26S, R33E)
Proration Unit: E/2 of Sections 16 & 9, T26S, R33E, NMPM, Lea County, New Mexico
Pool: Pool (84410), Salado Draw; Wolfcamp, (Gas)

Salado Draw 16/9 Fed Com #807H (aka Salado Draw 16/9 W2PA Fed Com #2H)
(API No. Pending)

Surface Location: 290' FSL & 1550' FEL (Unit O – Section 16, T26S, R33E)
First Take Point: 100' FSL & 1310' FEL (Section 16, T26S, R33E)
Bottomhole Location: 100' FNL & 1310' FEL (Unit A – Section 9, T26S, R33E)
Last Take Point: 100' FNL & 1310' FEL (Section 9, T26S, R33E)
Proration Unit: E/2 of Sections 16 & 9, T26S, R33E, NMPM, Lea County, New Mexico
Pool: Pool (84410), Salado Draw; Wolfcamp, (Gas)

Salado Draw 16/9 Fed Com #805H (aka Salado Draw 16/9 W2OB Fed Com #1H)
(API No. Pending)

Surface Location: 290' FSL & 1570' FEL (Unit O – Section 16, T26S, R33E)
First Take Point: 100' FSL & 2200' FEL (Section 16, T26S, R33E)
Bottomhole Location: 100' FNL & 2200' FEL (Unit B – Section 9, T26S, R33E)
Last Take Point: 100' FNL & 2200' FEL (Section 9, T26S, R33E)
Proration Unit: E/2 of Sections 16 & 9, T26S, R33E, NMPM, Lea County, New Mexico
Pool: Pool (84410), Salado Draw; Wolfcamp, (Gas)

As the owner of an interest that may be affected by the proposed unorthodox gas well locations, you are being provided notice as per Division rules and regulations. *Objections must be filed in writing at the Division's Santa Fe office within 20 days from the date this notice was sent to you.* If no objection is received within twenty days after the filing of these applications and proof of notice with the Division, the applications may be approved.

Should you have any questions regarding the above, please email me at arodrigues@mewbourne.com or call at (432) 682-3715.

Very truly yours,

MEWBOURNE OIL COMPANY

Ariana Rodrigues
Landman

Enclosures

MEWBOURNE OIL COMPANY

500 West Texas, Suite 1020
Midland, Texas 79701
Phone (432) 682-3715

October 24, 2023

Certified Mail

Cimarex Energy Co.
Attn: Permian Land Manager
6001 Deauville Blvd., Suite 300N
Midland, TX 79706

Re: Mewbourne Oil Company's Applications for Unorthodox Well Locations
Salado Draw 16/9, T26S, R33E, Lea County, New Mexico

Ladies and Gentlemen:

Enclosed please find a copy of the applications filed by Mewbourne Oil Company ("Mewbourne") for approval of unorthodox gas well locations for the below Salado Draw 16/9 wells located at the surface, first take point, last take point, and bottomhole locations described below. The wells will test Salado Draw; Wolfcamp (Gas) Pool and will be dedicated to a standard 640-acre gas spacing and proration unit comprising the E/2 of Section 16 & 9, T26S, R33E, NMPM, Lea County, New Mexico. The unorthodox locations are necessary in order to maximize the recovery of oil and gas reserves within the Wolfcamp formation underlying the E/2 of Section 16 & 9.

Salado Draw 16/9 Fed Com #808H (aka Salado Draw 16/9 W2PA Fed Com #1H)
(API No. Pending)

Surface Location: 290' FSL & 1510' FEL (Unit O – Section 16, T26S, R33E)
First Take Point: 100' FSL & 420' FEL (Section 16, T26S, R33E)
Bottomhole Location: 100' FNL & 420' FEL (Unit A – Section 9, T26S, R33E)
Last Take Point: 100' FNL & 420' FEL (Section 9, T26S, R33E)
Proration Unit: E/2 of Sections 16 & 9, T26S, R33E, NMPM, Lea County, New Mexico
Pool: Pool (84410), Salado Draw; Wolfcamp, (Gas)

Salado Draw 16/9 Fed Com #807H (aka Salado Draw 16/9 W2PA Fed Com #2H)
(API No. Pending)

Surface Location: 290' FSL & 1550' FEL (Unit O – Section 16, T26S, R33E)
First Take Point: 100' FSL & 1310' FEL (Section 16, T26S, R33E)
Bottomhole Location: 100' FNL & 1310' FEL (Unit A – Section 9, T26S, R33E)
Last Take Point: 100' FNL & 1310' FEL (Section 9, T26S, R33E)
Proration Unit: E/2 of Sections 16 & 9, T26S, R33E, NMPM, Lea County, New Mexico
Pool: Pool (84410), Salado Draw; Wolfcamp, (Gas)

Salado Draw 16/9 Fed Com #805H (aka Salado Draw 16/9 W2OB Fed Com #1H)
(API No. Pending)

Surface Location: 290' FSL & 1570' FEL (Unit O – Section 16, T26S, R33E)
First Take Point: 100' FSL & 2200' FEL (Section 16, T26S, R33E)
Bottomhole Location: 100' FNL & 2200' FEL (Unit B – Section 9, T26S, R33E)
Last Take Point: 100' FNL & 2200' FEL (Section 9, T26S, R33E)
Proration Unit: E/2 of Sections 16 & 9, T26S, R33E, NMPM, Lea County, New Mexico
Pool: Pool (84410), Salado Draw; Wolfcamp, (Gas)

As the owner of an interest that may be affected by the proposed unorthodox gas well locations, you are being provided notice as per Division rules and regulations. *Objections must be filed in writing at the Division's Santa Fe office within 20 days from the date this notice was sent to you.* If no objection is received within twenty days after the filing of these applications and proof of notice with the Division, the applications may be approved.

Should you have any questions regarding the above, please email me at arodrigues@mewbourne.com or call at (432) 682-3715.

Very truly yours,

MEWBOURNE OIL COMPANY

Ariana Rodrigues
Landman

Enclosures

MEWBOURNE OIL COMPANY

500 West Texas, Suite 1020
Midland, Texas 79701
Phone (432) 682-3715

October 24, 2023

Certified Mail

COG Operating LLC
Attn: Permian (Lea County) Land Manager
600 W Illinois Ave
Midland, TX 79701

Re: Mewbourne Oil Company's Application for Unorthodox Well Location
Salado Draw 16/9, T26S, R33E, Lea County, New Mexico

Ladies and Gentlemen:

Enclosed please find a copy of the application filed by Mewbourne Oil Company ("Mewbourne") for approval of unorthodox gas well location for the below Salado Draw 16/9 well located at the surface, first take point, last take point, and bottomhole locations described below. The well will test Salado Draw; Wolfcamp (Gas) Pool and will be dedicated to a standard 640-acre gas spacing and proration unit comprising the E/2 of Section 16 & 9, T26S, R33E, NMPM, Lea County, New Mexico. The unorthodox location is necessary in order to maximize the recovery of oil and gas reserves within the Wolfcamp formation underlying the E/2 of Section 16 & 9.

Salado Draw 16/9 Fed Com #808H (aka Salado Draw 16/9 W2PA Fed Com #1H)
(API No. Pending)

Surface Location:	290' FSL & 1510' FEL (Unit O – Section 16, T26S, R33E)
First Take Point:	100' FSL & 420' FEL (Section 16, T26S, R33E)
Bottomhole Location:	100' FNL & 420' FEL (Unit A – Section 9, T26S, R33E)
Last Take Point:	100' FNL & 420' FEL (Section 9, T26S, R33E)
Proration Unit:	E/2 of Sections 16 & 9, T26S, R33E, NMPM, Lea County, New Mexico
Pool:	Pool (84410), Salado Draw; Wolfcamp, (Gas)

As the owner of an interest that may be affected by the proposed unorthodox gas well location, you are being provided notice as per Division rules and regulations. *Objections must be filed in writing at the Division's Santa Fe office within 20 days from the date this notice was sent to you.* If no objection is received within twenty days after the filing of this application and proof of notice with the Division, the application may be approved.

Should you have any questions regarding the above, please email me at arodrigues@mewbourne.com or call at (432) 682-3715.

Very truly yours,

MEWBOURNE OIL COMPANY

Ariana Rodrigues
Landman

Enclosures

MEWBOURNE OIL COMPANY

500 West Texas, Suite 1020
Midland, Texas 79701
Phone (432) 682-3715

October 24, 2023

Certified Mail

Walsh & Watts Inc.
Attn: Permian Land Manager
1111 7th St
Wichita Falls, TX 76301

Re: Mewbourne Oil Company's Application for Unorthodox Well Location
Salado Draw 16/9, T26S, R33E, Lea County, New Mexico

Ladies and Gentlemen:

Enclosed please find a copy of the application filed by Mewbourne Oil Company ("Mewbourne") for approval of unorthodox gas well location for the below Salado Draw 16/9 well located at the surface, first take point, last take point, and bottomhole locations described below. The well will test Salado Draw; Wolfcamp (Gas) Pool and will be dedicated to a standard 640-acre gas spacing and proration unit comprising the E/2 of Section 16 & 9, T26S, R33E, NMPM, Lea County, New Mexico. The unorthodox formation is necessary in order to maximize the recovery of oil and gas reserves within the Wolfcamp formation underlying the E/2 of Section 16 & 9.

Salado Draw 16/9 Fed Com #808H (aka Salado Draw 16/9 W2PA Fed Com #1H)
(API No. Pending)

Surface Location:	290' FSL & 1510' FEL (Unit O – Section 16, T26S, R33E)
First Take Point:	100' FSL & 420' FEL (Section 16, T26S, R33E)
Bottomhole Location:	100' FNL & 420' FEL (Unit A – Section 9, T26S, R33E)
Last Take Point:	100' FNL & 420' FEL (Section 9, T26S, R33E)
Proration Unit:	E/2 of Sections 16 & 9, T26S, R33E, NMPM, Lea County, New Mexico
Pool:	Pool (84410), Salado Draw; Wolfcamp, (Gas)

As the owner of an interest that may be affected by the proposed unorthodox gas well location, you are being provided notice as per Division rules and regulations. *Objections must be filed in writing at the Division's Santa Fe office within 20 days from the date this notice was sent to you.* If no objection is received within twenty days after the filing of this application and proof of notice with the Division, the application may be approved.

Should you have any questions regarding the above, please email me at arodrigues@mewbourne.com or call at (432) 682-3715.

Very truly yours,

MEWBOURNE OIL COMPANY

Ariana Rodrigues
Landman

Enclosures

Notice List for Non-Standard Location Application
Salado Draw 16/9 Fed Com 808H (aka Salado Draw 16/9 W2PA Fed Com 1H)
Lea County, New Mexico

Certified Tracking Number	Owners	Attn	Address Line 1	City	State	Zip Code
9414 8361 0544 0541 0001 51	EOG Resources Inc.	Attn: Brian Pond	5509 Champions Drive	Midland	TX	79706
9414 8361 0544 0541 0698 20	Cimarex Energy Co.	Attn: Permian Land Manager	6001 Deauville Blvd., Suite 300N	Midland	TX	79706
9414 8361 0544 0542 9156 21	COG Operating LLC	Attn: Permian (Lea County) Land	600 W Illinois Ave	Midland	TX	79701
9414 8361 0544 0542 9247 39	Walsh & Watts Inc.	Attn: Permian Land Manager	1111 7th St	Wichita Falls	TX	76301

District I
1625 N. French Dr., Hobbs, NM 88240
Phone:(575) 393-6161 Fax:(575) 393-0720
District II
811 S. First St., Artesia, NM 88210
Phone:(575) 748-1283 Fax:(575) 748-9720
District III
1000 Rio Brazos Rd., Aztec, NM 87410
Phone:(505) 334-6178 Fax:(505) 334-6170
District IV
1220 S. St Francis Dr., Santa Fe, NM 87505
Phone:(505) 476-3470 Fax:(505) 476-3462

State of New Mexico
Energy, Minerals and Natural Resources
Oil Conservation Division
1220 S. St Francis Dr.
Santa Fe, NM 87505

CONDITIONS

Action 278959

CONDITIONS

Operator: MEWBOURNE OIL CO P.O. Box 5270 Hobbs, NM 88241	OGRID: 14744
	Action Number: 278959
	Action Type: [UF-NSL] Non-Standard Location (NSL)

CONDITIONS

Created By	Condition	Condition Date
llowe	None	10/25/2023