

Office
 District I – (575) 393-6161
 1625 N. French Dr., Hobbs, NM 88240
 District II – (575) 748-1283
 811 S. First St., Artesia, NM 88210
 District III – (505) 334-6178
 1000 Rio Brazos Rd., Aztec, NM 87410
 District IV – (505) 476-3460
 1220 S. St. Francis Dr., Santa Fe, NM
 87505

State of New Mexico
 Energy, Minerals and Natural Resources

OIL CONSERVATION DIVISION
 1220 South St. Francis Dr.
 Santa Fe, NM 87505

DHC-5415

Form C-103
 Revised July 18, 2013

SUNDRY NOTICES AND REPORTS ON WELLS (DO NOT USE THIS FORM FOR PROPOSALS TO DRILL OR TO DEEPEN OR PLUG BACK TO A DIFFERENT RESERVOIR. USE "APPLICATION FOR PERMIT" (FORM C-101) FOR SUCH PROPOSALS.)		WELL API NO. 30-039-22709
1. Type of Well: Oil Well <input type="checkbox"/> Gas Well <input checked="" type="checkbox"/> Other		5. Indicate Type of Lease STATE <input type="checkbox"/> FEE <input type="checkbox"/>
2. Name of Operator Hilcorp Energy Company		6. State Oil & Gas Lease No. FEDERAL: NMSF078738
3. Address of Operator 382 Road 3100, Aztec NM 87410		7. Lease Name or Unit Agreement Name San Juan 30-5 Unit
4. Well Location Unit Letter L: 1850 feet from the South line and 790 feet from the West line Section 27 Township 30N Range 05W NMPM County Rio Arriba		8. Well Number 81
11. Elevation (Show whether DR, RKB, RT, GR, etc.) 6539' GR		9. OGRID Number 372171
10. Pool name or Wildcat Blanco Mesaverde		

12. Check Appropriate Box to Indicate Nature of Notice, Report or Other Data

NOTICE OF INTENTION TO:		SUBSEQUENT REPORT OF:	
PERFORM REMEDIAL WORK <input type="checkbox"/>	PLUG AND ABANDON <input type="checkbox"/>	REMEDIAL WORK <input type="checkbox"/>	ALTERING CASING <input type="checkbox"/>
TEMPORARILY ABANDON <input type="checkbox"/>	CHANGE PLANS <input type="checkbox"/>	COMMENCE DRILLING OPNS. <input type="checkbox"/>	P AND A <input type="checkbox"/>
PULL OR ALTER CASING <input type="checkbox"/>	MULTIPLE COMPL <input type="checkbox"/>	CASING/CEMENT JOB <input type="checkbox"/>	
DOWNHOLE COMMINGLE <input checked="" type="checkbox"/>		OTHER: <input type="checkbox"/>	
CLOSED-LOOP SYSTEM <input type="checkbox"/>			
OTHER: <input type="checkbox"/>			

13. Describe proposed or completed operations. (Clearly state all pertinent details, and give pertinent dates, including estimated date of starting any proposed work). SEE RULE 19.15.7.14 NMAC. For Multiple Completions: Attach wellbore diagram of proposed completion or recompletion.

It is intended to recomplete the subject well in the Blanco Mesaverde (pool 72319) and downhole commingle the existing Basin Dakota (pool 71599) with the Mesaverde. The production will be commingled per Oil Conservation Division Order Number 11363. See the attached allocation methodology. Commingling will not reduce the value of the production. The Bureau of Land Management has been notified in writing of this application.

Proposed perforations are: MV - 5109' – 6081'; DK - 7835' - 7898' **These perforations are in TVD.**

As referenced in Order # R- 10771 interest owners were not re-notified.

Spud Date: Rig Release Date:

I hereby certify that the information above is true and complete to the best of my knowledge and belief.

SIGNATURE  TITLE Operations/Regulatory Technician Sr. DATE 6/11/2024

Type or print name Amanda Walker E-mail address: mwalker@hilcorp.com PHONE: 346-237-2177

For State Use Only

APPROVED BY:  TITLE Petroleum Engineer DATE 07/16/2024

Conditions of Approval (if any):

CONDITIONS OF APPROVAL

If an alteration is made to the Well or a condition within the Well changes which may cause the allocation of production to the Pools as approved within this Permit to become inaccurate, then no later than sixty (60) days after that event, the Operator shall submit Form C-103 to the OCD Engineering Bureau describing the event and include a revised allocation plan. If OCD denies the revised allocation plan, this Permit shall terminate on the date of such action.

If the downhole commingling of the Pools reduces the value of the oil and gas production to less than if it had remained segregated, no later than sixty (60) days after the decrease in value has occurred the Operator shall submit a new downhole commingling application to OCD to amend this Permit to remove the pool that caused the decrease in value. If the Operator fails to submit a new application, this Permit shall terminate on the following day, and if OCD denies the application, this Permit shall terminate on the date of such action.

If a completed interval of the Well is altered from what is submitted within this application, then no later than sixty (60) days after the alteration, the Operator shall submit Form C-103 to the OCD Engineering Bureau detailing the alteration and completed interval.

The Operator shall calculate the oil and gas production average during the fourth year after the commencement of commingling, which shall be used to establish a fixed percentage of the total oil and gas production that shall be allocated to each of the Pools ("fixed percentage allocation plan"). No later than ninety (90) days after the fourth year, the Operator shall submit a Form C-103 to the OCD Engineering Bureau that includes the fixed percentage allocation plan and all data used to determine it. If the Operator fails to do so, this Permit shall terminate on the following day. If OCD denies the fixed percentage allocation plan, this Permit shall terminate on the date of such action. If OCD approves the percentage allocation plan with or without modifications, then the approved percentage allocation plan shall be used to determine oil and gas allocation starting on the date of such action until the Well is plugged and abandoned.

OIL CONSERVATION DIVISION

P. O. BOX 2088

SANTA FE, NEW MEXICO 87501

Form C-107
Revised 10-1-72

DEPARTMENT

All distances must be from the corner boundaries of the Section.

LEASEE NORTHWEST PIPELINE CORPORATION		LEASE SAN JUAN 30-5 UNIT		WELL NO. 81
SECTION 27	TOWNSHIP 30N	RANGE 5W	COUNTY Rio Arriba	
LOCATION OF WELL				
1850	feet from the South line and	790	feet from the West line	
6537	Producing Formation Dakota	Pool Basin Dakota	Dedicated Acreage 320	Acres

1. Outline the acreage dedicated to the subject well by colored pencil or hatchure marks on the plat below.
2. If more than one lease is dedicated to the well, outline each and identify the ownership thereof (both as to working interest and royalty).
3. If more than one lease of different ownership is dedicated to the well, have the interests of all owners been consolidated by communitization, unitization, force-pooling, etc?

☒ Yes ☐ No If answer is "yes," type of consolidation Unitization

If answer is "no," list the owners and tract descriptions which have actually been consolidated. (Use reverse side of this form if necessary.)

No allowable will be assigned to the well until all interests have been consolidated (by communitization, unitization, forced-pooling, or otherwise) or until a non-standard unit, eliminating such interests, has been approved by the Commission.

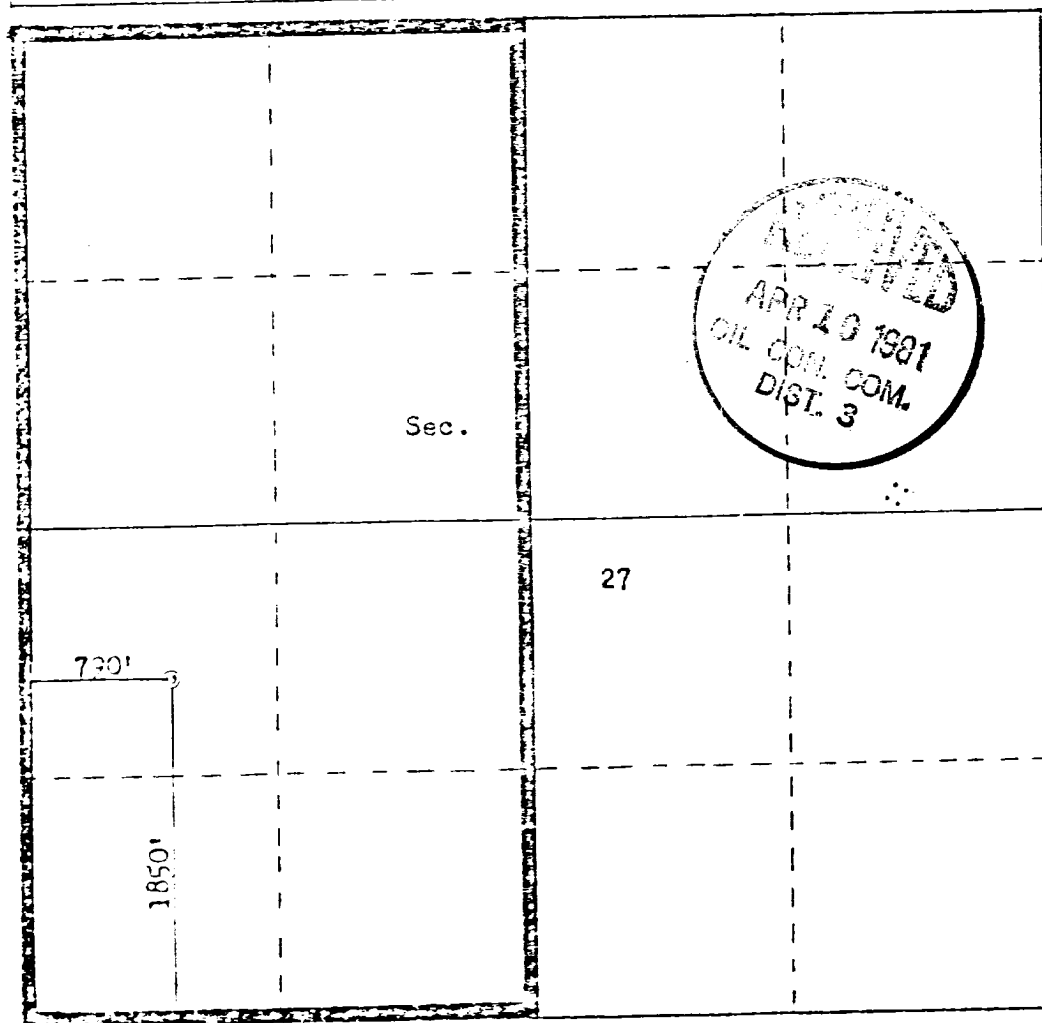

Scale: 1"=1000'

CERTIFICATION

I hereby certify that the information contained herein is true and complete to the best of my knowledge and belief.

Paul C. Thompson

Name

Paul C. Thompson

Position

Drilling Engineer

Company

Northwest Pipeline Corp

Date

February 23, 1981

I hereby certify that the well location shown on this plat was plotted from field notes of actual surveys made by me or under my supervision, and that the same is true and correct to the best of my knowledge and belief.

Date surveyed

February 19, 1981

Registered Professional Engineer
and Licensed Surveyor

Fred B. Kerr Jr.
Fred B. Kerr Jr.

Certificate No.

3950

1625 N. French Dr., Hobbs, NM 88240
Phone:(575) 393-6161 Fax:(575) 393-0720

811 S. First St., Artesia, NM 88210
Phone:(575) 748-1283 Fax:(575) 748-9720

1000 Rio Brazos Rd., Aztec, NM 87410
Phone:(505) 334-6178 Fax:(505) 334-6170

1220 S. St Francis Dr., Santa Fe, NM 87505
Phone:(505) 476-3470 Fax:(505) 476-3462

Form C-102
August 1, 2011

Permit 365798

**State of New Mexico
Energy, Minerals and Natural
Resources
Oil Conservation Division
1220 S. St Francis Dr.
Santa Fe, NM 87505**

WELL LOCATION AND ACREAGE DEDICATION PLAT

1. API Number 30-039-22709	2. Pool Code 72319	3. Pool Name BLANCO-MESAVERDE (PRORATED GAS)
4. Property Code 318433	5. Property Name SAN JUAN 30 5 UNIT	6. Well No. 081
7. OGRID No. 372171	8. Operator Name HILCORP ENERGY COMPANY	9. Elevation 6539

10. Surface Location

UL - Lot	L	Section 27	Township 30N	Range 05W	Lot Idn	Feet From 1850	N/S Line S	Feet From 790	E/W Line W	County RIO ARRIBA
----------	---	---------------	-----------------	--------------	---------	-------------------	---------------	------------------	---------------	-------------------------

11. Bottom Hole Location If Different From Surface

UL - Lot	Section	Township	Range	Lot Idn	Feet From	N/S Line	Feet From	E/W Line	County
12. Dedicated Acres 320.00			13. Joint or Infill		14. Consolidation Code			15. Order No. R-10987-A(6)	

NO ALLOWABLE WILL BE ASSIGNED TO THIS COMPLETION UNTIL ALL INTERESTS HAVE BEEN CONSOLIDATED OR A NON-STANDARD UNIT HAS BEEN APPROVED BY THE DIVISION

			
---	--	--	--

OPERATOR CERTIFICATION

I hereby certify that the information contained herein is true and complete to the best of my knowledge and belief, and that this organization either owns a working interest or unleased mineral interest in the land including the proposed bottom hole location(s) or has a right to drill this well at this location pursuant to a contract with an owner of such a mineral or working interest, or to a voluntary pooling agreement or a compulsory pooling order heretofore entered by the division.

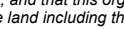
E-Signed By: 

Title: Operations Regulatory Tech Sr.

Date: 5/21/2024

SURVEYOR CERTIFICATION

I hereby certify that the well location shown on this plat was plotted from field notes of actual surveys made by me or under my supervision, and that the same is true and correct to the best of my belief.

Surveyed By: Fred B Kerr Jr
 Date of Survey: 2/19/1981
 Certificate Number: 3950

San Juan 30-5 Unit 081 Subtraction Allocation	3003922709
---	------------

Gas Allocation:

Production for the downhole commingle will be allocated using the subtraction method in agreement with local agencies. The base formation is the **Dakota** and the added formation to be commingled is the **Mesaverde**. The subtraction method applies an average monthly production forecast to the base formation using historic production. All production from this well exceeding the forecast will be allocated to the new formation.

After 3 years production will stabilize. A production average will be gathered during the 4th year and will be utilized to create a fixed percentage based allocation.

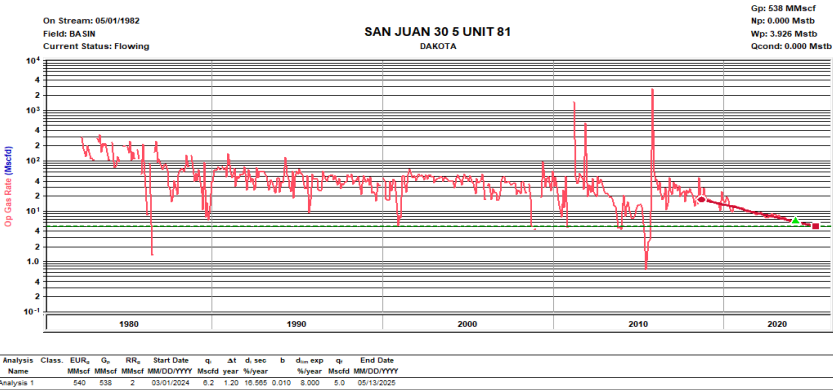

Oil Allocation:

Oil production will be allocated based on average formation yields from offset wells and will be a fixed rate for 4 years. The Dakota formation has historically never produced oil. If the well produces and oil, it will be allocated 100% to the Mesaverde formation.

After 4 years oil will be reevaluated and adjusted as needed based on average formation yields and new fixed gas allocation.

Formation	Yield (bbl/MM)	Remaining Reserves (MMcf)	% Oil Allocation
DK	0	2	#DIV/0!
MV	0	849	#DIV/0!

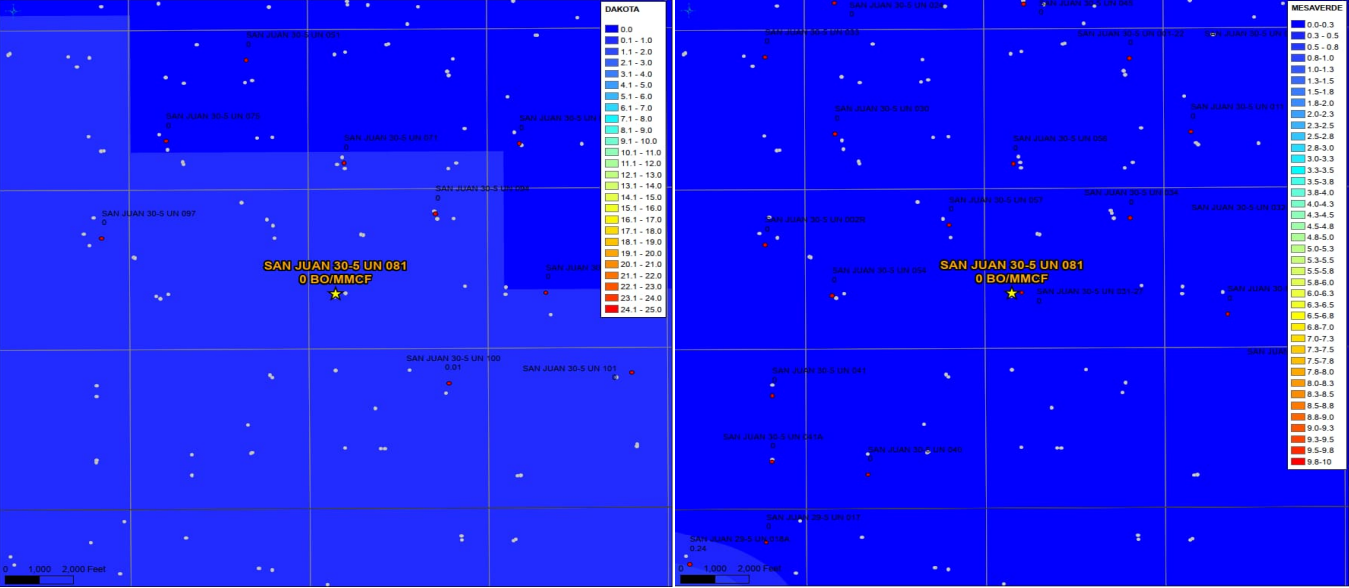

District I

1625 N. French Dr., Hobbs, NM 88240
Phone:(575) 393-6161 Fax:(575) 393-0720

District II

811 S. First St., Artesia, NM 88210
Phone:(575) 748-1283 Fax:(575) 748-9720

District III

1000 Rio Brazos Rd., Aztec, NM 87410
Phone:(505) 334-6178 Fax:(505) 334-6170

District IV

1220 S. St Francis Dr., Santa Fe, NM 87505
Phone:(505) 476-3470 Fax:(505) 476-3462

State of New Mexico
Energy, Minerals and Natural Resources
Oil Conservation Division
1220 S. St Francis Dr.
Santa Fe, NM 87505

CONDITIONS

Action 353034

CONDITIONS

Operator: HILCORP ENERGY COMPANY 1111 Travis Street Houston, TX 77002	OGRID: 372171
	Action Number: 353034
	Action Type: [C-107] Down Hole Commingle (C-107A)

CONDITIONS

Created By	Condition	Condition Date
dmcclure	If an alteration is made to the Well or a condition within the Well changes which may cause the allocation of production to the Pools as approved within this Permit to become inaccurate, then no later than sixty (60) days after that event, the Operator shall submit Form C-103 to the OCD Engineering Bureau describing the event and include a revised allocation plan. If OCD denies the revised allocation plan, this Permit shall terminate on the date of such action.	7/16/2024
dmcclure	If the downhole commingling of the Pools reduces the value of the oil and gas production to less than if it had remained segregated, no later than sixty (60) days after the decrease in value has occurred the Operator shall submit a new downhole commingling application to OCD to amend this Permit to remove the pool that caused the decrease in value. If the Operator fails to submit a new application, this Permit shall terminate on the following day, and if OCD denies the application, this Permit shall terminate on the date of such action.	7/16/2024
dmcclure	If a completed interval of the Well is altered from what is submitted within this application, then no later than sixty (60) days after the alteration, the Operator shall submit Form C-103 to the OCD Engineering Bureau detailing the alteration and completed interval.	7/16/2024
dmcclure	The Operator shall calculate the oil and gas production average during the fourth year after the commencement of commingling, which shall be used to establish a fixed percentage of the total oil and gas production that shall be allocated to each of the Pools ("fixed percentage allocation plan"). No later than ninety (90) days after the fourth year, the Operator shall submit a Form C-103 to the OCD Engineering Bureau that includes the fixed percentage allocation plan and all data used to determine it. If the Operator fails to do so, this Permit shall terminate on the following day. If OCD denies the fixed percentage allocation plan, this Permit shall terminate on the date of such action. If OCD approves the percentage allocation plan with or without modifications, then the approved percentage allocation plan shall be used to determine oil and gas allocation starting on the date of such action until the Well is plugged and abandoned.	7/16/2024