

State of New Mexico  
Energy, Minerals and Natural Resources Department

**Michelle Lujan Grisham**  
Governor

**Melanie A. Kenderdine**  
Cabinet Secretary

**Ben Shelton**  
Deputy Secretary

**Erin Taylor**  
Deputy Secretary

**Albert C.S. Chang**  
Division Director  
Oil Conservation Division



Jaclyn M. McLean  
[jmclean@hardymclean.com](mailto:jmclean@hardymclean.com)

**ADMINISTRATIVE NON-STANDARD LOCATION**

**Administrative Order NSL – 9103**

**Permian Resources Operating, LLC [OGRID 372165]  
Taipan 21 Federal Com Well No. 204H  
API No. 30-015-PENDING**

Reference is made to your application received on August 29<sup>th</sup>, 2025.

**Proposed Location**

	<b>Footages</b>	<b>Unit/Lot</b>	<b>Sec.</b>	<b>Twsp</b>	<b>Range</b>	<b>County</b>
Surface	1438 FSL & 326 FEL	I	20	20S	28E	Eddy
First Take Point	990 FSL & 100 FWL	M	21	20S	28E	Eddy
Last Take Point	990 FSL & 100 FEL	P	22	20S	28E	Eddy
Terminus	990 FSL & 10 FEL	P	22	20S	28E	Eddy

**Proposed Horizontal Units**

<b>Description</b>	<b>Acres</b>	<b>Pool</b>	<b>Pool Code</b>
S/2 S/2 Section 21	320	Burton Flat; Wolfcamp, North (GAS)	73520
S/2 S/2 Section 22			

You have requested to drill this horizontal well at an unorthodox well location described above in the referenced pool or formation. 19.15.16.15(B)(3)(a) NMAC governs this proposed well and provides that the operator shall dedicate to each horizontal **gas** well a standard horizontal spacing unit that comprises of one or more contiguous tracts that the horizontal well's completed interval penetrates, each of which consists of a governmental quarter section or equivalent. 19.15.16.15(C)(1)(a) NMAC governs the distance in the horizontal plane from any point in the

Administrative Order NSL - 9103  
Permian Resources Operating, LLC  
Page 2 of 2

completed interval to any outer boundary of the horizontal spacing unit, measured along a line perpendicular to the completed interval or to the tangent thereof, shall be a minimum of 660 feet for a **gas** well. 19.15.16.15(C)(1)(b) NMAC governs the first and last take point of a horizontal well shall be no closer than 330 feet for a **gas** in the horizontal plane, to any outer boundary of the horizontal spacing unit.

The request to deviate from an orthodox location has met all requirements of 19.15.16.15 (C)(5)(a) NMAC. It is understood that you are seeking this exception in order to create a non-standard location, comprised of First and Last Take Points referenced above within the described Horizontal Spacing Unit.

This well's completed interval is as close as 100 feet toward the western and eastern edge of the horizontal spacing unit. Encroachment will impact the following tracts.

Section 20, encroachment to the E/2 SE/4  
Section 23, encroachment to the W/2 SW/4

The Division understands you have given notice of this application to all operators or owners who are "affected persons," as defined in 19.15.2.7(A)(8) NMAC, in all adjoining units towards which the proposed location encroaches.

Division understands you are seeking this unorthodox location for optimal spacing to obtain maximum lateral length, to properly place stimulation energy, and to optimize pressure draw down within the Wolfcamp formation underlying the S/2 S/2 Section 21 and the S/2 S/2 of Section 22. Thereby preventing waste and protecting correlative rights.

Your application has been filed under 19.15.16.15(C)(6) NMAC, 19.15.15.13 NMAC and 19.15.4.12 (A)(2) NMAC.

Per 19.15.15.13 (B) NMAC, **Division approves this unorthodox location.**

Reference this NSL order number on the As Drilled C-102 submitted with the Authorization to Transport, to place this well into production.

The above approvals are subject to your following all other applicable Division rules.

Jurisdiction of this case is retained for the entry of further orders as Division deems necessary.



**Albert C.S. Chang**  
Division Director  
AC/lrl

Date: 11/26/2025

Revised March 23, 2017

ID NO. 500516

NSL - 9103

RECEIVED: <b>08/29/25</b>	REVIEWER:	TYPE:	APP NO:
---------------------------	-----------	-------	---------

ABOVE THIS TABLE FOR OCD DIVISION USE ONLY

**NEW MEXICO OIL CONSERVATION DIVISION**  
 - Geological & Engineering Bureau -  
 1220 South St. Francis Drive, Santa Fe, NM 87505

**ADMINISTRATIVE APPLICATION CHECKLIST**

THIS CHECKLIST IS MANDATORY FOR ALL ADMINISTRATIVE APPLICATIONS FOR EXCEPTIONS TO DIVISION RULES AND  
 REGULATIONS WHICH REQUIRE PROCESSING AT THE DIVISION LEVEL IN SANTA FE

**Applicant:** Permian Resources Operating, LLC **OGRID Number:** 372165  
**Well Name:** Taipan 21 Fed Com 204H **API:** 30-015-pending  
**Pool:** Burton Flat, Wolfcamp, North (GAS) **Pool Code:** 73520

**SUBMIT ACCURATE AND COMPLETE INFORMATION REQUIRED TO PROCESS THE TYPE OF APPLICATION  
 INDICATED BELOW**

**1) TYPE OF APPLICATION:** Check those which apply for [A]

A. Location – Spacing Unit – Simultaneous Dedication

☒ NSL☐ NSP (PROJECT AREA)☐ NSP (PRORATION UNIT)☐ SD

B. Check one only for [ I ] or [ II ]

[ I ] Commingling – Storage – Measurement

☐ DHC☐ CTB☐ PLC☐ PC☐ OLS☐ OLM

[ II ] Injection – Disposal – Pressure Increase – Enhanced Oil Recovery

☐ WFX☐ PMX☐ SWD☐ IPI☐ EOR☐ PPR**2) NOTIFICATION REQUIRED TO:** Check those which apply.A. ☒ Offset operators or lease holdersB. ☒ Royalty, overriding royalty owners, revenue ownersC. ☐ Application requires published noticeD. ☒ Notification and/or concurrent approval by SLOE. ☒ Notification and/or concurrent approval by BLMF. ☒ Surface ownerG. ☐ For all of the above, proof of notification or publication is attached, and/or,H. ☐ No notice required**FOR OCD ONLY**☐ Notice Complete☐ Application  
Content  
Complete

**3) CERTIFICATION:** I hereby certify that the information submitted with this application for  
 administrative approval is **accurate** and **complete** to the best of my knowledge. I also  
 understand that **no action** will be taken on this application until the required information and  
 notifications are submitted to the Division.

**Note: Statement must be completed by an individual with managerial and/or supervisory capacity.**

August 29, 2025

Date

Jaclyn M. McLean

Print or Type Name

505-372-6375

Phone Number

Jaclyn M. McLean

Signature

Digitally signed by Jaclyn M. McLean  
 Date: 2025.08.29 05:43:47 -06'00'

jmclean@hardymclean.com

e-mail Address



August 28, 2025

**VIA ONLINE FILING**

Albert Chang  
Division Director  
Oil Conservation Division  
Energy, Minerals and Natural Resources Department  
1220 South Saint Francis Drive  
Santa Fe, New Mexico 87505

**Re: Permian Resources Operating, LLC  
Request for Administrative Approval of Unorthodox Well Location**

Taipan 21 Fed Com 204H  
S/2 S/2 of Sections 21 and 22, Township 20 South, Range 28 East, Eddy County, New Mexico.  
Burton Flat, Wolfcamp, North (Gas) Pool (Code 73520)

Dear Mr. Chang,

In accordance with Division Rules 19.15.16.15(C)(6) and 19.15.15.13 NMAC, Permian Resources Operating, LLC ("Permian Resources") (OGRID No. 372165) seeks administrative approval of an unorthodox well location for the Taipan 21 Fed Com 204H well, in a 320-acre, more or less, non-standard horizontal spacing unit, comprised of the S/2 S/2 of Sections 21 and 22, Township 20 South, Range 28 East, Eddy County, New Mexico.

The location for the **Taipan 21 Fed Com 204H** well is as follows:

- Surface Hole Location: 1,438' FSL and 326' FEL, Section 20, Township 20 South, Range 28 East
- First Take Point: 990' FSL and 100' FWL, Section 21, Township 20 South, Range 28 East
- Last Take Point: 990' FSL and 100' FEL, Section 22, Township 20 South, Range 28 East
- Bottom Hole Location: 990' FSL and 10' FEL, Section 22, Township 20 South, Range 28 East

---

125 Lincoln Avenue, Suite 223  
Santa Fe, NM 87501  
505-230-4410

HardyMcClean.com

**Writer:**  
Jaclyn M. McLean  
Managing Partner  
jmclean@hardymcClean.com

Hardy McLean LLC  
August 28, 2025

Page 2

The completed interval of the well will be unorthodox because it is located less than 330' from the eastern, northern, and western boundaries of the offsetting spacing unit. As explained in the engineering statement, included as **Exhibit A**, approval of the unorthodox, completed interval is necessary to allow Permian Resources to optimize well spacing and improve overall productivity of the wells. This will prevent waste and protect correlative rights.

**Exhibit B** is a Form C-102 showing the location of the Taipan 21 Fed Com 204H well in relation to the offset tracts.

**Exhibit C** is a plat for Sections 14, 15, 16, 17, 20, 21, 22, and 23 of Township 20 South, Range 28 East, Eddy County, that shows the Taipan 21 Fed Com 204H well in relation to the adjoining tracts. Permian Resources is the offset operator of all adjoining tracts and spacing units. For this reason, Permian Resources provided notice to interest owners set out in Exhibit D.

**Exhibit D** is a list that identifies all affected persons who were sent a copy of this application and attachments by certified mail advising that any objections must be filed in writing with the Division within 20 days from the date the Division receives the application, along with the date notice was sent, and a copy of the notice letter to affected persons.

Thank you for your attention to this matter. Please let me know if you require additional information.

Very truly yours,

HARDY MCLEAN LLC

/s/ Jaclyn M. McLean  
Jaclyn M. McLean

ATTORNEYS FOR PERMIAN RESOURCES  
OPERATING, LLC



300 N. MARIENFELD STREET, SUITE 1000  
MIDLAND, TX 79701

OFFICE 432.695.4222  
FAX 432.695.4063

4/10/2025

**Re: Taipan 21 Fed Com #204H**  
**SHL:** 1,438' FSL, 326' FEL of Section 20, T20S-R28E  
**FTP:** 990' FSL, 100' FWL of Section 21, T20S-R28E  
**LTP:** 990' FSL, 100' FEL of Section 22, T20S-R28E  
**BHL:** 990' FSL, 10' FEL of Section 22, T20S-R28E  
Eddy County, New Mexico

To Whom It May Concern,

Permian Resources Operating, LLC ("Permian") respectfully requests administrative approval of a non-standard location for the Taipan 21 Fed Com #204H ("Well"). The Well's first and last take points will be unorthodox because it is being drilled from a First Take Point 100' from the west line to a Last Take Point 100' from the east line of the spacing unit. Further, the Well will be located 330' from the northern boundary of the spacing unit. Due to the optimal spacing of the planned wells in this section, Permian has planned the Well at this location 100' from the east and west lines, and 330' from the north line, to obtain maximum lateral length, properly place stimulation energy, and optimize pressure drawdown, which will create cost efficiencies, prevent waste, and protect correlative rights. Therefore, Permian respectfully requests approval of this non-standard location.

Sincerely,

A handwritten signature in black ink, appearing to read "S Hamilton", written over a horizontal line.

**Sam Hamilton**  
Reservoir Engineer  
Permian Resources Operating, LLC

**EXHIBIT A**

<u>C-102</u>  Submit Electronically Via OCD Permitting	State of New Mexico Energy, Minerals & Natural Resources Department OIL CONSERVATION DIVISION	Revised July 9, 2024	
		Submittal Type:	<input type="checkbox"/> Initial Submittal
			<input checked="" type="checkbox"/> Amended Report
		<input type="checkbox"/> As Drilled	

WELL LOCATION INFORMATION

API Number	Pool Code 73520	Pool Name Burton Flat, Wolfcamp, North (gas)
Property Code	Property Name TAIPAN 21 FED COM	Well Number 204H
OGRID No. 372165	Operator Name PERMIAN RESOURCES OPERATING, LLC	Ground Level Elevation 3233.58'
Surface Owner: <input type="checkbox"/> State <input checked="" type="checkbox"/> Fee <input type="checkbox"/> Tribal <input type="checkbox"/> Federal		Mineral Owner: <input checked="" type="checkbox"/> State <input type="checkbox"/> Fee <input type="checkbox"/> Tribal <input checked="" type="checkbox"/> Federal

Surface Location

UL	Section	Township	Range	Lot	Ft. from N/S	Ft. from E/W	Latitude	Longitude	County
I	20	20-S	28-E		1438' S	326' E	32.55570	-104.19251	EDDY

Bottom Hole Location

UL	Section	Township	Range	Lot	Ft. from N/S	Ft. from E/W	Latitude	Longitude	County
P	22	20-S	28-E		990' S	10' E	32.55455	-104.15701	EDDY

Dedicated Acres 320	Infill or Defining Well Defining	Defining Well API TBD	Overlapping Spacing Unit (Y/N) N	Consolidation Code TBD
Order Numbers. TBD			Well setbacks are under Common Ownership: <input checked="" type="checkbox"/> Yes <input type="checkbox"/> No	

Kick Off Point (KOP)

UL	Section	Township	Range	Lot	Ft. from N/S	Ft. from E/W	Latitude	Longitude	County
I	20	20-S	28-E		1438' S	326' E	32.55570	-104.19251	EDDY

First Take Point (FTP)

UL	Section	Township	Range	Lot	Ft. from N/S	Ft. from E/W	Latitude	Longitude	County
M	21	20-S	28-E		990' S	100' W	32.55447	-104.19113	EDDY

Last Take Point (LTP)

UL	Section	Township	Range	Lot	Ft. from N/S	Ft. from E/W	Latitude	Longitude	County
P	22	20-S	28-E		990' S	100' E	32.55455	-104.15730	EDDY

Unitized Area or Area of Uniform Interest	Spacing Unit Type <input checked="" type="checkbox"/> Horizontal <input type="checkbox"/> Vertical	Ground Floor Elevation:
---	--	-------------------------

<b>OPERATOR CERTIFICATIONS</b>  <i>I hereby certify that the information contained herein is true and complete to the best of my knowledge and belief, and, if the well is a vertical or directional well, that this organization either owns a working interest or unleased mineral interest in the land including the proposed bottom hole location or has a right to drill this well at this location pursuant to a contract with an owner of a working interest or unleased mineral interest, or to a voluntary pooling agreement or a compulsory pooling order heretofore entered by the division.</i>  <i>If this well is a horizontal well, I further certify that this organization has received the consent of at least one lessee or owner of a working interest or unleased mineral interest in each tract (in the target pool or formation) in which any part of the well's completed interval will be located or obtained a compulsory pooling order from the division.</i>		<b>SURVEYOR CERTIFICATIONS</b>  <i>I hereby certify that the well location shown on this plat was plotted from field notes of actual surveys made by me or under my supervision, and that the same is true and correct to the best of my beliefs.</i>  <b>PRELIMINARY</b>  THIS DOCUMENT SHALL NOT BE RECORDED FOR ANY PURPOSE AND SHALL NOT BE USED OR VIEWED OR RELIED UPON AS A FINAL SURVEY DOCUMENT.	
Signature  Date 12/5/24		Signature and Seal of Professional Surveyor	
Printed Name Cassie Evans		Certificate Number	Date of Survey
Email Address Cassie.Evans@permianres.com			

Note: No allowable will be assigned to this completion until all interests have been consolidated or a non-standard unit has been approved by the division.



## ACREAGE DEDICATION PLATS

This grid represents a standard section. You may superimpose a non-standard section, or larger area, over this grid. Operators must outline the dedicated acreage in a red box, clearly show the well surface location and bottom hole location, if it is directionally drilled, with the dimensions from the section lines in the cardinal directions. If this is a horizontal wellbore show on this plat the location of the First Take Point and Last Take Point, and the point within the Completed interval (other than the First Take Point or Last Take Point) that is closest to any outer boundary of the tract.

Surveyors shall use the latest United States government survey or dependent resurvey. Well locations will be in reference to the New Mexico Principal Meridian. If the land is not surveyed, contact the OCD Engineering Bureau. Independent subdivision surveys will not be acceptable.

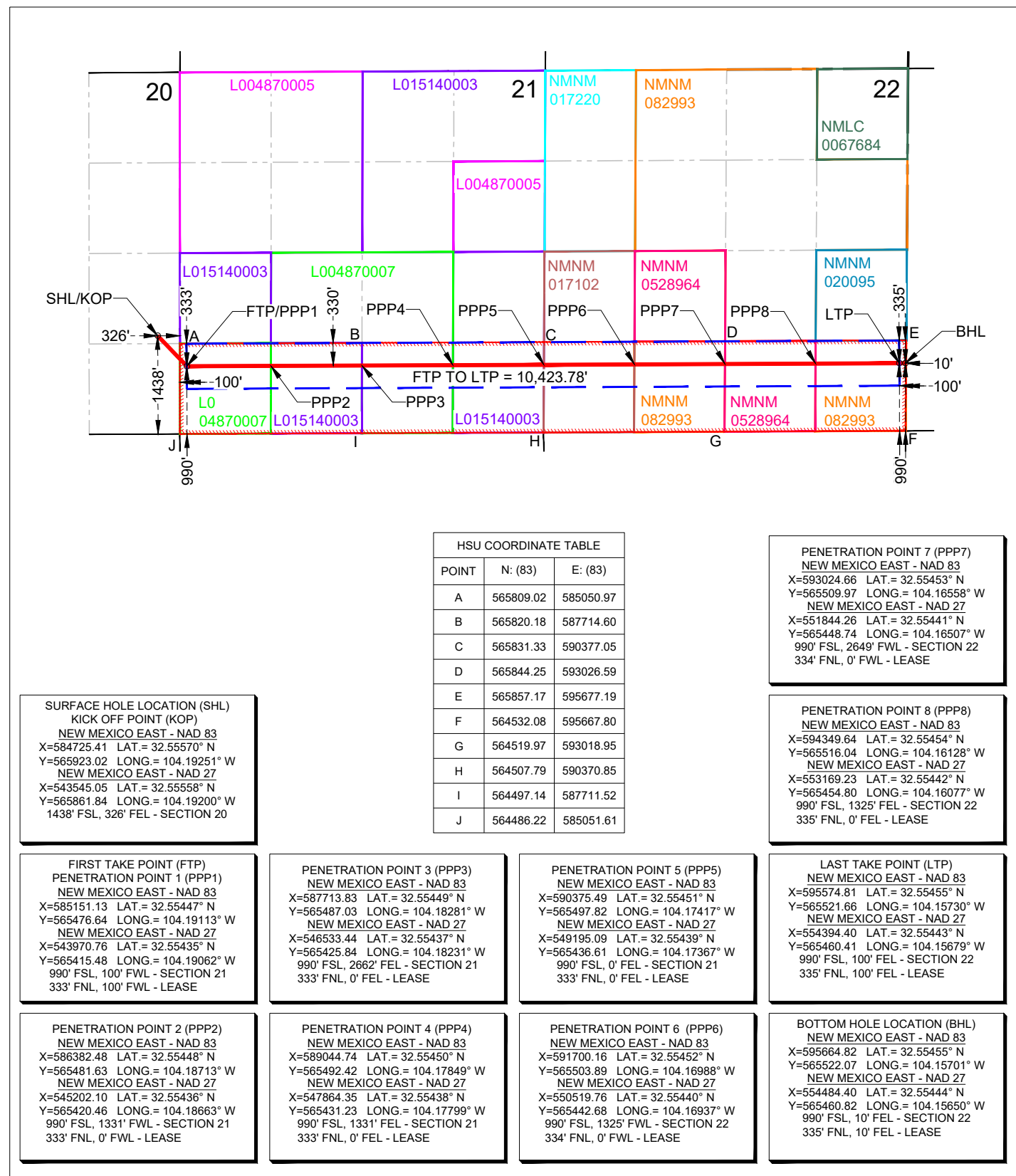



[illegible]

**Operator: Permian  
Resources: Boomerang  
Bone Spring Wells –  
Sec 26**

Tract 1	L0-1611-0003
Tract 2	K0-6599-0001
Tract 3	L0-0487-0005
Tract 4	L0-1514-0003
Tract 5	L0-0487-0007
Tract 6A/B	NMNM 017220
Tract 7	NMNM 017102
Tract 8A/B	NMNM 0528964
Tract 9A/B	NMNM 082993
Tract 10	NMNM 020095
Tract 11	NMNM 008941

Taipan 204H NSL Notice List			Tracking Number	Date Sent
<b>Notice Tract 1 (S/2SE/4, NW/4SE/4 Section 20, T20S-R28E)</b>		<b>L0-1611-0003</b>		
COG Operating LLC	Operator	600 W Illinois Avenue Midland, TX 79701	9414836208551286836144	8/29/2025
<b>Notice Tract 2 (S/2NE/4, NE/4SE/4 Section 20, T20S-R28E)</b>		<b>K0-6599-0001</b>		
COG Operating LLC	Operator	600 W Illinois Avenue Midland, TX 79701	9414836208551286836144	8/29/2025
<b>Notice Tract 3 (S/2NW/4, SE/4NE/4 Section 21, T20S-R28E)</b>		<b>L0-0487-0005</b>		
Permian Resources Operating, LLC	Operator	300 N. Marienfeld Street Midland, TX 79701	N/A	
EOG Resources, Inc.	Working Interest	5509 Champions Drive Midland, TX 79706	9414836208551286836229	8/29/2025
Permian Resources Operating, LLC	Working Interest	300 N. Marienfeld Street Midland, TX 79701	N/A	
Morris Allen Williams	Working Interest	1903 N McClane Rd Payson, AZ 85541	9414836208551286836304	8/29/2025
Claremont Corporation	Working Interest	PO Box 3226 Tulsa, OK 74101	941483621286836236	8/29/2025
QRE Operating, LLC	Working Interest	1401 McKinney St, Ste 2400 Houston, TX 77010		8/29/2025
EOG Resources, Inc.	Record Title	5509 Champions Drive Midland, TX 79706	9414836208551286836229	8/29/2025
State of New Mexico	Royalty	310 Old Santa Fe Trail Santa Fe, NM 87501	9414836208551286836137	8/29/2025
<b>Notice Tract 4 (SW/4NE/4, NW/4SW/4, NE/4SE/4 Section 21, T20S-R28E)</b>		<b>L0-1514-0003</b>		
Permian Resources Operating, LLC	Operator	300 N. Marienfeld Street Midland, TX 79701	N/A	
Magnum Hunter Production Inc.	Working Interest	6001 Deauville Blvd, Ste 300N Midland, TX 79706	9414836208551286836328	8/29/2025
Permian Resources Operating, LLC	Working Interest	300 N. Marienfeld Street Midland, TX 79701	N/A	
Claremont Corporation	Working Interest	PO Box 3226 Tulsa, OK 74101	9414836208551286836236	8/29/2025
QRE Operating, LLC	Working Interest	1401 McKinney St, Ste 2400 Houston, TX 77010	9414836208551286836328	8/29/2025
Morris Allen Williams	Working Interest	1903 N McClane Rd Payson, AZ 85541	9414836208551286836304	8/29/2025
Magnum Hunter Production Inc.	Record Title	6001 Deauville Blvd, Ste 300N Midland, TX 79706	9414836208551286836328	8/29/2025
State of New Mexico	Royalty	310 Old Santa Fe Trail Santa Fe, NM 87501	9414836208551286836137	8/29/2025
<b>Notice Tract 5 (NE/4SW/4, NW/4SE/4 Section 21, T20S-R28E)</b>		<b>L0-0487-0007</b>		
Permian Resources Operating, LLLC	Operator	300 N. Marienfeld Street Midland, TX 79701	N/A	
Permian Resources Operating, LLLC	Working Interest	300 N. Marienfeld Street Midland, TX 79701	N/A	
Claremont Corporation	Working Interest	PO Box 3226 Tulsa, OK 74101	9414836208551286836236	8/29/2025
McAnSo, LLC	Working Interest	PO Box 51407 Midland, TX 79710	9414836208551286836274	8/29/2025
Colgate Production, LLC	Record Title	300 N. Marienfeld Street Midland, TX 79701	N/A	
State of New Mexico	Royalty	310 Old Santa Fe Trail Santa Fe, NM 87501	9414836208551286836137	8/29/2025
<b>Notice Tract 6A (SW/4NW/4 Section 22, T20S-R28E)</b>		<b>NMNM 017220</b>		
Permian Resources Operating, LLC	Operator	300 N. Marienfeld Street Midland, TX 79701	N/A	
BEXP II GW Alpha, LLC	Working Interest	5914 W Courtyard Dr, Ste 200 Austin, TX 78730	9414836208551286836175	8/29/2025
BEXP II Omega Misc., LLC	Working Interest	5914 W Courtyard Dr, Ste 200 Austin, TX 78730	9414836208551286836205	8/29/2025
Davoil, Inc.	Working Interest	PO Box 122269 Fort Worth, TX 76121	9414836208551286836168	8/29/2025
Colgate Production, LLC	Lessee of Record	300 N. Marienfeld Street Midland, TX 79701	N/A	
Bureau of Land Management	Royalty	301 Dinosaur Trail Santa Fe, NM 87508	9414836208551286836199	8/29/2025
<b>Notice Tract 6B (SW/4NW/4 Section 23, T20S-R28E)</b>		<b>NMNM 017220</b>		
Permian Resources Operating, LLC	Operator	300 N. Marienfeld Street Midland, TX 79701	N/A	
BEXP II GW Alpha, LLC	Working Interest	5914 W Courtyard Dr, Ste 200 Austin, TX 78730	9414836208551286836175	8/29/2025
BEXP II Omega Misc., LLC	Working Interest	5914 W Courtyard Dr, Ste 200 Austin, TX 78730	9414836208551286836205	8/29/2025

Davoil, Inc.	Working Interest	PO Box 122269 Fort Worth, TX 76121	9414836208551286836168	8/29/2025
Colgate Production, LLC	Lessee of Record	300 N. Marienfeld Street Midland, TX 79701	N/A	
Bureau of Land Management	Royalty	301 Dinosaur Trail Santa Fe, NM 87508	9414836208551286836199	8/29/2025
<b>Notice Tract 7 (NW/4SW/4 Section 22, T20S-R28E)</b>		<b>NMNM 017102</b>		
Permian Resources Operating, LLC	Operator	300 N. Marienfeld Street Midland, TX 79701	N/A	
BEXP II GW Alpha, LLC	Working Interest	5914 W Courtyard Dr, Ste 200 Austin, TX 78730	9414836208551286836175	8/29/2025
BEXP II Omega Misc., LLC	Working Interest	5914 W Courtyard Dr, Ste 200 Austin, TX 78730	9414836208551286836205	8/29/2025
Davoil, Inc.	Working Interest	PO Box 122269 Fort Worth, TX 76121	9414836208551286836168	8/29/2025
Great Western Drilling Ltd.	Lessee of Record	PO Box 1659 Midland, TX 79702	9414836208551286836250	8/29/2025
Davoil, Inc.	Lessee of Record	PO Box 122269 Fort Worth, TX 76121	9414836208551286836168	8/29/2025
Bureau of Land Management	Royalty	301 Dinosaur Trail Santa Fe, NM 87508	9414836208551286836199	8/29/2025
<b>Notice Tract 8A (NE/4SW/4 Section 22, T20S-R28E)</b>		<b>NMNM 0528964</b>		
Permian Resources Operating, LLC	Operator	300 N. Marienfeld Street Midland, TX 79701	N/A	
BEXP II GW Alpha, LLC	Working Interest	5914 W Courtyard Dr, Ste 200 Austin, TX 78730	9414836208551286836175	8/29/2025
BEXP II Omega Misc., LLC	Working Interest	5914 W Courtyard Dr, Ste 200 Austin, TX 78730	9414836208551286836205	8/29/2025
Davoil, Inc.	Working Interest	PO Box 122269 Fort Worth, TX 76121	9414836208551286836168	8/29/2025
Colgate Production, LLC	Lessee of Record	300 N. Marienfeld Street Midland, TX 79701	N/A	
Bureau of Land Management	Royalty	301 Dinosaur Trail Santa Fe, NM 87508	9414836208551286836199	8/29/2025
<b>Notice Tract 8B (NW/4SW/4 Section 23, T20S-R28E)</b>		<b>NMNM 0528964</b>		
Permian Resources Operating, LLC	Operator	300 N. Marienfeld Street Midland, TX 79701	N/A	
Permian Resources Operating, LLC	Working Interest	300 N. Marienfeld Street Midland, TX 79701	N/A	
BEXP II GW Alpha, LLC	Working Interest	5914 W Courtyard Dr, Ste 200 Austin, TX 78730	9414836208551286836175	8/29/2025
BEXP II Omega Misc., LLC	Working Interest	5914 W Courtyard Dr, Ste 200 Austin, TX 78730	9414836208551286836205	8/29/2025
Davoil, Inc.	Working Interest	PO Box 122269 Fort Worth, TX 76121	9414836208551286836168	8/29/2025
Colgate Production LLC	Lessee of Record	300 N. Marienfeld Street Midland, TX 79701	N/A	
Bureau of Land Management	Royalty	301 Dinosaur Trail Santa Fe, NM 87508	9414836208551286836199	8/29/2025
<b>Notice Tract 9A (SE/4NW/4, S/2NE/4, NW/4SE/4 Section 22, T20S-R28E)</b>		<b>NMNM 082993</b>		
Permian Resources Operating, LLC	Operator	300 N. Marienfeld Street Midland, TX 79701	N/A	
BEXP II GW Alpha, LLC	Working Interest	5914 W Courtyard Dr, Ste 200 Austin, TX 78730	9414836208551286836175	8/29/2025
BEXP II Omega Misc., LLC	Working Interest	5914 W Courtyard Dr, Ste 200 Austin, TX 78730	9414836208551286836205	8/29/2025
Davoil, Inc.	Working Interest	PO Box 122269 Fort Worth, TX 76121	9414836208551286836168	8/29/2025
Colgate Production, LLC	Lessee of Record	300 N. Marienfeld Street Midland, TX 79701	N/A	
Bureau of Land Management	Royalty	301 Dinosaur Trail Santa Fe, NM 87508	9414836208551286836199	8/29/2025
<b>Notice Tract 9B (SW/4SW/4 Section 23, T20S-R28E)</b>		<b>NMNM 082993</b>		
Permian Resources Operating, LLC	Operator	300 N. Marienfeld Street Midland, TX 79701	N/A	
Permian Resources Operating, LLC	Lessee of Record	300 N. Marienfeld Street Midland, TX 79701	N/A	
Permian Resources Operating, LLC	Working Interest	300 N. Marienfeld Street Midland, TX 79701	N/A	
Bureau of Land Management	Royalty	301 Dinosaur Trail Santa Fe, NM 87508	9414836208551286836199	8/29/2025
<b>Notice Tract 10 (NE/4SE/4 Section 22, T20S-R28E)</b>		<b>NMNM 020095</b>		
Permian Resources Operating, LLC	Operator	300 N. Marienfeld Street Midland, TX 79701	N/A	

BEXP II GW Alpha, LLC	Working Interest	5914 W Courtyard Dr, Ste 200 Austin, TX 78730	9414836208551286836175	8/29/2025
BEXP II Omega Misc., LLC	Working Interest	5914 W Courtyard Dr, Ste 200 Austin, TX 78730 PO Box 122269	9414836208551286836205	8/29/2025
Davoil, Inc.	Working Interest	Fort Worth, TX 76121 1801 Broadway, Ste 1550	9414836208551286836168	8/29/2025
Gilmore Resources, Inc	Lessee of Record	Denver, CO 80202 C/O Willis Gilmore III 14706 Daubern Ct	9414836208551286836281	8/29/2025
Katherine Anne Gilmore Shannon and Laurence Davis Gilmore, Co-Trustees of The Katherine E. Gilmore Bypass Trust dated May 9, 2017	Lessee of Record	Cypress, TX 77429 PO Box 49407	941483621286836267	8/29/2025
E. Cecile Martin	Lessee of Record	Austin, TX 78765 C/O Judy Kelley 4210 Laurel Oak Dr	9414836208551286836359	8/29/2025
Freddie Jean Wheeler	Lessee of Record	San Angelo, TX 76904 PO Box 72	9414836208551286836243	8/29/2025
James R. Hurt	Lessee of Record	Odessa, TX 79760 409 W 14th St	9414836208551286836311	8/29/2025
Hurt Properties, LP	Lessee of Record	Austin, TX 78701 300 N. Marienfeld Street	9414836208551286841575	8/29/2025
Colgate Production, LLC	Lessee of Record	Midland, TX 79701 301 Dinosaur Trail	N/A	
Bureau of Land Management	Royalty	Santa Fe, NM 87508	9414836208551286836199	8/29/2025
<b>Notice Tract 11 (SE/4NW/4, E/2SW/4 Section 23, T20S-R28E)</b>		<b>NMNM 008941</b>		
Permian Resources Operating, LLC	Operator	300 N. Marienfeld Street Midland, TX 79701	N/A	
BEXP II GW Alpha, LLC	Working Interest	5914 W Courtyard Dr, Ste 200 Austin, TX 78730	9414836208551286836175	8/29/2025
BEXP II Omega Misc., LLC	Working Interest	5914 W Courtyard Dr, Ste 200 Austin, TX 78730 PO Box 122269	9414836208551286836205	8/29/2025
Davoil, Inc.	Working Interest	Fort Worth, TX 76121 300 N. Marienfeld Street	9414836208551286836168	8/29/2025
Permian Resources Operating, LLC	Lessee of Record	Midland, TX 79701 301 Dinosaur Trail	N/A	
Bureau of Land Management	Royalty	Santa Fe, NM 87508	9414836208551286836199	8/29/2025



August 29, 2025

**VIA CERTIFIED MAIL**  
**RETURN RECEIPT REQUESTED****TO: ALL AFFECTED PERSONS****Re: Permian Resources Operating, LLC**  
**Requests for Administrative Approval of Unorthodox Well Locations**

Enclosed are copies of administrative applications requesting approval of non-standard well locations for the following Permian Resources Operating, LLC's ("Permian Resources") wells:

- Taipan 21 Fed Com 201H
- Taipan 21 Fed Com 202H
- Taipan 21 Fed Com 203H
- Taipan 21 Fed Com 204H

Administrative applications for the above-referenced non-standard locations were filed with the New Mexico Oil Conservation Division on this date. Any objection to the applications must be filed in writing within twenty (20) days from the date this application is received by the New Mexico Oil Conservation Division, 1220 South St. Francis Drive, Santa Fe, New Mexico 87505. If no objection is received within this twenty-day period, this application may be approved administratively by the Division.

If you have any questions about this application, please contact Ryan Curry, Senior Landman at Permian Resources – [Ryan.Curry@permianres.com](mailto:Ryan.Curry@permianres.com).

Sincerely,

HARDY McLEAN LLC

/s/ Jaclyn M. McLean

Jaclyn M. McLean

*Attorneys for Permian Resources Operating, LLC*

---

125 Lincoln Avenue, Suite 223  
Santa Fe, NM 87501  
505-230-4410

[HardyMcClean.com](http://HardyMcClean.com)

**Writer:**  
Jaclyn M. McLean  
Managing Partner  
[jmclean@hardymclean.com](mailto:jmclean@hardymclean.com)

Sante Fe Main Office  
Phone: (505) 476-3441

General Information  
Phone: (505) 629-6116

Online Phone Directory  
<https://www.emnrd.nm.gov/ocd/contact-us>

State of New Mexico  
Energy, Minerals and Natural Resources  
Oil Conservation Division  
1220 S. St Francis Dr.  
Santa Fe, NM 87505

CONDITIONS

Action 500516

CONDITIONS

Operator: Permian Resources Operating, LLC 300 N. Marienfeld St Ste 1000 Midland, TX 79701	OGRID: 372165
	Action Number: 500516
	Action Type: [UF-NSL] Non-Standard Location (NSL)

CONDITIONS

Created By	Condition	Condition Date
llowe	This NSL order was approved with a pending API number. The owner of the NSL shall update the OCD when an API number is assigned to the pending APD by sending an e-mail to <a href="mailto:ocd.engineer@emnrd.nm.gov">ocd.engineer@emnrd.nm.gov</a> . TITLED: (Updating NSL-XXX with API number of the Well Name). The text of the email shall contain: NSL order number, API number and Well Name. If the Well name does not match the name on the NSL order. The order will be annulled.	9/5/2025
llowe	This well excludes acreage from its horizontal spacing unit (HSU) creating a non-standard spacing unit. The operator of this well needs to obtain an approved NSP order (Administratively) to produce from this Well. The C-104 will not be approved until the NSP is obtained.	12/1/2025