

AE Order Number Banner

Application Number: pDZD2609943179

Initial Application Part I

WFX-1071

SEELY OIL CO [20497]

Received: 3/20/2026

RECEIVED:	REVIEWER:	TYPE:	APP NO:
-----------	-----------	-------	---------

ABOVE THIS TABLE FOR OCD DIVISION USE ONLY

NEW MEXICO OIL CONSERVATION DIVISION
 - Geological & Engineering Bureau -
 1220 South St. Francis Drive, Santa Fe, NM 87505



ADMINISTRATIVE APPLICATION CHECKLIST

THIS CHECKLIST IS MANDATORY FOR ALL ADMINISTRATIVE APPLICATIONS FOR EXCEPTIONS TO DIVISION RULES AND REGULATIONS WHICH REQUIRE PROCESSING AT THE DIVISION LEVEL IN SANTA FE

Applicant: SEELY OIL CO. OGRID Number: 20497
 Well Name: E-K QUEEN UNIT 212 API: 30-025-29471
 Pool: E-K; YATES-SEVEN RIVERS-QUEEN Pool Code: 19950

SUBMIT ACCURATE AND COMPLETE INFORMATION REQUIRED TO PROCESS THE TYPE OF APPLICATION INDICATED BELOW

- 1) TYPE OF APPLICATION: Check those which apply for [A]
- A. Location - Spacing Unit - Simultaneous Dedication
 NSL NSP (PROJECT AREA) NSP (PRORATION UNIT) SD
- B. Check one only for [I] or [II]
- [I] Commingling - Storage - Measurement
 DHC CTB PLC PC OLS OLM
- [II] Injection - Disposal - Pressure Increase - Enhanced Oil Recovery
 WFX PMX SWD IPI EOR PPR

FOR OCD ONLY	
<input type="checkbox"/>	Notice Complete
<input type="checkbox"/>	Application Content Complete

- 2) NOTIFICATION REQUIRED TO: Check those which apply.
- A. Offset operators or lease holders
 B. Royalty, overriding royalty owners, revenue owners
 C. Application requires published notice
 D. Notification and/or concurrent approval by SLO
 E. Notification and/or concurrent approval by BLM
 F. Surface owner
 G. For all of the above, proof of notification or publication is attached, and/or,
 H. No notice required

3) CERTIFICATION: I hereby certify that the information submitted with this application for administrative approval is accurate and complete to the best of my knowledge. I also understand that no action will be taken on this application until the required information and notifications are submitted to the Division.

Note: Statement must be completed by an individual with managerial and/or supervisory capacity.

BRIAN WOOD
 Print or Type Name

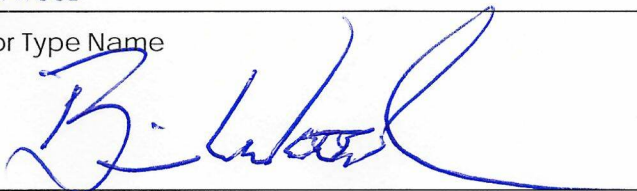
 Signature

3-20-26
 Date

505 466-8120
 Phone Number

brian@permitswest.com
 e-mail Address

Side 2

III. WELL DATA

A. The following well data must be submitted for each injection well covered by this application. The data must be both in tabular and schematic form and shall include:

- (1) Lease name; Well No.; Location by Section, Township and Range; and footage location within the section.
- (2) Each casing string used with its size, setting depth, sacks of cement used, hole size, top of cement, and how such top was determined.
- (3) A description of the tubing to be used including its size, lining material, and setting depth.
- (4) The name, model, and setting depth of the packer used or a description of any other seal system or assembly used.

Division District Offices have supplies of Well Data Sheets which may be used or which may be used as models for this purpose. Applicants for several identical wells may submit a "typical data sheet" rather than submitting the data for each well.

B. The following must be submitted for each injection well covered by this application. All items must be addressed for the initial well. Responses for additional wells need be shown only when different. Information shown on schematics need not be repeated.

- (1) The name of the injection formation and, if applicable, the field or pool name.
- (2) The injection interval and whether it is perforated or open-hole.
- (3) State if the well was drilled for injection or, if not, the original purpose of the well.
- (4) Give the depths of any other perforated intervals and detail on the sacks of cement or bridge plugs used to seal off such perforations.
- (5) Give the depth to and the name of the next higher and next lower oil or gas zone in the area of the well, if any.

XIV. PROOF OF NOTICE

All applicants must furnish proof that a copy of the application has been furnished, by certified or registered mail, to the owner of the surface of the land on which the well is to be located and to each leasehold operator within one-half mile of the well location.

Where an application is subject to administrative approval, a proof of publication must be submitted. Such proof shall consist of a copy of the legal advertisement which was published in the county in which the well is located. The contents of such advertisement must include:

- (1) The name, address, phone number, and contact party for the applicant;
- (2) The intended purpose of the injection well; with the exact location of single wells or the Section, Township, and Range location of multiple wells;
- (3) The formation name and depth with expected maximum injection rates and pressures; and,
- (4) A notation that interested parties must file objections or requests for hearing with the Oil Conservation Division, 1220 South St. Francis Dr., Santa Fe, New Mexico 87505, within 15 days.

NO ACTION WILL BE TAKEN ON THE APPLICATION UNTIL PROPER PROOF OF NOTICE HAS BEEN SUBMITTED.

NOTICE: Surface owners or offset operators must file any objections or requests for hearing of administrative applications within 15 days from the date this application was mailed to them.

TOPO! map printed on 12/07/19 from "Untitled.tpo"

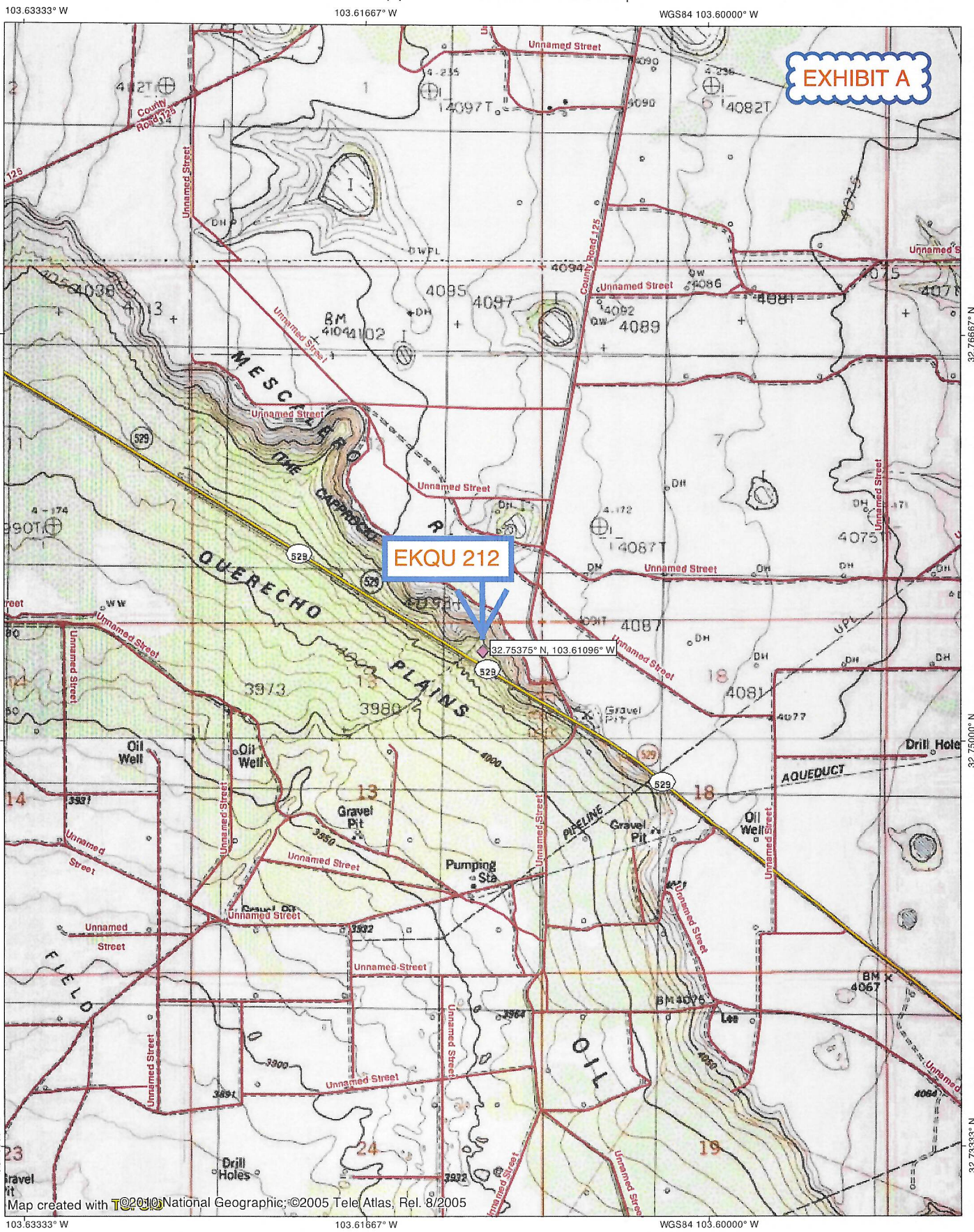
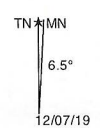
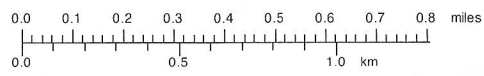

EXHIBIT A

EKQU 212

32.75375° N, 103.61096° W

Map created with TOPO! National Geographic, ©2005 Telet Atlas, Rel. 8/2005



N MEXICO OIL CONSERVATION COMMISS
WELL LOCATION AND ACREAGE DEDICATION PLAT



Form C-102
Supersedes C-128
Effective 1-1-85

All distances must be from the outer boundaries of the Section

Operator SUN EXPLORATION & PRODUCTION COMPANY		Lease MESCALERO RIDGE FEDERAL			Well No. 3
Tract Letter A	Section 13	Township 18 SOUTH	Range 33 EAST	County LFA	
Actual Footage Location of Well: 430 feet from the NORTH line and 900 feet from the EAST line					
Ground Level Elev. 4030.4'	Producing Formation BONE SPRINGS	Pool MESCALERO ESCARPE BONE SPRINGS		Dedicated Acreage: 40 Acres	

1. Outline the acreage dedicated to the subject well by colored pencil or hachure marks on the plat below.
2. If more than one lease is dedicated to the well, outline each and identify the ownership thereof (both as to working interest and royalty).
3. If more than one lease of different ownership is dedicated to the well, have the interests of all owners been consolidated by communitization, unitization, force-pooling, etc?

Yes No If answer is "yes," type of consolidation _____

If answer is "no," list the owners and tract descriptions which have actually been consolidated (Use reverse side of this form if necessary.) _____

No allowable will be assigned to the well until all interests have been consolidated (by communitization, unitization, forced-pooling, or otherwise) or until a non-standard unit, eliminating such interests, has been approved by the Commission.

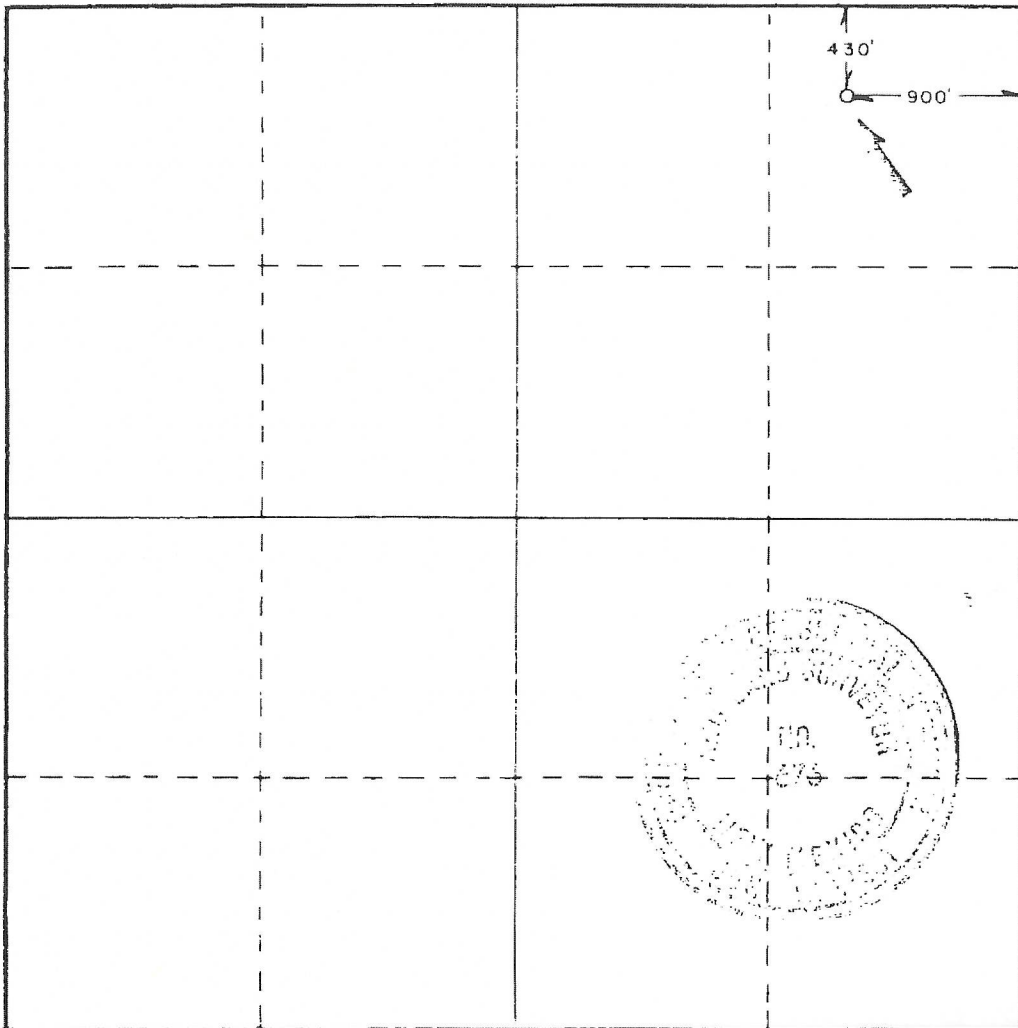

CERTIFICATION

I hereby certify that the information contained herein is true and complete to the best of my knowledge and belief.

Velma Reyes
Name

Velma Reyes
Position

Sr. Accounting Assistant
Company

Sun Exploration & Production Co

10/9/85
Date

I hereby certify that the well location shown on this plat was plotted from field notes of actual surveys made by me or under my supervision, and that the same is true and correct to the best of my knowledge and belief.

Date Surveyed
OCTOBER 1, 1985

Registered Professional Engineer and/or Land Surveyor

John W. West

Certificate No JOHN W. WEST, 676

RONALD J. EIDSON, 3239

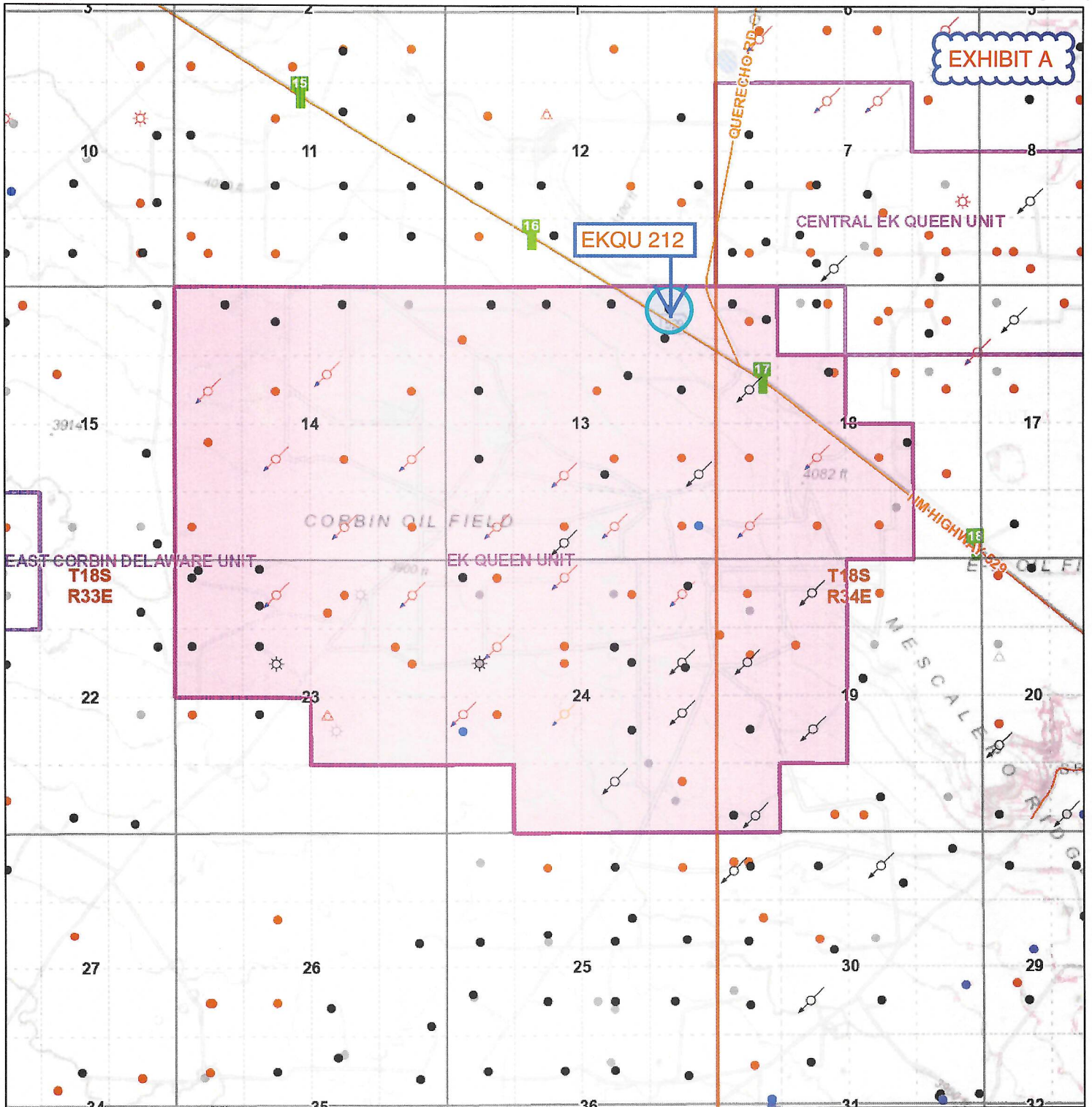

EXHIBIT A

EKQU 212

CENTRAL EK QUEEN UNIT

CORBIN OIL FIELD

EK QUEEN UNIT

EAST CORBIN DELAWARE UNIT
T18S
R33E

T18S
R34E

Oil, Gas, and Minerals Leases and Wells

0 0.2 0.4 0.8 mi

New Mexico State Land Office

Disclaimer:
The New Mexico State Land Office assumes no responsibility or liability for, or in connection with the accuracy, reliability or use of the information provided herein with respect to State Land Office data or data from other sources.

Data pertaining to New Mexico State Trust Lands are provisional and subject to revision, and do not constitute an official record of title. Official records may be reviewed at the New Mexico State Land Office in Santa Fe, New Mexico.

Map Created: 3/15/2026

Override 1	State Boundary
Override 1	County Seats
Override 1	NMOCD_Inactive
Subdivisions	Symbology
Sections	Miscellaneous
Townships	CO2 Cancelled
County Boundaries	CO2, Plugged
	CO2, Temporarily Abandoned

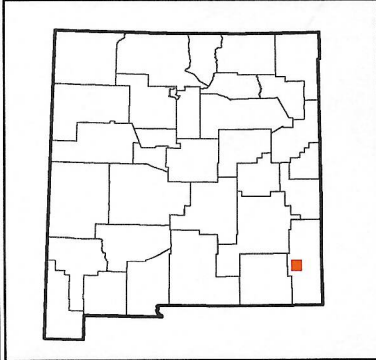

INJECTION WELL DATA SHEET

Side 1

OPERATOR: SEELY OIL CO.

WELL NAME & NUMBER: E-K QUEEN UNIT 212

WELL LOCATION: 430' FNL & 900' FEL A 13 18 S 33 E
 FOOTAGE LOCATION UNIT LETTER SECTION TOWNSHIP RANGE

WELLBORE SCHEMATIC

WELL CONSTRUCTION DATA

"As Is"
(not to scale)

Surface Casing

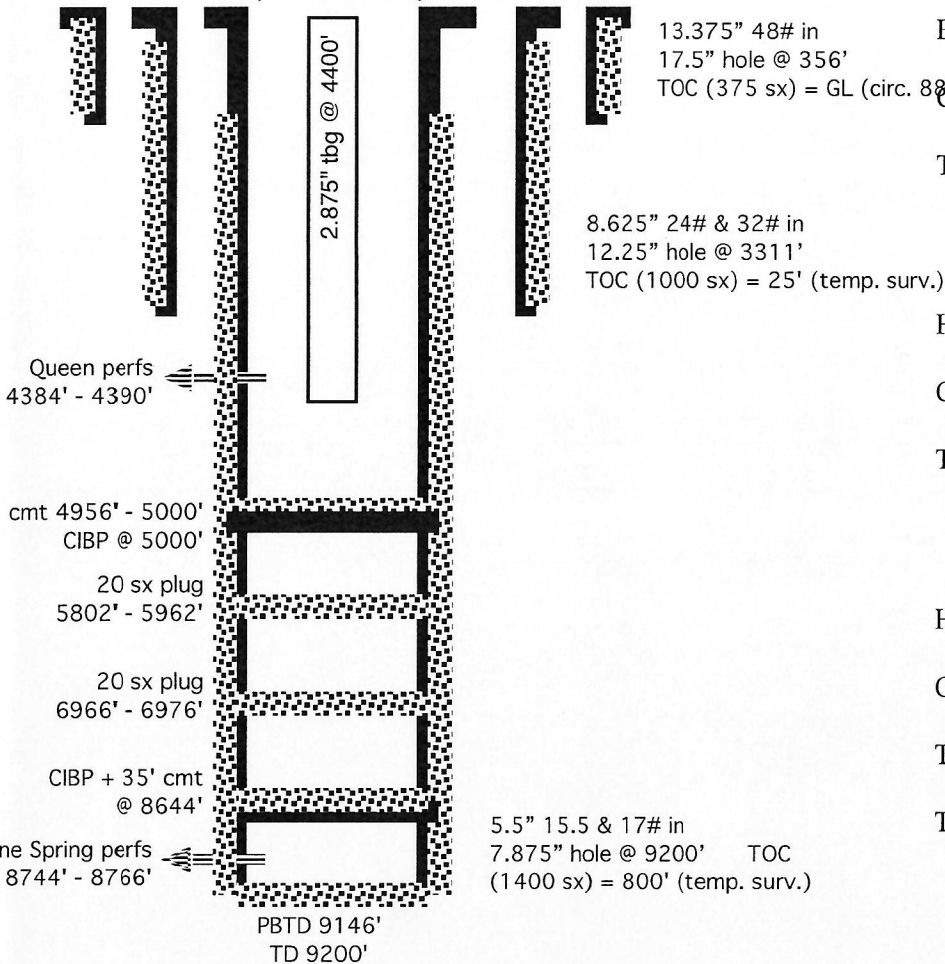

Hole Size: 17.5" Casing Size: 13.375"
 Cemented with: 375 sx. *or* _____ ft³
 Top of Cement: SURFACE Method Determined: CIRC. 88 SX

Intermediate Casing

Hole Size: 12.25" Casing Size: 8.625"
 Cemented with: 1000 sx. *or* _____ ft³
 Top of Cement: 25' Method Determined: TEMP. SURV.

Production Casing

Hole Size: 7.875" Casing Size: 5.5"
 Cemented with: 1400 sx. *or* _____ ft³
 Top of Cement: 880' Method Determined: TEMP. SURV.

Total Depth: 9200'

Injection Interval

4384 feet to 4390'

(Perforated ~~or Open Hole~~; indicate which)

Side 1

INJECTION WELL DATA SHEET

OPERATOR: SEELY OIL CO.

WELL NAME & NUMBER: E-K QUEEN UNIT 212

WELL LOCATION: <u>430' FNL & 900' FEL</u>	<u>A</u>	<u>13</u>	<u>18 S</u>	<u>33 E</u>
FOOTAGE LOCATION	UNIT LETTER	SECTION	TOWNSHIP	RANGE

WELLBORE SCHEMATIC

WELL CONSTRUCTION DATA

"Planned"
(not to scale)

Surface Casing

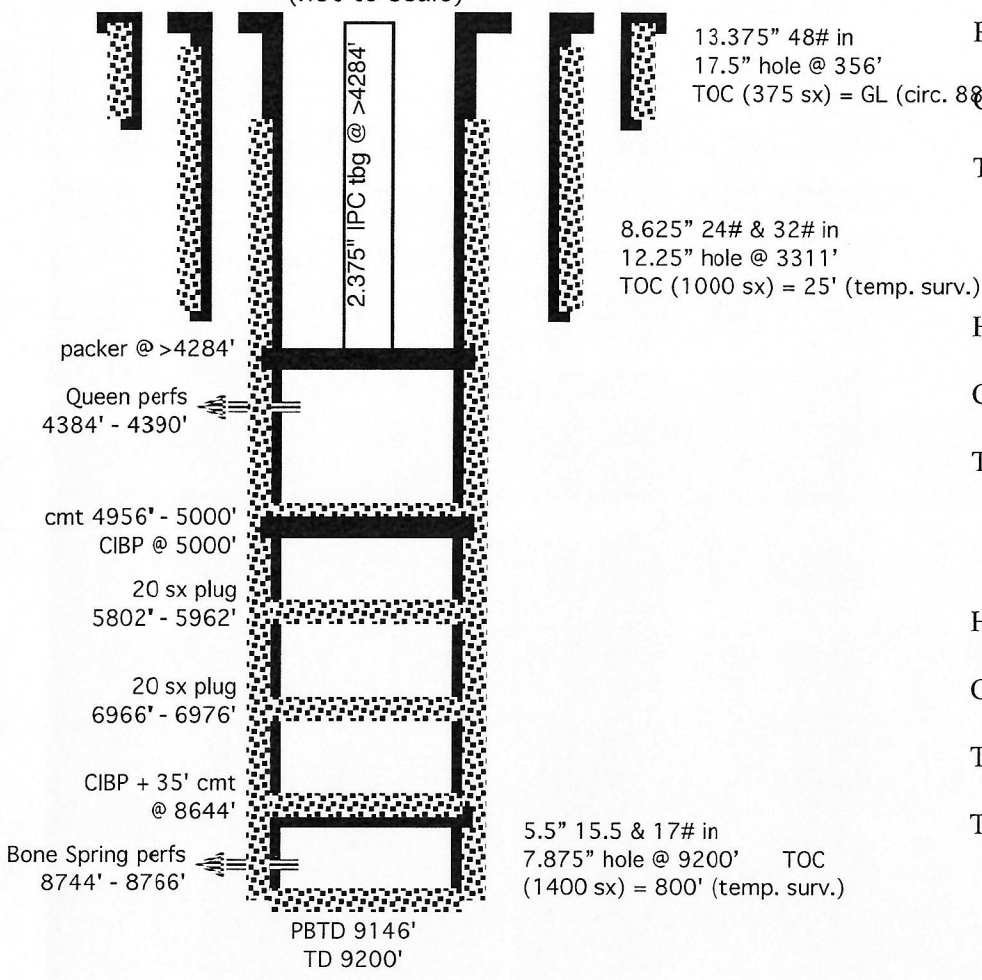

Hole Size: 17.5" Casing Size: 13.375"
 Cemented with: 375 sx. *or* _____ ft³
 Top of Cement: SURFACE Method Determined: CIRC. 88 SX

Intermediate Casing

Hole Size: 12.25" Casing Size: 8.625"
 Cemented with: 1000 sx. *or* _____ ft³
 Top of Cement: 25' Method Determined: TEMP. SURV.

Production Casing

Hole Size: 7.875" Casing Size: 5.5"
 Cemented with: 1400 sx. *or* _____ ft³
 Top of Cement: 880' Method Determined: TEMP. SURV.
 Total Depth: 9200'

Injection Interval

4384 feet to 4390'

(Perforated ~~or~~ Open Hole; indicate which)
 ■■■■■■■■

INJECTION WELL DATA SHEETTubing Size: 2-3/8" J-55 4.7# Lining Material: INTERNAL PLASTIC COATType of Packer: PLASTIC LINED AD-IPacker Setting Depth: ≈4300'

Other Type of Tubing/Casing Seal (if applicable): _____

Additional Data1. Is this a new well drilled for injection? _____ Yes XXX NoIf no, for what purpose was the well originally drilled? BONE SPRING OIL WELL2. Name of the Injection Formation: QUEEN3. Name of Field or Pool (if applicable): E-K; YATES-SEVEN RIVERS-QUEEN (POOL CODE 19950)

4. Has the well ever been perforated in any other zone(s)? List all such perforated intervals and give plugging detail, i.e. sacks of cement or plug(s) used. _____

YES - BONE SPRING PERFS (8744' - 8766')

5. Give the name and depths of any oil or gas zones underlying or overlying the proposed injection zone in this area: _____

OVER: YATES (3210') & SEVEN RIVERS (3624')UNDER: SAN ANDRES (5114'), DELAWARE (5902'), & BONE SPRING (6896')

Affidavit of Publication



STATE OF NEW MEXICO
COUNTY OF LEA

I, Daniel Russell, Publisher of the Hobbs News-Sun, a newspaper published at Hobbs, New Mexico, solemnly swear that the clipping attached hereto was published in the regular and entire issue of said newspaper, and not a supplement thereof for a period of 1 issue(s).

Beginning with the issue dated
March 08, 2026
and ending with the issue dated
March 08, 2026.

Publisher

Sworn and subscribed to before me this
8th day of March 2026.

Business Manager

My commission expires
January 29, 2027

(Seal) STATE OF NEW MEXICO
NOTARY PUBLIC
GUSSIE RUTH BLACK
COMMISSION # 1087526
COMMISSION EXPIRES 01/29/2027

This newspaper is duly qualified to publish legal notices or advertisements within the meaning of Section 3, Chapter 167, Laws of 1937 and payment of fees for said publication has been made.

LEGALS

LEGAL NOTICE
March 8, 2026

Seely Oil Co. is applying to convert the E-K Queen Unit 212 oil well to a water injection well. The well is at 430' FNL & 900' FEL, Sec. 13, T. 18 S., R. 33 E., Lea County, NM. This is 7 miles southwest of Buckeye, NM. It will inject water into the Queen (maximum injection pressure = 876 psi) from 4,384' to 4,390'. Injection will be at a maximum rate of 150 bwpd. Interested parties must file objections, protests, or requests for hearing with the NM Oil Conservation Division, 1220 South Saint Francis Dr., Santa Fe, NM 87505 or OCD.Engineer@emnrd.nm.gov within 15 days. NMOCD Engineering Bureau phone is 505 476-3441. Additional information can be obtained by contacting: Brian Wood, Permits West, Inc., 5 Caliente Rd., Suite 3A, Santa Fe, NM 87508. Phone number is (505) 466-8120.
#00309045

02108485

00309045

BRIAN WOOD
PERMITS WEST
5 CALIENTE RD, STE 3A
SANTA FE, NM 87508-9102



March 18, 2026

BLM
520 E. Greene
Carlsbad NM 88220

TYPICAL NOTICE

Seely Oil Co. is applying (see attached application) to convert its E-K Queen Unit 212 oil well to a water injection well. As required by NM Oil Conservation Division (NMOCD) Rules, I am notifying you of the following proposed water injection well. No action is needed unless you have questions or objections.

Well Name: E-K Queen Unit 212 (BLM lease) ID = 9200'
Proposed Injection Zone: Queen from 4384' to 4390'
Where: 430' FNL & 900' FEL Sec. 13, T. 18 S., R. 33 E., Lea County, NM
Approximate Location: 7 air miles southwest of Buckeye, NM
Applicant Name: Seely Oil Co. (817) 332-1377
Applicant's Address: 815 West 10th St., Ft. Worth, TX 76102

Submittal Information: Application for a water injection well will be filed with the NMOCD. If you have an objection, protest, or wish to request a hearing, then it must be filed with the NMOCD within 15 days of receipt of this letter. The New Mexico Oil Conservation Division address is 1220 South St. Francis Dr., Santa Fe, NM 87505. NMOCD phone number is (505) 476-3441. E-mail address is: OCD.Engineer@emnrd.nm.gov

Please call me if you have any questions.

Sincerely,

Brian Wood

CERTIFIED MAIL® RECEIPT
Domestic Mail Only

For delivery information, visit our website at www.usps.com

OFFICIAL USE

Certified Mail Fee	\$
Extra Services & Fees (check box, add fee as appropriate)	
<input type="checkbox"/> Return Receipt (hardcopy)	\$
<input type="checkbox"/> Return Receipt (electronic)	\$
<input type="checkbox"/> Certified Mail Restricted Delivery	\$
<input type="checkbox"/> Adult Signature Required	\$
<input type="checkbox"/> Adult Signature Restricted Delivery	\$
Postage	\$
Total Postage and Fees	\$

Sent To: CEB Oil Co
1320 Lake St
Fort Worth, TX 76201
See EKQU212

City, State, ZIP+4®

PS Form 3800, January 2023 PSN 7530-02-000-9047 See Reverse for Instructions

Postmark Here MAR 20 2026

CERTIFIED MAIL® RECEIPT
Domestic Mail Only

For delivery information, visit our website at www.usps.com

OFFICIAL USE

Certified Mail Fee	\$
Extra Services & Fees (check box, add fee as appropriate)	
<input type="checkbox"/> Return Receipt (hardcopy)	\$
<input type="checkbox"/> Return Receipt (electronic)	\$
<input type="checkbox"/> Certified Mail Restricted Delivery	\$
<input type="checkbox"/> Adult Signature Required	\$
<input type="checkbox"/> Adult Signature Restricted Delivery	\$
Postage	\$
Total Postage and Fees	\$

Sent To: COG Operating LLC
600 W Illinois Ave
Midland, TX 79701
See EKQU212

City, State, ZIP+4®

PS Form 3800, January 2023 PSN 7530-02-000-9047 See Reverse for Instructions

Postmark Here MAR 20 2026

EXHIBIT L

U.S. Postal Service™
CERTIFIED MAIL® RECEIPT
Domestic Mail Only

For delivery information, visit our website at www.usps.com

OFFICIAL USE

Certified Mail Fee	\$
Extra Services & Fees (check box, add fee as appropriate)	
<input type="checkbox"/> Return Receipt (hardcopy)	\$
<input type="checkbox"/> Return Receipt (electronic)	\$
<input type="checkbox"/> Certified Mail Restricted Delivery	\$
<input type="checkbox"/> Adult Signature Required	\$
<input type="checkbox"/> Adult Signature Restricted Delivery	\$
Postage	\$
Total Postage and Fees	\$

Sent To: Cross Border Resources Inc
14282 Gillis Road
Farmers Branch, TX 75244
See EKQU212

City, State, ZIP+4®

PS Form 3800, January 2023 PSN 7530-02-000-9047 See Reverse for Instructions

Postmark Here MAR 20 2026

U.S. Postal Service™
CERTIFIED MAIL® RECEIPT
Domestic Mail Only

For delivery information, visit our website at www.usps.com

OFFICIAL USE

Certified Mail Fee	\$
Extra Services & Fees (check box, add fee as appropriate)	
<input type="checkbox"/> Return Receipt (hardcopy)	\$
<input type="checkbox"/> Return Receipt (electronic)	\$
<input type="checkbox"/> Certified Mail Restricted Delivery	\$
<input type="checkbox"/> Adult Signature Required	\$
<input type="checkbox"/> Adult Signature Restricted Delivery	\$
Postage	\$
Total Postage and Fees	\$

Sent To: Chisos LTD
3355 W Alabama, Ste 1200 B
Houston, TX 77098
See EKQU212

City, State, ZIP+4®

PS Form 3800, January 2023 PSN 7530-02-000-9047 See Reverse for Instructions

Postmark Here MAR 20 2026

U.S. Postal Service™
CERTIFIED MAIL® RECEIPT
Domestic Mail Only

For delivery information, visit our website at www.usps.com

OFFICIAL USE

Certified Mail Fee	\$
Extra Services & Fees (check box, add fee as appropriate)	
<input type="checkbox"/> Return Receipt (hardcopy)	\$
<input type="checkbox"/> Return Receipt (electronic)	\$
<input type="checkbox"/> Certified Mail Restricted Delivery	\$
<input type="checkbox"/> Adult Signature Required	\$
<input type="checkbox"/> Adult Signature Restricted Delivery	\$
Postage	\$
Total Postage and Fees	\$

Sent To: Concho Oil & Gas LLC
600 W Illinois Ave
Midland, TX 79701
See EKQU212

City, State, ZIP+4®

PS Form 3800, January 2023 PSN 7530-02-000-9047 See Reverse for Instructions

Postmark Here MAR 20 2026

U.S. Postal Service™
CERTIFIED MAIL® RECEIPT
Domestic Mail Only

For delivery information, visit our website at www.usps.com

OFFICIAL USE

Certified Mail Fee	\$
Extra Services & Fees (check box, add fee as appropriate)	
<input type="checkbox"/> Return Receipt (hardcopy)	\$
<input type="checkbox"/> Return Receipt (electronic)	\$
<input type="checkbox"/> Certified Mail Restricted Delivery	\$
<input type="checkbox"/> Adult Signature Required	\$
<input type="checkbox"/> Adult Signature Restricted Delivery	\$
Postage	\$
Total Postage and Fees	\$

Sent To: Burnett Oil Co
801 Cherry St, #1500 Unit 9
Fort Worth, TX 76102
See EKQU212

City, State, ZIP+4®

PS Form 3800, January 2023 PSN 7530-02-000-9047 See Reverse for Instructions

Postmark Here MAR 20 2026

Received by OCD: 3/20/2026 1:11:24 PM

U.S. Postal Service™ CERTIFIED MAIL® RECEIPT
Domestic Mail Only

For delivery information, visit our website at www.usps.com

OFFICIAL USE

Certified Mail Fee \$

Extra Services & Fees (check box, add fee as appropriate)

Return Receipt (hardcopy) \$

Return Receipt (electronic) \$

Certified Mail Restricted Delivery \$

Adult Signature Required \$

Adult Signature Restricted Delivery \$

Postage \$

Total Postage and Fees \$

Sent To JC Pace Oil & Gas LLC
420 Throckmorton St, Ste 710
Fort Worth, TX 76102
See EKQU212

Street and Apt. No., or PO Box No.

City, State, ZIP+4®

PS Form 3800, January 2023 PSN 7530-02-000-9047 See Reverse for Instructions

U.S. Postal Service™ CERTIFIED MAIL® RECEIPT
Domestic Mail Only

For delivery information, visit our website at www.usps.com

OFFICIAL USE

Certified Mail Fee \$

Extra Services & Fees (check box, add fee as appropriate)

Return Receipt (hardcopy) \$

Return Receipt (electronic) \$

Certified Mail Restricted Delivery \$

Adult Signature Required \$

Adult Signature Restricted Delivery \$

Postage \$

Total Postage and Fees \$

Sent To Michael J Havel
7607 Chalkstone
Dallas, TX 75219
See EKQU212

Street and Apt. No., or PO Box No.

City, State, ZIP+4®

PS Form 3800, January 2023 PSN 7530-02-000-9047 See Reverse for Instructions

EXHIBIT L

U.S. Postal Service™ CERTIFIED MAIL® RECEIPT
Domestic Mail Only

For delivery information, visit our website at www.usps.com

OFFICIAL USE

Certified Mail Fee \$

Extra Services & Fees (check box, add fee as appropriate)

Return Receipt (hardcopy) \$

Return Receipt (electronic) \$

Certified Mail Restricted Delivery \$

Adult Signature Required \$

Adult Signature Restricted Delivery \$

Postage \$

Total Postage and Fees \$

Sent To PVB Oil Co
1320 Lake St
Fort Worth, TX 76102
See EKQU212

Street and Apt. No., or PO Box No.

City, State, ZIP+4®

PS Form 3800, January 2023 PSN 7530-02-000-9047 See Reverse for Instructions

U.S. Postal Service™ CERTIFIED MAIL® RECEIPT
Domestic Mail Only

For delivery information, visit our website at www.usps.com

OFFICIAL USE

Certified Mail Fee \$

Extra Services & Fees (check box, add fee as appropriate)

Return Receipt (hardcopy) \$

Return Receipt (electronic) \$

Certified Mail Restricted Delivery \$

Adult Signature Required \$

Adult Signature Restricted Delivery \$

Postage \$

Total Postage and Fees \$

Sent To Mitchel E Cheney
7670 Woodway Dr.
Houston, TX 77063
See EKQU212

Street and Apt. No., or PO Box No.

City, State, ZIP+4®

PS Form 3800, January 2023 PSN 7530-02-000-9047 See Reverse for Instructions

U.S. Postal Service™ CERTIFIED MAIL® RECEIPT
Domestic Mail Only

For delivery information, visit our website at www.usps.com

OFFICIAL USE

Certified Mail Fee \$

Extra Services & Fees (check box, add fee as appropriate)

Return Receipt (hardcopy) \$

Return Receipt (electronic) \$

Certified Mail Restricted Delivery \$

Adult Signature Required \$

Adult Signature Restricted Delivery \$

Postage \$

Total Postage and Fees \$

Sent To NM State Land Office
P. O. Box 1148
Santa Fe, NM 87504
See EKQU212

Street and Apt. No., or PO Box No.

City, State, ZIP+4®

PS Form 3800, January 2023 PSN 7530-02-000-9047 See Reverse for Instructions

U.S. Postal Service™ CERTIFIED MAIL® RECEIPT
Domestic Mail Only

For delivery information, visit our website at www.usps.com

OFFICIAL USE

Certified Mail Fee \$

Extra Services & Fees (check box, add fee as appropriate)

Return Receipt (hardcopy) \$

Return Receipt (electronic) \$

Certified Mail Restricted Delivery \$

Adult Signature Required \$

Adult Signature Restricted Delivery \$

Postage \$

Total Postage and Fees \$

Sent To Mewbourne Oil Co.
P. O. Box 5270
Hobbs, NM 88241
See EKQU212

Street and Apt. No., or PO Box No.

City, State, ZIP+4®

PS Form 3800, January 2023 PSN 7530-02-000-9047 See Reverse for Instructions

Received by OCD- 3/20/2026 1:11:24 PM

CERTIFIED MAIL® RECEIPT
Domestic Mail Only

For delivery information, visit our website at www.usps.com.

OFFICIAL USE

Certified Mail Fee \$

Extra Services & Fees (check box, add fee as appropriate)

Return Receipt (hardcopy) \$

Return Receipt (electronic) \$

Certified Mail Restricted Delivery \$

Adult Signature Required \$

Adult Signature Restricted Delivery \$

Postage \$

Total Postage and Fees \$

Sent To Merlyn W & Ruth Dahlin
3220 N FWY
Fort Worth, TX 76102
See EKQU212

Street and Apt. No., or PO Box No.

City, State, ZIP+4®

PS Form 3800, January 2023 PSN 7530-02-000-9047 See Reverse for Instructions

CERTIFIED MAIL® REC
Domestic Mail Only

For delivery information, visit our website at www.usps.com.

OFFICIAL USE

Certified Mail Fee \$

Extra Services & Fees (check box, add fee as appropriate)

Return Receipt (hardcopy) \$

Return Receipt (electronic) \$

Certified Mail Restricted Delivery \$

Adult Signature Required \$

Adult Signature Restricted Delivery \$

Postage \$

Total Postage and Fees \$

Sent To Manix Energy
PO Box 2818
Midland, TX 79702
See EKQU212

Street and Apt. No., or PO Box No.

City, State, ZIP+4®

PS Form 3800, January 2023 PSN 7530-02-000-9047 See Reverse for Instructions

EXHIBIT L

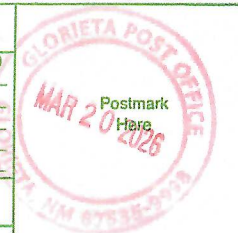

U.S. Postal Service™
CERTIFIED MAIL® RECEIPT
Domestic Mail Only

For delivery information, visit our website at www.usps.com.

OFFICIAL USE

Certified Mail Fee \$

Extra Services & Fees (check box, add fee as appropriate)

Return Receipt (hardcopy) \$

Return Receipt (electronic) \$

Certified Mail Restricted Delivery \$

Adult Signature Required \$

Adult Signature Restricted Delivery \$

Postage \$

Total Postage and Fees \$

Sent To Merlyna H Wright Family Trust
6300 Ridgela Pl, Ste 611
Fort Worth, TX 76116
See EKQU212

Street and Apt. No., or PO Box No.

City, State, ZIP+4®

PS Form 3800, January 2023 PSN 7530-02-000-9047 See Reverse for Instructions

U.S. Postal Service™
CERTIFIED MAIL® RECEIPT
Domestic Mail Only

For delivery information, visit our website at www.usps.com.

OFFICIAL USE

Certified Mail Fee \$

Extra Services & Fees (check box, add fee as appropriate)

Return Receipt (hardcopy) \$

Return Receipt (electronic) \$

Certified Mail Restricted Delivery \$

Adult Signature Required \$

Adult Signature Restricted Delivery \$

Postage \$

Total Postage and Fees \$

Sent To Lynn S Charuk
2401 Stutz Place
Midland, TX 79705
See EKQU212

Street and Apt. No., or PO Box No.

City, State, ZIP+4®

PS Form 3800, January 2023 PSN 7530-02-000-9047 See Reverse for Instructions



U.S. Postal Service™
CERTIFIED MAIL® RECEIPT
Domestic Mail Only

For delivery information, visit our website at www.usps.com.

OFFICIAL USE

Certified Mail Fee \$

Extra Services & Fees (check box, add fee as appropriate)

Return Receipt (hardcopy) \$

Return Receipt (electronic) \$

Certified Mail Restricted Delivery \$

Adult Signature Required \$

Adult Signature Restricted Delivery \$

Postage \$

Total Postage and Fees \$

Sent To Maverick Permian Agent Corp.
500 Dallas St, Ste 2300
Houston, TX 77002
See EKQU212

Street and Apt. No., or PO Box No.

City, State, ZIP+4®

PS Form 3800, January 2023 PSN 7530-02-000-9047 See Reverse for Instructions

U.S. Postal Service™
CERTIFIED MAIL® RECEIPT
Domestic Mail Only

For delivery information, visit our website at www.usps.com.

OFFICIAL USE

Certified Mail Fee \$

Extra Services & Fees (check box, add fee as appropriate)

Return Receipt (hardcopy) \$

Return Receipt (electronic) \$

Certified Mail Restricted Delivery \$

Adult Signature Required \$

Adult Signature Restricted Delivery \$

Postage \$

Total Postage and Fees \$

Sent To Kathleen A Havel
7607 Chalkstone
Dallas, TX 75219
See EKQU212

Street and Apt. No., or PO Box No.

City, State, ZIP+4®

PS Form 3800, January 2023 PSN 7530-02-000-9047 See Reverse for Instructions



CERTIFIED MAIL® RECEIPT
Domestic Mail Only

For delivery information, visit our website at www.usps.com

OFFICIAL USE

Certified Mail Fee \$

Extra Services & Fees (check box, add fee as appropriate)

Return Receipt (hardcopy) \$

Return Receipt (electronic) \$

Certified Mail Restricted Delivery \$

Adult Signature Required \$

Adult Signature Restricted Delivery \$

Postage \$

Total Postage and Fees \$

Sent To Raybaw Operating LLC
2626 Cole Ave, Ste 300
Dallas, TX 79701
See EKQU212

Street and Apt. No., or PO Box No.

City, State, ZIP+4®

PS Form 3800, January 2023 PSN 7530-02-000-9047 See Reverse for Instructions

9589 0710 5270 1338 0278 96

CERTIFIED MAIL® REC
Domestic Mail Only

For delivery information, visit our website at www.usps.com

OFFICIAL USE

Certified Mail Fee \$

Extra Services & Fees (check box, add fee as appropriate)

Return Receipt (hardcopy) \$

Return Receipt (electronic) \$

Certified Mail Restricted Delivery \$

Adult Signature Required \$

Adult Signature Restricted Delivery \$

Postage \$

Total Postage and Fees \$

Sent To PXP Gulf Coast Inc
700 Milam, #3100
Houston, TX 77002
See EKQU212

Street and Apt. No., or PO Box No.

City, State, ZIP+4®

PS Form 3800, January 2023 PSN 7530-02-000-9047 See Reverse for Instructions

EXHIBIT L

U.S. Postal Service™
CERTIFIED MAIL® RECEIPT
Domestic Mail Only

For delivery information, visit our website at www.usps.com

OFFICIAL USE

Certified Mail Fee \$

Extra Services & Fees (check box, add fee as appropriate)

Return Receipt (hardcopy) \$

Return Receipt (electronic) \$

Certified Mail Restricted Delivery \$

Adult Signature Required \$

Adult Signature Restricted Delivery \$

Postage \$

Total Postage and Fees \$

Sent To Santa Fe Exploration Co
PO Box 1136
Roswell, NM 88202
See EKQU212

Street and Apt. No., or PO Box No.

City, State, ZIP+4®

PS Form 3800, January 2023 PSN 7530-02-000-9047 See Reverse for Instructions

9589 0710 5270 1338 0275 82

U.S. Postal Service™
CERTIFIED MAIL® RECEIPT
Domestic Mail Only

For delivery information, visit our website at www.usps.com

OFFICIAL USE

Certified Mail Fee \$

Extra Services & Fees (check box, add fee as appropriate)

Return Receipt (hardcopy) \$

Return Receipt (electronic) \$

Certified Mail Restricted Delivery \$

Adult Signature Required \$

Adult Signature Restricted Delivery \$

Postage \$

Total Postage and Fees \$

Sent To BTA Oil Producers, LLC
104 S. Pecos
Midland, TX 79701
See EKQU212

Street and Apt. No., or PO Box No.

City, State, ZIP+4®

PS Form 3800, January 2023 PSN 7530-02-000-9047 See Reverse for Instructions

U.S. Postal Service™
CERTIFIED MAIL® RECEIPT
Domestic Mail Only

For delivery information, visit our website at www.usps.com

OFFICIAL USE

Certified Mail Fee \$

Extra Services & Fees (check box, add fee as appropriate)

Return Receipt (hardcopy) \$

Return Receipt (electronic) \$

Certified Mail Restricted Delivery \$

Adult Signature Required \$

Adult Signature Restricted Delivery \$

Postage \$

Total Postage and Fees \$

Sent To Ridge Runner Resources Operating
LLC
1004 N Big Spring St, Ste 325
Midland, TX 79701
See EKQU212

Street and Apt. No., or PO Box No.

City, State, ZIP+4®

PS Form 3800, January 2023 PSN 7530-02-000-9047 See Reverse for Instructions

9589 0710 5270 1338 0275 75

U.S. Postal Service™
CERTIFIED MAIL® RECEIPT
Domestic Mail Only

For delivery information, visit our website at www.usps.com

OFFICIAL USE

Certified Mail Fee \$

Extra Services & Fees (check box, add fee as appropriate)

Return Receipt (hardcopy) \$

Return Receipt (electronic) \$

Certified Mail Restricted Delivery \$

Adult Signature Required \$

Adult Signature Restricted Delivery \$

Postage \$

Total Postage and Fees \$

Sent To BPX Production Company
1000 Louisiana St, Ste 5600
Houston, TX 77002
See EKQU212

Street and Apt. No., or PO Box No.

City, State, ZIP+4®

PS Form 3800, January 2023 PSN 7530-02-000-9047 See Reverse for Instructions

9589 0710 5270 1338 0275 6

U.S. Postal Service™
CERTIFIED MAIL® RECEIPT
Domestic Mail Only

For delivery information, visit our website at www.usps.com.

OFFICIAL USE

Certified Mail Fee	\$
Extra Services & Fees (check box, add fee as appropriate)	
<input type="checkbox"/> Return Receipt (hardcopy)	\$
<input type="checkbox"/> Return Receipt (electronic)	\$
<input type="checkbox"/> Certified Mail Restricted Delivery	\$
<input type="checkbox"/> Adult Signature Required	\$
<input type="checkbox"/> Adult Signature Restricted Delivery	\$
Postage	\$
Total Postage and Fees	\$

Sent To: **Boswell Interests & Trust**
1320 Lake St
Fort Worth, TX 76102
See: EKQU212

Street and Apt. No., or P.O. Box No.
City, State, ZIP+4®

PS Form 3800, January 2023 PSN 7530-02-000-9047 See Reverse for Instructions



9589 0710 5270 1338 0275 37

U.S. Postal Service™
CERTIFIED MAIL® RECEIPT
Domestic Mail Only

For delivery information, visit our website at www.usps.com.

OFFICIAL USE

Certified Mail Fee	\$
Extra Services & Fees (check box, add fee as appropriate)	
<input type="checkbox"/> Return Receipt (hardcopy)	\$
<input type="checkbox"/> Return Receipt (electronic)	\$
<input type="checkbox"/> Certified Mail Restricted Delivery	\$
<input type="checkbox"/> Adult Signature Required	\$
<input type="checkbox"/> Adult Signature Restricted Delivery	\$
Postage	\$
Total Postage and Fees	\$

Sent To: **Bellwether Exploration Co**
1221 Lamar #1600
Houston, TX 77010
See: EKQU212

Street and Apt. No., or P.O. Box No.
City, State, ZIP+4®

PS Form 3800, January 2023 PSN 7530-02-000-9047 See Reverse for Instructions



EXHIBIT L

9589 0710 5270 1338 0275 51

U.S. Postal Service™
CERTIFIED MAIL® RECEIPT
Domestic Mail Only

For delivery information, visit our website at www.usps.com.

OFFICIAL USE

Certified Mail Fee	\$
Extra Services & Fees (check box, add fee as appropriate)	
<input type="checkbox"/> Return Receipt (hardcopy)	\$
<input type="checkbox"/> Return Receipt (electronic)	\$
<input type="checkbox"/> Certified Mail Restricted Delivery	\$
<input type="checkbox"/> Adult Signature Required	\$
<input type="checkbox"/> Adult Signature Restricted Delivery	\$
Postage	\$
Total Postage and Fees	\$

Sent To: **BLM**
520 E. Greene St.
Carlsbad, NM 88220
See: EKQU212

Street and Apt. No., or P.O. Box No.
City, State, ZIP+4®

PS Form 3800, January 2023 PSN 7530-02-000-9047 See Reverse for Instructions



9589 0710 5270 1338 0275 20

U.S. Postal Service™
CERTIFIED MAIL® RECEIPT
Domestic Mail Only

For delivery information, visit our website at www.usps.com.

OFFICIAL USE

Certified Mail Fee	\$
Extra Services & Fees (check box, add fee as appropriate)	
<input type="checkbox"/> Return Receipt (hardcopy)	\$
<input type="checkbox"/> Return Receipt (electronic)	\$
<input type="checkbox"/> Certified Mail Restricted Delivery	\$
<input type="checkbox"/> Adult Signature Required	\$
<input type="checkbox"/> Adult Signature Restricted Delivery	\$
Postage	\$
Total Postage and Fees	\$

Sent To: **Amy Dahlin Vernae Trust**
6300 Riddlea Pl, Ste 611
Fort Worth, TX 76116
See: EKQU212

Street and Apt. No., or P.O. Box No.
City, State, ZIP+4®

PS Form 3800, January 2023 PSN 7530-02-000-9047 See Reverse for Instructions



9589 0710 5270 1338 0275 44

U.S. Postal Service™
CERTIFIED MAIL® RECEIPT
Domestic Mail Only

For delivery information, visit our website at www.usps.com.

OFFICIAL USE

Certified Mail Fee	\$
Extra Services & Fees (check box, add fee as appropriate)	
<input type="checkbox"/> Return Receipt (hardcopy)	\$
<input type="checkbox"/> Return Receipt (electronic)	\$
<input type="checkbox"/> Certified Mail Restricted Delivery	\$
<input type="checkbox"/> Adult Signature Required	\$
<input type="checkbox"/> Adult Signature Restricted Delivery	\$
Postage	\$
Total Postage and Fees	\$

Sent To: **Black Shale Minerals LLC**
5006 State Highway 31 N
Longview, TX 75603
See: EKQU212

Street and Apt. No., or P.O. Box No.
City, State, ZIP+4®

PS Form 3800, January 2023 PSN 7530-02-000-9047 See Reverse for Instructions



9589 0710 5270 1338 0275 13

U.S. Postal Service™
CERTIFIED MAIL® RECEIPT
Domestic Mail Only

For delivery information, visit our website at www.usps.com.

OFFICIAL USE

Certified Mail Fee	\$
Extra Services & Fees (check box, add fee as appropriate)	
<input type="checkbox"/> Return Receipt (hardcopy)	\$
<input type="checkbox"/> Return Receipt (electronic)	\$
<input type="checkbox"/> Certified Mail Restricted Delivery	\$
<input type="checkbox"/> Adult Signature Required	\$
<input type="checkbox"/> Adult Signature Restricted Delivery	\$
Postage	\$
Total Postage and Fees	\$

Sent To: **Apache Corporation**
303 Veterans Airpark Ln, Ste 3000
Midland, TX 79705
See: EKQU212

Street and Apt. No., or P.O. Box No.
City, State, ZIP+4®

PS Form 3800, January 2023 PSN 7530-02-000-9047 See Reverse for Instructions



CERTIFIED MAIL® RECEIPT

Domestic Mail Only

For delivery information, visit our website at www.usps.com®.

OFFICIAL USE

Certified Mail Fee

Extra Services & Fees (check box, add fee as appropriate)

Return Receipt (hardcopy) \$ _____

Return Receipt (electronic) \$ _____

Certified Mail Restricted Delivery \$ _____

Adult Signature Required \$ _____

Adult Signature Restricted Delivery \$ _____



Postage

Total Postage and Fees

Apache Corporation
2000 W. Sam Houston Pkwy S, Ste 200
Houston, TX 77042
See: EKQU212

Sent To

Street and Apt. No., or P.O. Box No.

City, State, ZIP+4®

PS Form 3800, April 2015 PSN 7530-02-000-9047

See Reverse for Instructions

CERTIFIED MAIL® RECEIPT

Domestic Mail Only

EXHIBIT L

For delivery information, visit our website at www.usps.com®.

OFFICIAL USE

Certified Mail Fee

Extra Services & Fees (check box, add fee as appropriate)

Return Receipt (hardcopy) \$ _____

Return Receipt (electronic) \$ _____

Certified Mail Restricted Delivery \$ _____

Adult Signature Required \$ _____

Adult Signature Restricted Delivery \$ _____

Postmark Here

Postage

Total Postage and Fees

Hill Houston Trust
500 W 7th St, Ste 1802 Unit 16
Fort Worth, TX 76102
See: EKQU212

Sent To

Street and Apt. No., or P.O. Box No.

City, State, ZIP+4®

PS Form 3800, January 2023 PSN 7530-02-000-9047

See Reverse for Instructions

U.S. Postal Service™ CERTIFIED MAIL® RECEIPT

Domestic Mail Only

For delivery information, visit our website at www.usps.com®.

Certified Mail Fee

Extra Services & Fees (check box, add fee as appropriate)

Return Receipt (hardcopy) \$ _____

Return Receipt (electronic) \$ _____

Certified Mail Restricted Delivery \$ _____

Adult Signature Required \$ _____

Adult Signature Restricted Delivery \$ _____

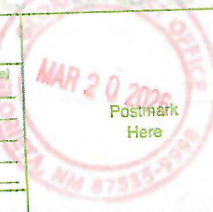

Postage

Total Postage and Fees

Hunt Cimarron LP
P.O. Box 1592
Roswell, NM 88202
See: EKQU212

Sent To

Street and Apt. No., or P.O. Box No.

City, State, ZIP+4®

PS Form 3800, January 2023 PSN 7530-02-000-9047

See Reverse for Instructions

U.S. Postal Service™ CERTIFIED MAIL® RECEIPT

Domestic Mail Only

For delivery information, visit our website at www.usps.com®.

OFFICIAL USE

Certified Mail Fee

Extra Services & Fees (check box, add fee as appropriate)

Return Receipt (hardcopy) \$ _____

Return Receipt (electronic) \$ _____

Certified Mail Restricted Delivery \$ _____

Adult Signature Required \$ _____

Adult Signature Restricted Delivery \$ _____

Postmark Here

Postage

Total Postage and Fees

Express Air Drilling
3833 Oak Lawn Ave
Dallas, TX 75219
See: EKQU212

Sent To

Street and Apt. No., or P.O. Box No.

City, State, ZIP+4®

PS Form 3800, January 2023 PSN 7530-02-000-9047

See Reverse for Instructions

U.S. Postal Service™ CERTIFIED MAIL® RECEIPT

Domestic Mail Only

For delivery information, visit our website at www.usps.com®.

Certified Mail Fee

Extra Services & Fees (check box, add fee as appropriate)

Return Receipt (hardcopy) \$ _____

Return Receipt (electronic) \$ _____

Certified Mail Restricted Delivery \$ _____

Adult Signature Required \$ _____

Adult Signature Restricted Delivery \$ _____



Postage

Total Postage and Fees

J C Thompson & J C Thompson Jr LP
325 N. St Paul St, Ste 4300
Dallas, TX 75201
See: EKQU212

Sent To

Street and Apt. No., or P.O. Box No.

City, State, ZIP+4®

PS Form 3800, January 2023 PSN 7530-02-000-9047

See Reverse for Instructions

U.S. Postal Service™ CERTIFIED MAIL® RECEIPT

Domestic Mail Only

For delivery information, visit our website at www.usps.com®.

OFFICIAL USE

Certified Mail Fee

Extra Services & Fees (check box, add fee as appropriate)

Return Receipt (hardcopy) \$ _____

Return Receipt (electronic) \$ _____

Certified Mail Restricted Delivery \$ _____

Adult Signature Required \$ _____

Adult Signature Restricted Delivery \$ _____

Postmark Here

Postage

Total Postage and Fees

Hill Houston
500 Throckmorton St
Fort Worth, TX 76102
See: EKQU212

Sent To

Street and Apt. No., or P.O. Box No.

City, State, ZIP+4®

PS Form 3800, January 2023 PSN 7530-02-000-9047

See Reverse for Instructions

CERTIFIED MAIL® RECEIPT
Domestic Mail Only

For delivery information, visit our website at www.usps.com

OFFICIAL USE

Certified Mail Fee
\$

Extra Services & Fees (check box, add fee as appropriate)

- Return Receipt (hardcopy) \$
- Return Receipt (electronic) \$
- Certified Mail Restricted Delivery \$
- Adult Signature Required \$
- Adult Signature Restricted Delivery \$

Postage
\$

Total Postage and Fees
\$

Sent To
EAB Oil Co
1320 Lake St
Fort Worth, TX 76102
See EKQU212

Street and Apt. No., or PO Box No.
City, State, ZIP+4®

PS Form 3800, January 2023 PSN 7530-02-000-9047 See Reverse for Instructions



CERTIFIED MAIL® RECEIPT
Domestic Mail Only

For delivery information, visit our website at www.usps.com

OFFICIAL USE

Certified Mail Fee
\$

Extra Services & Fees (check box, add fee as appropriate)

- Return Receipt (hardcopy) \$
- Return Receipt (electronic) \$
- Certified Mail Restricted Delivery \$
- Adult Signature Required \$
- Adult Signature Restricted Delivery \$

Postage
\$

Total Postage and Fees
\$

Sent To
C W & Ina Seely
815 W 10th St
Fort Worth, TX 76102
See EKQU212

Street and Apt. No., or PO Box No.
City, State, ZIP+4®

PS Form 3800, January 2023 PSN 7530-02-000-9047 See Reverse for Instructions



U.S. Postal Service™
CERTIFIED MAIL® RECEIPT
Domestic Mail Only

For delivery information, visit our website at www.usps.com

OFFICIAL USE

Certified Mail Fee
\$

Extra Services & Fees (check box, add fee as appropriate)

- Return Receipt (hardcopy) \$
- Return Receipt (electronic) \$
- Certified Mail Restricted Delivery \$
- Adult Signature Required \$
- Adult Signature Restricted Delivery \$

Postage
\$

Total Postage and Fees
\$

Sent To
Devon Energy Prod Company LP
333 W Sheridan Ave
Oklahoma City, OK 73102
See EKQU212

Street and Apt. No., or PO Box No.
City, State, ZIP+4®

PS Form 3800, January 2023 PSN 7530-02-000-9047 See Reverse for Instructions



U.S. Postal Service™
CERTIFIED MAIL® RECEIPT
Domestic Mail Only

For delivery information, visit our website at www.usps.com

OFFICIAL USE

Certified Mail Fee
\$

Extra Services & Fees (check box, add fee as appropriate)

- Return Receipt (hardcopy) \$
- Return Receipt (electronic) \$
- Certified Mail Restricted Delivery \$
- Adult Signature Required \$
- Adult Signature Restricted Delivery \$

Postage
\$

Total Postage and Fees
\$

Sent To
PXP Gulf Coast Inc
500 Dallas St, #700
Houston, TX 77002
See EKQU212

Street and Apt. No., or PO Box No.
City, State, ZIP+4®

PS Form 3800, January 2023 PSN 7530-02-000-9047 See Reverse for Instructions



U.S. Postal Service™
CERTIFIED MAIL® RECEIPT
Domestic Mail Only

For delivery information, visit our website at www.usps.com

OFFICIAL USE

Certified Mail Fee
\$

Extra Services & Fees (check box, add fee as appropriate)

- Return Receipt (hardcopy) \$
- Return Receipt (electronic) \$
- Certified Mail Restricted Delivery \$
- Adult Signature Required \$
- Adult Signature Restricted Delivery \$

Postage
\$

Total Postage and Fees
\$

Sent To
David L & Dawn Henderson
815 W 10th St
Fort Worth, TX 76102
See EKQU212

Street and Apt. No., or PO Box No.
City, State, ZIP+4®

PS Form 3800, January 2023 PSN 7530-02-000-9047 See Reverse for Instructions

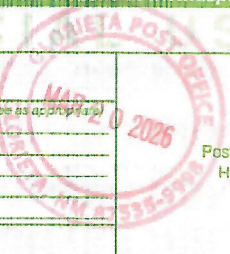

U.S. Postal Service™
CERTIFIED MAIL® RECEIPT
Domestic Mail Only

For delivery information, visit our website at www.usps.com

OFFICIAL USE

Certified Mail Fee
\$

Extra Services & Fees (check box, add fee as appropriate)

- Return Receipt (hardcopy) \$
- Return Receipt (electronic) \$
- Certified Mail Restricted Delivery \$
- Adult Signature Required \$
- Adult Signature Restricted Delivery \$

Postage
\$

Total Postage and Fees
\$

Sent To
ZPZ Delaware
2000 Post Oak Blvd
Houston, TX 77056
See EKQU212

Street and Apt. No., or PO Box No.
City, State, ZIP+4®

PS Form 3800, January 2023 PSN 7530-02-000-9047 See Reverse for Instructions



9589 0710 5270 1338 0278 72

**U.S. Postal Service™
CERTIFIED MAIL® RECEIPT**
Domestic Mail Only

For delivery information, visit our website at www.usps.com

OFFICIAL USE

Certified Mail Fee \$

Extra Services & Fees (check box, add fee as appropriate)

Return Receipt (hardcopy) \$

Return Receipt (electronic) \$

Certified Mail Restricted Delivery \$

Adult Signature Required \$

Adult Signature Restricted Delivery \$

Postage \$

Total Postage and Fees \$

Sent To **OXY USA WTP LP**
5 Greenway Plaza
Houston, TX 77046
See EKQU212

Street and Apt. No., or PO Box No.
City, State, ZIP+4®

PS Form 3800, January 2023 PSN 7530-02-000-9047 See Reverse for Instructions

GLORIETA POST OFFICE
MAR 20 2026
87525-9988

9589 0710 5270 1338 0277 59

**U.S. Postal Service™
CERTIFIED MAIL® RECEIPT**
Domestic Mail Only

For delivery information, visit our website at www.usps.com

OFFICIAL USE

Certified Mail Fee \$

Extra Services & Fees (check box, add fee as appropriate)

Return Receipt (hardcopy) \$

Return Receipt (electronic) \$

Certified Mail Restricted Delivery \$

Adult Signature Required \$

Adult Signature Restricted Delivery \$

Postage \$

Total Postage and Fees \$

Sent To **John P Oil Co**
1320 Lake St
Fort Worth, TX 76102
See EKQU212

Street and Apt. No., or PO Box No.
City, State, ZIP+4®

PS Form 3800, January 2023 PSN 7530-02-000-9047 See Reverse for Instructions

GLORIETA POST OFFICE
MAR 20 2026
87525-9988

EXHIBIT L

9589 0710 5270 1338 0279 95

**U.S. Postal Service™
CERTIFIED MAIL® RECEIPT**
Domestic Mail Only

For delivery information, visit our website at www.usps.com

OFFICIAL USE

Certified Mail Fee \$

Extra Services & Fees (check box, add fee as appropriate)

Return Receipt (hardcopy) \$

Return Receipt (electronic) \$

Certified Mail Restricted Delivery \$

Adult Signature Required \$

Adult Signature Restricted Delivery \$

Postage \$

Total Postage and Fees \$

Sent To **XTO Holdings LLC**
22777 Springwoods Village Pkwy
Spring, TX 77389
See EKQU212

Street and Apt. No., or PO Box No.
City, State, ZIP+4®

PS Form 3800, January 2023 PSN 7530-02-000-9047 See Reverse for Instructions

GLORIETA POST OFFICE
MAR 20 2026
87525-9988

9589 0710 5270 1338 0279 71

**U.S. Postal Service™
CERTIFIED MAIL® RECEIPT**
Domestic Mail Only

For delivery information, visit our website at www.usps.com

OFFICIAL USE

Certified Mail Fee \$

Extra Services & Fees (check box, add fee as appropriate)

Return Receipt (hardcopy) \$

Return Receipt (electronic) \$

Certified Mail Restricted Delivery \$

Adult Signature Required \$

Adult Signature Restricted Delivery \$

Postage \$

Total Postage and Fees \$

Sent To **Wes-Tex Drilling Co LP**
400 Pine St #700
Abilene, TX 76901
See EKQU212

Street and Apt. No., or PO Box No.
City, State, ZIP+4®

PS Form 3800, January 2023 PSN 7530-02-000-9047 See Reverse for Instructions

GLORIETA POST OFFICE
MAR 20 2026
87525-9988

1307 0710 5270 1338 0279 88

**U.S. Postal Service™
CERTIFIED MAIL® RECEIPT**
Domestic Mail Only

For delivery information, visit our website at www.usps.com

OFFICIAL USE

Certified Mail Fee \$

Extra Services & Fees (check box, add fee as appropriate)

Return Receipt (hardcopy) \$

Return Receipt (electronic) \$

Certified Mail Restricted Delivery \$

Adult Signature Required \$

Adult Signature Restricted Delivery \$

Postage \$

Total Postage and Fees \$

Sent To **Woody L Hunt**
4401 N. Mesa #201
El Paso, TX 79902
See EKQU212

Street and Apt. No., or PO Box No.
City, State, ZIP+4®

PS Form 3800, January 2023 PSN 7530-02-000-9047 See Reverse for Instructions

GLORIETA POST OFFICE
MAR 20 2026
87525-9988

9589 0710 5270 1338 0279 64

**U.S. Postal Service™
CERTIFIED MAIL® RECEIPT**
Domestic Mail Only

For delivery information, visit our website at www.usps.com

OFFICIAL USE

Certified Mail Fee \$

Extra Services & Fees (check box, add fee as appropriate)

Return Receipt (hardcopy) \$

Return Receipt (electronic) \$

Certified Mail Restricted Delivery \$

Adult Signature Required \$

Adult Signature Restricted Delivery \$

Postage \$

Total Postage and Fees \$

Sent To **Trigg Oil & Gas LP**
PO Box 520
Roswell, NM 88202
See EKQU212

Street and Apt. No., or PO Box No.
City, State, ZIP+4®

PS Form 3800, January 2023 PSN 7530-02-000-9047 See Reverse for Instructions

GLORIETA POST OFFICE
MAR 20 2026
87525-9988

EXHIBIT L

9589 0710 5270 1338 0279 57

U.S. Postal Service™
CERTIFIED MAIL® RECEIPT
Domestic Mail Only

For delivery information, visit our website at www.usps.com

OFFICIAL USE

Certified Mail Fee \$ _____

Extra Services & Fees (check box, add fee as appropriate)

Return Receipt (hardcopy) \$ _____

Return Receipt (electronic) \$ _____

Certified Mail Restricted Delivery \$ _____

Adult Signature Required \$ _____

Adult Signature Restricted Delivery \$ _____

Postage \$ _____

Total Postage and Fees \$ _____

Sent To **SSV&H Associates**
 815 W 10th St
 Fort Worth, TX 76102
 See EKQU212

Street and Apt. No., or P.O. Box No. _____

City, State, ZIP+4® _____

PS Form 3800, January 2023 PSN 7530-02-000-9047 See Reverse for Instructions



9589 0710 5270 1338 0277 66

U.S. Postal Service™
CERTIFIED MAIL® RECEIPT
Domestic Mail Only

For delivery information, visit our website at www.usps.com

OFFICIAL USE

Certified Mail Fee \$ _____

Extra Services & Fees (check box, add fee as appropriate)

Return Receipt (hardcopy) \$ _____

Return Receipt (electronic) \$ _____

Certified Mail Restricted Delivery \$ _____

Adult Signature Required \$ _____

Adult Signature Restricted Delivery \$ _____

Postage \$ _____

Total Postage and Fees \$ _____

Sent To **J R Oil, Ltd. Co.**
 P.O. Box 53657
 Lubbock, TX 79453
 See EKQU212

Street and Apt. No., or P.O. Box No. _____

City, State, ZIP+4® _____

PS Form 3800, January 2023 PSN 7530-02-000-9047 See Reverse for Instructions



9589 0710 5270 1338 0279 40

U.S. Postal Service™
CERTIFIED MAIL® RECEIPT
Domestic Mail Only

For delivery information, visit our website at www.usps.com

OFFICIAL USE

Certified Mail Fee \$ _____

Extra Services & Fees (check box, add fee as appropriate)

Return Receipt (hardcopy) \$ _____

Return Receipt (electronic) \$ _____

Certified Mail Restricted Delivery \$ _____

Adult Signature Required \$ _____

Adult Signature Restricted Delivery \$ _____

Postage \$ _____

Total Postage and Fees \$ _____

Sent To **Santa Fe Snyder Corp c/o Devon**
 333 W. Sheridan
 Oklahoma City, OK 73102
 See EKQU212

Street and Apt. No., or P.O. Box No. _____

City, State, ZIP+4® _____

PS Form 3800, January 2023 PSN 7530-02-000-9047 See Reverse for Instructions



EXHIBIT B

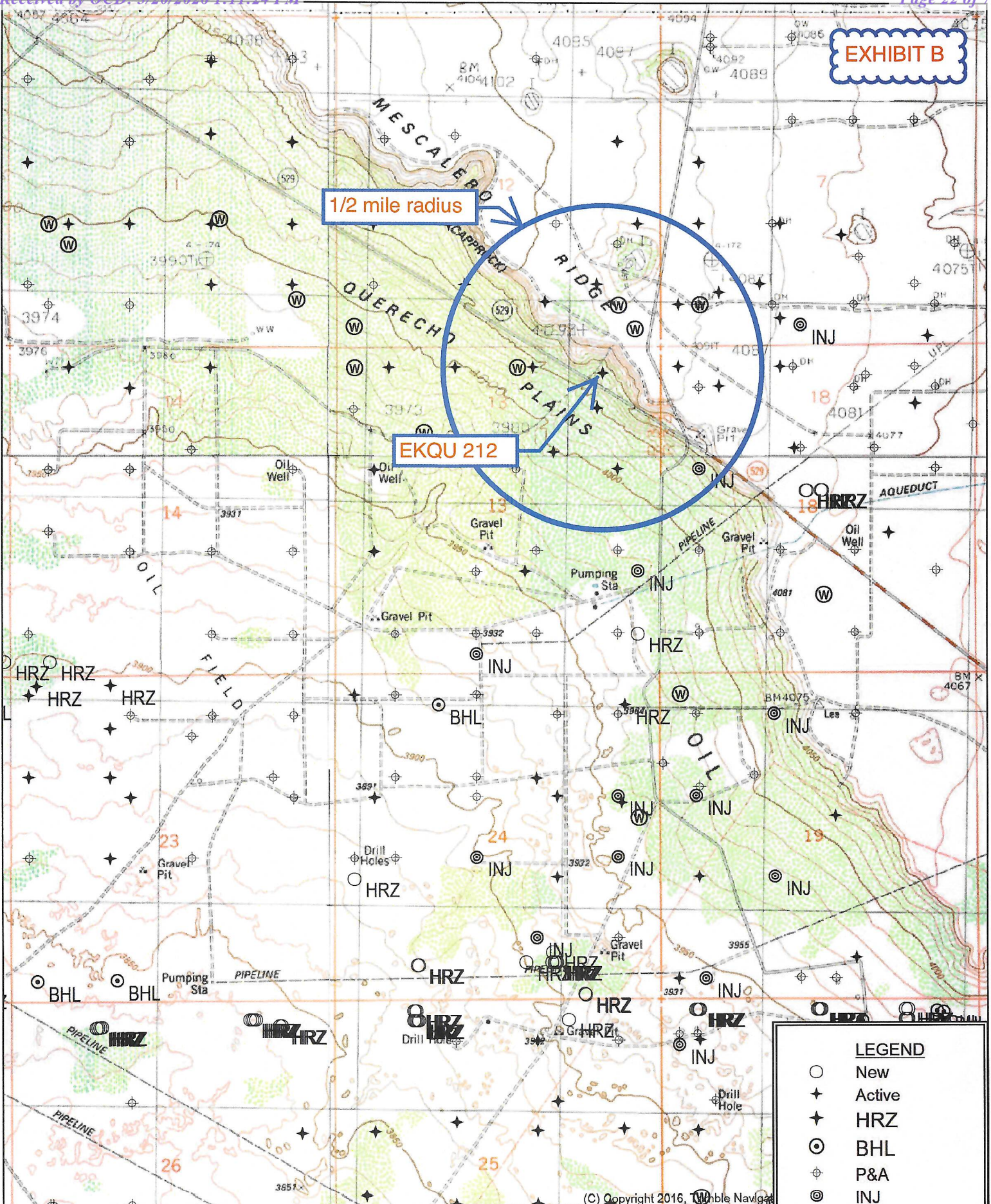

1/2 mile radius

EKQU 212

LEGEND

- New
- ★ Active
- ✦ HRZ
- ⊙ BHL
- ⊕ P&A
- ⊗ INJ
- ⊚ SWD
- ⊛ Brine
- ⊜ Water



Quad: IRONHOUSE WELL
 Scale: 1 inch = 2,000 ft.

(C) Copyright 2016, Tomable Navigat

SORTED BY DISTANCE FROM EKQU 212

API	OPERATOR	WELL	SHL UNIT-SECTION	TYPE WELL	TVD	ZONE @ TD	FEET FROM EKQU 212
3002555562	Mewbourne	Pile Driver 24 13 Federal Com 528H	P-24	O	plan 9107	Bone Spring	300
3002534324	Seely	EK Queen Unit 028	A-13	O	4687	Queen	566
3002555561	Mewbourne	Pile Driver 24 13 Federal Com 526H	P-24	O	plan 9236	Bone Spring	1020
3002529279	Seely	Mescalero Ridge Federal 001	B-13	O	9300	Bone Spring	1144
3002529305	Seely	Mescalero Ridge C Federal 001	D-18	O	9180	Bone Spring	1236
3002528800	Seely	State DW 005	P-12	O	9030	Bone Spring	1425
3002528895	J R Oil	State DW 008	O-12	O	9080	Bone Spring	1476
3002529604	Seely	EK Queen Unit 210	G-13	O	9300	Bone Spring	1506
3002534325	Seely	EK Queen Unit 029	H-13	O	4704	Queen	1565
3002502341	TJ Sively	Fox 002	D-18	P&A	4441	Queen	1579
3002528773	Seely	Lea XA State 002	M-7	O	8970	Bone Spring	1649
3002538609	Seely	Mescalero Ridge C Federal 002	D-18	O	9140	Bone Spring	1905
3002502306	Seely	Central EK Queen Unit 015	M-7	P&A	4385	Queen	1910
3002501600	Plateau	British American State 001	I-12	P&A	5513	San Andres	2097
3002501606	TJ Sively	Sively 13 Federal 005	G-13	P&A	4369	Queen	2105
3002502340	Seely	EK Queen Unit 041	E-18	I	4413	Queen	2196
3002555560	Mewbourne	Pile Driver 24 13 Federal Com 524H	N-24	O	plan 9123	Bone Spring	2280
3002534955	Seely	Central EK Queen Unit 017	M-7	O	4504	Queen	2293
3002529315	Seely	Mescalero Ridge B Federal 001	C-13	O	9220	Bone Spring	2384
3002528838	J R Oil	State DW 006	I-12	O	8914	Bone Spring	2481
3002528575	Oxy USA	State DW 001	J-12	P&A	11094	Wolfcamp	2526

EXHIBIT B

SORTED BY DISTANCE FROM EKQU 212

API	OPERATOR	WELL	SHL UNIT-SECTION	TYPE WELL	TVD	ZONE @ TD	FEET FROM EKQU 212
3002529023	J R Oil	State DW 010	N-12	O	9097	Bone Spring	2642

EXHIBIT B

EXHIBIT C

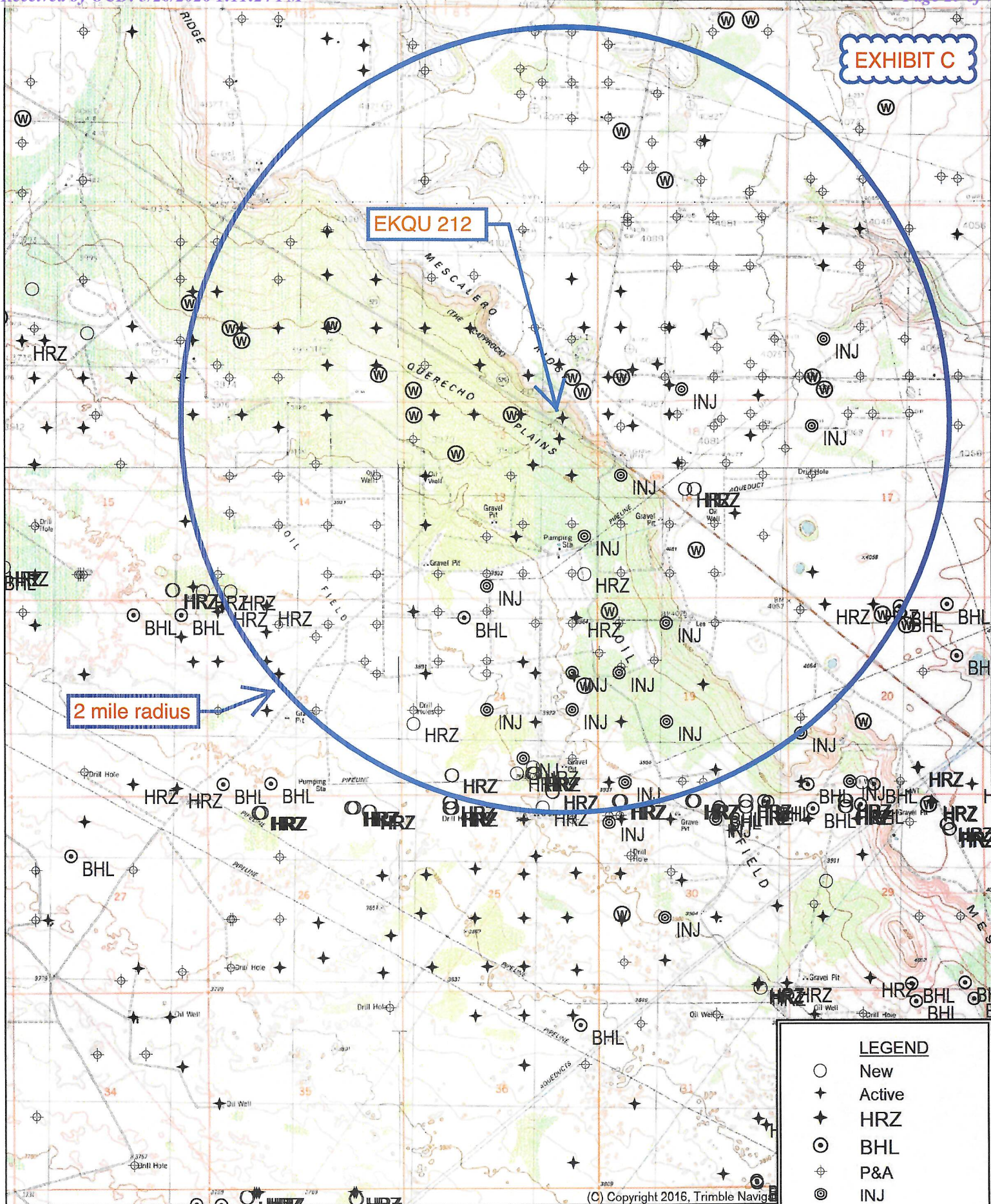

EKQU 212

2 mile radius

LEGEND	
○	New
+	Active
★	HRZ
⊙	BHL
⊕	P&A
⊗	INJ
⊚	SWD
⊛	Brine
⊜	Water



Quad: HOBBS
 Scale: 1 inch = 3,333 ft.

(C) Copyright 2016, Trimble Navigation

EKQU 212 AREA OF REVIEW LEASES AND OPERATORS

Aliquot Parts in Area of Review	Lessor	Lease	Lessee of Record	Well Operator
T 18 S, R 33 E				
N2SE4 & NESW Sec. 12	NMSLO	LG-1543-0003	Oxy USA WTP	J R Oil & Seely Oil
SESW & S2SE4 Sec. 12	NMSLO	LG-3228-0002	BTA	J R Oil & Seely Oil
NE4 & N2SE4 Sec. 13	BLM	NMLC-0063645, aka, NMNM-105443610	Seely Oil	Mewbourne & Seely Oil
E2NW4 Sec. 13	BLM	NMNM-004591, aka, NMNM-105336532	Seely Oil	Mewbourne & Seely Oil
T 18 S, R 34 E				
W2SW4 & SESW Sec. 7	NMSLO	LG-4226-0001	Devon	Seely Oil
NENW Sec. 18	BLM	NMNM-0559378, aka, NMNM-105446061	Seely Oil	Seely Oil
W2NW4 & SENW Sec. 18	BLM	NMLC-0065394B, aka, NMNM105557694	PXP Gulf	Seely Oil
NWSW Sec. 18	BLM	NMLC-0065394, aka, NMNM-105503516	Maverick Permian	Mewbourne & Seely Oil

EXHIBIT D

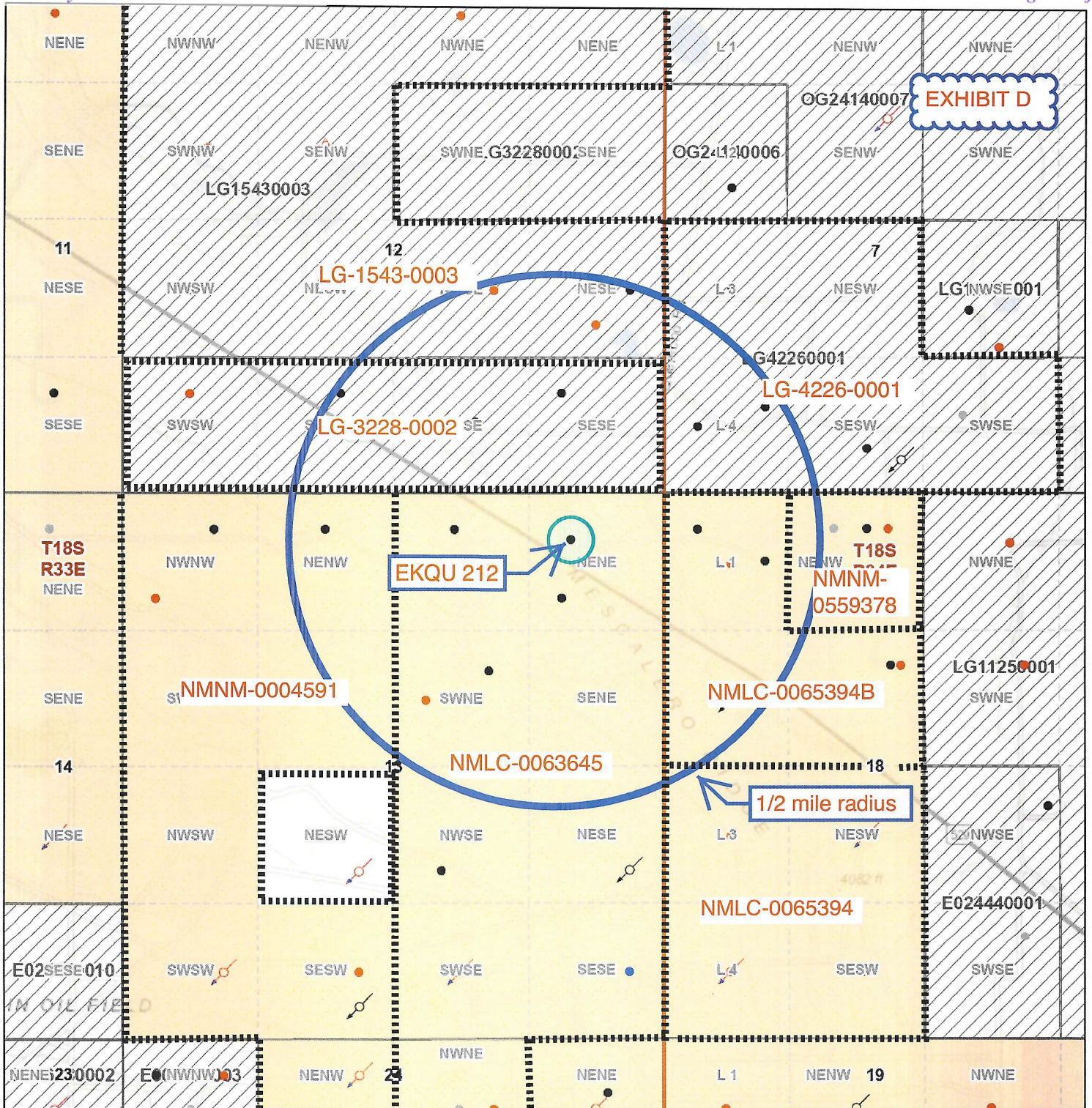

Oil, Gas, and Minerals Leases and Wells

0 0.1 0.2 0.4 mi

New Mexico State Land Office

Disclaimer:
The New Mexico State Land Office assumes no responsibility or liability for, or in connection with the accuracy, reliability or use of the information provided herein with respect to State Land Office data or data from other sources.

Data pertaining to New Mexico State Trust Lands are provisional and subject to revision, and do not constitute an official record of title. Official records may be reviewed at the New Mexico State Land Office in Santa Fe, New Mexico.

Map Created: 3/15/2026

	Override 1		NMOC_D_Inactive Symbology
	Subdivisions		Miscellaneous
	Sections		CO2 Cancelled
	Townships		CO2, Plugged
	County Boundaries		CO2, Temporarily Abandoned
	State Boundary		Gas, Cancelled
	County Seats		Gas, Plugged

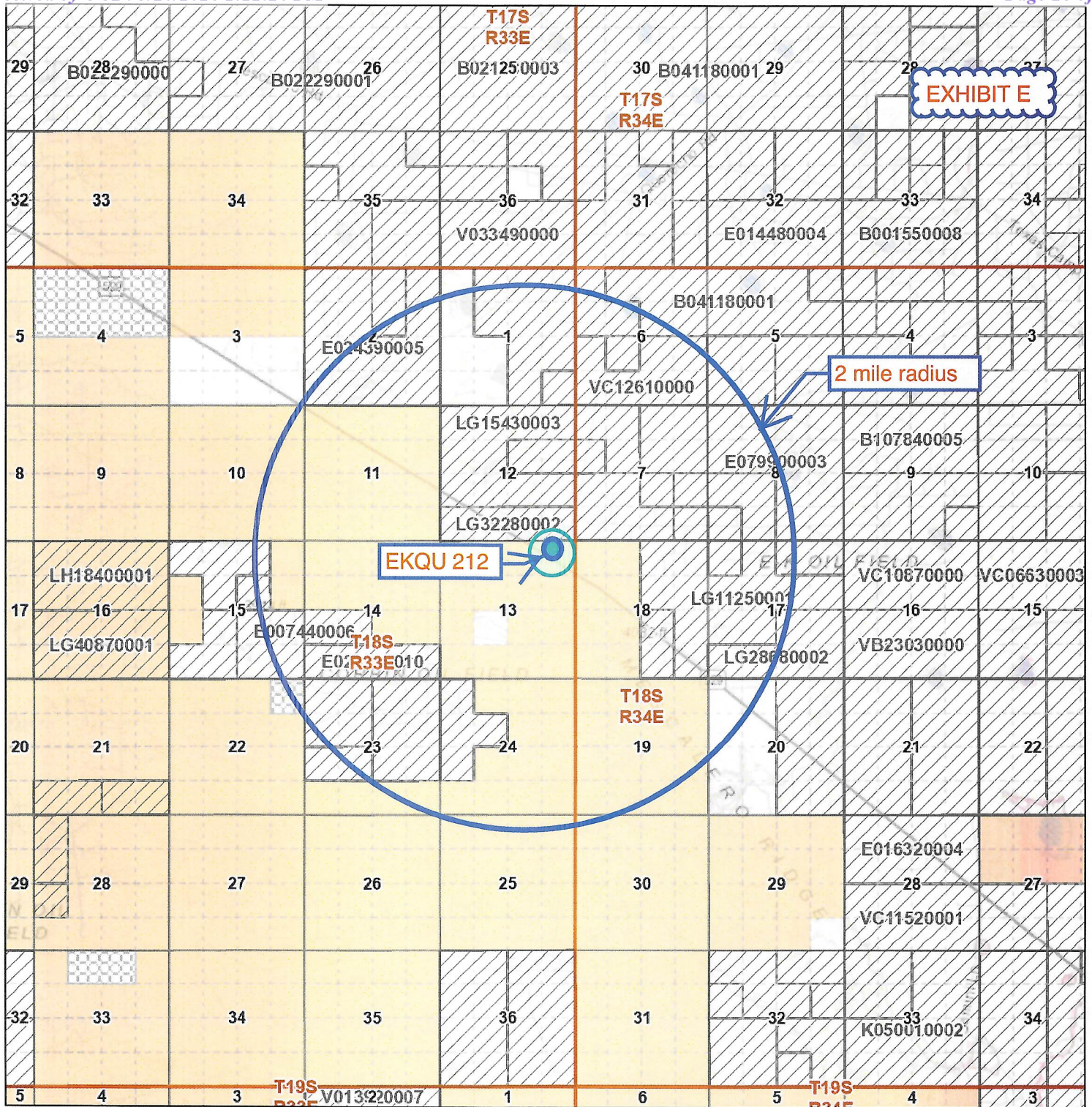

Oil, Gas, and Minerals Leases and Wells

0 0.42 0.85 1.7 mi

New Mexico State Land Office

Disclaimer:
The New Mexico State Land Office assumes no responsibility or liability for, or in connection with the accuracy, reliability or use of the information provided herein with respect to State Land Office data or data from other sources.
Data pertaining to New Mexico State Trust Lands are provisional and subject to revision, and do not constitute an official record of title. Official records may be reviewed at the New Mexico State Land Office in Santa Fe, New Mexico.

Map Created: 3/15/2026

	Override 1		County Seats
	Subdivisions		Oil and Gas Leases
	Sections		Federal Minerals Ownership
	Townships		All Minerals
	County Boundaries		Coal Only
	State Boundary		Oil and Gas Only
			Oil, Gas and Coal Only
			Other Minerals

Sorted by distance from EK Queen Unit 212

WELL	SPUD	TVD	STATUS	ZONE @ TD	HOLE O.D.	CASING O.D.	SET @ TVD	CEMENT	TOC	HOW TOC DETERMINED
Pile Driver 24 13 Federal Com 528H	not yet	plan 9107	O	Bone Spring	17.5	13.375	1750	1230 sx	GL	not yet
3002555562					12.25	9.625	5300	1030 sx	GL	not yet
P-24-18s-33e					8.75	7	9189	4460 sx	5100	not yet
					8.5	4.5	9107			
EK Queen Unit 028	7/28/98	4687	O	Queen	12.25	8.625	1723	810 sx	GL	No report
3002534324					7.875	5.5	4664	600 sx	1620	CBL
A-13-18S-33E										
Pile Driver 24 13 Federal Com 526H	not yet	plan 9236	O	Bone Spring	17.5	13.375	1750	1230 sx	GL	not yet
3002555561					12.25	9.625	5300	1030 sx	GL	not yet
P-24-18s-33e					8.75	7	9106	4460 sx	5100	not yet
					8.5	4.5	9137			

Sorted by distance from EK Queen Unit 212

WELL	SPUD	TVD	STATUS	ZONE @ TD	HOLE O.D.	CASING O.D.	SET @ TVD	CEMENT	TOC	HOW TOC DETERMINED
Mescalero Ridge Federal 001	5/31/85	9300	O	Bone Spring	17.5	13.375	360	375 sx	GL	Circ 130 sx
3002529279					11	8.625	3300	1300 sx	GL	Circ 530 sx
B-13-18S-33E					7.875	5.5	9300	1600 sx	500	Temp survey
Mescalero Ridge C Federal 001	9/20/85	9180	O	Bone Spring	17.5	13.375	365	375 sx	GL	Circ 135 sx
3002529305					12.25	8.625	3300	1050 sx	GL	Circ 250 sx
D-18-18S-34E					7.875	5.5	9180	1950 sx	No report	No report
State DW 005	7/24/84	9030	O	Bone Spring	17.5	13.375	348	500 sx	GL	Circ 50 sx
3002528800					11	8.625	3300	1300 sx	GL	Circ 150 sx
P-12-18S-33E					7.875	5.5	9030	1335 sx	3300	Temp survey

Sorted by distance from EK Queen Unit 212

WELL	SPUD	TVD	STATUS	ZONE @ TD	HOLE O.D.	CASING O.D.	SET @ TVD	CEMENT	TOC	HOW TOC DETERMINED
State DW 008	9/11/84	9080	O	Bone Spring	17.5	13.375	350	500 sx	GL	Circ
3002528895					11	8.625	3140	1300 sx	GL	Circ 150 sx
O-12-18S-33E					7.875	5.5	9072	2550 sx	3100	Temp survey
EK Queen Unit 210	4/20/02	9300	O	Bone Spring	17.25	13.375	364	375 sx	GL	Circ 105 sx
3002529604					12.25	8.625	3264	900 sx	GL	Circ 100 sx
G-13-18S-33E					7.875	5.5	9300	1450 sx	500	Temp survey
EK Queen Unit 029	3/21/98	4704	O	Queen	11	8.625	1764	505 sx	GL	No report
3002534325					7.875	5.5	4703	1545 sx	750	No report
H-13-18S-33E										

Sorted by distance from EK Queen Unit 212

WELL	SPUD	TVD	STATUS	ZONE @ TD	HOLE O.D.	CASING O.D.	SET @ TVD	CEMENT	TOC	HOW TOC DETERMINED
Fox 002	9/12/55	4441	P&A	Queen	No report	8.625	299	175 sx	No report	No report
3002502341										
D-18-18S-34E										
Lea XA State 002	6/19/84	8970	O	Bone Spring	17.5	13.375	565	500 sx	GL	Circ 125 sx
3002528773					11	8.625	4466	1600 sx	GL	Circ 343 sx
M-7-18S-34E					7.875	5.5	8970	2050 sx	3910	Temp survey
Mescalero Ridge C Federal 002	12/29/07	9140	O	Bone Spring	17.5	13.375	1800	1460 sx	GL	Circ 175 sx
3002538609					11	8.625	3150	1000 sx	GL	Circ 234 sx
D-18-18S-34E					7.875	5.5	9139	1220 sx	3270	CBL

Sorted by distance from EK Queen Unit 212

WELL	SPUD	TVD	STATUS	ZONE @ TD	HOLE O.D.	CASING O.D.	SET @ TVD	CEMENT	TOC	HOW TOC DETERMINED
Central EK Queen Unit 015	5/13/55	4385	P&A	Queen	17.25	13.375	262	275 sx	No report	No report
3002502306					11	8.625	1778	None	N/A	N/A
M-7-18S-34E					8	5.5	4344	200 sx	No report	No report
British American State 001	6/1/55	5513	P&A	San Andres	10.75	8.625	300	250 sx	GL	Circ
3002501600					8.25	7	4364	500 sx	3705	Temp survey
I-12-18S-33E					7.875	5.5	5465	300 sx	No report	No report
Sively 13 Federal 005	11/25/57	4369	P&A	Queen	12.25	8.625	335	175 sx	GL	Circ
3002501606										
G-13-18S-33E										

Sorted by distance from EK Queen Unit 212

WELL	SPUD	TVD	STATUS	ZONE @ TD	HOLE O.D.	CASING O.D.	SET @ TVD	CEMENT	TOC	HOW TOC DETERMINED
EK Queen Unit 041	12/20/54	4413	I	Queen	No report	8.625	1760	50 sx	GL	Circ
3002502340					No report	5.5	4373	100 sx	3700	CBL
E-18-18S-34E										
Pile Driver 24 13 Federal Com 524H	not yet	plan 9123	O	Bone Spring	17.5	13.375	1695	1190 sx	GL	not yet
3002555560					12.25	9.625	5250	1030 sx	GL	not yet
N-24-18s-33e					8.75	7	9130	4740 sx	5050	not yet
					8.5	4.5	9123			
Central EK Queen Unit 017	4/5/00	4504	O	Queen	11	8.625	1723	540 sx	GL	Circ 10 sx
3002534955					7.875	5.5	4504	710 sx	2200	CBL
M-7-18S-34E										

WELL	SPUD	TVD	STATUS	ZONE @ TD	HOLE O.D.	CASING O.D.	SET @ TVD	CEMENT	TOC	HOW TOC DETERMINED
Mescalero Ridge B Federal 001	8/18/85	9220	O	Bone Spring	17.5	13.375	355	375 sx	GL	Circ 130 sx
3002529315					12.25	8.625	3300	1100 sx	GL	Circ 325 sx
C-13-18S-33E					7.875	5.5	9220	1400 sx	2300	Temp survey
State DW 006	8/17/84	8914	O	Bone Spring	17.5	13.375	349	500 sx	GL	Circ 50 sx
3002528838					11	8.625	3300	1300 sx	GL	Circ 150 sx
I-12-18S-33E					7.875	5.5	8914	1265 sx	3310	Temp survey
State DW 001	1/31/84	11094	P&A	Wolfcamp	17.5	13.375	500	600 sx	GL	Circ 100 sx
3002528575					11	8.625	5283	4105 sx	GL	Circ
J-12-18S-33E					7.875	5.5	10866	950 sx	6490	Temp survey

Sorted by distance from EK Queen Unit 212

WELL	SPUD	TVD	STATUS	ZONE @ TD	HOLE O.D.	CASING O.D.	SET @ TVD	CEMENT	TOC	HOW TOC DETERMINED
State DW 010	11/12/84	9097	O	Bone Spring	17.5	13.375	350	500 sx	GL	Circ 50 sx
3002529023					11	8.625	3150	1300 sx	GL	Circ 300 sx
N-12-18S-33E					7.875	5.5	9097	1245 sx	3450	Temp survey

TOPO! map printed on 12/07/19 from "Untitled.tpo"

EXHIBIT H

sampled water well

windmill

EKQU 212

630123mE 3624842mN

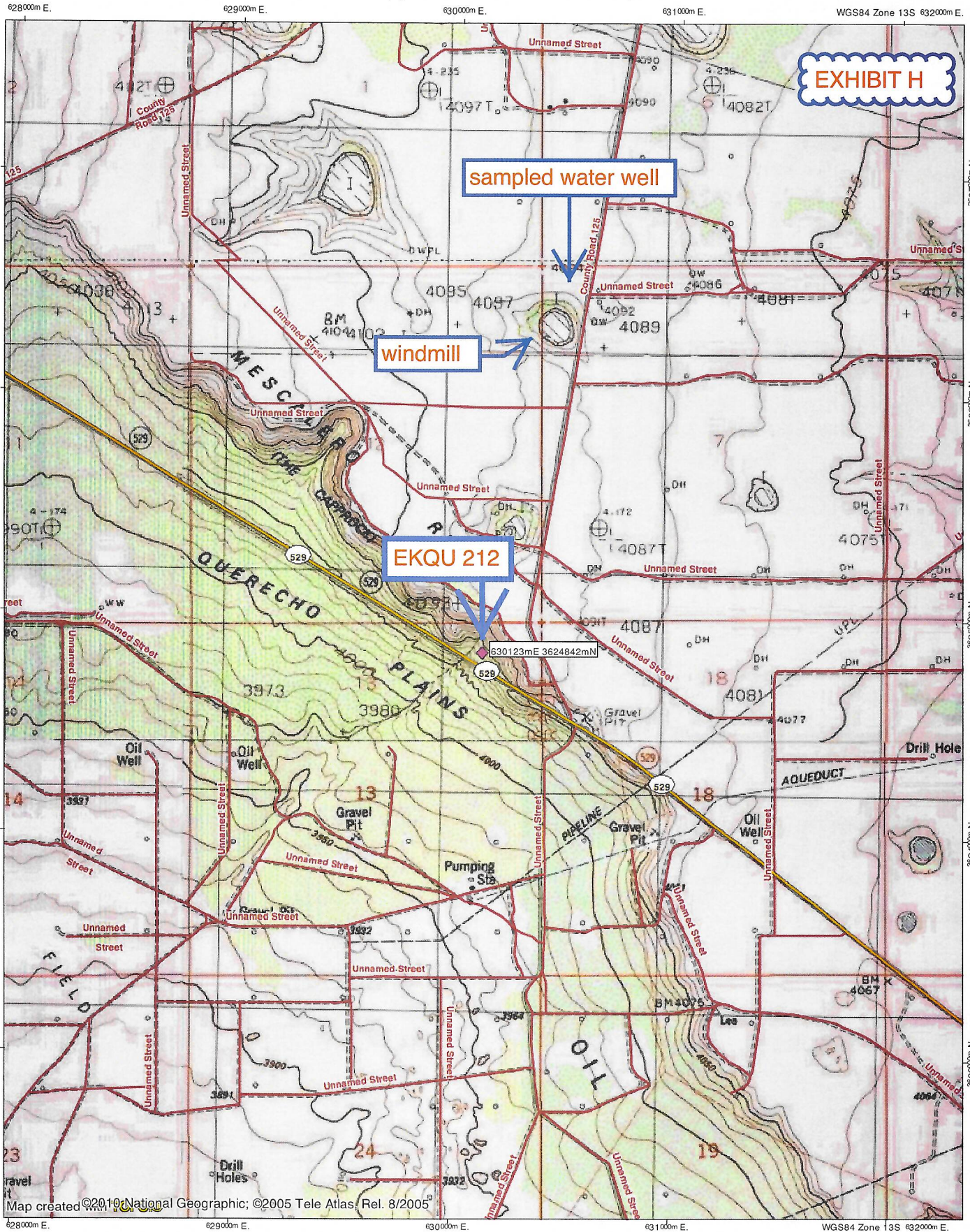

Map created ©2010 National Geographic; ©2005 Tele Atlas, Rel. 8/2005

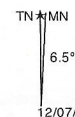

12/07/19

Water Column/Average Depth to Water

(A CLW##### in the POD suffix indicates the POD has been replaced & no longer serves a water right file.)

(R=POD has been replaced, O=orphaned, C=the file is closed)

(quarters are smallest to largest)

POD Number	Code	Sub basin	County	Q64	Q16	Q4	Sec	Tws	Range	X	Y	Map	(meters)		(In feet)	
													Distance	Well Depth	Depth Water	Water Column
L 13406 POD1		L	LE	SE	SE	SE	12	18S	33E	630278.8	3625061.0		268	220		
L 02878 POD2		L	LE		SE	SE	12	18S	33E	630196.0	3625175.0		340	220	220	0
L 06347		L	LE		SE	SE	12	18S	33E	630196.0	3625175.0 *		340	170	130	40
CP 00769 POD1		CP	LE	NW	NW	NE	13	18S	33E	629699.0	3624866.0 *		424	115	70	45
L 02898		L	LE		SW	SW	07	18S	34E	630598.0	3625182.0 *		584	204	150	54
CP 00623 POD2		CP	LE	NW	NE	NW	13	18S	33E	629242.8	3624542.5		929	100		
CP 00623 POD1		CP	LE	NW	NW	NW	13	18S	33E	628895.0	3624852.0 *		1228	82	60	22
L 08288		L	LE	SW	SW	SW	12	18S	33E	628890.0	3625054.0 *		1251	79	60	19
L 03436		L	LE		NW	SE	18	18S	34E	631229.6	3623771.1		1539	170	125	45
CP 00072 POD6		CP	LE	NE	SE	SE	11	18S	33E	628602.8	3625179.8		1557	100	61	39

Average Depth to Water: **109 feet**

Minimum Depth: **60 feet**

Maximum Depth: **220 feet**

Record Count: 10

Basin/County Search:

County: LE

UTM Filters (in meters):

Easting: 630123

Northing: 3624842

Radius: 001610

* UTM location was derived from PLSS - see Help

The data is furnished by the NMOSE/ISC and is accepted by the recipient with the expressed understanding that the OSE/ISC make no warranties, expressed or implied, concerning the accuracy, completeness, reliability, usability, or suitability for any particular purpose of the data.

EXHIBIT H







ANALYTICAL REPORT

PREPARED FOR

Attn: Brian Wood
Permits West Inc
5 Caliente Rd
Suite 3
Santa Fe, New Mexico 87508

Generated 1/29/2026 10:32:37 AM

JOB DESCRIPTION

EKQU

JOB NUMBER

885-41598-1

Eurofins Albuquerque

EXHIBIT I

Job Notes

The test results in this report relate only to the samples as received by the laboratory and will meet all requirements of the methodology, with any exceptions noted. This report shall not be reproduced except in full, without the express written approval of the laboratory. All questions should be directed to the Eurofins Environment Testing South Central, LLC Project Manager.

Authorization



Authorized for release by
Cheyenne Cason, Project Manager
cheyenne.cason@et.eurofinsus.com
(505)338-8812

Generated
1/29/2026 10:32:37 AM

Table of Contents

Cover Page	1
Table of Contents	3
Definitions/Glossary	4
Case Narrative	5
Client Sample Results	6
QC Sample Results	7
QC Association Summary	9
Lab Chronicle	10
Certification Summary	11
Chain of Custody	12
Receipt Checklists	13

EXHIBIT I



Definitions/Glossary

EXHIBIT I

Job ID: 885-41598-1

Client: Permits West Inc
Project/Site: EKQU

Glossary

Abbreviation	These commonly used abbreviations may or may not be present in this report.
☼	Listed under the "D" column to designate that the result is reported on a dry weight basis
%R	Percent Recovery
CFL	Contains Free Liquid
CFU	Colony Forming Unit
CNF	Contains No Free Liquid
DER	Duplicate Error Ratio (normalized absolute difference)
Dil Fac	Dilution Factor
DL	Detection Limit (DoD/DOE)
DL, RA, RE, IN	Indicates a Dilution, Re-analysis, Re-extraction, or additional Initial metals/anion analysis of the sample
DLC	Decision Level Concentration (Radiochemistry)
EDL	Estimated Detection Limit (Dioxin)
LOD	Limit of Detection (DoD/DOE)
LOQ	Limit of Quantitation (DoD/DOE)
MCL	EPA recommended "Maximum Contaminant Level"
MDA	Minimum Detectable Activity (Radiochemistry)
MDC	Minimum Detectable Concentration (Radiochemistry)
MDL	Method Detection Limit
ML	Minimum Level (Dioxin)
MPN	Most Probable Number
MQL	Method Quantitation Limit
NC	Not Calculated
ND	Not Detected at the reporting limit (or MDL or EDL if shown)
NEG	Negative / Absent
POS	Positive / Present
PQL	Practical Quantitation Limit
PRES	Presumptive
QC	Quality Control
RER	Relative Error Ratio (Radiochemistry)
RL	Reporting Limit or Requested Limit (Radiochemistry)
RPD	Relative Percent Difference, a measure of the relative difference between two points
TEF	Toxicity Equivalent Factor (Dioxin)
TEQ	Toxicity Equivalent Quotient (Dioxin)
TNTC	Too Numerous To Count

Case Narrative



Job ID: 885-41598-1

Client: Permits West Inc
Project: EKQU

Job ID: 885-41598-1

Eurofins Albuquerque

Job Narrative 885-41598-1

The analytical test results presented in this report meet all requirements of the associated regulatory program listed on the Accreditation/Certification Summary Page, unless otherwise noted. Data qualifiers and/or narrative comments are included to explain any exceptions, if applicable. Regulated compliance samples (e.g. SDWA, NPDES) must comply with associated agency requirements/permits.

- Matrix-specific batch QC (e.g., MS, MSD, SD) may not be reported when insufficient sample volume is available or when site-specific QC samples are not submitted. In such cases, a Laboratory Control Sample Duplicate (LCSD) may be analyzed to provide precision data for the batch.
- For samples analyzed using surrogate and/or isotope dilution analytes, any recoveries falling outside of established acceptance criteria are re-prepared and/or re-analyzed to confirm results, unless the deviation is due to sample dilution or otherwise explained in the case narrative.

Receipt

The sample was received on 1/20/2026 9:30 AM. Unless otherwise noted below, the sample arrived in good condition, and, where required, properly preserved and on ice. The temperature of the cooler at receipt time was 3.5°C.

Receipt Exceptions

The Field Sampler was not listed on the Chain of Custody.

HPLC/IC

No additional analytical or quality issues were noted, other than those described above or in the Definitions/ Glossary page.

General Chemistry

No additional analytical or quality issues were noted, other than those described above or in the Definitions/ Glossary page.

Eurofins Albuquerque

Client Sample Results



Client: Permits West Inc
Project/Site: EKQU

Job ID: 885-41598-1

Client Sample ID: Tank

Lab Sample ID: 885-41598-1

Date Collected: 01/19/26 06:50

Matrix: Water

Date Received: 01/20/26 09:30

Method: EPA 300.0 - Anions, Ion Chromatography

Analyte	Result	Qualifier	RL	Unit	D	Prepared	Analyzed	Dil Fac
Chloride	70		0.50	mg/L			01/21/26 15:23	1

General Chemistry

Analyte	Result	Qualifier	RL	Unit	D	Prepared	Analyzed	Dil Fac
HEM (Oil & Grease) (1664B)	ND		10	mg/L			01/21/26 12:03	1
Total Dissolved Solids (SM 2540C)	350		50	mg/L			01/22/26 12:18	1

Client Sample ID: Tank

Date Collected: 01/19/26 06:50

Date Received: 01/20/26 09:30

Method: EPA 300.0 - Anions, Ion Chromatography

Analyte: Chloride

General Chemistry

Total Dissolved Solids (SM 2540C)

QC Sample Results



Client: Permits West Inc
Project/Site: EKQU

Job ID: 885-41598-1

Method: 300.0 - Anions, Ion Chromatography

Lab Sample ID: MB 885-41662/4
Matrix: Water
Analysis Batch: 41662

Client Sample ID: Method Blank
Prep Type: Total/NA

Analyte	MB Result	MB Qualifier	RL	Unit	D	Prepared	Analyzed	Dil Fac
Chloride	ND		0.50	mg/L			01/21/26 11:45	1

Lab Sample ID: MB 885-41662/53
Matrix: Water
Analysis Batch: 41662

Client Sample ID: Method Blank
Prep Type: Total/NA

Analyte	MB Result	MB Qualifier	RL	Unit	D	Prepared	Analyzed	Dil Fac
Chloride	ND		0.50	mg/L			01/21/26 22:54	1

Lab Sample ID: LCS 885-41662/5
Matrix: Water
Analysis Batch: 41662

Client Sample ID: Lab Control Sample
Prep Type: Total/NA

Analyte	Spike Added	LCS Result	LCS Qualifier	Unit	D	%Rec	%Rec Limits
Chloride	5.00	4.86		mg/L		97	90 - 110

Lab Sample ID: LCS 885-41662/54
Matrix: Water
Analysis Batch: 41662

Client Sample ID: Lab Control Sample
Prep Type: Total/NA

Analyte	Spike Added	LCS Result	LCS Qualifier	Unit	D	%Rec	%Rec Limits
Chloride	5.00	4.84		mg/L		97	90 - 110

Lab Sample ID: MRL 885-41662/3
Matrix: Water
Analysis Batch: 41662

Client Sample ID: Lab Control Sample
Prep Type: Total/NA

Analyte	Spike Added	MRL Result	MRL Qualifier	Unit	D	%Rec	%Rec Limits
Chloride	0.500	0.514		mg/L		103	50 - 150

Method: 1664B - HEM and SGT-HEM

Lab Sample ID: MB 885-41703/1
Matrix: Water
Analysis Batch: 41703

Client Sample ID: Method Blank
Prep Type: Total/NA

Analyte	MB Result	MB Qualifier	RL	Unit	D	Prepared	Analyzed	Dil Fac
HEM (Oil & Grease)	ND		8.0	mg/L			01/21/26 12:03	1

Lab Sample ID: LCS 885-41703/2
Matrix: Water
Analysis Batch: 41703

Client Sample ID: Lab Control Sample
Prep Type: Total/NA

Analyte	Spike Added	LCS Result	LCS Qualifier	Unit	D	%Rec	%Rec Limits
HEM (Oil & Grease)	40.0	40.6		mg/L		102	78 - 114

Eurofins Albuquerque

QC Sample Results



Client: Permits West Inc
Project/Site: EKQU

Job ID: 885-41598-1

Method: 1664B - HEM and SGT-HEM (Continued)

Lab Sample ID: LCSD 885-41703/3
Matrix: Water
Analysis Batch: 41703

Client Sample ID: Lab Control Sample Dup
Prep Type: Total/NA

Analyte	Spike Added	LCSD Result	LCSD Qualifier	Unit	D	%Rec	%Rec Limits	RPD	RPD Limit
HEM (Oil & Grease)	40.0	38.2		mg/L		95	78 - 114	6	20

Method: 2540C - Solids, Total Dissolved (TDS)

Lab Sample ID: MB 885-41788/1
Matrix: Water
Analysis Batch: 41788

Client Sample ID: Method Blank
Prep Type: Total/NA

Analyte	MB Result	MB Qualifier	RL	Unit	D	Prepared	Analyzed	Dil Fac
Total Dissolved Solids	ND		50	mg/L			01/22/26 12:18	1

Lab Sample ID: LCS 885-41788/2
Matrix: Water
Analysis Batch: 41788

Client Sample ID: Lab Control Sample
Prep Type: Total/NA

Analyte	Spike Added	LCS Result	LCS Qualifier	Unit	D	%Rec	%Rec Limits
Total Dissolved Solids	1000	1010		mg/L		101	80 - 120

Lab Sample ID: 885-41598-1 DU
Matrix: Water
Analysis Batch: 41788

Client Sample ID: Tank
Prep Type: Total/NA

Analyte	Sample Result	Sample Qualifier	DU Result	DU Qualifier	Unit	D	RPD	RPD Limit
Total Dissolved Solids	350		340		mg/L		3	10

Lab Sample ID: ...
Matrix: Water
Analysis Batch: ...

Lab Sample ID: ...
Matrix: Water
Analysis Batch: ...

QC Association Summary

EXHIBIT I

Job ID: 885-41598-1

Client: Permits West Inc
Project/Site: EKQU

HPLC/IC

Analysis Batch: 41662

Lab Sample ID	Client Sample ID	Prep Type	Matrix	Method	Prep Batch
885-41598-1	Tank	Total/NA	Water	300.0	
MB 885-41662/4	Method Blank	Total/NA	Water	300.0	
MB 885-41662/53	Method Blank	Total/NA	Water	300.0	
LCS 885-41662/5	Lab Control Sample	Total/NA	Water	300.0	
LCS 885-41662/54	Lab Control Sample	Total/NA	Water	300.0	
MRL 885-41662/3	Lab Control Sample	Total/NA	Water	300.0	

General Chemistry

Analysis Batch: 41703

Lab Sample ID	Client Sample ID	Prep Type	Matrix	Method	Prep Batch
885-41598-1	Tank	Total/NA	Water	1664B	
MB 885-41703/1	Method Blank	Total/NA	Water	1664B	
LCS 885-41703/2	Lab Control Sample	Total/NA	Water	1664B	
LCSD 885-41703/3	Lab Control Sample Dup	Total/NA	Water	1664B	

Analysis Batch: 41788

Lab Sample ID	Client Sample ID	Prep Type	Matrix	Method	Prep Batch
885-41598-1	Tank	Total/NA	Water	2540C	
MB 885-41788/1	Method Blank	Total/NA	Water	2540C	
LCS 885-41788/2	Lab Control Sample	Total/NA	Water	2540C	
885-41598-1 DU	Tank	Total/NA	Water	2540C	

Lab Chronicle



Job ID: 885-41598-1

Client: Permits West Inc
Project/Site: EKQU

Client Sample ID: Tank
Date Collected: 01/19/26 06:50
Date Received: 01/20/26 09:30

Lab Sample ID: 885-41598-1
Matrix: Water

Prep Type	Batch Type	Batch Method	Run	Dilution Factor	Batch Number	Analyst	Lab	Prepared or Analyzed
Total/NA	Analysis	300.0		1	41662	EH	EET ALB	01/21/26 15:23
Total/NA	Analysis	1664B		1	41703	SS	EET ALB	01/21/26 12:03
Total/NA	Analysis	2540C		1	41788	HR	EET ALB	01/22/26 12:18

Laboratory References:

EET ALB = Eurofins Albuquerque, 4901 Hawkins NE, Albuquerque, NM 87109, TEL (505)345-3975

Client Sample ID:
Date Collected:
Date Received:

Lab Sample ID:
Matrix:

Accreditation/Certification Summary



: 885-41598-1

Client: Permits West Inc
Project/Site: EKQU

Laboratory: Eurofins Albuquerque

Unless otherwise noted, all analytes for this laboratory were covered under each accreditation/certification below.

Authority	Program	Identification Number	Expiration Date
New Mexico	State	NM9425	02-25-26
The following analytes are included in this report, but the laboratory is not certified by the governing authority. This list may include analytes for which the agency does not offer certification.			
Analysis Method	Prep Method	Matrix	Analyte
1664B		Water	HEM (Oil & Grease)
2540C		Water	Total Dissolved Solids
300.0		Water	Chloride
Oregon	NELAP	NM100001	02-25-26

1
1



Login Sample Receipt Checklist

Client: Permits West Inc

Job Number: 885-41598-1

Login Number: 41598

List Number: 1

Creator: McQuiston, Steven

List Source: Eurofins Albuquerque

Question	Answer	Comment
The cooler's custody seal, if present, is intact.	True	
Sample custody seals, if present, are intact.	True	
The cooler or samples do not appear to have been compromised or tampered with.	True	
Samples were received on ice.	True	
Cooler Temperature is acceptable.	True	
Cooler Temperature is recorded.	True	
COC is present.	True	
COC is filled out in ink and legible.	True	
COC is filled out with all pertinent information.	True	
Is the Field Sampler's name present on COC?	False	Refer to Job Narrative for details.
There are no discrepancies between the containers received and the COC.	True	
Samples are received within Holding Time (excluding tests with immediate HTs)	True	
Sample containers have legible labels.	True	
Containers are not broken or leaking.	True	
Sample collection date/times are provided.	True	
Appropriate sample containers are used.	True	
Sample bottles are completely filled.	True	
Sample Preservation Verified.	N/A	
There is sufficient vol. for all requested analyses, incl. any requested MS/MSDs	True	
Containers requiring zero headspace have no headspace or bubble is <6mm (1/4").	True	
TCEQ Mtd 1005 soil sample was frozen/delivered for prep within 48H of sampling.	N/A	

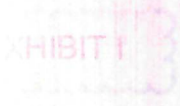



NM Oil Conservation Division
1220 S. St. Francis Dr.
Santa Fe, NM 87505

Re: Geology Statement
Seely Oil Company
E-K Queen Unit #212
Section 13, T. 18S, R. 33E
Lea County, New Mexico

To whom it may concern:

Publicly available geologic and engineering data related to the proposed well have been thoroughly reviewed, and no evidence for open faults or any other hydrologic connection between the proposed Queen injection zone and any underground sources of drinking water has been found. Please see the attached assessment for additional information.

Sincerely,

A handwritten signature in black ink that reads "Cory Walk".

Cory Walk
Geologist



Seismic Risk Assessment
Seely Oil Company
E-K Queen Unit #212
Section 13, Township 18 South, Range 33 East
Lea County, New Mexico

Cory Walk, M.S.

A handwritten signature in black ink that reads "Cory Walk".

Geologist

Permits West Inc.

March 19, 2026

EXHIBIT J

GENERAL INFORMATION

E-K Queen Unit #212 is located in the NE 1/4, section 13, T.18S, R.33E, about 7 miles southwest of Buckeye, NM in the Permian Basin. Seely Oil Company proposes to convert this oil well to a water injection well. Seely will inject water within the Queen formation from 4,384' -4,390' below ground surface. This report assesses any potential concerns relating to induced seismicity along deep penetrating basement-rooted faults or the connection between the injection zone and known underground potable water sources.

SEISMIC RISK ASSESSMENT

Historical Seismicity

Searching the USGS earthquake catalog resulted in no (0) earthquakes above a magnitude 2.5 within 6 miles (9.7 km) of the proposed injection site since 1970 (Fig. 1). The nearest earthquake above a magnitude 2.5 occurred on June 28, 2020, about 8.6 miles (13.9 km) east of the proposed SWD site and had a magnitude of 2.6.

Basement Faults and Subsurface Conditions

A structure contour map (Fig. 1) of the Precambrian basement shows E-K Queen Unit #212 is approximately 7.2 miles (11.7 km) from the nearest basement-rooted fault interpreted by an unidentified oil and gas operator using proprietary 3D Seismic data and published by Horne et al (2021).

Snee and Zoback (2018) state, "In the western part of Eddy County, New Mexico, S_{Hmax} is ~north-south (consistent with the state of stress in the Rio Grande Rift; Zoback and Zoback, 1980) but rotates to ~east-northeast-west-southwest in southern Lea County, New Mexico and the northernmost parts of Culberson and Reeves counties, Texas." **Around the E-K Queen Unit #212 site, Snee and Zoback indicate a S_{Hmax} direction of N060°E and an A_ϕ of 0.65, indicating an extensional (normal) stress regime.**

Induced seismicity is a growing concern of deep SWD wells. Snee and Zoback (2018) show that due to its orientation, the nearest Precambrian fault has a low probability of slipping (Fig. 2). Also, the proposed injection zone is much shallower in the Queen formation and therefore would not affect the deep-rooted Precambrian faults. Seismic data shows that the deep-rooted Precambrian faults do not penetrate anything above the Bone Spring Formation.

GROUNDWATER SOURCES

Three principal aquifers are used for potable groundwater in southern Lea County; these geologic units include the Triassic Santa Rosa formation, Tertiary Ogallala formation, and Quaternary alluvium. Nicholson and Clebsch (1961) state, "Potable ground water is not available below the Permian and Triassic unconformity but, because this boundary is not easily defined, the top of the Rustler anhydrite formation is regarded as the effective lower limit of 'potable' ground water." Around the E-K Queen #212 SWD well, a thick anhydrite unit interpreted to represent the Rustler formation lies at a depth of ~1728 feet bgs.



VERTICAL MIGRATION OF FLUIDS

OCD well records show approximately 2,500' of rock separate the injection zone from the top of the Bone Spring Formation (~6,896') that would prevent injected water from migrating into producing Bone Spring zones and deep-rooted Precambrian faults below. Data presented in Ruppel (2009) indicates the Precambrian basement lies at a depth of approximately 16,050' in this area. Therefore, the injection zone lies approximately 11,660' above the Precambrian basement and approximately 2,656' below the previously stated lower limit of potable water at the top of the Rustler formation.

CONCLUDING STATEMENTS

After examination of publicly available geologic and engineering data, there is no evidence of open faults or any other hydrologic connection between the disposal zone and any subsurface potable water sources. The shallow injection zone and orientation of nearby faults also remove any major concern of inducing seismic activity.

EXHIBIT J

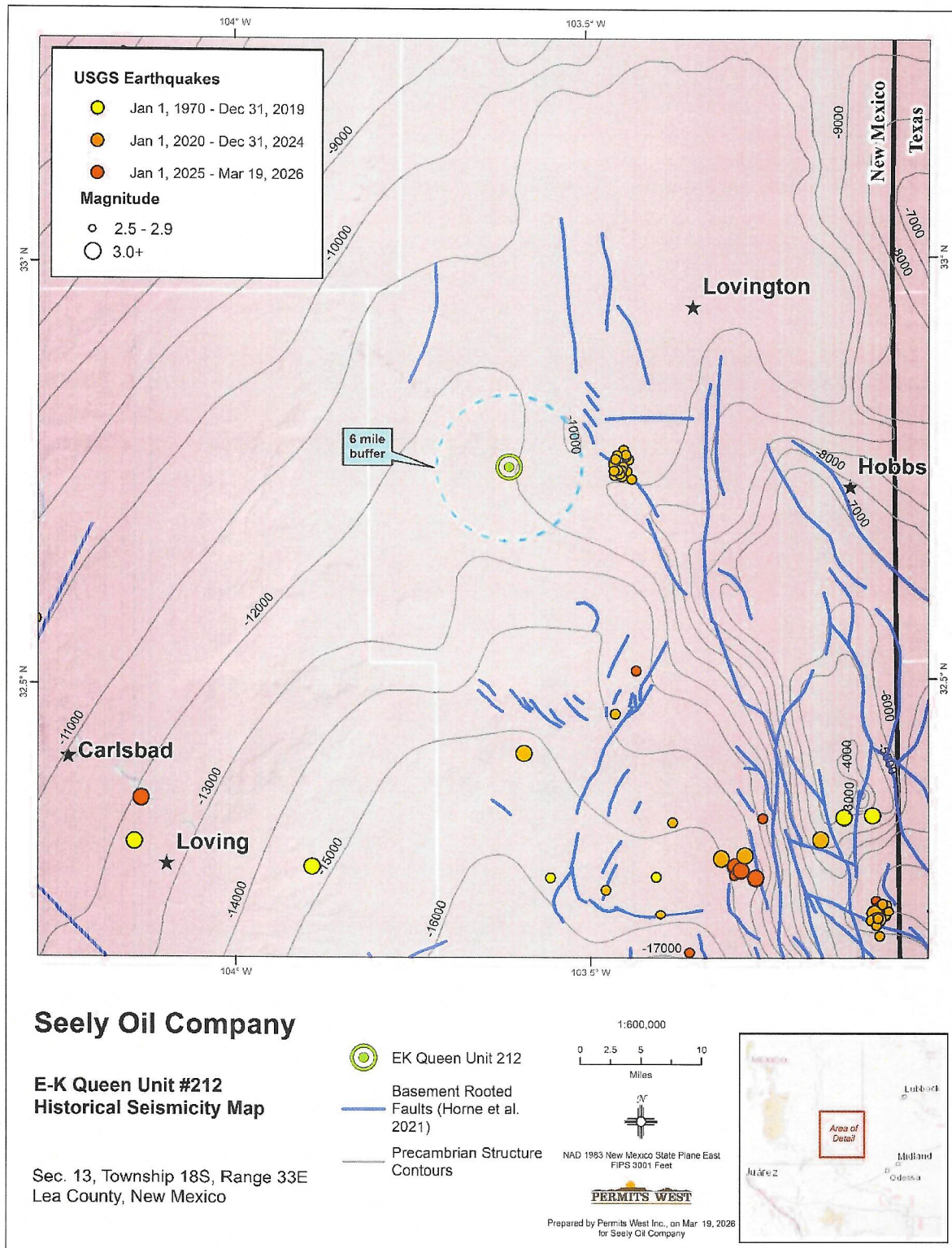

Figure 1. Structural contour map of the Precambrian basement in feet below sea level. Blue lines represent the locations of Precambrian basement-rooted faults (Horne et al., 2021). E-K Queen Unit #212 well lies ~7.2 miles southwest of the closest deeply penetrating fault and 8.6 miles west from the closest historic earthquake with a magnitude >2.5.

EXHIBIT J

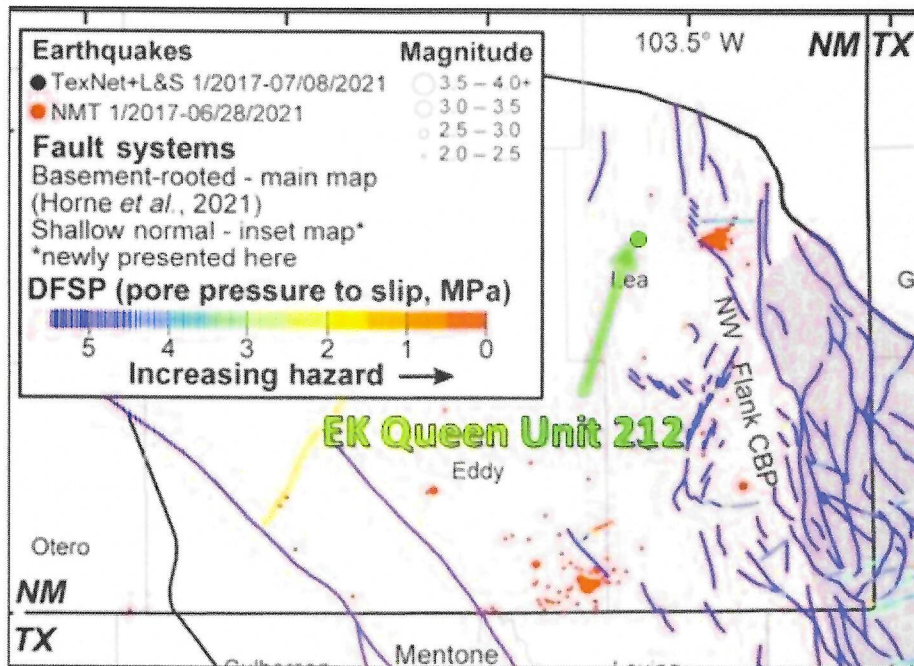

Figure 2. Modified from Hennings *et. al.* (2021) and shows an increased pore pressure to slip on the nearby faults which decreases the hazard potential. The proposed injection zone is shallower in the Queen Formation and therefore removes any major concern of inducing seismicity on any known basement-rooted fault.

A blue scalloped border containing the text "EXHIBIT J" in orange capital letters.**References Cited**

- Comer, J. B., 1991, Stratigraphic Analysis of the Upper Devonian Woodford Formation, Permian Basin, West Texas and Southeastern New Mexico: The University of Texas at Austin, Bureau of Economic Geology, Report of Investigations No. 201, 63 p.
- Frenzel, H. N., Bloomer, R. R., Cline, R. B., Cys, J. M., Galley, J. E., Gibson, W. R., Hills, J. M., King, W. E., Seager, W. R., Kottowski, F. E., Thompson, S., III, Luff, G. C., Pearson, B. T., and Van Sicken, D. C., 1988, The Permian Basin region, in Sloss, L. L., ed., Sedimentary cover—North American Craton, U.S.: Boulder, Colorado, Geological Society of America, The Geology of North America, v. D-2, p. 261–306.
- Horne, E. A., Hennings, P. H., and Zahm, C. K., 2021, Basement-rooted faults of the Delaware Basin and Central Basin Platform, Permian Basin, West Texas and southeastern New Mexico, in Callahan, O. A., and Eichhubl, P., eds., The geologic basement of Texas: a volume in honor of Peter T. Flawn: The University of Texas, Bureau of Economic Geology Report of Investigations No. 286, doi:10.23867/RI0286C6.
- Hennings, P., Dvory, N., Horne, E., Li, P., Savvaidis, A., and Zoback, M. (2021). Stability of the Fault Systems That Host-Induced Earthquakes in the Delaware Basin of West Texas and Southeast New Mexico. *The Seismic Record*. 1(2), 96–106, doi: 10.1785/0320210020
- Nicholson, A., Jr., and Clebsch, A., Jr., 1961, Geology and ground-water conditions in southern Lea County, New Mexico: New Mexico Bureau of Mines and Mineral Resources, Ground-Water Report 6, 123 pp., 2 plates.
- Ruppel, S.C., 2009, Integrated synthesis of the Permian basin: data and models for recovering existing and undiscovered oil resources from the largest oil-bearing basin: U.S. Oil & Natural Gas Technology, Bureau Economic Geology, The University of Texas at Austin, p. 1-959.
- Snee, J.-E.L., Zoback, M.D., 2018, State of stress in the Permian Basin, Texas and New Mexico: Implications for induced seismicity: *Leading Edge*, v. 37, p. 127–134.

SEELY OIL CO.
E-K QUEEN UNIT 212
430' FNL & 900' FEL
SEC. 13, T. 18 S., R. 33 E.
LEA COUNTY, NM

PAGE 1

WFX-1041

30-025-29471

I. Plan is to convert an oil well to a water injection well to increase oil recovery. The well will inject through its existing perforations (4384' - 4390') into the Queen, which is in the E-K; Yates-Seven Rivers-Queen Pool (pool code 19950).

The well and zone are in the E-K Queen Unit. Unit and waterflood were established in 1965 by Socony Mobil in 1965 via Orders R-2913 and R-2914. There have been subsequent WFX approvals (-474, -807, -900, and -988). A conversion application was filed in 2020 but not approved. There is no change in plans since 2020. Area of review, affected parties, etc. have been updated. This is an active water flood. Eight active water injectors are in the Unit.

II. Operator: Seely Oil Co. (OGRID 20497)
Operator phone number: (817) 332-1377
Operator address: 815 West 10th St., Ft. Worth TX 76102
Contact for Application: Brian Wood (Permits West, Inc.)
Phone: (505) 466-8120

III. A. (1) Lease: BLM NMLC-0063645
Lease Size: 800.00 acres (see Exhibit A for maps and C-102)
Closest Lease Line: 430'
Lease Area: E2 of Section 13, T. 18 S., R. 33 E. et al
Unit Number: 300120
Unit Size: 2,895.36 acres
Closest Unit Line: 430'
Unit Area: T. 18 S., R. 33 E.
Sections 13 & 14: all
Section 23: N2 & N2SE4
Section 24: N2, N2SW4, SESW, & SE4
T. 18 S., R. 34 E.
Section 18: NWNW, S2NW4, SW4, & W2SE4
Section 19: NW4, N2SW4, & SWSW

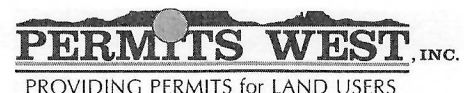

SEELY OIL CO.
E-K QUEEN UNIT 212
430' FNL & 900' FEL
SEC. 13, T. 18 S., R. 33 E.
LEA COUNTY, NM

PAGE 2

WFX-1041

30-025-29471

- A. (2) Surface casing (13.375", 48#) was set at 356' in a 17.5" hole with 375 sacks. Circulated 88 sacks to GL.

Intermediate casing (8.625", 24# & 32#) was set at 3311' in a 12.25" hole and cemented with 1000 sacks to 25' (temperature).

Production casing (5.5", 15.5# & 17#) was set at 9200' (TD) in a 7.875" hole and cemented with 1400 sacks to 800' (temperature) in 1986. The well was completed in the Bone Spring.

The well was subsequently plugged back in 2017 and completed in the Queen. A CIBP was set at 8644' with 35' of cement. Twenty sack plugs were set at 6966' - 6976' and 5802' - 5962'. A second CIBP was set at 5000' with 35' cement. Queen was perforated from 4384' to 4390'.

Mechanical integrity of the casing will be assured by hydraulically pressure testing to a minimum of 500 psi for 30 minutes or to 300 psi for 60 minutes.

- A. (3) Tubing will be 2.375" IPC. Setting depth will be \approx 4300'. (Injection interval will be 4384' to 4390'.)
- A. (4) A plastic lined AD-I packer will be set at \approx 4300', or no more than 100' above highest perforation (4384').
- B. (1) Injection zone will be the Queen sandstone, part of the E-K; Yates - Seven Rivers - Queen Pool. Reservoir is a stratigraphic trap. Average porosity = 13.3%. Average permeability = 30 mD. Average fracture gradient = 0.94 psi/foot. Water saturation was estimated as 40% before the waterflood started.
- B. (2) Injection interval will be 4384' to 4390'. The well is a cased hole.

SEELY OIL CO.
E-K QUEEN UNIT 212
430' FNL & 900' FEL
SEC. 13, T. 18 S., R. 33 E.
LEA COUNTY, NM

PAGE 3

WFX-1041

30-025-29471

- B. (3) Well was drilled and completed in 1986 as a 9200' deep Bone Spring oil well. Bone Spring was isolated with two CIBPs and 4 cement plugs and converted to a Queen oil well in 2017.
- B. (4) Well was perforated in 1986 from 8744' to 8766' with 2 shots per foot for a total of 45 holes in the Bone Spring. Bone Spring was isolated in 2017 and well was recompleted in the Queen. Queen is perforated from 4384' to 4390' with 12 holes. This same interval will be used for injection.
- B. (5) Next higher oil or gas zone in the area of review is the Seven Rivers. Its bottom is at 4342'. Highest Queen perforation will be 4384'.

Next lower oil or gas zone in the area of review is the San Andres. San Andres top is at 5114'. Deepest Queen perforation will be 4390'.

IV. This is not a horizontal or vertical expansion of an existing injection project (R-2913 and R-2914). There have been subsequent water flood expansions (WFX-474, -807, -900, & -988). A vertical contraction (R-2913-A) of the Unit deleted the Penrose.

V. Exhibit B shows and tabulates 22 existing or planned wells (16 oil wells + 5 P&A wells + 1 injector) within a half-mile radius, regardless of depth. Exhibit C shows 222 existing wells (67 oil or gas wells + 117 P & A wells + 12 injection or disposal wells + 26 water wells) within a two-mile radius.

Exhibit D shows and details all leases (BLM and NMSLO) within a half-mile radius. Exhibit E shows all lessors (BLM, fee, and NMSLO) within a 2-mile radius.

VI. Twenty-two wells are, or will be, within a half-mile radius. All have or will penetrate the Queen. The penetrators include 16 oil wells, 5 P&A wells, and 1 injector. A table abstracting the well construction details and histories of the

SEELY OIL CO.
 E-K QUEEN UNIT 212
 430' FNL & 900' FEL
 SEC. 13, T. 18 S., R. 33 E.
 LEA COUNTY, NM

PAGE 4

WFX-1041

30-025-29471

penetrators is in Exhibit F. Diagrams of the P&A penetrators are in Exhibit G, sequenced by API number.

- VII. 1. Average injection rate will be ≈ 100 bwpd. Maximum injection rate will be 150 bwpd.
2. System will be closed. Well will tie into the existing Unit pipeline system. The system consists of a branched injection system with Triplex injection pumps.
3. Average injection pressure will be ≈ 800 psi. Maximum injection pressure will be 876 psi ($= 0.2$ psi/foot $\times 4384'$ (top perforation)).
4. Water source will be produced water from Seely wells. No compatibility problems have reported from the $>7,275,722$ barrels that have been injected in the Unit since 1965.
5. Queen produces from 8 oil wells in the Unit. Goal is to recover more oil.

VIII. The Queen in the Unit is a sandstone stratigraphic trap with an average porosity of 13.3%. Average permeability is 30 millidarcies. Three hundred twenty-four active Queen injection wells are in the state. E-K Queen Unit shares its northeast border with Seely's Central EK Unit which has a similar water flood.

Formation depths are:

Quaternary = 0'
 Rustler = 1728'
 Salado = 1836'
 Tansill = 3105'
 Yates = 3210'
 Seven Rivers = 3624'
 Queen = 4343'

Proposed injection interval = 4384' - 4390'

San Andres = 5114'

SEELY OIL CO.
E-K QUEEN UNIT 212
430' FNL & 900' FEL
SEC. 13, T. 18 S., R. 33 E.
LEA COUNTY, NM

PAGE 5

WFX-1041

30-025-29471

Delaware = 5902'
Bone Spring = 6896'
PBSD = 9146'
TD = 9200'

State Engineer (Exhibit H) records indicate ten water wells are within a mile. Deepest water well within a mile (1610 meters) radius is 220'. None could be found during June 14, 2018, and January 19, 2026, field inspections. Two wells not in State Engineer records were found. A partially dismantled windmill is 1/3 miles NNE. A well with a submersible pump was sampled. It is 2/5 miles NNE. EKQU 212 is 1/10 mile southwest of the Ogallala aquifer.

There will be 2615' of vertical separation and 1377' of salt and anhydrite between the bottom of the only likely underground fresh water source (red beds) and the top of the Queen.

Produced water is currently being injected (6 wells) or disposed (1 well) into the Bone Spring, Penrose, Queen, Seven Rivers, or Yates in T. 18 S., R. 33 E.

- IX. The well will be stimulated with gelled KCL and sand.
- X. Borehole volume, DLL with MSFL, Compensated Neutron Density, and BHC Sonic logs are on file with NMOCD.
- XI. One active fresh water well is within a mile. Analyses from that well (1/3 mile NNE) are attached (Exhibit I).
- XII. Seely Oil Co. is not aware of any geologic or engineering data that may indicate the injection interval is in hydrologic connection with any underground source of water (Exhibit I). There are 398 active Queen injectors and 23 active Queen SWD wells in New Mexico. Previously approved water flood expansions in

SEELY OIL CO.
E-K QUEEN UNIT 212
430' FNL & 900' FEL
SEC. 13, T. 18 S., R. 33 E.
LEA COUNTY, NM

PAGE 6

WFX-1041

30-025-29471

the Unit include WFX-474, -807, -900, and -988. Exhibit J addresses the potential for hydrologic connection.

XIII. A legal ad (see Exhibit K) was published on March 8, 2026. Notice (this application) has been sent (Exhibit L) to the surface owner (BLM), government lessors (BLM, NMSLO), offset operators (J R Oil & Mewbourne) regardless of depth, lessees of record (BTA, Devon, Maverick Permian, OXY USA WTP, PXP), and operating right holders.

EXHIBIT G

Plateau's British-American State 1
API 30-025-01600
I-12-18s-33e
Spud: 6-1-55 and Plug: 11-23-56
production

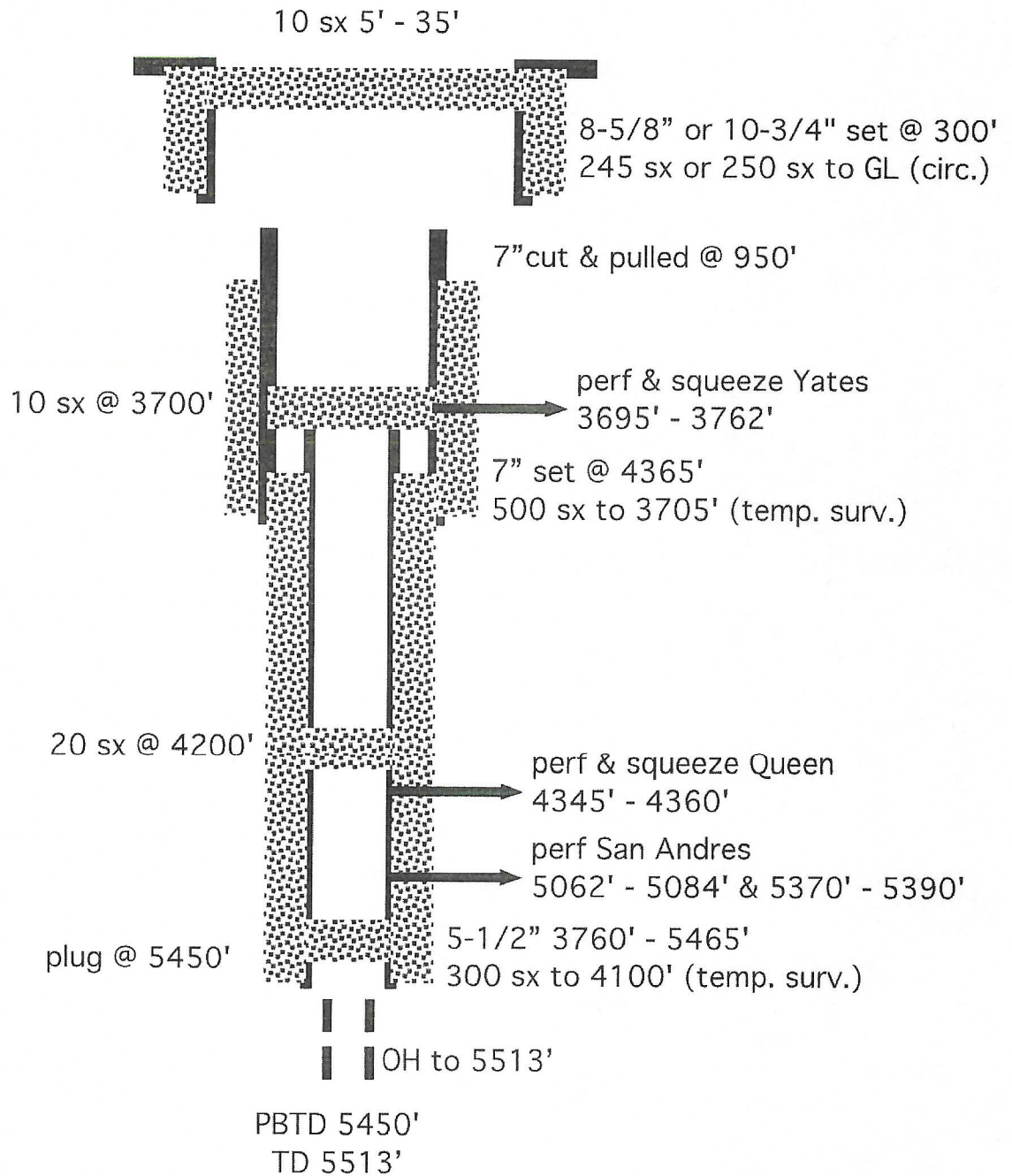

(not to scale)

EXHIBIT G

OPERATOR T.J. Silvey Federal
WELL NO. 5

LEASE EK Queen Unit
1980' FNL & 2310' FWL SECTION 13-18S-33E
UNIT LETTER G

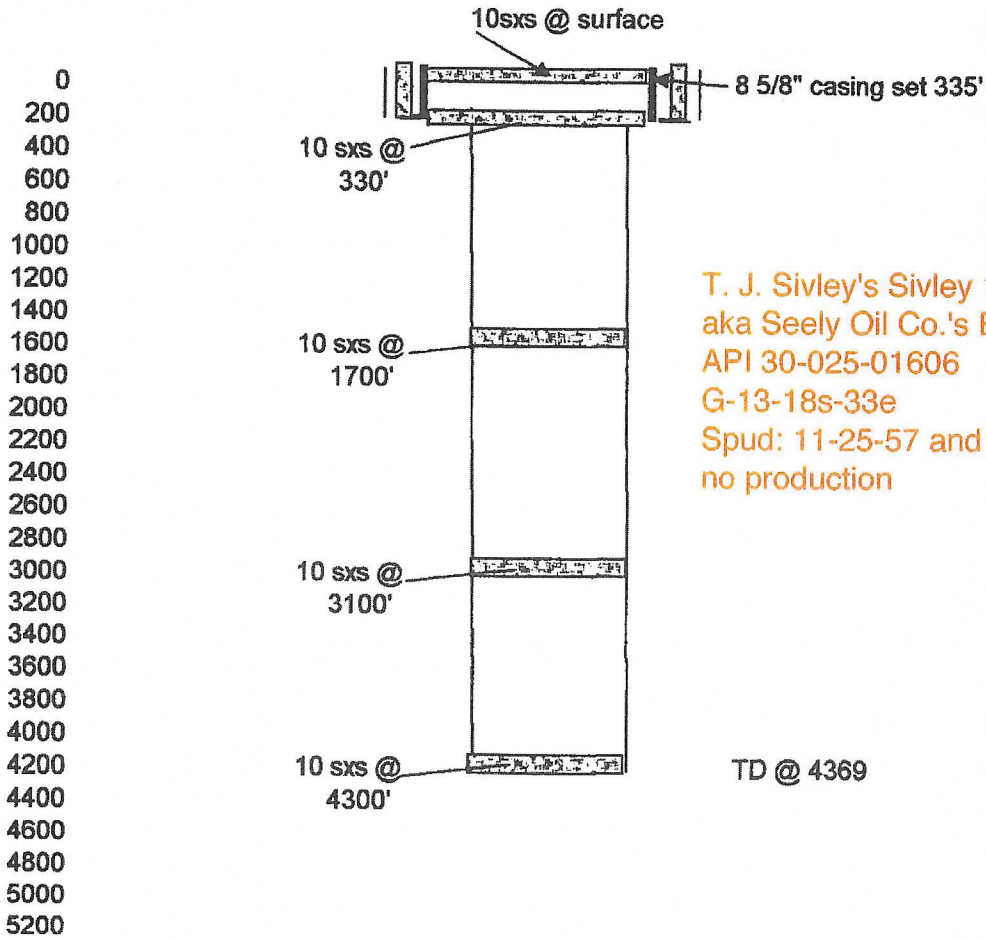

T. J. Sivley's Sivley 13 Federal 5,
aka Seely Oil Co.'s EKQU 211
API 30-025-01606
G-13-18s-33e
Spud: 11-25-57 and Plug: 12-7-57
no production

10 sacks each at 4300', 3100', 1700', 330' and at surface

from WFX-807

Seely Oil's Central EK Queen Unit 15

API 30-025-02306

M-7-18s-34e

Spud: 5-13-55 and Plug: 1-12-67 & 7-20-2000
production

EXHIBIT G

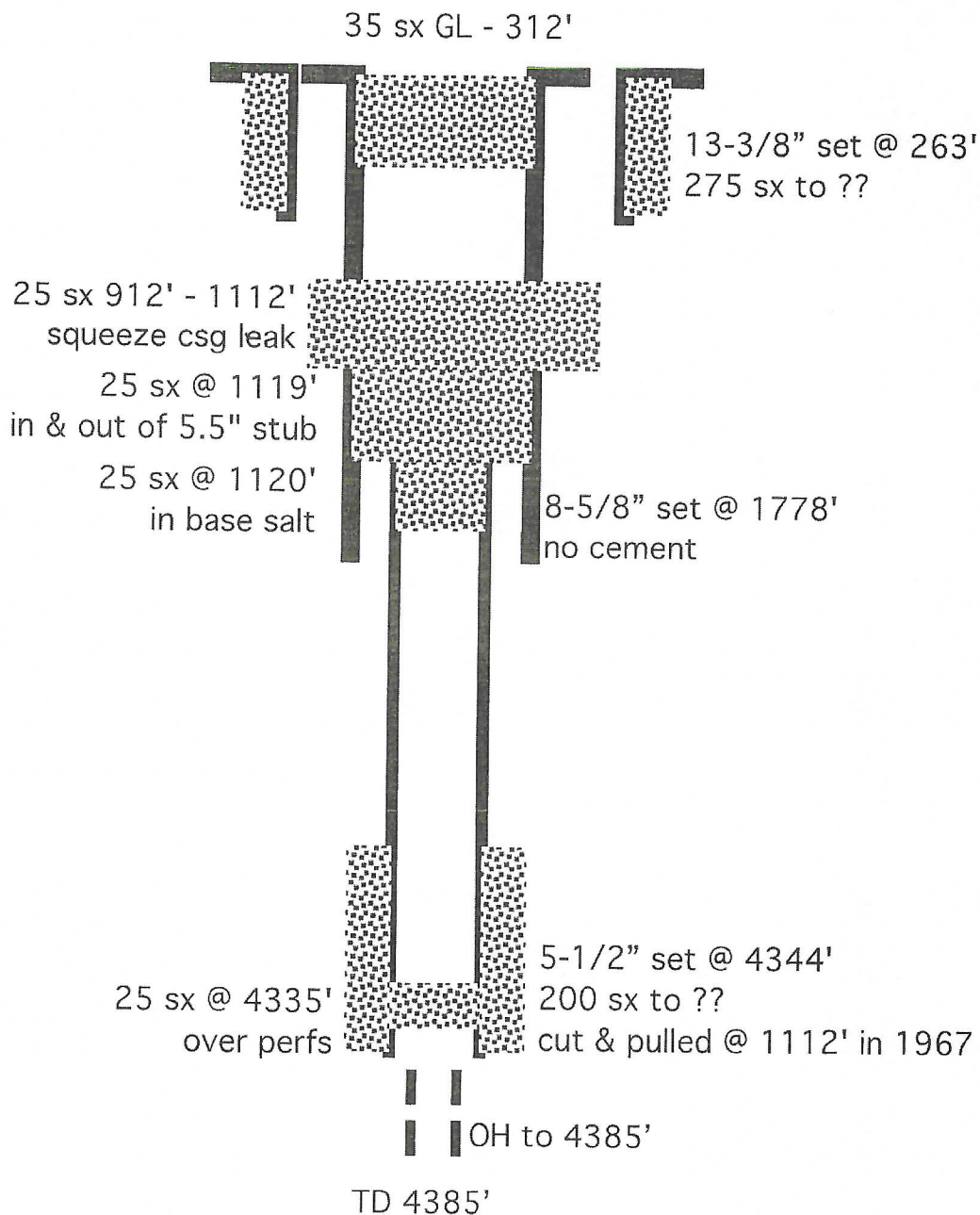

(not to scale)

T. J. Sivley's Fox 2
API 30-025-02341
D-18-18s-34e
Spud: 9-12-55 and Plug: 9-24-55
no production

EXHIBIT G

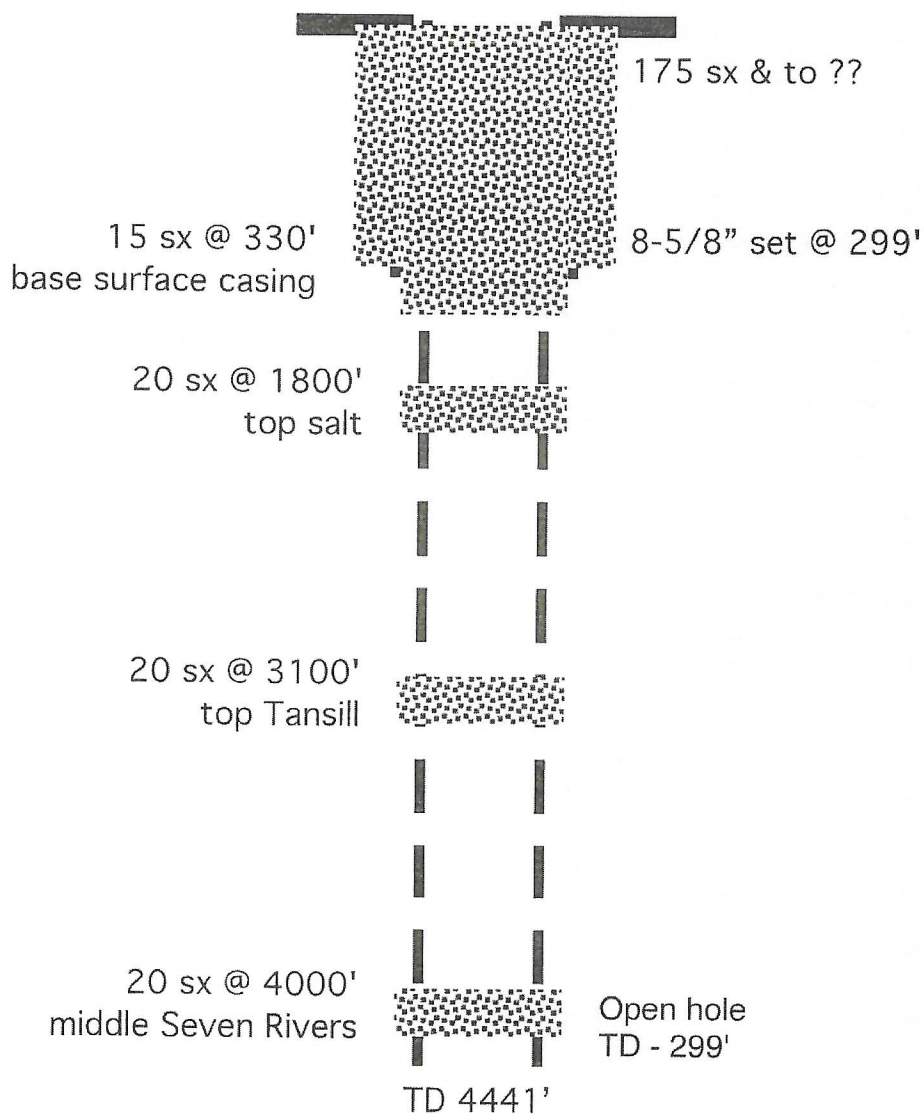

(not to scale)

OXY USA WTP LP
State DW #1
API No. 30-025-28575

EXHIBIT G

perf @ 550'
200 sx GL -550'

17-1/2" hole @ 500'
13-3/8" csg @ 500'
w/ 600sx-TOC-Surf-Circ

perf @ 1819'
squeeze 50 sx
1565' - 1819'

Oxy USA WTP's State DW 1
API 30-025-28575
J-12-18s-33e
Spud: 1-31-84 and Plug: 8-10-12
production

perf @ 3253'
squeeze 50 sx
3044' - 3253'

perf @ 4428'
squeeze 50 sx
4210' - 4428'

35 sx 5050' - 5380'

11" hole @ 5283'
8-5/8" csg @ 5283'
w/ 4105sx-TOC-Surf-Circ

25 sx 5698' - 5981'

squeeze 400 sx @ 6107'

Csg Parted @ 6400'

TOF @ 6404' to 9034' consisting of
2-7/8" tbg @ 9034' & TAC @ 8536'
1" st rods & 1-3/4" X 34' Rod pump

Perfs @ 8661-8883'

7-7/8" hole @ 11094'
5-1/2" csg @ 10866'
w/ 950sx-TOC-6490'-TS

CIBP @ 9890' w/ 3sx

PB-9863'

Perfs @ 10007-10023'

CIBP @ 10650' w/ 3sx

Perfs @ 10741-10747'

OH @ 10866-11094'

rom 30-025-28575

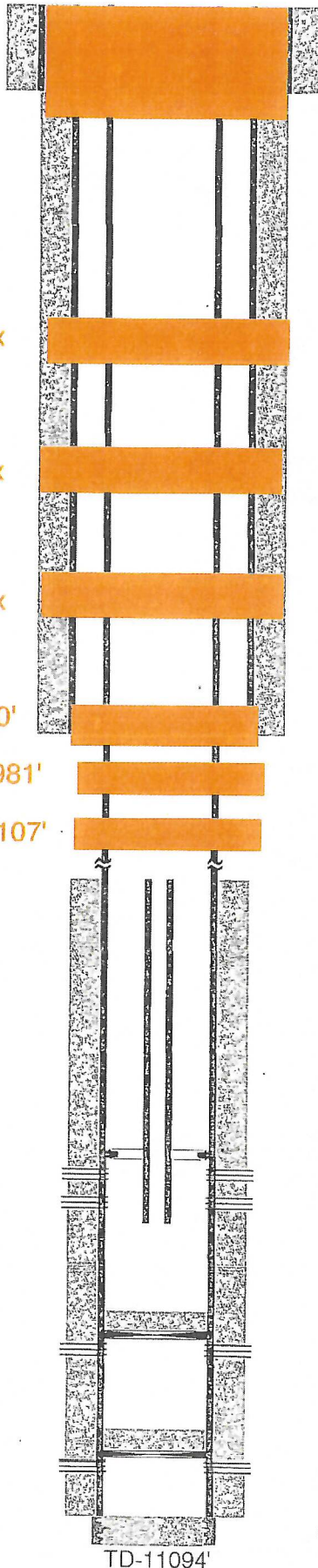

Sante Fe Main Office
Phone: (505) 476-3441

General Information
Phone: (505) 629-6116

Online Phone Directory
<https://www.emnrd.nm.gov/ocd/contact-us>

State of New Mexico
Energy, Minerals and Natural Resources
Oil Conservation Division
1220 S. St Francis Dr.
Santa Fe, NM 87505

CONDITIONS

Action 565225

CONDITIONS

Operator: SEELY OIL CO 815 W 10th Street Ft. Worth, TX 76102	OGRID: 20497
	Action Number: 565225
	Action Type: [C-108] Fluid Injection Well (C-108)

CONDITIONS

Created By	Condition	Condition Date
delilah.dougi	None	4/9/2026