







LEGEND:

-  All Bone Spring Units
-  1st & 3rd Bone Spring Units
-  2nd Bone Spring Units
-  BTA - Ochoa Acreage - JOA
-  Proposed Wolfcamp Units
-  Delaware Units



BTA Oil Producers, LLC

LOVING AREA

Bone Spring And Wolfcamp Spacing Units Outline

T23S-R28E & T23S-R29E

Eddy County, New Mexico



BTA OIL PRODUCERS, LLC

104 SOUTH PECOS STREET
MIDLAND, TEXAS 79701-5021
432-682-3753
FAX 432-683-0311

CARLTON BEAL, JR.
BARRY BEAL
SPENCER BEAL
KELLY BEAL
BARRY BEAL, JR.
STUART BEAL
ROBERT DAVENPORT, JR.

GULF COAST DISTRICT
TOTAL PLAZA
1201 LOUISIANA STREET, STE. 570
HOUSTON, TEXAS 77002
713-658-0077 FAX 713-655-0346

ROCKY MOUNTAIN DISTRICT
800 17TH STREET, STE. 2230 SOUTH
DENVER, COLORADO 80202
303-534-4404 FAX 303-534-4881

July 25, 2019

In re: BTA – Ochoa 8703 Fed #1H, #2H, #3H, and #4H
Lots 1, 2, NE/4 and E/2NW/4 of Section 7, and NW/4 of Section 8-T23S-R29E-
Eddy County, New Mexico, containing 474.11 acres, more or less

Oxy Y-1 Company
5 Greenway Plaza, Suite 110
Houston, TX 77046
Attention: Mr. Jeremy Murphrey

Dear Jeremy:

BTA Oil Producers, LLC ("BTA") sent well proposals dated July 8, 2019, to Oxy Y-1 Company ("Oxy") covering the BTA – Ochoa 8703 Fed #1H, #2H, #3H, and #4H. The wells were proposed under that certain Operating Agreement dated January 1, 1987, naming BTA as Operator, as amended and ratified. BTA agrees to amend the election period on each of the well proposals referenced above so that Oxy's election is due thirty (30) days from notice from BTA of receipt of an approved application for permit to drill ("APD") for each well.

Please signify your approval of the amendment of the election period as set out above by signing in the space provided below. Should you have any questions or wish to discuss, please call me at (432) 682-3753.

Respectfully,

Willis D. Price III
Land Manager

AGREED TO AND ACCEPTED:

Oxy Y-1 Company

By: [Signature]

Title: Land Negotiator Advisor

Date: 7/26/2019

Cases 20916 & 20917

BTA

Exhibit 2

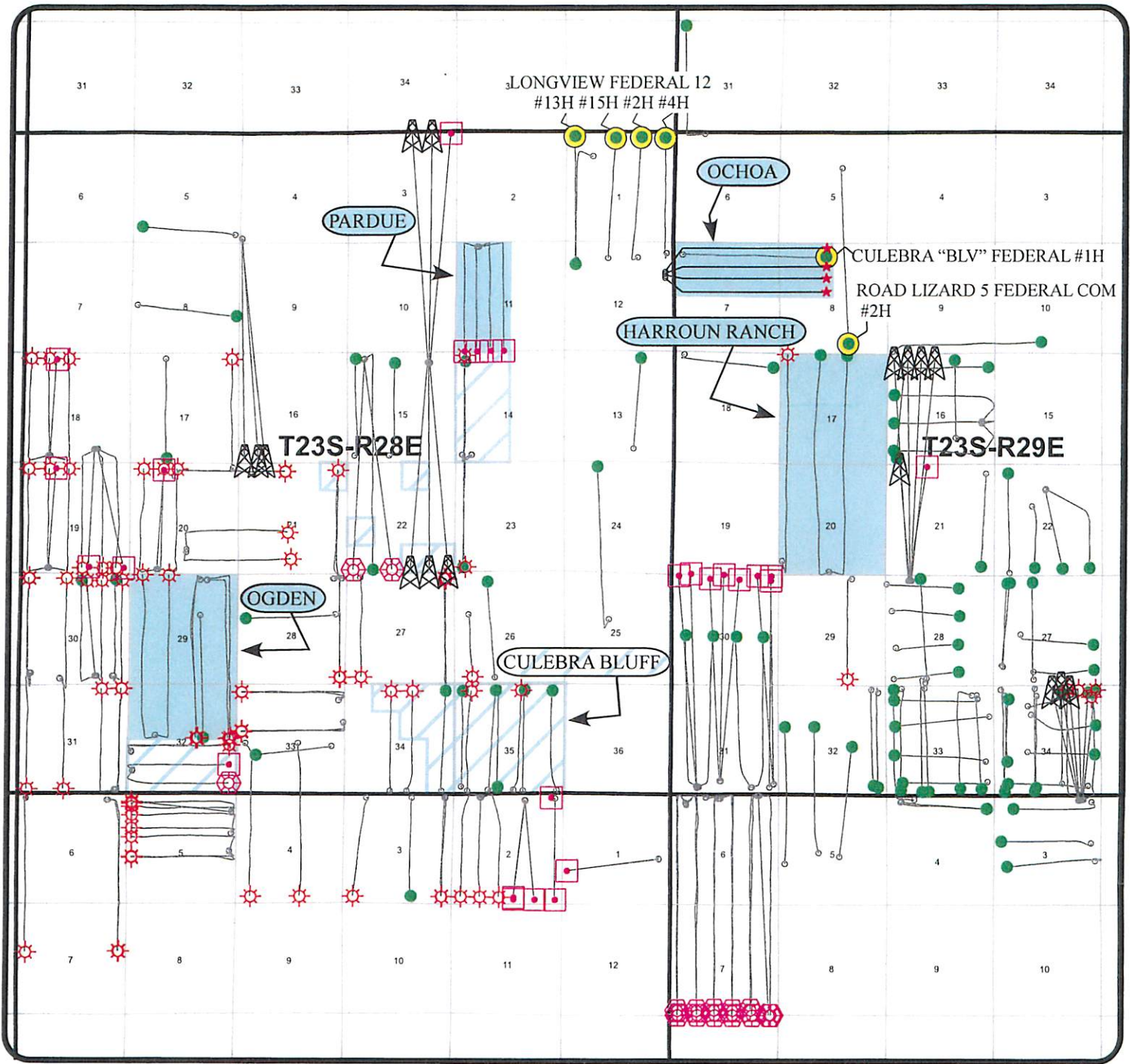

LEGEND:

REMARKS

** Only Proposed BTA Locations And Active Horizontal Wells Shown On The Map **

BTA Operated
 BTA Non-Operated

WELL SYMBOLS

SL BHL

- BTA PROPOSED LOCATION
- DRILLING
- TOTAL DEPTH REACHED
- COMPLETING
- OIL WELL
- GAS WELL



BTA Oil Producers, LLC

LOVING AREA

BTA ACREAGE POSITION MAP

T23S-R28E & T23S-R29E

Eddy County, New Mexico

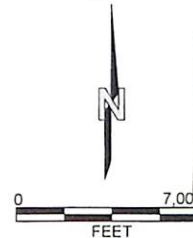

Cases 20916 & 20917

BTA

Exhibit 3