

**STATE OF NEW MEXICO  
ENERGY, MINERALS AND NATURAL RESOURCES DEPARTMENT  
OIL CONSERVATION DIVISION**

**IN THE MATTER OF THE APPLICATION OF  
MEWBOURNE OIL COMPANY FOR  
COMPULSORY POOLING  
IN CASE NOS. 21496 & 21960,  
EDDY COUNTY, NEW MEXICO.**

**CASE NO. \_\_\_\_\_**

**APPLICATION TO RESCIND DIVISION ORDER NOS. R-21537 & R-21537-A OR FOR  
DE NOVO HEARING BEFORE THE OIL CONSERVATION COMMISSION  
ON CASE NOS. 21496 AND 21960**

Griffin Energy Law, PLLC (“Griffin”) respectfully applies for an order revoking the pooling authority granted under Division Order Nos. R-21537 and R-21537-A, or for a *de novo* hearing before the Oil Conservation Commission (“Commission”) on Division Case Nos. 21496 and 21960. In conjunction with this Application, Griffin also moves the Oil Conservation Division (“Division”) to stay the effectiveness of Order Nos. R-21537 and R-21537-A, pending the Division’s final ruling on this application. In support, Griffin states as follows:

1. In Case Nos. 21496 and 21960, Mewbourne filed its Application for Compulsory Pooling, seeking Division approval of its pooling application, and a subsequent application to pool additional interest owners under the terms of Division Order No. R-21537, in the Wolfcamp formation underlying a horizontal spacing unit comprised of the N/2 of Section 28 and the N/2 of Section 29, Township 22 South, Range 27 East, NMPM, Eddy County, New Mexico. Mewbourne initially dedicated the pooled spacing unit to: (1) the City Slickers 28/29 W0HE Fee #1H Well; and (2) the City Slickers 28/29 W0AD Fee #1H Well.
2. Applicant requests the Division take agency notice of the application, exhibits, and other pleadings and materials filed into the Division records in Case Nos. 21496 and 21960.

3. Mewbourne filed its application in Case No. 21960, heard by the Division on June 17, 2021, seeking to re-open Case No. 21496 and Order No. R-21537, to pool additional uncommitted mineral interest owners that it failed to pool in the original case. In both proceedings, Mewbourne made no attempt to reach a voluntary agreement with the additional unleased mineral interest owners identified below, who sold their interests to Griffin, the applicant in this case.

4. Mewbourne's failure to provide notice to an unleased mineral interest in the unit is grounds for rescission of the pooled unit. The New Mexico Oil and Gas Act, NMSA 1978, § 70-2-1, *et seq.* ("Oil and Gas Act") provides special treatment for unleased mineral interests in a pooled unit: "If the interest of any owner or owners of any unleased mineral interest is pooled by virtue of this act, seven-eighths of such interest shall be considered as a working interest and one-eighth shall be considered a royalty interest, and he shall in all events be paid one-eighth of all production from the unit and creditable to his interest." NMSA 1978, § 70-2-17.

5. As described in detail in the quiet title action and default judgment order, filed in Eddy County in Fifth Judicial District Case No. D-503-CV-2023-00311, attached as ***Exhibit A***, Griffin is the owner of an undivided 11/60 of 8/8ths of the oil, gas, and other mineral interests in Eddy County, New Mexico ("Unleased Interest"), that is unleased and contains the horizontal spacing unit pooled in Order Nos. R-21537 and R-21537-A:

**Township 22 South, Range 27 East, N.M.P.M.**

SECTION 29: S/2 NW/4

6. In Case No. 21960, Mewbourne appears to have reopened the original case to provide notice to one of Griffin's predecessors, Charles Vernon Eskridge, II, who died on or about December 13, 1994. *See Exhibits 2 and 5*, included with the Application of Mewbourne Oil

Company for Compulsory Pooling, Eddy County, New Mexico, and accompanying exhibits, attached as ***Exhibit B***.

7. Mewbourne made no attempt to locate Mr. Eskridge's heirs, devisees, or descendants, nor the other owners of the unleased mineral interests pooled into the subject unit. Furthermore, Mewbourne failed to send a well proposal letter, AFE, or otherwise propose a lease or JOA, to Griffin's predecessor, prior to the pooling hearings, or allow them an opportunity to participate, as required by the New Mexico Oil and Gas Act, and Oil Conservation Division regulations. *See generally* NMSA 1978, § 70-2-17, 19.15.4.12 NMAC.

8. As such, Order Nos. R-21537 and R-21537-A are void because Mewbourne failed to provide notice of the hearings or make a necessary showing, and misrepresented to the Division during the hearings, that a good faith attempt was made to obtain a voluntary agreement with the pooled parties. Without such a finding that Mewbourne acted in good faith to obtain voluntary agreement with the pooled parties, the resulting pooling orders in Case Nos. 21496 and 21960 are void and should be rescinded. *See Continental Oil Co. v. N.M. Oil Cons. Comm'n*, 70 N.M. 310, 321, 373 P. 2d 809 (1962) (noting that the Commission is a creature of statute, and finding order invalid and void that lacked "basic jurisdictional findings, supported by evidence, . . . to show that the commission has heeded the mandate and standards set out by statute.").

9. The New Mexico District Court in Eddy County, New Mexico, determined in a quiet title action, attached as ***Exhibit A***, that Griffin is the owner of an unleased mineral interest in the unit as to the S/2 NW/4 of Section 29, included in the pooled unit under Pooling Order No. R-21537. The OCD lacks jurisdiction over contractual and title disputes, and New Mexico law has repeatedly recognized that "[e]xclusive jurisdiction of such matters reside in the courts of the State of New Mexico." *In re TMBR/Sharp*, Order No. R-11700. As such, the OCD must defer to the

Court's default judgment, which is attached as **Exhibit A**. The OCD's duty lies in the protection of correlative rights and necessitates that the Division vacate or declare void the pooling of Griffin's interests in Order Nos. R-21537 and R-21537-A.

10. Prior to considering Mewbourne's application for pooling, Mewbourne was required to provide notice to Griffin's predecessors of the pending pooling application. Mewbourne's failed to provide notice to Griffin's predecessors, and consequently Griffin, of the opportunity to protest Mewbourne's application.

11. Unfortunately, the issues addressed herein typify Mewbourne's "cookie cutter" approach to pooling applications that consistently deprive unleased mineral interest owners of their property rights and right to due process. Specifically, the March 29, 2021 well proposal letter attached to **Exhibit B** is directed to Charles V. Eskridge—who died in 1994—rather than to his estate. Nevertheless, the summary of communications attached as Exhibit C to **Exhibit B** states:

"4/03/2021: Certified mail packet received by Charles."

12. Looking to the attached return receipt reveals it was not signed by Charles V. Eskridge.

Recipient Signature	
Signature of Recipient:	C-19 CVE
Address of Recipient:	6651 w. 5 <sup>th</sup> St

Rather, "C-19" and "CVE" reveal that return receipt was marked by the postal worker under the certified mail signature confirmation process implemented during the Covid-19 pandemic where postal workers would not allow recipients to sign their name to maintain social distancing. Charles V. Eskridge could not sign the return receipt because he was dead, and the notation on the return



receipt clearly shows Charles V. Eskridge did not sign the return receipt. Mewbourne's statement that "Certified mail packed received by Charles" is false.

13. Thereafter, Mewbourne's summary of communications states that on April 9, 2021, it performed a "detailed search on the internet and no working phone number or email address found." Nevertheless, a detailed search was unnecessary as simply typing "Charles V. Eskridge" into google reveals that he died in 1994:



14. Had Mewbourne performed their duty with good faith and updated their title work, performed a simple google search, or looked at the return receipt they would have recognized: (1) Charles V. Eskridge was dead, (2) Charles V. Eskridge did not sign the return receipt, and (3) that notifying Charles V. Eskridge—rather than his estate—was wholly inadequate. Instead, Mewbourne relied on its notice of publication as a fall back—again giving notice to Charles V. Eskridge rather than his estate. *See Exhibit B*. This is wholly inadequate.

15. The Division erred in approving the pooling orders without first affording the mineral interest owners an opportunity to protest the application for pooling; as such, the

Division's approval of Mewbourne's pooling order violated due process rights and the Division's pooling rules.

16. As such, Griffin is entitled to, at least, its proportionate share, as described in Section 70-2-17 of the Oil and Gas Act. *See* § 70-2-17 ("seven-eighths of such interest shall be considered as a working interest and one-eighth shall be considered a royalty interest, and he shall in all events be paid one-eighth of all production from the unit and creditable to his interest").

17. In the alternative, Griffin requests this case be set for a *de novo* hearing before the Oil Conservation Commission because the Commission has jurisdiction and authority to award the requested relief to Griffin, pursuant to NMSA 1978, Section 70-2-13 and OCD Rule 19.15.4.23 NMAC. As provided in the Oil and Gas Act, the Commission has concurrent jurisdiction with the Division, NMSA 1978, § 70-2- 6(B); NMSA 1978, § 70-2-11(B). However, the Oil and Gas Act in Section 70-2-13 discusses the authority of the Commission for a *de novo* hearing only for proceedings brought by a party of record. Rule 19.15.4.10 limits *de novo* proceedings before the Commission to only those defined as a "party of record" in the underlying proceedings before the Division. Order No. R14097-A discusses who is a party of record for purposes of a *de novo* proceeding and that parties of record are limited to parties who actually entered in the case below. Neither Griffin, nor its predecessors in interest, entered an appearance in Case Nos. 21496 and 21960, and were not a "party of record" to the proceedings before the Division, because Mewbourne failed to properly alert them to the pooling application or the subsequent application to pool the additional interests.

18. Counsel has conferred with Mewbourne, but cannot come to an agreement with Mewbourne regarding this matter, and thus necessitates the filing of this application before the Division.

WHEREFORE, Griffin requests that the Division set this matter for special hearing before an Examiner of the Oil Conservation Division, and, after notice and hearing, enter an order revoking Mewbourne's pooling authority approved under order Nos. R-21537 and R-21537-A, or, in the alternative, modifying the pooling order to require Mewbourne to recognize Griffin's unleased mineral interest as a working interest in the pooled unit, and that the Division grant such further relief as the Division deems appropriate.

Respectfully submitted,

**Jackson Walker, LLP**

By: Reagan M. Marble

Reagan M. Marble  
NM Bar No. 161230  
1900 Broadway, Suite 1200  
San Antonio, Texas 78215  
210-978-7700  
[rmarble@jw.com](mailto:rmarble@jw.com)

*Attorneys for Griffin Energy Law, PLLC*

**CERTIFICATE OF SERVICE**

I hereby certify that on September 1, 2023, a true and correct copy of the foregoing pleading was served upon counsel by email who agreed to accept service of same:

Michael H. Feldewert  
Holland & Hart LLP  
110 N Guadalupe St.  
Santa Fe, NM 87501  
[mfeldewert@hollandhart.com](mailto:mfeldewert@hollandhart.com)

*Attorney for Mewbourne Oil Company*

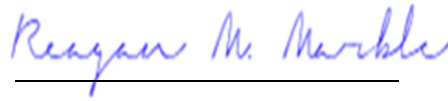
  
\_\_\_\_\_

# Exhibit

A

FILED  
5th JUDICIAL DISTRICT COURT  
Eddy County  
3/31/2023 3:27 PM  
MARTHA HUEREQUE  
CLERK OF THE COURT  
Martha Huereque

**Defendants.**

Case assigned to Riley, Lisa B.

**VERIFIED COMPLAINT TO QUIET TITLE**

COMES NOW Plaintiff Griffin Energy Law, PLLC, by and through its attorneys, Hinkle Shanor LLP (Jared A. Hembree and Melinda A. Branin) and for its Complaint to Quiet Title against Defendants states as follows:

**STATEMENT OF THE CASE**

1. This is an action under NMSA 1978 §42-6-1, *et seq.*, to quiet title to Plaintiff's undivided interests in the oil, gas, and other minerals in and under lands located in Eddy County, New Mexico.

**JURISDICTION AND VENUE**

2. The lands involved herein are situated wholly within Eddy County, New Mexico, being more particularly described as follows:

**Township 22 South, Range 27 East, N.M.P.M**

Section 19: E $\frac{1}{2}$ SE $\frac{1}{4}$

Section 29: S $\frac{1}{2}$ NW $\frac{1}{4}$

Section 30: E $\frac{1}{2}$ NE $\frac{1}{4}$

Containing 240 acres, more or less.

Hereinafter referred to as the "Subject Property."

3. Section 19 of the Subject Property is located approximately 1.44 miles West of Highway 285 and 0.75 miles South of Highway 180, Section 29 is located approximately 1.72 miles West of Highway 285 and 1.65 miles South of Highway 180, and Section 30 is located approximately 2 miles West of Highway 285 and 0.85 miles South of Highway 180.

4. Plaintiff owns an undivided  $11/60$  of  $8/8$ ths mineral interest in all the oil, gas, and other minerals in and under the Subject Property.

5. All Defendants that are nonresidents of the State of New Mexico are subject to *in rem* jurisdiction of this Court based upon their claim to ownership of interests in the Subject Property. All

Defendants that are residents of the State of New Mexico are subject to the personal jurisdiction of this Court and the *in rem* jurisdiction of this Court based upon their claim to ownership of interests in the property at issue.

6. Jurisdiction and venue are proper in this Court.

### **THE PARTIES**

7. Plaintiff Griffin Energy Law, PLLC is a Texas professional limited liability company organized under the laws of the State of Texas with its principal place of business in Midland, Texas.

8. Plaintiff has made a diligent search and inquiry to ascertain the names, whereabouts, and places of residence of any unknown heirs of the following deceased persons: CHARLES VERNON ESKRIDGE II, HINDA BARRY ESKRIDGE a.k.a. HINDA ANNAPOLIS BARRY ESKRIDGE, EDWARD W. ESKRIDGE, MATTIE ESKRIDGE, CLARA ESKRIDGE, MIRIAM ESKRIDGE HUNT, BUCKNER BRUMLEY BARRY, GLENNIE BARRY, ADELE T. MARCUS, KATHERINE MARCUS a.k.a. KATHERINE MARCUS BURKHALTER, LAWRENCE BARRY MARCUS, MARY GLEN MARCUS a.k.a. MARY GLEN SNYDER HANNIFIN, PATRICK J. HANNIFIN, MARY BRADLEY HANNIFIN, BUCKNER BRUMLEY BARRY, JR., BRENDA ANNICE BARRY, and TERRI LYNN HARGROVE. Plaintiff has not discovered any of this information. The unknown heirs of such deceased persons are made defendants under the name and style of "THE UNKNOWN HEIRS OF THE FOLLOWING DECEASED PERSONS: CHARLES VERNON ESKRIDGE II, HINDA BARRY ESKRIDGE a.k.a. HINDA ANNAPOLIS BARRY ESKRIDGE, EDWARD W. ESKRIDGE, MATTIE ESKRIDGE, CLARA ESKRIDGE, MIRIAM ESKRIDGE HUNT, BUCKNER BRUMLEY BARRY, GLENNIE BARRY, ADELE T. MARCUS, KATHERINE MARCUS a.k.a. KATHERINE MARCUS BURKHALTER, LAWRENCE BARRY MARCUS, MARY GLEN MARCUS a.k.a. MARY GLEN SNYDER HANNIFIN, PATRICK J. HANNIFIN, MARY BRADLEY HANNIFIN, BUCKNER BRUMLEY BARRY, JR., BRENDA ANNICE BARRY, and TERRI LYNN HARGROVE." By Rule 1-



004(J) and (K) NMRA, upon Order of the Court, Plaintiff shall give notice by publication to the unknown heirs of such deceased persons who may claim a lien, interest, or title adverse to Plaintiff.

9. Plaintiff, upon credible information and belief, alleges that other unknown persons may exist who claim a lien, interest, or title adverse to Plaintiff's undivided interests in the Subject Property. Plaintiff has made a diligent search and inquiry to ascertain the names, whereabouts, and residences of these unknown persons. Plaintiff has been unable to obtain such information. All unknown persons are made defendants under the name and style of: "ANY AND ALL UNKNOWN PERSONS WHO MAY CLAIM A LIEN, INTEREST, OR TITLE IN THE PREMISES ADVERSE TO THE PLAINTIFF." By Rule 1-004(J) and (K) NMRA, upon Order of the Court, Plaintiff shall be given notice by publication to the unknown persons who may claim a lien, interest, or title adverse to Plaintiff.

#### **CHAIN OF PLAINTIFF'S TITLE**

10. Plaintiff owns an undivided 11/60 of 8/8ths mineral interest in the Subject Property.

11. By Patent dated June 1, 1990, recorded as Patent No. 133150, William H. Taft, the President of the United States of America, patented the NW/4 of Section 29, Township 22 South, Range 27 East, Eddy County, New Mexico, to Hinda Barry Eskridge, the mother of Charles Vernon Eskridge, II.

12. By Patent dated September 25, 1911, recorded as Patent No. 226638, William H. Taft, the President of the United States of America, patented the E/2SE/4 of Section 19 and E/2NE/4 of Section 30, all in Township 22 South, Range 27 East, Eddy County, New Mexico to Edward W. Eskridge, the father of Charles Vernon Eskridge, II.

13. Edward W. Eskridge died on or about October 28, 1930, in Los Angeles, California, survived by his wife, Hinda Barry Eskridge, and his son, Charles Vernon Eskridge, II, as his only heirs at law. Upon information and belief, Edward W. Eskridge died intestate, and no New Mexico administration of his estate has been located. Edward W. Eskridge's interest in the Subject Property passed under the New Mexico laws of intestacy in place at the time of his death, resulting in his wife, Hinda Barry Eskridge,

receiving an undivided 5/8 interest and his son, Charles Vernon Eskridge, II, receiving an undivided 3/8 interest in the E½SE¼ of Section 19 and E½NE¼ of Section 30 of the Subject Property.

14. Hinda Barry Eskridge conveyed her interest in the Subject Property to her son, Charles Vernon Eskridge, II. *See Quitclaim Deed dated May 31, 1947, recorded in Eddy County Deeds Book 96, page 246.*

15. Charles Vernon Eskridge, II conveyed to Laurence L. Hord the E½SE¼ of Section 19 and the E½NE¼ of Section 30 of the Subject Property, reserving to himself an undivided 40% of all oil, gas, and other minerals lying in and under said lands. *See Warranty Deed dated September 26, 1947, recorded in Eddy County Deeds Book 98, page 147.*

16. Charles Vernon Eskridge, II conveyed to Frank Gentry all the S½NW¼ of Section 29 of the Subject Property, reserving to himself and undivided 40% of all oil, gas, and other minerals lying in and under said lands. *See Warranty Deed dated October 24, 1947, recorded in Eddy County Deeds Book 98, page 250.*

17. Charles Vernon Eskridge, II conveyed to Donald E. Blackmar, an undivided 20% interest in the oil, gas, and other minerals in the Subject Property. *See Mineral Deed dated September 14, 1970, recorded in Eddy County Deed Book 206, page 820.*

18. As a result of the conveyances described in paragraphs 14-17 above, Charles Vernon Eskridge, II owned an undivided 1/5 of 8/8ths mineral interest in the Subject Property (being a 20% interest).

19. An Affidavit of Marital Status from Mrs. Marguerite S. Davis Wells, as affiant, reflects that Charles Vernon Eskridge, II was married to Margaret Bentley on June 10, 1942, and their marriage ended in divorce on January 15, 1947, with no children born of the marriage. *See Affidavit of Marital Status dated October 28, 1977, recorded in Eddy County Miscellaneous Book 151, page 366.*

20. Upon information and belief, the interest in the Subject Property passed through the following estates of which no New Mexico probate or administration has been located:

a. **Charles Vernon Eskridge, II:**

Charles Vernon Eskridge, II died on or about December 13, 1994, in Los Angeles, California. Upon information and belief, he died intestate, unmarried, and without children. He was predeceased by his father, Edward W. Eskridge, his mother, Hinda Barry Eskridge, and his only sibling, William Barry Eskridge (who died as a child). His undivided 1/5 of 8/8ths mineral interest in the Subject Property passed under the New Mexico laws of intestacy in place at the time of his death, resulting in the interest passing to the descendants of his deceased mother, Hinda Barry Eskridge, who were living at the time of his death, as their sole and separate property, being: Katherine Marcus Burkhalter, Mary Glen Marcus Hannifin, Buckner Bunton Barry, Ann Barry Lewis, Deana R. Hargrove, Hal Dean Hargrove, Samuel B. Hargrove, Billy Russell Hargrove, James Wesley Willson, Jr., and Terri Lynn Hargrove.

b. **Mary Glen Marcus a.k.a. Mary Glen Snyder Hannifin:**

Mary Glen Marcus a.k.a. Mary Glen Snyder Hannifin died on January 2, 2000, in Solana Beach, San Diego County, California, survived by her husband, Patrick J. Hannifin, and her three children, Steven Patrick Hannifin, Margaret Jane Hannifin, and Mary Bradley Hannifin. Upon information and belief, Mary Glen Marcus died intestate and her interest in the Subject Property passed under the New Mexico laws of intestacy in place at the time of her death, resulting in her husband, Patrick J. Hannifin, receiving an undivided ¼ of her interest in the Subject Property and her children receiving an undivided ¾ of her interest in the Subject Property (being a ¼ of her interest each). *See Affidavits of Heirship recorded in Eddy County Records Book 1169, page 349, and Book 1169, page 350.*

c. **Patrick J. Hannifin:**

Patrick J. Hannifin died on January 9, 2014, in Solano Beach, San Diego County, California, predeceased by his wife, Mary Glen Marcus, and survived by his three children, Steven Patrick Hannifin, Margaret Jane Hannifin, and Mary Bradley Hannifin. Upon information and

belief, Patrick J. Hannifin died intestate and his interest in the Subject Property passed under the New Mexico laws of intestacy in place at the time of his death, resulting in his three children receiving his interest in the Subject Property in equal shares, as their sole and separate property.

d. **Mary Bradley Hannifin:**

Mary Bradley Hannifin died testate on December 7, 2014, in San Antonio, Texas. *See Affidavits of Heirship recorded in Eddy County Records Book 1169, page 351, and Book 1169, page 352.* She died unmarried and without issue, and she was survived by her siblings, Margaret Jane Hannifin and Steven Patrick Hannifin, as her only heirs at law. Her Last Will and Testament was probated in Bexar County, Texas Cause No. 2014PC4197. Mary Bradley Hannifin devised her interest in the Subject Property to her siblings, Margaret Jane Hannifin, and Steven Patrick Hannifin, in equal shares, as their sole and separate property. *See Last Will and Testament of Mary B. Hannifin, a true and correct copy of which is attached hereto as Exhibit A.*

e. **Katherine Marcus a/k/a Katherine Marcus Burkhalter:**

Upon information and belief, Katherine Marcus died on May 10, 2015, in Fort Worth, Texas, not married and without children. She was survived by her niece and nephew, namely: Steven Patrick Hannifin and Margaret Jane Hannifin. Upon information and belief, Katherine Marcus died intestate and her interest in the Subject Property passed under the New Mexico laws of intestacy in place at the time of her death, resulting in Steven Patrick Hannifin and Margaret Jane Hannifin receiving her interest in equal shares, as their sole and separate property. *See Affidavits of Heirship recorded in Eddy County Records Book 1169, page 353, and Book 1169, page 354.*

f. **Terri Lynn Hargrove:**

Terri Lynn Hargrove died on January 27, 2020, in Clyde, Texas, not married, and survived by her daughter, Chelsea Holland. Upon information and belief, Terri Lynn Hargrove died

intestate and her interest in the Subject Property passed under the New Mexico laws of intestacy in place at the time of her death, resulting in Chelsea Holland receiving her interest in the Subject Property, as her sole and separate property. *See Affidavits of Heirship recorded in Eddy County Records Book 1169, page 355, and Book 1169, page 356.*

21. The heirs of Charles Vernon Eskridge, II entered into a Family Settlement Agreement to confirm their ownership of the Subject Property in the following proportions:

Steven Patrick Hannifin	3/8
Margaret Jane Hannifin	3/8
Ann Barry Lewis	1/12
Buckner Bunton Barry	1/12
Deana Rena Hargrove	1/72
Hal Dean Hargrove	1/72
Samuel B. Hargrove	1/72
Billy Russell Hargrove, Jr.	1/72
James Wesley Willson, Jr.	1/72
Chelsea Holland	1/72
Total:	100% (being a collective 1/5 mineral interest)

*See executed Family Settlement Agreement effective February 1, 2020, recorded in Eddy County Records Book 1169, page 357.*

22. Deana Rena Hargrove conveyed all of her interest in the Subject Property to Griffin Energy Law, PLLC. *See Mineral and Royalty Deed dated March 17, 2023, effective March 1, 2020, recorded in Eddy County Records Book 1169, page 361.*

23. Ann Barry Lewis conveyed all of her interest in the Subject Property to Griffin Energy Law, PLLC. *See Mineral and Royalty Deed dated March 18, 2023, effective March 1, 2020, recorded in Eddy County Records Book 1169, page 360.*

24. Chelsea Holland conveyed all of her interest in the Subject Property to Griffin Energy Law, PLLC. *See Mineral and Royalty Deed dated March 17, 2023, effective March 1, 2020, recorded in Eddy County Records Book 1169, page 365.*

25. James Wesley Willson, Jr. conveyed all of his interest in the Subject Property to Griffin Energy Law, PLLC. *See Mineral and Royalty Deed dated March 17, 2023, effective March 1, 2020, recorded in Eddy County Records Book 1169, page 362.*

26. Steven Patrick Hannifin conveyed all of his interest in the Subject Property to Griffin Energy Law, PLLC. *See Mineral and Royalty Deed dated March 16, 2023, effective March 1, 2020, recorded in Eddy County Records Book 1169, page 358.*

27. Margaret Jane Hannifin conveyed all of her interest in the Subject Property to Griffin Energy Law, PLLC. *See Mineral and Royalty Deed dated March 16, 2023, effective March 1, 2020, recorded in Eddy County Records Book 1169, page 359.*

28. Hal Dean Hargrove conveyed all of his interest in the Subject Property to Griffin Energy Law, PLLC. *See Mineral and Royalty Deed dated March 17, 2023, effective March 1, 2020, recorded in Eddy County Records Book 1169, page 363.*

29. Billy Russell Hargrove conveyed all of his interest in the Subject Property to Griffin Energy Law, PLLC. *See Mineral and Royalty Deed dated March 17, 2023, effective March 1, 2020, recorded in Eddy County Records Book 1169, page 364.*

30. Samuel B. Hargrove conveyed all of his interest in the Subject Property to Griffin Energy Law, PLLC. *See Mineral and Royalty Deed dated March 17, 2023, effective March 1, 2020, recorded in Eddy County Records Book 1169, page 414.*

31. As a result of the foregoing, Plaintiff owns an undivided 11/60 of 8/8ths mineral interest in the Subject Property (being 11/12 of the undivided 1/5 mineral interest originally owned by Charles Vernon Eskridge, II).

### CONCLUSION

32. The adverse claims of the Defendants, if any, against the title of the Plaintiff must be quieted and set at rest.

33. It is appropriate for this Court to make its determination that Plaintiff owns an undivided 11/60 of 8/8ths mineral interest in the Subject Property, and Plaintiff, free and clear of any adverse claims of the Defendants; subject, however, to any valid and existing leases of record which may have been executed by Plaintiff's predecessors-in-interest.

**WHEREFORE**, Plaintiff prays that (i) its ownership of an undivided 11/60 of 8/8ths mineral interest in the Subject Property, subject to any valid and existing leases of record which may have been executed by Plaintiff's predecessors-in-interest, as set forth above, be established against all adverse claims of the Defendants, and each of them; that Defendants, and each of them, be barred and forever estopped from having or claiming any lien or other interest upon any right or title to Plaintiff's interest in the Subject Property, or any portion thereof, adverse to Plaintiff; that the Court determine the heirs and/or devisees of the following deceased persons to be: (i) the heirs of Edward W. Eskridge be determined to be Hinda Barry Eskridge and Charles Vernon Eskridge, II; (ii) the heirs of Charles Vernon Eskridge, II be determined to be Katherine Marcus Burkhalter, Mary Glen Marcus Hannifin, Buckner Bunton Barry, Ann Barry Lewis, Deana Rena Hargrove, Hal Dean Hargrove, Samuel B. Hargrove, Billy Russell Hargrove, Jr., James Wesley Willson, Jr., and Terri Lynn Hargrove; (iii) the heirs of Mary Glen Marcus Hannifin be determined to be Patrick J. Hannifin, Steven Patrick Hannifin, Margaret Jane Hannifin, and Mary Bradley Hannifin; (iv) the heirs of Patrick J. Hannifin be determined to be Steven Patrick Hannifin, Margaret Jane Hannifin, and Mary Bradley Hannifin; (v) the heirs and devisees of Mary Bradley Hannifin be determined to be Steven Patrick Hannifin and Margaret Jane Hannifin; (vi) the heirs of Katherine Marcus Burkhalter be determined to be Steven Patrick Hannifin and Margaret Jane Hannifin; (vii) the heir of Terri Lynn Hargrove be determined to be Chelsea Holland; that title to Plaintiff's interests in the Subject property be forever quieted and set at rest; and for such other relief as the Court deems proper.

Respectfully submitted,

**HINKLE SHANOR LLP**

By: 

Jared A. Hembree

Melinda A. Branin

P.O. Box 10

Roswell, New Mexico 88202-0010

(575) 622-6510

(575) 623-9332 (FAX)

[jhembree@hinklelawfirm.com](mailto:jhembree@hinklelawfirm.com)

[mbranin@hinklelawfirm.com](mailto:mbranin@hinklelawfirm.com)

*Attorneys for Plaintiff Griffin Energy Law, PLLC*



**SELF-AFFIRMED VERIFICATION**

SEAN GRIFFIN, as member of Griffin Energy Law, PLLC, Plaintiff herein, swears under the penalty of perjury under New Mexico law that: (a) I have read the above and foregoing *Complaint to Quiet Title*; and, (b) from personal knowledge know the matters therein contained are true and correct, except that those matters that are alleged upon information and belief, and as to those, I believe them to be true based on the information available to me.

  
\_\_\_\_\_  
**SEAN GRIFFIN, Plaintiff**  
**as member of Griffin Energy Law, PLLC**

Dated: March 31, 2023

**LAST WILL AND TESTAMENT**  
**OF**  
**MARY B. HANNIFIN**

I, MARY B. HANNIFIN, of Bexar County, Texas, declare this to be my Last Will and Testament. I hereby revoke all wills and codicils previously made by me.

**SECTION 1**  
**DISPOSITION OF PROPERTY**

**1.1 Specific Bequests.**

- A. I give the sum of \$10,000.00 cash to BRENDA LOZANO, if she survives me.
- B. I give my dog "Bella" to BRENDA LOZANO, if she survives me.
- C. To MARGARET JANE HANNIFIN, I give the wedding dress, my mink coat, and my gold rope pattern "dome" ring.
- D. To STEVEN P. HANNIFIN, I give the picture of our father in a wood and brass frame, my locket with pictures of our mother and father, our mother's childhood bible, the Ben Turner adobe painting, if in my possession, and a photo of our grandmother and me.
- E. To HONOR M.C. BASLIM, I give my gold bar pin with three diamonds and the framed handkerchiefs.
- F. I give to BRENDA LOZANO all eBay clothes and items in my garage and off-site storage unit and all other contents of the storage unit.
- G. I may tag other items of my personal property with a recipient's name or initials. I request that my executor distribute these items according to my designation.

1.2 Mineral Interests and Insurance. I give all oil, gas and other mineral and royalty interests I may own or be entitled to, to MARGARET JANE HANNIFIN and STEVEN P. HANNIFIN, in equal shares. I also give any life insurance benefits from my father's estate which have not been distributed to me as of the date of my death to MARGARET JANE HANNIFIN and STEVEN P. HANNIFIN, in equal shares. If one of them predeceases me, but is survived by living descendants, then his or her share of these bequests shall pass to such then living descendants on a per stirpes basis. If such deceased person is not survived by descendants, then these bequests shall pass to the survivor of them, or his or her living descendants, on a per stirpes basis.

1.3 I give all of the rest, residue and remainder of my estate, in equal shares, to those of MARY WYGOCKI MCCLURE and VIOLA WYGOCKI HALE, who are living at the date of my death.

## **SECTION 2** **INDEPENDENT EXECUTOR**

2.1 I appoint STEVEN P. HANNIFIN as independent executor of my estate. If he fails or ceases to act as executor for any reason, then I appoint KEVIN P. KENNEDY as independent executor.

2.2 No bond shall be required of my independent executor.

## **SECTION 3** **ADMINISTRATION**

3.1 No action shall be had in any court of probate jurisdiction in relation to the settlement of my estate other than the probating and recording of this will and the return of an inventory, appraisement, and list of claims of my estate.

3.2 My Independent Executor shall have all of the powers of a trustee under the Texas Trust Code. My Independent Executor shall be entitled to reasonable compensation for his services as Independent Executor.

3.3 The following items shall be charged against my residuary estate:

- A. All taxes (including any interest and penalties) payable by reason of my death.
- B. All of my debts, except that any debts which are payable in installments or are not due until at least one year from the date of my death need not be paid during the administration of my estate but may, if the terms of such debts permit, be continued and paid according to their tenor.
- C. All of my funeral expenses, the expenses of my last illness, and expenses of administering my estate.

These charges may be paid in such order and out of such of the assets in my residuary estate (including its income) as my executor deems appropriate.

3.4 In determining the estate and income tax liability related to my estate, my executor's decision as to all available tax elections and any election with respect to employee benefits payable by reason of my death shall be conclusive on all concerned. No compensating adjustments between income and principal or in the amount of any gift under this will shall be made as a result of any tax election.

#### **SECTION 4** **FORFEITURE OF INTEREST**

If any beneficiary, directly or indirectly, shall contest the validity of this will; or shall institute or join in (except as a party defendant) any proceeding to prevent any provision of this will from being carried out in accordance with its terms; or shall in any manner aid, assist or encourage another

in any such contest; then all benefits provided for such beneficiary in this will are revoked and such benefits shall pass to the residuary beneficiaries of this will (other than the contesting beneficiary) in proportion that the share of each such residuary beneficiary bears to the aggregate of the effective shares of all residuary beneficiaries (other than the contesting beneficiary).

**SECTION 5**  
**DEFINITIONS AND GENERAL PROVISIONS**

5.1 Any beneficiary who dies within 30 days after my death shall be considered not to have survived me.

5.2 No beneficiary of my estate shall have the power to anticipate, encumber or transfer his interest in my estate in any manner. No part of my estate shall be liable for or charged with any debts, contracts, liabilities or torts of a beneficiary or subject to seizure or other process by any creditor of a beneficiary.

5.3 Use of any gender includes the other genders, and the use of either the singular or the plural includes the other.

IN TESTIMONY WHEREOF, I hereunto sign my name to this my Last Will and Testament, consisting of six (6) typewritten pages, (including an attestation clause, signatures of witnesses and attached affidavit) on this the 22nd day of July, 2014.

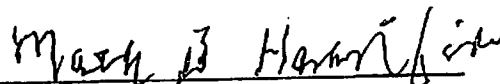
  
MARY B. HANNIFIN

We, the undersigned, do hereby certify that on the date above written, the foregoing instrument was signed and declared by MARY B. HANNIFIN to be her Last Will and Testament, in our presence. At her request, in her presence and in the presence of each other, we have signed our names as witnesses.

  
Witness

Address: 1920 Nacogdoches Rd., Suite 100  
San Antonio, Texas 78209

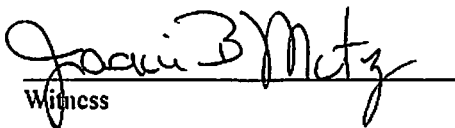
  
Witness

Address: 1920 Nacogdoches Rd., Suite 100  
San Antonio, Texas 78209

STATE OF TEXAS       §  
                                   §  
 COUNTY OF BEXAR    §

BEFORE ME, the undersigned authority, on this day personally appeared MARY B. HANNIFIN, Kim J. Harbert and Jackie B. Mutz, known to me to be the Testatrix and the witnesses, respectively, whose names are subscribed to the annexed and foregoing instrument in their respective capacities, and, all of said persons being by me duly sworn, the said MARY B. HANNIFIN, Testatrix, declared to me and to the witnesses in my presence that said instrument is her Last Will and Testament, and that she had willingly made and executed it as her free act and deed for the purposes therein expressed; and the witnesses, each on their oath stated to me, in the presence and hearing of the Testatrix, that the said Testatrix had declared to them that said instrument is her Last Will and Testament, and that she executed the same as such and wanted each of them to sign it as a witness and upon their oath each witness stated further that they did sign the same as witnesses in the presence of the Testatrix and at her request; that she was at that time eighteen years of age or over and was of sound mind; and that each of the witnesses was then at least fourteen years of age.

Mary B. Hannifin  
 MARY B. HANNIFIN

Kim J. Harbert  
 Witness

Jackie B. Mutz  
 Witness

SUBSCRIBED AND SWORN TO BEFORE ME by MARY B. HANNIFIN, Testatrix, and Kim J. Harbert and Jackie B. Mutz, witnesses, this 2nd day of July, 2014.

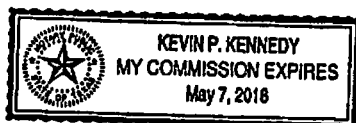

K. P. Kennedy  
 Notary Public, State of Texas

FILED  
5th JUDICIAL DISTRICT COURT  
Eddy County  
7/10/2023 2:03 PM  
MARTHA HUEREQUE  
CLERK OF THE COURT  
Gwyneth Gadbury

STATE OF NEW MEXICO  
COUNTY OF EDDY  
FIFTH JUDICIAL DISTRICT

GRIFFIN ENERGY LAW, PLLC

Plaintiff,

v.

THE UNKNOWN HEIRS OF THE  
FOLLOWING DECEASED PERSONS:  
CHARLES VERNON ESKRIDGE II,  
HINDA BARRY ESKRIDGE a.k.a.  
HINDA ANNAPOLIS BARRY ESKRIDGE,  
EDWARD W. ESKRIDGE, MATTIE  
ESKRIDGE, CLARA ESKRIDGE,  
MIRIAM ESKRIDGE HUNT, BUCKNER  
BRUMLEY BARRY, GLENNIE BARRY,  
ADELE T. MARCUS, KATHERINE  
MARCUS a.k.a. KATHERINE MARCUS  
BURKHALTER, LAWRENCE BARRY  
MARCUS, MARY GLEN MARCUS a.k.a.  
MARY GLEN SNYDER HANNIFIN,  
PATRICK J. HANNIFIN, MARY  
BRADLEY HANNIFIN, BUCKNER  
BRUMLEY BARRY, JR., BRENDA  
ANNICE BARRY, and TERRI LYNN  
HARGROVE;

and

ANY AND ALL UNKNOWN  
PERSONS WHO MAY CLAIM A LIEN,  
INTEREST, OR TITLE IN THE  
PREMISES ADVERSE TO THE  
PLAINTIFF;

Defendants.

D-503-CV-2023-00311

DEFAULT JUDGMENT AND FINAL DECREE QUIETING TITLE

THIS CAUSE coming to be heard before the Court on Plaintiff's *Motion for Default Judgment and Final Decree Quieting Title*, and the Plaintiff being represented by its attorneys of



record, Hinkle Shanor LLP (Jared A. Hembree and Melinda A. Branin), and it appearing to the Court that each and all of Defendants have been served with process as required by law, but that none of the Defendants have entered their appearance or otherwise pled herein, and the Clerk of the District Court has issued a *Certificate as to the State of the Record and Non-Appearance of Defendants* against all Defendants herein.

**IT IS, THEREFORE, ORDERED, ADJUDGED, AND DECREED** that Defendants: The Unknown Heirs of the following Deceased Persons: Charles Vernon Eskridge II, Hinda Barry Eskridge a.k.a. Hinda Annapolis Barry Eskridge, Edward W. Eskridge, Mattie Eskridge, Clara Eskridge, Miriam Eskridge Hunt, Buckner Brumley Barry, Glennie Barry, Adele T. Marcus, Katherine Marcus a.k.a. Katherine Marcus Burkhalter, Lawrence Barry Marcus, Mary Glen Marcus a.k.a. Mary Glen Snyder Hannifin, Patrick J. Hannifin, Mary Bradley Hannifin, Buckner Brumley Barry, Jr., Brenda Annice Barry, and Terri Lynn Hargrove; and Any and All Unknown Persons who may claim a Lien, Interest, or Title in the Premises adverse to the Plaintiff, be and hereby are jointly and severally adjudged to be in default and this proceeding may be heard and decided without further notice to said defaulting Defendants.

**THIS MATTER COMING ON FURTHER TO BE HEARD**, and the Court having examined the pleadings filed herein and being otherwise fully advised in the premises, **FINDS:**

1. The lands involved herein are situated wholly within Eddy County, New Mexico.
2. The defaulting Defendants have been duly served with process in accordance with law and by order entered in this Cause; the time for answering has expired, and none of the defaulting Defendants have filed an answer, motion, or otherwise responsive pleading herein.
3. Plaintiff claims an undivided 11/60 of 8/8ths mineral interest in and under the following described lands in Eddy County, New Mexico:

**Township 22 South, Range 27 East, N.M.P.M**

Section 19: E $\frac{1}{2}$ SE $\frac{1}{4}$

Section 29: S $\frac{1}{2}$ NW $\frac{1}{4}$

Section 30: E $\frac{1}{2}$ NE $\frac{1}{4}$

Containing 240 acres, more or less.

Hereinafter referred to as the "Subject Property."

4. By Patent dated June 1, 1990, recorded as Patent No. 133150, William H. Taft, the President of the United States of America, patented the NW/4 of Section 29, Township 22 South, Range 27 East, Eddy County, New Mexico, to Hinda Barry Eskridge, the mother of Charles Vernon Eskridge, II.

5. By Patent dated September 25, 1911, recorded as Patent No. 226638, William H. Taft, the President of the United States of America, patented the E/2SE/4 of Section 19 and E/2NE/4 of Section 30, all in Township 22 South, Range 27 East, Eddy County, New Mexico to Edward W. Eskridge, the father of Charles Vernon Eskridge, II.

6. Edward W. Eskridge died on or about October 28, 1930, in Los Angeles, California, survived by his wife, Hinda Barry Eskridge, and his son, Charles Vernon Eskridge, II, as his only heirs at law. Edward W. Eskridge died intestate, and no New Mexico administration of his estate has been located. Edward W. Eskridge's interest in the Subject Property passed under the New Mexico laws of intestacy in place at the time of his death, resulting in his wife, Hinda Barry Eskridge, receiving an undivided 5/8 interest and his son, Charles Vernon Eskridge, II, receiving an undivided 3/8 interest in the E $\frac{1}{2}$ SE $\frac{1}{4}$  of Section 19 and E $\frac{1}{2}$ NE $\frac{1}{4}$  of Section 30 of the Subject Property.

7. By Quitclaim Deed dated May 31, 1947, Hinda Barry Eskridge conveyed her interest in the Subject Property to her son, Charles Vernon Eskridge, II.

8. By Warranty Deed dated September 26, 1947, Charles Vernon Eskridge, II conveyed to Laurence L. Hord the E½SE¼ of Section 19 and the E½NE¼ of Section 30 of the Subject Property, reserving to himself an undivided 40% of all oil, gas, and other minerals lying in and under said lands.

9. By Warranty Deed dated October 24, 1947, Charles Vernon Eskridge, II conveyed to Frank Gentry all the S½NW¼ of Section 29 of the Subject Property, reserving to himself and undivided 40% of all oil, gas, and other minerals lying in and under said lands.

10. By Mineral Deed dated September 14, 1970, Charles Vernon Eskridge, II conveyed to Donald E. Blackmar, an undivided 20% interest in the oil, gas, and other minerals in the Subject Property.

11. As a result of the conveyances described above, Charles Vernon Eskridge, II owned an undivided 1/5 of 8/8ths mineral interest in the Subject Property (being a 20% interest).

12. Charles Vernon Eskridge, II was married to Margaret Bentley on June 10, 1942, and their marriage ended in divorce on January 15, 1947, with no children born of the marriage.

13. The interest in the Subject Property passed through the following estates of which no New Mexico probate or administration has been located:

i. **Charles Vernon Eskridge, II:**

Charles Vernon Eskridge, II died on or about December 13, 1994, in Los Angeles, California. He died intestate, unmarried, and without children. He was predeceased by his father, Edward W. Eskridge, his mother, Hinda Barry Eskridge, and his only sibling, William Barry Eskridge (who died as a child). His undivided 1/5 of 8/8ths mineral interest in the Subject Property passed under the New Mexico laws of intestacy in place at the time of his death, resulting in the interest passing to the descendants of his

deceased mother, Hinda Barry Eskridge, who were living at the time of his death, as their sole and separate property, being: Katherine Marcus Burkhalter, Mary Glen Marcus Hannifin, Buckner Bunton Barry, Ann Barry Lewis, Deana R. Hargrove, Hal Dean Hargrove, Samuel B. Hargrove, Billy Russell Hargrove, James Wesley Willson, Jr., and Terri Lynn Hargrove.

**ii. Mary Glen Marcus a.k.a. Mary Glen Snyder Hannifin:**

Mary Glen Marcus a.k.a. Mary Glen Snyder Hannifin died on January 2, 2000, in Solana Beach, San Diego County, California, survived by her husband, Patrick J. Hannifin, and her three children, Steven Patrick Hannifin, Margaret Jane Hannifin, and Mary Bradley Hannifin. Mary Glen Marcus died intestate and her interest in the Subject Property passed under the New Mexico laws of intestacy in place at the time of her death, resulting in her husband, Patrick J. Hannifin, receiving an undivided  $\frac{1}{4}$  of her interest in the Subject Property and her children receiving an undivided  $\frac{3}{4}$  of her interest in the Subject Property (being a  $\frac{1}{4}$  of her interest each).

**iii. Patrick J. Hannifin:**

Patrick J. Hannifin died on January 9, 2014, in Solano Beach, San Diego County, California, predeceased by his wife, Mary Glen Marcus, and survived by his three children, Steven Patrick Hannifin, Margaret Jane Hannifin, and Mary Bradley Hannifin. Patrick J. Hannifin died intestate and his interest in the Subject Property passed under the New Mexico laws of intestacy in place at the time of his death, resulting in his three children receiving his interest in the Subject Property in equal shares, as their sole and separate property.

iv. **Mary Bradley Hannifin:**

Mary Bradley Hannifin died testate on December 7, 2014, in San Antonio, Texas. She died unmarried and without issue, and she was survived by her siblings, Margaret Jane Hannifin and Steven Patrick Hannifin, as her only heirs at law. Her Last Will and Testament was probated in Bexar County, Texas Cause No. 2014PC4197. Mary Bradley Hannifin devised her interest in the Subject Property to her siblings, Margaret Jane Hannifin, and Steven Patrick Hannifin, in equal shares, as their sole and separate property.

v. **Katherine Marcus a/k/a Katherine Marcus Burkhalter:**

Katherine Marcus died on May 10, 2015, in Fort Worth, Texas, not married and without children. She was survived by her niece and nephew, namely: Steven Patrick Hannifin and Margaret Jane Hannifin. Katherine Marcus died intestate and her interest in the Subject Property passed under the New Mexico laws of intestacy in place at the time of her death, resulting in Steven Patrick Hannifin and Margaret Jane Hannifin receiving her interest in equal shares, as their sole and separate property.

vi. **Terri Lynn Hargrove:**

Terri Lynn Hargrove died on January 27, 2020, in Clyde, Texas, not married, and survived by her daughter, Chelsea Holland. Terri Lynn Hargrove died intestate and her interest in the Subject Property passed under the New Mexico laws of intestacy in place at the time of her death, resulting in Chelsea Holland receiving her interest in the Subject Property, as her sole and separate property.

14. The heirs of Charles Vernon Eskridge, II entered into a Family Settlement Agreement effective February 1, 2020, to confirm their ownership of the Subject Property in the following proportions:

Steven Patrick Hannifin	3/8
Margaret Jane Hannifin	3/8
Ann Barry Lewis	1/12
Buckner Bunton Barry	1/12
Deana Rena Hargrove	1/72
Hal Dean Hargrove	1/72
Samuel B. Hargrove	1/72
Billy Russell Hargrove, Jr.	1/72
James Wesley Willson, Jr.	1/72
Chelsea Holland	1/72
Total:	100% (being a collective 1/5 mineral interest)

15. By Mineral and Royalty Deed effective March 1, 2023, Deana Rena Hargrove conveyed all of her interest in the Subject Property to Griffin Energy Law, PLLC.

16. By Mineral and Royalty Deed effective March 1, 2023, Ann Barry Lewis conveyed all of her interest in the Subject Property to Griffin Energy Law, PLLC.

17. By Mineral and Royalty Deed effective March 1, 2020, Chelsea Holland conveyed all of her interest in the Subject Property to Griffin Energy Law, PLLC.

18. By Mineral and Royalty Deed effective March 1, 2020, James Wesley Willson, Jr. conveyed all of his interest in the Subject Property to Griffin Energy Law, PLLC.

19. By Mineral and Royalty Deed effective March 1, 2020, Steven Patrick Hannifin conveyed all of his interest in the Subject Property to Griffin Energy Law, PLLC.

20. By Mineral and Royalty Deed effective March 1, 2020, Margaret Jane Hannifin conveyed all of her interest in the Subject Property to Griffin Energy Law, PLLC.

21. By Mineral and Royalty Deed effective March 1, 2020, Hal Dean Hargrove conveyed all of his interest in the Subject Property to Griffin Energy Law, PLLC.

22. By Mineral and Royalty Deed effective March 1, 2020, Billy Russell Hargrove conveyed all of his interest in the Subject Property to Griffin Energy Law, PLLC.

23. By Mineral and Royalty Deed effective March 1, 2020, Samuel B. Hargrove conveyed all of his interest in the Subject Property to Griffin Energy Law, PLLC.

24. As a result of the foregoing, Plaintiff owns an undivided 11/60 of 8/8ths mineral interest in the Subject Property (being 11/12 of the undivided 1/5 mineral interest originally owned by Charles Vernon Eskridge, II).

**BASED UPON THE ABOVE FINDINGS OF FACT, THE COURT CONCLUDES  
AS A MATTER OF LAW:**

A. The Court has jurisdiction of the parties hereto and the subject matter hereof.

B. Plaintiff is entitled to a decree quieting their interest in the Subject Property, as described in Finding of Fact No. 24 above, against the defaulting Defendants herein.

**THEREFORE, IT IS ORDERED, ADJUDGED, AND DECREED**, that (i) the heirs of Edward W. Eskridge be determined to be Hinda Barry Eskridge and Charles Vernon Eskridge, II; (ii) the heirs of Charles Vernon Eskridge, II be determined to be Katherine Marcus Burkhalter, Mary Glen Marcus Hannifin, Buckner Bunton Barry, Ann Barry Lewis, Deana Rena Hargrove, Hal Dean Hargrove, Samuel B. Hargrove, Billy Russell Hargrove, Jr., James Wesley Willson, Jr.,

and Terri Lynn Hargrove; (iii) the heirs of Mary Glen Marcus Hannifin be determined to be Patrick J. Hannifin, Steven Patrick Hannifin, Margaret Jane Hannifin, and Mary Bradley Hannifin; (iv) the heirs of Patrick J. Hannifin be determined to be Steven Patrick Hannifin, Margaret Jane Hannifin, and Mary Bradley Hannifin; (v) the heirs and devisees of Mary Bradley Hannifin be determined to be Steven Patrick Hannifin and Margaret Jane Hannifin; (vi) the heirs of Katherine Marcus Burkhalter be determined to be Steven Patrick Hannifin and Margaret Jane Hannifin; (vii) the heir of Terri Lynn Hargrove be determined to be Chelsea Holland; (viii) that Plaintiff's title in and to the undivided interest in the Subject Property as set forth in Finding of Fact No. 24 above be established against all adverse claims of Defendants, and each of them; and (ix) that said Defendants, and each of them, and all persons claiming by, through, or under them, are forever barred and estopped from having or claiming any lien or other interests upon any right to or title to the Plaintiff's interest in and to the Subject Property, or any portion thereof, adverse to the Plaintiff.

**DONE** in the District Court of Eddy County, New Mexico, on the date of filing of this Final Decree in this Cause.

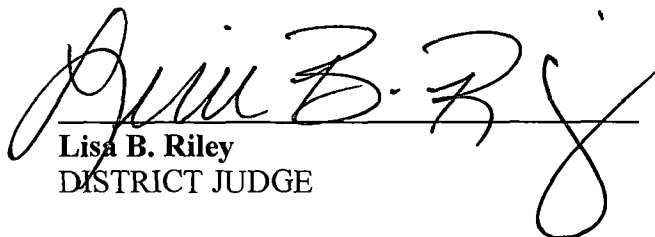
  
Lisa B. Riley  
DISTRICT JUDGE

Respectfully submitted:  
**HINKLE SHANOR LLP**

By: /s/ Jared A. Hembree  
Jared A. Hembree  
Melinda A. Branin  
P.O. Box 10  
Roswell, New Mexico 88202  
(575) 622-6510 / (575) 623-9332 (FAX)  
[jhembree@hinklelawfirm.com](mailto:jhembree@hinklelawfirm.com)  
[mbranin@hinklelawfirm.com](mailto:mbranin@hinklelawfirm.com)  
*Attorneys for Plaintiff*



# Exhibit

# B

**CASE NO. 21960**

**APPLICATIONS OF MEWBOURNE OIL COMPANY FOR COMPULSORY POOLING,  
EDDY COUNTY, NEW MEXICO**

**MEWBOURNE OIL COMPANY'S EXHIBIT LIST**

1. Application and Proposed Notice
2. Landman's Affidavit
3. Geologist's Affidavit
4. Notice Affidavit
5. Affidavit of Publication
6. Pooling Checklist



**BEFORE THE NEW MEXICO OIL CONSERVATION DIVISION**

**APPLICATION OF MEWBOURNE OIL COMPANY  
TO RE-OPEN CASE NO. 21496, FOR COMPULSORY  
POOLING, TO POOL ADDITIONAL PARTIES, EDDY  
COUNTY, NEW MEXICO.**

Case No. 21966**APPLICATION**

Mewbourne Oil Company applies for an order pooling all mineral interests in the Wolfcamp formation underlying a horizontal spacing unit comprised of the N/2 of Section 28 and the N/2 of Section 29, Township 22 South, Range 27 East, N.M.P.M., Eddy County, New Mexico, and in support thereof, states:

1. Applicant is an interest owner in the N/2 of Section 28 and the N/2 of Section 29, and has the right to drill a well or wells thereon.

2. Applicant proposes to drill the following wells to a depth sufficient to test the Wolfcamp formation:

(a) The City Slickers 28/29 W0HE Fee Well No. 1H, with a first take point in the SE/4NE/4 of 28 and a last take point in the SW/4NW/4 of Section 29; and

(b) The City Slickers 28/29 W0AD Fee Well No. 1H, with a first take point in the NE/4NE/4 of 28 and a last take point in the NW/4NW/4 of Section 29.

The N/2 of Section 28 and the N/2 of Section 29 will be dedicated to the wells.

3. This matter was heard in Case No. 21496, in which Order No. R-21537 was issued. Additional parties need to be pooled into the well unit.

4. Applicant has in good faith sought to obtain the voluntary joinder of all other mineral interest owners in the N/2 of Section 28 and the N/2 of Section 29 for the purposes set forth herein.

EXHIBIT |

5. Although applicant attempted to obtain voluntary agreements from all mineral interest owners to participate in the drilling of the wells or to otherwise commit their interests to the wells, certain interest owners have failed or refused to join in dedicating their interests. Therefore, applicant seeks an order pooling all mineral interest owners in the Wolfcamp formation underlying the N/2 of Section 28 and the N/2 of Section 29, pursuant to NMSA 1978 §§70-2-17.

6. The pooling of all mineral interest owners in the Wolfcamp formation underlying the N/2 of Section 28 and the N/2 of Section 29 will prevent the drilling of unnecessary wells, prevent waste, and protect correlative rights.

**WHEREFORE**, applicant requests that, after notice and hearing, the Division enter its order:

- A. Pooling all mineral interest owners in the Wolfcamp formation underlying the N/2 of Section 28 and the N/2 of Section 29;
- B. Designating applicant as operator of the wells;
- C. Considering the cost of drilling, completing, and equipping the wells, and allocating the cost among the wells' working interest owners;
- D. Approving actual operating charges and costs charged for supervision, together with a provision adjusting the rates pursuant to the COPAS accounting procedure; and
- E. Setting a 200% charge for the risk involved in drilling, completing, and equipping the wells in the event a working interest owner elects not to participate in the wells.

Respectfully submitted,

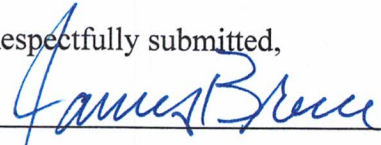
  
\_\_\_\_\_

James Bruce

Post Office Box 1056  
Santa Fe, New Mexico 87504  
(505) 982-2043

Attorney for Mewbourne Oil Company

***Application of Mewbourne Oil Company to re-open Case No. 21496, for compulsory pooling, to pool additional parties, Eddy County, New Mexico.*** Mewbourne Oil Company seeks an order pooling all mineral interests in the Wolfcamp formation underlying a horizontal spacing unit comprised of the N/2 of Section 28 and the N/2 of Section 29, Township 22 South, Range 27 East, NMPM. The unit will be dedicated to (a) The City Slickers 28/29 W0HE Fee Well No. 1H, with a first take point in the SE/4NE/4 of 28 and a last take point in the SW/4NW/4 of Section 29, and (b) The City Slickers 28/29 W0AD Fee Well No. 1H, with a first take point in the NE/4NE/4 of 28 and a last take point in the NW/4NW/4 of Section 29. Also to be considered will be the cost of drilling, completing, and equipping the wells and the allocation of the cost thereof, as well as actual operating costs and charges for supervision, designation of applicant as operator of the wells, and a 200% charge for the risk involved in drilling, completing, and equipping the wells. The unit is located approximately 2-1/2 miles northwest of Otis, New Mexico.



STATE OF NEW MEXICO  
ENERGY, MINERALS AND NATURAL RESOURCES DEPARTMENT  
OIL CONSERVATION DIVISION

**APPLICATION OF MEWBOURNE OIL COMPANY  
TO RE-OPEN CASE NO. 21496, FOR COMPULSORY  
POOLING, TO POOL ADDITIONAL PARTIES, EDDY  
COUNTY, NEW MEXICO.**

**Case No. 21960**

**SELF-AFFORMED STATEMENT OF COREY MITCHELL**

Corey Mitchell deposes and states:

1. I am a landman for Mewbourne Oil Company ("Mewbourne"), and have personal knowledge of the matters stated herein. I have been qualified by the Division as an expert petroleum landman.

2. Pursuant to NMAC 19.15.4.12.A(1), the following information is submitted in support of the compulsory pooling application filed herein:

(a) The purpose of this application is to force pool working interest and mineral owners into the Wolfcamp horizontal spacing unit described below, and in wells to be drilled in the unit.

(b) No opposition is expected because the interest owners being pooled have been contacted regarding the proposed wells but have simply refused to voluntarily commit their interests to the wells. Some interest owners are or may be unlocatable.

(c) A plat outlining the unit being pooled is attached hereto as Attachment A. Mewbourne seeks an order approving a 320.00-acre horizontal spacing unit in the Wolfcamp formation comprised of N/2 of Section 28 and the N/2 of Section 29, Township 22 South, Range 27 East, NMPM. Mewbourne further seeks the pooling of all mineral interests in the Wolfcamp formation underlying the unit. The unit will be dedicated to the City Slickers 28/29 W0AD Fee #1H & the City Slickers 28/29 W0HE Fee #1H wells. The referenced wells are horizontal wells. The City Slickers 28/29 W0AD Fee #1H has a first take point in Unit A of Section 28 and a final take point in Unit D of Section 29. The City Slickers 28/29 W0HE Fee #1H has a first take point in Unit A of Section 28 and a final take point in Unit E of Section 29.

(d) There are no depth severances in the Wolfcamp formation.

EXHIBIT 2

- (e) The parties being pooled and their interests are set forth in Attachment B. Their current and correct addresses are also set forth. To find the unlocatable parties we examined county and government records, and also conducted internet searches including google and drillinginfo.
- (f) Attachment C contains a summary of contacts with the interest owners, together with copies of the proposal letters sent to them.
- (g) Mewbourne has made a good faith effort to obtain the voluntary joinder of the working interest and mineral owners in the proposed wells.
- (h) Mewbourne has the right to pool the overriding royalty owners in the well unit.
- (i) Attachment D is the Authorization for Expenditure for each proposed well. The estimated cost of the wells set forth therein are fair and reasonable, and are comparable to the costs of other wells of similar depth and length drilled in this area of Eddy County.
- (j) Mewbourne requests overhead and administrative rates of \$8000/month for a drilling well and \$800/month for a producing well. These rates are fair, and comparable to the rates charged by other operators for wells of this type in this portion of Eddy County. They are also the rates set forth in the Joint Operating Agreement for the well unit. Mewbourne requests that these rates be adjusted periodically as provided in the COPAS Accounting Procedure.
- (k) Mewbourne requests that the maximum cost plus 200% risk charge be assessed against non-consenting working interest owners.
- (l) Applicant requests that it be designated operator of the wells.
- (m) The attachments to this affidavit were prepared by me or under my supervision, or compiled from company business records.
- (n) The granting of this application is in the interests of conservation and the prevention of waste.



3. I understand that this Self-Affirmed Statement will be used as written testimony in this case. I affirm that my testimony in paragraphs 1 through 2(n) above is true and correct and is made under penalty of perjury under the laws of the State of New Mexico. My testimony is made as of the date handwritten next to my signature below.

Date: 6.15.2021

Corey Mitchell  
Corey Mitchell

[illegible]

ATTACHMENT



District I  
1625 N. French Dr., Hobbs, NM 88240  
Phone: (575) 393-6161 Fax: (575) 393-0720  
District II  
811 S. First St., Artesia, NM 88210  
Phone: (575) 748-1283 Fax: (575) 748-9720  
District III  
1000 Rio Brazos Road, Aztec, NM 87410  
Phone: (505) 334-6178 Fax: (505) 334-6170  
District IV  
1220 S. St. Francis Dr., Santa Fe, NM 87505  
Phone: (505) 476-3460 Fax: (505) 476-3462

State of New Mexico  
Energy, Minerals & Natural Resources Department  
**OIL CONSERVATION DIVISION**  
1220 South St. Francis Dr.  
Santa Fe, NM 87505

Form C-102  
Revised August 1, 2011  
Submit one copy to appropriate  
District Office

☐ AMENDED REPORT

**WELL LOCATION AND ACREAGE DEDICATION PLAT**

1 API Number		2 Pool Code		3 Pool Name			
4 Property Code		5 Property Name <b>CITY SLICKERS 28/29 WOAD FEE</b>				6 Well Number <b>1H</b>	
7 GRID NO.		8 Operator Name <b>MEWBOURNE OIL COMPANY</b>				9 Elevation <b>3113'</b>	

**10 Surface Location**

UL or lot no.	Section	Township	Range	Lot Idn	Feet from the	North/South line	Feet from the	East/West line	County
<b>D</b>	<b>27</b>	<b>22S</b>	<b>27E</b>		<b>240</b>	<b>NORTH</b>	<b>250</b>	<b>WEST</b>	<b>EDDY</b>

**11 Bottom Hole Location If Different From Surface**

UL or lot no.	Section	Township	Range	Lot Idn	Feet from the	North/South line	Feet from the	East/West line	County
<b>D</b>	<b>29</b>	<b>22S</b>	<b>27E</b>		<b>440</b>	<b>NORTH</b>	<b>330</b>	<b>WEST</b>	<b>EDDY</b>

12 Dedicated Acres	13 Joint or Infill	14 Consolidation Code	15 Order No.

No allowable will be assigned to this completion until all interest have been consolidated or a non-standard unit has been approved by the division.

<p><b>16</b></p> <p><b>CORNER DATA</b> NAD 83 GRID - NM EAST</p> <p>A: FOUND 1/2" REBAR N 493342.8 - E 576281.6</p> <p>B: FOUND COTTON SPINDLE N 495989.3 - E 576274.8</p> <p>C: FOUND COTTON SPINDLE N 498651.1 - E 576265.1</p> <p>D: FOUND 1/2" REBAR W/YPC "ILLEGIBLE" N 498644.1 - E 581566.8</p> <p>E: FOUND 1/2" REBAR N 498654.2 - E 584191.2</p> <p>F: FOUND COTTON SPINDLE N 498664.1 - E 586815.6</p> <p>G: FOUND 3/4" REBAR N 498695.4 - E 589460.0</p> <p>H: FOUND 1/2" REBAR N 498726.7 - E 592104.6</p> <p>I: FOUND 1/2" REBAR N 496057.9 - E 592138.2</p> <p>J: FOUND 1/2" REBAR N 493389.0 - E 592171.4</p> <p>K: FOUND COTTON SPINDLE N 493378.6 - E 589533.1</p> <p>L: FOUND BRASS CAP "1969" N 493369.1 - E 586896.9</p> <p>M: FOUND BRASS CAP "1969" N 493354.1 - E 584237.3</p> <p>N: FOUND COTTON SPINDLE N 493355.7 - E 581571.1</p> <p>O: FOUND COTTON SPINDLE N 496017.3 - E 581551.7</p> <p>P: FOUND 1/2" REBAR W/YPC "ILLEGIBLE" N 496016.2 - E 586854.8</p> <p><b>GEODETIC DATA</b> NAD 83 GRID - NM EAST</p> <p><b>SURFACE LOCATION</b> N: 498427.2 - E: 587069.1 LAT: 32.3701591° N LONG: 104.1852084° W</p> <p><b>GEODETIC DATA</b> NAD 83 GRID - NM EAST</p> <p><b>BOTTOM HOLE</b> N: 498210.8 - E: 576596.6 LAT: 32.3695995° N LONG: 104.2191293° W</p>		<p><b>17 OPERATOR CERTIFICATION</b></p> <p>I hereby certify that the information contained herein is true and complete to the best of my knowledge and belief, and that this organization either owns a working interest or unleased mineral interest in the land including the proposed bottom hole location or has a right to drill this well at this location pursuant to a contract with an owner of such a mineral or working interest, or to a voluntary pooling agreement or a compulsory pooling order heretofore entered by the division.</p> <p>Signature _____ Date _____</p> <p>Printed Name _____</p> <p>E-mail Address _____</p>
<p><b>18 SURVEYOR CERTIFICATION</b></p> <p>I hereby certify that the well location shown on this plat was plotted from field notes of actual surveys made by me or under my supervision, and that the same is true and correct to the best of my belief.</p> <p><b>06-19-2020</b> Date of Survey</p> <p>Signature and Seal of Professional Surveyor</p> <p><b>19680</b> Certificate Number</p>		

Job No.: LS20060300

District I  
1625 N. French Dr., Hobbs, NM 88240  
Phone: (575) 393-6161 Fax: (575) 393-0720  
District II  
811 S. First St., Artesia, NM 88210  
Phone: (575) 748-1283 Fax: (575) 748-9720  
District III  
1000 Rio Brazos Road, Aztec, NM 87410  
Phone: (505) 334-6178 Fax: (505) 334-6170  
District IV  
1220 S. St. Francis Dr., Santa Fe, NM 87505  
Phone: (505) 476-3460 Fax: (505) 476-3462

State of New Mexico  
Energy, Minerals & Natural Resources Department  
**OIL CONSERVATION DIVISION**  
1220 South St. Francis Dr.  
Santa Fe, NM 87505

Form C-102  
Revised August 1, 2011  
Submit one copy to appropriate  
District Office

☐ AMENDED REPORT

**WELL LOCATION AND ACREAGE DEDICATION PLAT**

<sup>1</sup> API Number		<sup>2</sup> Pool Code		<sup>3</sup> Pool Name	
<sup>4</sup> Property Code		<sup>5</sup> Property Name <b>CITY SLICKERS 28/29 WOHE FEE</b>			
<sup>7</sup> OGRID NO.		<sup>8</sup> Operator Name <b>MEWBOURNE OIL COMPANY</b>			
		<sup>9</sup> Elevation <b>3113'</b>			

<sup>10</sup> Surface Location

UL or lot no.	Section	Township	Range	Lot Idn	Feet from the	North/South line	Feet From the	East/West line	County
<b>D</b>	<b>27</b>	<b>22S</b>	<b>27E</b>		<b>330</b>	<b>NORTH</b>	<b>250</b>	<b>WEST</b>	<b>EDDY</b>

<sup>11</sup> Bottom Hole Location If Different From Surface

UL or lot no.	Section	Township	Range	Lot Idn	Feet from the	North/South line	Feet from the	East/West line	County
<b>E</b>	<b>29</b>	<b>22S</b>	<b>27E</b>		<b>1900</b>	<b>NORTH</b>	<b>330</b>	<b>WEST</b>	<b>EDDY</b>

<sup>12</sup> Dedicated Acres	<sup>13</sup> Joint or Infill	<sup>14</sup> Consolidation Code	<sup>15</sup> Order No.

No allowable will be assigned to this completion until all interest have been consolidated or a non-standard unit has been approved by the division.

<p><sup>16</sup></p> <p><b>CORNER DATA</b> NAD 83 GRID - NM EAST</p> <p>A: FOUND 1/2" REBAR N 493342.8 - E 576281.6</p> <p>B: FOUND COTTON SPINDLE N 495989.3 - E 576274.8</p> <p>C: FOUND COTTON SPINDLE N 498651.1 - E 576265.1</p> <p>D: FOUND 1/2" REBAR W/YPC "ILLEGIBLE" N 498644.1 - E 581566.8</p> <p>E: FOUND 1/2" REBAR N 498654.2 - E 584191.2</p> <p>F: FOUND COTTON SPINDLE N 498664.1 - E 586815.6</p> <p>G: FOUND 3/4" REBAR N 498695.4 - E 589460.0</p> <p>H: FOUND 1/2" REBAR N 498726.7 - E 592104.6</p> <p>I: FOUND 1/2" REBAR N 496057.9 - E 592138.2</p> <p>J: FOUND 1/2" REBAR N 493389.0 - E 592171.4</p> <p>K: FOUND COTTON SPINDLE N 493378.6 - E 589533.1</p> <p>L: FOUND BRASS CAP "1969" N 493369.1 - E 586896.9</p> <p>M: FOUND BRASS CAP "1969" N 493354.1 - E 584237.3</p> <p>N: FOUND COTTON SPINDLE N 493355.7 - E 581571.1</p> <p>O: FOUND COTTON SPINDLE N 496017.3 - E 581551.7</p> <p>P: FOUND 1/2" REBAR W/YPC "ILLEGIBLE" N 496016.2 - E 586854.8</p> <p><b>GEODETIC DATA</b> NAD 83 GRID - NM EAST</p> <p><b>SURFACE LOCATION</b> N: 498337.1 - E: 587070.4 LAT: 32.3699115° N LONG: 104.1852045° W</p> <p><b>GEODETIC DATA</b> NAD 83 GRID - NM EAST</p> <p><b>BOTTOM HOLE</b> N: 496751.1 - E: 576601.9 LAT: 32.3655872° N LONG: 104.2191172° W</p>		<p><b><sup>17</sup> OPERATOR CERTIFICATION</b></p> <p>I hereby certify that the information contained herein is true and complete to the best of my knowledge and belief, and that this organization either owns a working interest or unleased mineral interest in the land including the proposed bottom hole location or has a right to drill this well at this location pursuant to a contract with an owner of such a mineral or working interest, or to a voluntary pooling agreement or a compulsory pooling order heretofore entered by the division.</p> <p>Signature _____ Date _____</p> <p>Printed Name _____</p> <p>E-mail Address _____</p>
<p><b><sup>18</sup> SURVEYOR CERTIFICATION</b></p> <p>I hereby certify that the well location shown on this plat was plotted from field notes of actual surveys made by me or under my supervision, and that the same is true and correct to the best of my belief.</p> <p><b>06-19-2020</b> Date of Survey</p> <p>Signature and Seal of Professional Surveyor _____</p> <p><b>19680</b> Certificate Number</p>		

Job No.: LS20060301



**TRACT OWNERSHIP**  
**City Slickers 28/29 W0AD Fee #1H & City Slickers 28/29 W0HE Fee #1H**  
**Sections 27 (N/2) & 26 (N/2), T22S, R27E**  
**Eddy County, New Mexico**

**Sections 28 (N/2) & 29 (N/2):**  
**Wolfcamp formation:**

	<u>% Leasehold Interest</u>
Mewbourne Oil Company, et al 500 West Texas, Ste. 1020 Midland, Texas 79701	84.985658%
* Enserch Exploration Inc. 4849 Greenville Ave. STE 1200 Dallas, Texas, 75206 <i>(Previously pooled under order #R-21537)</i>	5.245641%
* MRC Permian Company One Lincoln Centre 5400 LBJ Freeway, STE 1500 Dallas, TX 75240	3.163955%
* Charles V. Eskridge, ssp 6651 West 5 <sup>th</sup> Street Los Angeles, CA 90048	2.494213%
* Tommy & Werta Phipps as Trustees of the Phipps Living Trust u/t/a dated 10/13/2009 6280 Tack Ct. West Linn, Oregon 97068	1.558883%
* The heirs and/or devisees of Fowler S. Griffith 6280 Tack Ct. West Linn, Oregon 97068	1.247106%
* Oak Valley Mineral and Land, LP P.O. Box 50820 Midland, TX 79710	0.779441%
*Costilla Energy, Inc. 2305 Metz Place Midland, Texas 79705 <i>(Previously pooled under order #R-21537)</i>	0.325157%
* Spectrum 7, 1983-B Drilling Program 1100 Louisiana St. STE 2950 Houston, Texas 77002-5227 <i>(Previously pooled under order #R-21537)</i>	0.199946%

---

100.000000%

**\* Total interest being pooled: 15.014342%**

**Summary of Communications**

**Updated to include additional parties to be added to the previous R-21537 Order  
City Slickers 28/29 W0HE Fee 1H & City Slickers 28/29 W0AD Fee #1H**

Charles V. Eskridge, ssp

- 1) 03/29/2021: Well proposal letter with AFEs & JOA are sent via certified mail.
- 2) 04/03/2021: Certified mail packet received by Charles
- 3) 04/09/2021: Detailed search on the internet and no working phone number or email address found.
- 4) 05/26/2021: Never heard anything back from Charles V. Eskridge.

Tommy & Werta Phipps as Trustees of the Phipps Living Trust u/t/a dated 10/13/2009

- 1) 03/29/2021: Well proposal letter with AFEs & JOA are sent via certified mail.
- 2) 04/01/2021: Certified mail packet received by Werta Phipps
- 3) 04/09/2021: Detailed search on the internet and no working phone number or email address found.
- 4) 05/26/2021: Never heard anything back from Tommy & Werta Phipps.

The heirs and/or devisees of the Estate of David P. Griffith, deceased

- 1) 03/31/2021: Well proposal letter with AFEs & JOA are sent via certified mail.
- 2) 04/05/2021: Certified mail packet delivered and signed for
- 3) 04/09/2021: Detailed search on the internet and no working phone number or email address found.
- 4) 05/26/2021: Never heard anything back from any heirs and/or devisees of David P. Griffith.

Oak Valley Mineral and Land, LP

- 1) 03/22/2021: Well proposal letter with AFEs & JOA are sent via certified mail. However, no certified mail receipt was ever received back even though the documents were delivered.
- 2) 04/16/2021: Phone call and email correspondence with Phil Hammond who represents this interest.
- 3) 04/29/2021: Email correspondence with Phil Hammond indicating they will lease these minerals to a partner company (Mavros Oil Company) and informed me that the new Lessee will participate in these City Slicker wells .
- 4) 05/26/2021: Emailed back Phil Hammond for an update regarding the Oil and Gas lease and the executed AFEs and Joint Operating Agreement for the City Slickers wells. Never heard anything back.

ATTACHMENT

C

Fowler S. Griffith, ssp

- 1) 03/31/2021: Well proposal letter with AFEs & JOA are sent via certified mail.
- 2) 04/08/2021: Certified mail returned due to unlocatable/undeliverable address.
- 3) 04/09/2021: Detailed search on the internet and no working phone number or email address found.
- 4) 04/20/2021: Detailed search on the internet for a new address, phone number, or working email of this person. This person remains unlocatable.

MRC Permian Company

- 1) 03/19/2021: Well proposal letter with AFEs & JOA are sent via certified mail. However, no certified mail receipt was ever received back even though the documents were delivered. Also emailed all documents to David Johns who represents this interest.
- 2) 03/22/2021-03/23/2021: Email correspondence with David Johns regarding development and geological questions.
- 3) 04/06/2021: Email correspondence and phone conversation with David Johns indicating they will lease these minerals to a partner company (MRC Delaware Resources) and informed me that the new Lessee will participate in these City Slicker wells .
- 4.) 05/04/2021: Email correspondence with David Johns
- 5.) 05/06/2021: Email correspondence with David Johns where he informs me that the lease should be finalized, the corresponding AFEs should be executed, and he will begin negotiating the JOA with me soon.
- 6.) 05/26/2021: Emailed back David Johns for an update regarding the Oil and Gas lease and the executed AFEs and Joint Operating Agreement for the City Slickers wells. Never heard anything back.



MEWBOURNE OIL COMPANY

FASKEN CENTER  
500 WEST TEXAS, SUITE 1020  
MIDLAND, TX 79701

TELEPHONE (432) 682-3715

March 29, 2021

Via Certified Mail

Charles V. Eskridge  
6651 West 5<sup>th</sup> Street  
Los Angeles, CA 90048

- Re:
1. City Slickers 28/29 W0HE Fee #1H  
330' FNL & 250' FWL (27) (SL)  
1900' FNL & 330' FWL (29) (BHL)  
Sections 28/29, T22S, R27E  
Eddy County, New Mexico
  2. City Slickers 28/29 W0AD Fee #1H  
240' FNL & 250' FWL (27) (SL)  
440' FNL & 330' FWL (29) (BHL)  
Sections 28/29, T22S, R27E  
Eddy County, New Mexico
  3. City Slickers 28/29 Joint Operating Agreement dated April 1, 2021 & corresponding  
Ratification and Joinder of Operating Agreement document  
N/2 of Sec. 28, T22S, R27E  
N/2 of Sec. 29, T22S, R27E  
Eddy County, NM

Mr. Eskridge:

Mewbourne Oil Company ("Mewbourne") as Operator hereby proposes to form a 641.49 acre Working Interest Unit ("WIU") covering the N/2 of the above captioned sections 28 and 29 for oil and gas production. The targeted interval for the proposed unit is the Wolfcamp Formation. Mewbourne as Operator hereby proposes to drill the following horizontal Wolfcamp wells:

1. City Slickers 28/29 W0HE Fee #1H will have a surface location 330' FNL & 250' FWL in the above captioned Section 27 and a bottom hole location approximately 1900' FNL & 330' FWL of the above captioned Section 29. We anticipate drilling to an approximate total vertical depth of 8,960' and an approximate total measured depth of 19,300'. The N2 of Section 28 and the N2 of Section 29 will be dedicated to the well as the proration unit.
2. City Slickers 28/29 W0AD Fee #1H will have a surface location 240' FNL & 250' FWL in the above captioned Section 27 and a bottom hole location approximately 440' FNL & 330' FWL of the above captioned Section 29. We anticipate drilling to an approximate total



vertical depth of 8,956' and an approximate total measured depth of 19,300'. The N2 of Section 28 and the N2 of Section 29 will be dedicated to the well as the proration unit.

Regarding the above, enclosed for your further handling are our AFE's dated July 2, 2020 for the captioned proposed wells. In the event you elect to participate in the proposed wells, please execute the enclosed AFE's and return them to me within thirty (30) days.

Additionally, enclosed for your further handling is the Operating Agreement dated April 1, 2021, by and between Mewbourne Oil Company as Operator and Alpha Energy Partners, LLC, et al, as Non-Operator and a Ratification and Joinder of Operating Agreement document. Our proposed Operating Agreement will have COPAS rates of \$8,000/month while drilling, \$800/month for a producing well and a non-consent penalty of 100%/300%. Upon your review and approval of the Joint Operating Agreement, please execute the corresponding Ratification and Joinder of Operating Agreement document and return the original to me at the letterhead address provided.

Another option available to you instead of participating in these wells with your unleased mineral interest is to lease these minerals to us as the operator. We are drilling these City Slickers wells soon and would prefer to lease your minerals as opposed to moving forward with other options. Our records currently show you with 16 unleased mineral acres in the S2NW4 of Sec. 29, T22S, R27E. We are able to offer you a \$1,500 paid up lease bonus per net acre (\$24,000.00 total) in addition to a 3 year primary term and a 1/4<sup>th</sup> lease royalty (subject to your acceptance and Mewbourne's approval of title, lease form, and management approval). I have also attached Mewbourne's oil and gas lease for your review and approval should you choose to lease your minerals with us. If you choose to lease with us, please execute the lease in front of a notary public and mail the original lease and corresponding completed and signed W-9 form. Upon receipt of these documents, I will promptly issue you a check in the amount of \$24,000.00. Your prompt attention to this matter is greatly appreciated.

Should you have any questions regarding the above, please email me at [bdunn@mewbourne.com](mailto:bdunn@mewbourne.com) or call me at (432) 682-3715. Thank you.

Sincerely,

**MEWBOURNE OIL COMPANY**

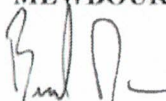

Brad Dunn  
Petroleum Landman



April 3, 2021

Dear Simple Certified:

The following is in response to your request for proof of delivery on your item with the tracking number:  
**9402 8368 9784 6780 8579 97.**

**Item Details**

<b>Status:</b>	Delivered, Left with Individual
<b>Status Date / Time:</b>	April 3, 2021, 1:41 pm
<b>Location:</b>	LOS ANGELES, CA 90048
<b>Postal Product:</b>	Priority Mail®
<b>Extra Services:</b>	Certified Mail™ Return Receipt Electronic Up to \$100 insurance included
<b>Recipient Name:</b>	Charles V Eskridge

**Shipment Details**

<b>Weight:</b>	1.0oz
----------------	-------

**Recipient Signature**

Signature of Recipient:

C-19  
eve

Address of Recipient:

6651  
w. 5<sup>th</sup> St

Note: Scanned image may reflect a different destination address due to Intended Recipient's delivery instructions on file.

Thank you for selecting the United States Postal Service® for your mailing needs. If you require additional assistance, please contact your local Post Office™ or a Postal representative at 1-800-222-1811.

Sincerely,  
United States Postal Service®  
475 L'Enfant Plaza SW  
Washington, D.C. 20260-0004

Charles V. Eskridge  
6651 West 5th Street  
Los Angeles, CA 90048  
Reference #: City Slickers 28/29



## MEWBOURNE OIL COMPANY

## AUTHORIZATION FOR EXPENDITURE

Well Name: CITY SLICKERS 28/29 W0AD FEE #1H		Prospect: Wolfcamp Sand	
Location: SL: 240 FNL & 250 FWL (27); BHL: 440 FNL & 330 FWL (29)		County: Eddy ST: NM	
Sec: 28	Blk:	Survey:	TWP: 22S RNG: 27E Prop. TVD: 8956 TMD: 19300

INTANGIBLE COSTS 0180		CODE	TCP	CODE	CC
Regulatory Permits & Surveys		0180-0100	\$20,000	0180-0200	
Location / Road / Site / Preparation		0180-0105	\$35,000	0180-0205	\$35,000
Location / Restoration (1/2) Battery Containment		0180-0106	\$200,000	0180-0206	\$50,000
Daywork / Turnkey / Footage Drilling 25 days drlg / 4 days comp @ \$18250/d		0180-0110	\$487,300	0180-0210	\$78,000
Fuel 1700 gal/day @ \$1.3/gal		0180-0114	\$59,000	0180-0214	\$320,000
Mud, Chemical & Additives		0180-0120	\$180,000	0180-0220	
Horizontal Drillout Services				0180-0222	\$220,000
Cementing		0180-0125	\$80,000	0180-0225	\$50,000
Logging & Wireline Services		0180-0130	\$2,300	0180-0230	\$450,000
Casing / Tubing / Snubbing Service		0180-0134	\$18,000	0180-0234	\$42,000
Mud Logging		0180-0137	\$35,000		
Stimulation 82 Stg 24.7 MM gal/ 24.7 MM lb				0180-0241	\$1,690,000
Stimulation Rentals & Other				0180-0242	\$185,000
Water & Other		0180-0145	\$35,000	0180-0245	\$355,000
Bits		0180-0148	\$96,100	0180-0248	\$5,000
Inspection & Repair Services		0180-0150	\$50,000	0180-0250	\$5,000
Misc. Air & Pumping Services		0180-0154		0180-0254	\$10,000
Testing & Flowback Services		0180-0158	\$12,000	0180-0258	\$24,000
Completion / Workover Rig				0180-0260	\$10,500
Rig Mobilization		0180-0164	\$80,000		
Transportation		0180-0165	\$30,000	0180-0265	\$30,000
Welding Services		0180-0168	\$4,000	0180-0268	\$15,000
Contract Services & Supervision		0180-0170		0180-0270	\$32,000
Directional Services Includes Vertical Control		0180-0175	\$356,500		
Equipment Rental		0180-0180	\$179,400	0180-0280	\$24,000
Well / Lease Legal		0180-0184	\$5,000	0180-0284	
Well / Lease Insurance		0180-0185	\$5,000	0180-0285	
Intangible Supplies		0180-0188	\$8,000	0180-0288	\$1,000
Damages		0180-0190	\$75,000	0180-0290	
ROW & Easements		0180-0192		0180-0292	\$4,000
Pipeline Interconnect				0180-0293	
Company Supervision		0180-0195	\$249,600	0180-0295	\$115,200
Overhead Fixed Rate		0180-0196	\$10,000	0180-0296	\$20,000
Well Abandonment		0180-0198		0180-0298	
Contingencies 2% (TCP) 2% (CC)		0180-0199	\$46,200	0180-0299	\$75,400
TOTAL			\$2,358,400		\$3,846,100

TANGIBLE COSTS 0181		CODE	TCP	CODE	CC
Casing (19.1" - 30")		0181-0793			
Casing (10.1" - 19.0") 450' - 13 3/8" 54.5# J-55 ST&C @ \$32.16/ft		0181-0794	\$15,500		
Casing (8.1" - 10.0") 2025' - 9 5/8" 40# N-80 LT&C @ \$24.42/ft		0181-0795	\$52,800		
Casing (6.1" - 8.0") 9300' - 7" 29# HCP-110 LT&C @ \$21.47/ft		0181-0796	\$213,200		
Casing (4.1" - 6.0") 10850' - 4 1/2" 13.5# P-110 BPN @ \$11.72/ft				0181-0797	\$135,800
Tubing 8550' - 2 7/8" 6.5# L-80 Tbg @ \$4.54/ft				0181-0798	\$41,500
Drilling Head		0181-0860	\$35,000		
Tubing Head & Upper Section				0181-0870	\$30,000
Horizontal Completion Tools Completion Liner Hanger				0181-0871	\$45,000
Sucker Rods				0181-0875	
Subsurface Equipment Packer				0181-0880	\$10,000
Artificial Lift Systems Gas Lift Valves				0181-0884	\$15,000
Pumping Unit				0181-0885	
Surface Pumps & Prime Movers (1/2) SWD pump/circ pump/VRU				0181-0886	\$55,000
Tanks - Oil (1/2) 6 - 750 bbl				0181-0890	\$60,000
Tanks - Water (1/2) 5 - 750 bbl coated				0181-0891	\$50,000
Separation / Treating Equipment 30"x10"x1k# 3ph vert, 4 - 36"x15"x1k# 3 - VRT, GB				0181-0895	\$154,000
Heater Treaters, Line Heaters 8"x20"x75# HT				0181-0897	\$27,000
Metering Equipment				0181-0898	\$15,000
Line Pipe & Valves - Gathering (1/2) 1 mi. 4" Steel Gas/ 1 mi. 6" poly SWD				0181-0900	\$31,000
Fittings / Valves & Accessories				0181-0906	\$150,000
Cathodic Protection Inc. Automation				0181-0908	\$57,500
Electrical Installation				0181-0909	\$50,000
Equipment Installation				0181-0910	\$75,000
Pipeline Construction (1/2) 1 mi. 4" Steel Gas/ 1 mi. 6" poly SWD				0181-0920	\$65,000
TOTAL			\$316,500		\$1,066,800
SUBTOTAL			\$2,674,900		\$4,912,900
TOTAL WELL COST					\$7,587,800

Extra Expense Insurance

☐ I elect to be covered by Operator's Extra Expense Insurance and pay my proportionate share of the premium. Operator has secured Extra Expense Insurance covering costs of well control, clean up and redrilling as estimated in Line Item 0180-0185.

☐ I elect to purchase my own well control insurance policy.

If neither box is checked above, non-operating working interest owner elects to be covered by Operator's well control insurance.

Prepared by: T. Cude	Date: 7/2/2020
Company Approval: <i>m. whitte</i>	Date: 7/6/2020
Joint Owner Interest: _____ Amount: _____	
Joint Owner Name: _____	Signature: _____

ATTACHMENT D

Revised: 01/31/2018



## MEWBOURNE OIL COMPANY

## AUTHORIZATION FOR EXPENDITURE

Well Name: CITY SLICKERS 28/29 W0HE FEE #1H		Prospect: Wolfcamp Sand	
Location: SL: 330 FNL & 250 FWL (27); BHL: 1900 FNL & 330 FWL (29)		County: Eddy	ST: NM
Sec. 28	Blk:	Survey:	TWP: 22S RNG: 27E Prop. TVD: 8960 TMD: 19300

INTANGIBLE COSTS 0180		CODE	TCP	CODE	CC
Regulatory Permits & Surveys		0180-0100	\$20,000	0180-0200	
Location / Road / Site / Preparation		0180-0105	\$35,000	0180-0205	\$35,000
Location / Restoration (1/2) Battery Containment		0180-0106	\$200,000	0180-0206	\$50,000
Daywork / Turnkey / Footage Drilling 25 days drlg / 4 days comp @ \$18250/d		0180-0110	\$487,300	0180-0210	\$78,000
Fuel 1700 gal/day @ \$1.3/gal		0180-0114	\$59,000	0180-0214	\$320,000
Mud, Chemical & Additives		0180-0120	\$180,000	0180-0220	
Horizontal Drillout Services				0180-0222	\$220,000
Cementing		0180-0125	\$80,000	0180-0225	\$50,000
Logging & Wireline Services		0180-0130	\$2,300	0180-0230	\$450,000
Casing / Tubing / Snubbing Service		0180-0134	\$18,000	0180-0234	\$42,000
Mud Logging		0180-0137	\$35,000		
Stimulation 82 Stg 24.7 MM gal/ 24.7 MM lb				0180-0241	\$1,690,000
Stimulation Rentals & Other				0180-0242	\$185,000
Water & Other		0180-0145	\$35,000	0180-0245	\$355,000
Bits		0180-0148	\$96,100	0180-0248	\$5,000
Inspection & Repair Services		0180-0150	\$50,000	0180-0250	\$5,000
Misc. Air & Pumping Services		0180-0154		0180-0254	\$10,000
Testing & Flowback Services		0180-0158	\$12,000	0180-0258	\$24,000
Completion / Workover Rig				0180-0260	\$10,500
Rig Mobilization		0180-0164	\$80,000		
Transportation		0180-0165	\$30,000	0180-0265	\$30,000
Welding Services		0180-0168	\$4,000	0180-0268	\$15,000
Contract Services & Supervision		0180-0170		0180-0270	\$32,000
Directional Services Includes Vertical Control		0180-0175	\$356,500		
Equipment Rental		0180-0180	\$179,400	0180-0280	\$24,000
Well / Lease Legal		0180-0184	\$5,000	0180-0284	
Well / Lease Insurance		0180-0185	\$5,000	0180-0285	
Intangible Supplies		0180-0188	\$8,000	0180-0288	\$1,000
Damages		0180-0190	\$75,000	0180-0290	
ROW & Easements		0180-0192		0180-0292	\$4,000
Pipeline Interconnect				0180-0293	
Company Supervision		0180-0195	\$249,600	0180-0295	\$115,200
Overhead Fixed Rate		0180-0196	\$10,000	0180-0296	\$20,000
Well Abandonment		0180-0198		0180-0298	
Contingencies 2% (TCP) 2% (CC)		0180-0199	\$46,200	0180-0299	\$75,400
TOTAL			\$2,358,400		\$3,846,100

TANGIBLE COSTS 0181		CODE	TCP	CODE	CC
Casing (19.1" - 30")		0181-0793			
Casing (10.1" - 19.0") 450' - 13 3/8" 54.5# J-55 ST&C @ \$32.16/ft		0181-0794	\$15,500		
Casing (8.1" - 10.0") 2025' - 9 5/8" 40# N-80 LT&C @ \$24.42/ft		0181-0795	\$52,800		
Casing (6.1" - 8.0") 9300' - 7" 29# HCP-110 LT&C @ \$21.47/ft		0181-0796	\$213,200		
Casing (4.1" - 6.0") 10850' - 4 1/2" 13.5# P-110 BPN @ \$11.72/ft				0181-0797	\$135,800
Tubing 8550' - 2 7/8" 6.5# L-80 Tbg @ \$4.54/ft				0181-0798	\$41,500
Drilling Head		0181-0860	\$35,000		
Tubing Head & Upper Section				0181-0870	\$30,000
Horizontal Completion Tools Completion Liner Hanger				0181-0871	\$45,000
Sucker Rods				0181-0875	
Subsurface Equipment Packer				0181-0880	\$10,000
Artificial Lift Systems Gas Lift Valves				0181-0884	\$15,000
Pumping Unit				0181-0885	
Surface Pumps & Prime Movers (1/2) SWD pump/circ pump/VRU				0181-0886	\$55,000
Tanks - Oil (1/2) 6 - 750 bbl				0181-0890	\$60,000
Tanks - Water (1/2) 5 - 750 bbl coated				0181-0891	\$50,000
Separation / Treating Equipment 30"x10"x1k# 3ph vert, 4 - 36"x15"x1k#, 3 - VRT, GB				0181-0895	\$154,000
Heater Treaters, Line Heaters 8"x20"x75# HT				0181-0897	\$27,000
Metering Equipment				0181-0898	\$15,000
Line Pipe & Valves - Gathering (1/2) 1 mi. 4" Steel Gas/ 1 mi. 6" poly SWD				0181-0900	\$31,000
Fittings / Valves & Accessories				0181-0906	\$150,000
Cathodic Protection Inc. Automation				0181-0908	\$57,500
Electrical Installation				0181-0909	\$50,000
Equipment Installation				0181-0910	\$75,000
Pipeline Construction (1/2) 1 mi. 4" Steel Gas/ 1 mi. 6" poly SWD				0181-0920	\$65,000
TOTAL			\$316,500		\$1,066,800
SUBTOTAL			\$2,674,900		\$4,912,900

TOTAL WELL COST		\$7,587,800
-----------------	--	-------------

Extra Expense Insurance

☐ I elect to be covered by Operator's Extra Expense Insurance and pay my proportionate share of the premium. Operator has secured Extra Expense Insurance covering costs of well control, clean up and redrilling as estimated in Line Item 0180-0185.

☐ I elect to purchase my own well control insurance policy.

If neither box is checked above, non-operating working interest owner elects to be covered by Operator's well control insurance.

Prepared by: T. Cude	Date: 7/2/2020
Company Approval: <i>m. whitaker</i>	Date: 7/6/2020
Joint Owner Interest: _____ Amount: _____	Signature: _____
Joint Owner Name: _____	

Revised: 01/31/2018

STATE OF NEW MEXICO  
ENERGY, MINERALS AND NATURAL RESOURCES DEPARTMENT  
OIL CONSERVATION DIVISION

APPLICATION OF MEWBOURNE OIL COMPANY  
FOR A COMPULSORY POOLING,  
EDDY COUNTY, NEW MEXICO.

Case No. 21496

VERIFIED STATEMENT OF TYLER HILL

COUNTY OF MIDLAND                    )  
                                                  ) ss.  
STATE OF TEXAS                        )

Tyler Hill, being duly sworn upon his oath, deposes and states:

1. I am over the age of 18, and have personal knowledge of the matters stated herein.
2. I am a geologist for Mewbourne Oil Company ("Mewbourne"), and I am familiar with the geological matters involved in this case. I have been qualified by the Division as an expert petroleum geologist.
3. The following geological plats are attached hereto:
  - (a) Attachment A is a structure map of the Wolfcamp formation, mapped on the top of the correlative Wolfcamp marker. It shows that structure dips to the east, and that the planned wellbores would drill perpendicular to strike. It also shows a line of cross-section, A-A'.
  - (b) Attachment B is a west-east cross section. The well logs on the cross-section give a representative sample of the Wolfcamp formation in this area. The target zone for the wells is the Upper Wolfcamp Sand, and that zone is continuous across the well unit.
4. I conclude from the maps that:
  - (a) The horizontal spacing unit is justified from a geologic standpoint.
  - (b) Each quarter section in the unit will contribute more or less equally to production.
  - (c) There is no faulting or other geologic impediment in the area which will affect the drilling of the subject wells.

EXHIBIT

3



5. Attachment C contains information from other wells drilled in the immediate area. There are numerous upper Wolfcamp sand wells, and the preferred orientation is for laydown units. The completed wells in the area are commercial.

6. Attachment D is the Survey Calculation Report for wells: City Slickers 28/29 W0AD Fee 1H, and City Slickers 28/29 W0HE Fee 1H. The producing interval of the proposed well will be orthodox. The Pool code is Purple Sage Wolfcamp (98220).

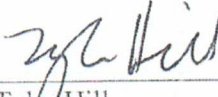
  
\_\_\_\_\_  
Tyler Hill

VERIFICATION

STATE OF TEXAS                    )  
                                              ) ss.  
COUNTY OF MIDLAND            )

Tyler Hill, being duly sworn upon his oath, deposes and states that: He is a geologist for Mewbourne Oil Company; he is authorized to make this verification on its behalf; he has read the foregoing statement, and knows the contents thereof; and the same is true and correct to the best of his knowledge, information, and belief.

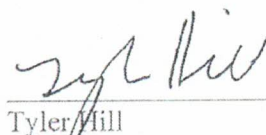
  
\_\_\_\_\_  
Tyler Hill

SUBSCRIBED AND SWORN TO before me this 20<sup>th</sup> day of October, 2020 by Tyler Hill.

My Commission Expires: 12/09/2023

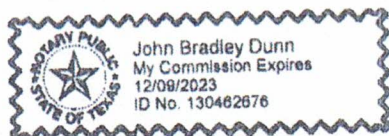

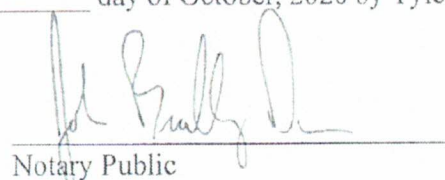
  
\_\_\_\_\_  
Notary Public

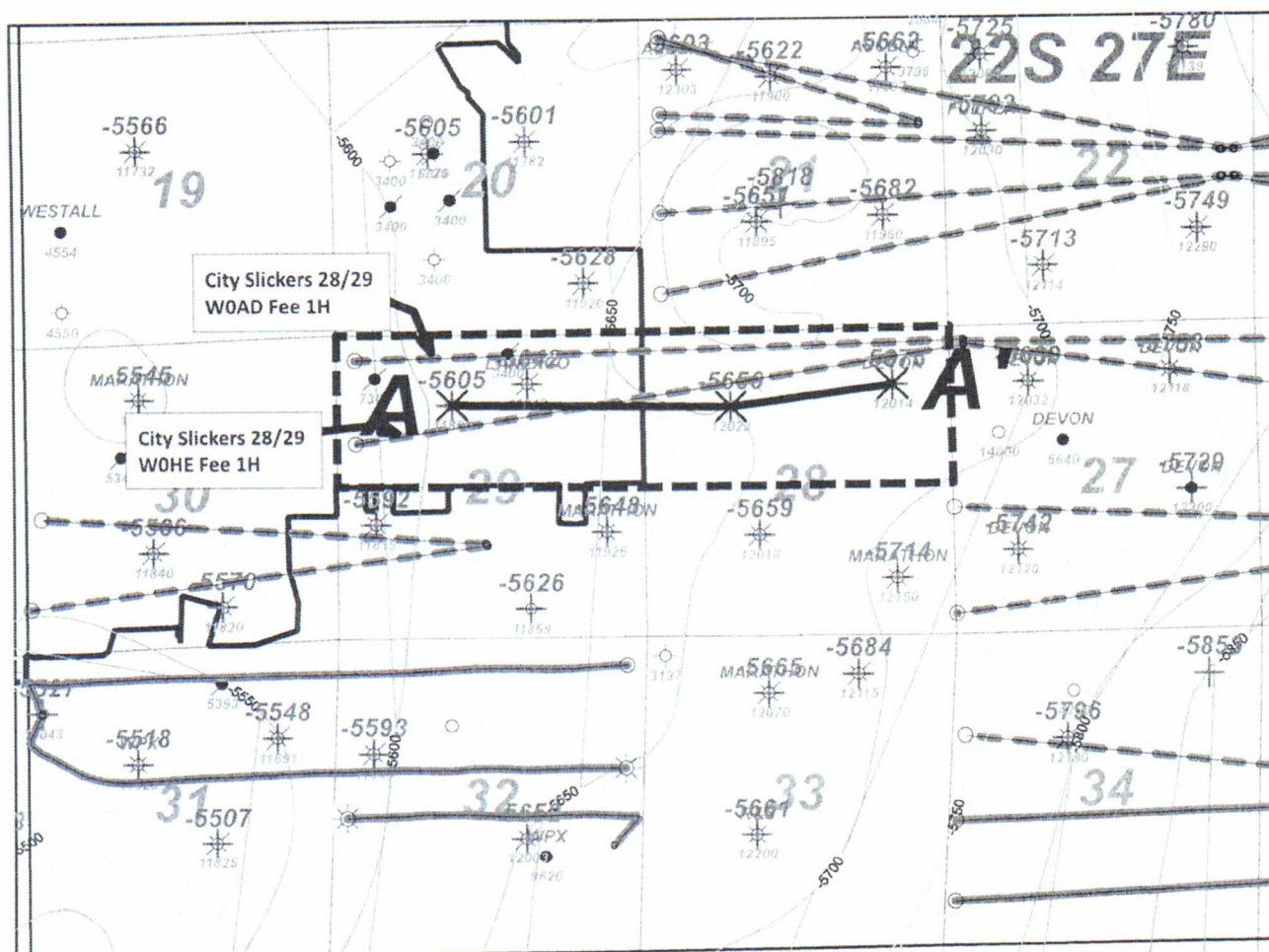

### Activity Color Code

- Wolfcamp Sand (Permitted)
- Wolfcamp Sand (Drilled)



 <b>Mewbourne Oil Company</b>		
<i>City Slickers 28/29 WOAD Fee 1H</i> <i>City Slickers 28/29 WOHE Fee 1H</i> <i>Structure top WFMP (C.I. 50')</i>		
Author: T. Hill	County:	Date: 19 October, 2020
Scale: 1.0"=3000'		

1 inch = 3000 feet



ATTACHMENT

A



## City Slickers 28/29 W0AD, HE

A

A'

3001224900  
BARBER WELL, BERRY CO.  
LSE 12041  
12001 AL/1840 FWI  
Datum: 1743.00  
Reference: KB  
TWP: 22 S - Range 27 E - Sec. 29

30015314700  
OXYGEN ENERGY PRODUCTION CO. LP  
TOWNSHIP 28 N  
RANGE 27 E  
Sec. 28  
Datum: 1743.00  
Reference: KB  
TWP: 22 S - Range 27 E - Sec. 28

300152460300  
MEADOWBROOK OIL CO.  
NEELY 1  
1800 AL/2042 FWI  
Datum: 1743.00  
Reference: KB  
TWP: 22 S - Range 27 E - Sec. 28

29B

28D

28A

WFMP

WFMP Sd X

WFMP Sd Y

WFMP Sd Z

WFMP Sh A

WFMP Sh B

-500

WFMP Sh C

WFMP Sh D

WFMP

WFMP Sd X

WFMP Sd Y

WFMP Sd Z

WFMP Sh A

WFMP Sh B

-500

WFMP Sh C

WFMP Sh D

City Slickers W0 Target

ATTACHMENT

City Slickers 28/29 W0AD Fee 1H  
City Slickers 28/29 W0HE Fee 1H



City Slickers Area Wolfcamp Production Table										
API	Well Name	Well Number	Operator	Location	Field	Cum Oil (Mbo)	Cum Gas (Bcf)	Cum Water (Mbw)	First Prod Date	WFMP Zone
300154437400	CYPRESS FEE 23 27 9	2H	MARATHON	9L-9P/23S/27E	PURPLE SAGE	70	0.82	412	5/1/2018	WFMP C Shale
300154404600	CYPRESS	1H	MARATHON	9M-9P/23S/27E	PURPLE SAGE	220	0.51	866	5/1/2017	WFMP Y Sand
300154408200	MICHAEL COLLINS 11 23S 27E RB	208H	MATADOR	11P-11M/23S/27E	PURPLE SAGE	211	0.70	880	9/1/2017	WFMP Y Sand
300154437600	CYPRESS FEE 23 27 9	4H	MARATHON	9L-9P/23S/27E	PURPLE SAGE	84	0.30	466	5/1/2018	WFMP Y Sand
300154437700	CYPRESS FEE 23 27 9	5H	MARATHON	9L-9I/23S/27E	PURPLE SAGE	122	0.50	596	3/1/2018	WFMP Y Sand
300154437800	CYPRESS FEE 23 27 9	6H	MARATHON	9L-9I/23S/27E	PURPLE SAGE	36	1.63	594	6/1/2018	WFMP Y Sand
300154438000	CYPRESS FEE 23 27 9	8H	MARATHON	9L-9I/23S/27E	PURPLE SAGE	78	0.38	466	3/1/2018	WFMP Y Sand
300154444300	MICHAEL COLLINS 11 23S 27E RB	203H	MATADOR	11I-11L/23S/27E	PURPLE SAGE	179	0.75	819	2/1/2018	WFMP Y Sand
300154447200	MICHAEL COLLINS 11 23S 27E RB	206H	MATADOR	11I-11E/23S/27E	PURPLE SAGE	178	0.52	796	2/1/2018	WFMP Y Sand
300154454400	WOLFMAN 5 4 WOLF FEDERAL COM	1H	MEWBOURNE	5L-4I/23S/27E	PURPLE SAGE	473	0.95	1072	4/1/2018	WFMP Y Sand
300154590400	SUNDOWN 31/32 WODA FEE	1H	MEWBOURNE	31D-32A/22S/27E	PURPLE SAGE	229	0.57	916	10/22/2019	WFMP Y Sand
300154590500	SUNDOWN 31 32 WOEH FEE	2H	MEWBOURNE	31E-32H/22S/27E	PURPLE SAGE	210	0.58	906	10/22/2019	WFMP Y Sand

ATTACHMENT

C

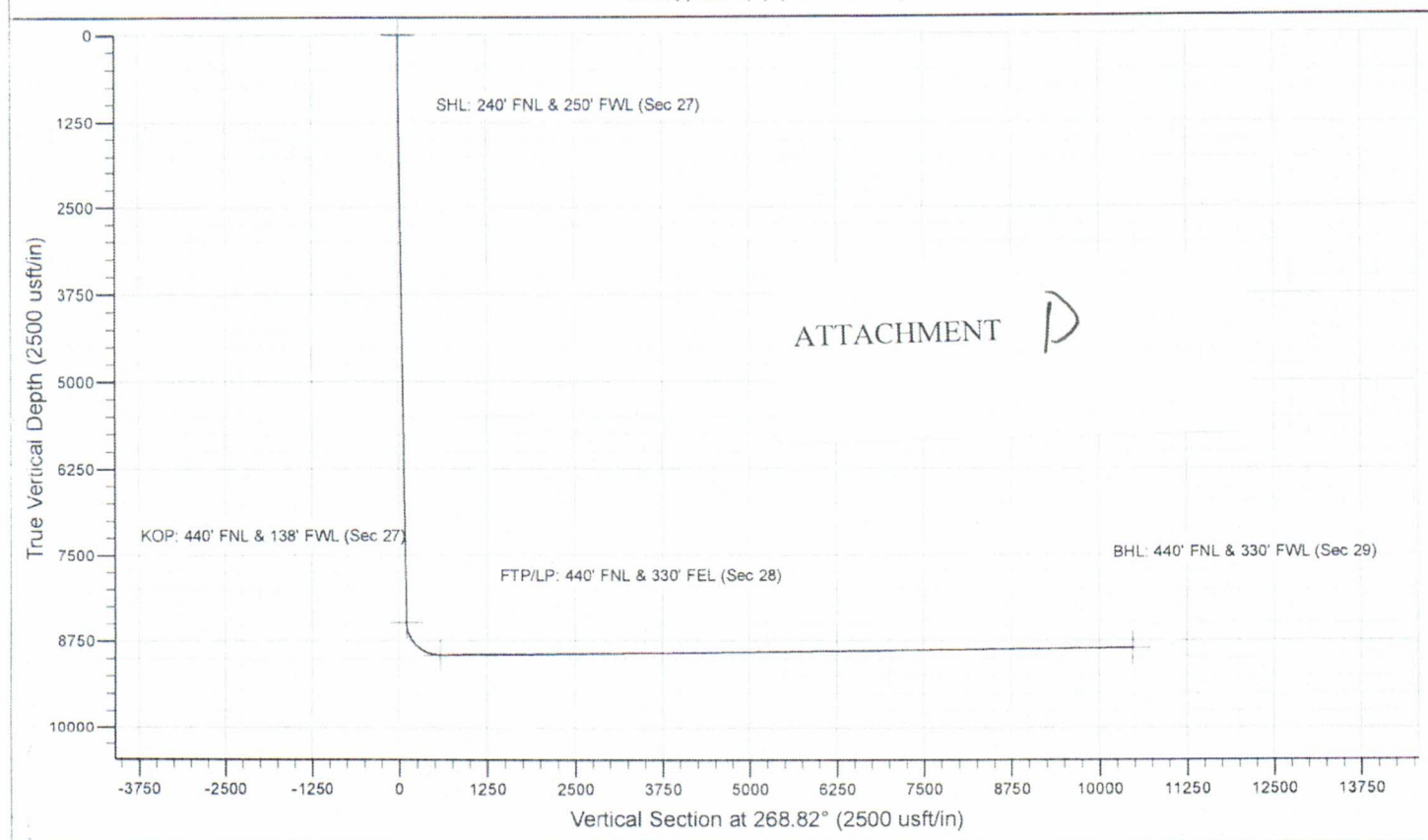
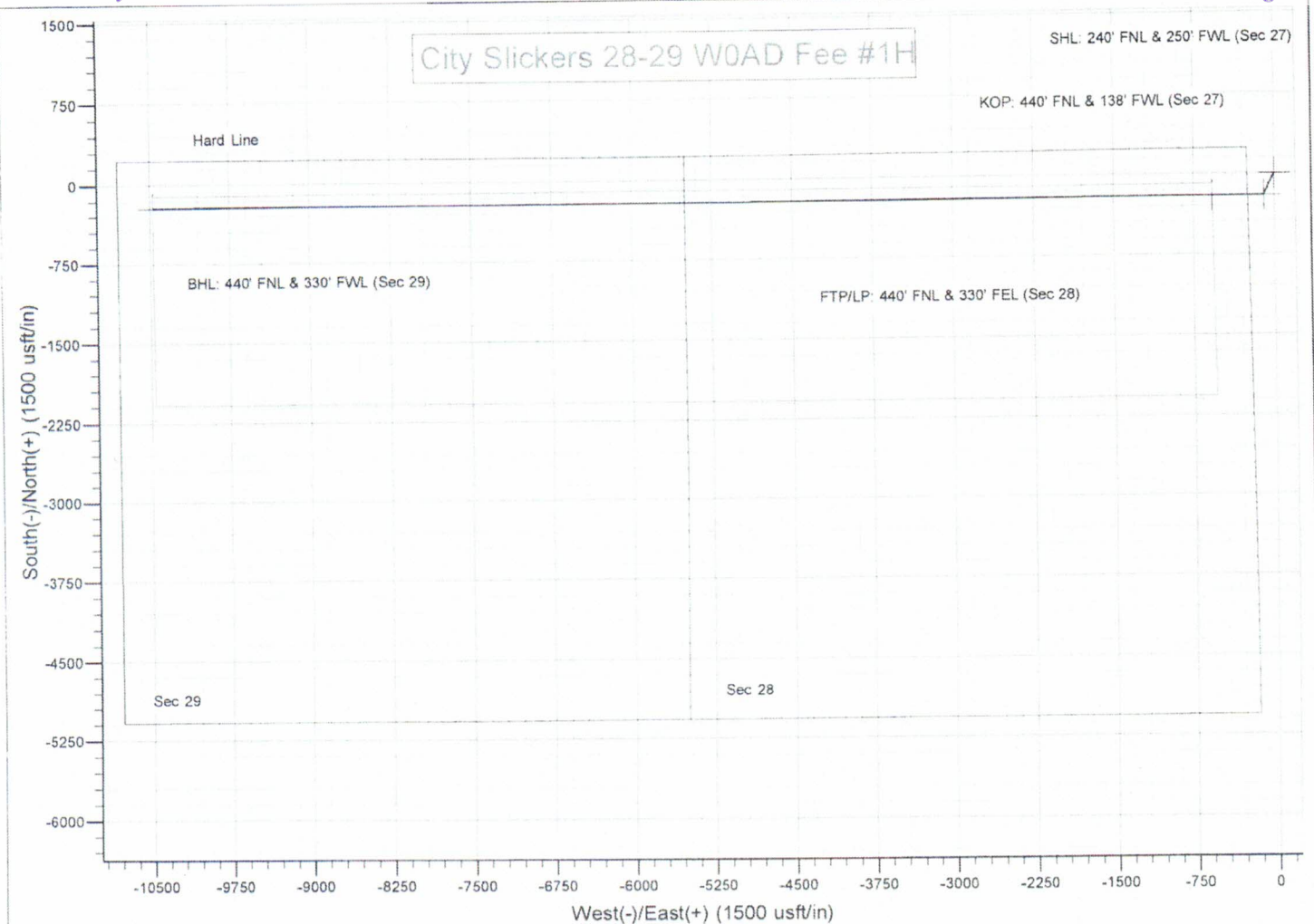

Mewbourne Oil Company																
City Slickers 28/29 W0HE Fee 1H																
SURVEY CALCULATION REPORT																
Minimum Curvature Calculations																
Operator: Mewbourne Oil Company										Target KBTV: 8.931 Feet		8931.00				
Lease Name: City Slickers 28/29 W0HE Fee 1H										Target Angle: 90.42 Degrees		90.42				
KOP 8453.54										Section Plane: 261.32 Degrees						
										Declination Corrected to True North: 6.63 Degrees						
										Bit to Survey Offset: 44 Feet						
Survey No	Measured Depth-ft	Drift (Deg)	Azimuth (Deg)	Course Length	TVD (Feet)	Vertical Section	+N/-S (Feet)	+E/-W (Feet)	Closure Distance	Closure Direction	BUR	DLS	KBTV	+Above -Below Target	DRIFT RADIANS	AZIMUTH (RADIANS)
T/I	8453.54	0.00	261.32	N/A	8453.5	0.0	0.0	0.0	0.0	0.0	N/A	N/A	8453.5	477.5	1E-12	4.56 #VALUE!
1	8528.89	9.04	261.32	75.354	8528.6	5.9	-0.9	-5.9	5.9	261.3	12.0	12.0	8528.6	402.4	0.15782	4.56 0.15782
2	8604.24	18.08	261.32	75.354	8601.8	23.6	-3.6	-23.3	23.6	261.3	12.0	12.0	8601.9	329.1	0.31564	4.56 0.15782
3	8679.60	27.13	261.32	75.354	8671.2	52.5	-7.9	-51.9	52.5	261.3	12.0	12.0	8671.6	259.4	0.47346	4.56 0.15782
4	8754.95	36.17	261.32	75.354	8735.3	92.0	-13.9	-91.0	92.0	261.3	12.0	12.0	8736.0	195.0	0.63128	4.56 0.15782
5	8830.30	45.21	261.32	75.354	8792.4	141.1	-21.3	-139.5	141.1	261.3	12.0	12.0	8793.4	137.6	0.7891	4.56 0.15782
6	8905.66	54.25	261.32	75.354	8841.1	198.5	-30.0	-196.3	198.5	261.3	12.0	12.0	8842.5	88.5	0.94692	4.56 0.15782
7	8981.01	63.30	261.32	75.354	8880.1	262.9	-39.7	-259.9	262.9	261.3	12.0	12.0	8882.0	49.0	1.10474	4.56 0.15782
8	9056.36	72.34	261.32	75.354	8908.5	332.6	-50.2	-328.8	332.6	261.3	12.0	12.0	8911.0	20.0	1.26256	4.56 0.15782
9	9131.72	81.38	261.32	75.354	8925.6	405.9	-61.3	-401.3	405.9	261.3	12.0	12.0	8928.6	2.4	1.42038	4.56 0.15782
10	9207.07	90.42	261.32	75.354	8931.0	481.0	-72.6	-475.5	481.0	261.3	12.0	12.0	8934.6	-3.6	1.5782	4.56 0.15782
11	9300.00	90.42	261.32	92.928	8930.3	573.9	-86.7	-567.3	573.9	261.3	0.0	0.0	8934.6	-3.6	1.5782	4.56 1E-10
12	9400.00	90.42	261.32	100	8929.6	673.9	-101.8	-666.2	673.9	261.3	0.0	0.0	8934.6	-3.6	1.5782	4.56 1E-10
13	9500.00	90.42	261.32	100	8928.8	773.9	-116.9	-765.0	773.9	261.3	0.0	0.0	8934.6	-3.6	1.5782	4.56 1E-10
14	9600.00	90.42	261.32	100	8928.1	873.9	-132.0	-863.9	873.9	261.3	0.0	0.0	8934.6	-3.6	1.5782	4.56 1E-10
15	9700.00	90.42	261.32	100	8927.3	973.9	-147.1	-962.8	973.9	261.3	0.0	0.0	8934.6	-3.6	1.5782	4.56 1E-10
16	9800.00	90.42	261.32	100	8926.6	1073.9	-162.1	-1061.6	1073.9	261.3	0.0	0.0	8934.6	-3.6	1.5782	4.56 1E-10
17	9900.00	90.42	261.32	100	8925.9	1173.9	-177.2	-1160.5	1173.9	261.3	0.0	0.0	8934.6	-3.6	1.5782	4.56 1E-10
18	10000.00	90.42	261.32	100	8925.1	1273.9	-192.3	-1259.3	1273.9	261.3	0.0	0.0	8934.6	-3.6	1.5782	4.56 1E-10
19	10100.00	90.42	261.32	100	8924.4	1373.9	-207.4	-1358.2	1373.9	261.3	0.0	0.0	8934.6	-3.6	1.5782	4.56 1E-10
20	10200.00	90.42	261.32	100	8923.6	1473.9	-222.5	-1457.0	1473.9	261.3	0.0	0.0	8934.6	-3.6	1.5782	4.56 1E-10
21	10300.00	90.42	261.32	100	8922.9	1573.9	-237.6	-1555.9	1573.9	261.3	0.0	0.0	8934.6	-3.6	1.5782	4.56 1E-10
22	10400.00	90.42	261.32	100	8922.2	1673.9	-252.7	-1654.7	1673.9	261.3	0.0	0.0	8934.6	-3.6	1.5782	4.56 1E-10



23	10500.00	90.42	261.32	100	8921.4	1773.9	-267.8	-1753.6	1773.9	261.3	0.0	0.0	8934.6	-3.6	1.5782	4.56	1E-10
24	10600.00	90.42	261.32	100	8920.7	1873.9	-282.9	-1852.4	1873.9	261.3	0.0	0.0	8934.6	-3.6	1.5782	4.56	1E-10
25	10700.00	90.42	261.32	100	8919.9	1973.9	-298.0	-1951.3	1973.9	261.3	0.0	0.0	8934.6	-3.6	1.5782	4.56	1E-10
26	10800.00	90.42	261.32	100	8919.2	2073.9	-313.1	-2050.1	2073.9	261.3	0.0	0.0	8934.6	-3.6	1.5782	4.56	1E-10
27	10900.00	90.42	261.32	100	8918.4	2173.9	-328.2	-2149.0	2173.9	261.3	0.0	0.0	8934.6	-3.6	1.5782	4.56	1E-10
28	11000.00	90.42	261.32	100	8917.7	2273.9	-343.3	-2247.8	2273.9	261.3	0.0	0.0	8934.6	-3.6	1.5782	4.56	1E-10
29	11100.00	90.42	261.32	100	8917.0	2373.9	-358.4	-2346.7	2373.9	261.3	0.0	0.0	8934.6	-3.6	1.5782	4.56	1E-10
30	11200.00	90.42	261.32	100	8916.2	2473.9	-373.5	-2445.5	2473.9	261.3	0.0	0.0	8934.6	-3.6	1.5782	4.56	1E-10
31	11300.00	90.42	261.32	100	8915.5	2573.9	-388.6	-2544.4	2573.9	261.3	0.0	0.0	8934.6	-3.6	1.5782	4.56	1E-10
32	11400.00	90.42	261.32	100	8914.7	2673.9	-403.7	-2643.2	2673.9	261.3	0.0	0.0	8934.6	-3.6	1.5782	4.56	1E-10
33	11500.00	90.42	261.32	100	8914.0	2773.9	-418.8	-2742.1	2773.9	261.3	0.0	0.0	8934.6	-3.6	1.5782	4.56	1E-10
34	11600.00	90.42	261.32	100	8913.3	2873.9	-433.9	-2840.9	2873.9	261.3	0.0	0.0	8934.6	-3.6	1.5782	4.56	1E-10
35	11700.00	90.42	261.32	100	8912.5	2973.9	-449.0	-2939.8	2973.9	261.3	0.0	0.0	8934.6	-3.6	1.5782	4.56	1E-10
36	11800.00	90.42	261.32	100	8911.8	3073.9	-464.1	-3038.6	3073.9	261.3	0.0	0.0	8934.6	-3.6	1.5782	4.56	1E-10
37	11900.00	90.42	261.32	100	8911.0	3173.9	-479.2	-3137.5	3173.9	261.3	0.0	0.0	8934.6	-3.6	1.5782	4.56	1E-10
38	12000.00	90.42	261.32	100	8910.3	3273.9	-494.3	-3236.3	3273.9	261.3	0.0	0.0	8934.6	-3.6	1.5782	4.56	1E-10
39	12100.00	90.42	261.32	100	8909.6	3373.9	-509.4	-3335.2	3373.9	261.3	0.0	0.0	8934.6	-3.6	1.5782	4.56	1E-10
40	12200.00	90.42	261.32	100	8908.8	3473.8	-524.5	-3434.0	3473.8	261.3	0.0	0.0	8934.6	-3.6	1.5782	4.56	1E-10
41	12300.00	90.42	261.32	100	8908.1	3573.8	-539.6	-3532.9	3573.8	261.3	0.0	0.0	8934.6	-3.6	1.5782	4.56	1E-10
42	12400.00	90.42	261.32	100	8907.3	3673.8	-554.7	-3631.7	3673.8	261.3	0.0	0.0	8934.6	-3.6	1.5782	4.56	1E-10
43	12500.00	90.42	261.32	100	8906.6	3773.8	-569.8	-3730.6	3773.8	261.3	0.0	0.0	8934.6	-3.6	1.5782	4.56	1E-10
44	12600.00	90.42	261.32	100	8905.9	3873.8	-584.9	-3829.4	3873.8	261.3	0.0	0.0	8934.6	-3.6	1.5782	4.56	1E-10
45	12700.00	90.42	261.32	100	8905.1	3973.8	-600.0	-3928.3	3973.8	261.3	0.0	0.0	8934.6	-3.6	1.5782	4.56	1E-10
46	12800.00	90.42	261.32	100	8904.4	4073.8	-615.1	-4027.1	4073.8	261.3	0.0	0.0	8934.6	-3.6	1.5782	4.56	1E-10
47	12900.00	90.42	261.32	100	8903.6	4173.8	-630.2	-4126.0	4173.8	261.3	0.0	0.0	8934.6	-3.6	1.5782	4.56	1E-10
48	13000.00	90.42	261.32	100	8902.9	4273.8	-645.3	-4224.8	4273.8	261.3	0.0	0.0	8934.6	-3.6	1.5782	4.56	1E-10
49	13100.00	90.42	261.32	100	8902.1	4373.8	-660.4	-4323.7	4373.8	261.3	0.0	0.0	8934.6	-3.6	1.5782	4.56	1E-10
50	13200.00	90.42	261.32	100	8901.4	4473.8	-675.5	-4422.5	4473.8	261.3	0.0	0.0	8934.6	-3.6	1.5782	4.56	1E-10
51	13300.00	90.42	261.32	100	8900.7	4573.8	-690.6	-4521.4	4573.8	261.3	0.0	0.0	8934.6	-3.6	1.5782	4.56	1E-10
52	13400.00	90.42	261.32	100	8899.9	4673.8	-705.7	-4620.2	4673.8	261.3	0.0	0.0	8934.6	-3.6	1.5782	4.56	1E-10
53	13500.00	90.42	261.32	100	8899.2	4773.8	-720.8	-4719.1	4773.8	261.3	0.0	0.0	8934.6	-3.6	1.5782	4.56	1E-10
54	13600.00	90.42	261.32	100	8898.4	4873.8	-735.9	-4817.9	4873.8	261.3	0.0	0.0	8934.6	-3.6	1.5782	4.56	1E-10
55	13700.00	90.42	261.32	100	8897.7	4973.8	-751.0	-4916.8	4973.8	261.3	0.0	0.0	8934.6	-3.6	1.5782	4.56	1E-10
56	13800.00	90.42	261.32	100	8897.0	5073.8	-766.1	-5015.6	5073.8	261.3	0.0	0.0	8934.6	-3.6	1.5782	4.56	1E-10
57	13900.00	90.42	261.32	100	8896.2	5173.8	-781.2	-5114.5	5173.8	261.3	0.0	0.0	8934.6	-3.6	1.5782	4.56	1E-10
58	14000.00	90.42	261.32	100	8895.5	5273.8	-796.3	-5213.3	5273.8	261.3	0.0	0.0	8934.6	-3.6	1.5782	4.56	1E-10
59	14100.00	90.42	261.32	100	8894.7	5373.8	-811.4	-5312.2	5373.8	261.3	0.0	0.0	8934.6	-3.6	1.5782	4.56	1E-10
60	14200.00	90.42	261.32	100	8894.0	5473.8	-826.5	-5411.0	5473.8	261.3	0.0	0.0	8934.6	-3.6	1.5782	4.56	1E-10

61	14300.00	90.42	261.32	100	8893.3	5573.8	-841.6	-5509.9	5573.8	261.3	0.0	0.0	8934.6	-3.6	1.5782	4.56	1E-10
62	14400.00	90.42	261.32	100	8892.5	5673.8	-856.7	-5608.7	5673.8	261.3	0.0	0.0	8934.6	-3.6	1.5782	4.56	1E-10
63	14500.00	90.42	261.32	100	8891.8	5773.8	-871.8	-5707.6	5773.8	261.3	0.0	0.0	8934.6	-3.6	1.5782	4.56	1E-10
64	14600.00	90.42	261.32	100	8891.0	5873.8	-886.9	-5806.4	5873.8	261.3	0.0	0.0	8934.6	-3.6	1.5782	4.56	1E-10
65	14700.00	90.42	261.32	100	8890.3	5973.8	-902.0	-5905.3	5973.8	261.3	0.0	0.0	8934.6	-3.6	1.5782	4.56	1E-10
66	14800.00	90.42	261.32	100	8889.6	6073.8	-917.1	-6004.1	6073.8	261.3	0.0	0.0	8934.6	-3.6	1.5782	4.56	1E-10
67	14900.00	90.42	261.32	100	8888.8	6173.8	-932.2	-6103.0	6173.8	261.3	0.0	0.0	8934.6	-3.6	1.5782	4.56	1E-10
68	15000.00	90.42	261.32	100	8888.1	6273.8	-947.3	-6201.8	6273.8	261.3	0.0	0.0	8934.6	-3.6	1.5782	4.56	1E-10
69	15100.00	90.42	261.32	100	8887.3	6373.8	-962.4	-6300.7	6373.8	261.3	0.0	0.0	8934.6	-3.6	1.5782	4.56	1E-10
70	15200.00	90.42	261.32	100	8886.6	6473.8	-977.5	-6399.5	6473.8	261.3	0.0	0.0	8934.6	-3.6	1.5782	4.56	1E-10
71	15300.00	90.42	261.32	100	8885.9	6573.8	-992.6	-6498.4	6573.8	261.3	0.0	0.0	8934.6	-3.6	1.5782	4.56	1E-10
72	15400.00	90.42	261.32	100	8885.1	6673.8	-1007.7	-6597.2	6673.8	261.3	0.0	0.0	8934.6	-3.6	1.5782	4.56	1E-10
73	15500.00	90.42	261.32	100	8884.4	6773.8	-1022.8	-6696.1	6773.8	261.3	0.0	0.0	8934.6	-3.6	1.5782	4.56	1E-10
74	15600.00	90.42	261.32	100	8883.6	6873.8	-1037.9	-6794.9	6873.8	261.3	0.0	0.0	8934.6	-3.6	1.5782	4.56	1E-10
75	15700.00	90.42	261.32	100	8882.9	6973.8	-1053.0	-6893.8	6973.8	261.3	0.0	0.0	8934.6	-3.6	1.5782	4.56	1E-10
76	15800.00	90.42	261.32	100	8882.1	7073.7	-1068.1	-6992.7	7073.7	261.3	0.0	0.0	8934.6	-3.6	1.5782	4.56	1E-10
77	15900.00	90.42	261.32	100	8881.4	7173.7	-1083.2	-7091.5	7173.7	261.3	0.0	0.0	8934.6	-3.6	1.5782	4.56	1E-10
78	16000.00	90.42	261.32	100	8880.7	7273.7	-1098.3	-7190.4	7273.7	261.3	0.0	0.0	8934.6	-3.6	1.5782	4.56	1E-10
79	16100.00	90.42	261.32	100	8879.9	7373.7	-1113.4	-7289.2	7373.7	261.3	0.0	0.0	8934.6	-3.6	1.5782	4.56	1E-10
80	16200.00	90.42	261.32	100	8879.2	7473.7	-1128.5	-7388.1	7473.7	261.3	0.0	0.0	8934.6	-3.6	1.5782	4.56	1E-10
81	16300.00	90.42	261.32	100	8878.4	7573.7	-1143.6	-7486.9	7573.7	261.3	0.0	0.0	8934.6	-3.6	1.5782	4.56	1E-10
82	16400.00	90.42	261.32	100	8877.7	7673.7	-1158.7	-7585.8	7673.7	261.3	0.0	0.0	8934.6	-3.6	1.5782	4.56	1E-10
83	16500.00	90.42	261.32	100	8877.0	7773.7	-1173.8	-7684.6	7773.7	261.3	0.0	0.0	8934.6	-3.6	1.5782	4.56	1E-10
84	16600.00	90.42	261.32	100	8876.2	7873.7	-1188.9	-7783.5	7873.7	261.3	0.0	0.0	8934.6	-3.6	1.5782	4.56	1E-10
85	16700.00	90.42	261.32	100	8875.5	7973.7	-1204.0	-7882.3	7973.7	261.3	0.0	0.0	8934.6	-3.6	1.5782	4.56	1E-10
86	16800.00	90.42	261.32	100	8874.7	8073.7	-1219.0	-7981.2	8073.7	261.3	0.0	0.0	8934.6	-3.6	1.5782	4.56	1E-10
87	16900.00	90.42	261.32	100	8874.0	8173.7	-1234.1	-8080.0	8173.7	261.3	0.0	0.0	8934.6	-3.6	1.5782	4.56	1E-10
88	17000.00	90.42	261.32	100	8873.3	8273.7	-1249.2	-8178.9	8273.7	261.3	0.0	0.0	8934.6	-3.6	1.5782	4.56	1E-10
89	17100.00	90.42	261.32	100	8872.5	8373.7	-1264.3	-8277.7	8373.7	261.3	0.0	0.0	8934.6	-3.6	1.5782	4.56	1E-10
90	17200.00	90.42	261.32	100	8871.8	8473.7	-1279.4	-8376.6	8473.7	261.3	0.0	0.0	8934.6	-3.6	1.5782	4.56	1E-10
91	17300.00	90.42	261.32	100	8871.0	8573.7	-1294.5	-8475.4	8573.7	261.3	0.0	0.0	8934.6	-3.6	1.5782	4.56	1E-10
92	17400.00	90.42	261.32	100	8870.3	8673.7	-1309.6	-8574.3	8673.7	261.3	0.0	0.0	8934.6	-3.6	1.5782	4.56	1E-10
93	17500.00	90.42	261.32	100	8869.6	8773.7	-1324.7	-8673.1	8773.7	261.3	0.0	0.0	8934.6	-3.6	1.5782	4.56	1E-10
94	17600.00	90.42	261.32	100	8868.8	8873.7	-1339.8	-8772.0	8873.7	261.3	0.0	0.0	8934.6	-3.6	1.5782	4.56	1E-10
95	17700.00	90.42	261.32	100	8868.1	8973.7	-1354.9	-8870.8	8973.7	261.3	0.0	0.0	8934.6	-3.6	1.5782	4.56	1E-10
96	17800.00	90.42	261.32	100	8867.3	9073.7	-1370.0	-8969.7	9073.7	261.3	0.0	0.0	8934.6	-3.6	1.5782	4.56	1E-10
97	17900.00	90.42	261.32	100	8866.6	9173.7	-1385.1	-9068.5	9173.7	261.3	0.0	0.0	8934.6	-3.6	1.5782	4.56	1E-10
98	18000.00	90.42	261.32	100	8865.9	9273.7	-1400.2	-9167.4	9273.7	261.3	0.0	0.0	8934.6	-3.6	1.5782	4.56	1E-10

99	18100.00	90.42	261.32	100	8865.1	9373.7	-1415.3	-9266.2	9373.7	261.3	0.0	0.0	8934.6	-3.6	1.5782	4.56	1E-10
100	18200.00	90.42	261.32	100	8864.4	9473.7	-1430.4	-9365.1	9473.7	261.3	0.0	0.0	8934.6	-3.6	1.5782	4.56	1E-10
101	18300.00	90.42	261.32	100	8863.6	9573.7	-1445.5	-9463.9	9573.7	261.3	0.0	0.0	8934.6	-3.6	1.5782	4.56	1E-10
102	18400.00	90.42	261.32	100	8862.9	9673.7	-1460.6	-9562.8	9673.7	261.3	0.0	0.0	8934.6	-3.6	1.5782	4.56	1E-10
103	18500.00	90.42	261.32	100	8862.1	9773.7	-1475.7	-9661.6	9773.7	261.3	0.0	0.0	8934.6	-3.6	1.5782	4.56	1E-10
104	18600.00	90.42	261.32	100	8861.4	9873.7	-1490.8	-9760.5	9873.7	261.3	0.0	0.0	8934.6	-3.6	1.5782	4.56	1E-10
105	18700.00	90.42	261.32	100	8860.7	9973.7	-1505.9	-9859.3	9973.7	261.3	0.0	0.0	8934.6	-3.6	1.5782	4.56	1E-10
106	18800.00	90.42	261.32	100	8859.9	10073.7	-1521.0	-9958.2	10073.7	261.3	0.0	0.0	8934.6	-3.6	1.5782	4.56	1E-10
107	18900.00	90.42	261.32	100	8859.2	10173.7	-1536.1	#####	10173.7	261.3	0.0	0.0	8934.6	-3.6	1.5782	4.56	1E-10
108	19000.00	90.42	261.32	100	8858.4	10273.7	-1551.2	#####	10273.7	261.3	0.0	0.0	8934.6	-3.6	1.5782	4.56	1E-10
109	19100.00	90.42	261.32	100	8857.7	10373.7	-1566.3	#####	10373.7	261.3	0.0	0.0	8934.6	-3.6	1.5782	4.56	1E-10
110	19200.00	90.42	261.32	100	8857.0	10473.7	-1581.4	#####	10473.7	261.3	0.0	0.0	8934.6	-3.6	1.5782	4.56	1E-10
111	19300.00	90.42	261.32	100	8856.2	10573.7	-1596.5	#####	10573.7	261.3	0.0	0.0	8934.6	-3.6	1.5782	4.56	1E-10
112	19327.92	90.42	261.32	27.917	8856.0	10601.6	-1600.7	#####	10601.6	261.3	0.0	0.0	8934.6	-3.6	1.5782	4.56	1E-10



**STATE OF NEW MEXICO  
ENERGY, MINERALS AND NATURAL RESOURCES DEPARTMENT  
OIL CONSERVATION DIVISION**

**APPLICATIONS OF MEWBOURNE OIL COMPANY  
FOR COMPULSORY POOLING, EDDY COUNTY,  
NEW MEXICO.**

**Case Nos. 21960**

**SELF-AFFIRMED STATEMENT OF NOTICE**

COUNTY OF SANTA FE     )  
                                          ) ss.  
STATE OF NEW MEXICO    )

James Bruce deposes and states:

1. I am over the age of 18, and have personal knowledge of the matters stated herein.
2. I am an attorney for Mewbourne Oil Company.
3. Mewbourne Oil Company has conducted a good faith, diligent effort to find the names and correct addresses of the interest owners entitled to receive notice of the application filed herein.
4. Notice of the application was provided to the interest owner, at their last known addresses, by certified mail. Copies of the notice letter and certified return receipts are attached hereto as Attachment A.
5. Applicant has complied with the notice provisions of Division Rules.
6. I understand that this Self-Affirmed Statement will be used as written testimony in this case. I affirm that my testimony in paragraphs 1 through 5 above is true and correct and is made under penalty of perjury under the laws of the State of New Mexico. My testimony is made as of the date handwritten next to my signature below.

Date:

6/15/21

James Bruce  
James Bruce

EXHIBIT

4



**JAMES BRUCE**  
ATTORNEY AT LAW

POST OFFICE BOX 1056  
SANTA FE, NEW MEXICO 87504

369 MONTEZUMA, NO. 213  
SANTA FE, NEW MEXICO 87501

(505) 982-2043 (Phone)  
(505) 660-6612 (Cell)  
(505) 982-2151 (Fax)

[jamesbruc@aol.com](mailto:jamesbruc@aol.com)

May 27, 2021

CERTIFIED MAIL - RETURN RECEIPT REQUESTED

To: Persons on Exhibit A

Ladies and gentlemen:

Enclosed is a copy of an application

Enclosed is a copy of an application (Case No. 21960), filed with the New Mexico Oil Conservation Division by Mewbourne Oil Company, seeking to pool the Wolfcamp formation underlying a horizontal spacing unit comprised of the N/2 of Section 28 and the N/2 of Section 29, Township 22 South, Range 27 East, N.M.P.M., Eddy County, New Mexico.

This matter is scheduled for hearing at 8:15 a.m. on Thursday, June 17, 2021. During the COVID-19 Public Health Emergency, state buildings are closed to the public and the hearing will be conducted remotely. To determine the location of the hearing or to participate in an electronic hearing, go to [emnrd.state.nm.us/OCD/hearings](http://emnrd.state.nm.us/OCD/hearings) or see the instructions posted on the Division's website, <http://emnrd.state.nm.us/OCD/announcements.html>. You are not required to attend this hearing, but as an owner of an interest who may be affected by the application, you may appear and present testimony. Failure to appear at that time and become a party of record will preclude you from contesting this matter at a later date. A party appearing in a Division case is required by Division Rules to file a Pre-Hearing Statement no later than Thursday, June 10, 2021. This statement may be filed online with the Division at [ocd.hearings@state.nm.us](mailto:ocd.hearings@state.nm.us), and should include: The name of the party and his or her attorney; a concise statement of the case; the name(s) of the witness(es) the party will call to testify at the hearing; the approximate time the party will need to present his or her case; and identification of any procedural matters that need to be resolved prior to the hearing. The Pre-Hearing Statement must also be provided to the undersigned.

Very truly yours,

  
James Bruce

Attorney for Mewbourne Oil Company

ATTACHMENT 

\* MRC Permian Company  
One Lincoln Centre  
5400 LBJ Freeway, STE 1500  
Dallas, TX 75240

\* Charles V. Eskridge, ssp  
6651 West 5<sup>th</sup> Street  
Los Angeles, CA 90048

\* Tommy & Werta Phipps as Trustees of  
the Phipps Living Trust u/t/a dated 10/13/2009  
6280 Tack Ct.  
West Linn, Oregon 97068

\* The heirs and/or devisees of Fowler S. Griffith  
6280 Tack Ct.  
West Linn, Oregon 97068

\* Oak Valley Mineral and Land, LP  
P.O. Box 50820  
Midland, TX 79710

The heirs & assigns of the Estate of David P. Griffith  
482 Esther Street  
Costa Mesa, California 82627

EXHIBIT

A

## SENDER: COMPLETE THIS SECTION

- Complete items 1, 2, and 3.  
 ■ Print your name and address on the reverse so that we can return the card to you.  
 ■ Attach this card to the back of the mailpiece, or on the front if space permits.

1. Article Addressed to:

\* Oak Valley Mineral and Land, LP  
 P.O. Box 50820  
 Midland, TX 79710

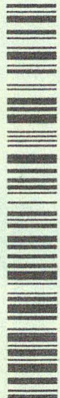

9590 9402 5941 0062 9352 73

2. 7020 0640 0000 1389 5377

(over \$500)

PS Form 3811, July 2015 PSN 7530-02-000-9053

M C SL

Domestic Return Receipt

## COMPLETE THIS SECTION ON DELIVERY

A. Signature ☒ Agent  
☐ Addressee  
 B. Received by (Printed Name) C. Date of Delivery  
 G. Mendonza 6/7/21  
 D. Is delivery address different from item 1? ☐ Yes  
 If YES, enter delivery address below: ☐ No

3. Service Type  
☐ Adult Signature  
☐ Adult Signature Restricted Delivery  
☒ Certified Mail®  
☐ Certified Mail Restricted Delivery  
☐ Collect on Delivery  
☐ Registered Mail™  
☐ Registered Mail Restricted Delivery  
☐ Return Receipt for Merchandise  
☐ Signature Confirmation™  
☐ Signature Confirmation Restricted Delivery  
☐ Priority Mail Express®  
☐ Registered Mail™  
☐ Registered Mail Restricted Delivery  
☐ Return Receipt for Merchandise  
☐ Signature Confirmation™  
☐ Signature Confirmation Restricted Delivery

U.S. Postal Service™  
CERTIFIED MAIL® RECEIPT

Domestic Mail Only

For delivery information, visit our website at [www.usps.com](http://www.usps.com)®.

## OFFICIAL USE

Certified Mail Fee

Extra Services &amp; Fees (check box, add fee as appropriate)

☐ Return Receipt (hardcopy) \$  
☐ Return Receipt (electronic) \$  
☐ Certified Mail Restricted Delivery \$  
☐ Adult Signature Required \$  
☐ Adult Signature Restricted Delivery \$

Postage

Total Postage and Fees

\* Oak Valley Mineral and Land, LP

P.O. Box 50820

Midland, TX 79710

Street and Apt. No.,

City, State, Zip+4®

PS Form 3800, April 2015 PSN 7530-02-000-9047

See Reverse for Instructions

Postmark  
Here



7020 0640 0000 1389 5360

**U.S. Postal Service™**  
**CERTIFIED MAIL® RECEIPT**  
*Domestic Mail Only*
For delivery information, visit our website at [www.usps.com](http://www.usps.com)®.**OFFICIAL USE**

Certified Mail Fee

\$

Extra Services &amp; Fees (check box, add fee as appropriate)

☐ Return Receipt (hardcopy) \$  
☐ Return Receipt (electronic) \$  
☐ Certified Mail Restricted Delivery \$  
☐ Adult Signature Required \$  
☐ Adult Signature Restricted Delivery \$
Postmark  
Here

Postage

\$

Total Postage and Fees

\$

Sent To

 The heirs & assigns of the Estate of David P. Griffith  
 482 Esther Street  
 Costa Mesa, California 92627

Street and Apt. No., or P

City, State, ZIP+4®

PS Form 3800, April 2015 PSN 7530-02-000-9047

See Reverse for Instructions

7020 0640 0000 1389 5407

**U.S. Postal Service™**  
**CERTIFIED MAIL® RECEIPT**  
*Domestic Mail Only*
For delivery information, visit our website at [www.usps.com](http://www.usps.com)®.**OFFICIAL USE**

Certified Mail Fee

\$

Extra Services &amp; Fees (check box, add fee as appropriate)

☐ Return Receipt (hardcopy) \$  
☐ Return Receipt (electronic) \$  
☐ Certified Mail Restricted Delivery \$  
☐ Adult Signature Required \$  
☐ Adult Signature Restricted Delivery \$
Postmark  
Here

Postage

\$

Total Postage and Fees

\$

Sent To

 \* Charles V. Eskridge, esp  
 6651 West 5<sup>th</sup> Street  
 Los Angeles, CA 90048

Street and Apt. No.

City, State, ZIP+4®

PS Form 3800, April 2015 PSN 7530-02-000-9047

See Reverse for Instructions

7020 0640 0000 1389 5414

**U.S. Postal Service™**  
**CERTIFIED MAIL® RECEIPT**  
*Domestic Mail Only*
For delivery information, visit our website at [www.usps.com](http://www.usps.com)®.**OFFICIAL USE**

Certified Mail Fee

\$

Extra Services &amp; Fees (check box, add fee as appropriate)

☐ Return Receipt (hardcopy) \$  
☐ Return Receipt (electronic) \$  
☐ Certified Mail Restricted Delivery \$  
☐ Adult Signature Required \$  
☐ Adult Signature Restricted Delivery \$
Postmark  
Here

Postage

\$

Total Postage and Fees

\$

Sent To

 \* MRC Permian Company  
 One Lincoln Centre  
 5400 LBJ Freeway, STE 1500  
 Dallas, TX 75240

Street and Apt. No., or P

City, State, ZIP+4®

PS Form 3800, April 2015 PSN 7530-02-000-9047

See Reverse for Instructions

PLACE STICKER AT TOP OF ENVELOPE TO THE RIGHT OF THE RETURN ADDRESS. FOLD AT DOTTED LINE.

**CERTIFIED MAIL®**

ALBUQUERQUE NM 870

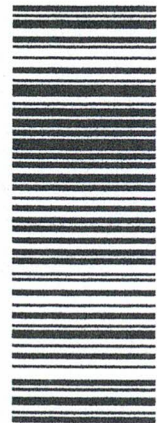

7020 0640 0000 1389 5384

James Bruce

P.O. Box 1056

Santa Fe, New Mexico 87504

ACK

SCAT  
4/5  
10  
20IA  
87504>1056  
57068-22

11/10/14

S77077.139

US POSTAGE  
FIRST-CLASS  
06251323232  
87501  
000128594\* The heirs and/or devisees of Fowler S. Griffith  
6280 Tack Ct.  
West Linn, Oregon 97068

NIXIE 971 DE 1 0006/06A1

RETURN TO SENDER  
INSUFFICIENT ADDRESS  
UNABLE TO FORWARD

BC: 87504105656 \*0568-01559-01-43

U.S. Postal Service™

**CERTIFIED MAIL® RECEIPT**

Domestic Mail Only

For delivery information, visit our website at [www.usps.com](http://www.usps.com)®**OFFICIAL USE**

Certified Mail Fee

Extra Services &amp; Fees (check box, add fee as appropriate)

☐ Return Receipt (hardcopy) \$☐ Return Receipt (electronic) \$☐ Certified Mail Restricted Delivery \$☐ Adult Signature Required \$☐ Adult Signature Restricted Delivery \$

Postage \$

Total Postage and Fees \$

Sent To \$

Street and Apt. No., or PO

City, State, ZIP+4®

Postmark Here

\* The heirs and/or devisees of Fowler S. Griffith  
6280 Tack Ct.  
West Linn, Oregon 97068

PS Form 3800, April 2015 PSN 7530-02-000-9047

See Reverse for Instructions



James Bruce  
P.O. Box 1056  
Santa Fe, New Mexico 87504

ADK

**CERTIFIED MAIL®** ALBUQUERQUE NM 870

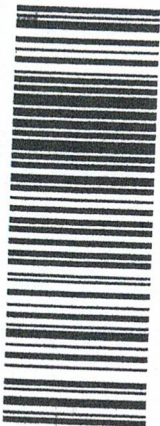

7020 0640 0000 1389 5391

JUN 2021 PM 2 L



\* Tommy & Werta Phipps as Trustees of  
the Phipps Living Trust u/t/a dated 10/13/2009  
6280 Tack Ct.

NINE West Linn, Oregon 97068

RETURN TO SENDER  
INSUFFICIENT ADDRESS  
UNABLE TO FORWARD

IA  
87504>1056  
97068-226980

0006/08/21

BC: 87504105656 20568-01476-01-43

**U.S. Postal Service™**  
**CERTIFIED MAIL® RECEIPT**  
Domestic Mail Only

For delivery information, visit our website at [www.usps.com](http://www.usps.com)®.

**OFFICIAL USE**

Certified Mail Fee

Extra Services & Fees (check box, add fee as appropriate)

- ☐ Return Receipt (hardcopy) \$
- ☐ Return Receipt (electronic) \$
- ☐ Certified Mail Restricted Delivery \$
- ☐ Adult Signature Required \$
- ☐ Adult Signature Restricted Delivery \$

Postage

Total Postage and Fees

Sent To

Street and Apt. No., or P.O. Box

City, State, ZIP+4®

PS Form 3800, April 2015 PSN 7530-02-000-9047

See Reverse for Instructions

\* Tommy & Werta Phipps as Trustees of  
the Phipps Living Trust u/t/a dated 10/13/2009  
6280 Tack Ct.  
West Linn, Oregon 97068

Postmark Here

7020 0640 0000 1389 5391



# Carlsbad Current Argus.

PART OF THE USA TODAY NETWORK

## Affidavit of Publication

Ad # 0004765750

This is not an invoice

JAMES BRUCE ATTORNEY AT LAW  
POBOX 1056

SANTA FE, NM 87504-1056

I, a legal clerk of the **Carlsbad Current Argus**, a newspaper published daily at the City of Carlsbad, in said county of Eddy, state of New Mexico and of general paid circulation in said county; that the same is a duly qualified newspaper under the laws of the State wherein legal notices and advertisements may be published; that the printed notice attached hereto was published in the regular and entire edition of said newspaper and not in supplement thereof on the date as follows, to wit:

06/04/2021

  
Legal Clerk

Subscribed and sworn before me this June 4, 2021:

  
State of WI, County of Brown  
NOTARY PUBLIC

1-7-25  
My commission expires

KATHLEEN ALLEN  
Notary Public  
State of Wisconsin

Ad # 0004765750  
PO #: Publication 1  
# of Affidavits 1

This is not an invoice

EXHIBIT 5

## NOTICE

To: MRC Permian Company, Charles V. Eskridge, Tommy Phipps and Werta Phipps as Trustees of the Phipps Living Trust, Fowler S. Griffith, Oak Valley Land Mineral and Land LP, and David P. Griffith, or your heirs, devisees, successors, or assigns: Mewbourne Oil Company has filed an application (designated Case No. 21960) with the New Mexico Oil Conservation Division to re-open Case No. 21496, and seeking an order pooling additional mineral interest owners in the Wolfcamp formation underlying a horizontal spacing unit comprised of the N/2 of Section 28 and the N/2 of Section 29, Township 22 South, Range 27 East, NMPM. The unit will be dedicated to (a) The City Slickers 28/29 W0HE Fee Well No. 1H, with a first take point in the SE/4NE/4 of 28 and a last take point in the SW/4NW/4 of Section 29, and (b) The City Slickers 28/29 W0AD Fee Well No. 1H, with a first take point in the NE/4NE/4 of 28 and a last take point in the NW/4NW/4 of Section 29. Also to be considered will be the cost of drilling, completing, and equipping the wells and the allocation of the cost thereof, as well as actual operating costs and charges for supervision, designation of applicant as operator of the wells, and a 200% charge for the risk involved in drilling, completing, and equipping the wells.

The application is scheduled to be heard at 8:15 a.m. on June 17, 2021. During the COVID-19 Public Health Emergency, state buildings are closed to the public and the hearing will be conducted remotely. To determine the location of the hearing or to participate in an electronic hearing, go to [emnrd.state.nm.us/OCD/hearings](http://emnrd.state.nm.us/OCD/hearings) or see the instructions posted on the Division's website, <http://emnrd.state.nm.us/OCD/announcements.html>. You are not required to attend this hearing, but as an owner of an interest who may be affected by the application, you may appear and present testimony. Failure to appear at that time and become a party of record will preclude you from contesting this matter at a later date. A party appearing in a Division case is required by Division Rules to file a Pre-Hearing Statement no later than Thursday, June 10, 2021. This statement may be filed online with the Division at [ocd.hearings@state.nm.us](mailto:ocd.hearings@state.nm.us), and should include: The name of the party and his or her attorney; a concise statement of the case; the name(s) of the witness(es) the party will call to testify at the hearing; the approximate time the party will need to present his or her case; and identification of any procedural

matters that need to be resolved prior to the hearing. The Pre-Hearing Statement must also be provided to the attorney for applicant, James Bruce, P.O. Box 1056, Santa Fe, New Mexico 87504, (505) 982-2043, jamesbruc@aol.com. The unit is located approximately 2-1/2 miles northwest of Otis, New Mexico.  
#4765750 , Current Argus,  
June 4, 2021

**COMPULSORY POOLING APPLICATION CHECKLIST****ALL INFORMATION IN THE APPLICATION MUST BE SUPPORTED BY SIGNED AFFIDAVITS**

<b>Case:</b>	<b>21960</b>
<b>Date</b>	<b>June 17, 2021</b>
Applicant	Mewbourne Oil Company
Designated Operator & OGRID (affiliation if applicable)	Mewbourne Oil Company/OGRID No. 14744
Applicant's Counsel:	James Bruce
Case Title:	Application of Mewbourne Oil Company for Compulsory Pooling, Eddy County, New Mexico
Entries of Appearance/Intervenors:	MTC Permian Company/Ho;;and & Hart LLP
Well Family	City Slickers Wolfcamp wells
<b>Formation/Pool</b>	
Formation Name(s) or Vertical Extent:	Wolfcamp Formation
Primary Product (Oil or Gas):	Gas
Pooling this vertical extent:	Entire Wolfcamp formation
Pool Name and Pool Code:	Purple Sage; Wolfcamp (Gas)/Pool Code 98220
Well Location Setback Rules:	Purple Sage pool rules and current horizontal well rules
Spacing Unit Size:	Half Section/320 acres
<b>Spacing Unit</b>	
Type (Horizontal/Vertical)	Horizontal
Size (Acres)	640 acres
Building Blocks:	320 acres
Orientation:	East-West
Description: TRS/County	N/2 §28 and N/2 §29-22S-27E, NMPM, Eddy County
Standard Horizontal Well Spacing Unit (Y/N), If No, describe	Yes
<b>Other Situations</b>	
Depth Severance: Y/N. If yes, description	No
Proximity Tracts: If yes, description	No
Proximity Defining Well: if yes, description	
Applicant's Ownership in Each Tract	Exhibit 2-B
<b>Well(s)</b>	
Name & API (if assigned), surface and bottom hole location, footages, completion target, orientation, completion status (standard or non-standard)	City Slickers 28/29 WOAD Fed. Com. Well No. 1H API No. 30-015-Pending SHL: 240 FNL & 250 FWL §27-22S-27E BHL: 440 FNL & 330 FWL §29 FTP: 440 FNL & 330 FEL §28 LTP: 440 FSL & 330 FWL §29 Upper Wolfcamp/TVD 8956 feet/MD 19300 feet

EXHIBIT

6



	City Slickers 28/29 W0HE Fed. Com. Well No. 1H API No. 30-015-Pending SHL: 330 FNL & 250 FWL §27-22S-27E BHL: 1900 FNL & 330 FWL §29 FTP: 1900 FNL & 330 FEL §28 LTP: 1900 FSL & 330 FWL §29 Upper Wolfcamp/TVD 8969 feet/MD 19300 feet
Horizontal Well First and Last Take Points	See above
Completion Target (Formation, TVD and MD)	See above
<b>AFE Capex and Operating Costs</b>	
Drilling Supervision/Month \$	\$8000
Production Supervision/Month \$	\$800
Justification for Supervision Costs	Exhibit 2, page 2
Requested Risk Charge	Cost + 200%/Exhibit 2, page 2
<b>Notice of Hearing</b>	
Proposed Notice of Hearing	Exhibit 1
Proof of Mailed Notice of Hearing (20 days before hearing)	Exhibit 4
Proof of Published Notice of Hearing (10 days before hearing)	Exhibit 5
<b>Ownership Determination</b>	
Land Ownership Schematic of the Spacing Unit	Exhibit 2-A
Tract List (including lease numbers and owners)	
Pooled Parties (including ownership type)	Exhibit 2-B
Unlocatable Parties to be Pooled	Exhibit 2-B
Ownership Depth Severance (including percentage above & below)	None
<b>Joinder</b>	
Sample Copy of Proposal Letter	Exhibit 2-C
List of Interest Owners (i.e. Exhibit A of JOA)	Exhibit 2-B
Chronology of Contact with Non-Joined Working Interests	Exhibit 2-C
Overhead Rates In Proposal Letter	
Cost Estimate to Drill and Complete	Exhibit 2-D
Cost Estimate to Equip Well	Exhibit 2-D
Cost Estimate for Production Facilities	Exhibit 2-D
<b>Geology</b>	
Summary (including special considerations)	Exhibit 3
Spacing Unit Schematic	Exhibit 3-A
Gunbarrel/Lateral Trajectory Schematic	Exhibit 3-A
Well Orientation (with rationale)	Standup/Exhibit 3
Target Formation	Wolfcamp

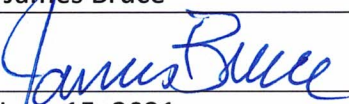

HSD Cross Section	Exhibit 3-B
Depth Severance Discussion	Not Applicable
<b>Forms, Figures and Tables</b>	
C-102	Exhibit 2-A
Tracts	Exhibit 2-B
Summary of Interests, Unit Recapitulation (Tracts)	Exhibit 2
General Location Map (including basin)	Exhibit 2-A
Well Bore Location Map	Exhibit 2-A
Structure Contour Map - Subsea Depth	Exhibit 3-A
Cross Section Location Map (including wells)	Exhibit 3-B
Cross Section (including Landing Zone)	Exhibit 3-B
<b>Additional Information</b>	
<b>CERTIFICATION: I hereby certify that the information provided in this checklist is complete and accurate.</b>	
<b>Printed Name</b> (Attorney or Party Representative):	James Bruce
<b>Signed Name</b> (Attorney or Party Representative):	
<b>Date:</b>	June 15, 2021

**COMPULSORY POOLING APPLICATION CHECKLIST****ALL INFORMATION IN THE APPLICATION MUST BE SUPPORTED BY SIGNED AFFIDAVITS**

<b>Case:</b>	<b>21960</b>
<b>Date</b>	<b>June 17, 2021</b>
<b>Applicant</b>	Mewbourne Oil Company
<b>Designated Operator &amp; OGRID (affiliation if applicable)</b>	Mewbourne Oil Company/OGRID No. 14744
<b>Applicant's Counsel:</b>	James Bruce
<b>Case Title:</b>	Application of Mewbourne Oil Company for Compulsory Pooling, Eddy County, New Mexico
<b>Entries of Appearance/Intervenors:</b>	<del>MRC Permian Company/Holland &amp; Hart LLP</del>
<b>Well Family</b>	Perazzi 9-10 WOMP Fed. Com. Well No. 1H
<b>Formation/Pool</b>	
<b>Formation Name(s) or Vertical Extent:</b>	Wolfcamp Formation
<b>Primary Product (Oil or Gas):</b>	Oil
<b>Pooling this vertical extent:</b>	Entire Wolfcamp formation
<b>Pool Name and Pool Code:</b>	Burton Flat; Upper Wolfcamp, East Oil/Pool Code 98315
<b>Well Location Setback Rules:</b>	Statewide rules and current horizontal well rules
<b>Spacing Unit Size:</b>	Quarter-quarter Sections/40 acres
<b>Spacing Unit</b>	
<b>Type (Horizontal/Vertical)</b>	Horizontal
<b>Size (Acres)</b>	320 acres
<b>Building Blocks:</b>	40 acres
<b>Orientation:</b>	West-East
<b>Description: TRS/County</b>	S/2S/2 §9 and S/2S/2 §10-20S-29E, NMPM, Eddy County
<b>Standard Horizontal Well Spacing Unit (Y/N), If No, describe</b>	Yes
<b>Other Situations</b>	
<b>Depth Severance: Y/N. If yes, description</b>	No
<b>Proximity Tracts: If yes, description</b>	No
<b>Proximity Defining Well: if yes, description</b>	
<b>Applicant's Ownership in Each Tract</b>	Exhibit 2 B-2
<b>Well(s)</b>	
<b>Name &amp; API (if assigned), surface and bottom hole location, footages, completion target, orientation, completion status (standard or non- standard)</b>	Perazzi 9-10 WOMP Fed. Com. Well No. 1H API No. 30-015-Pending SHL: 750 FSL & 210 FEL §8-20S-29E BHL: 440 FSL & 100 FEL §10 FTP: 440 FSL & 100 FWL §9 LTP: 440 FSL & 100 FEL §10 Upper Wolfcamp/TVD 9303 feet/MD 19812 feet



Horizontal Well First and Last Take Points	See above
Completion Target (Formation, TVD and MD)	See above
<b>AFE Capex and Operating Costs</b>	
Drilling Supervision/Month \$	\$8000
Production Supervision/Month \$	\$800
Justification for Supervision Costs	Exhibit 2, page 2
Requested Risk Charge	Cost + 200%/Exhibit 2, page 2
<b>Notice of Hearing</b>	
Proposed Notice of Hearing	Exhibit 1-B
Proof of Mailed Notice of Hearing (20 days before hearing)	Exhibit 4-B
Proof of Published Notice of Hearing (10 days before hearing)	Exhibit 5-B
<b>Ownership Determination</b>	
Land Ownership Schematic of the Spacing Unit	Exhibit 2-A-2
Tract List (including lease numbers and owners)	Exhibit 2-A-2
Pooled Parties (including ownership type)	Exhibit 2-B-2
Unlocatable Parties to be Pooled	Yes
Ownership Depth Severance (including percentage above & below)	None
<b>Joinder</b>	
Sample Copy of Proposal Letter	Exhibit 2-C
List of Interest Owners (i.e. Exhibit A of JOA)	Exhibit 2-B-2
Chronology of Contact with Non-Joined Working Interests	Exhibit 2-C
Overhead Rates In Proposal Letter	
Cost Estimate to Drill and Complete	Exhibit 2-D-2
Cost Estimate to Equip Well	Exhibit 2-D-2
Cost Estimate for Production Facilities	Exhibit 2-D-2
<b>Geology</b>	
Summary (including special considerations)	Exhibit 3
Spacing Unit Schematic	Exhibit 3-B
Gunbarrel/Lateral Trajectory Schematic	Exhibit 3-B, C
Well Orientation (with rationale)	Laydown/Exhibit 3, page 2 and Exhibit 3-B-1, 2
Target Formation	Wolfcamp
HSU Cross Section	Exhibit 3-C
Depth Severance Discussion	Not Applicable
<b>Forms, Figures and Tables</b>	
C-102	Exhibit 2-A-2
Tracts	Exhibit 2-A-2
Summary of Interests, Unit Recapitulation (Tracts)	Exhibit 2-B-2

General Location Map (including basin)	Exhibit 2-A-2
Well Bore Location Map	Exhibit 2-A-2
Structure Contour Map - Subsea Depth	Exhibit 3-B-1
Cross Section Location Map (including wells)	Exhibit 3-B-2
Cross Section (including Landing Zone)	Exhibit 3-C
<b>Additional Information</b>	
<b>CERTIFICATION: I hereby certify that the information provided in this checklist is complete and accurate.</b>	
<b>Printed Name</b> (Attorney or Party Representative):	James Bruce
<b>Signed Name</b> (Attorney or Party Representative):	
<b>Date:</b>	June 15, 2021