

**BEFORE THE OIL CONSERVATION DIVISION  
EXAMINER HEARING OCTOBER 5, 2023**

**APPLICATION OF DEVON ENERGY PRODUCTION  
COMPANY, L.P., FOR COMPULSORY POOLING,  
EDDY COUNTY, NEW MEXICO**

**Case No. 23788:**

**Tater Tot 2-35 Fed Com 622H Well  
Tater Tot 2-35 Fed Com 624H Well  
Tater Tot 2-35 Fed Com 713H Well**

**TABLE OF CONTENTS**  
**DEVON ENERGY PRODUCTION COMPANY, L.P.**

TAB 1	Reference for Case No. 23788 Application Case No. 23788:	<b>Tater Tot 2-35 Fed Com 622H Well</b> <b>Tater Tot 2-35 Fed Com 624H Well</b> <b>Tater Tot 2-35 Fed Com 713H Well</b>
	NMOCD Checklist Case No. 23788	
TAB 2	Exhibit A: Self-Affirmed Statement of Aaron Young, Landman Exhibit A-1: C-102 Form Exhibit A-2: Ownership and Sectional Map Exhibit A-3: Well Proposal Letter and AFE Exhibit A-4: Chronology of Contacts with Uncommitted Owners	
TAB 3	Exhibit B: Self-Affirmed Statement of Sarah Jancuska, Geologist Exhibit B-1: Structure Map Exhibit B-2: Stratigraphic Cross Section	
TAB 4	Exhibit C: Self-Affirmed Statement of Notice, Darin C. Savage Exhibit C-1: Notice Letter Exhibit C-2: Mailing List Exhibit C-3: Affidavit of Publication	

## **TAB 1**

Reference for Case No. 23788

Application Case No. 23788:

**Tater Tot 2-35 Fed Com 622H Well**

**Tater Tot 2-35 Fed Com 624H Well**

**Tater Tot 2-35 Fed Com 713H Well**

NMOCD Checklist Case No. 23788

**STATE OF NEW MEXICO  
ENERGY, MINERALS AND NATURAL RESOURCES DEPARTMENT  
OIL CONSERVATION DIVISION**

**APPLICATION OF DEVON ENERGY PRODUCTION  
COMPANY, L.P., FOR COMPULSORY POOLING,  
EDDY COUNTY, NEW MEXICO**

Case No. 23788

**APPLICATION**

Devon Energy Production Company, L.P., (“Devon”), OGRID No. 6137, through its undersigned attorneys, hereby files this Application with the Oil Conservation Division (“Division”) pursuant to the provisions of NMSA 1978, Section 70-2-17, for an order pooling all uncommitted mineral interests in the Purple Sage; Wolfcamp formation, designated as a gas pool, underlying a non-standard 599.2-acre, more or less, spacing and proration unit comprised of Lot 2 (NW/4 NE/4 equivalent), Lot 1 (NE/4 NE/4 equivalent), the S/2 NE/4, and the SE/4 of Section 2, Township 24 South, Range 29 East, NMPM, and the E/2 NE/4, SW/4 NE/4, and SE/4 of Section 35, Township 23 South, Range 29 East, NMPM, and, all in Eddy County, New Mexico. Section 2 is an irregular section which contains correction units.

In support of its Application, Devon states the following:

1. Devon is a working interest owner in the proposed non-standard horizontal spacing and proration unit (“HSU”) and has a right to drill a well thereon.
2. Devon proposes and dedicates to the HSU the **Tater Tot 2-35 Fed Com 622H Well, Tater Tot 2-35 Fed Com 624H Well, and Tater Tot 2-35 Fed Com 713H Well** as initial wells, to be drilled to a sufficient depth to test the Wolfcamp formation.

3. Devon proposes the **Tater Tot 2-35 Fed Com 622H Well**, a gas well, to be horizontally drilled from a surface location in the SW/4 SE/4 (Unit O) of Section 2 to a bottom hole location in the SW/4 NE/4 (Unit G) of Section 35.

4. Devon proposes the **Tater Tot 2-35 Fed Com 624H Well**, a gas well, to be horizontally drilled from a surface location in the SE/4 SE/4 (Unit P) of Section 2 to a bottom hole location in the NE/4 NE/4 (Unit A) of Section 35.

5. Devon proposes the **Tater Tot 2-35 Fed Com 713H Well**, a gas well, to be horizontally drilled from a surface location in the SE/4 SE/4 (Unit P) of Section 2 to a bottom hole location in the NE/4 NE/4 (Unit A) of Section 35.

6. The proposed wells are unorthodox in their location, and the take points and completed interval do not comply with setback requirements under the Division's Special Rules for the Purple Sage Wolfcamp pool, which are set out in Order No. R-14262.

7. Devon has made applications for administrative approval of the Nonstandard Locations ("NSL") of each well, and the Division has granted approval of each NSL in Order No. NSL-8626, Order No. NSL-8627, and Order No. NSL-8630.

8. Devon has made applications for administrative approval of the Nonstandard Proration ("NSP") Unit, and the Division has granted approval of the NSP Unit in Order No. NSP-2165.

9. Devon has sought in good faith, but has been unable to obtain, voluntary agreement from all interest owners to participate in the drilling of the wells or in the commitment of their interests to the wells for their development within the proposed HSU.

10. The pooling of all interests in the Bone Spring formation within the proposed HSU will avoid the drilling of unnecessary wells, prevent waste, and protect correlative rights.

11. In order to provide for its just and fair share of the oil and gas underlying the subject lands, Devon requests that all uncommitted interests in this HSU be pooled and that Devon be designated the operator of the proposed horizontal wells and HSU.

WHEREFORE, Devon requests that this Application be set for hearing on October 5, 2023, before an Examiner of the Oil Conservation Division, and after notice and hearing as required by law, the Division enter an order:

A. Recognizing the non-standard 599.2-acre, more or less, spacing and proration unit comprised of the E/2 NE/4, SW/4 NE/4, and SE/4 of Section 35, Township 23 South, Range 29 East, NMPM, and Lot 2 (NW/4 NE/4 equivalent), Lot 1 (NE/4 NE/4 equivalent), the S/2 NE/4, and the SE/4 of Section 2, Township 24 South, Range 29 East, NMPM, all in Eddy County, New Mexico;

B. Pooling all uncommitted mineral interests in the Purple Sage; Wolfcamp formation underlying the proposed non-standard HSU.

C. Approving the **Tater Tot 2-35 Fed Com 622H Well, Tater Tot 2-35 Fed Com 624H Well**, and **Tater Tot 2-35 Fed Com 713H Well** as the initial wells for the HSU.

D. Designating Devon as operator of this HSU and the horizontal wells to be drilled thereon;

E. Authorizing Devon to recover its costs of drilling, equipping, and completing the wells;

F. Approving actual operating charges and costs of supervision, to the maximum extent allowable, while drilling and after completion, together with a provision adjusting the rates pursuant to the COPAS accounting procedures; and

G. Setting a 200% charge for the risk assumed by Devon in drilling and completing the wells in the event a working interest owner elects not to participate in the wells.

Respectfully submitted,

ABADIE & SCHILL, PC

/s/ Darin C. Savage

---

Darin C. Savage

Andrew D. Schill  
William E. Zimsky  
214 McKenzie Street  
Santa Fe, New Mexico 87501  
Telephone: 970.385.4401  
Facsimile: 970.385.4901  
darin@abadieschill.com  
andrew@abadieschill.com  
bill@abadieschill.com

**Attorneys for Devon Energy Production  
Company, L.P.**

***Application of Devon Energy Production Company, L.P., for Compulsory Pooling, Eddy County, New Mexico.*** Applicant in the above-styled cause seeks an order from the Division pooling all mineral interests in the Purple Sage; Wolfcamp formation, designated as a gas pool, underlying a non-standard 599.2-acre, more or less, spacing and proration unit comprised of Lot 2 (NW/4 NE/4 equivalent), Lot 1 (NE/4 NE/4 equivalent), the S/2 NE/4, and the SE/4 of Section 2, Township 24 South, Range 29 East, NMPM, and the E/2 NE/4, SW/4 NE/4, and SE/4 of Section 35, Township 23 South, Range 29 East, NMPM, Eddy County, New Mexico. Section 2 is an irregular section containing correction lots. The proposed wells to be dedicated to the horizontal spacing unit are the **Tater Tot 2-35 Fed Com 622H Well**, a gas well, to be horizontally drilled from a surface location in the SW/4 SE/4 (Unit O) of Section 2 to a bottom hole location in the SW/4 NE/4 (Unit G) of Section 35; the **Tater Tot 2-35 Fed Com 624H Well**, a gas well, to be horizontally drilled from a surface location in the SE/4 SE/4 (Unit P) of Section 2 to a bottom hole location in the NE/4 NE/4 (Unit A) of Section 35; and the **Tater Tot 2-35 Fed Com 713H Well**, a gas well, to be horizontally drilled from a surface location in the SE/4 SE/4 (Unit P) of Section 2 to a bottom hole location in the NE/4 NE/4 (Unit A) of Section 35. The wells are unorthodox, and their take points and completed intervals do not comply with the setback requirements under the Division's Special Rules in Order No. R-14262 for the Purple Sage Wolfcamp; however, Applicant has applied for and received administrative approval of the unorthodox locations and has applied for and received administrative approval of the non-standard spacing unit; also to be considered will be the cost of drilling and completing the wells and the allocation of the costs thereof; actual operating costs and charges for supervision; the designation of the Applicant as Operator of the wells and unit; and a 200% charge for the risk involved in drilling and completing the wells. The wells and lands are located approximately 8.8 miles southeast of Loving, New Mexico.



# COMPULSORY POOLING APPLICATION CHECKLIST

## ALL INFORMATION IN THE APPLICATION MUST BE SUPPORTED BY SIGNED AFFIDAVITS

<b>Case: 23788</b>	<b>APPLICANT'S RESPONSE</b>
<b>Date</b>	<b>October 5, 2023</b>
Applicant	<b>DEVON ENERGY PRODUCTION COMPANY, L.P.</b>
Designated Operator & OGRID (affiliation if applicable)	<b>6137</b>
Applicant's Counsel:	Darin C. Savage, Abadie & Schill, P.C.
Case Title:	APPLICATION OF DEVON ENERGY PRODUCTION COMPANY, L.P. FOR COMPULSORY POOLING, EDDY COUNTY, NEW MEXICO
Entries of Appearance/Intervenors:	N/A
Well Family	Tater Tot
<b>Formation/Pool</b>	
Formation Name(s) or Vertical Extent:	Wolfcamp
Primary Product (Oil or Gas):	Gas
Pooling this vertical extent:	Purple Sage; Wolfcamp formation: See Exhibit A, Paras 4-8
Pool Name and Pool Code:	PURPLE SAGE; WOLFCAMP [Pool Code 98220]
Well Location Setback Rules:	Special field rules, see Order No. R-14262
<b>Spacing Unit</b>	
Type (Horizontal/Vertical)	Horizontal
Size (Acres)	599.2-acre, more or less
Building Blocks:	160 acre buidling blocks (quarter sections)
Orientation:	South-North
Description: TRS/County	Lot 2 (NW/4 NE/4 equivalent), Lot 1 (NE/4 NE/4 equivalent), the S/2 NE/4, and the SE/4 of Section 2, Township 24 South, Range 29 East, NMPM, and the E/2 NE/4, SW/4 NE/4, and SE/4 of Section 35, Township 23 South, Range 29 East, NMPM, and, all in Eddy County, New Mexico
Standard Horizontal Well Spacing Unit (Y/N), If No, describe and is approval of non-standard unit requested in this application?	No, non-standard spacing: Devon made application for adminstrative aprocal of the Non-Standard Proration (NSP) Unit, and the Division has granted approval of the NSP Unit in Order No. NSP-2165.
<b>Other Situations</b>	
Depth Severance: Y/N. If yes, description	No, N/A
Proximity Tracts: If yes, description	N/A
Proximity Defining Well: if yes, description	N/A
Revised to Douglings 10/4/2023 8:45:16 AM	See Exhibit A-2

Well(s)	
Name & API (if assigned), surface and bottom hole location, footages, completion target, orientation, completion status (standard or non-standard)	Add wells as needed
Well #1	Tater Tot 2-35 Fed Com 622H Well (API No. Pending), SHL: Unit O, 200' FSL, 2065' FEL, Section 2, T24S-R29E; BHL: Unit G, 1350' FNL, 2310' FEL, Section 35, T23S-R29E, standup, standard location
Horizontal Well First and Last Take Points	Tater Tot 2-35 Fed Com 622H Well: FTP 100' FSL, 2310' FEL, Section 2; LTP 1430' FNL, 2310' FEL, Section 35
Completion Target (Formation, TVD and MD)	Tater Tot 2-35 Fed Com 622H Well: TVD approx. 10,250', TMD 18,750'; Wolfcamp formation, See Exhibit A & B-2
Well #2	Tater Tot 2-35 Fed Com 624H Well (API No. Pending), SHL: Unit P, 240' FSL, 785' FEL, Section 2, T24S-R29E; BHL: Unit A, 20' FNL, 600' FEL, Section 35, T23S-R29E, standup, standard location
Horizontal Well First and Last Take Points	Tater Tot 2-35 Fed Com 624H Well: FTP 100' FSL, 600' FEL, Section 2; LTP 100' FNL, 600' FEL, Section 35
Completion Target (Formation, TVD and MD)	Tater Tot 2-35 Fed Com 624H Well: TVD approx. 10,390', TMD 20,345'; Wolfcamp formation, See Exhibit A & B-2
Well #3	Tater Tot 2-35 Fed Com 713H Well (API No. Pending), SHL: Unit P, 240' FSL, 815' FEL, Section 2, T24S-R29E; BHL: Unit A, 20' FNL, 1170' FEL, Section 35, T23S-R29E, standup, standard location
Horizontal Well First and Last Take Points	Tater Tot 2-35 Fed Com 713H Well: FTP 100' FSL, 1170' FEL, Section 2; LTP 100' FNL, 1170' FEL, Section 35
Completion Target (Formation, TVD and MD)	Tater Tot 2-35 Fed Com 713H Well: TVD approx. 10,563', TMD 20,569'; Wolfcamp formation, See Exhibit A & B-2
AFE Capex and Operating Costs	
Drilling Supervision/Month \$	\$8,000, Exhibit A, para 20; Exhibit A-3
Production Supervision/Month \$	\$800, Exhibit A, para 20; Exhibit A-3
Justification for Supervision Costs	Exhibit A
Requested Risk Charge	200%, Exhibit A
Notice of Hearing	
Proposed Notice of Hearing	Exhibit C, C-1
Proof of Mailed Notice of Hearing (20 days before hearing)	Exhibit C-2
Proof of Published Notice of Hearing (10 days before hearing)	Exhibit C-3
Ownership Determination	
Land Ownership Schematic of the Spacing Unit	Exhibit A-2
Tract List (including legal descriptions and owners)	Exhibit A-2

If approval of Non-Standard Spacing Unit is requested, Tract List (including lease numbers and owners) of Tracts subject to notice requirements.	N/A
Pooled Parties (including ownership type)	Exhibit A-2
Unlocatable Parties to be Pooled	Exhibit A: Para. 16
Ownership Depth Severance (including percentage above & below)	N/A
<b>Joinder</b>	
Sample Copy of Proposal Letter	Exhibit A-3
List of Interest Owners (ie Exhibit A of JOA)	Exhibit A-2
Chronology of Contact with Non-Joined Working Interests	Exhibit A-4
Overhead Rates In Proposal Letter	Exhibit A-3
Cost Estimate to Drill and Complete	Exhibit A-3
Cost Estimate to Equip Well	Exhibit A-3
Cost Estimate for Production Facilities	Exhibit A-3
<b>Geology</b>	
Summary (including special considerations)	Exhibit B
Spacing Unit Schematic	Exhibit B-1
Gunbarrel/Lateral Trajectory Schematic	Geologist believes Exhibits B-1 and B-2 provide accurate evaluation
Well Orientation (with rationale)	Exhibit B-1
Target Formation	Exhibit B-2
HSU Cross Section	Exhibit B-2
Depth Severance Discussion	N/A
<b>Forms, Figures and Tables</b>	
C-102	Exhibit A-1
Tracts	Exhibit A-2
Summary of Interests, Unit Recapitulation (Tracts)	Exhibit A-2
General Location Map (including basin)	Exhibit A-2
Well Bore Location Map	Exhibit A-1
Structure Contour Map - Subsea Depth	Exhibit B-1
Cross Section Location Map (including wells)	Exhibit B-2
Cross Section (including Landing Zone)	Exhibit B-2
<b>Additional Information</b>	
Special Provisions/Stipulations	
<b>CERTIFICATION: I hereby certify that the information provided in this checklist is complete and accurate.</b>	
<b>Printed Name</b> (Attorney or Party Representative):	Darin C. Savage
<b>Signed Name</b> (Attorney or Party Representative):	Darin C. Savage
<b>Date:</b>	10/3/23

## **TAB 2**

Case No. 23788

Exhibit A: Self-Affirmed Statement of Aaron Young, Landman  
Exhibit A-1: C-102 Form  
Exhibit A-2: Ownership and Sectional Map  
Exhibit A-3: Well Proposal Letter and AFE  
Exhibit A-4: Chronology of Contacts with Uncommitted Owners

**STATE OF NEW MEXICO  
ENERGY, MINERALS AND NATURAL RESOURCES DEPARTMENT  
OIL CONSERVATION DIVISION**

**APPLICATION OF DEVON ENERGY PRODUCTION  
COMPANY, L.P., FOR COMPULSORY POOLING,  
EDDY COUNTY, NEW MEXICO**

Case No. 23788

**SELF-AFFIRMED STATEMENT OF AARON YOUNG**

I, being duly sworn on oath, state the following:

1. I am over the age of eighteen years and have the capacity to execute this Self-Affirmed Statement, which is based on my personal knowledge.
2. I am employed as a Landman with Devon Energy Production Company, L.P. (“Devon”), and I am familiar with the subject application and the lands involved. I have previously testified before the New Mexico Oil Conservation Division (“Division”) as an expert witness in petroleum land matters and my credentials have been accepted by the Division and made a matter of record.
3. This Self-Affirmed Statement is submitted in connection with the filing by Devon of the above-referenced spacing and compulsory pooling applications pursuant to 19.15.4.12.A(1).
4. Devon seeks an order pooling all uncommitted mineral interests in the Purple Sage; Wolfcamp formation [Pool Code (98220)], designated as a gas pool, underlying a non-standard 599.2-acre, more or less, spacing and proration unit comprised of Lot 2 (NW/4 NE/4 equivalent), Lot 1 (NE/4 NE/4 equivalent), the S/2 NE/4, and the SE/4 of Section 2, Township 24 South, Range 29 East, NMPM, and the E/2 NE/4, SW/4 NE/4, and SE/4 of Section 35, Township 23 South, Range 29 East, NMPM, all in Eddy County, New Mexico. Section 2 is an irregular section which contains correction units.

**EXHIBIT  
A**

5. Under Case No. 23788, Devon proposes and dedicates to the HSU the **Tater Tot 2-35 Fed Com 622H Well, Tater Tot 2-35 Fed Com 624H Well, and Tater Tot 2-35 Fed Com 713H Well** as initial wells.

6. The **Tater Tot 2-35 Fed Com 622H Well**, (API-pending), a gas well, to be horizontally drilled from a surface location in the SW/4 SE/4 (Unit O) of Section 2 to a bottom hole location in the SW/4 NE/4 (Unit G) of Section 35; approximate TVD 10,250'; approximate TMD 18,750'; FTP in Section 2: 100' FSL, 2,310' FEL, LTP in Section 35: 1430' FNL, 2,310' FEL.

7. The **Tater Tot 2-35 Fed Com 624H Well**, (API-pending), a gas well, to be horizontally drilled from a surface location in the SE/4 SE/4 (Unit P) of Section 2, to a bottom hole location in the NE/4 NE/4 (Unit A) of Section 35; approximate TVD 10,390'; approximate TMD 20,345'; FTP in Section 2: 100' FSL, 600' FEL, LTP in Section 35: 100' FNL, 600' FEL.

8. The **Tater Tot 2-35 Fed Com 713H Well**, (API-pending), a gas well, to be horizontally drilled from a surface location in the SE/4 SE/4 (Unit P) of Section 2, to a bottom hole location in the NE/4 NE/4 (Unit A) of Section 35; approximate TVD 10,563', approximate TMD 20,569', FTP in Section 2: 100' FSL, 1,170', LTP in Section 35: 100' FNL, 1,170' FEL.

9. The proposed C-102s for each of the wells are attached as **Exhibit A-1**.

10. A general location plat and a plat outlining the units being pooled is attached hereto as **Exhibit A-2**, which show the location of the proposed wells within the unit. The proposed wells are unorthodox in location, and the take points and completed intervals do not comply with setback requirements under the special Division rules for the Purple Sage; Wolfcamp pool, which are set out in Order No. R-14262.

11. Devon has made applications for administrative approval of the Nonstandard Locations (“NSL”) of each well, and the Division has granted approval of each NSL in Order No. NSL-8626, Order No. NSL-8627, and Order No. NSL-8630.

12. Devon has made applications for administrative approval of the Nonstandard Proration (“NSP”) Unit, and the Division has granted approval of the NSP Unit in Order No. NSP-2165.

13. The parties being pooled, the nature of their interests, and their last known addresses are listed on **Exhibit A-2** attached hereto. **Exhibit A-2** includes information regarding working interest owners, record title owners, and overriding royalty interest owners.

14. There are no depth severances in the Wolfcamp formation in this acreage.

15. A review of records did not reveal any overlapping units.

16. I provided the law firm of Abadie & Schill P.C. a list of names and addresses for the uncommitted interest owners shown on **Exhibit A-2**. In compiling these addresses, I conducted a diligent search of the public records in Eddy County, New Mexico, where the wells are located, and of phone directories and did computer searches to locate the contact information for parties entitled to notification. All working interest owners were locatable and noticed. There were three unlocatable parties who were ORRI owners: Leslie Robert Honeyman Trust, LaNell Joy Honeyman, Trustee; LJA Charitable Investments, LLC and Strategic Energy Income Fund IV, LP. Devon published notice in the Carlsbad Current Argus, a newspaper of general circulation in Eddy County, New Mexico, to account for any unlocatable parties and cover any contingencies regarding notice.

17. Devon has made a good faith effort to negotiate with the interest owners but has been unable to obtain voluntary agreement from all interest owners to participate in the drilling of

the wells or in the commitment of their interests to the wells for their development within the proposed horizontal spacing unit. **Exhibit A-4** provides a chronology and history of contacts with the owners.

18. The interest owners being pooled have been contacted regarding the proposed wells but have failed or refused to voluntarily commit their interest in the wells. However, Devon has been in ongoing discussions with some of the interest owners to voluntarily enter into a Joint Operating Agreement. If a mutually agreeable Joint Operating Agreement is reached between Devon and another interest owner or owners, Devon requests that the voluntary agreement become operative and supersede the Division's order for said parties, except to the extent the Division deems it necessary to maintain spacing criteria for the purpose of conservation, the prevention of waste, and protection of correlative rights.

19. **Exhibit A-3** is a sample proposal letter and the AFEs for each proposed well. The estimated cost of the wells set forth in the AFEs is fair, reasonable, and comparable to the costs of other wells of similar depths and lengths drilled in this area of New Mexico.

20. Devon requests overhead and administrative rates of \$8,000/month for drilling each well and \$800/month for producing each well. These rates are fair and comparable to the rates charged by other operators for wells of this type in this area of southeastern New Mexico. Devon requests that these rates be adjusted periodically as provided in the COPAS Accounting Procedure.

21. Devon requests the maximum cost, plus 200% risk charge be assessed against non-consenting working interest owners.

22. Devon requests that it be designated operator of the unit and wells.

23. The Exhibits to this Self-Affirmed Statement were prepared by me or compiled from Devon's company business records under my direct supervision.



24. The granting of this Application is in the best interests of conservation, the prevention of waste, and the protection of correlative rights, and will avoid the drilling of unnecessary wells.

25. The foregoing is correct and complete to the best of my knowledge and belief.

*[Signature page follows]*

*Signature page of Self-Affirmed Statement of Aaron Young:*

I understand that this Self-Affirmed Statement will be used as written testimony before the Division in Case No. 23788 and affirm that my testimony herein is true and correct, to the best of my knowledge and belief and made under penalty of perjury under the laws of the State of New Mexico.

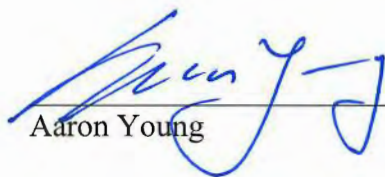
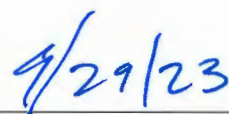
  
\_\_\_\_\_  
Aaron Young  
\_\_\_\_\_  
Date Signed

District I  
1625 N. French Dr., Hobbs, NM 88240  
Phone: (575) 393-6161 Fax: (575) 393-0720  
District II  
811 S. First St., Artesia, NM 88210  
Phone: (575) 748-1283 Fax: (575) 748-9720  
District III  
1000 Rio Brazos Road, Aztec, NM 87410  
Phone: (505) 334-6178 Fax: (505) 334-6170  
District IV  
1220 S. St. Francis Dr., Santa Fe, NM 87505  
Phone: (505) 476-3460 Fax: (505) 476-3462

State of New Mexico  
Energy, Minerals & Natural Resources Department  
OIL CONSERVATION DIVISION  
1220 South St. Francis Dr.  
Santa Fe, NM 87505

Form C-102  
Revised August 1, 2011  
Submit one copy to appropriate  
District Office

☐ AMENDED REPORT

WELL LOCATION AND ACREAGE DEDICATION PLAT

<sup>1</sup> API Number	<sup>2</sup> Pool Code 98220	<sup>3</sup> Pool Name PURPLE SAGE; WOLFCAMP (GAS)
<sup>4</sup> Property Code	<sup>5</sup> Property Name TATER TOT 2-35 FED COM	<sup>6</sup> Well Number 622H
<sup>7</sup> OGRID No. 6137	<sup>8</sup> Operator Name DEVON ENERGY PRODUCTION COMPANY, L.P.	<sup>9</sup> Elevation 3092.4

<sup>10</sup> Surface Location

UL or lot no.	Section	Township	Range	Lot Idn	Feet from the	North/South line	Feet from the	East/West line	County
O	2	24 S	29 E		200	SOUTH	2065	EAST	EDDY

<sup>11</sup> Bottom Hole Location If Different From Surface

UL or lot no.	Section	Township	Range	Lot Idn	Feet from the	North/South line	Feet from the	East/West line	County
G	35	23 S	29 E		1350	NORTH	2310	EAST	EDDY

<sup>12</sup> Dedicated Acres 599.2	<sup>13</sup> Joint or Infill	<sup>14</sup> Consolidation Code	<sup>15</sup> Order No.
----------------------------------------	-------------------------------	----------------------------------	-------------------------

No allowable will be assigned to this completion until all interests have been consolidated or a non-standard unit has been approved by the division.

	<p><b>TATER TOT 2-35 FED COM 622H</b> EL. = 3092.2 GEODETIC COORDINATES NAD 83 NMSP EAST SURFACE LOCATION N. = 451246.26 E. = 658834.80 LAT. = 32.2399804°N LONG. = 103.9533032°W</p> <p>KICK OFF POINT CALLS = _____ N. = _____ E. = _____ LAT. = _____ LONG. = _____</p> <p>FIRST TAKE POINT (PPP 1) 100' FSL, 2310' FEL N. = 451144.69 E. = 658591.02 LAT. = 32.2397035°N LONG. = 103.9540928°W</p> <p>LAST TAKE POINT 1430' FNL, 2310' FEL N. = 460225.62 E. = 658515.69 LAT. = 32.2646662°N LONG. = 103.9542328°W</p> <p>BOTTOM OF HOLE 1350' FNL, 2310' FEL N. = 460305.60 E. = 658515.24 LAT. = 32.2648861°N LONG. = 103.9542333°W</p> <p>PPP 2 0' FSL, 2301' FEL N. = 456336.54 E. = 658547.95 LAT. = 32.2539755°N LONG. = 103.9541729°W</p> <p>PPP 3 2659' FSL, 2307' FEL N. = 458995.33 E. = 658525.89 LAT. = 32.2612843°N LONG. = 103.9542139°W</p> <p>CORNER COORDINATES TABLE NAD 83 NMSP EAST</p> <table border="1"> <tr><td>A - N. = 461665.81</td><td>E. = 660817.24</td></tr> <tr><td>B - N. = 461654.17</td><td>E. = 658151.73</td></tr> <tr><td>C - N. = 461642.89</td><td>E. = 655486.69</td></tr> <tr><td>D - N. = 458986.32</td><td>E. = 655515.09</td></tr> <tr><td>E - N. = 456329.76</td><td>E. = 655543.48</td></tr> <tr><td>F - N. = 453684.45</td><td>E. = 655569.24</td></tr> <tr><td>G - N. = 451030.14</td><td>E. = 655595.01</td></tr> <tr><td>H - N. = 451042.47</td><td>E. = 658249.35</td></tr> <tr><td>I - N. = 451059.78</td><td>E. = 660901.66</td></tr> <tr><td>J - N. = 453693.03</td><td>E. = 660870.74</td></tr> <tr><td>K - N. = 456341.71</td><td>E. = 660848.02</td></tr> <tr><td>L - N. = 459002.24</td><td>E. = 660831.98</td></tr> <tr><td>M - N. = 456335.75</td><td>E. = 658196.75</td></tr> </table> <p>LEGEND --- SECTION LINE --- QUARTER LINE --- LEASE LINE --- WELL PATH</p>	A - N. = 461665.81	E. = 660817.24	B - N. = 461654.17	E. = 658151.73	C - N. = 461642.89	E. = 655486.69	D - N. = 458986.32	E. = 655515.09	E - N. = 456329.76	E. = 655543.48	F - N. = 453684.45	E. = 655569.24	G - N. = 451030.14	E. = 655595.01	H - N. = 451042.47	E. = 658249.35	I - N. = 451059.78	E. = 660901.66	J - N. = 453693.03	E. = 660870.74	K - N. = 456341.71	E. = 660848.02	L - N. = 459002.24	E. = 660831.98	M - N. = 456335.75	E. = 658196.75	<p><b><sup>17</sup> OPERATOR CERTIFICATION</b> I hereby certify that the information contained herein is true and complete to the best of my knowledge and belief, and that this organization either owns a working interest or unleased mineral interest in the land including the proposed bottom hole location or has a right to drill this well at this location pursuant to a contract with an owner of such a mineral or working interest, or to a voluntary pooling agreement or a compulsory pooling order heretofore entered by the division.</p> <p>Signature _____ Date _____</p> <p>Printed Name _____</p> <p>E-mail Address _____</p> <p><b><sup>18</sup> SURVEYOR CERTIFICATION</b> I hereby certify that the well location shown on this plat was plotted from field notes of actual surveys made by me or under my supervision, and that the same is true and correct to the best of my belief.</p> <p>JUNE 20, 2023</p> <p>Date of Survey _____</p> <p>Signature and Seal of Professional Surveyor: </p> <p>Certificate Number: 12797 Survey No. 8843B</p>
A - N. = 461665.81	E. = 660817.24																											
B - N. = 461654.17	E. = 658151.73																											
C - N. = 461642.89	E. = 655486.69																											
D - N. = 458986.32	E. = 655515.09																											
E - N. = 456329.76	E. = 655543.48																											
F - N. = 453684.45	E. = 655569.24																											
G - N. = 451030.14	E. = 655595.01																											
H - N. = 451042.47	E. = 658249.35																											
I - N. = 451059.78	E. = 660901.66																											
J - N. = 453693.03	E. = 660870.74																											
K - N. = 456341.71	E. = 660848.02																											
L - N. = 459002.24	E. = 660831.98																											
M - N. = 456335.75	E. = 658196.75																											

EXHIBIT  
A-1

Intent ☐ As Drilled ☐

API #		
Operator Name: DEVON ENERGY PRODUCTION COMPANY, L.P.	Property Name: TATER TOT 2-35 FED COM	Well Number 622H

## Kick Off Point (KOP)

UL	Section	Township	Range	Lot	Feet	From N/S	Feet	From E/W	County
Latitude					Longitude				NAD

## First Take Point (FTP)

UL O	Section 2	Township 24S	Range 29E	Lot	Feet 100	From N/S SOUTH	Feet 2310	From E/W EAST	County EDDY
Latitude 32.2397035					Longitude 103.9540928				NAD 83

## Last Take Point (LTP)

UL G	Section 35	Township 23S	Range 29E	Lot	Feet 1430	From N/S NORTH	Feet 2310	From E/W EAST	County EDDY
Latitude 32.2646662					Longitude 103.9542328				NAD 83

Is this well the defining well for the Horizontal Spacing Unit? ☐Is this well an infill well? ☐

If infill is yes please provide API if available, Operator Name and well number for Defining well for Horizontal Spacing Unit.

API #		
Operator Name:	Property Name:	Well Number

KZ 06/29/2018

District I  
1625 N. French Dr., Hobbs, NM 88240  
Phone: (575) 393-6161 Fax: (575) 393-0720  
District II  
811 S. First St., Artesia, NM 88210  
Phone: (575) 748-1283 Fax: (575) 748-9720  
District III  
1000 Rio Brazos Road, Aztec, NM 87410  
Phone: (505) 334-6178 Fax: (505) 334-6170  
District IV  
1220 S. St. Francis Dr., Santa Fe, NM 87505  
Phone: (505) 476-3460 Fax: (505) 476-3462

State of New Mexico  
Energy, Minerals & Natural Resources Department  
OIL CONSERVATION DIVISION  
1220 South St. Francis Dr.  
Santa Fe, NM 87505

Form C-102  
Revised August 1, 2011  
Submit one copy to appropriate  
District Office

☐ AMENDED REPORT

WELL LOCATION AND ACREAGE DEDICATION PLAT

<sup>1</sup> API Number	<sup>2</sup> Pool Code 98220	<sup>3</sup> Pool Name PURPLE SAGE; WOLFCAMP (GAS)
<sup>4</sup> Property Code	<sup>5</sup> Property Name TATER TOT 2-35 FED COM	<sup>6</sup> Well Number 624H
<sup>7</sup> OGRID No. 6137	<sup>8</sup> Operator Name DEVON ENERGY PRODUCTION COMPANY, L.P.	<sup>9</sup> Elevation 3072.4

<sup>10</sup> Surface Location

UL or lot no.	Section	Township	Range	Lot Idn	Feet from the	North/South line	Feet from the	East/West line	County
P	2	24 S	29 E		240	SOUTH	785	EAST	EDDY

<sup>11</sup> Bottom Hole Location If Different From Surface

UL or lot no.	Section	Township	Range	Lot Idn	Feet from the	North/South line	Feet from the	East/West line	County
A	35	23 S	29 E		20	NORTH	600	EAST	EDDY
<sup>12</sup> Dedicated Acres 599.2	<sup>13</sup> Joint or Infill	<sup>14</sup> Consolidation Code	<sup>15</sup> Order No.						

No allowable will be assigned to this completion until all interests have been consolidated or a non-standard unit has been approved by the division.

	<p><b>TATER TOT 2-35 FED COM 624H</b> EL. = 3072.4</p> <p>GEODETIC COORDINATES NAD 83 NMSP EAST SURFACE LOCATION N. = 451294.65 E. = 660114.00 LAT. = 32.2401009°N LONG. = 103.9491654°W</p> <p>KICK OFF POINT CALLS _____ N. = _____ E. = _____ LAT. = _____ LONG. = _____</p> <p>FIRST TAKE POINT (PPP 1) 100' FSL, 600' FEL N. = 451155.84 E. = 660300.62 LAT. = 32.2397175°N LONG. = 103.9485634°W</p> <p>LAST TAKE POINT 100' FNL, 600' FEL N. = 461563.21 E. = 660217.93 LAT. = 32.2683264°N LONG. = 103.9487102°W</p> <p>BOTTOM OF HOLE 20' FNL, 600' FEL N. = 461643.19 E. = 660217.48 LAT. = 32.2685463°N LONG. = 103.9487107°W</p> <p>PPP 2 0' FSL, 589' FEL N. = 456340.38 E. = 660259.43 LAT. = 32.2539693°N LONG. = 103.9486365°W</p> <p>PPP 3 2661' FSL, 594' FEL N. = 459000.46 E. = 660238.30 LAT. = 32.2612816°N LONG. = 103.9486740°W</p> <p>PPP 4 1332' FNL, 597' FEL N. = 460331.84 E. = 660227.71 LAT. = 32.2649415°N LONG. = 103.9486929°W</p> <p>CORNER COORDINATES TABLE NAD 83 NMSP EAST</p> <table border="1"> <tr><td>A</td><td>N. = 461665.81</td><td>E. = 660817.24</td></tr> <tr><td>B</td><td>N. = 461654.17</td><td>E. = 658151.73</td></tr> <tr><td>C</td><td>N. = 461642.89</td><td>E. = 655486.69</td></tr> <tr><td>D</td><td>N. = 458986.32</td><td>E. = 655515.09</td></tr> <tr><td>E</td><td>N. = 456329.76</td><td>E. = 655543.48</td></tr> <tr><td>F</td><td>N. = 453684.45</td><td>E. = 655569.24</td></tr> <tr><td>G</td><td>N. = 451030.14</td><td>E. = 655595.01</td></tr> <tr><td>H</td><td>N. = 451042.47</td><td>E. = 658249.35</td></tr> <tr><td>I</td><td>N. = 451059.78</td><td>E. = 660901.66</td></tr> <tr><td>J</td><td>N. = 453693.03</td><td>E. = 660870.74</td></tr> <tr><td>K</td><td>N. = 456341.71</td><td>E. = 660848.02</td></tr> <tr><td>L</td><td>N. = 459002.24</td><td>E. = 660831.98</td></tr> <tr><td>M</td><td>N. = 456335.75</td><td>E. = 658196.75</td></tr> </table> <p>LEGEND --- SECTION LINE --- QUARTER LINE --- LEASE LINE --- WELL PATH</p>	A	N. = 461665.81	E. = 660817.24	B	N. = 461654.17	E. = 658151.73	C	N. = 461642.89	E. = 655486.69	D	N. = 458986.32	E. = 655515.09	E	N. = 456329.76	E. = 655543.48	F	N. = 453684.45	E. = 655569.24	G	N. = 451030.14	E. = 655595.01	H	N. = 451042.47	E. = 658249.35	I	N. = 451059.78	E. = 660901.66	J	N. = 453693.03	E. = 660870.74	K	N. = 456341.71	E. = 660848.02	L	N. = 459002.24	E. = 660831.98	M	N. = 456335.75	E. = 658196.75	<p><b><sup>17</sup> OPERATOR CERTIFICATION</b></p> <p>I hereby certify that the information contained herein is true and complete to the best of my knowledge and belief, and that this organization either owns a working interest or unleased mineral interest in the land including the proposed bottom hole location or has a right to drill this well at this location pursuant to a contract with an owner of such a mineral or working interest, or to a voluntary pooling agreement or a compulsory pooling order heretofore entered by the division.</p> <p>Signature _____ Date _____</p> <p>Printed Name _____</p> <p>E-mail Address _____</p> <p><b><sup>18</sup> SURVEYOR CERTIFICATION</b></p> <p>I hereby certify that the well location shown on this plat was plotted from field notes of actual surveys made by me or under my supervision, and that the same is true and correct to the best of my belief.</p> <p>JUNE 9, 2023</p> <p>Date of Survey _____</p> <p>Signature and Seal of Professional Surveyor: </p> <p>Certificate Number: 12797 SURVEY NO. 6307G</p>
A	N. = 461665.81	E. = 660817.24																																							
B	N. = 461654.17	E. = 658151.73																																							
C	N. = 461642.89	E. = 655486.69																																							
D	N. = 458986.32	E. = 655515.09																																							
E	N. = 456329.76	E. = 655543.48																																							
F	N. = 453684.45	E. = 655569.24																																							
G	N. = 451030.14	E. = 655595.01																																							
H	N. = 451042.47	E. = 658249.35																																							
I	N. = 451059.78	E. = 660901.66																																							
J	N. = 453693.03	E. = 660870.74																																							
K	N. = 456341.71	E. = 660848.02																																							
L	N. = 459002.24	E. = 660831.98																																							
M	N. = 456335.75	E. = 658196.75																																							

Intent ☐ As Drilled ☐

API #		
Operator Name: DEVON ENERGY PRODUCTION COMPANY, L.P.	Property Name: TATER TOT 2-35 FED COM	Well Number 624H

Kick Off Point (KOP)

UL	Section	Township	Range	Lot	Feet	From N/S	Feet	From E/W	County
Latitude					Longitude				NAD

First Take Point (FTP)

UL P	Section 2	Township 24S	Range 29E	Lot	Feet 100	From N/S SOUTH	Feet 600	From E/W EAST	County EDDY
Latitude 32.2397175					Longitude 103.9485634				NAD 83

Last Take Point (LTP)

UL A	Section 35	Township 23S	Range 29E	Lot	Feet 100	From N/S NORTH	Feet 600	From E/W EAST	County EDDY
Latitude 32.2683264					Longitude 103.9487102				NAD 83

Is this well the defining well for the Horizontal Spacing Unit? ☐Is this well an infill well? ☐

If infill is yes please provide API if available, Operator Name and well number for Defining well for Horizontal Spacing Unit.

API #		
Operator Name:	Property Name:	Well Number

KZ 06/29/2018

District I  
1625 N. French Dr., Hobbs, NM 88240  
Phone: (575) 393-6161 Fax: (575) 393-0720  
District II  
811 S. First St., Artesia, NM 88210  
Phone: (575) 748-1283 Fax: (575) 748-9720  
District III  
1000 Rio Brazos Road, Aztec, NM 87410  
Phone: (505) 334-6178 Fax: (505) 334-6170  
District IV  
1220 S. St. Francis Dr., Santa Fe, NM 87505  
Phone: (505) 476-3460 Fax: (505) 476-3462

State of New Mexico  
Energy, Minerals & Natural Resources Department  
OIL CONSERVATION DIVISION  
1220 South St. Francis Dr.  
Santa Fe, NM 87505

Form C-102  
Revised August 1, 2011  
Submit one copy to appropriate  
District Office

☐ AMENDED REPORT

WELL LOCATION AND ACREAGE DEDICATION PLAT

<sup>1</sup> API Number	<sup>2</sup> Pool Code 98220	<sup>3</sup> Pool Name PURPLE SAGE; WOLFCAMP (GAS)
<sup>4</sup> Property Code	<sup>5</sup> Property Name TATER TOT 2-35 FED COM	<sup>6</sup> Well Number 713H
<sup>7</sup> OGRID No. 6137	<sup>8</sup> Operator Name DEVON ENERGY PRODUCTION COMPANY, L.P.	<sup>9</sup> Elevation 3072.6

<sup>10</sup> Surface Location

UL or lot no.	Section	Township	Range	Lot Idn	Feet from the	North/South line	Feet from the	East/West line	County
P	2	24 S	29 E		240	SOUTH	815	EAST	EDDY

<sup>11</sup> Bottom Hole Location If Different From Surface

UL or lot no.	Section	Township	Range	Lot Idn	Feet from the	North/South line	Feet from the	East/West line	County
A	35	23 S	29 E		20	NORTH	1170	EAST	EDDY
<sup>12</sup> Dedicated Acres 599.2	<sup>13</sup> Joint or Infill	<sup>14</sup> Consolidation Code	<sup>15</sup> Order No.						

No allowable will be assigned to this completion until all interests have been consolidated or a non-standard unit has been approved by the division.

	<p><b>TATER TOT 2-35 FED COM 713H</b> EL. = 3072.6</p> <p>GEODETIC COORDINATES NAD 83 NMSP EAST SURFACE LOCATION N. = 451294.38 E. = 660084.01 LAT. = 32.2401004°N LONG. = 103.9492623°W</p> <p>KICK OFF POINT CALLS _____ N. = _____ E. = _____ LAT. = _____ LONG. = _____</p> <p>FIRST TAKE POINT (PPP 1) 100' FSL, 1170' FEL N. = 451152.12 E. = 659730.76 LAT. = 32.2397129°N LONG. = 103.9504065°W</p> <p>LAST TAKE POINT 100' FNL, 1170' FEL N. = 461560.72 E. = 659648.06 LAT. = 32.2683252°N LONG. = 103.9505540°W</p> <p>BOTTOM OF HOLE 20' FNL, 1170' FEL N. = 461640.70 E. = 659647.62 LAT. = 32.2685450°N LONG. = 103.9505545°W</p> <p>PPP 2 0' FSL, 1159' FEL N. = 456339.10 E. = 659689.55 LAT. = 32.2539714°N LONG. = 103.9504800°W</p> <p>PPP 3 2660' FSL, 1164' FEL N. = 458998.75 E. = 659668.41 LAT. = 32.2612825°N LONG. = 103.9505177°W</p> <p>PPP 4 1331' FNL, 1167' FEL N. = 460329.76 E. = 659657.84 LAT. = 32.2649414°N LONG. = 103.9505365°W</p> <p>CORNER COORDINATES TABLE NAD 83 NMSP EAST</p> <table border="1"> <tr><td>A - N. = 461665.81</td><td>E. = 660817.24</td></tr> <tr><td>B - N. = 461654.17</td><td>E. = 658151.73</td></tr> <tr><td>C - N. = 461642.89</td><td>E. = 655486.69</td></tr> <tr><td>D - N. = 458986.32</td><td>E. = 655515.09</td></tr> <tr><td>E - N. = 456329.76</td><td>E. = 655543.48</td></tr> <tr><td>F - N. = 453684.45</td><td>E. = 655569.24</td></tr> <tr><td>G - N. = 451030.14</td><td>E. = 655595.01</td></tr> <tr><td>H - N. = 451042.47</td><td>E. = 658249.35</td></tr> <tr><td>I - N. = 451059.78</td><td>E. = 660901.66</td></tr> <tr><td>J - N. = 453693.03</td><td>E. = 660870.74</td></tr> <tr><td>K - N. = 456341.71</td><td>E. = 660848.02</td></tr> <tr><td>L - N. = 459002.24</td><td>E. = 660831.98</td></tr> <tr><td>M - N. = 456335.75</td><td>E. = 658196.75</td></tr> </table> <p>LEGEND --- SECTION LINE --- QUARTER LINE --- LEASE LINE --- WELL PATH</p>	A - N. = 461665.81	E. = 660817.24	B - N. = 461654.17	E. = 658151.73	C - N. = 461642.89	E. = 655486.69	D - N. = 458986.32	E. = 655515.09	E - N. = 456329.76	E. = 655543.48	F - N. = 453684.45	E. = 655569.24	G - N. = 451030.14	E. = 655595.01	H - N. = 451042.47	E. = 658249.35	I - N. = 451059.78	E. = 660901.66	J - N. = 453693.03	E. = 660870.74	K - N. = 456341.71	E. = 660848.02	L - N. = 459002.24	E. = 660831.98	M - N. = 456335.75	E. = 658196.75	<p><b><sup>17</sup> OPERATOR CERTIFICATION</b></p> <p>I hereby certify that the information contained herein is true and complete to the best of my knowledge and belief, and that this organization either owns a working interest or unleased mineral interest in the land including the proposed bottom hole location or has a right to drill this well at this location pursuant to a contract with an owner of such a mineral or working interest, or to a voluntary pooling agreement or a compulsory pooling order heretofore entered by the division.</p> <p>Signature _____ Date _____</p> <p>Printed Name _____</p> <p>E-mail Address _____</p> <p><b><sup>18</sup> SURVEYOR CERTIFICATION</b></p> <p>I hereby certify that the well location shown on this plat was plotted from field notes of actual surveys made by me or under my supervision, and that the same is true and correct to the best of my belief.</p> <p>JUNE 9, 2023</p> <p>Date of Survey _____</p> <p>Signature and Seal of Professional Surveyor: </p> <p>Certificate Number: 12797 Survey No. 8964B</p>
A - N. = 461665.81	E. = 660817.24																											
B - N. = 461654.17	E. = 658151.73																											
C - N. = 461642.89	E. = 655486.69																											
D - N. = 458986.32	E. = 655515.09																											
E - N. = 456329.76	E. = 655543.48																											
F - N. = 453684.45	E. = 655569.24																											
G - N. = 451030.14	E. = 655595.01																											
H - N. = 451042.47	E. = 658249.35																											
I - N. = 451059.78	E. = 660901.66																											
J - N. = 453693.03	E. = 660870.74																											
K - N. = 456341.71	E. = 660848.02																											
L - N. = 459002.24	E. = 660831.98																											
M - N. = 456335.75	E. = 658196.75																											



Intent ☐ As Drilled ☐

API #		
Operator Name: DEVON ENERGY PRODUCTION COMPANY, L.P.	Property Name: TATER TOT 2-35 FED COM	Well Number 713H

## Kick Off Point (KOP)

UL	Section	Township	Range	Lot	Feet	From N/S	Feet	From E/W	County
Latitude					Longitude				NAD

## First Take Point (FTP)

UL P	Section 2	Township 24S	Range 29E	Lot	Feet 100	From N/S SOUTH	Feet 1170	From E/W EAST	County EDDY
Latitude 32.2397129					Longitude 103.9504065				NAD 83

## Last Take Point (LTP)

UL A	Section 35	Township 23S	Range 29E	Lot	Feet 100	From N/S NORTH	Feet 1170	From E/W EAST	County EDDY
Latitude 32.2683252					Longitude 103.9505540				NAD 83

Is this well the defining well for the Horizontal Spacing Unit? ☐Is this well an infill well? ☐

If infill is yes please provide API if available, Operator Name and well number for Defining well for Horizontal Spacing Unit.

API #		
Operator Name:	Property Name:	Well Number

KZ 06/29/2018



**OWNERSHIP BREAKDOWN**  
**Tater Tot 2-35 Fed Com 622H, 624H, & 713H**

E/2NE/4, SW/4NE/4, SE/4 of Section 35, T23S-R29E &  
Lots 1, 2, S/2NE/4, and SE/4 of Section 2, T24S-R29E  
Eddy County, New Mexico,  
Wolfcamp Formation

Section 35			
Section 2			

**Tract 1:**  
V0-0440-3  
(319.2 acres)



**Tract 2:**  
NMNM 103604  
(200 acres)



**Tract 3:**  
NMNM 124616  
(80 acres)



**TRACT 1 OWNERSHIP (E/2 of Section 2, being 319.2 acres):**

<b>Owner</b>	<b>Net Acres</b>	<b>Tract WI</b>	<b>Status</b>
Devon Energy Production Company, L.P. 333 W. Sheridan Avenue Oklahoma City, OK 73102	252.60	.79136023	Committed
OXY USA Inc. 5 Greenway Plaza, Suite 110 Houston, TX 77046	66.60	.20863977	Uncommitted
<b>Total:</b>	<b>319.2</b>	<b>1.00</b>	

**TRACT 2 OWNERSHIP (SE/4, NE/4NE/4 of Section 35, being 200 acres):**

<b>Owner</b>	<b>Net Acres</b>	<b>Tract WI</b>	<b>Status</b>
Devon Energy Production Company, L.P. 333 W. Sheridan Avenue Oklahoma City, OK 73102	176.20	.880975	Committed
Allar Development LLC P.O.Box 1567 Graham, TX 76450	23.00	.11500	Committed
Highland (Texas) Energy Company Inc. 11886 Greenville Ave., Suite 106 Dallas, TX 75243	0.80	.004025	Committed
<b>Total:</b>	<b>200.00</b>	<b>1.00</b>	

**TRACT 3 OWNERSHIP (S/2NE/4 of Section 35, being 80 acres):**

<b>Owner</b>	<b>Net Acres</b>	<b>Tract WI</b>	<b>Status</b>
Devon Energy Production Company, L.P. 333 W. Sheridan Avenue Oklahoma City, OK 73102	80.00	1.00000	Committed
<b>Total:</b>	<b>80.00</b>	<b>1.00</b>	

**Overriding Royalty Interest seeking to Compulsory Pool:**

**ORRI Owners (Tract 1)**

Tap Rock Minerals, LP

**ORRI Owners (Tract 2)**

Cornerstone Family Trust  
LJA Charitable Investments, LLC  
The Allar Company  
Strategic Energy Company Fund IV, LP  
LaNell Joy Honeyman, SSP  
Leslie Robert Honeyman Trust, Joy Honeyman, Trustee

**ORRI Owners (Tract 3)**

None

**Record Title Owners**

Devon Energy Production Company L.P.  
Echo Production Inc.

**Unit Recapitulation-Wolfcamp-599.2 AC HSU**  
**E/2NE/4, SW/4NE/4, SE/4 of Section 35, T23S-R29E &**  
**Lots 1, 2, S/2NE/4, and SE/4 of Section 2, T24S-R29E**  
**Eddy County, New Mexico, Wolfcamp Formation**

Owner	Interest
Devon Energy Production Company, L.P.	84.9127479%
Allar Development LLC	3.8384513%
Highland (Texas) Energy Company, Inc.	0.1343458%
OXY USA Inc.	11.114455%
<b>TOTAL</b>	<b>100.0000000%</b>
Uncommitted Working Interest Owners seeking to Compulsory Pool	

**Pooling List Recapitulation: Full List of Uncommitted Parties/Persons to be Pooled:**

OXY U.S.A. Inc.	WI
Echo Production Inc.	RT
Tap Rock Minerals, LP	ORRI
Cornerstone Family Trust	ORRI
LJA Charitable Investments, LLC	ORRI
The Allar Company	ORRI
Strategic Energy Company Fund IV, LP	ORRI
LaNell Joy Honeyman, SSP	ORRI
Leslie Robert Honeyman Trust, Joy Honeyman, Trustee	ORRI



Devon Energy Corporation  
333 W. Sheridan Avenue  
Oklahoma City, OK 73102

405 235 3611 Phone  
www.devonenergy.com

June 13, 2023

**Sent via Priority Mail**

Working Interest Owners  
Listed on Attached Exhibit "A"

RE: Tater Tot 2-35 State Fed Com 624H, 622H and 713H  
Sections 2-24S-29E & 35-23S-29E  
Eddy County, New Mexico

Dear Working Interest Owner,

Devon Energy Production Company, L.P. ("Devon"), as Operator, proposes to drill, complete, and equip the following horizontal wells in the Wolfcamp formation:

- Tater Tot 2-35 State Fed Com 624H as a horizontal well to an approximate landing TVD of 10,390', bottom hole TVD of 10,345', and approximate TMD of 20,345' into the Wolfcamp formation at an approximate SHL of 240' FSL & 785' FEL of Section 2-24S-29E, or at a legal location in Unit P, and an approximate BHL of 20' FNL & 600' FEL of Section 35-23S-29E, or at a legal location in Unit A, Eddy County, New Mexico (collectively with all three proposed wells, the "Wells"). Enclosed for your review is Devon's Authority for Expenditure indicating drilling costs of \$4,048,013.31 and total completed well costs of \$9,909,603.61.
- Tater Tot 2-35 State Fed Com 622H as a horizontal well to an approximate landing TVD of 10,328', bottom hole TVD of 10,250', and approximate TMD of 18,750' into the Wolfcamp formation at an approximate SHL of 200' FSL & 2065' FEL of Section 2-24S-29E, or at a legal location in Unit O, and an approximate BHL of 1340' FNL & 2310' FEL of Section 35-23S-29E, or at a legal location in Unit G, Eddy County, New Mexico (collectively with all three proposed wells, the "Wells"). Enclosed for your review is Devon's Authority for Expenditure indicating drilling costs of \$3,917,280.27 and total completed well costs of \$9,778,870.57.
- Tater Tot 2-35 State Fed Com 713H as a horizontal well to an approximate landing TVD of 10,563', bottom hole TVD of 10,569', and approximate TMD of 20,569' into the Wolfcamp formation at an approximate SHL of 240' FSL & 815' FEL of Section 2-24S-29E, or at a legal location in Unit P, and an approximate BHL of 20' FNL & 1170' FEL of Section 35-23S-29E, or at a legal location in Unit A, Eddy County, New Mexico (collectively with all three proposed wells, the "Wells"). Enclosed for your review is Devon's Authority for Expenditure indicating drilling costs of \$4,441,795.41 and total completed well costs of \$10,303,385.71.

Devon reserves the right to modify the locations and drilling plans described above to address surface and subsurface concerns. Devon will advise of any such modifications.

EXHIBIT  
**A-3**

Tater Tot 2-35 State Fed Com 624H, 622H and 713H

June 13, 2023

Page No. 2

Devon is proposing to drill the Wells under the terms of the modified 2015 AAPL form of Operating Agreement ("JOA") which contains the following general provisions:

- Devon named as Operator
- Contract Area: All of Sections 2-24S-29E & 35-23S-29E
- 100% / 300% Non-Consenting Penalty
- \$8000/\$800 Drilling and Producing Overhead Rates

If you wish to participate in the operation, please indicate in the space provided below, along with a signed AFE, and deliver to my attention at the letterhead address or by email at [aaron.young@devon.com](mailto:aaron.young@devon.com), and Devon will provide the completed JOA for your review. If your election is to participate, a cash call invoice will be sent following receipt of a timely election.

If you do not wish to participate in the proposed operation, Devon would like to negotiate a voluntary agreement that includes your interest.

If an agreement is not reached within 30 days of the date of this letter, Devon will apply to the New Mexico Oil Conservation Division for compulsory pooling of your interest into a spacing unit for the proposed wells.

Sincerely,

DEVON ENERGY PRODUCTION COMPANY, L.P.

A handwritten signature in blue ink, appearing to read 'A. Young', is written over a faint, light blue rectangular background.

Aaron Young  
Sr. Staff Landman

Tater Tot 2-35 State Fed Com 624H, 622H and 713H

June 13, 2023

Page No. 3

Tater Tot 2-35 State Fed Com 624H

\_\_\_\_\_ I/we elect to participate in the drilling and completion of the Tater Tot 2-35 State Fed Com 624H well. A signed AFE is returned herewith.

\_\_\_\_\_ I/we elect not to participate in the drilling and completion of the Tater Tot 2-35 State Fed Com 624H well.

Tater Tot 2-35 State Fed Com 622H

\_\_\_\_\_ I/we elect to participate in the drilling and completion of the Tater Tot 2-35 State Fed Com 622H well. A signed AFE is returned herewith.

\_\_\_\_\_ I/we elect not to participate in the drilling and completion of the Tater Tot 2-35 State Fed Com 622H well.

Tater Tot 2-35 State Fed Com 713H

\_\_\_\_\_ I/we elect to participate in the drilling and completion of the Tater Tot 2-35 State Fed Com 713H well. A signed AFE is returned herewith.

\_\_\_\_\_ I/we elect not to participate in the drilling and completion of the Tater Tot 2-35 State Fed Com 713H well.

Company / Individual: \_\_\_\_\_

By: \_\_\_\_\_

Name: \_\_\_\_\_

Title: \_\_\_\_\_

Date: \_\_\_\_\_

Exhibit "A"  
Working Interest Owners

OXY USA Inc.  
Occidental Petroleum  
5 Greenway Plaza, Suite 110  
Houston, Texas 77046

THE ALLAR COMPANY  
P.O. Box 1567  
Graham, Texas 76450

ALLAR DEVELOPMENT LLC  
P.O. Box 1567  
Graham, Texas 76450

Highland (Texas) Energy Company  
11886 Greenville Avenue, Suite 106  
Dallas, Texas 75243





## Authorization for Expenditure

AFE # XX-132974.01

Well Name: TATER TOT 2-35 STATE FED COM 624H

AFE Date: 5/30/2023

Cost Center Number: 1093995601

State: NM

Legal Description: SEC 2-24S-29E

County/Parish: EDDY

Revision: ☐

Explanation and Justification:

DRILL AND COMPLETE

Code	Intangible Description	Drilling Costs	Completion Costs	Dry Hole Costs	Total Costs
6040110	CHEMICALS - OTHER	0.00	142,710.00	0.00	142,710.00
6060100	DYED LIQUID FUELS	110,016.54	369,245.00	0.00	479,261.54
6060130	GASEOUS FUELS	0.00	131,437.00	0.00	131,437.00
6080100	DISPOSAL - SOLIDS	108,051.96	5,328.00	0.00	113,379.96
6080110	DISP-SALTWATER & OTH	0.00	13,587.00	0.00	13,587.00
6080115	DISP VIA PIPELINE SW	0.00	106,500.00	0.00	106,500.00
6090100	FLUIDS - WATER	22,756.40	15,794.00	0.00	38,550.40
6090120	RECYC TREAT&PROC-H2O	0.00	296,218.00	0.00	296,218.00
6100100	PERMIT SURVEY&TITLE	10,000.00	0.00	0.00	10,000.00
6100110	RIGHT OF WAY	4,500.00	0.00	0.00	4,500.00
6110120	ROAD&SITE PREP M&S	26,166.67	0.00	0.00	26,166.67
6110130	ROAD&SITE PREP SVC	52,333.33	40,648.00	0.00	92,981.33
6120100	I & C SERVICES	0.00	88,588.75	0.00	88,588.75
6130170	COMM SVCS - WAN	3,274.30	0.00	0.00	3,274.30
6130360	RTOC - ENGINEERING	0.00	4,320.00	0.00	4,320.00
6130370	RTOC - GEOSTEERING	9,004.33	0.00	0.00	9,004.33
6140160	ENV-SERVICES	1,000.00	0.00	0.00	1,000.00
6150100	CH LOG PERFRTG&WL SV	0.00	289,190.00	0.00	289,190.00
6160100	MATERIALS & SUPPLIES	8,022.04	0.00	0.00	8,022.04
6170100	PULLING&SWABBING SVC	0.00	6,750.00	0.00	6,750.00
6170110	SNUBBG&COIL TUBG SVC	0.00	125,735.00	0.00	125,735.00
6190100	TRCKG&HL-SOLID&FLUID	81,366.40	0.00	0.00	81,366.40
6190110	TRUCKING&HAUL OF EQP	39,782.77	42,170.50	0.00	81,953.27
6200130	CONSLT & PROJECT SVC	107,724.53	86,403.00	0.00	194,127.53
6230120	SAFETY SERVICES	33,725.31	3,138.00	0.00	36,863.31
6300270	SOLIDS CONTROL SRVCS	63,194.03	0.00	0.00	63,194.03
6310120	STIMULATION SERVICES	0.00	1,218,952.00	0.00	1,218,952.00
6310190	PROPPANT PURCHASE	0.00	903,917.00	0.00	903,917.00
6310200	CASING & TUBULAR SVC	96,428.19	0.00	0.00	96,428.19
6310250	CEMENTING SERVICES	185,000.00	0.00	0.00	185,000.00
6310280	DAYWORK COSTS	569,450.00	0.00	0.00	569,450.00
6310300	DIRECTIONAL SERVICES	260,961.86	0.00	0.00	260,961.86
6310310	DRILL BITS	93,153.89	0.00	0.00	93,153.89
6310330	DRILL&COMP FLUID&SVC	283,554.54	16,836.00	0.00	300,390.54
6310370	MOB & DEMOBILIZATION	45,000.00	0.00	0.00	45,000.00
6310380	OPEN HOLE EVALUATION	21,282.96	0.00	0.00	21,282.96
6310480	TSNG-WELL, PL & OTH	0.00	134,557.00	0.00	134,557.00
6310600	MISC PUMPING SERVICE	0.00	52,108.00	0.00	52,108.00
6320100	EQPMNT SVC-SRF RNTL	138,339.25	227,272.00	0.00	365,611.25
6320110	EQUIP SVC - DOWNHOLE	77,600.95	35,043.00	0.00	112,643.95
6320160	WELDING SERVICES	2,292.01	0.00	0.00	2,292.01
6320190	WATER TRANSFER	0.00	49,883.00	0.00	49,883.00
6350100	CONSTRUCTION SVC	0.00	167,771.85	0.00	167,771.85
6520100	LEGAL FEES	1,000.00	0.00	0.00	1,000.00

Costs on this form are estimates only. Working Interest Owners should not consider these estimates



## Authorization for Expenditure

AFE # XX-132974.01

Well Name: TATER TOT 2-35 STATE FED COM 624H

AFE Date: 5/30/2023

Cost Center Number: 1093995601

State: NM

Legal Description: SEC 2-24S-29E

County/Parish: EDDY

Revision: ☐

Code	Intangible Description	Drilling Costs	Completion Costs	Dry Hole Costs	Total Costs
6550100	MISCS COSTS & SERVS	0.00	9,905.30	0.00	9,905.30
6550110	MISCELLANEOUS SVC	34,216.45	0.00	0.00	34,216.45
6550120	OTHER ROUSTABOUT SER	0.00	5,000.00	0.00	5,000.00
6630110	CAPITAL OVERHEAD	9,168.05	41,055.53	0.00	50,223.58
6740340	TAXES OTHER	0.00	32,088.36	0.00	32,088.36
	Total Intangibles	2,498,366.76	4,662,151.29	0.00	7,160,518.05

Code	Tangible Description	Drilling Costs	Completion Costs	Dry Hole Costs	Total Costs
6120110	I&C EQUIPMENT	0.00	114,201.43	0.00	114,201.43
6120120	MEASUREMENT EQUIP	0.00	27,876.98	0.00	27,876.98
6150110	LOG PERFORATG&WL EQP	0.00	11,250.00	0.00	11,250.00
6300150	SEPARATOR EQUIPMENT	0.00	328,268.70	0.00	328,268.70
6300220	STORAGE VESSEL&TANKS	0.00	64,610.00	0.00	64,610.00
6300230	PUMPS - SURFACE	0.00	10,561.25	0.00	10,561.25
6310130	ARTIFICIAL LIFT EQP	0.00	30,000.00	0.00	30,000.00
6310150	CASG-COND&DRIVE PIPE	25,000.00	0.00	0.00	25,000.00
6310420	TUBING & COMPONENTS	0.00	130,918.00	0.00	130,918.00
6310460	WELLHEAD EQUIPMENT	38,000.00	169,180.00	0.00	207,180.00
6310530	SURFACE CASING	26,735.00	0.00	0.00	26,735.00
6310540	INTERMEDIATE CASING	610,523.12	0.00	0.00	610,523.12
6310550	PRODUCTION CASING	820,902.00	0.00	0.00	820,902.00
6310580	CASING COMPONENTS	28,486.43	0.00	0.00	28,486.43
6330100	PIPE,FIT,FLANG,CPLNG	0.00	312,572.65	0.00	312,572.65
	Total Tangibles	1,549,646.55	1,199,439.01	0.00	2,749,085.56

TOTAL ESTIMATED COST	4,048,013.31	5,861,590.30	0.00	9,909,603.61
----------------------	--------------	--------------	------	--------------

### WORKING INTEREST OWNER APPROVAL

Company Name:

Signature:

Print Name:

Title:

Date:

Email:

Note: Please include/attach well requirement data with ballot.

Costs on this form are estimates only. Working Interest Owners should not consider these estimates the monies which will be required to perform the proposed operation.



## Authorization for Expenditure

AFE # XX-126528.01

Well Name: TATER TOT 2-35 STATE FED COM 622H

AFE Date: 5/30/2023

Cost Center Number: 1093827401

State: NM

Legal Description: SEC 2-24S-29E

County/Parish: EDDY

Revision: ☐

Explanation and Justification:

DRILL AND COMPLETE

Code	Intangible Description	Drilling Costs	Completion Costs	Dry Hole Costs	Total Costs
6040110	CHEMICALS - OTHER	0.00	142,710.00	0.00	142,710.00
6060100	DYED LIQUID FUELS	105,762.34	369,245.00	0.00	475,007.34
6060130	GASEOUS FUELS	0.00	131,437.00	0.00	131,437.00
6080100	DISPOSAL - SOLIDS	103,873.72	5,328.00	0.00	109,201.72
6080110	DISP-SALTWATER & OTH	0.00	13,587.00	0.00	13,587.00
6080115	DISP VIA PIPELINE SW	0.00	106,500.00	0.00	106,500.00
6090100	FLUIDS - WATER	21,876.44	15,794.00	0.00	37,670.44
6090120	RECYC TREAT&PROC-H2O	0.00	296,218.00	0.00	296,218.00
6100100	PERMIT SURVEY&TITLE	10,000.00	0.00	0.00	10,000.00
6100110	RIGHT OF WAY	4,500.00	0.00	0.00	4,500.00
6110120	ROAD&SITE PREP M&S	26,166.67	0.00	0.00	26,166.67
6110130	ROAD&SITE PREP SVC	52,333.33	40,648.00	0.00	92,981.33
6120100	I & C SERVICES	0.00	88,588.75	0.00	88,588.75
6130170	COMM SVCS - WAN	3,147.69	0.00	0.00	3,147.69
6130360	RTOC - ENGINEERING	0.00	4,320.00	0.00	4,320.00
6130370	RTOC - GEOSTEERING	8,656.14	0.00	0.00	8,656.14
6140160	ENV-SERVICES	1,000.00	0.00	0.00	1,000.00
6150100	CH LOG PERFRTG&WL SV	0.00	289,190.00	0.00	289,190.00
6160100	MATERIALS & SUPPLIES	7,711.84	0.00	0.00	7,711.84
6170100	PULLING&SWABBING SVC	0.00	6,750.00	0.00	6,750.00
6170110	SNUBBG&COIL TUBG SVC	0.00	125,735.00	0.00	125,735.00
6190100	TRCKG&HL-SOLID&FLUID	78,220.06	0.00	0.00	78,220.06
6190110	TRUCKING&HAUL OF EQP	38,244.42	42,170.50	0.00	80,414.92
6200130	CONSLT & PROJECT SVC	103,558.95	86,403.00	0.00	189,961.95
6230120	SAFETY SERVICES	32,421.19	3,138.00	0.00	35,559.19
6300270	SOLIDS CONTROL SRVCS	60,750.39	0.00	0.00	60,750.39
6310120	STIMULATION SERVICES	0.00	1,218,952.00	0.00	1,218,952.00
6310190	PROPPANT PURCHASE	0.00	903,917.00	0.00	903,917.00
6310200	CASING & TUBULAR SVC	92,699.43	0.00	0.00	92,699.43
6310250	CEMENTING SERVICES	185,000.00	0.00	0.00	185,000.00
6310280	DAYWORK COSTS	559,650.00	0.00	0.00	559,650.00
6310300	DIRECTIONAL SERVICES	250,870.78	0.00	0.00	250,870.78
6310310	DRILL BITS	89,551.74	0.00	0.00	89,551.74
6310330	DRILL&COMP FLUID&SVC	272,589.83	16,836.00	0.00	289,425.83
6310370	MOB & DEMOBILIZATION	45,000.00	0.00	0.00	45,000.00
6310380	OPEN HOLE EVALUATION	20,459.98	0.00	0.00	20,459.98
6310480	TSNG-WELL, PL & OTH	0.00	134,557.00	0.00	134,557.00
6310600	MISC PUMPING SERVICE	0.00	52,108.00	0.00	52,108.00
6320100	EQPMNT SVC-SRF RNTL	132,989.84	227,272.00	0.00	360,261.84
6320110	EQUIP SVC - DOWNHOLE	74,600.22	35,043.00	0.00	109,643.22
6320160	WELDING SERVICES	2,203.38	0.00	0.00	2,203.38
6320190	WATER TRANSFER	0.00	49,883.00	0.00	49,883.00
6350100	CONSTRUCTION SVC	0.00	167,771.85	0.00	167,771.85
6520100	LEGAL FEES	1,000.00	0.00	0.00	1,000.00

Costs on this form are estimates only. Working Interest Owners should not consider these estimates



## Authorization for Expenditure

AFE # XX-126528.01

Well Name: TATER TOT 2-35 STATE FED COM 622H

AFE Date: 5/30/2023

Cost Center Number: 1093827401

State: NM

Legal Description: SEC 2-24S-29E

County/Parish: EDDY

Revision: ☐

Code	Intangible Description	Drilling Costs	Completion Costs	Dry Hole Costs	Total Costs
6550100	MISCS COSTS & SERVS	0.00	9,905.30	0.00	9,905.30
6550110	MISCELLANEOUS SVC	32,893.35	0.00	0.00	32,893.35
6550120	OTHER ROUSTABOUT SER	0.00	5,000.00	0.00	5,000.00
6630110	CAPITAL OVERHEAD	8,813.53	41,055.53	0.00	49,869.06
6740340	TAXES OTHER	0.00	32,088.36	0.00	32,088.36
	Total Intangibles	2,426,545.26	4,662,151.29	0.00	7,088,696.55

Code	Tangible Description	Drilling Costs	Completion Costs	Dry Hole Costs	Total Costs
6120110	I&C EQUIPMENT	0.00	114,201.43	0.00	114,201.43
6120120	MEASUREMENT EQUIP	0.00	27,876.98	0.00	27,876.98
6150110	LOG PERFORATG&WL EQP	0.00	11,250.00	0.00	11,250.00
6300150	SEPARATOR EQUIPMENT	0.00	328,268.70	0.00	328,268.70
6300220	STORAGE VESSEL&TANKS	0.00	64,610.00	0.00	64,610.00
6300230	PUMPS - SURFACE	0.00	10,561.25	0.00	10,561.25
6310130	ARTIFICIAL LIFT EQP	0.00	30,000.00	0.00	30,000.00
6310150	CASG-COND&DRIVE PIPE	25,000.00	0.00	0.00	25,000.00
6310420	TUBING & COMPONENTS	0.00	130,918.00	0.00	130,918.00
6310460	WELLHEAD EQUIPMENT	38,000.00	169,180.00	0.00	207,180.00
6310530	SURFACE CASING	26,735.00	0.00	0.00	26,735.00
6310540	INTERMEDIATE CASING	610,523.12	0.00	0.00	610,523.12
6310550	PRODUCTION CASING	763,092.00	0.00	0.00	763,092.00
6310580	CASING COMPONENTS	27,384.89	0.00	0.00	27,384.89
6330100	PIPE,FIT,FLANG,CPLNG	0.00	312,572.65	0.00	312,572.65
	Total Tangibles	1,490,735.01	1,199,439.01	0.00	2,690,174.02

TOTAL ESTIMATED COST	3,917,280.27	5,861,590.30	0.00	9,778,870.57
----------------------	--------------	--------------	------	--------------

### WORKING INTEREST OWNER APPROVAL

Company Name:

Signature:

Print Name:

Title:

Date:

Email:

Note: Please include/attach well requirement data with ballot.

Costs on this form are estimates only. Working Interest Owners should not consider these estimates



## Authorization for Expenditure

AFE # XX-145383.01

Well Name: TATER TOT 2-35 STATE FED COM 713H

AFE Date: 5/30/2023

Cost Center Number: 1094603301

State: NM

Legal Description: SEC 2-24S-29E

County/Parish: EDDY

Revision: ☐

Explanation and Justification:

DRILL AND COMPLETE

Code	Intangible Description	Drilling Costs	Completion Costs	Dry Hole Costs	Total Costs
6040110	CHEMICALS - OTHER	0.00	142,710.00	0.00	142,710.00
6060100	DYED LIQUID FUELS	124,863.43	369,245.00	0.00	494,108.43
6060130	GASEOUS FUELS	0.00	131,437.00	0.00	131,437.00
6080100	DISPOSAL - SOLIDS	122,633.73	5,328.00	0.00	127,961.73
6080110	DISP-SALTWATER & OTH	0.00	13,587.00	0.00	13,587.00
6080115	DISP VIA PIPELINE SW	0.00	106,500.00	0.00	106,500.00
6090100	FLUIDS - WATER	25,827.41	15,794.00	0.00	41,621.41
6090120	RECYC TREAT&PROC-H2O	0.00	296,218.00	0.00	296,218.00
6100100	PERMIT SURVEY&TITLE	10,000.00	0.00	0.00	10,000.00
6100110	RIGHT OF WAY	4,500.00	0.00	0.00	4,500.00
6110120	ROAD&SITE PREP M&S	26,166.67	0.00	0.00	26,166.67
6110130	ROAD&SITE PREP SVC	52,333.33	40,648.00	0.00	92,981.33
6120100	I & C SERVICES	0.00	88,588.75	0.00	88,588.75
6130170	COMM SVCS - WAN	3,716.17	0.00	0.00	3,716.17
6130360	RTOC - ENGINEERING	0.00	4,320.00	0.00	4,320.00
6130370	RTOC - GEOSTEERING	10,219.48	0.00	0.00	10,219.48
6140160	ENV-SERVICES	1,000.00	0.00	0.00	1,000.00
6150100	CH LOG PERFRTG&WL SV	0.00	289,190.00	0.00	289,190.00
6160100	MATERIALS & SUPPLIES	9,104.63	0.00	0.00	9,104.63
6170100	PULLING&SWABBING SVC	0.00	6,750.00	0.00	6,750.00
6170110	SNUBBG&COIL TUBG SVC	0.00	125,735.00	0.00	125,735.00
6190100	TRCKG&HL-SOLID&FLUID	92,346.91	0.00	0.00	92,346.91
6190110	TRUCKING&HAUL OF EQP	45,151.51	42,170.50	0.00	87,322.01
6200130	CONSLT & PROJECT SVC	122,262.11	86,403.00	0.00	208,665.11
6230120	SAFETY SERVICES	38,276.59	3,138.00	0.00	41,414.59
6300270	SOLIDS CONTROL SRVCS	71,722.15	0.00	0.00	71,722.15
6310120	STIMULATION SERVICES	0.00	1,218,952.00	0.00	1,218,952.00
6310190	PROPPANT PURCHASE	0.00	903,917.00	0.00	903,917.00
6310200	CASING & TUBULAR SVC	109,441.31	0.00	0.00	109,441.31
6310250	CEMENTING SERVICES	185,000.00	0.00	0.00	185,000.00
6310280	DAYWORK COSTS	721,000.00	0.00	0.00	721,000.00
6310300	DIRECTIONAL SERVICES	296,179.03	0.00	0.00	296,179.03
6310310	DRILL BITS	105,725.14	0.00	0.00	105,725.14
6310330	DRILL&COMP FLUID&SVC	321,820.63	16,836.00	0.00	338,656.63
6310370	MOB & DEMOBILIZATION	45,000.00	0.00	0.00	45,000.00
6310380	OPEN HOLE EVALUATION	24,155.13	0.00	0.00	24,155.13
6310480	TSNG-WELL, PL & OTH	0.00	134,557.00	0.00	134,557.00
6310600	MISC PUMPING SERVICE	0.00	52,108.00	0.00	52,108.00
6320100	EQPMNT SVC-SRF RNTL	157,008.33	227,272.00	0.00	384,280.33
6320110	EQUIP SVC - DOWNHOLE	88,073.31	35,043.00	0.00	123,116.31
6320160	WELDING SERVICES	2,601.32	0.00	0.00	2,601.32
6320190	WATER TRANSFER	0.00	49,883.00	0.00	49,883.00
6350100	CONSTRUCTION SVC	0.00	167,771.85	0.00	167,771.85
6520100	LEGAL FEES	1,000.00	0.00	0.00	1,000.00

Costs on this form are estimates only. Working Interest Owners should not consider these estimates



## Authorization for Expenditure

AFE # XX-145383.01

Well Name: TATER TOT 2-35 STATE FED COM 713H

AFE Date: 5/30/2023

Cost Center Number: 1094603301

State: NM

Legal Description: SEC 2-24S-29E

County/Parish: EDDY

Revision: ☐

Code	Intangible Description	Drilling Costs	Completion Costs	Dry Hole Costs	Total Costs
6550100	MISCS COSTS & SERVS	0.00	9,905.30	0.00	9,905.30
6550110	MISCELLANEOUS SVC	38,834.01	0.00	0.00	38,834.01
6550120	OTHER ROUSTABOUT SER	0.00	5,000.00	0.00	5,000.00
6630110	CAPITAL OVERHEAD	10,405.29	41,055.53	0.00	51,460.82
6740340	TAXES OTHER	0.00	32,088.36	0.00	32,088.36
	Total Intangibles	2,866,367.62	4,662,151.29	0.00	7,528,518.91

Code	Tangible Description	Drilling Costs	Completion Costs	Dry Hole Costs	Total Costs
6120110	I&C EQUIPMENT	0.00	114,201.43	0.00	114,201.43
6120120	MEASUREMENT EQUIP	0.00	27,876.98	0.00	27,876.98
6150110	LOG PERFORATG&WL EQP	0.00	11,250.00	0.00	11,250.00
6300150	SEPARATOR EQUIPMENT	0.00	328,268.70	0.00	328,268.70
6300220	STORAGE VESSEL&TANKS	0.00	64,610.00	0.00	64,610.00
6300230	PUMPS - SURFACE	0.00	10,561.25	0.00	10,561.25
6310130	ARTIFICIAL LIFT EQP	0.00	30,000.00	0.00	30,000.00
6310150	CASG-COND&DRIVE PIPE	25,000.00	0.00	0.00	25,000.00
6310420	TUBING & COMPONENTS	0.00	130,918.00	0.00	130,918.00
6310460	WELLHEAD EQUIPMENT	38,000.00	169,180.00	0.00	207,180.00
6310530	SURFACE CASING	26,735.00	0.00	0.00	26,735.00
6310540	INTERMEDIATE CASING	624,752.08	0.00	0.00	624,752.08
6310550	PRODUCTION CASING	828,610.00	0.00	0.00	828,610.00
6310580	CASING COMPONENTS	32,330.71	0.00	0.00	32,330.71
6330100	PIPE,FIT,FLANG,CPLNG	0.00	312,572.65	0.00	312,572.65
	Total Tangibles	1,575,427.79	1,199,439.01	0.00	2,774,866.80

TOTAL ESTIMATED COST	4,441,795.41	5,861,590.30	0.00	10,303,385.71
----------------------	--------------	--------------	------	---------------

### WORKING INTEREST OWNER APPROVAL

Company Name:

Signature:

Print Name:

Title:

Date:

Email:

Note: Please include/attach well requirement data with ballot.

Costs on this form are estimates only. Working Interest Owners should not consider these estimates

**Chronology of Contact with Uncommitted Working Interests**  
**Tater Tot Fed Com 332H, 334H, 621H, 622H, 624H, 711H, 712H, & 713H**

Week of 6/13/2023, Devon sent initial well proposal letter, AFEs and terms to the proposed Operating Agreement

Week of 7/13/2023, follow up correspondence with uncommitted working interest owner. Sent proposed Operating Agreement form.

Week of 8/23/2023, follow up correspondence with uncommitted working interest owner. Continue to discuss proposed Operating Agreement form.

Week of 9/5/2023, follow up correspondence with uncommitted working interest owner. Discussed estimated development timing. Informed Devon was targeting October 5<sup>th</sup> hearing date.

Week of 9/11/2023, follow up correspondence with uncommitted working interest owner. Answered questions as to development plans.

Week of 9/27/2023, follow up correspondence with uncommitted working interest owner



## **TAB 3**

Case No. 23788

Exhibit B: Self-Affirmed Statement of Sarah Jancuska, Geologist  
Exhibit B-1: Structure Map  
Exhibit B-2: Stratigraphic Cross Section



**STATE OF NEW MEXICO  
DEPARTMENT OF ENERGY, MINERALS AND NATURAL RESOURCES  
OIL CONSERVATION DIVISION**

**APPLICATIONS OF DEVON ENERGY PRODUCTION  
COMPANY, L.P. FOR A HORIZONTAL SPACING UNIT  
AND COMPULSORY POOLING, EDDY COUNTY,  
NEW MEXICO**

Case Nos. 23786-23789

**SELF-AFFIRMED STATEMENT OF SARAH JANCUSKA**

Sarah Jancuska, of lawful age and being first duly sworn, declares as follows:

1. My name is Sarah Jancuska and I am employed by Devon Energy Production Company, L.P. ("Devon") as a geologist.

2. I have NOT previously testified before the New Mexico Oil Conservation Division as an expert witness in petroleum geology. My credentials as a petroleum geologist have NOT been accepted by the Division and made a matter of record. Attached is my resume showing my educational background and work experience, and I respectfully request that I be accepted as an expert witness in petroleum geology.

3. I am familiar with the application filed by Devon in this case, and I have conducted a geologic study of the lands in the subject area.

4. This self-affirmed statement is submitted in connection with the filing by Devon of the above-referenced compulsory pooling application pursuant to 19.15.4.12.A(1) NMAC.

5. **Exhibit B-1** is a structure map of Wolfcamp top with contour interval of 50 ft. The unit being pooled is outlined by red rectangle, with the approximate location and orientation of the initial wells noted with red arrows. The structure map shows that there is

**EXHIBIT  
B**

a regional down-dip to the East. I do not observe any faulting, pinchouts, or other geologic impediments to developing this targeted interval. Existing offsetting Wolfcamp development in this area is also depicted.

6. **Exhibit B-2** is a stratigraphic cross-section flattened on the Wolfcamp top. Each well in the cross-section contains a gamma ray, resistivity, and porosity log. The cross-section demonstrates reasonable continuity of the target zone. The well logs on the cross-section give a representative sample of the Upper Wolfcamp. I chose the logs from these wells to create the cross section because they penetrate the targeted intervals, are of good quality and are representative of the geology in the subject area.

7. The landing zone is highlighted by light, grey shading.

8. My geologic study indicates the Wolfcamp formation underlying the subject area is suitable for development by horizontal wells and the acreage comprising the proposed horizontal spacing unit will be productive and contribute more or less equally to production from the wells.

9. In my opinion, approval of Devon's application in this case is in the best interest of conservation, the prevention of waste, and protection of correlative rights.

10. **Devon Exhibits B-1 through B-2** were either prepared by me or compiled under my direction and supervision.

*[Signature page follows]*

*Signature page of Self-Affirmed Statement of Sarah Jancuska:*

I understand that this Self-Affirmed Statement will be used as written testimony before the Division in Case No. 23786, 23787, 23788, and 23789, and affirm that my testimony herein is true and correct, to the best of my knowledge and belief and made under penalty of perjury under the laws of the State of New Mexico.

Sarah Jancuska  
Sarah Jancuska

10/02/2023  
Date Signed

**Sarah N. Jancuska**

Oklahoma City, OK 73104  
703-851-1516; sarah.jancuska@dvn.com

**Internal Experience****Devon Energy**, Oklahoma City, OK

Geologist II, Asset Geologist - Delaware Basin March 2022 – Present

- Performs asset geologist duties that include well log correlation, regional mapping, identification of resource in place, planning and execution, and reservoir characterization studies for entire stratigraphic column of Potato Asset

Geologist I, Subsurface August 2021 – March 2022

- Core description, facies analysis and reservoir characterization of the Middle Bakken member, Williston Basin ND
- Helped organized an ichnology (trace fossils) class with an outside instructor

WellCon Geologist II, III, Jan 2018 – August 2021

- Collaborate with BU Geologists and Engineers to land and geosteering wells using StarSteer in the Permian, Anadarko Powder River, and Eagle Ford basins using SES/Starsteer and Petra/Kingdom
- Contributed to the team exceeding our 95% in zone goal every year since joining the team

**External Experience****TD Geosteering**, Denver, CO

Geologist, August 2017 – Jan 2018

- Remotely provide real-time reservoir navigation using in-house, physics based methods to accurately model the subsurface

**Virginia Tech**, Magallanes Basin, southern Chile

Research Assistant, January 2015 – March 2015; January 2016 – March 2016

- Measured sedimentologic sections, mapped stratigraphic and structural features, logged and documented field observations, used a Trimble GPS to collect high-resolution spatial data, and collected samples for laboratory analysis
- Contributed to construction of outcrop-based 3D geologic models (in Petrel) that are used by sponsoring companies to investigate and constrain reservoir heterogeneity in deep-water systems

**ConocoPhillips Co.**, Houston, TX

Geoscience Intern, May 2015 – August 2015

- Identified 30 potential recompletable opportunities and new areas for development in the Granite Wash Play in the Anadarko Basin
- Utilized PETRA for well log correlations and creating structure, isopach and net pay maps
- Integrated geologic and well performance data to build a refined well inventory evaluation
- Collaborated with the team's petrophysicist, reservoir engineer, and geologists

**Virginia Tech**, Blacksburg, VA

Teaching Assistant, August 2014 – December 2014

- GEOS 3204 Sedimentology-Stratigraphy

**Nomac Services Geo LLC / Chesapeake Operating Inc**, Oklahoma City, OK

Geosteerer III, July 2014

Geosteerer – Team Lead, February 2014 – June 2014

Geosteerer, February 2012 – February 2014

- Mentored and advised team members on all aspects of the job
- Successfully steered 530 wells (Eagle Ford, Miss Lime, STACK, Marcellus, Utica, Niobrara, Permian, Hanyesville, Barnett)

Sarah Jancuska

- Analyzed real time MWD data, nearby wells, and seismic-reflection data to determine the wellbore's location in relation to the target zone and made adjustments as needed
- Communicated essential information to drilling engineers and operations geologists

**Horizon Well Logging LLC**, Multiple Field Sites in WV, PA, ND, MT

*Field Geologist*, January 2011 – February 2012

- Monitored gas onsite and maintained gas equipment; analyzed lithology samples and identified formations; prepared and edited mud logs for operations geologists
- Trained and mentored new hires on site
- Completed the yearlong Field Geologist Development Program (FGDP)

**U.S. Bentonite Processing Inc**, Casper, WY

*Geologist*, July 2010 – December 2011

- Tested and analyzed field samples against API spec 13A, sections 9, 10 and 11
- Worked with the exploration department sampling and mapping material drilled at potential sites

## Education

**Virginia Polytechnic Institute and State University (Virginia Tech)**, Blacksburg, VA

*Master of Science, Geosciences*: December 2016

**LaSalle University**, Philadelphia, PA

*Bachelor of Science, Geology & Environmental Science*: May 2010

## Professional Societies

*Society for Sedimentary Geology (SEPM)*, September 2014 – Present

*American Association of Petroleum Geologists (AAPG)*, August 2014 – Present

## WFMP Cross Section A – A'



# Structure Map WFMP (Top of WFMP) CI = 50 Feet

**Horizontal Locations:**

***Tater Tot 2-35 Fed Com 711H***  
***Tater Tot 2-35 Fed Com 621H***  
***Tater Tot 2-35 Fed Com 332H***  
***Tater Tot 2-35 Fed Com 712H***  
***Tater Tot 2-35 Fed Com 622H***  
***Tater Tot 2-35 Fed Com 334H***  
***Tater Tot 2-35 Fed Com 713H***  
***Tater Tot 2-35 Fed Com 624H***

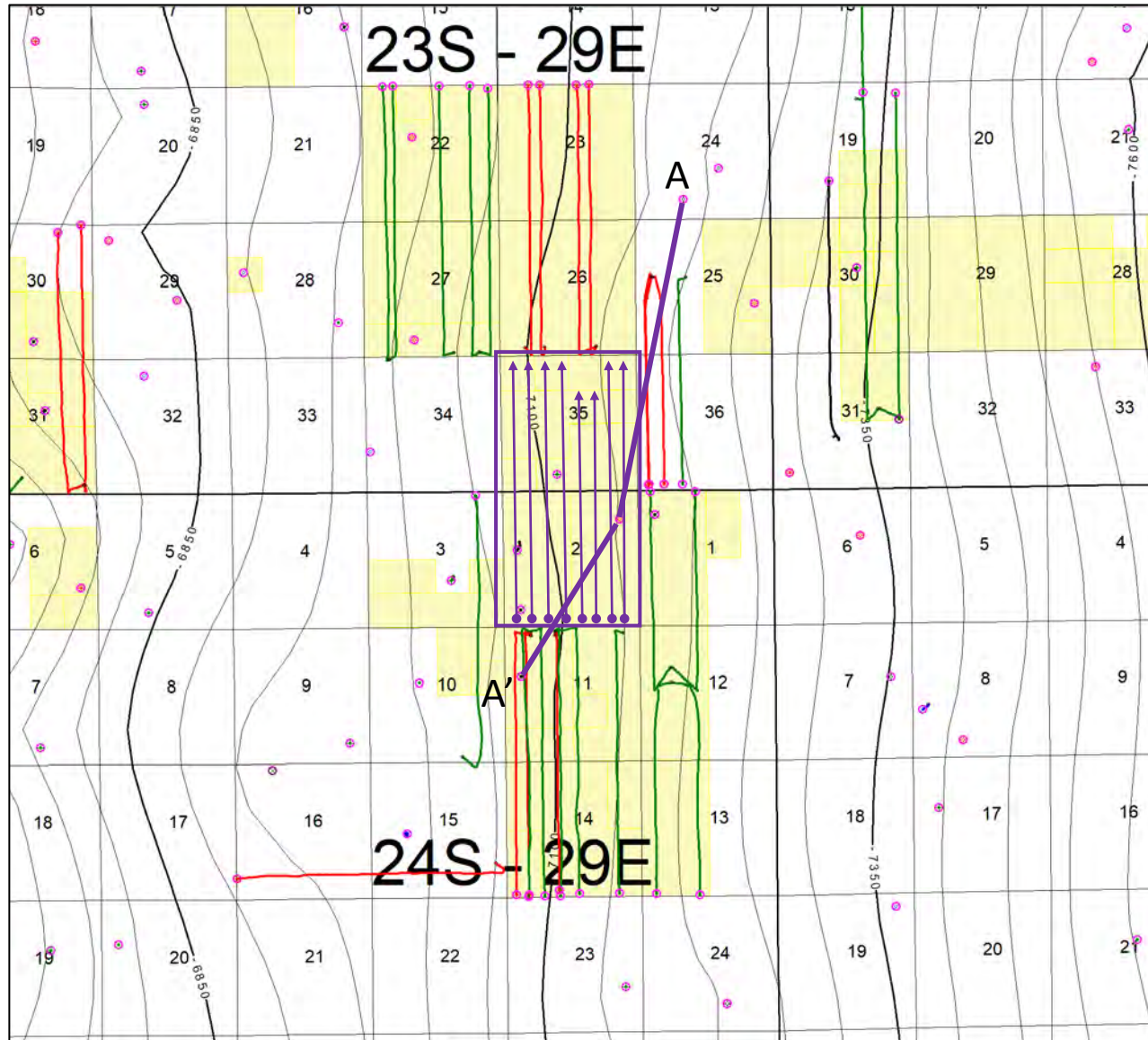

- Producing Horizontal Wells
- BHL
- FTP
- Control Points

**EXHIBIT  
B-1**



## Stratigraphic Cross Section A – A'

### WFMP

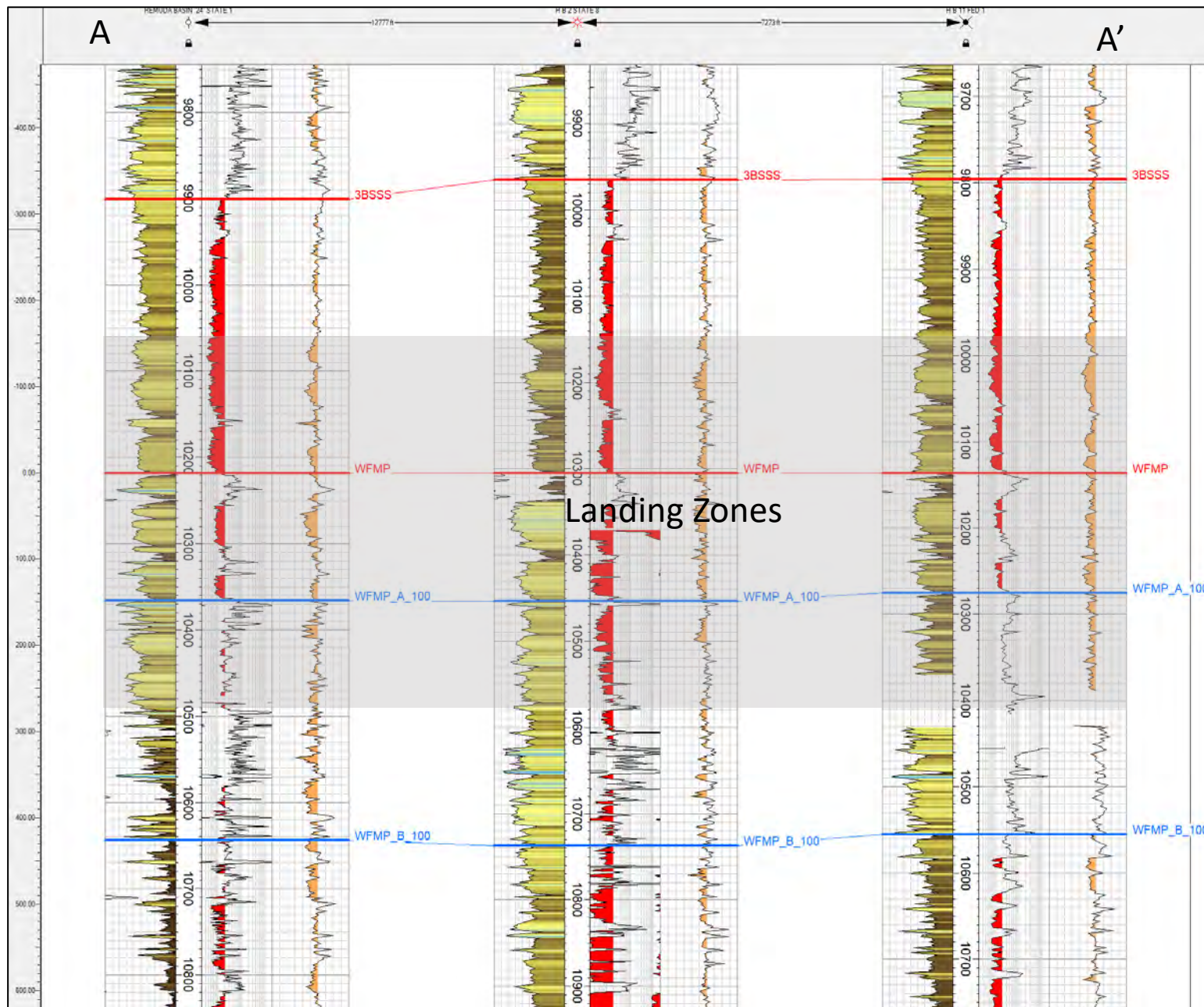

EXHIBIT  
**B-2**

## **TAB 4**

Case No. 23788

Exhibit C: Self-Affirmed Statement of Notice, Darin C. Savage  
Exhibit C-1: Notice Letter  
Exhibit C-2: Mailing List  
Exhibit C-3: Affidavit of Publication



**STATE OF NEW MEXICO  
ENERGY, MINERALS AND NATURAL RESOURCES DEPARTMENT  
OIL CONSERVATION DIVISION**

**APPLICATION OF DEVON ENERGY PRODUCTION  
COMPANY, L.P. FOR COMPULSORY POOLING,  
EDDY COUNTY, NEW MEXICO**

Case No. 23788

**SELF-AFFIRMED STATEMENT OF NOTICE**

I, Darin C. Savage, attorney and authorized representative of Devon Energy Production Company, L.P. ("Devon"), the Applicant herein, being first duly sworn, upon oath, states the following:

1. Notice of the applications and hearing in the above-reference cases was timely sent by certified mail, return receipt requested, through the United States Postal Service on September 13, 2023, to all uncommitted Working Interest owners sought to be pooled in this proceeding. *See* Exhibit C-2, attached hereto. Copies of notice letters and evidence of mailing to parties are attached hereto as Exhibits C-1 and C-2.

2. Notice was sent to the Carlsbad Current Argus, a newspaper of general circulation in Eddy County, New Mexico, and timely published in said newspaper on September 19, 2023. *See* Exhibit C-3.

*[Signature page follows]*

**EXHIBIT  
C**

*Signature page of Self-Affirmed Statement of Darin C. Savage:*

I understand that this Self-Affirmed Statement will be used as written testimony before the Division in Case No. 23788 and affirm that my testimony herein is true and correct, to the best of my knowledge and belief and made under penalty of perjury under the laws of the State of New Mexico.



---

Darin Savage

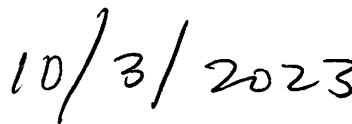

---

Date Signed



For the Pursuit of Energy

ABADIE | SCHILL PC

Colorado	New Mexico
Louisiana	Texas
Nebraska	Kansas
Montana	Wyoming
Oklahoma	California
	North Dakota

September 13, 2023

VIA CERTIFIED MAIL  
RETURN RECEIPT REQUESTED

TO: ALL INTEREST OWNERS SUBJECT TO POOLING PROCEEDINGS

Re: Application of Devon Energy Production Company, L.P.,  
for Compulsory Pooling, Eddy County, New Mexico  
Tater Tot 2-35 Fed Com 622H Well (Case No. 23788)  
Tater Tot 2-35 Fed Com 624H Well (Case No. 23788)  
Tater Tot 2-35 Fed Com 713H Well (Case No. 23788)

Case No. 23788:

Dear Interest Owners:

This letter is to advise you that Devon Energy Production Company, L.P. ("Devon"), has filed the enclosed application, Case No. 23788, with the New Mexico Oil Conservation Division ("Division") for the compulsory pooling of a non-standard horizontal spacing unit in the Wolfcamp formation.

In Case No. 23788, Devon seeks to pool the Purple Sage; Wolfcamp formation, designated as a gas pool, underlying a non-standard 599.2-acre, more or less, spacing and proration unit comprised of Lot 2 (NW/4 NE/4 equivalent), Lot 1 (NE/4 NE/4 equivalent), the S/2 NE/4, and the SE/4 of Section 2, Township 24 South, Range 29 East, NMPM, and the E/2 NE/4, SW/4 NE/4, and SE/4 of Section 35, Township 23 South, Range 29 East, NMPM, Eddy County, New Mexico. The proposed wells to be dedicated to the horizontal spacing unit are the **Tater Tot 2-35 Fed Com 622H Well**, the **Tater Tot 2-35 Fed Com 624H Well**, and the **Tater Tot 2-35 Fed Com 713H Well**.

A hearing has been requested before a Division Examiner on October 5, 2023, and the status of the hearing can be monitored through the Division's website. Division hearings

abadieschill.com

214 McKenzie Street, Santa Fe, New Mexico, 87501

O : 970.385.4401 • F : 970.385.4901

**EXHIBIT  
C-1**

will commence at 8:15 a.m., traditionally in Porter Hall at the Oil Conservation Division's Santa Fe Offices located at 1220 South Saint Francis Drive, Santa Fe, New Mexico 87505. However, under current Division policies, the hearing will be conducted remotely online. For information about remote access and status of the case, you can visit the Division's website at: <https://www.emnrd.nm.gov/oed/hearing-info/> or call (505) 476-3441.

You are being notified as an interest owner (subject to title examination) and are not required to attend this hearing, but as an owner of an interest that may be affected by this application, you may appear and present testimony. Failure to appear at that time and become a party of record will preclude you from challenging the matter at a later date.

Parties appearing in cases are required by Division Rule 19.15.4.13.B NMAC to file a Pre-hearing Statement at least four business days in advance of a scheduled hearing, but in no event later than 5 p.m. mountain time on the Thursday preceding the scheduled hearing date. This statement must be filed at the Division's Santa Fe office at the above specified address and should include: The names of the parties and their attorneys; a concise statement of the case; the names of all witnesses the party will call to testify at the hearing; the approximate time the party will need to present its case; and identification of any procedural matters that are to be resolved prior to the hearing.

If you have any questions about this matter, please contact Aaron Young at (405) 228-2850 or at [aaron.young@devon.com](mailto:aaron.young@devon.com).

Sincerely,

A handwritten signature in black ink, appearing to read 'Darin C. Savage', written over a horizontal line.

Darin C. Savage

Attorney for Devon Energy Production  
Company, L.P.

Mail Activity Report - CertifiedPro.net  
Mailed from 9/10/2023 to 9/16/2023  
User Name: abadieschill  
Generated: 9/26/2023 10:15:26 AM

USPS Article Number	Ownership	Reference Number	Date Mailed	Name 1	Name 2	Address 1	Address 2	City	State	Zip	Mailing Status	Service Options
9314869904300112028880	WI	4188.51	9/13/23	Highland (Texas) Energy Company Inc.		11886 Greenville Ave.	Suite 106	Dallas	TX	75243	Delivered	Return Receipt - Electronic, Certified Mail
9314869904300112028897	WI	4188.51	9/13/23	OXY USA Inc.		5 Greenway Plaza	Suite 110	Houston	TX	77046	Delivered	Return Receipt - Electronic, Certified Mail
9314869904300112028903	ORRI	4188.51	9/13/23	LeNell Joy Honeyman, SSP		406 Skywood Circle		Midland	TX	79705	Delivered	Return Receipt - Electronic, Certified Mail
9314869904300112028910	ORRI	4188.51	9/13/23	Leslie Robert Honeyman Trust,	LaNell Joy Honeyman, Trustee	406 Skywood Circle		Midland	TX	79705	Mailed	Return Receipt - Electronic, Certified Mail
9314869904300112028927	ORRI	4188.51	9/13/23	Tap Rock Minerals, LP		523 Park Point Drive	Suite 200	Golden	CO	80401	Delivered	Return Receipt - Electronic, Certified Mail
9314869904300112028934	ORRI	4188.51	9/13/23	Cornerstone Family Trust		P.O. Box 558		Peyton	CO	80831	Delivered	Return Receipt - Electronic, Certified Mail
9314869904300112028941	ORRI	4188.51	9/13/23	LJA Charitable Investments, LLC		P.O. Box 331363		Houston	TX	77233	Mailed	Return Receipt - Electronic, Certified Mail
9314869904300112028958	WI / ORRI	4188.51	9/13/23	The Allar Company		P.O. Box 1567		Graham	TX	76450	Delivered	Return Receipt - Electronic, Certified Mail
9314869904300112028965	ORRI	4188.51	9/13/23	Strategic Energy Income Fund IV, LP		2350 North Forest Road		Getzville	NY	14063	To be Returned	Return Receipt - Electronic, Certified Mail
9314869904300112028972	RT	4188.51	9/13/23	Echo Production, Inc.		P.O. Box 1210		Graham	TX	76450	Delivered	Return Receipt - Electronic, Certified Mail
9314869904300112028989	RI	4188.51	9/13/23	Bureau of Land Management		620 E. Greene St		Carlsbad	NM	88220	Delivered	Return Receipt - Electronic, Certified Mail





September 19, 2023

Dear Covius Document Services:

The following is in response to your request for proof of delivery on your item with the tracking number:  
**9314 8699 0430 0112 0289 89.**

#### Item Details

<b>Status:</b>	Delivered to Agent for Final Delivery
<b>Status Date / Time:</b>	September 18, 2023, 12:38 p.m.
<b>Location:</b>	CARLSBAD, NM 88220
<b>Postal Product:</b>	First-Class Mail®
<b>Extra Services:</b>	Certified Mail™ Return Receipt Electronic
<b>Recipient Name:</b>	Bureau of Land Management

#### Shipment Details

<b>Weight:</b>	5.0oz
----------------	-------

#### Recipient Signature

Signature of Recipient:  
(Authorized Agent)

BL m

Address of Recipient:

620 6.1 m

Note: Scanned image may reflect a different destination address due to Intended Recipient's delivery instructions on file.

Thank you for selecting the United States Postal Service® for your mailing needs. If you require additional assistance, please contact your local Post Office™ or a Postal representative at 1-800-222-1811.

Sincerely,  
United States Postal Service®  
475 L'Enfant Plaza SW  
Washington, D.C. 20260-0004

Information in this section provided by Covius Document Services, LLC.

**Reference Number:** 4188.51



September 19, 2023

Dear Covius Document Services:

The following is in response to your request for proof of delivery on your item with the tracking number:  
**9314 8699 0430 0112 0289 72.**

**Item Details**

**Status:** Delivered, Individual Picked Up at Post Office  
**Status Date / Time:** September 18, 2023, 09:56 a.m.  
**Location:** GRAHAM, TX 76450  
**Postal Product:** First-Class Mail®  
**Extra Services:** Certified Mail™  
Return Receipt Electronic  
**Recipient Name:** Echo Production Inc

**Shipment Details**

**Weight:** 5.0oz

**Destination Delivery Address**

**Street Address:** PO BOX 1210  
**City, State ZIP Code:** GRAHAM, TX 76450-1210

**Recipient Signature**

Signature of Recipient:

PO BOX 1210

Address of Recipient:

GRAHAM, TX 76450-1210

Note: Scanned image may reflect a different destination address due to Intended Recipient's delivery instructions on file.

Thank you for selecting the United States Postal Service® for your mailing needs. If you require additional assistance, please contact your local Post Office™ or a Postal representative at 1-800-222-1811.

Sincerely,  
United States Postal Service®  
475 L'Enfant Plaza SW  
Washington, D.C. 20260-0004

---

Information in this section provided by Covius Document Services, LLC.

**Reference Number:** 4188.51



September 19, 2023

Dear Covius Document Services:

The following is in response to your request for proof of delivery on your item with the tracking number:  
**9314 8699 0430 0112 0289 58.**

#### Item Details

**Status:** Delivered, Individual Picked Up at Post Office  
**Status Date / Time:** September 18, 2023, 10:39 a.m.  
**Location:** GRAHAM, TX 76450  
**Postal Product:** First-Class Mail®  
**Extra Services:** Certified Mail™  
Return Receipt Electronic  
**Recipient Name:** The Allar Company

#### Shipment Details

**Weight:** 5.0oz

#### Destination Delivery Address

**Street Address:** PO BOX 1567  
**City, State ZIP Code:** GRAHAM, TX 76450-7567

#### Recipient Signature

Signature of Recipient:

  
Steve Denny

Address of Recipient:

POB 1657

Note: Scanned image may reflect a different destination address due to Intended Recipient's delivery instructions on file.

Thank you for selecting the United States Postal Service® for your mailing needs. If you require additional assistance, please contact your local Post Office™ or a Postal representative at 1-800-222-1811.

Sincerely,  
United States Postal Service®  
475 L'Enfant Plaza SW  
Washington, D.C. 20260-0004

Information in this section provided by Covius Document Services, LLC.

**Reference Number:** 4188.51





September 18, 2023

Dear Covius Document Services:

The following is in response to your request for proof of delivery on your item with the tracking number:  
**9314 8699 0430 0112 0289 34.**

#### Item Details

**Status:** Delivered  
**Status Date / Time:** September 16, 2023, 11:05 a.m.  
**Location:** PEYTON, CO 80831  
**Postal Product:** First-Class Mail®  
**Extra Services:** Certified Mail™  
Return Receipt Electronic  
**Recipient Name:** Cornerstone Family Trust

#### Shipment Details

**Weight:** 5.0oz

#### Destination Delivery Address

**Street Address:** PO BOX 558  
**City, State ZIP Code:** PEYTON, CO 80831-0558

#### Recipient Signature

Signature of Recipient:	Signature X	
	Printed Name	John K. Thomas
Address of Recipient:	Delivery Address	P.O. Box 558

Note: Scanned image may reflect a different destination address due to Intended Recipient's delivery instructions on file.

Thank you for selecting the United States Postal Service® for your mailing needs. If you require additional assistance, please contact your local Post Office™ or a Postal representative at 1-800-222-1811.

Sincerely,  
United States Postal Service®  
475 L'Enfant Plaza SW  
Washington, D.C. 20260-0004

Information in this section provided by Covius Document Services, LLC.

**Reference Number:** 4188.51



September 20, 2023

Dear Covius Document Services:

The following is in response to your request for proof of delivery on your item with the tracking number:  
**9314 8699 0430 0112 0288 97.**



#### Item Details

**Status:** Delivered to Agent for Final Delivery  
**Status Date / Time:** September 19, 2023, 12:07 p.m.  
**Location:** HOUSTON, TX 77046  
**Postal Product:** First-Class Mail®  
**Extra Services:** Certified Mail™  
Return Receipt Electronic  
**Recipient Name:** OXY USA Inc

#### Shipment Details

**Weight:** 5.0oz

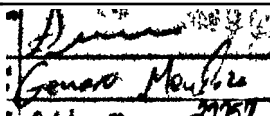
#### Recipient Signature

Signature of Recipient: (Authorized Agent)	
Address of Recipient:	

Note: Scanned image may reflect a different destination address due to Intended Recipient's delivery instructions on file.

Thank you for selecting the United States Postal Service® for your mailing needs. If you require additional assistance, please contact your local Post Office™ or a Postal representative at 1-800-222-1811.

Sincerely,  
United States Postal Service®  
475 L'Enfant Plaza SW  
Washington, D.C. 20260-0004

Information in this section provided by Covius Document Services, LLC.

**Reference Number:** 4188.51



September 19, 2023

Dear Covius Document Services:

The following is in response to your request for proof of delivery on your item with the tracking number:  
**9314 8699 0430 0112 0288 80.**



#### Item Details

**Status:** Delivered to Agent for Final Delivery  
**Status Date / Time:** September 18, 2023, 10:39 a.m.  
**Location:** DALLAS, TX 75243  
**Postal Product:** First-Class Mail®  
**Extra Services:** Certified Mail™  
Return Receipt Electronic  
**Recipient Name:** Highland Texas Energy Company Inc

#### Shipment Details

**Weight:** 5.0oz

#### Recipient Signature

Signature of Recipient: (Authorized Agent)	
Address of Recipient:	

Note: Scanned image may reflect a different destination address due to Intended Recipient's delivery instructions on file.

Thank you for selecting the United States Postal Service® for your mailing needs. If you require additional assistance, please contact your local Post Office™ or a Postal representative at 1-800-222-1811.

Sincerely,  
United States Postal Service®  
475 L'Enfant Plaza SW  
Washington, D.C. 20260-0004

---

Information in this section provided by Covius Document Services, LLC.

**Reference Number:** 4188.51

# Carlsbad Current Argus.

## Affidavit of Publication

Ad # 0005827763

This is not an invoice

ABADIE SCHILL P.C.

555 RIVERGATE # B 4-180

DURANGO, CO 81301-7485

I, a legal clerk of the **Carlsbad Current Argus**, a newspaper published daily at the City of Carlsbad, in said county of Eddy, state of New Mexico and of general paid circulation in said county; that the same is a duly qualified newspaper under the laws of the State wherein legal notices and advertisements may be published; that the printed notice attached hereto was published in the regular and entire edition of said newspaper and not in supplement thereof in editions dated as follows:

09/19/2023

*Nicole Jacobs*  
Legal Clerk

Subscribed and sworn before me this September 29,

2023:

*[Signature]*  
State of WI, County of Brown  
NOTARY PUBLIC

*10-25-26*  
My commission expires

CASE No. 23788: Notice -- to all parties and persons having any right, title, interest or claim in this case, including owners of working interest, overriding royalty interest, and record title, among others, whether such parties or persons are listed herein or not, as well as notice to all known and unknown heirs, devisees, assigns and successors of such affected parties and persons, which based on reasonable diligence include HIGHLAND (TEXAS) ENERGY COMPANY INC.; OXY USA INC.; LENELL JOY HONEYMAN, SSP; LESLIE ROBERT HONEYMAN TRUST; LANELL JOY HONEYMAN, TRUSTEE; TAP ROCK MINERALS, LP; CORNERSTONE FAMILY TRUST; LJA CHARITABLE INVESTMENTS, LLC; THE ALLAR COMPANY; STRATEGIC ENERGY INCOME FUND IV, LP; AND ECHO PRODUCTION, INC. -- of Devon Energy Production Company, L.P.'s application for approval of compulsory pooling, Eddy County, New Mexico. The State of New Mexico, through its Oil Conservation Division, hereby gives notice that the Division Examiner will conduct a public hearing at 8:15 a.m. on October 5, 2023, traditionally held at 1220 S. St. Francis, Santa Fe, New Mexico, 87505. However, under current Division policies, the hearing will be conducted remotely online. For information about remote access and the status of the case, you can visit the Division's website at: <https://www.emnrd.nm.gov/ocd/hearing-info/> or call (505) 476-3441. Devon Energy Production Company, L.P., at 333 W. Sheridan Ave, Oklahoma City, OK 73102, seeks an order from the Division pooling all mineral interests in the Purple Sage Wolfcamp formation, designated as a gas pool, underlying a non-standard 599.2-acre, more or less, spacing and proration unit comprised of Lot 2 (NW/4 NE/4 equivalent), Lot 1 (NE/4 NE/4 equivalent), the S/2 NE/4, and the SE/4 of Section 2, Township 24 South, Range 29 East, NMPM, and the E/2 NE/4, SW/4 NE/4, and SE/4 of Section 35, Township 23 South, Range 29 East, NMPM, Eddy County, New Mexico. Section 2 is an irregular section containing correction lots. The proposed wells to be dedicated to the horizontal spacing unit are the Tater Tot 2-35 Fed Com 622H Well, a gas well, to be horizontally drilled from a surface location in the SW/4 SE/4 (Unit O) of Section 2 to a bottom hole location in the SW/4 NE/4 (Unit G) of Section 35; the Tater Tot 2-35 Fed Com 624H Well, a gas well, to be horizontally drilled from a surface location in the SE/4 SE/4 (Unit P) of Section 2 to a bottom hole location in the NE/4 NE/4 (Unit A) of Section 35; and the Tater Tot 2-35 Fed Com 713H Well, a gas well, to be horizontally drilled from a surface location in the SE/4 SE/4 (Unit P) of Section 2 to a bottom hole location in the NE/4 NE/4 (Unit A) of Section 35. The wells are unorthodox, and their take points and completed intervals do not comply with the setback requirements under the Division's Special Rules in Order No. R-14262 for the Purple Sage Wolfcamp; however, Applicant has applied for and received administrative approval of the unorthodox locations and has applied for and received administrative approval of the non-standard spacing unit; also to be considered will be the cost of drilling and completing the wells and the allocation of the costs thereof; actual operating costs and charges for supervision; the designation of the Applicant as Operator of the wells and unit; and a 200% charge for the risk involved in drilling and completing the wells. The wells and lands are located approximately 8.8 miles southeast of Loving, New Mexico.

#5827763, Current Argus, September 19, 2023

Ad # 0005827763

PO #:

# of Affidavits: 1

This is not an invoice

RYAN SPELLER  
Notary Public  
State of Wisconsin

EXHIBIT  
C-3