

**STATE OF NEW MEXICO
DEPARTMENT OF ENERGY, MINERALS AND NATURAL RESOURCES
OIL CONSERVATION DIVISION**

**APPLICATION OF PERMIAN RESOURCES
OPERATING, LLC FOR COMPULSORY
POOLING, LEA COUNTY, NEW MEXICO.**

CASE NO. 23952

EXHIBIT INDEX

Compulsory Pooling Checklist

Exhibit A	Self-Affirmed Statement of Chris Astwood
A-1	Application & Proposed Notice of Hearing
A-2	C-102
A-3	Plat of Tracts, Tract Ownership, Applicable Lease Numbers, Unit Recapitulation, Pooled Parties
A-4	Sample Well Proposal Letter & AFEs
A-5	Chronology of Contact
Exhibit B	Self-Affirmed Statement of Ira Bradford
B-1	Regional Locator Map
B-2	Cross Section Location Map
B-3	Bone Spring Subsea Structure Map
B-4	Stratigraphic Cross-Section
B-5	Gun Barrel Development Plan
Exhibit C	Self-Affirmed Statement of Dana S. Hardy
C-1	Notice Letters to All Interested Parties
C-2	Chart of Notice to All Interested Parties
C-3	Copies of Certified Mail Receipts and Returns
C-4	Affidavit of Publication for November 10, 2023

COMPULSORY POOLING APPLICATION CHECKLIST

ALL INFORMATION IN THE APPLICATION MUST BE SUPPORTED BY SIGNED AFFIDAVITS

Case: 23952	APPLICANT'S RESPONSE
Date	December 7, 2023
Applicant	Permian Resources Operating, LLC
Designated Operator & OGRID (affiliation if applicable)	OGRID No. 372165
Applicant's Counsel:	Hinkle Shanor LLP
Case Title:	Application of Permian Resources Operating, LLC for Compulsory Pooling, Lea County, New Mexico.
Entries of Appearance/Intervenors:	None.
Well Family	Butters Stotch
Formation/Pool	
Formation Name(s) or Vertical Extent:	Bone Spring Formation
Primary Product (Oil or Gas):	Oil
Pooling this vertical extent:	Bone Spring Formation
Pool Name and Pool Code:	WC-025 G-07 S223505N; Bone Spring Pool (Code 98136)
Well Location Setback Rules:	Statewide
Spacing Unit	
Type (Horizontal/Vertical)	Horizontal
Size (Acres)	240 acres
Building Blocks:	quarter-quarter
Orientation:	South to North
Description: TRS/County	W/2 E/2 of Section 17 and W/2 SE/4 of Section 8, Township 22 South, Range 35 East, Lea County.
Standard Horizontal Well Spacing Unit (Y/N), If No, describe <u>and is approval of non-standard unit requested in this application?</u>	Yes.
Other Situations	
Depth Severance: Y/N. If yes, description	N/A
Proximity Tracts: If yes, description	N/A
Proximity Defining Well: if yes, description	N/A
Applicant's Ownership in Each Tract	Exhibit A-3
Well(s)	
Name & API (if assigned), surface and bottom hole location, footages, completion target, orientation, completion status (standard or non-standard)	Add wells as needed
Well #1	Butters Stotch 8 State Com 123H (API # ---) 2452' FSL & 1157' FEL (Unit I), Section 8, T22S, R35E 100' FSL & 2145' FEL (Unit O), Section 17, T22S, R35E Completion Target: Bone Spring (Approx. 10,350' TVD)
Horizontal Well First and Last Take Points	Exhibit A-2

Completion Target (Formation, TVD and MD)	Exhibit A-4
AFE Capex and Operating Costs	
Drilling Supervision/Month \$	\$10,000.00
Production Supervision/Month \$	\$1,000.00
Justification for Supervision Costs	Exhibit A
Requested Risk Charge	200%
Notice of Hearing	
Proposed Notice of Hearing	Exhibit A-1
Proof of Mailed Notice of Hearing (20 days before hearing)	Exhibit C-1, Exhibit C-2, Exhibit C-3
Proof of Published Notice of Hearing (10 days before hearing)	Exhibit C-4
Ownership Determination	
Land Ownership Schematic of the Spacing Unit	Exhibit A-3
Tract List (including lease numbers and owners)	Exhibit A-3
If approval of Non-Standard Spacing Unit is requested, Tract List (including lease numbers and owners) of Tracts subject to notice requirements.	N/A
Pooled Parties (including ownership type)	Exhibit A-3
Unlocatable Parties to be Pooled	N/A
Ownership Depth Severance (including percentage above & below)	N/A
Joinder	
Sample Copy of Proposal Letter	Exhibit A-4
List of Interest Owners (ie Exhibit A of JOA)	Exhibit A-3
Chronology of Contact with Non-Joined Working Interests	Exhibit A-5
Overhead Rates In Proposal Letter	Exhibit A-4
Cost Estimate to Drill and Complete	Exhibit A-4
Cost Estimate to Equip Well	Exhibit A-4
Cost Estimate for Production Facilities	Exhibit A-4
Geology	
Summary (including special considerations)	Exhibit B
Spacing Unit Schematic	Exhibit B-1
Gunbarrel/Lateral Trajectory Schematic	Exhibit B-5
Well Orientation (with rationale)	Exhibit B
Target Formation	Exhibit B
HSU Cross Section	Exhibit B-2
Depth Severance Discussion	N/A
Forms, Figures and Tables	
C-102	Exhibit A-2
Tracts	Exhibit A-3
Summary of Interests, Unit Recapitulation (Tracts)	Exhibit A-3
General Location Map (including basin)	Exhibit B-1

Well Bore Location Map	Exhibit B-2
Structure Contour Map - Subsea Depth	Exhibit B-3
Cross Section Location Map (including wells)	Exhibit B-2
Cross Section (including Landing Zone)	Exhibit B-4
Additional Information	
Special Provisions/Stipulations	N/A
CERTIFICATION: I hereby certify that the information provided in this checklist is complete and accurate.	
Printed Name (Attorney or Party Representative):	Dana S. Hardy
Signed Name (Attorney or Party Representative):	/s/ Dana S. Hardy
Date:	12/3/2023

**STATE OF NEW MEXICO
DEPARTMENT OF ENERGY, MINERALS AND NATURAL RESOURCES
OIL CONSERVATION DIVISION**

**APPLICATION OF PERMIAN RESOURCES
OPERATING, LLC FOR COMPULSORY
POOLING, LEA COUNTY, NEW MEXICO.**

CASE NO. 23952

**SELF-AFFIRMED STATEMENT
OF CHRIS ASTWOOD**

1. I am a landman with Permian Resources Operating, LLC (“Permian Resources”). I am over 18 years of age, have personal knowledge of the matters addressed herein, and am competent to provide this Self-Affirmed Statement. I have previously testified before the New Mexico Oil Conservation Division (“Division”) and my credentials as an expert in petroleum land matters were accepted and made a matter of record.

2. Copies of the application and proposed hearing notice are attached as **Exhibit A-1**.

3. None of the parties proposed to be pooled in this case indicated opposition to this matter proceeding by affidavit; therefore I do not expect any opposition at hearing.

4. Permian Resources seeks an order pooling all uncommitted interests in the Bone Spring formation underlying a 240-acre, more or less, standard horizontal spacing unit comprised of the W/2 E/2 of Section 17 and the W/2 SE/4 of Section 8, Township 22 South, Range 35 East, Lea County, New Mexico (“Unit”).

5. The Unit will be dedicated to the **Butters Stotch 8 State Com 123H** well (“Well”), which will be drilled from a surface hole location in the NE/4 SE/4 (Unit I) of Section 8 to a bottom hole location in the SW/4 SE/4 (Unit O) of Section 17. The Well will be completed in the WC-025 G-07 S223505N; Bone Spring Pool (Code 98136).

6. The completed interval of the Well will be orthodox.

7. **Exhibit A-2** contains the C-102 for the Well.

**Permian Resources Operating, LLC
Case No. 23952
Exhibit A**

8. **Exhibit A-3** contains a plat identifying ownership by tract in the Unit. This exhibit also includes any applicable lease numbers, a unit recapitulation, and the interests Permian Resources seeks to pool highlighted in yellow. All of the parties are locatable in that Permian believes it located valid addresses for them.

9. Permian Resources has conducted a diligent search of all county public records, including phone directories and computer databases, as well as internet searches, to locate the interest owners it seeks to pool.

10. **Exhibit A-4** contains a sample well proposal letter and AFEs sent to working interest owners for the Well. The estimated costs reflected on the AFEs are fair and reasonable and comparable to the cost of other wells of similar depth and length drilled in the subject formation in the area.

11. In my opinion, Permian Resources made a good-faith effort to reach voluntary joinder of uncommitted interests in the Well as indicated by the chronology of contact described in **Exhibit A-5**.

12. Permian Resources requests overhead and administrative rates of \$10,000 per month while the Well is being drilled and \$1,000 per month while the Well is producing. These rates are fair and are comparable to the rates charged by Permian and other operators in the vicinity.

13. The attached exhibits were either prepared by me or under my supervision or were compiled from company business records.

14. In my opinion, the granting of Permian Resources' application would serve the interests of conservation, the protection of correlative rights, and the prevention of waste.

15. I understand this Self-Affirmed Statement will be used as written testimony in this case. I affirm that my testimony above is true and correct and is made under penalty of perjury

under the laws of the State of New Mexico. My testimony is made as of the date next to my electronic signature below.



Chris Astwood

11/29/2023

Date

**STATE OF NEW MEXICO
DEPARTMENT OF ENERGY, MINERALS AND NATURAL RESOURCES
OIL CONSERVATION DIVISION**

**APPLICATION OF PERMIAN RESOURCES
OPERATING, LLC FOR COMPULSORY
POOLING, LEA COUNTY, NEW MEXICO.**

CASE NO. 23952

APPLICATION

Pursuant to NMSA § 70-2-17, Permian Resources Operating, LLC (“Applicant”) (OGRID No. 372165) applies for an order pooling all uncommitted interests in the Bone Spring formation underlying a 240-acre, more or less, standard horizontal spacing unit comprised of the W/2 E/2 of Section 17 and the W/2 SE/4 of Section 8, Township 22 South, Range 35 East, Lea County, New Mexico (“Unit”). In support of its application, Applicant states the following:

1. Applicant is a working interest owner in the Unit and has the right to drill wells thereon.
2. The Unit will be dedicated to the **Butters Stotch 8 State Com 123H** well (“Well”), which will be drilled from a surface hole location in the NE/4 SE/4 (Unit I) of Section 8 to a bottom hole location in the SW/4 SE/4 (Unit O) of Section 17.
3. The completed interval of the Well will be orthodox.
4. Applicant has undertaken diligent, good faith efforts to obtain voluntary agreements from all interest owners to participate in the drilling of the Well but has been unable to obtain voluntary agreements from all interest owners.
5. The pooling of uncommitted interests will avoid the drilling of unnecessary wells, prevent waste, and protect correlative rights.

**Permian Resources Operating, LLC
Case No. 23952
Exhibit A-1**

6. In order to allow Applicant to obtain its just and fair share of the oil and gas underlying the subject lands, all uncommitted interests in the Unit should be pooled and Applicant should be designated the operator of the Well and the Unit.

WHEREFORE, Applicant requests that this application be set for hearing before an Examiner of the Oil Conservation Division on December 7, 2023, and, after notice and hearing as required by law, the Division enter an order:

- A. Pooling all uncommitted interests in the Unit;
- B. Approving the Well in the Unit;
- C. Designating Permian Resources Operating, LLC as the operator of the Unit and the Well to be drilled thereon;
- D. Authorizing Applicant to recover its costs of drilling, equipping, and completing the Well;
- E. Approving the actual operating charges and costs of supervision while drilling and after completion, together with a provision adjusting the rates pursuant to the COPAS accounting procedures; and
- F. Imposing a 200% charge for the risk assumed by Permian Resources Operating, LLC in drilling and completing the Well against any working interest owner who does not voluntarily participate in the drilling of the Well.

Respectfully submitted,

HINKLE SHANOR LLP

/s/ Dana S. Hardy

Dana S. Hardy

Jaclyn M. McLean

P.O. Box 2068

Santa Fe, NM 87504-2068

Phone: (505) 982-4554

dhardy@hinklelawfirm.com

jmclean@hinklelawfirm.com

*Counsel for Permian Resources Operating,
LLC*

Application of Permian Resources Operating, LLC for Compulsory Pooling, Lea County, New Mexico. Applicant applies for an order pooling all uncommitted interests in the Bone Spring formation underlying a 240-acre, more or less, standard horizontal spacing unit comprised of the W/2 E/2 of Section 17 and the W/2 SE/4 of Section 8, Township 22 South, Range 35 East, Lea County, New Mexico ("Unit"). The Unit will be dedicated to the **Butters Stotch 8 State Com 123H** well ("Well"), which will be drilled from a surface hole location in the NE/4 SE/4 (Unit I) of Section 8 to a bottom hole location in the SW/4 SE/4 (Unit O) of Section 17. The completed interval of the Well will be orthodox. Also to be considered will be the cost of drilling and completing the Well and the allocation of the costs, the designation of Applicant as operator of the Well, and a 200% charge for the risk involved in drilling and completing the Well. The Well is located approximately 13 miles west of Eunice, New Mexico.

District I
1625 N. French Dr., Hobbs, NM 88240
District II
811 S. First St., Artesia, NM 88210
District III
1000 Rio Brazon Road, Artec, NM 87410
District IV
1220 S. St Francis Dr., NM 87505
Phone: (505) 476-3460 Fax (505) 476-3462

State of New Mexico
Energy, Minerals & Natural Resources Department
OIL CONSERVATION DIVISION
1220 South St. Francis Dr.
Santa Fe, NM 87505

Form C-102

Revised August 1, 2011

Submit one copy to appropriate
District Office

☐ AMENDED REPORT

WELL LOCATION AND ACREAGE DEDICATION PLAT

¹ API Number 30-025-52194	² Pool Code 98136	³ Pool Name WC-025 G-07 S223505N; Bone Spring
⁴ Property Code 334831	⁵ Property Name BUTTERS STOTCH 8 STATE COM	⁶ Well Number #123H
⁷ OGRID No. 372165	⁸ Operator Name PERMIAN RESOURCES OPERATING, LLC	⁹ Elevation 3,573'

¹⁰ Surface Location

UL or lot no.	Section	Township	Range	Lot Idn	Feet from the	North/South line	Feet from the	East/West line	County
I	8	22 S	35 E		2,452'	SOUTH	1,157'	EAST	LEA

¹¹ Bottom Hole Location If Different From Surface

UL or lot no.	Section	Township	Range	Lot Idn	Feet from the	North/South line	Feet from the	East/West line	County
O	17	22 S	35 E		100'	SOUTH	2,145'	EAST	LEA

¹² Dedicated Acres 240	¹³ Joint or Infill	¹⁴ Consolidation Code	¹⁵ Order No.
--------------------------------------	-------------------------------	----------------------------------	-------------------------

No allowable will be assigned to this completion until all interests have been consolidated or a non-standard unit has been approved by the division.

	<p>SURFACE HOLE LOCATION & KICK-OFF POINT 2,452' FSL & 1,157' FEL NM EAST-NAD 83 NORTH: 512,637.76' EAST: 834,062.65' LAT: 32.40573913 LONG: -103.38484021 NM EAST-NAD 27 NORTH: 512,576.81' EAST: 792,879.01' LAT: 32.40561443 LONG: -103.38436346</p> <p>FIRST TAKE POINT & PENETRATION POINT 1 2,540' FSL & 2,145' FEL NM EAST-NAD 83 NORTH: 512,713.37' EAST: 833,073.70' LAT: 32.40597102 LONG: -103.38804207 NM EAST-NAD 27 NORTH: 512,652.43' EAST: 791,890.09' LAT: 32.40584634 LONG: -103.38756514</p> <p>PENETRATION POINT 2 0' FNL & 2,145' FEL NM EAST-NAD 83 NORTH: 510,173.45' EAST: 833,096.17' LAT: 32.39898963 LONG: -103.38804203 NM EAST-NAD 27 NORTH: 510,112.58' EAST: 791,912.51' LAT: 32.39886492 LONG: -103.38756530</p> <p>LAST TAKE POINT & BOTTOM HOLE LOCATION 100' FSL & 2,145' FEL NM EAST-NAD 83 NORTH: 504,996.22' EAST: 833,141.75' LAT: 32.38475911 LONG: -103.38804263 NM EAST-NAD 27 NORTH: 504,935.49' EAST: 791,957.99' LAT: 32.38463434 LONG: -103.38756630</p>	<p>17 OPERATOR CERTIFICATION I hereby certify that the information contained herein is true and complete to the best of my knowledge and belief, and that this organization either owns a working interest or unleased mineral interest in the land including the proposed bottom hole location or has a right to drill this well at this location pursuant to a contract with an owner of such a mineral or working interest, or to a voluntary pooling agreement or a compulsory pooling order heretofore entered by the division.</p> <p><i>K. Schlichting</i> 10/31/23 Signature Date Kania Schlichting 10/31/23 Printed Name Date kanicia.schlichting@permianres.com 10/31/23 Email Address Date</p>
	<p>CORNER COORDINATES NEW MEXICO EAST-NAD 83 A-CALCULATED CORNER N: 515,397.31' E: 829,901.27' B-FOUND 1" IRON PIPE N: 515,449.12' E: 832,548.57' C-FOUND NAIL N: 515,485.49' E: 835,194.28' D-FOUND 2" IRON PIPE N: 510,200.16' E: 835,241.00' E-FOUND 2" IRON PIPE N: 504,920.36' E: 835,287.50' F-FOUND IRON ROD N: 504,860.89' E: 830,002.73' G-FOUND 2" IRON PIPE N: 510,134.32' E: 829,952.96' H-FOUND IRON PIPE N: 512,773.96' E: 829,929.62'</p>	<p>18 SURVEYOR CERTIFICATION I hereby certify that the well location shown on this plat was plotted from field notes of actual surveys made by me or under my supervision, and that the same is true and correct to the best of my belief.</p> <p>Date: 9/12/2023</p> <p> MARK J. MURRAY P.L.S. NO. 12177</p>
	<p>Permian Resources Operating, LLC Case No. 23952 Exhibit A-2</p>	

Exhibit
Butters Stotch 123H & 124H Ownership Map
Township 22 South - Range 35 East, Lea County, New Mexico

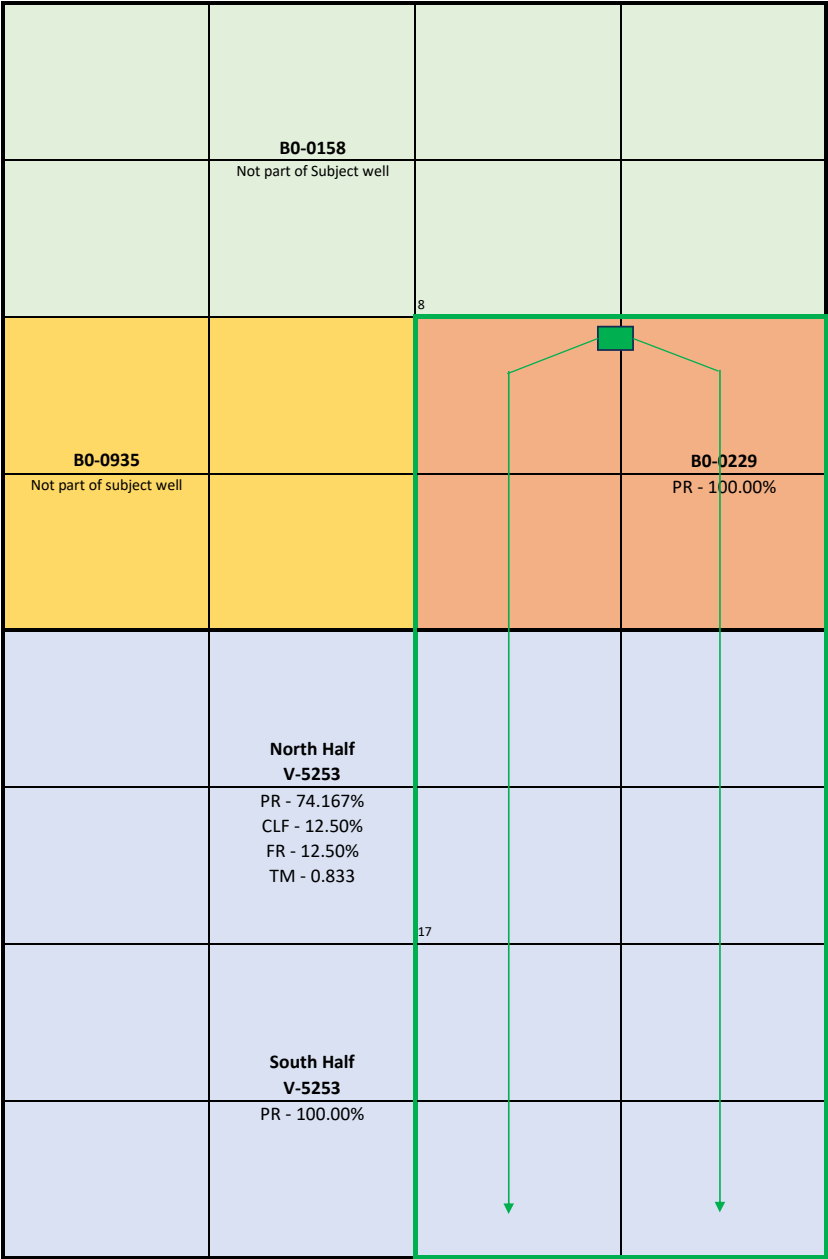

PR	Permian Resources Operating, LLC 300 N. Marienfeld Street, Ste. 1000 Midland, TX 79701	ORRI	Chevron USA, Inc. 6301 Deauville Blvd. Midland, TX 79706	B0-0229
FR	FR Energy, LLC 55 Waugh Drive, Suite 1200 Houston, TX 77007			
CLF	CL&F Operating, LLC 16945 Northcase Drive, Suite 1500 Houston, TX 77060			
TM	Timothy R. MacDonald 3017 Avenue O Galveston, TX 77550			
EP	Earthstone Permian, LLC 31400 Woodloch Forest Drive, Suite 300 The Woodlands, TX 77380 <small>*May own all or a portion of what Permian Resources is listed as owning in V-5253. All documents had been sent to Title Attorney for review. However, Earthsone did merge into Permian Resources, effective 11/1/2023.</small>			

Permian Resources Operating, LLC
Case No. 23952
Exhibit A-3

Unit Size 480.0000000

B0-0229

160

Working Interest

Name	Interest	Acres	Unit Participation
Permian Resources Operating, LLC	1.0000000	160.0000000	0.3333333
Total	1.0000000	160.0000000	0.3333333

V-5253 - North Half

160

Working Interest

Name	Interest	Acres	Unit Participation
Permian Resources Operating, LLC	0.7416700	118.6672000	0.2472233
CL&F Operating, LLC	0.1250000	20.0000000	0.0416667
FR Energy, LLC	0.1250000	20.0000000	0.0416667
Timothy MacDonald	0.0083300	1.3328000	0.0027767
Total	1.0000000	160.0000000	0.3333333

V-5253 - South Half

160

Working Interest

Name	Interest	Acres	Unit Participation
Permian Resources Operating, LLC	1.0000000	160.0000000	0.3333333
Total	1.0000000	160.0000000	0.3333333

Unit Total 1.0000000

Pooled Parties are Highlighted in Yellow

Unit Size

480.0000000

B0-0229

160

Net Interest

Name	Interest	Acres	Unit Participation
Permian Resources Operating, LLC	0.8250000	132.0000000	0.2750000
Chisholm Energy Operating, LLC	0.0500000	8.0000000	0.0166667
Royalty - State of NM	0.1250000	20.0000000	0.0416667
Total	1.0000000	160.0000000	0.3333333

V-5253 - North Half

160

Net Interest

Name	Interest	Acres	Unit Participation
Permian Resources Operating, LLC	0.5945721	95.1315408	0.1981907
CL&F Operating, LLC	0.0983333	15.7333344	0.0327778
FR Energy, LLC	0.0983333	15.7333344	0.0327778
Timothy MacDonald	0.0066779	1.0684608	0.0022260
Nearburg Exploration Company, LLC	0.0037500	0.6000000	0.0012500
Nearburg Producing Company Employee Fund	0.0100000	1.6000000	0.0033333
Map2004-OK	0.0050000	0.8000000	0.0016667
Providence Minerals, LLC	0.0166667	2.6666640	0.0055556
Royalty - State of NM	0.1666667	26.6666656	0.0555556
Total	1.0000000	160.0000000	0.3333333

V-5253 - South Half

160

Net Interest

Name	Interest	Acres	Unit Participation
Permian Resources Operating, LLC	0.8333333	133.3333328	0.2777778
Royalty - State of NM	0.1666667	26.6666672	0.0555556
Total	1.0000000	160.0000000	0.3333333

Unit Total

1.0000000

Pooled Parties are Highlighted in Yellow



300 N. MARIENFELD STREET, SUITE 1000
MIDLAND, TX 79701

OFFICE 432.695.4222
FAX 432.695.4063

August 3, 2023

Via Certified Mail

Timothy R. MacDonald
3003 Paleo PT
College Station, TX 77845

RE: Well Proposals – Butters Stotch 8 State Com 123H & 124H
E/2 of Section 17 & SE/4 of Section 8, T22S-R35E
Lea County, New Mexico

To Whom It May Concern:

Permian Resources Operating, LLC ("Permian"), as Operator, hereby proposes the drilling and completion of the Butters Stotch 8 State Com 123H and Butters Stotch 8 State Com 124H ("Well(s)") at the following approximate locations within Township 22 South, Range 35 East:

1. Butters Stotch 8 State Com 123H

SHL: NW/4SE/4 of Section 8 (Unit J) or another legal location within the SE/4 of Section 8
BHL: 1,980' FEL & 50' FSL of Section 17
FTP: 1,980' FEL & 2,540' FSL of Section 8
LTP: 1,980' FEL & 100' FSL of Section 17
TVD: 10,350'
TMD: 17,850'
Proration: W/2E/2 of Section 17 & W/2SE/4 of Section 8, T22S-R35E
Targeted Interval: 2nd Bone Spring
Total Cost: See attached AFE

2. Butters Stotch 8 State Com 124H

SHL: NW/4SE/4 of Section 8 (Unit J) or another legal location within the SE/4 of Section 8
BHL: 660' FEL & 50' FSL of Section 17
FTP: 660' FEL & 2,540' FSL of Section 8
LTP: 660' FEL & 100' FSL of Section 17
TVD: 10,350'
TMD: 17,850'
Proration: E/2E/2 of Section 17 & E/2SE/4 of Section 8, T22S-R35E
Targeted Interval: 2nd Bone Spring
Total Cost: See attached AFE

Please note that the surface hole locations listed above are currently planned for the NW/4SE/4 of Section 8, but onsite are presently being conducted and surface hole locations may move to another legal location within the SE/4 of Section 8. All other locations, TVDs, and targets are also approximate and subject to change dependent on

Permian Resources Operating, LLC
Case No. 23952
Exhibit A-4

surface or subsurface issues encountered. Permian is proposing to drill these Wells under the modified terms of the 1989 AAPL Operating Agreement and a form of said Operating Agreement will be provided upon request. The Operating Agreement will include the following general provisions:

- 100%/300%/300% non-consent provisions
- \$10,000/\$1,000 drilling and producing rates
- Permian Resources Operating, LLC named as Operator

Please indicate your election to participate in the drilling and completion of the proposed Wells in the space provided below. Please sign and return one copy of this letter, a signed copy of the proposed AFE, and your geologic well requirements.

In the interest of time, should we not reach an agreement within thirty (30) days of the date of your receipt of this letter, Permian will apply to the New Mexico Oil Conservation Division for compulsory pooling of your interest into a spacing unit for the proposed Wells. If you do not wish to participate, Permian would be interested in acquiring your interest in the subject lands which is subject to further mutually agreeable negotiation.

Thank you for your time and consideration, if you have any questions at all, please don't hesitate to contact me at 432.315.0102 or by email at chris.astwood@permianres.com.

Respectfully,

PERMIAN RESOURCES OPERATING, LLC



Chris Astwood
Senior Landman

Enclosures

Elections on page to follow.

<u>Well Elections:</u>		
(Please indicate your response in the spaces below)		
Well	Elect to Participate	Elect to go Non-Consent
Butters Stotch 8 State Com 123H		
Butters Stotch 8 State Com 124H		

Timothy R. MacDonald

By: _____

Printed Name: _____

Title: _____

Date: _____



300 N. MARIENFELD STREET, SUITE 1000
MIDLAND, TX 79701

OFFICE 432.695.4222
FAX 432.695.4063

August 3, 2023

Via Certified Mail

Timothy R. MacDonald
3017 Avenue O
Galveston, TX 77550

RE: Well Proposals – Butters Stotch 8 State Com 123H & 124H
E/2 of Section 17 & SE/4 of Section 8, T22S-R35E
Lea County, New Mexico

To Whom It May Concern:

Permian Resources Operating, LLC ("Permian"), as Operator, hereby proposes the drilling and completion of the Butters Stotch 8 State Com 123H and Butters Stotch 8 State Com 124H ("Well(s)") at the following approximate locations within Township 22 South, Range 35 East:

1. Butters Stotch 8 State Com 123H

SHL: NW/4SE/4 of Section 8 (Unit J) or another legal location within the SE/4 of Section 8

BHL: 1,980' FEL & 50' FSL of Section 17

FTP: 1,980' FEL & 2,540' FSL of Section 8

LTP: 1,980' FEL & 100' FSL of Section 17

TVD: 10,350'

TMD: 17,850'

Proration: W/2E/2 of Section 17 & W/2SE/4 of Section 8, T22S-R35E

Targeted Interval: 2nd Bone Spring

Total Cost: See attached AFE

2. Butters Stotch 8 State Com 124H

SHL: NW/4SE/4 of Section 8 (Unit J) or another legal location within the SE/4 of Section 8

BHL: 660' FEL & 50' FSL of Section 17

FTP: 660' FEL & 2,540' FSL of Section 8

LTP: 660' FEL & 100' FSL of Section 17

TVD: 10,350'

TMD: 17,850'

Proration: E/2E/2 of Section 17 & E/2SE/4 of Section 8, T22S-R35E

Targeted Interval: 2nd Bone Spring

Total Cost: See attached AFE

Please note that the surface hole locations listed above are currently planned for the NW/4SE/4 of Section 8, but onsite are presently being conducted and surface hole locations may move to another legal location within the SE/4 of Section 8. All other locations, TVDs, and targets are also approximate and subject to change dependent on surface or subsurface issues encountered. Permian is proposing to drill these Wells under the modified terms of the 1989 AAPL Operating Agreement and a form of said

Operating Agreement will be provided upon request. The Operating Agreement will include the following general provisions:

- 100%/300%/300% non-consent provisions
- \$10,000/\$1,000 drilling and producing rates
- Permian Resources Operating, LLC named as Operator

Please indicate your election to participate in the drilling and completion of the proposed Wells in the space provided below. Please sign and return one copy of this letter, a signed copy of the proposed AFE, and your geologic well requirements.

In the interest of time, should we not reach an agreement within thirty (30) days of the date of your receipt of this letter, Permian will apply to the New Mexico Oil Conservation Division for compulsory pooling of your interest into a spacing unit for the proposed Wells. If you do not wish to participate, Permian would be interested in acquiring your interest in the subject lands which is subject to further mutually agreeable negotiation.

Thank you for your time and consideration, if you have any questions at all, please don't hesitate to contact me at 432.315.0102 or by email at chris.astwood@permianres.com.

Respectfully,

PERMIAN RESOURCES OPERATING, LLC



Chris Astwood
Senior Landman

Enclosures

Elections on page to follow.

<u>Well Elections:</u>		
(Please indicate your response in the spaces below)		
Well	Elect to Participate	Elect to go Non-Consent
Butters Stotch 8 State Com 123H		
Butters Stotch 8 State Com 124H		

Timothy R. MacDonald

By: _____

Printed Name: _____

Title: _____

Date: _____

PERMIAN

RESOURCES

Butters Stotch 8 State Com 123H – Chronology of Communication/Events

August 3, 2023 – Well Proposals sent to WI parties

August 8, 2023 – Emails with CL&F Operating on JOA proposal

August 9, 2023 – Emails with FR Energy, LLC regarding WI/NRI calculations

Emails with CL&F Operating on WI/NRI

August 16, 2023 – Emails with FR Energy, LLC regarding WI/NRI calculations

August 29, 2023 – FR Energy, LLC returns signed well elections

August 31, 2023 – Emails with CL&F Operating on development plans

September 19, 2023 – Emails with CL&F Operating on development plans

September 27, 2023 – Email JOA draft to CL&F Operating for review.

October 11, 2023 – Email negotiations over JOA with CL&F. Acceptance of JOA terms with CL&F.

November 16, 2023 – CL&F returns signed AFE's

Permian Resources Operating, LLC
Case No. 23952
Exhibit A-5

STATE OF NEW MEXICO
DEPARTMENT OF ENERGY, MINERALS AND NATURAL RESOURCES
OIL CONSERVATION DIVISION

APPLICATION OF PERMIAN RESOURCES
OPERATING, LLC FOR COMPULSORY
POOLING, LEA COUNTY, NEW MEXICO.

CASE NO. 23952

SELF-AFFIRMED STATEMENT
OF IRA BRADFORD

1. I am a geologist with Permian Resources Operating, LLC ("Permian Resources"). I am over 18 years of age, have personal knowledge of the matters addressed herein, and am competent to provide this Self-Affirmed Statement. I have previously testified before the New Mexico Oil Conservation Division ("Division") and my credentials as an expert in petroleum geology were accepted and made a matter of record.

2. I am familiar with the geological matters that pertain to the above-referenced case.

3. **Exhibit B-1** is a regional locator map that identifies the Butters Stotch project area, in proximity to the Capitan Reef within the Delaware Basin, for the Bone Spring horizontal spacing unit that is the subject of this application.

4. **Exhibit B-2** is a cross section location map for the proposed horizontal spacing unit ("Unit") within the Bone Spring formation, which is highlighted with a blue box. The approximate wellbore path for the proposed **Butters Stotch 8 State Com 123H** well ("Well") is represented by a dashed black line. Existing producing wells in the targeted interval are represented by solid orange lines. This map identifies the cross-section running from A-A' with the cross-section wells name and a black line in proximity to the proposed Well.

5. **Exhibit B-3** is a Subsea Structure map on the Bone Spring formation in TVD subsea with a contour interval of 50 ft. The approximate wellbore path for the proposed Well is represented by a dashed orange line. It also identifies the location of the cross-section running

Permian Resources Operating, LLC
Case No. 23952
Exhibit B

from A-A' in proximity to the proposed Well. The data points are indicated by red triangles. The map demonstrates the formation is gently dipping to the southwest in this area. I do not observe any faulting, pinch-outs, or geologic impediments to developing the targeted intervals with horizontal wells.

6. **Exhibit B-4** identifies two wells penetrating the targeted interval I used to construct a stratigraphic cross-section from A to A'. It contains gamma ray, resistivity, and porosity logs. The cross section is oriented from north to south and is hung on the top of the Second Bone Spring formation. The proposed landing zone for the Well is labeled on the exhibit. The approximate well-path for the proposed Well is indicated by a dashed orange line to be drilled from north to south across the units. This cross-section demonstrates the target interval is continuous across the Unit.

7. **Exhibit B-5** is a gun barrel diagram that shows the wells in the Bone Spring formation. The individual spacing units are outlined in blue boxes and are identified with their respective case numbers.

8. In my opinion, a stand-up orientation for the Well is appropriate to properly develop the subject acreage because of consistent rock properties throughout the Unit and is the preferred fracture orientation in this portion of the trend.

9. Based on my geologic study of the area, the targeted interval underlying the Unit is suitable for development by horizontal wells and the tracts comprising the Unit will contribute more or less equally to the production of the Well.

10. In my opinion, the granting of Permian Resources' application will serve the interests of conservation, the protection of correlative rights, and the prevention of waste.

11. The exhibits attached hereto were either prepared by me or under my supervision or were compiled from company business records.

12. I understand this Self-Affirmed Statement will be used as written testimony in this case. I affirm my testimony above is true and correct and is made under penalty of perjury under the laws of the State of New Mexico. My testimony is made as of the date identified next to my signature below.

Ira Bradford

11/30/2023
Date

Regional Locator Map

Butters Stotch 8 State Com

Permian Resources Operating, LLC
Case No. 23952
Exhibit B-1

Exhibit B-1

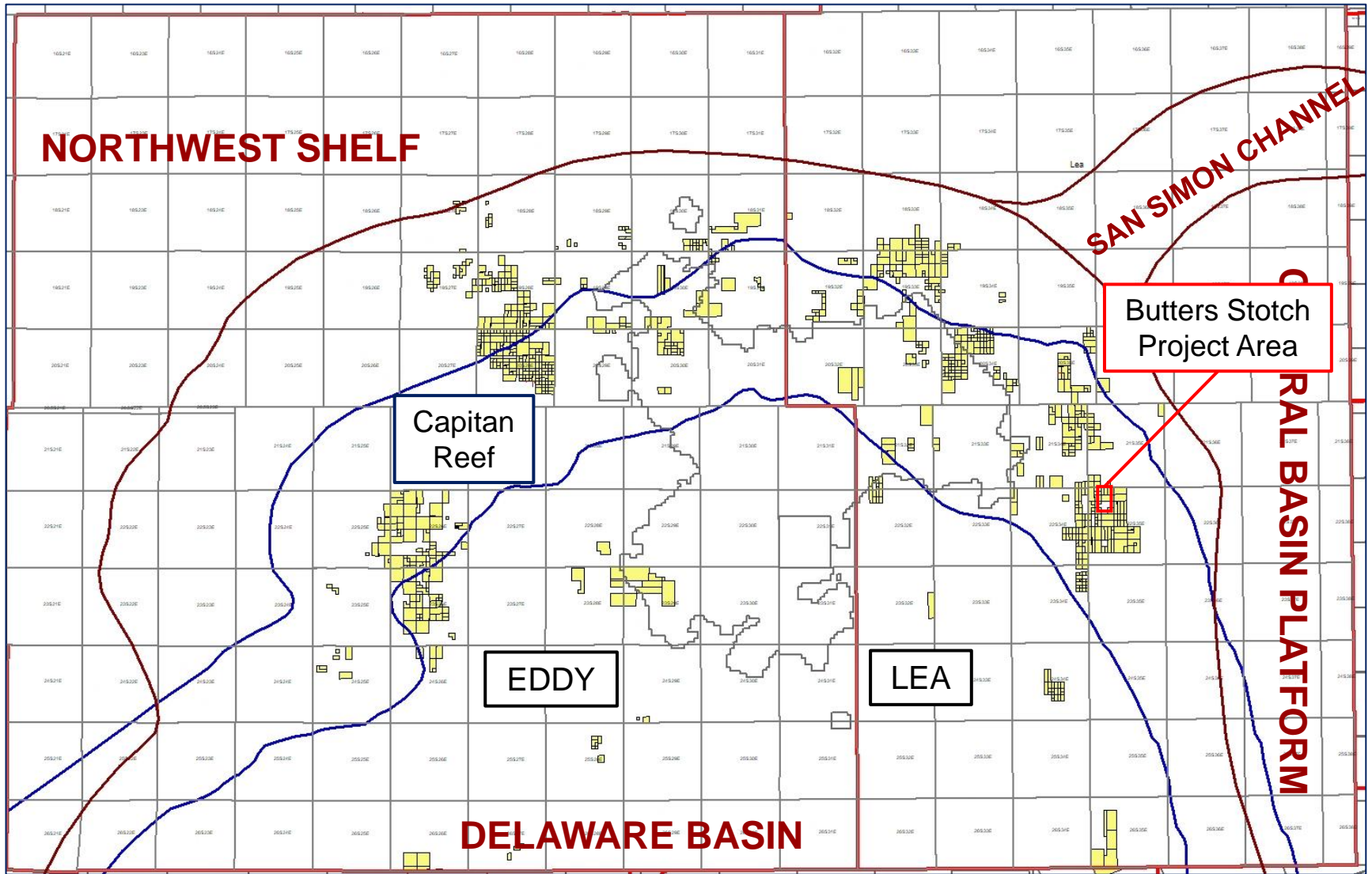

Permian Resources

Cross-Section Locator Map

Butters Stotch 8 State Com

Case No. 23952

Exhibit B-2

Exhibit B-2

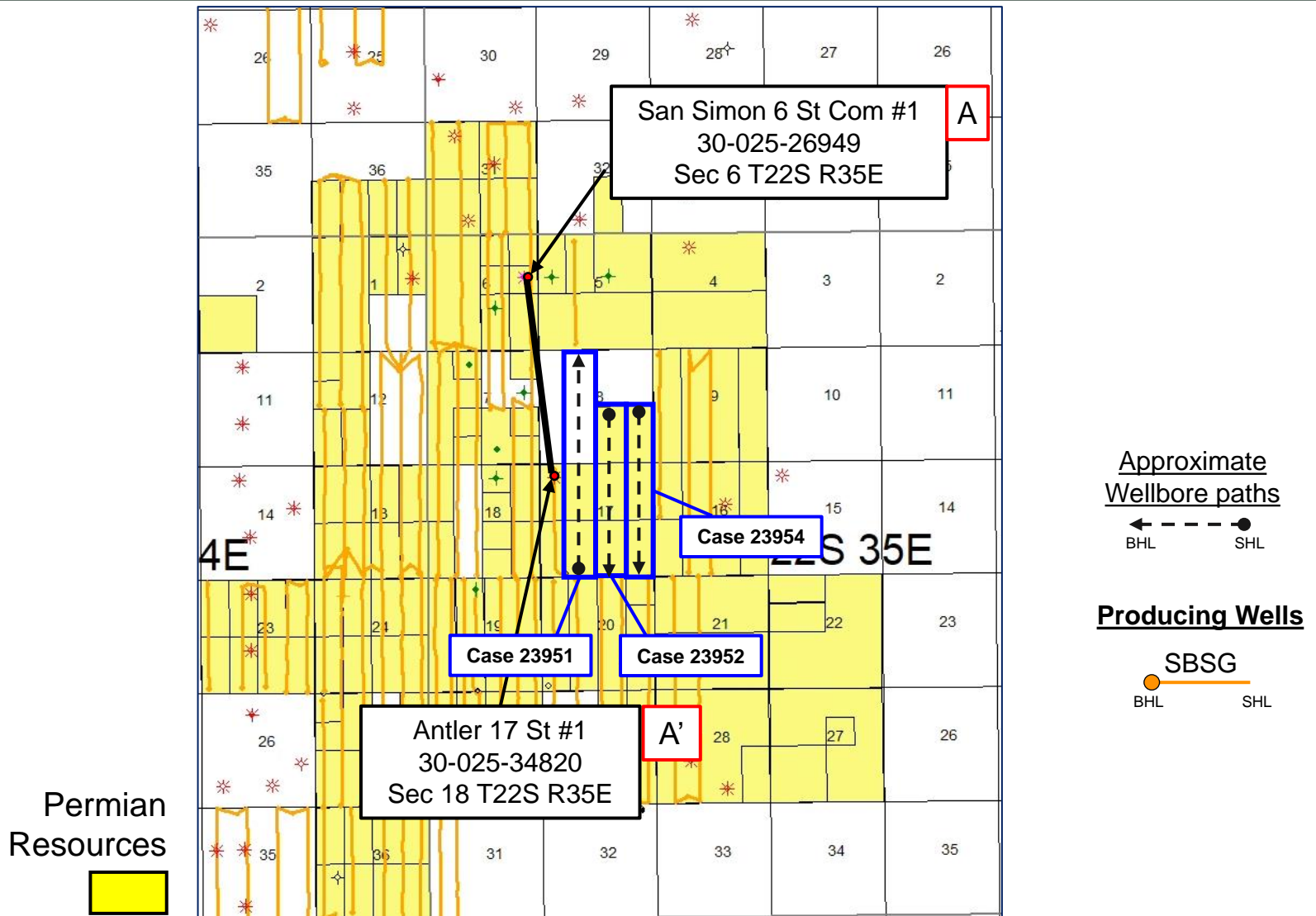



Second Bone Spring – Structure Map

Butters Stotch 8 State Com

Exhibit B-3

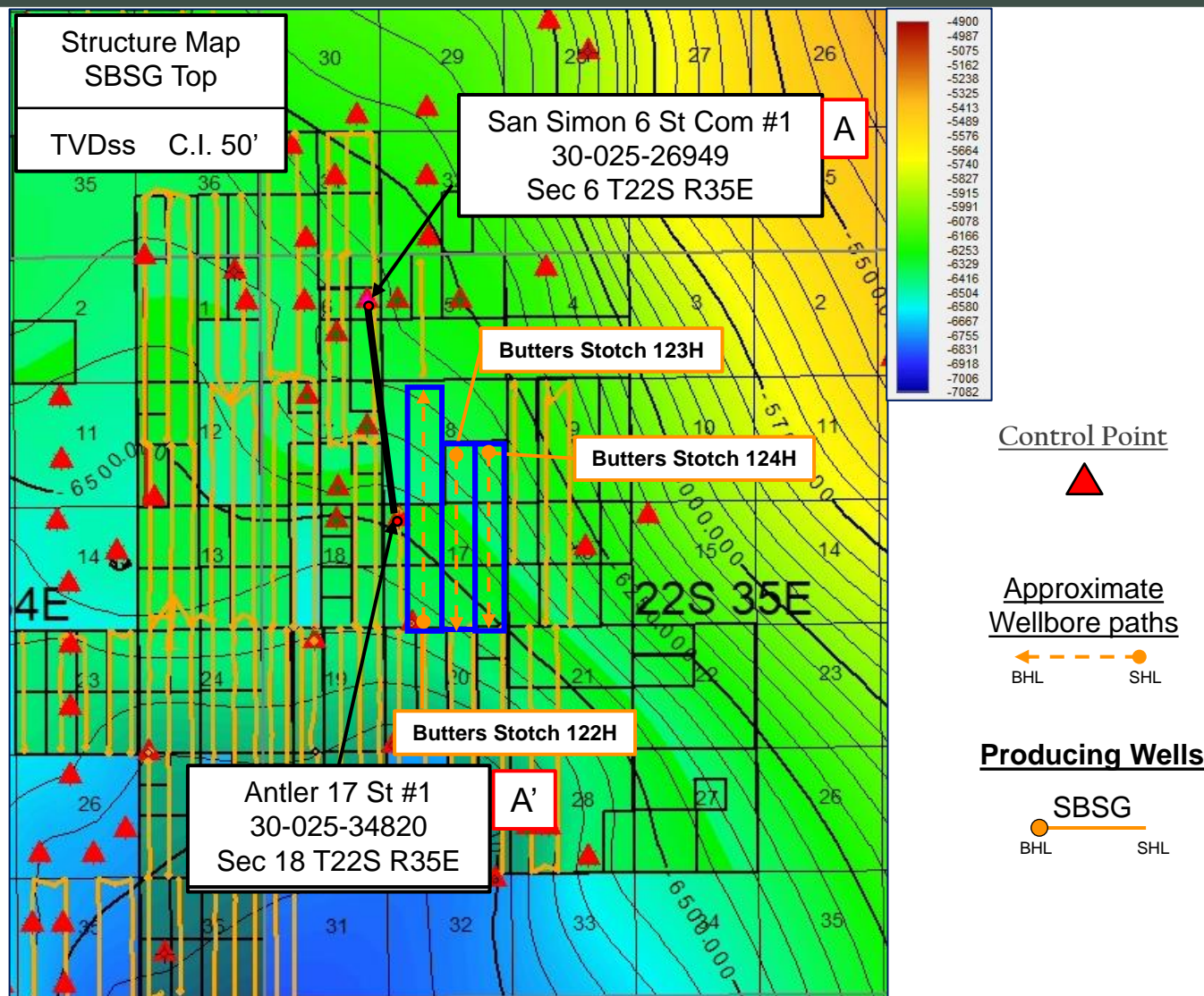

Stratigraphic Cross-Section A-A'

Butters Stotch 8 State Com

Permian Resources Operating, LLC
Case No. 23952
Exhibit B-4

Exhibit B-4

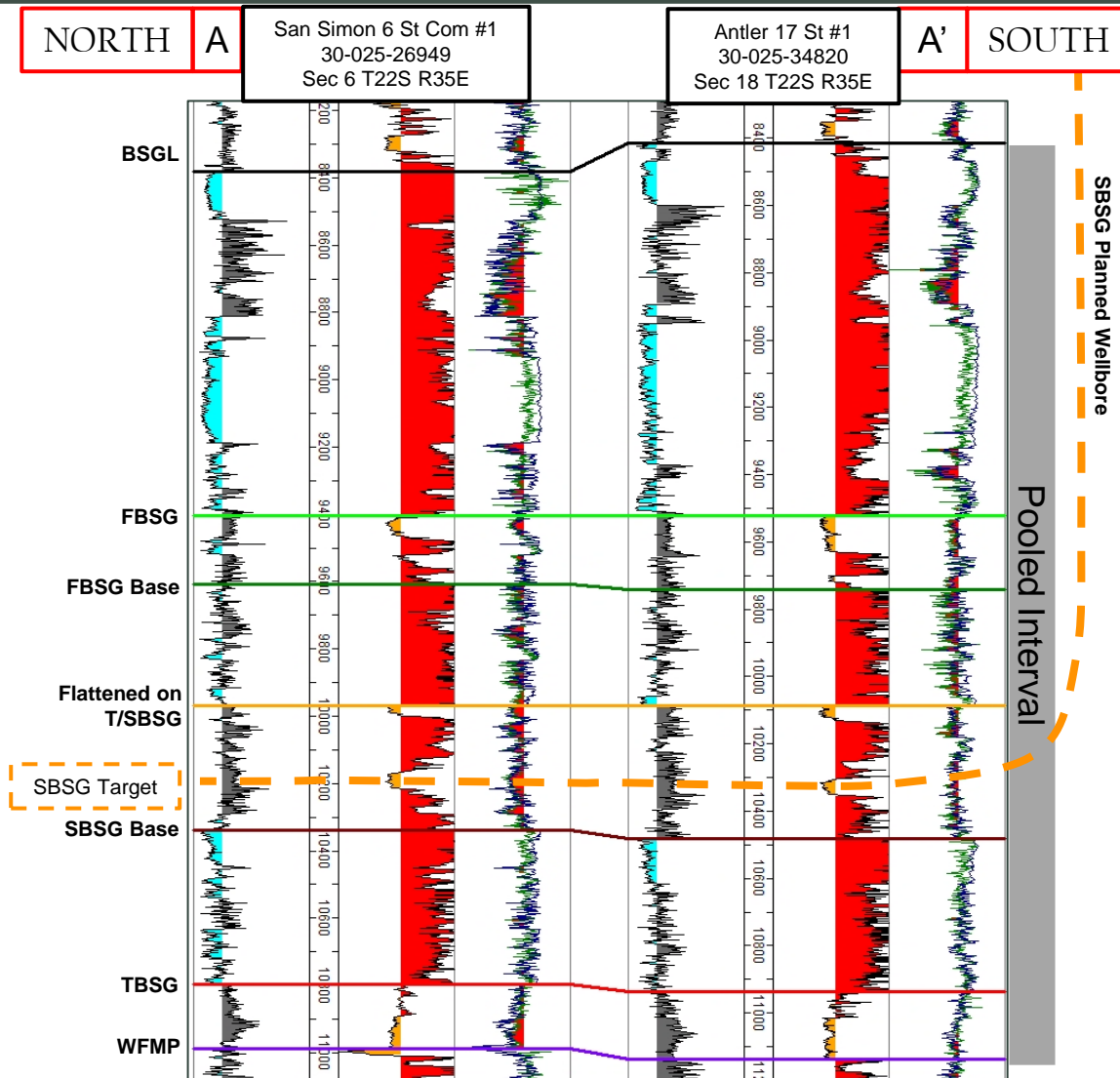

Gun Barrel Development Plan

Butters Stotch 8 State Com

Permian Resources Operating, LLC
Case No. 23952
Exhibit B-5

Exhibit B-5

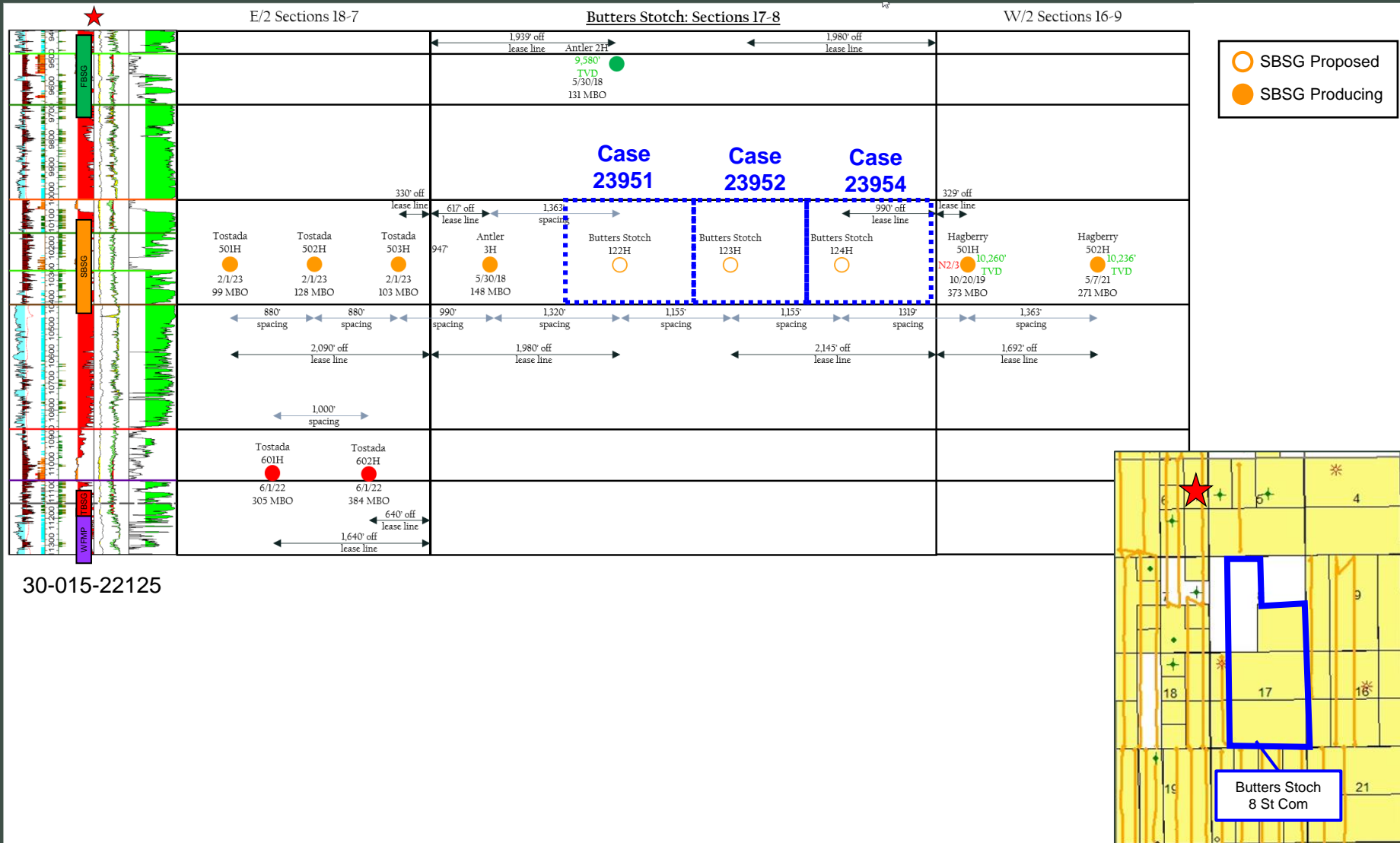

**STATE OF NEW MEXICO
DEPARTMENT OF ENERGY, MINERALS AND NATURAL RESOURCES
OIL CONSERVATION DIVISION**

**APPLICATION OF PERMIAN RESOURCES
OPERATING, LLC FOR COMPULSORY
POOLING, LEA COUNTY, NEW MEXICO.**

CASE NO. 23952

**SELF-AFFIRMED STATEMENT
OF DANA S. HARDY**

1. I am attorney in fact and authorized representative of Permian Resources Operating, LLC, the Applicant herein.

2. I am familiar with the Notice Letters attached as **Exhibit C-1** and caused the Notice Letters, along with the Application in this case, to be sent to the parties set out in the chart attached as **Exhibit C-2**.

3. Exhibit C-2 also provides the date each Notice Letter was sent and the date each return was received.

4. Copies of the certified mail green cards and white slips are attached as **Exhibit C-3** as supporting documentation for proof of mailing and the information provided on Exhibit C-2.

5. On November 10, 2023, I caused a notice to be published to all interested parties in the Hobbs News-Sun. An Affidavit of Publication from the Legal Clerk of the Hobbs News-Sun, along with a copy of the notice publication, is attached as **Exhibit C-4**.

6. I understand this Self-Affirmed Statement will be used as written testimony in the subject cases. I affirm that my testimony above is true and correct and it made under penalty of perjury under the laws of the State of New Mexico. My testimony is made as of the date handwritten next to my signature below.

/s/ Dana S. Hardy
Dana S. Hardy

December 4, 2023
Date

**Permian Resources Operating, LLC
Case No. 23952
Exhibit C**



hinklelawfirm.com

HINKLE SHANOR LLP**ATTORNEYS AT LAW**

P.O. BOX 2068

SANTA FE, NEW MEXICO 87504

505-982-4554 (FAX) 505-982-8623

WRITER:
Dana S. Hardy, Partner
dhardy@hinklelawfirm.com

November 15, 2023

VIA CERTIFIED MAIL
RETURN RECEIPT REQUESTED**TO ALL PARTIES ENTITLED TO NOTICE****Re: Case No. 23952 – Application of Permian Resources Operating, LLC for Compulsory Pooling, Lea County, New Mexico.**

To whom it may concern:

This letter is to advise you that the enclosed application was filed with the New Mexico Oil Conservation Division. The hearing will be conducted on **December 7, 2023**, beginning at 8:15 a.m.

Hearings are currently conducted remotely. To participate in the electronic hearing, see the instructions posted on the OCD Hearings website: <https://www.emnrd.nm.gov/ocd/hearing-info/>. You are not required to attend this hearing, but as an owner of an interest that may be affected by this application, you may appear and present testimony. Failure to appear at that time and become a party of record will preclude you from challenging the matter at a later date.

Pursuant to Division Rule 19.15.4.13.B, a party who intends to present evidence at the hearing shall file a pre-hearing statement and serve copies on other parties, or the attorneys of parties who are represented by counsel, at least four business days in advance of a scheduled hearing, but in no event later than 5:00 p.m. Mountain Time, on the Thursday preceding the scheduled hearing date. The statement must be submitted through the OCD E-Permitting system (<https://wwwapps.emnrd.nm.gov/ocd/ocdpermitting/>) or via e-mail to ocd.hearings@emnrd.nm.gov and should include: the names of the parties and their attorneys, a concise statement of the case, the names of all witnesses the party will call to testify at the hearing, the approximate time the party will need to present its case, and identification of any procedural matters that are to be resolved prior to the hearing.

Please contact Chris Astwood with Permian Resources at 432-315-0102 if you have questions regarding this matter.

Sincerely,

/s/ Dana S. Hardy

Dana S. Hardy

**Permian Resources Operating,
LLC Case No. 23952
Exhibit C-1**

Enclosure

PO BOX 10
ROSWELL, NEW MEXICO 88202
(575) 622-6510
FAX (575) 623-93327601 JEFFERSON ST NE · SUITE 180
ALBUQUERQUE, NEW MEXICO 87109
505-858-8320
(FAX) 505-858-8321PO BOX 2068
SANTA FE, NEW MEXICO 87504
(505) 982-4554
FAX (505) 982-8623

**STATE OF NEW MEXICO
DEPARTMENT OF ENERGY, MINERALS AND NATURAL RESOURCES
OIL CONSERVATION DIVISION**

**APPLICATION OF PERMIAN RESOURCES
OPERATING, LLC FOR COMPULSORY
POOLING, LEA COUNTY, NEW MEXICO.**

CASE NO. 23952

NOTICE LETTER CHART

PARTY	NOTICE LETTER SENT	RETURN RECEIVED
CL&F Operating, LLC 16945 Northcase Drive, Ste 1500 Houston, TX 77060	11/15/23	Per USPS Tracking Last Checked 12/01/23): 11/22/23 – Item being returned to sender.
CL&F Operating LLC 1700 City Plaza Dr., Ste. 360 Spring, TX 77389	11/15/23	Per USPS Tracking Last Checked 12/01/23): 11/20/23 – Delivered to individual at the address.
Chevron USA, Inc. 6301 Deauville Blvd. Midland, TX 79706	11/15/23	11/27/23
FR Energy, LLC 55 Waugh Dr., Ste. 1200 Houston, TX 77007	11/15/23	Per USPS Tracking Last Checked 12/01/23): 11/29/23 – Item in transit to next facility.
Timothy R. MacDonald 3003 Paleo PT College Station, TX 77845	11/15/23	11/27/23
Timothy R. MacDonald 3017 Avenue O Galveston, TX 77550	11/15/23	Per USPS Tracking Last Checked 12/01/23): 11/25/23 – Delivery attempted.
Map2004-OK P101 North Robinson, Suite 1000 Oklahoma City, OK 73102	11/15/23	11/27/23
Nearburg Exploration Company, LLC 5447 Glen Lakes Drive Dallas, TX 75231	11/15/23	12/01/23
Nearburg Producing Company Employee Fund P.O. Box 823085 Dallas, TX 75382	11/15/23	12/01/23

**Permian Resources Operating, LLC Case
No. 23952
Exhibit C-2**

**STATE OF NEW MEXICO
DEPARTMENT OF ENERGY, MINERALS AND NATURAL RESOURCES
OIL CONSERVATION DIVISION**

**APPLICATION OF PERMIAN RESOURCES
OPERATING, LLC FOR COMPULSORY
POOLING, LEA COUNTY, NEW MEXICO.**

CASE NO. 23952

NOTICE LETTER CHART

Providence Minerals, LLC P16400 Dallas Parkway, Suite 400 Dallas, TX 75248	11/15/23	11/27/23
State of New Mexico 310 Old Santa Fe Trl Santa Fe, NM 87501	11/15/23	11/27/23

7022 1670 0002 1189 1306

CERTIFIED MAIL® RECEIPT
 Domestic Mail Only
For delivery information, visit our website at www.usps.com®.**OFFICIAL USE**

Certified Mail Fee

\$

Extra Services & Fees (check box, add fee as appropriate)

- ☐ Return Receipt (hardcopy) \$
☐ Return Receipt (electronic) \$
☐ Certified Mail Restricted Delivery \$
☐ Adult Signature Required \$
☐ Adult Signature Restricted Delivery \$

Postage

\$

Total Postage and Fees

\$

Sent To

Chevron USA, Inc.
 6301 Deauville Blvd.
 Midland, TX 79706
 23952 - Permian Butters Stotch

PS Form 3800, April 2015 PSN 7530-02-000-9047

See Reverse for Instructions

Postmark
Here

NOV 15 2023

SENDER: COMPLETE THIS SECTION

- Complete items 1, 2, and 3.
- Print your name and address on the reverse so that we can return the card to you.
- Attach this card to the back of the mailpiece, or on the front if space permits.

1. Article Addressed to:

Chevron USA, Inc.
 6301 Deauville Blvd.
 Midland, TX 79706

23952 - Permian Butters Stotch



9590 9402 7635 2122 6515 32

2. Article Number (Transfer from service label)

7022 1670 0002 1189 1306

PS Form 3811, July 2020 PSN 7530-02-000-9053

COMPLETE THIS SECTION ON DELIVERY

A. Signature

X

☐ Agent☐ Addressee

B. Received by (Printed Name)

Ashland Hinkle

C. Date of Delivery

11/26/23

 D. Is delivery address different from item 1? ☐ Yes
 If YES, enter delivery address below: ☐ No
RECEIVED

NOV 27 2023

3. Service Type

- ☐ Adult Signature ☐ Priority Mail Express®
☐ Adult Signature Restricted Delivery ☐ Registered Mail™
☐ Certified Mail® ☐ Registered Mail Restricted Delivery
☐ Certified Mail Restricted Delivery ☐ Signature Confirmation™
☐ Collect on Delivery ☐ Signature Confirmation Restricted Delivery
☐ Collect on Delivery Restricted Delivery
☐ Insured Mail
☐ Insured Mail Restricted Delivery (over \$500)

Hinkle Shanor LLC

Santa Fe, NM 87501

Domestic Return Receipt

Permian Resources Operating, LLC
 Case No. 23952
 Exhibit C-3

7022 1670 0002 1189 7162

CERTIFIED MAIL® RECEIPT	
Domestic Mail Only	
For delivery information, visit our website at www.usps.com ®.	
OFFICIAL USE	
Certified Mail Fee	\$
Extra Services & Fees (check box, add fee as appropriate)	
<input type="checkbox"/> Return Receipt (hardcopy)	\$
<input type="checkbox"/> Return Receipt (electronic)	\$
<input type="checkbox"/> Certified Mail Restricted Delivery	\$
<input type="checkbox"/> Adult Signature Required	\$
<input type="checkbox"/> Adult Signature Restricted Delivery	\$
Postage	\$
Total Postage and Fees	\$
Sent To	
Timothy R. MacDonald 3003 Paleo PT College Station, TX 77845 23952 - Permian Butters Stotch	
PS Form 3800, April 2015 PSN 7530-02-000-9047 See Reverse for Instructions	

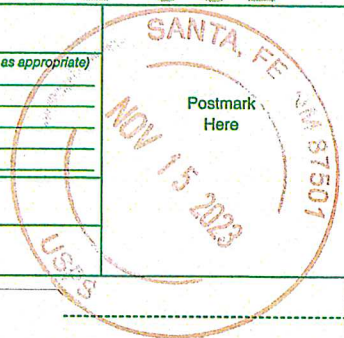

SENDER: COMPLETE THIS SECTION	COMPLETE THIS SECTION ON DELIVERY
<ul style="list-style-type: none"> Complete items 1, 2, and 3. Print your name and address on the reverse so that we can return the card to you. Attach this card to the back of the mailpiece, or on the front if space permits. 	<p>A. Signature</p> <p>X </p> <p><input type="checkbox"/> Agent <input type="checkbox"/> Addressee</p> <p>B. Received by (Printed Name) C. Date of Delivery</p> <p></p> <p>D. Is delivery address different from item 1? <input type="checkbox"/> Yes If YES, enter delivery address below: <input type="checkbox"/> No</p>
<p>1. Article Addressed to:</p> <p>Timothy R. MacDonald 3003 Paleo PT College Station, TX 77845 23952 - Permian Butters Stotch</p>	<p>RECEIVED</p> <p>NOV 27 2023</p>
<p>2. Article Number (Transfer from service label)</p> <p>7022 1670 0002 1189 7162</p>	<p>3. Service Type <u>Hinkle Shanor LLC</u></p> <p><input type="checkbox"/> Adult Signature <u>Santa Fe NM 87501</u></p> <p><input type="checkbox"/> Adult Signature Restricted Delivery</p> <p><input type="checkbox"/> Certified Mail®</p> <p><input type="checkbox"/> Certified Mail Restricted Delivery</p> <p><input type="checkbox"/> Collect on Delivery</p> <p><input type="checkbox"/> Collect on Delivery Restricted Delivery</p> <p><input type="checkbox"/> Insured Mail</p> <p><input type="checkbox"/> Insured Mail Restricted Delivery (over \$500)</p> <p><input type="checkbox"/> Priority Mail Express®</p> <p><input type="checkbox"/> Registered Mail™</p> <p><input type="checkbox"/> Registered Mail Restricted Delivery</p> <p><input type="checkbox"/> Signature Confirmation™</p> <p><input type="checkbox"/> Signature Confirmation Restricted Delivery</p>
PS Form 3811, July 2020 PSN 7530-02-000-9053	
Domestic Return Receipt	

7022 1670 0002 1189 7179

CERTIFIED MAIL® RECEIPT	
Domestic Mail Only	
For delivery information, visit our website at www.usps.com ®.	
OFFICIAL USE	
Certified Mail Fee	
Extra Services & Fees (check box, add fee as appropriate)	
<input type="checkbox"/> Return Receipt (hardcopy)	\$
<input type="checkbox"/> Return Receipt (electronic)	\$
<input type="checkbox"/> Certified Mail Restricted Delivery	\$
<input type="checkbox"/> Adult Signature Required	\$
<input type="checkbox"/> Adult Signature Restricted Delivery	\$
Postage	
Total Postage and Fees	
Sent To	
Map2004-OK P101 North Robinson, Suite 1000 Oklahoma City, OK 73102 23952 - Permian Butters Stotch	
PS Form 3800, April 2015 PSN 7530-02-000-9047 See Reverse for Instructions	

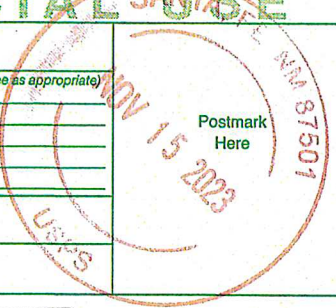

SENDER: COMPLETE THIS SECTION	COMPLETE THIS SECTION ON DELIVERY
<ul style="list-style-type: none"> Complete items 1, 2, and 3. Print your name and address on the reverse so that we can return the card to you. Attach this card to the back of the mailpiece, or on the front if space permits. 	A. Signature X <i>[Signature]</i> <input type="checkbox"/> Agent <input type="checkbox"/> Addressee B. Received by (Printed Name) <i>Alysha Harmon</i> C. Date of Delivery <i>11-2023</i> D. Is delivery address different from item 1? <input type="checkbox"/> Yes <input type="checkbox"/> No If YES, enter delivery address below:
1. Article Addressed to: <div> Map2004-OK P101 North Robinson, Suite 1000 Oklahoma City, OK 73102 23952 - Permian Butters Stotch </div>	<div> RECEIVED NOV 27 2023 </div>
2. Article Number (Transfer from service label) 7022 1670 0002 1189 7179	3. Service Type <i>Hinkle Shanor LLP</i> <input type="checkbox"/> Adult Signature <input type="checkbox"/> Priority Mail Express® <input type="checkbox"/> Adult Signature Restricted Delivery <input type="checkbox"/> Registered Mail™ <input type="checkbox"/> Certified Mail® <input type="checkbox"/> Registered Mail Restricted Delivery <input type="checkbox"/> Certified Mail Restricted Delivery <input type="checkbox"/> Signature Confirmation™ <input type="checkbox"/> Collect on Delivery <input type="checkbox"/> Signature Confirmation Restricted Delivery <input type="checkbox"/> Collect on Delivery Restricted Delivery <input type="checkbox"/> Insured Mail <input type="checkbox"/> Insured Mail Restricted Delivery (over \$500)
PS Form 3811, July 2020 PSN 7530-02-000-9053 Domestic Return Receipt	

7022 1670 0002 1189 1337

CERTIFIED MAIL® RECEIPT	
Domestic Mail Only	
For delivery information, visit our website at www.usps.com ®.	
OFFICIAL USE	
Certified Mail Fee	\$
Extra Services & Fees (check box, add fee as appropriate)	
<input type="checkbox"/> Return Receipt (hardcopy)	\$
<input type="checkbox"/> Return Receipt (electronic)	\$
<input type="checkbox"/> Certified Mail Restricted Delivery	\$
<input type="checkbox"/> Adult Signature Required	\$
<input type="checkbox"/> Adult Signature Restricted Delivery	\$
Postage	\$
Total Postage and Fees	\$
Postmark Here	
NOV 15 2023	
Str Nearburg Exploration Company, LLC 5447 Glen Lakes Drive Dallas, TX 75231 Citi 23952 - Permian Butters Stotch	
PS Form 3800, April 2015 PSN 7530-02-000-9047 See Reverse for Instructions	

SENDER: COMPLETE THIS SECTION	COMPLETE THIS SECTION ON DELIVERY
<ul style="list-style-type: none"> Complete items 1, 2, and 3. Print your name and address on the reverse so that we can return the card to you. Attach this card to the back of the mailpiece, or on the front if space permits. 	A. Signature X <i>Tony Jones</i> <input checked="" type="checkbox"/> Agent <input type="checkbox"/> Addressee B. Received by (Printed Name) <i>TONY JONES</i> C. Date of Delivery <i>11/20/23</i> D. Is delivery address different from item 1? <input type="checkbox"/> Yes <input type="checkbox"/> No If YES, enter delivery address below:
1. Article Addressed to: Nearburg Exploration Company, LLC 5447 Glen Lakes Drive Dallas, TX 75231 23952 - Permian Butters Stotch	RECEIVED DEC 01 2023
2. Article Number (Transfer from service label) 7022 1670 0002 1189 1337	3. Service Type <input type="checkbox"/> Adult Signature <input type="checkbox"/> Priority Mail Express® <input type="checkbox"/> Adult Signature Restricted Delivery <input type="checkbox"/> Registered Mail™ <input type="checkbox"/> Certified Mail® <input type="checkbox"/> Registered Mail Restricted Delivery <input type="checkbox"/> Certified Mail Restricted Delivery <input type="checkbox"/> Signature Confirmation™ <input type="checkbox"/> Collect on Delivery <input type="checkbox"/> Signature Confirmation Restricted Delivery <input type="checkbox"/> Collect on Delivery Restricted Delivery <input type="checkbox"/> Insured Mail <input type="checkbox"/> Insured Mail Restricted Delivery (over \$500)
PS Form 3811, July 2020 PSN 7530-02-000-9053	Domestic Return Receipt

7022 1670 0002 1189 0293

CERTIFIED MAIL® RECEIPT	
Domestic Mail Only	
For delivery information, visit our website at www.usps.com ®.	
OFFICIAL USE	
Certified Mail Fee	\$
Extra Services & Fees (check box, add fee as appropriate)	
<input type="checkbox"/> Return Receipt (hardcopy)	\$
<input type="checkbox"/> Return Receipt (electronic)	\$
<input type="checkbox"/> Certified Mail Restricted Delivery	\$
<input type="checkbox"/> Adult Signature Required	\$
<input type="checkbox"/> Adult Signature Restricted Delivery	\$
Postage	\$
Total Postage and Fees	\$
Sent To	
Nearburg Producing Company Employee Fund	
P.O. Box 823085	
Dallas, TX 75382	
23952 - Permian Butters Stotch	
PS Form 3800, April 2015 PSN 7530-02-000-9047 See Reverse for Instructions.	

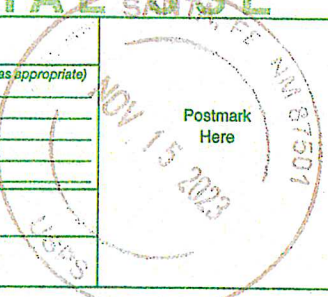

SENDER: COMPLETE THIS SECTION		COMPLETE THIS SECTION ON DELIVERY	
<ul style="list-style-type: none"> Complete items 1, 2, and 3. Print your name and address on the reverse so that we can return the card to you. Attach this card to the back of the mailpiece, or on the front if space permits. 		<p>A. Signature <input checked="" type="checkbox"/> Agent <input type="checkbox"/> Addressee</p> <p>X <i>Tony Jones</i></p>	
<p>1. Article Addressed to:</p> <p>Nearburg Producing Company Employee Fund P.O. Box 823085 Dallas, TX 75382</p> <p>23952 - Permian Butters Stotch</p>		<p>B. Received by (Printed Name) <i>Tony Jones</i></p> <p>C. Date of Delivery <i>11/20/23</i></p>	
<p>2. Article Number (Transfer from service label)</p> <p>7022 1670 0002 1189 0293</p>		<p>D. Is delivery address different from item 1? <input type="checkbox"/> Yes <input type="checkbox"/> No</p> <p>If YES, enter delivery address below:</p> <p>RECEIVED</p> <p>DEC 01 2023</p>	
<p>9590 9402 7635 2122 6647 47</p>		<p>3. Service Type</p> <p><input type="checkbox"/> Adult Signature <input type="checkbox"/> Priority Mail Express®</p> <p><input type="checkbox"/> Adult Signature Restricted Delivery <input type="checkbox"/> Registered Mail™</p> <p><input type="checkbox"/> Certified Mail® <input type="checkbox"/> Registered Mail Restricted Delivery</p> <p><input type="checkbox"/> Certified Mail Restricted Delivery <input type="checkbox"/> Signature Confirmation™</p> <p><input type="checkbox"/> Collect on Delivery <input type="checkbox"/> Signature Confirmation Restricted Delivery</p> <p><input type="checkbox"/> Collect on Delivery Restricted Delivery</p> <p><input type="checkbox"/> Insured Mail</p> <p><input type="checkbox"/> Insured Mail Restricted Delivery (over \$500)</p>	
PS Form 3811, July 2020 PSN 7530-02-000-9053		Domestic Return Receipt	

7022 1670 0002 1189 0286

U.S. Postal Service CERTIFIED MAIL® RECEIPT Domestic Mail Only	
For delivery information, visit our website at www.usps.com ®.	
OFFICIAL USE	
Certified Mail Fee	\$
Extra Services & Fees (check box, add fee as appropriate)	
<input type="checkbox"/> Return Receipt (hardcopy)	\$
<input type="checkbox"/> Return Receipt (electronic)	\$
<input type="checkbox"/> Certified Mail Restricted Delivery	\$
<input type="checkbox"/> Adult Signature Required	\$
<input type="checkbox"/> Adult Signature Restricted Delivery	\$
Postage	\$
Total Postage and Fees	\$
Sent To	
Providence Minerals, LLC P16400 Dallas Parkway, Suite 400 Dallas, TX 75248	
23952 - Permian Butters Stotch	
PS Form 3800, April 2015 PSN 7530-02-000-9047 See Reverse for Instructions	

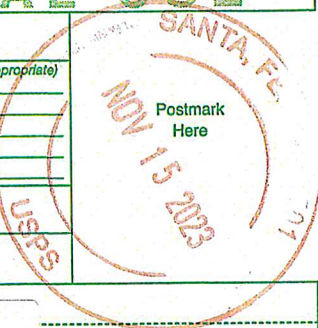

SENDER: COMPLETE THIS SECTION	COMPLETE THIS SECTION ON DELIVERY
<p>■ Complete items 1, 2, and 3.</p> <p>■ Print your name and address on the reverse so that we can return the card to you.</p> <p>■ Attach this card to the back of the mailpiece, or on the front if space permits.</p> <p>1. Article Addressed to:</p> <p>Providence Minerals, LLC P16400 Dallas Parkway, Suite 400 Dallas, TX 75248</p> <p>23952 - Permian Butters Stotch</p> <p>9590 9402 7635 2122 6647 54</p> <p>2. Article Number (Transfer from service label) 7022 1670 0002 1189 0286</p>	<p>A. Signature <input checked="" type="checkbox"/> Agent <input type="checkbox"/> Addressee</p> <p>B. Received by (Printed Name) C. Date of Delivery</p> <p>D. Is delivery address different from item 1? <input type="checkbox"/> Yes <input type="checkbox"/> No If YES, enter delivery address below:</p> <p>RECEIVED NOV 27 2023</p> <p>3. Service Type Hinkle Shanor LLP Santa Fe NM 87504</p> <p><input type="checkbox"/> Adult Signature <input type="checkbox"/> Priority Mail Express® <input type="checkbox"/> Adult Signature Restricted Delivery <input type="checkbox"/> Registered Mail™ <input type="checkbox"/> Certified Mail® <input type="checkbox"/> Registered Mail Restricted Delivery <input type="checkbox"/> Certified Mail Restricted Delivery <input type="checkbox"/> Signature Confirmation™ <input type="checkbox"/> Collect on Delivery <input type="checkbox"/> Signature Confirmation Restricted Delivery <input type="checkbox"/> Collect on Delivery Restricted Delivery <input type="checkbox"/> Insured Mail <input type="checkbox"/> Insured Mail Restricted Delivery (over \$500)</p>
PS Form 3811, July 2020 PSN 7530-02-000-9053	Domestic Return Receipt

7022 1670 0002 1189 7148

CERTIFIED MAIL® RECEIPT	
Domestic Mail Only	
For delivery information, visit our website at www.usps.com ®.	
OFFICIAL USE	
Certified Mail Fee	\$
Extra Services & Fees (check box, add fee as appropriate)	
<input type="checkbox"/> Return Receipt (hardcopy)	\$
<input type="checkbox"/> Return Receipt (electronic)	\$
<input type="checkbox"/> Certified Mail Restricted Delivery	\$
<input type="checkbox"/> Adult Signature Required	\$
<input type="checkbox"/> Adult Signature Restricted Delivery	\$
Postage	\$
Total Postage and Fees	\$
State of New Mexico 310 Old Santa Fe Trl Santa Fe, NM 87501 23952 - Permian Butters Stotch	
PS Form 3800, April 2015 PSN 7530-02-000-9047 See Reverse for Instructions	

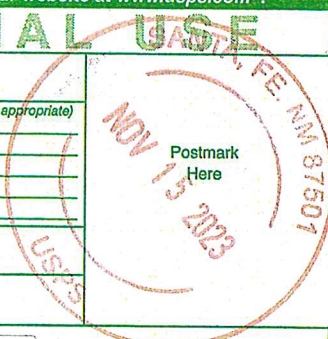

SENDER: COMPLETE THIS SECTION	COMPLETE THIS SECTION ON DELIVERY
<ul style="list-style-type: none"> Complete items 1, 2, and 3. Print your name and address on the reverse so that we can return the card to you. Attach this card to the back of the mailpiece, or on the front if space permits. 	<p>A. Signature</p> <p>X </p> <p><input type="checkbox"/> Agent <input type="checkbox"/> Addressee</p> <p>B. Received by (Printed Name) <u>Marcus A Baraka</u> C. Date of Delivery <u>11/20/23</u></p> <p>D. Is delivery address different from item 1? <input type="checkbox"/> Yes If YES, enter delivery address below: <input type="checkbox"/> No</p>
<p>1. Article Addressed to:</p> <p>State of New Mexico 310 Old Santa Fe Trl Santa Fe, NM 87501 23952 - Permian Butters Stotch</p>	<p>RECEIVED</p> <p>NOV 27 2023</p>
<p>2. Article Number (Transfer from service label)</p> <p>7022 1670 0002 1189 7148</p>	<p>3. Service Type</p> <p><input type="checkbox"/> Adult Signature <u>Hinkle Shanor LLC</u> <input type="checkbox"/> Adult Signature Restricted Delivery <u>Santa Fe, NM 87501</u> <input type="checkbox"/> Certified Mail® <input type="checkbox"/> Certified Mail Restricted Delivery <input type="checkbox"/> Collect on Delivery <input type="checkbox"/> Collect on Delivery Restricted Delivery <input type="checkbox"/> Insured Mail <input type="checkbox"/> Insured Mail Restricted Delivery (over \$500)</p> <p><input type="checkbox"/> Priority Mail Express® <input type="checkbox"/> Registered Mail™ <input type="checkbox"/> Registered Mail Restricted Delivery <input type="checkbox"/> Signature Confirmation™ <input type="checkbox"/> Signature Confirmation Restricted Delivery</p>
PS Form 3811, July 2020 PSN 7530-02-000-9053	Domestic Return Receipt

7022 1670 0002 1189 1320

U.S. Postal Service™
CERTIFIED MAIL® RECEIPT
Domestic Mail Only

For delivery information, visit our website at www.usps.com®.

OFFICIAL USE

Certified Mail Fee \$

Extra Services & Fees (check box, add fee as appropriate)

<input type="checkbox"/> Return Receipt (hardcopy)	\$	
<input type="checkbox"/> Return Receipt (electronic)	\$	
<input type="checkbox"/> Certified Mail Restricted Delivery	\$	
<input type="checkbox"/> Adult Signature Required	\$	
<input type="checkbox"/> Adult Signature Restricted Delivery	\$	

Postage \$

Total Postage and Fees \$

Sent To

Street CL&F Operating, LLC
16945 Northcase Drive, Ste 1500
Houston, TX 77060

City, St 23952 - Permian Butters Stotch

PS Form 3800, April 2015 PSN 7530-02-000-9047 See Reverse for Instructions

SANTAFÉ, NM 87501
NOV 15 2023
Postmark Here

USPS Tracking®

FAQs >

Tracking Number:

Remove X

70221670000211891320

Copy Add to Informed Delivery (<https://informedelivery.usps.com/>)

Latest Update

Your item was returned to the sender at 4:52 pm on November 22, 2023 in HOUSTON, TX 77060 because the forwarding order for this address is no longer valid.

Get More Out of USPS Tracking:

USPS Tracking Plus®

Alert

Forward Expired

HOUSTON, TX 77060
November 22, 2023, 4:52 pm

Vacant

HOUSTON, TX 77060
November 21, 2023, 11:46 am

Refused

HOUSTON, TX 77060
November 21, 2023, 11:42 am

Redelivery Scheduled for Next Business Day

HOUSTON, TX 77060
November 20, 2023, 12:32 pm

In Transit to Next Facility

November 19, 2023

Arrived at USPS Regional Facility

NORTH HOUSTON TX DISTRIBUTION CENTER

Feedback

November 18, 2023, 4:09 pm

Departed USPS Facility

ALBUQUERQUE, NM 87101

November 16, 2023, 8:05 am

Arrived at USPS Facility

ALBUQUERQUE, NM 87101

November 15, 2023, 10:35 pm

Hide Tracking History

What Do USPS Tracking Statuses Mean? (<https://faq.usps.com/s/article/Where-is-my-package>)

Text & Email Updates



USPS Tracking Plus®



Product Information



See Less

Track Another Package

Enter tracking or barcode numbers

Need More Help?

Contact USPS Tracking support for further assistance.

FAQs

7022 1670 0002 1189 1313

U.S. Postal Service™ CERTIFIED MAIL® RECEIPT Domestic Mail Only	
For delivery information, visit our website at www.usps.com ®.	
OFFICIAL USE	
Certified Mail Fee	
\$	
Extra Services & Fees (check box, add fee as appropriate)	
<input type="checkbox"/> Return Receipt (hardcopy)	\$
<input type="checkbox"/> Return Receipt (electronic)	\$
<input type="checkbox"/> Certified Mail Restricted Delivery	\$
<input type="checkbox"/> Adult Signature Required	\$
<input type="checkbox"/> Adult Signature Restricted Delivery	\$
Postage	
\$	
Total Postage and Fees	
\$	
Service	
Street	CL&F Operating LLC 1700 City Plaza Dr., Ste. 360 Spring, TX 77389
City	23952 - Permian Butters Stotch
PS Form 3800, April 2015 PSN 7530-02-000-9047 See Reverse for Instructions	



USPS Tracking®

FAQs >

Tracking Number:

Remove X

70221670000211891313

Copy Add to Informed Delivery (<https://informedelivery.usps.com/>)

Latest Update

Your item was delivered to an individual at the address at 2:10 pm on November 20, 2023 in SPRING, TX 77389.

Get More Out of USPS Tracking:

USPS Tracking Plus®

Delivered

Delivered, Left with Individual

SPRING, TX 77389
November 20, 2023, 2:10 pm

Arrived at USPS Regional Facility

NORTH HOUSTON TX DISTRIBUTION CENTER
November 18, 2023, 4:09 pm

In Transit to Next Facility

November 17, 2023

Departed USPS Facility

ALBUQUERQUE, NM 87101
November 16, 2023, 8:05 am

Arrived at USPS Facility

ALBUQUERQUE, NM 87101
November 15, 2023, 10:35 pm

Feedback

● Hide Tracking History

[What Do USPS Tracking Statuses Mean?](https://faq.usps.com/s/article/Where-is-my-package) (https://faq.usps.com/s/article/Where-is-my-package)

Text & Email Updates



USPS Tracking Plus®



Product Information



See Less ^

Track Another Package

Enter tracking or barcode numbers

Need More Help?

Contact USPS Tracking support for further assistance.

FAQs

062T 68T 2000 0670 2207

U.S. Postal Service™ CERTIFIED MAIL® RECEIPT Domestic Mail Only	
For delivery information, visit our website at www.usps.com ®.	
OFFICIAL USE	
Certified Mail Fee	\$
Extra Services & Fees (check box, add fee as appropriate)	
<input type="checkbox"/> Return Receipt (hardcopy)	\$
<input type="checkbox"/> Return Receipt (electronic)	\$
<input type="checkbox"/> Certified Mail Restricted Delivery	\$
<input type="checkbox"/> Adult Signature Required	\$
<input type="checkbox"/> Adult Signature Restricted Delivery	\$
Postage	\$
Total Postage and Fees	\$
Sent To	
St	FR Energy, LLC
Ch	55 Waugh Dr., Ste. 1200
	Houston, TX 77007
	23952 - Permian Butlers Stotch
PS Form 3800, April 2015 PSN 7530-02-000-9047 See Reverse for Instructions	



USPS Tracking®

FAQs >

Tracking Number:

Remove X

70221670000211891290

Copy Add to Informed Delivery (<https://informedelivery.usps.com/>)

Latest Update

Your package is moving within the USPS network and is on track to be delivered to its final destination. It is currently in transit to the next facility.

Get More Out of USPS Tracking:

USPS Tracking Plus®

- Delivered
- Out for Delivery
- Preparing for Delivery

Moving Through Network

In Transit to Next Facility

November 29, 2023

Arrived at USPS Regional Facility

NORTH HOUSTON TX DISTRIBUTION CENTER
November 25, 2023, 3:33 pm

Departed USPS Facility

ALBUQUERQUE, NM 87101
November 16, 2023, 8:05 am

Arrived at USPS Facility

ALBUQUERQUE, NM 87101
November 15, 2023, 10:35 pm

Feedback

● Hide Tracking History

[What Do USPS Tracking Statuses Mean?](https://faq.usps.com/s/article/Where-is-my-package) (https://faq.usps.com/s/article/Where-is-my-package)

Text & Email Updates	▼
USPS Tracking Plus®	▼
Product Information	▼
See Less ^	

Track Another Package

Enter tracking or barcode numbers

Need More Help?

Contact USPS Tracking support for further assistance.

FAQs

5512 681T 2000 041T 2202

U.S. Postal Service™ CERTIFIED MAIL® RECEIPT Domestic Mail Only	
For delivery information, visit our website at www.usps.com ®.	
OFFICIAL USE	
Certified Mail Fee	\$
Extra Services & Fees (check box, add fee as appropriate)	
<input type="checkbox"/> Return Receipt (hardcopy)	\$
<input type="checkbox"/> Return Receipt (electronic)	\$
<input type="checkbox"/> Certified Mail Restricted Delivery	\$
<input type="checkbox"/> Adult Signature Required	\$
<input type="checkbox"/> Adult Signature Restricted Delivery	\$
Postage	\$
Total Postage and Fees	\$
To Timothy R. MacDonald 3017 Avenue O Galveston, TX 77550 23952 - Permian Butte's Stotch	
PS Form 3800, April 2015 PSN 7530-02-000-9047 See Reverse for Instructions	

SANTA FE NM 87501
NOV 15 2023
USPS

USPS Tracking®

FAQs >

Tracking Number:

Remove X

70221670000211897155

Copy

Schedule a Redelivery (<https://tools.usps.com/redelivery.htm>)

Latest Update

This is a reminder to arrange for redelivery of your item before December 4, 2023 or your item will be returned on December 5, 2023. You may arrange redelivery by using the Schedule a Redelivery feature on this page or may pick up the item at the Post Office indicated on the notice.

Get More Out of USPS Tracking:

USPS Tracking Plus®

Feedback

Delivery Attempt: Action Needed

Reminder to Schedule Redelivery of your item before December 4, 2023

November 25, 2023

Notice Left (No Authorized Recipient Available)

GALVESTON, TX 77550

November 20, 2023, 12:17 pm

Arrived at USPS Regional Facility

NORTH HOUSTON TX DISTRIBUTION CENTER

November 18, 2023, 4:09 pm

In Transit to Next Facility

November 17, 2023

Departed USPS Facility

ALBUQUERQUE, NM 87101

November 16, 2023, 8:05 am

Arrived at USPS Facility

ALBUQUERQUE, NM 87101

November 15, 2023, 10:35 pm

Hide Tracking History

[What Do USPS Tracking Statuses Mean?](https://faq.usps.com/s/article/Where-is-my-package) (https://faq.usps.com/s/article/Where-is-my-package)

Text & Email Updates



Schedule Redelivery



USPS Tracking Plus®



Product Information



See Less ^

Track Another Package

Enter tracking or barcode numbers

Need More Help?

Contact USPS Tracking support for further assistance.

FAQs

Affidavit of Publication

STATE OF NEW MEXICO
COUNTY OF LEA

I, Daniel Russell, Publisher of the Hobbs News-Sun, a newspaper published at Hobbs, New Mexico, solemnly swear that the clipping attached hereto was published in the regular and entire issue of said newspaper, and not a supplement thereof for a period of 1 issue(s).

Beginning with the issue dated
November 10, 2023
and ending with the issue dated
November 10, 2023.



Publisher

Sworn and subscribed to before me this
10th day of November 2023.

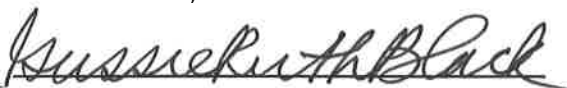

Business Manager

My commission expires

January 29, 2027

(Seal)

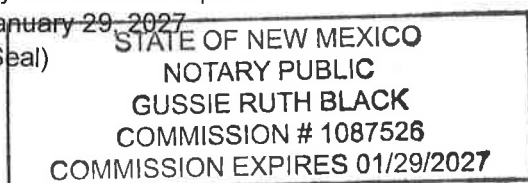

This newspaper is duly qualified to publish legal notices or advertisements within the meaning of Section 3, Chapter 167, Laws of 1937 and payment of fees for said publication has been made.

LEGAL NOTICE November 10, 2023

This is to notify all interested parties, including the State of New Mexico, Chevron USA, Nearburg Producing Company Employee Fund, Nearburg Exploration Company, LLC, Map2004-OK, Providence Minerals, LLC, CL&F Operating, LLC, FR Energy, LLC, Timothy MacDonald; and their successors and assigns, that the New Mexico Oil Conservation Division will conduct a hearing on an application submitted by Permian Resources Operating, LLC (Case No. 23952). The hearing will be conducted remotely on December 7, 2023, beginning at 8:15 a.m. To participate in the electronic hearing, see the instructions posted on the OCD Hearings website for that date: <https://www.emnrd.nm.gov/ocd/hearing-info/>. Applicant applies for an order pooling all uncommitted interests in the Bone Spring formation underlying a 240-acre, more or less, standard horizontal spacing unit comprised of the W/2 E/2 of Section 17 and the W/2 SE/4 of Section 8, Township 22 South, Range 35 East, Lea County, New Mexico ("Unit"). The Unit will be dedicated to the **Butters Stotch 8 State Com 123H** well ("Well"), which will be drilled from a surface hole location in the NE/4 SE/4 (Unit I) of Section 8 to a bottom hole location in the SW/4 SE/4 (Unit O) of Section 17. The completed interval of the Well will be orthodox. Also to be considered will be the cost of drilling and completing the Well and the allocation of the costs, the designation of Applicant as operator of the Well, and a 200% charge for the risk involved in drilling and completing the Well. The Well is located approximately 13 miles west of Eunice, New Mexico. #00284804

02107475

00284804

GILBERT
HINKLE, SHANOR LLP
PO BOX 2068
SANTA FE, NM 87504

Permian Resources Operating, LLC
Case No. 23952
Exhibit C-4