

**BEFORE THE OIL CONSERVATION DIVISION
EXAMINER HEARING MARCH 13, 2025**

CASE No. 25228

LEAD BELLY 36/35 WELLS

EDDY COUNTY, NEW MEXICO



**STATE OF NEW MEXICO
ENERGY, MINERALS AND NATURAL RESOURCES DEPARTMENT
OIL CONSERVATION DIVISION**

**APPLICATION OF MEWBOURNE OIL
COMPANY FOR COMPULSORY POOLING,
EDDY COUNTY, NEW MEXICO.**

CASE NO. 25228

TABLE OF CONTENTS

- **Mewbourne Exhibit A:** Compulsory Pooling Application Checklist
- **Mewbourne Exhibit B:** Application for Compulsory Pooling
- **Mewbourne Exhibit C:** Self-Affirmed Statement of Arian Rodrigues, Landman
 - Mewbourne Exhibit C-1: C-102
 - Mewbourne Exhibit C-2: Land Tract Map / Uncommitted Interest Owners
 - Mewbourne Exhibit C-3: Sample Well Proposal Letter with AFEs
 - Mewbourne Exhibit C-4: Chronology of Contacts
- **Mewbourne Exhibit D:** Self-Affirmed Statement of Charles Crosby, Geologist
 - Mewbourne Exhibit D-1: Locator map
 - Mewbourne Exhibit D-2: Subsea structure & cross-section map
 - Mewbourne Exhibit D-3: Stratigraphic cross-section
- **Mewbourne Exhibit E:** Self-Affirmed Statement of Notice
- **Mewbourne Exhibit F:** Affidavit of Publication for the Case

COMPULSORY POOLING APPLICATION CHECKLIST

ALL INFORMATION IN THE APPLICATION MUST BE SUPPORTED BY SIGNED AFFIDAVITS

Case: 25228	APPLICANT'S RESPONSE
Date:	March 13, 2025
Applicant	Mewbourne Oil Company
Designated Operator & OGRID (affiliation if applicable)	Mewbourne Oil Company [OGRID 14744]
Applicant's Counsel:	Holland & Hart LLP
Case Title:	APPLICATION OF MEWBOURNE OIL COMPANY FOR COMPULSORY POOLING, EDDY COUNTY, NEW MEXICO.
Entries of Appearance/Intervenors:	N/A
Well Family	Lead Belly 36/35 Fed Com
Formation/Pool	
Formation Name(s) or Vertical Extent:	Bone Spring
Primary Product (Oil or Gas):	Oil
Pooling this vertical extent:	Bone Spring formation
Pool Name and Pool Code:	Tamano; Bone Spring [Pool Code 58040]
Well Location Setback Rules:	Statewide Rules
Spacing Unit	
Type (Horizontal/Vertical)	Horizontal
Size (Acres)	960-acres
Building Blocks:	40 acres
Orientation:	East-West
Description: TRS/County	E/2 of Section 35 and all of Section 36, Township 18 South, Range 31 East, NMPM, Eddy County, New Mexico.
Standard Horizontal Well Spacing Unit (Y/N), If No, describe and is approval of non-standard unit requested in this application?	No; approval for NSP will be sought administratively.
Other Situations	
Depth Severance: Y/N. If yes, description	No
Proximity Tracts: If yes, description	No
Proximity Defining Well: if yes, description	
Applicant's Ownership in Each Tract	Exhibit C-2
Well(s)	
Name & API (if assigned), surface and bottom hole location, footages, completion target, orientation, completion status (standard or non-standard)	
Well #1	Lead Belly 36/35 Fed Com #521H (API No. Pending) SHL: 2000' FSL & 505' FEL (Unit I) of Section 36 BHL: 660 FNL & 2540 FEL (Unit B) of Section 35 Completion Target: Bone Spring formation Well Orientation: Laydown / East-West Completion Location expected to be: Standard

BEFORE THE OIL CONSERVATION DIVISION

Santa Fe, New Mexico

Exhibit No. A

Submitted by: Mewbourne Oil Company

Hearing Date: March 13, 2025

Case No. 25228

Well #2	Lead Belly 36/35 Fed Com #523H (API No. Pending) SHL: 1960 FSL & 505' FEL (Unit I) of Section 36 BHL: 1950 FNL & 2540 FEL (Unit G) of Section 35 Completion Target: Bone Spring formation Well Orientation: Laydown / East-West Completion Location expected to be: Standard
Well #3	Lead Belly 36/35 Fed Com #525H (API No. Pending) SHL: 1920 FSL & 505 FEL (Unit I) of Section 36 BHL: 2000 FSL & 2540 FEL (Unit J) of Section 35 Completion Target: Bone Spring formation Well Orientation: Laydown / East-West Completion Location expected to be: Standard
Well #4	Lead Belly 36/35 Fed Com #527H (API No. Pending) SHL: 1880 FSL & 505 FEL (Unit I) of Section 36 BHL: 700 FSL & 2540 FEL (Unit O) of Section 35 Completion Target: Bone Spring formation Well Orientation: Laydown / East-West Completion Location expected to be: Standard
Well #5	Lead Belly 36/35 Fed Com #622H (API No. Pending) SHL: 1980 FNL & 505 FEL (Unit I) of Section 36 BHL: 700 FNL & 2540 FEL (Unit O) of Section 35 Completion Target: Bone Spring formation Well Orientation: Laydown / East-West Completion Location expected to be: Standard
Well #6	Lead Belly 36/35 Fed Com #624H (API No. 30-015-53749) SHL: 1940 FSL & 505 FEL (Unit I) of Section 36 BHL: 2080 FNL & 2540 FEL (Unit G) of Section 35 Completion Target: Bone Spring formation Well Orientation: Laydown / East-West Completion Location expected to be: Standard
Well #7	Lead Belly 36/35 Fed Com #626H (API No. Pending) SHL: 1900 FNL & 505 FEL (Unit I) of Section 36 BHL: 1,800 FSL & 2540 FEL (Unit J) of Section 35 Completion Target: Bone Spring formation Well Orientation: Laydown / East-West Completion Location expected to be: Standard
Well #8	Lead Belly 36/35 Fed Com #628H (API No. Pending) SHL: 1860 FNL & 505 FEL (Unit I) of Section 36 BHL: 450 FSL & 2540 FEL (Unit O) of Section 35 Completion Target: Bone Spring formation Well Orientation: Laydown / East-West Completion Location expected to be: Standard
Horizontal Well First and Last Take Points	Exhibit C-1
Completion Target (Formation, TVD and MD)	Exhibit C-1
AFE Capex and Operating Costs	

Drilling Supervision/Month \$	Exhibit C-3
Production Supervision/Month \$	Exhibit C-3
Justification for Supervision Costs	Exhibit C-3
Requested Risk Charge	Exhibit C-3
Notice of Hearing	
Proposed Notice of Hearing	Exhibit B
Proof of Mailed Notice of Hearing (20 days before hearing)	Exhibit E
Proof of Published Notice of Hearing (10 days before hearing)	Exhibit F
Ownership Determination	
Land Ownership Schematic of the Spacing Unit	Exhibit C-2
Tract List (including lease numbers and owners)	Exhibit C-2
If approval of Non-Standard Spacing Unit is requested, Tract List (including lease numbers and owners) of Tracts subject to notice requirements.	N/A
Pooled Parties (including ownership type)	Exhibit C-2
Unlocatable Parties to be Pooled	N/A
Ownership Depth Severance (including percentage above & below)	Exhibit C-2
Joinder	
Sample Copy of Proposal Letter	Exhibit C-3
List of Interest Owners (ie Exhibit A of JOA)	Exhibit C-2
Chronology of Contact with Non-Joined Working Interests	Exhibit C-4
Overhead Rates In Proposal Letter	Exhibit C-3
Cost Estimate to Drill and Complete	Exhibit C-3
Cost Estimate to Equip Well	Exhibit C-3
Cost Estimate for Production Facilities	Exhibit C-3
Geology	
Summary (including special considerations)	Exhibit D
Spacing Unit Schematic	Exhibit D-1
Gunbarrel/Lateral Trajectory Schematic	Exhibit D-2
Well Orientation (with rationale)	Exhibit D
Target Formation	Exhibit D, D-3
HSU Cross Section	Exhibit D-3
Depth Severance Discussion	N/A
Forms, Figures and Tables	
C-102	Exhibit C-1
Tracts	Exhibit C-2
Summary of Interests, Unit Recapitulation (Tracts)	Exhibit C-2
General Location Map (including basin)	Exhibit D
Well Bore Location Map	Exhibit D-1
Structure Contour Map - Subsea Depth	Exhibit D-2
Cross Section Location Map (including wells)	Exhibit D-2
Cross Section (including Landing Zone)	Exhibit D-3
Additional Information	
Special Provisions/Stipulations	N/A
CERTIFICATION: I hereby certify that the information provided in this checklist is complete and accurate.	
Printed Name (Attorney or Party Representative):	Adam G. Rankin
Signed Name (Attorney or Party Representative):	
Date:	6-Mar-25

**STATE OF NEW MEXICO
ENERGY, MINERALS AND NATURAL RESOURCES DEPARTMENT
OIL CONSERVATION DIVISION**

**APPLICATION OF MEWBOURNE OIL
COMPANY FOR COMPULSORY POOLING,
EDDY COUNTY, NEW MEXICO.**

CASE NO. 25228

APPLICATION

Mewbourne Oil Company ("Mewbourne" or "Applicant") (OGRID No. 14744), through its undersigned attorneys, hereby files this application with the Oil Conservation Division pursuant to the provisions of NMSA 1978, § 70-2-17, for an order pooling a non-standard 960-acre, more or less, horizontal well spacing unit in the Bone Spring formation underlying the E/2 of Section 35 and all of Section 36, Township 18 South, Range 31 East, NMPM, Eddy County, New Mexico.

In support of its application, Mewbourne states:

1. Applicant is a working interest owner in the proposed horizontal spacing unit and has the right to drill thereon.
2. Applicant seeks to initially dedicate the above-referenced spacing unit to the drilled **Lead Belly 36/35 Fed Com #521H** well, with a surface location in the NE/4 SE/4 (Unit I) of Section 36 and bottomhole location in the NW/4 NE/4 (Unit B) of Section 35; **Lead Belly 36/35 Fed Com #523H** and **Lead Belly 36/35 Fed Com #624H** well, with a surface location in the NE/4 SE/4 (Unit I) of Section 36 and bottomhole location in the SW/4 NE/4 (Unit G) of Section 35; **Lead Belly 36/35 Fed Com #525H** and **Lead Belly 36/35 Fed Com #626H** well, with a surface location in the NE/4 SE/4 (Unit I) of Section 36 and bottomhole location in the NW/4 SE/4 (Unit J) of Section 35; and **Lead Belly 36/35 Fed Com #527H**, **Lead Belly 36/35 Fed Com #622H**, and

**BEFORE THE OIL CONSERVATION DIVISION
Santa Fe, New Mexico
Exhibit No. B
Submitted by: Mewbourne Oil Company
Hearing Date: March 13, 2025
Case No. 25228**

Lead Belly 36/35 Fed Com #628H well, with a surface location in the NE/4 SE/4 (Unit I) of Section 36 and bottomhole location in the SW/4 SE/4 (Unit O) of Section 35.

3. Applicant will file separately for administrative approval of the non-standard horizontal spacing unit.

4. Applicant has sought and been unable to obtain voluntary agreement for the development of these lands from all mineral owners in the subject spacing unit.

5. The pooling of interests will avoid the drilling of unnecessary wells, will prevent waste, and will protect correlative rights.

WHEREFORE, Applicant requests that this matter be set for hearing before an Examiner of the Oil Conservation Division on March 13, 2025, and, after notice and hearing as required by law, the Division enter an order:

- A. Pooling all uncommitted mineral owners in the horizontal spacing unit;
- B. Designating Applicant as operator of this spacing unit and the horizontal wells to be drilled thereon;
- C. Authorizing Applicant to recover its costs of drilling, completing, and equipping the wells;
- D. Approving the actual operating charges and costs of supervision while drilling and after completion, together with a provision adjusting the rates pursuant to the COPAS accounting procedures; and
- E. Imposing a 200% charge for the risk assumed by Applicant in drilling and completing the wells against any working interest owner who does not voluntarily participate in the drilling of the wells.

Respectfully submitted,

HOLLAND & HART LLP

By: 

Michael H. Feldewert
Adam G. Rankin
Paula M. Vance
Post Office Box 2208
Santa Fe, New Mexico 87504-2208
(505) 988-4421
(505) 983-6043 Facsimile
mfeldewert@hollandhart.com
agrarkin@hollandhart.com
pmvance@hollandhart.com

ATTORNEYS FOR MEWBOURNE OIL COMPANY

CASE: _____

Application of Mewbourne Oil Company for Compulsory Pooling, Eddy County, New Mexico. Applicant in the above-styled cause seeks an order pooling a non-standard 960-acre, more or less, horizontal well spacing unit in the Bone Spring formation underlying the E/2 of Section 35 and all of Section 36, Township 18 South, Range 31 East, NMPM, Eddy County, New Mexico. This spacing unit will be initially dedicated to the proposed **Lead Belly 36/35 Fed Com #521H** well, with a surface location in the NE/4 SE/4 (Unit I) of Section 36 and bottomhole location in the NW/4 NE/4 (Unit B) of Section 35; **Lead Belly 36/35 Fed Com #523H** and **Lead Belly 36/35 Fed Com #624H** well, with a surface location in the NE/4 SE/4 (Unit I) of Section 36 and bottomhole location in the SW/4 NE/4 (Unit G) of Section 35; **Lead Belly 36/35 Fed Com #525H** and **Lead Belly 36/35 Fed Com #626H** well, with a surface location in the NE/4 SE/4 (Unit I) of Section 36 and bottomhole location in the NW/4 SE/4 (Unit J) of Section 35; and **Lead Belly 36/35 Fed Com #527H**, **Lead Belly 36/35 Fed Com #622H**, and **Lead Belly 36/35 Fed Com #628H** well, with a surface location in the NE/4 SE/4 (Unit I) of Section 36 and bottomhole location in the SW/4 SE/4 (Unit O) of Section 35. Also to be considered will be the cost of drilling and completing the wells and the allocation of the costs thereof, the operating costs and charges for supervision, the designation of applicant as operator of the proposed spacing unit, and a 200% charge for risk involved in drilling said wells. Said area is located approximately 30 miles northeast of Carlsbad, New Mexico.

**STATE OF NEW MEXICO
ENERGY, MINERALS AND NATURAL RESOURCES DEPARTMENT
OIL CONSERVATION DIVISION**

**APPLICATION OF MEWBOURNE OIL
COMPANY FOR COMPULSORY POOLING,
EDDY COUNTY, NEW MEXICO.**

CASE NO. 25228

SELF-AFFIRMED STATEMENT OF ARIANA RODRIGUES

1. My name is Ariana Rodrigues. I work for Mewbourne Oil Company (“Mewbourne”) as a Landman.

2. I have previously testified before the New Mexico Oil Conservation Division (“Division”) as an expert witness in petroleum land matters. My credentials as a petroleum landman have been accepted by the Division and made a matter of record.

3. I am familiar with the application filed by Mewbourne in this case, and I am familiar with the status of the lands in the subject area.

4. None of the uncommitted parties in this case have indicated opposition to proceeding by self-affirmed statement and, therefore, I do not expect any opposition at the hearing.

5. Under **Case No. 25228**, Mewbourne seeks an order pooling all uncommitted interests in a non-standard 960-acre, more or less, horizontal well spacing unit in the Bone Spring formation underlying the E/2 of Section 35 and all of Section 36, Township 18 South, Range 31 East, NMPM, Eddy County, New Mexico. Mewbourne seeks to initially dedicate the unit to the drilled **Lead Belly 36/35 Fed Com #521H** well, with a surface location in the NE/4 SE/4 (Unit I) of Section 36 and bottomhole location in the NW/4 NE/4 (Unit B) of Section 35; **Lead Belly 36/35 Fed Com #523H** and **Lead Belly 36/35 Fed Com #624H** well, with a surface location in the NE/4 SE/4 (Unit I) of Section 36 and bottomhole location in the SW/4 NE/4 (Unit G) of Section 35;

BEFORE THE OIL CONSERVATION DIVISION
Santa Fe, New Mexico
Exhibit No. C
Submitted by: Mewbourne Oil Company
Hearing Date: March 13, 2025
Case No. 25228

Lead Belly 36/35 Fed Com #525H and **Lead Belly 36/35 Fed Com #626H** well, with a surface location in the NE/4 SE/4 (Unit I) of Section 36 and bottomhole location in the NW/4 SE/4 (Unit J) of Section 35; and **Lead Belly 36/35 Fed Com #527H**, **Lead Belly 36/35 Fed Com #622H**, and **Lead Belly 36/35 Fed Com #628H** well, with a surface location in the NE/4 SE/4 (Unit I) of Section 36 and bottomhole location in the SW/4 SE/4 (Unit O) of Section 35.

6. Mewbourne will file separately for administrative approval of the non-standard horizontal spacing unit.

7. **Mewbourne Exhibit C-1** contains a draft Form C-102 for the wells. This form demonstrates that the completed interval for the wells will comply with statewide setbacks for oil wells. The exhibit shows that the wells will be assigned to the Tamano; Bone Spring [Pool Code 58040].

8. **Mewbourne Exhibit C-2** identifies the tracts of land comprising the horizontal spacing unit, the ownership interests in each tract, and ownership interests on a spacing unit basis. The subject acreage is comprised of federal lands. The parties Mewbourne seeks to pool are identified with an asterisk.

9. **Mewbourne Exhibit C-3** contains a sample of the well proposal letter and AFEs sent to owners with a working interest. The costs reflected in the AFEs are consistent with what Mewbourne and other operators have incurred for drilling similar horizontal wells in the area in this formation.

10. Mewbourne requests that the overhead and administrative costs for drilling and producing the proposed wells be set at \$11,000 per month while drilling and \$1,100 per month while producing. These costs are consistent with what other operators are charging in this area for similar wells.

11. **Mewbourne Exhibit C-4** contains a general summary of the contacts with the uncommitted interest owners. As indicated in the exhibit, Mewbourne has made a good faith effort to locate and has had communications with all of the parties that it seeks to pool in this case in an effort to reach voluntary joinder. In my opinion, Mewbourne has undertaken good faith efforts to reach an agreement with the uncommitted interest owners.

12. Mewbourne has provided the law firm of Holland & Hart LLP with the names and addresses of the parties that Mewbourne seeks to pool and instructed that they be notified of this hearing. Mewbourne has conducted a diligent search of all public records in the county where the property is located, reviewed telephone directories, and conducted computer searches to locate contact information for each interest owner.

13. **Mewbourne Exhibits C-1 through C-4** were either prepared by me or compiled under my direction and supervision.

14. I affirm under penalty of perjury under the laws of the State of New Mexico that the foregoing statements are true and correct. I understand that this self-affirmed statement will be used as written testimony in this case. This statement is made on the date next to my signature below.

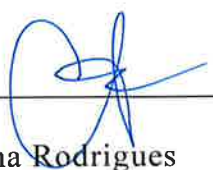
Ariana Rodrigues

03/06/2025
Date

C-102 Submit Electronically Via OCD Permitting	State of New Mexico Energy, Minerals & Natural Resources Department OIL CONSERVATION DIVISION	Revised July 9, 2024	
		Submittal Type:	<input type="checkbox"/> Initial Submittal
			<input type="checkbox"/> Amended Report
		<input type="checkbox"/> As Drilled	

WELL LOCATION INFORMATION

API Number	Pool Code 58040	Pool Name Tamano; Bone Spring
Property Code	Property Name LEAD BELLY 36/35 FED COM	Well Number 521H
OGRID No. 14744	Operator Name MEWBOURNE OIL COMPANY	Ground Level Elevation 3670'
Surface Owner: <input checked="" type="checkbox"/> State <input type="checkbox"/> Fee <input type="checkbox"/> Tribal <input type="checkbox"/> Federal		Mineral Owner: <input checked="" type="checkbox"/> State <input type="checkbox"/> Fee <input type="checkbox"/> Tribal <input checked="" type="checkbox"/> Federal

Surface Location

UL I	Section 36	Township 18S	Range 31E	Lot	Ft. from N/S 2000' FSL	Ft. from E/W 505' FEL	Latitude 32.7023001	Longitude -103.81617	County EDDY
----------------	----------------------	------------------------	---------------------	-----	----------------------------------	---------------------------------	-------------------------------	--------------------------------	-----------------------

Bottom Hole Location

UL B	Section 35	Township 18S	Range 31E	Lot	Ft. from N/S 660' FNL	Ft. from E/W 2540' FEL	Latitude 32.7095204	Longitude -103.84023	County EDDY
----------------	----------------------	------------------------	---------------------	-----	---------------------------------	----------------------------------	-------------------------------	--------------------------------	-----------------------

Dedicated Acres 960	Infill or Defining Well	Defining Well API	Overlapping Spacing Unit (Y/N) Y	Consolidation Code C
Order Numbers.			Well setbacks are under Common Ownership: <input type="checkbox"/> Yes <input checked="" type="checkbox"/> No	

Kick Off Point (KOP)

UL A	Section 36	Township 18S	Range 31E	Lot	Ft. from N/S 660' FNL	Ft. from E/W 10' FEL	Latitude 32.7096448	Longitude -103.81483	County EDDY
----------------	----------------------	------------------------	---------------------	-----	---------------------------------	--------------------------------	-------------------------------	--------------------------------	-----------------------

First Take Point (FTP)

UL A	Section 36	Township 18S	Range 31E	Lot	Ft. from N/S 660' FNL	Ft. from E/W 100' FEL	Latitude 32.7096443	Longitude -103.81512	County EDDY
----------------	----------------------	------------------------	---------------------	-----	---------------------------------	---------------------------------	-------------------------------	--------------------------------	-----------------------

Last Take Point (LTP)

UL B	Section 35	Township 18S	Range 31E	Lot	Ft. from N/S 660' FNL	Ft. from E/W 2540' FEL	Latitude 32.7095204	Longitude -103.84023	County EDDY
----------------	----------------------	------------------------	---------------------	-----	---------------------------------	----------------------------------	-------------------------------	--------------------------------	-----------------------

Unitized Area or Area of Uniform Interest	Spacing Unit Type <input checked="" type="checkbox"/> Horizontal <input type="checkbox"/> Vertical	Ground Floor Elevation: 3,698'
---	--	---------------------------------------

OPERATOR CERTIFICATIONS <i>I hereby certify that the information contained herein is true and complete to the best of my knowledge and belief, and, if the well is a vertical or directional well, that this organization either owns a working interest or unleased mineral interest in the land including the proposed bottom hole location or has a right to drill this well at this location pursuant to a contract with an owner of a working interest or unleased mineral interest, or to a voluntary pooling agreement or a compulsory pooling order heretofore entered by the division.</i> <i>If this well is a horizontal well, I further certify that this organization has received the consent of at least one lessee or owner of a working interest or unleased mineral interest in each tract (in the target pool or formation) in which any part of the well's completed interval will be located or obtained a compulsory pooling order from the division.</i>  03/06/2025 Signature Date John Smith Printed Name john.smith@mewbourne.com Email Address		SURVEYOR CERTIFICATIONS <i>I hereby certify that the well location shown on this plat was plotted from field notes of actual surveys made by me or under my supervision, and that the same is true and correct to the best of my belief.</i> BEFORE THE OIL CONSERVATION DIVISION Santa Fe, New Mexico Exhibit No. C-1 Submitted by: Mewbourne Oil Company Hearing Date: March 13, 2025 Case No. 25228 Signature and Seal of Professional Surveyor Certificate Number Date of Survey	
--	--	---	--

Note: No allowable will be assigned to this completion until all interests have been consolidated or a non-standard unit has been approved by the division.

This grid represents a standard section. You may superimpose a non-standard section, or larger area, over this grid. Operators must outline the dedicated acreage in a red box, clearly show the well surface location and bottom hole location, if it is directionally drilled, with the dimensions from the section lines in the cardinal directions. If this is a horizontal wellbore show on this plat the location of the First Take Point and Last Take Point, and the point within the Completed interval (other than the First Take Point or Last Take Point) that is closest to any outer boundary of the tract.

Surveyors shall use the latest United States government survey or dependent resurvey. Well locations will be in reference to the New Mexico Principal Meridian. If the land is not surveyed, contact the OCD Engineering Bureau. Independent subdivision surveys will not be acceptable.

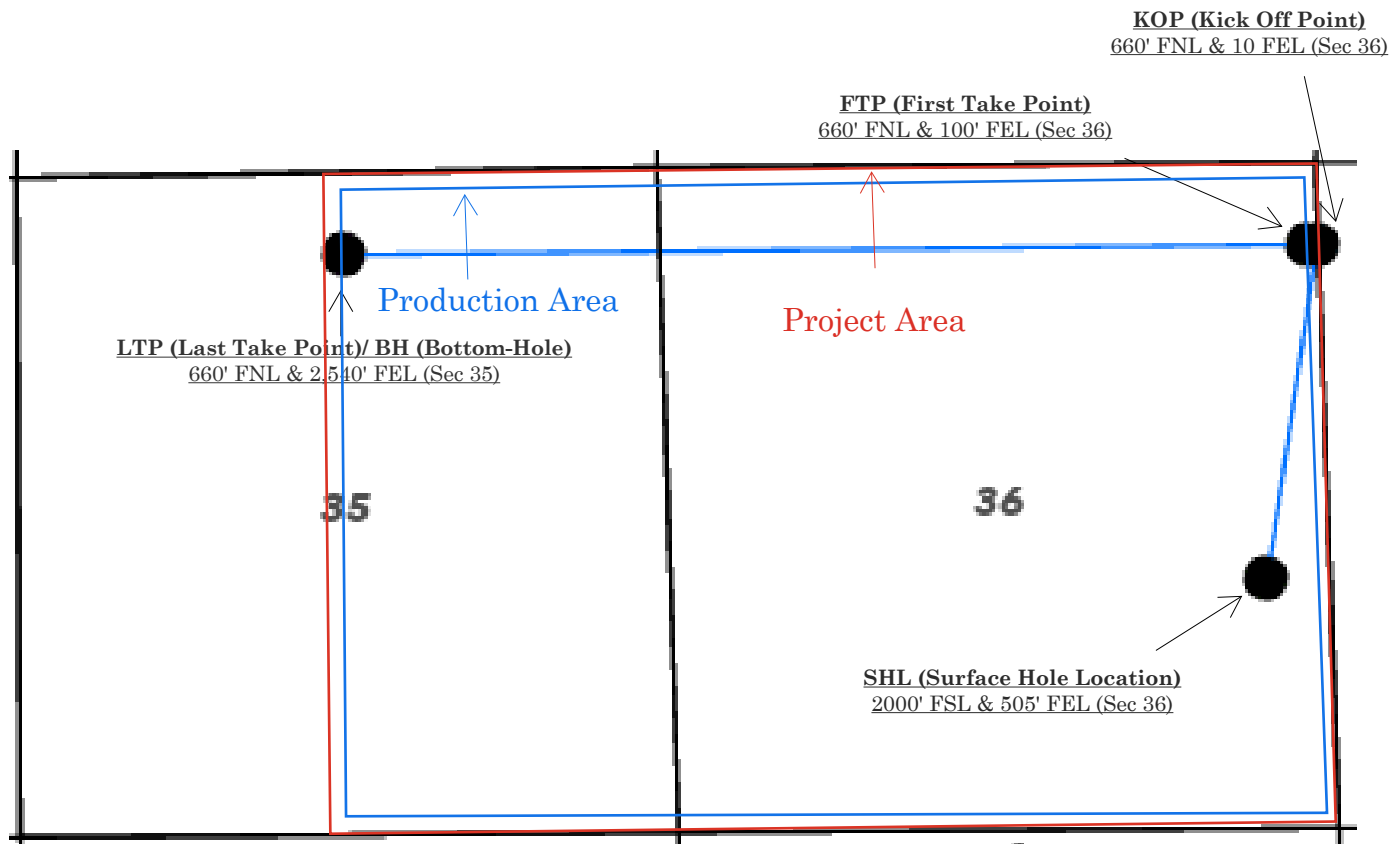

C-102 Submit Electronically Via OCD Permitting	State of New Mexico Energy, Minerals & Natural Resources Department OIL CONSERVATION DIVISION	Revised July 9, 2024	
		Submittal Type:	<input type="checkbox"/> Initial Submittal
			<input type="checkbox"/> Amended Report
			<input type="checkbox"/> As Drilled

WELL LOCATION INFORMATION

API Number	Pool Code 58040	Pool Name Tamano; Bone Spring
Property Code	Property Name LEAD BELLY 36/35 FED COM	Well Number 523H
OGRID No. 14744	Operator Name MEWBOURNE OIL COMPANY	Ground Level Elevation 3670'
Surface Owner: <input checked="" type="checkbox"/> State <input type="checkbox"/> Fee <input type="checkbox"/> Tribal <input type="checkbox"/> Federal		Mineral Owner: <input checked="" type="checkbox"/> State <input type="checkbox"/> Fee <input type="checkbox"/> Tribal <input checked="" type="checkbox"/> Federal

Surface Location

UL I	Section 36	Township 18S	Range 31E	Lot	Ft. from N/S 1960' FSL	Ft. from E/W 505' FEL	Latitude 32.7021907	Longitude -103.81617	County EDDY
----------------	----------------------	------------------------	---------------------	-----	----------------------------------	---------------------------------	-------------------------------	--------------------------------	-----------------------

Bottom Hole Location

UL G	Section 35	Township 18S	Range 31E	Lot	Ft. from N/S 1950' FNL	Ft. from E/W 2540' FEL	Latitude 32.7059756	Longitude -103.84011	County EDDY
----------------	----------------------	------------------------	---------------------	-----	----------------------------------	----------------------------------	-------------------------------	--------------------------------	-----------------------

Dedicated Acres 960	Infill or Defining Well	Defining Well API	Overlapping Spacing Unit (Y/N) Y	Consolidation Code C
Order Numbers.			Well setbacks are under Common Ownership: <input type="checkbox"/> Yes <input checked="" type="checkbox"/> No	

Kick Off Point (KOP)

UL H	Section 36	Township 18S	Range 31E	Lot	Ft. from N/S 1950' FNL	Ft. from E/W 10' FEL	Latitude 32.7060985	Longitude -103.81470	County EDDY
----------------	----------------------	------------------------	---------------------	-----	----------------------------------	--------------------------------	-------------------------------	--------------------------------	-----------------------

First Take Point (FTP)

UL H	Section 36	Township 18S	Range 31E	Lot	Ft. from N/S 1950' FNL	Ft. from E/W 100' FEL	Latitude 32.7060988	Longitude -103.81499	County EDDY
----------------	----------------------	------------------------	---------------------	-----	----------------------------------	---------------------------------	-------------------------------	--------------------------------	-----------------------

Last Take Point (LTP)

UL G	Section 35	Township 18S	Range 31E	Lot	Ft. from N/S 1950' FNL	Ft. from E/W 2540' FEL	Latitude 32.7059756	Longitude -103.84011	County EDDY
----------------	----------------------	------------------------	---------------------	-----	----------------------------------	----------------------------------	-------------------------------	--------------------------------	-----------------------

Unitized Area or Area of Uniform Interest	Spacing Unit Type <input checked="" type="checkbox"/> Horizontal <input type="checkbox"/> Vertical	Ground Floor Elevation: 3,698'
---	--	---------------------------------------

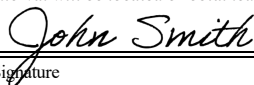
OPERATOR CERTIFICATIONS <i>I hereby certify that the information contained herein is true and complete to the best of my knowledge and belief, and, if the well is a vertical or directional well, that this organization either owns a working interest or unleased mineral interest in the land including the proposed bottom hole location or has a right to drill this well at this location pursuant to a contract with an owner of a working interest or unleased mineral interest, or to a voluntary pooling agreement or a compulsory pooling order heretofore entered by the division.</i> <i>If this well is a horizontal well, I further certify that this organization has received the consent of at least one lessee or owner of a working interest or unleased mineral interest in each tract (in the target pool or formation) in which any part of the well's completed interval will be located or obtained a compulsory pooling order from the division.</i>  03/06/2025 Signature Date John Smith Printed Name john.smith@mewbourne.com Email Address		SURVEYOR CERTIFICATIONS <i>I hereby certify that the well location shown on this plat was plotted from field notes of actual surveys made by me or under my supervision, and that the same is true and correct to the best of my belief.</i> Signature and Seal of Professional Surveyor Certificate Number Date of Survey	
--	--	---	--

Note: No allowable will be assigned to this completion until all interests have been consolidated or a non-standard unit has been approved by the division.

This grid represents a standard section. You may superimpose a non-standard section, or larger area, over this grid. Operators must outline the dedicated acreage in a red box, clearly show the well surface location and bottom hole location, if it is directionally drilled, with the dimensions from the section lines in the cardinal directions. If this is a horizontal wellbore show on this plat the location of the First Take Point and Last Take Point, and the point within the Completed interval (other than the First Take Point or Last Take Point) that is closest to any outer boundary of the tract.

Surveyors shall use the latest United States government survey or dependent resurvey. Well locations will be in reference to the New Mexico Principal Meridian. If the land is not surveyed, contact the OCD Engineering Bureau. Independent subdivision surveys will not be acceptable.

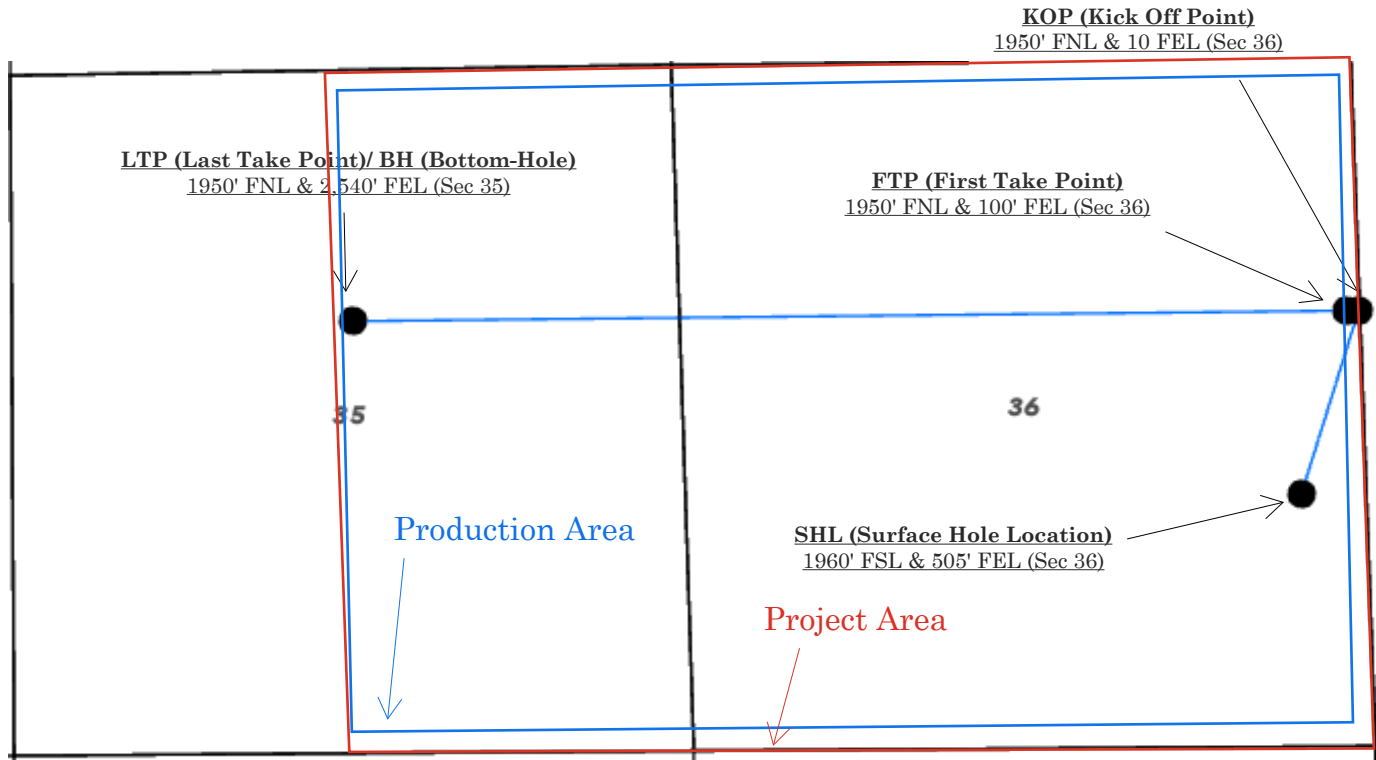

C-102 Submit Electronically Via OCD Permitting	State of New Mexico Energy, Minerals & Natural Resources Department OIL CONSERVATION DIVISION	Revised July 9, 2024	
		Submittal Type:	<input type="checkbox"/> Initial Submittal
			<input type="checkbox"/> Amended Report
		<input type="checkbox"/> As Drilled	

WELL LOCATION INFORMATION

API Number	Pool Code 1 * 11 &	Pool Name FS_ S a 4a' Wbd Y
Property Code	Property Name LEAD BELLY 36/35 FED COM	Well Number 525H
OGRID No. 14744	Operator Name MEWBOURNE OIL COMPANY	Ground Level Elevation 3670'
Surface Owner: <input checked="" type="checkbox"/> State <input type="checkbox"/> Fee <input type="checkbox"/> Tribal <input type="checkbox"/> Federal		Mineral Owner: <input checked="" type="checkbox"/> State <input type="checkbox"/> Fee <input type="checkbox"/> Tribal <input checked="" type="checkbox"/> Federal

Surface Location

UL I	Section 36	Township 18S	Range 31E	Lot	Ft. from N/S 1920' FSL	Ft. from E/W 505' FEL	Latitude 32.7020802	Longitude -103.81616	County EDDY
----------------	----------------------	------------------------	---------------------	-----	----------------------------------	---------------------------------	-------------------------------	--------------------------------	-----------------------

Bottom Hole Location

UL J	Section 35	Township 18S	Range 31E	Lot	Ft. from N/S 2000' FSL	Ft. from E/W 2540' FEL	Latitude 32.7022553	Longitude -103.84018	County EDDY
----------------	----------------------	------------------------	---------------------	-----	----------------------------------	----------------------------------	-------------------------------	--------------------------------	-----------------------

Dedicated Acres 960	Infill or Defining Well	Defining Well API	Overlapping Spacing Unit (Y/N) Y	Consolidation Code C
Order Numbers.			Well setbacks are under Common Ownership: <input type="checkbox"/> Yes <input checked="" type="checkbox"/> No	

Kick Off Point (KOP)

UL I	Section 36	Township 18S	Range 31E	Lot	Ft. from N/S 2000' FSL	Ft. from E/W 10' FEL	Latitude 32.7023028	Longitude -103.81456	County EDDY
----------------	----------------------	------------------------	---------------------	-----	----------------------------------	--------------------------------	-------------------------------	--------------------------------	-----------------------

First Take Point (FTP)

UL I	Section 36	Township 18S	Range 31E	Lot	Ft. from N/S 2000' FSL	Ft. from E/W 100' FEL	Latitude 32.7023024	Longitude -103.81486	County EDDY
----------------	----------------------	------------------------	---------------------	-----	----------------------------------	---------------------------------	-------------------------------	--------------------------------	-----------------------

Last Take Point (LTP)

UL J	Section 35	Township 18S	Range 31E	Lot	Ft. from N/S 2000' FSL	Ft. from E/W 2540' FEL	Latitude 32.7022553	Longitude -103.84018	County EDDY
----------------	----------------------	------------------------	---------------------	-----	----------------------------------	----------------------------------	-------------------------------	--------------------------------	-----------------------

Unitized Area or Area of Uniform Interest	Spacing Unit Type <input checked="" type="checkbox"/> Horizontal <input type="checkbox"/> Vertical	Ground Floor Elevation: 3,698'
---	--	---------------------------------------

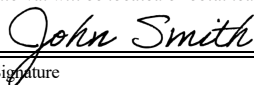
OPERATOR CERTIFICATIONS <i>I hereby certify that the information contained herein is true and complete to the best of my knowledge and belief, and, if the well is a vertical or directional well, that this organization either owns a working interest or unleased mineral interest in the land including the proposed bottom hole location or has a right to drill this well at this location pursuant to a contract with an owner of a working interest or unleased mineral interest, or to a voluntary pooling agreement or a compulsory pooling order heretofore entered by the division.</i> <i>If this well is a horizontal well, I further certify that this organization has received the consent of at least one lessee or owner of a working interest or unleased mineral interest in each tract (in the target pool or formation) in which any part of the well's completed interval will be located or obtained a compulsory pooling order from the division.</i>  03/06/2025 Signature Date John Smith Printed Name john.smith@mewbourne.com Email Address		SURVEYOR CERTIFICATIONS <i>I hereby certify that the well location shown on this plat was plotted from field notes of actual surveys made by me or under my supervision, and that the same is true and correct to the best of my belief.</i> Signature and Seal of Professional Surveyor Certificate Number Date of Survey	
--	--	---	--

Note: No allowable will be assigned to this completion until all interests have been consolidated or a non-standard unit has been approved by the division.

This grid represents a standard section. You may superimpose a non-standard section, or larger area, over this grid. Operators must outline the dedicated acreage in a red box, clearly show the well surface location and bottom hole location, if it is directionally drilled, with the dimensions from the section lines in the cardinal directions. If this is a horizontal wellbore show on this plat the location of the First Take Point and Last Take Point, and the point within the Completed interval (other than the First Take Point or Last Take Point) that is closest to any outer boundary of the tract.

Surveyors shall use the latest United States government survey or dependent resurvey. Well locations will be in reference to the New Mexico Principal Meridian. If the land is not surveyed, contact the OCD Engineering Bureau. Independent subdivision surveys will not be acceptable.

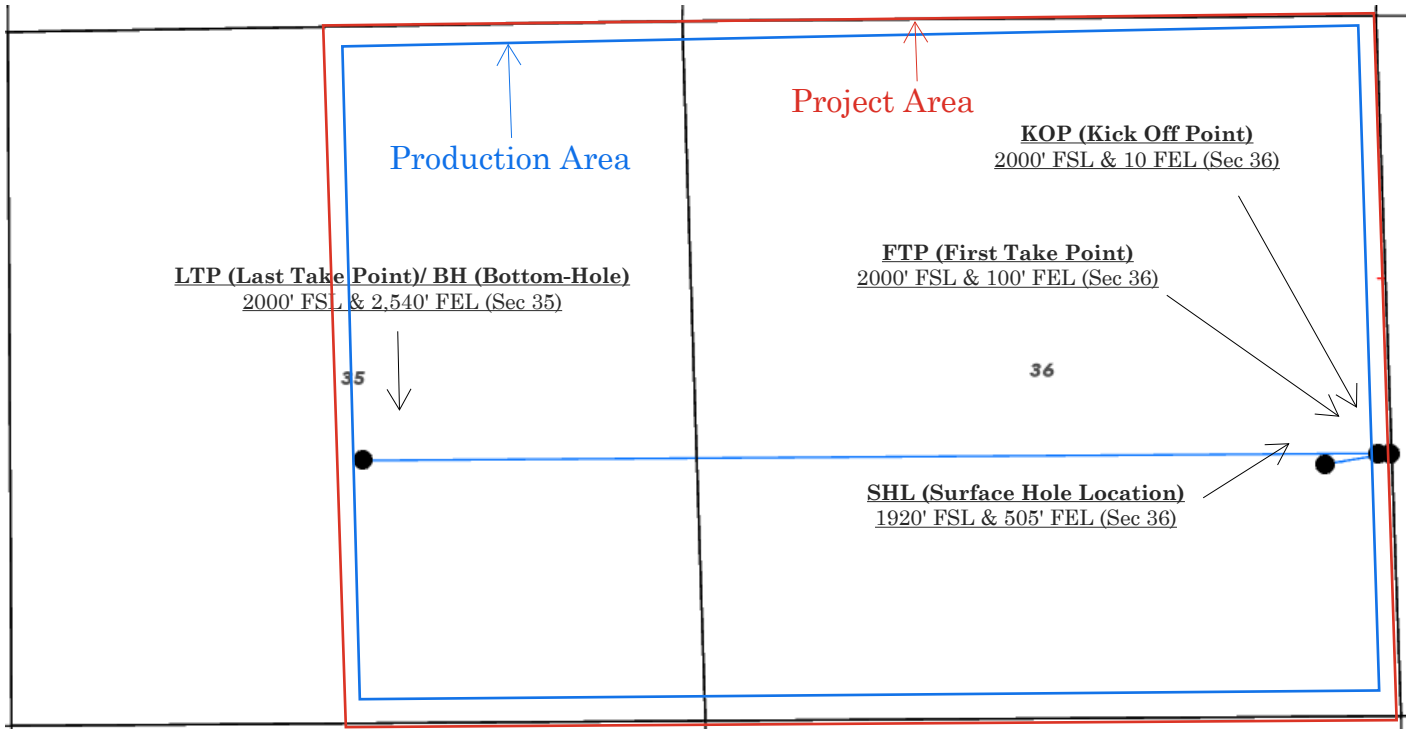

C-102 Submit Electronically Via OCD Permitting	State of New Mexico Energy, Minerals & Natural Resources Department OIL CONSERVATION DIVISION	Revised July 9, 2024	
		Submittal Type:	<input type="checkbox"/> Initial Submittal
			<input type="checkbox"/> Amended Report
		<input type="checkbox"/> As Drilled	

WELL LOCATION INFORMATION

API Number	Pool Code 1 * 11 &	Pool Name FS_ S a 4a' Wbd Y
Property Code	Property Name LEAD BELLY 36/35 FED COM	Well Number 527H
OGRID No. 14744	Operator Name MEWBOURNE OIL COMPANY	Ground Level Elevation 3670'
Surface Owner: <input checked="" type="checkbox"/> State <input type="checkbox"/> Fee <input type="checkbox"/> Tribal <input type="checkbox"/> Federal		Mineral Owner: <input checked="" type="checkbox"/> State <input type="checkbox"/> Fee <input type="checkbox"/> Tribal <input checked="" type="checkbox"/> Federal

Surface Location

UL I	Section 36	Township 18S	Range 31E	Lot	Ft. from N/S 1880' FSL	Ft. from E/W 505' FEL	Latitude 32.7019702	Longitude -103.81616	County EDDY
-------------	-------------------	---------------------	------------------	-----	-------------------------------	------------------------------	----------------------------	-----------------------------	--------------------

Bottom Hole Location

UL O	Section 35	Township 18S	Range 31E	Lot	Ft. from N/S 700' FSL	Ft. from E/W 2540' FEL	Latitude 32.6986816	Longitude -103.83987	County EDDY
-------------	-------------------	---------------------	------------------	-----	------------------------------	-------------------------------	----------------------------	-----------------------------	--------------------

Dedicated Acres 960	Infill or Defining Well	Defining Well API	Overlapping Spacing Unit (Y/N) Y	Consolidation Code C
Order Numbers.			Well setbacks are under Common Ownership: <input type="checkbox"/> Yes <input checked="" type="checkbox"/> No	

Kick Off Point (KOP)

UL P	Section 36	Township 18S	Range 31E	Lot	Ft. from N/S 700' FSL	Ft. from E/W 10' FEL	Latitude 32.6987299	Longitude -103.81443	County EDDY
-------------	-------------------	---------------------	------------------	-----	------------------------------	-----------------------------	----------------------------	-----------------------------	--------------------

First Take Point (FTP)

UL P	Section 36	Township 18S	Range 31E	Lot	Ft. from N/S 700' FSL	Ft. from E/W 100' FEL	Latitude 32.6987294	Longitude -103.81472	County EDDY
-------------	-------------------	---------------------	------------------	-----	------------------------------	------------------------------	----------------------------	-----------------------------	--------------------

Last Take Point (LTP)

UL O	Section 35	Township 18S	Range 31E	Lot	Ft. from N/S 700' FSL	Ft. from E/W 2540' FEL	Latitude 32.6986816	Longitude -103.83987	County EDDY
-------------	-------------------	---------------------	------------------	-----	------------------------------	-------------------------------	----------------------------	-----------------------------	--------------------

Unitized Area or Area of Uniform Interest	Spacing Unit Type <input checked="" type="checkbox"/> Horizontal <input type="checkbox"/> Vertical	Ground Floor Elevation: 3,698'
---	--	---------------------------------------

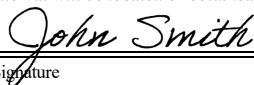
OPERATOR CERTIFICATIONS <i>I hereby certify that the information contained herein is true and complete to the best of my knowledge and belief, and, if the well is a vertical or directional well, that this organization either owns a working interest or unleased mineral interest in the land including the proposed bottom hole location or has a right to drill this well at this location pursuant to a contract with an owner of a working interest or unleased mineral interest, or to a voluntary pooling agreement or a compulsory pooling order heretofore entered by the division.</i> <i>If this well is a horizontal well, I further certify that this organization has received the consent of at least one lessee or owner of a working interest or unleased mineral interest in each tract (in the target pool or formation) in which any part of the well's completed interval will be located or obtained a compulsory pooling order from the division.</i>  03/06/2025 Signature Date John Smith Printed Name john.smith@mewbourne.com Email Address		SURVEYOR CERTIFICATIONS <i>I hereby certify that the well location shown on this plat was plotted from field notes of actual surveys made by me or under my supervision, and that the same is true and correct to the best of my belief.</i> Signature and Seal of Professional Surveyor Certificate Number Date of Survey	
--	--	---	--

Note: No allowable will be assigned to this completion until all interests have been consolidated or a non-standard unit has been approved by the division.

This grid represents a standard section. You may superimpose a non-standard section, or larger area, over this grid. Operators must outline the dedicated acreage in a red box, clearly show the well surface location and bottom hole location, if it is directionally drilled, with the dimensions from the section lines in the cardinal directions. If this is a horizontal wellbore show on this plat the location of the First Take Point and Last Take Point, and the point within the Completed interval (other than the First Take Point or Last Take Point) that is closest to any outer boundary of the tract.

Surveyors shall use the latest United States government survey or dependent resurvey. Well locations will be in reference to the New Mexico Principal Meridian. If the land is not surveyed, contact the OCD Engineering Bureau. Independent subdivision surveys will not be acceptable.

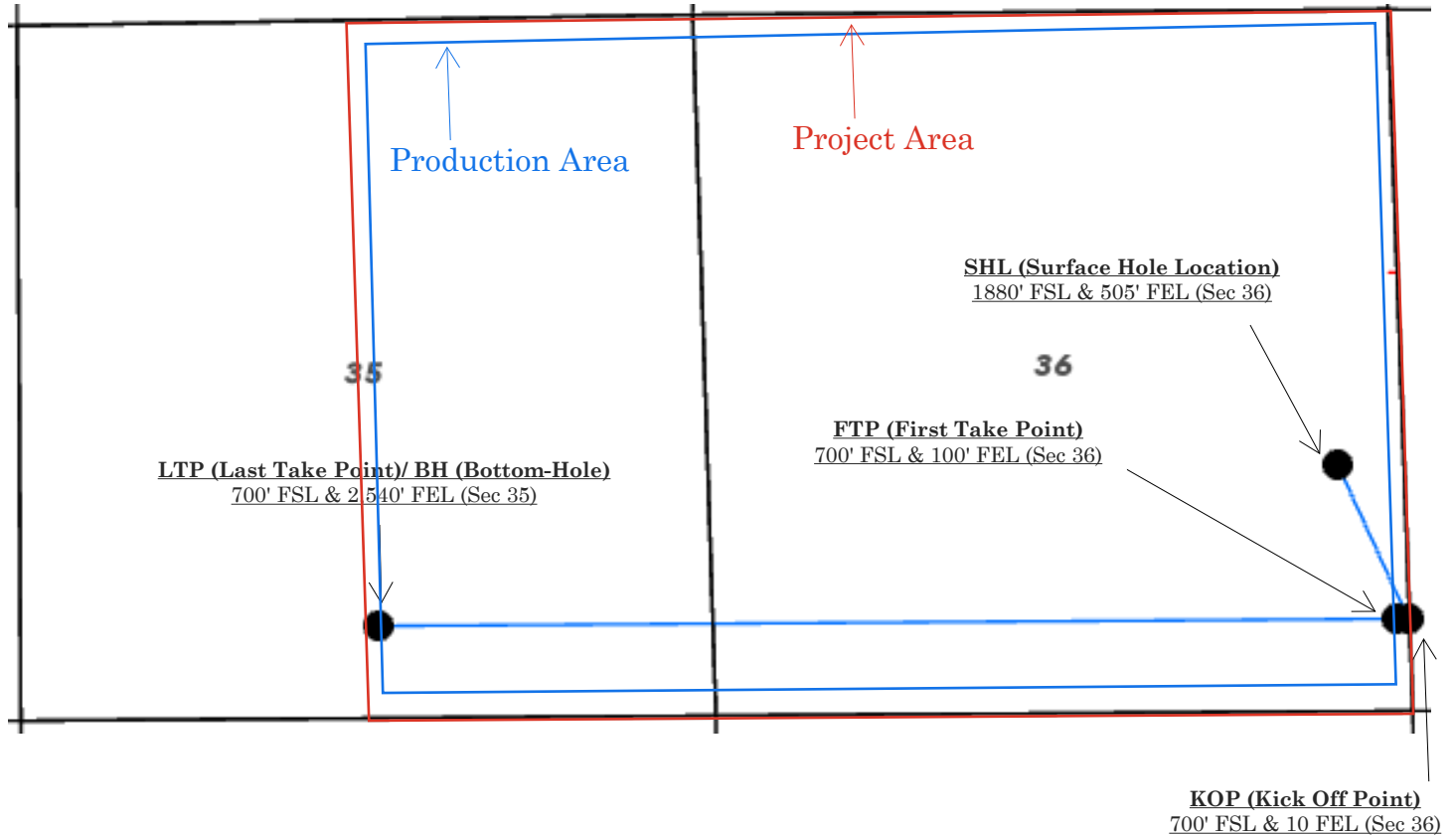

This grid represents a standard section. You may superimpose a non-standard section, or larger area, over this grid. Operators must outline the dedicated acreage in a red box, clearly show the well surface location and bottom hole location, if it is directionally drilled, with the dimensions from the section lines in the cardinal directions. If this is a horizontal wellbore show on this plat the location of the First Take Point and Last Take Point, and the point within the Completed interval (other than the First Take Point or Last Take Point) that is closest to any outer boundary of the tract.

Surveyors shall use the latest United States government survey or dependent resurvey. Well locations will be in reference to the New Mexico Principal Meridian. If the land is not surveyed, contact the OCD Engineering Bureau. Independent subdivision surveys will not be acceptable.

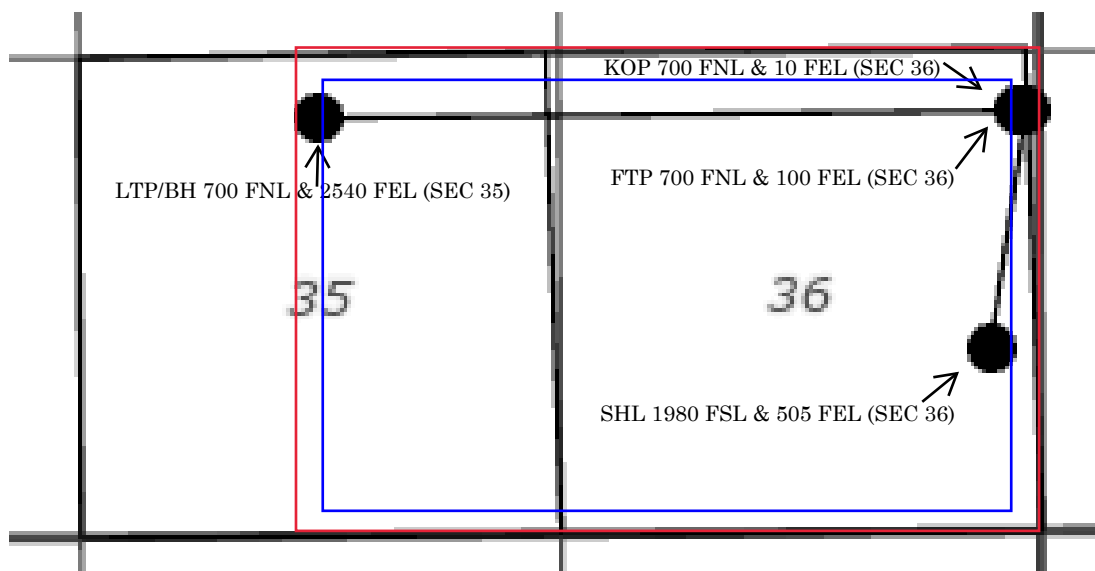

Santa Fe Main Office Phone: (505) 476-3441 General Information Phone: (505) 629-6116 Online Phone Directory Visit: https://www.emnrd.nm.gov/ocd/contact-us/	State of New Mexico Energy, Minerals & Natural Resources Department OIL CONSERVATION DIVISION	C-102 Revised July 9, 2024 Submit Electronically via OCD Permitting
		Submittal Type: <input type="checkbox"/> Initial Submittal <input type="checkbox"/> Amended Report <input type="checkbox"/> As Drilled

WELL LOCATION INFORMATION

API Number	Pool Code 1 * " &	Pool Name FS_ S a 4a` Wbd` Y
Property Code	Property Name LEAD BELLY 36/35 FED COM	Well Number 624H
OGRID No. 14744	Operator Name MEWBOURNE OIL COMPANY	Ground Level Elevation 3670'
Surface Owner: <input checked="" type="checkbox"/> State <input type="checkbox"/> Fee <input type="checkbox"/> Tribal <input type="checkbox"/> Federal		Mineral Owner: <input type="checkbox"/> State <input type="checkbox"/> Fee <input type="checkbox"/> Tribal <input checked="" type="checkbox"/> Federal

Surface Location

UL I	Section 36	Township 18S	Range 31E	Lot	Ft. from N/S 1940 FSL	Ft. from E/W 505 FEL	Latitude 32.7021351863	Longitude -103.8161663033	County EDDY
----------------	----------------------	------------------------	---------------------	-----	---------------------------------	--------------------------------	----------------------------------	-------------------------------------	-----------------------

Bottom Hole Location

UL G	Section 35	Township 18S	Range 31E	Lot	Ft. from N/S 2080 FNL	Ft. from E/W 2540 FEL	Latitude 32.7056182158	Longitude -103.8401023405	County EDDY
----------------	----------------------	------------------------	---------------------	-----	---------------------------------	---------------------------------	----------------------------------	-------------------------------------	-----------------------

Dedicated Acres 960	Infill or Defining Well	Defining Well API	Overlapping Spacing Unit (Y/N) Y	Consolidation Code C
Order Numbers.			Well setbacks are under Common Ownership: <input checked="" type="checkbox"/> Yes <input type="checkbox"/> No	

Kick Off Point (KOP)

UL	Section 36	Township 18S	Range 31E	Lot	Ft. from N/S 2080 FNL	Ft. from E/W 10 FEL	Latitude 32.7057364119	Longitude -103.8146884215	County EDDY
----	----------------------	------------------------	---------------------	-----	---------------------------------	-------------------------------	----------------------------------	-------------------------------------	-----------------------

First Take Point (FTP)

UL	Section 36	Township 18S	Range 31E	Lot	Ft. from N/S 2080 FNL	Ft. from E/W 100 FEL	Latitude 32.7057414722	Longitude -103.8149816345	County EDDY
----	----------------------	------------------------	---------------------	-----	---------------------------------	--------------------------------	----------------------------------	-------------------------------------	-----------------------

Last Take Point (LTP)

UL	Section 35	Township 18S	Range 31E	Lot	Ft. from N/S 2080 FNL	Ft. from E/W 2540 FEL	Latitude 32.7056182158	Longitude -103.8401023405	County EDDY
----	----------------------	------------------------	---------------------	-----	---------------------------------	---------------------------------	----------------------------------	-------------------------------------	-----------------------

Unitized Area or Area of Uniform Interest	Spacing Unit Type <input checked="" type="checkbox"/> Horizontal <input type="checkbox"/> Vertical	Ground Floor Elevation: 3670'
---	--	---

OPERATOR CERTIFICATIONS

I hereby certify that the information contained herein is true and complete to the best of my knowledge and belief, and, if the well is a vertical or directional well, that this organization either owns a working interest or unleased mineral interest in the land including the proposed bottom hole location or has a right to drill this well at this location pursuant to a contract with an owner of a working interest or unleased mineral interest, or to a voluntary pooling agreement or a compulsory pooling order heretofore entered by the division.

If this well is a horizontal well, I further certify that this organization has received the consent of at least one lessee or owner of a working interest or unleased mineral interest in each tract (in the target pool or formation) in which any part of the well's completed interval will be located or obtained a compulsory pooling order from the division.

Brett Miller 03/06/2025
Signature Date

Brett Miller

Printed Name

brett.miller@mewbourne.com

Email Address

SURVEYOR CERTIFICATIONS

I hereby certify that the well location shown on this plat was plotted from field notes of actual surveys made by me or under my supervision, and that the same is true and correct to the best of my belief.

Signature and Seal of Professional Surveyor

Certificate Number

Date of Survey

Note: No allowable will be assigned to this completion until all interests have been consolidated or a non-standard unit has been approved by the division.

This grid represents a standard section. You may superimpose a non-standard section, or larger area, over this grid. Operators must outline the dedicated acreage in a red box, clearly show the well surface location and bottom hole location, if it is directionally drilled, with the dimensions from the section lines in the cardinal directions. If this is a horizontal wellbore show on this plat the location of the First Take Point and Last Take Point, and the point within the Completed interval (other than the First Take Point or Last Take Point) that is closest to any outer boundary of the tract.

Surveyors shall use the latest United States government survey or dependent resurvey. Well locations will be in reference to the New Mexico Principal Meridian. If the land is not surveyed, contact the OCD Engineering Bureau. Independent subdivision surveys will not be acceptable.

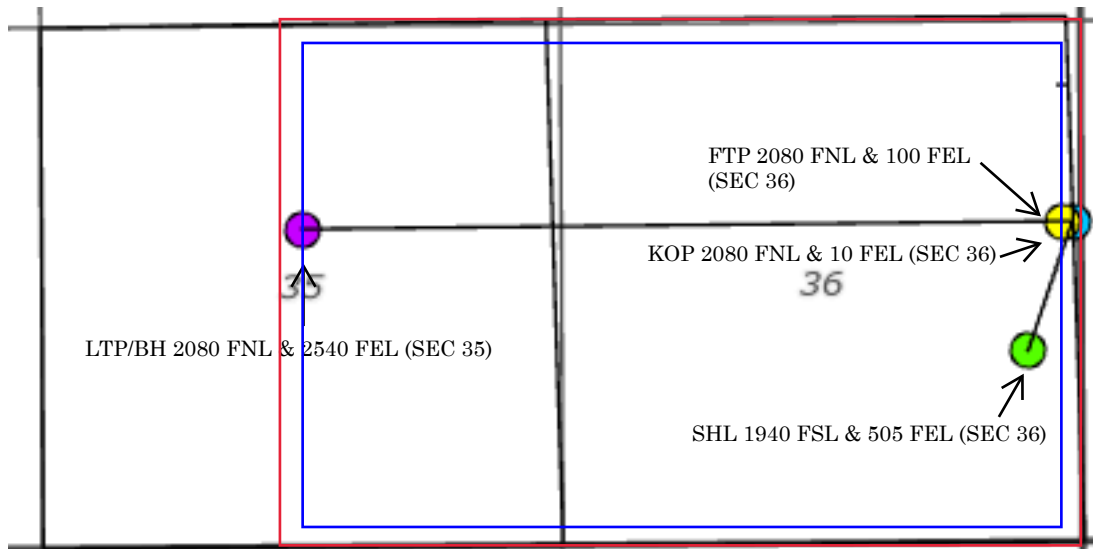

Santa Fe Main Office Phone: (505) 476-3441 General Information Phone: (505) 629-6116 Online Phone Directory Visit: https://www.emnrd.nm.gov/ocd/contact-us/	State of New Mexico Energy, Minerals & Natural Resources Department OIL CONSERVATION DIVISION	C-102 Revised July 9, 2024 Submit Electronically via OCD Permitting
	Submittal Type:	<input type="checkbox"/> Initial Submittal <input type="checkbox"/> Amended Report <input type="checkbox"/> As Drilled

WELL LOCATION INFORMATION

API Number	Pool Code 1 * " &	Pool Name FS S a 4a` Wbd` Y
Property Code	Property Name LEAD BELLY 36/35 FED COM	Well Number 626H
OGRID No. 14744	Operator Name MEWBOURNE OIL COMPANY	Ground Level Elevation 3670'
Surface Owner: <input checked="" type="checkbox"/> State <input type="checkbox"/> Fee <input type="checkbox"/> Tribal <input type="checkbox"/> Federal		Mineral Owner: <input type="checkbox"/> State <input type="checkbox"/> Fee <input type="checkbox"/> Tribal <input checked="" type="checkbox"/> Federal

Surface Location

UL	Section	Township	Range	Lot	Ft. from N/S	Ft. from E/W	Latitude	Longitude	County
I	36	18S	31E		1900 FSL	505 FEL	32.7020250026	-103.8163086776	EDDY

Bottom Hole Location

UL	Section	Township	Range	Lot	Ft. from N/S	Ft. from E/W	Latitude	Longitude	County
J	35	18S	31E		1800 FSL	2540 FEL	32.7017049473	-103.8399707513	EDDY

Dedicated Acres 960	Infill or Defining Well	Defining Well API	Overlapping Spacing Unit (Y/N) Y	Consolidation Code C
Order Numbers.			Well setbacks are under Common Ownership: <input checked="" type="checkbox"/> Yes <input type="checkbox"/> No	

Kick Off Point (KOP)

UL	Section	Township	Range	Lot	Ft. from N/S	Ft. from E/W	Latitude	Longitude	County
	36	18S	31E		1800 FSL	10 FEL	32.7017530990	-103.8145423038	EDDY

First Take Point (FTP)

UL	Section	Township	Range	Lot	Ft. from N/S	Ft. from E/W	Latitude	Longitude	County
	36	18S	31E		1800 FSL	100 FEL	32.7017525749	-103.8148350029	EDDY

Last Take Point (LTP)

UL	Section	Township	Range	Lot	Ft. from N/S	Ft. from E/W	Latitude	Longitude	County
	35	18S	31E		1800 FSL	2540 FEL	32.7017049473	-103.8399707513	EDDY

Unitized Area or Area of Uniform Interest	Spacing Unit Type <input checked="" type="checkbox"/> Horizontal <input type="checkbox"/> Vertical	Ground Floor Elevation: 3670'
---	--	----------------------------------

OPERATOR CERTIFICATIONS

I hereby certify that the information contained herein is true and complete to the best of my knowledge and belief, and, if the well is a vertical or directional well, that this organization either owns a working interest or unleased mineral interest in the land including the proposed bottom hole location or has a right to drill this well at this location pursuant to a contract with an owner of a working interest or unleased mineral interest, or to a voluntary pooling agreement or a compulsory pooling order heretofore entered by the division.

If this well is a horizontal well, I further certify that this organization has received the consent of at least one lessee or owner of a working interest or unleased mineral interest in each tract (in the target pool or formation) in which any part of the well's completed interval will be located or obtained a compulsory pooling order from the division.

Brett Miller 03/06/2025

Signature

Date

Brett Miller

Printed Name

brett.miller@mewbourne.com

Email Address

SURVEYOR CERTIFICATIONS

I hereby certify that the well location shown on this plat was plotted from field notes of actual surveys made by me or under my supervision, and that the same is true and correct to the best of my belief.

Signature and Seal of Professional Surveyor

Certificate Number

Date of Survey

Note: No allowable will be assigned to this completion until all interests have been consolidated or a non-standard unit has been approved by the division.

This grid represents a standard section. You may superimpose a non-standard section, or larger area, over this grid. Operators must outline the dedicated acreage in a red box, clearly show the well surface location and bottom hole location, if it is directionally drilled, with the dimensions from the section lines in the cardinal directions. If this is a horizontal wellbore show on this plat the location of the First Take Point and Last Take Point, and the point within the Completed interval (other than the First Take Point or Last Take Point) that is closest to any outer boundary of the tract.

Surveyors shall use the latest United States government survey or dependent resurvey. Well locations will be in reference to the New Mexico Principal Meridian. If the land is not surveyed, contact the OCD Engineering Bureau. Independent subdivision surveys will not be acceptable.

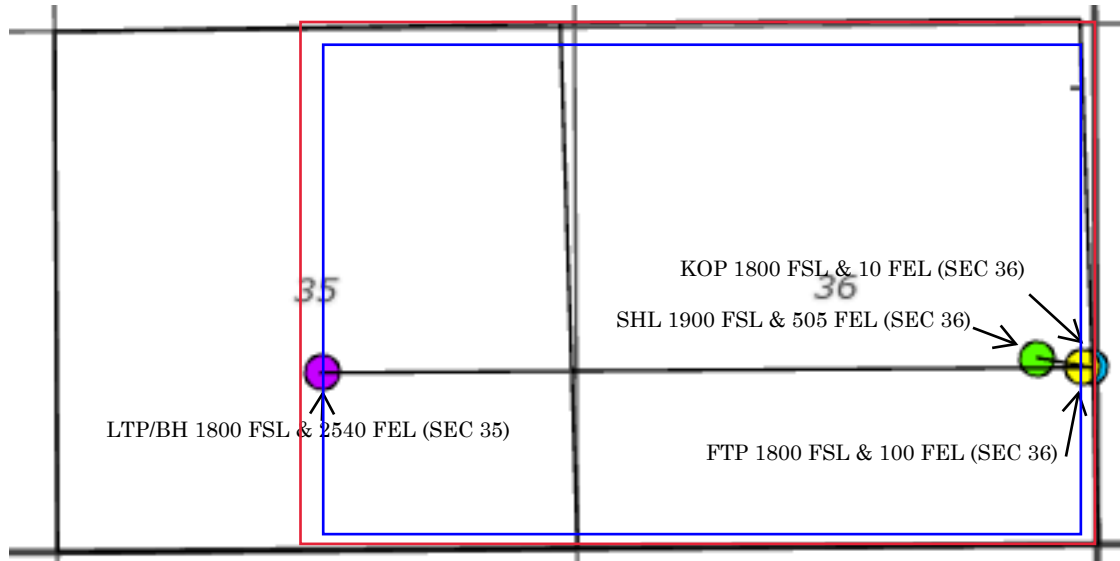

Santa Fe Main Office Phone: (505) 476-3441 General Information Phone: (505) 629-6116 Online Phone Directory Visit: https://www.emnrd.nm.gov/ocd/contact-us/	State of New Mexico Energy, Minerals & Natural Resources Department OIL CONSERVATION DIVISION	<div style="text-align: right;"> C-102 Revised July 9, 2024 Submit Electronically via OCD Permitting </div>	
		Submittal Type:	<input type="checkbox"/> Initial Submittal <input type="checkbox"/> Amended Report <input type="checkbox"/> As Drilled

WELL LOCATION INFORMATION

API Number	Pool Code 58040	Pool Name Tamano; Bone Spring	
Property Code	Property Name LEAD BELLY 36/35 FED COM		Well Number 628H
OGRID No. 14744	Operator Name MEWBOURNE OIL COMPANY		Ground Level Elevation 3670'
Surface Owner: <input checked="" type="checkbox"/> State <input type="checkbox"/> Fee <input type="checkbox"/> Tribal <input type="checkbox"/> Federal		Mineral Owner: <input type="checkbox"/> State <input type="checkbox"/> Fee <input type="checkbox"/> Tribal <input checked="" type="checkbox"/> Federal	

Surface Location

UL I	Section 36	Township 18S	Range 31E	Lot	Ft. from N/S 1860 FSL	Ft. from E/W 505 FEL	Latitude 32.7019152606	Longitude -103.8161581443	County EDDY
---------	---------------	-----------------	--------------	-----	--------------------------	-------------------------	---------------------------	------------------------------	----------------

Bottom Hole Location

UL O	Section 35	Township 18S	Range 31E	Lot	Ft. from N/S 450 FSL	Ft. from E/W 2540 FEL	Latitude 32.6979946372	Longitude -103.8398461812	County EDDY
---------	---------------	-----------------	--------------	-----	-------------------------	--------------------------	---------------------------	------------------------------	----------------

Dedicated Acres 960	Infill or Defining Well	Defining Well API	Overlapping Spacing Unit (Y/N) Y	Consolidation Code C
Order Numbers.			Well setbacks are under Common Ownership: <input checked="" type="checkbox"/> Yes <input type="checkbox"/> No	

Kick Off Point (KOP)

UL	Section	Township	Range	Lot	Ft. from N/S	Ft. from E/W	Latitude	Longitude	County
	36	18S	31E		450 FSL	10 FEL	32.6980425944	-103.8144058980	EDDY

First Take Point (FTP)

UL	Section	Township	Range	Lot	Ft. from N/S	Ft. from E/W	Latitude	Longitude	County
	36	18S	31E		450 FSL	100 FEL	32.6980421566	-103.8146987926	EDDY

Last Take Point (LTP)

UL	Section	Township	Range	Lot	Ft. from N/S	Ft. from E/W	Latitude	Longitude	County
	35	18S	31E		450 FSL	2540 FEL	32.6979946372	-103.8398461812	EDDY

Unitized Area or Area of Uniform Interest	Spacing Unit Type <input checked="" type="checkbox"/> Horizontal <input type="checkbox"/> Vertical	Ground Floor Elevation: 3670'
---	--	----------------------------------

OPERATOR CERTIFICATIONS		SURVEYOR CERTIFICATIONS	
<p><i>I hereby certify that the information contained herein is true and complete to the best of my knowledge and belief, and, if the well is a vertical or directional well, that this organization either owns a working interest or unleased mineral interest in the land including the proposed bottom hole location or has a right to drill this well at this location pursuant to a contract with an owner of a working interest or unleased mineral interest, or to a voluntary pooling agreement or a compulsory pooling order heretofore entered by the division.</i></p> <p><i>If this well is a horizontal well, I further certify that this organization has received the consent of at least one lessee or owner of a working interest or unleased mineral interest in each tract (in the target pool or formation) in which any part of the well's completed interval will be located or obtained a compulsory pooling order from the division.</i></p> <p><i>Brett Miller</i> 03/06/2025</p>		<p><i>I hereby certify that the well location shown on this plat was plotted from field notes of actual surveys made by me or under my supervision, and that the same is true and correct to the best of my belief.</i></p>	
Signature Date		Signature and Seal of Professional Surveyor	
Brett Miller			
Printed Name			
brett.miller@mewbourne.com			
Email Address		Certificate Number	Date of Survey

This grid represents a standard section. You may superimpose a non-standard section, or larger area, over this grid. Operators must outline the dedicated acreage in a red box, clearly show the well surface location and bottom hole location, if it is directionally drilled, with the dimensions from the section lines in the cardinal directions. If this is a horizontal wellbore show on this plat the location of the First Take Point and Last Take Point, and the point within the Completed interval (other than the First Take Point or Last Take Point) that is closest to any outer boundary of the tract.

Surveyors shall use the latest United States government survey or dependent resurvey. Well locations will be in reference to the New Mexico Principal Meridian. If the land is not surveyed, contact the OCD Engineering Bureau. Independent subdivision surveys will not be acceptable.

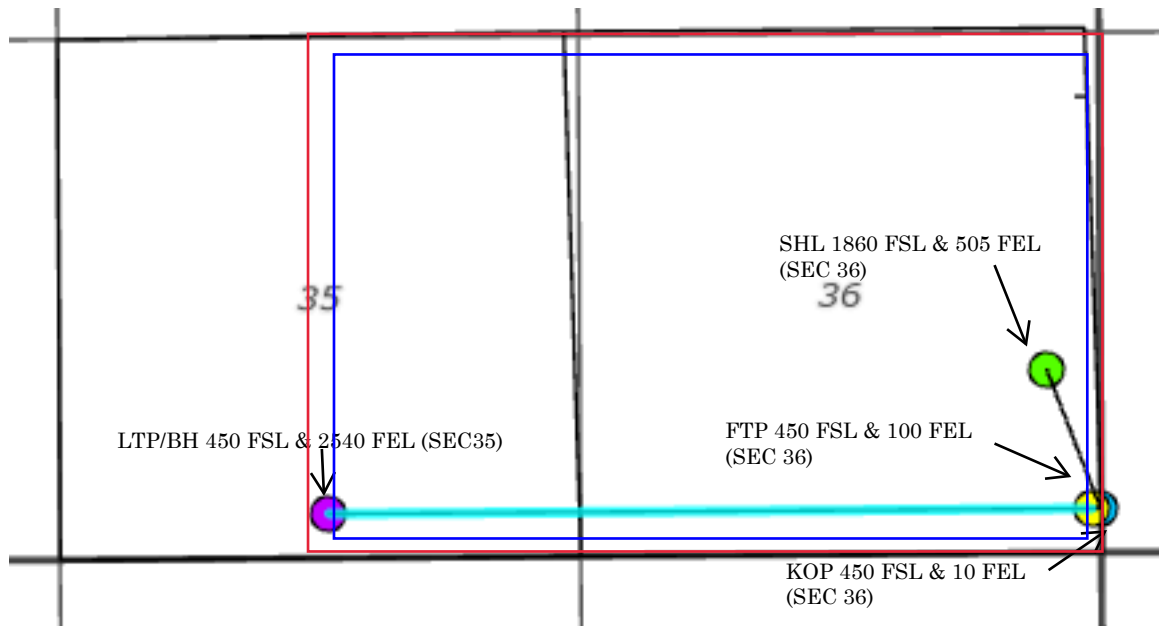

Section Plat
Lead Belly 36/35 Fed Com #521H
Lead Belly 36/35 Fed Com #523H
Lead Belly 36/35 Fed Com #525H
Lead Belly 36/35 Fed Com #527H
Lead Belly 36/35 Fed Com #622H
Lead Belly 36/35 Fed Com #624H
Lead Belly 36/35 Fed Com #626H
Lead Belly 36/35 Fed Com #628H
T18S, R31E, Eddy County, New Mexico

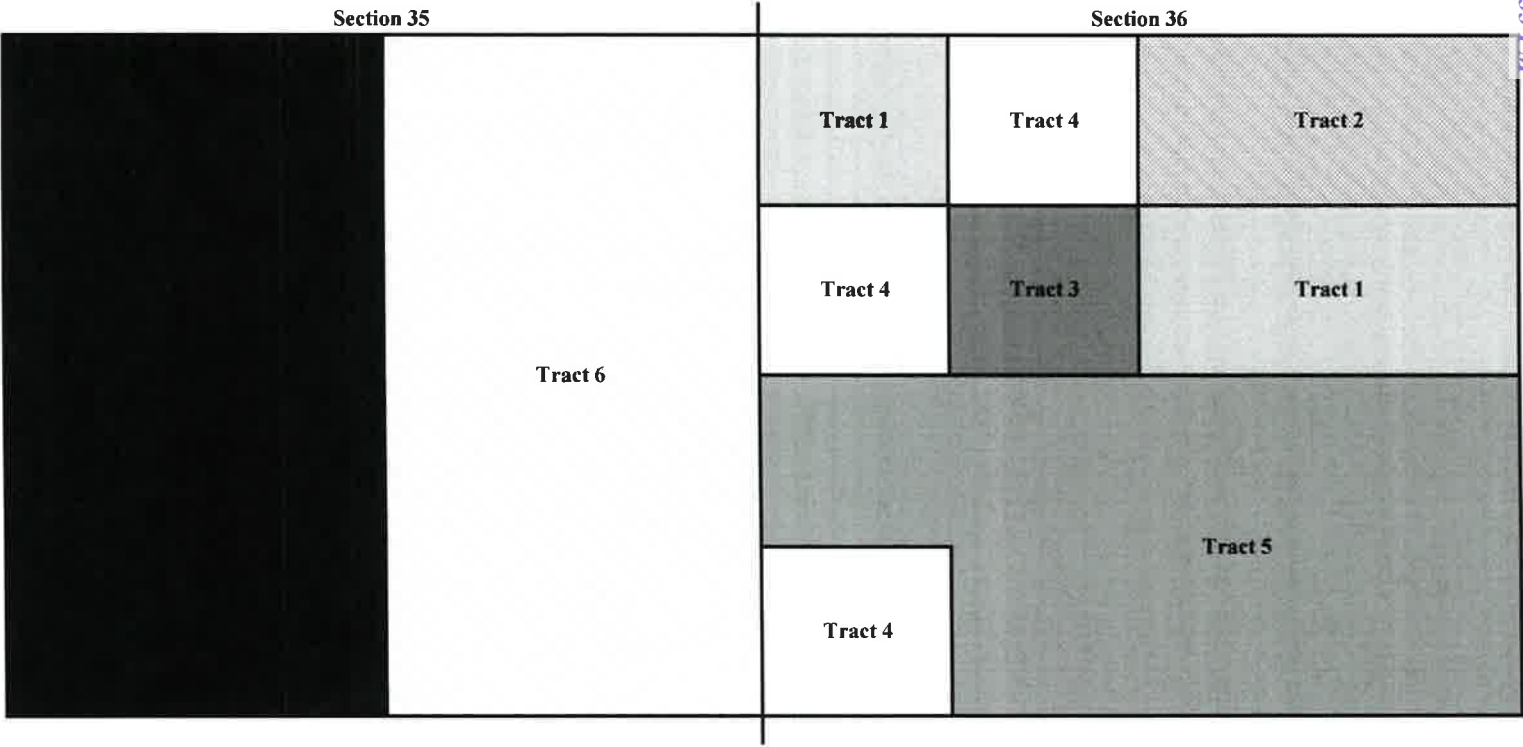

RECAPITULATION

Tract Number	Number of Acres Committeed	Percentage of Interest in Communitized Area
1	120.00	12.500000%
2	80.00	8.333333%
3	40.00	4.166667%
4	120.00	12.500000%
5	280.00	29.166667%
6	320.00	33.333333%
TOTAL	960.00	100.000000%

Lead Belly 36/35 Fed Com #521H
Lead Belly 36/35 Fed Com #523H
Lead Belly 36/35 Fed Com #525H
Lead Belly 36/35 Fed Com #527H
Lead Belly 36/35 Fed Com #622H
Lead Belly 36/35 Fed Com #624H
Lead Belly 36/35 Fed Com #626H
Lead Belly 36/35 Fed Com #628H
T18S, R31E, Eddy County, New Mexico

Ownership by Tract

Tract 1: NW/4 NW/4, & S/2 NE/4 Sec 36 (V0-6900)

Entity/Individual	Interest	Gross Acres	Net Acres
COG Operating LLC	95.0000000%	120.00	114.000000
Concho Oil & Gas LLC	5.0000000%	120.00	6.000000
Total	100.000000%		120.000000

Tract 2: N/2 NE/4 Sec 36 (V0-6402)

Entity/Individual	Interest	Gross Acres	Net Acres
Mewbourne Oil Company, et. al.	34.000000%	80.00	27.200000
COG Operating LLC	47.500000%	80.00	38.000000
Concho Oil & Gas LLC	2.500000%	80.00	2.000000
Elliott-Hall Company	8.000000%	80.00	6.400000
Elliott Industries Limited Partnership	8.000000%	80.00	6.400000
Total	100.000000%		80.000000

Tract 3: SE/4 NW/4 Sec 36 (B0-1778)

Entity/Individual	Interest	Gross Acres	Net Acres
COG Operating LLC	95.000000%	40.00	38.000000
Concho Oil & Gas LLC	5.000000%	40.00	2.000000
Total	100.000000%		40.000000

Tract 4: SW/4 NW/4, NE/4 NW/4, & SW/4 SW/4 Sec 36 (E0-9222)

Entity/Individual	Interest	Gross Acres	Net Acres
COG Operating LLC	66.900000%	120.00	80.280000
Concho Oil & Gas LLC	1.766667%	120.00	2.120000
Other Parties Not Pooled	31.333333%	120.00	37.600000
Total	100.000000%		120.000000

Tract 5: NWSE of Section 23 - Federal Lease NMNM 0065680

Entity/Individual	Interest	Gross Acres	Net Acres
COG Operating LLC	36.071429%	280.00	101.000000
Concho Oil & Gas LLC	1.428571%	280.00	4.000000
MRC Delaware Resources LLC	32.777143%	280.00	91.776000
Riverbend Production, LP	26.785714%	280.00	75.000000
Other Parties Not Pooled	2.937143%	280.00	8.224000
Total	100.000000%		280.000000

Tract 6: E2 Sec 35 - NMLC 0029382B

Entity/Individual	Interest	Gross Acres	Net Acres
Mewbourne Oil Company	49.0000000%	320.00	156.800000
ConocoPhillips Company	50.0000000%	320.00	160.000000
Other Parties Not Pooled	1.0000000%	320.00	3.200000
Total	100.000000%		320.000000

Spacing Unit Ownership

Owners	Percentage	
Mewbourne Oil Company, et al.	24.273333%	233.024000
COG Operating LLC*	38.675000%	371.280000
Concho Oil & Gas LLC*	1.679167%	16.120000
ConocoPhillips Company*	16.666667%	160.000000
MRC Delaware Resources LLC*	9.560000%	91.776000
Riverbend Production, LP*	7.812500%	75.000000
Elliott-Hall Company*	0.666667%	6.400000
Elliott Industries Limited Partnership*	0.666667%	6.400000
Total	100.000000%	960.00000000

75.726667%

MEWBOURNE OIL COMPANY

500 West Texas, Suite 1020
Midland, Texas 79701
Phone (432) 682-3715

November 15, 2024

Overnight Mail

«Owner_Name»
«Attention»
«Address_Line_1»
«Address_Line_2»
«City», «State» «Zip»

Re: Lead Belly 36/35 Working Interest Unit and Well Proposals
All of Section 36 and E/2 of Section 35
T18S, R31E, Eddy County, New Mexico

Ladies and Gentlemen:

Mewbourne Oil Company ("MOC"), as Operator, hereby proposes creating a working interest unit comprising of All of Section 36 and the E/2 of Section 35, T18S, R31E, Eddy County, New Mexico. As part of the initial development of this unit, MOC hereby proposes the following wells targeting the Bone Spring formation:

- 1) LEAD BELLY 36/35 FED COM #521H – API # - pending
Surface Location: 2000 FSL & 505 FEL, Section 36, T18S, R31E
Bottom Hole Location: 660 FNL & 2540 FEL, Section 35, T18S, R31E
Proposed Total Vertical Depth: 8,940'
Proposed Total Measured Depth: 16,645'
- 2) LEAD BELLY 36/35 FED COM #523H – API # - pending
Surface Location: 1960 FSL & 505 FEL, Section 36, T18S, R31E
Bottom Hole Location: 1950 FNL & 2540 FEL, Section 35, T18S, R31E
Proposed Total Vertical Depth: 8,952'
Proposed Total Measured Depth: 16,339'
- 3) LEAD BELLY 36/35 FED COM #525H – API # - pending
Surface Location: 1920 FSL & 505 FEL, Section 36, T18S, R31E
Bottom Hole Location: 2000 FSL & 2540 FEL, Section 35, T18S, R31E
Proposed Total Vertical Depth: 8,957'
Proposed Total Measured Depth: 16,239'
- 4) LEAD BELLY 36/35 FED COM #527H – API # - pending
Surface Location: 1880 FSL & 505 FEL, Section 36, T18S, R31E
Bottom Hole Location: 700 FSL & 2540 FEL, Section 35, T18S, R31E
Proposed Total Vertical Depth: 8,980'
Proposed Total Measured Depth: 16,353'
- 5) LEAD BELLY 36/35 FED COM #622H – API # - pending
Surface Location: 1980 FSL & 505 FEL, Section 36, T18S, R31E
Bottom Hole Location: 700 FNL & 2540 FEL, Section 35, T18S, R31E
Proposed Total Vertical Depth: 9,662'
Proposed Total Measured Depth: 17,334'
- 6) LEAD BELLY 36/35 FED COM #624H – API # - pending
Surface Location: 1940 FSL & 505 FEL, Section 36, T18S, R31E
Bottom Hole Location: 2080 FNL & 2540 FEL, Section 35, T18S, R31E
Proposed Total Vertical Depth: 9,696'
Proposed Total Measured Depth: 17,026'
- 7) LEAD BELLY 36/35 FED COM #626H – API # - pending
Surface Location: 1900 FSL & 505 FEL, Section 36, T18S, R31E
Bottom Hole Location: 1800 FSL & 2540 FEL, Section 35, T18S, R31E
Proposed Total Vertical Depth: 9,700'
Proposed Total Measured Depth: 16,945'

- 8) LEAD BELLY 36/35 FED COM # 628H – API # - pending
Surface Location: 1860 FSL & 505 FEL, Section 36, T18S, R31E
Bottom Hole Location: 450 FSL & 2540 FEL, Section 35, T18S, R31E
Proposed Total Vertical Depth: 9,760'
Proposed Total Measured Depth: 17,099'

Regarding the above, enclosed for your further handling is our Operating Agreement dated November 1, 2024, along with an extra set of signature pages and our AFEs dated November 15, 2024 for the captioned proposed wells.

In the event your firm elects to participate in the proposed wells, please execute the enclosed extra set of JOA signature/notary pages and the AFEs before mailing them back to my attention to the address on the letterhead above within thirty (30) days.

Please contact me at (432) 682-3715 or arodrigues@mewbourne.com if you have any questions or need additional information.

Very truly yours,

MEWBOURNE OIL COMPANY

Ariana Rodrigues
Landman

MEWBOURNE OIL COMPANY
AUTHORIZATION FOR EXPENDITURE

Well Name: LEAD BELLY 36/35 FED COM # 521H (B2AB)		Prospect: LEAD BELLY			
Location: SL: 2000 FSL & 505 FEL (36); BHL: 660 FNL & 2540 FEL (35)		County: EDDY ST: NM			
Sec. 36	Blk:	Survey:	TWP: 18S RNG: 31E Prop. TVD: 8940 TMD: 16645		
INTANGIBLE COSTS 0180		CODE	TCP	CODE	CC
Regulatory Permits & Surveys		0180-0100	\$20,000	0180-0200	
Location / Road / Site / Preparation		0180-0105	\$100,000	0180-0205	\$35,000
Location / Restoration		0180-0106	\$150,000	0180-0206	\$80,000
Daywork / Turnkey / Footage Drilling 14 days drlg / 3 days comp @ \$27,000/d		0180-0110	\$403,700	0180-0210	\$86,500
Fuel 1700 gal/day @ \$3.90/gal		0180-0114	\$99,100	0180-0214	\$94,100
Alternate Fuels		0180-0115		0180-0215	\$66,000
Mud, Chemical & Additives		0180-0120	\$40,000	0180-0220	
Mud - Specialized		0180-0121	\$240,000	0180-0221	
Horizontal Drillout Services				0180-0222	\$165,000
Stimulation Toe Preparation				0180-0223	\$21,000
Cementing		0180-0125	\$140,000	0180-0225	\$65,000
Logging & Wireline Services		0180-0130	\$23,100	0180-0230	\$220,300
Casing / Tubing / Snubbing Service		0180-0134	\$40,000	0180-0234	\$18,000
Mud Logging		0180-0137	\$15,000		
Stimulation 37 Stg 14.9 MMgal & 14.9 MMlbs				0180-0241	\$1,542,000
Stimulation Rentals & Other				0180-0242	\$191,000
Water & Other		0180-0145	\$35,000	0180-0245	\$322,100
Bits		0180-0148	\$64,100	0180-0248	
Inspection & Repair Services		0180-0150	\$50,000	0180-0250	\$5,000
Misc. Air & Pumping Services		0180-0154		0180-0254	\$10,000
Testing & Flowback Services		0180-0158	\$12,000	0180-0258	\$24,000
Completion / Workover Rig				0180-0260	\$10,500
Rig Mobilization		0180-0164	\$125,000		
Transportation		0180-0165	\$30,000	0180-0265	\$40,000
Welding, Construction, & Maint. Services		0180-0168	\$4,000	0180-0268	\$16,500
Contract Services & Supervision		0180-0170	\$96,900	0180-0270	\$47,500
Directional Services Includes vertical control		0180-0175	\$350,000		
Equipment Rental		0180-0180	\$108,400	0180-0280	\$23,200
Well / Lease Legal		0180-0184	\$5,000	0180-0284	
Well / Lease Insurance		0180-0185	\$4,000	0180-0285	
Intangible Supplies		0180-0188	\$7,000	0180-0288	\$1,000
Damages		0180-0190	\$10,000	0180-0290	\$10,000
Pipeline Interconnect & ROW Easements		0180-0192		0180-0292	\$5,000
Company Supervision		0180-0195	\$61,200	0180-0295	\$18,000
Overhead Fixed Rate		0180-0196	\$10,000	0180-0296	\$20,000
Contingencies 5% (TCP) 5% (CC)		0180-0199	\$112,200	0180-0299	\$156,800
TOTAL		\$2,355,700		\$3,293,500	
TANGIBLE COSTS 0181					
Casing (19.1" - 30")		0181-0793			
Casing (10.1" - 19.0") 1005' - 13 3/8" 54.5# J-55 ST&C @ \$42.93/ft		0181-0794	\$46,100		
Casing (8.1" - 10.0") 2770' - 9 5/8" 40# J-55 LT&C @ \$33.60/ft		0181-0795	\$99,400		
Casing (6.1" - 8.0") 9300' - 7" 29# HPP110 BT&C @ \$30.17/ft		0181-0796	\$299,700		
Casing (4.1" - 6.0") 7495' - 4 1/2" 13.5# P-110 CDC-HTQ @ \$17.99/ft				0181-0797	\$144,000
Tubing 8565' - 2 7/8" 6.5# L-80 IPC Tbg @ \$10.75/ft				0181-0798	\$98,300
Drilling Head		0181-0860	\$50,000		
Tubing Head & Upper Section				0181-0870	\$30,000
Horizontal Completion Tools				0181-0871	\$75,000
Subsurface Equip. & Artificial Lift				0181-0880	\$40,000
Service Pumps (1/8) TP/CP/Circ pump				0181-0886	\$5,000
Storage Tanks (1/8) (6)OT/(5)WT/(1)GB				0181-0890	\$36,000
Emissions Control Equipment (1/8) (4)VRT/(2)VRU/(1)FLARE/(3)KO/(1)AIR				0181-0892	\$55,000
Separation / Treating Equipment (1/8) (4)H SEP/(1)V SEP/(3)VHT/(1)HHT				0181-0895	\$44,000
Automation Metering Equipment				0181-0898	\$61,000
Oil/Gas Pipeline-Pipe/Valves&Misc				0181-0900	\$41,000
Water Pipeline-Pipe/Valves & Misc				0181-0901	
On-site Valves/Fittings/Lines&Misc				0181-0906	\$73,000
Wellhead Flowlines - Construction				0181-0907	\$210,000
Cathodic Protection				0181-0908	
Electrical Installation				0181-0909	\$210,000
Equipment Installation				0181-0910	\$64,000
Oil/Gas Pipeline - Construction				0181-0920	\$65,000
Water Pipeline - Construction				0181-0921	

MEWBOURNE OIL COMPANY
AUTHORIZATION FOR EXPENDITURE

Well Name: LEAD BELLY 36/35 FED COM # 523H (B2HG)		Prospect: LEAD BELLY	
Location: SL: 1960 FSL & 505 FEL (36); BHL: 1950 FNL & 2540 FEL (35)		County: EDDY	ST: NM
Sec. 36	Blk:	Survey:	TWP: 18S RNG: 31E Prop. TVD: 8952 TMD: 16339

INTANGIBLE COSTS 0180	CODE	TCP	CODE	CC
Regulatory Permits & Surveys	0180-0100	\$20,000	0180-0200	
Location / Road / Site / Preparation	0180-0105	\$100,000	0180-0205	\$35,000
Location / Restoration	0180-0106	\$150,000	0180-0206	\$80,000
Daywork / Turnkey / Footage Drilling 14 days drlg / 3 days comp @ \$27,000/d	0180-0110	\$403,700	0180-0210	\$86,500
Fuel 1700 gal/day @ \$3.90/gal	0180-0114	\$99,100	0180-0214	\$94,100
Alternate Fuels	0180-0115		0180-0215	\$66,000
Mud, Chemical & Additives	0180-0120	\$40,000	0180-0220	
Mud - Specialized	0180-0121	\$240,000	0180-0221	
Horizontal Drillout Services			0180-0222	\$165,000
Stimulation Toe Preparation			0180-0223	\$21,000
Cementing	0180-0125	\$140,000	0180-0225	\$65,000
Logging & Wireline Services	0180-0130	\$23,100	0180-0230	\$220,300
Casing / Tubing / Snubbing Service	0180-0134	\$40,000	0180-0234	\$18,000
Mud Logging	0180-0137	\$15,000		
Stimulation 37 Stg 14.9 MMgal & 14.9 MMlbs			0180-0241	\$1,542,000
Stimulation Rentals & Other			0180-0242	\$191,000
Water & Other	0180-0145	\$35,000	0180-0245	\$322,100
Bits	0180-0148	\$64,100	0180-0248	
Inspection & Repair Services	0180-0150	\$50,000	0180-0250	\$5,000
Misc. Air & Pumping Services	0180-0154		0180-0254	\$10,000
Testing & Flowback Services	0180-0158	\$12,000	0180-0258	\$24,000
Completion / Workover Rig			0180-0260	\$10,500
Rig Mobilization	0180-0164	\$125,000		
Transportation	0180-0165	\$30,000	0180-0265	\$40,000
Welding, Construction, & Maint. Services	0180-0168	\$4,000	0180-0268	\$16,500
Contract Services & Supervision	0180-0170	\$96,900	0180-0270	\$47,500
Directional Services Includes vertical control	0180-0175	\$350,000		
Equipment Rental	0180-0180	\$108,400	0180-0280	\$23,200
Well / Lease Legal	0180-0184	\$5,000	0180-0284	
Well / Lease Insurance	0180-0185	\$4,000	0180-0285	
Intangible Supplies	0180-0188	\$7,000	0180-0288	\$1,000
Damages	0180-0190	\$10,000	0180-0290	\$10,000
Pipeline Interconnect & ROW Easements	0180-0192		0180-0292	\$5,000
Company Supervision	0180-0195	\$61,200	0180-0295	\$18,000
Overhead Fixed Rate	0180-0196	\$10,000	0180-0296	\$20,000
Contingencies 5% (TCP) 5% (CC)	0180-0199	\$112,200	0180-0299	\$156,800
TOTAL		\$2,355,700		\$3,293,500

TANGIBLE COSTS 0181				
Casing (19.1" - 30")	0181-0793			
Casing (10.1" - 19.0") 1005' - 13 3/8" 54.5# J-55 ST&C @ \$42.93/ft	0181-0794	\$46,100		
Casing (8.1" - 10.0") 2770' - 9 5/8" 40# J-55 LT&C @ \$33.60/ft	0181-0795	\$99,400		
Casing (6.1" - 8.0") 9310' - 7" 29# HPP110 BT&C @ \$30.17/ft	0181-0796	\$300,000		
Casing (4.1" - 6.0") 7180' - 4 1/2" 13.5# P-110 CDC-HTQ @ \$17.99/ft			0181-0797	\$138,000
Tubing 8575' - 2 7/8" 6.5# L-80 IPC Tbg @ \$10.75/ft			0181-0798	\$98,400
Drilling Head	0181-0860	\$50,000		
Tubing Head & Upper Section			0181-0870	\$30,000
Horizontal Completion Tools			0181-0871	\$75,000
Subsurface Equip. & Artificial Lift			0181-0880	\$40,000
Service Pumps (1/8) TP/CP/Circ pump			0181-0886	\$5,000
Storage Tanks (1/8) (6)OT/(5)WT/(1)GB			0181-0890	\$36,000
Emissions Control Equipment (1/8) (4)VRT/(2)VRU/(1)FLARE/(3)KO/(1)AIR			0181-0892	\$55,000
Separation / Treating Equipment (1/8) (4)H SEP/(1)V SEP/(3)VHT/(1)HHT			0181-0895	\$44,000
Automation Metering Equipment			0181-0898	\$61,000
Oil/Gas Pipeline-Pipe/Valves&Misc			0181-0900	\$41,000
Water Pipeline-Pipe/Valves & Misc			0181-0901	
On-site Valves/Fittings/Lines&Misc			0181-0906	\$73,000
Wellhead Flowlines - Construction			0181-0907	\$210,000
Cathodic Protection			0181-0908	
Electrical Installation			0181-0909	\$210,000
Equipment Installation			0181-0910	\$64,000
Oil/Gas Pipeline - Construction			0181-0920	\$65,000
Water Pipeline - Construction			0181-0921	\$2,000
TOTAL		\$495,500		\$1,247,400
SUBTOTAL		\$2,851,200		\$4,540,900
TOTAL WELL COST		\$7,392,100		

Extra Expense Insurance

☐ I elect to be covered by Operator's Extra Expense Insurance and pay my proportionate share of the premium.
Operator has secured Extra Expense Insurance covering costs of well control, clean up and redrilling as estimated in Line Item 0180-0185.

☐ I elect to purchase my own well control insurance policy.

If neither box is checked above, non-operating working interest owner elects to be covered by Operator's well control insurance.

Prepared by: H. Buckley

Date: 11/15/2024

Company Approval:

Date:

Joint Owner Interest: Amount:

Joint Owner Name: Signature:

MEWBOURNE OIL COMPANY
AUTHORIZATION FOR EXPENDITURE

Well Name: LEAD BELLY 36/35 FED COM # 525H (B2IJ)		Prospect: LEAD BELLY	
Location: SL: 1920 FSL & 505 FEL (36); BHL: 2000 FSL & 2540 FEL (35)		County: EDDY	ST: NM
Sec. 36	Blk:	Survey:	TWP: 18S
		RNG: 31E	Prop. TVD: 8957
		TMD: 16239	

INTANGIBLE COSTS 0180	CODE	TCP	CODE	CC
Regulatory Permits & Surveys	0180-0100	\$20,000	0180-0200	
Location / Road / Site / Preparation	0180-0105	\$100,000	0180-0205	\$35,000
Location / Restoration	0180-0106	\$150,000	0180-0206	\$80,000
Daywork / Turnkey / Footage Drilling 14 days drlg / 3 days comp @ \$27,000/d	0180-0110	\$403,700	0180-0210	\$86,500
Fuel 1700 gal/day @ \$3.90/gal	0180-0114	\$99,100	0180-0214	\$94,100
Alternate Fuels	0180-0115		0180-0215	\$66,000
Mud, Chemical & Additives	0180-0120	\$40,000	0180-0220	
Mud - Specialized	0180-0121	\$240,000	0180-0221	
Horizontal Drillout Services			0180-0222	\$165,000
Stimulation Toe Preparation			0180-0223	\$21,000
Cementing	0180-0125	\$140,000	0180-0225	\$65,000
Logging & Wireline Services	0180-0130	\$23,100	0180-0230	\$220,300
Casing / Tubing / Snubbing Service	0180-0134	\$40,000	0180-0234	\$18,000
Mud Logging	0180-0137	\$15,000		
Stimulation 37 Stg 14.9 MMgal & 14.9 MMlbs			0180-0241	\$1,542,000
Stimulation Rentals & Other			0180-0242	\$191,000
Water & Other	0180-0145	\$35,000	0180-0245	\$322,100
Bits	0180-0148	\$64,100	0180-0248	
Inspection & Repair Services	0180-0150	\$50,000	0180-0250	\$5,000
Misc. Air & Pumping Services	0180-0154		0180-0254	\$10,000
Testing & Flowback Services	0180-0158	\$12,000	0180-0258	\$24,000
Completion / Workover Rig			0180-0260	\$10,500
Rig Mobilization	0180-0164	\$125,000		
Transportation	0180-0165	\$30,000	0180-0265	\$40,000
Welding, Construction, & Maint. Services	0180-0168	\$4,000	0180-0268	\$16,500
Contract Services & Supervision	0180-0170	\$96,900	0180-0270	\$47,500
Directional Services Includes vertical control	0180-0175	\$350,000		
Equipment Rental	0180-0180	\$108,400	0180-0280	\$23,200
Well / Lease Legal	0180-0184	\$5,000	0180-0284	
Well / Lease Insurance	0180-0185	\$4,000	0180-0285	
Intangible Supplies	0180-0188	\$7,000	0180-0288	\$1,000
Damages	0180-0190	\$10,000	0180-0290	\$10,000
Pipeline Interconnect & ROW Easements	0180-0192		0180-0292	\$5,000
Company Supervision	0180-0195	\$61,200	0180-0295	\$18,000
Overhead Fixed Rate	0180-0196	\$10,000	0180-0296	\$20,000
Contingencies 5% (TCP) 5% (CC)	0180-0199	\$112,200	0180-0299	\$156,800
TOTAL		\$2,355,700		\$3,293,500

TANGIBLE COSTS 0181				
Casing (19.1" - 30")	0181-0793			
Casing (10.1" - 19.0") 1005' - 13 3/8" 54.5# J-55 ST&C @ \$42.93/ft	0181-0794	\$46,100		
Casing (8.1" - 10.0") 2770' - 9 5/8" 40# J-55 LT&C @ \$33.60/ft	0181-0795	\$99,400		
Casing (6.1" - 8.0") 9325' - 7" 29# HPP110 BT&C @ \$30.17/ft	0181-0796	\$300,500		
Casing (4.1" - 6.0") 7065' - 4 1/2" 13.5# P-110 CDC-HTQ @ \$17.99/ft			0181-0797	\$135,700
Tubing 8590' - 2 7/8" 6.5# L-80 IPC Tbg @ \$10.75/ft			0181-0798	\$98,600
Drilling Head	0181-0860	\$50,000		
Tubing Head & Upper Section			0181-0870	\$30,000
Horizontal Completion Tools			0181-0871	\$75,000
Subsurface Equip. & Artificial Lift			0181-0880	\$40,000
Service Pumps (1/8) TP/CP/Circ pump			0181-0886	\$5,000
Storage Tanks (1/8) (6)OT/(5)WT/(1)GB			0181-0890	\$36,000
Emissions Control Equipment (1/8) (4)VRT/(2)VRU/(1)FLARE/(3)KO/(1)AIR			0181-0892	\$55,000
Separation / Treating Equipment (1/8) (4)H SEP/(1)V SEP/(3)VHT/(1)HHT			0181-0895	\$44,000
Automation Metering Equipment			0181-0898	\$61,000
Oil/Gas Pipeline-Pipe/Valves&Misc			0181-0900	\$41,000
Water Pipeline-Pipe/Valves & Misc			0181-0901	
On-site Valves/Fittings/Lines&Misc			0181-0906	\$73,000
Wellhead Flowlines - Construction			0181-0907	\$210,000
Cathodic Protection			0181-0908	
Electrical Installation			0181-0909	\$210,000
Equipment Installation			0181-0910	\$64,000
Oil/Gas Pipeline - Construction			0181-0920	\$65,000
Water Pipeline - Construction			0181-0921	\$2,000
TOTAL		\$496,000		\$1,245,300
SUBTOTAL		\$2,851,700		\$4,538,800
TOTAL WELL COST		\$7,390,500		

Extra Expense Insurance

☐

I elect to be covered by Operator's Extra Expense Insurance and pay my proportionate share of the premium.
Operator has secured Extra Expense Insurance covering costs of well control, clean up and redrilling as estimated in Line Item 0180-0185.

☐

I elect to purchase my own well control insurance policy.

If neither box is checked above, non-operating working interest owner elects to be covered by Operator's well control insurance.

Prepared by: H. Buckley

Date: 11/15/2024

Company Approval:

Date:

Joint Owner Interest: Amount:

Joint Owner Name: Signature:

MEWBOURNE OIL COMPANY
AUTHORIZATION FOR EXPENDITURE

Well Name: LEAD BELLY 36/35 FED COM # 527H (B2PO)		Prospect: LEAD BELLY	
Location: SL: 1880 FSL & 505 FEL (36); BHL: 700 FSL & 2540 FEL (35)		County: EDDY	ST: NM
Sec. 36	Blk:	Survey:	TWP: 18S RNG: 31E Prop. TVD: 8980 TMD: 16353

INTANGIBLE COSTS 0180		CODE	TCP	CODE	CC
Regulatory Permits & Surveys		0180-0100	\$20,000	0180-0200	
Location / Road / Site / Preparation		0180-0105	\$100,000	0180-0205	\$35,000
Location / Restoration		0180-0106	\$150,000	0180-0206	\$80,000
Daywork / Turnkey / Footage Drilling	14 days drlg / 3 days comp @ \$27,000/d	0180-0110	\$403,700	0180-0210	\$86,500
Fuel	1700 gal/day @ \$3.90/gal	0180-0114	\$99,100	0180-0214	\$94,100
Alternate Fuels		0180-0115		0180-0215	\$66,000
Mud, Chemical & Additives		0180-0120	\$40,000	0180-0220	
Mud - Specialized		0180-0121	\$240,000	0180-0221	
Horizontal Drillout Services				0180-0222	\$165,000
Stimulation Toe Preparation				0180-0223	\$21,000
Cementing		0180-0125	\$140,000	0180-0225	\$65,000
Logging & Wireline Services		0180-0130	\$23,100	0180-0230	\$220,300
Casing / Tubing / Snubbing Service		0180-0134	\$40,000	0180-0234	\$18,000
Mud Logging		0180-0137	\$15,000		
Stimulation	37 Stg 14.9 MMgal & 14.9 MMlbs			0180-0241	\$1,542,000
Stimulation Rentals & Other				0180-0242	\$191,000
Water & Other		0180-0145	\$35,000	0180-0245	\$322,100
Bits		0180-0148	\$64,100	0180-0248	
Inspection & Repair Services		0180-0150	\$50,000	0180-0250	\$5,000
Misc. Air & Pumping Services		0180-0154		0180-0254	\$10,000
Testing & Flowback Services		0180-0158	\$12,000	0180-0258	\$24,000
Completion / Workover Rig				0180-0260	\$10,500
Rig Mobilization		0180-0164	\$125,000		
Transportation		0180-0165	\$30,000	0180-0265	\$40,000
Welding, Construction, & Maint. Services		0180-0168	\$4,000	0180-0268	\$16,500
Contract Services & Supervision		0180-0170	\$96,900	0180-0270	\$47,500
Directional Services	Includes vertical control	0180-0175	\$350,000		
Equipment Rental		0180-0180	\$108,400	0180-0280	\$23,200
Well / Lease Legal		0180-0184	\$5,000	0180-0284	
Well / Lease Insurance		0180-0185	\$4,000	0180-0285	
Intangible Supplies		0180-0188	\$7,000	0180-0288	\$1,000
Damages		0180-0190	\$10,000	0180-0290	\$10,000
Pipeline Interconnect & ROW Easements		0180-0192		0180-0292	\$5,000
Company Supervision		0180-0195	\$61,200	0180-0295	\$18,000
Overhead Fixed Rate		0180-0196	\$10,000	0180-0296	\$20,000
Contingencies	5% (TCP) 5% (CC)	0180-0199	\$112,200	0180-0299	\$156,800
TOTAL		\$2,355,700		\$3,293,500	

TANGIBLE COSTS 0181					
Casing (19.1" - 30")		0181-0793			
Casing (10.1" - 19.0")	1005' - 13 3/8" 54.5# J-55 ST&C @ \$42.93/ft	0181-0794	\$46,100		
Casing (8.1" - 10.0")	2770' - 9 5/8" 40# J-55 LT&C @ \$33.60/ft	0181-0795	\$99,400		
Casing (6.1" - 8.0")	9330' - 7" 29# HPP110 BT&C @ \$30.17/ft	0181-0796	\$300,600		
Casing (4.1" - 6.0")	7170' - 4 1/2" 13.5# P-110 CDC-HTQ @ \$17.99/ft			0181-0797	\$137,800
Tubing	8595' - 2 7/8" 6.5# L-80 IPC Tbg @ \$10.75/ft			0181-0798	\$98,700
Drilling Head		0181-0860	\$50,000		
Tubing Head & Upper Section				0181-0870	\$30,000
Horizontal Completion Tools				0181-0871	\$75,000
Subsurface Equip. & Artificial Lift				0181-0880	\$40,000
Service Pumps	(1/8) TP/CP/Circ pump			0181-0886	\$5,000
Storage Tanks	(1/8) (6)OT/(5)WT/(1)GB			0181-0890	\$36,000
Emissions Control Equipment	(1/8) (4)VRT/(2)VRU/(1)FLARE/(3)KO/(1)AIR			0181-0892	\$55,000
Separation / Treating Equipment	(1/8) (4)H SEP/(1)V SEP/(3)VHT/(1)HHT			0181-0895	\$44,000
Automation Metering Equipment				0181-0898	\$61,000
Oil/Gas Pipeline-Pipe/Valves&Misc				0181-0900	\$41,000
Water Pipeline-Pipe/Valves & Misc				0181-0901	
On-site Valves/Fittings/Lines&Misc				0181-0906	\$73,000
Wellhead Flowlines - Construction				0181-0907	\$210,000
Cathodic Protection				0181-0908	
Electrical Installation				0181-0909	\$210,000
Equipment Installation				0181-0910	\$64,000
Oil/Gas Pipeline - Construction				0181-0920	\$65,000
Water Pipeline - Construction				0181-0921	\$2,000
TOTAL		\$496,100		\$1,247,500	
SUBTOTAL		\$2,851,800		\$4,541,000	
TOTAL WELL COST		\$7,392,800			

Extra Expense Insurance

☐ I elect to be covered by Operator's Extra Expense Insurance and pay my proportionate share of the premium.
Operator has secured Extra Expense Insurance covering costs of well control, clean up and redrilling as estimated in Line Item 0180-0185.

☐ I elect to purchase my own well control insurance policy.

If neither box is checked above, non-operating working interest owner elects to be covered by Operator's well control insurance.

Prepared by: H. Buckley	Date: 11/15/2024
Company Approval:	Date:
Joint Owner Interest: Amount:	Signature:
Joint Owner Name:	

MEWBOURNE OIL COMPANY
AUTHORIZATION FOR EXPENDITURE

Well Name: LEAD BELLY 36/35 FED COM # 622H (B3AB)

Prospect: LEAD BELLY

Location: SL: 1980 FSL & 505 FEL (36); BHL: 700 FNL & 2540 FEL (35)

County: EDDY

ST: NM

Sec. 36

Blk:

Survey:

TWP: 18S

RNG: 31E

Prop. TVD: 9662

TMD: 17334

INTANGIBLE COSTS 0180		CODE	TCP	CODE	CC
Regulatory Permits & Surveys		0180-0100	\$20,000	0180-0200	
Location / Road / Site / Preparation		0180-0105	\$100,000	0180-0205	\$35,000
Location / Restoration		0180-0106	\$150,000	0180-0206	\$80,000
Daywork / Turnkey / Footage Drilling	15 days drlg / 3 days comp @ \$27,000/d	0180-0110	\$432,500	0180-0210	\$86,500
Fuel	1700 gal/day @ \$3.90/gal	0180-0114	\$106,200	0180-0214	\$94,100
Alternate Fuels		0180-0115		0180-0215	\$66,000
Mud, Chemical & Additives		0180-0120	\$40,000	0180-0220	
Mud - Specialized		0180-0121	\$245,000	0180-0221	
Horizontal Drillout Services				0180-0222	\$165,000
Stimulation Toe Preparation				0180-0223	\$21,000
Cementing		0180-0125	\$140,000	0180-0225	\$65,000
Logging & Wireline Services		0180-0130	\$23,100	0180-0230	\$220,300
Casing / Tubing / Snubbing Service		0180-0134	\$40,000	0180-0234	\$18,000
Mud Logging		0180-0137	\$15,000		
Stimulation	37 Stg 14.9 MMgal & 14.9 MMLbs			0180-0241	\$1,554,000
Stimulation Rentals & Other				0180-0242	\$191,000
Water & Other		0180-0145	\$35,000	0180-0245	\$322,100
Bits		0180-0148	\$64,100	0180-0248	
Inspection & Repair Services		0180-0150	\$50,000	0180-0250	\$5,000
Misc. Air & Pumping Services		0180-0154		0180-0254	\$10,000
Testing & Flowback Services		0180-0158	\$12,000	0180-0258	\$24,000
Completion / Workover Rig				0180-0260	\$10,500
Rig Mobilization		0180-0164	\$125,000		
Transportation		0180-0165	\$30,000	0180-0265	\$40,000
Welding, Construction, & Maint. Services		0180-0168	\$4,000	0180-0268	\$16,500
Contract Services & Supervision		0180-0170	\$102,600	0180-0270	\$47,500
Directional Services	Includes vertical control	0180-0175	\$350,000		
Equipment Rental		0180-0180	\$116,100	0180-0280	\$23,200
Well / Lease Legal		0180-0184	\$5,000	0180-0284	
Well / Lease Insurance		0180-0185	\$4,000	0180-0285	
Intangible Supplies		0180-0188	\$7,000	0180-0288	\$1,000
Damages		0180-0190	\$10,000	0180-0290	\$10,000
Pipeline Interconnect & ROW Easements		0180-0192		0180-0292	\$5,000
Company Supervision		0180-0195	\$64,800	0180-0295	\$18,000
Overhead Fixed Rate		0180-0196	\$10,000	0180-0296	\$20,000
Contingencies	5% (TCP) 5% (CC)	0180-0199	\$115,100	0180-0299	\$157,400
TOTAL			\$2,416,500		\$3,306,100

TANGIBLE COSTS 0181					
Casing (19.1" - 30")		0181-0793			
Casing (10.1" - 19.0")	1005' - 13 3/8" 54.5# J-55 ST&C @ \$42.93/ft	0181-0794	\$46,100		
Casing (8.1" - 10.0")	2770' - 9 5/8" 40# J-55 LT&C @ \$33.60/ft	0181-0795	\$99,400		
Casing (6.1" - 8.0")	9995' - 7" 29# HPP110 BT&C @ \$30.17/ft	0181-0796	\$322,100		
Casing (4.1" - 6.0")	7490' - 4 1/2" 13.5# P-110 CDC-HTQ @ \$17.99/ft			0181-0797	\$143,900
Tubing	9260' - 2 7/8" 6.5# L-80 IPC Tbg @ \$10.75/ft			0181-0798	\$106,300
Drilling Head		0181-0860	\$50,000		
Tubing Head & Upper Section				0181-0870	\$30,000
Horizontal Completion Tools				0181-0871	\$75,000
Subsurface Equip. & Artificial Lift				0181-0880	\$40,000
Service Pumps	(1/8) TP/CP/Circ pump			0181-0886	\$5,000
Storage Tanks	(1/8) (6)OT/(5)WT/(1)GB			0181-0890	\$36,000
Emissions Control Equipment	(1/8) (4)VRT/(2)VRU/(1)FLARE/(3)KO/(1)AIR			0181-0892	\$55,000
Separation / Treating Equipment	(1/8) (4)H SEP/(1)V SEP/(3)VHT/(1)HHT			0181-0895	\$44,000
Automation Metering Equipment				0181-0898	\$61,000
Oil/Gas Pipeline-Pipe/Valves&Misc				0181-0900	\$41,000
Water Pipeline-Pipe/Valves & Misc				0181-0901	
On-site Valves/Fittings/Lines&Misc				0181-0906	\$73,000
Wellhead Flowlines - Construction				0181-0907	\$210,000
Cathodic Protection				0181-0908	
Electrical Installation				0181-0909	\$210,000
Equipment Installation				0181-0910	\$64,000
Oil/Gas Pipeline - Construction				0181-0920	\$65,000
Water Pipeline - Construction				0181-0921	\$2,000
TOTAL			\$517,600		\$1,261,200
SUBTOTAL			\$2,934,100		\$4,567,300

TOTAL WELL COST \$7,501,400

Extra Expense Insurance

☐

I elect to be covered by Operator's Extra Expense Insurance and pay my proportionate share of the premium.
Operator has secured Extra Expense Insurance covering costs of well control, clean up and redrilling as estimated in Line Item 0180-0185.

☐

I elect to purchase my own well control insurance policy.

If neither box is checked above, non-operating working interest owner elects to be covered by Operator's well control insurance.

Prepared by: H. Buckley

Date: 11/15/2024

Company Approval:

Date:

Joint Owner Interest: Amount:

Joint Owner Name: Signature:

MEWBOURNE OIL COMPANY
AUTHORIZATION FOR EXPENDITURE

Well Name: LEAD BELLY 36/35 FED COM # 624H (B3HG)		Prospect: LEAD BELLY	
Location: SL: 1940 FSL & 505 FEL (36); BHL: 2080 FNL & 2540 FEL (35)		County: EDDY	ST: NM
Sec. 36	Blk:	Survey:	TWP: 18S RNG: 31E Prop. TVD: 9696 TMD: 17026

INTANGIBLE COSTS 0180		CODE	TCP	CODE	CC
Regulatory Permits & Surveys		0180-0100	\$20,000	0180-0200	
Location / Road / Site / Preparation		0180-0105	\$100,000	0180-0205	\$35,000
Location / Restoration		0180-0106	\$150,000	0180-0206	\$80,000
Daywork / Turnkey / Footage Drilling	15 days drlg / 3 days comp @ \$27,000/d	0180-0110	\$432,500	0180-0210	\$86,500
Fuel	1700 gal/day @ \$3.90/gal	0180-0114	\$106,200	0180-0214	\$94,100
Alternate Fuels		0180-0115		0180-0215	\$66,000
Mud, Chemical & Additives		0180-0120	\$40,000	0180-0220	
Mud - Specialized		0180-0121	\$245,000	0180-0221	
Horizontal Drillout Services				0180-0222	\$165,000
Stimulation Toe Preparation				0180-0223	\$21,000
Cementing		0180-0125	\$140,000	0180-0225	\$65,000
Logging & Wireline Services		0180-0130	\$23,100	0180-0230	\$220,300
Casing / Tubing / Snubbing Service		0180-0134	\$40,000	0180-0234	\$18,000
Mud Logging		0180-0137	\$15,000		
Stimulation	37 Stg 14.9 MMgal & 14.9 MMlbs			0180-0241	\$1,554,000
Stimulation Rentals & Other				0180-0242	\$191,000
Water & Other		0180-0145	\$35,000	0180-0245	\$322,100
Bits		0180-0148	\$64,100	0180-0248	
Inspection & Repair Services		0180-0150	\$50,000	0180-0250	\$5,000
Misc. Air & Pumping Services		0180-0154		0180-0254	\$10,000
Testing & Flowback Services		0180-0158	\$12,000	0180-0258	\$24,000
Completion / Workover Rig				0180-0260	\$10,500
Rig Mobilization		0180-0164	\$125,000		
Transportation		0180-0165	\$30,000	0180-0265	\$40,000
Welding, Construction, & Maint. Services		0180-0168	\$4,000	0180-0268	\$16,500
Contract Services & Supervision		0180-0170	\$102,600	0180-0270	\$47,500
Directional Services	Includes vertical control	0180-0175	\$350,000		
Equipment Rental		0180-0180	\$116,100	0180-0280	\$23,200
Well / Lease Legal		0180-0184	\$5,000	0180-0284	
Well / Lease Insurance		0180-0185	\$4,000	0180-0285	
Intangible Supplies		0180-0188	\$7,000	0180-0288	\$1,000
Damages		0180-0190	\$10,000	0180-0290	\$10,000
Pipeline Interconnect & ROW Easements		0180-0192		0180-0292	\$5,000
Company Supervision		0180-0195	\$64,800	0180-0295	\$18,000
Overhead Fixed Rate		0180-0196	\$10,000	0180-0296	\$20,000
Contingencies	5% (TCP) 5% (CC)	0180-0199	\$115,100	0180-0299	\$157,400
TOTAL			\$2,416,500		\$3,306,100

TANGIBLE COSTS 0181					
Casing (19.1" - 30")		0181-0793			
Casing (10.1" - 19.0")	1005' - 13 3/8" 54.5# J-55 ST&C @ \$42.93/ft	0181-0794	\$46,100		
Casing (8.1" - 10.0")	2770' - 9 5/8" 40# J-55 LT&C @ \$33.60/ft	0181-0795	\$99,400		
Casing (6.1" - 8.0")	10015' - 7" 29# HPP110 BT&C @ \$30.17/ft	0181-0796	\$322,700		
Casing (4.1" - 6.0")	7165' - 4 1/2" 13.5# P-110 CDC-HTQ @ \$17.99/ft			0181-0797	\$137,700
Tubing	9280' - 2 7/8" 6.5# L-80 IPC Tbg @ \$10.75/ft			0181-0798	\$106,500
Drilling Head		0181-0860	\$50,000		
Tubing Head & Upper Section				0181-0870	\$30,000
Horizontal Completion Tools				0181-0871	\$75,000
Subsurface Equip. & Artificial Lift				0181-0880	\$40,000
Service Pumps	(1/8) TP/CP/Circ pump			0181-0886	\$5,000
Storage Tanks	(1/8) (6)OT/(5)WT/(1)GB			0181-0890	\$36,000
Emissions Control Equipment	(1/8) (4)VRT/(2)VRU/(1)FLARE/(3)KO/(1)AIR			0181-0892	\$55,000
Separation / Treating Equipment	(1/8) (4)H SEP/(1)V SEP/(3)VHT/(1)HHT			0181-0895	\$44,000
Automation Metering Equipment				0181-0898	\$61,000
Oil/Gas Pipeline-Pipe/Valves&Misc				0181-0900	\$41,000
Water Pipeline-Pipe/Valves & Misc				0181-0901	
On-site Valves/Fittings/Lines&Misc				0181-0906	\$73,000
Wellhead Flowlines - Construction				0181-0907	\$210,000
Cathodic Protection				0181-0908	
Electrical Installation				0181-0909	\$210,000
Equipment Installation				0181-0910	\$64,000
Oil/Gas Pipeline - Construction				0181-0920	\$65,000
Water Pipeline - Construction				0181-0921	\$2,000
TOTAL			\$518,200		\$1,255,200
SUBTOTAL			\$2,934,700		\$4,561,300
TOTAL WELL COST		\$7,496,000			

Extra Expense Insurance

☐ I elect to be covered by Operator's Extra Expense Insurance and pay my proportionate share of the premium.
Operator has secured Extra Expense Insurance covering costs of well control, clean up and redrilling as estimated in Line Item 0180-0185.

☐ I elect to purchase my own well control insurance policy.

If neither box is checked above, non-operating working interest owner elects to be covered by Operator's well control insurance.

Prepared by: H. Buckley	Date: 11/15/2024
Company Approval:	Date:
Joint Owner Interest: Amount:	Signature:
Joint Owner Name:	

MEWBOURNE OIL COMPANY
AUTHORIZATION FOR EXPENDITURE

Well Name:	LEAD BELLY 36/35 FED COM # 626H (B3IJ)	Prospect:	LEAD BELLY										
Location:	SL: 1900 FSL & 505 FEL (36); BHL: 1800 FSL & 2540 FEL (35)	County:	EDDY	ST:	NM								
Sec.	36	Blk:		Survey:		TWP:	18S	RNG:	31E	Prop. TVD:	9700	TMD:	16945

INTANGIBLE COSTS 0180		CODE	TCP	CODE	CC
Regulatory Permits & Surveys		0180-0100	\$20,000	0180-0200	
Location / Road / Site / Preparation		0180-0105	\$100,000	0180-0205	\$35,000
Location / Restoration		0180-0106	\$150,000	0180-0206	\$80,000
Daywork / Turnkey / Footage Drilling	15 days drlg / 3 days comp @ \$27,000/d	0180-0110	\$432,500	0180-0210	\$86,500
Fuel	1700 gal/day @ \$3.90/gal	0180-0114	\$106,200	0180-0214	\$94,100
Alternate Fuels		0180-0115		0180-0215	\$66,000
Mud, Chemical & Additives		0180-0120	\$40,000	0180-0220	
Mud - Specialized		0180-0121	\$245,000	0180-0221	
Horizontal Drillout Services				0180-0222	\$165,000
Stimulation Toe Preparation				0180-0223	\$21,000
Cementing		0180-0125	\$140,000	0180-0225	\$65,000
Logging & Wireline Services		0180-0130	\$23,100	0180-0230	\$220,300
Casing / Tubing / Snubbing Service		0180-0134	\$40,000	0180-0234	\$18,000
Mud Logging		0180-0137	\$15,000		
Stimulation	37 Stg 14.9 MMgal & 14.9 MMlbs			0180-0241	\$1,554,000
Stimulation Rentals & Other				0180-0242	\$191,000
Water & Other		0180-0145	\$35,000	0180-0245	\$322,100
Bits		0180-0148	\$64,100	0180-0248	
Inspection & Repair Services		0180-0150	\$50,000	0180-0250	\$5,000
Misc. Air & Pumping Services		0180-0154		0180-0254	\$10,000
Testing & Flowback Services		0180-0158	\$12,000	0180-0258	\$24,000
Completion / Workover Rig				0180-0260	\$10,500
Rig Mobilization		0180-0164	\$125,000		
Transportation		0180-0165	\$30,000	0180-0265	\$40,000
Welding, Construction, & Maint. Services		0180-0168	\$4,000	0180-0268	\$16,500
Contract Services & Supervision		0180-0170	\$102,600	0180-0270	\$47,500
Directional Services	Includes vertical control	0180-0175	\$350,000		
Equipment Rental		0180-0180	\$116,100	0180-0280	\$23,200
Well / Lease Legal		0180-0184	\$5,000	0180-0284	
Well / Lease Insurance		0180-0185	\$4,000	0180-0285	
Intangible Supplies		0180-0188	\$7,000	0180-0288	\$1,000
Damages		0180-0190	\$10,000	0180-0290	\$10,000
Pipeline Interconnect & ROW Easements		0180-0192		0180-0292	\$5,000
Company Supervision		0180-0195	\$64,800	0180-0295	\$18,000
Overhead Fixed Rate		0180-0196	\$10,000	0180-0296	\$20,000
Contingencies	5% (TCP) 5% (CC)	0180-0199	\$115,100	0180-0299	\$157,400
TOTAL			\$2,416,500		\$3,306,100
TANGIBLE COSTS 0181					
Casing (19.1" - 30")		0181-0793			
Casing (10.1" - 19.0")	1005' - 13 3/8" 54.5# J-55 ST&C @ \$42.93/ft	0181-0794	\$46,100		
Casing (8.1" - 10.0")	2770' - 9 5/8" 40# J-55 LT&C @ \$33.60/ft	0181-0795	\$99,400		
Casing (6.1" - 8.0")	10025' - 7" 29# HPP110 BT&C @ \$30.17/ft	0181-0796	\$323,000		
Casing (4.1" - 6.0")	7070' - 4 1/2" 13.5# P-110 CDC-HTQ @ \$17.99/ft			0181-0797	\$135,800
Tubing	9295' - 2 7/8" 6.5# L-80 IPC Tbg @ \$10.75/ft			0181-0798	\$106,700
Drilling Head		0181-0860	\$50,000		
Tubing Head & Upper Section				0181-0870	\$30,000
Horizontal Completion Tools				0181-0871	\$75,000
Subsurface Equip. & Artificial Lift				0181-0880	\$40,000
Service Pumps	(1/8) TP/CP/Circ pump			0181-0886	\$5,000
Storage Tanks	(1/8) (6)OT/(5)WT/(1)GB			0181-0890	\$36,000
Emissions Control Equipment	(1/8) (4)VRT/(2)VRU/(1)FLARE/(3)KO/(1)AIR			0181-0892	\$55,000
Separation / Treating Equipment	(1/8) (4)H SEP/(1)V SEP/(3)VHT/(1)HHT			0181-0895	\$44,000
Automation Metering Equipment				0181-0898	\$61,000
Oil/Gas Pipeline-Pipe/Valves&Misc				0181-0900	\$41,000
Water Pipeline-Pipe/Valves & Misc				0181-0901	
On-site Valves/Fittings/Lines&Misc				0181-0906	\$73,000
Wellhead Flowlines - Construction				0181-0907	\$210,000
Cathodic Protection				0181-0908	
Electrical Installation				0181-0909	\$210,000
Equipment Installation				0181-0910	\$64,000
Oil/Gas Pipeline - Construction				0181-0920	\$65,000
Water Pipeline - Construction				0181-0921	\$2,000
TOTAL			\$518,500		\$1,253,500
SUBTOTAL			\$2,935,000		\$4,559,600
TOTAL WELL COST			\$7,494,600		

Extra Expense Insurance			
<input type="checkbox"/>	I elect to be covered by Operator's Extra Expense Insurance and pay my proportionate share of the premium. Operator has secured Extra Expense Insurance covering costs of well control, clean up and redrilling as estimated in Line Item 0180-0185.		
<input type="checkbox"/>	I elect to purchase my own well control insurance policy.		
If neither box is checked above, non-operating working interest owner elects to be covered by Operator's well control insurance.			
Prepared by:	H. Buckley	Date:	11/15/2024
Company Approval:		Date:	
Joint Owner Interest:	Amount:	Signature:	
Joint Owner Name:			

MEWBOURNE OIL COMPANY
AUTHORIZATION FOR EXPENDITURE

Well Name: LEAD BELLY 36/35 FED COM # 628H (B3PO)		Prospect: LEAD BELLY			
Location: SL: 1860 FSL & 505 FEL (36); BHL: 450 FSL & 2540 FEL (35)		County: EDDY ST: NM			
Sec. 36	Blk:	Survey:	TWP: 18S RNG: 31E Prop. TVD: 9760 TMD: 17099		
INTANGIBLE COSTS 0180		CODE	TCP	CODE	CC
Regulatory Permits & Surveys		0180-0100	\$20,000	0180-0200	
Location / Road / Site / Preparation		0180-0105	\$100,000	0180-0205	\$35,000
Location / Restoration		0180-0106	\$150,000	0180-0206	\$80,000
Daywork / Turnkey / Footage Drilling 15 days drlg / 3 days comp @ \$27,000/d		0180-0110	\$432,500	0180-0210	\$86,500
Fuel 1700 gal/day @ \$3.90/gal		0180-0114	\$106,200	0180-0214	\$94,100
Alternate Fuels		0180-0115		0180-0215	\$66,000
Mud, Chemical & Additives		0180-0120	\$40,000	0180-0220	
Mud - Specialized		0180-0121	\$245,000	0180-0221	
Horizontal Drillout Services				0180-0222	\$165,000
Stimulation Toe Preparation				0180-0223	\$21,000
Cementing		0180-0125	\$140,000	0180-0225	\$65,000
Logging & Wireline Services		0180-0130	\$23,100	0180-0230	\$220,300
Casing / Tubing / Snubbing Service		0180-0134	\$40,000	0180-0234	\$18,000
Mud Logging		0180-0137	\$15,000		
Stimulation 37 Stg 14.9 MMgal & 14.9 MMlbs				0180-0241	\$1,554,000
Stimulation Rentals & Other				0180-0242	\$191,000
Water & Other		0180-0145	\$35,000	0180-0245	\$322,100
Bits		0180-0148	\$64,100	0180-0248	
Inspection & Repair Services		0180-0150	\$50,000	0180-0250	\$5,000
Misc. Air & Pumping Services		0180-0154		0180-0254	\$10,000
Testing & Flowback Services		0180-0158	\$12,000	0180-0258	\$24,000
Completion / Workover Rig				0180-0260	\$10,500
Rig Mobilization		0180-0164	\$125,000		
Transportation		0180-0165	\$30,000	0180-0265	\$40,000
Welding, Construction, & Maint. Services		0180-0168	\$4,000	0180-0268	\$16,500
Contract Services & Supervision		0180-0170	\$102,600	0180-0270	\$47,500
Directional Services Includes vertical control		0180-0175	\$350,000		
Equipment Rental		0180-0180	\$116,100	0180-0280	\$23,200
Well / Lease Legal		0180-0184	\$5,000	0180-0284	
Well / Lease Insurance		0180-0185	\$4,000	0180-0285	
Intangible Supplies		0180-0188	\$7,000	0180-0288	\$1,000
Damages		0180-0190	\$10,000	0180-0290	\$10,000
Pipeline Interconnect & ROW Easements		0180-0192		0180-0292	\$5,000
Company Supervision		0180-0195	\$64,800	0180-0295	\$18,000
Overhead Fixed Rate		0180-0196	\$10,000	0180-0296	\$20,000
Contingencies 5% (TCP) 5% (CC)		0180-0199	\$115,100	0180-0299	\$157,400
TOTAL			\$2,416,500		\$3,306,100
TANGIBLE COSTS 0181					
Casing (19.1" - 30")		0181-0793			
Casing (10.1" - 19.0") 1005' - 13 3/8" 54.5# J-55 ST&C @ \$42.93/ft		0181-0794	\$46,100		
Casing (8.1" - 10.0") 2770' - 9 5/8" 40# J-55 LT&C @ \$33.60/ft		0181-0795	\$99,400		
Casing (6.1" - 8.0") 10330' - 7" 29# HPP110 BT&C @ \$30.17/ft		0181-0796	\$332,800		
Casing (4.1" - 6.0") 6920' - 4 1/2" 13.5# P-110 CDC-HTQ @ \$17.99/ft				0181-0797	\$133,000
Tubing 9300' - 2 7/8" 6.5# L-80 IPC Tbg @ \$10.75/ft				0181-0798	\$106,800
Drilling Head		0181-0860	\$50,000		
Tubing Head & Upper Section				0181-0870	\$30,000
Horizontal Completion Tools				0181-0871	\$75,000
Subsurface Equip. & Artificial Lift				0181-0880	\$40,000
Service Pumps (1/8) TP/CP/Circ pump				0181-0886	\$5,000
Storage Tanks (1/8) (6)OT/(5)WT/(1)GB				0181-0890	\$36,000
Emissions Control Equipment (1/8) (4)VRT/(2)VRU/(1)FLARE/(3)KO/(1)AIR				0181-0892	\$55,000
Separation / Treating Equipment (1/8) (4)H SEP/(1)V SEP/(3)VHT/(1)HHT				0181-0895	\$44,000
Automation Metering Equipment				0181-0898	\$61,000
Oil/Gas Pipeline-Pipe/Valves&Misc				0181-0900	\$41,000
Water Pipeline-Pipe/Valves & Misc				0181-0901	
On-site Valves/Fittings/Lines&Misc				0181-0906	\$73,000
Wellhead Flowlines - Construction				0181-0907	\$210,000
Cathodic Protection				0181-0908	
Electrical Installation				0181-0909	\$210,000
Equipment Installation				0181-0910	\$64,000
Oil/Gas Pipeline - Construction				0181-0920	\$65,000
Water Pipeline - Construction				0181-09	

Summary of Communications

Lead Belly 36/35 Fed Com #521H
Lead Belly 36/35 Fed Com #523H
Lead Belly 36/35 Fed Com #525H
Lead Belly 36/35 Fed Com #527H
Lead Belly 36/35 Fed Com #622H
Lead Belly 36/35 Fed Com #624H
Lead Belly 36/35 Fed Com #626H
Lead Belly 36/35 Fed Com #628H
T18S, R31E, Eddy County, New Mexico

COG Operating LLC

Concho Oil & Gas LLC

ConocoPhillips Company

Various Dates: Spoke to and emailed above listed party regarding Working Interest Unit.

11/15/2024: Mailed and Emailed Working Interest Unit and Well Proposal to the above listed party.

1/13/2025: Spoke to and emailed above listed party regarding Working Interest Unit and Well Proposal.

2/28/2025: Correspondence with above listed party regarding Working Interest Unit and Well Proposal.

MRC Delaware Resources LLC

11/15/2024: Mailed Working Interest Unit and Well Proposal to the above listed party.

Riverbend Production, LP

11/18/2024: Called and left voicemail for above listed party.

12/11/2024: Called and spoke to above listed party regarding Working Interest Unit.

1/13/2025: Called and spoke to above listed party regarding Working Interest Unit. Mailed and Emailed Working Interest Unit and Well Proposal to the above listed party.

Elliott-Hall Company

Unknown date: Spoke to above listed party regarding Working Interest Unit.

1/13/2025: Mailed and Emailed Working Interest Unit and Well Proposal to the above listed party.

Elliott Industries Limited Partnership

Unknown date: Spoke to above listed party regarding Working Interest Unit.

1/13/2025: Called and spoke to above listed party regarding Working Interest Unit. Mailed and Emailed Working Interest Unit and Well Proposal to the above listed party.

BEFORE THE OIL CONSERVATION DIVISION

Santa Fe, New Mexico

Exhibit No. C-4

Submitted by: Mewbourne Oil Company

Hearing Date: March 13, 2025

Case No. 25228

**STATE OF NEW MEXICO
ENERGY, MINERALS AND NATURAL RESOURCES DEPARTMENT
OIL CONSERVATION DIVISION**

**APPLICATION OF MEWBOURNE OIL
COMPANY FOR COMPULSORY POOLING,
EDDY COUNTY, NEW MEXICO.**

CASE NO. 25228

SELF-AFFIRMED STATEMENT OF Charles Crosby

1. My name is Charles Crosby. I work for Mewbourne Oil Company ("Mewbourne") as a Geologist.
2. I have previously testified before the New Mexico Oil Conservation Division ("Division") as an expert witness in petroleum geology. My credentials as a petroleum geologist have been accepted by the Division and made a matter of record.
3. I am familiar with the application filed by Mewbourne in this case, and I have conducted a geologic study of the lands in the subject area.
4. Mewbourne is targeting the 2nd and 3rd Bone Spring sand intervals of the Bone Spring formation in this case.
5. **Mewbourne Exhibit D-1** is a general locator map.
6. **Mewbourne Exhibit D-2** is a subsea structure map that I prepared for the top of the Wolfcamp formation. The contour intervals are 100 feet. The area comprising the proposed spacing unit is outlined by a dashed black box with the approximate location and orientation of the initial wells noted with a green and red dashed arrows. The structure map shows the targeted formation gently dipping to the east/southeast. The structure appears consistent across the proposed spacing unit, and I do not observe any faulting, pinch outs, or other geologic impediments to drilling horizontal wells.

BEFORE THE OIL CONSERVATION DIVISION
Santa Fe, New Mexico
Exhibit No. D
Submitted by: Mewbourne Oil Company
Hearing Date: March 13, 2025
Case No. 25228

7. Mewbourne Exhibit D-2 also shows a line of cross-section through the proposed horizontal spacing unit from A to A'. I chose the logs from these wells to create the cross-section because they penetrate the targeted interval, are of good quality and have been subjected to petrophysical analysis of the targeted interval. In my opinion, these well logs are representative of the geology in the subject area.

8. **Mewbourne Exhibit D-3** is a stratigraphic cross-section that I prepared using the logs from the representative wells shown in Exhibit D-2. Each well on the cross-section contains gamma ray, resistivity, and porosity logs. The target intervals for the proposed wells are marked on the cross-section with arrows. The cross-section demonstrates that the targeted intervals are continuous across the proposed spacing unit.

9. In my opinion, laydown orientation of the proposed wells is the appropriate orientation for horizontal well development in this area due to regional stress regime direction.

10. Based on my geologic study, the Bone Spring formation underlying the subject area is suitable for development by horizontal wells and the acreage comprising the proposed spacing unit will contribute more-or-less equally to the production from the wellbores. I have not identified any geologic impediments to drilling horizontal wells in the area of the spacing unit proposed.

11. In my opinion, horizontal drilling will be the most efficient method to develop this acreage, to prevent the drilling of unnecessary wells, and to result in the greatest ultimate recovery, and that approving Mewbourne's application will be in the best interest of conservation, the prevention of waste, and protection of correlative rights.

12. **Mewbourne Exhibits D-1 through D-3** were either prepared by me or compiled under my direction and supervision.

13. I affirm under penalty of perjury under the laws of the State of New Mexico that the foregoing statements are true and correct. I understand that this self-affirmed statement will be used as written testimony in this case. This statement is made on the date next to my signature below.

A handwritten signature in blue ink, appearing to be "C8", written over a horizontal line.

Charles Crosby

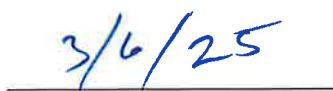
A handwritten date "3/6/25" in blue ink, written over a horizontal line.

Date

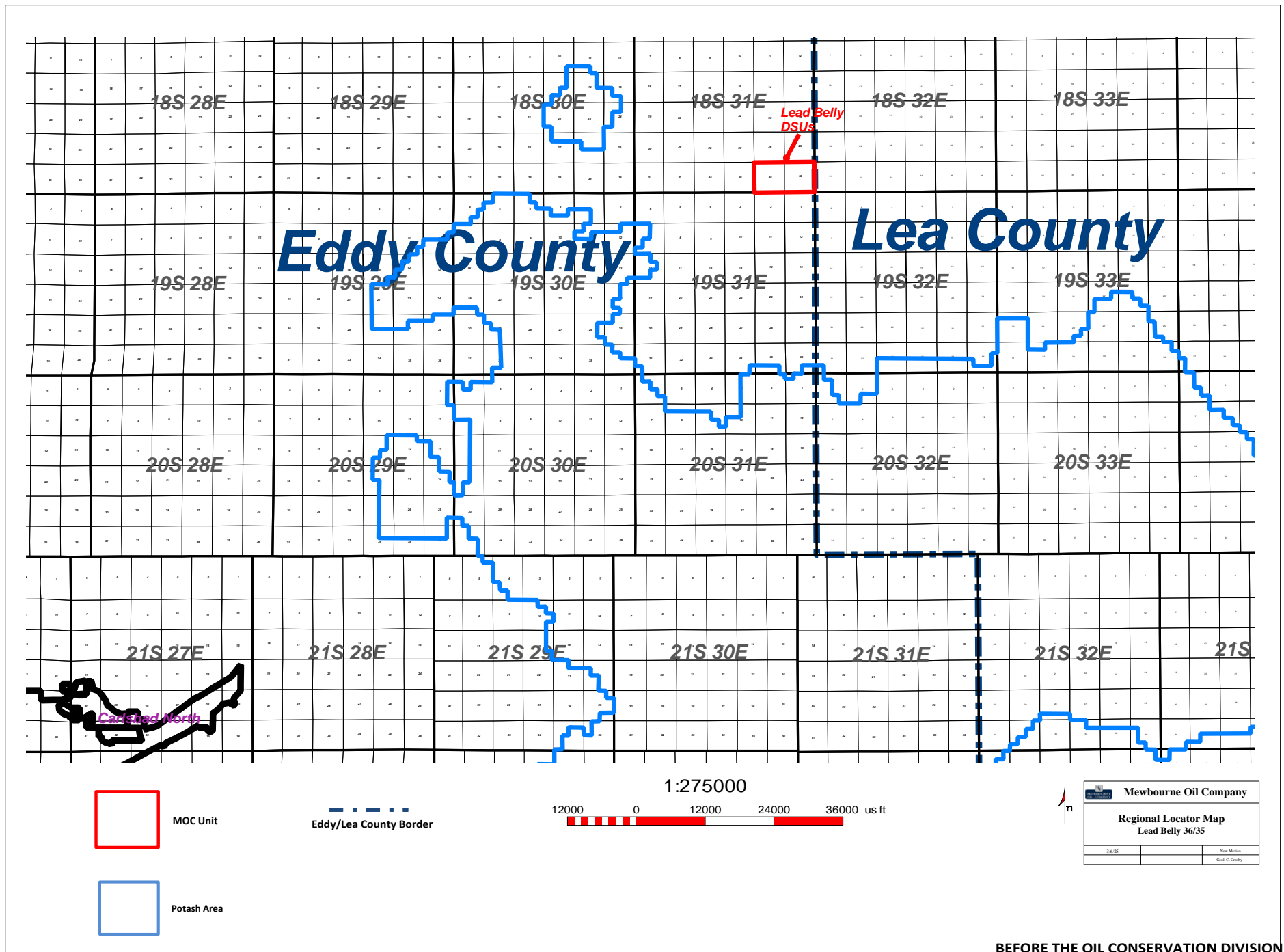

BEFORE THE OIL CONSERVATION DIVISION
 Santa Fe, New Mexico
 Exhibit No. D-1
 Submitted by: Mewbourne Oil Company
 Hearing Date: March 13, 2025
 Case No. 25228

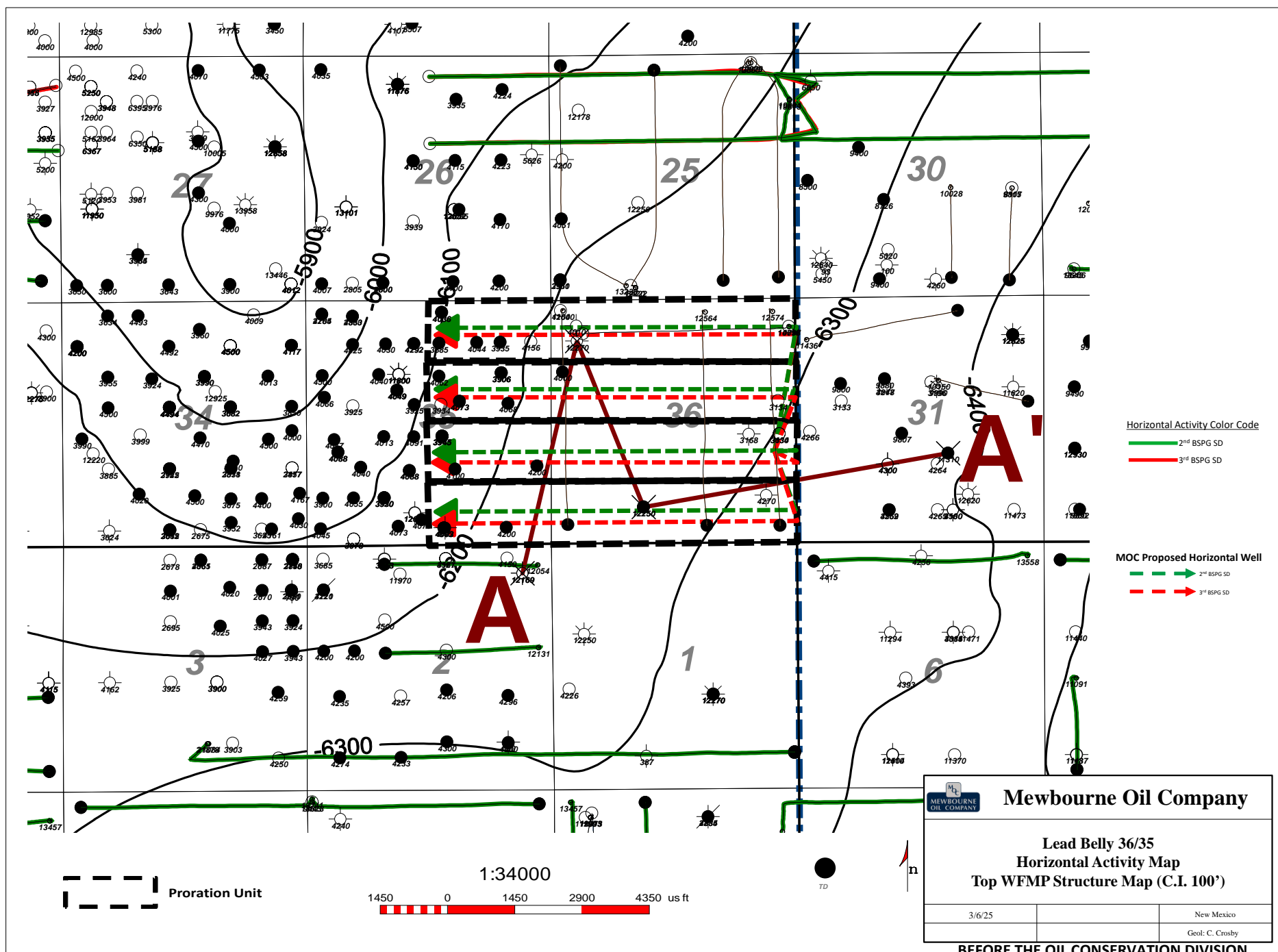

BEFORE THE OIL CONSERVATION DIVISION

Santa Fe, New Mexico

Exhibit No. D-2

Submitted by: Mewbourne Oil Company

Hearing Date: March 13, 2025

Case No. 25228

A
W

30015360290000
MARBOB ENERGY CORP
CORSAIR STATE COM 1
Datum=3644.00
660 FNL/660 FWL
TWP: 19 S - Range: 31 E - Sec: 2

5140 ft

30015336020000
MARBOB ENERGY CORP
NERVOUS PURVIS STAT 1
Datum=3675.00
990 FNL/660 FWL
TWP: 18 S - Range: 31 E - Sec: 36

3855 ft

30015235040000
GULF OIL CORP
EDDY UP STATE COM 1
Datum=3681.00
750 FNL/1980 FWL
TWP: 18 S - Range: 31 E - Sec: 36

6665 ft

30025359300000
LYNX PETR CONSUL INC
LUSK 31 FEDERAL 3
Datum=3693.00
1680 FNL/2080 FWL
TWP: 18 S - Range: 32 E - Sec: 31

A'
E

2A

36D

36N

31J

Top 2nd BSPG SD

500

Lead Belly 2nd SD Target

Top 3rd BSPG Carbonate

Top 3rd BSPG SD

Lead Belly 3rd SD Target

Top WFMP

500

0

-500

Lead Belly 36/35 2nd-3rd BSPG SD Cross
Section Exhibit (A-A')

**STATE OF NEW MEXICO
ENERGY, MINERALS AND NATURAL RESOURCES DEPARTMENT
OIL CONSERVATION DIVISION**

**APPLICATION OF MEWBOURNE OIL
COMPANY FOR COMPULSORY POOLING,
EDDY COUNTY, NEW MEXICO.**

CASE NO. 25228

**SELF-AFFIRMED STATEMENT OF
ADAM G. RANKIN**

1. I am attorney in fact and authorized representative of Mewbourne Oil Company (“Mewbourne”), the Applicant herein. I have personal knowledge of the matter addressed herein and am competent to provide this self-affirmed statement.

2. The above-referenced application and notice of the hearing on this application was sent by certified mail to the locatable affected parties on the date set forth in the letter attached hereto.

3. The spreadsheet attached hereto contains the names of the parties to whom notice was provided.

4. The spreadsheet attached hereto contains the information provided by the United States Postal Service on the status of the delivery of this notice as of February 28, 2025.

5. I caused a notice to be published to all parties subject to this proceeding. An affidavit of publication from the publication’s legal clerk with a copy of the notice publication is attached herein.

6. I affirm under penalty of perjury under the laws of the State of New Mexico that the foregoing statements are true and correct. I understand that this self-affirmed statement will be used as written testimony in this case. This statement is made on the date next to my signature below.

**BEFORE THE OIL CONSERVATION DIVISION
Santa Fe, New Mexico
Exhibit No. E
Submitted by: Mewbourne Oil Company
Hearing Date: March 13, 2025
Case No. 25228**



Adam G. Rankin

March 6, 2025

Date



Paula M. Vance
Associate
Phone (505) 988-4421
Email pmvance@hollandhart.com

February 21, 2025

VIA CERTIFIED MAIL
CERTIFIED RECEIPT REQUESTED

TO: ALL INTEREST OWNERS SUBJECT TO POOLING PROCEEDINGS

Re: Application of Mewbourne Oil Company for Compulsory Pooling, Eddy County, New Mexico: Lead Belly 36/35 Fed Com #521H, #523H, #525H, #527H, #622H, #624H, #626H, and #628H wells

Greetings:

This letter is to advise you that Mewbourne Oil Company has filed the enclosed application with the New Mexico Oil Conservation Division. A hearing has been requested before a Division Examiner on March 13, 2025, and the status of the hearing can be monitored through the Division's website at <https://www.emnrd.nm.gov/ocd/>.

It is anticipated that hearings will be held in a hybrid format with both in-person and virtual participation options. The meeting will be held in the Pecos Hall Hearing Room at the Wendall Chino Building, 1st Floor, 1220 South St. Francis Dr., Santa Fe, New Mexico. To participate virtually in the hearing, see the instructions posted on the OCD Hearings website: <https://www.emnrd.nm.gov/ocd/hearing-info/>.

You are not required to attend this hearing, but as an owner of an interest that may be affected by this application, you may appear and present testimony. Failure to appear at that time and become a party of record will preclude you from challenging the matter at a later date. Parties appearing in cases are required to file a Pre-hearing Statement four business days in advance of a scheduled hearing that complies with the provisions of NMAC 19.15.4.13.B.

If you have any questions about this matter, please contact Ariana Rodrigues at (432) 682-3715, or at arodrigues@mewbourne.com.

Sincerely,

A handwritten signature in blue ink, appearing to read 'Paula M. Vance'.

Paula M. Vance
ATTORNEY FOR MEWBOURNE OIL COMPANY

T 505.988.4421 F 505.983.6043
110 North Guadalupe, Suite 1, Santa Fe, NM 87501-1849
Mail to: P.O. Box 2208, Santa Fe, NM 87504-2208
www.hollandhart.com

Alaska	Montana	Utah
Colorado	Nevada	Washington, D.C.
Idaho	New Mexico	Wyoming

MOC - Lead Belly 36/35 wells - Case no. 25228
Postal Delivery Report

9414811898765456358006	Riverbend Production, Lp	Attn Travis Hall	1001 Fannin St Ste 2020	Houston	TX	77002-6715	Your item was delivered to an individual at the address at 1:05 pm on February 25, 2025 in HOUSTON, TX 77002.
9414811898765456358044	Elliott Industries Limited Partnership	Attn Permian Land Manager	PO Box 150530	Ogden	UT	84415-0530	Your item has been delivered and is available at a PO Box at 7:38 am on February 25, 2025 in OGDEN, UT 84415.
9414811898765456358075		Elliott-Hall Company	PO Box 1328	Santa Fe	NM	87504-1328	Your item arrived at the SANTA FE, NM 87504 post office at 11:14 am on February 24, 2025 and is ready for pickup.

AFFIDAVIT OF PUBLICATION

CARLSBAD CURRENT-ARGUS
PO BOX 507
HUTCHINSON, KS 67504-0507

STATE OF NEW MEXICO } SS
COUNTY OF EDDY }

Account Number: 1232
Ad Number: 36400
Description: Lead Belly 36 35 wells 25228
Ad Cost: \$136.82

Sherry Groves, being first duly sworn, says:

That she is the Agent of the the Carlsbad Current-Argus, a Weekly newspaper of general circulation, printed and published in Carlsbad, Eddy County, New Mexico; that the publication, a copy of which is attached hereto, was published in said newspaper on the following dates:

February 27, 2025

That said newspaper was regularly issued and circulated on those dates.

SIGNED:

Sherry Groves

Agent

Subscribed to and sworn to me this 27th day of February 2025.

Leanne Kaufenberg
Leanne Kaufenberg, Notary Public, Redwood County
Minnesota

KARI REESE
HOLLAND & HART LLP
420 L STREET, SUITE 550
ANCHORAGE, AK 99501
klreese@hollandhart.com

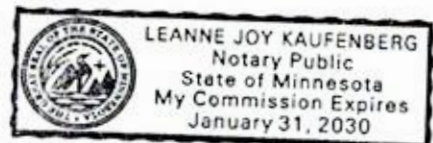

BEFORE THE OIL CONSERVATION DIVISION
Santa Fe, New Mexico
Exhibit No. F
Submitted by: Mewbourne Oil Company
Hearing Date: March 13, 2025
Case No. 25228

PUBLIC NOTICE

Case No. 25228: Application of Mewbourne Oil Company for Compulsory Pooling, Eddy County, New Mexico. Notice to all affected interest owners, including all heirs, devisees and successors of: Riverbend Production, LP; Elliott Industries Limited Partnership; Elliott-Hall Company. The State of New Mexico, Energy Minerals and Natural Resources Department, Oil Conservation Division ("Division") hereby gives notice that the Division will hold public hearing 8:30 a.m. on March 13, 2025, to consider this application. The hearing will be conducted in a hybrid fashion, both in-person at the Energy, Minerals, Natural Resources Department, Wendell Chino Building, Pecos Hall, 1220 South St. Francis Drive, 1st Floor, Santa Fe, NM 87505 and via the WebEx virtual meeting platform. To participate in the hearings electronically, see the instructions posted on the docket for the hearing date: <https://www.emnrd.nm.gov/ocd/hearing-info/> or contact Freya Tschantz, at Freya.Tschantz@emnrd.nm.gov. Applicant in the above-styled cause seeks an order pooling a non-standard 960-acre, more or less, horizontal well spacing unit in the Bone Spring formation underlying the E/2 of Section 35 and all of Section 36, Township 18 South, Range 31 East, NMPM, Eddy County, New Mexico. This spacing unit will be initially dedicated to the proposed Lead Belly 36/35 Fed Com #521H well, with a surface location in the NE/4 SE/4 (Unit I) of Section 36 and bottomhole location in the NW/4 NE/4 (Unit B) of Section 35; Lead Belly 36/35 Fed Com #523H and Lead Belly 36/35 Fed Com #624H well, with a surface location in the NE/4 SE/4 (Unit I) of Section 36 and bottomhole location in the SW/4 NE/4 (Unit G) of Section 35; Lead Belly 36/35 Fed Com #525H and Lead Belly 36/35 Fed Com #626H well, with a surface location in the NE/4 SE/4 (Unit I) of Section 36 and bottomhole location in the NW/4 SE/4 (Unit J) of Section 35; and Lead Belly 36/35 Fed Com #527H, Lead Belly 36/35 Fed Com #622H, and Lead Belly 36/35 Fed Com #628H well, with a surface location in the NE/4 SE/4 (Unit I) of Section 36 and bottomhole location in the SW/4 SE/4 (Unit O) of Section 35. Also to be considered will be the cost of drilling and completing the wells and the allocation of the costs thereof, the operating costs and charges for supervision, the designation of applicant as operator of the proposed spacing unit, and a 200% charge for risk involved

in drilling said wells. Said area is located approximately 30 miles northeast of Carlsbad, New Mexico.

Published in the Carlsbad Current-Argus February 27, 2025.
#36400