

**STATE OF NEW MEXICO
DEPARTMENT OF ENERGY, MINERALS AND NATURAL RESOURCES
OIL CONSERVATION DIVISION**

**APPLICATION OF 3R OPERATING, LLC
FOR COMPULSORY POOLING,
EDDY COUNTY, NEW MEXICO.**

CASE NO. 25321

NOTICE OF AMENDED EXHIBITS

3R Operating, LLC is providing the attached amended exhibit packet, which includes the following revised exhibits:

- Compulsory Pooling Checklist; and
- Exhibit A-3.

Respectfully submitted,

HARDY MCLEAN LLP

/s/ Dana S. Hardy

Dana S. Hardy

Jaclyn M. McLean

P.O. Box 2068

Santa Fe, NM 87504-2068

Phone: (505) 982-4554

Facsimile: (505) 982-8623

dhardy@hardymclean.com

jmclean@hardymclean.com

Counsel for 3R Operating, LLC

CERTIFICATE OF SERVICE

I hereby certify that a true and correct copy of the foregoing was served on counsel of record via electronic mail on September 4, 2025:

Ocean Munds-Dry
Gabrielle Gerholt
309 Johnston St.
Santa Fe, NM 87501
(505) 592-0521
(303) 312-8518
omundsdry@civiresources.com
ggerholt@civiresources.com
Attorneys for Civitas Permian Operating, LLC

Modrall, Sperling, Roehl, Harris & Sisk, P.A.
Earl E. DeBrine, Jr.
Deana Bennett
Post Office Box 2168
Albuquerque, NM 87103-2168
(505) 848-1800
earl.debrine@modrall.com
deana.bennett@modrall.com
*Attorneys for Cimarex Energy Co. of Colorado,
Magnum Hunter Production, Inc., Coterra Energy*

/s/ Dana S. Hardy

**STATE OF NEW MEXICO
DEPARTMENT OF ENERGY, MINERALS AND NATURAL RESOURCES
OIL CONSERVATION DIVISION**

**APPLICATION OF 3R OPERATING, LLC
FOR COMPULSORY POOLING,
EDDY COUNTY, NEW MEXICO.**

CASE NO. 25321

EXHIBIT INDEX

Compulsory Pooling Checklist

Exhibit A	Self-Affirmed Statement of Brian Van Staveren
A-1	Application & Proposed Notice of Hearing
A-2	C-102
A-3	Plat of Tracts, Tract Ownership, Applicable Lease Numbers, Unit Recapitulation, Pooled Parties
A-4	Sample Well Proposal Letter & AFE
A-5	Chronology of Contact
Exhibit B	Self-Affirmed Statement of Brian Atwell
B-1	Location Map
B-2	Cross-Section Location Map & Subsea Structure Map
B-3	Stratigraphic Cross-Section
B-4	Gun Barrel Diagram
B-5	Gross Interval Isopach Map
Exhibit C	Self-Affirmed Statement of Jaclyn M. McLean
C-1	Notice Letter to All Interested Parties Sent March 19, 2025
C-2	Postal Delivery Report
C-3	Electronic Return Receipts
C-4	Affidavit of Publication for April 15, 2025

COMPULSORY POOLING APPLICATION CHECKLIST	
ALL INFORMATION IN THE APPLICATION MUST BE SUPPORTED BY SIGNED AFFIDAVITS	
Case: 25321	APPLICANT'S RESPONSE
Date: September 11, 2025	
Applicant	3R Operating, LLC
Designated Operator & OGRID (affiliation if applicable)	3R Operating, LLC (OGRID No. 331569)
Applicant's Counsel:	Hardy McLean LLC
Case Title:	Application of 3R Operating, LLC for Compulsory Pooling, Eddy County, New Mexico.
Entries of Appearance/Intervenors:	Civitas Permian Operating, LLC; Cimarex Energy Co. of Colorado; Magnum Hunter Production, Inc.; Coterra Energy
Well Family	Boudin
Formation/Pool	
Formation Name(s) or Vertical Extent:	Wolfcamp Formation
Primary Product (Oil or Gas):	Gas
Pooling this vertical extent:	Wolfcamp Formation
Pool Name and Pool Code:	Purple Sage; (Wolfcamp) [Gas] Pool (Code 98220)
Well Location Setback Rules:	Order R-14262
Spacing Unit	
Type (Horizontal/Vertical)	Horizontal
Size (Acres)	797.27-acres
Building Blocks:	160 acres
Orientation:	West to East
Description: TRS/County	N/2 of Sections 2 and 3 and NE/4 of Section 4, Township 25 South, Range 26 East, Eddy County.
Standard Horizontal Well Spacing Unit (Y/N), If No, describe and is approval of non-standard unit requested in this application?	Yes.
Other Situations	
Depth Severance: Y/N. If yes, description	No.
Proximity Tracts: If yes, description	No.
Proximity Defining Well: if yes, description	N/A
Applicant's Ownership in Each Tract	Exhibit A-3
Well(s)	
Name & API (if assigned), surface and bottom hole location, footages, completion target, orientation, completion status (standard or non-standard)	Add wells as needed
Well #1	Boudin 4 2 Fed Com Fed Com 701H SHL: 1,652' FNL & 1,625' FEL (Unit G), Section 4, T25S-R26E BHL: 660' FNL & 330' FEL (Lot 1), Section 2, T25S-R26E Completion Target: Wolfcamp (Approx. 8,740' TVD)
AFE Capex and Operating Costs	
Drilling Supervision/Month \$	\$10,000
Production Supervision/Month \$	\$1,000
Justification for Supervision Costs	Exhibit A-4
Requested Risk Charge	200%
Notice of Hearing	
Proposed Notice of Hearing	Exhibit A-1
Proof of Mailed Notice of Hearing (20 days before hearing)	Exhibits C-1, C-2, C-3
Proof of Published Notice of Hearing (10 days before hearing)	Exhibit C-4
Ownership Determination	
Land Ownership Schematic of the Spacing Unit	Exhibit A-3
Tract List (including lease numbers and owners)	Exhibit A-3
If approval of Non-Standard Spacing Unit is requested, Tract List (including lease numbers and owners) of Tracts subject to notice requirements.	N/A
Pooled Parties (including ownership type)	Exhibit A-3

Unlocatable Parties to be Pooled	N/A
Ownership Depth Severance (including percentage above & below)	N/A
Joinder	
Sample Copy of Proposal Letter	Exhibit A-4
List of Interest Owners (ie Exhibit A of JOA)	Exhibit A-3
Chronology of Contact with Non-Joined Working Interests	Exhibit A-5
Overhead Rates In Proposal Letter	Exhibit A-4
Cost Estimate to Drill and Complete	Exhibit A-4
Cost Estimate to Equip Well	Exhibit A-4
Cost Estimate for Production Facilities	Exhibit A-4
Geology	
Summary (including special considerations)	Exhibit B
Spacing Unit Schematic	Exhibit B-1
Gunbarrel/Lateral Trajectory Schematic	Exhibit B-4
Well Orientation (with rationale)	Exhibit B
Target Formation	Exhibit B
HSU Cross Section	Exhibit B-2
Depth Severance Discussion	N/A
Forms, Figures and Tables	
C-102	Exhibit A-2
Tracts	Exhibit A-3
Summary of Interests, Unit Recapitulation (Tracts)	Exhibit A-3
General Location Map (including basin)	Exhibit B-1
Well Bore Location Map	Exhibit B-2
Structure Contour Map - Subsea Depth	Exhibit B-2
Cross Section Location Map (including wells)	Exhibit B-2
Cross Section (including Landing Zone)	Exhibit B-3
Additional Information	
Special Provisions/Stipulations	N/A
CERTIFICATION: I hereby certify that the information provided in this checklist is complete and accurate.	
Printed Name (Attorney or Party Representative):	Dana S. Hardy
Signed Name (Attorney or Party Representative):	/s/ Dana S. Hardy
Date:	9/3/2025

**STATE OF NEW MEXICO
DEPARTMENT OF ENERGY, MINERALS AND NATURAL RESOURCES
OIL CONSERVATION DIVISION**

**APPLICATION OF 3R OPERATING, LLC
FOR COMPULSORY POOLING,
EDDY COUNTY, NEW MEXICO.**

CASE NO. 25321

**SELF-AFFIRMED STATEMENT
OF BRIAN VAN STAVEREN**

1. I am a Land Advisor with 3R Operating, LLC ("3R"). I am over 18 years of age, have personal knowledge of the matters addressed herein, and am competent to provide this Self-Affirmed Statement. I have previously testified before the New Mexico Oil Conservation Division ("Division") and my credentials as an expert in petroleum land matters were accepted and made a matter of record.
2. Copies of 3R's application and proposed hearing notice are attached as **Exhibit A-1**.
3. None of the parties proposed to be pooled in this case indicated opposition to this matter proceeding by affidavit; therefore I do not expect any opposition at hearing.
4. 3R seeks to pool all uncommitted interests in the Wolfcamp formation underlying an 800-acre, more or less, standard horizontal spacing unit comprised of the N/2 of Sections 2 and 3 and the NE/4 of Section 4, Township 25 South, Range 26 East, Eddy County, New Mexico ("Unit").
5. The Unit will be dedicated to the **Boudin 4 2 Fed 701H** well ("Well"), which will be drilled from surface hole locations in the SW/4 NE/4 (Unit G) of Section 4 to bottom hole locations in the NE/4 NE/4 (Unit A) of Section 2.
6. The completed interval of the Well will be orthodox.
7. **Exhibit A-2** contains the C-102 for the Well.
8. **Exhibit A-3** contains a plat identifying ownership by tract in the Unit. This exhibit also includes any applicable lease numbers, a unit recapitulation, and the interests 3R seeks to pool

highlighted in yellow.

9. 3R has conducted a diligent search of all county public records, including phone directories and computer databases, as well as internet searches, to locate the interest owners it seeks to pool.

10. **Exhibit A-4** contains a sample well proposal letter and AFEs sent to working interest owners for the Well. The estimated costs reflected on the AFE are fair and reasonable and comparable to the cost of other wells of similar depth and length drilled in the subject formation in the area.

11. In my opinion, 3R made a good-faith effort to reach voluntary joinder of uncommitted interests in the Well as indicated by the chronology of contact described in **Exhibit A-5**.

12. 3R requests overhead and administrative rates of \$10,000 per month while the Well is being drilled and \$1,000 per month while the Well is producing. These rates are fair and are comparable to the rates charged by 3R and other operators in the vicinity.

13. The attached exhibits were either prepared by me or under my supervision or were compiled from company business records.

14. In my opinion, the granting of 3R's application would serve the interests of conservation, the protection of correlative rights, and the prevention of waste.

15. I understand this Self-Affirmed Statement will be used as written testimony in this case. I affirm that my testimony above is true and correct and is made under penalty of perjury under the laws of the State of New Mexico. My testimony is made as of the date next to my electronic signature below.

BRIAN VAN STAVEREN

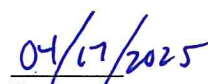
Date

**STATE OF NEW MEXICO
DEPARTMENT OF ENERGY, MINERALS AND NATURAL RESOURCES
OIL CONSERVATION DIVISION**

**APPLICATION OF 3R OPERATING, LLC
FOR COMPULSORY POOLING,
EDDY COUNTY, NEW MEXICO.**

CASE NO. _____

APPLICATION

Pursuant to NMSA § 70-2-17, 3R Operating, LLC (OGRID No. 331569) ("Applicant") applies for an order pooling all uncommitted interests in the Wolfcamp formation underlying an 800-acre, more or less, standard horizontal spacing unit comprised of the N/2 of Sections 2 and 3 and the NE/4 of Section 4, Township 25 South, Range 26 East, Eddy County, New Mexico ("Unit"). In support of its application, Applicant states the following:

1. Applicant is a working interest owner in the Unit and has the right to drill wells thereon.
2. The Unit will be dedicated to the **Boudin 4 2 Fed Com 701H** well ("Well"), which will be drilled from a surface hole location in the SW/4 NE/4 (Unit G) of Section 4 to a bottom hole location in the NE/4 NE/4 (Unit A) of Section 2.
3. The completed interval of the Well will be orthodox.
4. Applicant has undertaken diligent, good faith efforts to obtain voluntary agreements from all interest owners to participate in the drilling of the Well but has been unable to obtain voluntary agreements from all interest owners.
5. The pooling of uncommitted interests will avoid the drilling of unnecessary wells, prevent waste, and protect correlative rights.
6. In order to allow Applicant to obtain its just and fair share of the oil and gas underlying the subject lands, all uncommitted interests in the Unit should be pooled and Applicant should be designated the operator of the Well and the Unit.

**3R Operating, LLC
Case No. 25321
Exhibit A-1**

WHEREFORE, Applicant requests that this application be set for hearing before an Examiner of the Oil Conservation Division on May 8, 2025, and, after notice and hearing as required by law, the Division enter an order:

- A. Pooling all uncommitted interests in the Unit;
- B. Designating Applicant as operator of the Unit and the Well to be drilled thereon;
- C. Authorizing Applicant to recover its costs of drilling, equipping and completing the Well;
- D. Approving the actual operating charges and costs of supervision while drilling and after completion, together with a provision adjusting the rates pursuant to the COPAS accounting procedures; and
- E. Imposing a 200% penalty for the risk assumed by Applicant in drilling and completing the Well against any working interest owner who does not voluntarily participate in the drilling of the Well.

Respectfully submitted,

HARDY McLEAN LLC

/s/ Dana S. Hardy

Dana S. Hardy

Jaclyn M. McLean

125 Lincoln Ave., Ste. 223

Santa Fe, NM 87501

Phone: (505) 230-4410

dhardy@hardymclean.com

jmclean@hardymclean.com

COUNSEL FOR 3R OPERATING, LLC

		<p>502H, with first take points in the NW4NE4 (Unit B) of Section 15 and last take points in the SW4SE4 (Unit O) of Section 22; and</p> <ul style="list-style-type: none"> • Sour Grapes 15 State Com 203H, Sour Grapes State Com 304H and Sour Grapes State Com 503H, with first take points in the NE4NE4 (Unit A) of Section 15 and last take points in the SE4SE4 (Unit P) of Section 22. <p>This proposed horizontal well spacing unit will overlap the following existing spacing units in the Bone Spring formation (Berry; Bone Spring, South Pool (96660)):</p> <ul style="list-style-type: none"> • A 240-acre spacing unit comprised of the W2SE4 of Section 15 and the W2E2 of Section 22, dedicated to the Lychee BWS State Com 1H (30-025-42445), operated by COG Operating; and • A 320-acre spacing unit comprised of the E2W2 of Sections 15 and 22, dedicated to the Lychee State Com 3H (30-025-45256) and the Lychee State Com 503H (30-025-46423) operated by COG Operating. <p>Also, to be considered will be the cost of drilling and completing the wells and the allocation of the costs thereof, the operating costs and charges for supervision, the designation of applicant as operator, and a 200% charge for risk involved in drilling and completing the wells. The subject area is located approximately 17 miles west of Eunice, New Mexico.</p> <p>Setting: Status Conference Joined with Cases: 25312</p>
9.	25321	<p>Application of 3R Operating, LLC for Compulsory Pooling, Eddy County, New Mexico.</p> <p>Applicant applies for an order pooling all uncommitted interests in the Wolfcamp formation underlying an 800-acre, more or less, standard horizontal spacing unit comprised of N/2 of Sections 2 and 3 and the NE/4 of Section 4, Township 25 South, Range 26 East, Eddy County, New Mexico ("Unit"). The Unit will be dedicated to the Boudin 4 2 Fed Com 701H well ("Well"), which will be drilled from a surface hole location in the SW/4 NE/4 (Unit G) of Section 4 to a bottom hole location in the NE/4 NE/4 (Unit A) of Section 2. The completed interval of the Well will be orthodox. Also to be considered will be the cost of drilling and completing the Well and the allocation of the costs, the designation of Applicant as the operator of the Well, and a 200% charge for the risk involved in drilling and completing the Well. The Well is located approximately 7 miles East of Whites City, New Mexico.</p> <p>Setting: Status Conference Joined with Cases: 25322</p>
10.	25322	<p>Application of 3R Operating, LLC for Compulsory Pooling, Eddy County, New Mexico.</p> <p>Applicant applies for an order pooling all uncommitted interests in the Wolfcamp formation underlying an 800-acre, more or less, standard horizontal spacing unit comprised of the S/2 of Sections 2 and 3 and the SE/4 of Section 4, Township 25 South, Range 26 East, Eddy County, New Mexico ("Unit"). The Unit will be dedicated to the Boudin 4 2 Fed Com 703H well ("Well"), which will be drilled from a surface hole location in the NW/4 SE/4 (Unit J) of Section 4 to a bottom hole location in the SE/4 SE/4 (Unit P) of Section 2. The completed interval of the Well will be orthodox. Also to be considered will be the cost of drilling and completing the Well and the allocation of the costs, the designation of Applicant as the operator of the Well, and a 200% charge for the risk involved in drilling and completing the Well. The Well is located approximately 7 miles East of Whites City, New Mexico.</p> <p>Setting: Status Conference Joined with Cases: 25321</p>
11.	25323	<p>Application of 3R Operating, LLC for Compulsory Pooling, Eddy County, New Mexico.</p> <p>Applicant applies for an order pooling all uncommitted interests in the Wolfcamp formation 640-acre, more or less, standard horizontal spacing unit comprised of N/2 of Sections 34 and 35, Township 24 South, Range 26 East, Eddy County, New Mexico ("Unit"). The Unit will be dedicated to the McMuffin 34 35 Fed Com 701H well ("Well"), which will be drilled from a surface hole location in the NE/4 NE/4 (Unit A) of Section 33 to a bottom hole location in the NE/4 NE/4 (Unit A) of Section 35. The completed interval of the Well will be orthodox. Also to be considered will be the cost of drilling and completing the Well and the allocation of the costs, the designation of Applicant as the operator of the Well, and a 200% charge for the risk involved in drilling and</p>

C-102 Submit Electronically Via OCD Permitting	State of New Mexico Energy, Minerals & Natural Resources Department OIL CONSERVATION DIVISION	Revised July 9, 2024	
		Submittal Type:	<input type="checkbox"/> Initial Submittal
			<input type="checkbox"/> Amended Report
		<input type="checkbox"/> As Drilled	

WELL LOCATION INFORMATION

API Number	Pool Code 98220	Pool Name Purple Sage: Wolfcamp
Property Code	Property Name BOUDIN 4 2 FED COM	Well Number 701H
OGRID No. 331569	Operator Name 3R OPERATING, LLC	Ground Level Elevation 3333.8
Surface Owner: <input type="checkbox"/> State <input type="checkbox"/> Fee <input type="checkbox"/> Tribal <input type="checkbox"/> Federal		Mineral Owner: <input type="checkbox"/> State <input type="checkbox"/> Fee <input type="checkbox"/> Tribal <input type="checkbox"/> Federal

Surface Location

UL G	Section 4	Township 25 S	Range 26 E	Lot	Ft. from N/S 1652 NORTH	Ft. from E/W 1625 EAST	Latitude 32.1619467°N	Longitude 104.2946411°W	County EDDY
------	-----------	---------------	------------	-----	-------------------------	------------------------	-----------------------	-------------------------	-------------

Bottom Hole Location

UL	Section 2	Township 25 S	Range 26 E	Lot 1	Ft. from N/S 660 NORTH	Ft. from E/W 330 EAST	Latitude 32.1646011°N	Longitude 104.2561993°W	County EDDY
----	-----------	---------------	------------	-------	------------------------	-----------------------	-----------------------	-------------------------	-------------

Dedicated Acres 800	Infill or Defining Well	Defining Well API	Overlapping Spacing Unit (Y/N)	Consolidation Code
Order Numbers.			Well setbacks are under Common Ownership: <input type="checkbox"/> Yes <input type="checkbox"/> No	

Kick Off Point (KOP)

UL	Section 4	Township 25 S	Range 26 E	Lot 2	Ft. from N/S 660 NORTH	Ft. from E/W 2410 EAST	Latitude 32.1646784°N	Longitude 104.2971541°W	County EDDY
----	-----------	---------------	------------	-------	------------------------	------------------------	-----------------------	-------------------------	-------------

First Take Point (FTP)

UL	Section 4	Township 25 S	Range 26 E	Lot 2	Ft. from N/S 660 NORTH	Ft. from E/W 2310 EAST	Latitude 32.1646777°N	Longitude 104.2968310°W	County EDDY
----	-----------	---------------	------------	-------	------------------------	------------------------	-----------------------	-------------------------	-------------

Last Take Point (LTP)

UL	Section 2	Township 25 S	Range 26 E	Lot 1	Ft. from N/S 660 NORTH	Ft. from E/W 330 EAST	Latitude 32.1646011°N	Longitude 104.2561993°W	County EDDY
----	-----------	---------------	------------	-------	------------------------	-----------------------	-----------------------	-------------------------	-------------

Unitized Area or Area of Uniform Interest	Spacing Unit Type <input type="checkbox"/> Horizontal <input type="checkbox"/> Vertical	Ground Floor Elevation:
---	---	-------------------------

OPERATOR CERTIFICATIONS

I hereby certify that the information contained herein is true and complete to the best of my knowledge and belief, and, if the well is a vertical or directional well, that this organization either owns a working interest or unleased mineral interest in the land including the proposed bottom hole location or has a right to drill this well at this location pursuant to a contract with an owner of a working interest run leased mineral interest, or to a voluntary pooling agreement or a compulsory pooling order here to fore entered by the division.

If this well is a horizontal well, I further certify that this organization has received the consent of at least one lessee or owner of a working interest or unleased mineral interest in each tract (in the target pool or formation) in which any part of the well's completed interval will be located or obtained a compulsory pooling order from the division.

Austin Tramell 08/15/2025
Signature Date

Austin Tramell
Printed Name

atramell@3roperating.com
Email Address

SURVEYOR CERTIFICATIONS

I hereby certify that the well location shown on this plat was plotted from field notes of actual surveys made by me or under my supervision, and that the same is true and correct to the best of my belief.

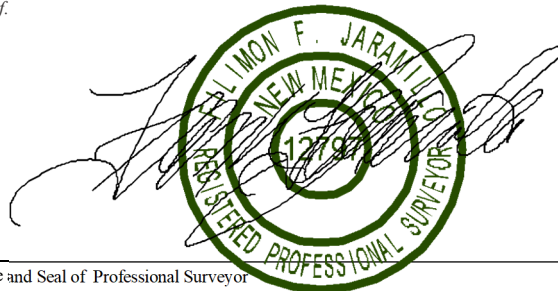

Signature and Seal of Professional Surveyor
FILIMON F. JARAMILLO

Certificate Number

PLS 12797

Date of Survey

NOVEMBER 11, 2024

SURVEY NO. 10339

Note: No allowable will be assigned to this completion until all interests have been consolidated or a non-standard unit has been approved by the division.

3R Operating, LLC
Case No. 25321
Exhibit A-2

This grid represents a standard section. You may superimpose a non-standard section, or larger area, over this grid. Operators must outline the dedicated acreage in a red box, clearly show the well surface location and bottom hole location, if it is directionally drilled, with the dimensions from the section lines in the cardinal directions. If this is a horizontal wellbore show on this plat the location of the First Take Point and Last Take Point, and the point within the Completed interval (other than the First Take Point or Last Take Point) that is closest to any outer boundary of the tract.

Surveyors shall use the latest United States government survey or dependent resurvey. Well locations will be in reference to the New Mexico Principal Meridian. If the land is not surveyed, contact the OCD Engineering Bureau. Independent subdivision surveys will not be acceptable.

BOUDIN 4 2 FED COM 701H
EL. = 3333.8

GEODETTIC COORDINATES

NAD 83 NMSP EAST
SURFACE LOCATION
1652' FNL, 1625' FEL
N.=422653.48
E.=553310.50
LAT.=32.1619467°N
LONG.=104.2946411°W

KICK OFF POINT
660' FNL, 2410' FEL
N.=423646.93
E.=552532.55
LAT.=32.1646784°N
LONG.=104.2971541°W

FIRST TAKE POINT
660' FNL, 2310' FEL
N.=423646.70
E.=552632.52
LAT.=32.1646777°N
LONG.=104.2968310°W

LAST TAKE POINT
660' FNL, 330' FEL
N.=423625.47
E.=565205.32
LAT.=32.1646011°N
LONG.=104.2561993°W

BOTTOM OF HOLE
660' FNL, 330' FEL
N.=423625.47
E.=565205.32
LAT.=32.1646011°N
LONG.=104.2561993°W

PPP2
658' FNL, 1326' FWL
N.=423640.57
E.=556267.36
LAT.=32.1646569°N
LONG.=104.2850842°W

PPP3
658' FNL, 1319' FEL
N.=423636.10
E.=558910.31
LAT.=32.1646410°N
LONG.=104.2765430°W

PPP4
659' FNL, 0' FEL
N.=423633.88
E.=560228.98
LAT.=32.1646330°N
LONG.=104.2722814°W

CORNER COORDINATES TABLE

NAD 83 NMSP EAST

A	N.=424308.86	E.=549630.09
B	N.=424307.30	E.=552290.42
C	N.=424301.41	E.=554946.51
D	N.=424295.83	E.=557601.13
E	N.=424292.44	E.=560241.79
F	N.=424293.38	E.=562892.51
G	N.=424284.14	E.=565541.41
H	N.=421660.76	E.=549634.68
I	N.=421648.11	E.=554928.26
J	N.=421595.85	E.=560189.34
K	N.=421627.87	E.=565516.56
L	N.=419015.63	E.=549638.69
M	N.=419027.21	E.=552316.64
N	N.=418962.92	E.=554915.87
O	N.=418917.93	E.=557526.56
P	N.=418877.08	E.=560133.52
Q	N.=418883.74	E.=562810.12
R	N.=418979.78	E.=565490.59

LEGEND

--- SECTION LINE
--- QUARTER LINE
--- LEASE LINE
--- WELL PATH

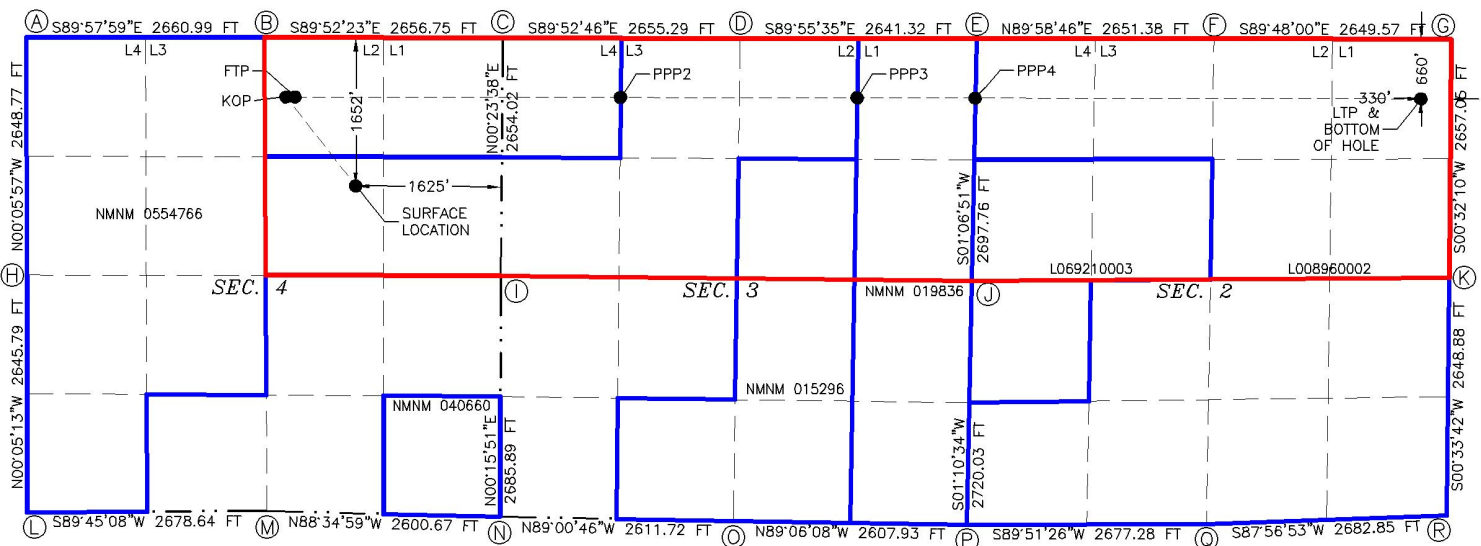
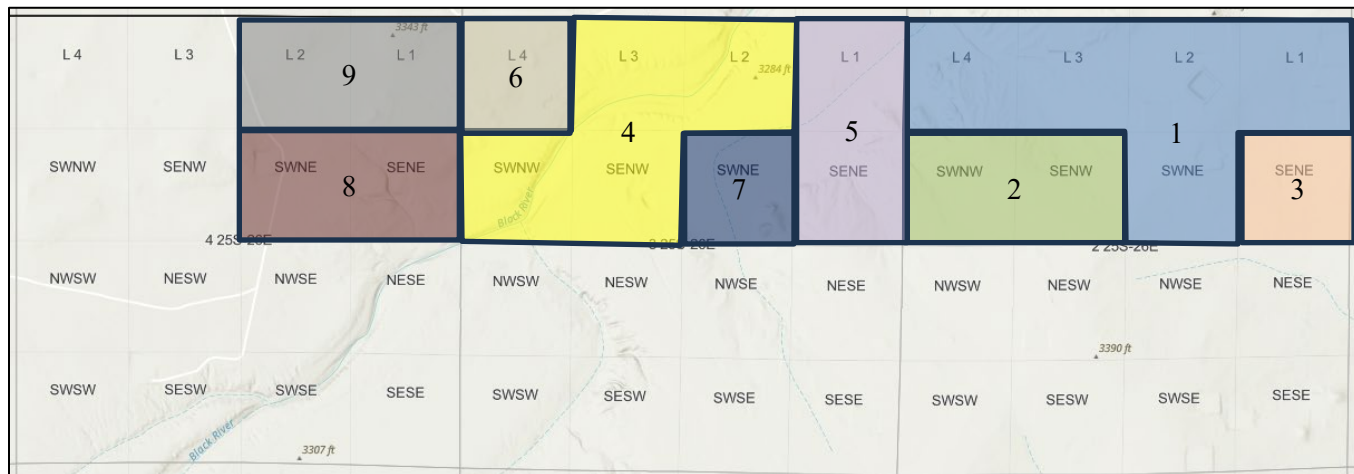

EXHIBIT A-3
N/2 of Sections 2 and 3 and the NE/4 of Section 4, T24S-R26E
Wolfcamp Formation
Eddy County, New Mexico
797.27 acres, more or less



TRACT 1 – Lots 1-4 (N/2 N/2) and SW/4 NE/4 of Section 2, T25S-R26E – 200.32 acres**State of New Mexico Lease L-896**

Ridge Runner AssetCo II, LLC – 90.00% WI

MEC Petroleum Corp. – 10.00% WI – under JOA

TRACT 2 – S/2 NW/4 of Section 2, T25S-R26E – 80.00 acres**State of New Mexico Lease L-6921**

Ridge Runner AssetCo II, LLC – 90.00% WI

MEC Petroleum Corp. – 10.00% WI – under JOA

1B4S Enterprises, LLC – ORRI

V.J. Callaway and Bonnie Callaway – ORRI

W.R. Eriksen and Wanda Eriksen – ORRI

Mumford & Company – ORRI

Clyde R. Wilson, Trustee – ORRI

E.L. Latham Minerals, LLC - ORRI

TRACT 3 – SE/4 NE/4 of Section 2, T25S-R26E – 40.00 acres**State of New Mexico Lease L-896**

Ridge Runner AssetCo II, LLC – 90.00% WI

MEC Petroleum Corp. – 10.00% WI – under JOA

TRACT 4 – Lots 2-3 (NW/4 NE/4 and NE/4 NW/4) and S/2 NW/4 of Section 3, T25S-R26E – 159.36 acres**Fee Leases**

Ridge Runner AssetCo II, LLC – 46.502811% WI

MEC Petroleum Corp. – 5.166979% WI – under JOA

WPX Energy Permian, LLC – 9.66814% WI

Chevron USA, Inc. – 6.45701% WI

Magnum Hunter Production, Inc. – 32.20506% WI

Pearson-Sibert Oil Company of Texas - ORRI

TRACT 5 – Lot 1 (NE/4 NE/4) and SE/4 NE/4 of Section 3, T25S-R26E – 78.86 acres**United States of America Lease NM-19836**

Ridge Runner II Nominee Corp. – 46.502811% WI

MEC Petroleum Corp. – 5.166979% WI – under JOA

WPX Energy Permian, LLC – 9.66814% WI

Chevron USA, Inc. – 6.45701% WI

Magnum Hunter Production, Inc. – 32.20506% WI

Pearson-Sibert Oil Company of Texas – ORRI

Alan Jochimsen – ORRI

Karemont Properties, LLC – ORRI

States Royalty, LP - ORRI

TRACT 6 – Lot 4 (NW/4 NW/4) of Section 3, T25S-R26E – 39.50 acres

United States of America Lease NMNM-0554766

Ridge Runner II Nominee Corp. – 46.502811% WI

MEC Petroleum Corp. – 5.166979% WI – under JOA

WPX Energy Permian, LLC – 9.66814% WI

Chevron USA, Inc. – 6.45701% WI

Magnum Hunter Production, Inc. – 32.20506% WI

Pearson-Sibert Oil Company of Texas - ORRI

TRACT 7 – SW/4 NE/4 of Section 3, T25S-R26E – 40.00 acres

United States of America Lease NM-015296

Ridge Runner II Nominee Corp. – 46.502811% WI

MEC Petroleum Corp. – 5.166979% WI – under JOA

WPX Energy Permian, LLC – 9.66814% WI

Chevron USA, Inc. – 6.45701% WI

Magnum Hunter Production, Inc. – 32.20506% WI

Pearson-Sibert Oil Company of Texas – ORRI

AmeriPermian Holdings, LLC - ORRI

TRACT 8 – S/2 NE/4 of Section 4, T25S-R26E – 80.00 acres

Fee Leases

Ridge Runner II Nominee Corp. – 46.502811% WI

MEC Petroleum Corp. – 5.166979% WI – under JOA

WPX Energy Permian, LLC – 9.66814% WI

Chevron USA, Inc. – 6.45701% WI

Magnum Hunter Production, Inc. – 32.20506% WI

Pearson-Sibert Oil Company of Texas - ORRI

TRACT 9 – Lots 1-2 (N/2 NE/4) of Section 4, T25S-R26E – 79.23 acres

United States of America Lease NM-0554766

Ridge Runner II Nominee Corp. – 46.502811% WI

MEC Petroleum Corp. – 5.166979% WI – under JOA

WPX Energy Permian, LLC – 9.66814% WI

Chevron USA, Inc. – 6.45701% WI

Magnum Hunter Production, Inc. – 32.20506% WI

*Parties to be pooled are highlighted in yellow.

Pearson-Sibert Oil Company of Texas - ORRI

*Parties to be pooled are highlighted in yellow.

RECAPITLATION**N/2 of Sections 2 and 3 and the NE/4 of Section 4, T24S-R26E****Wolfcamp Formation****Eddy County, New Mexico****797.27 acres, more or less****Working Interest Owners**

<u>Ridge Runner AssetCo II, LLC</u>	<u>36.000000%</u>
<u>Ridge Runner II Nominee Corp.</u>	<u>27.901687%</u>
<u>Magnum Hunter Production, Inc.</u>	<u>19.323036%</u>
<u>MEC Petroleum Corp.</u>	<u>7.1001870%</u>
<u>WPX Energy Permian, LLC</u>	<u>5.8008840%</u>
<u>Chevron USA, Inc.</u>	<u>3.8742060%</u>
<u>Total</u>	<u>100%</u>

*Parties to be pooled are highlighted in yellow.

RECAPITLATION

N/2 of Sections 2 and 3 and the NE/4 of Section 4, T24S-R26E

Wolfcamp Formation

Eddy County, New Mexico

797.27 acres, more or less

Overriding Interest Owners

1B4S Enterprises, LLC – ORRI

V.J. Callaway and Bonnie Callaway – ORRI

W.R. Eriksen and Wanda Eriksen – ORRI

Mumford & Company – ORRI

Clyde R. Wilson, Trustee – ORRI

E.L. Latham Minerals, LLC - ORRI

Pearson-Sibert Oil Company of Texas - ORRI

Alan Jochimsen – ORRI

Karemont Properties, LLC – ORRI

States Royalty, LP - ORRI

AmeriPermian Holdings, LLC - ORRI

*Parties to be pooled are highlighted in yellow.

Brian van Staveren
Land Advisor
bvanstaveren@3ROperating.com



20405 State Highway 249
Suite 820
Houston, TX 77070

January 23, 2025

Chevron USA, Inc.
1400 Smith Street
Houston, Texas 77002
Attn: Corie Mathews

Re: Well Proposals
Boudin 4 2 Fed Com 701H
Boudin 4 2 Fed Com 702H
Boudin 4 2 Fed Com 801H
Boudin 4 2 Fed Com 802H
Boudin 4 2 Fed Com 703H
Boudin 4 2 Fed Com 704H
Boudin 4 2 Fed Com 803H
Boudin 4 2 Fed Com 804H
E/2 of Section 2 and all of Sections 3 and 4, Township 25 South, Range 26 East
Eddy County, New Mexico

Dear Working Interest Owner:

3R Operating, LLC ("3R Operating") hereby proposes to drill, complete and operate the following 2.5-mile horizontal wells to test the Wolfcamp XY and Wolfcamp B formations in the E/2 of Section 2 and all of Sections 3 and 4, Township 25 South, Range 26 East, N.M.P.M., Eddy County, New Mexico:

- **Boudin 4 2 Fed Com 701H** as a horizontal Wolfcamp XY formation test, with the SHL location being 1,652' FNL and 1,625' FEL, of Section 4, Township 25 South, Range 26 East, and the BHL location being 660' FNL and 330' FEL of Section 2, Township 25 South, Range 26 East, Eddy County, New Mexico.
- **Boudin 4 2 Fed Com 702H** as a horizontal Wolfcamp XY formation test, with the SHL location being 1,682' FNL and 1,625' FEL, of Section 4, Township 25 South, Range 26

3R Operating, LLC
Case No. 25321
Exhibit A-4

Brian van Staveren
Land Advisor
bvanstaveren@3ROperating.com



20405 State Highway 249
Suite 820
Houston, TX 77070

East, and the BHL location being 1,980' FNL and 330' FEL of Section 2, Township 25 South, Range 26 East, Eddy County, New Mexico.

- **Boudin 4 2 Fed Com 801H** as a horizontal Wolfcamp B formation test, with the SHL location being 1,712' FNL and 1,625' FEL, of Section 4, Township 25 South, Range 26 East, and the BHL location being 660' FNL and 330' FEL of Section 2, Township 25 South, Range 26 East, Eddy County, New Mexico.
- **Boudin 4 2 Fed Com 802H** as a horizontal Wolfcamp B formation test, with the SHL location being 1,472' FNL and 1,625' FEL, of Section 4, Township 25 South, Range 26 East, and the BHL location being 1,980' FNL and 330' FEL of Section 2, Township 25 South, Range 26 East, Eddy County, New Mexico.
- **Boudin 4 2 Fed Com 703H** as a horizontal Wolfcamp XY formation test, with the SHL location being 2,590' FSL and 1,920' FEL, of Section 4, Township 25 South, Range 26 East, and the BHL location being 1,980' FSL and 330' FEL of Section 2, Township 25 South, Range 26 East, Eddy County, New Mexico.
- **Boudin 4 2 Fed Com 704H** as a horizontal Wolfcamp XY formation test, with the SHL location being 2,560' FSL and 1,920' FEL, of Section 4, Township 25 South, Range 26 East, and the BHL location being 660' FSL and 330' FEL of Section 2, Township 25 South, Range 26 East, Eddy County, New Mexico.
- **Boudin 4 2 Fed Com 803H** as a horizontal Wolfcamp B formation test, with the SHL location being 2,530' FSL and 1,920' FEL, of Section 4, Township 25 South, Range 26 East, and the BHL location being 1,980' FSL and 330' FEL of Section 2, Township 25 South, Range 26 East, Eddy County, New Mexico.
- **Boudin 4 2 Fed Com 804H** as a horizontal Wolfcamp B formation test, with the SHL location being 2,500' FSL and 1,920' FEL, of Section 4, Township 25 South, Range 26 East, and the BHL location being 600' FSL and 330' FEL of Section 2, Township 25 South, Range 26 East, Eddy County, New Mexico.

Please find enclosed the Authority for Expenditures ("AFE") for the wells reflecting the estimated costs to drill, test, complete and equip the wells.

Brian van Staveren
Land Advisor
bvanstaveren@3ROperating.com



20405 State Highway 249
Suite 820
Houston, TX 77070

Please also find enclosed A.A.P.L. Form 610-2015 Model Form Operating Agreement covering the acreage for the respective wells for your review and approval.

In lieu of participating, 3R Operating is open to purchasing your leasehold at a mutually agreeable price.

If you have any questions, please do not hesitate to contact me by phone at (432) 254-8866 or by email at bvanstaveren@3ROperating.com.

Sincerely,

Brian van Staveren
Land Advisor

Ridge Runner Resources II

Statement of Estimated Well Cost (100%)

Well

Field

County, State:

BHL:

Proposed TD:

Normal Pressure?

Boudin 4 2 Fed Com 701H

Eddy

Wolfcamp XY

21,640 MD 8,740 TVD

Yes

PROP #: _____

WI #: _____

NRI #: _____

AFE #: _____

			BCP	ACP	TOTAL
	COSTS TO CASING POINT: TANGIBLES				
2510-400	Conductor Casing or Drive Pipe		\$42,000		\$42,000
2510-405	Surface Casing		\$19,113		\$19,113
2510-410	Intermediate Casing/Drlg Liner		\$59,232		\$59,232
2510-415	Wellhead Equipment - Surface & MLS		\$45,000		\$45,000
2510-420	Other Sub-Surface Equipment		\$0		
2510-425	Cementing Equipment		\$45,000		\$45,000
2510-500	Production Casing		\$476,080		\$476,080
2510-600	Nonoperated		\$0		
2510-700	Impairment		\$0		
2510-999	Accruals		\$0		
	TOTAL COST TO CASING POINT - TANGIBLES		\$686,425		\$686,425
	COSTS TO CASING POINT: INTANGIBLES				
2500-100	Roads/Location		\$100,000		\$100,000
2500-105	Drilling Turnkey		\$0		
2500-110	Drilling Daywork		\$922,250		\$922,250
2500-115	Fuel/Power		\$240,000		\$240,000
2500-125	Equipment Rental		\$205,100		\$205,100
2500-130	Legal Fees		\$0		
2500-135	Bonds, Permits and Inspection		\$40,000		\$40,000
2500-155	Mud and Chemicals		\$350,000		\$350,000
2500-160	Cementing Services		\$210,000		\$210,000
2500-170	Supervision/Consulting		\$64,000		\$64,000
2500-175	Casing and Other Tangible Crew		\$75,000		\$75,000
2500-180	Damages/Penalties		\$0		
2500-185	Coring and Analysis		\$0		
2500-190	Cuttings/Fluids Disposal		\$175,000		\$175,000
2500-195	Directional Drilling Services		\$405,500		\$405,500
2500-200	Drill Bits		\$125,000		\$125,000
2500-210	Surface Damages/ROW		\$0		
2500-215	Contract Labor and Services		\$60,000		\$60,000
2500-220	Mud Logging		\$0		
2500-235	Reclamation		\$0		
2500-240	Rig Mobilization/Demob		\$100,000		\$100,000
2500-245	Fishing Tools and Services		\$0		
2500-250	Testing-Drill Stem/Production		\$0		
2500-260	Wireline Services		\$0		
2500-265	Water		\$37,000		\$37,000
2500-270	Camp Expenses		\$68,800		\$68,800
2500-285	Contingencies		\$195,704		\$195,704
2500-290	Environmental		\$50,000		\$50,000
2500-300	Overhead		\$0		
2500-350	Insurance		\$0		
2500-600	Nonoperated		\$0		
2500-700	Impairment		\$0		
2500-999	Accruals		\$0		
	TOTAL COST TO CASING POINT - INTANGIBLES		\$3,423,354		\$3,423,354
	COMPLETION COSTS: TANGIBLES				
2530-415	Wellhead			\$35,000	\$35,000
2530-420	Subsurface Equipment			\$0	
2530-510	Tubing			\$81,400	\$81,400
2530-515	Rods			\$0	
2530-525	Artificial Lift Equipment			\$120,000	\$120,000
2530-530	Gas Metering Equipment			\$35,000	\$35,000
2530-531	Electrical			\$100,000	\$100,000
2530-535	LACT Unit			\$25,000	\$25,000
2530-540	Production Facilities and Flowlines			\$350,000	\$350,000
2530-545	Pumping Unit			\$0	
2530-550	Separator, Heater, Treater			\$275,000	\$275,000
2530-555	Tank Battery			\$175,000	\$175,000
2530-560	Vapor Recovery Unit			\$0	
2530-590	Other Misc Equipment			\$125,000	\$125,000

EXHIBIT A-5 - Summary of Chronological Contact

Date	From	To	Contact Type	Summary	Notes
1/23/2025	3R Operating, LLC	Chevron USA, Inc.	Certified Mail	Well proposals, AFEs and JOA sent to attention of Corie Mathews	
1/23/2025	3R Operating, LLC	Magnum Hunter Production, Inc.	Certified Mail	Well proposals, AFEs and JOA sent to attention of Pat Gray	
1/23/2025	3R Operating, LLC	MEC Petroleum Corp.	Certified Mail	Well proposals, AFEs and JOA sent to attention of Gary Causey	
1/23/2025	3R Operating, LLC	WPX Energy Permian, LLC	Certified Mail	Well proposals, AFEs and JOA sent to attention of Jake Nourse	
2/10/2025	3R Operating, LLC	Magnum Hunter Production, Inc.	Lunch	Lunch meeting with Brad Weschler at Magnum Hunter to discuss trade possibilities	
2/6/2025	3R Operating, LLC	Magnum Hunter Production, Inc.	Phone Call	Phone conversation with Keaton Curtis on trade possibilities	
2/11/2025	3R Operating, LLC	Magnum Hunter Production, Inc.	Email	Phone call to Keaton Curtis at Magnum Hunter	Left Voicemail
2/12/2025	3R Operating, LLC	Magnum Hunter Production, Inc.	Email	Phone conversation with Keaton Curtis on trade possibilities	
2/13/2025	3R Operating, LLC	Magnum Hunter Production, Inc.	Email	Trade proposal sent to Keaton Curtis	
2/14/2025	Magnum Hunter Production, Inc.	3R Operating, LLC	Email	Email from Keaton Curtis discussing trade proposal from 02/13	
3/3/2025	3R Operating, LLC	Magnum Hunter Production, Inc.	Email	Email to Keaton Curtis asking about status of trade proposal	
3/17/2025	3R Operating, LLC	Magnum Hunter Production, Inc.	Email	Email to Keaton Curtis asking to set up phone call the following day	
3/18/2025	3R Operating, LLC	Magnum Hunter Production, Inc.	Email	Email to Keaton Curtis and Brad Weschler asking about setting up phone call to discuss trade	
3/18/2025	3R Operating, LLC	Magnum Hunter Production, Inc.	Phone Call	Phone conversation with Keaton Curtis regarding latest trade proposal to be sent	
3/18/2025	3R Operating, LLC	Magnum Hunter Production, Inc.	Email	Email with slides outlining latest trade proposal	
3/20/2025	MEC Petroleum Corp.	3R Operating, LLC	Email	MEC signed and returned AFEs to participate	
5/19/2025	3R Operating, LLC	Magnum Hunter Production, Inc.	Email	Carry offer sent to MHR; 3R earns 77.5% of MHR's interest by drilling 4 WCXY wells	
5/20/2025	Magnum Hunter Production, Inc.	3R Operating, LLC	Phone Call	Phone conversation with Keaton Curtis regarding carry offer sent the previous day; carry offer was rejected	
5/20/2025	Magnum Hunter Production, Inc.	3R Operating, LLC	Phone Call	Continuation of phone call with Keaton Curtis;	
				MHR proposes trade for their 320 acres in the E/2 of Sections 3 and 10, T24S-R26E	
6/12/2025	Magnum Hunter Production, Inc.	3R Operating, LLC	Email	Email from Keaton Curtis further discussing trade proposal	
7/9/2025	Magnum Hunter Production, Inc.	3R Operating, LLC	Email	Email from Keaton Curtis detailing potential acreage trade	
7/31/2025	Magnum Hunter Production, Inc.	3R Operating, LLC	Email	Trade terms with Magnum Hunter (Coterra) agreed to	
8/13/2025	3R Operating, LLC	Magnum Hunter Production, Inc.	Email	Signed Letter Agreement with Magnum Hunter (Coterra) sent	

3R Operating, LLC
Case No. 25321
Exhibit A-5

STATE OF NEW MEXICO
DEPARTMENT OF ENERGY, MINERALS AND NATURAL RESOURCES
OIL CONSERVATION DIVISION

APPLICATION OF 3R OPERATING, LLC
FOR COMPULSORY POOLING, EDDY
COUNTY, NEW MEXICO.

CASE NO. 25321

SELF-AFFIRMED STATEMENT
OF BRIAN ATWELL

1. I am a geologist with 3R Operating, LLC ("3R"). I am over 18 years of age, have personal knowledge of the matters addressed herein, and am competent to provide this Self-Affirmed Statement. I have previously testified before the New Mexico Oil Conservation Division ("Division") and my credentials as an expert in petroleum geology matters were accepted and made a matter of record.

2. I am familiar with the geological matters that pertain to the above-referenced cases.

3. **Exhibit B-1** is a regional locator map that identifies the Boudin project area, in proximity to the Capitan Reef within the Delaware Basin, for the Wolfcamp horizontal spacing units that are the subject of these applications.

4. **Exhibit B-2** is a Subsea Structure map of the Wolfcamp formation in TVD subsea with a contour interval of 50 ft and cross-section location map for the proposed horizontal spacing unit within the Wolfcamp formation. The map demonstrates the formation is gently dipping to the west in this area. I do not observe any faulting, pinch-outs, or geologic impediments to developing the targeted intervals with horizontal wells. The approximate wellbore paths for the proposed **Boudin 4 2 Fed 701H** well ("Well") is represented by a thick, solid red line. Existing producing wells in the targeted interval on the proposed horizontal spacing unit are represented by dashed red lines (NA). This map identifies a cross-section running from A-A' with a purple line in proximity to the proposed Well.

3R Operating, LLC
Case No. 25321
Exhibit B

5. **Exhibit B-3** identifies four wells penetrating the targeted interval, which I used to construct a stratigraphic cross-section from A to A'. It contains gamma ray, resistivity, and porosity logs. The cross section is oriented from west to east and is hung on the top of the Wolfcamp formation. The proposed landing zones for the Well is labeled on the exhibit (LZ).

6. **Exhibit B-4** is a gun barrel diagram that shows the proposed Well in the Wolfcamp formation.

7. **Exhibit B-5** is a gross interval thickness map of the Wolfcamp A. In my opinion, a laydown orientation for the Well is appropriate to properly develop the subject acreage because of consistent rock properties throughout the Unit and the preferred fracture orientation in this portion of the trend.

8. Based on my geologic study of the area, the targeted interval underlying the Unit is suitable for development by horizontal wells and the tracts comprising the Unit will contribute more or less equally to the production of the Well.

9. In my opinion, the granting of 3R's applications will serve the interests of conservation, the protection of correlative rights, and the prevention of waste.

10. The exhibits attached hereto were either prepared by me or under my supervision or were compiled from company business records.

11. I understand this Self-Affirmed Statement will be used as written testimony in this case. I affirm my testimony above is true and correct and is made under penalty of perjury under the laws of the State of New Mexico. My testimony is made as of the date identified next to my signature below.

12.

Brian Atwell
BRIAN ATWELL

8-18-25
Date

Exhibit B-1: General Location Map

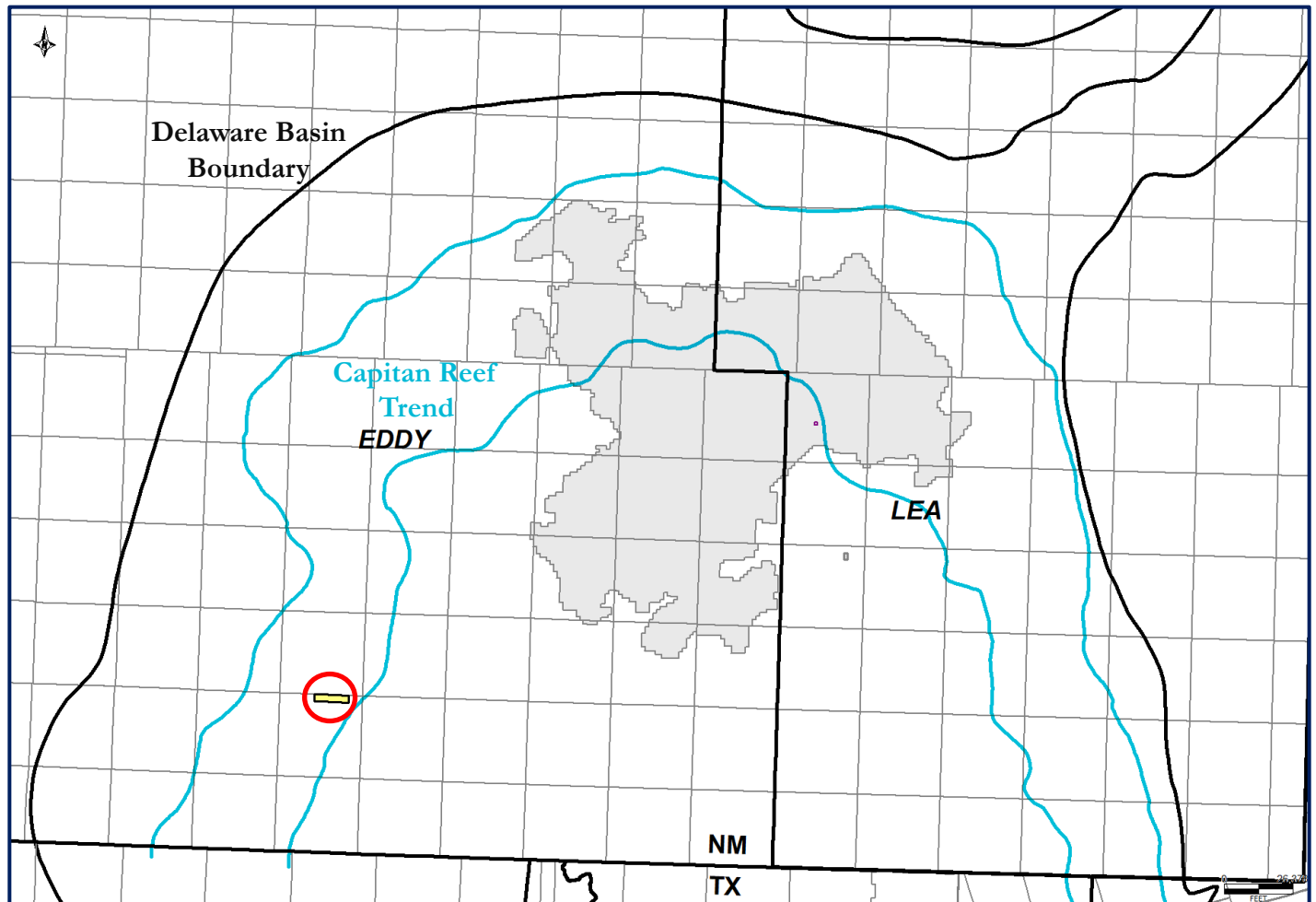

- Location of the Boudin N2 proposed pooling application area is shown inside the red circle in Eddy County, NM.

Exhibit B-3: Stratigraphic Cross-Section (Top Wolfcamp Datum)

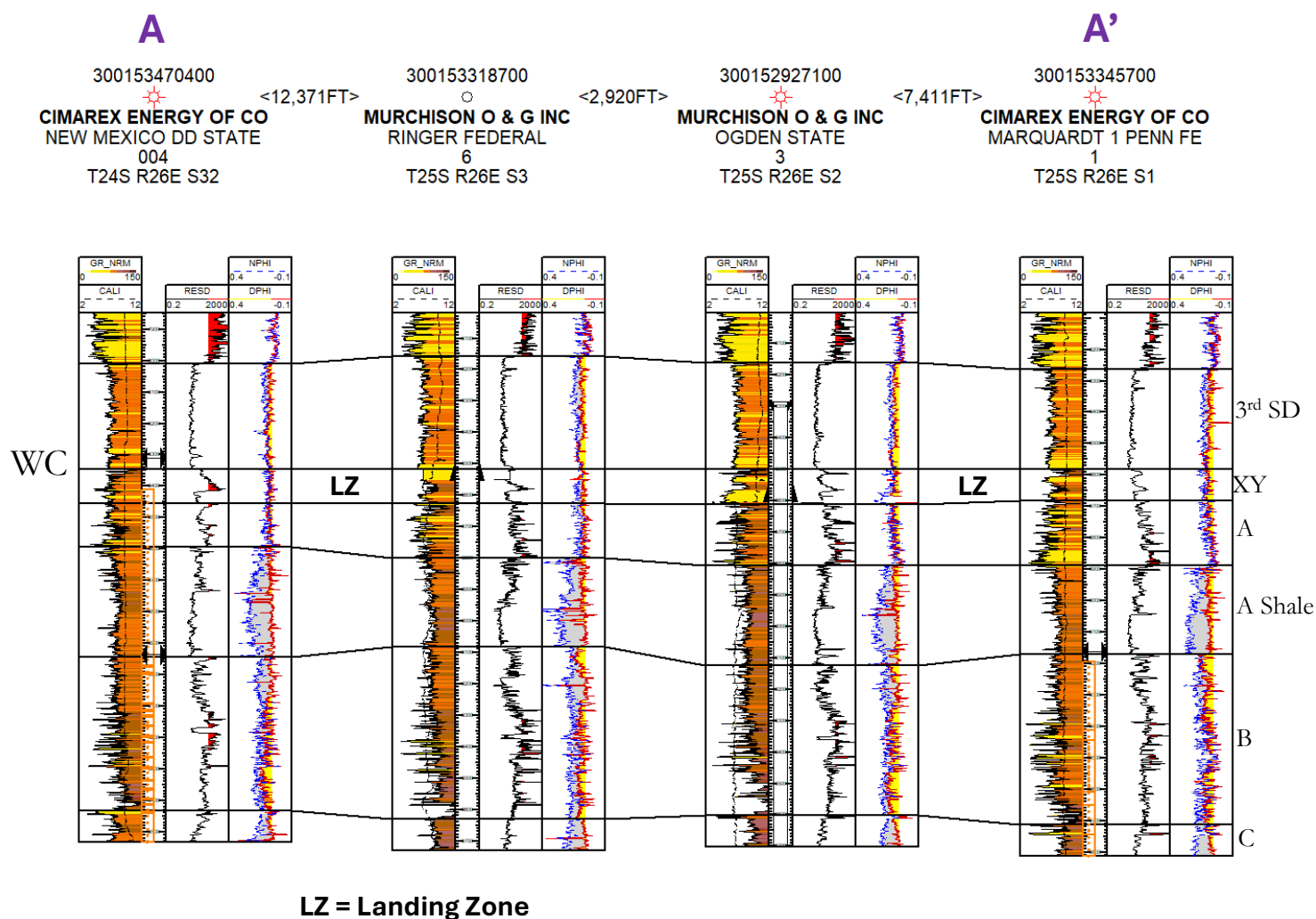

Exhibit B-4: Gun Barrel Diagram

300153318700



MURCHISON O & G INC
 RINGER FEDERAL
 6
 T25S R26E S3

- Gun barrel diagram within the Wolfcamp formation. Structural dip is to the east. Boudin well is planned to be drilled west to east, downdip.

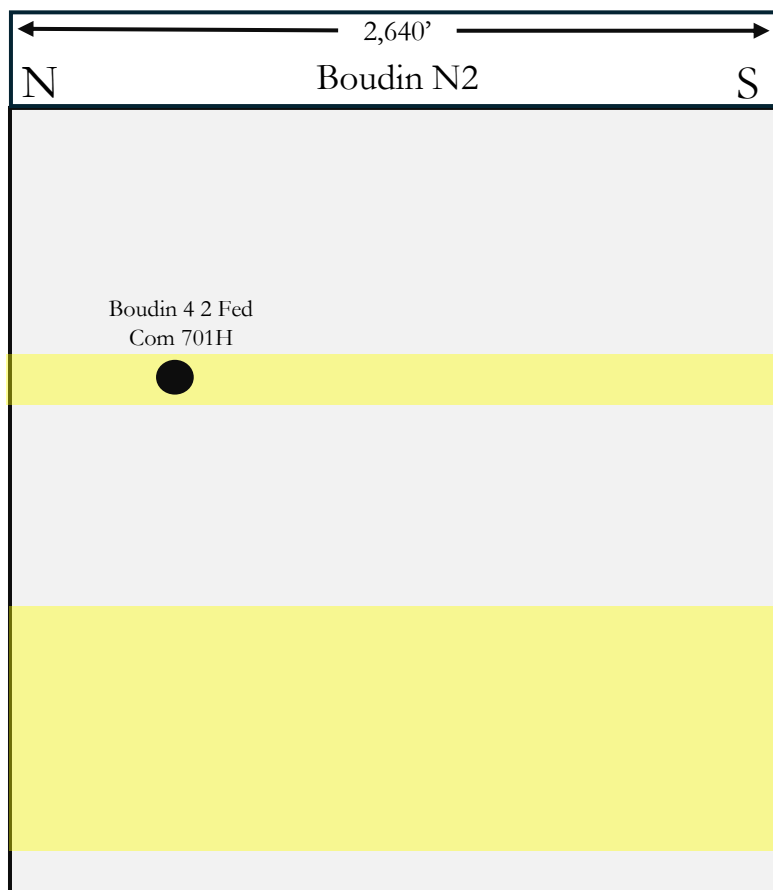
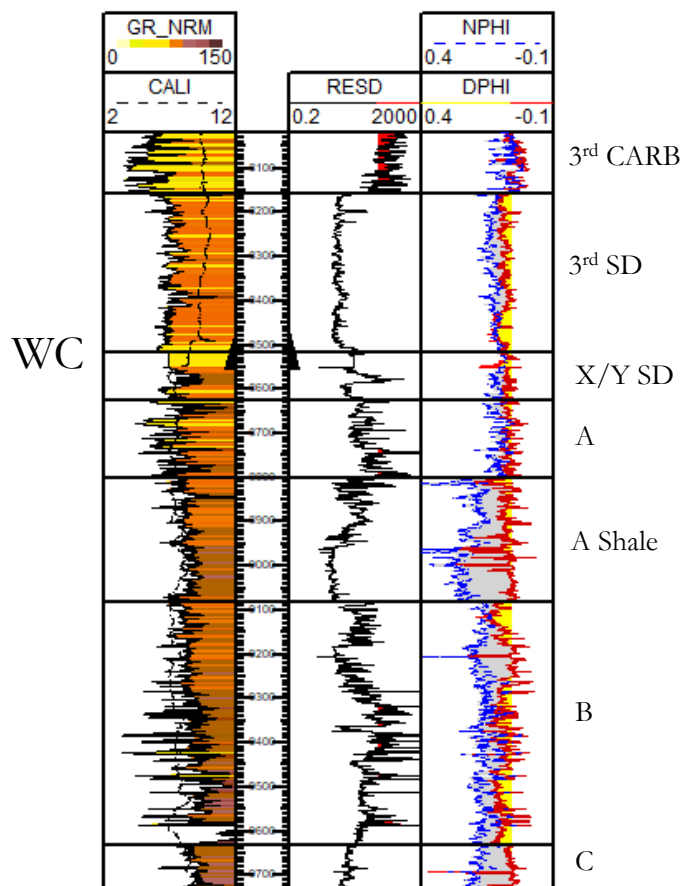

3R Operating, LLC
 Case No. 25321
 Exhibit B-4

Exhibit B-5: Gross Interval Isopach – Top Wolfcamp to Wolfcamp B

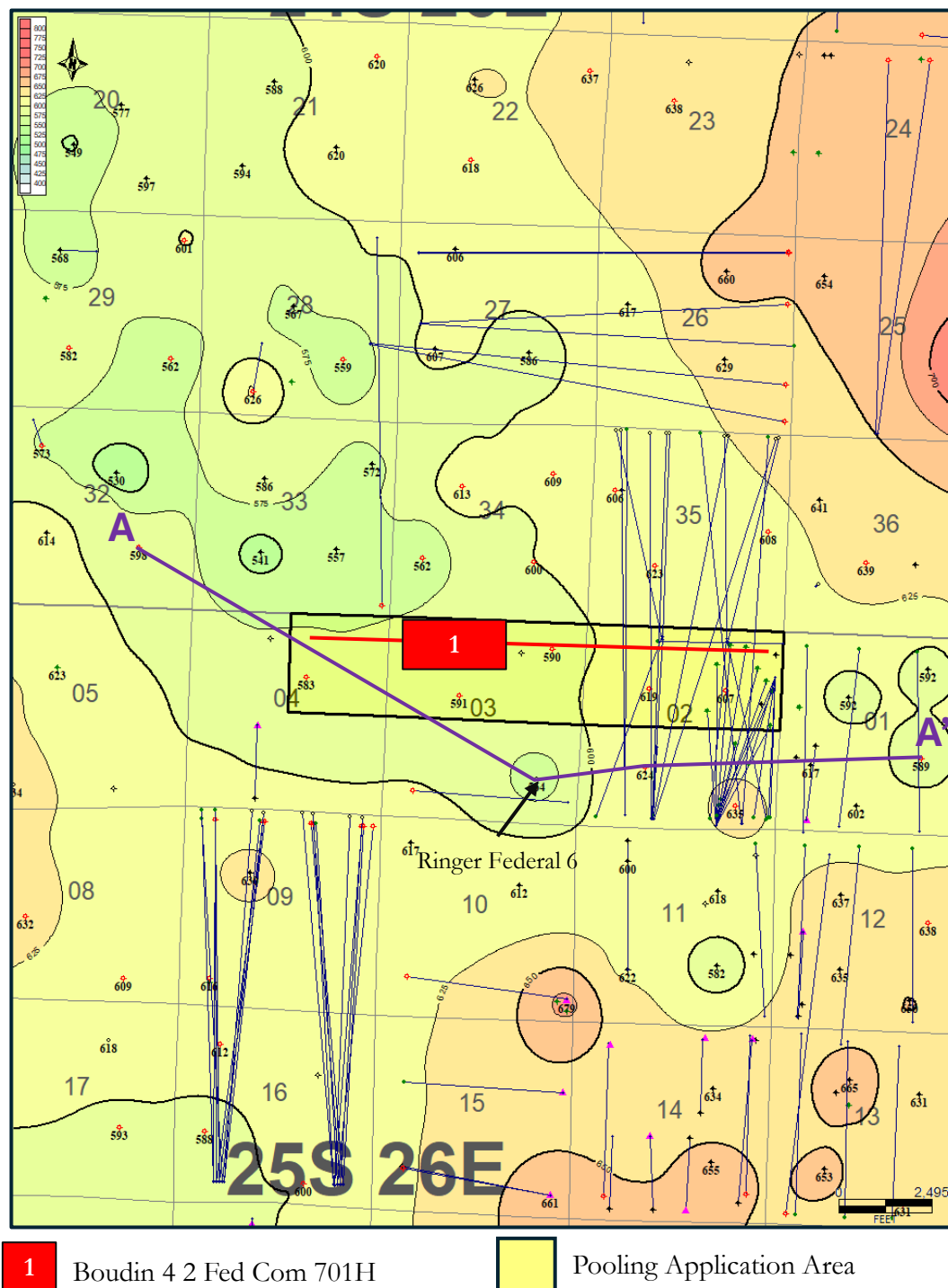

Top Wolfcamp to Wolfcamp B thickness is relatively consistent over the project area.

3R Operating, LLC
Case No. 25321
Exhibit B-5

**STATE OF NEW MEXICO
DEPARTMENT OF ENERGY, MINERALS AND NATURAL RESOURCES
OIL CONSERVATION DIVISION**

**APPLICATION OF 3R OPERATING, LLC
FOR COMPULSORY POOLING,
EDDY COUNTY, NEW MEXICO.**

CASE NO. 25321

**SELF-AFFIRMED STATEMENT
OF JACLYN M. MCLEAN**

1. I am attorney in fact and authorized representative of 3R Operating, LLC (“3R”) the Applicant herein.
2. I am familiar with the Notice Letter attached as **Exhibit C-1**, and caused the Notice Letter, along with the Applications in these cases, to be sent to the parties listed in the Postal Delivery Report attached as **Exhibit C-2**.
3. Exhibit C-2 also provides the date the Notice Letter was sent, along with the delivery status of each.
4. Electronic return receipts are attached as **Exhibit C-3** as supporting documentation for proof of mailing and the information provided on Exhibit C-2.
5. On April 15, 2025, I caused a notice to be published in the Carlsbad Current-Argus. An Affidavit of Publication from the legal clerk of the Carlsbad Current-Argus along with a copy of the Notice Publication, is attached as **Exhibit C-4**.
6. I understand this Self-Affirmed Statement will be used as written testimony in the subject case. I affirm that my testimony above is true and correct and is made under penalty of perjury under the laws of the State of New Mexico. My testimony is made as of the date handwritten next to my signature below.

/s/Jaclyn M. McLean
Jaclyn M. McLean

August 18, 2025
Date

**3R Operating, LLC
Case No. 25321
Exhibit C**



March 19, 2025

VIA CERTIFIED MAIL
RETURN RECEIPT REQUESTED

TO: ALL INTERESTED PARTIES

**Re: Case No. 25321 – Application of 3R Operating, LLC for Compulsory Pooling,
Eddy County, New Mexico.**

To whom it may concern:

This letter is to advise you that the enclosed application was filed with the New Mexico Oil Conservation Division. The hearing will be conducted on **May 8, 2025**, beginning at 9:00 a.m.

The hearing will be conducted in a hybrid fashion, both virtually and in-person at the Energy, Minerals, Natural Resources Department, Wendell Chino Building, Pecos Hall, 1220 South St. Francis Drive, 1st Floor, Santa Fe, NM 87505. The hearing may be held only virtually at the discretion of the Division. To confirm the manner in which the hearing will be held, and to participate virtually, please visit the OCD Hearings website at the following link: <https://www.emnrd.nm.gov/oed/hearing-info/>. You are not required to attend this hearing, but as an owner of an interest that may be affected by this application, you may appear and present testimony. Failure to appear at that time and become a party of record will preclude you from challenging the matter at a later date.

Pursuant to Division Rule 19.15.4.13.B, a party who intends to present evidence at the hearing shall file a pre-hearing statement and serve copies on other parties, or the attorneys of parties who are represented by counsel, at least four business days prior to the scheduled hearing, but in no event later than 5:00 p.m. Mountain Time, on the Thursday preceding the scheduled hearing date. If you are not registered with the OCD's E-Permitting system, you must submit the statement via e-mail to ocd.hearings@emnrd.nm.gov and should include: the names of the parties; whether or not the parties are represented by counsel; a concise statement of the case; the names of witnesses anticipated to be called to testify at the hearing; the approximate amount of time needed to present the case; and an identification of any procedural matters that are to be resolved prior to the hearing.

If you have any questions about this application, please contact Brian Van Staveren, Land Advisor for 3R Operating, LLC at bvanstaveren@3ROperating.com.

125 Lincoln Avenue, Suite 223
Santa Fe, NM 87501
505-230-4410

HardyMcClean.com

Writer:
Jaclyn M. McLean
Managing Partner
jmclean@hardymcClean.com

3R Operating, LLC
Case No. 25321
Exhibit C-1

Hardy McLean LLC
March 19, 2025

Page 2

Sincerely,
/s/ Jaclyn M. McLean
Jaclyn M. McLean

Postal Delivery Report

3R Boudin - Case No. 25321

Recipient	Date Mailed	USPS Tracking Number	Date Received	Status
Alan Jochimsen	3/19/2025	9414836208551279992727	3/24/2025	Delivered, Left with Individual
1B4S Enterprises, LLC	3/19/2025	9414836208551279992741	3/28/2025	Delivered, Left with Individual
AmericaWest Resources, LLC	3/19/2025	9414836208551279992710	4/30/2025	Delivered, PO Box MIDLAND, TX 79701
AmeriPermian Holdings, LLC	3/19/2025	9414836208551279992734	3/24/2025	Delivered, Left with Individual SPRING, TX 77380
Diana K. Hammonds	3/19/2025	9414836208551279992765	3/24/2025	Delivered, Left with Individual
Clyde R. Wilson, Trustee	3/19/2025	9414836208551279992772	3/27/2025	Delivered, Left with Individual
E.L. Latham Minerals, LLC	3/19/2025	9414836208551279992796	3/24/2025	Delivered, PO Box FORT WORTH, TX 76109
Chevron USA, Inc.	3/19/2025	9414836208551279992789	3/25/2025	Delivered to Agent, Picked up at USPS

3R Operating, LLC
Case No. 25321
Exhibit C-2

Hatch Royalty, LLC	3/19/2025	9414836208551279992802	3/24/2025	Delivered, Front Desk/Reception/Mail Room
Elk Range Royaltys II, LP	3/19/2025	9414836208551279992819	3/25/2025	Delivered, Left with Individual
Janet Tidwell Revocable Trust	3/19/2025	9414836208551279992826		
Karemont Properties, LLC	3/19/2025	9414836208551279992833	3/27/2025	Delivered, Individual Picked Up at Post Office MIDLAND, TX 79707
Kelly Lohman	3/19/2025	9414836208551279992840	3/24/2025	Delivered, Left with Individual
MEC Petroleum Corp.	3/19/2025	9414836208551279992857	4/30/2025	Delivered, Individual Picked Up at Postal Facility MIDLAND, TX 79701
Mumford & Company	3/19/2025	9414836208551279992871	3/24/2025	Delivered, Individual Picked Up at Post Office ALBUQUERQUE, NM 87111
Pearson-Sibert Oil Company of Texas	3/19/2025	9414836208551279992864		In Transit to Next Facility, Arriving Late

MRC Permian Company	3/19/2025	9414836208551279992901		In Transit to Next Facility, Arriving Late
Magnum Hunter Production, Inc.	3/19/2025	9414836208551279992895	3/24/2025	Delivered, Front Desk/Reception/Mail Room
Silverspur Resources, LLC	3/19/2025	9414836208551279992925	3/24/2025	Delivered, PO Box
Nancy B. Parks	3/19/2025	9414836208551279992918	5/10/2025	Delivered, To Original Sender SANTA FE, NM 87501
Source Energy Permian II, LLC	3/19/2025	9414836208551279992932	3/25/2025	Delivered, Front Desk/Reception/Mail Room
Springbok Energy Partners II, LLC	3/19/2025	9414836208551279992949	4/16/2025	Delivered, To Original Sender SANTA FE, NM 87501
United States of America - BLM	3/19/2025	9414836208551279992963	3/24/2025	Delivered, Front Desk/Reception/Mail Room
States Royalty, LP	3/19/2025	9414836208551279992956	3/24/2025	Delivered, Individual Picked Up at Post Office

State of New Mexico	3/19/2025	9414836208551279992987	3/26/2025	Delivered, Individual Picked Up at Postal Facility
Speyside Resources, LLC	3/19/2025	9414836208551279992970	4/30/2025	Delivered, Individual Picked Up at Postal Facility MIDLAND, TX 79701
V.J. Callaway and Bonnie Callaway	3/19/2025	9414836208551279992994	4/1/2025	Delivered, Left with Individual SANTA FE, NM 87501
Suncrest Resources, LLC	3/19/2025	9414836208551279993007	4/1/2025	Delivered, Individual Picked Up at Postal Facility
W.R. Eriksen and Wanda Eriksen	3/19/2025	9414836208551279993014		In Transit to Next Facility, Arriving Late
WPX Energy Permian, LLC	3/19/2025	9414836208551279993021	3/24/2025	Delivered, Individual Picked Up at Postal Facility
Wing Resources IV, LLC	3/19/2025	9414836208551279993038	3/24/2025	Delivered, Left with Individual



March 24, 2025

Dear Simple Certified:

The following is in response to your request for proof of delivery on your item with the tracking number:
9414 8362 0855 1279 9927 27.

Item Details

Status:	Delivered, Left with Individual
Status Date / Time:	March 24, 2025, 1:48 pm
Location:	MIDLAND, TX 79707
Postal Product:	First-Class Mail®
Extra Services:	Certified Mail™
	Return Receipt Electronic

Recipient Signature

Signature of Recipient:

Address of Recipient:

Note: Scanned image may reflect a different destination address due to Intended Recipient's delivery instructions on file.

Thank you for selecting the United States Postal Service® for your mailing needs. If you require additional assistance, please contact your local Post Office™ or a Postal representative at 1-800-222-1811.

Sincerely,
United States Postal Service®
475 L'Enfant Plaza SW
Washington, D.C. 20260-0004

Alan Jochimsen
4209 Cardinal Lane
Midland, TX 79707
Reference #: 3R Boudin
Item ID: 3R Boudin

3R Operating, LLC
Case No. 25321
Exhibit C-3



March 28, 2025

Dear Simple Certified:

The following is in response to your request for proof of delivery on your item with the tracking number:
9414 8362 0855 1279 9927 41.

Item Details

Status:	Delivered, Left with Individual
Status Date / Time:	March 28, 2025, 2:48 pm
Location:	AMARILLO, TX 79109
Postal Product:	First-Class Mail®
Extra Services:	Certified Mail™
	Return Receipt Electronic

Recipient Signature

Signature of Recipient:

Address of Recipient:

3203 BOWIE ST, AMARILLO,
TX 79109

Note: Scanned image may reflect a different destination address due to Intended Recipient's delivery instructions on file.

Thank you for selecting the United States Postal Service® for your mailing needs. If you require additional assistance, please contact your local Post Office™ or a Postal representative at 1-800-222-1811.

Sincerely,
United States Postal Service®
475 L'Enfant Plaza SW
Washington, D.C. 20260-0004

1B4S Enterprises, LLC
3203 Bowie Street
Amarillo, TX 79109
Reference #: 3R Boudin
Item ID: 3R Boudin



April 30, 2025

Dear Simple Certified:

The following is in response to your request for proof of delivery on your item with the tracking number:
9414 8362 0855 1279 9927 10.

Item Details

Status:	Delivered, PO Box
Status Date / Time:	April 30, 2025, 11:28 am
Location:	MIDLAND, TX 79701
Postal Product:	First-Class Mail®
Extra Services:	Certified Mail™
	Return Receipt Electronic

Recipient Signature

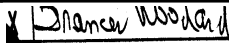
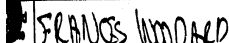
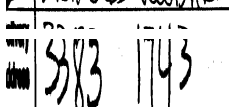
Signature of Recipient:	 
Address of Recipient:	

Note: Scanned image may reflect a different destination address due to Intended Recipient's delivery instructions on file.

Thank you for selecting the United States Postal Service® for your mailing needs. If you require additional assistance, please contact your local Post Office™ or a Postal representative at 1-800-222-1811.

Sincerely,
United States Postal Service®
475 L'Enfant Plaza SW
Washington, D.C. 20260-0004

AmericaWest Resources, LLC
P.O. Box 3383
Midland, TX 79702
Reference #: 3R Boudin
Item ID: 3R Boudin



March 24, 2025

Dear Simple Certified:

The following is in response to your request for proof of delivery on your item with the tracking number:
9414 8362 0855 1279 9927 34.

Item Details

Status:	Delivered, Left with Individual
Status Date / Time:	March 24, 2025, 12:02 pm
Location:	SPRING, TX 77380
Postal Product:	First-Class Mail®
Extra Services:	Certified Mail™
	Return Receipt Electronic

Recipient Signature

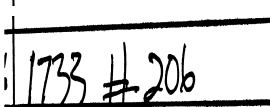
Signature of Recipient:	
Address of Recipient:	

Note: Scanned image may reflect a different destination address due to Intended Recipient's delivery instructions on file.

Thank you for selecting the United States Postal Service® for your mailing needs. If you require additional assistance, please contact your local Post Office™ or a Postal representative at 1-800-222-1811.

Sincerely,
United States Postal Service®
475 L'Enfant Plaza SW
Washington, D.C. 20260-0004

AmeriPermian Holdings, LLC
1733 Woodstead Court
Suite 206
The Woodlands, TX 77380
Reference #: 3R Boudin
Item ID: 3R Boudin



March 24, 2025

Dear Simple Certified:

The following is in response to your request for proof of delivery on your item with the tracking number:
9414 8362 0855 1279 9927 65.

Item Details

Status:	Delivered, Left with Individual
Status Date / Time:	March 24, 2025, 3:08 pm
Location:	NEW BOSTON, TX 75570
Postal Product:	First-Class Mail®
Extra Services:	Certified Mail™
	Return Receipt Electronic

Recipient Signature

Signature of Recipient:

Address of Recipient:

Note: Scanned image may reflect a different destination address due to Intended Recipient's delivery instructions on file.

Thank you for selecting the United States Postal Service® for your mailing needs. If you require additional assistance, please contact your local Post Office™ or a Postal representative at 1-800-222-1811.

Sincerely,
United States Postal Service®
475 L'Enfant Plaza SW
Washington, D.C. 20260-0004

Diana K. Hammonds
108 Sharlotte
New Boston, TX 75570
Reference #: 3R Boudin
Item ID: 3R Boudin



March 27, 2025

Dear Simple Certified:

The following is in response to your request for proof of delivery on your item with the tracking number:
9414 8362 0855 1279 9927 72.

Item Details

Status:	Delivered, Left with Individual
Status Date / Time:	March 27, 2025, 10:58 am
Location:	LUBBOCK, TX 79423
Postal Product:	First-Class Mail®
Extra Services:	Certified Mail™
	Return Receipt Electronic

Recipient Signature

Signature of Recipient:

Belinda
Belinda Rodriguez

Address of Recipient:

4203 106th

Note: Scanned image may reflect a different destination address due to Intended Recipient's delivery instructions on file.

Thank you for selecting the United States Postal Service® for your mailing needs. If you require additional assistance, please contact your local Post Office™ or a Postal representative at 1-800-222-1811.

Sincerely,
United States Postal Service®
475 L'Enfant Plaza SW
Washington, D.C. 20260-0004

Clyde R. Wilson, Trustee
4203 106th Street
Lubbock, TX 79423
Reference #: 3R Boudin
Item ID: 3R Boudin



March 24, 2025

Dear Simple Certified:

The following is in response to your request for proof of delivery on your item with the tracking number:
9414 8362 0855 1279 9927 96.

Item Details

Status:	Delivered, PO Box
Status Date / Time:	March 24, 2025, 1:40 pm
Location:	FORT WORTH, TX 76109
Postal Product:	First-Class Mail®
Extra Services:	Certified Mail™
	Return Receipt Electronic

Recipient Signature

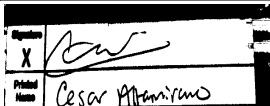
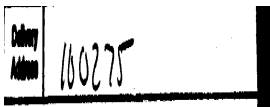
Signature of Recipient:	
Address of Recipient:	

Note: Scanned image may reflect a different destination address due to Intended Recipient's delivery instructions on file.

Thank you for selecting the United States Postal Service® for your mailing needs. If you require additional assistance, please contact your local Post Office™ or a Postal representative at 1-800-222-1811.

Sincerely,
United States Postal Service®
475 L'Enfant Plaza SW
Washington, D.C. 20260-0004

E.L. Latham Minerals, LLC
P.O. Box 100912
Fort Worth, TX 76107
Reference #: 3R Boudin
Item ID: 3R Boudin



March 25, 2025

Dear Simple Certified:

The following is in response to your request for proof of delivery on your item with the tracking number:
9414 8362 0855 1279 9927 89.

Item Details

Status:	Delivered to Agent, Picked up at USPS
Status Date / Time:	March 25, 2025, 1:00 pm
Location:	HOUSTON, TX 77002
Postal Product:	First-Class Mail®
Extra Services:	Certified Mail™
	Return Receipt Electronic

Recipient Signature

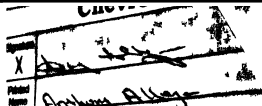
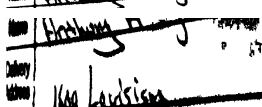
Signature of Recipient: (Authorized Agent)	
Address of Recipient:	

Note: Scanned image may reflect a different destination address due to Intended Recipient's delivery instructions on file.

Thank you for selecting the United States Postal Service® for your mailing needs. If you require additional assistance, please contact your local Post Office™ or a Postal representative at 1-800-222-1811.

Sincerely,
United States Postal Service®
475 L'Enfant Plaza SW
Washington, D.C. 20260-0004

Chevron USA, Inc.
1400 Smith Street
Houston, TX 77002
Reference #: 3R Boudin
Item ID: 3R Boudin



March 24, 2025

Dear Simple Certified:

The following is in response to your request for proof of delivery on your item with the tracking number:
9414 8362 0855 1279 9928 02.

Item Details

Status:	Delivered, Front Desk/Reception/Mail Room
Status Date / Time:	March 24, 2025, 1:22 pm
Location:	AUSTIN, TX 78701
Postal Product:	First-Class Mail®
Extra Services:	Certified Mail™
	Return Receipt Electronic

Recipient Signature

Signature of Recipient:

Address of Recipient:

Note: Scanned image may reflect a different destination address due to Intended Recipient's delivery instructions on file.

Thank you for selecting the United States Postal Service® for your mailing needs. If you require additional assistance, please contact your local Post Office™ or a Postal representative at 1-800-222-1811.

Sincerely,
United States Postal Service®
475 L'Enfant Plaza SW
Washington, D.C. 20260-0004

Hatch Royalty, LLC
600 W. 5th Street
Suite 1250
Austin, TX 78701
Reference #: 3R Boudin
Item ID: 3R Boudin



March 25, 2025

Dear Simple Certified:

The following is in response to your request for proof of delivery on your item with the tracking number:
9414 8362 0855 1279 9928 19.

Item Details

Status:	Delivered, Left with Individual
Status Date / Time:	March 25, 2025, 1:02 pm
Location:	DALLAS, TX 75207
Postal Product:	First-Class Mail®
Extra Services:	Certified Mail™
	Return Receipt Electronic

Recipient Signature

Signature of Recipient:

Address of Recipient:

Note: Scanned image may reflect a different destination address due to Intended Recipient's delivery instructions on file.

Thank you for selecting the United States Postal Service® for your mailing needs. If you require additional assistance, please contact your local Post Office™ or a Postal representative at 1-800-222-1811.

Sincerely,
United States Postal Service®
475 L'Enfant Plaza SW
Washington, D.C. 20260-0004

Elk Range Royaltys II, LP
2110 Farrington Street
Dallas, TX 75207
Reference #: 3R Boudin
Item ID: 3R Boudin



March 27, 2025

Dear Simple Certified:

The following is in response to your request for proof of delivery on your item with the tracking number:
9414 8362 0855 1279 9928 33.

Item Details

Status:	Delivered, Individual Picked Up at Post Office
Status Date / Time:	March 27, 2025, 3:19 pm
Location:	MIDLAND, TX 79707
Postal Product:	First-Class Mail®
Extra Services:	Certified Mail™
	Return Receipt Electronic

Recipient Signature

Signature of Recipient:

n - m cny
M, + 426-2

Address of Recipient:

1 Box 9451

Note: Scanned image may reflect a different destination address due to Intended Recipient's delivery instructions on file.

Thank you for selecting the United States Postal Service® for your mailing needs. If you require additional assistance, please contact your local Post Office™ or a Postal representative at 1-800-222-1811.

Sincerely,
United States Postal Service®
475 L'Enfant Plaza SW
Washington, D.C. 20260-0004

Karemont Properties, LLC
P.O. Box 9451
Midland, TX 79708
Reference #: 3R Boudin
Item ID: 3R Boudin



March 24, 2025



Dear Simple Certified:

The following is in response to your request for proof of delivery on your item with the tracking number:
9414 8362 0855 1279 9928 40.

Item Details

Status:	Delivered, Left with Individual
Status Date / Time:	March 24, 2025, 1:11 pm
Location:	TALKING ROCK, GA 30175
Postal Product:	First-Class Mail®
Extra Services:	Certified Mail™
	Return Receipt Electronic

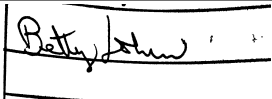
Recipient Signature

Signature of Recipient:	
Address of Recipient:	

Note: Scanned image may reflect a different destination address due to Intended Recipient's delivery instructions on file.

Thank you for selecting the United States Postal Service® for your mailing needs. If you require additional assistance, please contact your local Post Office™ or a Postal representative at 1-800-222-1811.

Sincerely,
United States Postal Service®
475 L'Enfant Plaza SW
Washington, D.C. 20260-0004

Kelly Lohman
60 Arbor Hill Place
Talking Rock, GA 30175
Reference #: 3R Boudin
Item ID: 3R Boudin



April 30, 2025

Dear Simple Certified:

The following is in response to your request for proof of delivery on your item with the tracking number:
9414 8362 0855 1279 9928 57.

Item Details

Status:	Delivered, Individual Picked Up at Postal Facility
Status Date / Time:	April 30, 2025, 9:27 am
Location:	MIDLAND, TX 79701
Postal Product:	First-Class Mail®
Extra Services:	Certified Mail™
	Return Receipt Electronic

Recipient Signature

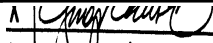
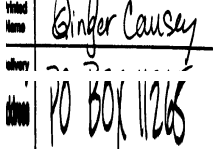
Signature of Recipient:	
Address of Recipient:	

Note: Scanned image may reflect a different destination address due to Intended Recipient's delivery instructions on file.

Thank you for selecting the United States Postal Service® for your mailing needs. If you require additional assistance, please contact your local Post Office™ or a Postal representative at 1-800-222-1811.

Sincerely,
United States Postal Service®
475 L'Enfant Plaza SW
Washington, D.C. 20260-0004

MEC Petroleum Corp.
P.O. Box 11265
Midland, TX 79702
Reference #: 3R Boudin
Item ID: 3R Boudin



March 24, 2025

Dear Simple Certified:

The following is in response to your request for proof of delivery on your item with the tracking number:
9414 8362 0855 1279 9928 71.

Item Details

Status:	Delivered, Individual Picked Up at Post Office
Status Date / Time:	March 24, 2025, 12:32 pm
Location:	ALBUQUERQUE, NM 87111
Postal Product:	First-Class Mail®
Extra Services:	Certified Mail™
	Return Receipt Electronic

Recipient Signature

Signature of Recipient:

Address of Recipient:

11601 WOODMAR LN N
ALBUQUERQUE, NM 87111-0518

Note: Scanned image may reflect a different destination address due to Intended Recipient's delivery instructions on file.

Thank you for selecting the United States Postal Service® for your mailing needs. If you require additional assistance, please contact your local Post Office™ or a Postal representative at 1-800-222-1811.

Sincerely,
United States Postal Service®
475 L'Enfant Plaza SW
Washington, D.C. 20260-0004

Mumford & Company
11601 Woodmar Lane NE
Albuquerque, NM 87111
Reference #: 3R Boudin
Item ID: 3R Boudin



March 24, 2025

Dear Simple Certified:

The following is in response to your request for proof of delivery on your item with the tracking number:
9414 8362 0855 1279 9928 95.

Item Details

Status:	Delivered, Front Desk/Reception/Mail Room
Status Date / Time:	March 24, 2025, 3:09 pm
Location:	MIDLAND, TX 79706
Postal Product:	First-Class Mail®
Extra Services:	Certified Mail™
	Return Receipt Electronic

Recipient Signature

Signature of Recipient:

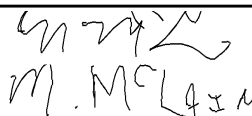

Address of Recipient:

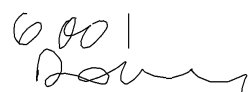

Note: Scanned image may reflect a different destination address due to Intended Recipient's delivery instructions on file.

Thank you for selecting the United States Postal Service® for your mailing needs. If you require additional assistance, please contact your local Post Office™ or a Postal representative at 1-800-222-1811.

Sincerely,
United States Postal Service®
475 L'Enfant Plaza SW
Washington, D.C. 20260-0004

Magnum Hunter Production, Inc.
6001 Deauville Boulevard
Suite N3 047
Midland, TX 79706
Reference #: 3R Boudin
Item ID: 3R Boudin



March 24, 2025

Dear Simple Certified:

The following is in response to your request for proof of delivery on your item with the tracking number:
9414 8362 0855 1279 9929 25.

Item Details

Status:	Delivered, PO Box
Status Date / Time:	March 24, 2025, 11:39 am
Location:	SOUTHLAKE, TX 76092
Postal Product:	First-Class Mail®
Extra Services:	Certified Mail™
	Return Receipt Electronic

Recipient Signature

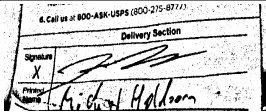
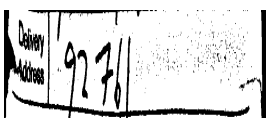
Signature of Recipient:	
Address of Recipient:	

Note: Scanned image may reflect a different destination address due to Intended Recipient's delivery instructions on file.

Thank you for selecting the United States Postal Service® for your mailing needs. If you require additional assistance, please contact your local Post Office™ or a Postal representative at 1-800-222-1811.

Sincerely,
United States Postal Service®
475 L'Enfant Plaza SW
Washington, D.C. 20260-0004

Silverspur Resources, LLC
P.O. Box 92761
Southlake, TX 76092
Reference #: 3R Boudin
Item ID: 3R Boudin



May 10, 2025

Dear Simple Certified:

The following is in response to your request for proof of delivery on your item with the tracking number:
9414 8362 0855 1279 9929 18.

Item Details

Status:	Delivered, To Original Sender
Status Date / Time:	May 10, 2025, 9:43 am
Location:	SANTA FE, NM 87501
Postal Product:	First-Class Mail®
Extra Services:	Certified Mail™
	Return Receipt Electronic

Recipient Signature

Signature of Recipient:

Address of Recipient:

125 LINCOLN AVE STE 223,
SANTA FE, NM 87501

Note: Scanned image may reflect a different destination address due to Intended Recipient's delivery instructions on file.

Thank you for selecting the United States Postal Service® for your mailing needs. If you require additional assistance, please contact your local Post Office™ or a Postal representative at 1-800-222-1811.

Sincerely,
United States Postal Service®
475 L'Enfant Plaza SW
Washington, D.C. 20260-0004

Nancy B. Parks
9241 Elm Tree Circle
Tyler, TX 75703
Reference #: 3R Boudin
Item ID: 3R Boudin



March 25, 2025



Dear Simple Certified:

The following is in response to your request for proof of delivery on your item with the tracking number:
9414 8362 0855 1279 9929 32.

Item Details

Status:	Delivered, Front Desk/Reception/Mail Room
Status Date / Time:	March 25, 2025, 12:15 pm
Location:	DALLAS, TX 75248
Postal Product:	First-Class Mail®
Extra Services:	Certified Mail™
	Return Receipt Electronic

Recipient Signature

Signature of Recipient:	
Address of Recipient:	

Note: Scanned image may reflect a different destination address due to Intended Recipient's delivery instructions on file.

Thank you for selecting the United States Postal Service® for your mailing needs. If you require additional assistance, please contact your local Post Office™ or a Postal representative at 1-800-222-1811.

Sincerely,
United States Postal Service®
475 L'Enfant Plaza SW
Washington, D.C. 20260-0004

Source Energy Permian II, LLC
16400 Dallas Parkway
Suite 400
Dallas, TX 75248
Reference #: 3R Boudin
Item ID: 3R Boudin



April 16, 2025

Dear Simple Certified:

The following is in response to your request for proof of delivery on your item with the tracking number:
9414 8362 0855 1279 9929 49.

Item Details

Status:	Delivered, To Original Sender
Status Date / Time:	April 16, 2025, 9:46 am
Location:	SANTA FE, NM 87501
Postal Product:	First-Class Mail®
Extra Services:	Certified Mail™
	Return Receipt Electronic

Recipient Signature

Signature of Recipient:

Address of Recipient:

125 LINCOLN AVE STE 223,
SANTA FE, NM 87501

Note: Scanned image may reflect a different destination address due to Intended Recipient's delivery instructions on file.

Thank you for selecting the United States Postal Service® for your mailing needs. If you require additional assistance, please contact your local Post Office™ or a Postal representative at 1-800-222-1811.

Sincerely,
United States Postal Service®
475 L'Enfant Plaza SW
Washington, D.C. 20260-0004

Springbok Energy Partners II, LLC
5950 Berkshire Lane
Suite 1250
Dallas, TX 75225
Reference #: 3R Boudin
Item ID: 3R Boudin



March 24, 2025

Dear Simple Certified:

The following is in response to your request for proof of delivery on your item with the tracking number:
9414 8362 0855 1279 9929 63.

Item Details

Status:	Delivered, Front Desk/Reception/Mail Room
Status Date / Time:	March 24, 2025, 12:25 pm
Location:	SANTA FE, NM 87508
Postal Product:	First-Class Mail®
Extra Services:	Certified Mail™
	Return Receipt Electronic

Recipient Signature

Signature of Recipient:

Address of Recipient:

Note: Scanned image may reflect a different destination address due to Intended Recipient's delivery instructions on file.

Thank you for selecting the United States Postal Service® for your mailing needs. If you require additional assistance, please contact your local Post Office™ or a Postal representative at 1-800-222-1811.

Sincerely,
United States Postal Service®
475 L'Enfant Plaza SW
Washington, D.C. 20260-0004

United States of America - BLM
307 Disosaur Trl
Santa Fe, NM 87508
Reference #: 3R Boudin
Item ID: 3R Boudin



March 24, 2025

Dear Simple Certified:

The following is in response to your request for proof of delivery on your item with the tracking number:
9414 8362 0855 1279 9929 56.

Item Details

Status:	Delivered, Individual Picked Up at Post Office
Status Date / Time:	March 24, 2025, 9:45 am
Location:	BRECKENRIDGE, TX 76424
Postal Product:	First-Class Mail®
Extra Services:	Certified Mail™
	Return Receipt Electronic

Recipient Signature

Signature of Recipient:

Christine Spivey
Christine Spivey

Address of Recipient:

PO Box 911

Note: Scanned image may reflect a different destination address due to Intended Recipient's delivery instructions on file.

Thank you for selecting the United States Postal Service® for your mailing needs. If you require additional assistance, please contact your local Post Office™ or a Postal representative at 1-800-222-1811.

Sincerely,
United States Postal Service®
475 L'Enfant Plaza SW
Washington, D.C. 20260-0004

States Royalty, LP
300 N. Breckenridge Avenue
Breckenridge, TX 76424
Reference #: 3R Boudin
Item ID: 3R Boudin



March 26, 2025



Dear Simple Certified:

The following is in response to your request for proof of delivery on your item with the tracking number:
9414 8362 0855 1279 9929 87.

Item Details

Status:	Delivered, Individual Picked Up at Postal Facility
Status Date / Time:	March 26, 2025, 7:49 am
Location:	SANTA FE, NM 87501
Postal Product:	First-Class Mail®
Extra Services:	Certified Mail™
	Return Receipt Electronic

Recipient Signature

Signature of Recipient:	<table><tbody><tr><td>Signature</td><td>X</td><td></td></tr><tr><td>Printed Name</td><td></td><td>Marcus A. Bavela</td></tr></tbody></table>	Signature	X		Printed Name		Marcus A. Bavela
Signature	X						
Printed Name		Marcus A. Bavela					
Address of Recipient:	<table><tbody><tr><td>Delivery Address</td><td></td><td>1148</td></tr></tbody></table>	Delivery Address		1148			
Delivery Address		1148					

Note: Scanned image may reflect a different destination address due to Intended Recipient's delivery instructions on file.

Thank you for selecting the United States Postal Service® for your mailing needs. If you require additional assistance, please contact your local Post Office™ or a Postal representative at 1-800-222-1811.

Sincerely,
United States Postal Service®
475 L'Enfant Plaza SW
Washington, D.C. 20260-0004

State of New Mexico
310 Old Santa Fe Trail
Santa Fe, NM 87501
Reference #: 3R Boudin
Item ID: 3R Boudin



April 30, 2025

Dear Simple Certified:

The following is in response to your request for proof of delivery on your item with the tracking number:
9414 8362 0855 1279 9929 70.

Item Details

Status:	Delivered, Individual Picked Up at Postal Facility
Status Date / Time:	April 30, 2025, 1:14 pm
Location:	MIDLAND, TX 79701
Postal Product:	First-Class Mail®
Extra Services:	Certified Mail™
	Return Receipt Electronic

Recipient Signature

Signature of Recipient:	<table><tbody><tr><td>Signature</td><td></td></tr><tr><td>Printed Name</td><td>Petrus Sma. A.</td></tr></tbody></table>	Signature		Printed Name	Petrus Sma. A.
Signature					
Printed Name	Petrus Sma. A.				
Address of Recipient:	<table><tbody><tr><td>Delivery Address</td><td></td></tr></tbody></table>	Delivery Address			
Delivery Address					

Note: Scanned image may reflect a different destination address due to Intended Recipient's delivery instructions on file.

Thank you for selecting the United States Postal Service® for your mailing needs. If you require additional assistance, please contact your local Post Office™ or a Postal representative at 1-800-222-1811.

Sincerely,
United States Postal Service®
475 L'Enfant Plaza SW
Washington, D.C. 20260-0004

Speyside Resources, LLC
P.O. Box 10458
Midland, TX 79702
Reference #: 3R Boudin
Item ID: 3R Boudin



April 1, 2025

Dear Simple Certified:

The following is in response to your request for proof of delivery on your item with the tracking number:
9414 8362 0855 1279 9929 94.

Item Details

Status:	Delivered, Left with Individual
Status Date / Time:	April 1, 2025, 10:05 am
Location:	SANTA FE, NM 87501
Postal Product:	First-Class Mail®
Extra Services:	Certified Mail™
	Return Receipt Electronic

Recipient Signature

Signature of Recipient:

Address of Recipient:

125 LINCOLN AVE STE 223,
SANTA FE, NM 87501

Note: Scanned image may reflect a different destination address due to Intended Recipient's delivery instructions on file.

Thank you for selecting the United States Postal Service® for your mailing needs. If you require additional assistance, please contact your local Post Office™ or a Postal representative at 1-800-222-1811.

Sincerely,
United States Postal Service®
475 L'Enfant Plaza SW
Washington, D.C. 20260-0004

V.J. Callaway and Bonnie Callaway
1525 W. College Lane
Hobbs, NM 88242
Reference #: 3R Boudin
Item ID: 3R Boudin



April 1, 2025

Dear Simple Certified:

The following is in response to your request for proof of delivery on your item with the tracking number:
9414 8362 0855 1279 9930 07.

Item Details

Status:	Delivered, Individual Picked Up at Postal Facility
Status Date / Time:	April 1, 2025, 10:44 am
Location:	FORT WORTH, TX 76161
Postal Product:	First-Class Mail®
Extra Services:	Certified Mail™
	Return Receipt Electronic

Recipient Signature

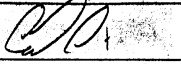
Signature of Recipient:	Signature X	
	Printed Name	
Address of Recipient:	Delivery Address	

Note: Scanned image may reflect a different destination address due to Intended Recipient's delivery instructions on file.

Thank you for selecting the United States Postal Service® for your mailing needs. If you require additional assistance, please contact your local Post Office™ or a Postal representative at 1-800-222-1811.

Sincerely,
United States Postal Service®
475 L'Enfant Plaza SW
Washington, D.C. 20260-0004

Suncrest Resources, LLC
P.O. Box 164812
Fort Worth, TX 76161
Reference #: 3R Boudin
Item ID: 3R Boudin



March 24, 2025

Dear Simple Certified:

The following is in response to your request for proof of delivery on your item with the tracking number:
9414 8362 0855 1279 9930 21.

Item Details

Status:	Delivered, Individual Picked Up at Postal Facility
Status Date / Time:	March 24, 2025, 8:53 am
Location:	OKLAHOMA CITY, OK 73102
Postal Product:	First-Class Mail®
Extra Services:	Certified Mail™
	Return Receipt Electronic

Recipient Signature

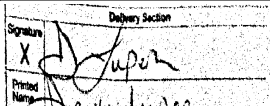
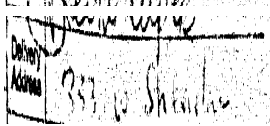
Signature of Recipient:	
Address of Recipient:	

Note: Scanned image may reflect a different destination address due to Intended Recipient's delivery instructions on file.

Thank you for selecting the United States Postal Service® for your mailing needs. If you require additional assistance, please contact your local Post Office™ or a Postal representative at 1-800-222-1811.

Sincerely,
United States Postal Service®
475 L'Enfant Plaza SW
Washington, D.C. 20260-0004

WPX Energy Permian, LLC
333 W. Sheridan Avenue
Oklahoma City, OK 73102
Reference #: 3R Boudin
Item ID: 3R Boudin



March 24, 2025

Dear Simple Certified:

The following is in response to your request for proof of delivery on your item with the tracking number:
9414 8362 0855 1279 9930 38.

Item Details

Status:	Delivered, Left with Individual
Status Date / Time:	March 24, 2025, 12:43 pm
Location:	DALLAS, TX 75201
Postal Product:	First-Class Mail®
Extra Services:	Certified Mail™
	Return Receipt Electronic

Recipient Signature

Signature of Recipient:

Address of Recipient:

Note: Scanned image may reflect a different destination address due to Intended Recipient's delivery instructions on file.

Thank you for selecting the United States Postal Service® for your mailing needs. If you require additional assistance, please contact your local Post Office™ or a Postal representative at 1-800-222-1811.

Sincerely,
United States Postal Service®
475 L'Enfant Plaza SW
Washington, D.C. 20260-0004

Wing Resources IV, LLC
2100 McKinney Avenue
Suite 1540
Dallas, TX 75201
Reference #: 3R Boudin
Item ID: 3R Boudin

AFFIDAVIT OF PUBLICATION

CARLSBAD CURRENT-ARGUS
PO BOX 507
HUTCHINSON, KS 67504-0507

STATE OF NEW MEXICO } SS
COUNTY OF EDDY }

Account Number: 1491
Ad Number: 43570
Description: 25321 3R-Boudin
Ad Cost: \$89.35

Sherry Groves, being first duly sworn, says:

That she is the Agent of the the Carlsbad Current-Argus, a Weekly newspaper of general circulation, printed and published in Carlsbad, Eddy County, New Mexico; that the publication, a copy of which is attached hereto, was published in said newspaper on the following dates:

April 15, 2025

That said newspaper was regularly issued and circulated on those dates.

SIGNED:

Sherry Groves

Agent

Subscribed to and sworn to me this 15th day of April 2025.

Leanne Kaufenberg

Leanne Kaufenberg, Notary Public, Redwood County
Minnesota

CARA DOUGLAS
HARDY MCLEAN LLC
125 LINCOLN AVE. SUITE 223
SANTA FE, NM 87501
cdouglas@hardymclean.com

This is to notify all interested parties, including; WPX Energy Permian, LLC; W.R.Eriksen and Wanda Eriksen; V.J. Callaway and Bonnie Callaway; Suncrest Resources, LLC; States Royalty, LP; Springbok Energy Partners II, LLC; Speyside Resources, LLC; Silverspur Resources, LLC; Pearson-Siebert Oil Company of Texas; Nancy B. Parks; Mumford & Company; MRC Permian Company; MEC Petroleum Corp.; Magnum Hunter Production, Inc.; Kelly Lohman; Karemont Properties, LLC; Janet Tidewell Revocable Trust; Hatch Royalty, LLC; E.L.Latham Minerals, LLC; Diana K. Hammonds; Clyde R. Wilson, Trustee; Chevron USA, Inc.; AmeriPermian Holdings, LLC; AmericaWest Resources, LLC; Alan Jochimsen; 1B4S Enterprises, LLC; Wing Resources IV, LLC; Elk Range Royalties II, LP; and their successors and assigns; that the New Mexico Oil Conservation Division will conduct a hearing on the applications submitted by 3R Operating, LLC ("Applicant") (Case No. 25321). The hearing will be conducted on May 8, 2025 in a hybrid fashion, both virtually and in person at the Energy, Minerals, Natural Resources Department, 1st Floor, Santa Fe, NM 87505. To participate virtually, see the instructions posted on the OCD website: <https://www.emnrd.nm.gov/oed/hearing-info/>. In Case No. 25321, Applicant applies for an order pooling all uncommitted interests in the Wolfcamp formation underlying an 800-acre, more or less, standard horizontal spacing unit comprised of N/2 of Sections 2 and 3 and the NE/4 of Section 4, Township 25 South, Range 26 East, Eddy County, New Mexico ("Unit"). The Unit will be dedicated to the Boudin 4 2 Fed Com 701H well ("Well"), which will be drilled from a surface hole location in the SW/4 NE/4 (Unit G) of Section 4 to a bottom hole location in the NE/4 NE/4 (Unit A) of Section 2. The completed interval of the Well will be orthodox. Also to be considered will be the cost of drilling and completing the Well and the allocation of the costs, the designation of Applicant as the operator of the Well, and a 200% charge for the risk involved in drilling and completing the Well. The Well is located approximately 7 miles East of Whites City, New Mexico.

Published in the Carlsbad Current-Argus April 15, 2025.
#43570

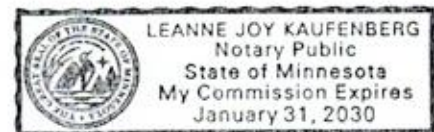

3R Operating, LLC
Case No. 25321
Exhibit C-4