

2/25/2026

**2026 PLAN OF DEVELOPMENT  
GALLEGOS CANYON UNIT  
SAN JUAN COUNTY, NEW MEXICO**

**Previous Year Operations:**

**Drilling:** SIMCOE LLC ("SIMCOE") did not drill any new wells.

**Recompletions:** SIMCOE did not recomplete any wells.

**Plug Back:** SIMCOE TA'd / Plugged back the following well completions:

Well Name/Project	API #	Legal Location (Surface)	Plugged Back Formation
GCU 303-PC: Abandon - Temporary Plug	3004524012	SENE SEC. 33, T29N, R12W	PICTURED CLIFFS
GCU 537-PC: Abandon - Temporary Plug	3004529069	NWNE SEC. 18, T29N, R12W	PICTURED CLIFFS
GCU 504-PC: Abandon - Temporary Plug	3004528155	NENW SEC. 17, T29N, R12W	PICTURED CLIFFS
GCU 389-FT: Abandon - Temporary Plug	3004528154	SWNE SEC. 21, T29N, R12W	FRUITLAND COAL
GCU 328-FS: Abandon - Permanent Plug	3004524735	SESE SEC. 33, T29N, R12W	FRUITLAND SAND

**Conversions:** SIMCOE did not convert any wells.

**Plug & Abandonment:** SIMCOE Permanently Plugged and Abandoned the following wells:

Well Name/Project	API #	Legal Location (Surface)	Plug Date
GCU 077-FS	3004508235	SWSW SEC. 18, T29N, R12W	1/15/2025
GCU COM H 180E-GP/DK	3004524869	SESE SEC. 28, T29N, R12W	2/11/2025
GCU 275-PC	3004522251	NWNW SEC. 13, T28N, R13W	5/1/2025

**Repairs and Maintenance:** SIMCOE Repaired/Maintained the following wells:

Well Name/Project	API #	Legal Location (Surface)	Producing Formation
GCU 507-PC: Tubing Repair	3004528331	NWNW SEC. 20, T29N, R12W	PICTURED CLIFFS
GCU 505-FS/PC: Rod Pump Repair - Parted Rods	3004528235	SESE SEC. 17, T29N, R12W	FRUITLAND SAND / PICTURED CLIFFS
GCU 500-PC: Tubing Repair	3004528414	NENW SEC. 13, T29N, R13W	PICTURED CLIFFS
GCU 300-PC: Rod Pump Repair	3004524009	NESE SEC. 19, T29N, R12W	PICTURED CLIFFS
GCU 331-FT/PC: Tubing Repair	3004525840	SWNW SEC. 29, T29N, R12W	FRUITLAND COAL / PICTURED CLIFFS
GCU 523-PC: Tubing Repair	3004528596	SWNW SEC. 35, T29N, R12W	PICTURED CLIFFS
GCU 417-FT: Rod Pump Repair	3004528758	NESW SEC. 19, T28N, R11W	FRUITLAND COAL
GCU 137-FT/PC: Tubing Repair	3004506965	SESE SEC. 36, T28N, R13W	FRUITLAND COAL / PICTURED CLIFFS
GCU 287-PC: Rod Pump Repair	3004523606	SWSE SEC. 35, T29N, R13W	PICTURED CLIFFS
GCU 598-CH: Wellhead Repair	3004531600	SWSW SEC. 22, T29N, R12W	CHACRA
GCU 159-FT: Tubing Repair	3004507040	SENE SEC. 31, T28N, R12W	FRUITLAND COAL
GCU 157E-MA: Rod Pump Repair	3004526398	SWNW SEC. 35, T28N, R13W	MANCOS
GCU 174E-MA/DK: Rod Pump Repair	3004525202	SWNW SEC. 28, T28N, R12W	MANCOS / DAKOTA
GCU 083E-GP: Tubing Repair	3004526011	NENW SEC. 26, T28N, R12W	GALLUP
GCU 230E-GP/DK: Rod Pump Repair	3004526010	SWSE SEC. 23, T28N, R12W	GALLUP / DAKOTA
GCU 208-GP/DK: Tubing Repair	3004511589	SENE SEC. 15, T28N, R12W	GALLUP / DAKOTA
GCU 535-PC: Rod Pump Repair	3004529034	SESE SEC. 13, T29N, R13W	PICTURED CLIFFS
GCU 527-PC: Rod Pump Repair	3004529033	SESE SEC. 27, T29N, R12W	PICTURED CLIFFS
GCU 237-PC: Rod Pump Repair	3004511713	SESE SEC. 13, T28N, R13W	PICTURED CLIFFS
GCU 021-PC: Rod Pump Repair	3004507420	SWSW SEC. 18, T28N, R12W	PICTURED CLIFFS
GCU 212E-MA/DK: Tubing Repair	3004524734	SESE SEC. 32, T29N, R12W	MANCOS / DAKOTA
GCU 221E-MA: Rod Pump Repair	3004524259	SESE SEC. 31, T29N, R12W	MANCOS
GCU 241-PC: Tubing Repair	3004511687	SENE SEC. 29, T28N, R12W	PICTURED CLIFFS
GCU 172E-MA/DK: Rod Pump Repair	3004524250	SESE SEC. 25, T29N, R13W	MANCOS / DAKOTA
GCU 328 - SWDW Repair	3004524735	SESE SEC. 33, T29N, R12W	MESAVERDE

GCU 544-PC: Tubing Repair	3004529317	SESE SEC. 7, T28N, R11W	PICTURED CLIFFS
GCU 417-FT: Tubing Repair	3004528758	NESW SEC. 19, T28N, R11W	FRUITLAND COAL
GCU 583-FT: Tubing Repair	3004531053	SESW SEC. 4, T27N, R12W	FRUITLAND COAL
GCU 305-PC: Tubing Repair	3004523956	SWSE SEC. 36, T29N, R13W	PICTURED CLIFFS
GCU 055-FC/PC: Tubing Repair	3004507044	SWNE SEC. 35, T28N, R12W	FRUITLAND COAL / PICTURED CLIFFS
GCU 520-PC: Tubing Repair	3004528595	NWSE SEC. 22, T29N, R12W	PICTURED CLIFFS
GCU 300-PC: Tubing Repair	3004524009	NESE SEC. 19, T29N, R12W	PICTURED CLIFFS
GCU 330-FS/PC: Tubing Repair	3004525822	NENE SEC. 24, T29N, R13W	FRUITLAND SAND / PICTURED CLIFFS
GCU 168E-GP/DK: Rod Pump Repair	3004524863	NENW SEC. 19, T28N, R11W	GALLUP / DAKOTA
GCU 259 - SWDW Repair	3004520006	NESE SEC. 14, T28N, R12W	MESAVERDE

### Participating Areas

**Paying Well Determination:** SIMCOE did not submit any well for paying determination.

**PA Application submitted or approved:** SIMCOE did not submit a PA Application.

**Other: any surface disturbing activities completed:** SIMCOE did not create any new surface disturbances.

### Planned Year Operations:

**Drilling:** SIMCOE does not anticipate any Drilling projects.

**Recompletions:** SIMCOE does not anticipate any Recompletion projects.

**Plug Back:** SIMCOE does not anticipate any Plug Back projects.

**Conversions:** SIMCOE does not anticipate any Conversion projects.

**Plug & Abandonment:** SIMCOE anticipates permanently plugging and abandoning the following wells:

Well Name/Project	API #	Legal Location (Surface)	Formation
GCU 268-PC	3004522239	SESE SEC. 32, T28N, R12W	PICTURED CLIFFS
GCU 538-FS/PC	3004529068	SWSW SEC. 17, T29N, R12W	FRUITLAND SAND / PICTURED CLIFFS
GCU 539-PC	3004529074	SENE SEC. 20, T29N, R12W	PICTURED CLIFFS
GCU 598-CH	3004531600	SWSW SEC. 22, T29N, R12W	CHACRA
GCU 237-PC	3004511713	SESW SEC. 13, T28N, R13W	PICTURED CLIFFS

### Participating Areas

**Paying Well Determination planned:** SIMCOE will not be submitting any well for paying determination.

**PA Application submitted or approved:** SIMCOE will not be submitting a PA Application.

**PA Termination:** SIMCOE will not be submitting a PA Termination.

**Other – any surface disturbing activities completed:** SIMCOE anticipates no new surface disturbances.

### Water Use

As there are no planned development projects in the GCU for 2026, there is no planned water use.

**Water Disposal:** See table below.

**SWD WELLS (WIW)**

WELL NAME	API NO.	LEGAL DESCRIPTION	STATUS
GALLEGOS CANYON UNIT 13-1	3004528601	NWSE SEC 13-T29N-R13W	GCU 13-1 disposed 21,962 bbls in 2025. All water is piped to location. Average daily volume is 60 bbls/day.
GALLEGOS CANYON UNIT 259	3004520006	SESE SEC 14-T28N-R12W	GCU 259 disposed 17,252 bbls in 2025. All water is trucked to location. Average daily volume is 99 bbls/day. This well was shut in for 6 months due to a downhole failure.
GALLEGOS CANYON UNIT 307	3004524248	NWSW SEC 30-T29N-R12W	GCU 307 disposed 43,506 bbls in 2025. Water is piped and trucked to location. Average daily volume is 119 bbls/day.
GALLEGOS CANYON UNIT 328	3004524735	SESW SEC 33-T29N-R12W	GCU 328 disposed 7797 bbls in 2025. All water is trucked to location, except for the GCU 303 (which is piped). Average daily volume is 119 bbls/day (when not shut in). This well was shut in most of the year due to mechanical issues.

**SUMMARY OF PLANNED YEAR OPERATIONS AND OTHER INFORMATION:**

**GCU Development Potential**

SIMCOE has several improved recovery and reserves growth possibilities in GCU. There is infill development potential in the Fruitland Coal for improved recovery purposes, which could be done by drilling new wells, recompleting current Dakota or Pictured Cliffs wells, or both. There is potential for horizontal well development of the Dakota reservoir. The Mancos and Gallup reservoirs in the Unit have black oil potential like what other operators have drilled in the Lybrook area to the southeast of GCU, where over 180 horizontal Mancos wells have been drilled to date in the Mancos black oil window. In the current oil and gas price environment, such development in GCU is not economic but could be pursued by SIMCOE in the future should product prices improve from their current levels. It is therefore not in our current Plan of Development to pursue these opportunities. We will, however, continue to conduct internal geologic and reservoir studies to assess the opportunities with a view toward bringing them to life when product prices support the investment.

**Shut-In Wells**

As mentioned in the Previous Year Operations above, SIMCOE P&A'd the GCU #275 well and TA'd the GCU #303, GCU #504, and GCU #537 wells. These were listed as Shut-In in last year's POD. There remains 6 wells in Shut-In status, those being: GCU #145, GCU #219, GCU #208E, GCU #153E, GCU #197E, and GCU COM D #160E. These wells produce from the Dakota formation. SIMCOE will continue to evaluate these wells for Mancos/Gallup Potential or possible return to production.

## STATUS OF WELLS –“Unit” Wells

PROD = PRODUCING, SI = SHUT IN, TA ZONE = TEMPORARILY ABANDONED ZONE. Note that P&A wells are excluded from this list. This list includes only those wells where at least one formation is located in and reports to a GCU Participating Area.

Well Name	API Number	Reservoir	Reservoir Prod Status	Well Status	Surface Section	Surface Township	Surface Range	Surface Qtr	PA/CA/Lease	ONRR Agmt
GALLEGOS CANYON UNIT 079	3004506729	FRUITLAND COAL	PROD	PROD	9	27N	12W	NENE	FC PA - NMNM 078391M	892000844L
GALLEGOS CANYON UNIT 079	3004506729	FARMINGTON	PROD	PROD	9	27N	12W	NENE	Lease: NMSF078902-A	082078902A
GALLEGOS CANYON UNIT 079	3004506729	PICTURED CLIFFS	PROD	PROD	9	27N	12W	NENE	PC PA - NMNM 078391A	892000844E
GALLEGOS CANYON UNIT 146	3004506823	DAKOTA	PROD	PROD	6	27N	12W	NESE	DK PA - NMNM 078391C	892000844F
GALLEGOS CANYON UNIT 064	3004506837	PICTURED CLIFFS	PROD	PROD	4	27N	12W	NESE	PC PA - NMNM 078391A	892000844E
GALLEGOS CANYON UNIT 089	3004506918	DAKOTA	PROD	PROD	6	27N	12W	NENW	DK PA - NMNM 078391C	892000844F
GALLEGOS CANYON UNIT 178	3004506919	FRUITLAND COAL	PROD	PROD	4	27N	12W	NWNW	FC PA - NMNM 078391M	892000844L
GALLEGOS CANYON UNIT 062	3004506920	PICTURED CLIFFS	TA ZONE	TA	4	27N	12W	NENW	PC PA - NMNM 078391A	892000844E (N/A - TA Zone)
GALLEGOS CANYON UNIT 194	3004506935	DAKOTA	PROD	PROD	5	27N	12W	NWNW	DK PA - NMNM 078391C	892000844F
GALLEGOS CANYON UNIT 194	3004506935	MANCOS	PROD	PROD	5	27N	12W	NWNW	CA: NMNM132763	NM 132763
GALLEGOS CANYON UNIT 080	3004506938	FRUITLAND COAL	PROD	PROD	6	27N	12W	NENE	FC PA - NMNM 078391M	892000844L
GALLEGOS CANYON UNIT 080	3004506938	PICTURED CLIFFS	TA ZONE	PROD	6	27N	12W	NENE	PC PA - NMNM 078391A	892000844E (N/A - TA Zone)
GALLEGOS CANYON UNIT 137	3004506965	FRUITLAND COAL	PROD	PROD	36	28N	13W	SESE	FC PA - NMNM 078391M	892000844L
GALLEGOS CANYON UNIT 137	3004506965	PICTURED CLIFFS	PROD	PROD	36	28N	13W	SESE	PC PA - NMNM 078391A	892000844E
GALLEGOS CANYON UNIT 177	3004506966	DAKOTA	PROD	PROD	31	28N	12W	SESE	DK PA - NMNM 078391C	892000844F
GALLEGOS CANYON UNIT 090	3004506981	DAKOTA	PROD	PROD	35	28N	13W	SWSW	DK PA - NMNM 078391C	892000844F
GALLEGOS CANYON UNIT 095	3004507008	DAKOTA	PROD	PROD	31	28N	11W	NESW	DK PA - NMNM 078391C	892000844F
GALLEGOS CANYON UNIT 159	3004507040	FRUITLAND COAL	PROD	PROD	31	28N	12W	SENE	FC PA - NMNM 078391M	892000844L
GALLEGOS CANYON UNIT 055	3004507044	FRUITLAND COAL	PROD	PROD	35	28N	12W	SWNE	FC PA - NMNM 078391M	892000844L

GALLEGOS CANYON UNIT 055	3004507044	PICTURED CLIFFS	PROD	PROD	35	28N	12W	SWNE	PC PA - NMNM 078391A	892000844E
GALLEGOS CANYON UNIT 190	3004507057	DAKOTA	PROD	PROD	32	28N	12W	NENW	DK PA - NMNM 078391C	892000844F
GALLEGOS CANYON UNIT 185	3004507085	DAKOTA	PROD	PROD	33	28N	12W	NWNW	DK PA - NMNM 078391C	892000844F
GALLEGOS CANYON UNIT 156	3004507123	DAKOTA	PROD	PROD	26	28N	13W	SWSE	DK PA - NMNM 078391C	892000844F
GALLEGOS CANYON UNIT 165	3004507171	DAKOTA	PROD	PROD	29	28N	12W	SENE	DK PA - NMNM 078391C	892000844F
GALLEGOS CANYON UNIT 084	3004507211	DAKOTA	PROD	PROD	26	28N	13W	NWNW	DK PA - NMNM 078391C	892000844F
GALLEGOS CANYON UNIT 017	3004507217	PICTURED CLIFFS	PROD	PROD	28	28N	12W	NENE	PC PA - NMNM 078391A	892000844E
GALLEGOS CANYON UNIT 176	3004507228	DAKOTA	TA ZONE	TA	25	28N	13W	NENW	DK PA - NMNM 078391C	892000844F (N/A - TA Zone)
GALLEGOS CANYON UNIT 033	3004507268	FRUITLAND COAL	PROD	PROD	21	28N	12W	SWSW	FC PA - NMNM 078391M	892000844L
GALLEGOS CANYON UNIT 006	3004507287	FRUITLAND COAL	PROD	PROD	22	28N	12W	NWSW	FC PA - NMNM 078391M	892000844L
GALLEGOS CANYON UNIT 006	3004507287	PICTURED CLIFFS	PROD	PROD	22	28N	12W	NWSW	PC PA - NMNM 078391A	892000844E
GALLEGOS CANYON UNIT 035	3004507293	FRUITLAND COAL	PROD	PROD	20	28N	12W	NESW	FC PA - NMNM 078391M	892000844L
GALLEGOS CANYON UNIT 035	3004507293	PICTURED CLIFFS	TA ZONE	PROD	20	28N	12W	NESW	PC PA - NMNM 078391A	892000844E (N/A - TA Zone)
GALLEGOS CANYON UNIT 168	3004507369	DAKOTA	PROD	PROD	19	28N	11W	NENE	DK PA - NMNM 078391C	892000844F
GALLEGOS CANYON UNIT 021	3004507420	PICTURED CLIFFS	PROD	PROD	18	28N	12W	SWSW	PC PA - NMNM 078391A	892000844E
GALLEGOS CANYON UNIT 139	3004507432	DAKOTA	PROD	PROD	18	28N	11W	SESE	DK PA - NMNM 078391C	892000844F
GALLEGOS CANYON UNIT 005	3004507466	FRUITLAND COAL	PROD	PROD	13	28N	13W	SENE	FC PA - NMNM 078391M	892000844L
GALLEGOS CANYON UNIT 167	3004507516	DAKOTA	PROD	PROD	18	28N	11W	NENW	DK PA - NMNM 078391C	892000844F
GALLEGOS CANYON UNIT 042	3004507557	FRUITLAND COAL	PROD	PROD	12	28N	13W	SESW	FC PA - NMNM 078391M	892000844L
GALLEGOS CANYON UNIT 042	3004507557	PICTURED CLIFFS	PROD	PROD	12	28N	13W	SESW	PC PA - NMNM 078391A	892000844E
GALLEGOS CANYON UNIT 032	3004507558	FRUITLAND COAL	PROD	PROD	7	28N	12W	SESW	FC PA - NMNM 078391M	892000844L
GALLEGOS CANYON UNIT 032	3004507558	PICTURED CLIFFS	PROD	PROD	7	28N	12W	SESW	PC PA - NMNM 078391A	892000844E

GALLEGOS CANYON UNIT 138	3004507578	DAKOTA	PROD	PROD	7	28N	11W	SESE	DK PA - NMNM 078391C	892000844F
GALLEGOS CANYON UNIT COM F 162	3004507668	DAKOTA	PROD	PROD	36	29N	12W	NWSE	DK PA - NMNM 078391C	892000844F / NM 85792
GALLEGOS CANYON UNIT 066	3004507691	FRUITLAND COAL	TA ZONE	TA	35	29N	13W	SWNE	FC PA - NMNM 078391M	892000844L (N/A - TA Zone)
GALLEGOS CANYON UNIT 066	3004507691	PICTURED CLIFFS	TA ZONE	TA	35	29N	13W	SWNE	PC PA - NMNM 078391A	892000844E (N/A - TA Zone)
GALLEGOS CANYON UNIT 086	3004507697	DAKOTA	PROD	PROD	35	29N	13W	SENE	DK PA - NMNM 078391C	892000844F
GALLEGOS CANYON UNIT COM I 181	3004507707	DAKOTA	PROD	PROD	34	29N	12W	SENE	DK PA - NMNM 078391C	892000844F
GALLEGOS CANYON UNIT COM A 142	3004507767	DAKOTA	PROD	PROD	25	29N	12W	SWSE	DK PA - NMNM 078391C	892000844F
GALLEGOS CANYON UNIT COM A 142	3004507767	CHACRA	PROD	PROD	25	29N	12W	SWSE	Fee leases only	N/A
GALLEGOS CANYON UNIT 172	3004507793	DAKOTA	PROD	PROD	25	29N	13W	SESE	DK PA - NMNM 078391C	892000844F
GALLEGOS CANYON UNIT 074	3004507803	PICTURED CLIFFS	PROD	PROD	29	29N	12W	NESW	PC PA - NMNM 078391A	892000844E
GALLEGOS CANYON UNIT 188	3004507840	DAKOTA	PROD	PROD	30	29N	12W	NWSE	DK PA - NMNM 078391C	892000844F
GALLEGOS CANYON UNIT COM B 143	3004507857	DAKOTA	PROD	PROD	25	29N	12W	SENE	DK PA - NMNM 078391C	892000844F
GALLEGOS CANYON UNIT COM B 143	3004507857	CHACRA	PROD	PROD	25	29N	12W	SENE	Fee leases only	N/A - Fee leases
GALLEGOS CANYON UNIT 171	3004507907	DAKOTA	PROD	PROD	25	29N	13W	NWNW	DK PA - NMNM 078391C	892000844F
GALLEGOS CANYON UNIT 145	3004507909	DAKOTA	SI	SI	26	29N	12W	NENE	DK PA - NMNM 078391C	892000844F
GALLEGOS CANYON UNIT 152	3004507975	DAKOTA	PROD	PROD	21	29N	12W	SWSW	DK PA - NMNM 078391C	892000844F
GALLEGOS CANYON UNIT COM E 161	3004507977	DAKOTA	PROD	PROD	23	29N	13W	SWSE	DK PA - NMNM 078391C	892000844F / 7940001780
GALLEGOS CANYON UNIT 111	3004507988	DAKOTA	PROD	PROD	20	29N	12W	NESW	DK PA - NMNM 078391C	892000844F
GALLEGOS CANYON UNIT 001	3004507999	FRUITLAND COAL	PROD	PROD	19	29N	12W	NESW	FC PA - NMNM 078391M	892000844L
GALLEGOS CANYON	3004508057	DAKOTA	PROD	PROD	23	29N	13W	SENE	DK PA - NMNM 078391C	892000844F

UNIT COM 094										
GALLEGOS CANYON UNIT 151	3004508062	DAKOTA	PROD	PROD	21	29N	12W	SWNE	DK PA - NMNM 078391C	892000844F
GALLEGOS CANYON UNIT 110	3004508077	DAKOTA	PROD	PROD	19	29N	12W	SWNE	DK PA - NMNM 078391C	892000844F
GALLEGOS CANYON UNIT 106	3004508139	DAKOTA	PROD	PROD	24	29N	13W	NENE	DK PA - NMNM 078391C	892000844F
GALLEGOS CANYON UNIT 134	3004508225	DAKOTA	PROD	PROD	17	29N	12W	SWSW	DK PA - NMNM 078391C	892000844F
GALLEGOS CANYON UNIT 108	3004508271	DAKOTA	PROD	PROD	13	29N	13W	NWSE	DK PA - NMNM 078391C	892000844F
GALLEGOS CANYON UNIT 133	3004508365	DAKOTA	PROD	PROD	17	29N	12W	SWNE	DK PA - NMNM 078391C	892000844F
GALLEGOS CANYON UNIT 102	3004508378	DAKOTA	PROD	PROD	13	29N	13W	NENW	DK PA - NMNM 078391C	892000844F
GALLEGOS CANYON UNIT 201	3004511566	DAKOTA	PROD	PROD	12	28N	12W	SWSW	DK PA - NMNM 078391C	892000844F
GALLEGOS CANYON UNIT 203	3004511567	DAKOTA	PROD	PROD	13	28N	12W	SENE	DK PA - NMNM 078391C	892000844F
GALLEGOS CANYON UNIT 205	3004511568	DAKOTA	PROD	PROD	17	28N	12W	SESW	DK PA - NMNM 078391C	892000844F
GALLEGOS CANYON UNIT 193	3004511570	DAKOTA	PROD	PROD	30	28N	12W	SWNW	DK PA - NMNM 078391C	892000844F
GALLEGOS CANYON UNIT 200	3004511573	DAKOTA	PROD	PROD	29	29N	12W	SWSW	DK PA - NMNM 078391C	892000844F
GALLEGOS CANYON UNIT 206	3004511586	DAKOTA	PROD	PROD	10	28N	12W	SESW	DK PA - NMNM 078391C	892000844F
GALLEGOS CANYON UNIT 207	3004511587	DAKOTA	PROD	PROD	14	28N	12W	SWNE	DK PA - NMNM 078391C	892000844F
GALLEGOS CANYON UNIT 208	3004511589	DAKOTA	PROD	PROD	15	28N	12W	SENE	DK PA - NMNM 078391C	892000844F
GALLEGOS CANYON UNIT 208	3004511589	GALLUP	PROD	PROD	15	28N	12W	SENE	GP D PA - NMNM 078391F	8920008440
GALLEGOS CANYON UNIT 191	3004511590	DAKOTA	PROD	PROD	32	28N	12W	SESE	DK PA - NMNM 078391C	892000844F
GALLEGOS CANYON UNIT 195	3004511592	DAKOTA	PROD	PROD	33	29N	12W	SESW	DK PA - NMNM 078391C	892000844F
GALLEGOS CANYON UNIT 213	3004511618	DAKOTA	PROD	PROD	8	28N	12W	NWSE	DK PA - NMNM 078391C	892000844F
GALLEGOS CANYON UNIT 217	3004511620	DAKOTA	PROD	PROD	13	28N	12W	NESW	DK PA - NMNM 078391C	892000844F
GALLEGOS CANYON UNIT 216	3004511621	DAKOTA	PROD	PROD	14	28N	12W	SESW	DK PA - NMNM 078391C	892000844F

GALLEGOS CANYON UNIT 215	3004511622	DAKOTA	PROD	PROD	16	28N	12W	SWSW	DK PA - NMNM 078391C	892000844F
GALLEGOS CANYON UNIT 229	3004511626	DAKOTA	PROD	PROD	21	28N	12W	SENE	DK PA - NMNM 078391C	892000844F
GALLEGOS CANYON UNIT 219	3004511629	DAKOTA	SI	SI	23	28N	12W	NENE	DK PA - NMNM 078391C	892000844F
GALLEGOS CANYON UNIT 231	3004511631	PICTURED CLIFFS	PROD	PROD	27	28N	12W	NWNE	PC PA - NMNM 078391A	892000844E
GALLEGOS CANYON UNIT 221	3004511649	DAKOTA	PROD	PROD	31	29N	12W	SWNE	DK PA - NMNM 078391C	892000844F
GALLEGOS CANYON UNIT 221	3004511649	MANCOS	PROD	PROD	31	29N	12W	SWNE	GP D PA - NMNM 078391F	8920008440
GALLEGOS CANYON UNIT 212	3004511650	DAKOTA	PROD	PROD	32	29N	12W	NESW	DK PA - NMNM 078391C	892000844F
GALLEGOS CANYON UNIT 212	3004511650	MANCOS	PROD	PROD	32	29N	12W	NESW	GP D PA - NMNM 078391F	8920008440
GALLEGOS CANYON UNIT 222	3004511681	DAKOTA	PROD	PROD	7	28N	12W	SESW	DK PA - NMNM 078391C	892000844F
GALLEGOS CANYON UNIT 220	3004511682	FRUITLAND SAND	PROD	PROD	13	28N	12W	NESE	FS A PA - NMNM 078391G	892000844A
GALLEGOS CANYON UNIT 250	3004511683	GALLUP	PROD	PROD	14	28N	12W	SESW	GP D PA - NMNM 078391F	8920008440
GALLEGOS CANYON UNIT 226	3004511684	FRUITLAND COAL	TA ZONE	TA	18	28N	12W	SWSW	FC PA - NMNM 078391M	892000844L (N/A - TA Zone)
GALLEGOS CANYON UNIT 224	3004511685	DAKOTA	PROD	PROD	18	28N	12W	SWNE	DK PA - NMNM 078391C	892000844F
GALLEGOS CANYON UNIT 241	3004511687	PICTURED CLIFFS	PROD	PROD	29	28N	12W	SWNW	PC PA - NMNM 078391A	892000844E
GALLEGOS CANYON UNIT 245	3004511689	DAKOTA	PROD	PROD	36	28N	12W	SWNW	DK PA - NMNM 078391C	892000844F
GALLEGOS CANYON UNIT 245	3004511689	MANCOS	PROD	PROD	36	28N	12W	SWNW	Lease: NMSF078903	0820789030
GALLEGOS CANYON UNIT 244	3004511690	FRUITLAND COAL	PROD	PROD	36	28N	12W	NWSE	FC PA - NMNM 078391M	892000844L
GALLEGOS CANYON UNIT 244	3004511690	PICTURED CLIFFS	PROD	PROD	36	28N	12W	NWSE	PC PA - NMNM 078391A	892000844E
GALLEGOS CANYON UNIT 235	3004511691	DAKOTA	PROD	PROD	13	28N	13W	SENE	DK PA - NMNM 078391C	892000844F
GALLEGOS CANYON UNIT 237	3004511713	PICTURED CLIFFS	PROD	PROD	13	28N	13W	SESW	PC PA - NMNM 078391A	892000844E
GALLEGOS CANYON UNIT 243	3004511738	FRUITLAND COAL	PROD	PROD	24	28N	12W	NWNE	FC PA - NMNM 078391M	892000844L
GALLEGOS CANYON UNIT 255	3004511798	FRUITLAND SAND	PROD	PROD	18	28N	11W	NENW	FS A PA - NMNM 078391G	892000844A

GALLEGOS CANYON UNIT 124	3004513076	DAKOTA	PROD	PROD	35	28N	12W	NWNW	DK PA - NMNM 078391C	892000844F
GALLEGOS CANYON UNIT 096	3004513093	DAKOTA	PROD	PROD	18	29N	12W	SWSE	DK PA - NMNM 078391C	892000844F
GALLEGOS CANYON UNIT 263	3004520277	DAKOTA	PROD	PROD	20	29N	12W	NWNW	DK PA - NMNM 078391C	892000844F
GALLEGOS CANYON UNIT 269	3004522233	PICTURED CLIFFS	PROD	PROD	18	28N	12W	SWSE	PC PA - NMNM 078391A	892000844E
GALLEGOS CANYON UNIT 274	3004522234	FARMINGTON	PROD	PROD	20	28N	12W	SESE	FM A PA - NMNM 078391J	892000844G
GALLEGOS CANYON UNIT 274	3004522234	PICTURED CLIFFS	PROD	PROD	20	28N	12W	SESE	PC PA - NMNM 078391A	892000844E
GALLEGOS CANYON UNIT 273	3004522238	PICTURED CLIFFS	PROD	PROD	32	28N	12W	NENW	PC PA - NMNM 078391A	892000844E
GALLEGOS CANYON UNIT 268	3004522239	PICTURED CLIFFS	PROD	PROD	32	28N	12W	SESE	PC PA - NMNM 078391A	892000844E
GALLEGOS CANYON UNIT 287	3004523606	PICTURED CLIFFS	PROD	PROD	35	29N	13W	SWSE	PC PA - NMNM 078391A	892000844E
GALLEGOS CANYON UNIT 278	3004523652	FRUITLAND SAND	TA ZONE	PROD	17	28N	12W	SWSE	Lease: NMSF078106	820781060 (N/A - TA Zone)
GALLEGOS CANYON UNIT 278	3004523652	PICTURED CLIFFS	PROD	PROD	17	28N	12W	SWSE	PC PA - NMNM 078391A	892000844E
GALLEGOS CANYON UNIT 282	3004523653	PICTURED CLIFFS	PROD	PROD	31	28N	12W	NWSE	PC PA - NMNM 078391A	892000844E
GALLEGOS CANYON UNIT 286	3004523655	PICTURED CLIFFS	PROD	PROD	24	29N	13W	SESE	PC PA - NMNM 078391A	892000844E
GALLEGOS CANYON UNIT 293	3004523788	PICTURED CLIFFS	PROD	PROD	32	29N	12W	SWNW	PC PA - NMNM 078391A	892000844E
GALLEGOS CANYON UNIT 283	3004523793	PICTURED CLIFFS	PROD	PROD	29	29N	12W	NWNE	PC PA - NMNM 078391A	892000844E
GALLEGOS CANYON UNIT 290	3004523821	PICTURED CLIFFS	PROD	PROD	15	28N	12W	NWSE	PC PA - NMNM 078391A	892000844E
GALLEGOS CANYON UNIT 207E	3004523897	DAKOTA	PROD	PROD	14	28N	12W	NWNW	DK PA - NMNM 078391C	892000844F
GALLEGOS CANYON UNIT 207E	3004523897	MANCOS	PROD	PROD	14	28N	12W	NWNW	GP D PA - NMNM 078391F	8920008440
GALLEGOS CANYON UNIT 208E	3004523898	DAKOTA	SI	SI	15	28N	12W	NESE	DK PA - NMNM 078391C	892000844F
GALLEGOS CANYON UNIT 227E	3004523899	DAKOTA	PROD	PROD	20	28N	12W	NENW	DK PA - NMNM 078391C	892000844F
GALLEGOS CANYON UNIT 227E	3004523899	PICTURED CLIFFS	PROD	PROD	20	28N	12W	NENW	PC PA - NMNM 078391A	892000844E
GALLEGOS CANYON UNIT 242E	3004523901	DAKOTA	PROD	PROD	24	28N	12W	NESW	DK PA - NMNM 078391C	892000844F

GALLEGOS CANYON UNIT 110E	3004523905	DAKOTA	PROD	PROD	19	29N	12W	NESE	DK PA - NMNM 078391C	892000844F
GALLEGOS CANYON UNIT 305	3004523956	PICTURED CLIFFS	PROD	PROD	36	29N	13W	SWSE	PC PA - NMNM 078391A	892000844E
GALLEGOS CANYON UNIT 299	3004523999	PICTURED CLIFFS	PROD	PROD	31	28N	12W	NWNW	PC PA - NMNM 078391A	892000844E
GALLEGOS CANYON UNIT 301	3004524005	PICTURED CLIFFS	TA ZONE	TA	20	29N	12W	NESE	PC PA - NMNM 078391A	892000844E (N/A - TA Zone)
GALLEGOS CANYON UNIT 300	3004524009	PICTURED CLIFFS	PROD	PROD	19	29N	12W	NESE	PC PA - NMNM 078391A	892000844E
GALLEGOS CANYON UNIT 303	3004524012	PICTURED CLIFFS	TA ZONE	TA ZONE	33	29N	12W	SESW	PC PA - NMNM 078391A	892000844E
GALLEGOS CANYON UNIT 150E	3004524167	DAKOTA	PROD	PROD	22	29N	12W	SESE	DK PA - NMNM 078391C	892000844F
GALLEGOS CANYON UNIT 154E	3004524168	DAKOTA	PROD	PROD	27	29N	12W	SWNW	DK PA - NMNM 078391C	892000844F
GALLEGOS CANYON UNIT 200E	3004524170	DAKOTA	PROD	PROD	29	29N	12W	SWSE	DK PA - NMNM 078391C	892000844F
GALLEGOS CANYON UNIT 187E	3004524172	DAKOTA	PROD	PROD	30	29N	12W	SESW	DK PA - NMNM 078391C	892000844F
GALLEGOS CANYON UNIT 199E	3004524174	DAKOTA	PROD	PROD	34	29N	12W	NESW	DK PA - NMNM 078391C	892000844F
GALLEGOS CANYON UNIT 170E	3004524175	DAKOTA	PROD	PROD	35	29N	12W	SWNW	DK PA - NMNM 078391C	892000844F
GALLEGOS CANYON UNIT 169E	3004524176	DAKOTA	PROD	PROD	35	29N	12W	SENE	DK PA - NMNM 078391C	892000844F
GALLEGOS CANYON UNIT 093E	3004524177	DAKOTA	PROD	PROD	36	29N	12W	NWSW	DK PA - NMNM 078391C	892000844F
GALLEGOS CANYON UNIT 108E	3004524178	DAKOTA	PROD	PROD	13	29N	13W	SESW	DK PA - NMNM 078391C	892000844F
GALLEGOS CANYON UNIT 106E	3004524188	DAKOTA	PROD	PROD	24	29N	13W	NWNW	DK PA - NMNM 078391C	892000844F
GALLEGOS CANYON UNIT 203E	3004524211	DAKOTA	PROD	PROD	13	28N	12W	SESE	DK PA - NMNM 078391C	892000844F
GALLEGOS CANYON UNIT 172E	3004524250	DAKOTA	PROD	PROD	25	29N	13W	SESW	DK PA - NMNM 078391C	892000844F
GALLEGOS CANYON UNIT 172E	3004524250	MANCOS	PROD	PROD	25	29N	13W	SESW	Lease: NMSF078926	0820789260
GALLEGOS CANYON UNIT 196E	3004524254	DAKOTA	PROD	PROD	19	28N	12W	NWNW	DK PA - NMNM 078391C	892000844F
GALLEGOS CANYON UNIT 221E	3004524259	DAKOTA	TA ZONE	PROD	31	29N	12W	SESE	DK PA - NMNM 078391C	892000844F (N/A - TA Zone)
GALLEGOS CANYON UNIT 221E	3004524259	GALLUP	PROD	PROD	31	29N	12W	SESE	GP D PA - NMNM 078391F	8920008440

GALLEGOS CANYON UNIT 216E	3004524271	DAKOTA	PROD	PROD	14	28N	12W	NESE	DK PA - NMNM 078391C	892000844F
GALLEGOS CANYON UNIT 216E	3004524271	GALLUP	PROD	PROD	14	28N	12W	NESE	GP D PA - NMNM 078391F	8920008440
GALLEGOS CANYON UNIT 218E	3004524272	DAKOTA	PROD	PROD	22	28N	12W	NWNW	DK PA - NMNM 078391C	892000844F
GALLEGOS CANYON UNIT COM B 143E	3004524284	DAKOTA	PROD	PROD	25	29N	12W	SWSW	DK PA - NMNM 078391C	892000844F
GALLEGOS CANYON UNIT COM B 143E	3004524284	CHACRA	PROD	PROD	25	29N	12W	SWSW	CA: NMNM108232	N/A - Fee leases
GALLEGOS CANYON UNIT 111E	3004524289	DAKOTA	PROD	PROD	20	29N	12W	NESE	DK PA - NMNM 078391C	892000844F
GALLEGOS CANYON UNIT 151E	3004524290	DAKOTA	PROD	PROD	21	29N	12W	NWNW	DK PA - NMNM 078391C	892000844F
GALLEGOS CANYON UNIT 145E	3004524291	DAKOTA	PROD	PROD	26	29N	12W	NWNW	DK PA - NMNM 078391C	892000844F
GALLEGOS CANYON UNIT 153E	3004524292	DAKOTA	SI	SI	28	29N	12W	NENW	DK PA - NMNM 078391C	892000844F
GALLEGOS CANYON UNIT 184E	3004524427	DAKOTA	PROD	PROD	28	28N	12W	NWSE	DK PA - NMNM 078391C	892000844F
GALLEGOS CANYON UNIT 185E	3004524428	DAKOTA	PROD	PROD	33	28N	12W	NENE	DK PA - NMNM 078391C	892000844F
GALLEGOS CANYON UNIT 185E	3004524428	MANCOS	PROD	PROD	33	28N	12W	NENE	Lease: NMSF078903B	082078903B
GALLEGOS CANYON UNIT 166E	3004524429	DAKOTA	PROD	PROD	34	28N	12W	SWNW	DK PA - NMNM 078391C	892000844F
GALLEGOS CANYON UNIT 152E	3004524553	DAKOTA	PROD	PROD	21	29N	12W	SWSE	DK PA - NMNM 078391C	892000844F
GALLEGOS CANYON UNIT COM G 179E	3004524556	DAKOTA	PROD	PROD	26	29N	12W	NWSE	DK PA - NMNM 078391C	892000844F
GALLEGOS CANYON UNIT 321	3004524625	PICTURED CLIFFS	PROD	PROD	12	28N	13W	SWSE	PC PA - NMNM 078391A	892000844E
GALLEGOS CANYON UNIT 217E	3004524645	DAKOTA	PROD	PROD	13	28N	12W	NWNW	DK PA - NMNM 078391C	892000844F
GALLEGOS CANYON UNIT 217E	3004524645	GALLUP	PROD	PROD	13	28N	12W	NWNW	Lease: NMSF078905	0820789050
GALLEGOS CANYON UNIT 315	3004524655	PICTURED CLIFFS	PROD	PROD	21	28N	12W	SENW	PC PA - NMNM 078391A	892000844E
GALLEGOS CANYON UNIT 317	3004524656	PICTURED CLIFFS	PROD	PROD	27	28N	12W	SENW	PC PA - NMNM 078391A	892000844E
GALLEGOS CANYON UNIT 310	3004524728	FRUITLAND SAND	PROD	PROD	9	28N	12W	NWSE	FS C PA - NMNM 078391I	892000844I

GALLEGOS CANYON UNIT 310	3004524728	PICTURED CLIFFS	PROD	PROD	9	28N	12W	NWSE	PC PA - NMNM 078391A	892000844E
GALLEGOS CANYON UNIT 212E	3004524734	DAKOTA	PROD	PROD	32	29N	12W	SESE	DK PA - NMNM 078391C	892000844F
GALLEGOS CANYON UNIT 212E	3004524734	MANCOS	PROD	PROD	32	29N	12W	SESE	GP D PA - NMNM 078391F	8920008440
GALLEGOS CANYON UNIT 328	3004524735	FRUITLAND SAND	PA ZONE	PA ZONE	33	29N	12W	SESW	FS C PA - NMNM 078391I	892000844I
GALLEGOS CANYON UNIT COM I 181E	3004524736	DAKOTA	PROD	PROD	34	29N	12W	SENE	DK PA - NMNM 078391C	892000844F
GALLEGOS CANYON UNIT 197E	3004524737	DAKOTA	SI	SI	36	29N	13W	SWNE	DK PA - NMNM 078391C	892000844F
GALLEGOS CANYON UNIT 312	3004524798	FRUITLAND SAND	PROD	PROD	16	28N	12W	NWNE	FS C PA - NMNM 078391I	892000844I
GALLEGOS CANYON UNIT 312	3004524798	PICTURED CLIFFS	PROD	PROD	16	28N	12W	NWNE	PC PA - NMNM 078391A	892000844E
GALLEGOS CANYON UNIT 189E	3004524839	DAKOTA	PROD	PROD	36	29N	13W	NESW	DK PA - NMNM 078391C	892000844F
GALLEGOS CANYON UNIT 167E	3004524862	DAKOTA	PROD	PROD	18	28N	11W	SENE	DK PA - NMNM 078391C	892000844F
GALLEGOS CANYON UNIT 168E	3004524863	DAKOTA	PROD	PROD	19	28N	11W	NENW	DK PA - NMNM 078391C	892000844F
GALLEGOS CANYON UNIT 168E	3004524863	GALLUP	PROD	PROD	19	28N	11W	NENW	GP D PA - NMNM 078391F	8920008440
GALLEGOS CANYON UNIT 182E	3004524864	PICTURED CLIFFS	PROD	PROD	19	28N	11W	NESW	PC PA - NMNM 078391A	892000844E
GALLEGOS CANYON UNIT COM D 160E	3004524868	DAKOTA	SI	SI	27	29N	12W	SESW	DK PA - NMNM 078391C	892000844F
GALLEGOS CANYON UNIT 086E	3004524958	DAKOTA	PROD	PROD	35	29N	13W	SESE	DK PA - NMNM 078391C	892000844F
GALLEGOS CANYON UNIT 086E	3004524958	MANCOS	PROD	PROD	35	29N	13W	SESE	GP B PA - NMNM 078391D	NM 132557
GALLEGOS CANYON UNIT 085E	3004525169	DAKOTA	PROD	PROD	19	28N	12W	NESE	DK PA - NMNM 078391C	892000844F
GALLEGOS CANYON UNIT 193E	3004525173	DAKOTA	PROD	PROD	30	28N	12W	SWSW	DK PA - NMNM 078391C	892000844F
GALLEGOS CANYON UNIT 193E	3004525173	FRUITLAND COAL	PROD	PROD	30	28N	12W	SWSW	FC PA - NMNM 078391M	892000844L
GALLEGOS CANYON UNIT 174E	3004525202	DAKOTA	PROD	PROD	28	28N	12W	SWNW	DK PA - NMNM 078391C	892000844F
GALLEGOS CANYON UNIT 174E	3004525202	MANCOS	PROD	PROD	28	28N	12W	SWNW	Lease: NMSF078828A	082078828A

GALLEGOS CANYON UNIT 186E	3004525203	DAKOTA	PROD	PROD	33	28N	12W	SESW	DK PA - NMNM 078391C	892000844F
GALLEGOS CANYON UNIT 263E	3004525210	DAKOTA	PROD	PROD	20	29N	12W	SENE	DK PA - NMNM 078391C	892000844F
GALLEGOS CANYON UNIT 096E	3004525213	DAKOTA	PROD	PROD	18	29N	12W	NWNE	DK PA - NMNM 078391C	892000844F
GALLEGOS CANYON UNIT 134E	3004525222	DAKOTA	PROD	PROD	17	29N	12W	NESE	DK PA - NMNM 078391C	892000844F
GALLEGOS CANYON UNIT 134E	3004525222	CHACRA	PROD	PROD	17	29N	12W	NESE	Lease: NMSF080491	0820804910
GALLEGOS CANYON UNIT COM F 162E	3004525223	DAKOTA	PROD	PROD	36	29N	12W	NWNE	DK PA - NMNM 078391C	892000844F
GALLEGOS CANYON UNIT 204E	3004525262	DAKOTA	TA ZONE	PROD	34	28N	12W	NESE	DK PA - NMNM 078391C	892000844F (N/A - TA Zone)
GALLEGOS CANYON UNIT 204E	3004525262	PICTURED CLIFFS	PROD	PROD	34	28N	12W	NESE	PC PA - NMNM 078391A	892000844E
GALLEGOS CANYON UNIT 335	3004525447	FRUITLAND SAND	PROD	PROD	14	28N	12W	NESE	Lease: NMSF078905	0820789050
GALLEGOS CANYON UNIT 335	3004525447	PICTURED CLIFFS	PROD	PROD	14	28N	12W	NESE	PC PA - NMNM 078391A	892000844E
GALLEGOS CANYON UNIT 228E	3004525448	DAKOTA	PROD	PROD	21	28N	12W	SENE	DK PA - NMNM 078391C	892000844F
GALLEGOS CANYON UNIT 219E	3004525449	DAKOTA	PROD	PROD	23	28N	12W	NWNW	DK PA - NMNM 078391C	892000844F
GALLEGOS CANYON UNIT 095E	3004525500	DAKOTA	PROD	PROD	31	28N	11W	SESE	DK PA - NMNM 078391C	892000844F
GALLEGOS CANYON UNIT 246E	3004525501	DAKOTA	PROD	PROD	35	28N	12W	SESE	DK PA - NMNM 078391C	892000844F
GALLEGOS CANYON UNIT 333	3004525807	FRUITLAND SAND	PROD	PROD	33	29N	12W	NWNE	CA: NMNM108303	NM 108303
GALLEGOS CANYON UNIT 333	3004525807	PICTURED CLIFFS	PROD	PROD	33	29N	12W	NWNE	PC PA - NMNM 078391A	892000844E
GALLEGOS CANYON UNIT 330	3004525822	FRUITLAND SAND	PROD	PROD	24	29N	13W	NENE	Fee leases only	N/A - Fee leases
GALLEGOS CANYON UNIT 330	3004525822	PICTURED CLIFFS	PROD	PROD	24	29N	13W	NENE	PC PA - NMNM 078391A	892000844E
GALLEGOS CANYON UNIT 331	3004525840	FRUITLAND SAND	PROD	PROD	29	29N	12W	SWNW	FS E PA - NMNM 078391L	892000844K
GALLEGOS CANYON UNIT 331	3004525840	PICTURED CLIFFS	PROD	PROD	29	29N	12W	SWNW	PC PA - NMNM 078391A	892000844E
GALLEGOS CANYON UNIT 230E	3004526010	DAKOTA	PROD	PROD	23	28N	12W	SWSE	DK PA - NMNM 078391C	892000844F
GALLEGOS CANYON UNIT 230E	3004526010	GALLUP	PROD	PROD	23	28N	12W	SWSE	GP A PA - NMNM 078391B	892000844B

GALLEGOS CANYON UNIT 231E	3004526012	DAKOTA	PROD	PROD	27	28N	12W	SWNW	DK PA - NMNM 078391C	892000844F
GALLEGOS CANYON UNIT 340	3004526119	FRUITLAND SAND	PROD	PROD	24	29N	13W	SWNW	Fee leases only	892000844L
GALLEGOS CANYON UNIT 340	3004526119	PICTURED CLIFFS	PROD	PROD	24	29N	13W	SWNW	PC PA - NMNM 078391A	892000844E
GALLEGOS CANYON UNIT COM A 142E	3004526125	DAKOTA	PROD	PROD	25	29N	12W	SWNE	DK PA - NMNM 078391C	892000844F
GALLEGOS CANYON UNIT COM A 142E	3004526125	CHACRA	PROD	PROD	25	29N	12W	SWNE	Fee leases only	N/A - Fee leases
GALLEGOS CANYON UNIT 347	3004526134	FRUITLAND SAND	PROD	PROD	15	28N	12W	NWSE	FS C PA - NMNM 078391I	892000844I
GALLEGOS CANYON UNIT 346	3004526135	FRUITLAND SAND	PROD	PROD	15	28N	12W	SWNW	FS C PA - NMNM 078391I	892000844I
GALLEGOS CANYON UNIT 344	3004526140	FRUITLAND SAND	PROD	PROD	29	29N	12W	NESW	FS E PA - NMNM 078391L	892000844K
GALLEGOS CANYON UNIT 138E	3004526155	DAKOTA	PROD	PROD	7	28N	11W	NWSW	DK PA - NMNM 078391C	892000844F
GALLEGOS CANYON UNIT 109E	3004526181	DAKOTA	PROD	PROD	18	29N	12W	SWNW	DK PA - NMNM 078391C	892000844F
GALLEGOS CANYON UNIT 089E	3004526187	DAKOTA	PROD	PROD	6	27N	12W	NWSW	DK PA - NMNM 078391C	892000844F
GALLEGOS CANYON UNIT 201E	3004526189	DAKOTA	PROD	PROD	11	28N	12W	SWSE	DK PA - NMNM 078391C	892000844F
GALLEGOS CANYON UNIT 008E	3004526191	DAKOTA	PROD	PROD	22	28N	12W	NWSE	DK PA - NMNM 078391C	892000844F
GALLEGOS CANYON UNIT 222E	3004526192	DAKOTA	PROD	PROD	12	28N	13W	SESE	DK PA - NMNM 078391C	892000844F
GALLEGOS CANYON UNIT 222E	3004526192	GALLUP	PROD	PROD	12	28N	13W	SESE	GP B PA - NMNM 078391D	892000844C
GALLEGOS CANYON UNIT 090E	3004526193	DAKOTA	PROD	PROD	35	28N	13W	SESE	DK PA - NMNM 078391C	892000844F
GALLEGOS CANYON UNIT 137E	3004526194	DAKOTA	PROD	PROD	36	28N	13W	SWSW	DK PA - NMNM 078391C	892000844F
GALLEGOS CANYON UNIT 137E	3004526194	MANCOS	PROD	PROD	36	28N	13W	SWSW	Lease: NMSF077967	0820779670
GALLEGOS CANYON UNIT 178E	3004526206	DAKOTA	PROD	PROD	4	27N	12W	SENE	DK PA - NMNM 078391C	892000844F
GALLEGOS CANYON UNIT 233E	3004526210	DAKOTA	PROD	PROD	27	28N	12W	NWSE	DK PA - NMNM 078391C	892000844F
GALLEGOS CANYON UNIT 175E	3004526211	DAKOTA	PROD	PROD	25	28N	13W	SWSW	DK PA - NMNM 078391C	892000844F

GALLEGOS CANYON UNIT 191E	3004526223	DAKOTA	PROD	PROD	32	28N	12W	SWNE	DK PA - NMNM 078391C	892000844F
GALLEGOS CANYON UNIT 156E	3004526234	DAKOTA	PROD	PROD	26	28N	13W	NWSW	DK PA - NMNM 078391C	892000844F
GALLEGOS CANYON UNIT 102E	3004526253	DAKOTA	PROD	PROD	13	29N	13W	NENE	DK PA - NMNM 078391C	892000844F
GALLEGOS CANYON UNIT 237E	3004526269	DAKOTA	PROD	PROD	13	28N	13W	NENW	DK PA - NMNM 078391C	892000844F
GALLEGOS CANYON UNIT 238E	3004526271	DAKOTA	PROD	PROD	23	28N	13W	NWSE	DK PA - NMNM 078391C	892000844F
GALLEGOS CANYON UNIT 147E	3004526283	DAKOTA	PROD	PROD	4	27N	12W	NESW	DK PA - NMNM 078391C	892000844F
GALLEGOS CANYON UNIT 147E	3004526283	MANCOS	PROD	PROD	4	27N	12W	NESW	Lease: NMSF078902	0820789020
GALLEGOS CANYON UNIT 124E	3004526289	DAKOTA	PROD	PROD	35	28N	12W	SESW	DK PA - NMNM 078391C	892000844F
GALLEGOS CANYON UNIT 244E	3004526291	DAKOTA	PROD	PROD	36	28N	12W	SWSW	DK PA - NMNM 078391C	892000844F
GALLEGOS CANYON UNIT 244E	3004526291	MANCOS	PROD	PROD	36	28N	12W	SWSW	Lease: NMSF078903	0820789030
GALLEGOS CANYON UNIT 232E	3004526338	DAKOTA	PROD	PROD	26	28N	12W	SESE	DK PA - NMNM 078391C	892000844F
GALLEGOS CANYON UNIT 084E	3004526340	DAKOTA	PROD	PROD	26	28N	13W	SWNE	DK PA - NMNM 078391C	892000844F
GALLEGOS CANYON UNIT 235E	3004526348	PICTURED CLIFFS	PROD	PROD	13	28N	13W	SWSE	PC PA - NMNM 078391A	892000844E
GALLEGOS CANYON UNIT 194E	3004526363	DAKOTA	PROD	PROD	5	27N	12W	NWSW	DK PA - NMNM 078391C	892000844F
GALLEGOS CANYON UNIT 356	3004526365	FRUITLAND SAND	PROD	PROD	19	29N	12W	SWNE	FS B PA - NMNM 078391H	892000844H
GALLEGOS CANYON UNIT 357	3004526366	FRUITLAND SAND	PROD	PROD	29	29N	12W	NENE	FS E PA - NMNM 078391L	892000844K
GALLEGOS CANYON UNIT 358	3004526367	FRUITLAND SAND	PROD	PROD	29	29N	12W	SWSE	FS E PA - NMNM 078391L	892000844K
GALLEGOS CANYON UNIT 361	3004526431	FRUITLAND SAND	PROD	PROD	15	28N	12W	NWNE	FS C PA - NMNM 078391I	892000844I
GALLEGOS CANYON UNIT 355	3004526440	PICTURED CLIFFS	PROD	PROD	4	27N	12W	NESW	PC PA - NMNM 078391A	892000844E
MONCRIEF FEDERAL 001E	3004526450	DAKOTA	PROD	PROD	22	29N	12W	NWNW	DK PA - NMNM 078391C	892000844F / 7940001310
GALLEGOS CANYON UNIT 265E	3004526706	DAKOTA	TA ZONE	PROD	25	28N	12W	NESW	DK PA - NMNM 078391C	892000844F (N/A - TA Zone)
GALLEGOS CANYON UNIT 265E	3004526706	MANCOS	PROD	PROD	25	28N	12W	NESW	GP A PA - NMNM 078391B	892000844B

GALLEGOS CANYON UNIT 382	3004527547	FRUITLAND COAL	PROD	PROD	13	29N	13W	SESW	FC PA - NMNM 078391M	892000844L
GALLEGOS CANYON UNIT 384	3004527575	FRUITLAND COAL	PROD	PROD	21	29N	12W	SWSW	FC PA - NMNM 078391M	892000844L
GALLEGOS CANYON UNIT 501	3004528052	PICTURED CLIFFS	PROD	PROD	13	29N	13W	NWSE	PC PA - NMNM 078391A	892000844E
GALLEGOS CANYON UNIT 503	3004528064	PICTURED CLIFFS	PROD	PROD	18	29N	12W	SWSE	PC PA - NMNM 078391A	892000844E
GALLEGOS CANYON UNIT 515	3004528065	PICTURED CLIFFS	PROD	PROD	35	29N	12W	SENE	PC PA - NMNM 078391A	892000844E
GALLEGOS CANYON UNIT 506	3004528067	PICTURED CLIFFS	PROD	PROD	16	29N	12W	NWSW	PC PA - NMNM 078391A	892000844E
GALLEGOS CANYON UNIT 397	3004528118	FRUITLAND COAL	PROD	PROD	36	29N	13W	NESW	FC PA - NMNM 078391M	892000844L
GALLEGOS CANYON UNIT 502	3004528119	PICTURED CLIFFS	PROD	PROD	18	29N	12W	SWNW	PC PA - NMNM 078391A	892000844E
GALLEGOS CANYON UNIT 388	3004528153	FRUITLAND COAL	PROD	PROD	17	29N	12W	SWNE	FC PA - NMNM 078391M	892000844L
GALLEGOS CANYON UNIT 389	3004528154	FRUITLAND COAL	TA ZONE	TA ZONE	21	29N	12W	SWNE	FC PA - NMNM 078391M	892000844L
GALLEGOS CANYON UNIT 504	3004528155	PICTURED CLIFFS	TA ZONE	TA ZONE	17	29N	12W	NENW	PC PA - NMNM 078391A	892000844E
GALLEGOS CANYON UNIT 517	3004528156	FRUITLAND SAND	PROD	PROD	18	28N	11W	SENE	FS A PA - NMNM 078391G	892000844A
GALLEGOS CANYON UNIT 517	3004528156	PICTURED CLIFFS	PROD	PROD	18	28N	11W	SENE	PC PA - NMNM 078391A	892000844E
GALLEGOS CANYON UNIT 395	3004528234	FRUITLAND COAL	PROD	PROD	30	29N	12W	NWNE	FC PA - NMNM 078391M	892000844L
GALLEGOS CANYON UNIT 505	3004528235	FRUITLAND SAND	TA ZONE	PROD	17	29N	12W	SESE	Lease: NMSF080491	820804910 (N/A - TA Zone)
GALLEGOS CANYON UNIT 505	3004528235	PICTURED CLIFFS	PROD	PROD	17	29N	12W	SESE	PC PA - NMNM 078391A	892000844E
GALLEGOS CANYON UNIT 508	3004528266	PICTURED CLIFFS	PROD	PROD	21	29N	12W	NWNW	PC PA - NMNM 078391A	892000844E
GALLEGOS CANYON UNIT 390	3004528309	FRUITLAND COAL	PROD	PROD	23	29N	13W	SESW	FC PA - NMNM 078391M	892000844L
GALLEGOS CANYON UNIT 396	3004528310	FRUITLAND COAL	TA ZONE	TA	35	29N	13W	SWSW	FC PA - NMNM 078391M	892000844L (N/A - TA Zone)
GALLEGOS CANYON UNIT 507	3004528331	PICTURED CLIFFS	PROD	PROD	20	29N	12W	NWNW	PC PA - NMNM 078391A	892000844E
GALLEGOS CANYON UNIT 511	3004528365	PICTURED CLIFFS	PROD	PROD	26	29N	12W	NWNW	PC PA - NMNM 078391A	892000844E
GALLEGOS CANYON UNIT 500	3004528414	PICTURED CLIFFS	PROD	PROD	13	29N	13W	NENW	PC PA - NMNM 078391A	892000844E

GALLEGOS CANYON UNIT 520	3004528595	PICTURED CLIFFS	PROD	PROD	22	29N	12W	NWSE	PC PA - NMNM 078391A	892000844E
GALLEGOS CANYON UNIT 523	3004528596	PICTURED CLIFFS	PROD	PROD	35	29N	12W	SWNW	PC PA - NMNM 078391A	892000844E
GALLEGOS CANYON UNIT 521	3004528605	PICTURED CLIFFS	PROD	PROD	36	29N	12W	NWSW	PC PA - NMNM 078391A	892000844E
GALLEGOS CANYON UNIT 414	3004528726	FRUITLAND COAL	PROD	PROD	18	28N	11W	SWSW	FC PA - NMNM 078391M	892000844L
GALLEGOS CANYON UNIT 414	3004528726	FRUITLAND SAND	PROD	PROD	18	28N	11W	SWSW	FS A PA - NMNM 078391G	892000844A
GALLEGOS CANYON UNIT 533	3004528733	PICTURED CLIFFS	TA ZONE	TA	22	29N	12W	NWSW	PC PA - NMNM 078391A	892000844E (N/A - TA Zone)
GALLEGOS CANYON UNIT 410	3004528734	FRUITLAND COAL	PROD	PROD	35	29N	12W	NESW	FC PA - NMNM 078391M	892000844L
GALLEGOS CANYON UNIT 416	3004528757	FRUITLAND COAL	PROD	PROD	19	28N	11W	SWNE	FC PA - NMNM 078391M	892000844L
GALLEGOS CANYON UNIT 417	3004528758	FRUITLAND COAL	PROD	PROD	19	28N	11W	NESW	FC PA - NMNM 078391M	892000844L
GALLEGOS CANYON UNIT 418	3004528760	FRUITLAND COAL	PROD	PROD	13	28N	12W	NWSW	FC PA - NMNM 078391M	892000844L
GALLEGOS CANYON UNIT 525	3004528773	PICTURED CLIFFS	PROD	PROD	26	29N	12W	SESW	PC PA - NMNM 078391A	892000844E
GALLEGOS CANYON UNIT 526	3004528774	PICTURED CLIFFS	PROD	PROD	27	29N	12W	NWNE	PC PA - NMNM 078391A	892000844E
GALLEGOS CANYON UNIT 532	3004529032	PICTURED CLIFFS	TA ZONE	TA	26	29N	12W	SENE	PC PA - NMNM 078391A	892000844E (N/A - TA Zone)
GALLEGOS CANYON UNIT 527	3004529033	PICTURED CLIFFS	PROD	PROD	27	29N	12W	SESE	PC PA - NMNM 078391A	892000844E
GALLEGOS CANYON UNIT 535	3004529034	PICTURED CLIFFS	PROD	PROD	13	29N	13W	SESW	PC PA - NMNM 078391A	892000844E
GALLEGOS CANYON UNIT 399	3004529036	FRUITLAND COAL	PROD	PROD	24	29N	13W	SENE	FC PA - NMNM 078391M	892000844L
GALLEGOS CANYON UNIT 402	3004529037	FRUITLAND COAL	PROD	PROD	36	29N	13W	SWNE	FC PA - NMNM 078391M	892000844L
GALLEGOS CANYON UNIT 522	3004529044	PICTURED CLIFFS	PROD	PROD	22	29N	12W	NENW	PC PA - NMNM 078391A	892000844E
GALLEGOS CANYON UNIT 421	3004529045	FRUITLAND COAL	PROD	PROD	31	29N	12W	NWSW	FC PA - NMNM 078391M	892000844L
GALLEGOS CANYON UNIT 538	3004529068	FRUITLAND SAND	PROD	PROD	17	29N	12W	SWSW	Lease: NMSF080600	0820806000
GALLEGOS CANYON UNIT 538	3004529068	PICTURED CLIFFS	PROD	PROD	17	29N	12W	SWSW	PC PA - NMNM 078391A	892000844E
GALLEGOS CANYON UNIT 537	3004529069	PICTURED CLIFFS	TA ZONE	TA ZONE	18	29N	12W	NWNE	PC PA - NMNM 078391A	892000844E

GALLEGOS CANYON UNIT 539	3004529074	PICTURED CLIFFS	PROD	PROD	20	29N	12W	SENE	PC PA - NMNM 078391A	892000844E
GALLEGOS CANYON UNIT 528	3004529077	PICTURED CLIFFS	PROD	PROD	36	29N	12W	NWNW	PC PA - NMNM 078391A	892000844E
GALLEGOS CANYON UNIT 529	3004529078	PICTURED CLIFFS	PROD	PROD	36	29N	12W	NWSE	PC PA - NMNM 078391A	892000844E
GALLEGOS CANYON UNIT 544	3004529317	PICTURED CLIFFS	PROD	PROD	7	28N	11W	SESE	PC PA - NMNM 078391A	892000844E
GALLEGOS CANYON UNIT 540	3004529321	PICTURED CLIFFS	PROD	PROD	21	29N	12W	SENE	PC PA - NMNM 078391A	892000844E
GALLEGOS CANYON UNIT COM 568	3004530220	FRUITLAND COAL	PROD	PROD	36	29N	12W	NWNE	FC PA - NMNM 078391M	892000844L
GALLEGOS CANYON UNIT COM 558	3004530223	FRUITLAND COAL	PROD	PROD	16	29N	12W	NESW	FC PA - NMNM 078391M	892000844L
GALLEGOS CANYON UNIT 551	3004530276	FRUITLAND SAND	PROD	PROD	18	28N	11W	NESE	FS A PA - NMNM 078391G	892000844A
GALLEGOS CANYON UNIT 551	3004530276	PICTURED CLIFFS	PROD	PROD	18	28N	11W	NESE	PC PA - NMNM 078391A	892000844E
GALLEGOS CANYON UNIT 563	3004530290	FRUITLAND COAL	PROD	PROD	26	29N	12W	SWSW	FC PA - NMNM 078391M	892000844L
GALLEGOS CANYON UNIT 575	3004530299	PICTURED CLIFFS	PROD	PROD	13	28N	12W	SESE	PC PA - NMNM 078391A	892000844E
GALLEGOS CANYON UNIT 553	3004530524	FRUITLAND COAL	PROD	PROD	33	29N	12W	SESW	FC PA - NMNM 078391M	892000844L
GALLEGOS CANYON UNIT 556	3004530595	PICTURED CLIFFS	PROD	PROD	18	28N	11W	SENW	PC PA - NMNM 078391A	892000844E
GALLEGOS CANYON UNIT 579	3004530672	FRUITLAND COAL	PROD	PROD	34	29N	12W	SWNE	FC PA - NMNM 078391M	892000844L
GALLEGOS CANYON UNIT 580	3004530679	FRUITLAND SAND	TA ZONE	TA	13	28N	12W	SESW	FS A PA - NMNM 078391G	892000844A (N/A - TA Zone)
GALLEGOS CANYON UNIT 580	3004530679	PICTURED CLIFFS	TA ZONE	TA	13	28N	12W	SESW	PC PA - NMNM 078391A	892000844E (N/A - TA Zone)
GALLEGOS CANYON UNIT 555	3004530683	DAKOTA	PROD	PROD	12	28N	12W	SWSE	DK PA - NMNM 078391C	892000844F
GALLEGOS CANYON UNIT 571	3004530703	FRUITLAND COAL	PROD	PROD	14	28N	13W	SWNE	FC PA - NMNM 078391M	892000844L
GALLEGOS CANYON UNIT 583	3004531053	FRUITLAND COAL	PROD	PROD	4	27N	12W	SESW	FC PA - NMNM 078391M	892000844L
GALLEGOS CANYON UNIT 597	3004531620	FRUITLAND COAL	PROD	PROD	21	29N	12W	NWSE	FC PA - NMNM 078391M	892000844L
GALLEGOS CANYON UNIT 595	3004531660	FRUITLAND COAL	PROD	PROD	19	29N	12W	NWNW	FC PA - NMNM 078391M	892000844L

## STATUS OF WELLS – “Non-Unit” Wells

Well Name/Number	API Number	Reservoir	Well Status	SF Section	SF Township	SF Range	SF QtrQtr	CA or Lease	ONRR Reporting
GALLEGOS CANYON UNIT 093	3004507699	FRUITLAND COAL	PROD	36	29N	12W	SWNW	State of NM CA	N/A - State
GALLEGOS CANYON UNIT 028	3004507931	FRUITLAND SAND	PROD	30	29N	12W	NENE	CA	NM93997
GALLEGOS CANYON UNIT 195E	3004524260	FRUITLAND COAL	PROD	33	29N	12W	SESE	CA	NM108157
GALLEGOS CANYON UNIT 083E	3004526011	GALLUP	PROD	26	28N	12W	NENW	Lease	820789040
GALLEGOS CANYON UNIT 165E	3004526222	MANCOS	PROD	29	28N	12W	SESE	CA	NM112699
GALLEGOS CANYON UNIT 157E	3004526398	MANCOS	PROD	35	28N	13W	SWNW	Lease	820779670
GALLEGOS CANYON UNIT 351	3004526414	FRUITLAND SAND	PROD	10	28N	12W	SESE	Lease	820781090
GALLEGOS CANYON UNIT 566	3004530319	FRUITLAND COAL	PROD	28	29N	12W	SESW	CA	NM108154
GALLEGOS CANYON UNIT 566	3004530319	FRUITLAND SAND	PROD	28	29N	12W	SESW	CA	NM108154
GALLEGOS CANYON UNIT 598	3004531600	CHACRA	TA	22	29N	12W	SWSW	CA	NM132979
GALLEGOS CANYON UNIT 192	3004511571	FRUITLAND COAL	TA	30	28N	12W	SESE	Lease	5160084700

**PRODUCTION GRAPHS BY PA**

**GCU DAKOTA PA – NMNM 078391C**

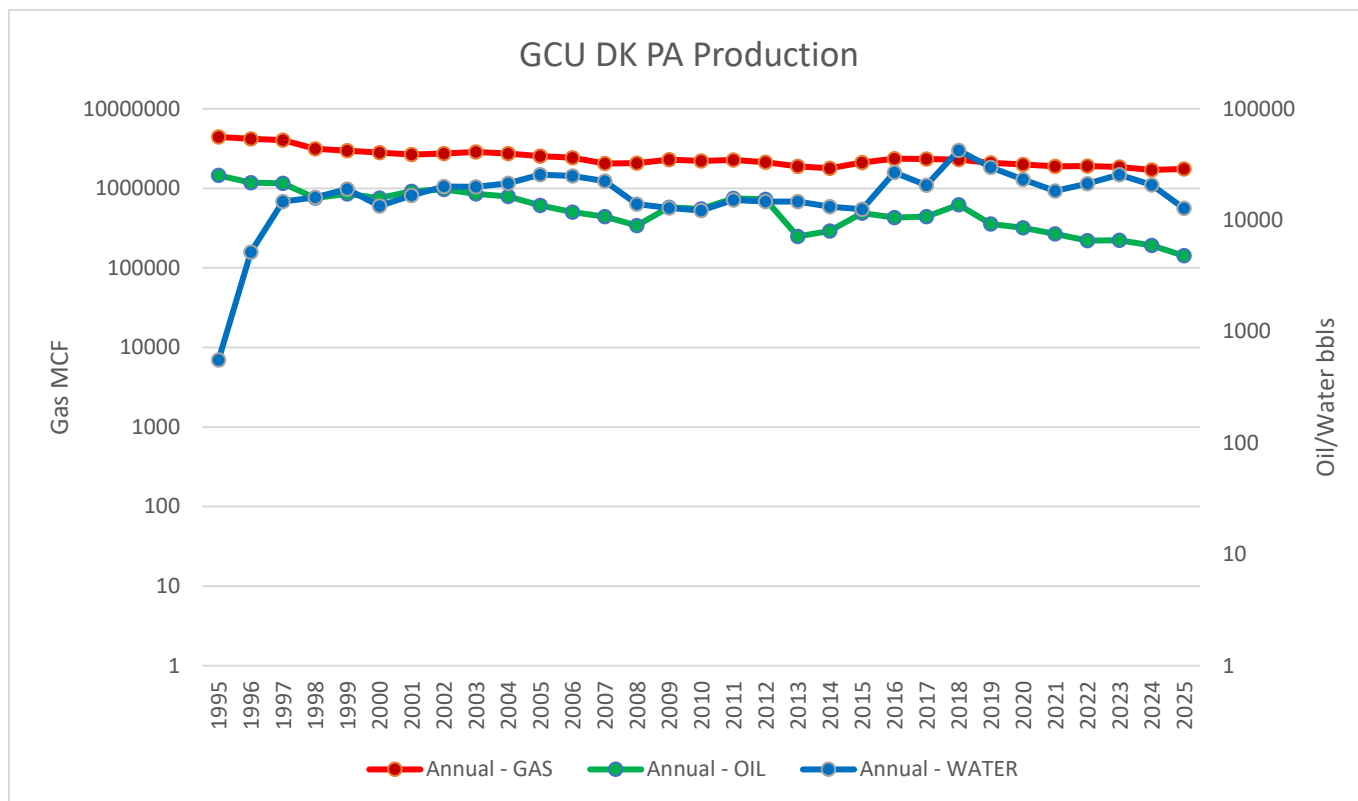

**GCU FRUITLAND COAL PA - NMNM 078391M**

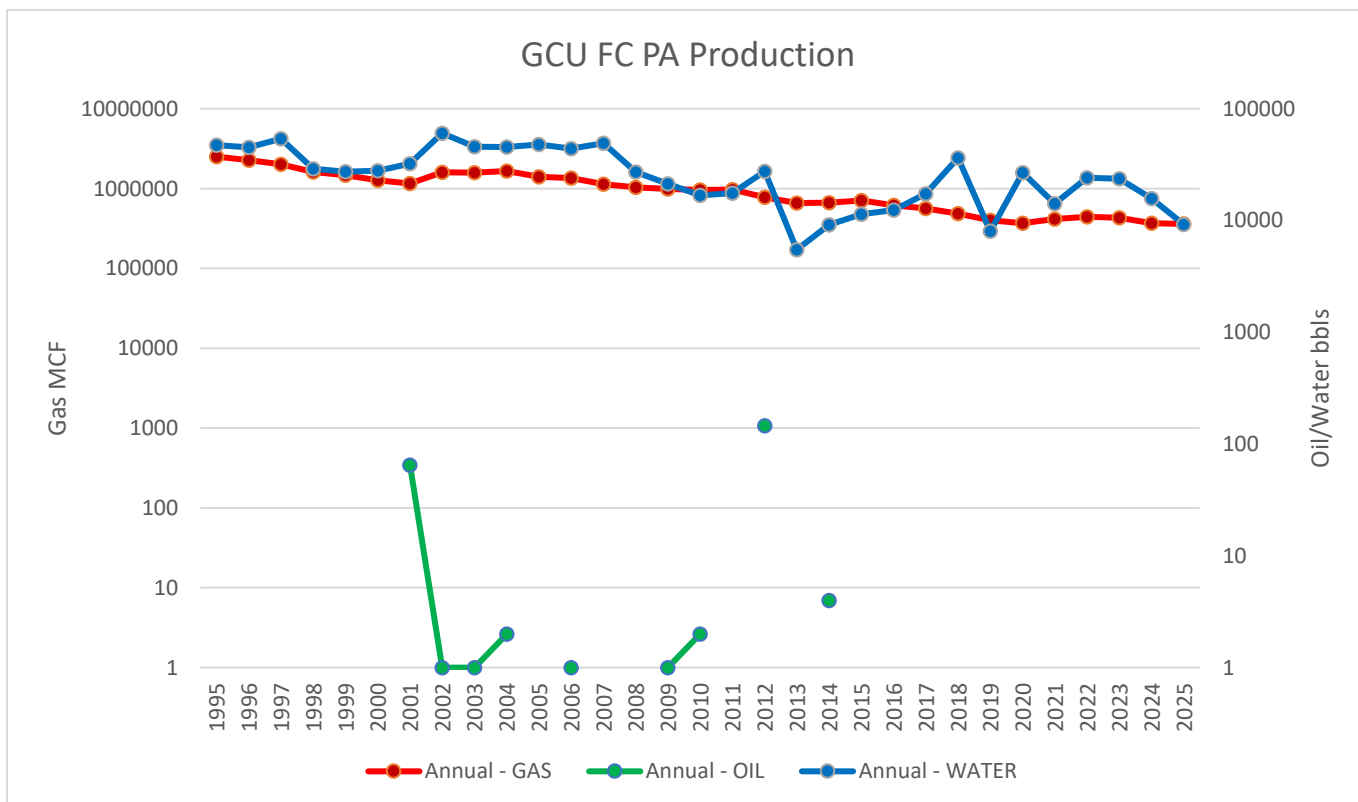

**GCU PICTURED CLIFFS PA - NMNM 078391A**

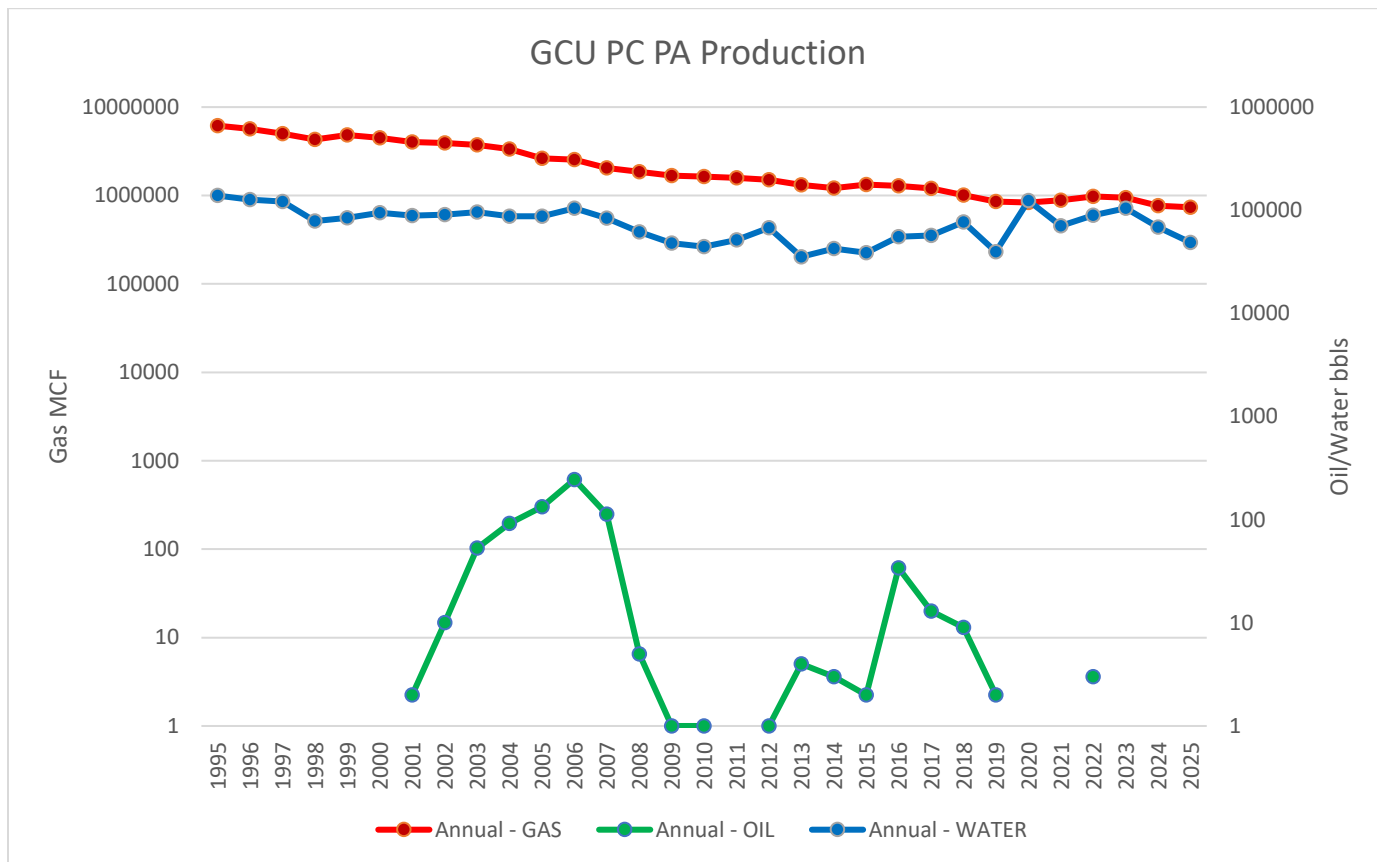

**GCU FRUITLAND SAND "A" PA - NMNM 078391G**

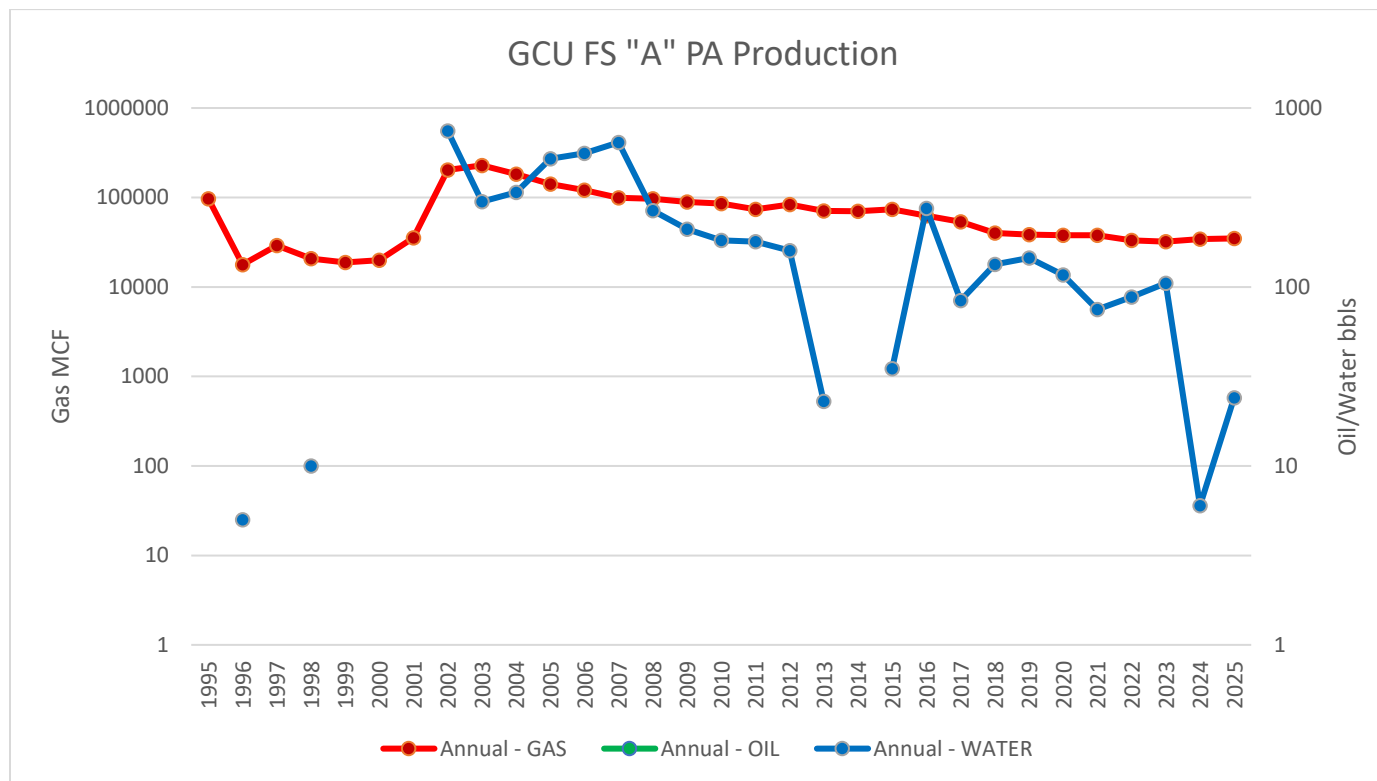

**GCU FRUITLAND SAND "B" PA - NMNM 078391H**

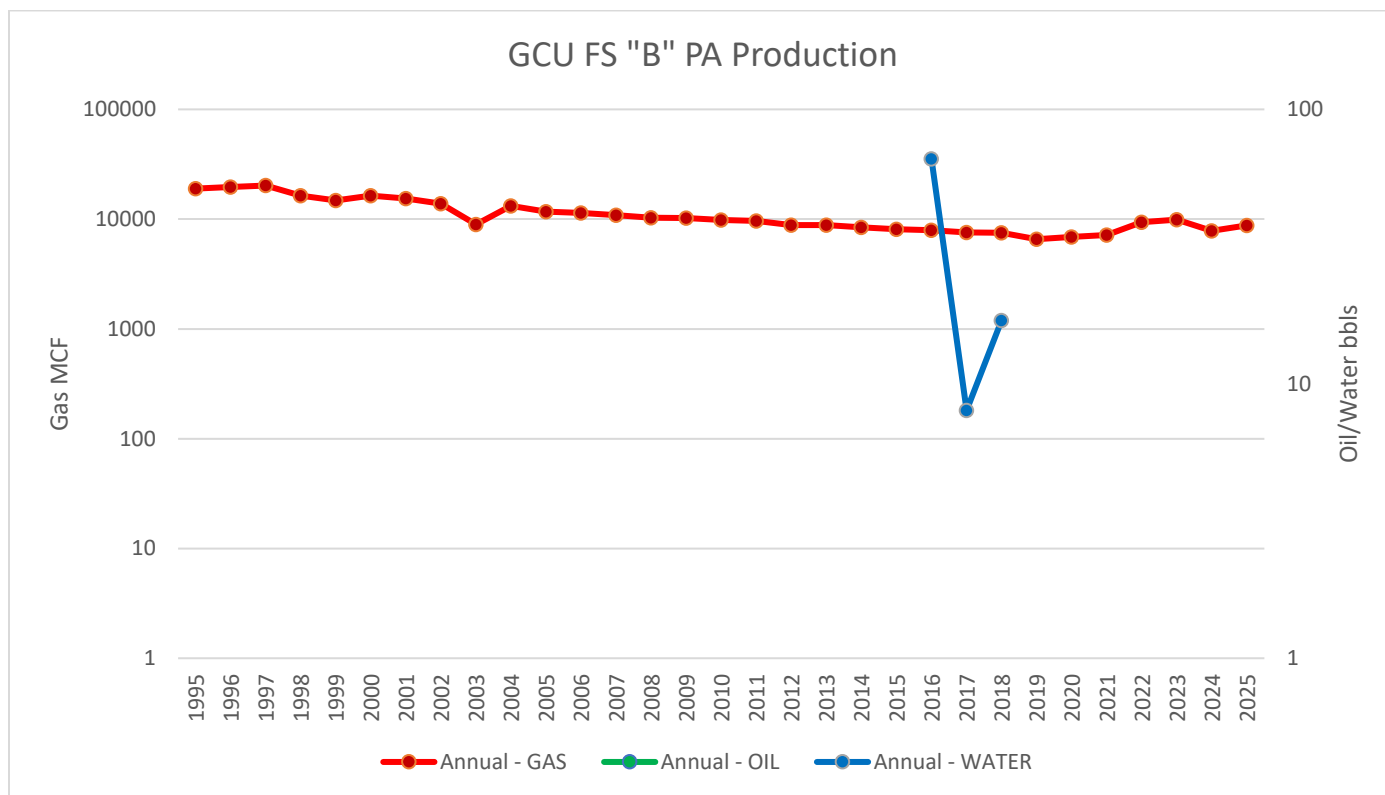

**GCU FRUITLAND SAND "C" PA - NMNM 078391I**

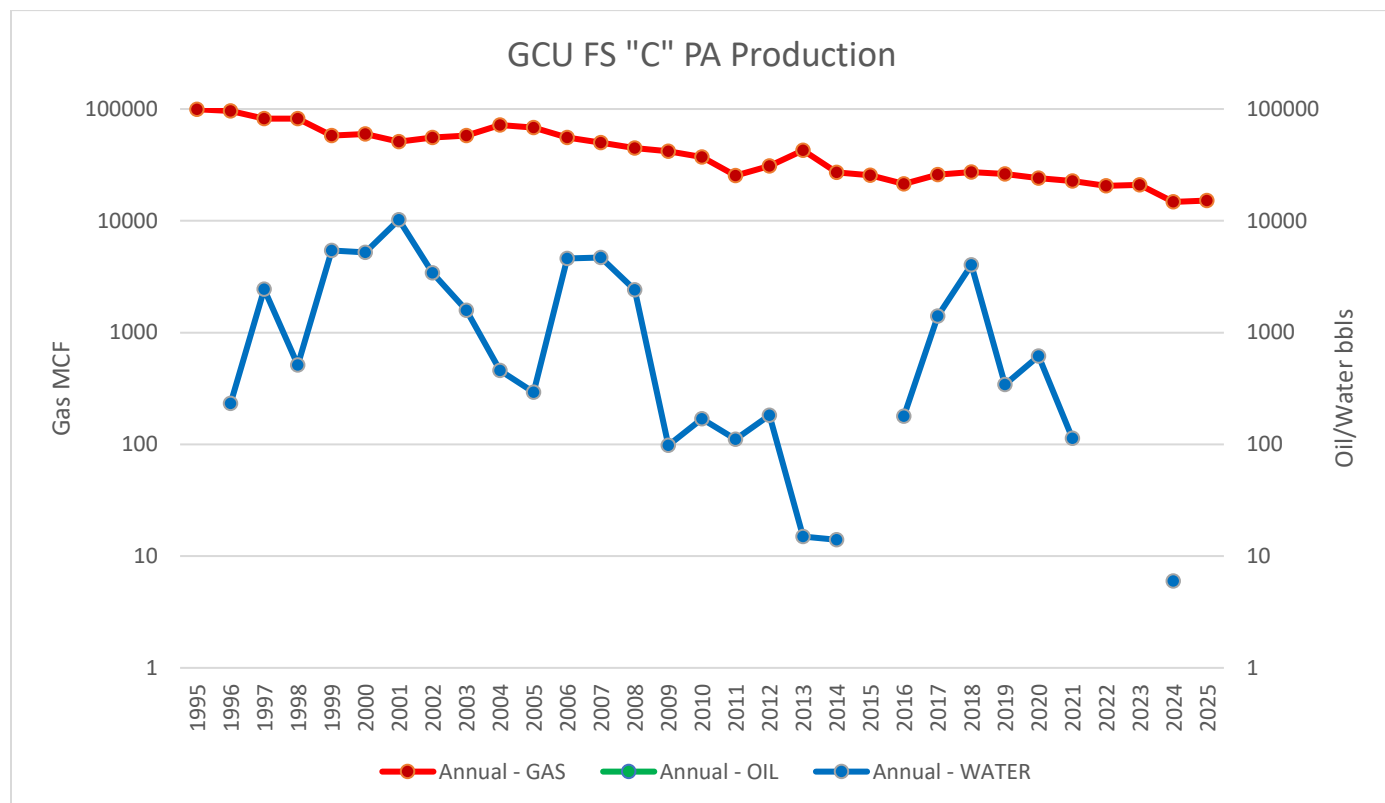

**GCU FRUITLAND SAND "E" PA - NMNM 078391L**

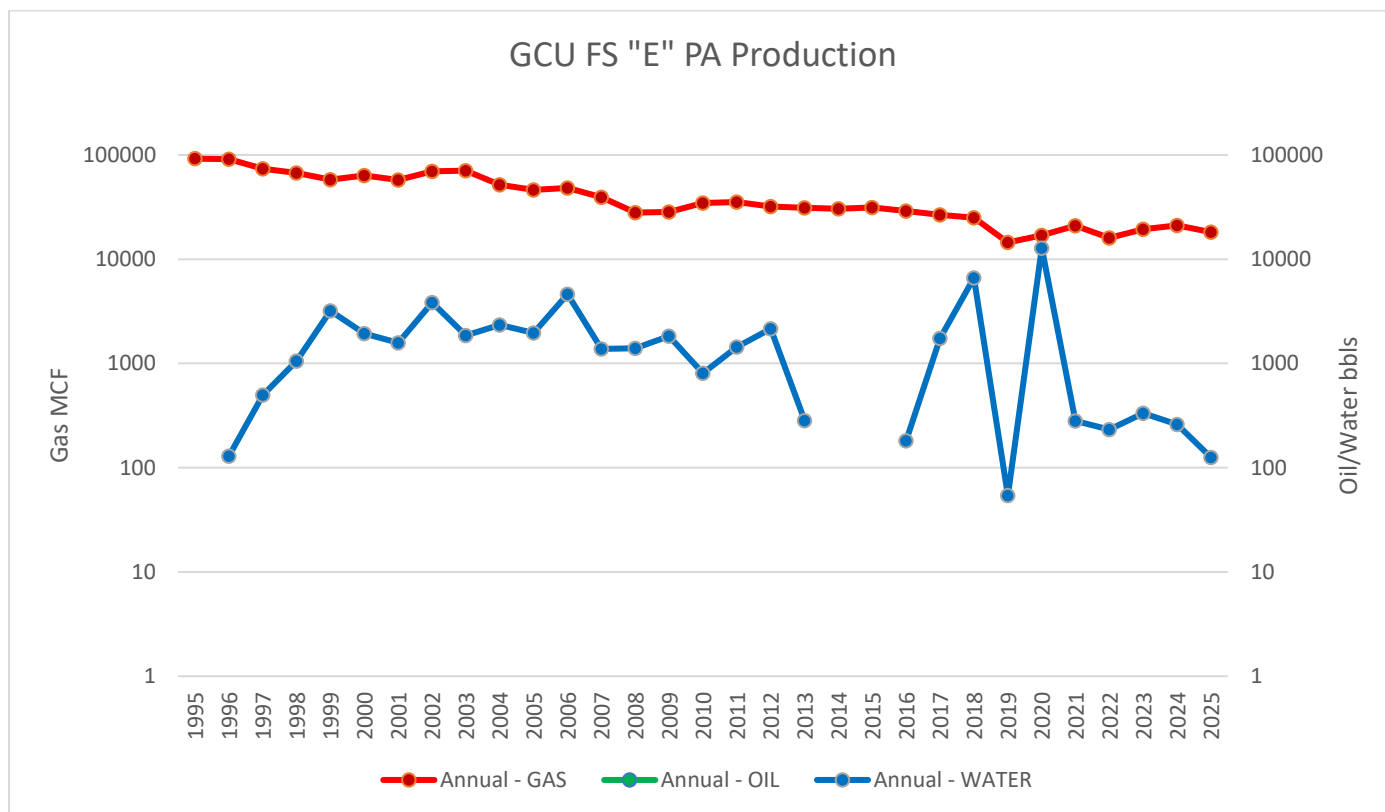

**GCU GALLUP "A" PA - NMNM 078391B**

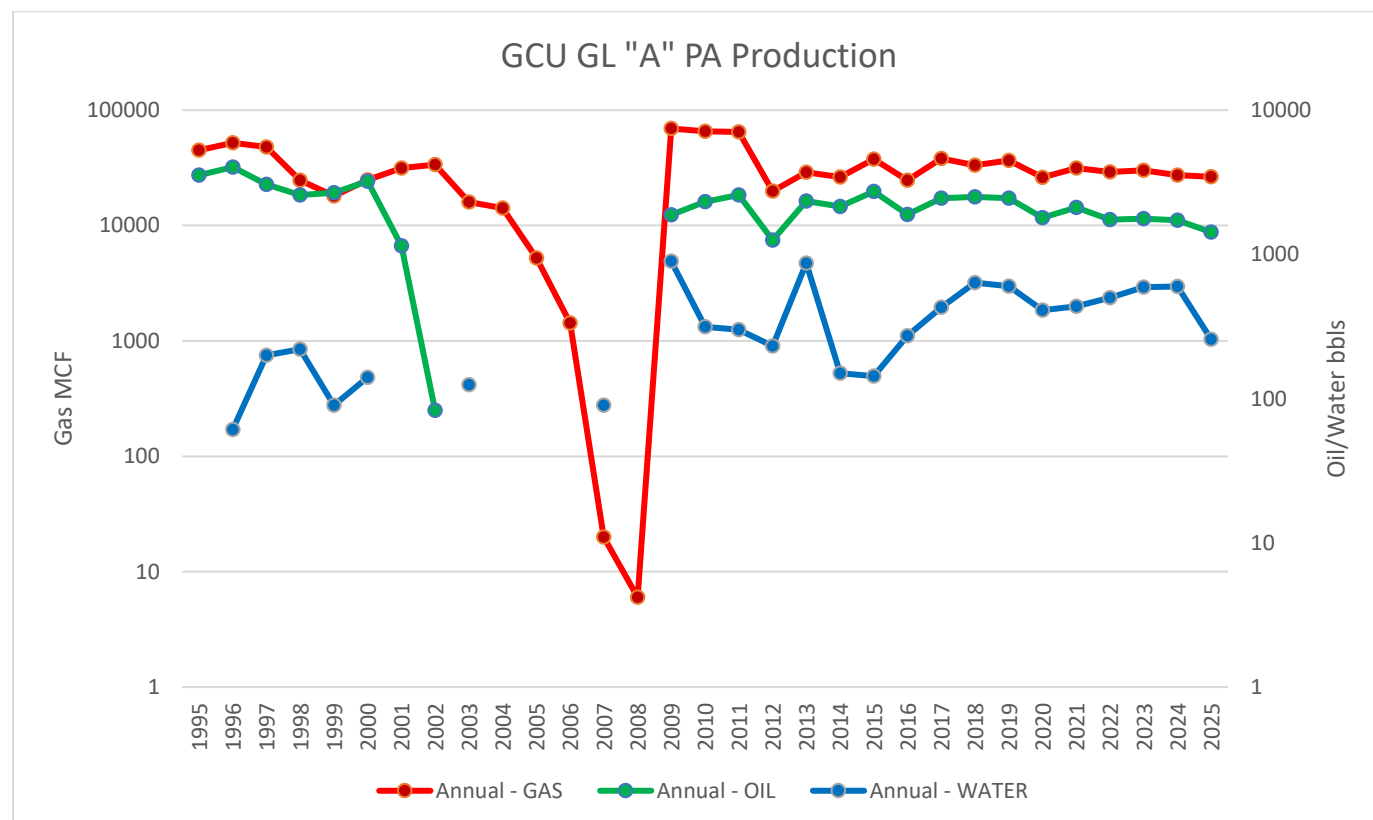

**GCU GALLUP "B" PA - NMNM 078391D**

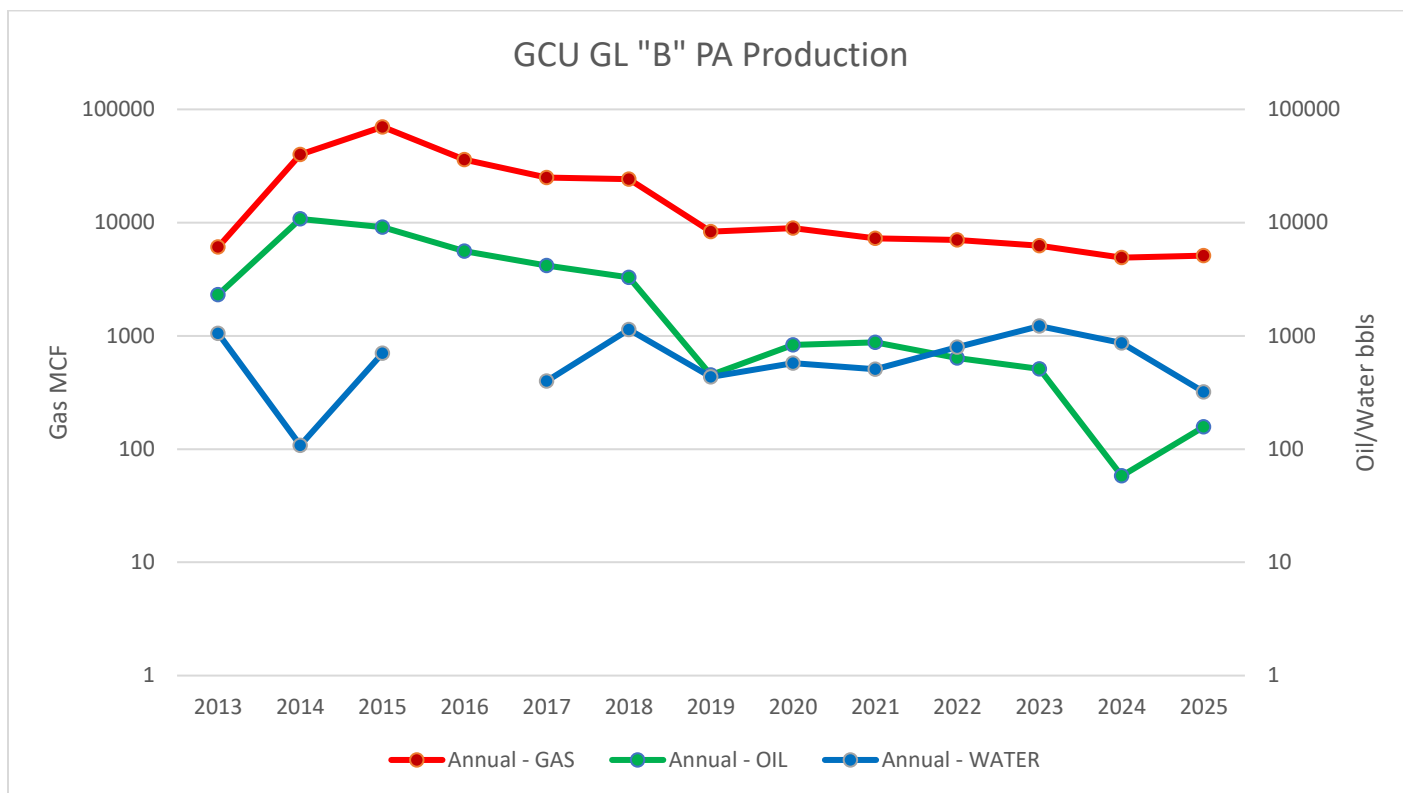

**GCU GALLUP "D" PA - NMNM 078391F**

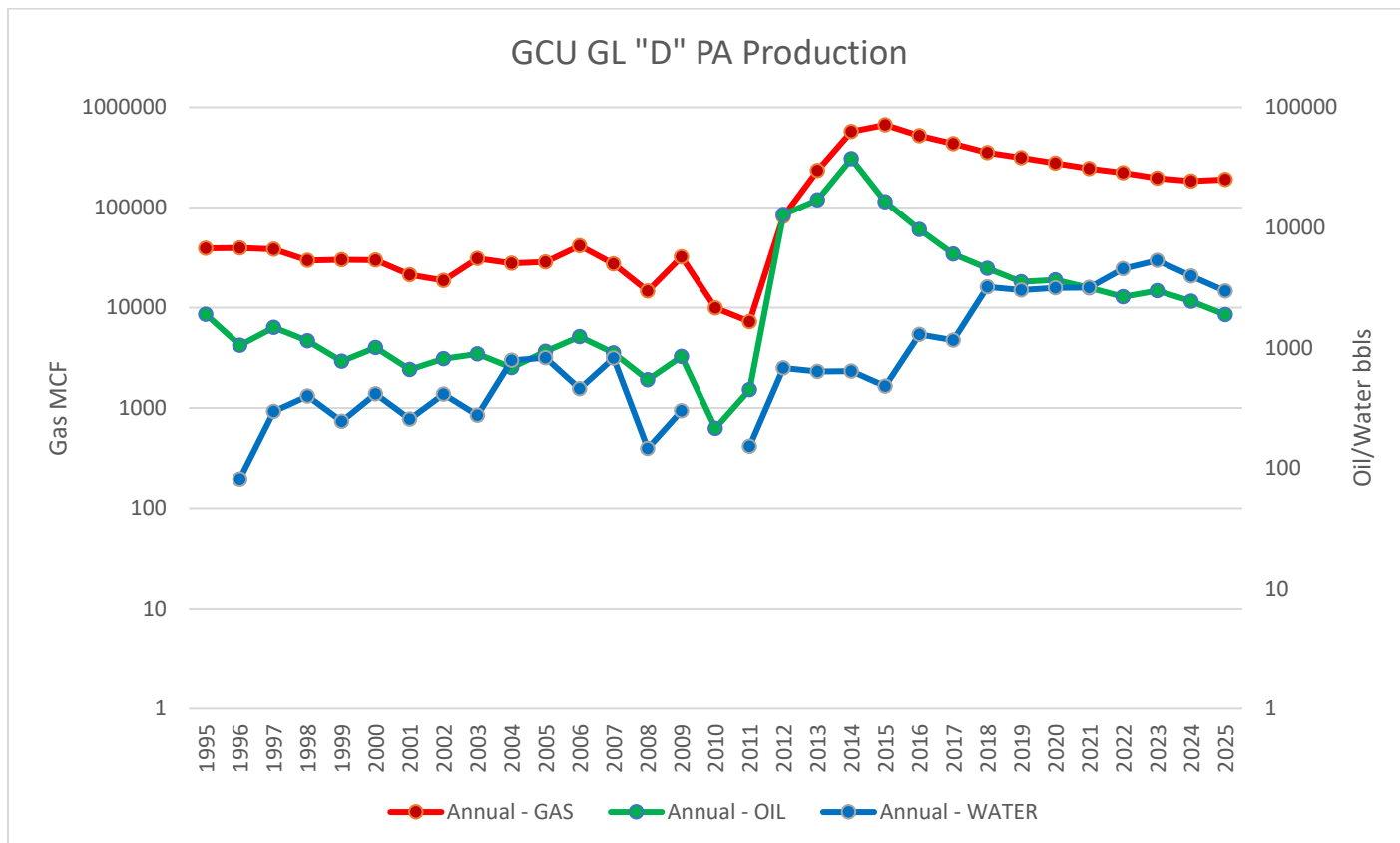

**GCU FARMINGTON SAND PA - NMNM 078391J**

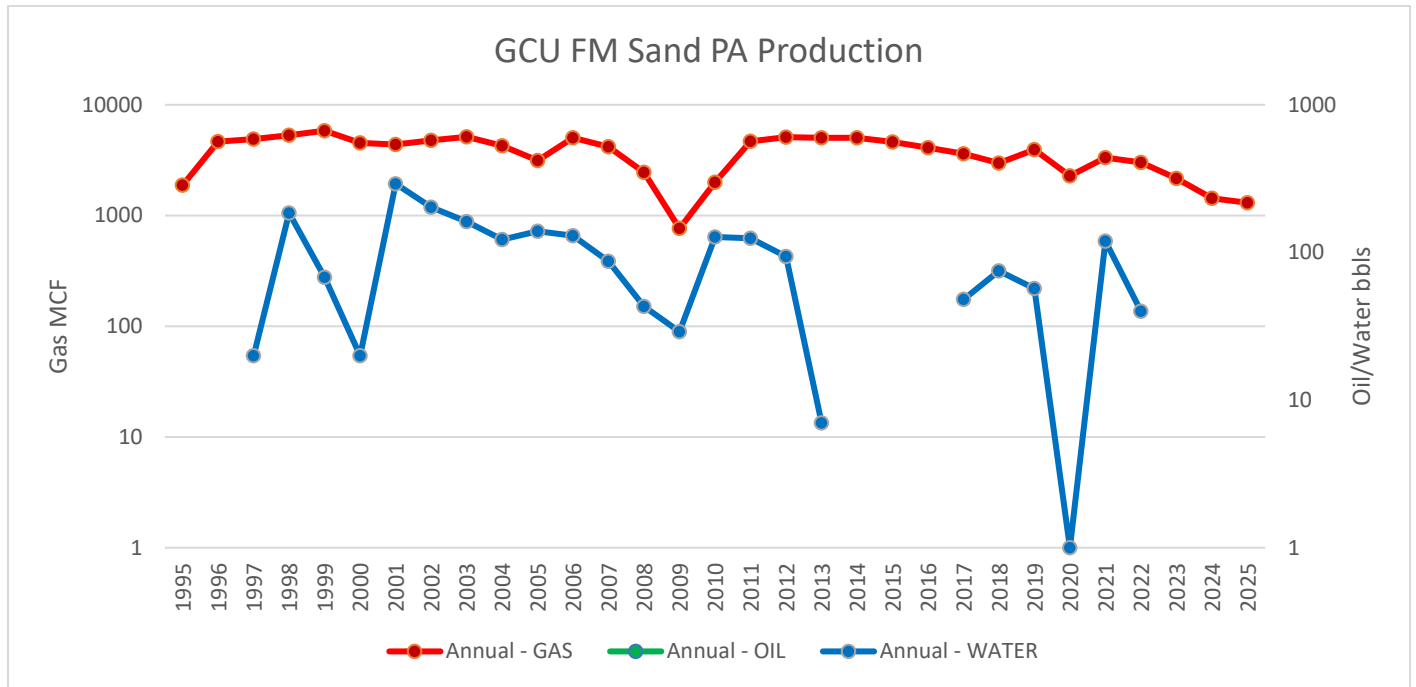

### MAPS OF PARTICIPATING AREAS

#### DAKOTA PARTICIPATING AREA NMNM 078391C

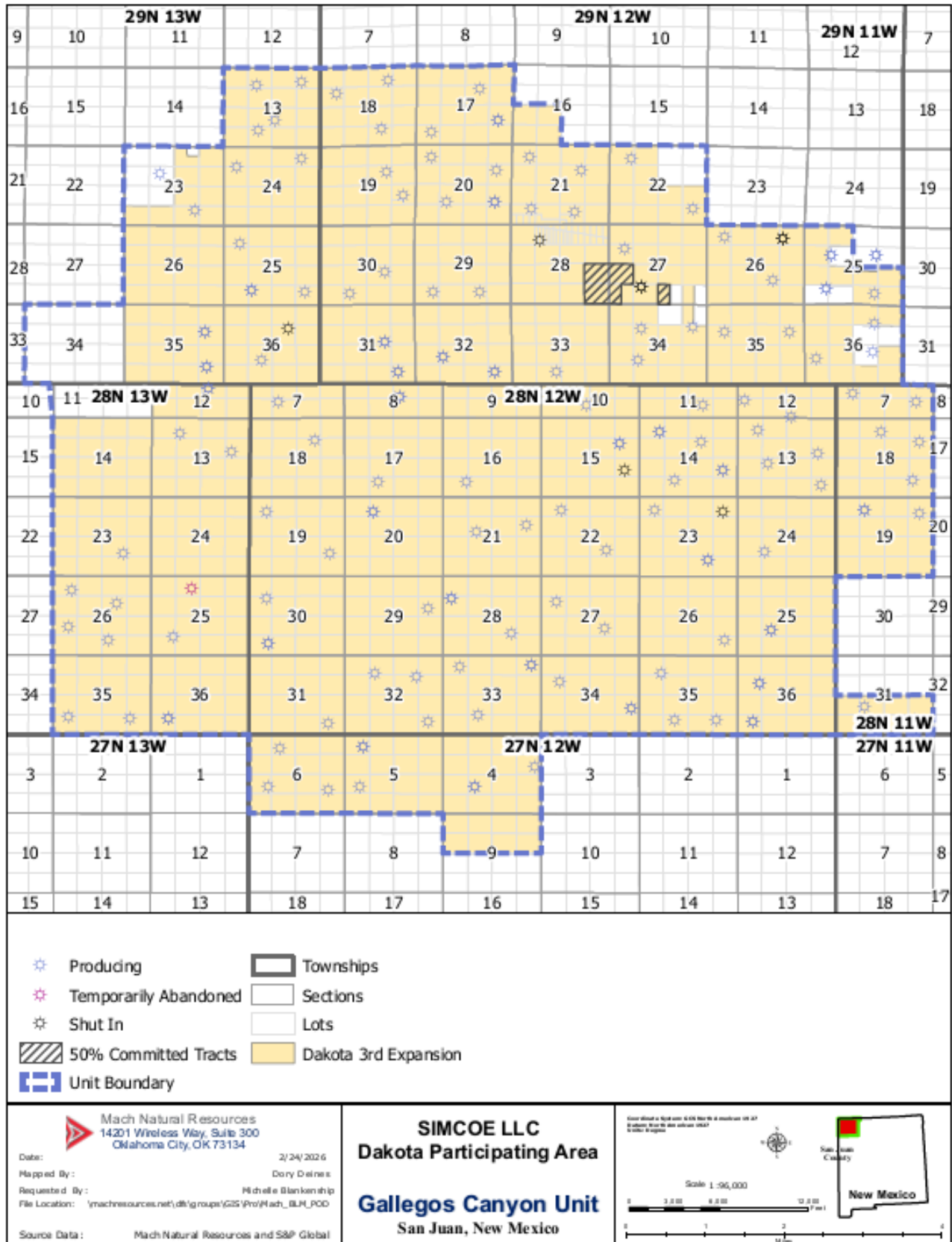

PICTURED CLIFFS PARTICIPATING AREA  
NMNM 078391A

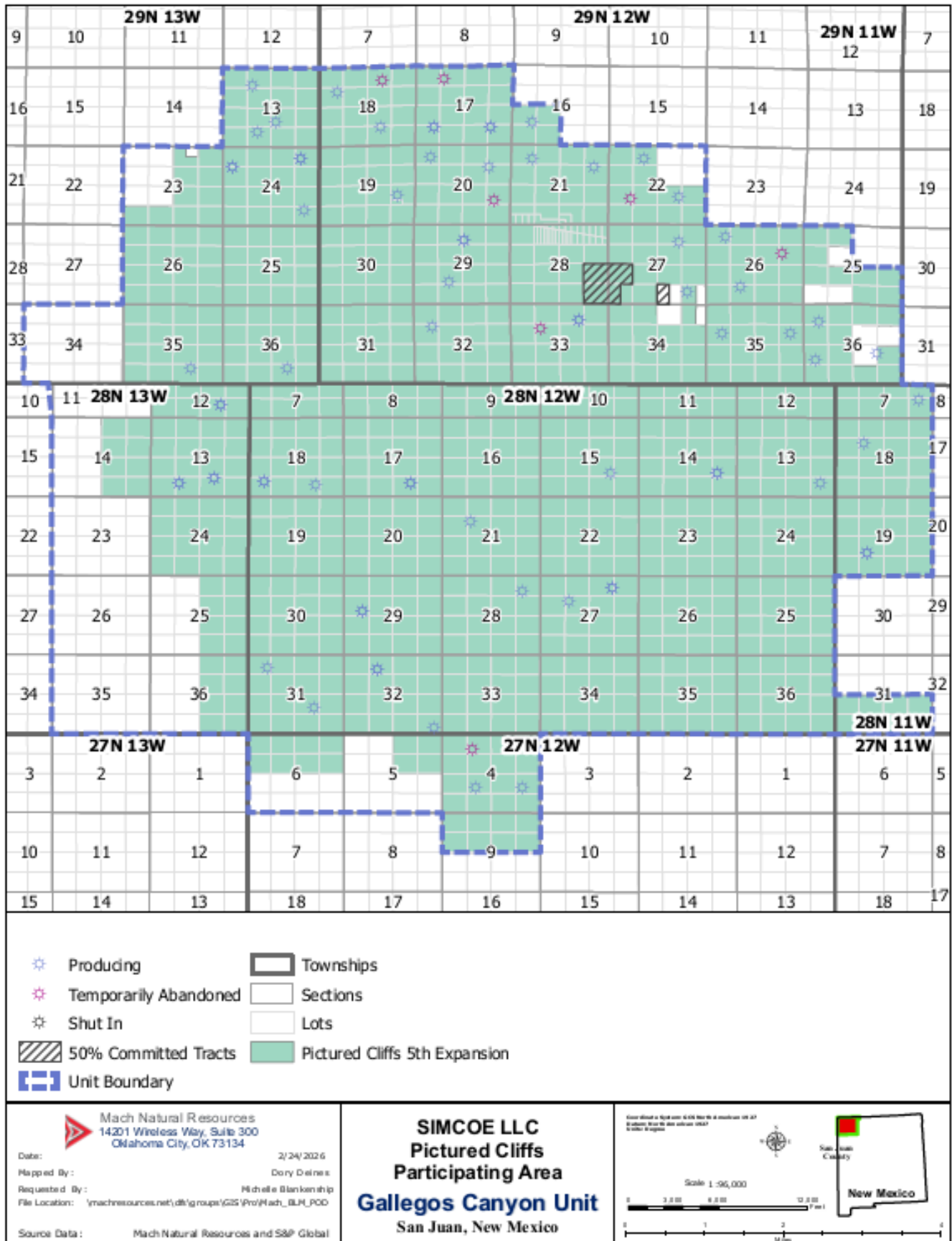

### FRUITLAND COAL PARTICIPATING AREA NMNM 078391M

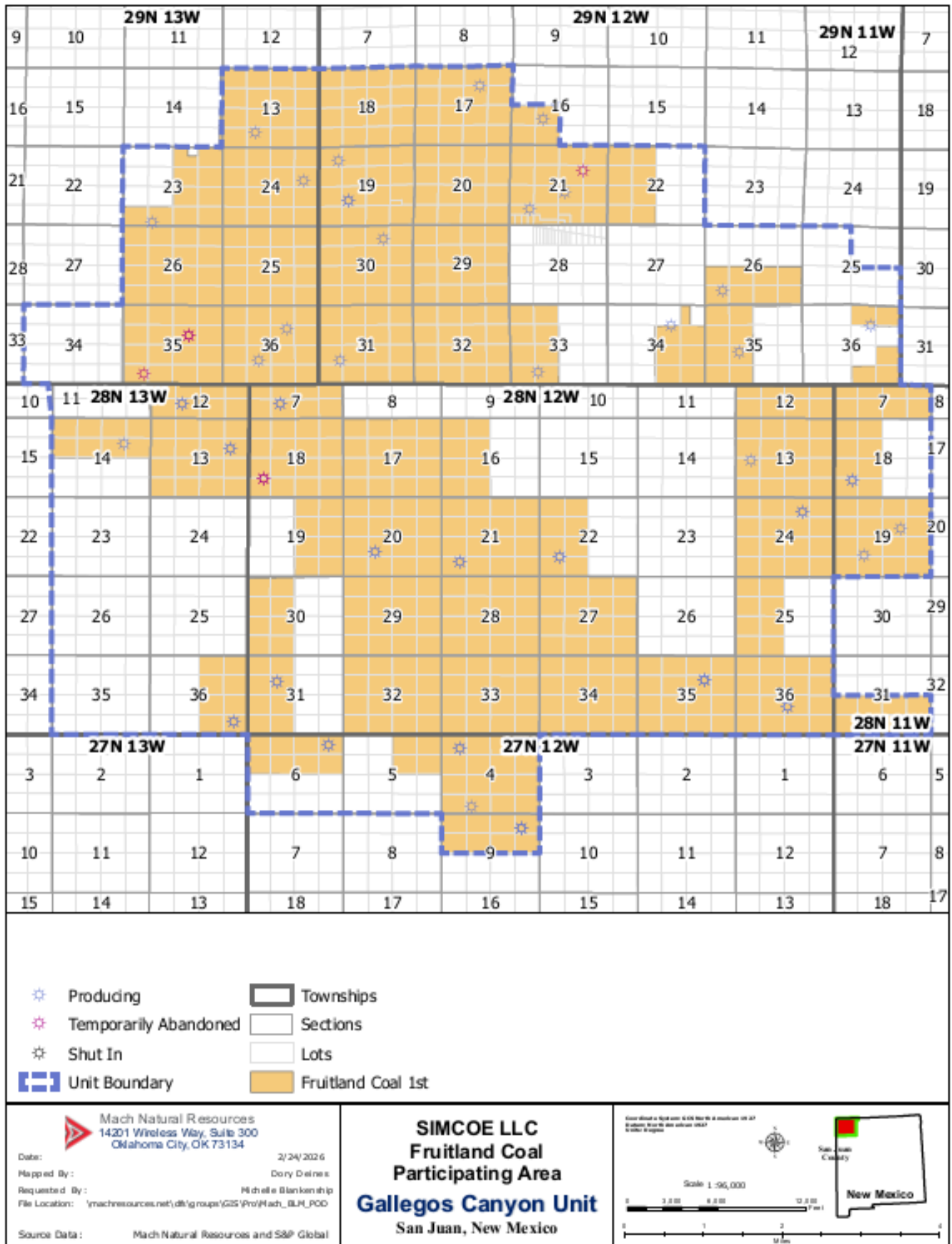

### GALLUP PARTICIPATING AREAS

Gallup "A": NMNM 078391B, Gallup "B": NMNM 078391D, Gallup "D": NMNM 078391F

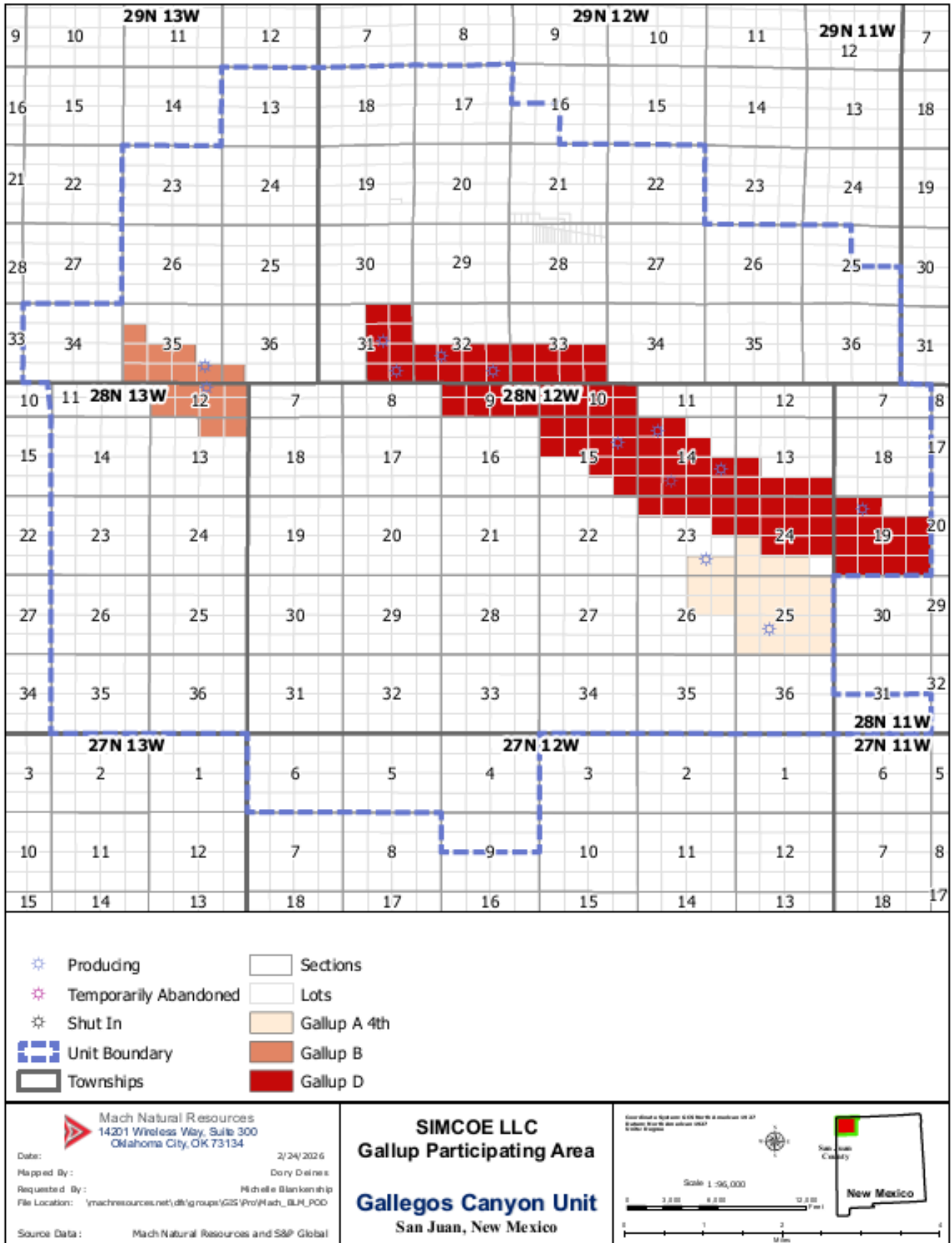

### FRUITLAND SAND PARTICIPATING AREAS

FS "A": NMNM 078391G, FS "B": NMNM 078391H, FS "C": NMNM 078391I, FS "E": NMNM 078391L

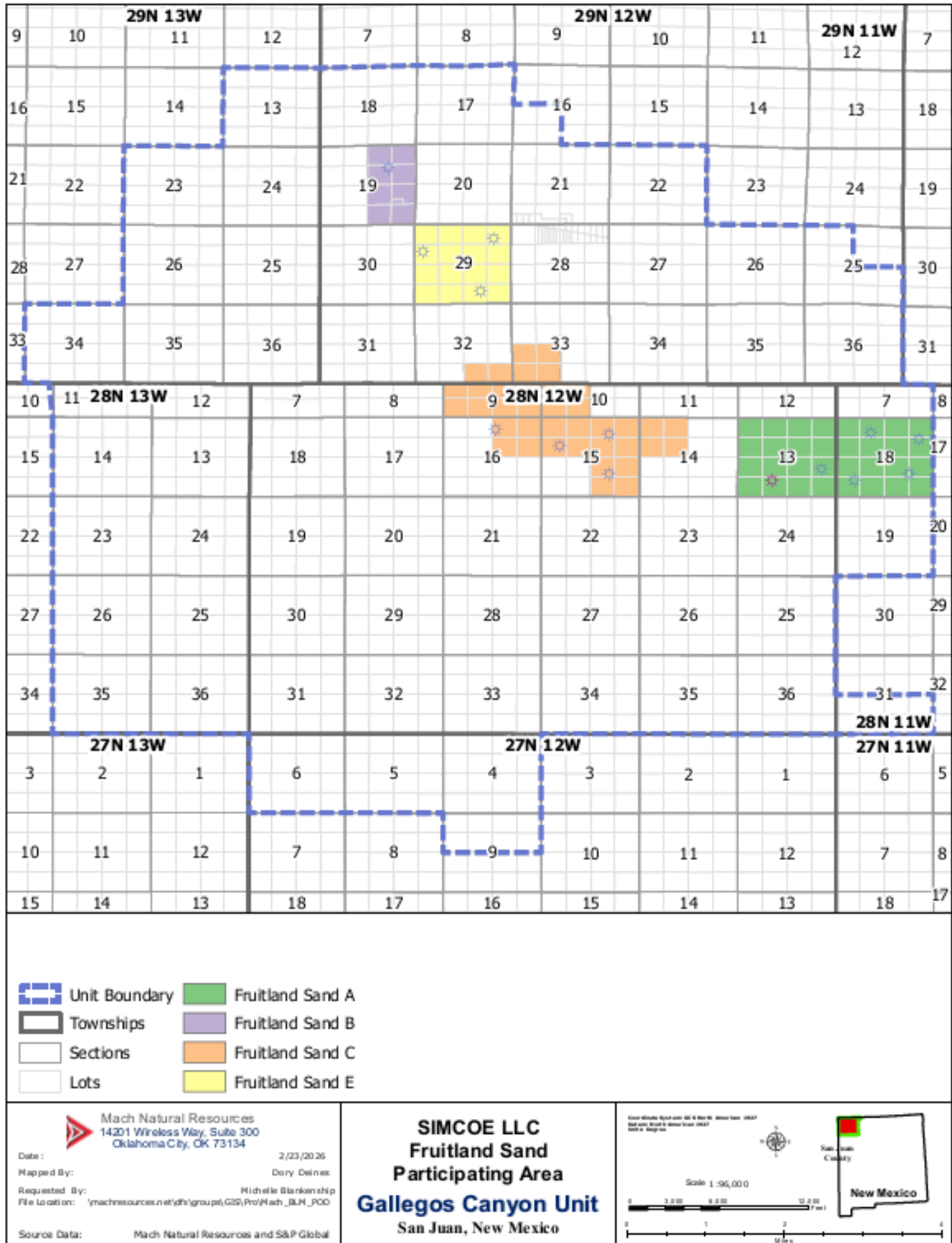

FARMINGTON SAND PARTICIPATING AREA  
NMNM 078391J

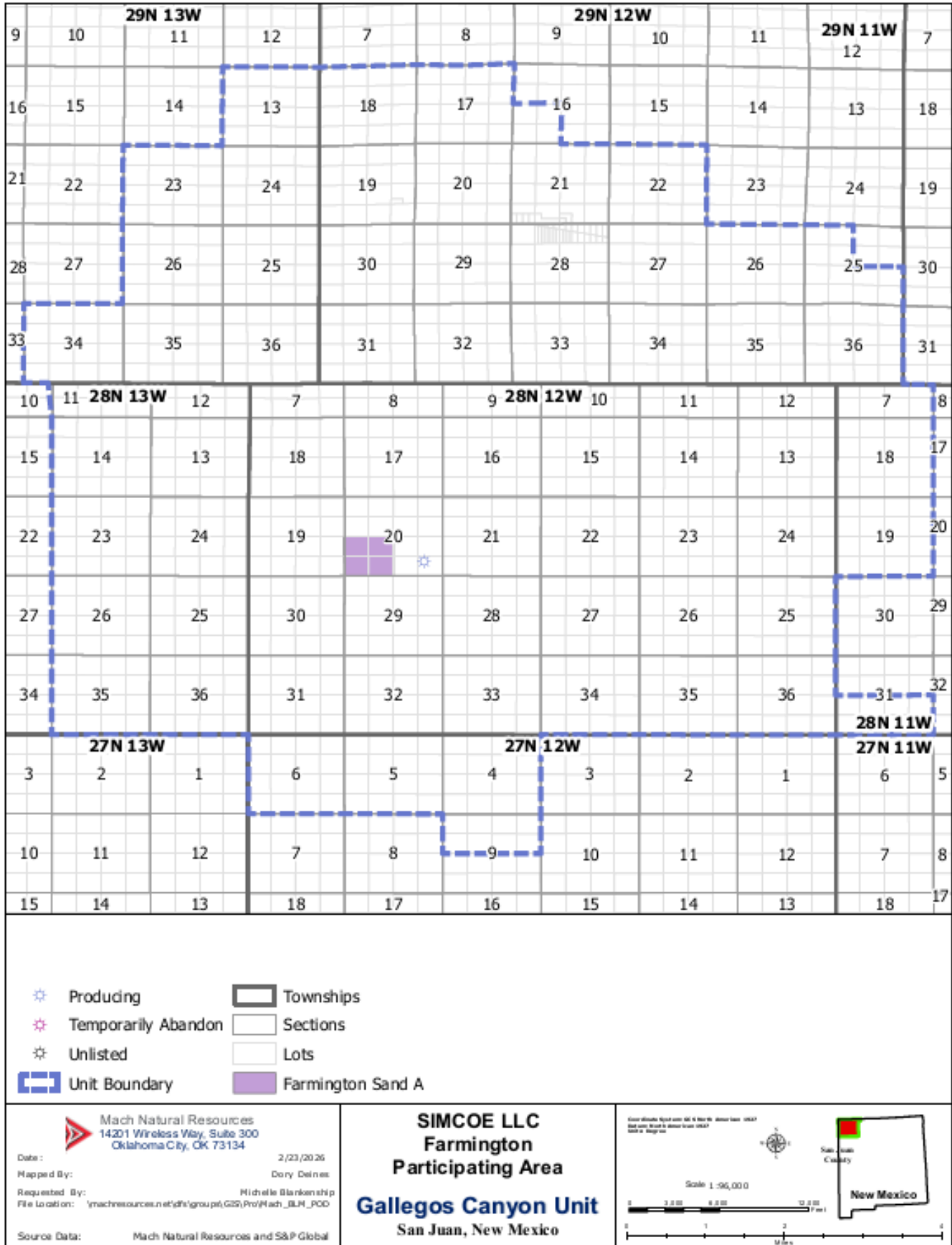

### GCU Lease Map

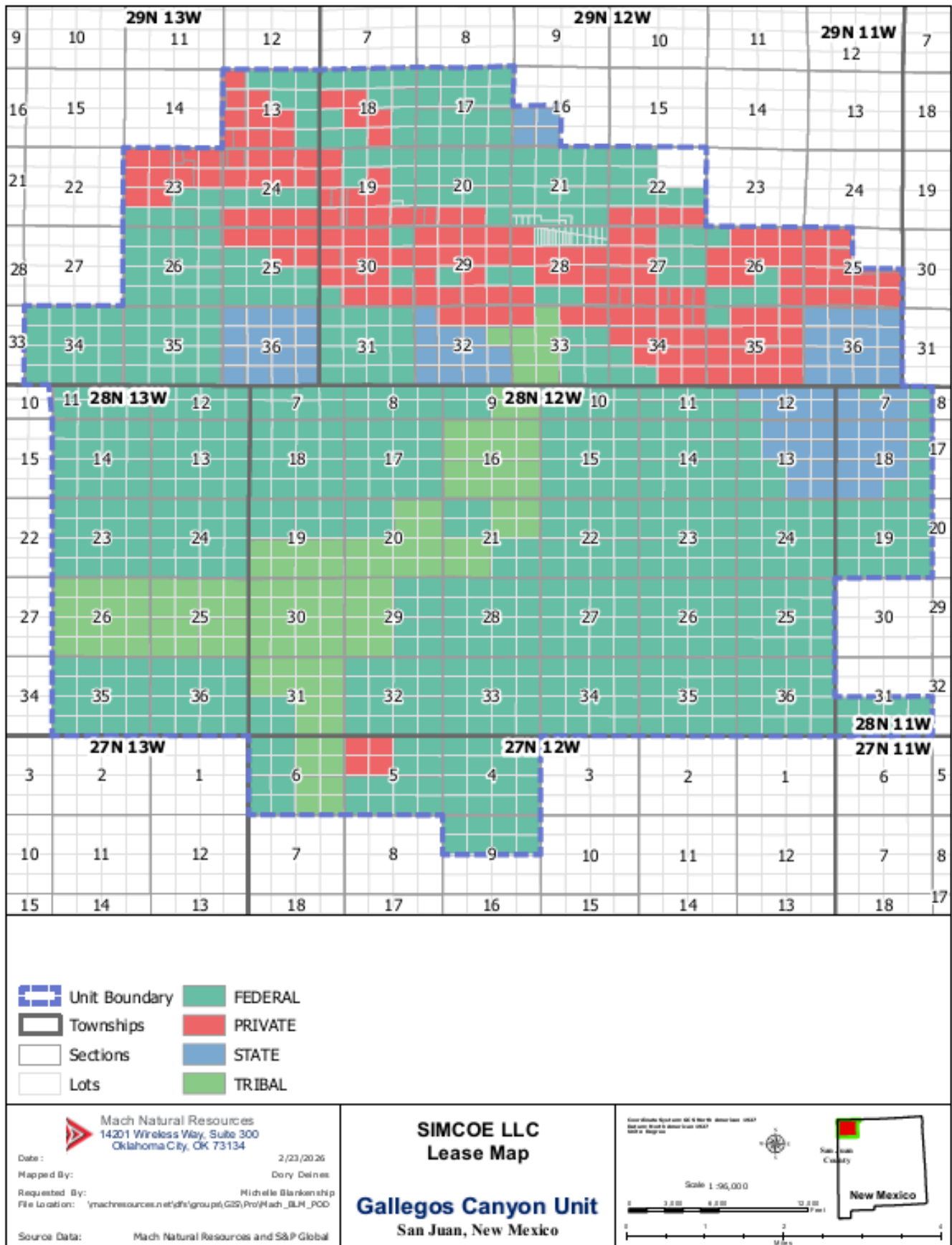

\*Tribal leases are Navajo

### GCU BOUNDARY MAP WITH TRACTS

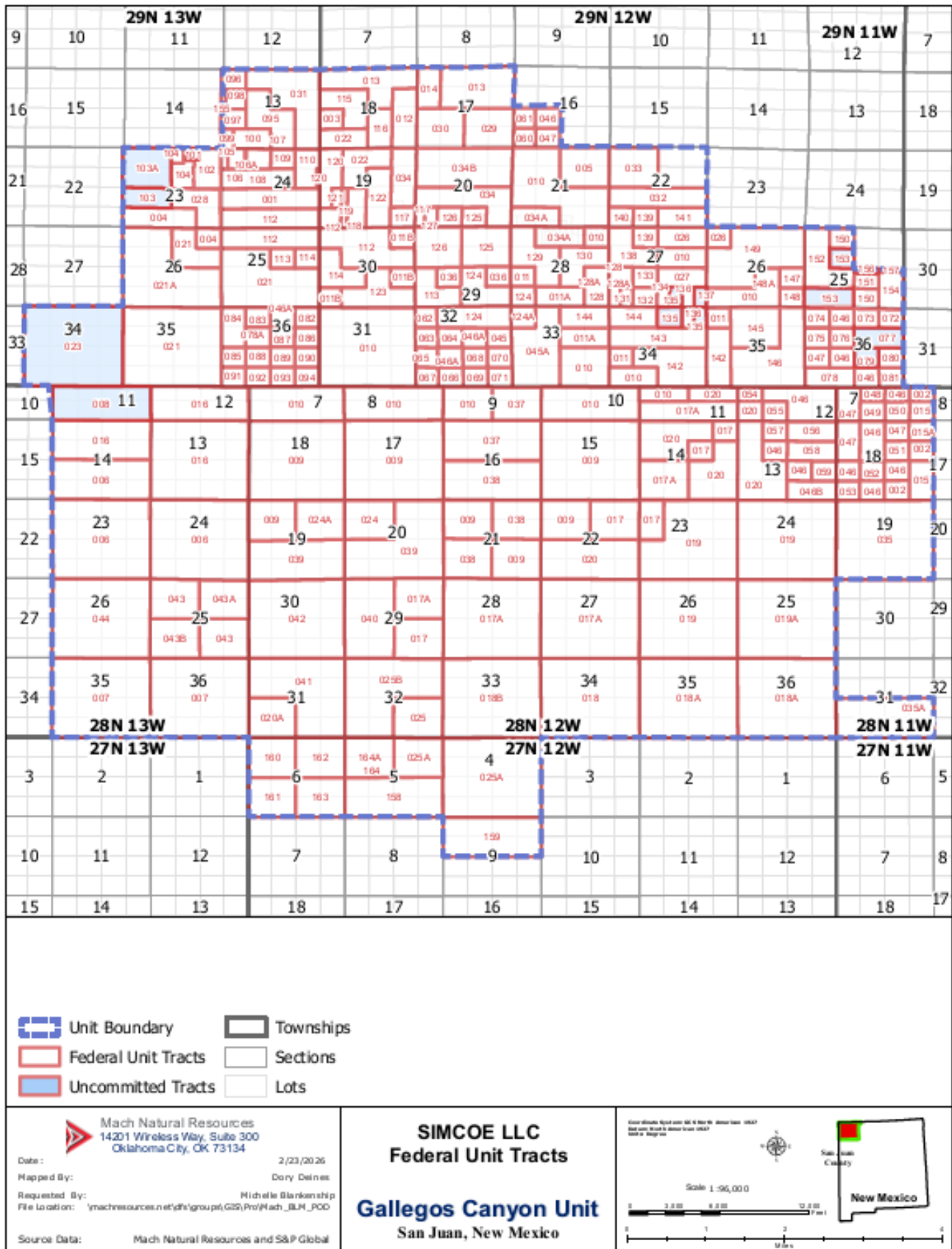

100% Non-Committed Tracts: 8, 23, 77, 79, 101, 103, 103A, 135, 137, 153, 156  
 50% Non-Committed Tracts: 128A, 134, 148A

### GCU INFRASTRUCTURE MAP

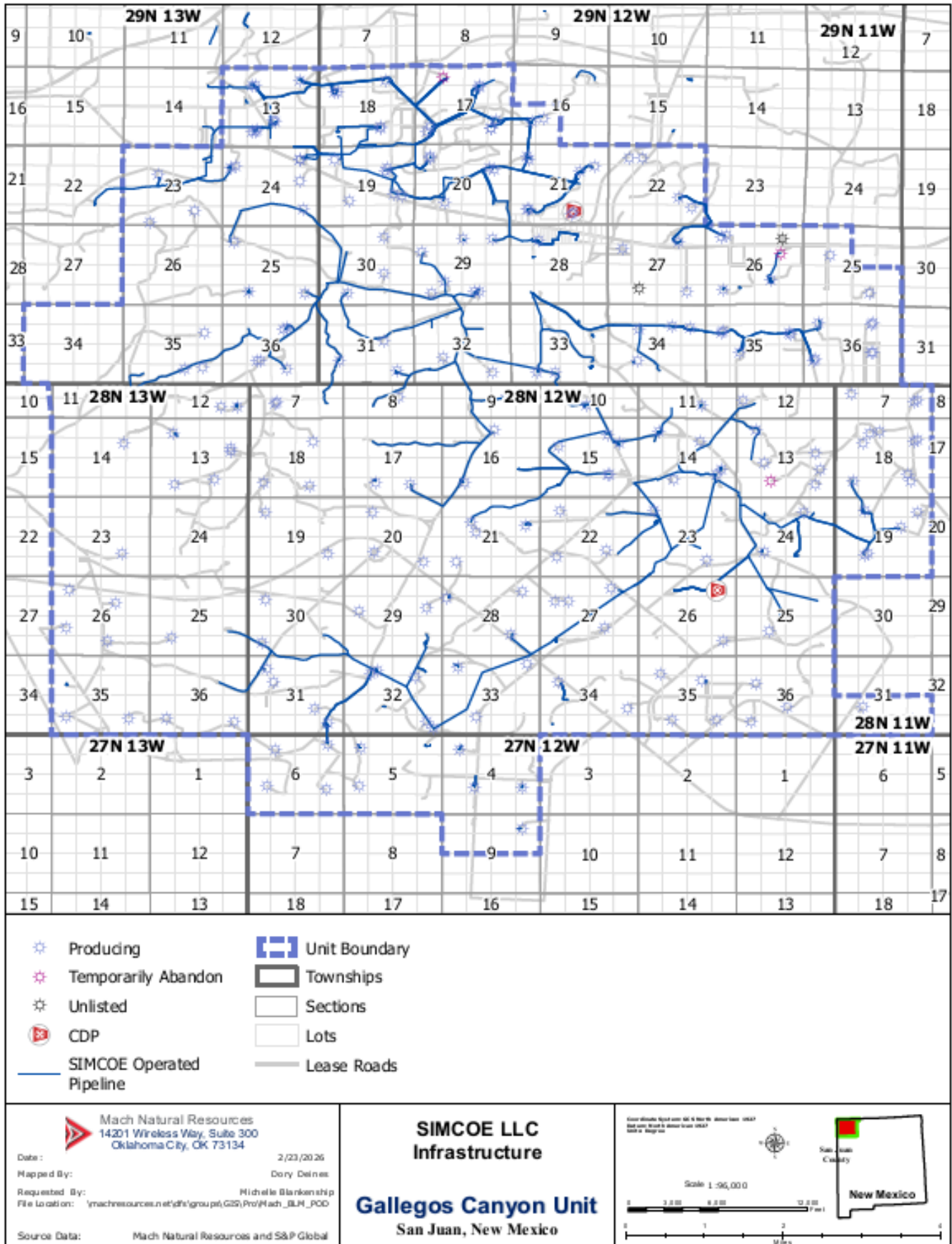

Sante Fe Main Office  
Phone: (505) 476-3441

General Information  
Phone: (505) 629-6116

Online Phone Directory  
<https://www.emnrd.nm.gov/ocd/contact-us>

**State of New Mexico**  
**Energy, Minerals and Natural Resources**  
**Oil Conservation Division**  
**1220 S. St Francis Dr.**  
**Santa Fe, NM 87505**

CONDITIONS

Action 565678

**CONDITIONS**

Operator: SIMCOE LLC 1199 Main Ave., Suite 101 Durango, CO 81301	OGRID: 329736
	Action Number: 565678
	Action Type: [HEAR] Order Compliance/Progress Report (ORDER COMPLIANCE REPORT)

**CONDITIONS**

Created By	Condition	Condition Date
dmcclure	ACCEPTED FOR RECORD	4/8/2026